

VICINITY MAP

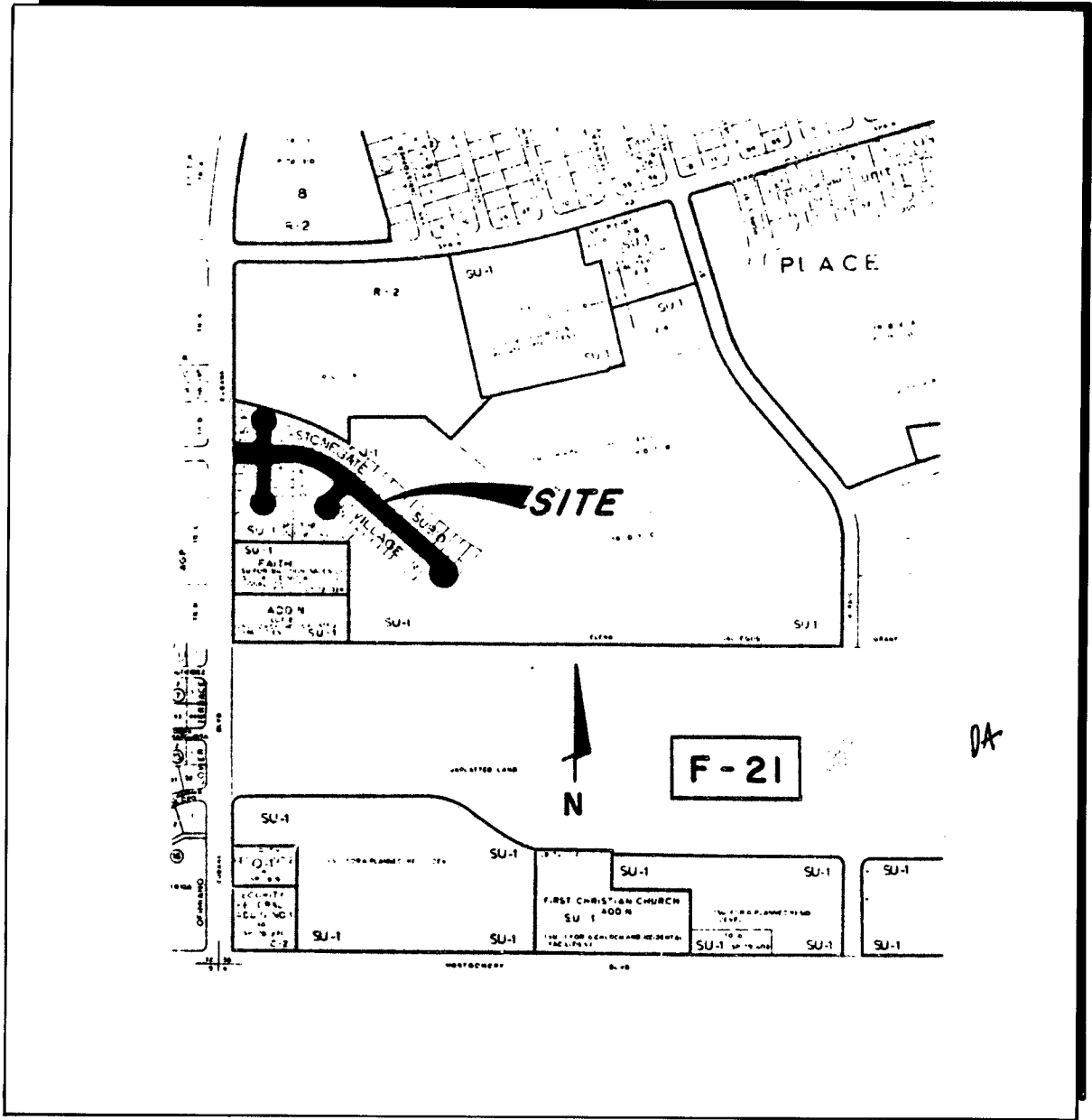

INDEX TO DRAWINGS

1. COVER SHEET
2. STORM SEWER PLAN & PROFILE

StoneGate Village

NOTICE TO CONTRACTORS

1. New Mexico Standard Specifications for Public Works Construction -1979 Edition will be referred to hereon as the "Standard Specification".
 2. All work detailed on these plans to be performed under contract shall, except as otherwise stated or provided for hereon, be constructed in accordance with "Contract Documents for City-Wide Utilities and Cash Paving No. 30 and the Standard Specification."
- Backfill compaction shall be according to specified street use.
- Tack coat requirements shall be determined by the City Engineer.
- Two working days prior to any excavation, contractor must contact Line Locating Service, 765-1234, for location of existing utilities.
- Prior to construction, the contractor shall excavate and verify the horizontal and vertical locations of all obstructions. Should a conflict exist, the contractor shall notify the engineer or surveyor so that the conflict can be resolved with a minimum amount of delay.

APPROVED FOR CONSTRUCTION BY

Richard S. Heller
CITY ENGINEER

9/9/82 36 1449101821
DATE

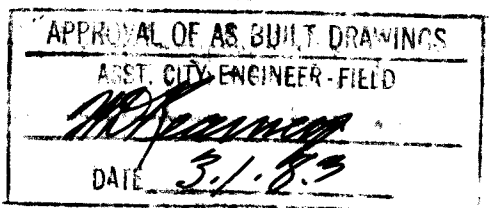

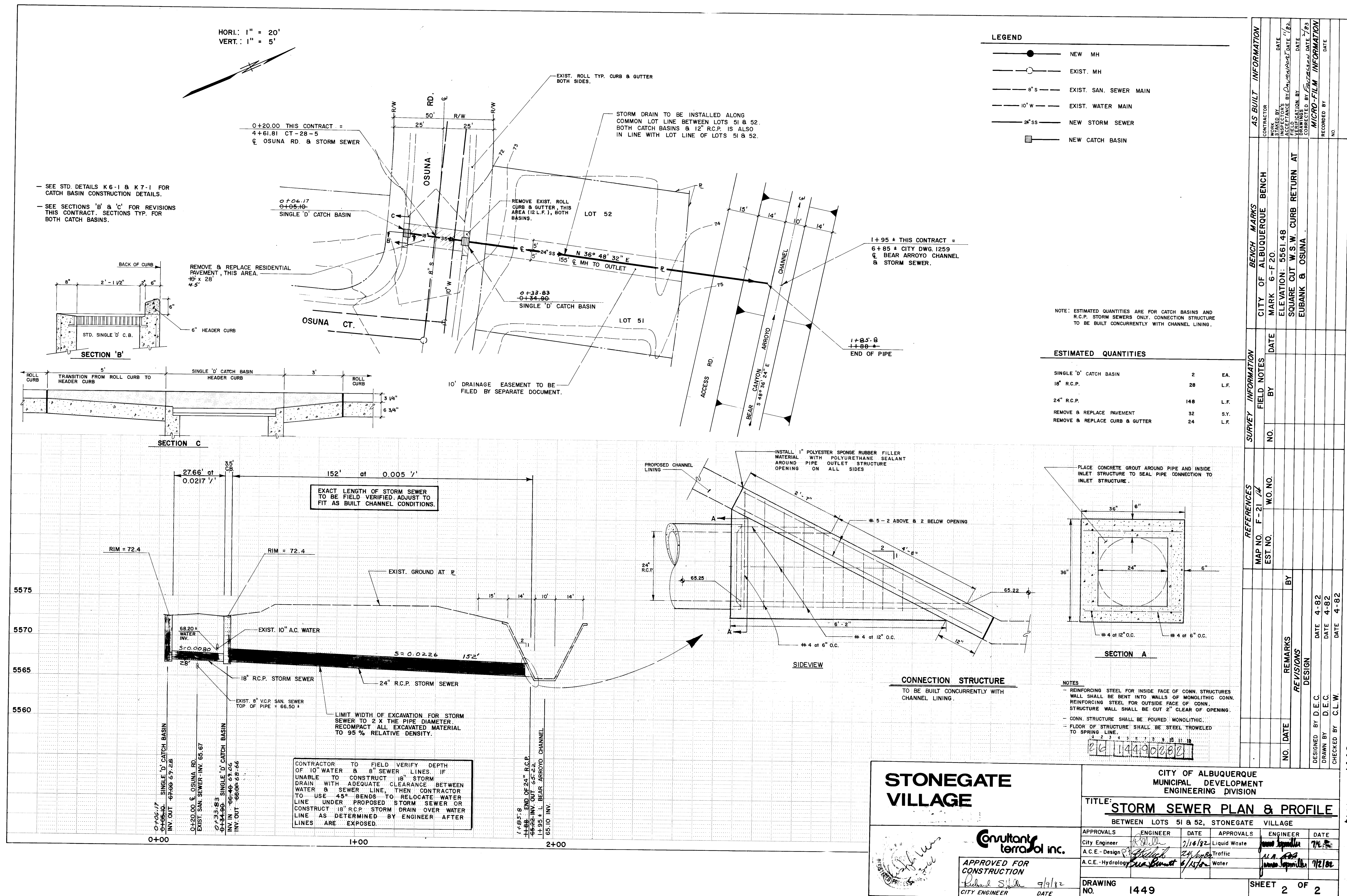

1449