



AMENDMENT TO GRANT OF EASEMENT  
CONCERNING THE CONSTRUCTION, MAINTENANCE, AND  
PUBLIC USE OF A BIKEWAY AND RELATED STRUCTURES

This indenture made and executed this 24<sup>th</sup> day of March, 1984, by and between the Albuquerque Academy, in the County of Bernalillo and State of New Mexico, hereinafter called the "Grantor" and the City of Albuquerque, New Mexico, a municipal corporation, hereinafter called the "Grantee".

It is the intention of the Grantor and Grantee that this indenture amend that certain instrument entitled GRANT OF EASEMENT CONCERNING THE CONSTRUCTION, MAINTENANCE, AND PUBLIC USE OF A BIKEWAY AND RELATED STRUCTURES which was entered into, made and executed by the Grantor and Grantee on September 8, 1983, and is recorded in the real property records of the Bernalillo County Clerk at Book C-19 and Page 68-1, Document Number 82-3121. Except as specifically amended herein, said GRANT OF EASEMENT CONCERNING THE CONSTRUCTION, MAINTENANCE, AND PUBLIC USE OF A BIKEWAY AND RELATED STRUCTURES shall remain in full force and effect as to all its terms.

A portion of the legal land description of the GRANT OF EASEMENT CONCERNING THE CONSTRUCTION, MAINTENANCE, AND PUBLIC USE OF A BIKEWAY AND RELATED STRUCTURES is hereby amended to include the land described as follows:

A certain tract of land situate in the west 1/2 of Section 30, T11N, R4E, N.M.P.M., Bernalillo County, New Mexico, being a westerly portion of Tract A-1-A, ALBUQUERQUE ACADEMY CAMPUS, as the same is shown and designated on the plat filed in the office of the County Clerk of Bernalillo County, New Mexico on September 23, 1983, and also being a portion of Wyoming Boulevard, N.E. right-of-way said tract being six (6) feet to the left and six (6) feet to the right of the following described centerline and being more particularly described by New Mexico State Plane Grid Bearings (Central Zone) and ground distances as follows:

BEGINNING at the most southerly point on the herein described centerline, said point being a point of curvature within the existing right-of-way of Wyoming Boulevard, N.E.; whence the ACS Control Station 11-E19, a brass cap (having New Mexico State Plane Grid Coordinates, Central Zone: X=409,394.95, Y=1,508,657.39), bears

S42°48'26"E, 3059 feet and from said point of beginning running thence, 15.85 feet along the arc of a curve to the right having a radius of 77.63 feet and a chord bearing N15°51'56"W, 15.82 feet to a point on the easterly right-of-way of said Wyoming Boulevard, N.E., thence leaving said right-of-way and continuing along said centerline, 11.85 feet along the arc of a curve to the right having a radius of 77.63 feet and a chord bearing N05°38'39"W, 11.84 feet to a point of tangency; thence, N01°16'16"W, 37.50 feet to a point of curvature; thence, 42.41 feet along the arc of a curve to the left having a radius of 173.00 feet and a chord bearing N08°17'40"W, 42.31 feet to a point of reverse curvature; thence, 59.05 feet along the arc of a curve to the right having a radius of 1423.00 feet and a chord bearing N14°07'44"W, 59.04 feet to a point of reverse curvature; thence, 42.41 feet along the arc of a curve to the left having a radius of 173.00 feet and a chord bearing N19°57'49"W, 42.31 feet to a point of tangency; thence, N26°59'12"W, 1.70 feet to a point of curvature; thence, 94.94 feet along the arc of a curve to the right having a radius of 131.71 feet and a chord bearing N06°20'09"W, 92.90 feet to the ending and most northerly point on the herein described centerline, whence the said ACS Control Station 11-E19 bears S39°58'48"E, 3316.73 feet

Tract contains 0.0842 acre, more or less.

IN WITNESS WHEREOF, this Grant is duly executed by the parties hereto.

CITY OF ALBUQUERQUE,  
a municipal corporation

By: Frank A. Kleinhenz  
Frank A. Kleinhenz  
Chief Administrative Officer

ATTEST:

Cynthia L. Garcia  
City Clerk

-2-

ALBUQUERQUE ACADEMY

By: Frank A. Kleinhenz  
Its: Chief Administrative Officer

Recommended by the  
Transportation Department:

Joseph A. Marts

Reviewed by the  
Legal Department:

John P. Foy

ACKNOWLEDGEMENTS

STATE OF NEW MEXICO )  
 ) ss  
COUNTY OF BERNALILLO )

The foregoing instrument was acknowledged before me on this 24<sup>th</sup> day of March, 1984, by Frank A. Kleinhenz, Chief Administrative Officer of the City of Albuquerque, a municipal corporation, on behalf of said corporation.

John P. Foy  
Notary Public

My Commission Expires:

12/12/84

STATE OF NEW MEXICO )  
 ) ss  
COUNTY OF BERNALILLO )

The foregoing instrument was acknowledged before me on this 24<sup>th</sup> day of March, 1984, by Frank A. Kleinhenz, Chief Administrative Officer of the Albuquerque Academy, on behalf of said entity.

Marvin J. Duran  
Notary Public

My Commission Expires:

8/25/87

-4-

LASON 1-505-344-9404  
BEST COPY AVAILABLE

EXHIBIT MAP  
SCALE 1"=40'

CURVE DATA

NR.	RADIUS	ARC	CHORD	DELTA	TANGENT
C1	25.00'	40.54'	36.24'	95°54'40"	26.30'
C2	1435.00'	83.37'	93.36'	83°45'09"	47.00'
C3	160.00'	40.98'	40.87'	14°40'34"	20.60'
C4	140.00'	44.01'	43.83'	18°00'36"	22.19'
C5	1447.00'	318.02'	317.38'	12°35'33"	159.65'
C6	25.00'	40.40'	36.15'	92°35'43"	26.16'
C7	140.00'	42.13'	41.97'	17°14'24"	21.62'
C8	160.00'	39.23'	39.13'	14°02'47"	19.71'
C9	1436.00'	59.59'	59.58'	02°22'39"	29.80'
C10	140.00'	36.82'	36.72'	15°04'12"	18.52'
C11	1447.00'	216.04'	215.84'	08°33'16"	108.22'
C12	140.00'	36.82'	36.72'	15°04'12"	18.52'
C13	270.00'	78.04'	77.77'	16°33'40"	39.30'
C14	25.00'	24.31'	23.97'	52°43'15"	13.61'
C15	25.00'	16.09'	15.81'	36°52'26"	8.33'
C16	77.63'	15.85'	15.82'	11°41'46"	7.95'
C17	77.63'	11.85'	11.84'	08°44'45"	5.94'
C18	77.63'	27.70'	27.55'	20°26'34"	14.00'
C19	173.00'	42.41'	42.31'	14°02'47"	21.31'
C20	1423.00'	59.05'	59.04'	02°22'39"	29.83'
C21	131.71'	94.94'	92.90'	41°18'06"	49.64'

DESCRIPTION

A certain tract of land situate in the west 1/2 of Section 30, T11N, R4E, N.M.P.M., Bernalillo County, New Mexico, being a westerly portion of Tract A-1-A, ALBUQUERQUE ACADEMY CAMPUS, as the same is shown and designated on the plat filed in the office of the County Clerk of Bernalillo County, New Mexico on September 23, 1983, and also being a portion of Wyoming Boulevard, N.E. right-of-way said tract being six (6) feet to the left and six (6) feet to the right of the following described centerline and being more particularly described by New Mexico State Plane Grid Bearings (Central Zone) and ground distances as follows:

BEGINNING at the most southerly point on the herein described centerline, said point being a point of curvature within the existing right-of-way of Wyoming Boulevard, N.E.; whence the ACS Control Station 11-E19, a brass cap (having New Mexico State Plane Grid Coordinates, Central Zone: X=409,394.95, Y=1,508,657.39), bears S42°48'26"E, 3059.09 feet and from said point of beginning running thence, 15.85 feet along the arc of a curve to the right having a radius of 77.63 feet and a chord bearing N15°51'56"W, 15.82 feet to a point on the easterly right-of-way of said Wyoming Boulevard, N.E., thence leaving said right-of-way and continuing along said centerline, 11.85 feet along the arc of a curve to the right having a radius of 77.63 feet and a chord bearing N05°38'39"W, 11.84 feet to a point of tangency; thence, N01°16'16"W, 37.50 feet to a point of curvature; thence, 42.41 feet along the arc of a curve to the left having a radius of 173.00 feet and a chord bearing N08°17'40"W, 42.31 feet to a point of reverse curvature; thence, 59.05 feet along the arc of a curve to the right having a radius of 1423.00 feet and a chord bearing N14°07'44"W, 59.04 feet to a point of reverse curvature; thence, 42.41 feet along the arc of a curve to the left having a radius of 173.00 feet and a chord bearing N19°57'49"W, 42.31 feet to a point of tangency; thence, N26°59'12"W, 1.70 feet to a point of curvature; thence, 94.94 feet along the arc of a curve to the right having a radius of 131.71 feet and a chord bearing N06°20'09"W, 92.90 feet to the ending and most northerly point on the herein described centerline, whence the said ACS Control Station 11-E19 bears S39°58'48"E, 3316.73 feet.

Tract contains 0.0842 acre, more or less.

Bohannon-Huston, Inc.  
4125 Carlisle Blvd., N.E.  
Albuquerque, NM 87107

January 24, 1984  
Job No. 3 136 9

A. Dwan Weaver  
A. Dwan Weaver  
N.M.P.L.S. No. 6544

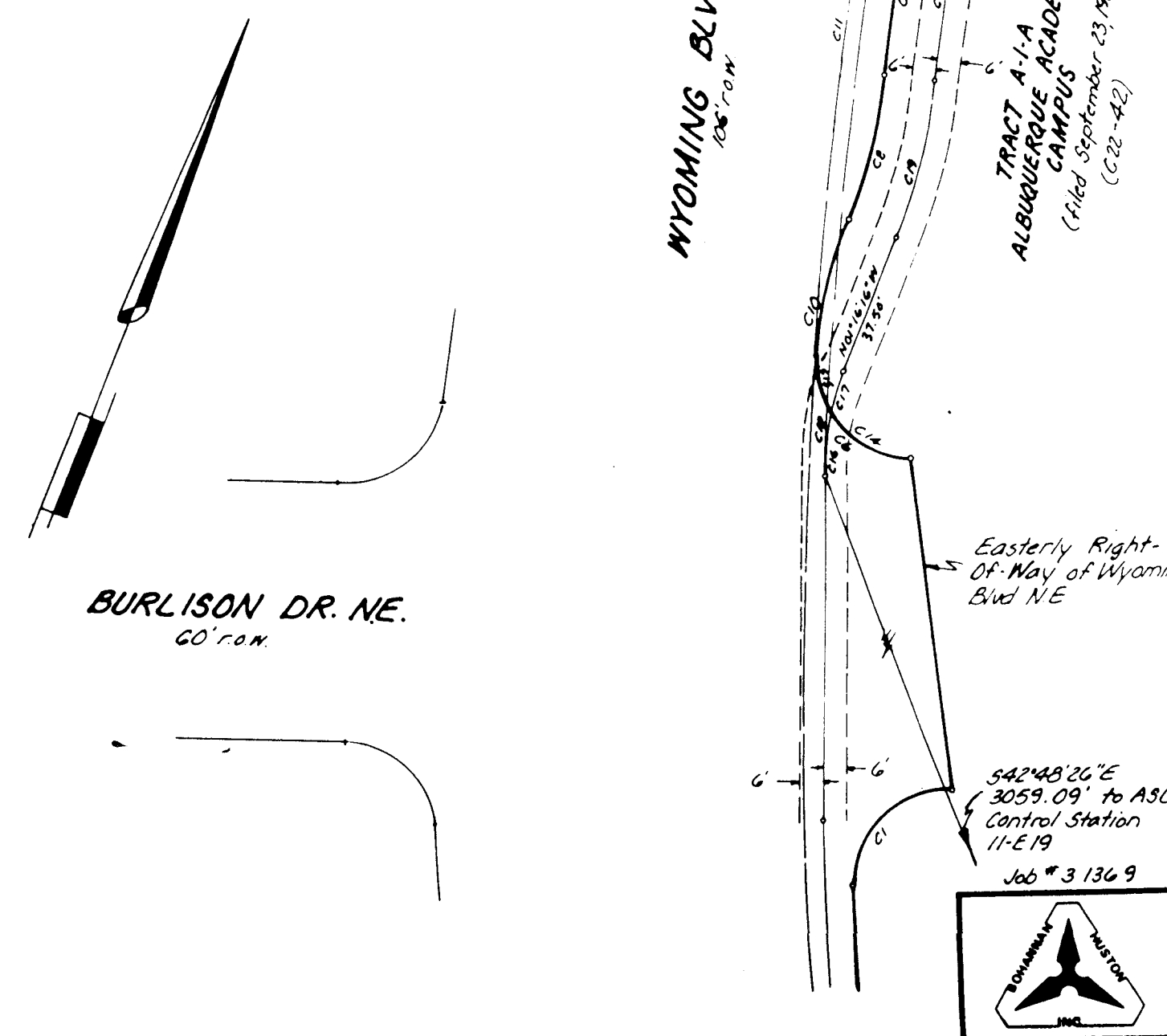
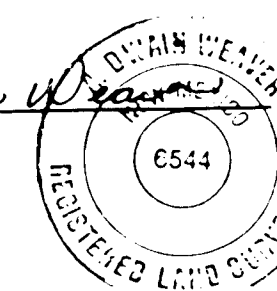

1 2 3 4 5 6 7 8 9 10 11 12  
26 154803 184

DRAWING NO. 1548 MAP NO. E-19 SHEET 3A OF 8





C22-42-3

SP No. 07-05-0104

93 05010

REPLAT OF

TRACT A-1 and TRACT A-2  
ALBUQUERQUE ACADEMY CAMPUS  
(FILED JANUARY 20, 1982)

IN  
SECTION 29 & 30, T11N, R4E, N.M.P.M.  
NOW COMPRISING

TRACT A-1-A and TRACT A-2-A  
ALBUQUERQUE ACADEMY CAMPUS

ALBUQUERQUE, NEW MEXICO  
SCALE: 1"=300'  
JULY 1983

CURVE DATA FOR THIS SHEET ONLY

NR.	RADIUS	ARC	CHORD	DELTA	TANGENT
C1	436.51'	142.44'	141.81'	18°41'49"	71.86'
C2	706.83'	248.20'	246.93'	20°07'08"	125.39'
C3	407.44'	161.51'	160.46'	22°42'44"	81.83'
C4	25.00'	38.53'	34.83'	88°17'50"	24.27'
C5	2228.09'	168.46'	168.42'	04°19'55"	84.27'
C6	1447.00'	168.40'	1589.22'	66°37'00"	950.80'
C7	1353.00'	226.68'	226.42'	09°35'58"	113.41'
C8	500.00'	226.64'	224.71'	25°58'16"	115.30'
C9	500.00'	158.71'	158.05'	18°11'14"	80.03'
C10	270.00'	78.04'	77.77'	16°33'40"	39.30'
C11	1000.00'	239.95'	239.41'	13°45'00"	120.00'
C12	1447.00'	443.23'	441.50'	17°33'01"	223.37'
C13	1447.00'	705.10'	698.15'	27°55'10"	359.70'

TANGENT DATA FOR THIS SHEET ONLY

NR.	DISTANCE	BEARING
T1	6.59'	S89°54'38"E
T2	264.03'	S84°27'43"E
T3	317.72'	S81°27'45"E
T4	313.27'	S88°48'09"E
T5	119.40'	S41°35'36"E
T6	137.00'	S21°28'22"E
T7	164.33'	S44°11'06"E
T8	144.64'	S68°52'54"E
T9	166.53'	S31°19'57"E
T10	199.82'	S82°51'12"E
T11	64.46'	N63°06'59"E
T12	131.46'	N41°33'20"E
T13	11.26'	N63°06'13"E
T14	142.78'	N8°39'52"E
T15	99.50'	S04°20'12"E
T16	244.56'	S80°32'08"E
T17	25.00'	N85°39'53"E

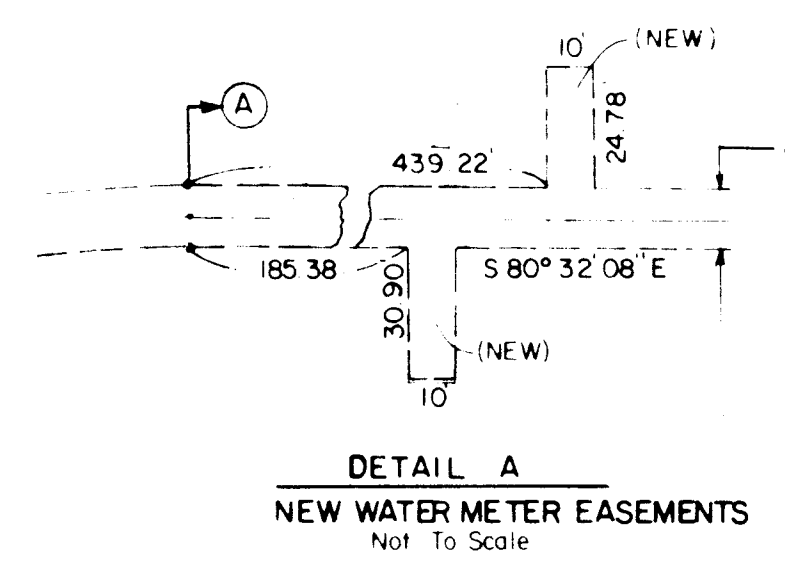
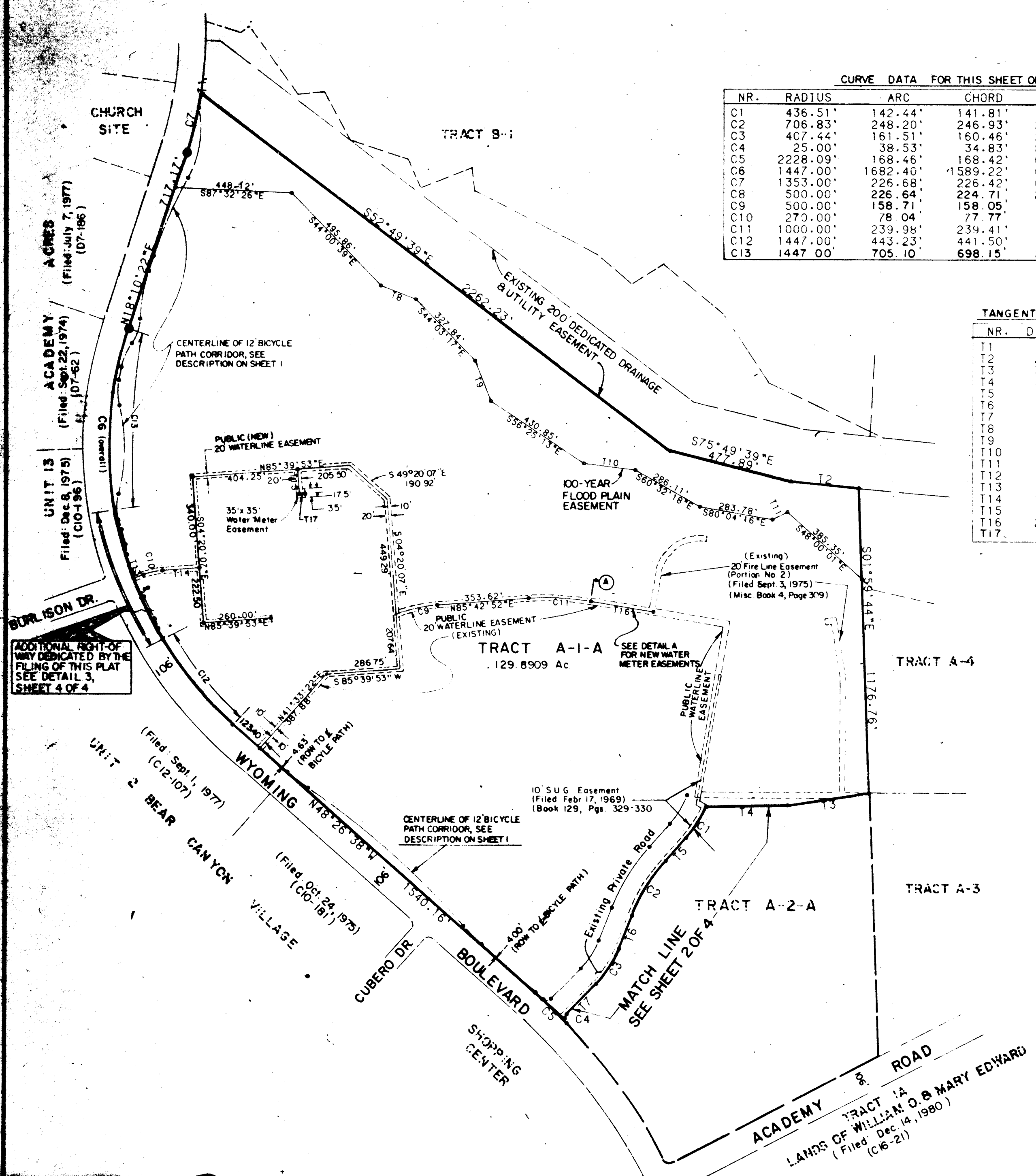

SURVEYOR'S CERTIFICATION

I, Carlos P. Pacheco, under the laws of New Mexico, certify that I am a registered Land Surveyor, and that this plat was prepared by me or under my supervision from record documents, shows all easements of record, meets the minimum requirements for monumentation and surveys contained in the Albuquerque Subdivision Ordinance, and is true and accurate to the best of my knowledge and belief.

Carlos P. Pacheco July 7, 1983  
P.L.S. No. 7280  
New Mexico

SP-83-273

SHEET 3 OF 4 SHEETS

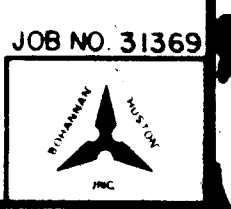

SP-83-273

C22-42-3

SP No. 07-05-0104

EAST RIGHT-OF-WAY

WYOMING

BOULEVARD

N E

CURVE DATA FOR THIS SHEET ONLY

NR.	RADIUS	ARC	CHORD	DELTA	TANGENT
C1	25.00'	40.54'	36.24'	92°54'40"	26.30'
C2	1435.00'	93.97'	93.96'	03°45'08"	47.00'
C3	140.00'	40.96'	40.86'	14°40'34"	20.65'
C4	140.00'	40.96'	40.86'	14°40'34"	20.65'
C5	1447.00'	318.02'	317.38'	12°35'33"	162.45'
C6	25.00'	40.40'	36.15'	92°35'43"	26.16'
C7	140.00'	42.13'	41.97'	17°14'24"	21.22'
C8	140.00'	39.23'	39.13'	14°02'47"	19.71'
C9	140.00'	39.23'	39.13'	14°02'47"	19.71'
C10	140.00'	36.82'	36.72'	15°02'39"	18.80'
C11	140.00'	216.04'	215.84'	08°33'16"	108.23'
C12	270.00'	78.04'	77.77'	16°33'40"	39.30'

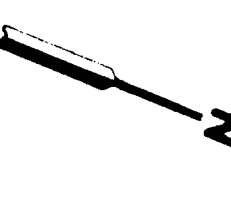
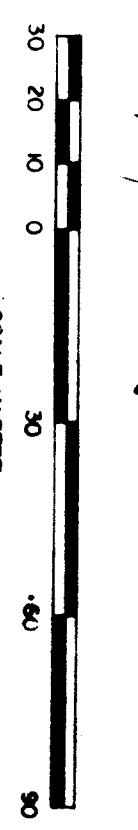

DETAIL 3

SHOWING THE ENTRANCE AND INTERSECTION OF WYOMING BLVD. AND CUBERO BLVD. AS REFERENCED ON SHEET 304-A.

REPLAT OF  
TRACT A-1 and TRACT A-2  
ALBUQUERQUE ACADEMY CAMPUS  
(FILED JANUARY 20, 1982)  
IN  
SECTION 29 & 30, T11N, R4E, N.M.P.M.  
NOW COMPRISING  
TRACT A-1-A and TRACT A-2-A  
ALBUQUERQUE ACADEMY CAMPUS  
ALBUQUERQUE, NEW MEXICO  
SCALE: 1"=300'  
JULY 1983

ADDENDUM  
NO. 4

DRAWING NO. 1548  
SHEET 3 OF 8

SURVEYOR'S CERTIFICATION

I, Carlos P. Pacheco, under the laws of New Mexico, certify that I am a registered Land Surveyor, and that this plat was prepared by me or under my supervision from record documents, shows all easements of record, meets the minimum requirements for monumentation and surveys contained in the Albuquerque Subdivision Ordinance, and is true and accurate to the best of my knowledge and belief.

Carlos P. Pacheco July 7, 1983  
P.L.S. No. 7280  
New Mexico





ALBUQUERQUE ACADEMY CAMPUS

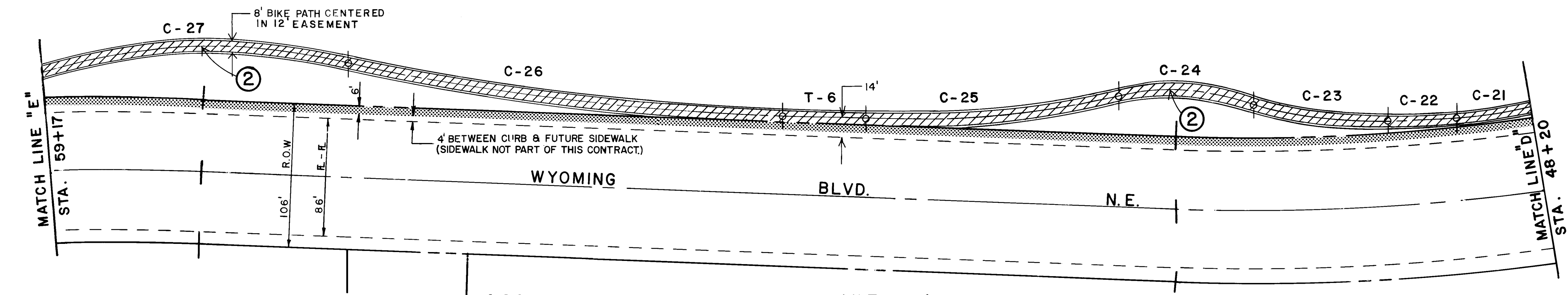

SCALE 1" = 50'

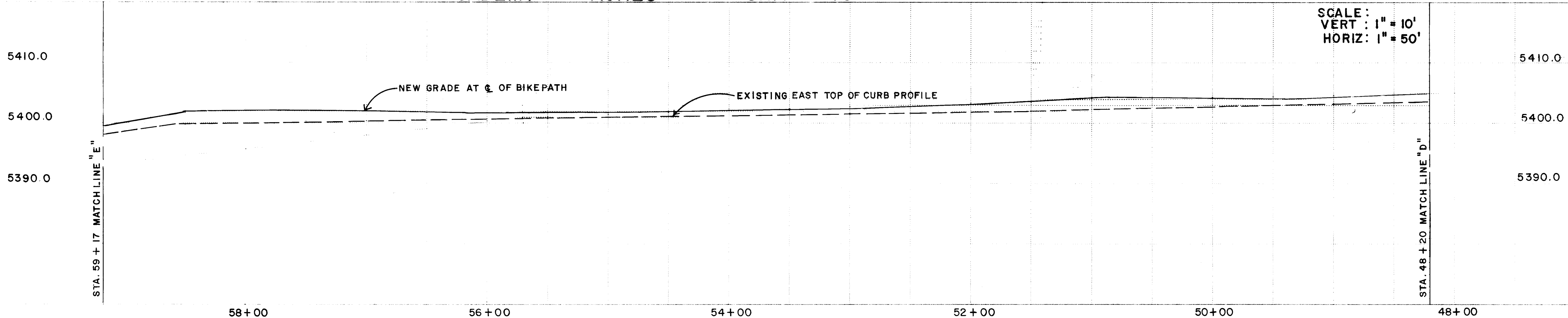

SCALE:  
VERT: 1" = 10'  
HORIZ: 1" = 50'

ALBUQUERQUE ACADEMY CAMPUS

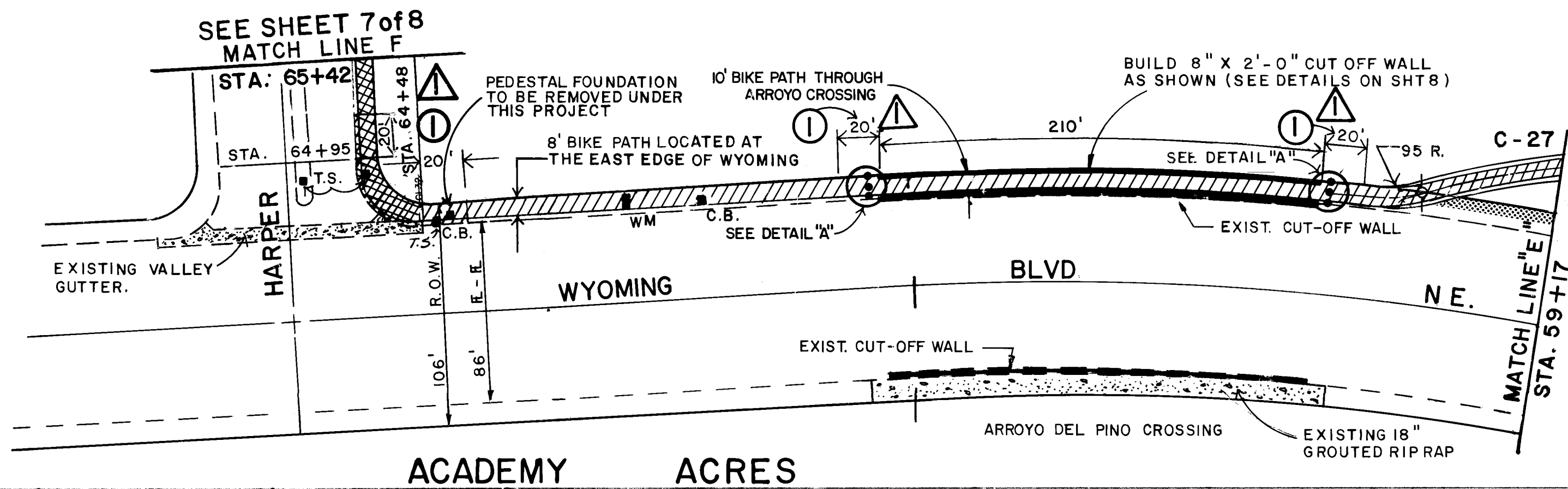

SCALE 1" = 50'

CURVE DATA FOR THIS SHEET			
CURVE	RADIUS	ARC	DELTA
C21	241.46'	99.41'	23°-35'-20"
C22	1435.00'	50.94'	2°-02'-02"
C23	246.38'	99.45'	23°-07'-37"
C24	175.01'	102.11'	33°-25'-45"
C25	656.50'	186.13'	16°-14'-39"
C26	1779.81'	329.43'	10°-36'-18"
C27	393.67'	293.45'	42°-42'-34"

TANGENT DATA FOR THIS SHEET		
TANGENT	LENGTH	BEARING
T6	61.05'	N18°10'22"E

ADDENDUM  
NO. 4

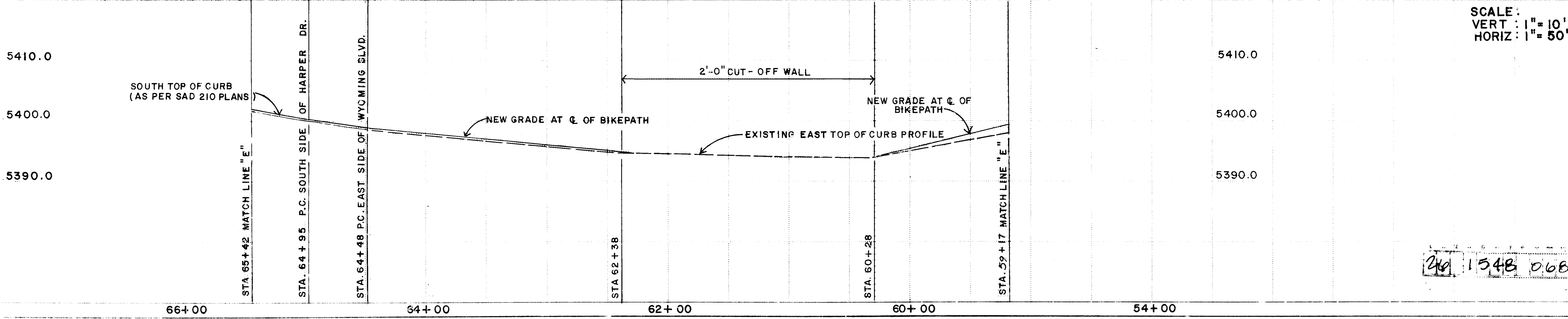

SCALE:  
VERT: 1" = 10'  
HORIZ: 1" = 50'

**NOTES:**

- 20' TRANSITION FROM AN 8' BIKEPATH TO A 10' BIKEPATH AROUND CURB RETURN, AND THROUGH ARROYO DEL PINO CROSSING.
- WHEN C OF BIKEPATH IS GREATER THAN 20' FROM BACK OF CURB, BIKEPATH GRADE SHOULD MATCH EXISTING GRADE, EXCEPT AT BUS BAYS, WHERE C OF BIKEPATH IS LESS THAN 20' FROM BACK OF CURB AND AT BUS BAYS, SEE TYPICAL BIKE TRAIL SECTION ON SHT. 8 TO DETERMINE BIKEPATH GRADE. IN ALL CASES BIKEPATH SURFACE IS TO BE 2" ABOVE SURROUNDING GROUND SURFACE AS SHOWN IN DETAIL ON SHEET 8.

**GENERAL NOTE**

- ALL AREAS WHERE THE NATURAL GROUND IS DISTURBED DURING CONSTRUCTION OF THE BIKEPATH ARE TO BE REVEGETATED WITH NATIVE GRASSES.
- SEE SHEET 2 OF 8 FOR DESCRIPTION OF CENTERLINE OF BIKEPATH CORRIDOR.

**LEGEND**

- 4" CEMENT TREATED BASE COURSE BIKEPATH
- 6' FUTURE SIDEWALK
- 8' ASPHALT BIKEPATH
- T.S. ——— TRAFFIC SIGNAL
- C.B. ——— CONDUIT BOX
- P.F. ——— PEDESTAL FOUNDATION
- WM ——— WATER METER
- HORIZONTAL CURVE P.C. TO HORIZONTAL CURVE P.C.

**BOLLARD PLACEMENT DETAIL A-A**

SCALE: 1/4" = 1'-0"

SECTION A-A

**CITY OF ALBUQUERQUE**  
MUNICIPAL DEVELOPMENT DEPARTMENT  
ENGINEERING DIVISION

**TITLE**  
WYOMING BIKEPATH - FROM ACADEMY ROAD TO HARPER ROAD.

APPROVAL	DATE	APPROVAL	ENGINEER	DATE
City Engineer	4/16/84	City Engineer	Steve Boberg	4/16/84
ACE Design	4/16/84	ACE Design	Steve Boberg	4/16/84
ACE Hydrology	4/16/84	ACE Hydrology	Steve Boberg	4/16/84
TRANS. Dept.	4/16/84	TRANS. Dept.	Steve Boberg	4/16/84

DRAWING NO. 1548 MAP NO. E-19 SHEET 6 OF 8



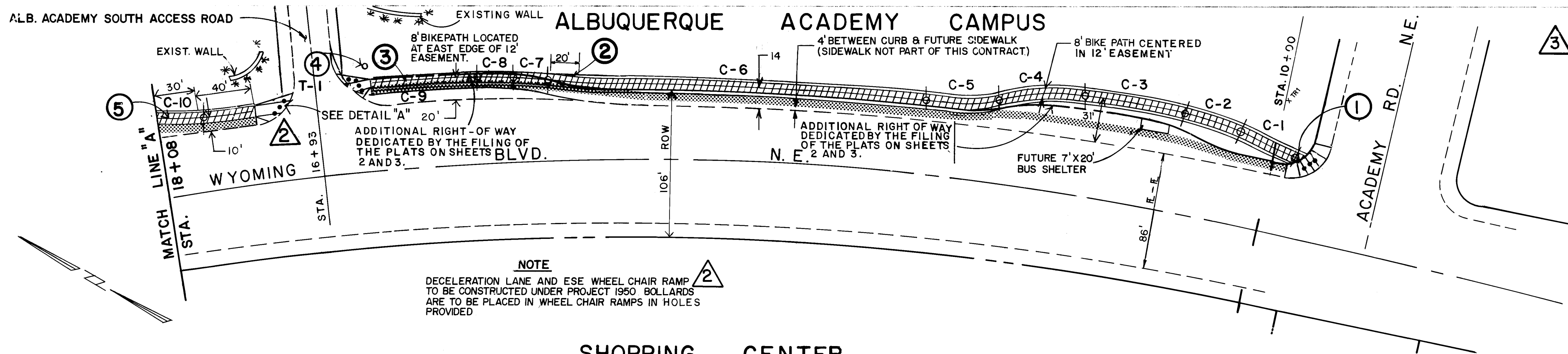

CURVE DATA FOR THIS SHEET

CURVE	RADIUS	ARC	DELTA
C1	152.00'	44.10'	16°-37'-23"
C2	148.00'	42.39'	16°-24'-38"
C3	2248.72'	72.60'	1°-50'-59"
C4	198.00'	62.57'	18°-06'-21"
C5	202.00'	53.51'	15°-10'-39"
C6	2232.09'	273.30'	7°-00'-55"
C7	156.00'	25.67'	9°-25'-41"
C8	144.00'	27.08'	10°-46'-29"
C9	2236.72'	91.28'	2°-20'-17"
C10	628.12'	41.84'	3°-48'-59"
C11	781.07'	100.12'	7°-20'-39"
C12	3147.72'	802.56'	14°-36'-30"

TANGENT DATA FOR THIS SHEET

TANGENT	LENGTH	BEARING
T1	108.36'	N48°57'37"W
T2	277.84'	N48°26'39"W

- NOTES:
- SEE SHEET 8 FOR WHEEL CHAIR RAMP DETAIL AND BOLLARD LOCATION.
  - BIKEPATH TO SHIFT TO EAST EDGE OF EASEMENT IN 20' TRANSITION.
  - BIKEPATH IN THIS AREA WILL BE NARROWED FROM 8' WIDTH TO 6' WIDTH WHEN SIDEWALK IS CONSTRUCTED.
  - LIGHT POLE TO REMAIN IN PLACE.
  - BIKE PATH TO SHIFT 4' TO EAST IN A 30' TRANSITION FROM STA. 17+78.
  - WHERE  $\Delta$  OF BIKEPATH IS GREATER THAN 20' FROM BACK OF CURB, BIKE-PATH GRADE SHOULD MATCH EXISTING GRADE, EXCEPT AT BUS BAYS. WHERE  $\Delta$  OF BIKEPATH IS LESS THAN 20' FROM BACK OF CURB AND AT BUS BAYS, SEE TYPICAL BIKE TRAIL SECTION ON SHT. 8 TO DETERMINE BIKEPATH GRADE. IN ALL CASES BIKEPATH SURFACE IS TO BE 2" ABOVE SURROUNDING GROUND SURFACE AS SHOWN IN DETAIL ON SHEET 8.

#### GENERAL NOTE

- ALL AREAS WHERE THE NATURAL GROUND IS DISTURBED DURING CONSTRUCTION OF THE BIKE PATH ARE TO BE REVEGETATED WITH NATIVE GRASSES BY CITY OF ALBUQ.
- SEE SHEET 2 OF 8 FOR DESCRIPTION OF CENTERLINE OF BIKEPATH CORRIDOR.

#### LEGEND

- 6' FUTURE SIDEWALK
- 8' ASPHALT BIKEPATH
- HORIZONTAL CURVE P.C. TO HORIZONTAL CURVE P.C.

SCALE:  
VERT: 1" = 10'  
HORIZ: 1" = 50'

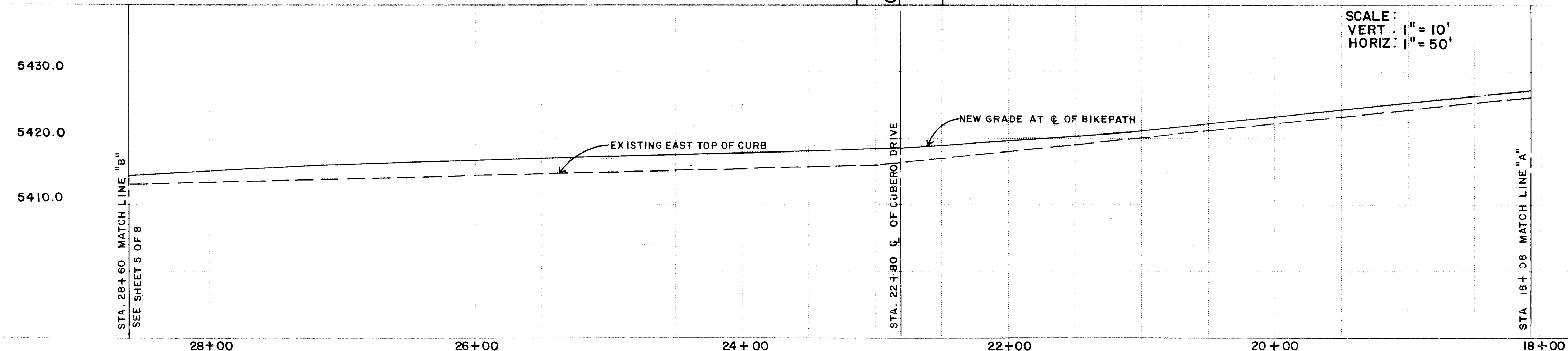
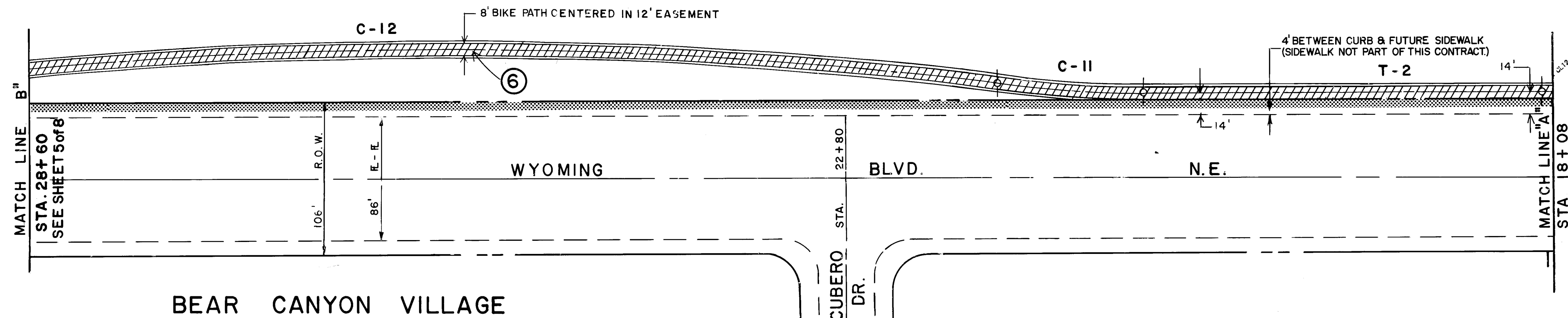
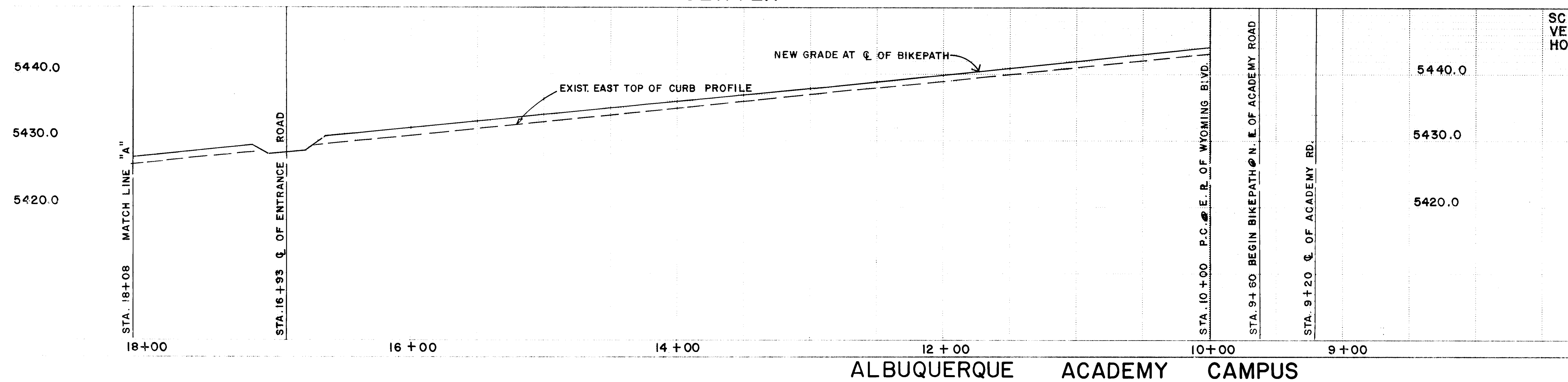

SCALE:  
VERT: 1" = 10'  
HORIZ: 1" = 50'

DETAIL "A"  
NOT TO SCALE  
24 1548 0484  
ADDENDUM NO.4

CITY OF ALBUQUERQUE  
MUNICIPAL DEVELOPMENT DEPARTMENT  
ENGINEERING DIVISION

TITLE  
**WYOMING BIKEPATH-FROM ACADEMY ROAD TO HARPER ROAD N.E.**

APPROVALS	ENGINEER	DATE	APPROVALS	ENGINEER	DATE
City Engineer	Steve Boberg	4/6/84	Liquid Waste		
ACE Design	Steve Boberg	4/6/84	Traffic		
ACE Hydrology	Steve Boberg	4/6/84	Water		
Trans Dept	Steve Boberg	4/6/84			

DRAWING NO. 1548 MAP NO. E-19 SHEET 4 OF 8

AS BUILT INFORMATION

CUT IN TOP OF CURB WEST END S.W. RETURN AT ACADEMY AND WYOMING ELEVATION 5440.82

DATE 10-E-19

REVISIONS

NO.	DATE	REVISIONS	BY
1	4-1-84	ADDITION OF NOTE # 6 & OFFSETS	S.B.
2	4-24-84	CURVE & TANGENT DATA	S.B.
3	4-17-84	ADDITION OF DETAIL "A" & NOTE	S.B.
4	4-17-84	ADDITION OF NOTES # 4 & 5	S.B.

DESIGNED BY STEVE BOBERG  
DRAWN BY L.L. A.U.S., M.B., R.M.S.  
CHECKED BY

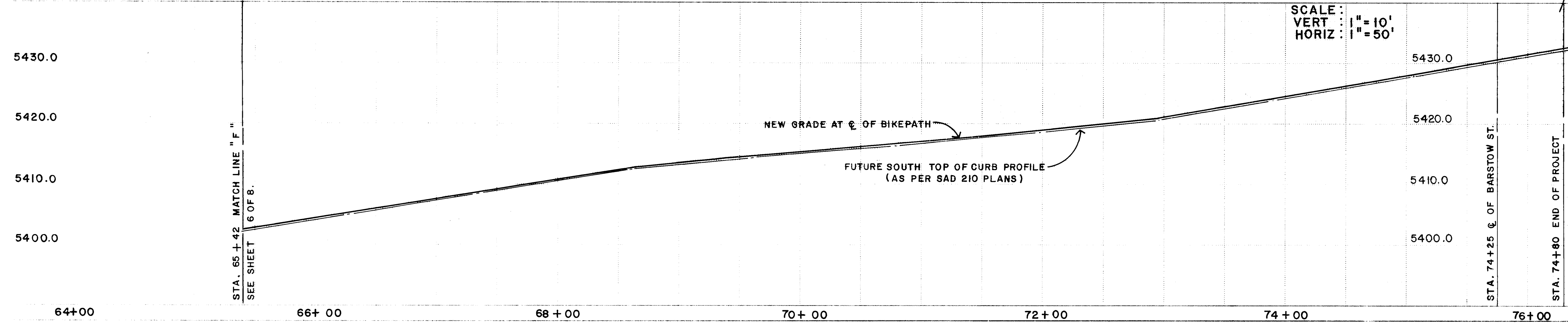
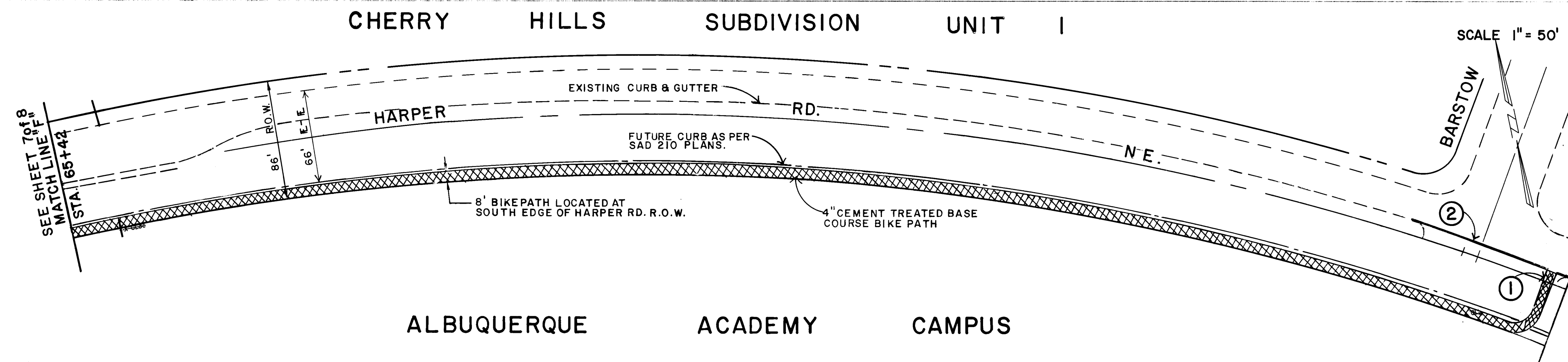

- NOTES:**
1. CONSTRUCT ASPHALT RAMP AS SHOWN ON DETAIL SHEET 8 OF 8.
  2. 8" EXTRUDED ASPHALT CURB ACROSS OPENING, SEE DETAIL SHEET 8 OF 8.

**LEGEND**

XXXXXX 4" CEMENT TREATED BASE COURSE BIKE PATH

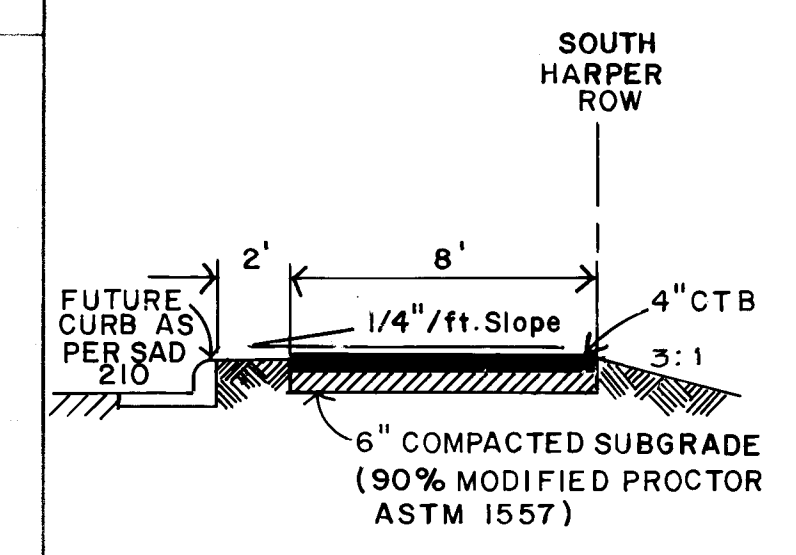

**TYPICAL BIKE TRAIL SECTION**  
STA. 64+48 TO STA. 74+80

**GENERAL NOTE:**

ALL AREAS WHERE THE NATURAL GROUND IS DISTURBED DURING CONSTRUCTION OF BIKEPATH ARE TO BE REVEGETATED WITH NATIVE GRASSES.

ADDENDUM  
NO. 4

26 1548 0784

*[Signature]*

CITY OF ALBUQUERQUE  
MUNICIPAL DEVELOPMENT DEPARTMENT  
ENGINEERING DIVISION

**TITLE**  
WYOMING BIKEPATH - FROM ACADEMY ROAD TO HARPER ROAD.

APPROVALS	ENGINEER	DATE	APPROVALS	ENGINEER	DATE
City Engineer	<i>[Signature]</i>	3/6/04	City Engineer	<i>[Signature]</i>	3/6/04
A.C.E. Design	<i>[Signature]</i>	3/6/04	A.C.E. Design	<i>[Signature]</i>	3/6/04
A.C.E. Hydrology	<i>[Signature]</i>	3/6/04	A.C.E. Hydrology	<i>[Signature]</i>	3/6/04

DRAWING NO. 1548 MAP NO. E-19 SHEET 7 OF 8



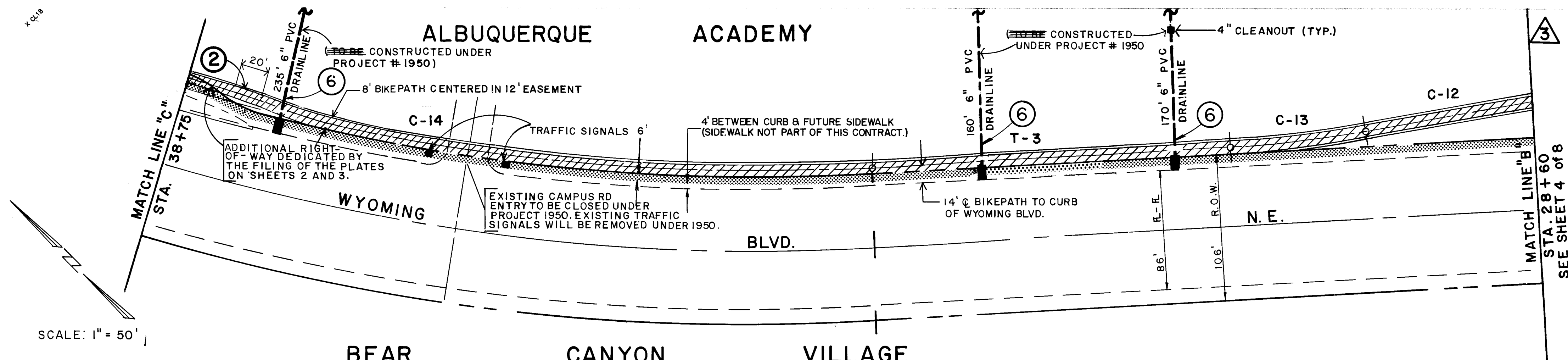

CURVE DATA FOR THIS SHEET

CURVE	RADIUS	ARC	DELTA
C12	3147.71'	802.56'	14°-36'-30"
C13	789.70'	100.12'	7°-15'-50"
C14	1442.37'	637.96'	25°-20'-30"
C15	77.63'	27.70'	20°-26'-32"
C16	173.00'	42.41'	14°-02'-47"
C17	1423.00'	59.05'	2°-22'-39"
C18	173.00'	42.41'	14°-02'-47"
C19	131.71'	94.94'	41°-18'-06"
C20	711.09'	343.83'	27°-42'-14"
C21	241.46'	99.41'	23°-35'-20"

TANGENT DATA FOR THIS SHEET

TANGENT	LENGTH	BEARING
T3	262.23'	N48°26'39"W
T4	90.07'	N21°42'50"W
T5	37.50'	N01°16'16"W

- NOTES:
- BIKEPATH TO SHIFT TO EAST EDGE OF EASEMENT IN 20' TRANSITION.
  - BIKEPATH IN THIS AREA WILL BE NARROWED FROM 8' WIDTH TO 6' WIDTH WHEN SIDEWALK IS CONSTRUCTED.
  - HOLES WILL BE PROVIDED IN WHEEL CHAIR RAMPS UNDER PROJECT #1950 FOR BOLLARDS INSTALLED UNDER THIS PROJECT.
  - WHERE C OF BIKEPATH IS GREATER THAN 20' FROM BACK OF CURB, BIKEPATH GRADE SHOULD MATCH EXISTING GRADE, EXCEPT AT BUS BAYS. WHERE C OF BIKEPATH IS LESS THAN 20' FROM BACK OF CURB AND AT BUS BAYS, SEE TYPICAL BIKE TRAIL SECTION ON SHEET 8 TO DETERMINE BIKEPATH GRADE. IN ALL CASES BIKEPATH SURFACE IS TO BE 2" ABOVE SURROUNDING GROUND SURFACE AS SHOWN IN DETAIL ON SHEET 8.
  - ALL PVC DRAIN LINES UNDER BIKE PATH ENCASED IN CONCRETE.

GENERAL NOTE

- ALL AREAS WHERE THE NATURAL GROUND IS DISTURBED DURING CONSTRUCTION OF THE BIKEPATH ARE TO BE REVEGETATED WITH NATIVE GRASSES BY CITY OF ALBUQ.
- SEE SHEET 2 OF 8 FOR DESCRIPTION OF CENTERLINE OF BIKEPATH CORRIDOR.

- LEGEND
- 6' FUTURE SIDEWALK
  - 8' ASPHALT BIKEPATH
  - TRAFFIC SIGNALS
  - HORIZONTAL CURVE P.C. TO HORIZONTAL CURVE P.C.

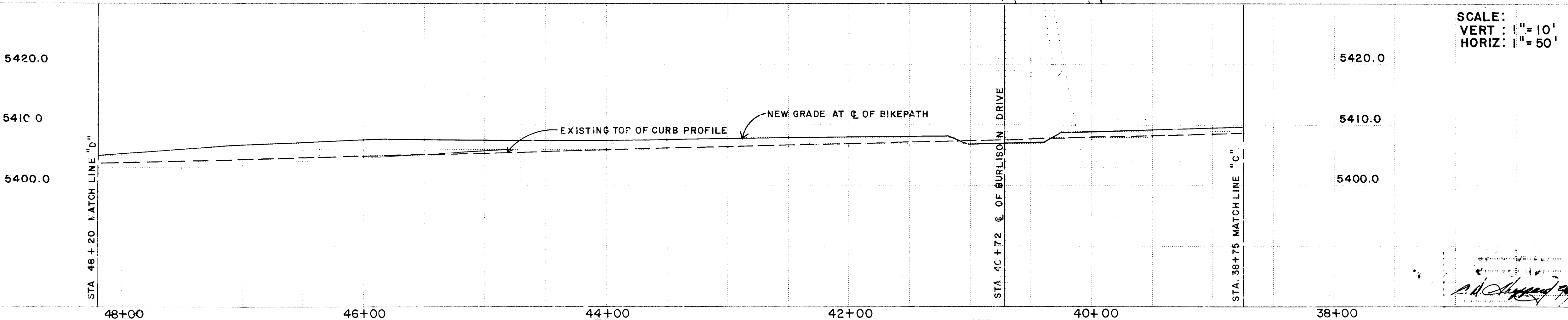
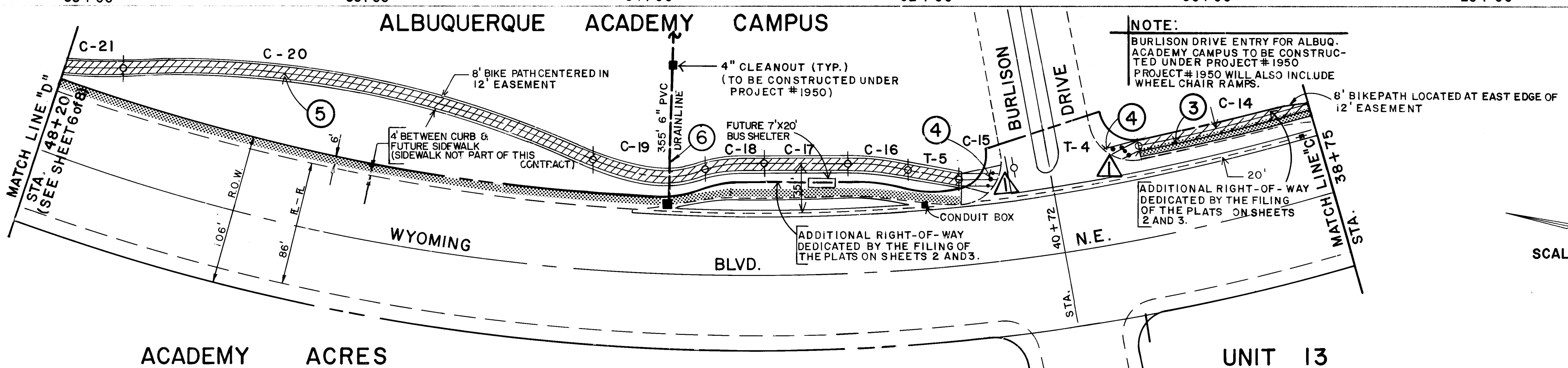
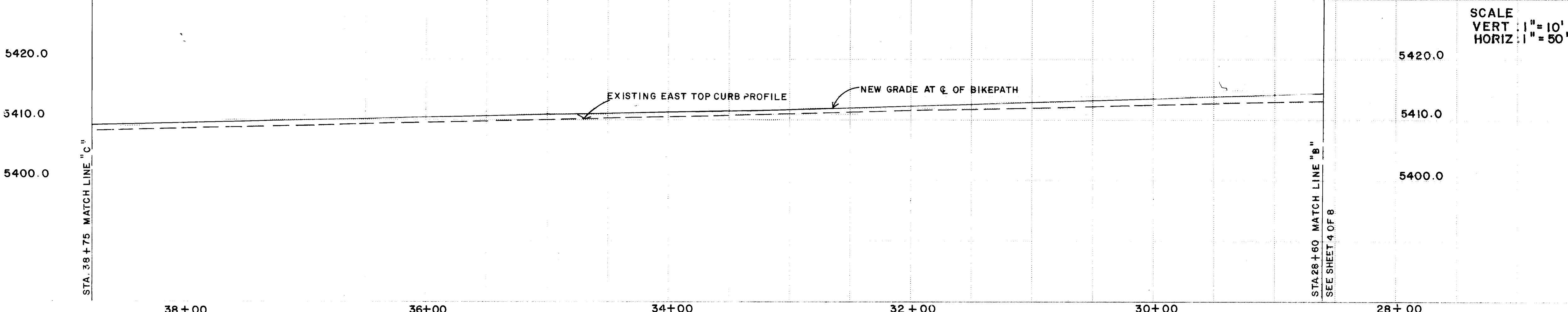

ADDENDUM NO. 4

CITY OF ALBUQUERQUE  
MUNICIPAL DEVELOPMENT DEPARTMENT  
ENGINEERING DIVISION

TITLE  
**WYOMING BIKEPATH - FROM ACADEMY ROAD TO HARPER ROAD.**

APPROVALS	ENGINEER	DATE	APPROVALS	ENGINEER	DATE
City Engineer	<i>[Signature]</i>	4/1/84	City Engineer	<i>[Signature]</i>	4/1/84
A.C.E. - Design	<i>[Signature]</i>	3/8/84	A.C.E. - Design	<i>[Signature]</i>	3/8/84
A.C.E. - Hydrology	<i>[Signature]</i>	3/8/84	A.C.E. - Hydrology	<i>[Signature]</i>	3/8/84

DESIGNED BY STEVE BOBERG  
DRAWN BY L.L. AUS, M.B. R.M.S.  
CHECKED BY

DRAWING NO. **1548** MAP NO. **E-19** SHEET **5** OF **8**