

# RACKHEATH PARK ADDITION NO. 1 BLOCK 8

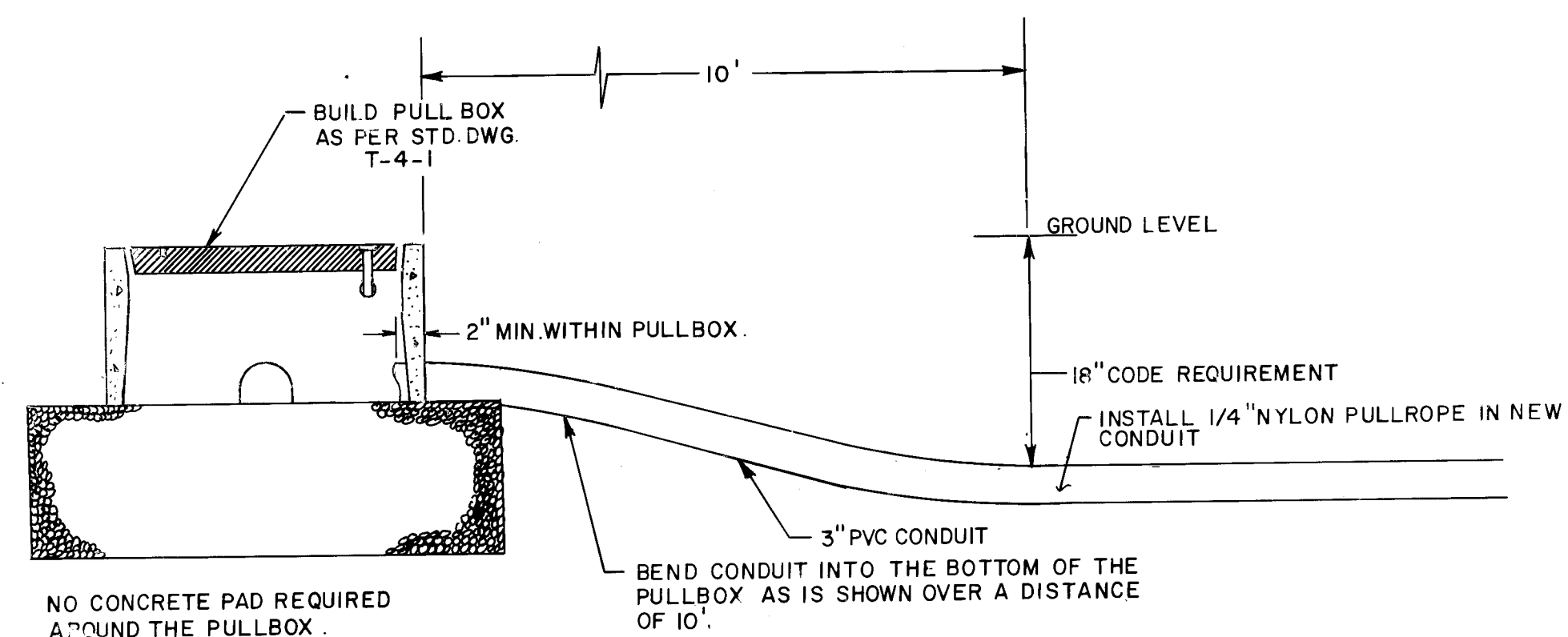
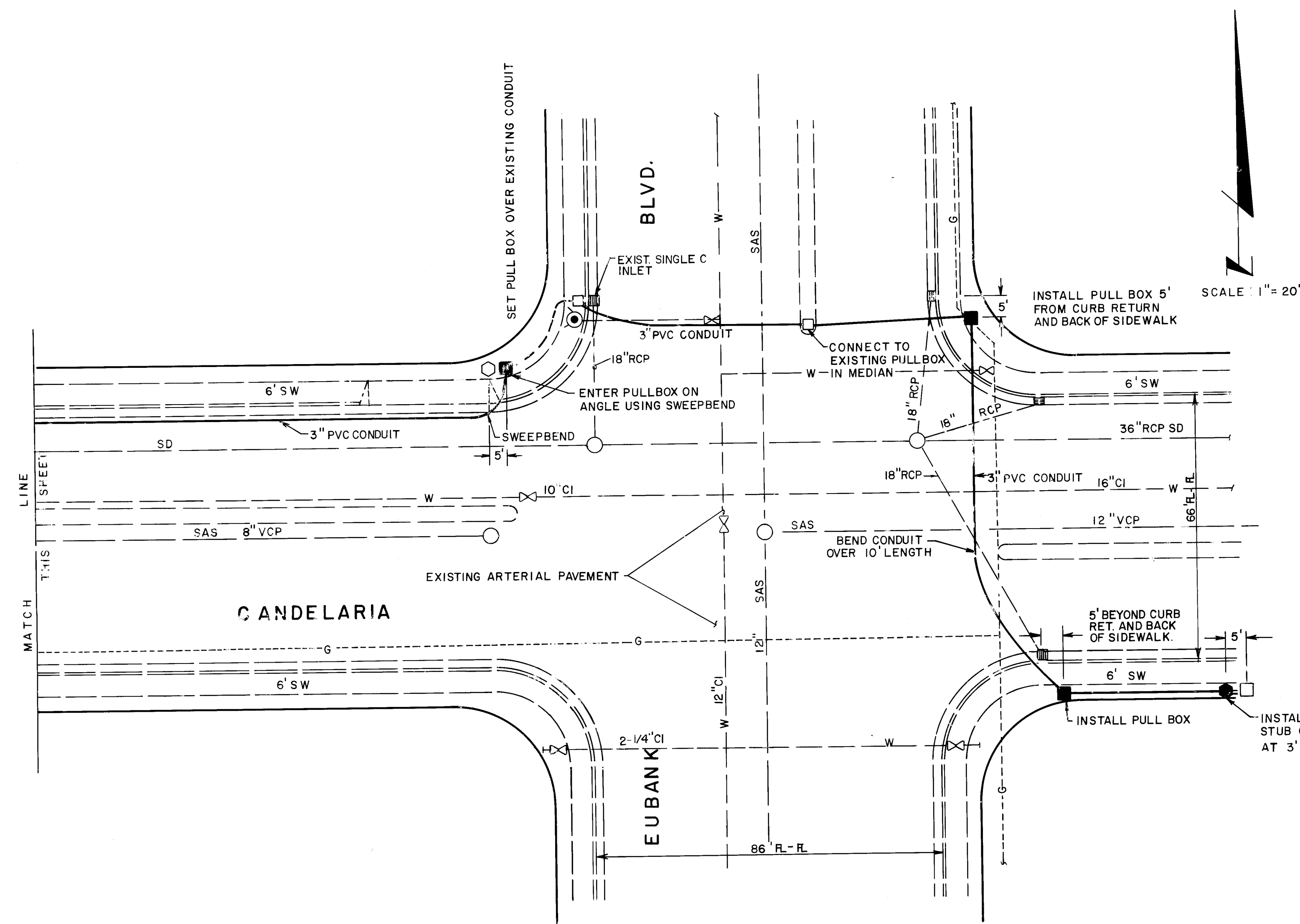
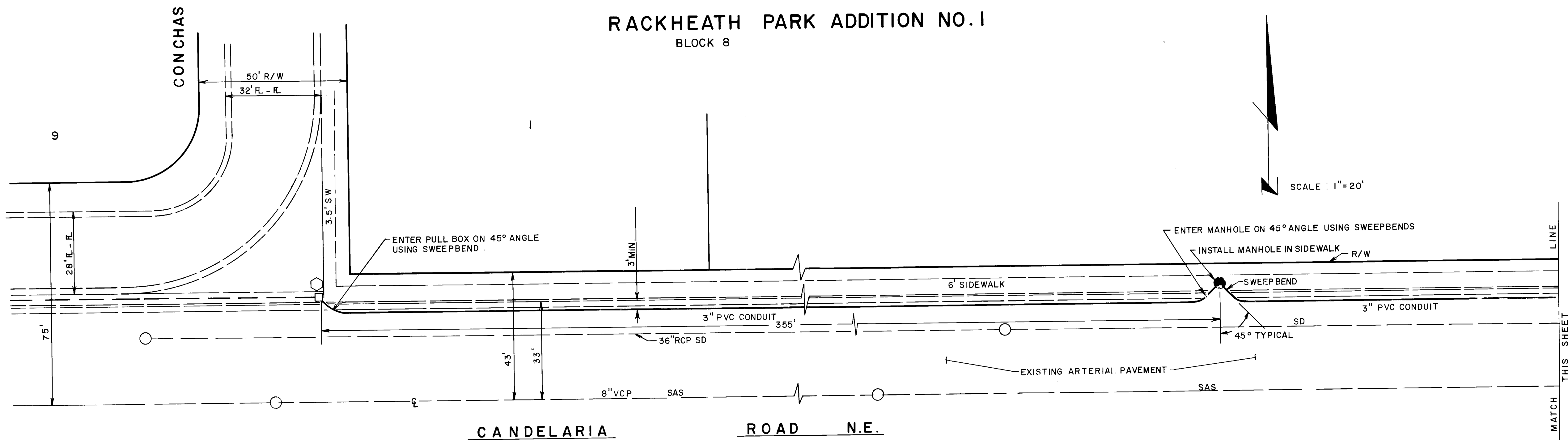

DETAIL OF CONDUIT CONNECTION TO PULLBOX  
SCALE: 1" = 1'

## NOTES:

- PULL BOXES AND MANHOLES SHALL BE INSTALLED SO THAT TOP OF LID WILL BE FLUSH WITH TOP OF SIDEWALK.
- CONTRACTOR MUST SUBMIT A CONSTRUCTION SIGNING AND BARRICADING PLAN TO TRAFFIC ENGINEERING DIVISION AND RECEIVE A BARRICADING PERMIT PRIOR TO CONSTRUCTION.
- ALL CONSTRUCTION SIGNING AND BARRICADING TO COMPLY WITH MANUAL ON UNIFORM TRAFFIC CONTROL DEVICES, 1978 EDITION.
- CONTRACTOR'S OPERATION, BARRICADING AND SIGNING SHALL NOT AFFECT THRU LANES OF CANDELARIA AND EUBANK BETWEEN 7 AM AND 9 AM OR 4 PM AND 6 PM.

AS BUILT INFORMATION		BENCH MARKS		SURVEY INFORMATION		ENGINEER'S SEAL	
CONTRACT NO.	DATE	N/A	DATE	NO	BY	NO	DATE
CONCHAS -							
INSPECTED BY	DATE						
ACCEPTANCE BY	DATE						
VERIFICATION BY	DATE						
DRAWINGS	DATE						
SUBMITTED BY	DATE						
MICRO-FILM	DATE						
RECORDED BY	DATE						
NO							

ZONE ATLAS H-20 N.S.

### NOTICE TO CONTRACTORS

- All work detailed on these plans to be performed under contract shall, except as otherwise stated or provided for herein, be constructed in accordance with the New Mexico Standard Specifications for Public Works Construction-1979 Edition (referred to herein as the Standard Specifications) and the Contract Documents for Public Works Contract 84-1.
- Two (2) working days prior to any excavation, the contractor must contact Line Locating Service, 765-1234, for location of existing utilities.
- Prior to construction, the contractor shall excavate and verify the horizontal and vertical locations of all obstructions. Should a conflict exist, the contractor shall notify the engineer or surveyor so that the conflict can be resolved with minimum amount of delay.

THE FOLLOWING NOTES ALSO APPLY WHEN CHECKED

☐ All utilities and utility service lines shall be installed prior to paving.

☒ Backfill compaction shall be according to specified street use. (ARTERIAL)

☒ Tack coat requirements shall be determined by the City Engineer.

☐ Sidewalks and wheelchair ramps within the curb returns shall be constructed wherever a new curb return is constructed.

☐ If curb is depressed for a driveway or a handicap ramp, the driveway or ramp shall be constructed prior to acceptance of the curb and gutter.

☐ All storm drainage facilities shall be completed prior to final acceptance.

### LEGEND

- EXISTING PULL BOX
- EXISTING SPLICE CABINET
- EXISTING TRAFFIC CONTROLLER
- PULL BOX TO BE INSTALLED - LARGE PLASTIC TYPE - FURNISHED BY TRAFFIC ENGINEERING
- NEW SP FOUNDATION - TYPE II TO BE INSTALLED
- NEW TRAFFIC SIGNAL MANHOLE TO BE INSTALLED
- 3" RIGID PVC CONDUIT TO BE INSTALLED
- EXISTING CONDUIT
- EXISTING STD. CURB AND GUTTER
- EXISTING MANHOLE
- EXISTING INLET

CITY OF ALBUQUERQUE MUNICIPAL DEVELOPMENT DEPARTMENT ENGINEERING DIVISION			
TITLE: CANDELARIA RD. B/W CONCHAS AND EUBANK BLVD CONDUIT INSTALLATION			
APPROVALS	ENGINEER	DATE	APPROVALS
City Engineer	<i>[Signature]</i>	1/16/84	Liquid Waste
A.C.E. - Design	<i>[Signature]</i>	1/16/84	Traffic
A.C.E. - Hydrology	<i>[Signature]</i>	1/16/84	Water
DESIGNED BY	STEVE BOBERG	DATE	OCT, 1983
DRAWN BY	D. ZANORA	DATE	10/83
CHECKED BY	STEVE BOBERG	DATE	OCT, 1983

26 1934 0184

DATE 7/3/84

MAP NO. H-20 SHEET 1 OF 1