

• L E G E N D •

MATERIALS

CONCRETE
RIP-RAP



LINES

SUBDIVISION BOUNDARY
PROPERTY LINE (PLAN)
PROPERTY LINE (SECTION)
CENTERLINE
EASEMENT LINE
MATCH LINE
SECTION CUT LINE

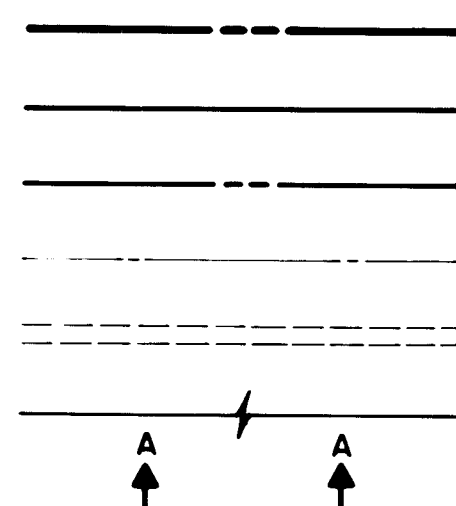

EARTHWORK

CONTOUR LINE
SPOT ELEVATION
PROJECT / PHASE BOUNDARY
SWALE
DIRECTION OF FLOW

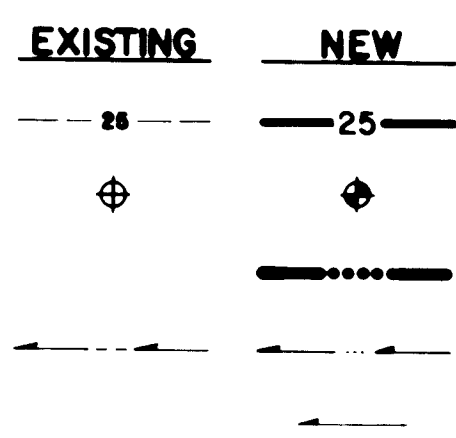

MISCELLANEOUS UTILITIES

GAS LINE
UNDERGROUND TELEPHONE
UNDERGROUND ELECTRICAL
STORM DRAIN
STORM DRAIN MANHOLE
STORM DRAIN INLET

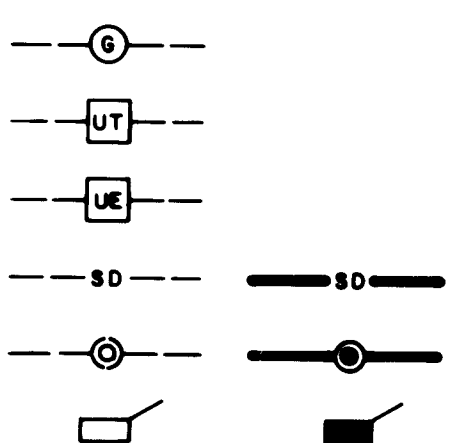

SANITARY SEWER

SANITARY SEWER LINE
SANITARY SEWER MANHOLE
SAS SERVICE CONNECTIONS
SAS CAP OR PLUG
ENCASEMENT

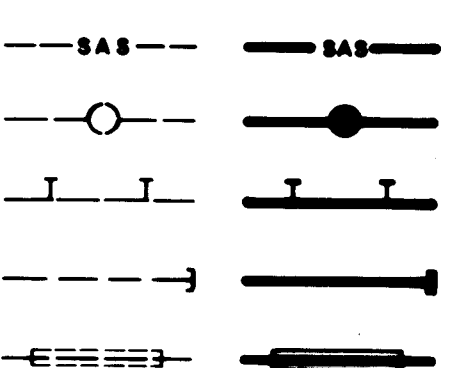

WATER

WATER LINE
WATER SERVICE CONNECTIONS
GATE VALVE
FIRE HYDRANT
BUTTERFLY VALVE
REDUCER
WATER PRESSURE ZONE BOUNDARY

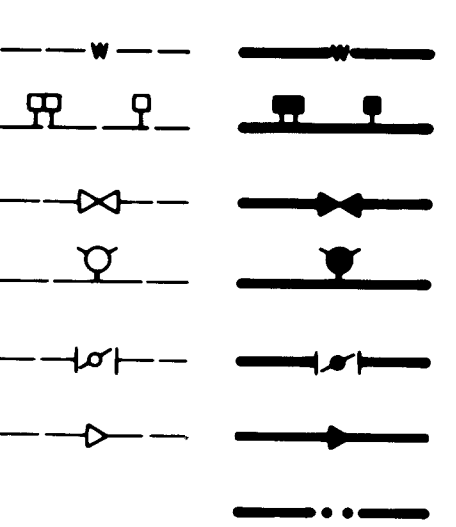

WATER FITTINGS

CAPS AND PLUGS
ELBOW
CROSS
TEE

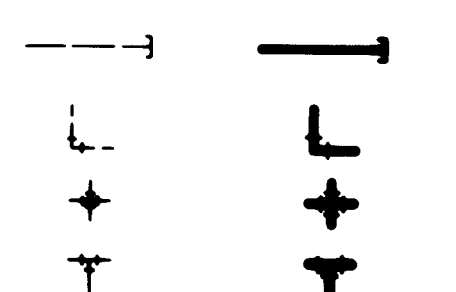

MISCELLANEOUS

CHAINLINK FENCE
FIELD FENCE
COMMON YARD WALL
RETAINING WALL
POWER OR TELEPHONE POLE



CONSTRUCTION PLANS FOR
MONTANO ROAD N.W.
SANITARY SEWER EXTENSION

ALBUQUERQUE, NEW MEXICO

MAY, 1984

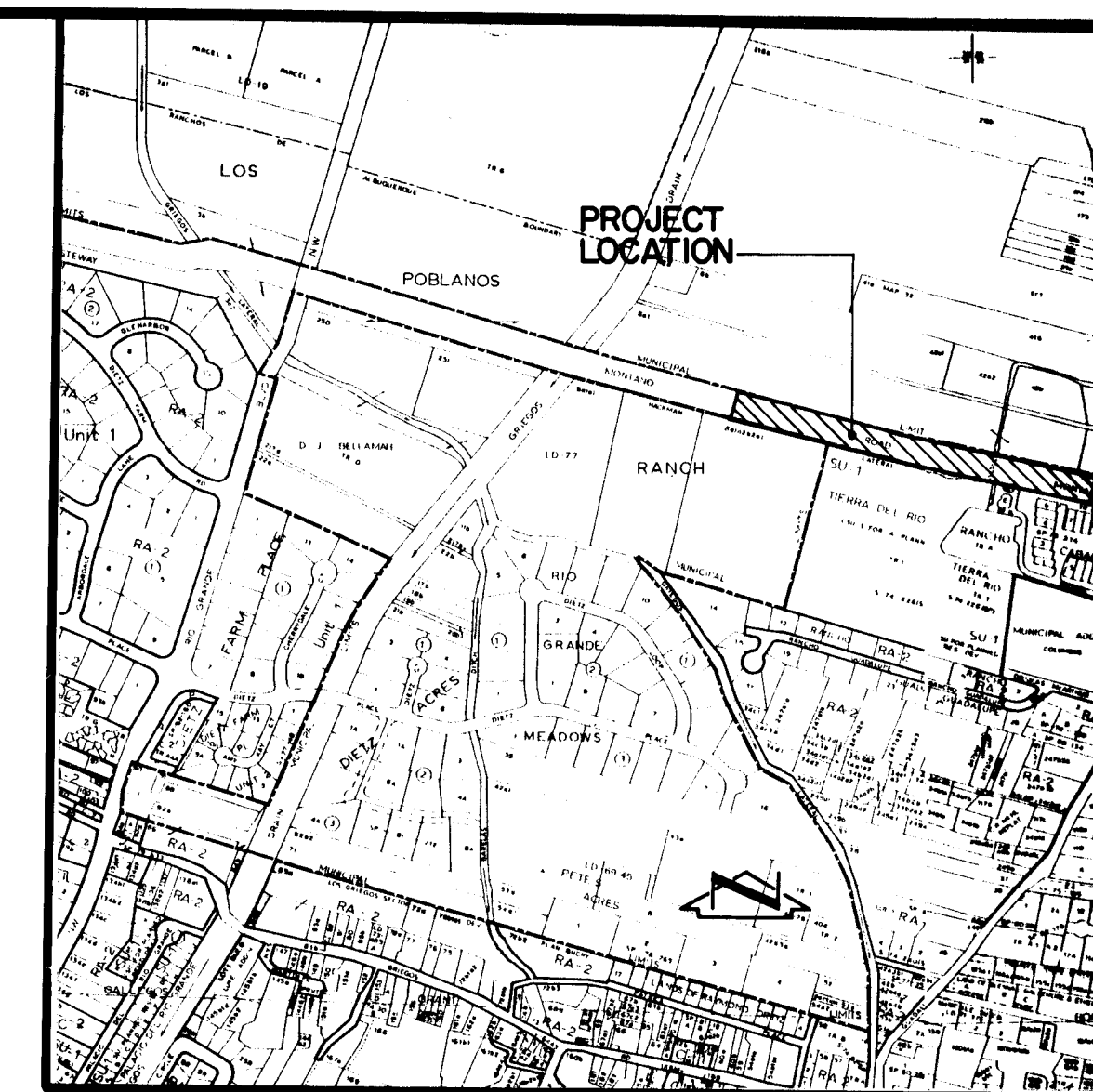

VICINITY MAP
SCALE: 1" = 800'

F-13

GENERAL NOTES

1. ALL WORK DETAILED ON THESE PLANS TO BE PERFORMED UNDER CONTRACT SHALL, EXCEPT AS OTHERWISE STATED OR PROVIDED FOR HEREON, SHALL BE CONSTRUCTED IN ACCORDANCE WITH THE NEW MEXICO STANDARD SPECIFICATIONS FOR PUBLIC WORKS CONSTRUCTION - 1979 EDITION (REFERRED TO HEREIN AS THE STANDARD SPECIFICATIONS) AND THE CONTRACT DOCUMENTS FOR PUBLIC WORKS CONTRACT NO. 85-1.
2. TWO (2) WORKING DAYS PRIOR TO ANY EXCAVATION, CONTRACTOR MUST CONTACT LINE LOCATING SERVICE, 765-1234, FOR LOCATION OF EXISTING UTILITIES.
3. PRIOR TO CONSTRUCTION, THE CONTRACTOR SHALL EXCAVATE AND VERIFY THE HORIZONTAL AND VERTICAL LOCATION OF ALL POTENTIAL OBSTRUCTIONS. SHOULD A CONFLICT EXIST, THE CONTRACTOR SHALL NOTIFY THE ENGINEER SO THAT THE CONFLICT CAN BE RESOLVED WITH A MINIMUM AMOUNT OF DELAY.
4. ALL WORK ON THIS PROJECT SHALL BE PERFORMED IN ACCORDANCE WITH APPLICABLE FEDERAL, STATE AND LOCAL LAWS, RULES AND REGULATIONS CONCERNING CONSTRUCTION SAFETY AND HEALTH.

INDEX OF DRAWINGS

SHEET NO.	DESCRIPTION
1	COVER
283	PLAN AND PROFILE
4	TRAFFIC CONTROL PLAN

1	2	3	4	5	6	7	8	9	10	11	12
2	6	2	1	3	2	0	1	8	5		

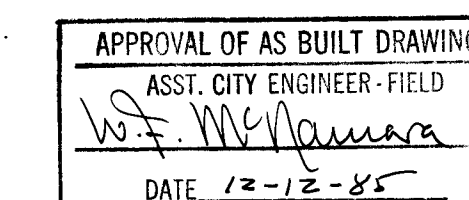

REV	SHEETS	CITY ENGINEER	DATE	USER DEPARTMENT	DATE	USER DEPARTMENT	DATE
Δ	5/3/85	W.F. McQuinn	5/6/85	Public Works	5/7/85		

APPROVED FOR CONSTRUCTION

C.E.

2132

SHEET 1 OF 4

NUCLEAR PHARMACY

MONTANO ROAD

NOTE:
DUE TO FLAT SLOPE, CONTRACTOR
SHALL USE A LASER DEVICE FOR
LAYING ALL SEWER.

HORIZONTAL SCALE: 1" = 50'
VERTICAL SCALE: 1" = 10'

4980
4970
4960
4950

29+00 28+00 27+00 26+00 25+00 24+00 23+00 22+00 21+00

35
STA. 27+35 CONSTRUCT 2 DIA.
TYPE 'E' MANHOLE

35
STA. 23+35 CONSTRUCT 4 DIA.
TYPE 'E' MANHOLE

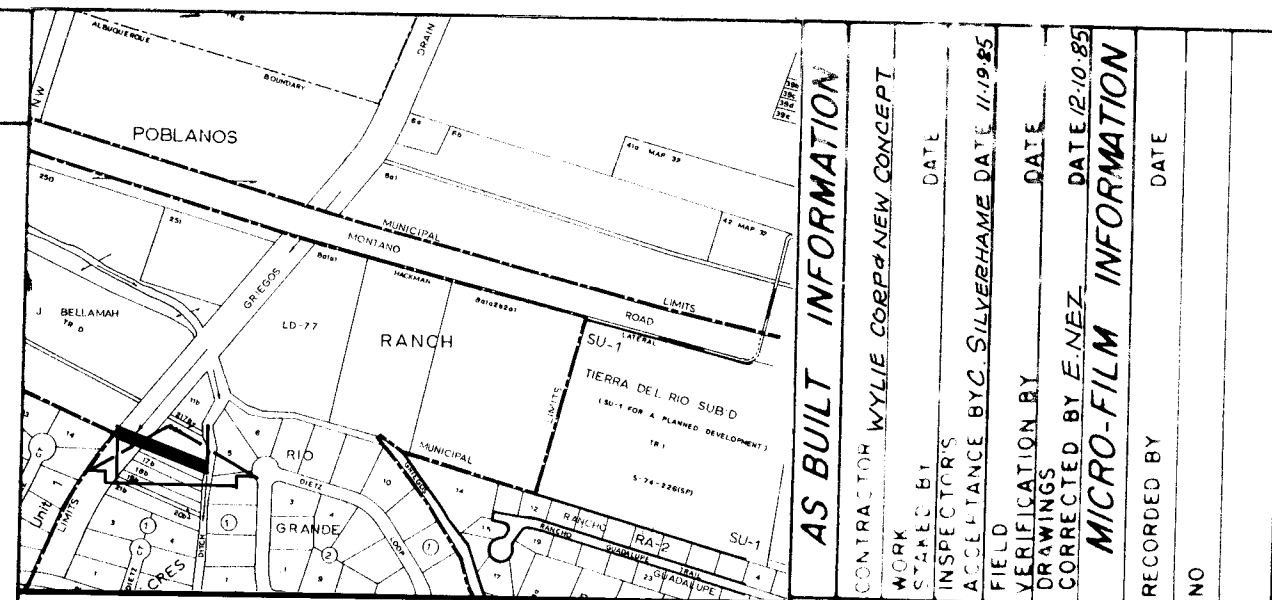

VICINITY MAP F-13

GENERAL NOTES

- All work detailed on these plans to be performed under contract shall, except otherwise stated or provided for hereon, be constructed in accordance with the New Mexico Standard Specifications for Public Works Construction - 1979 Edition (referred to herein as the Standard Specifications) and the City of Albuquerque Contract Documents for Public Works Contract No. 85-1.
- All work on this project shall be performed in accordance with applicable federal, state and local laws, rules and regulations concerning construction safety and health.
- Two working days prior to any excavation, Contractor must contact Line Locating Service, 765-1234, for location of existing utilities.
- Prior to construction, the Contractor shall excavate and verify the horizontal and vertical locations of all existing utilities and potential obstructions. Should a conflict exist, the Contractor shall notify the Engineer so that the conflict can be resolved with a minimum amount of delay.
- The Contractor shall maintain access to adjacent buildings at all times.
- All pavement removal and replacement and trenching required within Public right-of-way shall be performed in accordance with current City of Albuquerque standards.

SANITARY SEWER SYSTEM

- All stationing is based on street centerline unless indicated otherwise.
- All sewer pipe shall be PVC (SDR 35) or as approved by the City of Albuquerque Water Resources Division (See Note 5).
- Slopes shown on the profiles are based on true distances.
- All manholes shall be four-foot diameter type 'E' as per City of Albuquerque Standard Drawing S-2-X unless otherwise noted.
- Vitrified clay and ductile iron are acceptable pipe materials in lieu of PVC.

26 21320385

CITY OF ALBUQUERQUE
MUNICIPAL DEVELOPMENT DEPARTMENT
ENGINEERING DIVISION

TITLE: MONTANO ROAD NW.
SANITARY SEWER EXTENSION

APPROVALS	ENGINEER	DATE	APPROVALS	ENGINEER	DATE
City Engineer			Liquid Waste		5/5/85
A C E - Design		5/28/85	Traffic		5/21/85
Hydrology		5/27/85	Water		5/3/85

DRAWING NO. 2132 MAP NO. F-13 SHEET 3 OF 4

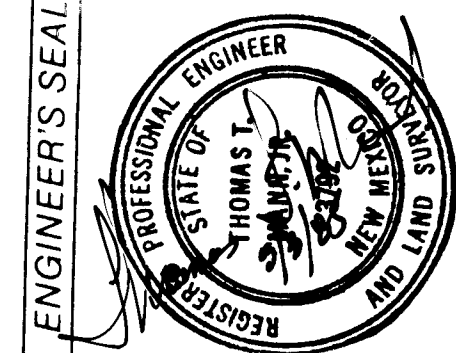

REVISIONS	DATE	DESIGNED BY	CHECKED BY
1. Revision from As-Built Drawings			
2. ADDED THIS SHEET			
NO. DATE			

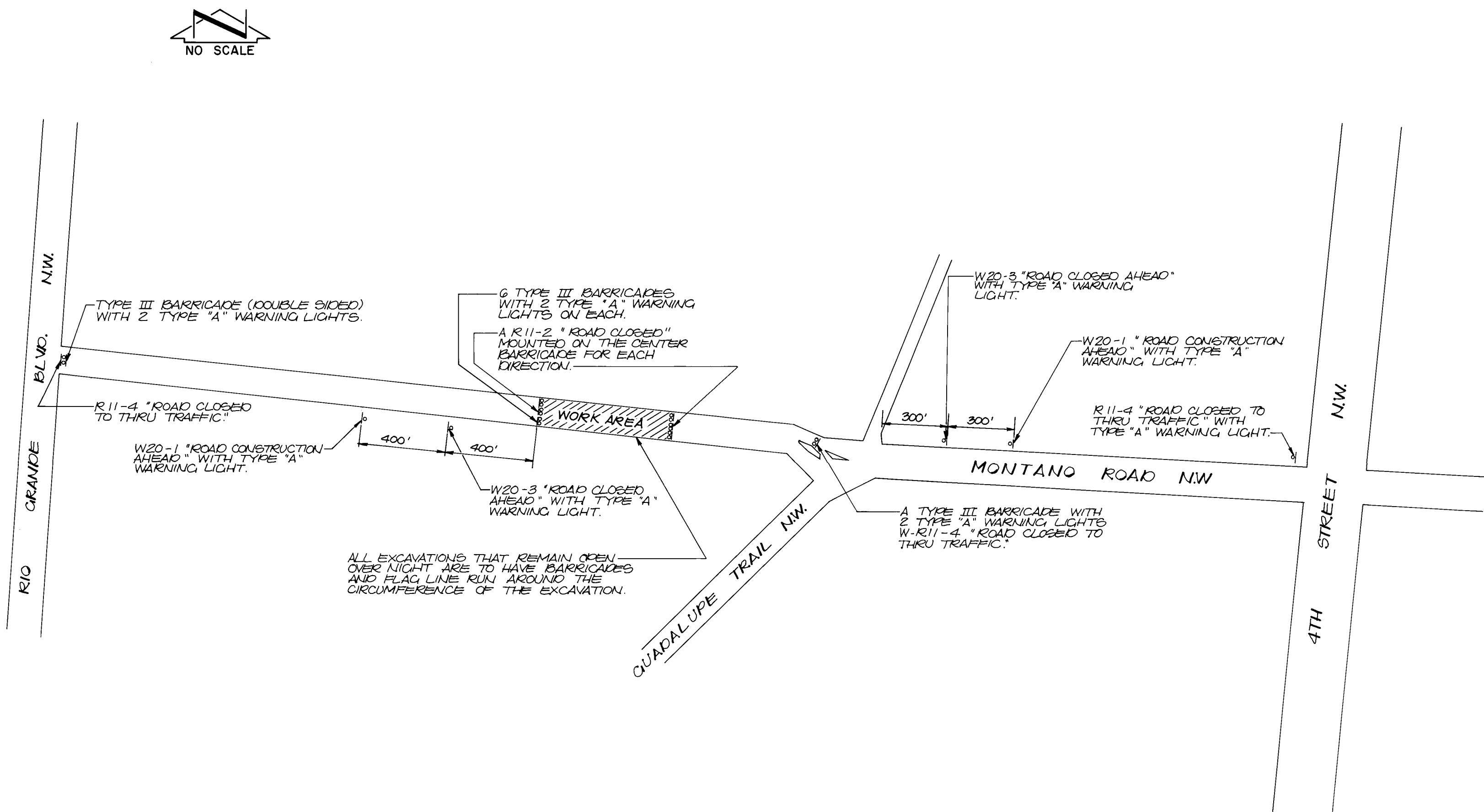

- GENERAL NOTES FOR TRAFFIC CONTROL
- All traffic control devices shall comply with Chapter VI of the 1978 edition of the "Manual for Uniform Traffic Control Devices".
 - The contractor shall prepare and submit to the project engineer a detailed construction schedule, which is subject to the approval of the City Traffic Engineer, three working days prior to commencing construction.
 - Unless otherwise provided as part of the construction documents, the contractor shall prepare and submit to the project engineer a detailed traffic control plan, which is subject to the approval of the City Traffic Engineer, three working days in advance of any required closures.
 - Contractor shall notify the following services 24 hours in advance of any complete closures: Police Department, Fire Department, Ambulance Services, and the Transit Department.
 - Permits to barricade or detour traffic must be obtained for each phase of construction through the traffic engineers office at least 24 hours in advance of construction activities.
 - All advance warning signs and barricades must be installed before construction begins as directed by the engineer.
 - All sign locations will be selected in the field and approved by the project engineer.
 - All advance warning signs shall be 48" x 48" minimum.
 - All advance warning signs not directly applicable shall be removed, completely covered or turned away from oncoming traffic.
 - All construction signing shall be black on a reflectorized orange field unless otherwise specified. All construction barricades and channelization devices shall be orange on white, reflectorized, unless otherwise specified.
 - All signs will be ground mounted on single or double posts with the bottom of the sign seven feet above sidewalk level. Existing posts may be used at some locations, with the approval of the project engineer. Portable signs supports will be acceptable as an alternate for signs which are in place for less than one week.
 - All existing regulatory signs that need to be removed, relocated or reinstalled shall be done by the City of Albuquerque, Traffic Engineering Division. The contractor shall notify the Traffic Engineering Division three working days in advance of any required work.
 - Traffic control devices required after dark are to be equipped with warning lights. Type (A) flashing warning lights shall be used on all advance warning signs and on all devices which are intended to warn motorist(s) or pedestrians of hazards or obstructions in or near the travel path. Type (C) steady burn lights shall be used on all devices which are intended to define the travel path.
 - All signs, barricades and/or barrels will be reflectorized. All barrels may have sand or water ballast limited to 100 lbs.
 - All signs, barricades and/or barrels will be moved forward as the construction progresses (where applicable).
 - Contractor shall inspect and maintain all barricades at least once each day except for barricades on or adjacent to arterial and collector streets which shall be checked twice daily, including inspection during hours of darkness.
 - Barrels and barricades are not be intermixed in the same series of channelization.
 - Excavations must be plated or patched prior to opening to traffic.
 - A minimum width of 11 feet shall be provided for traffic in one direction.
 - Equipment and materials are not to be stored within the street right-of-way during non-working hours.
 - The contractor shall maintain access to businesses and residences adjacent to the construction area.
 - The contractor shall provide and maintain a safe and adequate means of channelizing pedestrian traffic around all work areas throughout the period of construction. All such channelization shall be arranged to prevent pedestrians from having to enter the roadway in order to pass around the work areas.
 - The contractor shall be required to keep the public informed, through the local news media, of construction operations involving street or lane closures, and shall provide the City Traffic Engineer documented proof that this has been done.

AS BUILT INFORMATION			BENCH MARKS			SURVEY INFORMATION			REFERENCES			REMARKS			
CONTRACTOR	WORK	DATE	A STANDARD USC & GS BRASS TABLET STAMPED	NO.	BY	MAP NO.	EST. NO.	W.O. NO.	NO.	BY	NO.	EST. NO.	W.O. NO.	NO.	BY
STAMPED BY	DATE	DATE	"DOUGLAS 1903" SET IN TOP OF A CONC. POST, 0.25' ABOVE GROUND. TO REACH THE STATION FROM THE INTERSECTION OF CENTRAL & 4TH GO NORTH ON 4TH 36 MI. TO DELMAR ST NW, THEN WEST ON DELMAR 300' TO GRAD 51 NW, THEN NORTH ON GRAD 300' TO THE STATION IS LOCATED ON THE WEST EDGE OF THE DOUGLAS MARTIN LEM. SCHOOL GROUNDS. ELEVATION = 4972.253 FEET.												
FIELD	DATE	DATE													
ACCEPTANCE BY	DATE	DATE													
VERIFICATION BY	DATE	DATE													
CORRECTION BY	DATE	DATE													
RECORDED BY	DATE	DATE													
NO															

26 21320485

APPROVED FOR
CONSTRUCTION

CITY ENGINEER DATE

CITY OF ALBUQUERQUE MUNICIPAL DEVELOPMENT DEPARTMENT ENGINEERING DIVISION					
TITLE: TRAFFIC CONTROL SCHEMATIC MONTANO RD. NW SANITARY SEWER EXTENSION					
APPROVALS	ENGINEER	DATE	APPROVALS	ENGINEER	DATE
City Engineer	<i>[Signature]</i>	6/15/84	Sanitary Sewer	<i>[Signature]</i>	6/15/84
A.C.E. - Design	<i>[Signature]</i>	6/15/84	Traffic	<i>[Signature]</i>	6/15/84
A.C.E. - Hydrology	<i>[Signature]</i>	6/15/84	Water	<i>[Signature]</i>	6/15/84
DRAWING NO. 2132			SHEET 4 OF 4		