

• L E G E N D •

MATERIALS

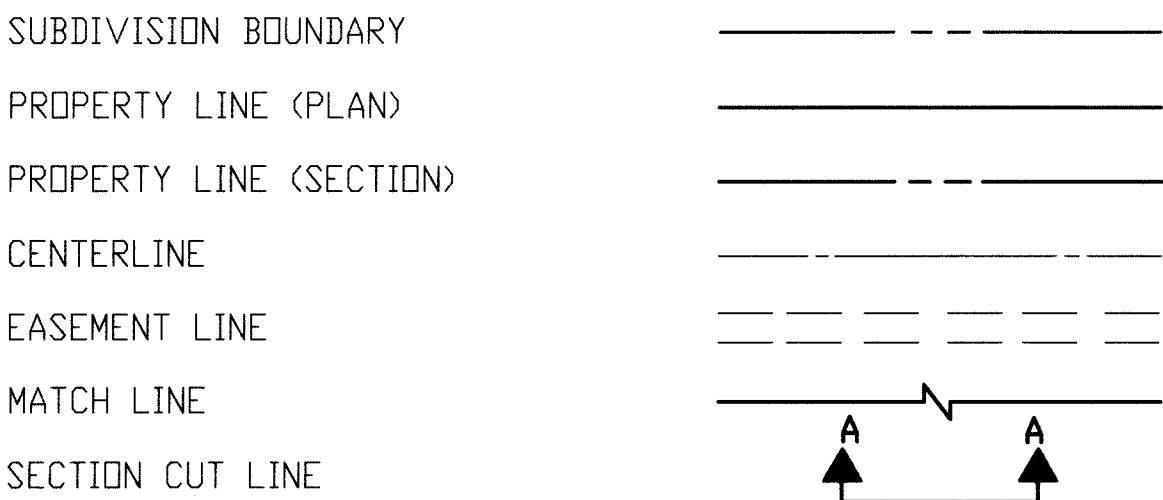

LINES



EARTHWORK

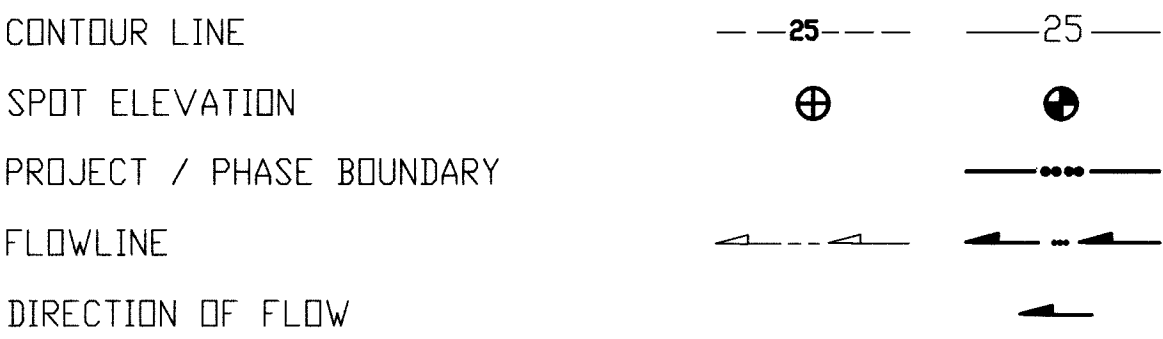

MISCELLANEOUS UTILITIES

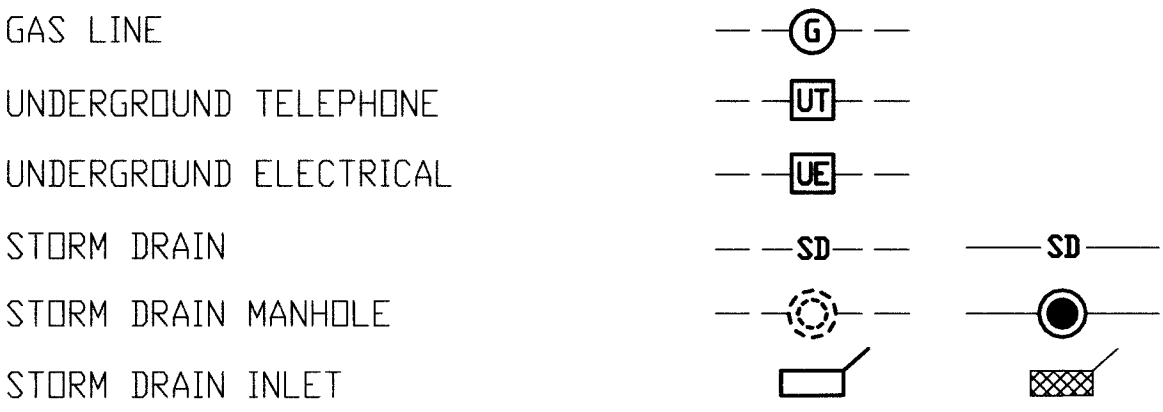

SANITARY SEWER

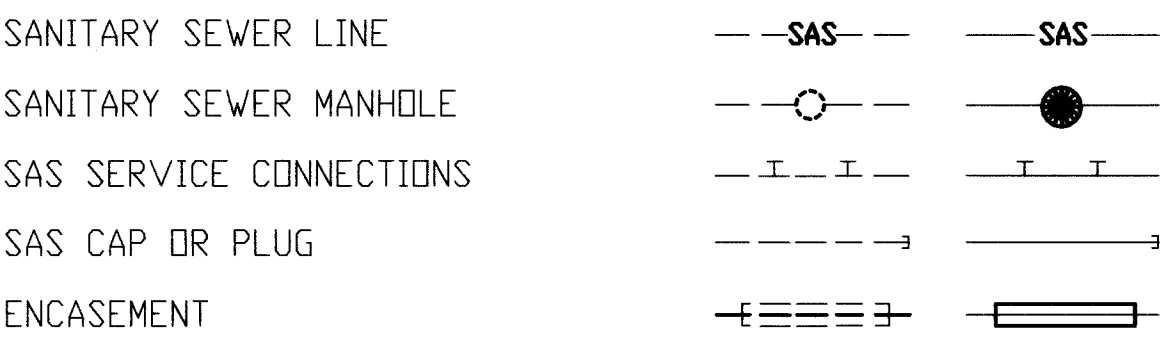

WATER

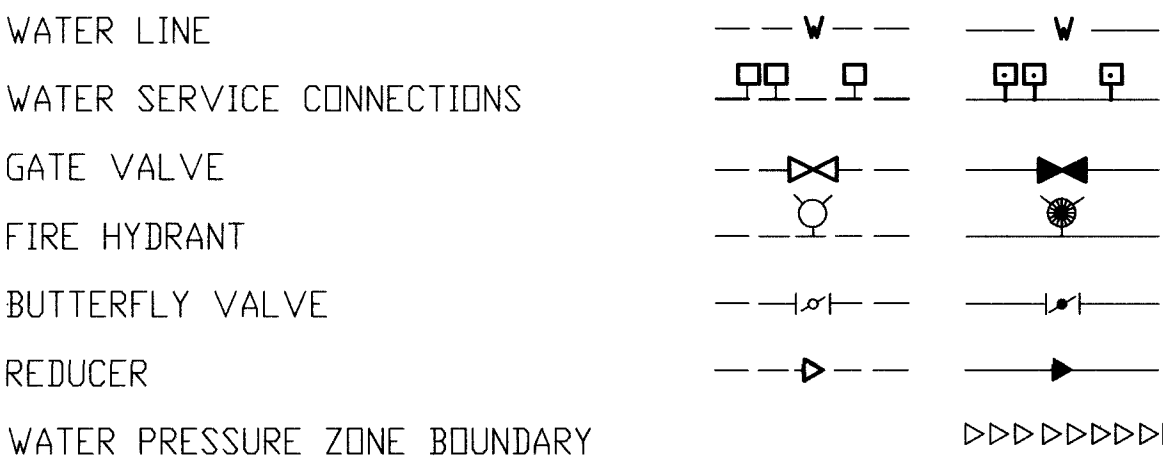

WATER FITTINGS

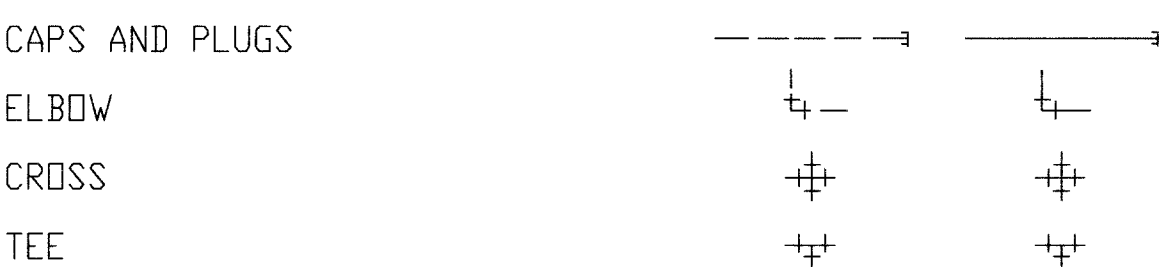

MISCELLANEOUS

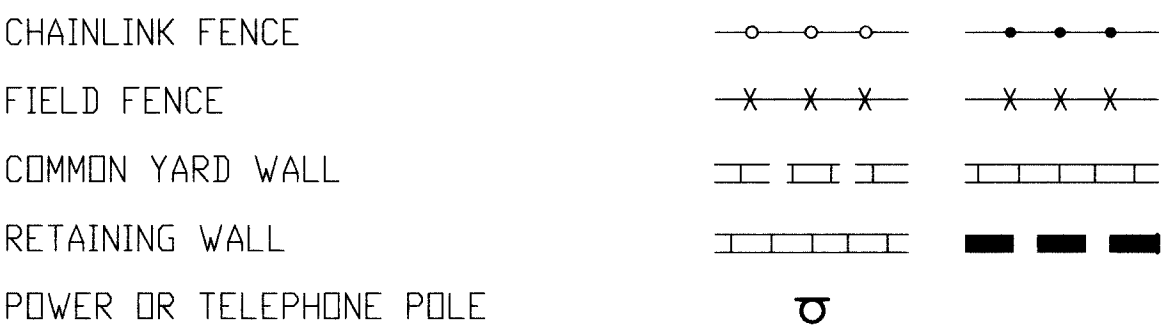

CONSTRUCTION PLANS

for

McLEOD BUSINESS PARK

8" WATERLINE EXTENSION

ALBUQUERQUE, NEW MEXICO

OCTOBER , 1995

INDEX OF DRAWINGS

SHEET	DESCRIPTION
1	COVER SHEET, VICINITY MAP, GENERAL NOTES, LEGEND AND INDEX OF DRAWINGS
2	FINAL PLAT
3	WATERLINE EXTENSION PLAN & PROFILE
4	SIGNING & CONSTRUCTION TRAFFIC CONTROL STANDARDS
5	TYPICAL TRAFFIC CONTROL & SIGNING EXAMPLES

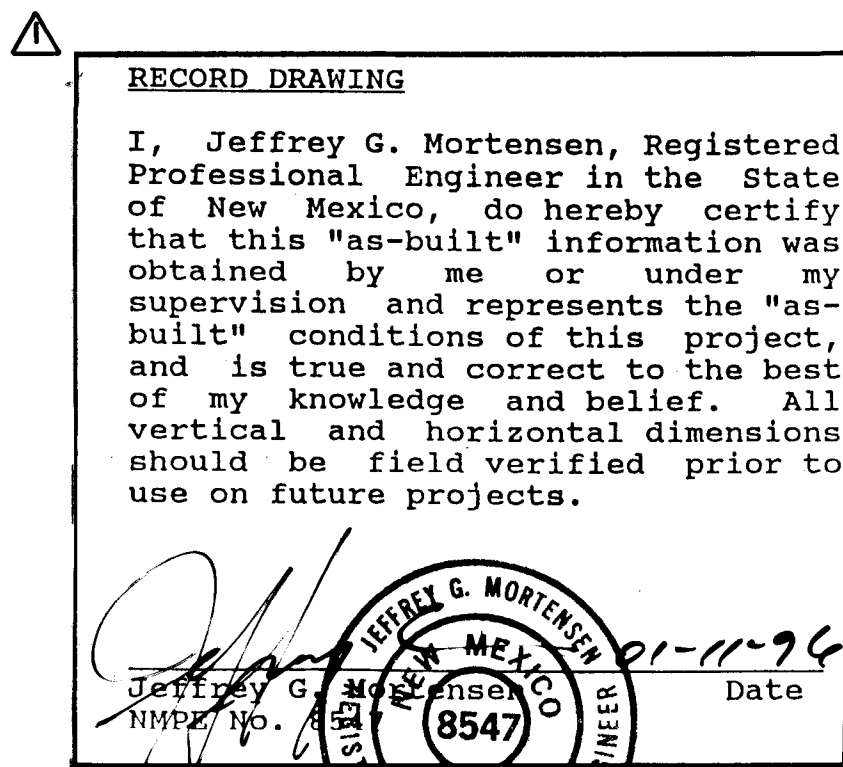

RECORD DRAWING

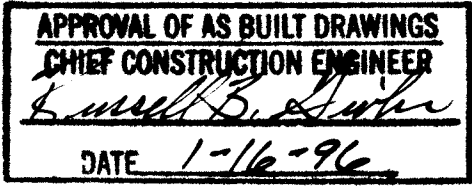

1 2 3 4 5 6 7 8 9 10 11 12 13 14 15  
20-2555.91 01/96

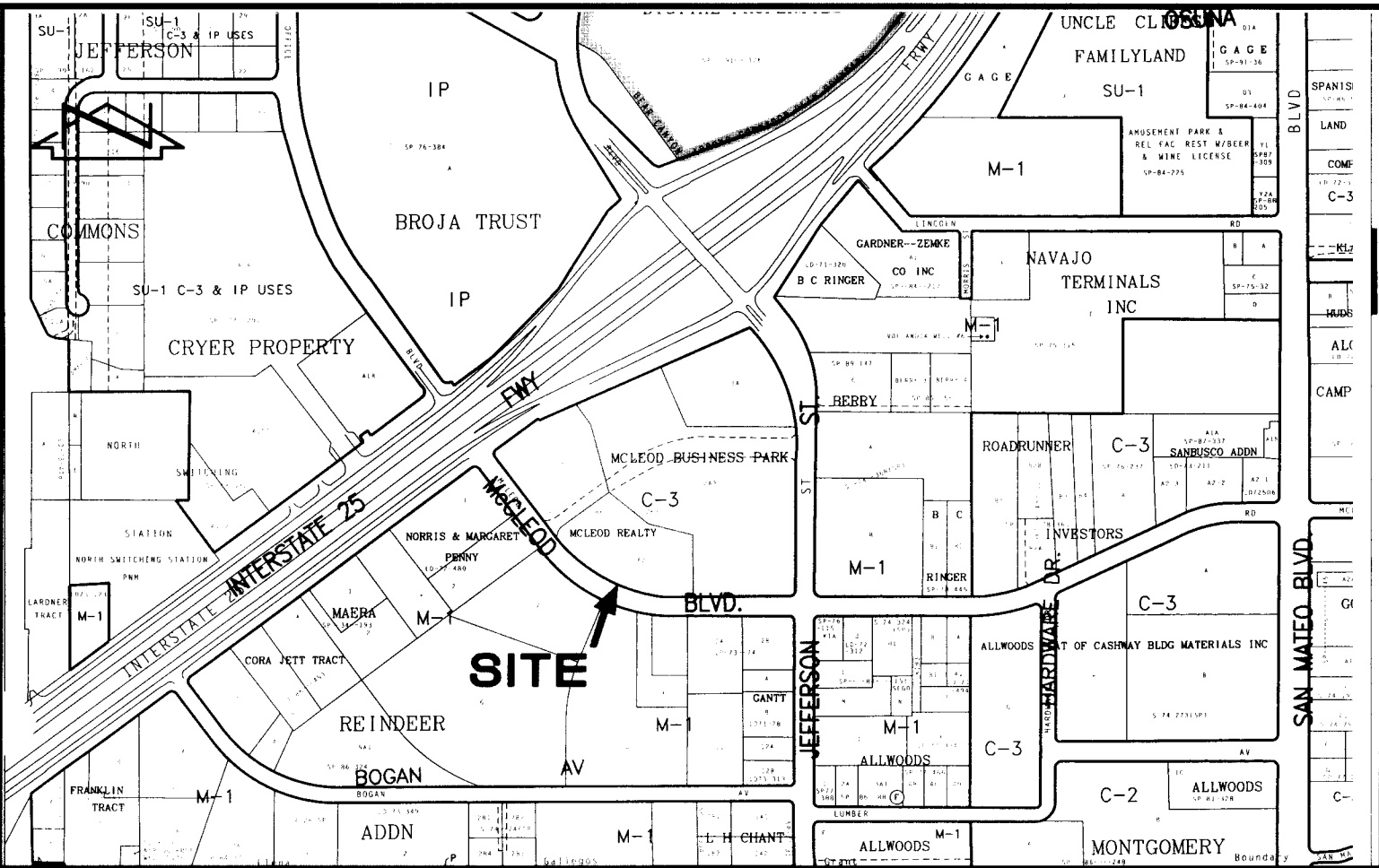

VICINITY MAP  
SCALE: 1" = 750'

F-17

GENERAL NOTES:

- ALL WORK DETAILED ON THESE PLANS TO BE PERFORMED UNDER CONTRACT SHALL, EXCEPT AS OTHERWISE STATED OR PROVIDED FOR HEREON, BE CONSTRUCTED IN ACCORDANCE WITH THE CITY OF ALBUQUERQUE STANDARD SPECIFICATIONS-PUBLIC WORKS CONSTRUCTION-1986 - UPDATE NO. 6.
- TWO (2) WORKING DAYS PRIOR TO ANY EXCAVATION, CONTRACTOR MUST CONTACT NEW MEXICO ONE CALL SYSTEM, 260-1990 (ALBUQUERQUE AREA), 1-800-321-ALERT(2537) (STATEWIDE), FOR LOCATION OF EXISTING UTILITIES.
- IF ANY UTILITY LINES, PIPELINES, OR UNDERGROUND UTILITY LINES ARE SHOWN ON THESE DRAWINGS, THEY ARE SHOWN IN AN APPROXIMATE MANNER ONLY, AND SUCH LINES MAY EXIST WHERE NONE ARE SHOWN. IF ANY SUCH EXISTING LINES ARE SHOWN, THE LOCATION IS BASED UPON INFORMATION PROVIDED BY THE OWNER OF SAID UTILITY, AND THE INFORMATION MAY BE INCOMPLETE, OR MAY BE OBSOLETE BY THE TIME CONSTRUCTION COMMENCES. THE ENGINEER HAS CONDUCTED ONLY PRELIMINARY INVESTIGATION OF THE LOCATION, DEPTH, SIZE, OR TYPE OF EXISTING UTILITY LINES, PIPELINES, OR UNDERGROUND UTILITY LINES. THIS INVESTIGATION IS NOT CONCLUSIVE, AND MAY NOT BE COMPLETE, THEREFORE, MAKES NO REPRESENTATION PERTAINING THERETO, AND ASSUMES NO RESPONSIBILITY OR LIABILITY THEREFOR. THE CONTRACTOR SHALL INFORM ITSELF OF THE LOCATION OF ANY UTILITY LINE, PIPELINE, OR UNDERGROUND UTILITY LINE IN OR NEAR THE AREA OF THE WORK IN ADVANCE OF AND DURING EXCAVATION WORK. THE CONTRACTOR IS FULLY RESPONSIBLE FOR ANY AND ALL DAMAGE CAUSED BY ITS FAILURE TO LOCATE, IDENTIFY AND PRESERVE ANY AND ALL EXISTING UTILITIES, PIPELINES, AND UNDERGROUND UTILITY LINES. IN PLANNING AND CONDUCTING EXCAVATION, THE CONTRACTOR SHALL COMPLY WITH STATE STATUTES, MUNICIPAL AND LOCAL ORDINANCES, RULES AND REGULATIONS, IF ANY, PERTAINING TO THE LOCATION OF THESE LINES AND FACILITIES.
- SHOULD A CONFLICT EXIST BETWEEN THESE PLANS AND ACTUAL FIELD CONDITIONS, THE CONTRACTOR SHALL PROMPTLY NOTIFY THE ENGINEER IN WRITING SO THAT THE CONFLICT CAN BE RESOLVED WITH A MINIMUM AMOUNT OF DELAY FOR ALL PARTIES.
- THE CONTRACTOR SHALL MAINTAIN ACCESS TO ADJACENT PROPERTIES DURING CONSTRUCTION.
- ALL WORK ON THIS PROJECT SHALL BE PERFORMED IN ACCORDANCE WITH APPLICABLE FEDERAL, STATE AND LOCAL LAWS, RULES AND REGULATIONS CONCERNING SAFETY AND HEALTH.
- ALL UTILITIES AND UTILITY SERVICE LINES SHALL BE INSTALLED PRIOR TO PAVING.
- BACKFILL COMPACTION SHALL BE ACCORDING TO SPECIFIED STREET USE.
- TACK COAT REQUIREMENTS SHALL BE DETERMINED DURING CONSTRUCTION BY THE PROJECT ENGINEER.
- SIDEWALKS AND WHEELCHAIR RAMPS WITHIN THE CURB RETURNS SHALL BE CONSTRUCTED WHEREVER A NEW CURB RETURN IS CONSTRUCTED.
- IF CURB IS DEPRESSSED FOR A DRIVEPAD OR A HANDICAP RAMP, THE DRIVEPAD OR RAMP SHALL BE CONSTRUCTED PRIOR TO ACCEPTANCE OF THE CURB AND GUTTER.
- ALL STORM DRAINAGE FACILITIES SHALL BE COMPLETED PRIOR TO FINAL ACCEPTANCE.
- CONTRACTOR SHALL COORDINATE WITH THE WATER SYSTEM DIVISION FOR THE EXECUTION OF THE VALVE SHUT OFF PLAN, NOT LESS THAN THREE (3) WORKING DAYS IN ADVANCE OF ANY WORK THAT MAY AFFECT THE EXISTING PUBLIC WATER UTILITIES. ONLY WATER SYSTEM DIVISION PERSONNEL SHALL OPERATE EXISTING VALVES. REFER TO SECTION 18 OF THE SPECIFICATION. THE WATER SYSTEM DIVISION PHONE NUMBER IS 857-8200.
- CONTRACTOR SHALL NOTIFY THE CITY SURVEYOR NOT LESS THAN SEVEN (7) DAYS PRIOR TO STARTING WORK IN ORDER THAT THE CITY SURVEYOR MAY TAKE NECESSARY MEASURES TO INSURE THE PRESERVATION OF SURVEY MONUMENTS. CONTRACTOR SHALL NOT DISTURB PERMANENT SURVEY MONUMENTS WITHOUT THE CONSENT OF THE CITY SURVEYOR AND SHALL NOTIFY THE CITY SURVEYOR AND BARE THE EXPENSE OF REPLACING ANY THAT MAY BE DISTURBED WITHOUT PERMISSION. REPLACEMENT SHALL BE DONE ONLY BY THE CITY SURVEYOR. WHEN A CHANGE IS MADE IN THE FINISHED ELEVATION OF THE PAVEMENT OF ANY ROADWAY IN WHICH A PERMANENT SURVEY MONUMENT IS LOCATED, CONTRACTOR SHALL, AT HIS OWN EXPENSE, ADJUST THE MONUMENT COVER TO THE NEW GRADE UNLESS OTHERWISE SPECIFIED. REFER TO SECTION 4.4 OF THE SPECIFICATIONS.
- THREE (3) WORKING DAYS PRIOR TO BEGINNING CONSTRUCTION THE CONTRACTOR SHALL SUBMIT TO THE CONSTRUCTION CO-ORDINATION DIVISION A DETAILED CONSTRUCTION SCHEDULE. TWO (2) WORKING DAYS PRIOR TO CONSTRUCTION THE CONTRACTOR SHALL OBTAIN A BARRICADING PERMIT FROM THE CONSTRUCTION COORDINATION DIVISION. CONTRACTOR SHALL NOTIFY BARRICADE ENGINEER (768-2551) PRIOR TO OCCUPYING AN INTERSECTION. CONTRACTOR SHALL REFER TO SECTION 19 OF THE STANDARD SPECIFICATION FOR TRAFFIC CONTROL.
- ALL STREET STRIPING ALTERED OR DESTROYED SHALL BE REPLACED IN KIND BY CONTRACTOR TO LOCATION AND IN KIND AS EXISTING OR AS INDICATED BY THIS PLAN SET.
- CAUTION: THESE DRAWINGS DO NOT INCLUDE NECESSARY COMPONENTS FOR CONSTRUCTION SAFETY WHICH SHALL REMAIN THE RESPONSIBILITY OF THE CONTRACTOR.
- ANY WORK OCCURRING WITHIN AN ARTERIAL ROADWAY REQUIRES TWENTY-FOUR HOUR CONSTRUCTION.

REV.	SHEETS	CITY ENGINEER	DATE	USER	DEPARTMENT	DATE	USER	DEPARTMENT	DATE
			01/96						
APPROVAL OF REVISIONS									

		APPROVED FOR CONSTRUCTION  12/13/95 C.E.
CITY PROJECT # 2555.91		SHEET 1 OF 5

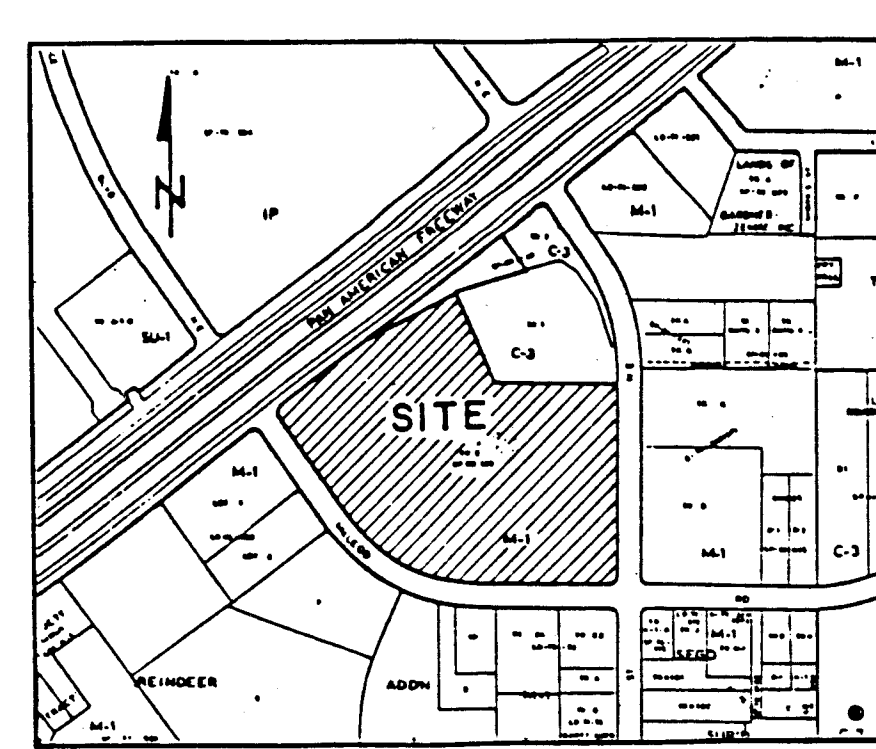
VICINITY MAP  
NOT TO SCALE

86 67346

State of New Mexico  
County of Bernalillo  
The undersigned, Daniel L. Morehead, a duly qualified and licensed Surveyor, do hereby certify that the foregoing is a true and correct copy of the original record of the same as the same appears from the records of the County Clerk of Bernalillo County, New Mexico.

**MC LEOD BUSINESS PARK****TRACTS 2-A-1, 2-A-2 & 2-A-3**CITY OF ALBUQUERQUE,  
BERNALILLO COUNTY, NEW MEXICOBEING A REPLAT  
OF  
TRACT 2-A**MCLEOD BUSINESS PARK**

JULY, 1986

## GENERAL NOTES:

1. BEARING BASIS: The recorded plat of McLeod Business Park, filed Aug. 30, 1985 (Vol. C28, Folio 45). (Bearings determined by calculation to be state plane grid bearings.)
2. The purpose of this replat is to create 3 tracts for commercial development.
3. Hearings and distances are record.
4. No property corners set.
5. 6' sidewalks are required to be constructed along Jefferson Rd. N.E. and McLeod Rd. N.E.
6. Prior to development, City of Albuquerque Water and Sanitary Sewer Service to Tract 2-A-3 must be verified and coordinated with the Public Works Department, City of Albuquerque, via a request for a water and sanitary sewer availability statement.

## Plat Data

86-464  
D.R. Case Number  
F-17  
Case Allow Number  
20 1155  
Case Allowage  
3  
Total Number Tracts Created  
0  
Total Mileage of Streets Created  
N/A  
Date of Survey  
07-11-1986  
Title Log No.

SP-86-263

APPROVED BY:  
*[Signature]* 7-22-86  
Traffic Engineer, Transportation Department  
*[Signature]* 7-22-86  
City and Metropolitan Department  
*[Signature]* 07-14-86  
Public Works Department  
*[Signature]* 7-22-86  
Water Resources Department  
*[Signature]* 7-18-86  
Property Management  
*[Signature]* 7-22-86  
Albuquerque Metropolitan Arroyo Flood Control Authority  
*[Signature]* 7-22-86  
City Engineer, Engineering Division  
*[Signature]* 7-22-86  
City Planner, Albuquerque Bernalillo County Planning Division  
*[Signature]* 7-11-86  
Public Service Company of New Mexico  
*[Signature]* 7-11-86  
Mountain Bell  
*[Signature]* 7-10-86  
Gas Company of New Mexico

## CERTIFICATION

I, Daniel L. Morehead, New Mexico Registered Land Surveyor No. 8324, do hereby certify that this plat was prepared under my supervision, that no field survey was performed, that this plat shows all easements of record and meets the minimum requirements of the Albuquerque Subdivision Ordinance and is true and correct to the best of my knowledge and belief.

*[Signature]* 7-2-86  
Daniel L. Morehead  
N.R.L.S. No. 8324  
State of New Mexico)  
County of Bernalillo)

The foregoing instrument was acknowledged before me this 2nd day of July, 1986, by Daniel L. Morehead.

*[Signature]* 7-2-86  
Notary Public  
OFFICIAL SEAL  
NOTARY PUBLIC, NEW MEXICO  
Notary bond filed with Secretary of State

## LEGAL DESCRIPTION

A Tract of land situate within projected Section 35, Township 11 North, Range 3 East and within the Elena Gallegos Grant, being Tract 2-A of McLeod Business Park, Albuquerque, New Mexico as the same is shown and designated on said plat filed in the office of the County Clerk of Bernalillo County, New Mexico on Aug. 30, 1985 (Vol. C28, Folio 45), and being more particularly described as follows:

Beginning at the Southeasterly return at the intersection of U.S. Interstate Highway I-25 - East Frontage Road and McLeod Road N.E., from whence NMHC Brass Cap Sta. "NMHC 1-25-18" bears S 55° 23' 35" W, 877.75 feet;

Thence 39.27 feet along a curve to the right whose radius is 25.00 feet and whose chord bears N 08° 26' 40" E, 35.36 feet through a central angle of 90° 00' 00"; thence N 53° 26' 40" E, 216.36 feet to a point on the Southeasterly boundary of Tract 3-A, McLeod Business Park; thence along said boundary N 68° 21' 30" E, 567.04 feet to a point on the Southerly boundary of Tract 1-A of McLeod Business Park; thence along said Southerly boundary S 23° 38' 30" E, 299.61 feet; thence continuing S 89° 56' 00" E, 470.55 feet to the Northwest corner of the Tract heretofore described; thence leaving said Southerly boundary 77.68 feet along a curve to the right whose radius is 743.81 feet and whose chord bears S 02° 55' 31" E, 77.64 feet through a central angle of 05° 59' 02" to a point on the Westerly R/W line of Jefferson Rd., N.E.; thence along said R/W line S 00° 04' 00" W, 624.50 feet; thence 39.27 feet along a curve to the right whose radius is 25.00 feet and whose chord bears S 45° 04' 00" W, 35.36 feet through a central angle of 90° 00' 00" to a point on the Northerly R/W line of McLeod Rd., N.E.; thence along said R/W line N 89° 56' 00" W, 488.07 feet; thence continuing 612.07 feet along a curve to the right whose radius is 657.00 feet and whose chord bears N 63° 18' 40" W, 590.18 feet through a central angle of 53° 22' 40"; thence continuing N 36° 33' 20" W, 417.52 feet to the beginning corner and containing 20.1155 acres (876,230 sq. ft.), more or less.

## FREE CONSENT &amp; DEDICATION

The undersigned owner and proprietor of the land shown hereon, does hereby consent to the replat shown hereon, and said owner dedicates all easements as shown hereon.

Electrical Power and Communication easements are reserved for overhead distribution lines for pole type utilities and buried distribution lines, conduits, pipes and other related equipment for underground utilities where shown or indicated, and including the right of ingress and egress for construction and maintenance, and the right to trim interfering trees and shrubs. Also included are easements for the right to install power and communication service lines along side lot lines.

Additional PM easements may be required to serve future customers. These easements shall include minimum working space requirements for single and three phase transformers. See Public Service Company of New Mexico (PSCNM) Distribution Standard Drawing DS-7-16.2 for details.

Don McLeod Date

STATE OF NEW MEXICO)  
COUNTY OF BERNALILLO)

The foregoing instrument was acknowledged before me this 2nd day of July, 1986, by Don McLeod.

My commission expires \_\_\_\_\_  
Notary Public

Greiner Engineering

Design

Drawn LA, KM

Check J, PW

Scale

Date

Job No.

Sheet 1 of 2

Date

Job No.

Sheet 1 of 2

Date

Job No.

Sheet 1 of 2

Date

Job No.

Sheet 1 of 2

Date

Job No.

Sheet 1 of 2

Date

Job No.

Sheet 1 of 2

Date

Job No.

Sheet 1 of 2

Date

Job No.

Sheet 1 of 2

Date

Job No.

Sheet 1 of 2

Date

Job No.

Sheet 1 of 2

Date

Job No.

Sheet 1 of 2

Date

Job No.

Sheet 1 of 2

Date

Job No.

Sheet 1 of 2

Date

Job No.

Sheet 1 of 2

Date

Job No.

Sheet 1 of 2

Date

Job No.

Sheet 1 of 2

Date

Job No.

Sheet 1 of 2

Date

Job No.

Sheet 1 of 2

Date

Job No.

Sheet 1 of 2

Date

Job No.

Sheet 1 of 2

Date

Job No.

Sheet 1 of 2

Date

Job No.

Sheet 1 of 2

Date

Job No.

Sheet 1 of 2

Date

Job No.

Sheet 1 of 2

Date

Job No.

Sheet 1 of 2

Date

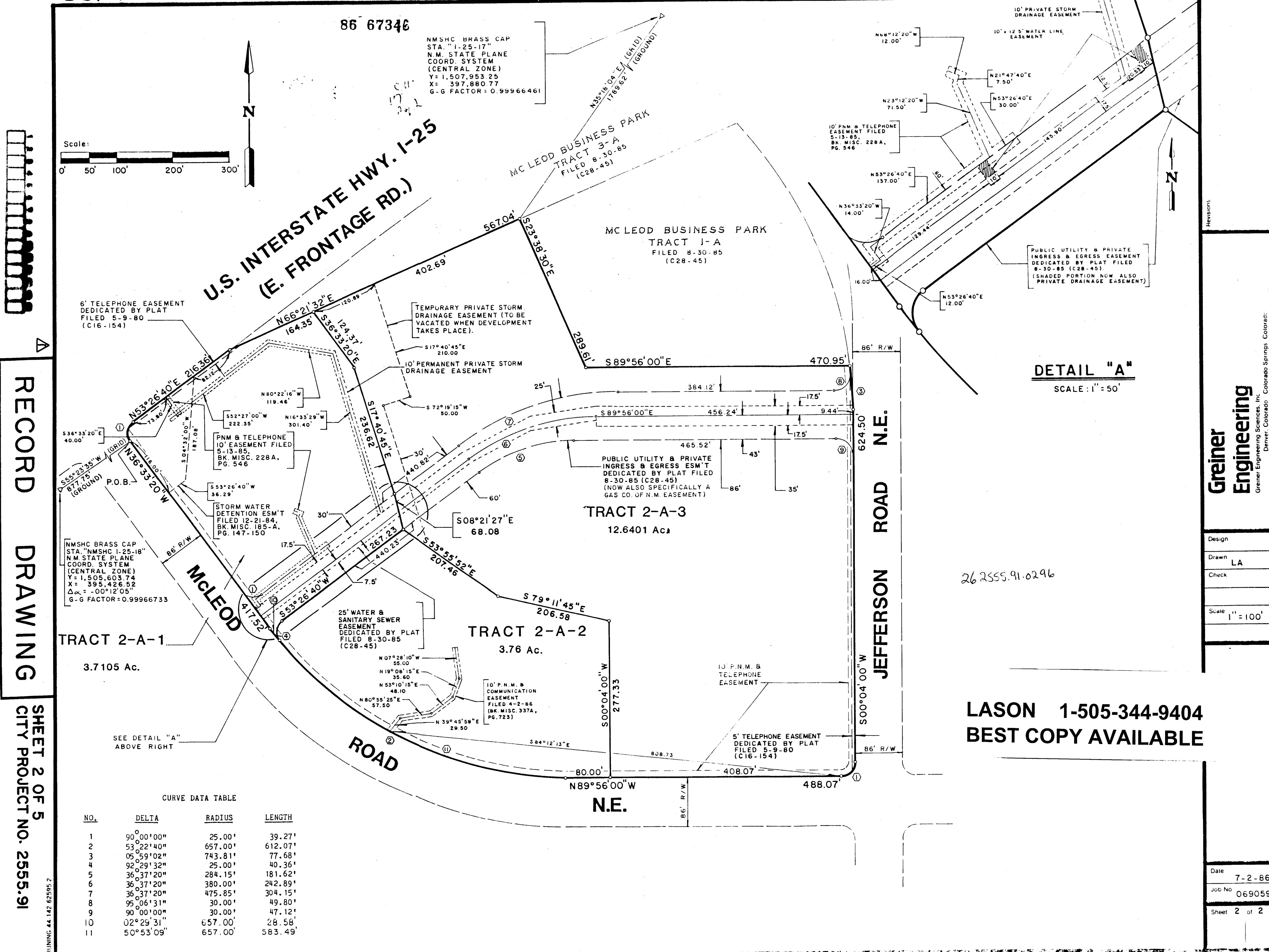

Greiner Engineering

Design

Drawn LA

Check

Scale 1" = 100'

Date

Job No.

Sheet 2 of 2

Date

Job No.

Sheet 2 of 2

Date

Job No.

Sheet 2 of 2

Date

Job No.

Sheet 2 of 2

Date

Job No.

Sheet 2 of 2

Date

Job No.

Sheet 2 of 2

Date

Job No.

Sheet 2 of 2

Date

Job No.

Sheet 2 of 2

Date

Job No.

Sheet 2 of 2

Date

Job No.

Sheet 2 of 2

Date

Job No.

Sheet 2 of 2

Date

Job No.

Sheet 2 of 2

Date



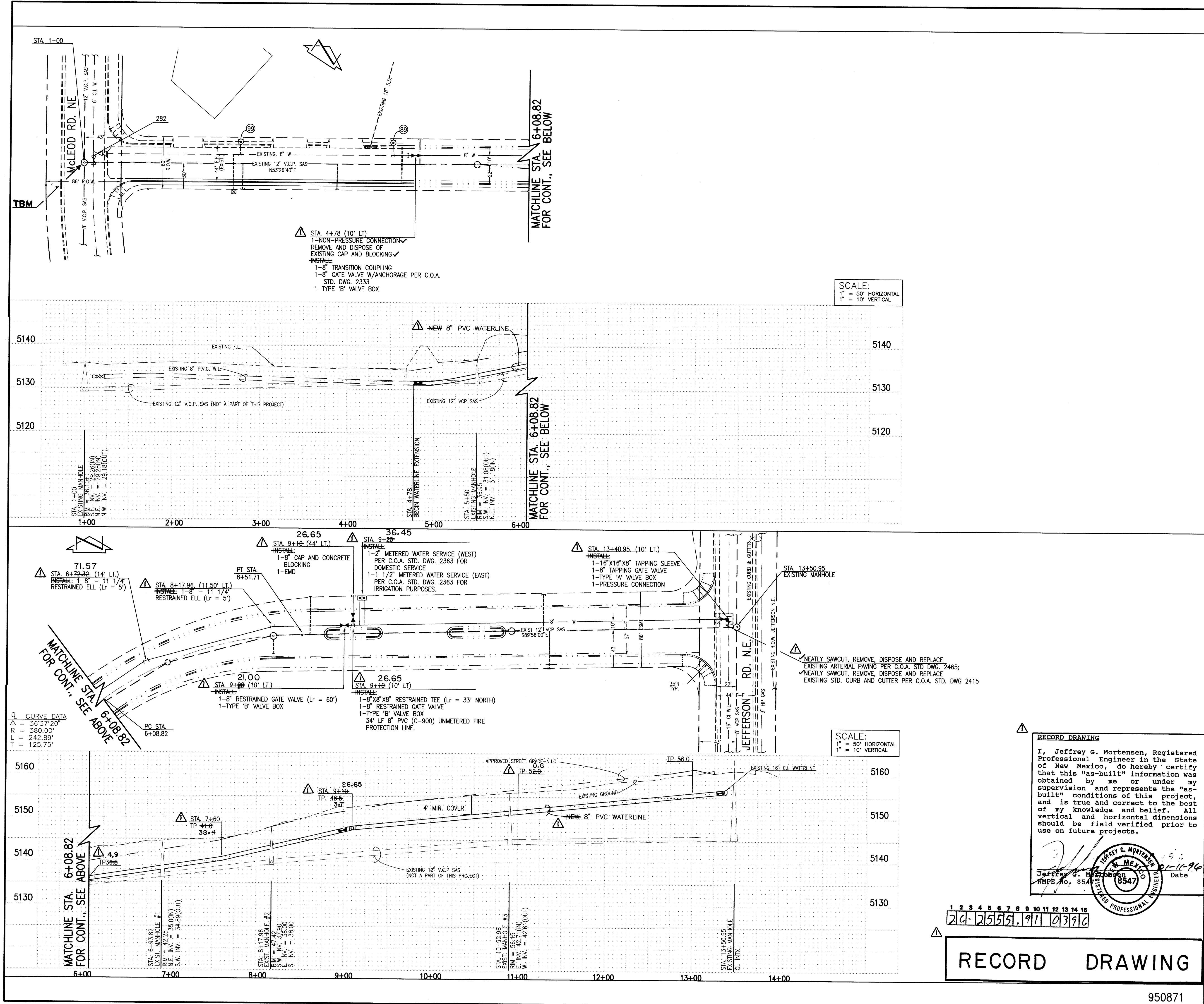

- WATERLINE CONSTRUCTION NOTES:
- ALL STATIONING IS BASED ON EASEMENT CENTERLINE UNLESS INDICATED OTHERWISE.
  - FOR ALL LINES 12" AND SMALLER, WATER MAIN SHALL BE PVC C-900 PIPE OR AS APPROVED BY THE CITY OF ALBUQUERQUE CITY ENGINEER. DUCTILE IRON IS AN ACCEPTABLE PIPE MATERIAL IN LIEU OF PVC.
  - FOR ALL LINES 14" AND LARGER, WATER MAIN SHALL BE DUCTILE IRON OR AS APPROVED BY THE CITY OF ALBUQUERQUE CITY ENGINEER. CONCRETE CYLINDER IS AN ACCEPTABLE PIPE MATERIAL IN LIEU OF DUCTILE IRON.
  - WATERLINE SHALL HAVE A MINIMUM COVER OF 4'0" FINISHED GRADE TO TOP OF PIPE). EXTRA DEPTH TRENCHING, IF REQUIRED, SHALL BE CONSIDERED INCIDENTAL TO CONSTRUCTION. THEREFORE, NO SEPARATE PAYMENT WILL BE MADE.
  - ELECTRONIC MARKER DISCS (EMD) SHALL BE INSTALLED IN ACCORDANCE WITH THE STANDARD SPECIFICATION.
  - IN ACCORDANCE WITH SECTION 801 OF THE "STANDARD SPECIFICATIONS", METALIZED DETECTABLE WARNING TAPE SHALL BE INSTALLED 18" ABOVE ALL PVC PIPE INSTALLED ON THIS PROJECT.
  - VALVE STEM AND FIRE HYDRANT EXTENSIONS SHALL BE PROVIDED IN ACCORDANCE WITH THE STANDARD SPECIFICATIONS. THE COST OF EACH EXTENSION SHALL BE CONSIDERED INCIDENTAL TO CONSTRUCTION THEREFORE NO SEPARATE PAYMENT WILL BE MADE.
  - JOINT RESTRAINT SHALL BE CONSIDERED INCIDENTAL TO WATERLINE CONSTRUCTION THEREFORE NO SEPARATE PAYMENT WILL BE MADE.
  - JOINT RESTRAINT SHALL BE PROVIDED ON ALL JOINTS OF FIRE HYDRANT LEGS FROM TEE TO FIRE HYDRANT INCLUDING THE TEE AND FIRE HYDRANT.
  - FOR THE PURPOSES OF THIS PROJECT, ALL RESTRAINED JOINTS AND JOINT RESTRAINT SHALL BE MECHANICALLY RESTRAINED.

- WATER VALVE SHUTOFF PLAN REQUIREMENTS:
- AS A MINIMUM, THE FOLLOWING VALVES SHALL BE CLOSED TO FACILITATE THE PROPOSED CONNECTION @ STA. 4+78:  
282
  - THE CONTRACTOR SHALL NOTIFY WATER SYSTEMS THREE (3) WORKING DAYS IN ADVANCE OF ANY WORK THAT MAY AFFECT EXISTING WATERLINE. ALL SHUTOFFS SHALL BE PERFORMED BY THE WATER SYSTEM DIVISION PERSONNEL (857-8200).
  - THE CONTRACTOR SHALL PROVIDE ALL RESTRAINTS AND THRUST BLOCKS NECESSARY TO EFFECT THE NECESSARY SHUTOFFS AND CONNECTIONS.
  - EXISTING WATER VALVE AND WATERLINE INFORMATION OBTAINED FROM CITY OF ALBUQUERQUE AUTOMATED WATER DISTRIBUTION SYSTEM SECTIONAL MAP F-17.
  - AT THE TIME OF WATER SHUTOFF APPLICATION, THE CONTRACTOR SHALL REQUEST THAT THE WATER SYSTEM DIVISION NOTIFY ALL AFFECTED PROPERTY OWNERS AT LEAST 24 HOURS IN ADVANCE OF THE RESPECTIVE SHUTOFFS.

**RECORD DRAWING**

I, Jeffrey G. Mortensen, Registered Professional Engineer in the State of New Mexico, do hereby certify that this "as-built" information was obtained by me or under my supervision and represents the "as-built" conditions of this project, and is true and correct to the best of my knowledge and belief. All vertical and horizontal dimensions should be field verified prior to use on future projects.

Jeffrey G. Mortensen  
NMPE No. 8547  
Date 11-11-95

JEFFREY G. MORTENSEN  
NEW MEXICO  
REGISTERED PROFESSIONAL ENGINEER  
8547

**JMA** JEFF MORTENSEN & ASSOCIATES, INC.  
6603-B MIDWAY PARK BLVD. NE  
ALBUQUERQUE, N.M. 87109  
ENGINEERS & SURVEYORS (505) 345-4250

CITY OF ALBUQUERQUE  
PUBLIC WORKS DEPARTMENT  
ENGINEERING GROUP

TITLE: McLEOD BUSINESS P/ 8" WATERLINE EXTENS PLAN AND PROFILE

APPROVALS	ENGINEER	DATE	APPROV.
DRC CHAIRMAN	<i>R. G. Gandy</i>	11-21-95	WATER
TRANSPORTATION	<i>R. G. Gandy</i>	11-27-95	WASTE WA
HYDROLOGY	<i>R. G. Gandy</i>	11/27/95	

**RECORD DRAWING**

PROJECT NO. 950871  
2555.91  
MAP NO. F-17

## CONSTRUCTION TRAFFIC CONTROL GENERAL NOTES

1. CONTRACTOR MUST OBTAIN FROM CONSTRUCTION COORDINATION AN EXCAVATION/BARRICADING PERMIT BEFORE ENGAGING IN ANY CONSTRUCTION, MAINTENANCE OR REPAIR WORK IN ANY OF THE CITY OF ALBUQUERQUE'S RIGHTS-OF-WAY. EMERGENCY WORK THAT WOULD PRESERVE LIFE OR PROPERTY IS EXCLUDED WITH THE UNDERSTANDING, THAT A PERMIT SHALL BE OBTAINED WITHIN 24 TO 48 HOURS.

2. CONTRACTOR SHALL AT THE TIME OF PERMIT REQUEST, SUBMIT FOR APPROVAL BY CONSTRUCTION COORDINATION, A TRAFFIC CONTROL PLAN DETAILING ALL EXISTING TOPOGRAPHY SUCH AS LANE WIDTHS, DRIVEWAYS, AND BUSINESS/RESIDENTIAL ACCESSES. THE TRAFFIC CONTROL PLAN SHALL INCLUDE ALL PHASES OF WORK AND SCHEDULES INVOLVED IN THE CONSTRUCTION PROJECT. ANY SEPARATE PHASES OF A CONSTRUCTION PROJECT SHALL BE GIVEN AN INDIVIDUAL PERMIT EACH. BLANKET PERMITS WILL NOT BE ISSUED.

3. THESE TYPICAL TRAFFIC CONTROL PLANS DO NOT REFLECT THE EXISTING TOPOGRAPHY SUCH AS DRIVEWAYS, LANE WIDTHS, AND BUSINESS/RESIDENTIAL ACCESSES. EVERY LOCATION THAT REQUIRES CONSTRUCTION TRAFFIC CONTROL SHALL HAVE A DETAILED TRAFFIC CONTROL PLAN SHOWING ALL EXISTING TOPOGRAPHY.

4. CONSTRUCTION SHALL NOT BEGIN UNLESS A TRAFFIC CONTROL PLAN HAS BEEN APPROVED AND VERIFIED BY CONSTRUCTION COORDINATION.

5. CONSTRUCTION COORDINATION SHALL BE NOTIFIED 48 HOURS PRIOR TO ANY TRAFFIC CONTROL CHANGES NEEDED BY CONTRACTOR, THAT WERE NOT PREVIOUSLY APPROVED. THESE TRAFFIC CONTROL CHANGES SHALL BE REQUESTED IN WRITING ACCOMPANIED WITH A TRAFFIC CONTROL PLAN REFLECTING SUCH CHANGES.

6. ALL CONSTRUCTION TRAFFIC CONTROL DEVICES SHALL COMPLY TO THE MANUAL ON UNIFORM TRAFFIC CONTROL DEVICES (MUTCD), LATEST EDITION. IT IS THE RESPONSIBILITY OF THE CONTRACTOR TO INSTALL, SERVICE AND MAINTAIN ALL TRAFFIC CONTROL DEVICES. TRAFFIC CONTROL DEVICES SHALL NOT BE REMOVED OR ALTERED IN ANY WAY WITHOUT THE APPROVAL OF CONSTRUCTION COORDINATION, PER SECTION 6A-4 OF THE MUTCD, LATEST EDITION.

7. THE CONSTRUCTION TRAFFIC CONTROL INITIAL SET-UP SHALL BE BY AN AMERICAN TRAFFIC SAFETY SERVICES ASSOCIATION (ATSSA) CERTIFIED WORKSITE TRAFFIC SUPERVISOR. THE MAINTENANCE AND SERVICING SHALL ALSO BE DONE BY AN ATSSA CERTIFIED WORKSITE TRAFFIC SUPERVISOR OR EQUIVALENT.

8. CONTRACTOR IS RESPONSIBLE TO MAINTAIN AND SERVICE ALL TRAFFIC CONTROL DEVICES 24 HOURS A DAY, 7 DAYS A WEEK THROUGHOUT LENGTH OF PROJECT. CONTRACTOR IS RESPONSIBLE THAT ALL TRAFFIC CONTROL DEVICES COMPLY WITH THE MUTCD, LATEST EDITION.

9. ALL ADVANCE WARNING SIGNS SHALL BE DOUBLE INDICATED WHENEVER THERE ARE MULTI-LANE TRAFFIC IN ANY ONE GIVEN DIRECTION AND THERE IS SUFFICIENT MEDIAN SPACE.

10. ALL BARRICADES IN ALL TAPERS AND TANGENTS SHALL BE PLACED APART, A DISTANCE MEASURED IN FEET, EQUAL TO THAT OF THE POSTED SPEED LIMIT. NO EXCEPTIONS UNLESS APPROVED BY CONSTRUCTION COORDINATION PER MUTCD SECTION 6A-4.

11. CONTRACTOR SHALL NOT BEGIN WORK BEFORE 8:30 A.M. OR END WORK AFTER 4:00 P.M. WITHOUT THE APPROVAL OF CONSTRUCTION COORDINATION.

12. CONTRACTOR IS RESPONSIBLE TO PROVIDE CONSTRUCTION COORDINATION, A WEEKLY LOG OF DAILY INSPECTIONS OF BARRICADE AND MAINTENANCE SCHEDULES ON PROJECTS THAT ARE OVER ONE WEEK DURATION.

13. EQUIPMENT OR MATERIALS SHALL NOT BE STORED WITHIN 15 FEET OF A TRAVELLED TRAFFIC LANE DURING NON-WORKING HOURS WITHOUT THE APPROVAL OF CONSTRUCTION COORDINATION.

14. CONTRACTOR SHALL PROVIDE AND MAINTAIN A SAFE AND ADEQUATE MEANS OF CHANNELIZING PEDESTRIAN TRAFFIC AROUND AND THROUGH THE CONSTRUCTION AREA.

15. CONTRACTOR IS RESPONSIBLE FOR OBLITERATION OF ANY CONFLICTING STRIPING AND RESPONSIBLE FOR ALL TEMPORARY STRIPING.

16. CONTRACTOR SHALL MAINTAIN ACCESS TO ALL FACILITIES, BUSINESSES AND/OR RESIDENTS AT ALL TIMES.

17. CONTRACTOR SHALL PROVIDE ACCESS SIGNS FOR BUSINESSES LOCATED WITHIN THE CONSTRUCTION AREA UNDER THE SUPERVISION OF CONSTRUCTION COORDINATION. EACH ACCESS SIGN SHALL HAVE 5 INCH, WHITE OPAQUE LETTERING ON BLUE REFLECTORIZED BACKGROUND. ACCESS SIGNS SHALL BE CONSIDERED INCIDENTAL TO THE BID AND NOT PART OF THE CONTRACT UNLESS OTHERWISE STATED. NO MORE THAN 3 BUSINESSES SHALL BE LISTED ON A ACCESS SIGN. SHOPPING CENTERS AND MALLS SHALL BE LISTED AS SUCH.

18. ALL ADVANCE WARNING SIGNS SHALL MEET THE MINIMUM REFLECTIVE INTENSITY REQUIREMENTS SET FORTH BY THE CITY OF ALBUQUERQUE. CONSTRUCTION COORDINATION SHALL DETERMINE ALL REQUIREMENTS AND APPROVE OR DISAPPROVE ANY ADVANCE WARNING SIGN PER SECTION 6A-4 OF THE MUTCD, LATEST EDITION.

19. 24 HOURS PRIOR TO OCCUPYING OR CLOSING OF A RIGHT-OF-WAY, CONTRACTOR SHALL NOTIFY: POLICE, FIRE DEPARTMENT, SCHOOLS, HOSPITALS, TRANSIT AUTHORITY, BUSINESSES AND/OR RESIDENTS THAT WILL BE AFFECTED BY THE CONSTRUCTION.

20. ANY FIELD ADJUSTMENTS SHALL BE APPROVED BY CONSTRUCTION COORDINATION.

21. EXCAVATIONS SHALL BE PLATED, TEMPORARILY PATCHED OR RESURFACED PRIOR TO OPENING OF TRAFFIC. A MINIMUM OF 11 FEET SHALL BE PROVIDED FOR TRAFFIC IN ANY GIVEN DIRECTION. CONTRACTOR IS RESPONSIBLE FOR ANY WORK INVOLVED IN SATISFYING THESE REQUIREMENTS.

22. CONTRACTOR SHALL AT ALL TIMES COMPLY WITH THE FOLLOWING:  
1. STANDARDS AND REQUIREMENTS SET FORTH IN THE MANUAL ON UNIFORM TRAFFIC CONTROL DEVICES, LATEST EDITION.  
2. THE CITY OF ALBUQUERQUE TRAFFIC CODE, LATEST EDITION.  
3. SECTION 19 OF THE CITY OF ALBUQUERQUE'S STANDARD SPECIFICATIONS FOR PUBLIC WORK CONSTRUCTION, AS WELL AS OTHER SECTIONS.

23. FAILURE TO COMPLY WITH ANY OF THE ABOVE MENTIONED, WILL BE ADEQUATE CAUSE TO CEASE ALL WORK ON ANY CONSTRUCTION PROJECT. WORK WILL NOT RESUME UNTIL ALL REQUIREMENTS ARE ADDRESSED AND APPROVED BY CONSTRUCTION COORDINATION.

24. ALL TRAFFIC CONTROL DEVICES SHALL BE KEPT IN NEW-CLEAN CONDITION. WASHING OF EQUIPMENT IS INCIDENTAL TO ITS PLACEMENT AND MAINTENANCE.

25. TRAFFIC CONTROL STANDARDS APPLY ONLY WHERE THE CONSTRUCTION TRAFFIC CONTROL PLANS ARE NOT SPECIFIC.

## PROJECT CONSTRUCTION TRAFFIC CONTROL GENERAL NOTES

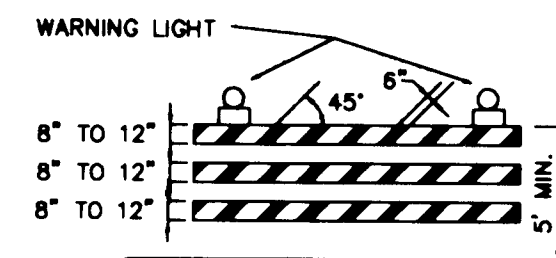

TYPE III BARRICADE

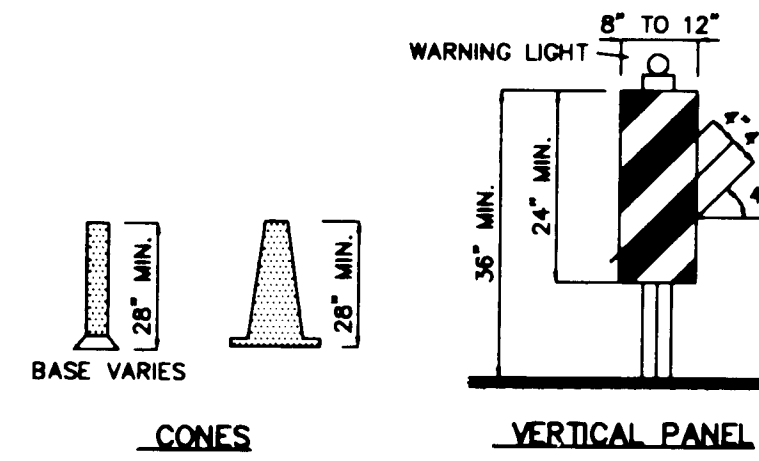

VERTICAL PANEL

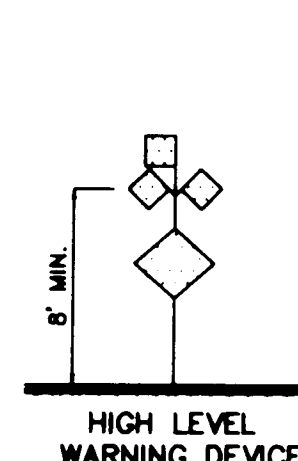

HIGH LEVEL WARNING DEVICE

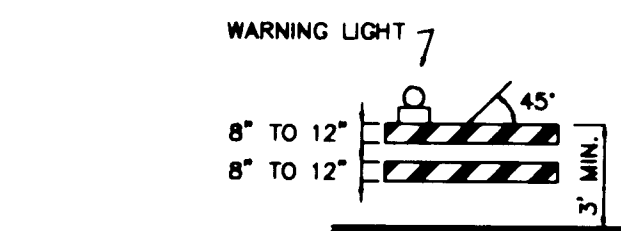

TYPE II BARRICADE

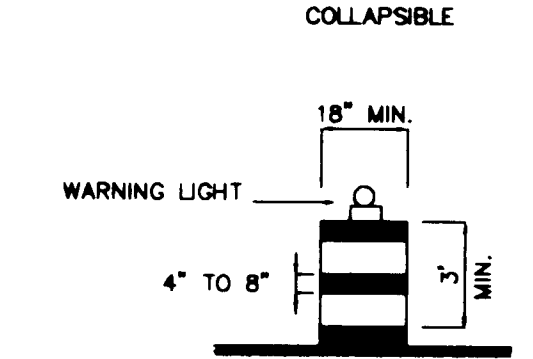

BARREL

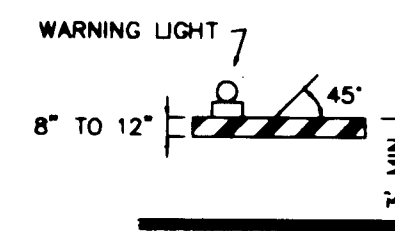

TYPE I BARRICADE

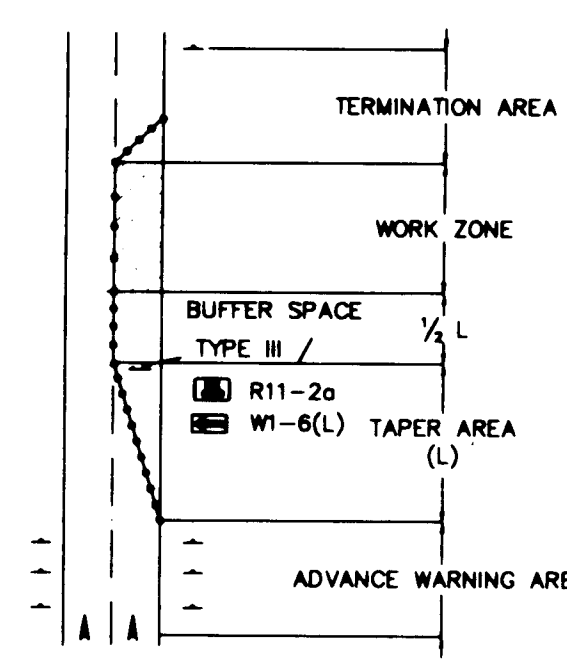

TRAFFIC CONTROL ELEMENTS

## LEGEND

- WORK AREA  
BARRICADE - TYPE I, TYPE II, OR BARREL  
BARRICADE - TYPE III  
VERTICAL PANEL  
WARNING SIGN  
DISTANCE BETWEEN SIGNS - A DISTANCE MEASURED IN FEET EQUAL TO A VALUE OF TEN TIMES THE SPEED LIMIT OF THE STREET  
FLAGMAN POSITION  
SPACING BETWEEN BARRICADES - A DISTANCE MEASURED IN FEET EQUAL TO THE SPEED LIMIT OF THE STREET  
TAPER LENGTH - SEE CHART BELOW  
THE TANGENT LENGTH IS EQUAL TO THE TAPER LENGTH FOR A GIVEN STREET.

## TAPER REQUIREMENTS

SPEED LIMIT (MPH)	TAPER LENGTH (FEET)			MINIMUM NUMBER OF DEVICES FOR TAPER	MAXIMUM DEVICE SPACING IN FEET	
	10' LANE	11' LANE	12' LANE		ALONG TAPER	AFTER TAPER
20	70	75	80	5	20	20
25	105	115	125	6	25	25
30	150	165	180	7	30	30
35	205	225	245	8	35	35
40	270	295	320	9	40	40
45	450	495	540	13	45	45
50	500	550	600	13	50	50
55	550	605	660	13	55	55

## RECOMMENDED SIGN SPACING FOR ADVANCE WARNING SIGN SERIES

SPEED PER HOUR	MINIMUM DISTANCE IN FEET	
	BETWEEN SIGNS	FROM LAST SIGN TO TAPER
0-20	10 X SPEED LIMIT	10 X SPEED LIMIT
25-30	10 X SPEED LIMIT	10 X SPEED LIMIT
30-35	10 X SPEED LIMIT	10 X SPEED LIMIT
40-45	10 X SPEED LIMIT	10 X SPEED LIMIT
50-60	10 X SPEED LIMIT	10 X SPEED LIMIT

## TAPER CRITERIA

TYPE OF TAPER	TAPER LENGTH
UPSTREAM TAPER:	
MERGING TAPER	L MINIMUM
SHIFTING TAPER	1/2 L MINIMUM
SHOULDER TAPER	1/2 L MINIMUM
TWO-WAY TRAFFIC TAPER	100 FEET MAXIMUM
DOWNSTREAM TAPERS	100 FEET PER LANE

## TAPER LENGTH COMPUTATION

SPEED LIMIT	L =
40 MPH OR LESS	$L = \frac{WS^2}{60}$
45 MPH OR GREATER	$L = W \times S$

L = TAPER LENGTH  
W = WIDTH OF OFFSET IN FEET  
S = POSTED SPEED OR OFF-PEAK 85-PERCENTILE SPEED IN MPH

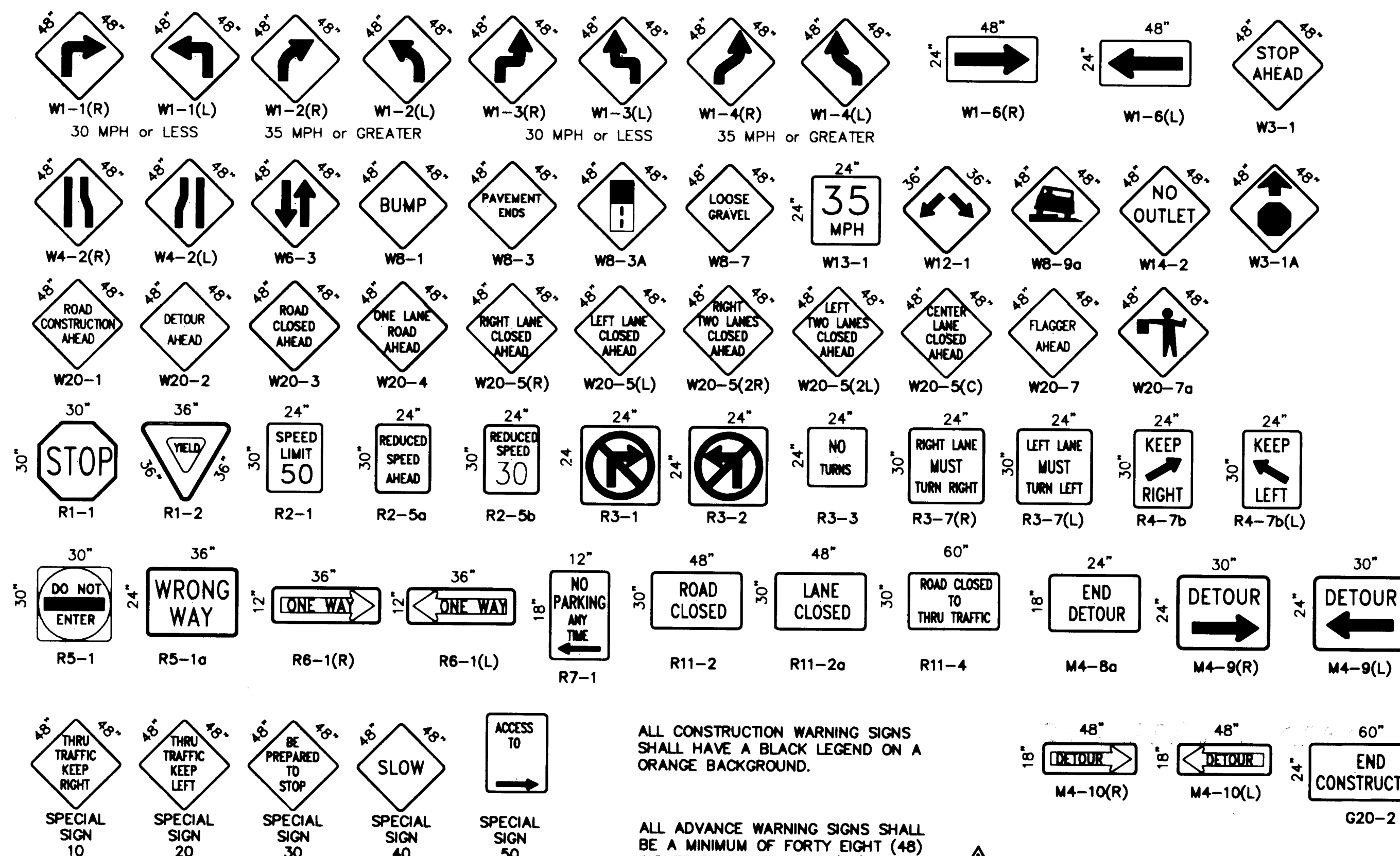

ALL CONSTRUCTION WARNING SIGNS SHALL HAVE A BLACK LEGEND ON A ORANGE BACKGROUND.

ALL ADVANCE WARNING SIGNS SHALL BE A MINIMUM OF FORTY EIGHT (48) INCHES BY FORTY EIGHT (48) INCHES IN SIZE AND SHALL HAVE ONE WARNING LIGHT.

RECORD DRAWING

JMA. NO. 95087 I

CITY OF ALBUQUERQUE PUBLIC WORKS DEPARTMENT ENGINEERING GROUP			
TITLE: McLEOD BUSINESS PARK SIGNING AND CONSTRUCTION TRAFFIC CONTROL STANDARDS			
APPROVALS	ENGINEER	DATE	APPROVALS
DRG CHAIRMAN	B.G. Bailey	11-21-95	WATER
TRANSPORTATION	M.P. Bailey	11-21-95	WASTE WATER
HYDROLOGY	M.P. Bailey	11-21-95	N/A
PROJECT NO.	2555.91	MAP NO.	F-17
SHEET NO.		4	



