

NOTES TO CONTRACTOR:  
-SEE CITY STD. DETAILS T-2 AND T-3 FOR MEDIAN CUT STANDARDS.  
-CONSTRUCT ASPHALT CURB (TC) TO MEET CONCRETE CURB (TC) WITH SMOOTH TRANSITION.  
-SEWER AND WATER MAINS ARE LOCATED IN THE RESIDENTIAL FRONTAGE ROAD.

LOT D-1, BLOCK 110  
SNOWHEIGHTS SUB'D.

LEGEND

	NEW ARTERIAL PAVING - P-3
	NEW CONCRETE MEDIAN CURB - P-8
	NEW ASPHALT CURB - P-8
	EXISTING CURB AND GUTTER
	NEW ELEVATION
	EXISTING ELEVATION
	TOP OF CURB
	TOP OF ASPHALT
	FLOW LINE

CURVE DATA				
CURVE	R	Δ	T	L
①	150'	16° 15' 37"	21.43'	42.57'
②	4'	132° 50' 09"	9.16'	9.27'
③	50'	47° 09' 51"	21.22'	41.15'
④	8'	108° 47' 22"	11.17'	15.19'
⑤	50'	71° 12' 38"	35.80'	62.14'

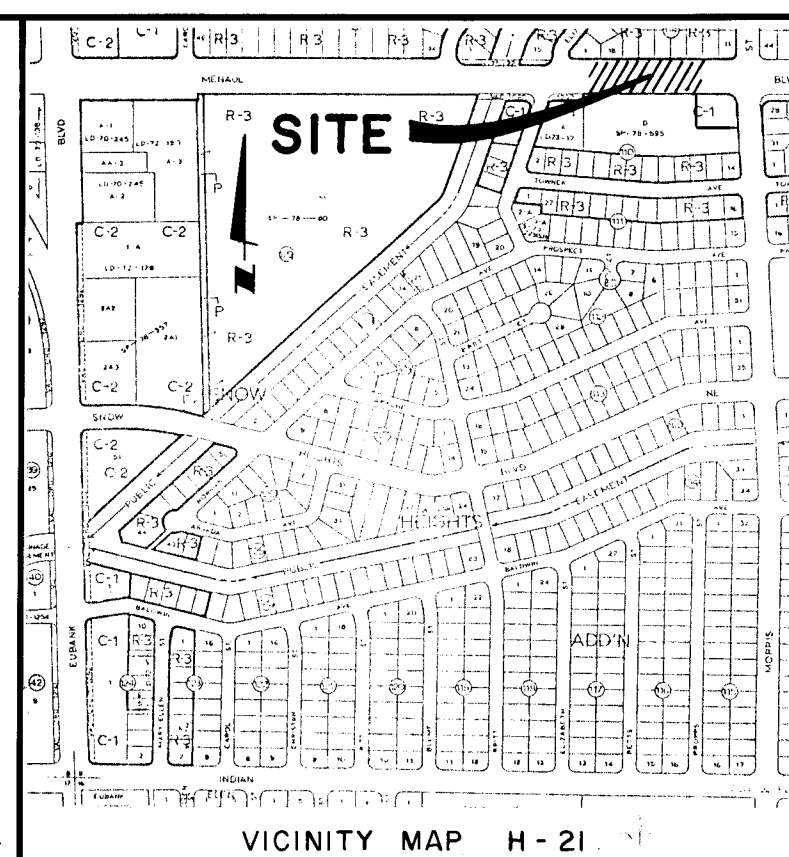

NOTICE TO CONTRACTOR

- All work detailed on these plans to be performed under contract shall, except as otherwise stated or provided for hereon, be constructed in accordance with the City of Albuquerque Interim Standard Specifications for Public Works Construction 1985 edition.
- Two (2) working days prior to any excavation, contractor must contact Line Locating Service, 765-1234, for location of existing utilities.
- Prior to construction, the contractor shall excavate and verify the horizontal and vertical locations of all obstructions. Should a conflict exist, the contractor shall notify the engineer or surveyor so that the conflict can be resolved with minimum amount of delay.

THE FOLLOWING NOTES APPLY WHEN CHECKED

- ☐ All utilities and utility service lines shall be installed prior to paving.
- ☒ Backfill compaction shall be according to specified street use.
- ☒ Tack coat requirements shall be determined by the City Engineer.
- ☐ Sidewalks and wheelchair ramps within the curb returns shall be constructed wherever a new curb return is constructed.
- ☐ If curb is depressed for a driveway or a handicap ramp, the driveway or ramp shall be constructed prior to acceptance of the curb and gutter.
- ☐ All storm drainage facilities shall be completed prior to final acceptance.

TRAFFIC HANDLING NOTES

CONTRACTOR MUST SUBMIT A CONSTRUCTION SIGNING AND BARRICADING PLAN TO TRAFFIC ENGINEERING DIVISION AND RECEIVE A BARRICADING PERMIT PRIOR TO CONSTRUCTION.

ALL CONSTRUCTION SIGNING AND BARRICADING TO COMPLY WITH THE MANUAL ON UNIFORM TRAFFIC CONTROL DEVICES, 1978 EDITION.

CONTRACTORS OPERATION, BARRICADING AND SIGNING SHALL NOT AFFECT THRU LANES BETWEEN 7 AM AND 9 AM AND 4 PM AND 6 PM.

26 27160186

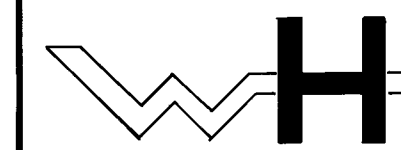

WEISS - HINES ENGINEERING, INC.  
1100 - B ALVARADO N.E., ALBUQUERQUE, N.M. 87109  
505 266-3444

CITY OF ALBUQUERQUE  
MUNICIPAL DEVELOPMENT DEPARTMENT  
ENGINEERING DIVISION

TITLE: **MEDIAN CUT**  
ON MENAUL BLVD. WEST OF MORRIS AVE.

APPROVALS	ENGINEER	DATE	APPROVALS	ENGINEER	DATE
City Engineer	<i>[Signature]</i>	1/29/86	Liquid Waste	<i>[Signature]</i>	1-8-86
A.C.E. Design	<i>[Signature]</i>	1/29/86	Traffic	<i>[Signature]</i>	1-8-86
A.C.E. Hydrology	<i>[Signature]</i>	1/29/86	Water	<i>[Signature]</i>	1-8-86

DRAWING NO.	2716	MAP NO.	H-21	SHEET	OF
				1	1