

SCANNED BY LASON

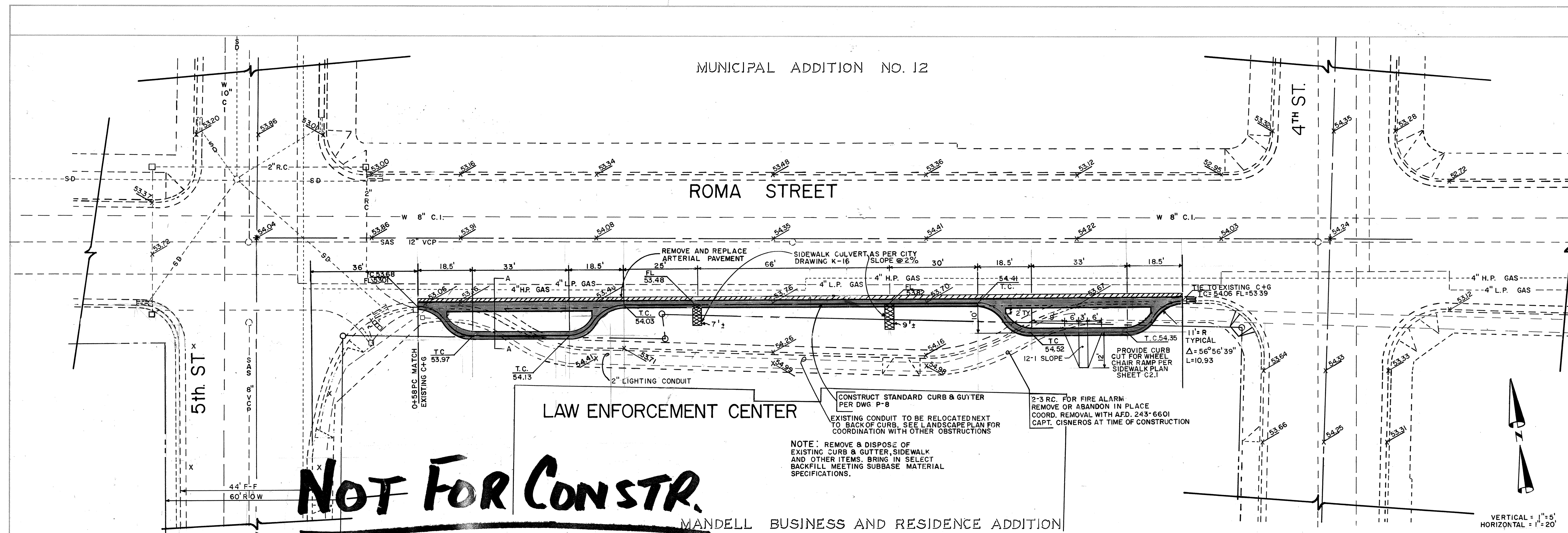

NOT FOR CONSTR.
HOLD FOR AS-BUILTS
FROM Bern. County

Construction is part
of Police/Sheriff Bldg.
Expansion Administered
by County. Aug 9/87

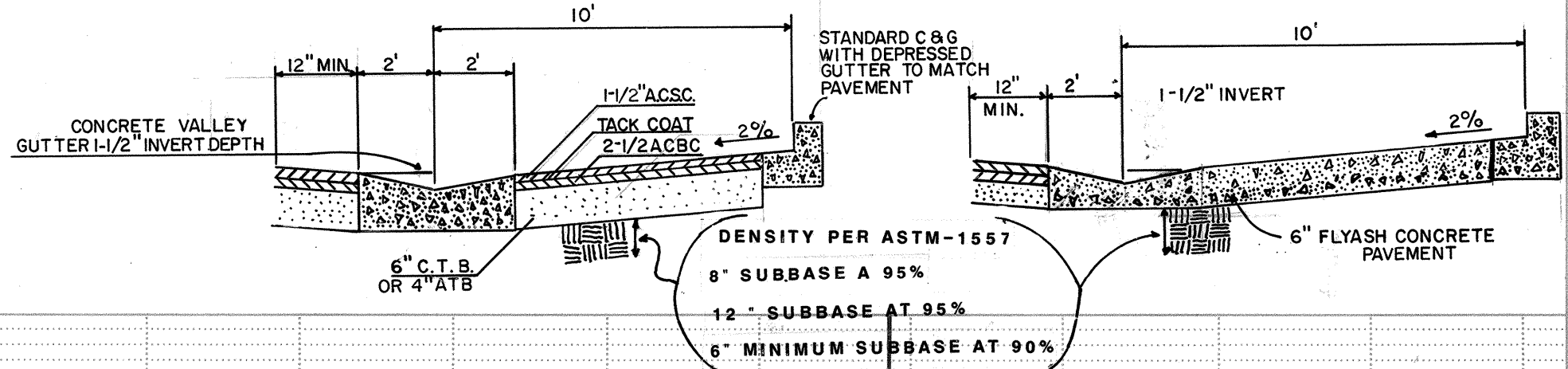
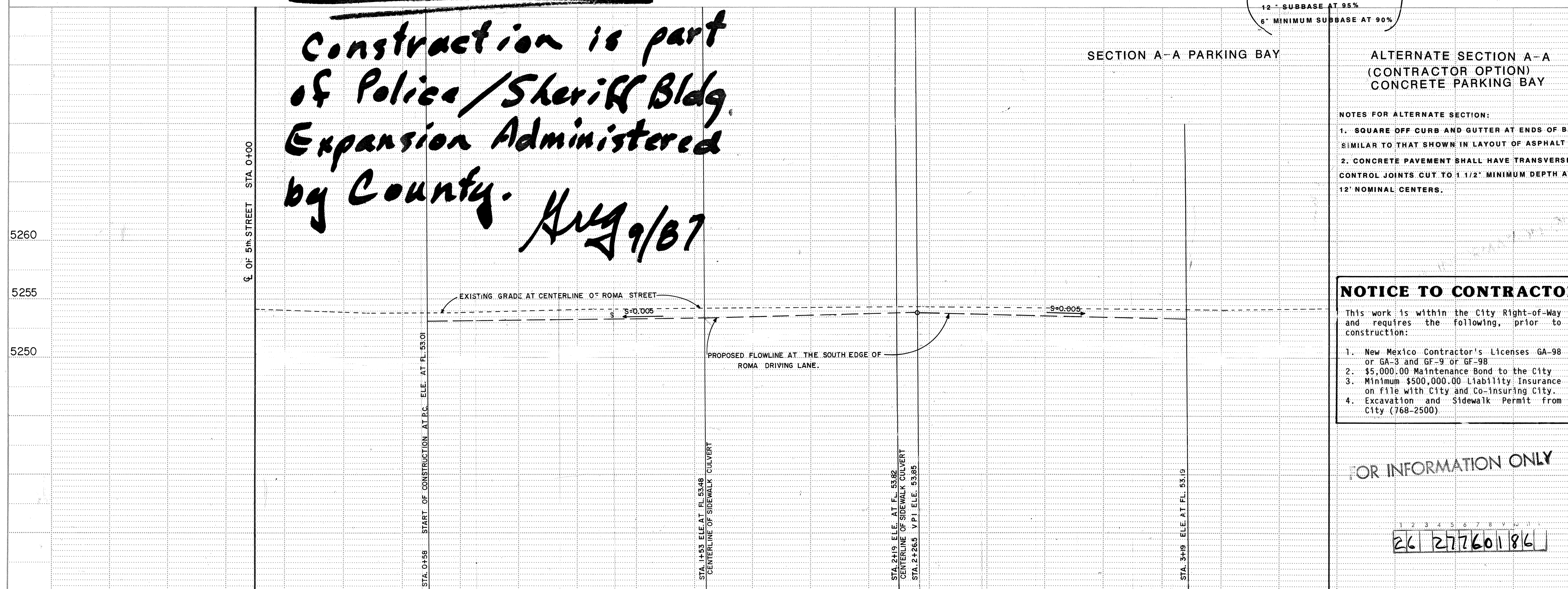

ALTERNATE SECTION A-A
(CONTRACTOR OPTION)
CONCRETE PARKING BAY

NOTES FOR ALTERNATE SECTION:

1. SQUARE OFF CURB AND GUTTER AT ENDS OF BAY SIMILAR TO THAT SHOWN IN LAYOUT OF ASPHALT BAY
2. CONCRETE PAVEMENT SHALL HAVE TRANSVERSE CONTROL JOINTS CUT TO 1 1/2\"/>

NOTICE TO CONTRACTOR

This work is within the City Right-of-Way and requires the following, prior to construction:

1. New Mexico Contractor's License GA-98 or GA-3 and GF-9 or GF-9B
2. \$5,000.00 Maintenance Bond to the City
3. Minimum \$500,000.00 Liability Insurance on file with City and Co-insuring City.
4. Excavation and Sidewalk Permit from City (768-2500)

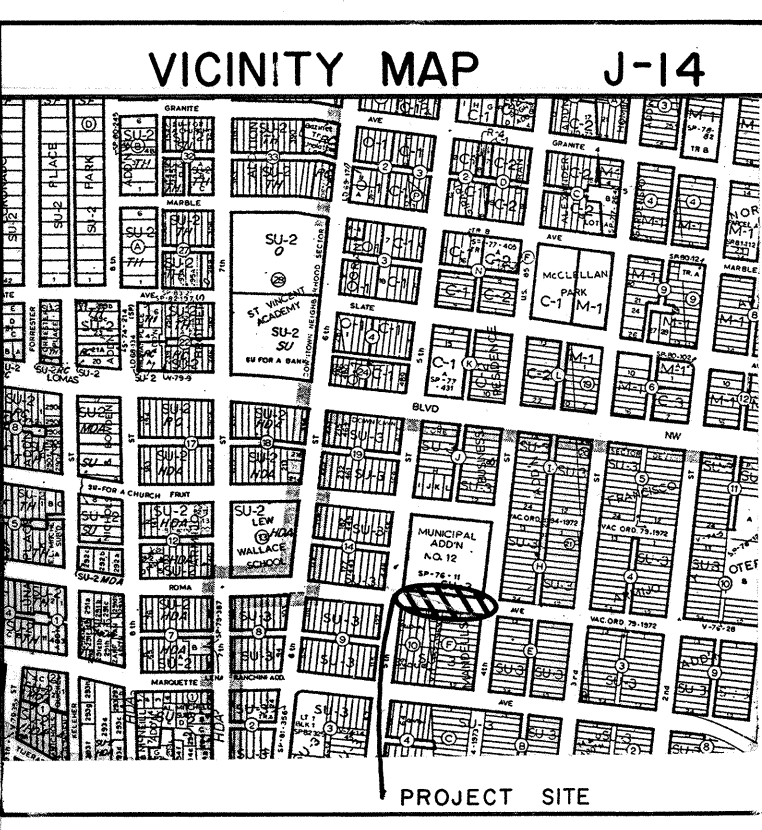

LEGEND

EXISTING ELEVATION

PROPOSED ELEVATION

- GENERAL NOTES**
1. ALL DIMENSIONS ARE TO THE FACE OF CURB.
 2. ALL WORK DETAILED ON THESE PLANS TO BE PERFORMED UNDER CONTRACT SHALL, EXCEPT AS OTHERWISE STATED OR PROVIDED FOR HEREON, BE CONSTRUCTED IN ACCORDANCE WITH THE CITY OF ALBUQUERQUE INTERIM STANDARD SPECIFICATIONS - PUBLIC WORKS CONSTRUCTION - 1985.
 3. TWO (2) WORKING DAYS PRIOR TO ANY EXCAVATION, CONTRACTOR MUST CONTACT LINE LOCATING SERVICE, 765-1234, FOR LOCATION OF EXISTING UTILITIES.
 4. PRIOR TO GRADING, THE CONTRACTOR SHALL EXCAVATE AND VERIFY THE HORIZONTAL AND VERTICAL LOCATION OF ALL POTENTIAL OBSTRUCTIONS. SHOULD ANY CONFLICTS EXIST, THE CONTRACTOR SHALL NOTIFY THE ENGINEER SO THAT THE CONFLICT CAN BE RESOLVED WITH A MINIMUM AMOUNT OF DELAY.
 5. THE CONTRACTOR SHALL MAINTAIN ACCESS TO ADJACENT PROPERTIES DURING CONSTRUCTION.
 6. ALL WORK ON THIS PROJECT SHALL BE PERFORMED IN ACCORDANCE WITH APPLICABLE FEDERAL, STATE AND LOCAL LAWS, RULES AND REGULATIONS CONCERNING CONSTRUCTION SAFETY AND HEALTH.
 7. THE CONTRACTOR MUST SUBMIT A CONSTRUCTION SIGNING AND BARRICADING PLAN TO TRAFFIC ENGINEERING TO RECEIVE A BARRICADING PERMIT PRIOR TO CONSTRUCTION.
 8. CONTRACTOR SHALL ADJUST TO GRADE ALL WATER METERS, VALVE BOXES AND MANHOLES ENCOUNTERED WITHIN THE CONSTRUCTION LIMITS.
 9. WHERE WATER METER BOXES ARE ENCOUNTERED WITHIN THE PROPOSED GRADING, THE METER BOX SHALL BE ADJUSTED TO GRADE AND THE COVER REPLACED WITH THE HEAVYWEIGHT COVER AND LID AS PER STANDARD DRAWING W-19.
 10. SUBGRADE SHALL BE COMPACTED TO 95% ASTM D-1557.
 11. TACK COAT REQUIREMENTS SHALL BE DETERMINED BY THE CITY ENGINEER.
 12. IF CURB IS DEPRESSURED FOR A DRIVEPAD OR A HANDICAP RAMP, THE DRIVEPAD OR RAMP SHALL BE CONSTRUCTED PRIOR TO ACCEPTANCE OF THE CURB AND GUTTER.

CITY OF ALBUQUERQUE
MUNICIPAL DEVELOPMENT DEPARTMENT
ENGINEERING DIVISION

TITLE: ROMA STREET IMPROVEMENTS
FOR
POLICE BUILDING

APPROVALS	ENGINEER	DATE	APPROVALS	ENGINEER	DATE
City Engineer	[Signature]	5/20/86	Liquid Waste	[Signature]	5/20/86
A.C.E.-Design	[Signature]	5/20/86	Traffic	[Signature]	5/20/86
A.C.E.-Hydrology	[Signature]	5/20/86	Water	[Signature]	5/20/86

DESIGNED BY A. HOLE **DATE 3-7-86**
DRAWN BY GASKA **DATE 3-7-86**
CHECKED BY A. HOLE **DATE 3-7-86**

APPROVED FOR CONSTRUCTION
CITY ENGINEER **DATE**

DRAWING NO. 2776 **MAP NO. J-14** **SHEET 1 OF 1**