

30' PRIVATE ACCESS & UTILITY EASEMENT

1" = 40' HORIZ.
SCALE 1" = 5' VERTICAL

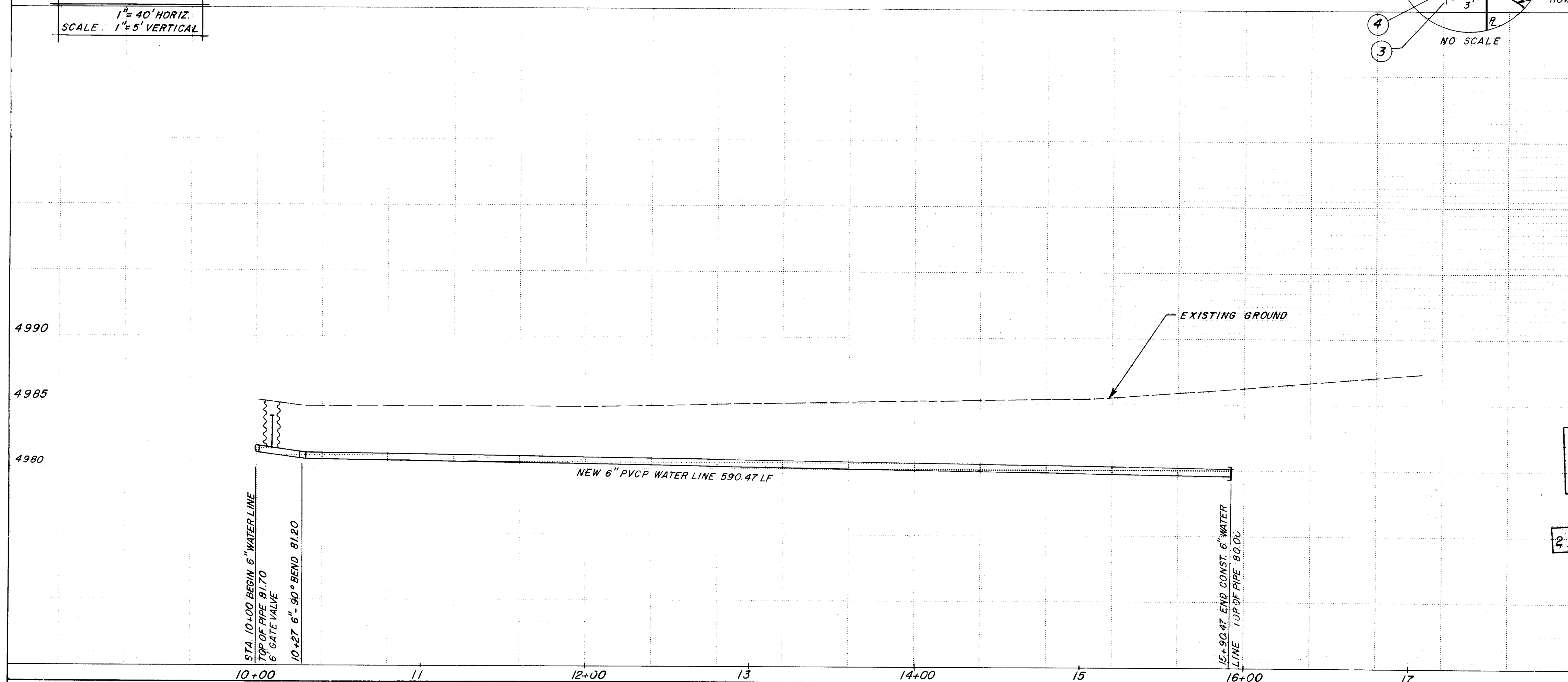

LANDS OF ERNEST SEILER
M.R.G.C.D. MAP NO. 27
SEC. 21, T11N, R3E, NMRM.

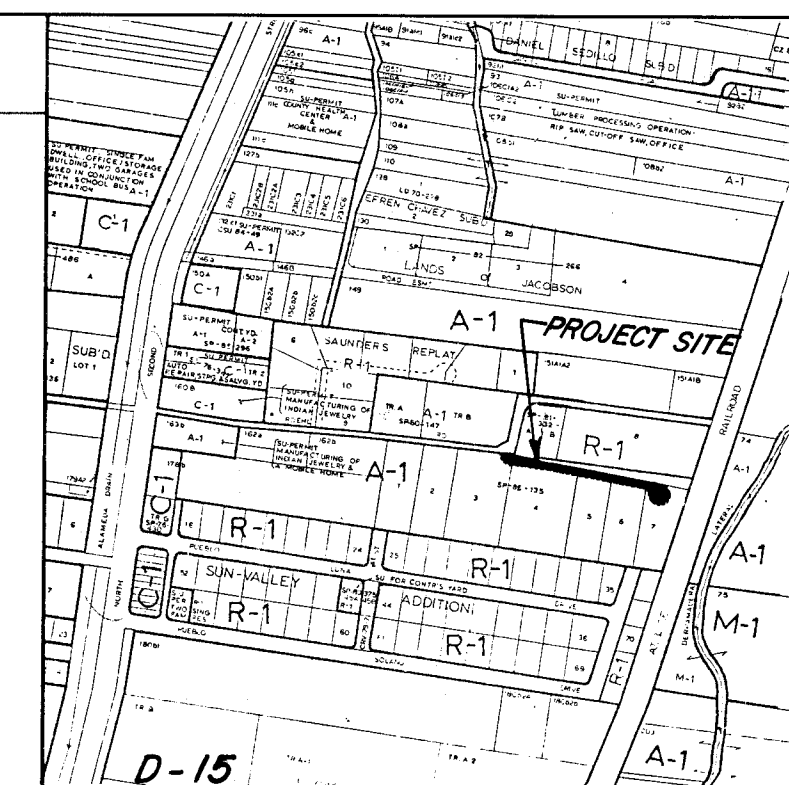

NOTICE TO CONTRACTORS

- All work detailed on these plans to be performed under contract shall, except as otherwise stated or provided for hereon, be constructed in accordance with the City of Albuquerque Interim Standard Specifications for Construction 1985.
- Two (2) working days prior to any excavation, the contractor must contact Line Locating Service, 765-1234, for location of existing utilities.
- Prior to construction, the contractor shall excavate and verify the horizontal and vertical locations of all obstructions. Should a conflict exist, the contractor shall notify the engineer or surveyor so that the conflict can be resolved with minimum amount of delay.

THE FOLLOWING NOTES ALSO APPLY WHEN CHECKED

- ☐ All utilities and utility service lines shall be installed prior to paving.
- ☒ Backfill compaction shall be according to specified street use.
- ☐ Tack coat requirements shall be determined by the City Engineer.
- ☐ Sidewalks and wheelchair ramps within the curb returns shall be constructed wherever a new curb return is constructed.
- ☐ If curb is depressed for a driveway or a handicap ramp, the driveway or ramp shall be constructed prior to acceptance of the curb and gutter.
- ☐ All storm drainage facilities shall be completed prior to final acceptance.

CONSTRUCTION NOTES:

- BUILD NEW 6" PVC PIPE
- EXACT LOCATION TO BE VERIFIED IN THE FIELD.
- BUILD FIRE HYDRANT 4-1/2' BURY AS PER STD. DRAWING W-20.
- BUILD CONCRETE PAD 3'x3'x6" AROUND FIRE HYDRANT
- INSTALL 6" CAP AT EAST END OF LINE WITH BLOCKING
- BUILD STATIONARY BOLLARDS AS PER STD. DRAWING K-22.
- 30' ACCESS & UTILITY EASEMENT INCLUDED ON PLAT. FILING DATE MARCH 27, 1985 RECORDING NO. C26-166.

Legend

- NEW 6" PVC WATER LINE
- NEW GATE VALVE
- NEW FIRE HYDRANT
- EXISTING WATER LINE
- EXISTING GAS LINE

CITY OF ALBUQUERQUE
PUBLIC WORKS DEPARTMENT
ENGINEERING GROUP

TITLE: WATER LINE EXT. ON 30' PRIVATE ACCESS & UTILITY EASEMENT OFF OF ROEHL RD. NW

APPROVALS	ENGINEER	DATE	APPROVALS	ENGINEER	DATE
DRG. Chairperson	<i>[Signature]</i>	4/23/86	Liquid Waste	<i>[Signature]</i>	4/23/86
Design Review Section	<i>[Signature]</i>	4/23/86	Transportation Dev.	<i>[Signature]</i>	4/23/86
A.C.E. - Hydrology	<i>[Signature]</i>	4/23/86	Water	<i>[Signature]</i>	4/23/86

DRAWING NO. 2837 MAP NO. D-15 SHEET 1 OF 1