

AF 254020

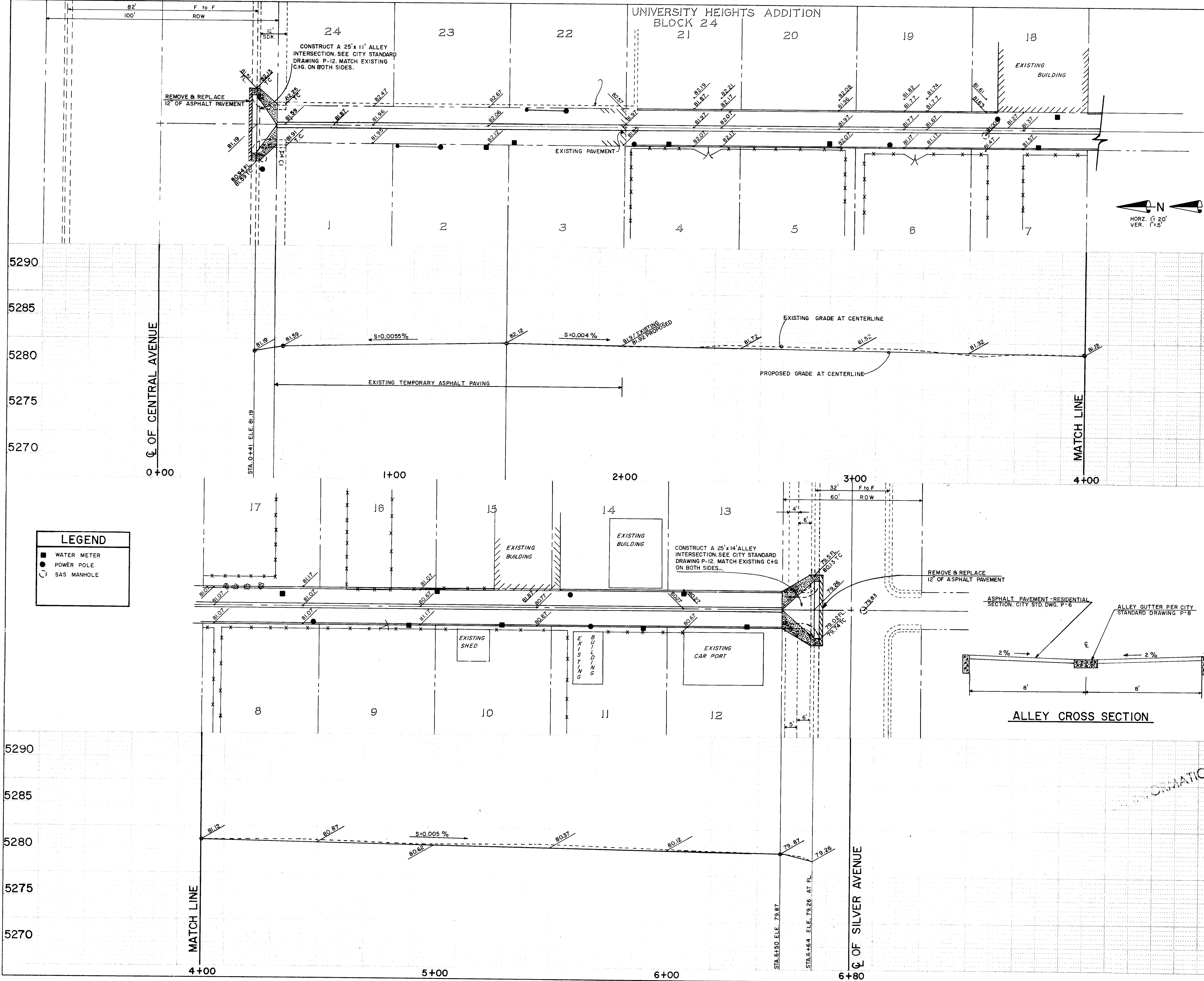

LEGEND

- WATER METER
- POWER POLE
- SAS MANHOLE

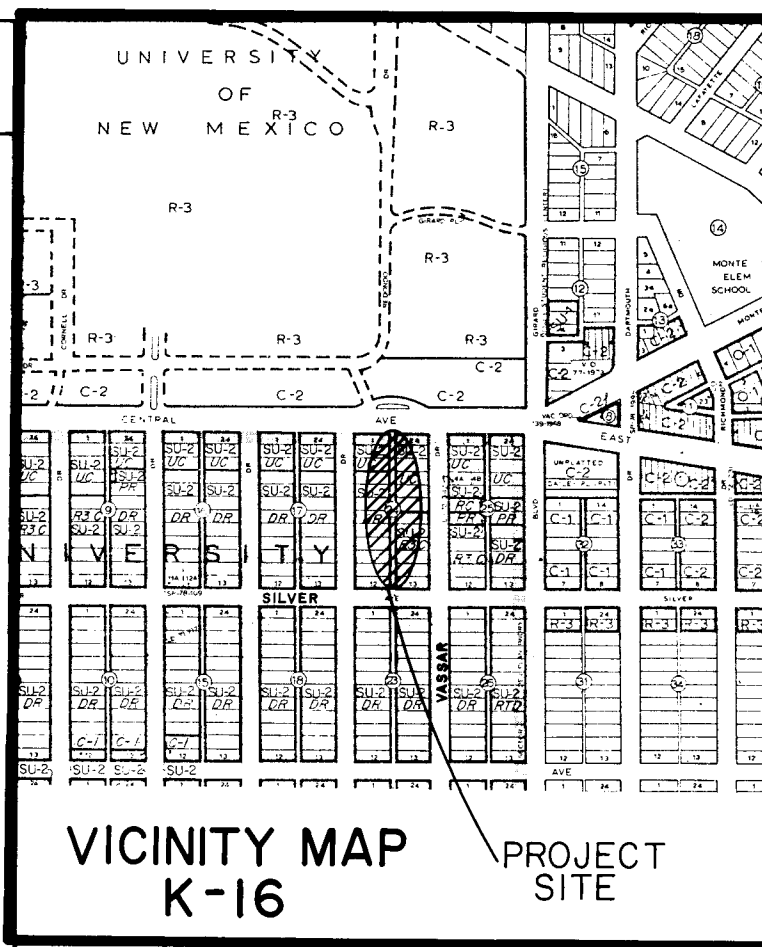

GENERAL NOTES

1. ALL WORK DONE ON ALLEY IS FOR GRADING ONLY.
2. ALL WORK DETAILED ON THESE PLANS TO BE PERFORMED UNDER CONTRACT SHALL, EXCEPT AS OTHERWISE STATED OR PROVIDED FOR HEREON, BE CONSTRUCTED IN ACCORDANCE WITH THE CITY OF ALBUQUERQUE INTERIM STANDARD SPECIFICATIONS - PUBLIC WORKS CONSTRUCTION - 1985.
3. TWO (2) WORKING DAYS PRIOR TO ANY EXCAVATION, CONTRACTOR MUST CONTACT LINE LOCATING SERVICE, 765-1234, FOR LOCATION OF EXISTING UTILITIES.
4. PRIOR TO GRADING, THE CONTRACTOR SHALL EXCAVATE AND VERIFY THE HORIZONTAL AND VERTICAL LOCATION OF ALL POTENTIAL OBSTRUCTIONS. SHOULD ANY CONFLICTS EXIST, THE CONTRACTOR SHALL NOTIFY THE ENGINEER SO THAT THE CONFLICT CAN BE RESOLVED WITH A MINIMUM AMOUNT OF DELAY.
5. THE CONTRACTOR SHALL MAINTAIN ACCESS TO ADJACENT PROPERTIES DURING CONSTRUCTION.
6. ALL WORK ON THIS PROJECT SHALL BE PERFORMED IN ACCORDANCE WITH APPLICABLE FEDERAL, STATE AND LOCAL LAWS, RULES AND REGULATIONS CONCERNING CONSTRUCTION SAFETY AND HEALTH.
7. THE CONTRACTOR MUST SUBMIT A CONSTRUCTION SIGNING AND BARRICADING PLAN TO TRAFFIC ENGINEERING TO RECEIVE A BARRICADING PERMIT PRIOR TO CONSTRUCTION.
8. CONTRACTOR SHALL ADJUST TO GRADE ALL WATER METERS, VALVE BOXES AND MANHOLES ENCOUNTERED WITHIN THE CONSTRUCTION LIMITS.
9. WHERE WATER METER BOXES ARE ENCOUNTERED WITHIN THE PROPOSED GRADING, THE METER BOX SHALL BE ADJUSTED TO GRADE AND THE COVER REPLACED WITH THE HEAVYWEIGHT COVER AND LID AS PER STANDARD DRAWING W-19.
10. SUBGRADE SHALL BE COMPACTED TO 95% ASTM D-1557.
11. TACK COAT REQUIREMENTS SHALL BE DETERMINED BY THE CITY ENGINEER.
12. IF CURB IS DEPRESSED FOR A DRIVEPAD OR A HANDICAP RAMP, THE DRIVEPAD OR RAMP SHALL BE CONSTRUCTED PRIOR TO ACCEPTANCE OF THE CURB AND GUTTER.

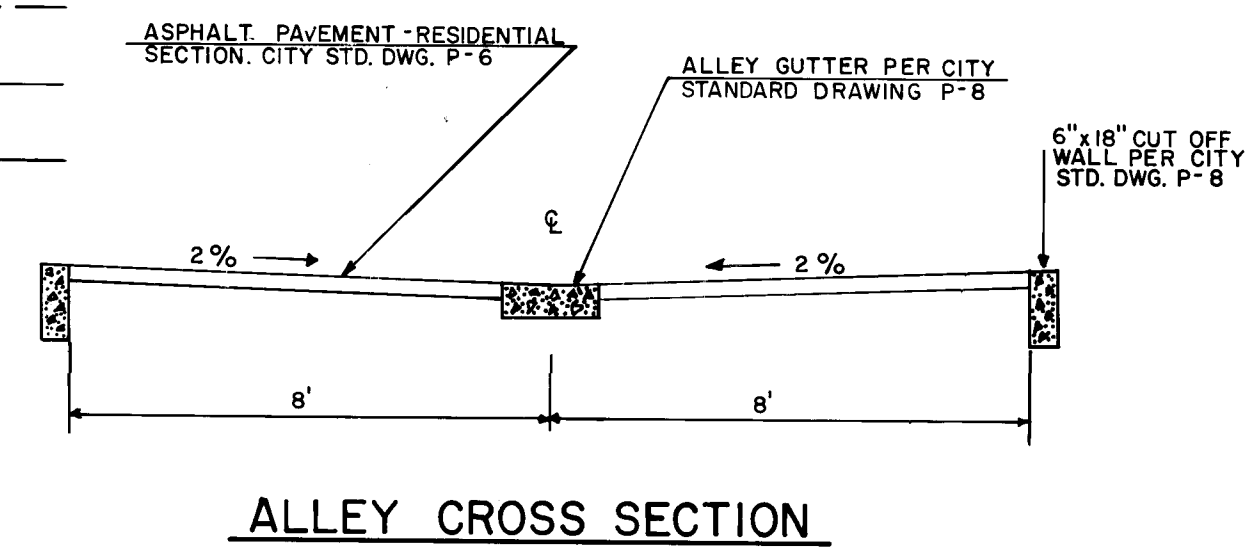

26 28420186

| CITY OF ALBUQUERQUE MUNICIPAL DEVELOPMENT DEPARTMENT ENGINEERING DIVISION | | | | | |
|---|--------------------|---------|--------------|--------------------|---------|
| TITLE: ALLEY GRADES - B/W CENTRAL AVENUE & SILVER AVE., ONE BLOCK WEST OF VASSAR DRIVE. | | | | | |
| APPROVALS | ENGINEER | DATE | APPROVALS | ENGINEER | DATE |
| City Engineer | <i>[Signature]</i> | 7/23/86 | Liquid Waste | <i>[Signature]</i> | 7/23/86 |
| ACE - Design | <i>[Signature]</i> | 7/23/86 | Traffic | <i>[Signature]</i> | 7/23/86 |
| ACE - Hydrology | <i>[Signature]</i> | 7/23/86 | Water | <i>[Signature]</i> | 7/23/86 |

| DESIGN | | REVISIONS | | REMARKS | |
|--------|------|-----------|------|---------|------|
| NO. | DATE | NO. | DATE | NO. | DATE |
| | | | | | |
| | | | | | |
| | | | | | |
| | | | | | |

| DESIGNED BY G.R.O. | | DRAWN BY M.J. GASKA | | CHECKED BY G.R. OLSON | |
|--------------------|---------|---------------------|---------|-----------------------|---------|
| DATE | DATE | DATE | DATE | DATE | DATE |
| 7-31-86 | 7-31-86 | 7-31-86 | 7-31-86 | 7-31-86 | 7-31-86 |

| DRAWING NO. 2842 | | MAP NO. K-16 | | SHEET 1 OF 1 | |
|------------------|--|--------------|--|--------------|--|
|------------------|--|--------------|--|--------------|--|