

VICINITY MAP  
SCALE: 1" = 800'

D-19

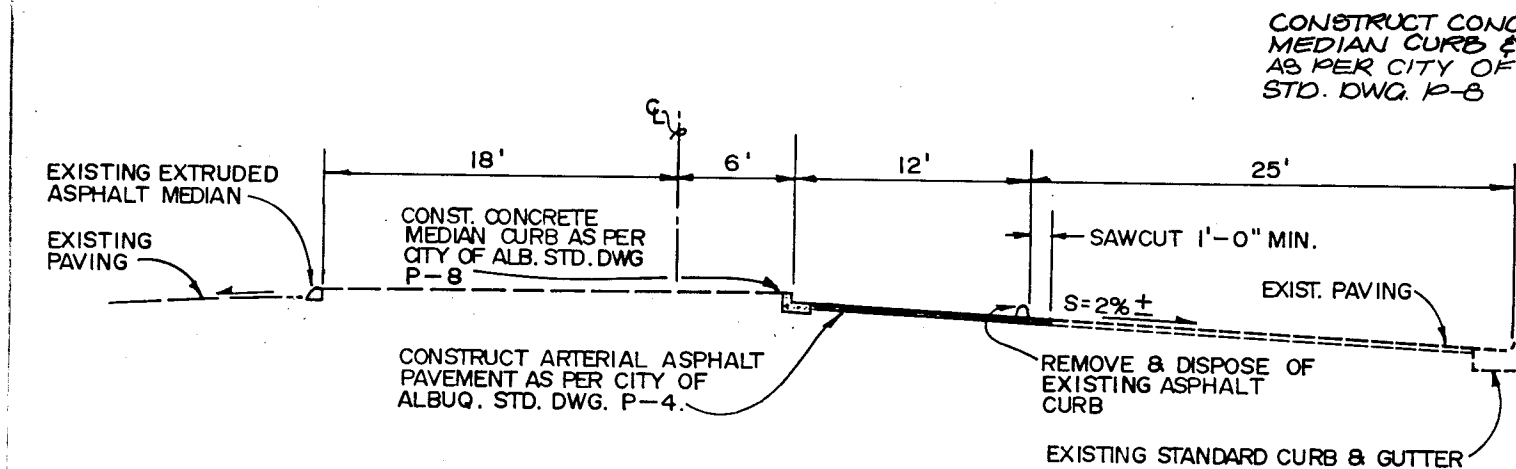

SECTION A-A  
SCALE: 1" = 10'

TRACT A-1-B

LOMA DEL NORTE, UNIT 3

TRACT A-2-B  
(FRENCH MORTUARY)

WYOMING BOULEVARD N.E.

CURVE	ARC	DELTA	RADIUS
1	43.09'	16°27'33"	150'
2	43.09'	16°27'33"	150'
3	12.57'	90°00'00"	9'
4	45.12'	86°10'39"	30'

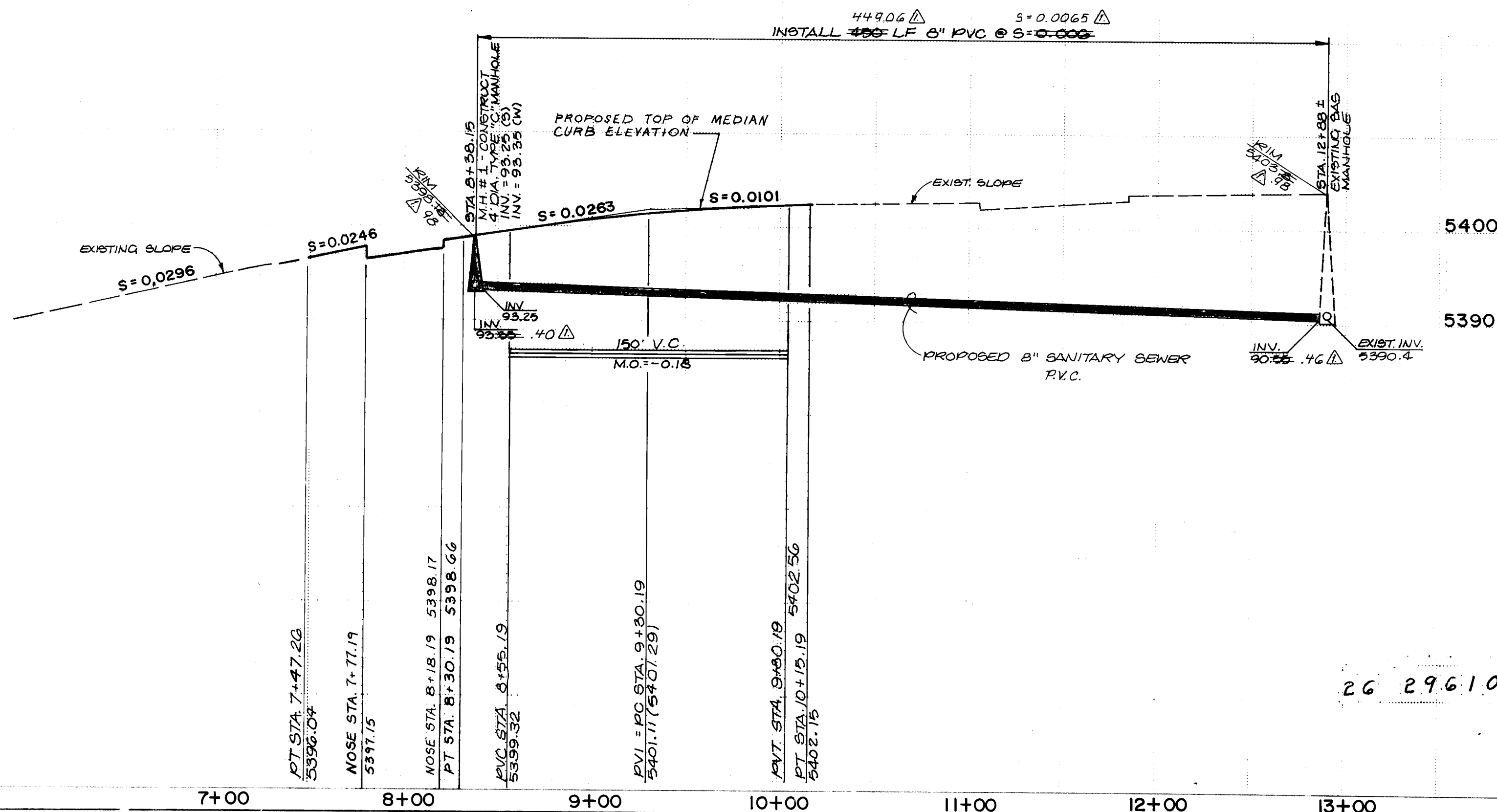
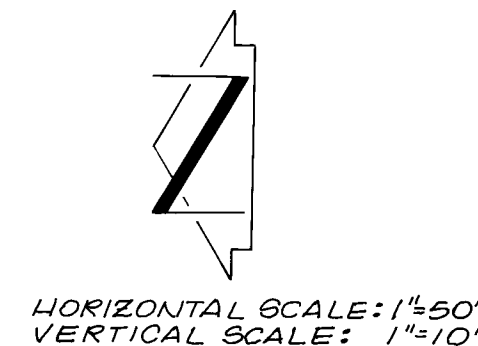

DATE 11-13-86

26 29610186

TMA JOB NO. 60294

#### GENERAL NOTES

- ALL WORK DETAILED ON THESE PLANS TO BE PERFORMED UNDER CONTRACT SHALL, EXCEPT OTHERWISE STATED OR PROVIDED FOR HEREON, BE CONSTRUCTED IN ACCORDANCE WITH THE CITY OF ALBUQUERQUE INTERIM STANDARD SPECIFICATIONS - PUBLIC WORKS CONSTRUCTION - 1985.
- TWO WORKING DAYS PRIOR TO ANY EXCAVATION, CONTRACTOR MUST CONTACT LINE LOCATING SERVICE, 765-1234, FOR LOCATION OF EXISTING UTILITIES.
- THE CONTRACTOR SHALL MAINTAIN ACCESS TO ADJACENT PROPERTIES AT ALL TIMES.
- THE CONTRACTOR MUST SUBMIT A CONSTRUCTION SIGNING AND BARRICADING PLAN TO TRAFFIC ENGINEERING TO RECEIVE A BARRICADING PERMIT PRIOR TO CONSTRUCTION.
- ALL SLOPES SHOWN ON PROFILES ARE BASED ON CENTERLINE STATIONING.
- ALL DIMENSIONS AND RADII OF CURB AND CURB RETURNS ARE SHOWN TO FACE OF CURB.
- WHERE REMOVAL OF EXISTING CURB AND GUTTER, SIDEWALK OR PAVEMENT IS REQUIRED, THE CONTRACTOR SHALL SAWCUT AND/OR REMOVE TO THE NEAREST JOINT. CURB AND GUTTER SHOWN AS EXISTING AND NOT TO BE REMOVED UNDER THIS CONTRACT WHICH IS DAMAGED OR DISPLACED BY THE CONTRACTOR SHALL BE REMOVED AND REPLACED BY THE CONTRACTOR AT THE CONTRACTOR'S EXPENSE.

#### STREET PAVING IMPROVEMENTS

- CONTRACTOR SHALL ADJUST TO GRADE ALL VALVE BOXES AND MANHOLES ENCOUNTERED WITHIN THE CONSTRUCTION LIMITS.
- IF ANY UTILITY LINES, PIPELINES, OR UNDERGROUND UTILITY LINES ARE SHOWN ON THESE DRAWINGS, THEY ARE SHOWN IN AN APPROXIMATE MANNER ONLY, AND SUCH LINES MAY EXIST WHERE NONE ARE SHOWN. IF ANY SUCH EXISTING LINES ARE SHOWN, THE LOCATION IS BASED UPON INFORMATION PROVIDED BY THE OWNER OF SAID UTILITY, AND THE INFORMATION MAY BE INCOMPLETE, OR MAY BE OBSOLETE BY THE TIME CONSTRUCTION COMMENCES. THE ENGINEER HAS UNDERTAKEN NO FIELD VERIFICATION OF THE LOCATION, DEPTH, SIZE, OR TYPE OF EXISTING UTILITY LINES, PIPELINES, OR UNDERGROUND UTILITY LINES, MAKES NO REPRESENTATION PERTAINING THERETO, AND ASSUMES NO RESPONSIBILITY OR LIABILITY THEREFOR. THE CONTRACTOR SHALL INFORM ITSELF OF THE LOCATION OF ANY UTILITY LINE, PIPELINE, OR UNDERGROUND UTILITY LINE IN OR NEAR THE AREA OF THE WORK IN ADVANCE OF AND DURING EXCAVATION WORK. THE CONTRACTOR IS FULLY RESPONSIBLE FOR ANY AND ALL DAMAGE CAUSED BY ITS FAILURE TO LOCATE, IDENTIFY AND PRESERVE ANY AND ALL EXISTING UTILITIES, PIPELINES, AND UNDERGROUND UTILITY LINES. IN PLANNING AND CONDUCTING EXCAVATION, THE CONTRACTOR SHALL COMPLY WITH STATE STATUTES, MUNICIPAL AND LOCAL ORDINANCES, RULES AND REGULATIONS, IF ANY, PERTAINING TO THE LOCATION OF THESE LINES AND FACILITIES.
- MEDIAN CURB AND GUTTER SHALL BE CONSTRUCTED AS PER CITY OF ALBUQUERQUE STANDARD DRAWING P-8.
- CONTRACTOR SHALL CONSTRUCT ASPHALT PAVING TO ARTERIAL STANDARDS AS PER CITY OF ALBUQUERQUE STANDARD DRAWING P-4.

#### SANITARY SEWER

- ALL STATIONING IS BASED ON CENTERLINE OF ROW.
- SANITARY SEWER LINES SHALL BE PVC OR AS APPROVED BY THE CITY OF ALBUQUERQUE WATER UTILITIES DEPARTMENT.
- ALL MANHOLES SHALL BE 4-FOOT DIAMETER MANHOLES AS PER CITY OF ALBUQUERQUE STANDARD DRAWING S-1 UNLESS OTHERWISE NOTED.
- SEWER SERVICE LATERALS SHALL BE CONSTRUCTED AS PER CITY OF ALBUQUERQUE STANDARD DRAWING S-9.
- WHERE SEWER AND WATER LINES CROSS, IF VERTICAL CLEARANCE DOES NOT EXCEED 1'-6", THE SEWER LINE SHALL BE PRESSURE PIPE FROM MANHOLE TO MANHOLE.

CITY OF ALBUQUERQUE  
MUNICIPAL DEVELOPMENT DEPARTMENT  
ENGINEERING DIVISION

TITLE FRENCH MORTUARY  
SANITARY SEWER EXTENSION AND LEFT TURNBAY

APPROVAL	ENGINEER	DATE	APPROVAL	ENGINEER	DATE
City Engineer	W. Williams	7/23/86	City Engineer	W. Williams	7/23/86
ACE - Design	W. Williams	7/23/86	ACE - Design	W. Williams	7/23/86
ACE - Hydrology	W. Williams	7/23/86	ACE - Hydrology	W. Williams	7/23/86

DRAWING NO. 2961 MAP NO. D-19 SHEET 1 OF 1