

REORDER BY PART NUMBER 8553
SACCO PRODUCTS • NEW HOPE, MINNESOTA
REORDER BY PART NUMBER 8553
SACCO PRODUCTS • NEW HOPE, MINNESOTA
REORDER BY PART NUMBER 8553
SACCO PRODUCTS • NEW HOPE, MINNESOTA
REORDER BY PART NUMBER 8553
SACCO PRODUCTS • NEW HOPE, MINNESOTA

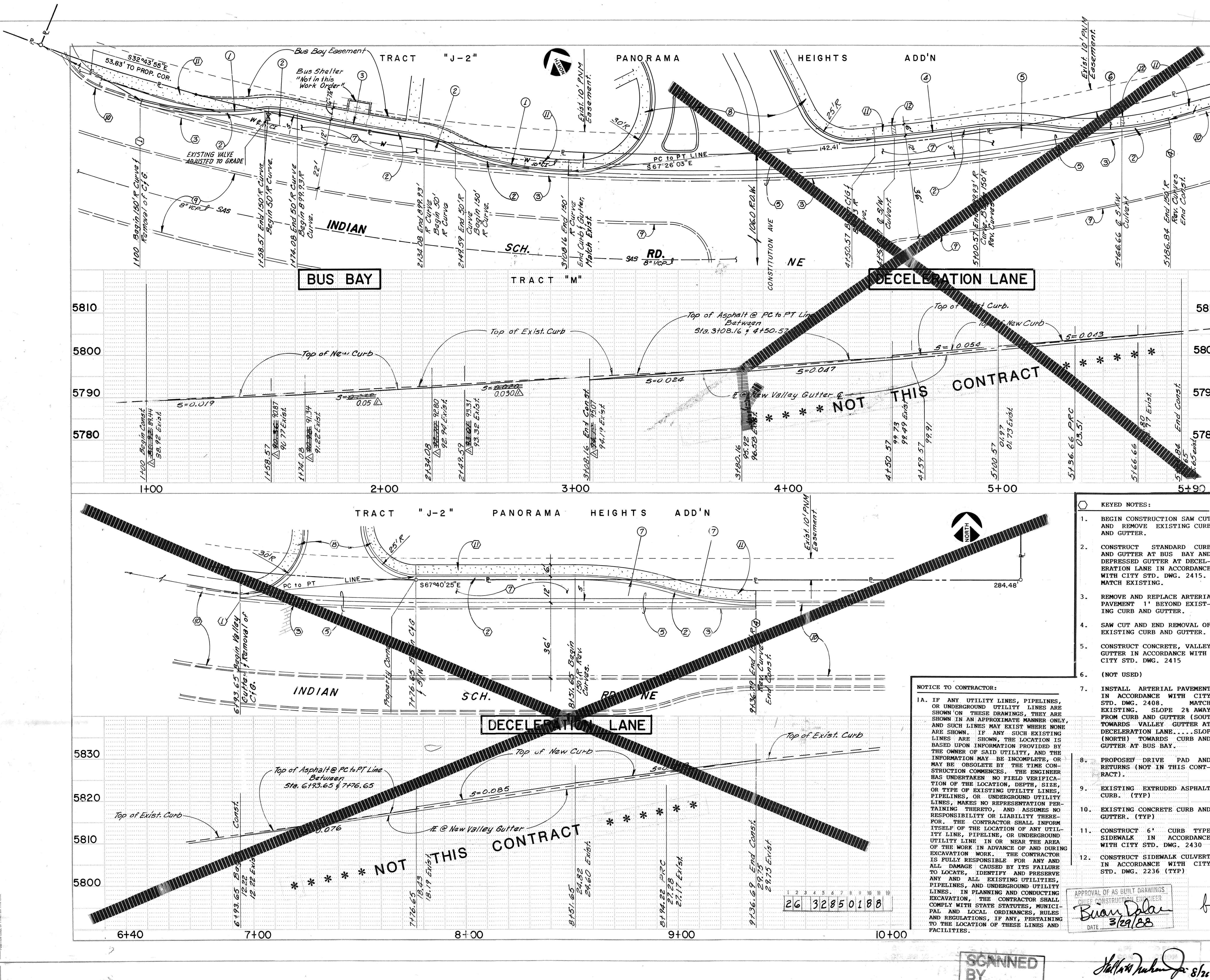

SITE

CONSTITUTION

VICINITY MAP

J-22-Z

TRAFFIC HANDLING NOTES:

- CONTRACTOR MUST SUBMIT A CONSTRUCTION SIGNING AND BARRICADING PLAN TO TRAFFIC ENGINEERING DIVISION AND RECEIVE A BARRICADING PERMIT PRIOR TO CONSTRUCTION.
- ALL CONSTRUCTION SIGNING AND BARRICADING TO COMPLY WITH MANUAL ON UNIFORM TRAFFIC CONTROL DEVICES, 1978 EDITION.

NOTICE TO CONTRACTOR

- ALL WORK DETAILED ON THESE PLANS TO BE PERFORMED UNDER CONTRACT SHALL, EXCEPT AS OTHERWISE STATED OR PROVIDED FOR HEREON, BE CONSTRUCTED IN ACCORDANCE WITH THE "CITY OF ALBUQUERQUE, STANDARD SPECIFICATIONS FOR PUBLIC WORKS CONSTRUCTION, 1986" (COA STD).
- TWO (2) WORKING DAYS PRIOR TO ANY EXCAVATION, CONTRACTOR MUST CONTACT LINE LOCATING SERVICE, 765-1234, FOR LOCATION OF EXISTING UTILITIES.
- PRIOR TO CONSTRUCTION, THE CONTRACTOR SHALL EXCAVATE AND VERIFY THE HORIZONTAL AND VERTICAL LOCATIONS OF ALL OBSTRUCTIONS SHOULD A CONFLICT EXIST. THE CONTRACTOR SHALL NOTIFY THE ENGINEER OR SURVEYOR SO THAT THE CONFLICT CAN BE RESOLVED WITH MINIMUM AMOUNT OF DELAY.
- BACKFILL COMPACTION SHALL BE ACCORDING TO SPECIFIED STREET USE.
- ALL STORM DRAINAGE FACILITIES SHALL BE COMPLETED PRIOR TO FINAL ACCEPTANCE.
- THE CONTRACTOR SHALL PROMPTLY CLEAN UP ANY MATERIAL EXCAVATED WITHIN THE PUBLIC RIGHT-OF-WAY SO THAT THE EXCAVATED MATERIAL IS NOT SUSCEPTIBLE TO BEING WASHED DOWN THE STREET.
- CONTRACTOR SHALL ASSIST THE ENGINEER/INSPECTOR IN THE RECORDING OF DATA ON ALL UTILITY LINES AND ACCESSORIES AS REQUIRED BY THE CITY OF ALBUQUERQUE FOR THE PREPARATION OF "AS CONSTRUCTED" DRAWINGS. CONTRACTOR SHALL NOT COVER UTILITY LINES AND ACCESSORIES UNTIL ALL DATA HAS BEEN RECORDED.
- CURB AND GUTTER SHOWN AS EXISTING AND NOT TO BE REMOVED UNDER THE CONTRACT WHICH IS DAMAGED OR DISPLACED BY THE CONTRACTOR SHALL BE REMOVED AND REPLACED BY THE CONTRACTOR AT HIS EXPENSE.
- ALL WORK ON THIS PROJECT SHALL BE PERFORMED IN ACCORDANCE WITH APPLICABLE FEDERAL, STATE AND LOCAL LAWS, RULES AND REGULATIONS CONCERNING CONSTRUCTION SAFETY AND HEALTH.
- WHEN ABUTTING NEW PAVEMENT TO EXISTING, CUT BACK EXISTING PAVEMENT TO A NEAT, STRAIGHT LINE AS REQUIRED TO REMOVE ANY BROKEN OR CRACKED PAVEMENT, AND MATCH NEW TO EXISTING.

#	R	Δ	L
1	150.00'	22 22'24"	58.57'
2	50.00'	17 46'36"	15.51'
3	899.93'	03 49'12"	60.00'

HORIZ. : 1"=20'
VERT. : 1"=10'

CITY OF ALBUQUERQUE
MUNICIPAL DEVELOPMENT DEPARTMENT
ENGINEERING DIVISION

TITLE: NW COR. OF TRAMWAY BLVD. & INDIAN SCH. RD. NE
HIGH RIDGE SHOPPING CENTER
BUS BAY

APPROVALS	ENGINEER	DATE	APPROVALS	ENGINEER	DATE
City Engineer	Robert D. Jones	6/25/87	City Engineer	Robert D. Jones	6/25/87
Design	Robert D. Jones	6/25/87	Design	Robert D. Jones	6/25/87
Hydrology	Robert D. Jones	6/25/87	Hydrology	Robert D. Jones	6/25/87

DESIGNED BY: JSM
DRAWN BY: JSM
CHECKED BY: JSM

DATE: May-87
DATE: May-87
DATE: May-87

REVISIONS

NO.	DATE	REVISIONS
1	6/25/87	Revised from as-built information

SCANNED BY: [Signature]