

SANTA RITA WEST
INFRASTRUCTURE
IMPROVEMENTS
PHASE I

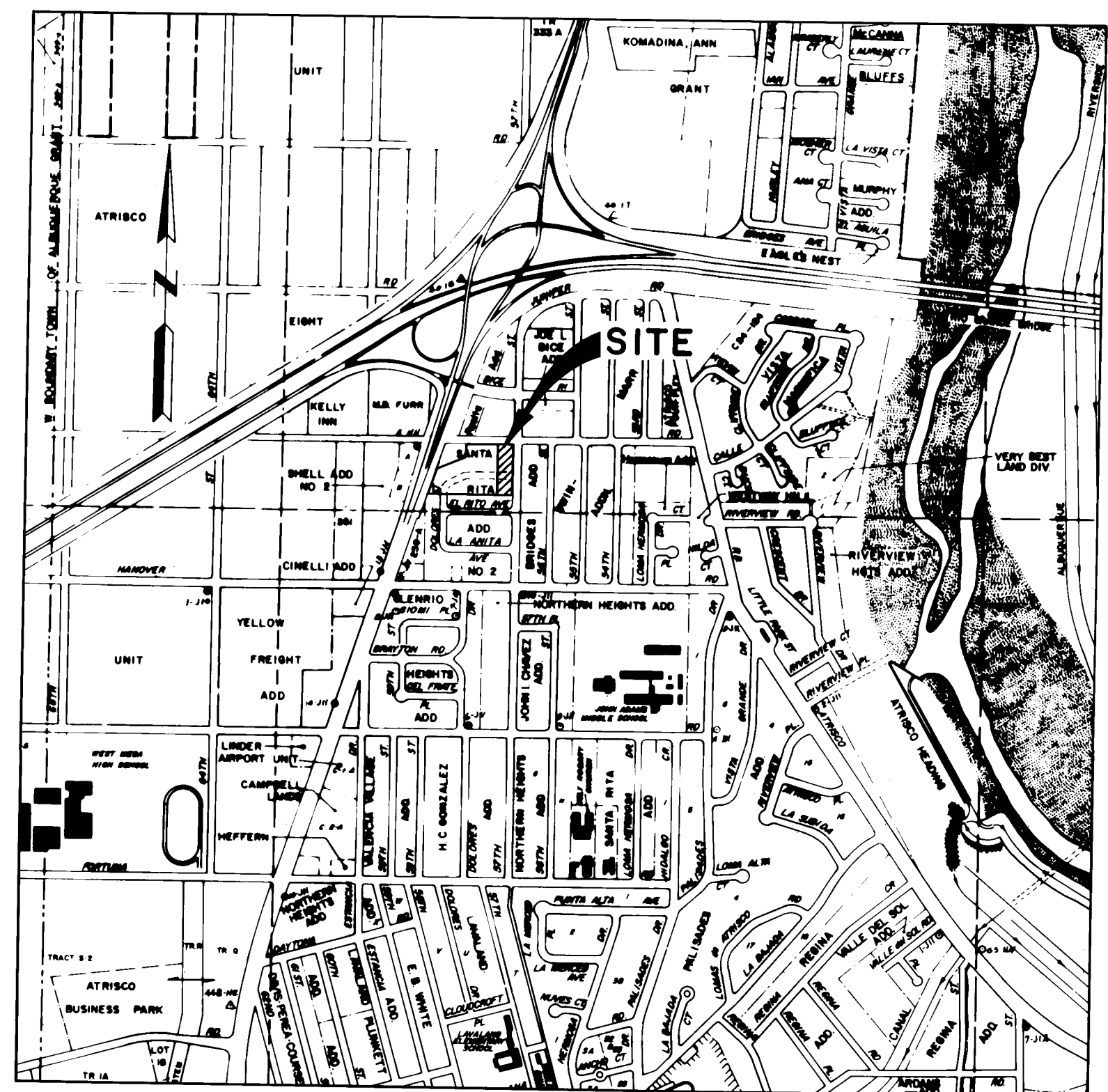

LOCATION MAP
ZONE ATLAS MAP H-II
SCALE: 1"=1000'

DESCRIPTION	INDEX	SHEET NO.
TITLE SHEET, INDEX & GENERAL NOTES		1
SUBDIVISION PLAT		2
PAVING & STORM DRAIN PLAN & PROFILE		3
SANITARY SEWER & WATERLINE PLAN & PROFILE		4

GENERAL NOTES

- ALL WORK DETAILED ON THESE PLANS TO BE PERFORMED UNDER THIS CONTRACT, EXCEPT AS OTHERWISE STATED OR PROVIDED FOR HEREON, BE CONSTRUCTED IN ACCORDANCE WITH THE CITY OF ALBUQUERQUE STANDARD SPECIFICATIONS FOR PUBLIC WORKS CONSTRUCTION, 1986 EDITION, INCLUDING, BUT NOT LIMITED TO, SECTION 19, CONSTRUCTION TRAFFIC CONTROL.
- REFERENCES MADE TO STANDARD DRAWINGS REFER TO CITY OF ALBUQUERQUE STANDARD DRAWINGS.
- TWO WORKING DAYS PRIOR TO ANY EXCAVATION, CONTRACTOR MUST CONTACT LINE LOCATING SERVICE, 765-1234, FOR LOCATION OF EXISTING UTILITIES.
- PRIOR TO CONSTRUCTION, THE CONTRACTOR SHALL EXCAVATE AND VERIFY THE HORIZONTAL AND VERTICAL LOCATIONS OF ALL OBSTRUCTIONS. SHOULD A CONFLICT EXIST, THE CONTRACTOR SHALL NOTIFY THE ENGINEER OR SURVEYOR SO THAT THE CONFLICT CAN BE RESOLVED WITH A MINIMUM AMOUNT OF DELAY.
- BACKFILL COMPACTION SHALL BE ACCORDING TO SPECIFIED STREET USE.
- TACK COAT REQUIREMENTS SHALL BE DETERMINED BY THE ENGINEER.
- CONTRACTOR SHALL PROVIDE 12" SUBGRADE PREPARATION UNDER ALL NEW PAVEMENT.
- SUBGRADE PREPARATION UNDER CURB AND GUTTER (INCLUDING ONE FOOT BEHIND BACK OF CURB, UNDER VALLEY GUTTER, UNDER CONCRETE MEDIAN PAVEMENT AND SIDEWALKS) SHALL BE CONSIDERED INCIDENTAL TO THE CONSTRUCTION OF SUCH AND SHALL BE INCLUDED IN THE BID ITEM PRICE FOR SUCH ITEMS.
- WHEN ABUTTING NEW PAVEMENT TO EXISTING, CUT BACK EXISTING PAVEMENT TO A NEAT STRAIGHT LINE AS REQUIRED TO REMOVE ANY BROKEN OR CRACKED PAVEMENT, AND MATCH NEW TO EXISTING. NO SEPARATE PAYMENT SHALL BE MADE OF SUCH CUTTING OF EXISTING PAVEMENT BUT SHALL BE CONSIDERED INCIDENTAL TO THE PROJECT. CUTTING OF PAVEMENT SHALL BE IN CONFORMANCE WITH THE SPECIFICATIONS.
- ALL WATER VALVE BOXES AND SEWER MANHOLES IN THE CONSTRUCTION AREA ARE TO BE ADJUSTED TO FINISH GRADE UNDER THIS CONTRACT.
- ALL FITTINGS ON WATERLINES SHALL HAVE CONCRETE BLOCKING EXCEPT WHERE SPECIFICALLY INDICATED TO HAVE LOCKED MECHANICAL JOINTS. SEE STANDARD DRAWING 2320. NO SEPARATE PAYMENT WILL BE MADE FOR BLOCKING OR FOR LOCKED MECHANICAL JOINTS.
- ELECTRONIC MARKER DISCS SHALL BE PLACED IN ACCORDANCE WITH SECTION 170 OF THE CITY OF ALBUQUERQUE STANDARD SPECIFICATIONS FOR PUBLIC WORKS CONSTRUCTION, 1986 EDITION. NO SEPARATE PAYMENT WILL BE MADE FOR ELECTRONIC MARKER DISCS.
- CONTRACTOR SHALL ASSIST THE ENGINEER/INSPECTOR IN THE RECORDING OF DATA ON ALL UTILITY LINES AND ACCESSORIES AS REQUIRED BY THE CITY OF ALBUQUERQUE FOR THE PREPARATION OF "AS CONSTRUCTED" DRAWINGS. CONTRACTOR SHALL NOT COVER UTILITY LINES AND ACCESSORIES UNTIL ALL DATA HAS BEEN RECORDED.

DATE 2/1/91

THE PAUTSCH TRUST
ALBUQUERQUE, NEW MEXICO

REV	SHEETS	CITY ENGR.	DATE	USER	DEPT.	DATE	USER	DEPT.	DATE
APPROVAL OF REVISIONS									

26 34950189

SET NUMBER

ANDREWS, ASBURY & ROBERT, INC.
CONSULTING ENGINEERS
ALBUQUERQUE NEW MEXICO

APPROVED FOR
CONSTRUCTION
CITY ENGINEER
DATE 11/15/90

3495

SHEET 1 OF 4

87-500

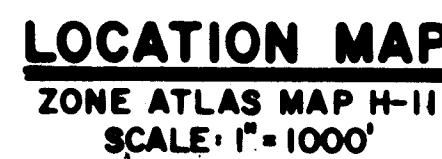

FREE CONSENT AND DEDICATION STATEMENT

THE SUBDIVISION DESCRIBED HEREIN IS WITH THE FREE CONSENT AND IN ACCORDANCE WITH THE DESIRES OF THE UNDERSIGNED OWNERS AND/OR PROPRIETORS THEREOF AND SAID OWNERS AND/OR PROPRIETORS DO HEREBY DEDICATE ALL STREETS AND PUBLIC RIGHT-OF-WAY SHOWN HEREON TO THE CITY OF ALBUQUERQUE IN FEE SIMPLE AND DO HEREBY GRANT ALL UTILITY EASEMENTS AND FACILITIES THEREIN AND DO HEREBY AGREE TO ALL EASEMENTS AND FACILITIES SHOWN HEREON AND TO TRIM AND EGRESS (BOTH SURFACE AND SUBSURFACE) AND THE RIGHT TO TRIM INTERFERING TREES AND SHRUBS; INCLUDED ARE EASEMENTS FOR JOINT POWER AND COMMUNICATION SERVICE LINES; AND DO ALSO GRANT TO THE CITY OF ALBUQUERQUE THE DRAINAGE EASEMENTS SHOWN HEREON INCLUDING THE RIGHT TO CONSTRUCT, OPERATE, INSPECT AND MAINTAIN FACILITIES THEREIN. SAID OWNERS AND/OR PROPRIETORS DO HEREBY FREELY CONSENT TO THE FOREGOING AND DO HEREBY REPRESENT THAT WE ARE AUTHORIZED TO SQA.CT.

THE PAUTSCH TRUST
BY: John R. Pautsch, Jr.
JOHN R. PAUTSCH, JR.

BY: Carolyn S. Pautsch
CAROLYN S. PAUTSCH

CO-TRUSTEES U/A/T DATED 11-24-86

ACKNOWLEDGEMENT

STATE OF NEW MEXICO)
)SS
COUNTY OF BERNALILLO)

THE FOREGOING INSTRUMENT WAS ACKNOWLEDGED BEFORE ME THIS
 DAY OF December 1987 BY JACK R. PAUTSCH, JR.,
 STEE USA/T DATED 11-24-86.

MY COMMISSION EXPIRES: 12-18-89

ACKNOWLEDGEMENT

STATE OF NEW MEXICO)
)SS
COUNTY OF BERNALILLO)

THE FOREGOING INSTRUMENT WAS ACKNOWLEDGED BEFORE ME THIS
DAY OF December 1987 BY CAROLYN S. PAUTSCH,
TRUSTEE U/A/T DATED 11-24-86.

MY COMMISSION EXPIRES: 12-18-89

TALOS LOG No. SP-12-02-175

LOT SUMMARY

- 1- 0.1727 Ac
2- 0.1727 Ac
3- 0.1515 Ac
4- 0.1588 Ac
5- 3.3947 Ac

A.C.S. Sta. "2-H11"
 $X = 363,802.25$
 $Y = 1,493,065.22$
 Central Zone
 $\Delta\theta = -0^{\circ}15'43''$
 $G-G \text{ Factor} = 0.9999$
 $Elev. = 5095.653$

N 75° 26' 44" E
289.71' (Plot)
N 75° 25' 43" E
289.61' (Grid)

$R = 25.00'$
 $\Delta = 90^\circ 00' 00''$
 $L = 39.27'$

25' Public Drainage
& Utility Easement
by this plat.

SCALE: 1" = 100'

DESCRIPTION

A CERTAIN TRACT OF LAND SITUATE WITHIN PROJECTED SECTION 11, TOWNSHIP 10 NORTH, RANGE 2 EAST, N.M.P.M. IN THE TOWN OF ATISCADO GRANT, CITY OF ALBUQUERQUE, BERNALILLO COUNTY, NEW MEXICO, BEING AND COMPRISING ALL OF LOTS 32 TO 40 IN BLOCK 1, LOTS 11 TO 14, IN BLOCK 3 OF SANTA RITA ADDITION NO. 2 AS THE SAME ARE SHOWN AND DESIGNATED ON THE PLAT THEREOF RECORDED IN THE BERNALILLO COUNTY CLERK'S OFFICE ON AUGUST 24, 1962 IN BOOK CS, PAGE 128; AND LOTS 2 TO 7 IN BLOCK A, AND LOTS 1 & 2 IN BLOCK B OF SANTA RITA ADDITION NO. 2 AS THE SAME ARE SHOWN AND DESIGNATED ON THE REPLAT THEREOF RECORDED IN THE BERNALILLO COUNTY CLERK'S OFFICE ON MAY 5, 1966 IN BOOK C6, PAGE 121. ALL BEING MORE PARTICULARLY DESCRIBED AS FOLLOWS:

APPLICANT: 1990 IN BLOCK B, PAGE 21; ALL BEING MORE PARTICULARLY DESCRIBED AS FOLLOWS:
BEGINNING AT THE NORTHWEST CORNER OF THE TRACT HEREIN DESCRIBED BEING COMMON TO THE NORTHWEST CORNER OF SAID LOT 10 IN BLOCK 1; THENCE
S 89°19'00" E, 295.70 FEET DISTANCE TO A POINT OF CURVATURE; THENCE,
SOUTHEASTERLY 39.27 FEET DISTANCE ALONG THE ARC OF A CURVE BEARING TO THE RIGHT HAVING A RADIUS OF
25.00 FEET AND A CENTRAL ANGLE OF 90°00'00" TO A POINT OF TANGENCY; THENCE,
S 00°41'00" W, 353.00 FEET DISTANCE TO THE SOUTHEAST CORNER OF THE TRACT HEREIN DESCRIBED BEING COMMON
TO THE SOUTHEAST CORNER OF SAID LOT 14 IN BLOCK 3; THENCE,
N 89°19'00" W, 470.00 FEET DISTANCE TO THE SOUTHWEST CORNER OF SAID LOT 1 IN BLOCK B; THENCE,
N 00°41'00" E, 4.04 FEET DISTANCE TO A POINT; THENCE,
N 89°19'00" W, 160.00 FEET DISTANCE TO THE SOUTHWEST CORNER OF THE TRACT HEREIN DESCRIBED BEING COMMON
TO THE SOUTHWEST CORNER OF SAID LOT 7 IN BLOCK A; THENCE,
N 00°41'00" E, 11.06 FEET DISTANCE TO A POINT ON THE EASTERLY RIGHT-OF-WAY LINE OF COORS BLVD. NW
TO A POINT; THENCE,
N 19°04'00" E, 135.23 FEET DISTANCE ALONG THE SAID EASTERLY RIGHT-OF-WAY LINE OF COORS BLVD. NW TO
A POINT; THENCE,

PUBLIC UTILITY EASEMENTS

PUBLIC UTILITY EASEMENTS SHOWN ON THIS PLAT ARE TEN (10) FEET AND SEVEN (7) FEET WIDE AND ARE GRANTED FOR THE COMMON AND JOINT USE OF:

- A. THE PUBLIC SERVICE COMPANY OF NEW MEXICO FOR THE INSTALLATION, MAINTENANCE, AND SERVICE OF OVERHEAD AND UNDERGROUND ELECTRICAL LINES, TRANSFORMERS, AND OTHER EQUIPMENT AND RELATED FACILITIES REASONABLY NECESSARY TO PROVIDE ELECTRICAL SERVICE.
- B. MOUNTAIN BELL FOR THE INSTALLATION, MAINTENANCE AND SERVICE OF ALL BURIED AND AERIAL COMMUNICATION LINES AND OTHER RELATED EQUIPMENT AND FACILITIES REASONABLY NECESSARY TO PROVIDE COMMUNICATION SERVICES, INCLUDING BUT NOT LIMITED TO ABOVE GROUND PEDESTALS AND CLOSURES.
- C. JONES INTERCABLE FOR THE INSTALLATION, MAINTENANCE, AND SERVICE OF SUCH LINES, CABLE, AND OTHER RELATED EQUIPMENT AND FACILITIES REASONABLY NECESSARY TO PROVIDE CABLE TV SERVICE.

INCLUDED IS THE RIGHT OF INGRESS AND EGRESS FOR THE CONSTRUCTION AND MAINTENANCE AND THE RIGHT TO TRIM INTERFERING TREES AND SHRUBS. ALSO INCLUDED IS THE RIGHT TO INSTALL AND MAINTAIN SERVICE LINES.

PLAT FOR
SANTA RITA WEST

CITY OF ALBUQUERQUE
BERNALILLO COUNTY, NEW MEXICO
NOVEMBER, 1987

APPROVALS

Public Service Company of New Mexico	12-9-37
Mountain Bell Telephone Company	12-11-37
Gas Company of New Mexico	12-10-38
Chief City Surveyor	12/11/37

PROPERTY MANAGEMENT	DATE
<i>Dan DeHaven</i>	12/15/97
TRAFFIC ENGINEER	DATE
<i>D. H. Hines</i>	12-15-97
PARKS AND RECREATION DIRECTOR	DATE
<i>W. Hines</i>	12-15-97
WATER RESOURCES DEPARTMENT	DATE

ALBUQUERQUE METROPOLITAN ARROYO FLOOD CONTROL AUTHORITY	DATE
CITY ENGINEER, ENGINEERING DIVISION	DATE
PLANNING DIRECTOR, CITY/COUNTY PLANNING DIVISION	DATE

SURVEYOR'S CERTIFICATE

I, GAYLE D. JEWELL, A REGISTERED LAND SURVEYOR
UNDER THE LAWS OF THE STATE OF NEW MEXICO,
DO HEREBY CERTIFY THAT THIS PLAT WAS PREPARED
BY ME OR UNDER MY SUPERVISION, SHOWS ALL
EASEMENTS OF RECORD, MEETS THE MINIMUM
REQUIREMENTS FOR MONUMENTATION AND SURVEYS
OF THE ALBUQUERQUE SUBDIVISION ORDINANCE, AND
IS TRUE AND CORRECT TO THE BEST OF MY KNOWLEDGE
AND BELIEF.

Gayle B. Jewell 12-02-87
GAYLE B. JEWELL, L.S. NO. 4071 DATE

ACKNOWLEDGEMENT

[illegible]

THE FOREGOING INSTRUMENT WAS ACKNOWLEDGED
BEFORE ME THIS 2nd DAY OF December,
1987 BY GAYLE JEWELL, L.S. NO. 4071, A
REGISTERED LAND SURVEYOR UNDER THE LAWS OF
THE STATE OF NEW MEXICO.

NOTARY PUBLIC Caroline A. Ford

OFFICIAL SEAL
Caroline A. Ford
NOTARY PUBLIC - STATE OF NEW MEXICO
Notary Bond Filed with Secretary of State
My Commission Expires 9/29/16

ANDREWS, ASBURY & ROBERT, INC
— CONSULTING ENGINEERS —
ALBUQUERQUE 87-500 NEW MEXICO

SHEET | OF |

ENGINEER'S SEAL				SURVEY INFORMATION		BENCH MARKS		AS BUILT INFORMATION		
 ANDREWS, ASHURY & ROBERT, INC. CONSULTING ENGINEERS				FIELD NOTES				CONTRACTOR		
				NO.	BY	DATE			STARTED BY	
				REMARKS		BY			INSPECTOR'S	
DESIGNED BY J/M				DATE Feb., 1988		BRASS CAP SET IN CONCRETE MEDIAN, LOCATED		DATE		
DRAWN BY TL				DATE Feb., 1988		107.5 FT. SOUTH AND 2.0 FT. EAST OF THE CENTERLINE		DATE		
CHECKED BY JJ				DATE Feb., 1988		INTERSECTION OF COORS BLVD. NW. AND ILIFF		DATE		
REVISIONS						RD. NW.		DATE		
DESIGN								MICRO-FILM INFORMATION		
								RECORDED BY		
								DATE		
								NO.		

CITY OF ALBUQUERQUE
PUBLIC WORKS DEPARTMENT
ENGINEERING GROUP

**SANTA RITA WEST
INFRASTRUCTURE IMPROVEMENTS PHASE I
SUBDIVISION PLAT**

APPROVALS		ENGINEER	DATE	APPROVALS		ENGINEER	DATE
D.R.C. Chair		<i>[Signature]</i>	04/11/88				
Trans. Dev.		<i>[Signature]</i>	04/15/88				
Utility Dev.		<i>[Signature]</i>	4/14/88				
<i>[Signature]</i>		<i>[Signature]</i>	4/14/88				
DRAWING NO. 3495		MAP NO. H-11		SHEET 2 OF 4			

26 34950289

11084

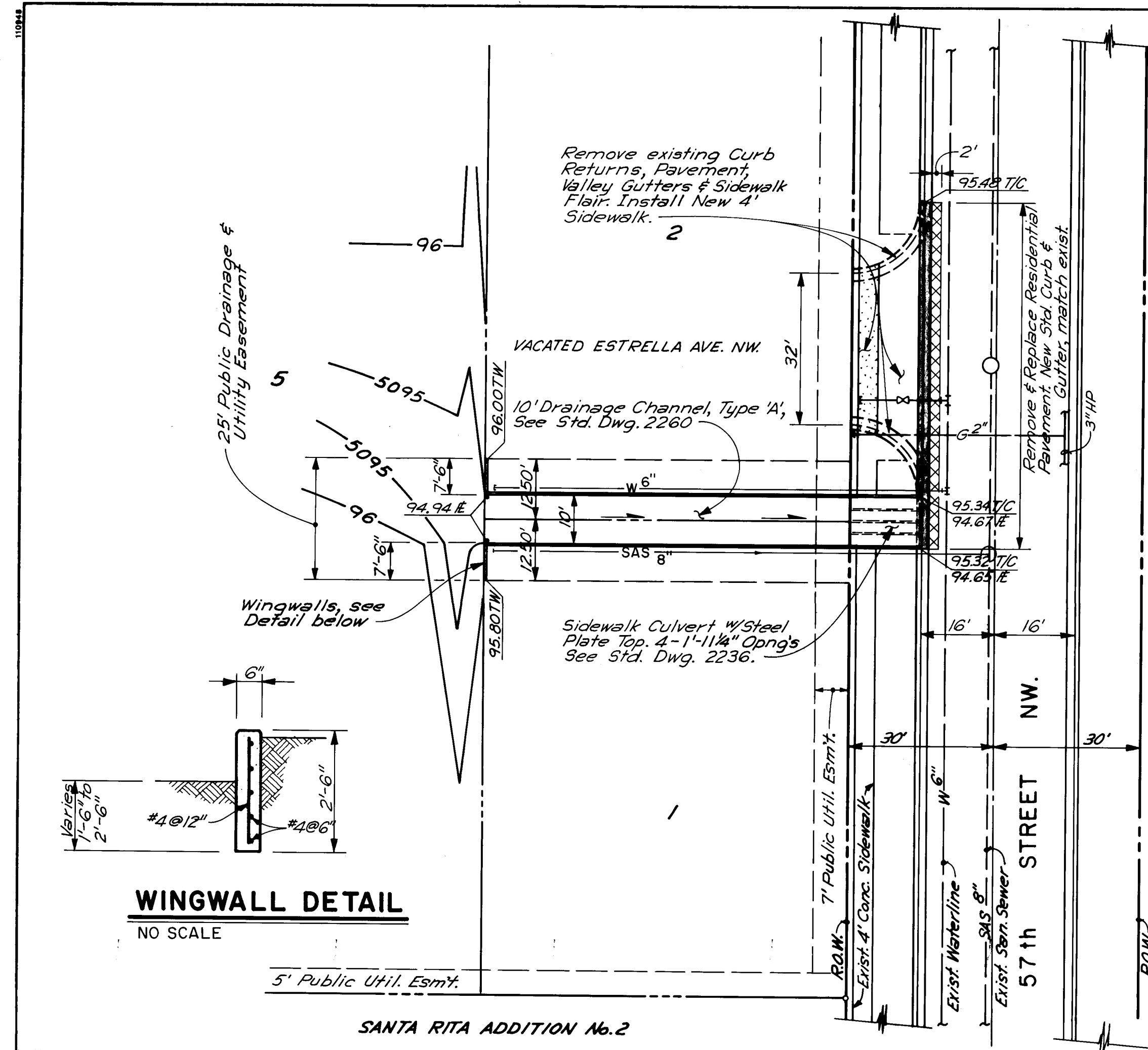

PLAN
SCALE: 1" = 20'

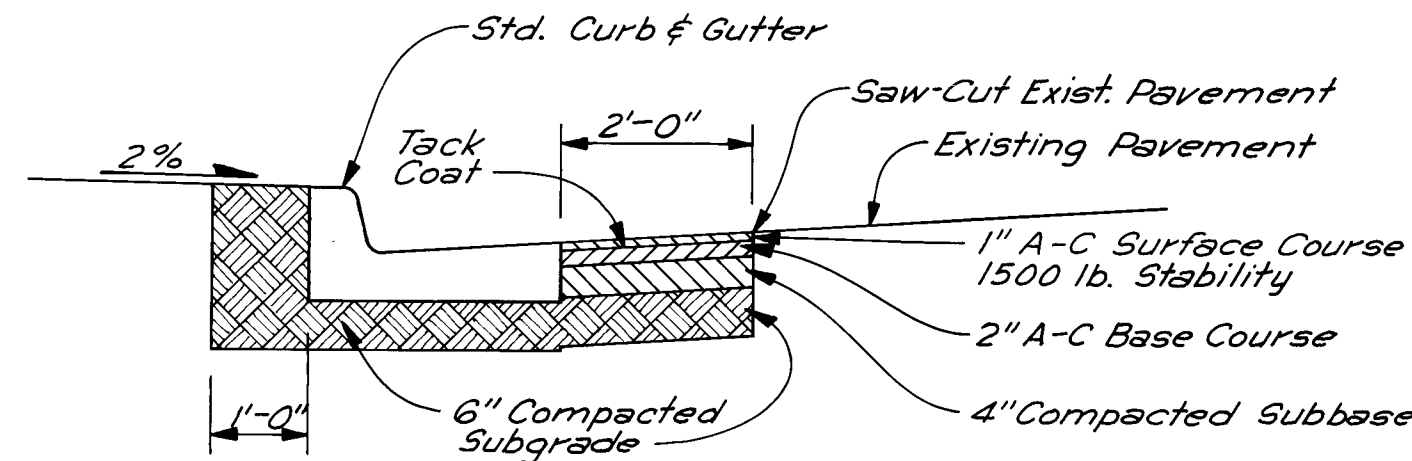

PAVEMENT REPLACEMENT SECTION
NO SCALE

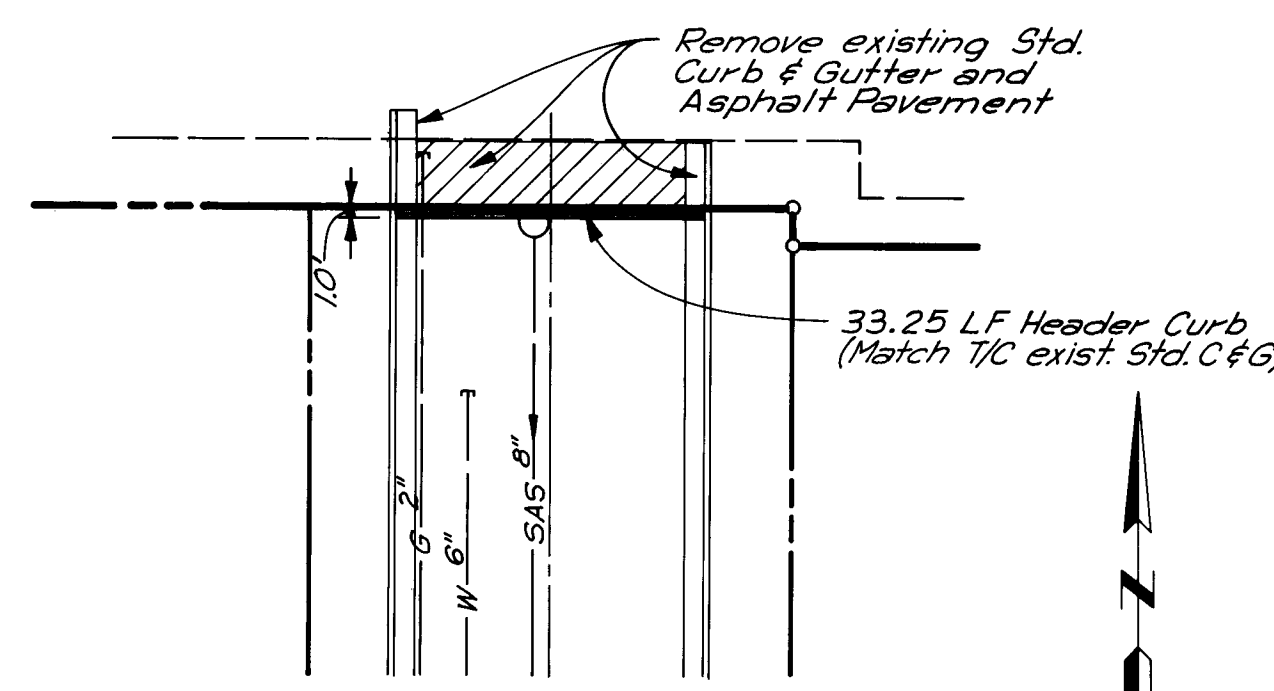

DOLORES ST. HEADER CURB
SCALE: 1" = 20'

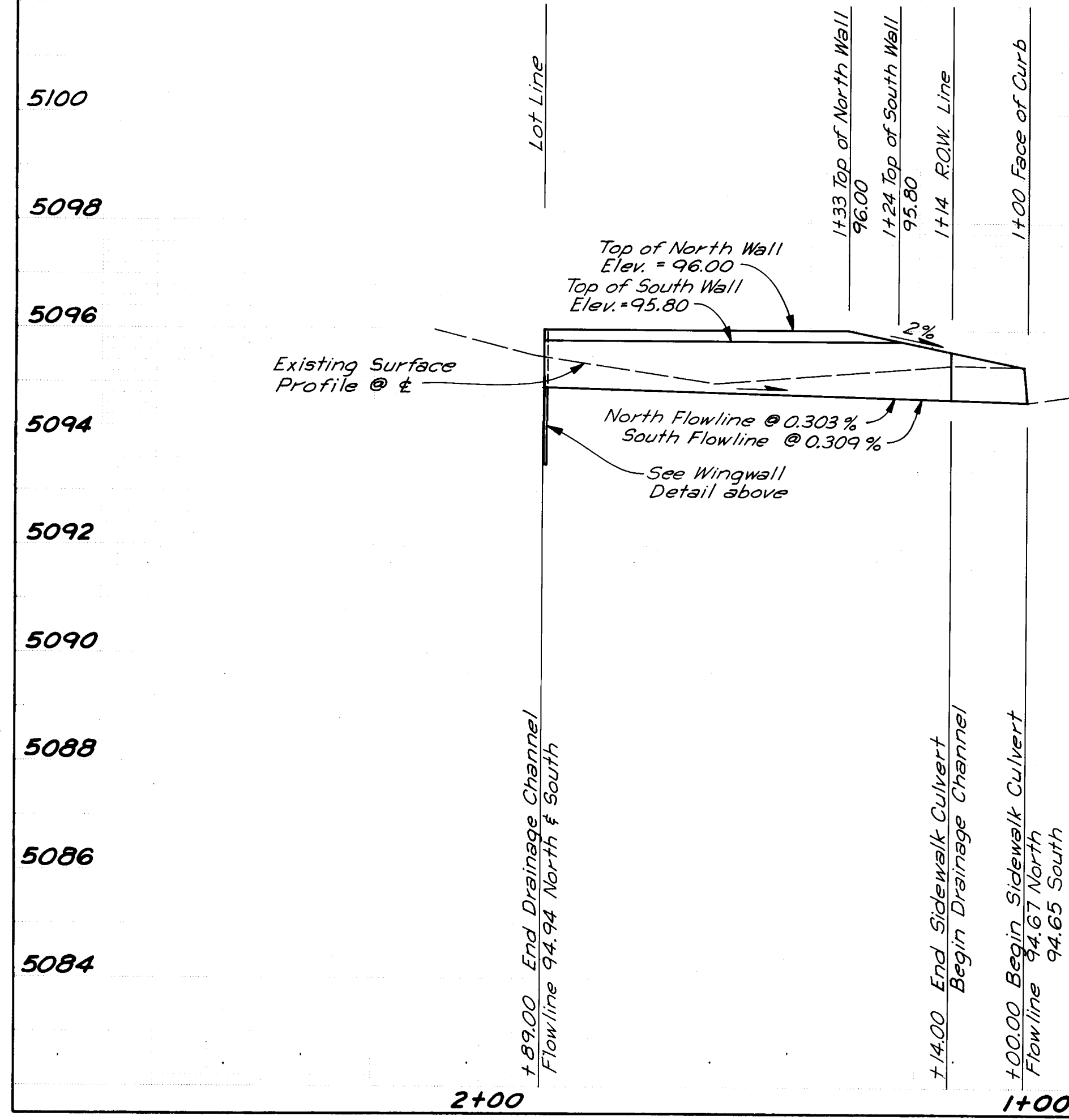

PROFILE
SCALE: 1" = 20' Horiz.
1" = 2' Vert.

ENGINEER'S SEAL			SURVEY INFORMATION		BENCH MARKS		AS BUILT INFORMATION	
			FIELD NOTES					
	NO.	BY	DATE					
			ACS STA. 2-H.I. ELEVATION 5095.653					
			BRASS CAP SET IN CONCRETE MEDIAN, LOCATED					
			107.5 FT. SOUTH AND 2.0 FT. EAST OF THE CENTERLINE					
			INTERSECTION OF COORS BLVD. NW. AND ILLIFF					
			RD. NW.					
REVISIONS			DESIGN			MICRO-FILM INFORMATION		
NO. DATE		REMARKS	BY		DATE	RECORDED BY		
			DESIGNED BY JM		DATE Feb., 1988			
			DRAWN BY TL, JCS		DATE Feb., 1988			
			CHECKED BY JM		DATE Feb., 1988			

CITY OF ALBUQUERQUE
PUBLIC WORKS DEPARTMENT
ENGINEERING GROUP

SANTA RITA WEST
INFRASTRUCTURE IMPROVEMENTS PHASE I
PAVING & STORM DRAIN PLAN & PROFILE

APPROVALS	ENGINEER	DATE	APPROVALS	ENGINEER	DATE
D.R.C. Chair		04/15/88			
Trans. Dev		04/16/88			
Utility Dev		4/19/88			

DRAWING NO. 3495 MAP NO. H-11 SHEET 3 OF 4

26 34950389

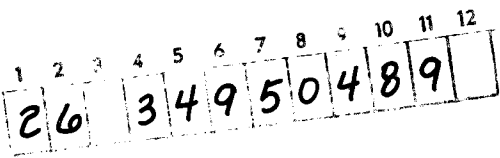

NOTES:

CONTRACTOR SHALL COORDINATE VALVE SHUT-OFF WITH WATER SYSTEMS DIVISION (823-4200) NOT LESS THAN TWO (2) WORKING DAYS PRIOR TO ANY WORK WHICH MAY EFFECT EXISTING UTILITIES.

[illegible]