

SAN PEDRO BLVD AND KATHRYN AVE  
INTERSECTION IMPROVEMENTS

INDEX	
SHEET NO.	DESCRIPTION
1 OF 3	TITLE SHEET
2 OF 3	PLAN VIEW & TRAFFIC CONTROL PLAN
3 OF 3	CROSS SECTIONS

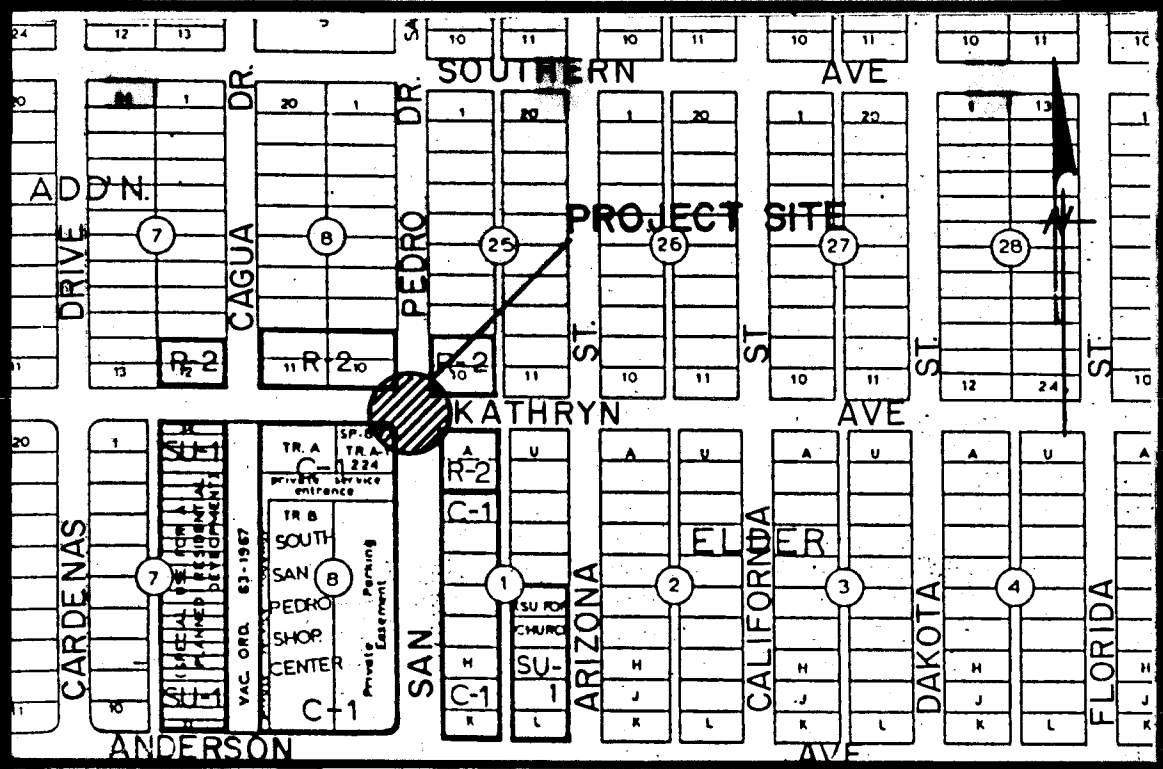

LOCATION MAP

- GENERAL NOTES:
- ALL WORK DETAILED ON THESE PLANS TO BE PERFORMED UNDER CONTRACT SHALL, EXCEPT AS OTHERWISE STATED OR PROVIDED FOR HEREON, BE CONSTRUCTED IN ACCORDANCE WITH THE CITY OF ALBUQUERQUE STANDARD SPECIFICATIONS - PUBLIC WORKS CONSTRUCTION - 1986.
  - TWO (2) WORKING DAYS PRIOR TO ANY EXCAVATION, CONTRACTOR MUST CONTACT LINE LOCATING SERVICE, 765-1234, FOR LOCATION OF EXISTING UTILITIES.
  - SHOULD A CONFLICT EXIST BETWEEN THESE PLANS AND ACTUAL FIELD CONDITIONS, THE CONTRACTOR SHALL PROMPTLY NOTIFY THE ENGINEER IN WRITING SO THAT THE CONFLICT CAN BE RESOLVED WITH A MINIMUM AMOUNT OF DELAY FOR ALL PARTIES.
  - THE CONTRACTOR SHALL MAINTAIN ACCESS TO ADJACENT PROPERTIES DURING CONSTRUCTION.
  - ALL WORK ON THIS PROJECT SHALL BE PERFORMED IN ACCORDANCE WITH APPLICABLE FEDERAL, STATE AND LOCAL LAWS, RULES AND REGULATIONS CONCERNING CONSTRUCTION SAFETY AND HEALTH.
  - THE CONTRACTOR MUST SUBMIT A CONSTRUCTION SIGNING AND BARRICADING PLAN TO TRAFFIC ENGINEERING TO RECEIVE A BARRICADING PERMIT 48 HOURS PRIOR TO CONSTRUCTION.
  - ALL UTILITIES AND UTILITY SERVICE LINES SHALL BE INSTALLED PRIOR TO PAVING.
  - BACKFILL COMPACTION SHALL BE ACCORDING TO SPECIFIED STREET USE.
  - TACK COAT REQUIREMENTS SHALL BE DETERMINED BY THE CITY ENGINEER.
  - SIDEWALKS AND WHEELCHAIR RAMPS WITHIN THE CURB RETURNS SHALL BE CONSTRUCTED WHEREVER A NEW CURB RETURN IS CONSTRUCTED.
  - IF CURB IS DEPRESSED FOR A DRIVEPAD OR A HANDICAP RAMP, THE DRIVEPAD OR RAMP SHALL BE CONSTRUCTED PRIOR TO ACCEPTANCE OF THE CURB AND GUTTER.
  - ALL STORM DRAINAGE FACILITIES SHALL BE COMPLETED PRIOR TO FINAL ACCEPTANCE.
  - ALL STATIONING SHALL BE BASED ON CONSTRUCTION CENTERLINE.
  - PAINTING FOR TRAFFIC STRIPING SHALL BE CONDUCTED BY OWNER.

26 36900189

APPROVAL OF AS BUILT DRAWINGS  
CHIEF CONSTRUCTION ENGINEER  
*[Signature]*  
DATE 7-13-89

REV.	SHEETS	CITY ENGINEER	DATE	USER	DEPT.	DATE	USER	DEPT.	DATE
APPROVAL OF REVISIONS									

	CITY OF ALBUQUERQUE	APPROVED FOR CONSTRUCTION <i>[Signature]</i> 1-24-89
	DRAWING NO. 3690	SHEET OF 1 3

MESA PARK ADD'N.

ELDER HOMESTEAD ADD'N.

CENTRAL PARK ADD'N.

SOUTH SAN PEDRO SHOPPING CENTER

## LEGEND

- Existing Curb & Gutter
- Existing Asphalt Pavement
- Right of Way
- Limits of New Pavement
- MH Existing SAS MH
- Existing Top of Surface Course
- New Top of Surface Course
- ADD 5300 to all given elevation
- Existing 2" Traffic Signal Conduit

## PLAN VIEW

SCALE: 1" = 20'

5/8" PLANT MIX SEAL  
2" ASPHALT SURFACE COURSE  
1800 LBS STABILITY  
2" ASPHALT BASE COURSE  
1500 LBS STABILITY  
4" A.T.B.  
12" COMPACTED SUBGRADE  
95% COMPACTION

## ASPHALT CONCRETE PAVEMENT SECTION

## GENERAL NOTES:

- ALL EXISTING UNDER GROUND UTILITIES ARE SHOWN ON PROJECT PLANS # 2285 SHEET 22. NO UNDERGROUND UTILITIES, SHOULD BE AFFECTED EXCEPT THE ADJUSTMENT OF THE EXISTING SAS MH.
- PREPARE SUBGRADE FOR ARTERIAL/COLLECTOR ROADWAYS, 12" AT 95% COMPACTION ASTM 1557 INCLUDING REGRADING AND ANY BORROW OR REMOVAL NECESSARY TO ACHIEVE REQUIRED GRADE.
- EXISTING SEWER MANHOLE FRAME COVER, ADJUST TO GRADE WITH MASONRY, OVER 2".
- REMOVE AND REPLACE ASPHALT AT LIMITS SHOWN ON PLAN VIEW THIS SHEET. (SEE PAVEMENT SECTION FOR COMPONENTS).
- ALL EXISTING CURB AND GUTTER TO REMAIN.
- ALL ELEVATIONS GIVEN ARE AT TOP OF SURFACE COURSE.
- SIGNALIZATION DETECTOR LOOPS AND PAVEMENT MARKINGS WILL BE REPLACED BY CITY CREWS. CONTACT TOM VAN ETEN 823-4008, TWO WEEKS AND (48) FORTYEIGHT HOURS BEFORE CONSTRUCTION.
- CONTRACTOR WILL BE RESPONSIBLE FOR THE PRESERVATION OF THE EXISTING TRAFFIC CONDUIT. ANY DAMAGE TO CONDUIT MUST BE REPLACED AT THE EXPENSE OF THE CONTRACTOR. THIS DOES NOT INCLUDE DETECTOR LOOPS.

## TRAFFIC CONTROL SIGNS

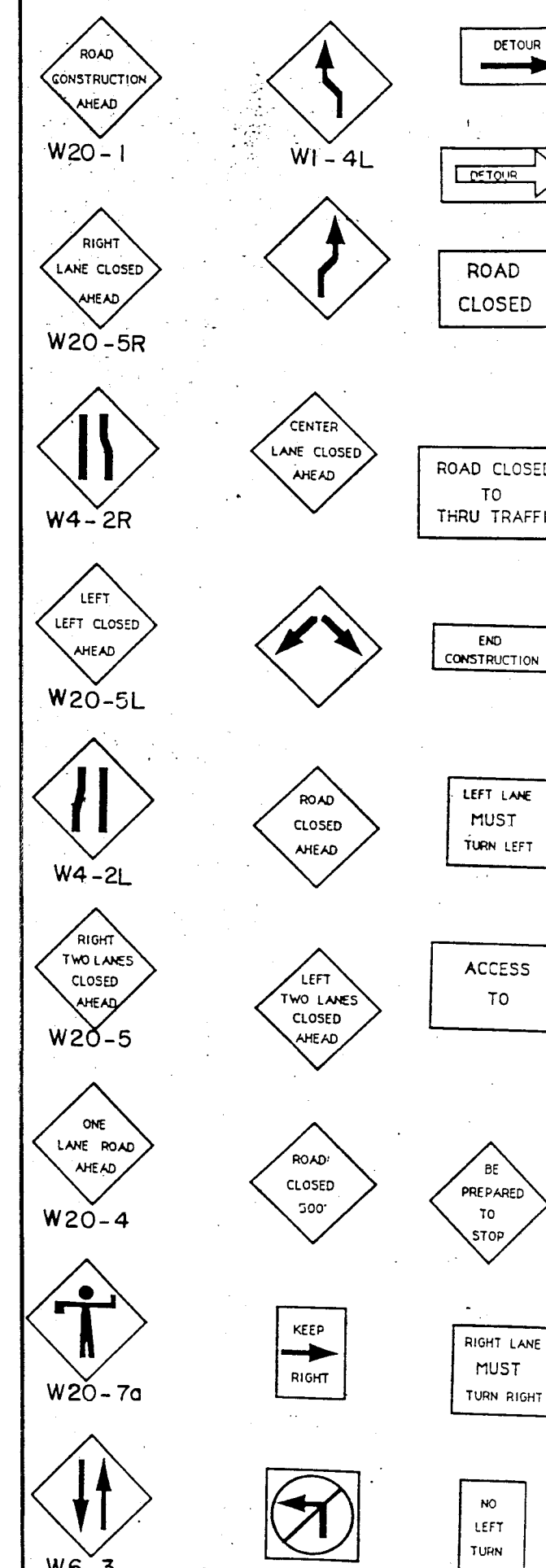

AS BUILT INFORMATION		BENCH MARKS		SURVEY INFORMATION		ENGINEER'S SEAL		REVISIONS		DESIGN	
CONTRACTOR	SUNDANCE MECH	BM 19-L18	A STANDARD ACS DISK LOCATED AT THE S.W. CORNER OF SAN PEDRO BLVD AND KATHRYN AVE S.E.	NO.	DATE	NO.	DATE	NO.	DATE	NO.	DATE
WORKED BY	CITY										
INSPECTED BY	L. ROMERO										
ACCEPTANCE DATE	8/1/89										
DRAWING	DATE										
VERIFICATION BY	ELEV = 5301.96										
RECORDED BY											
NO											

CITY OF ALBUQUERQUE  
PUBLIC WORKS DEPARTMENT  
ENGINEERING GROUP

TITLE: **SAN PEDRO BLVD. AND KATHRYN AVE S.E. INTERSECTION IMPROVEMENTS**

APPROVALS	ENGINEER	DATE	APPROVALS	ENGINEER	DATE
D.R.C. Chair		12/8/88			
Trans. Dev.		12/8/88			
Utility Dev.		12/8/88			
Hydrology		12/8/88			

DRAWING NO. **3690** MAP NO. **L-18** SHEET **2** OF **3**

NOTE:  
L = Distance Between Signs - A Distance Measured In Feet Equal To A Value Of Ten Times The Speed Limit Of The Street.

