

CONSTRUCTION DOCUMENTS
CLASS I CONSTRUCTION

MARIPOSA BASIN
ACCESS RAMP & TRAIL “D” SECTION

INDEX OF DRAWINGS

TITLE

SHEET NO.

COVER SHEET

CS-1 OF 3

LAYOUT PLAN - DETAILS

2 OF 3

GRADING PLAN - DETAILS

3 OF 3

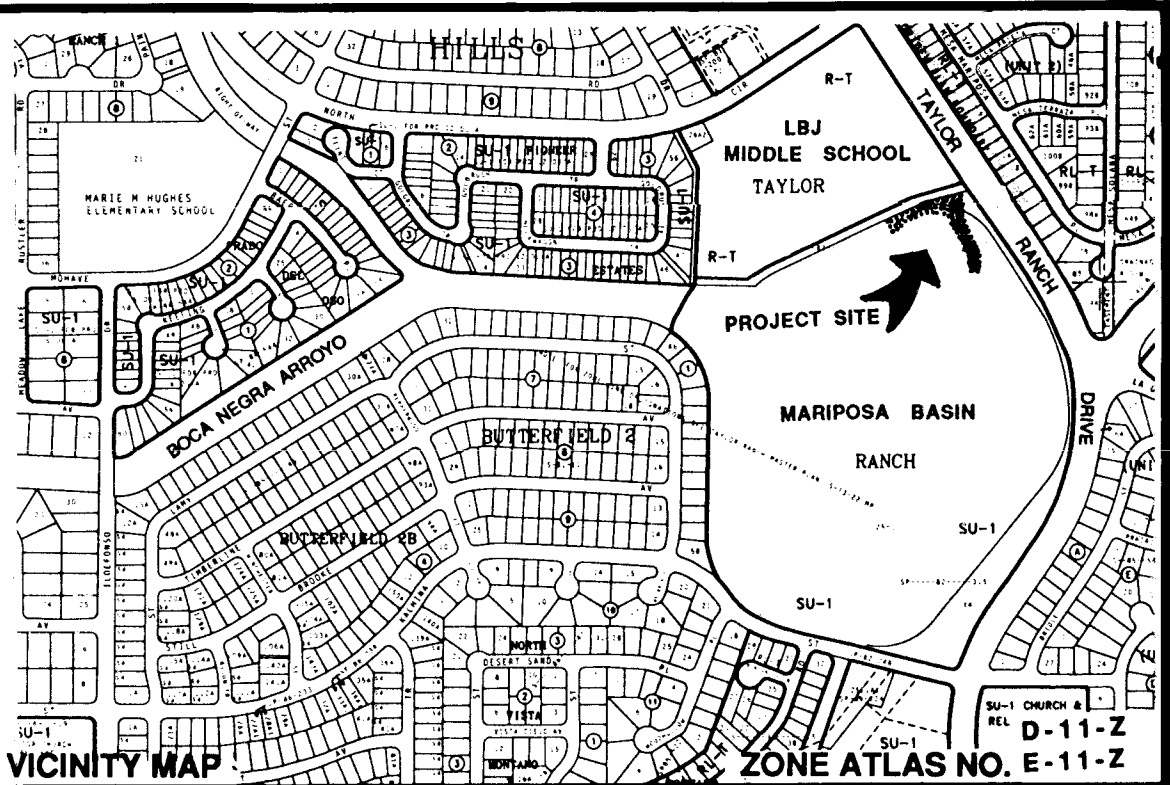

NOTICE TO CONTRACTOR

- 1. All work detailed on these plans to be performed under contract shall, except as otherwise stated or provided for hereon, be constructed in accordance with City of Albuquerque Standard Specifications, Public Works Construction, 1986 as amended through Update #4.
- 2. Two (2) working days prior to any excavation, contractor must contact contact Line Locating Service, 260-1990 for location of existing utilities.
- 3. Prior to construction, the contractor shall verify the horizontal and vertical locations of all obstructions. Should a conflict exist, the contractor shall notify the engineer or surveyor so that the conflict can be resolved with a minimum amount of delay.

THE FOLLOWING ALSO APPLY WHEN CHECKED

- ☐ All utilities and utility service lines shall be installed prior to paving.
- ☐ Backfill compaction shall be according to specified street use.
- ☐ Tack coat requirements shall be determined by the city engineer.
- ☐ Sidewalks and wheelchair ramps within the curb returns shall be constructed wherever a new curb return is constructed.
- ☐ If curb is depressed for a drivepad or ramp, it shall be constructed prior to acceptance of the curb and gutter.
- ☐ All storm drainage facilities shall be completed prior to final acceptance.

1 2 3 4 5 6 7 8 9 10 11 12 13 14 15
20-4000.92 10/1/97

APPROVAL OF AS BUILT DRAWINGS
CHIEF CONSTRUCTION ENGINEER
[Signature]
DATE 4-8-97

REV.	SHEETS	CITY ENGR.	DATE	USER DEPT.	DATE	USER DEPT.	DATE
APPROVAL OF REVISIONS							
				CITY OF ALBUQUERQUE PARKS AND GENERAL SERVICES DEPARTMENT DESIGN AND DEVELOPMENT DIVISION		APPROVED FOR CONSTRUCTION <i>[Signature]</i> 4/22/97 DATE	
				PROJECT NUMBER 4000.92		SHEET 1 OF 3	

TOPOGRAPHIC MAP SHOWING
A PORTION OF
MARIPOSA BASIN
WITHIN SECTION 23 & 26,
TOWNSHIP 11 NORTH, RANGE 2 EAST,
NEW MEXICO PRINCIPAL MERIDIAN
CITY OF ALBUQUERQUE
BERNALILLO COUNTY, NEW MEXICO
JANUARY, 1994

GENERAL NOTES:

1. WELDS ARE TO BE GROUND SMOOTH.
2. EXPOSED STEEL AND SLEEVE TO BE PAINTED WITH AN OIL BASE ALKID PRIMER AND AN OIL BASE ALKID ENAMEL TOP COAT. COLOR TO BE BRIGHT YELLOW.

CONSTRUCTION NOTES:

- A. 4" NOMINAL DIA. SCHEDULE 40 GALV. STEEL PIPE, 5'-2" TO BE FILLED W/CONC. PAINT PIPE BRIGHT YELLOW ABOVE FINISHED GRADE.
- B. PAVEMENT OR FINISHED GRADE.
- C. CONC. COLLAR, 4000 PSI AT 28 DAYS, W/SMOOTH OR BROOM FINISH WHERE PAVEMENT IS ADJACENT.
- M. PLACEMENT OF POSTS SHOULD BE WELL AWAY FROM TRAFFIC ON MAJOR ROADWAYS & PREFERABLY AT THE R.O.W. LINE. TRAFFIC ENGINEERING SHOULD BE CONSULTED ON LOCATION WHEN NEAR TRAFFIC.
- N. ALIGN WITH TRAFFIC FLOW IN EASEMENTS OR BIKEPATH TO AVOID TRIPPING HAZARDS WITH BOX.
- P. PIPES ARE NOT TO BE FILLED W/CONC. WHEN PIPES ARE LOCATED WITHIN 15' OF STREET FLOWLINE. USE WELDED STEEL CAP INSTEAD.
- O. WHERE CONNECTING BOLLARDS ARE SPECIFIED, WELD 1-1/4" NOM. SCH 40 PIPE BETWEEN BOLLARDS.

STATIONARY POST DETAIL
COA DWG. 2250
(NTS)

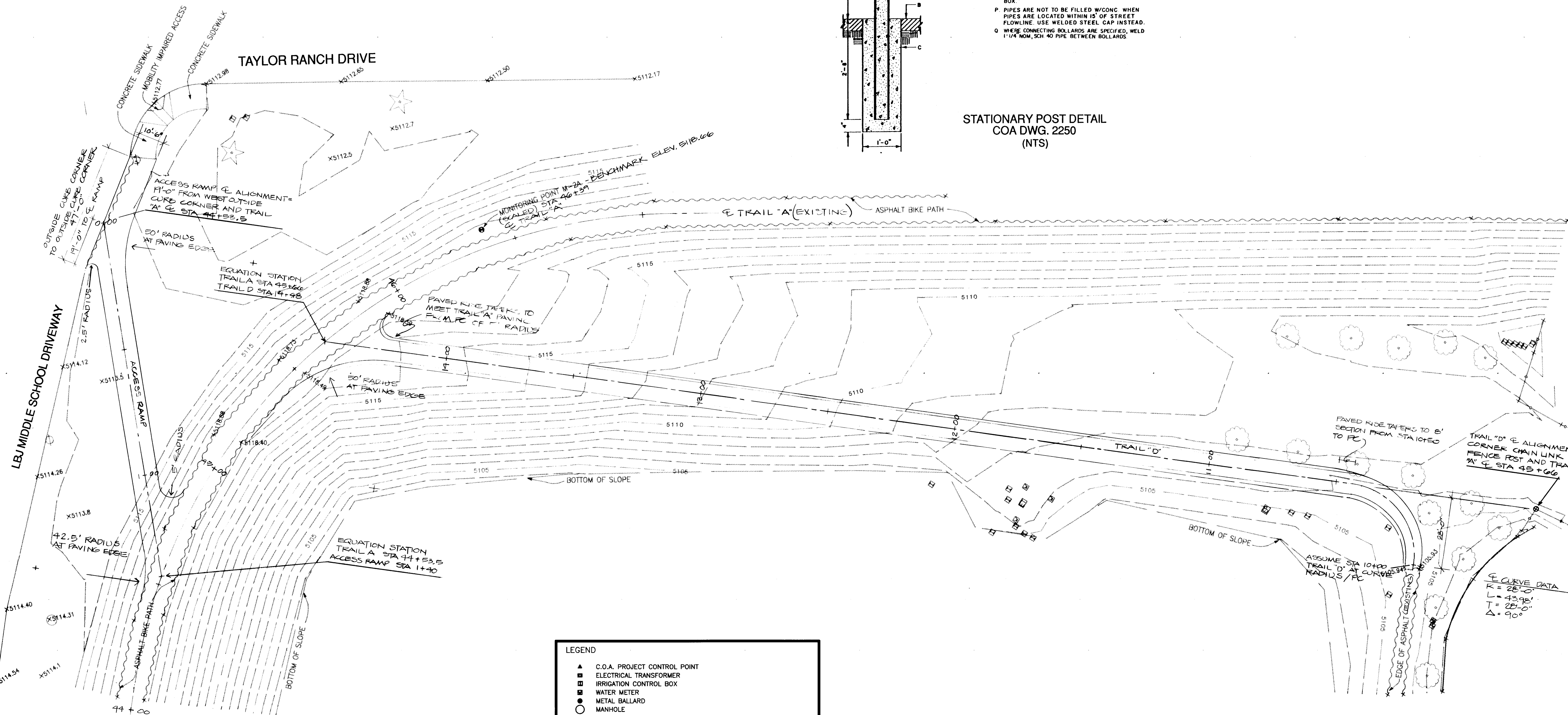

LEGEND

- ▲ C.O.A. PROJECT CONTROL POINT
- ELECTRICAL TRANSFORMER
- IRRIGATION CONTROL BOX
- WATER METER
- METAL BALLARD
- MANHOLE
- CHAIN-LINK FENCE
- MARIPOSA DETENTION BASIN DAM MONITORING ALUMINUM CAP (DO NOT DISTURB FOR INFORMATION CALL JAN FIALA AT 768-3609)
- OVERHEAD UTILITY LINES
- EDGE OF ASPHALT
- +5000.00 SPOT ELEVATION AT TOP OF BACK C & G OR TOP OF ASPHALT
- +5000.0 SPOT ELEVATION ON DIRT
- ELECTRICAL RISER
- TELEPHONE RISER
- LIGHT POLE
- CONIFEROUS TREE
- RUSSIAN OLIVE TREE
- COTTONWOOD TREE
- DECIDUOUS TREE
- DROP INLET

SURVEY INFORMATION			AS BUILT INFORMATION		
NO.	FIELD NOTES		BENCHMARK	DATE	
	BY	DATE			
			AMAFCA MARIPOSA DETENTION		
			BASIN DAM MONITORING ALUMINUM		
			CAP M-2A LOCATED APPROXIMATELY		
			73 FT. SOUTHEAST OF THE		
			INTERSECTION OF TRAIL 'A' AND		
			TRAIL 'D' - ELEVATION 5105.66		

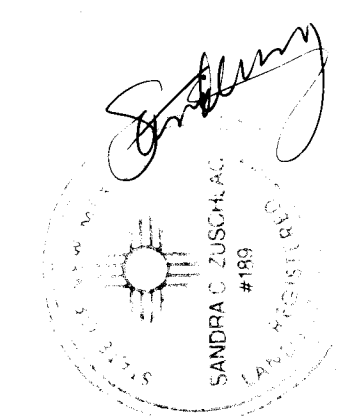

26 40 00 12 22 97

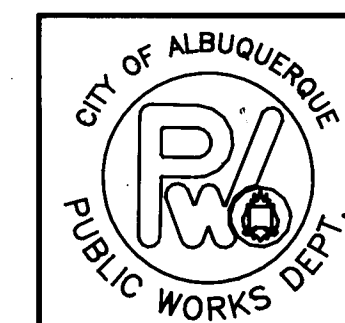

CITY OF ALBUQUERQUE
PUBLIC WORKS DEPARTMENT
ENGINEERING GROUP
SURVEY SECTION

CITY OF ALBUQUERQUE PARKS AND GENERAL SERVICES DEPARTMENT DESIGN AND DEVELOPMENT DIVISION					
TITLE: LAYOUT PLAN MARIPOSA BASIN ACCESS RAMP - TRAIL "D" SECTION					
APPROVALS	ENGINEER	DATE	APPROVALS	ENGINEER	DATE
CHAIRPERSON	3/4/94	4-19-94	WATER	N/A RWE	3-30-94
TRANSPORTATION	3/4/94	4-01-94	WASTE WATER	N/A RWE	3-30-94
HYDROLOGY	3/4/94	4-01-94	AMAFCA	3/28/94	
PARKS					
PROJECT NO. 4000.92 MAP NO. E-11-Z SHEET 2 OF 3					

DESIGNED BY: REM
DATE: 3-20-94
DRAWN BY: REM
DATE: 3-20-94
CHECKED BY:
DATE:

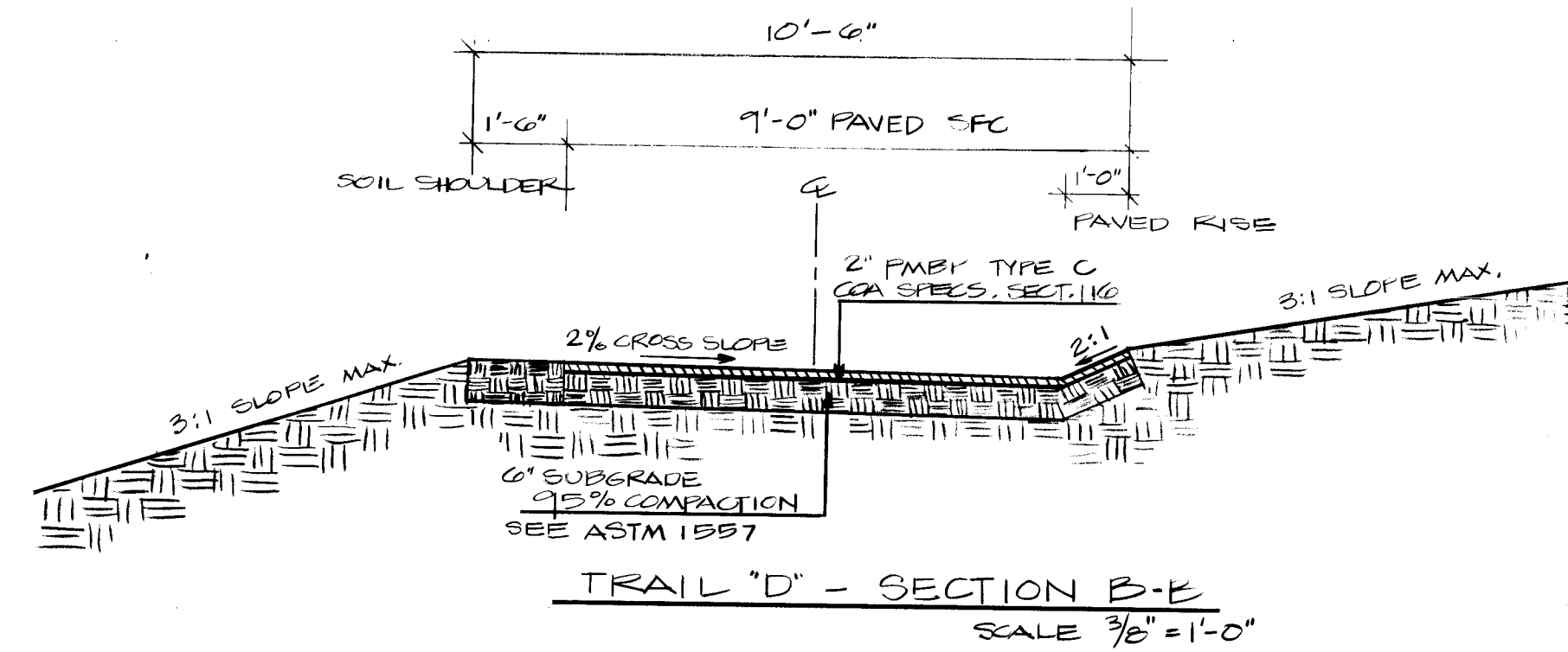

NOTES:

1. ALL AREAS OF CONSTRUCTION SHALL BE CLEARED AND GRUBBED ACCORDING TO CITY OF ALBUQUERQUE STANDARD SPECIFICATIONS, SECTION 201.
2. EXISTING IRRIGATION LATERALS RUNNING PARALLEL WITH TRAIL "D" HAVE BEEN CAPPED. ALL FITTINGS AND HEADS EXPOSED DURING CONSTRUCTION SHALL BE SALVAGED AND RETURNED TO COA PARK MANAGEMENT.
3. THE CAPACITY TO RETAIN POTENTIAL FLOOD WATERS WITHIN THE BASIN CANNOT CHANGE THEREFORE NO FILL CAN BE ADDED FROM OR ADDED TO THE BASIN AREA. ALL FILL REQUIRED FOR TRAIL "D" CONSTRUCTION MUST COME FROM A SPOIL AREA WITHIN THE BASIN AS DESIGNATED BY THE PROJECT MANAGER. FILL NECESSARY FOR ACCESS RAMP CONSTRUCTION MUST BE OBTAINED FROM A SOURCE OUTSIDE THE BASIN.

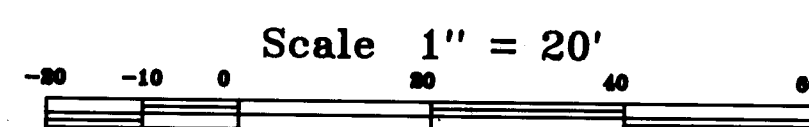
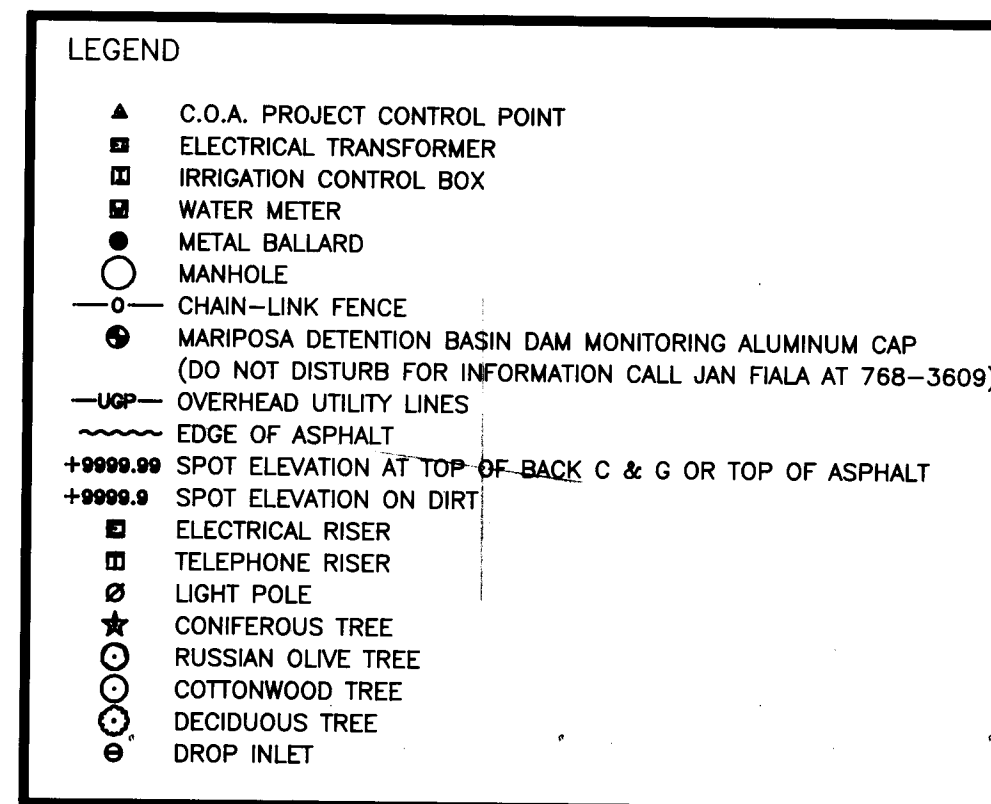
[illegible]

1	2	3	4	5	6	7	8	9	10	11	12	13	14	15
2	6	-	4	0	0	0	.	9	2		0	3	9	7

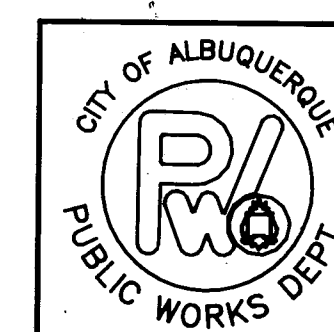

CITY OF ALBUQUERQUE
PUBLIC WORKS DEPARTMENT
ENGINEERING GROUP
SURVEY SECTION

CITY OF ALBUQUERQUE
PARKS AND GENERAL SERVICES DEPARTMENT
DESIGN AND DEVELOPMENT DIVISION

TITLE: **GRADING PLAN**
MARIPOSA BASIN
ACCESS RAMP - TRAIL "D" SECTION

APPROVALS	ENGINEER	DATE	APPROVALS	ENGINEER	DATE
CHAIRPERSON	<i>B. G. G. G.</i>	4/19/94	WATER	N/A RWE	3-30-94
TRANSPORTATION	<i>N. G. G.</i>	4/19/94	WASTE WATER	N/A RWE	3-30-94
HYDROLOGY	<i>J. G. G.</i>	4/19/94	AMAFCA	<i>J. G. G.</i>	3/29/94
PARKS					

PROJECT NO. 4000.92	MAP NO. E-11-Z	SHEET 3 OF 3
----------------------------	-----------------------	----------------------------