

CITY OF ALBUQUERQUE PUBLIC WORKS DEPARTMENT PLANS FOR CONSTRUCTION

NMSHTD PROJECT NO. SP-HM-7501(213)

SAWMILL AREA SIDEWALK IMPROVEMENTS

INDEX TO DRAWINGS

SHEET NO.	TITLE
1	TITLE SHEET AND INDEX TO DRAWINGS
2	ASPEN AVENUE
3	19TH, 20TH & 23RD STREET
4	21ST & 22ND STREET
5	SECTIONS AND DETAILS

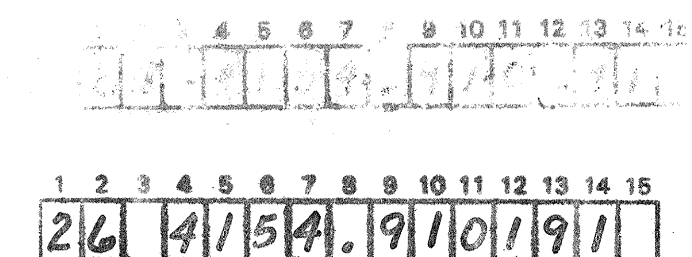
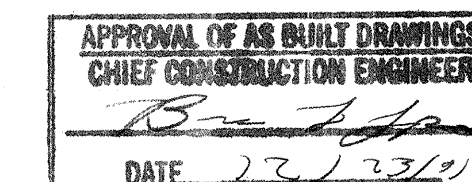

REV.	SHEETS	CITY ENGINEER	DATE	USER DEPARTMENT	DATE	USER DEPARTMENT	DATE

APPROVAL OF REVISIONS



S-SEC Smith-Scheuch
Engineering Company
Albuquerque, New Mexico

PROJECT NO.

4154.91

APPROVED FOR
CONSTRUCTION

[Signature]
9-17-91 C.E.

SHEET 1 OF 5

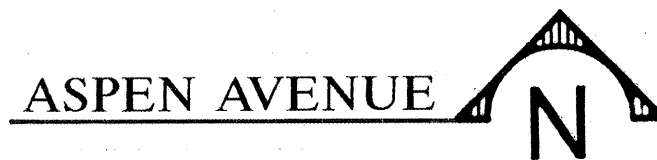

- | | | | | | | | | | | | | | | |
|----|---|---|---|---|---|---|---|----|----|----|----|----|----|----|
| 1 | 2 | 3 | 4 | 5 | 6 | 7 | 8 | 9 | 10 | 11 | 12 | 13 | 14 | 15 |
| 26 | | 4 | 4 | 5 | 4 | | 9 | 10 | 2 | 9 | | | | |

CITY OF ALBUQUERQUE
PUBLIC WORKS DEPARTMENT
ENGINEERING GROUP

TITLE: SAWMILL AREA SIDEWALK IMPROVEMENTS

ASPEN AVENUE

PROJECT NO.	4154.91	MAP NO.	H-13	SHEET	2	OF	5
-------------	---------	---------	------	-------	---	----	---

- 1 CONSTRUCT 4' SIDEWALK (4" THICK)
COA DWG. 2430.
- 2 CONSTRUCT 4' SIDEWALK (6" THICK)
SEE DETAIL A/5.
- 3 CONSTRUCT WHEELCHAIR RAMP
(CASE II)
IN EXIST. DEPRESSED CURB.
- 4 REMOVE AND RELOCATE EXIST. SIGN TO
BACK OF NEW SIDEWALK. (BY COA).
- 5 REMOVE AND RELOCATE EXIST.
MAILBOX TO BACK OF NEW SIDEWALK.
- 6 REMOVE AND RELOCATE EXIST. FENCE
AS REQUIRED TO BACK OF NEW
SIDEWALK AND/OR WHEEL CHAIR RAMP.
- 7 EXIST. CATV BOX TO BE RELOCATED
TO BACK OF NEW SIDEWALK BY JONES
INTERCABLE.
- ~~8 CONSTRUCT RETAINING WALL--
SEE DETAIL C/5.~~
- ~~9 REMOVE AND DISPOSE OF EXIST. TREE--~~
- ~~10 CONSTRUCT CONCRETE STEPS--
AS REQUIRED.~~
- ~~11 ADJUST WATER METER TO GRADE--~~
- 12 REMOVE AND DISPOSE CONCRETE
HEADWALL, COMPLETE.
- 13 PLACE FILL BETWEEN NEW SIDEWALK
AND EXIST. FENCE. GRADE LEVEL AND
COMPACT TO 85% (ASTM D-1557)

1	THREE (3) WORKING DAYS PRIOR TO BEGINNING CONSTRUCTION, THE CONTRACTOR SHALL SUBMIT A DETAILED CONSTRUCTION SCHEDULE TO THE CITY CONSTRUCTION COORDINATION DIVISION. TWO (2) DAYS PRIOR TO CONSTRUCTION, THE CONTRACTOR SHALL OBTAIN A BARRICADING PERMIT FROM THE CONSTRUCTION COORDINATION DIVISION. CONTRACTOR SHALL NOTIFY BARRICADE ENGINEER (788-2551) PRIOR TO OCCUPYING AN INTERSECTION. REFER TO SECTION 19 OF THE GENERAL CONDITIONS OF THE STANDARD SPECIFICATIONS.	10	THE CONTRACTOR IS TO CONSTRUCT THE IMPROVEMENTS ON EACH STREET IN THE FOLLOWING ORDER. 1) DRIVEPADS, 2) SIDEWALKS, 3) TRANSITIONS, 4) RETAINING WALLS, 5) MISC. ITEMS.
2	THE CONTRACTOR SHALL NOTIFY THE FIELD ENGINEER NOT LESS THAN SEVEN (7) DAYS PRIOR TO STARTING WORK, IN ORDER THAT THE FIELD ENGINEER MAY TAKE NECESSARY MEASURES TO INSURE THE PRESERVATION OF SURVEY MONUMENTS. CONTRACTOR SHALL NOT DISTURB PERMANENT SURVEY MONUMENTS WITHOUT THE CONSENT OF THE FIELD ENGINEER AND SHALL NOTIFY THE FIELD ENGINEER AND BEAR THE EXPENSE OF REPLACING ANY THAT MAY BE DISTURBED WITHOUT PERMISSION. REPLACEMENT SHALL BE DONE ONLY BY THE FIELD ENGINEER. WHEN A CHANGE IS MADE IN THE FINISHED ELEVATION OF THE PAVEMENT OF ANY ROADWAY IN WHICH A PERMANENT SURVEY MONUMENT IS LOCATED, CONTRACTOR SHALL, AT HIS OWN EXPENSE, ADJUST THE MONUMENT COVER TO THE NEW GRADE UNLESS OTHERWISE SPECIFIED. REFER TO SECTION 4.4 OF THE GENERAL CONDITIONS OF THE STANDARD SPECIFICATIONS.	11	ALL GAS VALVES, GAS MANHOLES, ELECTRICAL MANHOLES, TELEPHONE MANHOLES, CATV BOXES AND UTILITY POLES WILL BE ADJUSTED TO POSITION AND GRADE BY EACH UTILITY COMPANY. CONTRACTOR SHALL CONTACT EACH AFFECTED UTILITY COMPANY A MINIMUM OF ONE WEEK PRIOR TO WHEN THE WORK NEEDS TO BE DONE.
3	THE SPECIFICATIONS USED FOR THIS PROJECT ARE THE CITY OF ALBUQUERQUE STANDARD SPECIFICATIONS FOR PUBLIC WORKS CONSTRUCTION, 1986 EDITION.	12	THE EXISTING CURB AND GUTTER IS NOT TO BE DISTURBED DURING CONSTRUCTION. THE CONTRACTOR SHALL BE RESPONSIBLE FOR THE REPLACEMENT OF ANY CURB AND GUTTER DISTURBED DURING CONSTRUCTION AT HIS OWN EXPENSE.
4	DISPOSAL OF ALL WASTE MATERIALS SHALL BE IN CITY-APPROVED WASTE AREAS SECURED BY AND AT THE EXPENSE OF THE CONTRACTOR.	13	THE CONTRACTOR SHALL NOTIFY THE UTILITY COMPANIES BY CALLING NEW MEXICO ONE CALL SYSTEM 280-1990 TWO (2) WORKING DAYS PRIOR TO COMMENCING WORK IN AREAS NEAR UNDERGROUND UTILITY LINES.
5	SUBGRADE PREPARATION UNDER SIDEWALKS AND DRIVE PADS AND GRADING REQUIRED BETWEEN NEW SIDEWALK OR RETAINING WALL AND RW SHALL BE CONSIDERED INCIDENTAL TO THE CONSTRUCTION OF THE NEW SIDEWALK, AND NO SEPARATE PAYMENT SHALL BE MADE FOR THOSE ITEMS OF WORK.	14	CONTRACTOR SHALL NOT PAVE OVER ANY SURFACE FEATURE, I.E., GAS VALVE, MANHOLE COVER, ETC. WITHOUT PRIOR APPROVAL FROM THE FIELD ENGINEER.
6	THE CONTRACTOR IS TO EXERCISE CARE WHEN REMOVING EXISTING PAVEMENT TO AVOID DISTURBING ANY EXISTING UNDERGROUND UTILITIES. IT SHALL BE HIS RESPONSIBILITY TO COORDINATE WITH THE UTILITY COMPANIES IN ORDER TO PREVENT ANY SERVICE DISRUPTION. SEE SECTION 18 "UTILITIES," CITY OF ALBUQUERQUE, STANDARD SPECIFICATIONS FOR CONTRACTOR REQUIREMENTS.	15	CONTRACTOR SHALL CONFINES HIS WORK TO WITHIN THE CONSTRUCTION LIMIT AND/OR RIGHT-OF-WAY UNLESS OTHERWISE NOTED ON THE PLANS.
7	THE WATER SYSTEMS DIVISION (857-8200) SHALL BE NOTIFIED THREE (3) WORKING DAYS IN ADVANCE OF ANY WORK WHICH MAY AFFECT THE EXISTING PUBLIC WATER FACILITIES. REFER TO SECTION 18 OF THE GENERAL CONDITIONS OF THE STANDARD SPECIFICATIONS.	16	THE USE OF VIBRATORY ROLLERS ON THIS PROJECT IS PROHIBITED UNLESS APPROVED BY THE FIELD ENGINEER.
8	ALL EXCAVATION SHALL BE GOVERNED BY FEDERAL, STATE AND LOCAL LAWS, RULES, AND REGULATIONS CONCERNING CONSTRUCTION SAFETY AND HEALTH.	17	THE CONTRACTOR SHALL COMPLY WITH TRAFFIC CONTROL SPECIFICATIONS PER SECTION 19, CITY OF ALBUQUERQUE STANDARD SPECIFICATIONS.
9	ALL SIGNS AND CODING WILL BE IN ACCORDANCE WITH THE "MANUAL OF UNIFORM TRAFFIC CONTROL DEVICES FOR STREETS AND HIGHWAYS" CURRENT EDITION PUBLISHED BY THE U.S. DEPARTMENT OF TRANSPORTATION.	18	SHUT-OFF OF WATER VALVES IF REQUIRED IS TO BE PERFORMED BY THE COA WATER SYSTEMS DIVISION (857-8200).
		19	ALL WATER VALVES AND FIRE HYDRANTS REMOVED TO BE SALVAGED AND RETURNED TO THE C.O.A.
		20	THE CONTRACTOR SHALL MAINTAIN WATER AND SEWER SERVICE DURING CONSTRUCTION.
		* 21	NEW SIDEWALKS ON ASPEN & ALL W/C RAMPS SHALL BE 4" THICK. SIDEWALKS AND DRIVEPADS ON 19TH, 20TH, 21ST, 22ND & 23RD SHALL BE 6" THICK
		22	PAVE AROUND ALL OBSTRUCTIONS IN NEW SIDEWALK PER COA DWG. 2431

- * 10 THE CONTRACTOR IS TO CONSTRUCT THE IMPROVEMENTS ON EACH STREET IN THE FOLLOWING ORDER. 1) DRIVEPADS, 2) SIDEWALKS, 3) TRANSITIONS, 4) RETAINING WALLS, 5) MISC. ITEMS.
- 11 ALL GAS VALVES, GAS MANHOLES, ELECTRICAL MANHOLES, TELEPHONE MANHOLES, CATV BOXES AND UTILITY POLES WILL BE ADJUSTED TO RITON AND GRADE BY EACH UTILITY COMPANY. CONTRACTOR SHALL CONTACT EACH AFFECTED UTILITY COMPANY A MINIMUM OF ONE WEEK PRIOR TO WHEN THE WORK NEEDS TO BE DONE.
- 12 THE EXISTING CURB AND GUTTER IS NOT TO BE DISTURBED DURING CONSTRUCTION. THE CONTRACTOR SHALL BE RESPONSIBLE FOR THE REPLACEMENT OF ANY CURB AND GUTTER DISTURBED DURING CONSTRUCTION AT HIS OWN EXPENSE.
- 13 THE CONTRACTOR SHALL NOTIFY THE UTILITY COMPANIES BY CALLING NEW MEXICO ONE CALL SYSTEM 280-1990 TWO (2) WORKING DAYS PRIOR TO COMMENCING WORK IN AREAS NEAR UNDERGROUND UTILITY LINES.
- 14 CONTRACTOR SHALL NOT PAVE OVER ANY SURFACE FEATURE, I.E., GAS VALVE, MANHOLE COVER, ETC. WITHOUT PRIOR APPROVAL FROM THE FIELD ENGINEER.
- 15 CONTRACTOR SHALL CONFINE HIS WORK TO WITHIN THE CONSTRUCTION LIMIT AND/OR RIGHT-OF-WAY UNLESS OTHERWISE NOTED ON THE PLANS.
- 16 THE USE OF VIBRATORY ROLLERS ON THIS PROJECT IS PROHIBITED UNLESS APPROVED BY THE FIELD ENGINEER.
- 17 THE CONTRACTOR SHALL COMPLY WITH TRAFFIC CONTROL SPECIFICATIONS PER SECTION 19, CITY OF ALBUQUERQUE STANDARD SPECIFICATIONS.
- 18 SHUT-OFF OF WATER VALVES IF REQUIRED IS TO BE PERFORMED BY THE COA WATER SYSTEMS DIVISION (857-8200).
- 19 ALL WATER VALVES AND FIRE HYDRANTS REMOVED TO BE SALVAGED AND RETURNED TO THE C.O.A.
- 20 THE CONTRACTOR SHALL MAINTAIN WATER AND SEWER SERVICE DURING CONSTRUCTION.
- * 21 NEW SIDEWALKS ON ASPEN & ALL W/C RAMPS SHALL BE 4" THICK. SIDEWALKS AND DRIVEPADS ON 14TH, 20TH, 21ST, 22ND & 23RD SHALL BE 6" THICK.
- 22 PAVE AROUND ALL OBSTRUCTIONS IN NEW SIDEWALK PER COA DWG. 2431

AS BUILT INFORMATION	
CONTRACTOR	M.C.C. Inc.
WORK ORDER NO.	
INSPECTED BY	N/A
DATE	
ACCEPTANCE BY	L. Romero
DATE	1/26
FIELD VERIFICATION BY	
CORRECTED BY	
MICRO-FILM INFORMATION	
RECORDED BY	
DATE	
NO.	

BENCH MARKS

SURVEY INFORMATION

ENGINEER'S SEAL

--	--	--	--	--

ERQUE
ARTMENT
ROUP

MENTS

APPROVALS	ENGINEER	DATE
	<i>HLA</i>	9-4-91
WATER	<i>ALO</i>	"

SHEET 2 OF 5

PROJECT NO 88-01-04A

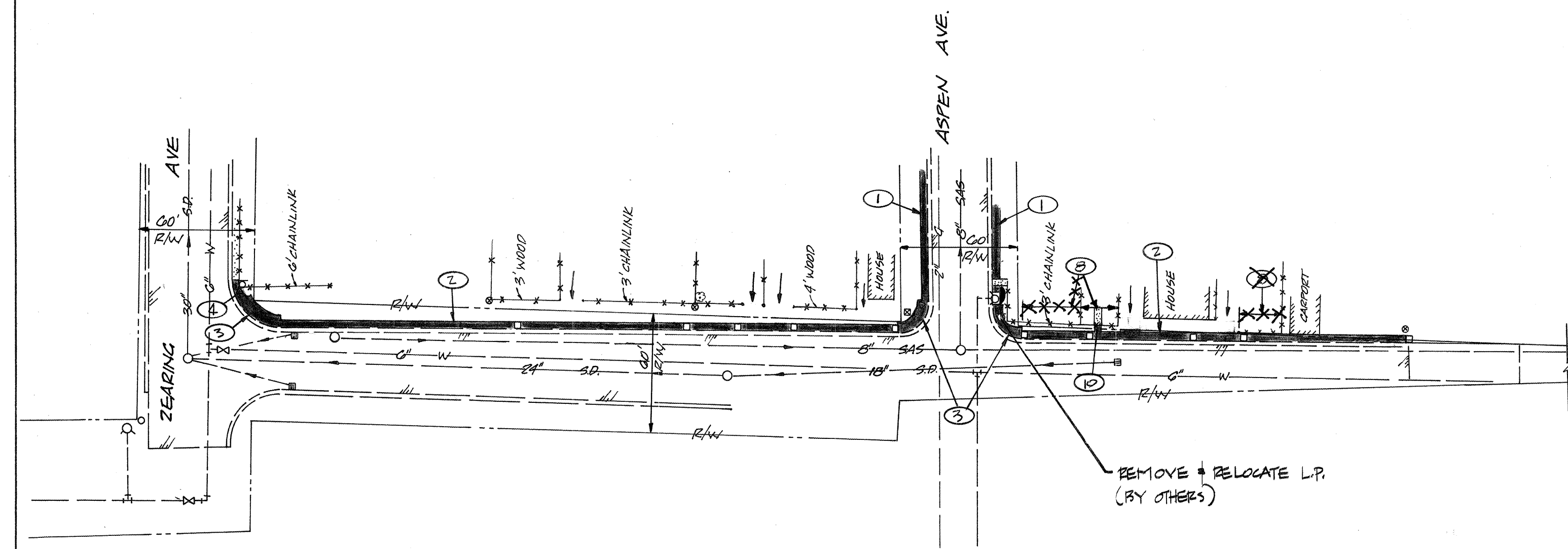

19TH STREET

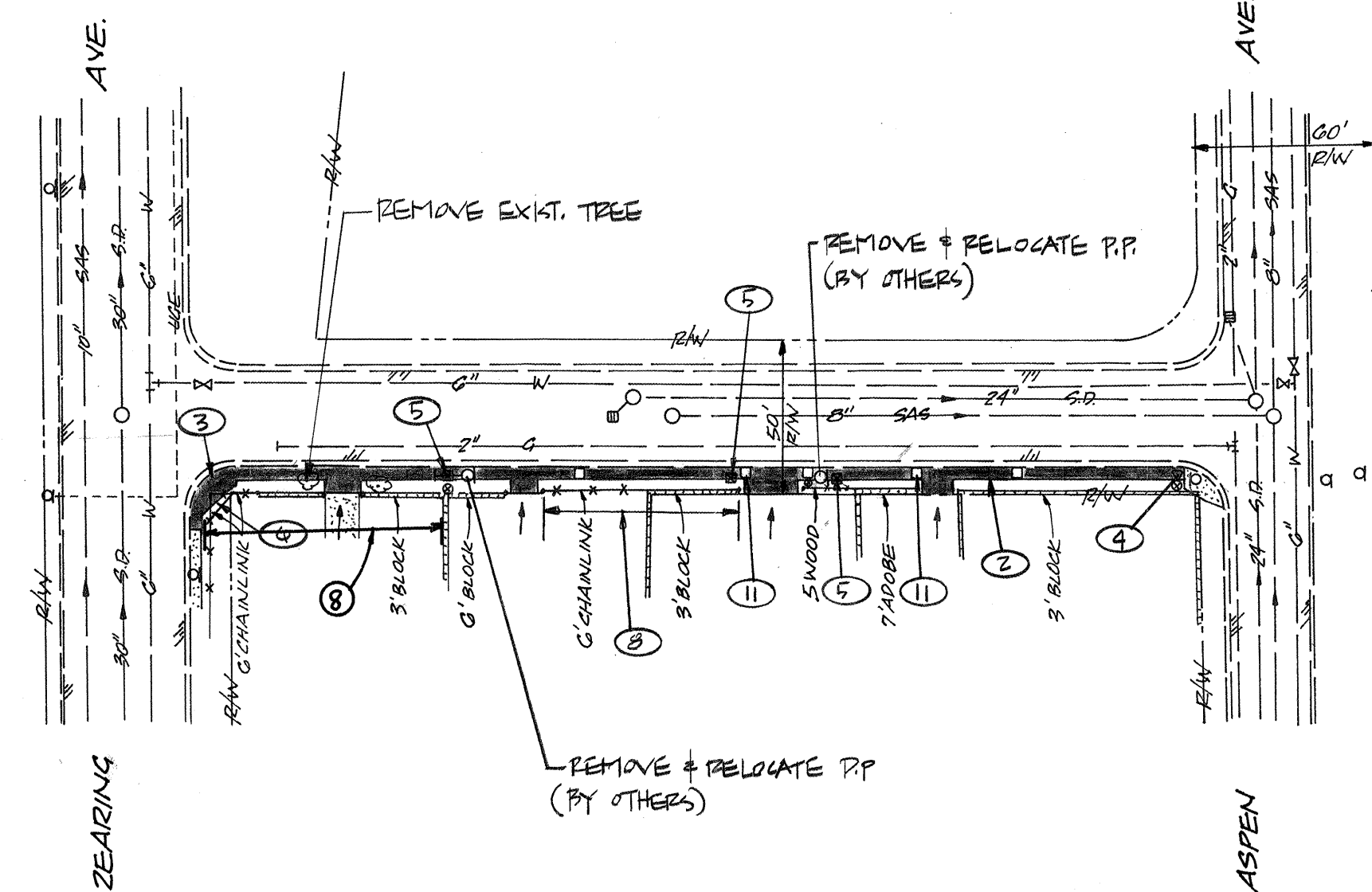

23RD STREET

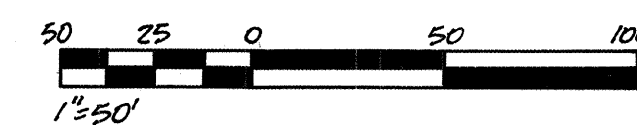

KEYED NOTES

- 1 CONSTRUCT 4' SIDEWALK (4" THICK)
COA DWG. 2430.
- 2 CONSTRUCT 4' SIDEWALK (6" THICK)
SEE DETAIL A/5.
- 3 CONSTRUCT WHEELCHAIR RAMP
(CASE II)
IN EXIST. DEPRESSED CURB.
- 4 REMOVE AND RELOCATE EXIST. SIGN TO
BACK OF NEW SIDEWALK. (BY COA).
- 5 REMOVE AND RELOCATE EXIST.
MAILBOX TO BACK OF NEW SIDEWALK.
- 6 REMOVE AND RELOCATE EXIST. FENCE
AS REQUIRED TO BACK OF NEW
SIDEWALK AND/OR WHEEL CHAIR RAMP.
- 7 EXIST. CATV BOX TO BE RELOCATED
TO BACK OF NEW SIDEWALK BY JONES
INTERABLE.
- 8 CONSTRUCT RETAINING WALL.
SEE DETAIL C/5.
- 9 REMOVE AND DISPOSE OF EXIST. TREE.
AND PLANT NEW 2 1/2" CAL. TREE 2 BACK S/W
- 10 CONSTRUCT CONCRETE STEPS
AS REQUIRED. SEE DETAIL D/5
- 11 ADJUST WATER METER TO GRADE.
- 12 TRANSITION SIDEWALK PER
COA DWG. 2432.
- 13 SAWCUT EXIST. CURB, REMOVE
EXIST. S/W AS REQD + CONSTRUCT
W/C RAMP (CASE II)

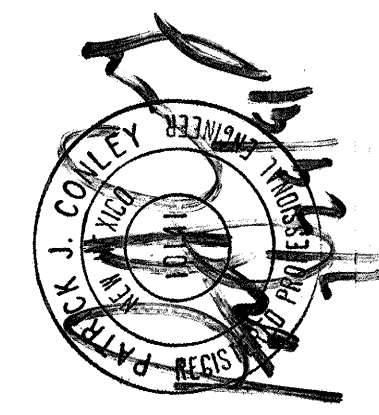
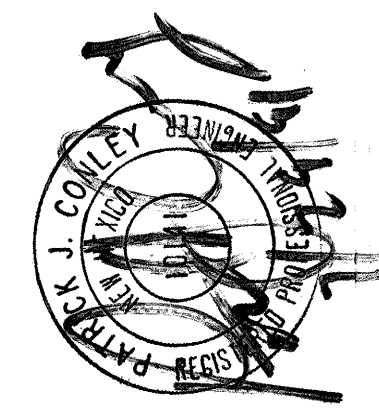
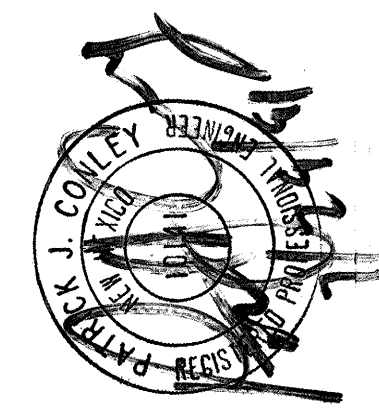
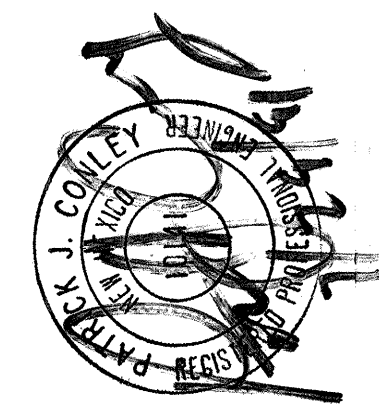
AS BUILT INFORMATION		BENCH MARKS		SURVEY INFORMATION		ENGINEER'S SEAL		REVISIONS		DESIGN	
CONTRACTOR	M.C.C. Inc.	NO.	DATE	NO.	DATE			NO.	DATE	REMARKS	BY
INSPECTOR'S	N/A	10253	GEORGE MARQUEZ JR 9/91	10253	GEORGE MARQUEZ JR 9/91						
FIELD ENGINEER	DATE	DATE	DATE	DATE	DATE			NO.	DATE	REMARKS	BY
FIELD ENGINEER	DATE	DATE	DATE	DATE	DATE						
VERIFICATION BY	DATE	DATE	DATE	DATE	DATE			NO.	DATE	REMARKS	BY
VERIFICATION BY	DATE	DATE	DATE	DATE	DATE						
RECORDED BY	DATE	DATE	DATE	DATE	DATE			NO.	DATE	REMARKS	BY
RECORDED BY	DATE	DATE	DATE	DATE	DATE						

PROJECT NO. 89-01-04A

S-SEC

Smith-Scheuch
Engineering Company

Albuquerque, New Mexico

CITY OF ALBUQUERQUE
PUBLIC WORKS DEPARTMENT
ENGINEERING GROUP

TITLE: SAWMILL AREA SIDEWALK IMPROVEMENTS

19TH, 20TH & 23RD STREET

APPROVALS	ENGINEER	DATE	APPROVALS	ENGINEER	DATE
DRC CHAIRMAN	Roger Roca	9-17-91	WATER	ALC	9-4-91
TRANSPORTATION	ALC	9-16-91	WASTEWATER	ALC	"
HYDROLOGY	ALC	9-12-91			

PROJECT NO.	4154.91	MAP NO.	H-13	SHEET	3	OF	5
-------------	---------	---------	------	-------	---	----	---

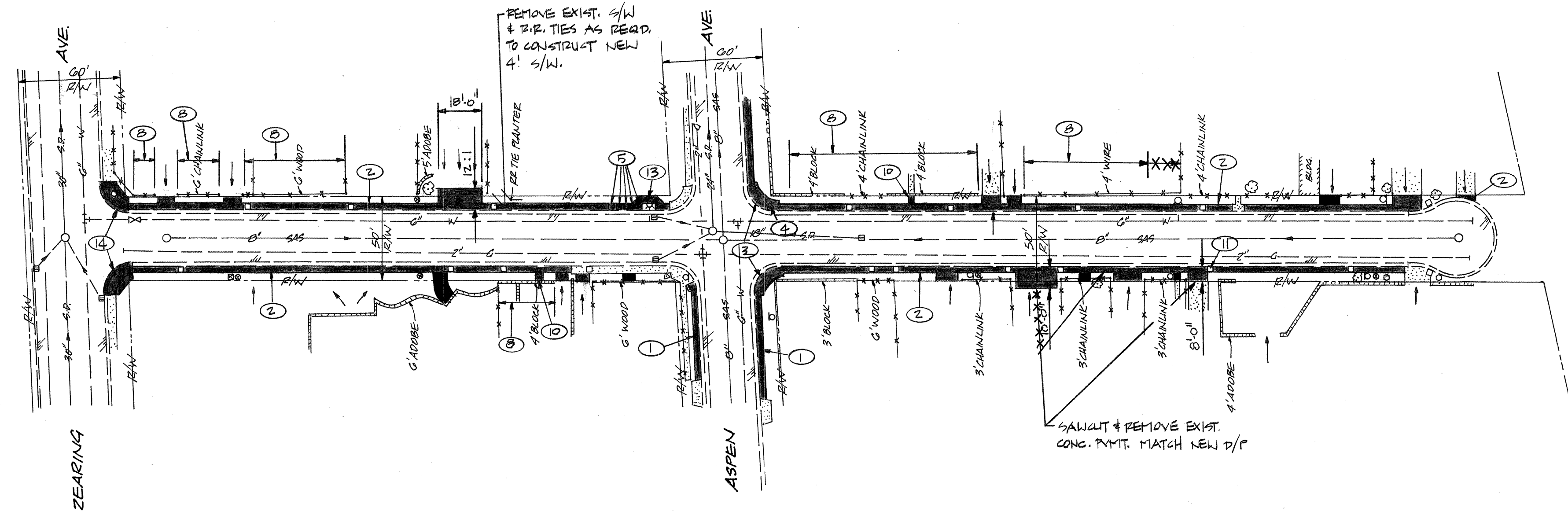

21ST STREET

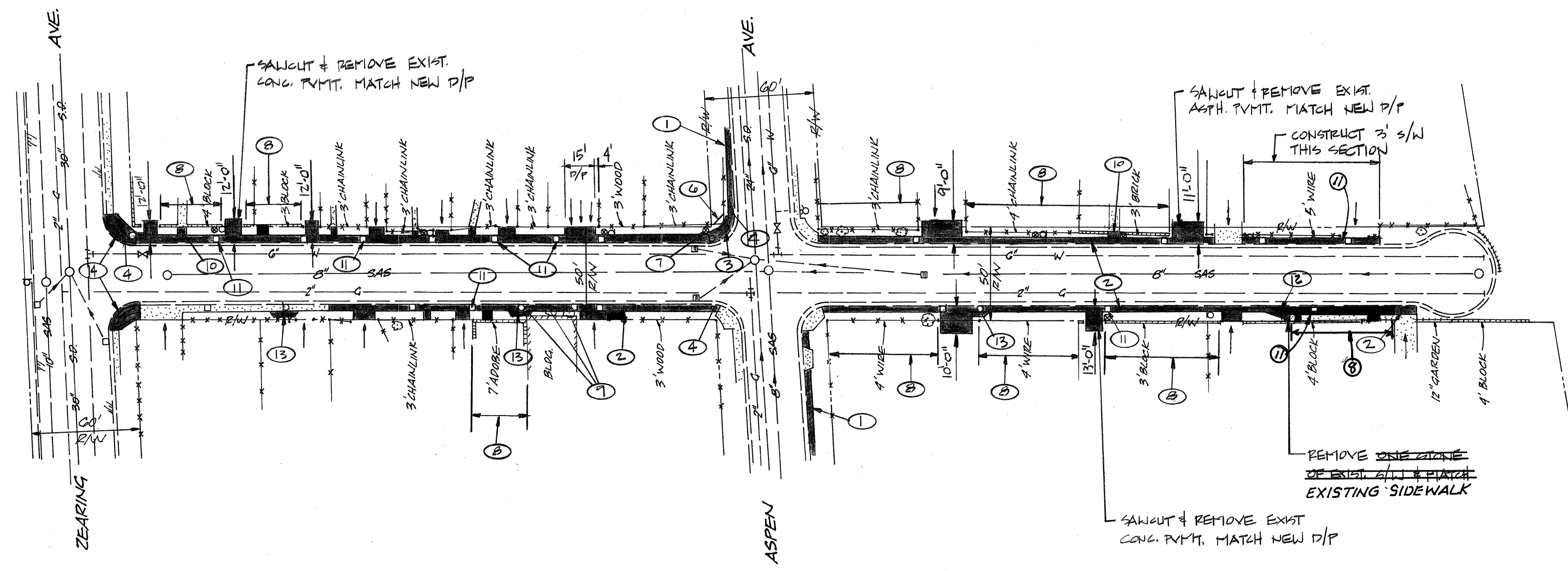

22ND STREET

KEYED NOTES

- CONSTRUCT 4' SIDEWALK (4" THICK) COA DWG. 2430.
- CONSTRUCT 4' SIDEWALK (6" THICK) SEE DETAIL A/5.
- CONSTRUCT WHEELCHAIR RAMP (CASE II) IN EXIST. DEPRESSED CURB.
- REMOVE AND RELOCATE EXIST. SIGN TO BACK OF NEW SIDEWALK. (BY COA).
- REMOVE AND RELOCATE EXIST. MAILBOX TO BACK OF NEW SIDEWALK.
- REMOVE AND RELOCATE EXIST. FENCE AS REQUIRED TO BACK OF NEW SIDEWALK AND/OR WHEEL CHAIR RAMP.
- EXIST. CATV BOX TO BE RELOCATED TO BACK OF NEW SIDEWALK BY JONES INTERCABLE.
- CONSTRUCT RETAINING WALL. SEE DETAIL C/5.
- REMOVE AND DISPOSE OF EXIST. TREE.
- CONSTRUCT CONCRETE STEPS AS REQUIRED. SEE DETAIL D/5.
- ADJUST WATER METER TO GRADE.
- TRANSITION SIDEWALK PER COA DWG. 2432.
- CONSTRUCT SIDEWALK PER COA DWG. 2431.
- SALVAGE EXIST. CURBS, REMOVE EXIST. S/W AS REQ'D & CONSTRUCT W/C RAMP (CASE II) PER COA DWG. 2441.

ENGINEER'S SEAL		SURVEY INFORMATION		BENCH MARKS		AS BUILT INFORMATION	
		NO.	BY	DATE	NO.	DATE	CONTRACTOR
		10293	GEORGE MARQUEZ JR.	6/91			M.C.C. INC.
REVISIONS		REMARKS		BY		DATE	
DESIGN		DESIGN		BY		DATE	
CHECKED BY P/C		CHECKED BY P/C		DATE 7/91		DATE 7/91	
DRAWN BY DA		DRAWN BY DA		DATE 7/91		DATE 7/91	
DESIGNED BY DA/P/C		DESIGNED BY DA/P/C		DATE 7/91		DATE 7/91	

S-SEC Smith-Scheuch Engineering Company
Abuquerque, New Mexico

CITY OF ALBUQUERQUE PUBLIC WORKS DEPARTMENT ENGINEERING GROUP					
TITLE: SAWMILL AREA SIDEWALK IMPROVEMENTS					
21ST & 22ND STREET					
APPROVALS	ENGINEER	DATE	APPROVALS	ENGINEER	DATE
DRC CHAIRMAN	<i>Ronald Rios</i>	9-17-91	WATER	<i>ALD</i>	9-4-91
TRANSPORTATION	<i>Alfonso</i>	9-16-91	WASTEWATER	<i>ALD</i>	
HYDROLOGY	<i>Alfonso</i>	9/12/91			
PROJECT NO. 4154.91		MAP NO. H-13		SHEET 4 OF 5	