

RECORD DRAWING

THE UNDERSIGNED DOES HEREBY CERTIFY THAT THIS DRAWING WAS REVISED IN ACCORDANCE WITH INFORMATION FURNISHED BY CONDORE CONSTRUCTION (CONTRACTOR), THE CITY OF ALBUQUERQUE, (CONSTRUCTION ENGINEER), AND GREINER (DESIGN ENGINEER) TO REFLECT THE REPORTED LOCATION OF THE WORK AS ACTUALLY ACCOMPLISHED.

Richard Peña
GREINER, INC.
REGISTERED PROFESSIONAL ENGINEER
N.E.W. MEXICO
#10505
10-13-93
DATE

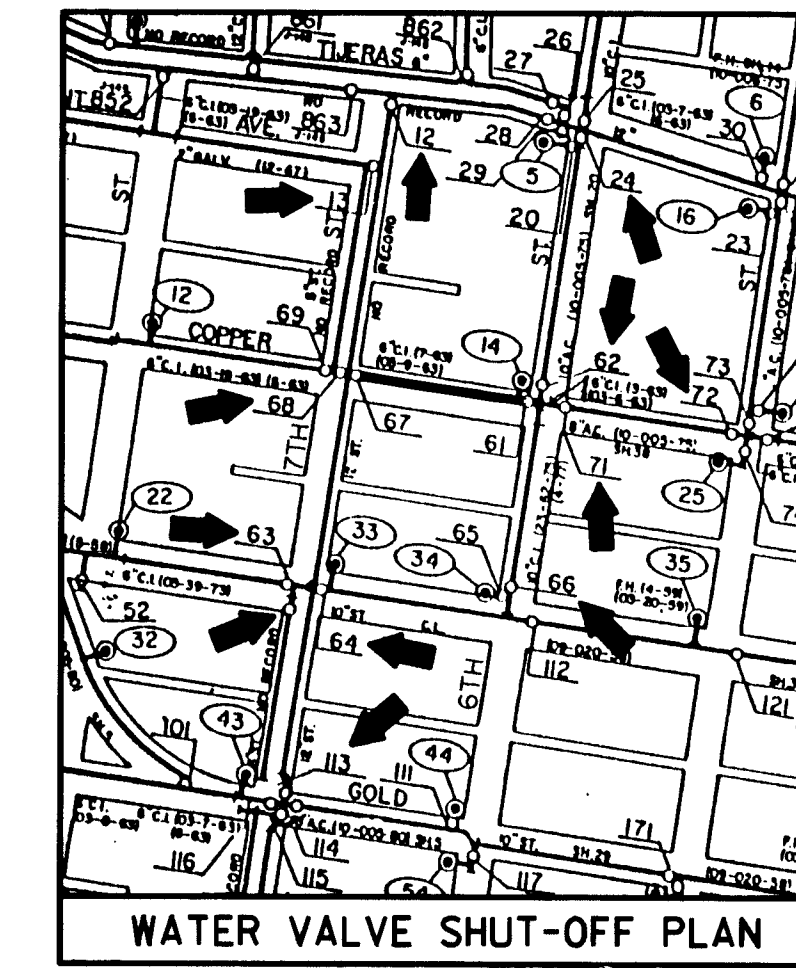

COPPER AVE. - 6TH ST. TO 7TH ST.

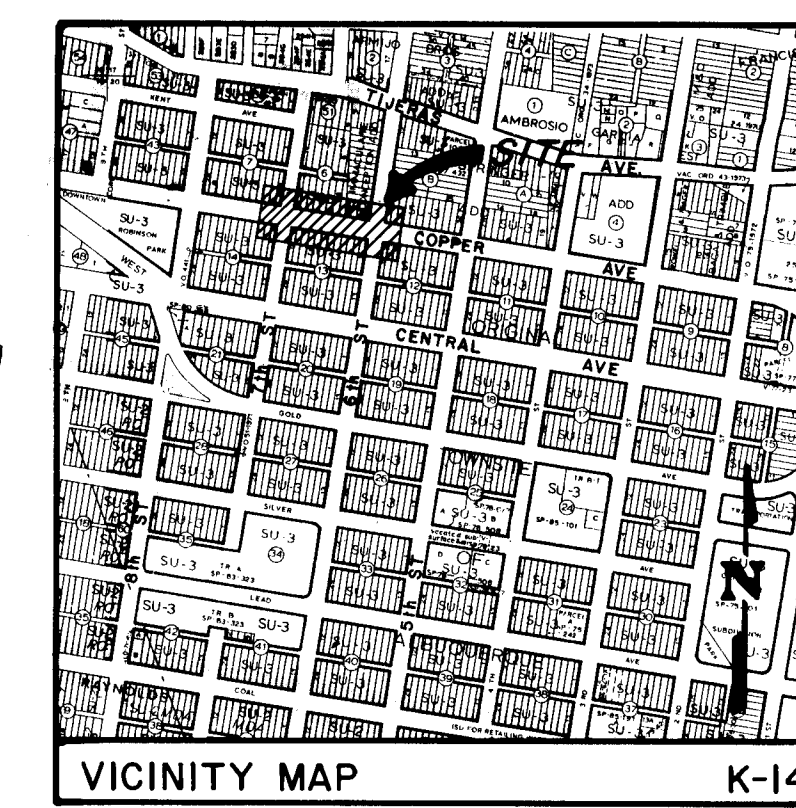

SCALE
1"=50' HORIZ.
1"=5' VERT.

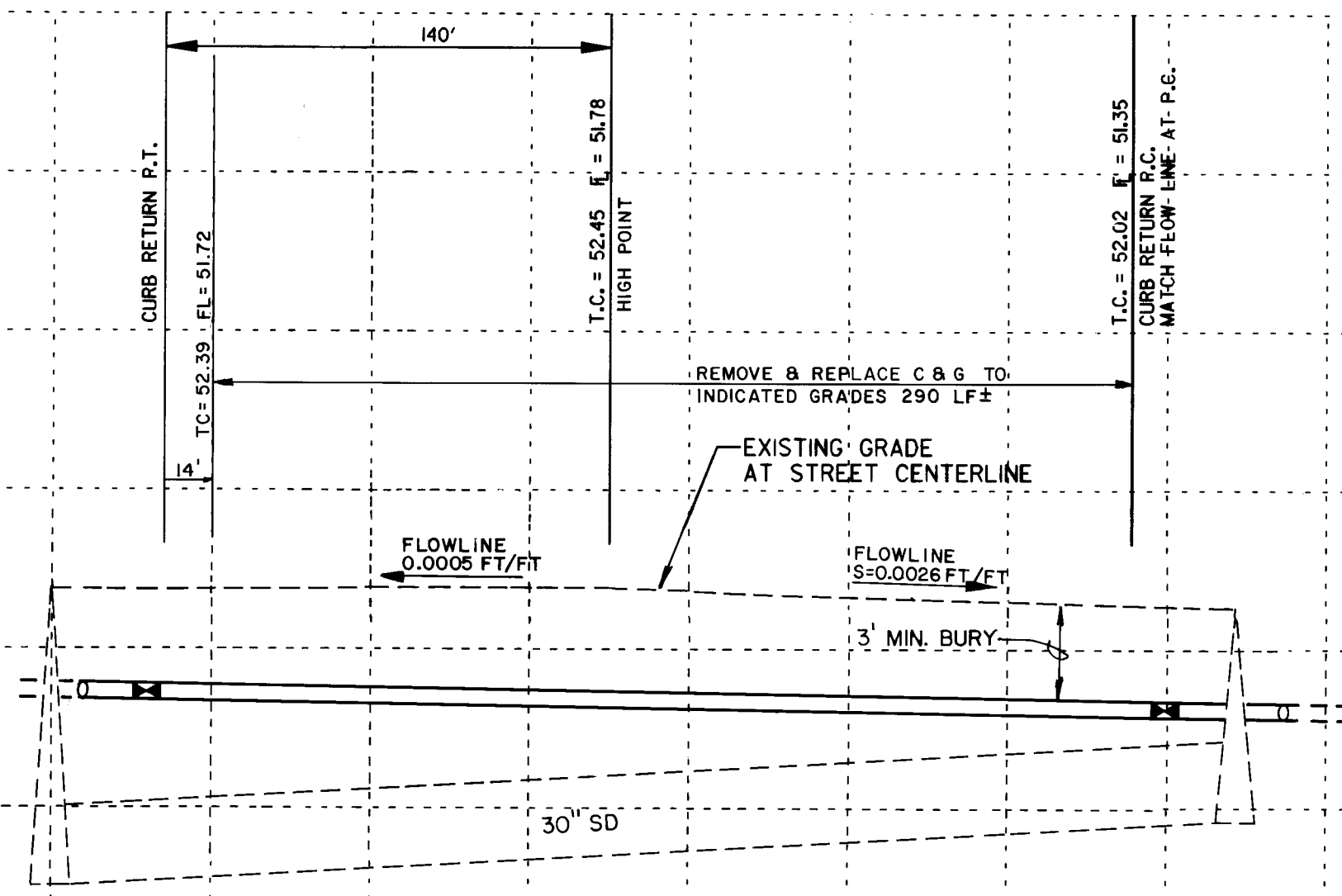

1 2 3 4 5 6 7 8 9 10 11 12 13 14 15
26 43 24 91 01 94

SCANNED BY
BY LASON

GENERAL NOTES

- INCORPORATE THIS SHEET INTO CITY PROJECT NO. 4559.90 - PUBLIC WORKS CONTRACT 93-1.
- DELETED
- VERIFY GAS LINE DEPTH BEFORE CROSSING WITH NEW WATER MAIN PRIOR TO CONNECTIONS.
- RE-ESTABLISH VEGETATION BEHIND BACK OF CURB AND TRANSITION TO NEW TOP OF CURB.
- TRANSITION NEW TOP OF CURB INTO EXISTING TOP OF CURB AT DRIVEWAY AND CURB RETURN.
- ALL WORK DETAILED ON THESE DRAWINGS TO BE PERFORMED UNDER THIS CONTRACT SHALL, EXCEPT AS OTHERWISE STATED, BE CONSTRUCTED IN ACCORDANCE WITH THE CITY OF ALBUQUERQUE STANDARD SPECIFICATIONS FOR PUBLIC WORKS CONSTRUCTION, 1986, HEREBY REFERRED AS THE SPECIFICATIONS. REFERENCES MADE TO STANDARD DRAWINGS IMPLY THAT SECTION OF THE SPECIFICATIONS WHICH INCLUDES MISCELLANEOUS STANDARD DETAILS.
- TWO (2) WORKING DAYS PRIOR TO ANY EXCAVATION, CONTRACTOR MUST CONTACT NEW MEXICO ONE-CALL SYSTEM, INC., 260-1990, FOR LOCATION OF EXISTING UTILITIES.
- PRIOR TO CONSTRUCTION, THE CONTRACTOR SHALL EXCAVATE AND VERIFY THE HORIZONTAL AND VERTICAL LOCATIONS OF ALL OBSTRUCTIONS. SHOULD A CONFLICT EXIST, THE CONTRACTOR SHALL NOTIFY THE ENGINEER SO THAT THE CONFLICT CAN BE RESOLVED WITH MINIMUM AMOUNT OF DELAY.
- ALL WORK ON THIS PROJECT SHALL BE PERFORMED IN ACCORDANCE WITH APPLICABLE FEDERAL, STATE, AND LOCAL LAWS, RULES, AND REGULATIONS CONCERNING CONSTRUCTION SAFETY AND HEALTH.
- RESTRAINED JOINTS SHALL BE UTILIZED FOR REPLACEMENT WATER LINES. CONCRETE BLOCKING SHALL NOT BE UTILIZED EXCEPT WHERE SPECIFICALLY AUTHORIZED BY THE ENGINEER.

CAUTION!
NOTE THAT ALL EXISTING UTILITIES MAY NOT BE SHOWN HEREON AND THAT ANY EXISTING UTILITIES THAT ARE SHOWN ARE IN "APPROXIMATE LOCATION ONLY". IT SHALL BE THE SOLE RESPONSIBILITY OF THE CONTRACTOR TO CONTACT ALL THE UTILITY OWNERS AND TO CONDUCT ALL NECESSARY FIELD INVESTIGATIONS PRIOR TO ANY EXCAVATION TO DETERMINE THE ACTUAL LOCATIONS OF UTILITIES AND OTHER IMPROVEMENTS.

APPROVAL OF AS BUILT DRAWINGS
CHIEF CONSTRUCTION ENGINEER
DATE 5/20/94

APPROVED FOR
CONSTRUCTION
CITY ENGINEER
DATE 5/13/93

Greiner, Inc.

CITY OF ALBUQUERQUE PUBLIC WORKS DEPARTMENT ENGINEERING GROUP					
TITLE: PUBLIC WORKS CONTRACT 93-1 COPPER AVE. (WATER)					
APPROVALS	ENGINEER	DATE	APPROVALS	ENGINEER	DATE
DRC Chairman	<i>S. J. Baldry</i>	5-14-93	Water	<i>William Balch</i>	5-3-93
Transportation	<i>R. Peña</i>	5-03-93	Waste Water	<i>William Balch</i>	5-3-93
Hydrology	<i>J. Ripley</i>	5/3/93			
DESIGNED BY: R. PEÑA		DATE: 1-93			
DRAWN BY: J. RIPLEY		DATE: 1-93			
CHECKED BY: M. HOLSTAD		DATE: 3-93			
DRAWING NO.	4324.91	MAP NO.	K-14N	SHEET	OF

AS BUILT INFORMATION		BENCH MARKS		SURVEY INFORMATION	
CONTRACTOR CONDORE	DATE 7-93	C.O.A. 1-K14, SW CORNER 6TH/COPPER	NO.	BY	DATE
WORK STAKED BY CITY SURVEY			41	HAIRKEN/KERR/FISCHER	2-1-93
INSPECTOR BY C. SPENCE	DATE 9-93	ELEV. = 4952.291			
FIELD ADJUSTED BY R. PEÑA	DATE 10-93				
CORRECTED BY R. PEÑA					
MICRO-FILM INFORMATION					
RECORDED BY					
DATE					