

# LAURELWOOD PARK

## CITY PROJECT NO. 4550.90

NOTE: THIS PROJECT IS DESIGNATED FOR CLASS II CONSTRUCTION

### LANDSCAPE PLANS INDEX

SHEET	DESCRIPTION
1	TITLE SHEET
2	GENERAL NOTES
3	GRADING PLAN
4	CONSTRUCTION LAYOUT PLAN
5	PLANTING PLAN
6	IRRIGATION PLAN
7	PLAY AREA ENLARGEMENT
8	CONSTRUCTION DETAILS
9	LANDSCAPE IRRIGATION DETAILS

#### CONSTRUCTION NOTES:

- ALL WORK DETAILED ON THESE PLANS AND PERFORMED UNDER THIS CONTRACT SHALL BE CONSTRUCTED IN ACCORDANCE WITH THE STATE OF NEW MEXICO STANDARD SPECIFICATIONS FOR PUBLIC WORKS CONSTRUCTION, LATEST EDITION, AND THROUGH UPDATE #6.
- THE CONTRACTOR SHALL ABIDE BY ALL LOCAL, STATE, AND FEDERAL LAWS, RULES AND REGULATIONS WHICH APPLY TO THE CONSTRUCTION OF THESE IMPROVEMENTS.
- PRIOR TO CONSTRUCTION, THE CONTRACTOR SHALL EXCAVATE AND VERIFY THE HORIZONTAL AND VERTICAL LOCATIONS OF ALL POTENTIAL OBSTRUCTIONS. SHOULD A CONFLICT EXIST, THE CONTRACTOR SHALL NOTIFY THE CONSTRUCTION OBSERVER SO THAT THE CONFLICT CAN BE RESOLVED WITH A MINIMUM AMOUNT OF DELAY.
- TWO (2) WORKING DAYS PRIOR TO ANY EXCAVATION, THE CONTRACTOR SHALL CONTACT LINE LOCATING SERVICE FOR LOCATION OF EXISTING UTILITIES.
- ALL ELECTRICAL, TELEPHONE, CABLE TV, GAS AND OTHER UTILITY LINES, CABLES, AND APPURTENANCES ENCOUNTERED DURING CONSTRUCTION THAT REQUIRE RELOCATION, SHALL BE COORDINATED WITH THAT UTILITY. THE CONTRACTOR SHALL BE RESPONSIBLE FOR COORDINATION OF ALL NECESSARY UTILITY ADJUSTMENTS. NO ADDITIONAL COMPENSATION WILL BE ALLOWED FOR DELAYS OR INCONVENIENCES CAUSED BY UTILITY COMPANY WORK CREWS. THE CONTRACTOR MAY BE REQUIRED TO RESCHEDULE HIS ACTIVITIES TO ALLOW UTILITY CREWS TO PERFORM THEIR REQUIRED WORK.
- A DISPOSAL SITE FOR ALL EXCESS EXCAVATION MATERIAL, AND UNSUITABLE MATERIAL SHALL BE OBTAINED BY THE CONTRACTOR IN COMPLIANCE WITH APPLICABLE ENVIRONMENTAL REGULATIONS AND APPROVED BY THE CONSTRUCTION OBSERVER. ALL COSTS INCURRED IN OBTAINING A DISPOSAL SITE AND HAUL THERETO SHALL BE CONSIDERED INCIDENTAL TO THE PROJECT AND NO SEPARATE MEASUREMENT OR PAYMENT SHALL BE MADE.
- THE CONTRACTOR IS RESPONSIBLE FOR PROTECTING THE EXISTING UTILITY LINES WITHIN THE CONSTRUCTION AREA. ANY DAMAGE TO EXISTING FACILITIES CAUSED BY CONSTRUCTION ACTIVITY SHALL BE REPAIRED OR REPLACED AT THE CONTRACTOR'S EXPENSE AND APPROVED BY THE CONSTRUCTION OBSERVER.
- OVERNIGHT PARKING OF CONSTRUCTION EQUIPMENT SHALL NOT OBSTRUCT DRIVEWAYS OR DESIGNATED TRAFFIC LANES. THE CONTRACTOR SHALL NOT STORE ANY EQUIPMENT OR MATERIAL WITHIN THE PUBLIC RIGHT-OF WAY.
- THE CONTRACTOR SHALL OBTAIN ALL THE NECESSARY PERMITS FOR THE PROJECT PRIOR TO COMMENCING CONSTRUCTION (I.E. BARRICADING, TOPSOIL DISTURBANCE AND EXCAVATION PERMITS, ETC.)
- THE CONTRACTOR SHALL BE RESPONSIBLE TO REPLACE AT HIS EXPENSE ANY AND ALL PROPERTY CORNERS DESTROYED DURING CONSTRUCTION. ALL PROPERTY CORNERS MUST BE RESET BY A REGISTERED LAND SURVEYOR.
- ALL PERMANENT PAVEMENT MARKING AND TRAFFIC SIGNING SHALL BE FURNISHED AND INSTALLED BY THE CONTRACTOR PER PLAN.
- THE CONTRACTOR SHALL PREPARE A CONSTRUCTION TRAFFIC CONTROL AND SIGNING PLAN AND OBTAIN APPROVAL OF SUCH PLAN FROM THE CITY OF ALBUQUERQUE, TRAFFIC ENGINEERING DEPARTMENT, PRIOR TO BEGINNING ANY CONSTRUCTION WORK ON OR ADJACENT TO EXISTING STREETS.
- ALL BARRICADES AND CONSTRUCTION SIGNING SHALL CONFORM TO APPLICABLE SECTIONS OF THE "MANUAL ON UNIFORM TRAFFIC CONTROL DEVICES" (MUTCD), U.S. DEPARTMENT OF TRANSPORTATION, LATEST EDITION.
- THE CONTRACTOR SHALL MAINTAIN ALL CONSTRUCTION BARRICADES AND SIGNING AT ALL TIMES. THE CONTRACTOR SHALL VERIFY THE PROPER LOCATION OF ALL BARRICADING AT THE END AND BEGINNING OF EACH DAY.
- ALL SAWCUT PAVEMENT SHALL HAVE A UNIFORM EDGE AND BE SPRAYED WITH TACK.
- WHEN ABUTTING NEW CURB AND GUTTER TO EXISTING PAVEMENT, A 1' WIDE SECTION OF EXISTING PAVEMENT ADJACENT TO THE CURB AND GUTTER SHALL BE SAWCUT, REMOVED, AND REPLACED AS PER THE STANDARD SPECIFICATIONS.

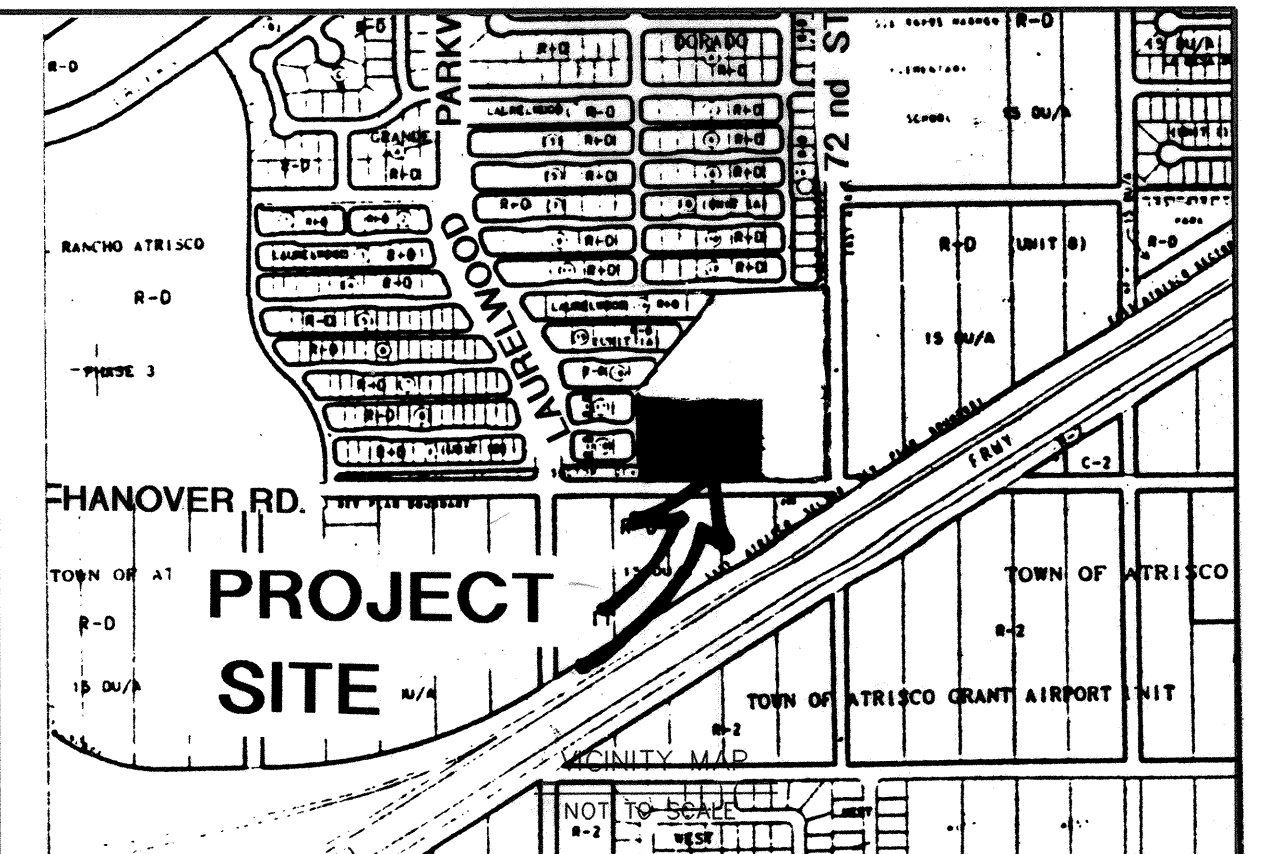

#### NOTICE TO CONTRACTORS

- ALL STREET STRIPING ALTERED OR DESTROYED SHALL BE REPLACED IN KIND BY CONTRACTOR TO LOCATION AND IN KIND AS EXISTING OR AS INDICATED BY THIS PLAN SET.
- CONTRACTOR SHALL NOTIFY THE ENGINEER NOT LESS THAN SEVEN (7) DAYS PRIOR TO STARTING WORK IN ORDER THAT THE CITY SURVEYOR MAY TAKE NECESSARY MEASURES TO INSURE THE PRESERVATION OF SURVEY MONUMENTS. CONTRACTOR SHALL NOT DISTURB PERMANENT SURVEY MONUMENTS WITHOUT THE CONSENT OF THE CITY SURVEYOR AND SHALL NOTIFY THE CITY SURVEYOR AND BEAR THE EXPENSE OF REPLACING ANY THAT MAY BE DISTURBED WITHOUT PERMISSION. REPLACEMENT SHALL BE DONE ONLY BY THE CITY SURVEYOR. WHEN A CHANGE IS MADE IN THE FINISHED ELEVATIONS OF THE PAVEMENT OF ANY ROADWAY IN WHICH A PERMANENT SURVEY MONUMENT IS LOCATED, CONTRACTOR SHALL, AT HIS OWN EXPENSE, ADJUST THE MONUMENT COVER TO THE NEW GRADE UNLESS OTHERWISE SPECIFIED.

#### THE FOLLOWING NOTES ALSO APPLY WHEN CHECKED

- ☒ ALL UTILITIES AND UTILITY SERVICE LINES SHALL BE INSTALLED PRIOR TO PAVING.
- ☐ BACKFILL COMPACTION SHALL BE ACCORDING TO SPECIFIED STREET USE.
- ☐ TACK COAT REQUIREMENTS SHALL BE DETERMINED BY THE CITY ENGINEER.
- ☐ SIDEWALKS AND WHEELCHAIR RAMPS WITHIN THE CURB RETURNS SHALL BE CONSTRUCTED WHEREVER A NEW CURB RETURN IS CONSTRUCTED.
- ☐ IF CURB IS DEPRESSIONED FOR A DRIVEPAD, THE DRIVEPAD SHALL BE CONSTRUCTED PRIOR TO ACCEPTANCE OF CURB AND GUTTER.
- ☒ ALL STORM DRAINAGE FACILITIES SHALL BE COMPLETED PRIOR TO FINAL ACCEPTANCE.
- ☐ THE REQUESTOR OR DEVELOPER SHALL BE RESPONSIBLE FOR REPAIR OR REPLACEMENT OF ALL CURB AND GUTTER OR SIDEWALK DAMAGED AFTER APPROVAL BY THE CITY ENGINEER OF WORK COMPLETED BY THE CONTRACTOR.

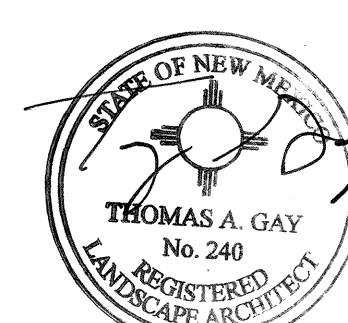
REV.	SHEETS	CITY ENGINEER	DATE	USER DEPARTMENT	DATE	USER DEPARTMENT	DATE
ENGINEERS' STAMP & SIGNATURE		APPROVALS		ENGINEER		DATE	
		DRC Chairman		Sally G. Sandoval		8-23-96	
		Transportation		K. Sandoval		8-23-96	
		Water/Wastewater		K. Sandoval		8-23-96	
		Hydrology		C. Sandoval		8-23-96	
		Parks		C. Sandoval		8-23-96	
Const. Mngmt.							
NMUI							
CITY PROJECT NO.		4550.90		SHEET		OF	
				1		9	



GENERAL NOTES

- 1
- ALL WORK SHALL BE PERFORMED IN ACCORDANCE WITH CITY OF ALBUQUERQUE STANDARD SPECIFICATIONS FOR PUBLIC WORKS CONSTRUCTION AND ALL OTHER APPLICABLE REQUIREMENTS, CODES AND ORDINANCES OF THE CITY OF ALBUQUERQUE AND ANY OTHER GOVERNING BODIES HAVING JURISDICTION.

- 2
- ALL QUANTITIES SHOWN IN PLANT LIST AND IRRIGATION PARTS LIST ARE FOR CONVENIENCE. CONTRACTOR SHALL BE RESPONSIBLE FOR HIS/HER QUANTITY TAKE OFFS. IN SITUATIONS WHERE PLANS CONFLICT WITH QUANTITIES SHOWN IN PLANT LIST OR IRRIGATION PARTS LIST THE QUANTITIES IN THE PLANS SHALL GOVERN.

- 3
- CONTRACTOR SHALL BE FAMILIAR WITH PLANS, DETAILS AND SPECIFICATIONS AS THEY PERTAIN TO THE SITE. IT SHALL BE THE CONTRACTOR'S RESPONSIBILITY TO NOTIFY THE LANDSCAPE ARCHITECT IF ANY ITEMS CONTAINED WITHIN THE SCOPE OF WORK DEFINED HEREIN ARE IN CONFLICT WITH THE PROPOSED CONTRACT.

- 4
- EXISTING UTILITY LINES ARE TO BE BLUE STAKED PRIOR TO ANY EXCAVATION. CHECK AND FIELD VERIFY ALL SITE CONDITIONS, UTILITIES AND SERVICES PRIOR TO EXCAVATION. CALL N.M. ONE CALL AT 260-1990 FOR BLUE STAKING. IF PROBLEMS ARE DISCOVERED, CONTACT OWNER'S REPRESENTATIVE TO DETERMINE A COURSE OF ACTION.

- 5
- CONTRACTOR SHALL PROTECT NEWLY GRADED AREAS FROM TRAFFIC AND EROSION. KEEP AREAS FREE OF TRASH AND DEBRIS. REPAIR AND RE-ESTABLISH GRADES IN SETTLED, ERODED AND RUTTED AREAS AT THE CONCLUSION OF EACH PLANTING SEQUENCE OR AS DIRECTED BY THE OWNERS REPRESENTATIVE.

- 6
- CONTRACTOR SHALL EXERCISE CAUTION WHEN WORKING IN THE VICINITY OF EXISTING CITY FACILITIES. ANY DAMAGED ITEMS SHALL BE REPAIRED OR REPLACED IN KIND, AS DETERMINED BY THE OWNER'S REPRESENTATIVE. REPLACEMENTS SHALL BE AT CONTRACTORS EXPENSE.

PLANTING NOTES

- GENERAL
- 1
- SCOPE: WORK COVERED IN THESE NOTES CONSISTS OF THE PLANTING OF SEED, TREES, SHRUBS AND GROUNDCOVERS, GRADING AND MULCHING, INCLUDING THE FURNISHING OF ALL LABOR, EQUIPMENT, MATERIALS AND PERFORMING ALL WORK IN CONNECTION WITH THE DRAWINGS AND SPECIFICATIONS.

- 2
- CONTRACTOR SHALL BE FAMILIAR WITH PLANS, DETAILS AND SPECIFICATIONS AS THEY PERTAIN TO THE SITE. IT SHALL BE THE CONTRACTORS RESPONSIBILITY TO NOTIFY THE OWNER'S REPRESENTATIVE IF ANY ITEMS CONTAINED WITHIN THE SCOPE OF WORK DEFINED HEREIN, ARE IN CONFLICT WITH PROPOSED CONTRACT.

PROTECTION

- 3
- PROTECTION OF PERSONS AND PROPERTY: CONTRACTOR IS TO BARRICADE OPEN EXCAVATIONS OCCURRING AS PART OF THIS WORK AND POST WITH WARNING LIGHTS OR OTHER WARNING MEASURES AS NECESSARY. PROTECTION OF EXISTING SHRUBS, TREES AND OTHER PLANT MATERIALS ARE ALSO TO BE INCLUDED.

- 4
- PROTECT STRUCTURES, UTILITIES, SIDEWALKS, PAVEMENTS AND OTHER FACILITIES FROM DAMAGE CAUSED BY SETTLEMENT, LATERAL MOVEMENT, UNDERMINING, WASHOUT AND OTHER HAZARDS CREATED BY EARTHWORK OPERATIONS.ALL DAMAGES THAT MAY OCCUR DURING THIS PHASE OF WORK SHALL BE THE CONTRACTORS FINANCIAL RESPONSIBILITY.

GRADING

- 5
- PERFORM GRADING AND EXCAVATION WORK IN COMPLIANCE WITH APPLICABLE SPECIFICATIONS, REQUIREMENTS, CODES AND ORDINANCES OF GOVENING BODIES HAVING JURISDICTION.

- 6
- ROUGH GRADING: ROUGH GRADING SHALL BE PERFORMED TO SPECIFICATIONS BY GENERAL CONTRACTOR. GRADES SHALL BE AS PER THE PLANS, + 2"

- 7
- ALL EARTHWORK SHALL BE DONE SO THAT ALL WATER DRAINS AWAY FROM ALL BUILDINGS.

- 8
- FINE GRADING: SURFACE SHALL BE RAKED FREE OF STONES AND EXIRANEOUS MATERIALS AND DEBRIS TO A SMOOTH AND EVEN TEXTURE. ALL EXTRANEOUS MATTER WILL BE DISPOSED OF BY CONTRACTOR.

PLANTINGS

- 9
- PLANT MATERIAL SUBSTITUTIONS SHALL NOT BE MADE WITHOUT THE WRITTEN PERMISSION OF THE OWNER'S REPRESENTATIVE. THE USE OF MATERIALS DIFFERING IN KIND, QUALITY OR SIZE FROM THAT SPECIFIED WILL BE ALLOWED ONLY AFTER THE OWNER'S REPRESENTATIVE IS CONVINCED THAT ALL MEANS OF OBTAINING THE SPECIFIED MATERIALS HAVE BEEN EXHAUSTED. AT THE TIME BIDS ARE SUBMITTED, THE CONTRACTOR IS ASSUMED TO HAVE LOCATED THE MATERIALS NECESSARY TO COMPLETE THE JOB AS SPECIFIED. ALL REQUESTS FOR SUBSTITUTIONS MUST BE SUBMITTED NO LATER THAN 2 WEEKS PRIOR TO THE INITIATION OF WORK.

- 10
- PLANT MATERIAL QUALITY, SIZE AND CONDITION SHALL BE IN ACCORDANCE WITH AMERICAN STANDARD FOR NURSERY STOCK, 1980 EDITION, AS PUBLISHED BY THE COMMITTEE ON HORTICULTURAL STANDARDS OF THE AMERICAN ASSOCIATION OF NURSERYMEN, INC.

- 11
- ALL PLANTS SHALL BE TYPICAL OF THEIR SPECIES OR VARIETY. ALL PLANTS SHALL HAVE NORMAL, WELL DEVELOPED BRANCHES AND VIGOROUS ROOT SYSTEMS. THEY SHALL BE SOUND, HEALTHY, VIGOROUS, FREE FROM DEFECTS, DISFIGURING KNOTS, ABRASIONS OF THE BARK, SUNSCALD INJURIES, PLANT DISEASES, INSECT EGGS, BORES AND ALL OTHER FORMS OF INFECTIONS.

- 12
- UNLESS OTHERWISE STATED ON THE DRAWINGS OR APPROVED BY OWNER'S REPRESENTATIVE, ALL PLANTS SHALL BE NURSERY GROWN AND SHALL BE TAGGED WITH NURSERY LABELS INDICATING SPECIES AND VARIETY.

- 13
- CONTAINER GROWN PLANT MATERIAL SHALL HAVE BEEN ESTABLISHED IN ITS DELIVERY CONTAINER FOR NOT LESS THAN SIX MONTHS, BUT FOR NOT MORE THAN TWO YEARS. ANY ROOTBOUND MATERIAL WILL NOT BE ACCEPTED.

- 14
- BALLED AND BURLAPPED PLANT MATERIAL SHALL HAVE A SOLID BALL OF EARTH OF MINIMUM SPECIFIED SIZE AND HELD IN PLACE SECURELY BY BURLAP AND A STOUT TWINE OR ROPE. BROKEN OR LOOSE BALLS WILL BE REJECTED.

- 15
- UNLESS SPECIFICALLY NOTED ON THE DRAWINGS, ALL TREES SHALL HAVE A SINGLE TRUNK THAT IS STRAIGHT AND FREE OF "DOG-LEGS", "CROOKS", "Y-CROTCHES", OR OTHER DISFIGURING SHAPES. THE CENTRAL LEADER OF ALL TREES SHALL NOT HAVE BEEN PRUNED. TREES WITH DOUBLE LEADERS ARE NOT ACCEPTABLE, UNLESS SPECIFIED AS MULTI-TRUNKED.

- 16
- ALL PLANT MATERIAL SHALL HAVE A UNIFORM SHAPE AROUND ITS COMPLETE CIRCUMFERENCE. PLANT MATERIAL WITH IRREGULAR BRANCHING PATTERNS OR WITH BRANCHING PATTERNS MORE HIGHLY DEVELOPED ON ONE SIDE THAN ON OTHER SIDES SHALL NOT BE ACCEPTABLE.

- 17
- THE OWNER'S REPRESENTATIVE SHALL INSPECT ALL PLANT MATERIAL AT THE CONTRACTOR'S YARD PRIOR TO DELIVERY, DURING PLANTING AND AFTER PLANTING AT THE JOB SITE.

- 18
- AT THE OPTION OF THE CONTRACTOR, THE OWNER'S REPRESENTATIVE WILL INSPECT PLANT MATERIAL AT A WHOLESALE NURSERY OF THE CONTRACTOR'S CHOICE PRIOR TO DELIVERY OF MATERIALS TO THE CONTRACTOR'S YARD. HOWEVER, AT NO ADDITIONAL EXPENSE TO THE OWNER, THE CONTRACTOR SHALL BE RESPONSIBLE FOR ALL TRAVEL EXPENSES INCURRED BY THE OWNER'S REPRESENTATIVE FOR ANY TRAVEL OUTSIDE OF THE ALBUQUERQUE METROPOLITAN AREA.

- 19
- THE OWNER'S REPRESENTATIVE SHALL BE THE JUDGE OF THE QUALITY AND ACCEPTABILITY OF ALL PLANT MATERIALS. ALL REJECTED MATERIAL SHALL BE IMMEDIATELY REMOVED FROM THE SITE AND REPLACED WITH ACCEPTABLE MATERIAL AT NO ADDITIONAL COST TO OWNER.

- 20
- ALL COLLECTED PLANTS MUST BE PRESENTED ON THE SITE AND SHALL BE IN ACCORDANCE WITH THE NEW MEXICO DEPARTMENT OF AGRICULTURE PLANT PROTECTION ACT, REGULATORY ORDER NO. 4.

- 21
- ALL PLANT MATERIALS SHOWN ON PLANS SHALL BE MULCHED AS PER DETAILS AND SPECIFICATIONS.

- 22
- ALL TREES, SHRUBS AND GROUNDCOVERS SHALL BE GUARANTEED FOR THE PERIOD OF ONE YEAR BEGINNING ON THE DATE OF FINAL CONTRACT ACCEPTANCE.

SEEDING NOTES

- GENERAL
- 1
- ALL AREAS DISTURBED OR DENUDED OF VEGETATION SHALL BE RESEEDED WITH THE NATIVE SEED MIX AS DESCRIBED IN THE PLANS AND SHALL COMPLY WITH NPDES STANDARDS FOR DUST AND EROSION CONTROL, AND ANY OTHER LOCAL ORDINANCES HAVING JURISDICTION.

- 2
- ALL DISTURBED OR DENUDED AREAS BEYOND THE LIMITS OF CONSTRUCTION SHALL BE RESEDED AS PER THE NATIVE SEED MIX AND AS PER THE OWNER'S DIRECTION.

- 3
- ALL RECLAMATION SEEDING OUTSIDE THE LIMITS OF CONSTRUCTION SHALL BE CONSIDERED INCIDENTAL TO CONTRACT.

IRRIGATION NOTES

- GENERAL
- 1
- WORK UNDER THIS SECTION CONSISTS OF INSTALLING A COMPLETE UNDERGROUND IRRIGATION SYSTEM AS SHOWN ON THESE PLANS, DETAILS AND SPECIFICATIONS. THE CONTRACTOR PERFORMING THIS WORK SHALL FURNISH ALL LABOR, EQUIPMENT, MATERIALS AND PERMITS NECESSARY FOR THE COMPLETION OF THE IRRIGATION SYSTEM, EXCEPT FOR THOSE COMPONENTS SPECIFIED TO BE FURNISHED BY OTHERS.

- 2
- THE CONTRACTOR SHALL BE FAMILIAR WITH THESE PLANS, DETAILS AND SPECIFICATIONS AS THEY PERTAIN TO THE SITE. IT SHALL BE THE CONTRACTOR'S RESPONSIBILITY TO NOTIFY THE OWNER'S REPRESENTATIVE OF ANY ITEMS THAT ARE IN CONFLICT WITH THE PROPOSED CONTRACT.

- 3
- EXISTING UTILITY LINES ARE TO BE BLUE STAKED PRIOR TO EXCAVATION FOR IRRIGATION LINES AND EQUIPMENT. CHECK AND FIELD VERIFY ALL SITE CONDITIONS, UTILITIES AND SERVICES PRIOR TO TRENCHING. CALL N.M. ONE CALL AT 260-1990 FOR BLUE STAKING.

- 4
- ALL PLANT MATERIALS SHALL BE IRRIGATED WITH AUTOMATIC IRRIGATION SYSTEMS AS PER PLANS, DETAILS AND SPECIFICATIONS UNLESS OTHERWISE INDICATED ON THE DRAWING.

- 5
- WHERE TREES, LIGHT STANDARDS, ETC. ARE AN OBSTRUCTION OF PIPING AND DRIP EMITTERS, THEY SHALL BE ADJUSTED AND/OR RELOCATED AS NECESSARY TO OBTAIN FULL COVERAGE WITHOUT EXCESSIVE OVERFLOW.

- 6
- CONTRACTOR SHALL FLUSH ALL LINES PRIOR TO INSTALLING HEADS AND EMITTERS.

- 7
- PLANS ARE DIAGRAMMATIC AND APPROXIMATE DUE TO SCALE OF DRAWINGS. ALL VALVES SHALL BE LOCATED IN PLANTING AREAS OR SODDED AREAS WHERE SHOWN AND ALL PIPING SHALL BE INSTALLED PRIOR TO LANDSCAPING OR PAVING WORK. NO TEES, ELLS OR OTHER TURNS IN PIPING SHALL BE LOCATED UNDER PAVING. CAP ALL ENDS HAND TIGHT, PRIOR TO BACKFILL.

- 8
- COMPLY WITH REQUIREMENTS OF THE UNIFORM PLUMBING CODE AND ANY OTHER GOVERNMENTAL BODIES HAVING JURISDICTION.

- 9
- REFER TO IRRIGATION DETAILS, SPECIFICATIONS AND MANUFACTURERS RECOMMENDATIONS FOR ALL INSTALLATION PROCEDURES NOT FULLY DESCRIBED ON THE IRRIGATION PLANS.

- 10
- ALL BACKFILLING SHALL BE CLEAN MATERIAL FROM EXCAVATION. BACKFILLED TRENCH IS TO BE EVEN WITH EXISTING GRADES AFTER COMPACTION.

- 11
- TRENCH BACKFILL MATERIAL SHALL BE COMPACTED TO 85% PROCTOR DENSITY.

- 12
- ALL VALVES TO BE IN APPROVED VALVE BOXES. LOCATE VALVE BOXES IN GROUPS OF TWO OR THREE AND NEAR WALKWAYS WHEREVER POSSIBLE.

- 13
- COORDINATE PROGRAMS TO AVOID STATION OVERLAP.

COMPONENTS AND PRODUCTS

- 14
- ALL COMPONENTS INSTALLED AS THE UNDERGROUND IRRIGATION SYSTEM ARE TO BE NEW AND IN GOOD WORKING ORDER AND WITHOUT FLAWS UNLESS OTHERWISE INDICATED ON THE PLANS, DETAILS AND SPECIFICATIONS.

- 15
- IF THE CONTRACT DRAWINGS AND/OR SPECIFICATIONS DO NOT THOROUGHLY DESCRIBE THE METHOD OR TECHNIQUES TO BE USED FOR INSTALLATION, THEN THE CONTRACTOR SHALL FOLLOW THE INSTALLATION METHODS RECOMMENDED BY THE MANUFACTURER.

- 16
- ALL PLANT MATERIALS INSTALLED SHALL HAVE THE AUTOMATIC IRRIGATION SYSTEM FULLY OPERABLE AT THE TIME OF PLANT INSTALLATION.

WARRANTY AND MAINTENANCE

- 17
- THE CONTRACTOR SHALL FURNISH A CERTIFICATE OF WARRANTY AND A GUARANTEE OF WORK AND MATERIALS FOR A ONE-YEAR PERIOD FROM DATE OF FINAL ACCEPTANCE. FINAL PAYMENT FOR THE SYSTEM SHALL NOT BE MADE UNLESS THIS CERTIFICATE IS PRESENTED TO THE OWNER.

- 18
- THE CONTRACTOR SHALL MAINTAIN THE IRRIGATION SYSTEM, IN SATISFACTORY WORKING ORDER, DURING THE TIME OF CONTRACT WORK.

- 19
- THE CONTRACTOR SHALL BE LIABLE FOR ANY LOSS OR DAMAGE TO ANY WORK OR MATERIALS, SUPPLIES AND EQUIPMENT ON THE JOB SITE CAUSED BY THE CONTRACTOR, ITS EMPLOYEES OR ANY OTHER UNFORESEEN CAUSE UNTIL FINAL ACCEPTANCE OF PROJECT WITH THE OWNER'S REPRESENTATIVE.

AS-BUILT INFORMATION		BENCH MARKS		SURVEY INFORMATION		ENGINEER'S SEAL		REMARKS		DESIGN REVISIONS		DATE	
CONTRACTOR	DATE			NO.	BY	DATE							
WORK BY	DATE												
INSPECTED BY	DATE												
ACCEPTANCE BY	DATE												
VERIFICATION BY	DATE												
DRAWINGS CHECKED BY	DATE												
MICRO-FILM INFORMATION													
RECORDED BY	DATE												
NO.													



8-9-96

<b>BOHANNAN-HUSTON INC.</b> ENGINEERS • PLANNERS • PHOTOGRAMMETRISTS • SURVEYORS • LANDSCAPE ARCHITECTS ALBUQUERQUE LAS CRUCES SANTA FE			
<b>CITY OF ALBUQUERQUE</b> <b>PUBLIC WORKS DEPARTMENT</b> <b>ENGINEERING DEVELOPMENT GROUP</b>			
TITLE: <b>LAURELWOOD PARK</b> <b>GENERAL NOTES</b>			
DESIGN REVIEW COMMITTEE	CITY ENGINEER APPROVAL	MO./DAY/YR.	MO./DAY/YR.
CITY PROJECT NO.	ZONE MAP NO.	SHEET	OF
4550.90	J-10	2	9

RECORD DRAWING

DATE: 9/18/97 AS BUILT



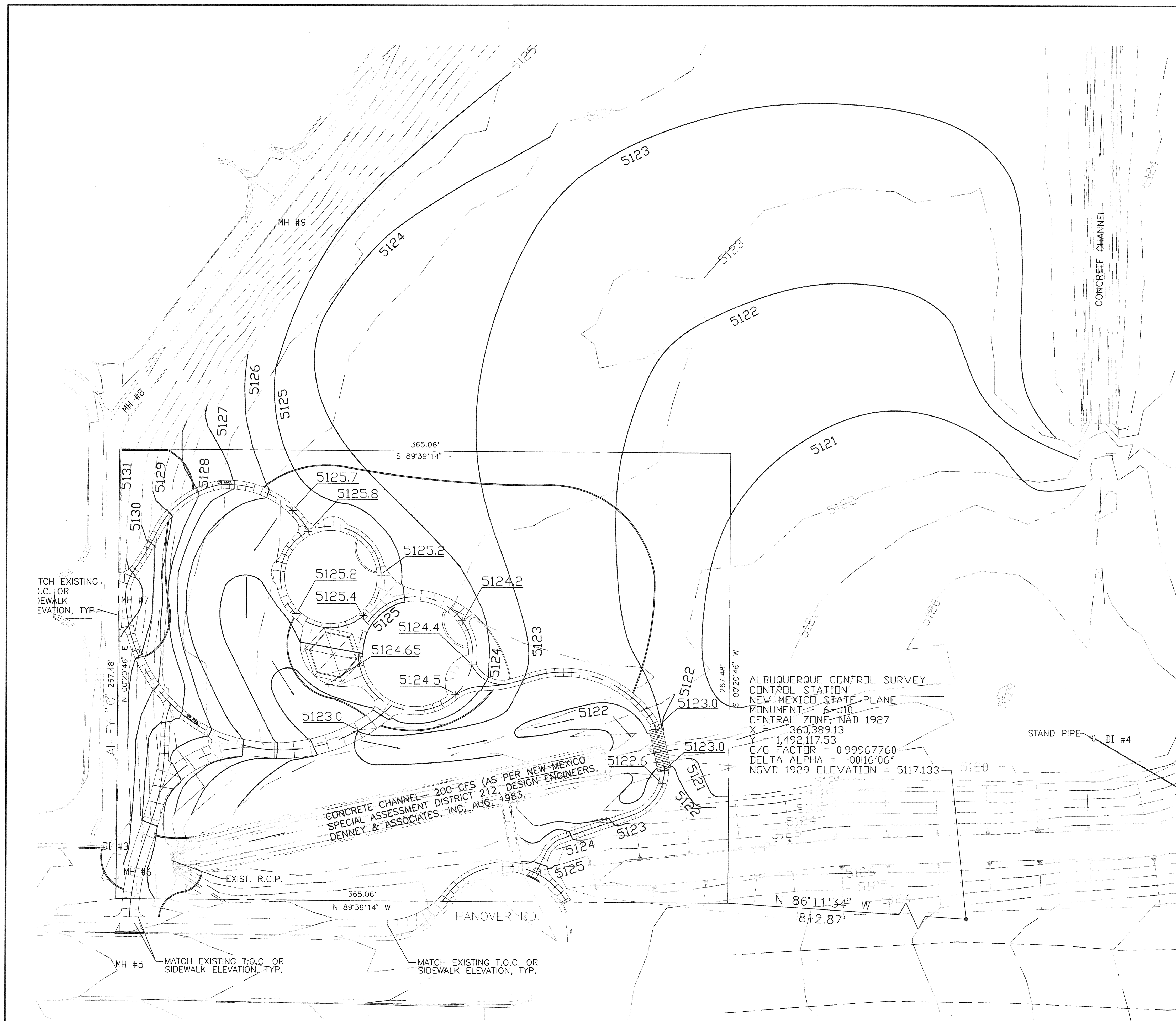

LEGEND

- EXIST. CONTOUR
- PROP. CONTOUR
- FLOWLINE
- + 5125.2 PROP. SPOT ELEVATION

NOTE:

- TO ACHIEVE PROPER FILL ELEVATIONS, CUT CAN BE OBTAINED FROM THE POND AREA. CUT CANNOT EXCEED 1' FROM EXISTING ELEVATION.

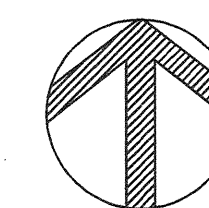

0 30 60 90  
SCALE: 1" = 30'

<b>BOHANNAN-HUSTON INC.</b> ENGINEERS • PLANNERS • PHOTOGRAMMETRISTS • SURVEYORS • LANDSCAPE ARCHITECTS ALBUQUERQUE LAS CRUCES SANTA FE			
<b>CITY OF ALBUQUERQUE</b> PUBLIC WORKS DEPARTMENT ENGINEERING DEVELOPMENT GROUP			
TITLE: <b>LAURELWOOD PARK GRADING PLAN</b>			
DESIGN REVIEW COMMITTEE	CITY ENGINEER APPROVAL	MO./DAY/YR.	MO./DAY/YR.
LAST DESIGN UPDATE			
CITY PROJECT NO. <b>4550.90</b>	ZONE MAP NO. <b>J-10</b>	SHEET <b>3</b>	OF <b>9</b>

RECORD DRAWING  
DATE: 9/18/97 AS BUILT

SURVEY INFORMATION		BENCH MARKS		AS-BUILT INFORMATION	
NO.	BY	DATE		CONTRACTOR	DATE
				WORK STAMPED BY	DATE
				FIELD ACCEPTANCE BY	DATE
				DESIGNING BY	DATE
				CHECKED BY	DATE
				MICRO-FILM INFORMATION	
				RECORDED BY	DATE
				NO.	

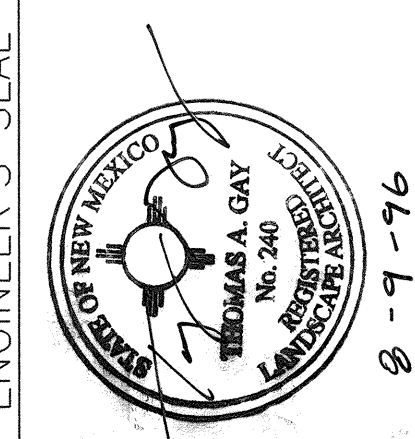







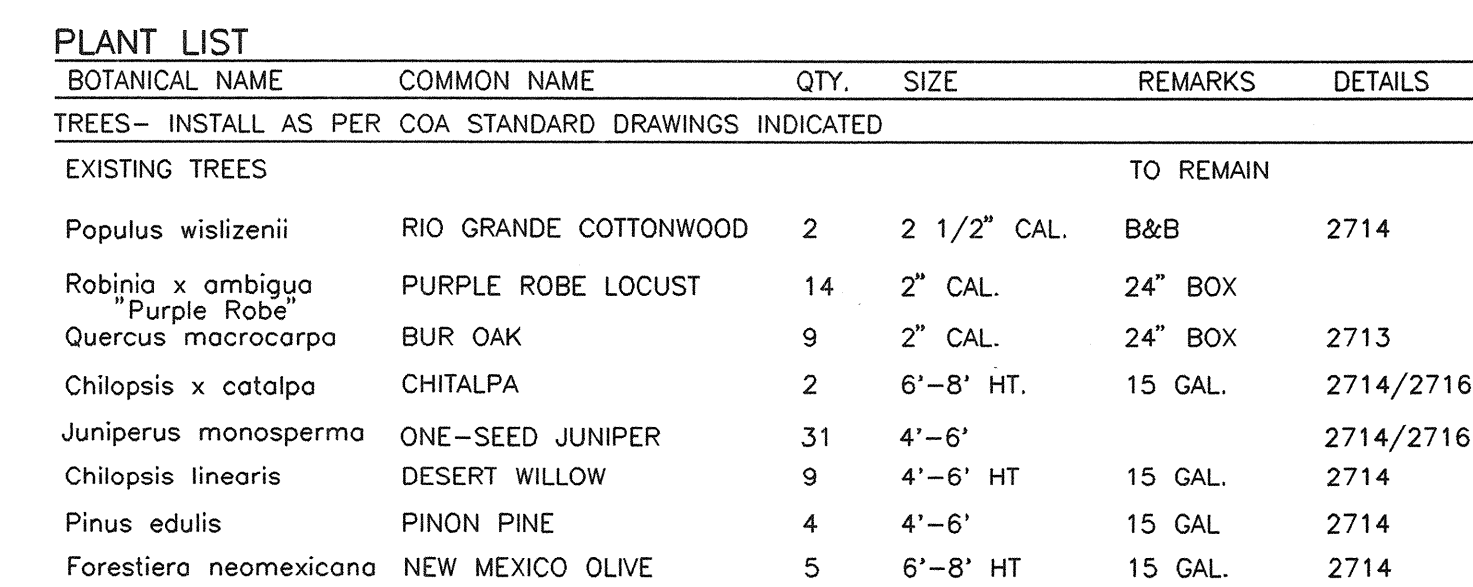





SHRUBS-- INSTALL AS PER COA STANDARD DRAWINGS INDICATED				
<i>Salix exigua</i>	COYOTE WILLOW	8	5 GAL.	2717
<i>Rhus microphylla</i>	LITTLE LEAF SUMAC	16	1 GAL.	
<i>Fallugia paradoxa</i>	APACHE PLUME	62	5 GAL.	2717
<i>Cercocarpus montanus</i>	MOUNTAIN MAHOGANY	16	5 GAL.	2717
<i>Caryopteris clandonensis</i>	BLUE MIST	59	5 GAL.	2717
<i>Cotoneaster lacteus</i>	COTONEASTER	25	5 GAL.	2717
<i>Atriplex canescens</i>	FOUR WING SALTBUSH	7	5 GAL.	2717

GROUND COVERS—INSTALL AS PER COA STANDARD DRAWINGS INDICATED						
"A" 	Miscanthus zebrinus or Eragrostis tricoles	ZEBRA GRASS SAND LOVEGRASS	85	4" POTS	24" O.C.	2717
"B" 	Pennisetum setaceum	FOUNTAIN GRASS	137	4" POTS	24" O.C.	2717
"C" 	Helictotrichon sempervirens or Festuca ovina	BLUE AVENA SHEEP FESCUE	404	4" POTS	12" O.C.	2717
TURF GRASS SEED MIX					250 LBS PLS PER ACRE	
	10% BY WEIGHT	"ADELPHI" BLUEGRASS				
	90% BY WEIGHT	"FALCON" FESCUE				

NATIVE GRASS SEEDING		
BOTANICAL NAME	COMMON NAME	LBS PLS/AC
<i>Oryzopsis hymenoides</i> Paloma	PALOMA INDIAN RICEGRASS	5.0
<i>Hilaria jamesii</i> Viva	VIVA GALLETA	1.0
<i>Bouteloua curtipendula</i> Niner	NINER SIDEQATS GRAMA	3.0
<i>Bouteloua gracilis</i> "Hatchita"	HATCHITA BLUE GRAMA	1.0
<i>Sporobolus cryptandrus</i>	SAND DROPSEED	1.0
<i>Melampodium leucanthum</i>	BLACKFOOT DAISY	.25
<i>Sphaeralcea coccinea</i>	SCARLET GLOBEMALLOW	.25
<i>Secocia multicaupitatus</i>	THREADLEAF GROUNDSEL	.25

ALL AREAS DISTURBED OR DENUDED DURING THE COURSE OF WORK SHALL BE RECLAIMED WITH THE NATIVE SEED MIX AND INSTALLED AS PER CITY OF ALBUQUERQUE STANDARD SPECIFICATIONS, REFERENCE GRADING PLAN FOR ADDITIONAL LOCATIONS.

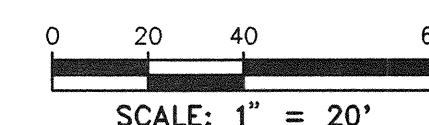

RECORD DRAWING

COPYRIGHT BOHANNAN-HUSTON, INC.  
 8/9/96

RECORD DRAWING



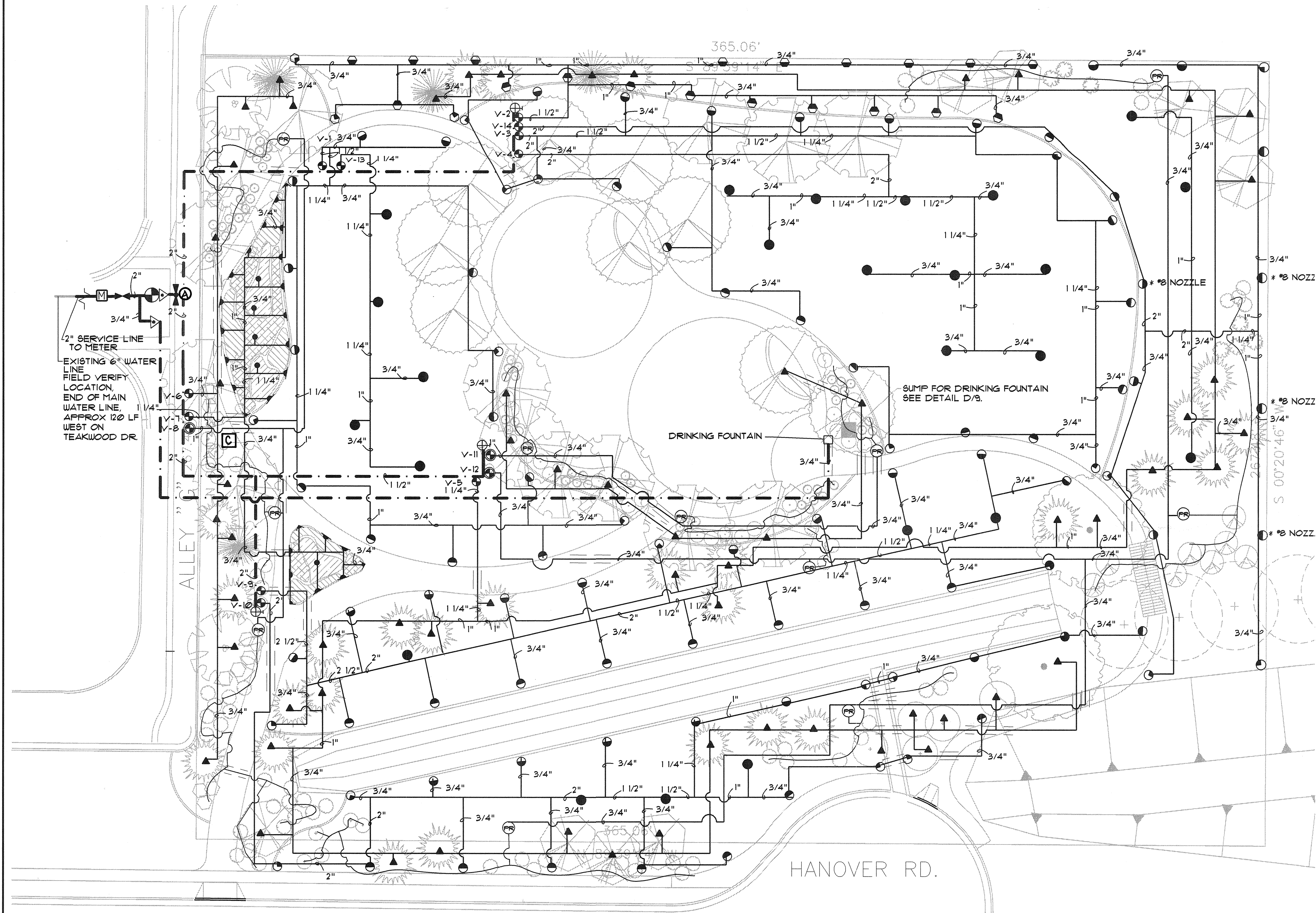

LEGEND

- ALL IRRIGATION EQUIPMENT SHALL BE INSTALLED AS PER CITY OF ALBUQUERQUE STANDARD DRAWING INDICATED OR AS PER THE DETAILS, SEE SHEETS
- IRRNET 16 STATION CONTROLLER M51 1T SOR**
- WATER METER 2"**
- MASTER VALVE-BERHAD 1 1/2" 910-P (SEE PLAN)** DETAIL: 2702-A  
FEBCO 825 1 1/2" RPBA  
STRONGBOX INSULATED ENCLOSURE SBBC-30 ALI  
RAYCHEM WINTERGUARD HEAT TAPE H612250
- DRINKING FOUNTAIN SERVICE LINE** DETAIL: 2702-A  
FEBCO 825 3/4" RPBA  
STRONGBOX INSULATED ENCLOSURE SBBC-30 ALI  
RAYCHEM WINTERGUARD HEAT TAPE H612250
- MANUAL GATE VALVE** DETAIL: 2707
- CHAMPION 100RS-100 MANUAL DRAIN ASSEMBLY** DETAIL: F/9.
- CRISPIN UNIVERSAL AIR RELEASE VALVE ASSEMBLY 10.0-1"** DETAIL: 2705
- WILKENS 2" 500Y SBR MAINLINE PRESSURE REDUCING VALVE** DETAIL: E/9.
- RAINBIRD PEB AUTOMATIC CONTROL VALVE** DETAIL: 2703
- RAINBIRD PEB AUTOMATIC DRIP CONTROL VALVE** DETAIL: B/9  
W/ WYE STRAINER
- BUBBLER- RAINBIRD 1402 .5 GPM** DETAIL: 2710
- PEPCO INLINE PRESSURE REDUCER** DETAIL: C/9
- HARDIE E-2 EMITTER DBK-08 2 GPH** DETAIL: C/9  
OR HARDIE E-2 EMITTER DBK-16 4 GPH (SEE VALVE LEGEND)  
ON 1/2" POLY PIPE, 2 EMITTERS PER SHRUB, TYPICAL.
- HUNTER PGM ROTOR ASSEMBLY** DETAIL: 2709  
PGM #.75 NOZZLE .75 GPM  
PGM #1.5 NOZZLE 1.5 GPM
- HUNTER ROTOR ASSEMBLY** DETAIL: 2709  
I-20 #2 NOZZLE .9 GPM  
I-20 #5 NOZZLE 2.0 GPM  
I-20 #6 NOZZLE 2.7 GPM  
I-20 #8 NOZZLE 4.2 GPM
- RAINBIRD 1812 10 SERIES POP UP SPRAY** DETAIL: 2709  
100 PCS-040 .4 GPM  
10H PCS-060 .60 GPM  
10F PCS-125 1.25 GPM
- MAINLINE 2" SCH 40 PVC** DETAILS: 2704  
THRUST BLOCKS AS PER THE SPECIFICATIONS
- LATERAL SCH 40 PVC**
- SLEEVE SCH 40 PVC** TWO SIZES LARGER THAN THE PIPE TO BE SLEEVED

VALVE LEGEND

VALVE NO.	HEAD TYPE OR EMITTER	SIZE	GPM
V-1	I-20	1 1/2"	26.7
V-2	PGM	1 1/2"	27.75
V-3	I-20	1 1/2"	38.5
V-4	I-20	1 1/2"	42.0
V-5	1402	1"	21.0
V-6	1402	1"	6.0
V-7	1812	1"	20.25
V-8	DBK-16	1"	9.18
V-9	I-20	1 1/2"	52.5
V-10	I-20	1 1/2"	48.1
V-11	DBK-08	1"	8.26
V-12	DBK-16	1"	7.06
V-13	I-20	1"	21.0
V-14	I-20	1 1/2"	44.8

IRRIGATION NOTES

MANUAL DRAIN SHALL BE INSTALLED AT ALL LOW POINTS IN THE MAINLINE. AIR RELEASE SHALL BE INSTALLED AT ALL HIGH POINTS IN THE MAINLINE.

ELECTRICAL POWER FOR IRRIGATION CONTROLLER AND HEAT TAPE CAN BE FOUND AT THE CUL DE SAC OF HANOVER ROAD, AT TRANSFORMER #28970. CONTRACTOR SHALL RUN CONDUIT FROM POWER SOURCE TO THE GROUND IN CONDUIT LOCATED ON THE OPPOSITE SIDE OF THE POWER POLE FROM THE TRANSFORMER, EITHER THE NORTHEAST OR SOUTHEAST QUADRANT.

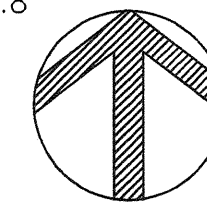

0 20 40 60  
SCALE: 1" = 20'

IRRIGATION SCHEDULE

PROGRAM	STATION	CALCULATED PRECIPITATION	RUN TIME IN MINUTES	CYCLES/IRRIGATION	IRRIGATIONS PER MONTH	COMMENTS
1	4.13	.40"/HR	153	2	14	TURFGRASS 7.17"/31 DAYS
2	1.3	.40"/HR	153	2	14	TURFGRASS 7.17"/31 DAYS
3	2.9,10	.40"/HR	300	2	3	RECL. SEED 2"/31 DAYS
4	5,6	.5 GPM	78	3	5	TREES ON BUBBLERS 3.2 GAL/DAY
5	11	2 GPH	93	3	3	SHRUBS @ 2 GPH 9.3 GAL/MO.
6	12,8	4 GPH	93	3	3	SHRUBS @ 4 GPH 9.3 GAL/MO.
7	7	1.70"/HR	35	1	4	ORNAMENTAL GRASS 25" PER YR

RECORD DRAWING

9/18/97 As Built



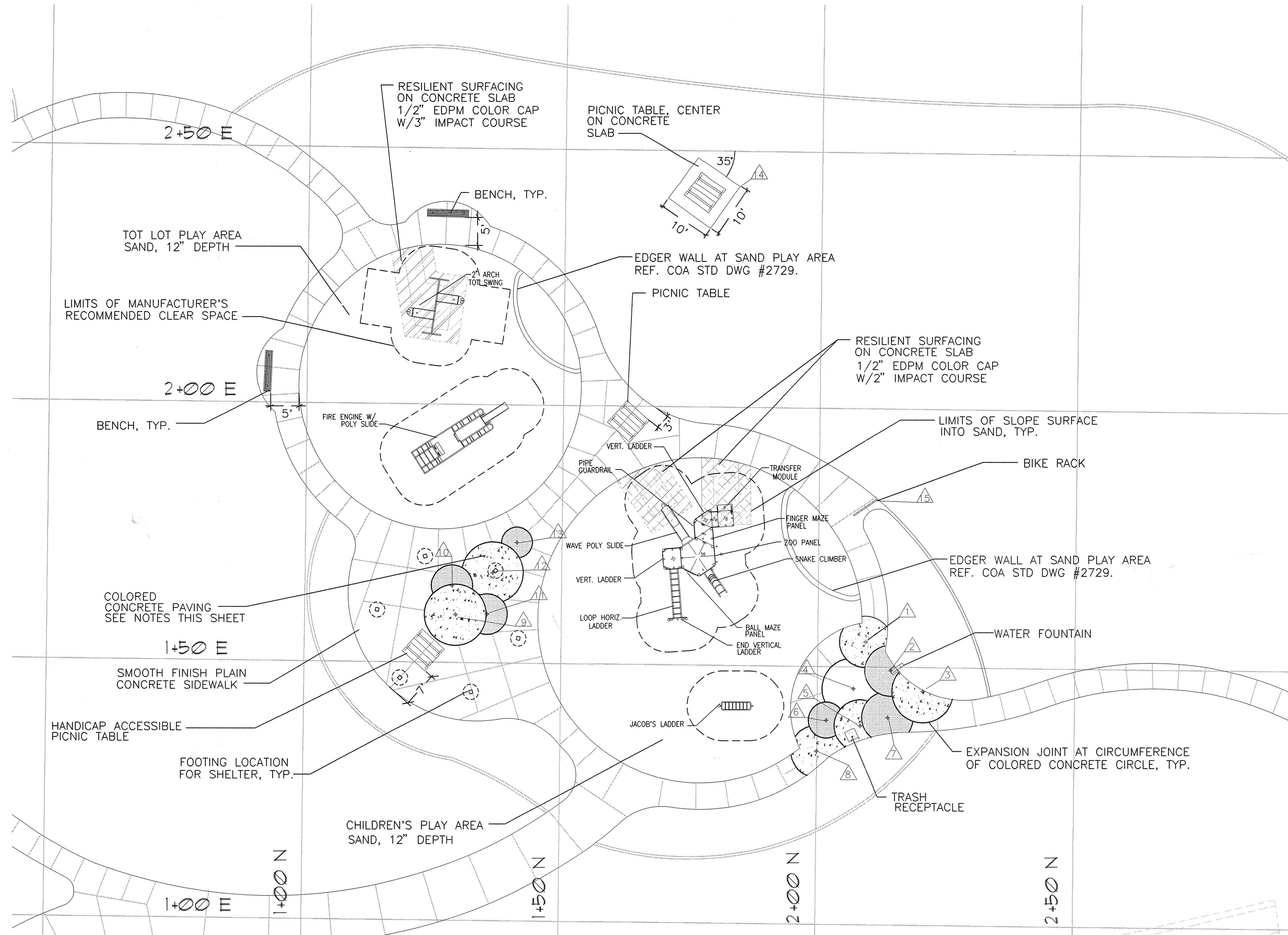

**PLAY AREA STRUCTURE- PARTS LIST**  
EQUIPMENT AS MANUFACTURED BY LANDSCAPE STRUCTURES, OR APPROVED EQUAL  
"PLAYBOOSTER" SYSTEM WITH ALUMINUM POSTS AND INDEPENDENT PLAY ITEMS

**CHILDREN'S PLAY AREA**  
QTY DESCRIPTION

POSTS		RED
6	111404C	132" POST
1	111404D	124" POST
1	111404E	116" POST
3	111404F	108" POST
DECKS		
1	111232A	HEXAGON TENDERDECK
3	111253A	KICK PLATE FOR 8" RISE
1	111228A	SQUARE TENDERDECK
1	111248G	TRANSFER MODULE, RIGHT 32" DECK
1	111231A	TRIANGULAR TENDERDECK
ENCLOSURES		BLUE
2	116245A	PIPE GUARDRAIL
3	116249A	VERTICAL LADDER 32" DECK
1	116247A	VERTICAL LADDER - PANEL 24"
SLIDES		RED
1	111314A	WAVE SLIDE 56" DECK
ATTACHMENTS/CONNECTORS		BLUE
1	111469C	2" LOOP HORIZONTAL LADDER
1	111273A	END VERTICAL LADDER W/POSTS
1	111359A	SNAKE CLIMBER 56" DECK
INDEPENDENT EQUIPMENT		RED
1	117965A	JACOB'S LADDER DB ST ONLY
PERMALENE PANELS		TAN OVER RED
1	115236A	BALL MAZE PANEL
1	115229A	FINGER MAZE PANEL
1	115227A	ZOO PANEL

**TOT LOT PLAY AREA**

INDEPENDENT EQUIPMENT		RED
1	100048A	2" ARCH TOT SWING, 2 PLACE
1	100034B	FIRE ENGINE WITH POLY SLIDE

**COLORLED CONCRETE SIDEWALK**

	COLORLED CONCRETE COA STD DWG NO. 2720 DAVIS COLORS: BRICK RED
	COLORLED CONCRETE COA STD DWG NO. 2720 DAVIS COLORS: HARVEST GOLDENROD

**SITE FURNISHINGS/MATERIALS**

QTY	MANUFACTURER/ MODEL NO.	COLOR	NOTES
PICNIC TABLES			
(1)	WABASH VALLEY SIGNATURE SERIES MODEL S612	RED	8' LENGTH, HANDICAP INSTALLATION OR APPROVED EQUAL.
(2)	WABASH VALLEY SIGNATURE SERIES MODEL S610	RED	MULTI PEDESTAL, INGROUND MOUNT, OR APPROVED EQUAL. CONTACT THE PLAYWELL GROUP, (505) 899-1762. INSTALL AS PER MANUFACTURER'S RECOMMENDATIONS
BENCH			
(2)	WABASH VALLEY CONTEMPORARY MODEL CD 8212	RED	6' BENCH, INGROUND MOUNT, OR APPROVED EQUAL. CONTACT THE PLAYWELL GROUP, (505) 899-1762. INSTALL AS PER MANUFACTURER'S RECOMMENDATIONS
BIKE RACK			
(1)	LANDSCAPE STRUCTURES MODEL NO 100102A	RED	DIRECT BURY
(1)	CONTACT EXERPLAY, (505) 281-0151		INSTALL AS PER MANUFACTURER'S RECOMMENDATIONS
TRASH RECEPTACLE			
(1)	MATERIALS INC., MODEL: RINCONADA III		INSTALL AS PER MANUFACTURER'S RECOMMENDATIONS
WATER FOUNTAIN			
(1)	MDP MODEL NO 410 OR APPROVED EQUAL	RED	HANDICAP W/ACCESS DOOR
(1)	CONTACT EXERPLAY, (505) 281-0151		DIRECT BURY
(1)	INSTALL AS PER MANUFACTURER'S RECOMMENDATIONS		
SHELTER			
(1)	34" OUTSIDE DIAMETER		SEE NOTES
(1)	HEXAGON SHELTER W/ PITCHED ROOF		AS MANUFACTURED BY ALUMINUM SALES, ALBUQ. OR APPROVED EQUAL
(1)	CONTACT EXERPLAY, (505) 281-0151		INSTALL AS PER MANUFACTURER'S RECOMMENDATIONS
RESILIENT SURFACING			
(1)	SURFACE CREATIONS, POURED IN PLACE	RED, BLACK AND TAN	
(1)	RESILIENT SURFACING	EQUAL PARTS	
(1)	CONTACT: LEISURE DESIGNS, 1-800-543-2232		
(1)	INSTALL AS PER MANUFACTURER'S RECOMMENDATIONS		

**LAYOUT GRID POINTS-  
COLORLED CONCRETE LAYOUT**

NOTE: REFERENCE CONSTRUCTION LAYOUT PLAN FOR LOCATION OF BASELINES.

PT.NO.	GRID LOCATION	RADIUS
1	1+54.9N 2+09.2E	5'
2	1+49.4N 2+14.1E	5'
3	1+45.3N 2+20.5E	6'
4	1+45.8N 2+5.0E	6'
5	1+38.5N 2+08.3E	5'
6	1+39.6N 2+1.8E	3.5'
7	1+40.2N 2+13.7E	5'
8	1+33.6N 2+00E	5'
9	1+59.5N 1+29.3E	6'
10	1+65.2N 1+28.8E	4'
11	1+59.5N 1+35.6E	4'
12	1+67.6N 1+36.6E	6'
13	1+73.7N 1+41.3E	3'

**CONSTRUCTION NOTES**

ALL SHELTER COMPONENTS TO BE PRIMED AND FINISHED BY THE MANUFACTURER, AZTEC GOLD FOR THE POSTS, CRIMSON RED FOR THE ROOF AND TRIM.

SHELTER MANUFACTURER SHALL PROVIDE SHOP DRAWINGS AND DETAILS FOR ALL SHELTER COMPONENTS, AND FOOTINGS. SHOP DRAWINGS SHALL BE STAMPED BY AN ENGINEER, LICENSED BY THE STATE OF NEW MEXICO.

CONCRETE FOOTINGS FOR ALL SITE FURNISHINGS AND THE SHELTER SHALL BE COLORED TO MATCH THE ADJACENT SIDEWALK COLOR, AS APPLICABLE.

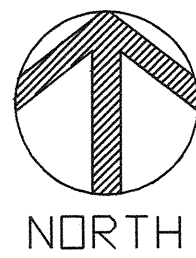

0 10 20 30  
SCALE: 1" = 10'

AS-BUILT INFORMATION		BENCH MARKS		SURVEY INFORMATION		ENGINEER'S SEAL		REVISIONS		DESIGN		DATE	
CONTRACTOR	DATE	NO.	BY	NO.	BY	NO.	DATE	NO.	DATE	NO.	DATE	NO.	DATE
WORKED BY	DATE												
ACCEPTED BY	DATE												
VERIFIED BY	DATE												
DRAWING BY	DATE												
REVIEWED BY	DATE												
NO.													

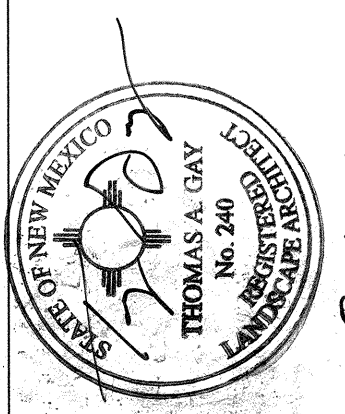

<b>BOHANNAN-HUSTON INC.</b> ENGINEERS • PLANNERS • PHOTOGRAMMETRISTS • SURVEYORS • LANDSCAPE ARCHITECTS ALBUQUERQUE LAS CRUCES SANTA FE	
<b>CITY OF ALBUQUERQUE</b> PUBLIC WORKS DEPARTMENT ENGINEERING DEVELOPMENT GROUP	
TITLE: LAURELWOOD PARK PLAY AREA ENLARGEMENT	
DESIGN REVIEW COMMITTEE CITY ENGINEER APPROVAL APPROVED AUG 23 1996 DESIGN REVIEW COMMITTEE	LAST DESIGN UPDATE MO/DAY/YR. MO/DAY/YR. MO/DAY/YR. MO/DAY/YR. MO/DAY/YR.
CITY PROJECT NO. 4550.90	ZONE MAP NO. J-10
SHEET 7	OF 9



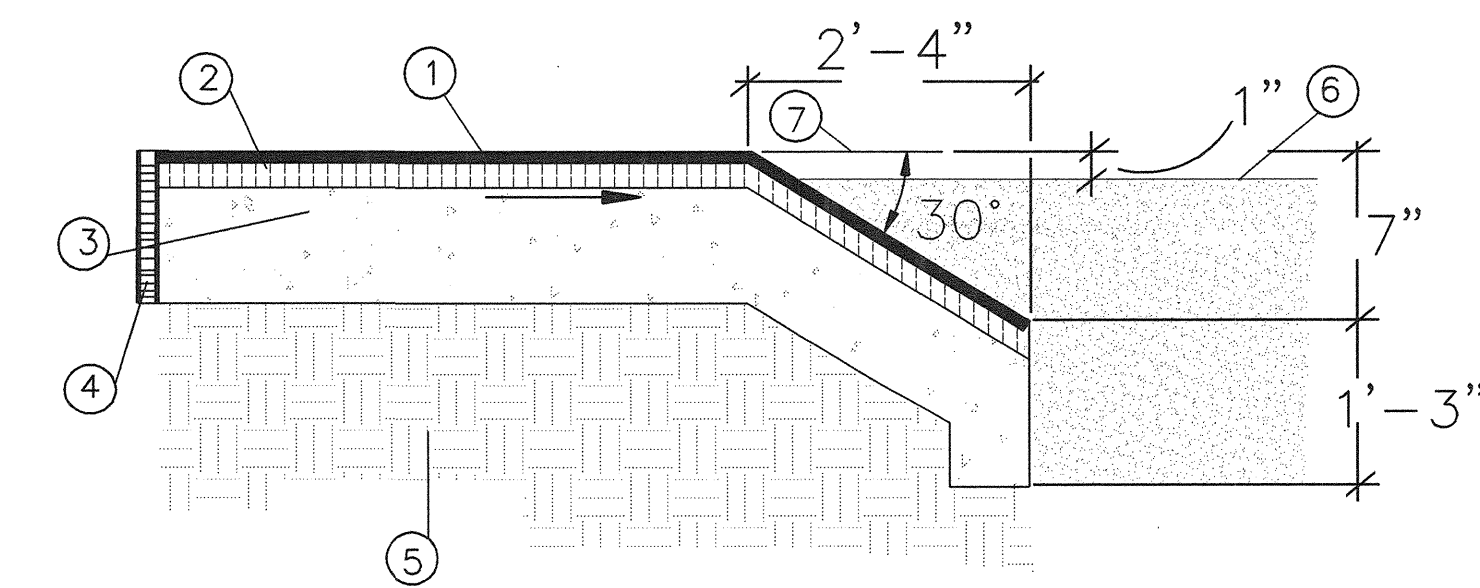



- SHELTER MANUFACTURER SHALL PROVIDE SHOP DRAWINGS AND DETAILS  
FOR ALL SHELTER COMPONENTS AND FOOTINGS.  
SHOP DRAWINGS SHALL BE STAMPED BY AN ENGINEER,  
LICENSED BY THE STATE OF NEW MEXICO

POURED IN PLACE SAFETY SURFACE

N.T.S.

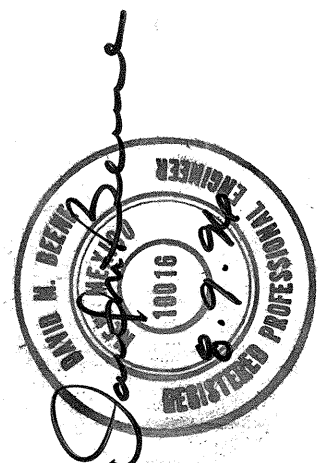
N.T.S.

[illegible]

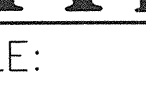
	<b>BOHANNAN-HUSTON INC.</b> <i>ENGINEERS • PLANNERS • PHOTOGRAMMETRISTS • SURVEYORS • LANDSCAPE ARCHITECTS</i> <b>ALBUQUERQUE      LAS CRUCES      SANTA FE</b>																			
	<b>CITY OF ALBUQUERQUE</b> <b>PUBLIC WORKS DEPARTMENT</b> <b>ENGINEERING DEVELOPMENT GROUP</b>																			
<b>TITLE:</b> <span style="float: right;">LAURELWOOD PARK</span> <span style="float: right;">CONSTRUCTION DETAILS</span>																				
<div style="border: 1px solid black; padding: 5px; text-align: center;">             DESIGN REVIEW COMMITTEE                AUG 23 1995              DESIGN REVIEW COMMITTEE           </div>	<div style="border: 1px solid black; padding: 5px; text-align: center;">             CITY ENGINEER APPROVAL      </div>	<table border="1" style="width: 100%; border-collapse: collapse;"> <tr> <td style="width: 15%; text-align: center; vertical-align: middle;">LAST DESIGN UPDATE</td> <td style="width: 30%; text-align: center;">MO./DAY/YR.</td> <td style="width: 30%; text-align: center;">MO./DAY/YR.</td> </tr> <tr><td></td><td></td><td></td></tr> <tr><td></td><td></td><td></td></tr> <tr><td></td><td></td><td></td></tr> <tr><td></td><td></td><td></td></tr> <tr><td></td><td></td><td></td></tr> </table>	LAST DESIGN UPDATE	MO./DAY/YR.	MO./DAY/YR.															
LAST DESIGN UPDATE	MO./DAY/YR.	MO./DAY/YR.																		
CITY PROJECT NO. <div style="font-size: 2em; font-weight: bold;">4550.90</div>	ZONE MAP NO. <div style="font-size: 2em; font-weight: bold;">J-10</div>	SHEET <div style="font-size: 2em; font-weight: bold;">8</div> OF <div style="font-size: 2em; font-weight: bold;">9</div>																		



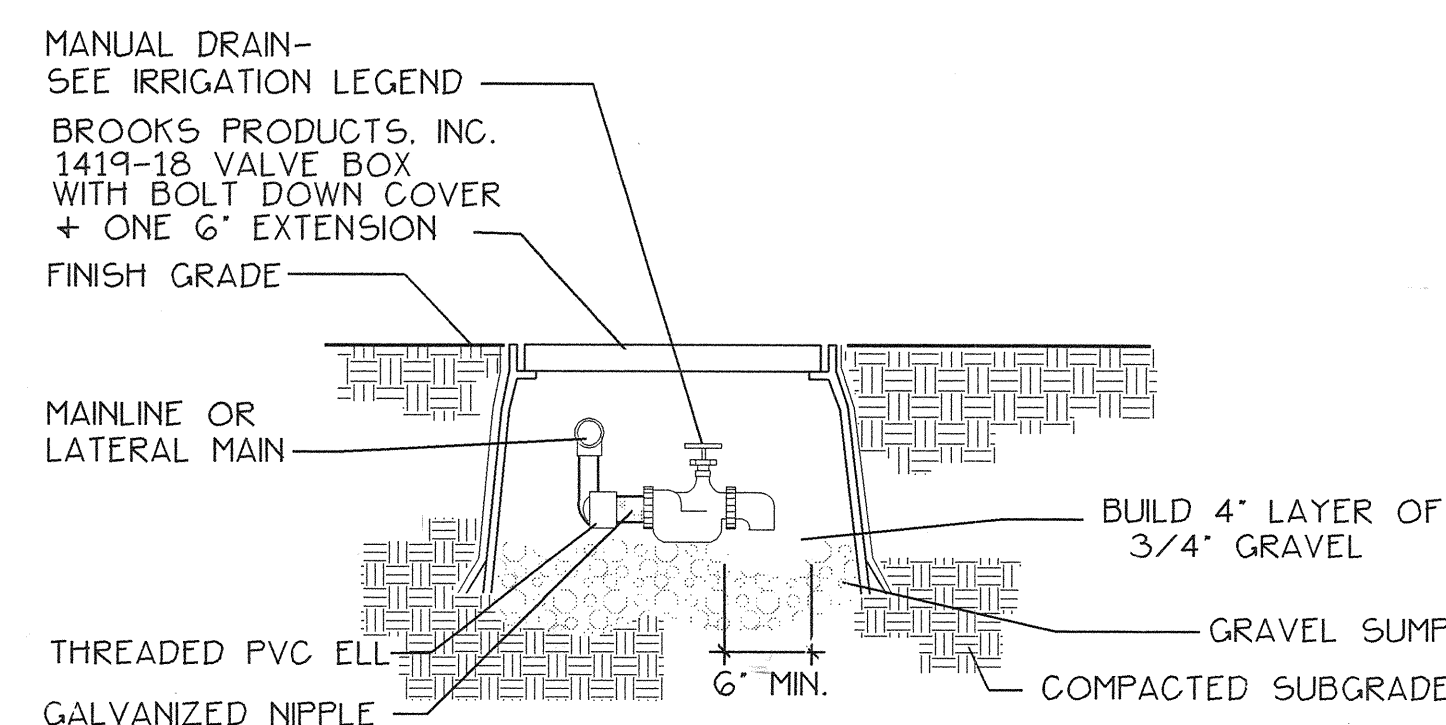
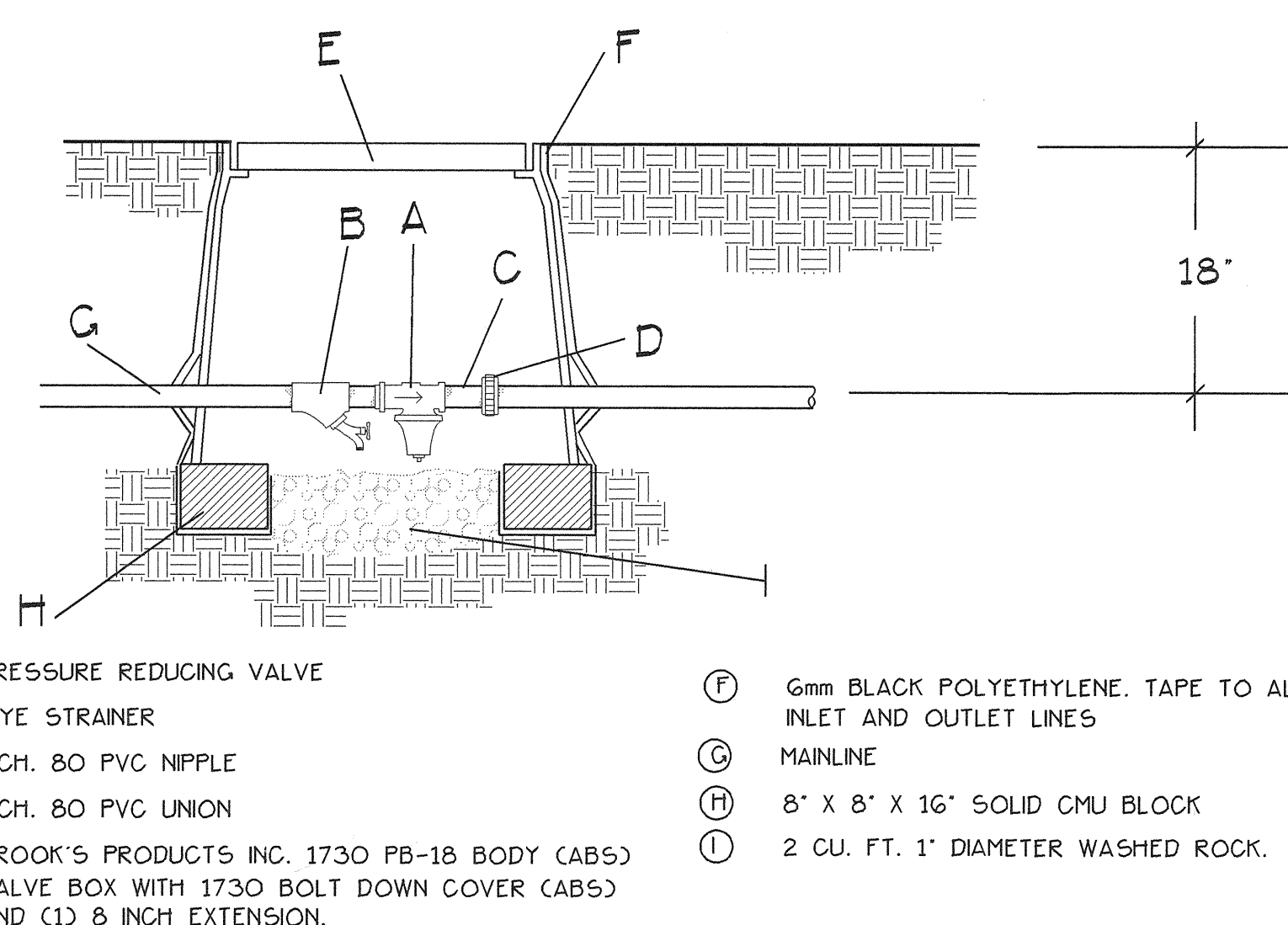
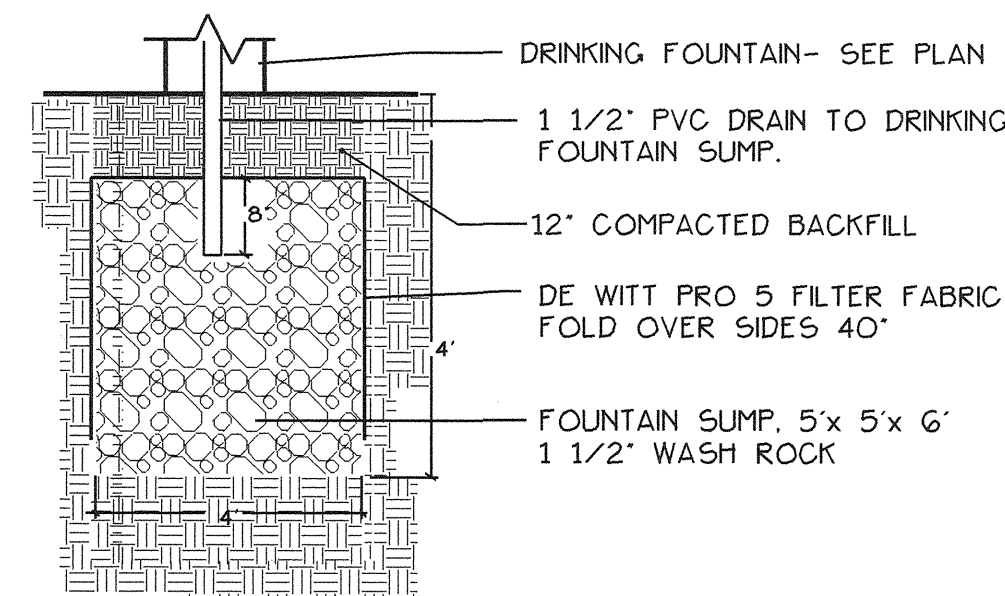
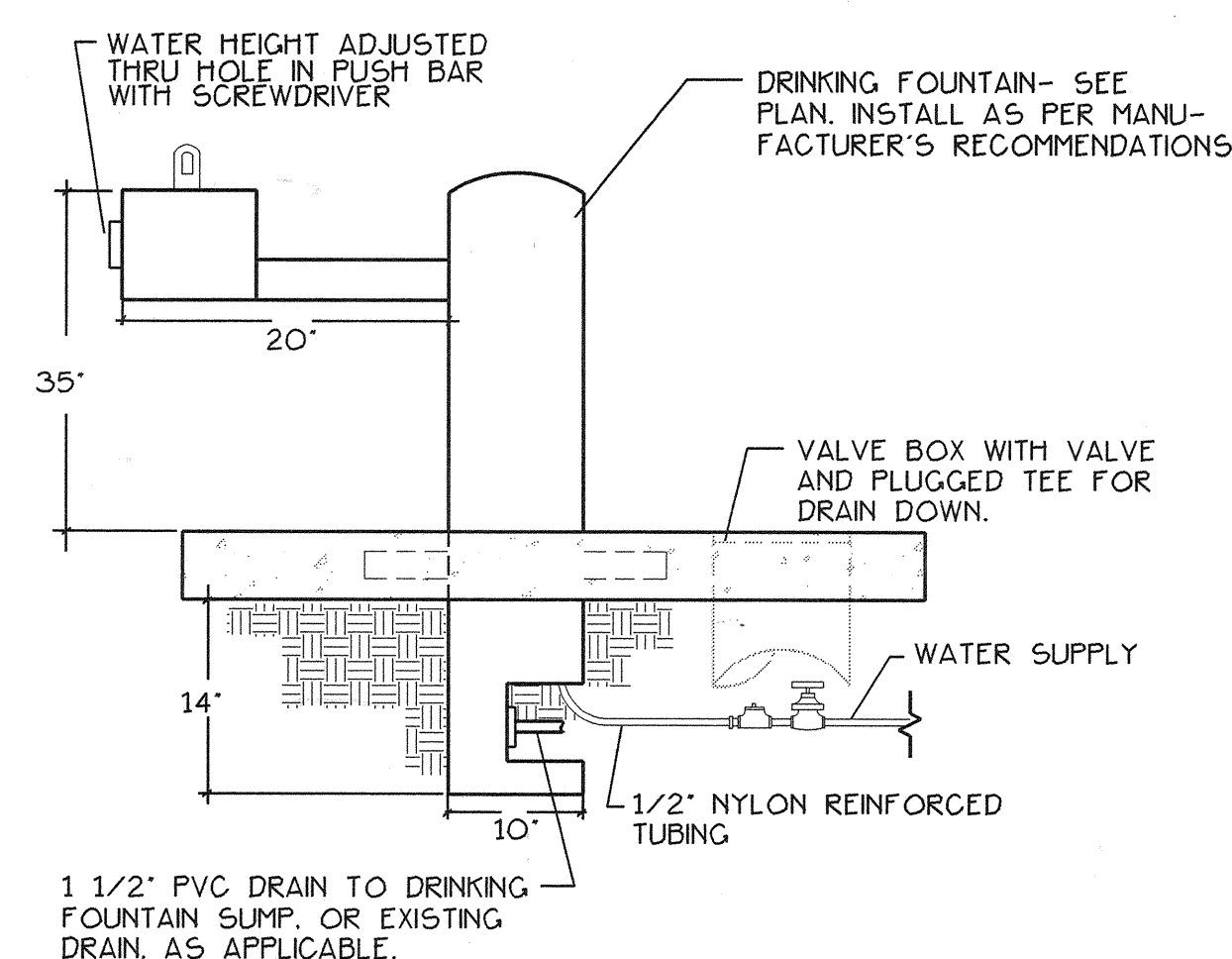
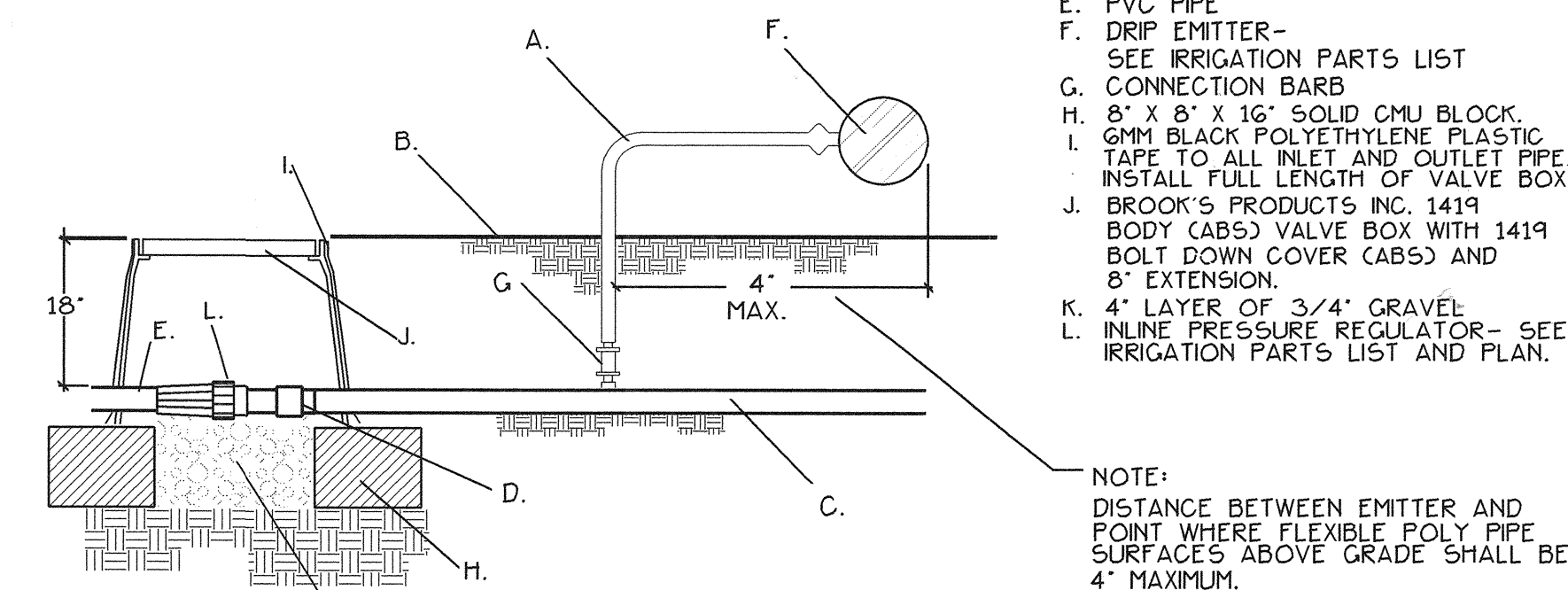
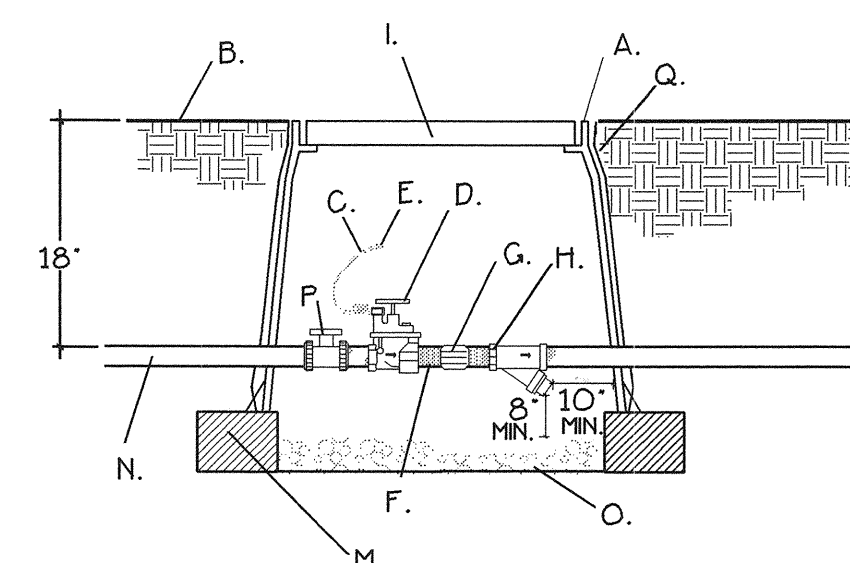
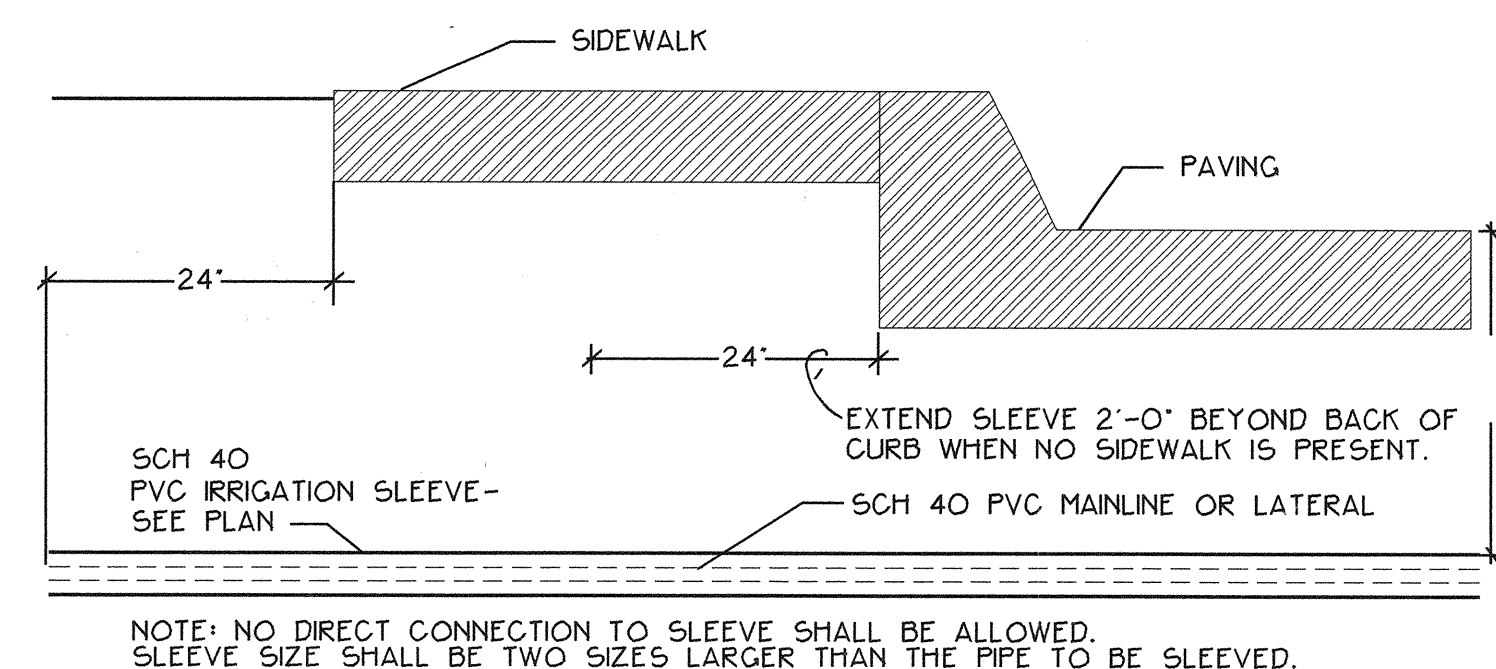

ENGINEER'S SEAL			SURVEY INFORMATION		BENCH MARKS		AS-BUILT INFORMATION	
			FIELD NOTES				CONTRACTOR	
			NO.	BY	DATE			DATE
						WORK SPACED BY:		DATE
						INSPECTION ACCEPTANCE BY:		DATE
						FIELD LOCATION BY:		DATE
						DRAWINGS CORRECTED BY:		DATE
						MICRO-FILM INFORMATION		
						RECORDED BY:		DATE
						NO.		





STATE OF NEW MEXICO  
THOMAS A. GAY  
No. 246  
LICENSED PROFESSIONAL ENGINEER  
EXPIRES 12/31/96

DESIGNED BY: TAG  
DATE: 8/9/96

DRAWN BY: PAA  
DATE: 8/9/96

8-9-96

	<b>BOHANNAN-HUSTON INC.</b> <i>ENGINEERS • PLANNERS • PHOTOGRAMMETRISTS • SURVEYORS • LANDSCAPE ARCHITECTS</i> <b>ALBUQUERQUE      LAS CRUCES      SANTA FE</b>
	<b>CITY OF ALBUQUERQUE</b> <b>PUBLIC WORKS DEPARTMENT</b> <b>ENGINEERING DEVELOPMENT GROUP</b>