

**TYPICAL SECTION AT BACK OF CURB
ON VISTA ALEGRE**
N.T.S.

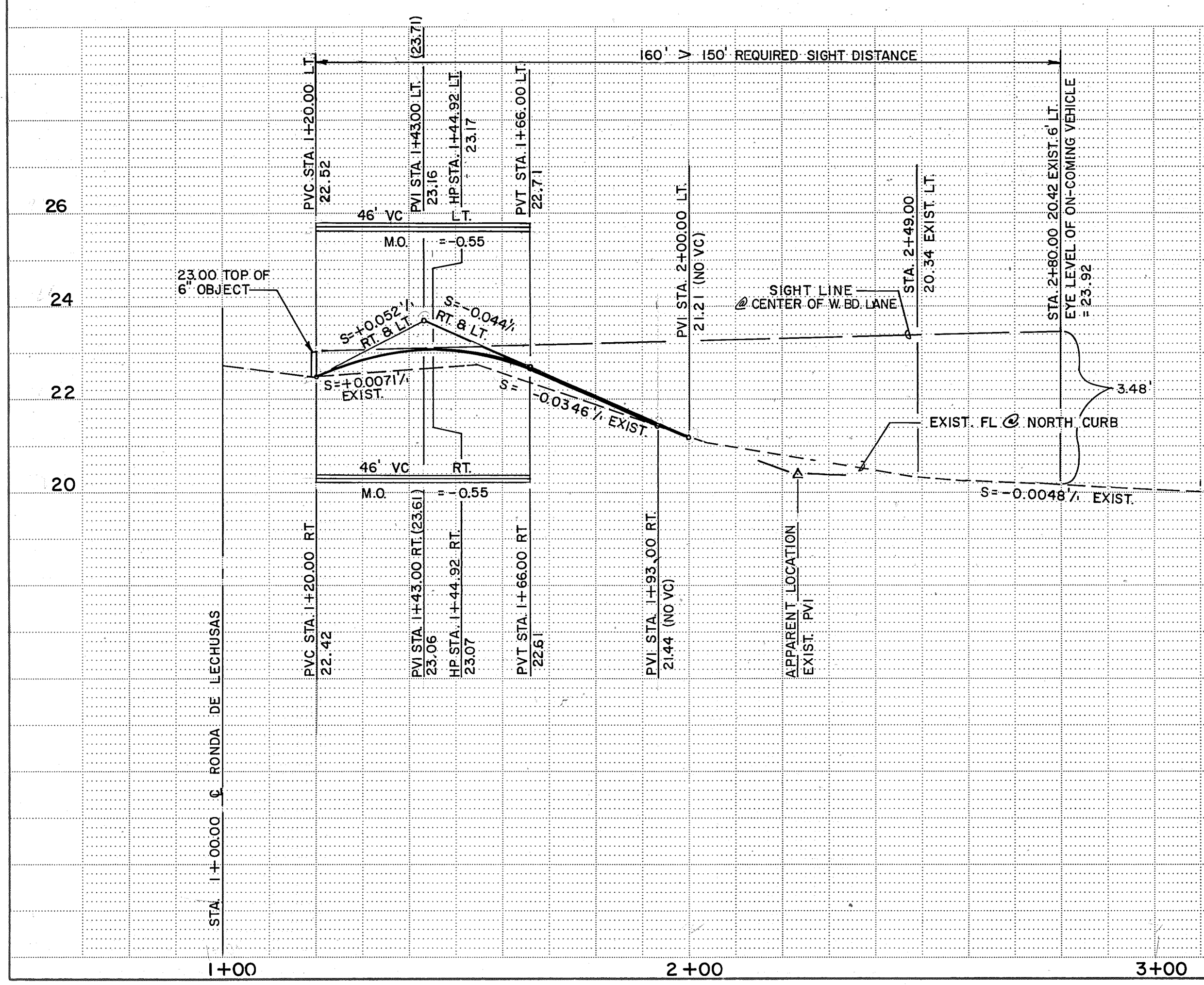

SIGHT DISTANCE CALCULATIONS

HT. of Object = $0.5' + 22.50' = 23.00'$ @ STA 1+20.00, 6' LT
 HP of VC @ 6' LT = $23.14'$ @ STA 1+44.92, 6' LT
 Slope of Sight Line = $(23.14' - 23.00') / (144.92 - 120.00) = 0.0056$
 $23.00 + 0.0056 \times 160 = 23.90'$ @ STA 2+80, 6' LT
 Exist elev @ 6' LT STA 2+80 = 20.42
 Eye level = 23.92 VS 23.90 LINE OF SIGHT, OK
 160' > 150' required sight distance for 25 MPH design speed.

APPROVAL OF AS BUILT DRAWINGS
 CHIEF CONSTRUCTION ENGINEER
[Signature]
 DATE 8-29-94

1 2 3 4 5 6 7 8 9 10 11 12 13 14 15
 26 4776.910194

APPROVED FOR
 CITY ENGINEER
[Signature]
 DATE 8-29-94

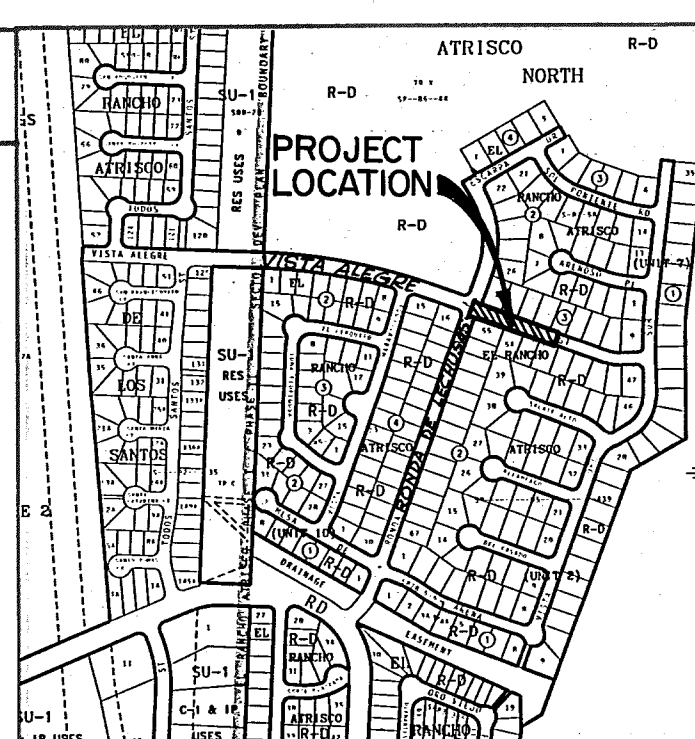

GENERAL NOTES:

- ALL WORK DETAILED ON THESE PLANS TO BE PERFORMED UNDER CONTRACT SHALL, EXCEPT AS OTHERWISE STATED OR PROVIDED FROM HEREON, BE CONSTRUCTED IN ACCORDANCE WITH THE CITY OF ALBUQUERQUE STANDARD SPECIFICATIONS FOR PUBLIC WORKS CONSTRUCTION, 1986 EDITION AS AMENDED WITH UPDATE NO. 4.
- TWO (2) WORKING DAYS PRIOR TO ANY EXCAVATION, CONTRACTOR MUST LINE LOCATING SERVICE, (260-1990) FOR LOCATION OF EXISTING UTILITIES.
- PRIOR TO CONSTRUCTION, THE CONTRACTOR SHALL EXCAVATE AND VERIFY THE HORIZONTAL AND VERTICAL LOCATIONS OF ALL OBSTRUCTIONS AND EXISTING PAVEMENT. SHOULD A CONFLICT EXIST, THE CONTRACTOR SHALL NOTIFY THE ENGINEER THAT THE CONFLICT CAN BE RESOLVED WITH MINIMUM AMOUNT OF DELAY.
- CONTRACTOR SHALL NOTIFY THE PROJECT ENGINEER NOT LESS THAN SEVEN (7) DAYS PRIOR TO STARTING WORK IN ORDER THAT THE ENGINEER MAY TAKE NECESSARY MEASURES TO INSURE THE PRESERVATION OF SURVEY MONUMENTS. CONTRACTOR SHALL NOT DISTURB PERMANENT SURVEY MONUMENTS WITHOUT THE CONSENT OF THE ENGINEER AND BEAR THE EXPENSE OF REPLACING ANY THAT MAY BE DISTURBED WITHOUT PERMISSION. REPLACEMENT SHALL BE DONE ONLY BY THE ENGINEER. WHEN A CHANGE IS MADE IN ANY ROADWAY IN WHICH A PERMANENT SURVEY MONUMENT IS LOCATED, CONTRACTOR SHALL, AT HIS OWN EXPENSE, ADJUST THE MONUMENT COVER TO THE NEW GRADE UNLESS OTHERWISE SPECIFIED. REFER TO SECTION 4.4 OF GENERAL CONDITIONS OF THE CITY OF ALBUQUERQUE STANDARD SPECIFICATIONS FOR PUBLIC WORKS CONSTRUCTION.
- THE CONTRACTOR SHALL CONTACT WATER SYSTEMS DIVISION (857-8200) THREE (3) WORKING DAYS PRIOR TO NEEDING SHUT-OFF OR TURN-ON OF VALVES. ONLY CITY WATER SYSTEMS PERSONNEL ARE AUTHORIZED TO OPERATE VALVE.
- THREE (3) WORKING DAYS PRIOR TO BEGINNING CONSTRUCTION, THE CONTRACTOR SHALL SUBMIT TO THE CONSTRUCTION COORDINATION DIVISION A DETAILED CONSTRUCTION SCHEDULE. TWO (2) WORKING DAYS PRIOR TO CONSTRUCTION, THE CONTRACTOR SHALL OBTAIN A BARRICADING PERMIT FROM THE CONSTRUCTION COORDINATION DIVISION. CONTRACTOR SHALL NOTIFY BARRICADING ENGINEER (768-2551) PRIOR TO OCCUPYING AN INTERSECTION. SEE SECTION 19 OF THE SPECIFICATIONS.
- ALL STREET STRIPING ALTERED OR DESTROYED SHALL BE REPLACED IN KIND BY CONTRACTOR TO LOCATION AND IN KIND AS EXISTING OR AS INDICATED BY THIS PLAN SET. ALL NEW STRIPING SHALL BE PLASTIC AS PER CITY STANDARDS.

SCALE:
 1" = 20' HORIZ.
 1" = 2' VERT.

CITY OF ALBUQUERQUE
 PUBLIC WORKS DEPARTMENT
 ENGINEERING GROUP

TITLE: INTERSECTION OF VISTA ALEGRE STREET NW
 AND RONDA DE LECHUSAS NW

APPROVALS	ENGINEER	DATE	APPROVALS	ENGINEER	DATE
DRG CHAIRMAN	<i>[Signature]</i>	2-1-94	WATER	<i>[Signature]</i>	1-7-94
TRANSPORTATION	<i>[Signature]</i>	1-12-94	WASTE WATER	<i>[Signature]</i>	1-7-94
HYDROLOGY	<i>[Signature]</i>	1-13-94			

PROJECT NO. 4776.91
 MAP NO. G-10
 SHEET 1 OF 1

AS BUILT INFORMATION	
CONTRACTOR	CH, INC.
WORK ORDER NO.	400001
DATE	7/94
INSPECTOR'S ACCEPTANCE	DATE 7/94
VERIFICATION BY	DATE 7-94
RECORDED BY	DATE 7-94
MICRO-FILM INFORMATION	
RECORDED BY	DATE
NO.	

BENCH MARKS	
THE STATION IS A STANDARD AS BUILT SET IN A 2" X 4" IRON PIPE 1 FT. ABOVE GROUND. STA. IS LOCATED ON TOP OF A VOLCANIC OUTCROP. TO REACH THIS STA. BEGIN AT 1-40 & CROSS RD. WEST ON DART RD. 0.7 MILE TO END OF PAVEMENT. CONTINUE WEST ON DIRT RD. TO TOP OF DIRT MILE. THE STATION IS ABOUT 800 FT. WEST OF THIS POINT.	ELEVATION = 5334.50 FT.

SURVEY INFORMATION	
FIELD NOTES	DATE 10/93
BY	COMMUNITY SCIENCES
NO.	1

ENGINEER'S SEAL
[Signature]
 10274
 11-15-93

REVISIONS	
NO.	DATE
DESIGNED BY	DATE 11/93
DRAWN BY	DATE 11/93
CHECKED BY	DATE 11/93