

CONSTRUCTION PLANS FOR
ALAMEDA PRV STATION
ALAMEDA AND BARSTOW BLVD.

CITY OF ALBUQUERQUE PROJECT NUMBER 5103.13
MARCH 1997

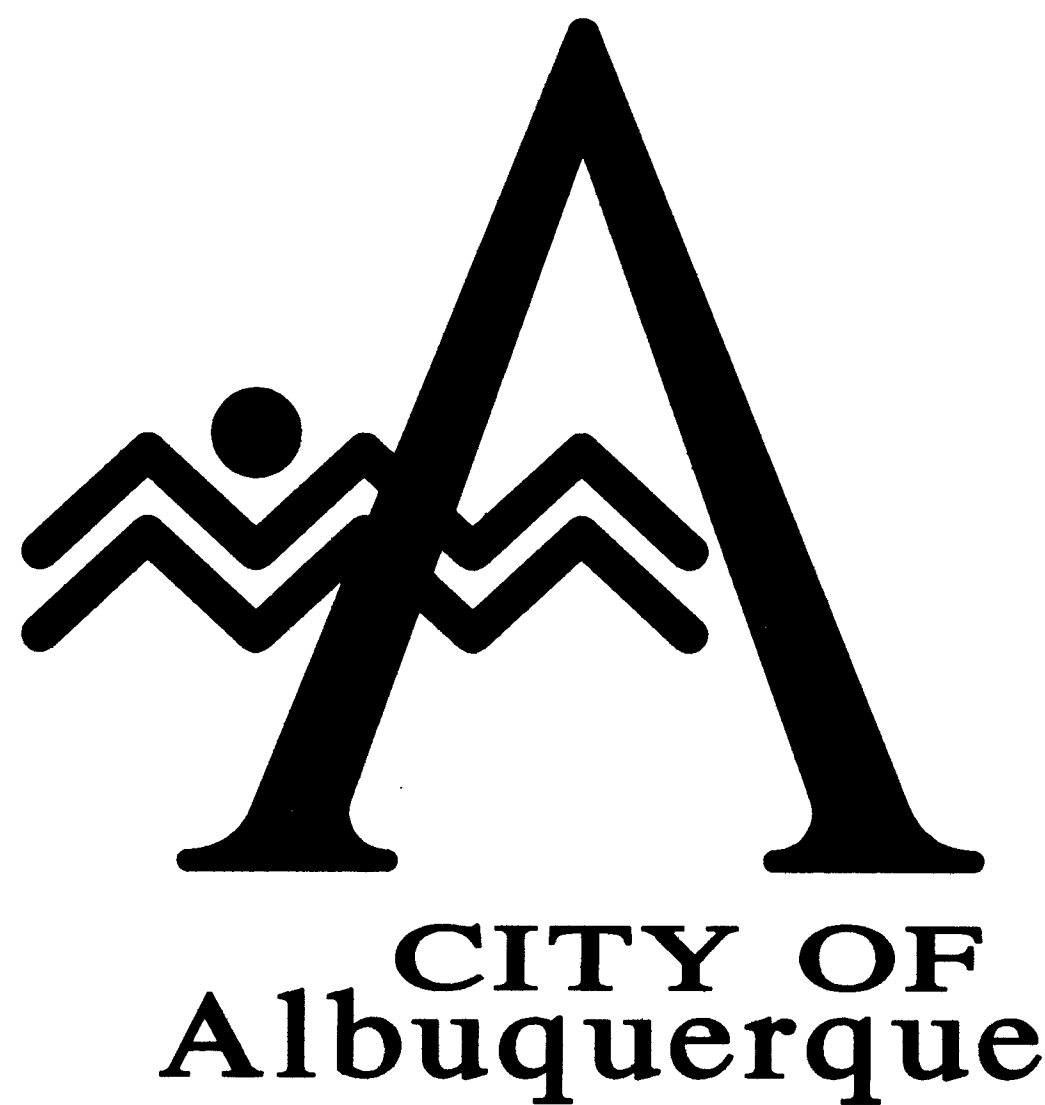
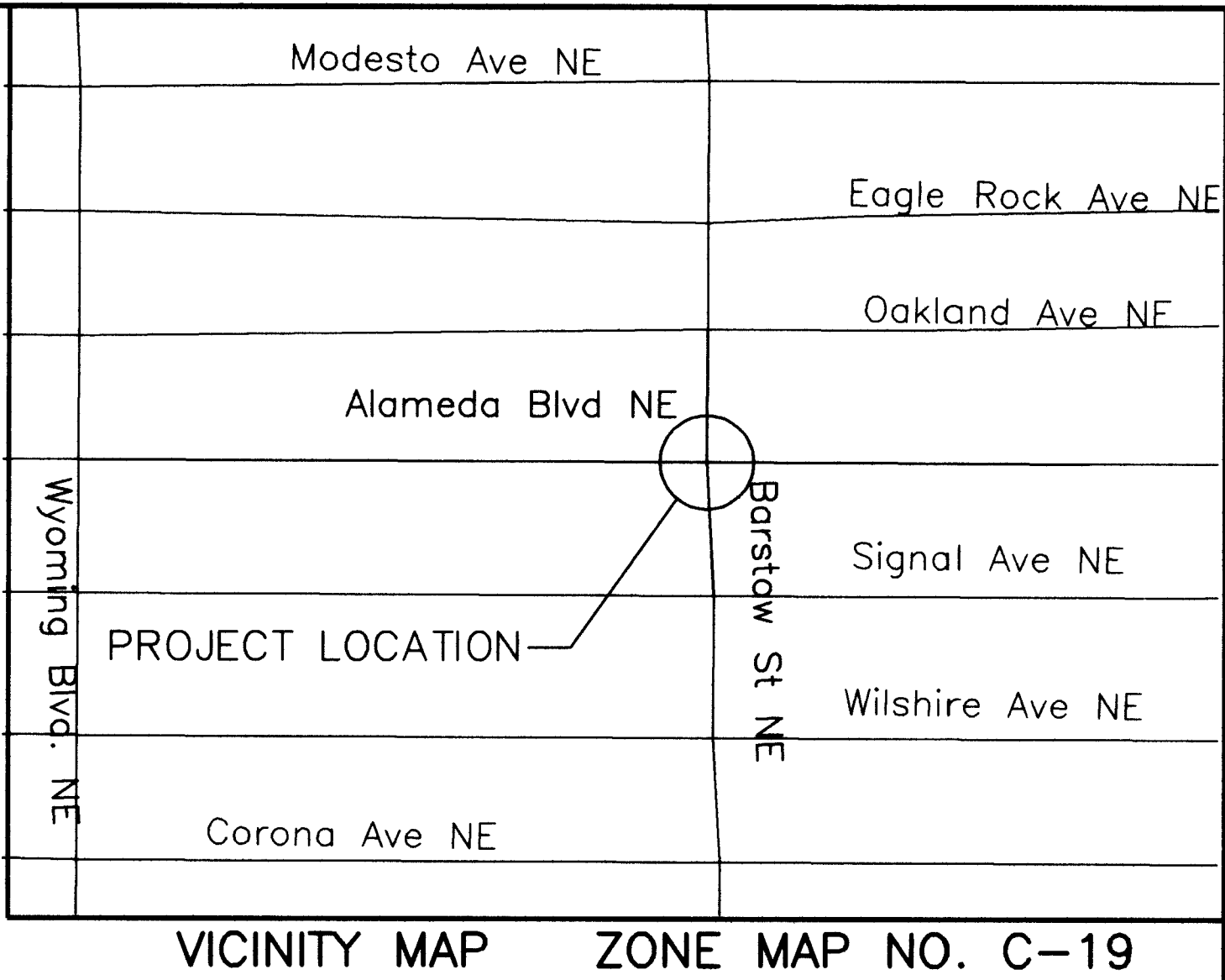

INDEX

SHEET NO.	SHEET TITLE
1.	TITLE SHEET, VICINITY MAP
2.	GENERAL NOTES AND DETAIL SHEET
3.	PRV STATION STRUCTURAL DETAILS
4.	PRV STATION PIPING DETAILS
5.	SIGNING AND CONSTRUCTION TRAFFIC CONTROL STANDARDS
6.	TYPICAL TRAFFIC CONTROL & SIGNING (REF. M.U.T.C.D.)
7.	PLAN AND PROFILE - BARSTOW AND ALAMEDA



1 2 3 4 5 6 7 8 9 10 11 12 13 14 15
26 51 03.11398C19

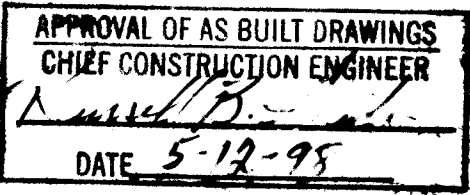

SCANNED BY
BY LASON

RECORD DRAWING
Drawing revised to reflect the
best information available. Do
not use without field verification.

REV.	SHEETS	CITY ENGINEER	DATE	USER DEPARTMENT	DATE	USER DEPARTMENT	DATE
ENGINEERS STAMP & SIGNATURE		APPROVALS		ENGINEER	DATE	*****	
		DRC Chairman	<i>Silvestro</i>	4-5-97	APPROVED FOR CONSTRUCTION		
		Transportation	<i>Silvestro</i>	4-5-97			
		Water/Wastewater	<i>Silvestro</i>	4-5-97			
		Hydrology	<i>Silvestro</i>	4-5-97			
		Parks	<i>Silvestro</i>	4-5-97			
CITY PROJECT No.		5103.13		Sheet 1 of 7			

1. THE CONTRACTOR SHALL PROVIDE INGRESS AND EGRESS TO LOCAL BUSINESSES AND RESIDENCES FOR THE DURATION OF THE PROJECT. THE CONTRACTOR SHALL ADVISE OF ANY SCHEDULED ACCESS CLOSURES, AT LEAST 24 HOURS IN ADVANCE, WITH PROPERTY OWNERS AND THE CONSTRUCTION PROJECT MANAGER.
2. TWO (2) WORKING DAYS PRIOR TO ANY EXCAVATION, CONTRACTOR MUST CONTACT N.M. ONE-CALL SYSTEM, 260-1990, FOR LOCATION OF EXISTING UTILITIES.
3. WHEN ABUTTING NEW PAVEMENT TO EXISTING, CONTRACTOR SHALL SAW CUT, TO FULL PAVEMENT DEPTH, THE EXISTING PAVEMENT TO A NEAT VERTICAL STRAIGHT LINE AS REQUIRED TO REMOVE ANY BROKEN OR CRACKED PAVEMENT AND MATCH NEW TO EXISTING.
4. THE CONTRACTOR SHALL ASSUME RESPONSIBILITY FOR ANY DAMAGE TO EXISTING PAVEMENTS, PAVEMENT MARKINGS, CURB AND GUTTER, DRIVEPADS, WHEELCHAIR RAMPS OR SIDEWALK DURING CONSTRUCTION. APART FROM THOSE SECTIONS INDICATED FOR REMOVAL ON THE PLANS, AND SHALL REPAIR OR REPLACE PER CITY OF ALBUQUERQUE STANDARDS AT HIS OWN EXPENSE.
5. ALL STRIPING AND PAVEMENT MARKINGS SHALL BE REPLACED WITH REFLECTORIZED PLASTIC PAVEMENT MARKINGS BY CONTRACTOR TO EXISTING LOCATION OR AS INDICATED BY THIS PLAN SET.
6. CONTRACTOR SHALL BE RESPONSIBLE FOR ACQUIRING, AT HIS OWN EXPENSE, ALL PERMITS NECESSARY FOR CONSTRUCTION. THREE (3) WORKING DAYS PRIOR TO BEGINNING CONSTRUCTION THE CONTRACTOR SHALL SUBMIT TO THE CONSTRUCTION COORDINATION DIVISION A DETAILED CONSTRUCTION SCHEDULE. TWO (2) WORKING DAYS PRIOR TO THE CONSTRUCTION THE CONTRACTOR SHALL OBTAIN A BARRICADING PERMIT FROM THE CONSTRUCTION COORDINATION DIVISION. THE CONTRACTOR SHALL NOTIFY BARRICADE ENGINEER (768-2551) PRIOR TO OCCUPYING AN INTERSECTION.
7. ALL WORK DETAILED ON THESE PLANS TO BE PERFORMED UNDER THIS CONTRACT SHALL, EXCEPT AS OTHERWISE STATED OR PROVIDED FOR HEREIN, BE CONSTRUCTED IN ACCORDANCE WITH THE CITY OF ALBUQUERQUE STANDARD SPECIFICATIONS FOR PUBLIC WORKS CONSTRUCTION, 1986 EDITION THROUGH UPDATE NO.6.
8. THE CONTRACTOR SHALL COORDINATE HIS CONSTRUCTION ACTIVITIES WITH ALL OTHER CONTRACTORS AND UTILITY COMPANIES WORKING IN THE SAME AREA. THE CONTRACTOR MAY BE REQUIRED TO RESCHEDULE THEIR ACTIVITIES TO ALLOW ADDITIONAL CREWS TO PERFORM THEIR REQUIRED WORK. NO ADDITIONAL COMPENSATION WILL BE ALLOWED FOR DELAYS OR INCONVENIENCE CAUSED BY UTILITY COMPANY WORK CREWS.
9. THE LOCATION OF ALL EXISTING UTILITIES, AS SHOWN ON THE DRAWINGS, IS APPROXIMATE. THE CONTRACTOR SHALL BE RESPONSIBLE FOR MAKING FINAL UTILITY LOCATION DETERMINATION IN THE FIELD DURING CONSTRUCTION. THE CONTRACTOR SHALL FIELD VERIFY LOCATION OF ALL UTILITIES PRIOR TO BEGINNING CONSTRUCTION OF THE PROJECT.
10. THE CONTRACTOR SHALL NOTIFY CITY WATER SYSTEMS (857-8250) A MINIMUM OF FIVE (5) WORKING DAYS PRIOR TO SHUTOFF. ONLY CITY WATER SYSTEMS STAFF MAY OPERATE VALVES.
11. THE CONTRACTOR SHALL TAKE PRECAUTIONS TO PROTECT HORIZONTAL AND VERTICAL CONTROL SURVEY MONUMENTS PRIOR TO INITIATING CONSTRUCTION. IF DURING THE COURSE OF CONSTRUCTION OPERATIONS, THE CONTRACTOR DISTURBS OR DESTROYS A MONUMENT, THE CONTRACTOR SHALL NOTIFY THE CITY SURVEYOR. THE MONUMENT SHALL ONLY BE REPLACED BY THE CITY SURVEY SECTION AT THE CONTRACTOR'S EXPENSE.
12. CONTACT CITY OF ALBUQUERQUE TRAFFIC OPERATIONS (857-8680) BEFORE DISTURBING TRAFFIC SIGNAL EQUIPMENT OR LOOP DETECTORS.
13. THE CONTRACTOR SHALL PROPERLY HANDLE AND DISPOSE OF ALL ASPHALT PAVING MATERIAL REMOVED ON THE PROJECT BY HAULING TO AN APPROVED LANDFILL IN ACCORDANCE WITH REGULATIONS OF THE NEW MEXICO SOLID WASTE ACT.
14. ALL NEW STREET PAVING, CURB AND GUTTER, SIDEWALKS OR DRIVEPADS SHALL MATCH THE ELEVATIONS OF ABUTTING EXISTING AREAS.
15. ALL WORK IMPACTING AN ARTERIAL ROADWAY WILL REQUIRE 24-HR CONSTRUCTION IN ACCORDANCE WITH THE CITY OF ALBUQUERQUE'S ORANGE BARREL POLICY.
16. THE CONTRACTOR SHALL BE RESPONSIBLE FOR REPLACING ANY TRAFFIC SIGNS, SIGNALS, OR CONTROL DEVICES THAT ARE REMOVED DURING CONSTRUCTION. THIS SHALL BE CONSIDERED INCIDENTAL TO THE TRENCHING, BACKFILL, AND COMPACTION BID ITEM IN ACCORDANCE WITH THE CONTRACT PRICE AND NO ADDITIONAL PAYMENT SHALL BE MADE.
17. ALL COMPACTION TO BE PERFORMED DURING THIS PROJECT SHALL BE 95% OF THE MODIFIED PROCTOR PER ASTM D-1557.
18. ALL EXISTING SIGNS WHICH WILL NEED TO BE REMOVED DUE TO CONSTRUCTION ACTIVITY WILL BE REINSTALLED BY THE CONTRACTOR IN ACCORDANCE WITH M.U.T.C.D. REQUIREMENTS. PAYMENT FOR REMOVAL AND REINSTALLATION OF SIGNS WILL BE CONSIDERED INCIDENTAL TO CONSTRUCTION AND NO ADDITIONAL PAYMENT WILL BE MADE. ANY SIGNS WHICH ARE DAMAGED DURING REMOVAL OR REINSTALLATION SHALL BE REPLACED IN-KIND BY THE CONTRACTOR AT HIS EXPENSE.
19. ALL EXCAVATIONS SHALL BE IN ACCORDANCE WITH OSHA 29CFR 1926.650.
20. THE PRV STATION IS A CONFINED SPACE AND ACTIVITIES MUST COMPLY WITH OSHA 29 CFR 1910.146.

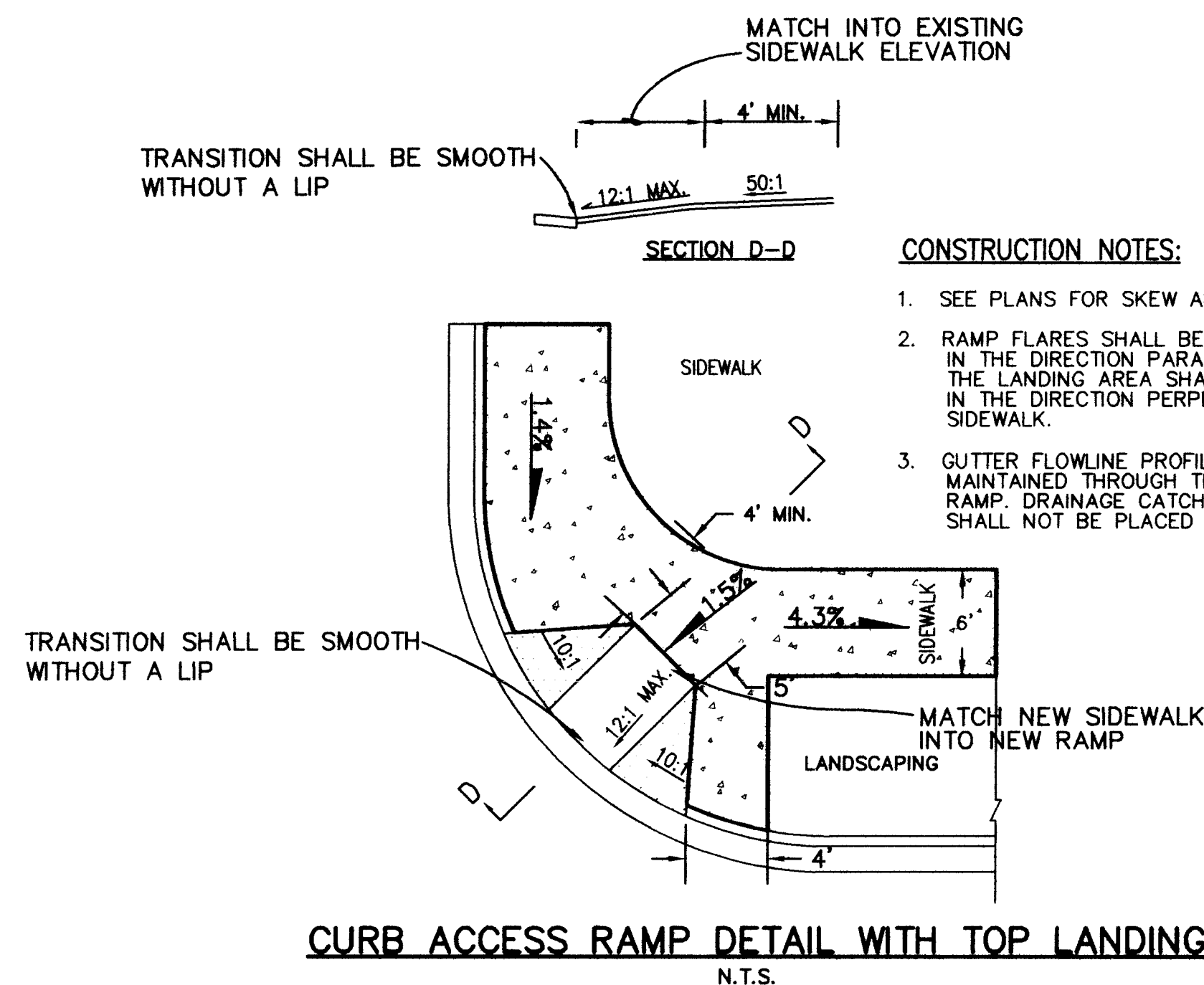
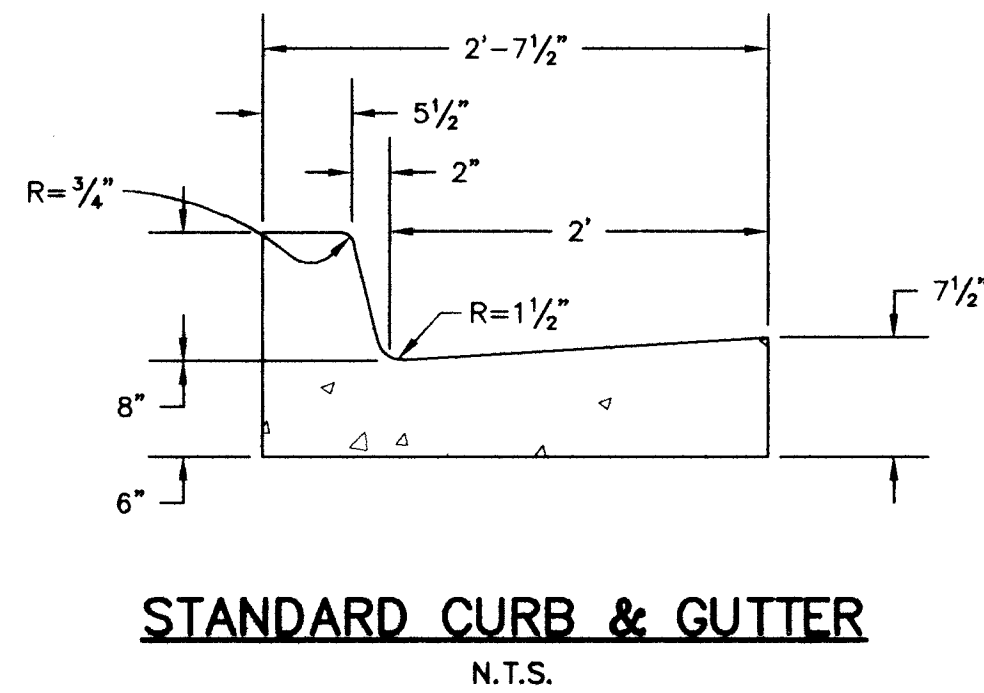

UTILITY OWNERS TELEPHONE	A.T. & T. ISHMAEL PANTOJA (505)842-2806 U.S. WEST COMMUNICATIONS NORMA CARRILLO (505)245-8706
ELECTRICITY	P.N.M. ELECTRIC SERVICES JIM VANN (505)848-3426
GAS	P.N.M. GAS SERVICES DEBBIE O'CALLAGHAN (505)241-7705
CABLE TELEVISION	JONES INTERCABLE KAREN SHORE (505)761-6220
WATER	CITY OF ALBUQUERQUE (505)857-8200
SEWER	CITY OF ALBUQUERQUE (505)873-6200

[illegible]

Gannett Fleming West, Inc.
ENGINEERS AND PLANNERS

CITY OF ALBUQUERQUE
PUBLIC WORKS DEPARTMENT
ENGINEERING DEVELOPMENT GROUP

TITLE: ALAMEDA PRV STATION
GENERAL NOTES AND DETAILS

[illegible]

City Project No.	Zone Map No.
5103.13	C-19

RECORD DRAWING
Drawing revised to reflect the
best information available. Do
not use without field verification

PRV VAULT DIMENSION AND REINFORCING SCHEDULE																				
STANDARD PRV VAULT DIMENSIONS													WALL REINFORCING							
PIPE SIZE (IN)	STANDARD PRV NO METER, NO BYPASS		STANDARD PRV NO METER, W/BYPASS		WITH PROPELLER METER AND NO BYPASS		WITH PROPELLER METER AND BYPASS		WITH MAGNETIC FLOW METER AND BYPASS		WALL THICKNESS		TOP THICKNESS		WITHOUT BYPASS			WITH BYPASS		
	"L"	"W"	"L"	"W"	"L"	"W"	"L"	"W"	"L"	"W"	L(t)	W(t)	T(t)	T(t)	"L"	"W"	"L"	"W"	"L"	"W"
															a	a	b	a	a	b
6	10'-6"	5'-6"	11'-8"	8'-0"	10'-6"	5'-6"	14'-6"	8'-0"	15'-8"	8'-6"	1'-0"	1'-0"	1'-0"	0'-8"	#6 @ 12"	TYPICAL	TYPICAL	#5 @ 6"	TYPICAL	#6 @ 12"
8	10'-6"	5'-8"	12'-0"	8'-2"	10'-6"	5'-8"	15'-4"	8'-2"	16'-2"	8'-8"	1'-0"	1'-0"	1'-0"	0'-8"	#6 @ 12"	TYPICAL	TYPICAL	#5 @ 6"	TYPICAL	#6 @ 12"
10	10'-6"	5'-10"	13'-0"	8'-4"	11'-4"	5'-10"	17'-4"	8'-4"	17'-4"	8'-10"	1'-0"	1'-0"	1'-0"	0'-8"	#6 @ 12"	#6 @ 12"	TYPICAL	#5 @ 6"	#6 @ 12"	#6 @ 12"
12	10'-6"	6'-0"	13'-8"	8'-6"	12'-8"	6'-0"	19'-0"	8'-6"	18'-4"	9'-0"	1'-0"	1'-0"	1'-0"	0'-8"	#6 @ 12"	#6 @ 12"	TYPICAL	#5 @ 6"	#6 @ 12"	#6 @ 12"
14	10'-6"	6'-2"	14'-9"	8'-8"	14'-3"	6'-2"	21'-6"	8'-8"	20'-2"	9'-2"	1'-0"	1'-2"	1'-0"	0'-8"	#5 @ 6"	#5 @ 6"	#6 @ 12"	#5 @ 6"	#5 @ 6"	#6 @ 12"
16	10'-6"	6'-4"	15'-4"	8'-10"	16'-6"	6'-4"	24'-2"	8'-10"	21'-0"	9'-4"	1'-0"	1'-2"	1'-0"	0'-8"	#5 @ 6"	#5 @ 6"	#6 @ 12"	#5 @ 6"	#5 @ 6"	#6 @ 12"

DIMENSIONAL NOTES:

"L"=VAULT LENGTH

"W"=VAULT WIDTH

L(t)=WALL THICKNESS(LENGTH)

W(t)=WALL THICKNESS(WIDTH)

T(t)=TOP SLAB THICKNESS

WALL REINFORCING NOTES:

1. "a" BAR DESIGNATION REPRESENTS WALL DOWELS PROTRUDING VERTICALLY FROM BASE SLAB ALONG LENGTHWISE DIMENSION "L" OR WIDTH DIMENSION "W".

2. "b" BAR DESIGNATION REPRESENTS ADDITIONAL HORIZONTAL WALL CORNER REINFORCING.

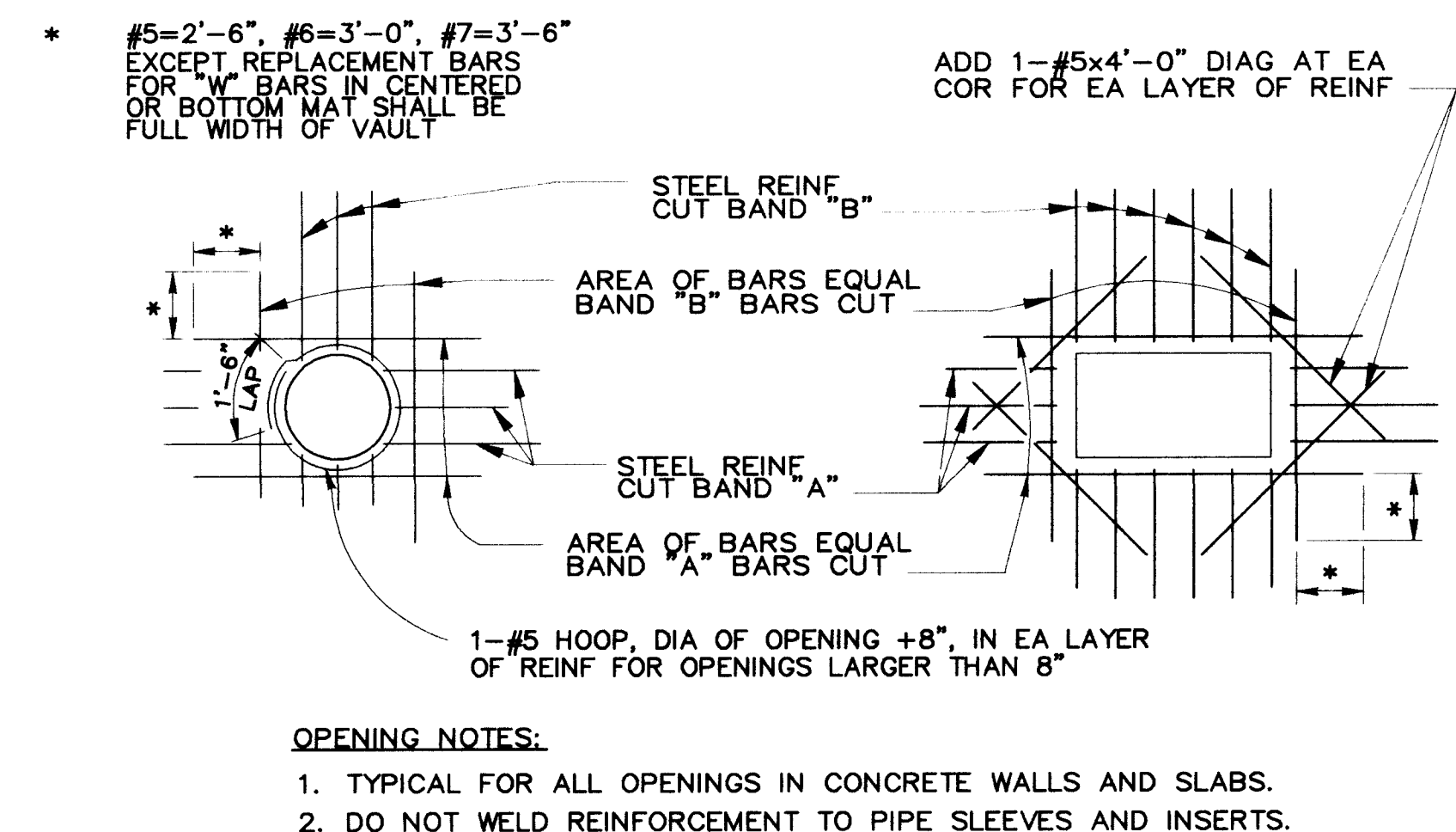
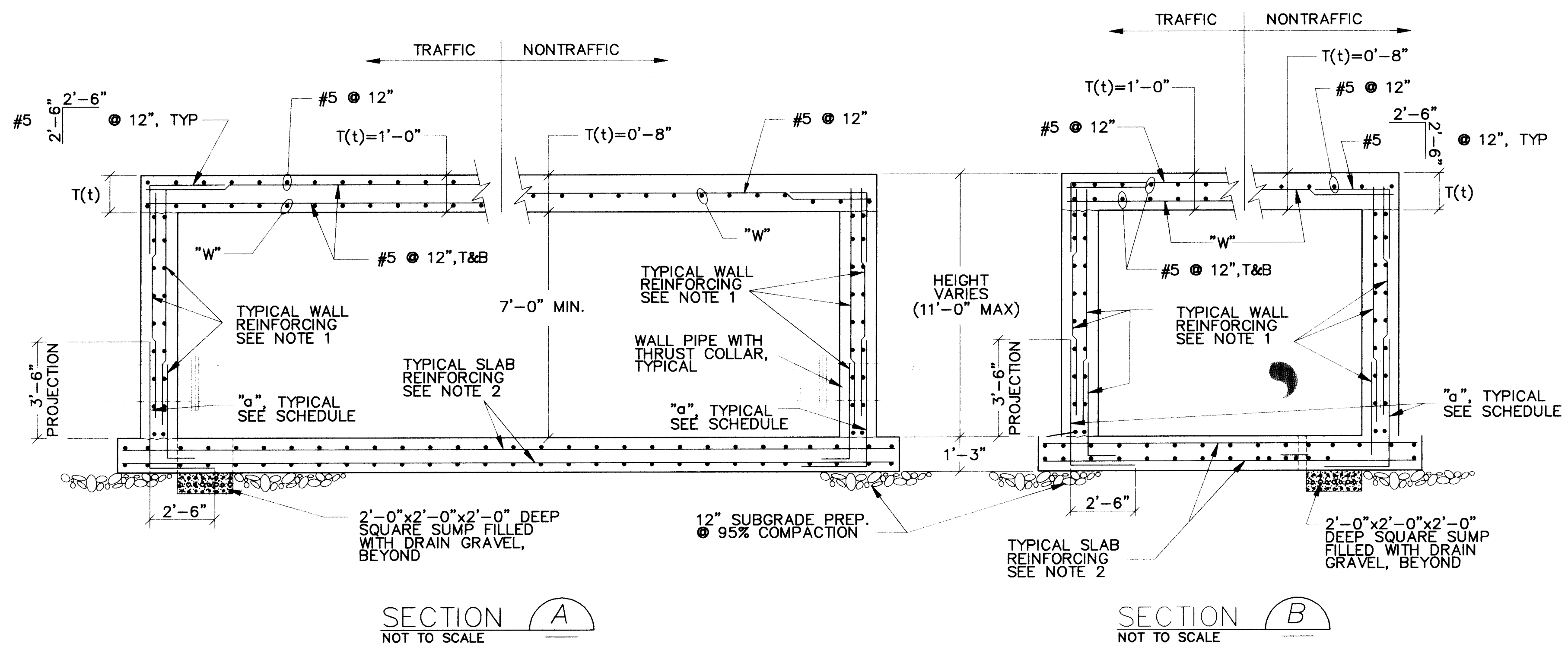
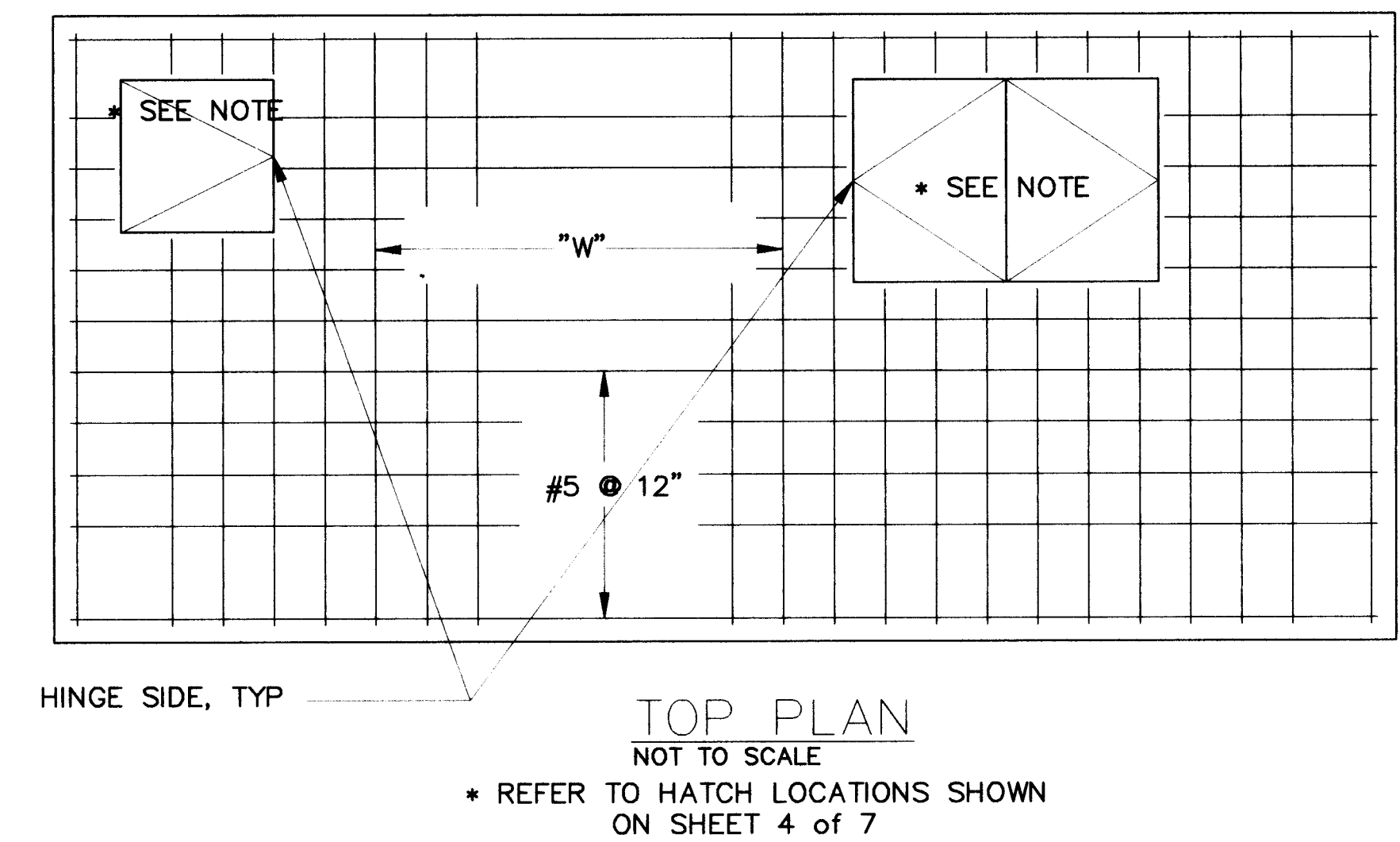
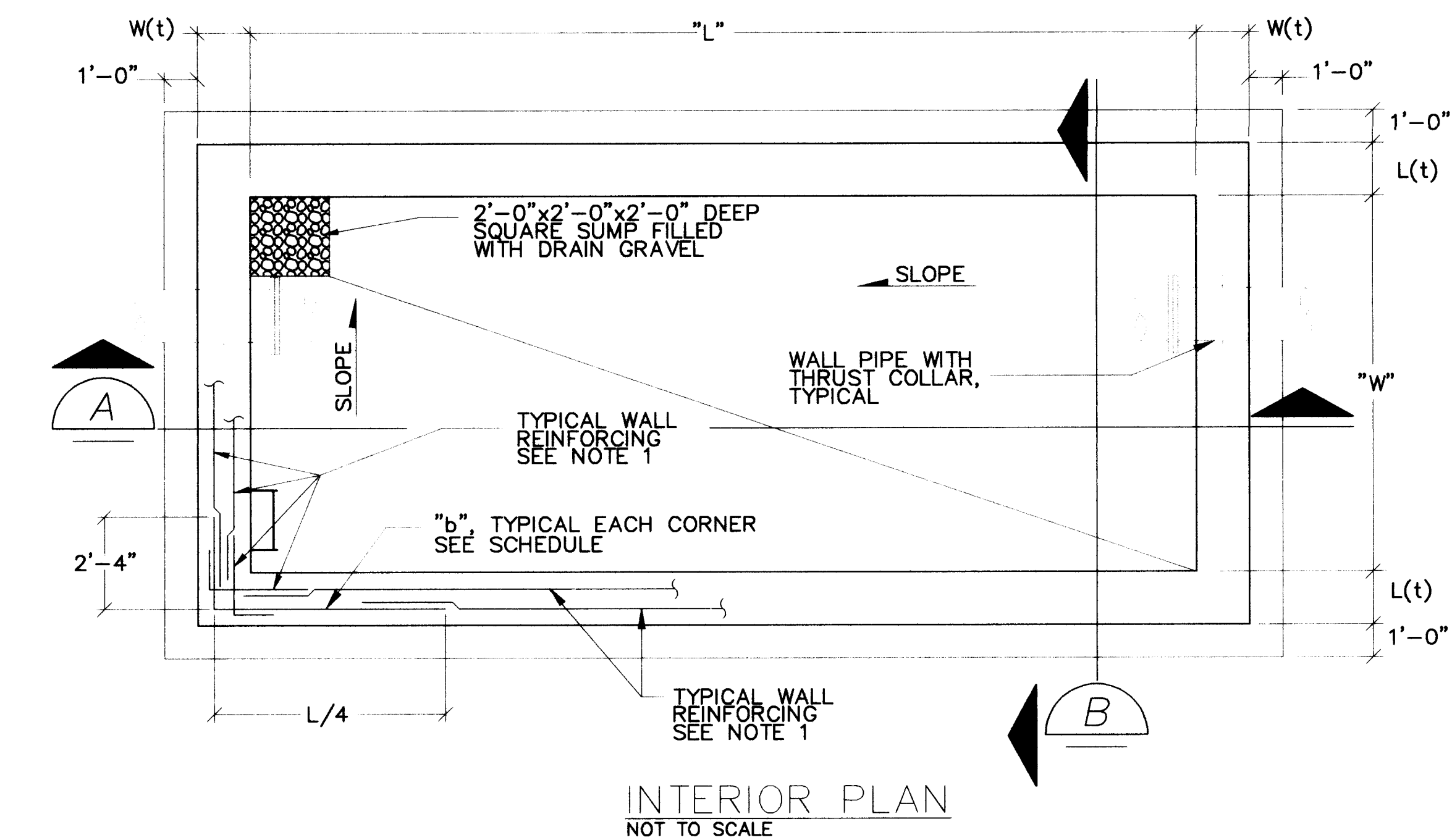

VAULT TOP REINFORCING		
VAULT DIMENSION	REINFORCING	
	T(t)=0'-8"	T(t)=1'-0"
"W"	"W"	"W"
≤ 6'-0"	#5 @ 12"	#5 @ 12"
> 6'-0" ≤ 7'-0"	#5 @ 12"	#6 @ 12"
> 7'-0" ≤ 9'-0"	#6 @ 12"	#7 @ 12"
> 9'-0" ≤ 10'-0"	#7 @ 12"	#7 @ 12"

- GENERAL NOTES:**
- DETAILS SHOWN ON THIS PLAN SHEET ARE FROM THE CITY OF ALBUQUERQUE'S STANDARD DRAWING NO. 2357 (STANDARD PRV STATION STRUCTURAL DETAILS) AS MODIFIED HEREIN. THE STANDARD PRV VAULT DIMENSIONS TO BE USED FOR THIS DIMENSION AND REINFORCING SCHEDULE SHOWN ON THIS SHEET FOR A 10-INCH PRV STATION WITH MAGNETIC FLOW METER AND BYPASS. THE VAULT TOP THICKNESS SHALL BE FOR NONTRAFFIC CONDITIONS.
 - THE DIMENSIONS AND LOCATIONS OF OPENINGS SHALL BE IN ACCORDANCE WITH THE PRV STATION DETAILS ON SHEET 4 OF 7.

- CONSTRUCTION NOTES: ALAMEDA PRV**
- TYPICAL WALL REINFORCING SHALL BE #5 @ 12" O.C. EACH WAY, EACH FACE UNLESS SHOWN OTHERWISE ON THE SCHEDULE. PROVIDE BARS AS INDICATED ON THE SCHEDULE AND LAP WITH #5 @ 12" FOR REMAINDER OF WALL HEIGHT OR LENGTH.
 - TYPICAL BASE SLAB REINFORCING SHALL BE #5 @ 12" EACH WAY, TOP AND BOTTOM OF SLAB.
 - CONCRETE SHALL BE IN ACCORDANCE WITH SPECIFICATION SECTION 510 WITH F'c = 4000 PSI. ALL REINFORCING STEEL SHALL BE GRADE 60.
 - ALAMEDA PRV SHALL BE CONSTRUCTED FOR NON-TRAFFIC INSTALLATION.
 - OPENINGS SHALL BE LOCATED IN LANDSCAPE AREA AND SHALL BE OUT OF SIDEWALK.
 - INSTALL 3/4" EXPANSION JOINT BETWEEN PRV VAULT AND ALL SIDEWALK AND CURB AND GUTTER.
 - PRECAST CONCRETE OR PREFABRICATED STEEL VAULT MAY BE USED IN LIEU OF CAST-IN-PLACE CONCRETE. CONTRACTOR SHALL PROVIDE OWNER WITH COMPLETE CALCULATIONS SUPPORTING THE SUBSTITUTION.

Gannett Fleming West, Inc.
ENGINEERS AND PLANNERS

CITY OF ALBUQUERQUE
PUBLIC WORKS DEPARTMENT
ENGINEERING DEVELOPMENT GROUP

TITLE:
ALAMEDA PRV STATION
PRV STATION STRUCTURAL DETAILS

DESIGN REVIEW COMMITTEE
CITY ENGINEER
DESIGN
REVIEW COMMITTEE
CITY ENGINEER

City Project No. 5103.13
Zone Map No. C-19
Sheet 3 of 7

AS-BUILT INFORMATION		BENCH MARKS		SURVEY INFORMATION		ENGINEER'S SEAL	
CONTRACTOR	Albuquerque Underground	DATE	1/98	NO.	BY	NO.	BY
STANDARD	Albuquerque Underground	DATE	1/98	NO.	BY	NO.	BY
FIELD	Albuquerque Underground	DATE	1/98	NO.	BY	NO.	BY
REVISIONS	Albuquerque Underground	DATE	1/98	NO.	BY	NO.	BY
CORRECTED BY	CPW	DATE	3/98	NO.	BY	NO.	BY
RECORDED BY		DATE		NO.	BY	NO.	BY

CONSTRUCTION TRAFFIC CONTROL GENERAL NOTES

1. CONTRACTOR MUST OBTAIN FROM CONSTRUCTION COORDINATION AN EXCAVATION/BARRICADING PERMIT BEFORE ENGAGING IN ANY CONSTRUCTION, MAINTENANCE OR REPAIR WORK IN ANY OF THE CITY OF ALBUQUERQUE'S RIGHTS-OF-WAY. EMERGENCY WORK THAT WOULD PRESERVE LIFE OR PROPERTY IS EXCLUDED WITH THE UNDERSTANDING, THAT A PERMIT SHALL BE OBTAINED WITHIN 24 TO 48 HOURS.

2. CONTRACTOR SHALL AT THE TIME OF PERMIT REQUEST, SUBMIT FOR APPROVAL BY CONSTRUCTION COORDINATION, A TRAFFIC CONTROL PLAN DETAILING ALL EXISTING TOPOGRAPHY SUCH AS LANE WIDTHS, DRIVEWAYS, AND BUSINESS/RESIDENTIAL ACCESSES. THE TRAFFIC CONTROL PLAN SHALL INCLUDE ALL PHASES OF WORK AND SCHEDULES INVOLVED IN THE CONSTRUCTION PROJECT. ANY SEPARATE PHASES OF A CONSTRUCTION PROJECT SHALL BE GIVEN AN INDIVIDUAL PERMIT EACH. BLANKET PERMITS WILL NOT BE ISSUED.

3. TYPICAL TRAFFIC CONTROL PLANS DO NOT REFLECT THE EXISTING TOPOGRAPHY SUCH AS DRIVEWAYS, LANE WIDTHS, AND BUSINESS/RESIDENTIAL ACCESSES. EVERY LOCATION THAT REQUIRES CONSTRUCTION TRAFFIC CONTROL SHALL HAVE A DETAILED TRAFFIC CONTROL PLAN SHOWING ALL EXISTING TOPOGRAPHY.

4. CONSTRUCTION SHALL NOT BEGIN UNLESS A TRAFFIC CONTROL PLAN HAS BEEN APPROVED AND VERIFIED BY CONSTRUCTION COORDINATION.

5. CONSTRUCTION COORDINATION SHALL BE NOTIFIED 48 HOURS PRIOR TO ANY TRAFFIC CONTROL CHANGES NEEDED BY CONTRACTOR, THAT WERE NOT PREVIOUSLY APPROVED. THESE TRAFFIC CONTROL CHANGES SHALL BE REQUESTED IN WRITING ACCOMPANIED WITH A TRAFFIC CONTROL PLAN REFLECTING SUCH CHANGES.

6. ALL CONSTRUCTION TRAFFIC CONTROL DEVICES SHALL COMPLY WITH THE MANUAL ON UNIFORM TRAFFIC CONTROL DEVICES (MUTCD), LATEST EDITION. IT IS THE RESPONSIBILITY OF THE CONTRACTOR TO INSTALL, SERVICE AND MAINTAIN ALL TRAFFIC CONTROL DEVICES. TRAFFIC CONTROL DEVICES SHALL NOT BE REMOVED OR ALTERED IN ANY WAY WITHOUT THE APPROVAL OF CONSTRUCTION COORDINATION, PER SECTION 6A-4 OF THE MUTCD, LATEST EDITION.

7. THE CONSTRUCTION TRAFFIC CONTROL INITIAL SET-UP FOR EACH PHASE SHALL BE BY AN AMERICAN TRAFFIC SAFETY SERVICES ASSOCIATION (ATSSA) CERTIFIED WORKSITE TRAFFIC SUPERVISOR. THE MAINTENANCE AND SERVICING SHALL ALSO BE DONE BY AN ATSSA CERTIFIED WORKSITE TRAFFIC SUPERVISOR OR EQUIVALENT.

8. CONTRACTOR IS RESPONSIBLE TO MAINTAIN AND SERVICE ALL TRAFFIC CONTROL DEVICES 24 HOURS A DAY, 7 DAYS A WEEK THROUGHOUT LENGTH OF PROJECT. CONTRACTOR IS RESPONSIBLE THAT ALL TRAFFIC CONTROL DEVICES COMPLY WITH THE MUTCD, LATEST EDITION.

9. ALL ADVANCE WARNING SIGNS SHALL BE DOUBLE INDICATED WHENEVER THERE IS MULTI-LANE TRAFFIC IN ANY ONE GIVEN DIRECTION AND THERE IS SUFFICIENT MEDIAN SPACE.

10. ALL BARRICADES IN ALL TAPERS AND TANGENTS SHALL BE PLACED APART, A DISTANCE MEASURED IN FEET, EQUAL TO THAT OF THE POSTED SPEED LIMIT. NO EXCEPTIONS UNLESS APPROVED BY CONSTRUCTION COORDINATION PER MUTCD SECTION 6A-4.

11. CONTRACTOR SHALL NOT BEGIN WORK BEFORE 7:00 A.M. OR END WORK AFTER 7:00 P.M. WITHOUT THE APPROVAL OF CONSTRUCTION COORDINATION.

12. CONTRACTOR IS RESPONSIBLE TO PROVIDE CONSTRUCTION COORDINATION, A WEEKLY LOG OF DAILY INSPECTIONS OF BARRICADE AND MAINTENANCE SCHEDULES ON PROJECTS THAT ARE OVER ONE WEEK DURATION.

13. EQUIPMENT OR MATERIALS SHALL NOT BE STORED WITHIN 15 FEET OF A TRAVELLED TRAFFIC LANE DURING NON-WORKING HOURS WITHOUT THE APPROVAL OF CONSTRUCTION COORDINATION.

14. CONTRACTOR SHALL PROVIDE AND MAINTAIN A SAFE AND ADEQUATE MEANS OF CHANNELIZING PEDESTRIAN TRAFFIC AROUND AND THROUGH THE CONSTRUCTION AREA.

15. CONTRACTOR IS RESPONSIBLE FOR OBLITERATION OF ANY CONFLICTING STRIPING AND RESPONSIBLE FOR ALL TEMPORARY STRIPING.

16. CONTRACTOR SHALL MAINTAIN ACCESS TO ALL FACILITIES, BUSINESSES AND/OR RESIDENTS AT ALL TIMES.

17. CONTRACTOR SHALL PROVIDE ACCESS SIGNS FOR BUSINESSES LOCATED WITHIN THE CONSTRUCTION AREA UNDER THE SUPERVISION OF CONSTRUCTION COORDINATION. EACH ACCESS SIGN SHALL HAVE 5 INCH, ORANGE LETTERING ON WHITE BACKGROUND. SHOPPING CENTERS AND MALLS SHALL BE LISTED AS SUCH.

18. ALL ADVANCE WARNING SIGNS SHALL MEET THE MINIMUM REFLECTIVE INTENSITY REQUIREMENTS SET FORTH BY THE CITY OF ALBUQUERQUE. CONSTRUCTION COORDINATION SHALL DETERMINE ALL REQUIREMENTS AND APPROVE OR DISAPPROVE ANY ADVANCE WARNING SIGN PER SECTION 6A-4 OF THE MUTCD, LATEST EDITION.

19. 24 HOURS PRIOR TO OCCUPYING OR CLOSING OF A RIGHT-OF-WAY, CONTRACTOR SHALL NOTIFY: POLICE, FIRE DEPARTMENT, SCHOOLS, HOSPITALS, TRANSIT AUTHORITY, BUSINESSES AND/OR RESIDENTS THAT WILL BE AFFECTED BY THE CONSTRUCTION.

20. ANY FIELD ADJUSTMENTS SHALL BE APPROVED BY CONSTRUCTION COORDINATION.

21. EXCAVATIONS SHALL BE PLATED, TEMPORARILY PATCHED OR RESURFACED PRIOR TO OPENING OF TRAFFIC. A MINIMUM OF 11 FEET, UNLESS OTHERWISE SPECIFIED IN THE PLANS, SHALL BE PROVIDED FOR TRAFFIC IN ANY GIVEN DIRECTION. CONTRACTOR IS RESPONSIBLE FOR ANY WORK INVOLVED IN SATISFYING THESE REQUIREMENTS.

22. CONTRACTOR SHALL AT ALL TIMES COMPLY WITH THE FOLLOWING:

1. STANDARDS AND REQUIREMENTS SET FORTH IN THE MANUAL ON UNIFORM TRAFFIC CONTROL DEVICES, LATEST EDITION.
2. THE CITY OF ALBUQUERQUE TRAFFIC CODE, LATEST EDITION.
3. SECTION 19 OF THE CITY OF ALBUQUERQUE'S STANDARD SPECIFICATIONS FOR PUBLIC WORKS CONSTRUCTION, AS WELL AS OTHER SECTIONS.

23. FAILURE TO COMPLY WITH ANY OF THE ABOVE MENTIONED, WILL BE ADEQUATE CAUSE TO CEASE ALL WORK ON ANY CONSTRUCTION PROJECT. WORK WILL NOT RESUME UNTIL ALL REQUIREMENTS ARE ADDRESSED AND APPROVED BY CONSTRUCTION COORDINATION.

24. ALL TRAFFIC CONTROL DEVICES SHALL BE KEPT IN NEW-CLEAN CONDITION. WASHING OF EQUIPMENT IS INCIDENTAL TO ITS PLACEMENT AND MAINTENANCE.

25. TRAFFIC CONTROL STANDARDS APPLY ONLY WHERE THE CONSTRUCTION TRAFFIC CONTROL PLANS ARE NOT SPECIFIC.

26. ADVANCE WARNING SIGNS SHALL BE 36"x36", UNLESS OTHERWISE SPECIFIED IN THE PLANS, WITH SUPER ENGINEERING GRADE SHEETING OR BETTER.

27. ITEM 0420.115 - REFLECTORIZED PAINTED MARKINGS IS INCLUDED FOR PAVEMENT STRIPING BETWEEN SURFACING LIFTS AND FOR USE ON TEMPORARY PAVEMENTS, AS DIRECTED BY THE PROJECT MANAGER.

28. IMPACT ATTENUATORS SHALL BE CONSIDERED AS INCLUDED IN THE CONTRACT PRICE FOR ITEM NUMBER 0019.01-CONSTRUCTION TRAFFIC CONTROL AND BARRICADING AND NO ADDITIONAL MEASUREMENT OR PAYMENT WILL BE MADE.

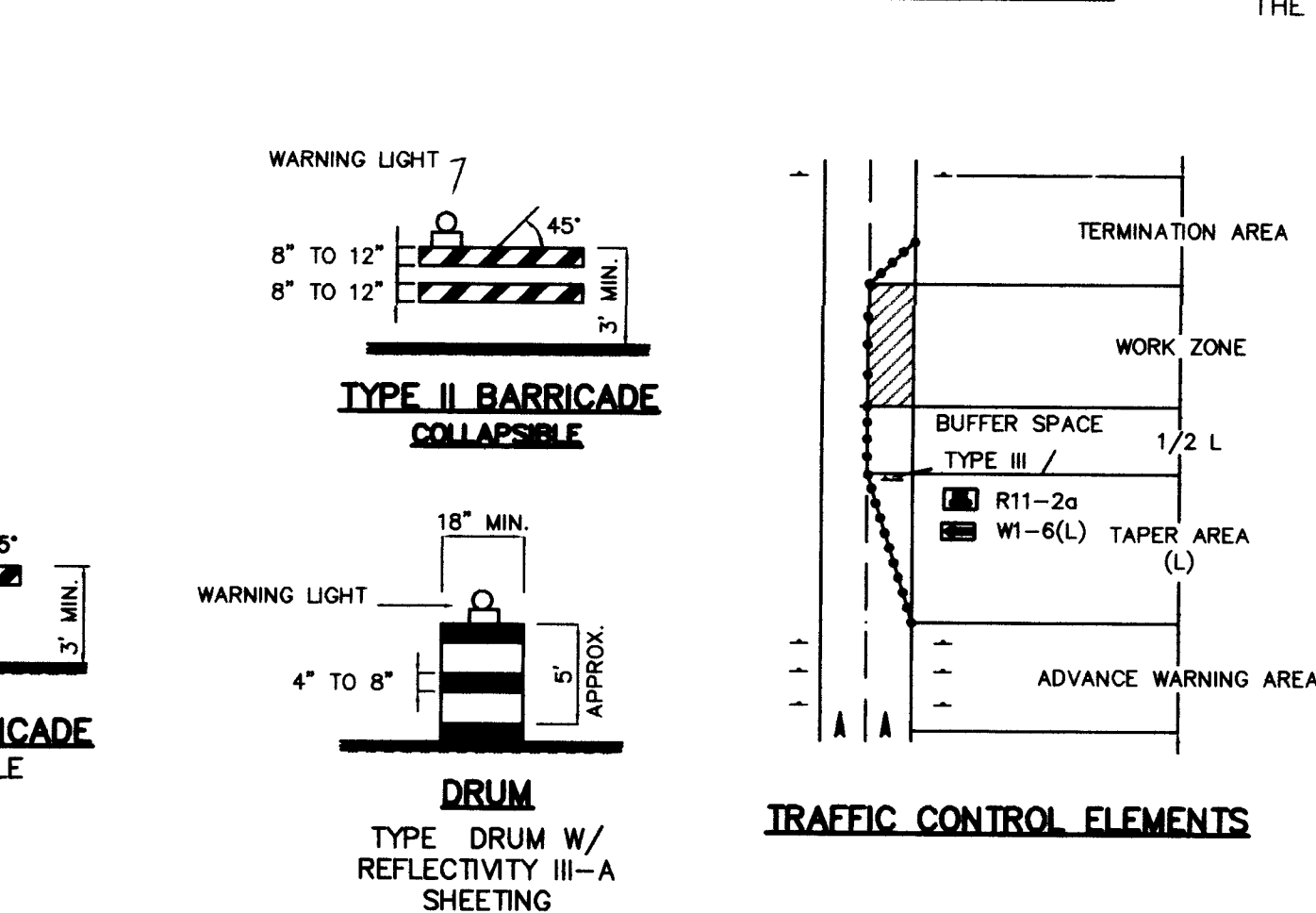
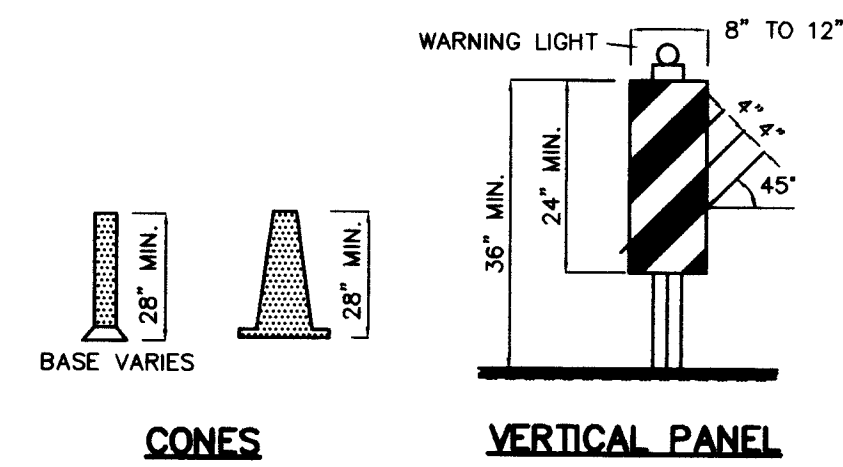
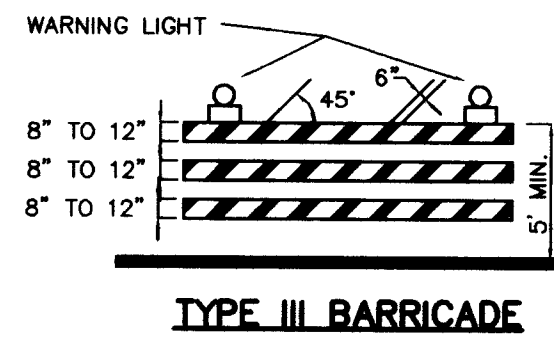

TYPE I BARRICADE
COLLAPSIBLE

DRUM
TYPE DRUM W/
REFLECTIVITY III-A
SHEETING

TRAFFIC CONTROL ELEMENTS

SIGN FACE DETAILS

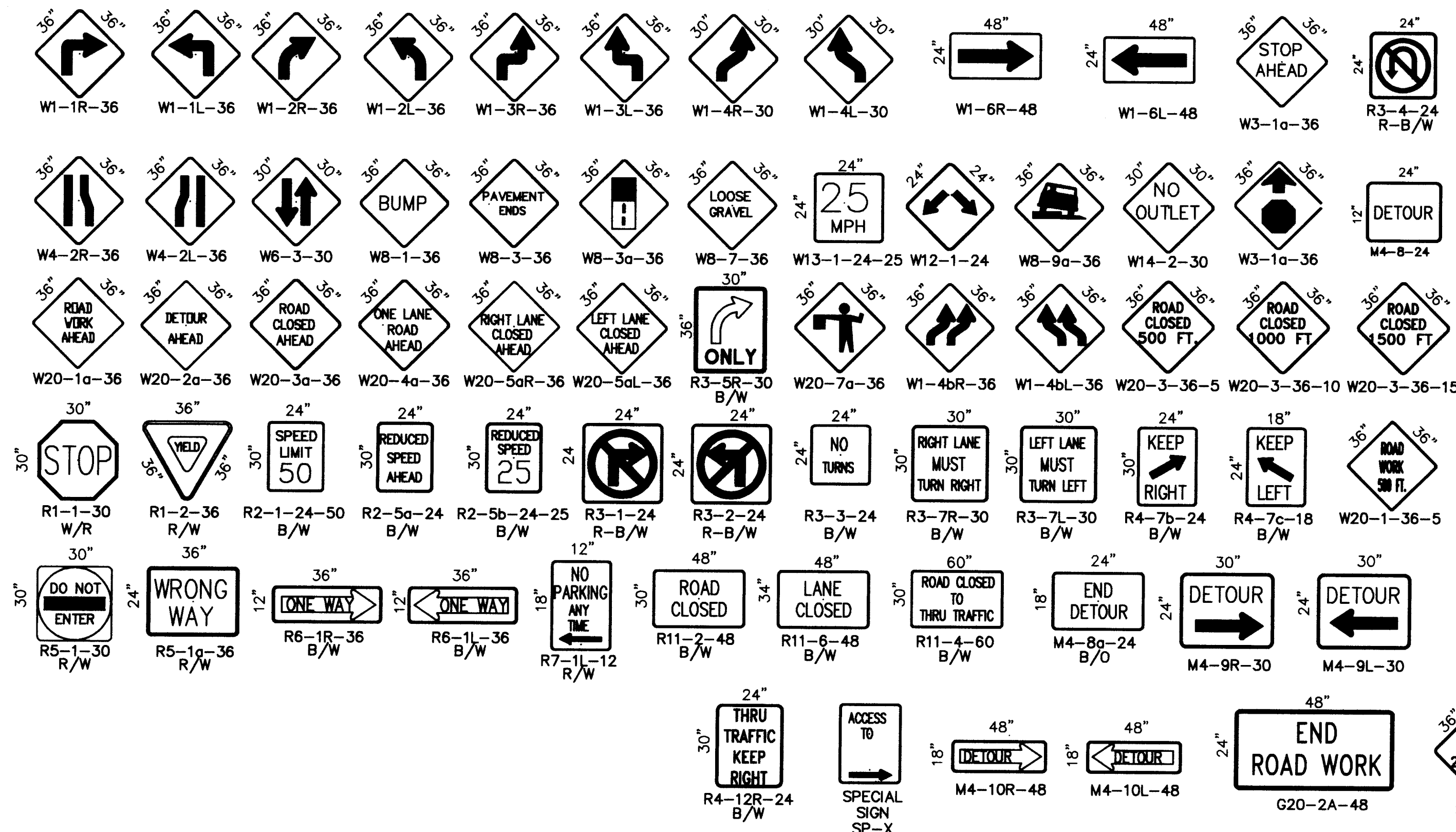

ALL CONSTRUCTION WARNING SIGNS
SHALL HAVE A BLACK LEGEND ON A
ORANGE BACKGROUND.

LEGEND

- WORK AREA
- BARRICADE - TYPE I, TYPE II, OR TYPE "H" DRUM W/ REFLECTIVITY III-A SHEETING
- BARRICADE - TYPE III
- VERTICAL PANEL
- WARNING SIGN
- DISTANCE BETWEEN SIGNS - A DISTANCE MEASURED IN FEET EQUAL TO A VALUE OF TEN TIMES THE SPEED LIMIT OF THE STREET FLAGMAN POSITION
- SPACING BETWEEN BARRICADES- A DISTANCE MEASURED IN FEET EQUAL TO THE SPEED LIMIT OF THE STREET
- L TAPER LENGTH - SEE CHART BELOW
- THE TANGENT LENGTH IS EQUAL TO THE TAPER LENGTH FOR A GIVEN STREET.

TAPER REQUIREMENTS

SPEED LIMIT (MPH)	TAPER LENGTH (L) (FEET)			MINIMUM NUMBER OF DEVICES FOR TAPER	MAXIMUM DEVICE SPACING IN FEET	
	10' LANE	11' LANE	12' LANE		BEFORE TAPER	AFTER TAPER
20	70	75	80	5	20	20
25	105	115	125	6	25	25
30	150	165	180	7	30	30
35	205	225	245	8	35	35
40	270	295	320	9	40	40
45	450	495	540	13	45	45
50	500	550	600	13	50	50
55	550	605	660	13	55	55

RECOMMENDED SIGN SPACING(D) FOR ADVANCE WARNING SIGN SERIES

SPEED MILES PER HOUR	MINIMUM DISTANCE BETWEEN SIGNS	FROM LAST SIGN TO TAPER
0-20	10 X SPEED LIMIT	10 X SPEED LIMIT
25-30	10 X SPEED LIMIT	10 X SPEED LIMIT
30-35	10 X SPEED LIMIT	10 X SPEED LIMIT
40-45	10 X SPEED LIMIT	10 X SPEED LIMIT
50-60	10 X SPEED LIMIT	10 X SPEED LIMIT

TAPER CRITERIA

TYPE OF TAPER	TAPER LENGTH
UPSTREAM TAPER:	
MERGING TAPER	L MINIMUM
SHIFTING TAPER	1/2 L MINIMUM
SHOULDER TAPER	1/2 L MINIMUM
TWO-WAY TRAFFIC TAPER	100 FEET MAXIMUM
DOWNSTREAM TAPERS	100 FEET PER LANE

TAPER LENGTH COMPUTATION

SPEED LIMIT	
40 MPH OR LESS	$L = \frac{WS^2}{60}$
45 MPH OR GREATER	$L = W \times S$

L = TAPER LENGTH
W = WIDTH OF OFFSET IN FEET
S = POSTED SPEED OR OFF-PEAK 85-PERCENTILE SPEED IN MPH



CITY OF ALBUQUERQUE
PUBLIC WORKS DEPARTMENT
ENGINEERING DEVELOPMENT GROUP

TITLE:
SIGNING AND CONSTRUCTION TRAFFIC CONTROL STANDARDS

Design Review Committee	City Engineer Approval	Mo./Day/Yr.	Mo./Day/Yr.
DESIGN REVIEW COMMITTEE	CITY ENGINEER		
City Project No.	Zone Map No.	Sheet	Of
5103.13	C-19	5	7

SCANNED BY
BY LASON

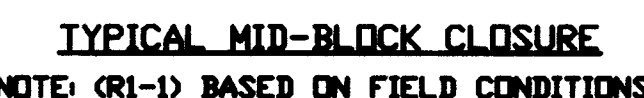
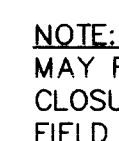

- TRAFFIC SPLIT NOTES:
1. THE OFFSET DISTANCE MUST BE CALCULATED IN ALL SHIFTING TAPERS. THE OFFSET DISTANCES SHALL INCLUDE LANE WIDTHS PLUS MEDIAN WIDTHS.
 2. 1/2 L IS MINIMUM DISTANCE FOR SHIFTING TAPERS.
 3. REVERSE CURVES MAY BE IMPLEMENTED. ALL CURVE DATA SHALL BE CALCULATED.
 4. MEDIAN REMOVAL SHALL BE REQUIRED IF 1/2 L OR REVERSE CURVE IS NOT SUFFICIENT. MEDIAN REMOVAL SHALL TAKE PLACE BEFORE SPLITS.
 5. REDUCED SPEED MAY BE CONSIDERED.
 6. * USE W1-3 FOR 30 MPH OR LESS, W1-4 FOR SPEED 35 MPH OR GREATER.

GENERAL NOTE:

ALL CONSTRUCTION WARNING SIGNS SHALL HAVE A BLACK LEGEND ON A ORANGE BACKGROUND.

ALL ADVANCE WARNING SIGNS SHALL BE A MINIMUM OF THIRTY SIX (36) INCHES BY THIRTY SIX (36) INCHES IN SIZE AND SHALL HAVE ONE WARNING LIGHT.

SCANNED BY
BY LASON

[illegible]

