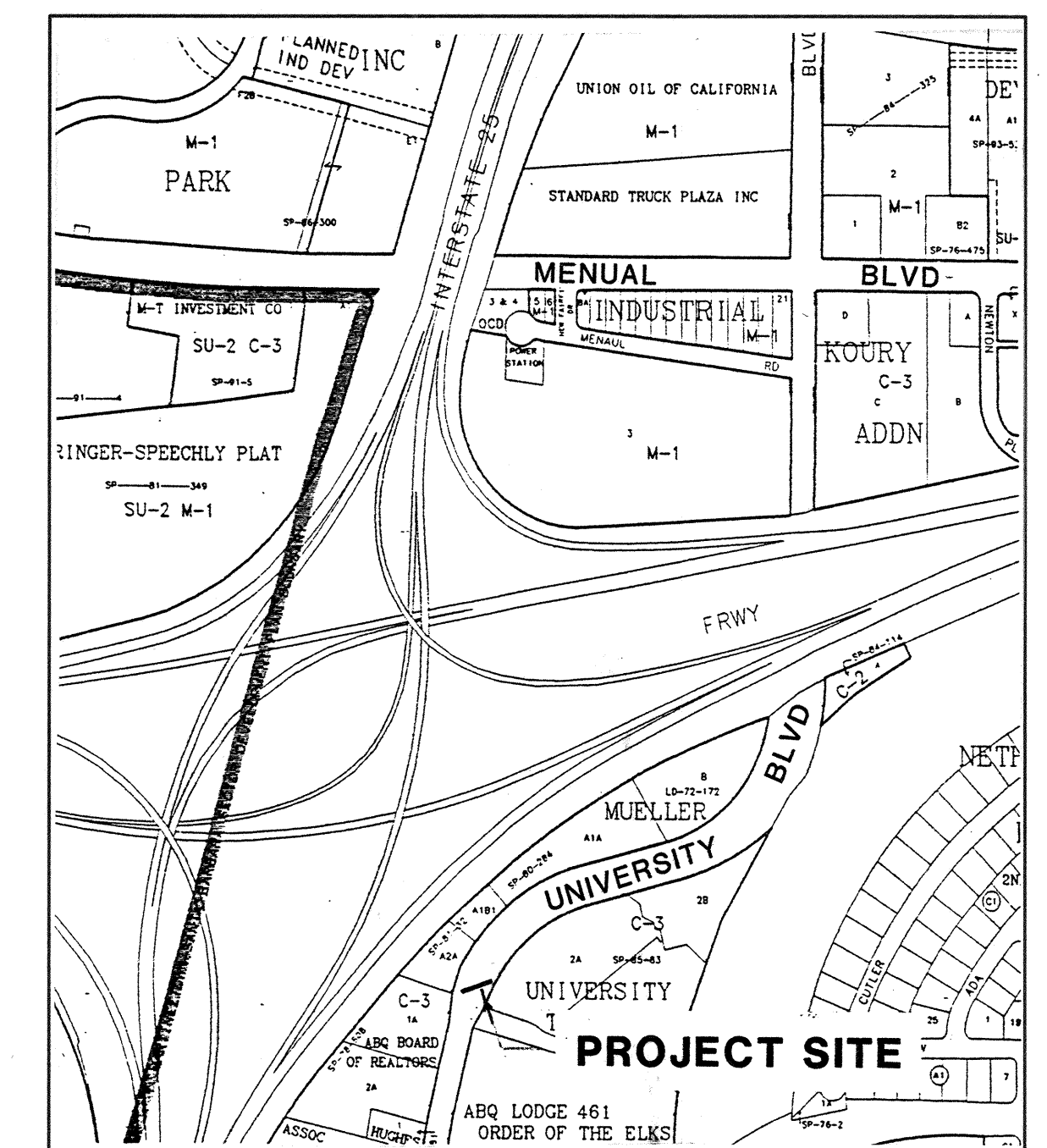

University Blvd
Inlets
Storm Drain
5/31/90

GENERAL NOTES

9. Contractor shall assist the Engineer/Inspector in the recording of data on all utility lines and accessories as required by the City of Albuquerque for the preparation of record drawings. Contractor shall not cover utility lines and accessories until all data has been recorded.
10. Existing curb and gutter not to be removed under the contract which is damaged or displaced by the Contractor shall be removed and replaced by the Contractor at his expense.
11. All work on this project shall be performed in accordance with applicable federal, state, and local laws, rules, and regulations concerning construction safety and health.
12. The Contractor is responsible for protecting and maintaining all existing monumentation controls. In the event of inadvertent destruction or alteration, the Contractor must immediately notify the City Chief Surveyor.
13. **WARNING--EXISTING UTILITY LINE LOCATIONS** are shown in an approximate manner only, and such lines may exist where none are shown. The location of any such existing lines is based upon information provided by the utility company, the Owner, or by others, and the information may be incomplete or may be obsolete by the time construction commences.

The Engineer has undertaken no field verification of the location, depth, size, or type of existing underground utility lines, makes no representation pertaining thereto, and assumes no responsibility or liability therefor. The Contractor shall inform itself of the location of any utility line in or near the area of the work in advance of and during excavation work. The Contractor is fully responsible for any and all damage caused by its failure to locate, identify, and preserve any and all existing utilities. The Contractor shall comply with State statutes, municipal and local ordinances, rules and regulations pertaining to the location of these lines and facilities, in planning and conducting excavation, whether by calling or notifying the utilities, complying with "Blue Stakes" procedures, or otherwise.

$$1'' = 750' \pm$$

VICINITY MAP

H-15

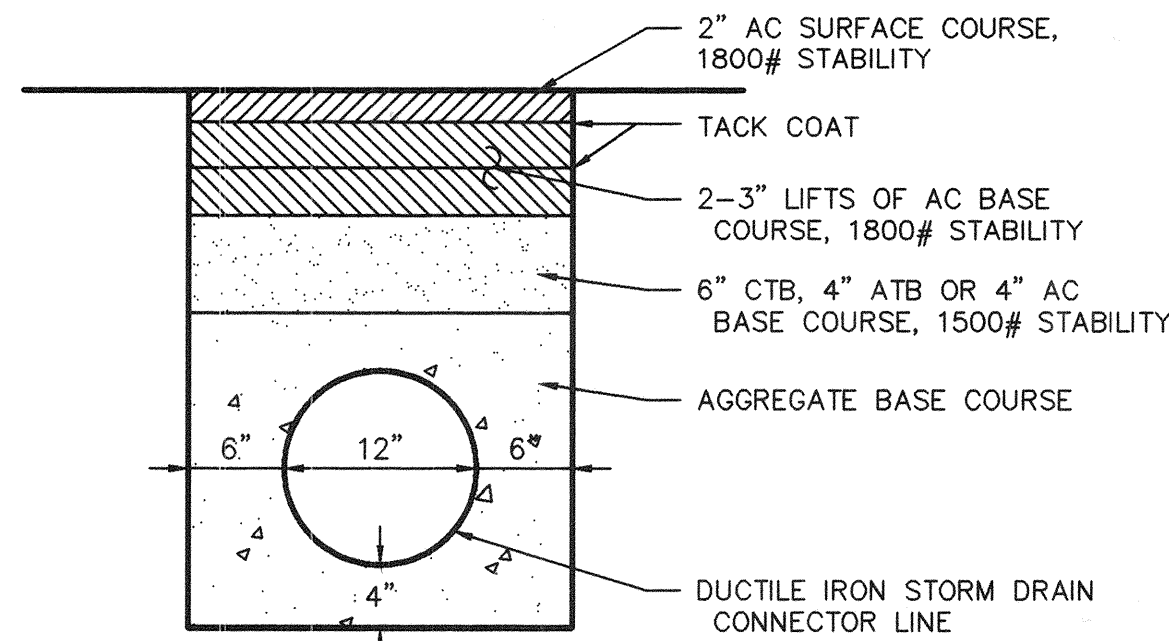

TRENCH DETAIL
NO SCALE

LEGEND

- EXISTING
- LANDSCAPED AREA
 - TELEPHONE MH
 - ☆ LIGHTPOLE
 - ⋈ WATER VALVE
 - SANITARY SEWER MH
 - ⋈ FIRE HYDRANT
 - ⋈ SIGN POSTS
 - ⋈ TELEPHONE RISER
 - ⋈ BENCH
 - ⋈ WATER METER
- ▨ GRAVEL
 - ▨ SIDEWALK

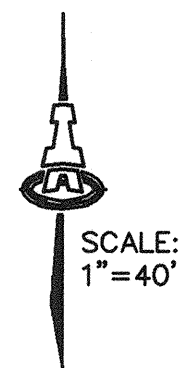

INLET NO. 4
STA. 08+45.21, 33' LT
BUILD TYPE SINGLE D
INLET
REMOVE & DISPOSE 12 LF
CURB & GUTTER
BUILD 8 LF STD. CURB &
GUTTER
BEND 4" LINE TO MAKE
TRANSITION TO STANDARD
LOCATION BEHIND CURB

BUILD 12" DIP CONNECTOR LINE
REMOVE & REPLACE 25 SY
ARTERIAL PVM'T PER STD.
DWG. 2465

INLET NO. 3
STA. 08+04.26, 33' RT
BUILD TYPE SINGLE D
INLET
REMOVE & DISPOSE 12 LF
CURB & GUTTER
BUILD 8 LF STD. CURB &
GUTTER

INLET NO. 2
STA. 01+51.60, 33' RT
BUILD TYPE SINGLE D
INLET
REMOVE & DISPOSE 12 LF
CURB & GUTTER
BUILD 8 LF STD. CURB &
GUTTER

BUILD 12" DIP CONNECTOR LINE
REMOVE & REPLACE 33 SY
ARTERIAL PVM'T PER STD.
DWG. 2465

INLET NO. 1
STA. 00+71.04, 33' LT
BUILD TYPE SINGLE D
INLET
REMOVE & DISPOSE 12 LF
VALLEY GUTTER
BUILD 8 LF VALLEY GUTTER

Sta. -00+01.40, 34.47' LT
Benchmark - City of Albuquerque
aluminum disc 14-H15
elevation 5075.18

STORM DRAIN INLET PLAN

SCALE: 1"=40'

FOR INFORMATION ONLY
FOR INFORMATION ONLY

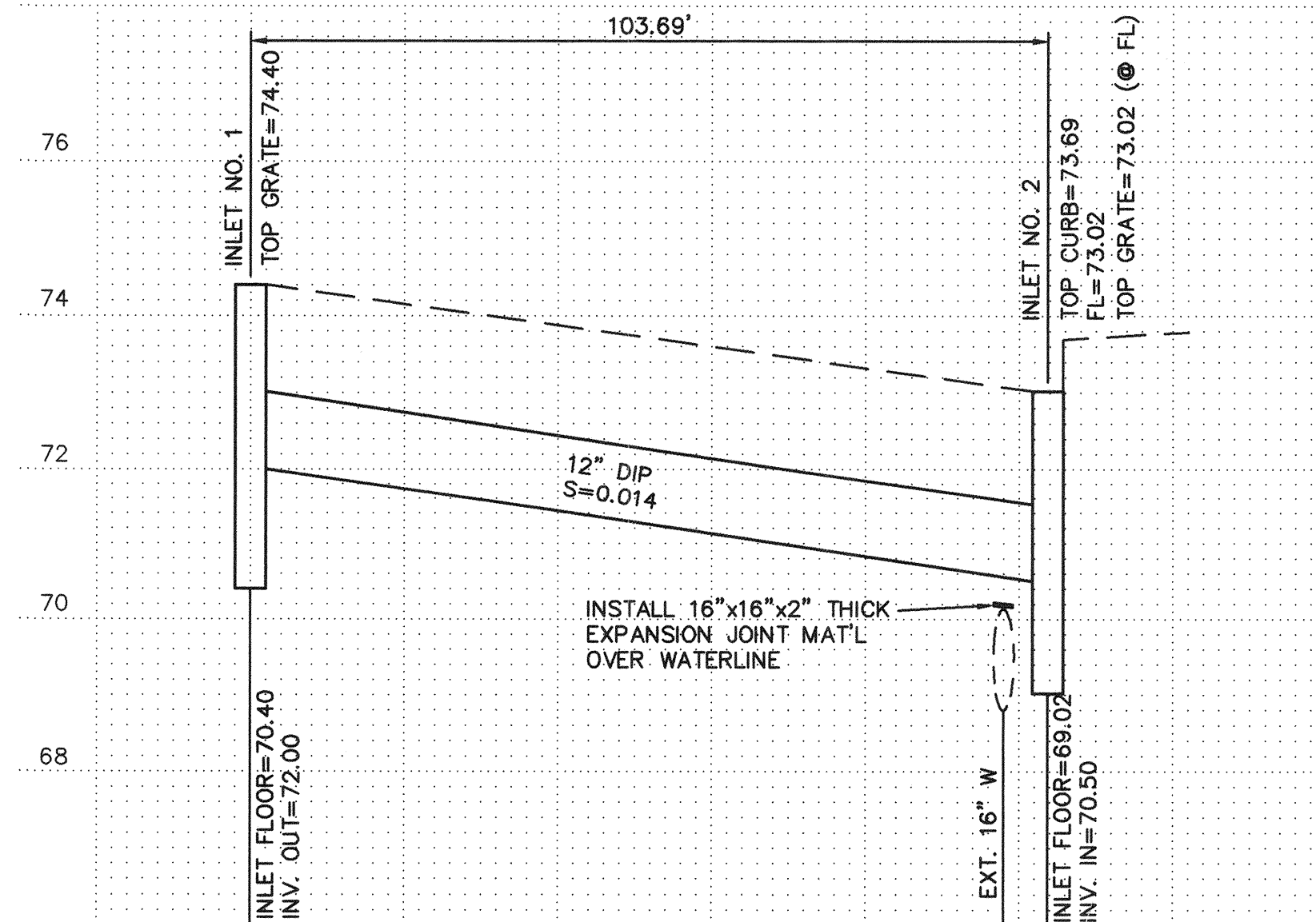

PROFILE - INLET 1 to 2
SCALE: 1"=20' HOR., 1"=2' VER.

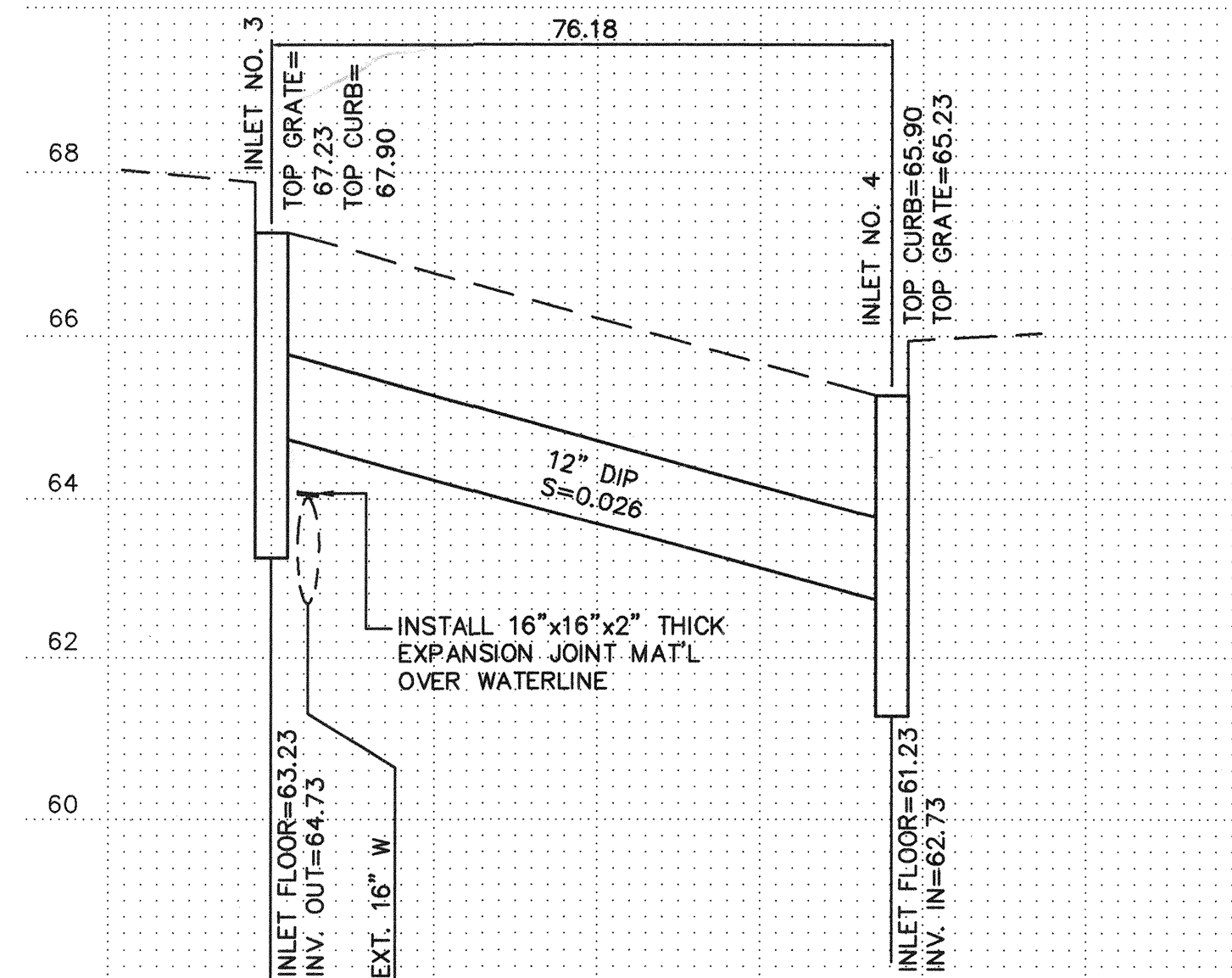

PROFILE - INLET 3 to 4
SCALE: 1"=20' HOR., 1"=2' VER.

NOTES:

- DUCTILE IRON PIPE SHALL BE STANDARD PRESSURE CLASS (350 PSI) WITH CEMENT MORTAR LINING WITH BITUMINOUS SEAL COAT, AND RUBBER GASKET PUSH-ON JOINTS.
- TYPE SINGLE D DRAINAGE INLETS SHALL BE MODIFIED WHEN CONSTRUCTED ALONG STANDARD CURB & GUTTER SECTIONS SO THAT THE GRATE IS SLOPED AND DEPRESSED SIMILAR TO A SINGLE C INLET. THE CURB ADJACENT TO THE INLET SHALL BE CONTINUOUS AND BE CONSTRUCTED TO THE STANDARD CURB & GUTTER DIMENSIONS.

AS-BUILT INFORMATION				BENCH MARKS				SURVEY INFORMATION				ENGINEER'S SEAL			
CONTRACTOR	DATE	BY	NO.	CONTRACTOR	DATE	BY	NO.	CONTRACTOR	DATE	BY	NO.	CONTRACTOR	DATE	BY	NO.
STANDARD BY	DATE	BY	NO.	STANDARD BY	DATE	BY	NO.	STANDARD BY	DATE	BY	NO.	STANDARD BY	DATE	BY	NO.
FIELD ACCEPTANCE BY	DATE	BY	NO.	FIELD ACCEPTANCE BY	DATE	BY	NO.	FIELD ACCEPTANCE BY	DATE	BY	NO.	FIELD ACCEPTANCE BY	DATE	BY	NO.
FIELD CORRECTION BY	DATE	BY	NO.	FIELD CORRECTION BY	DATE	BY	NO.	FIELD CORRECTION BY	DATE	BY	NO.	FIELD CORRECTION BY	DATE	BY	NO.
RECORDED BY	DATE	BY	NO.	RECORDED BY	DATE	BY	NO.	RECORDED BY	DATE	BY	NO.	RECORDED BY	DATE	BY	NO.



81310SD.DWGmed 4/28/95

CITY OF ALBUQUERQUE
PUBLIC WORKS DEPARTMENT
ENGINEERING GROUP

TITLE: UNIVERSITY BOULEVARD
STORM DRAIN INLETS

APPROVALS	ENGINEER	DATE	APPROVALS	ENGINEER	DATE
DRC CHAIRMAN			WATER		
TRANSPORTATION			WASTE WATER		
HYDROLOGY					

PROJECT NO. 5137.90 MAP NO. H-15 SHEET 2 OF 2