

CITY OF ALBUQUERQUE
NEW MEXICO
DEPARTMENT OF
MUNICIPAL DEVELOPMENT
ENGINEERING DIVISION



AUGUST 2013

NEAR HEIGHTS FLOOD CONTROL
WASHINGTON AVE TO MONROE ST FROM
MOUNTAIN ROAD TO SUMMER AVE
5498.91

APPROVED AS RECORD DRAWINGS
DMD/CSD
CITY CONSTRUCTION ENGINEER
DATE: 2/23/15

FINAL PLANS

I, RAYMOND J. SMITH, P.E., A REGISTERED PROFESSIONAL ENGINEER IN THE STATE OF NEW MEXICO, CERTIFY THAT THE INFORMATION ON THESE RECORD DRAWINGS REPRESENTS THE "AS-BUILT" CONDITIONS OF THE PROJECT, AND IS TRUE AND CORRECT TO THE BEST OF MY KNOWLEDGE AND BELIEF. THE INFORMATION CONTAINED ON THESE DRAWINGS WAS COMPILED, IN PART, FROM INFORMATION SUPPLIED BY OTHERS. SOUDER, MILLER & ASSOCIATES TAKES NO RESPONSIBILITY FOR INFORMATION SUPPLIED BY OTHERS AND MAKES NO REPRESENTATION AS TO ITS ACCURACY. ALL VERTICAL AND HORIZONTAL DIMENSIONS SHOULD BE FIELD VERIFIED PRIOR TO USE ON FUTURE PROJECTS.
Raymond J. Smith
NMPE NO. 18738 Souder, Miller & Associates
4000 Camino Real NE, Suite 200 Albuquerque, NM 87110

RECORD DRAWING

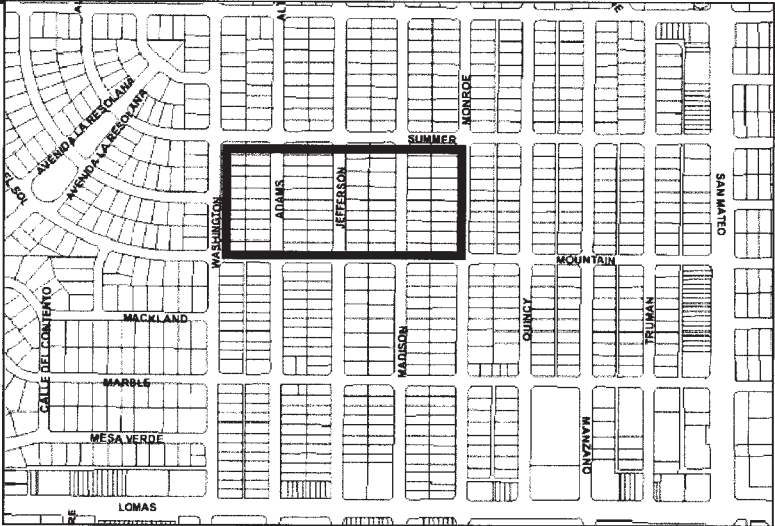

VICINITY MAP
ZONE ATLAS MAP J-17
NTS

RECORD DRAWING INFO	
CITY INSPECTOR	JOE BACA
CITY PROJECT MANAGER	RICHARD COSTALES
CONTRACTOR	TLC
SURVEYOR	RIO GRANDE SURVEYING
CONST. PROJECT COORDINATOR	ADAM BERGSTRASSER
LETTER OF ACCEPTANCE DATE	9/1/2014
CONSTRUCTION ENGINEER	BEN BROKAW













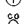

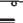

Gannett Fleming West, Inc.
2155 Louisiana NE, Suite 7000 Albuquerque, New Mexico 87110
Office: (505) 265-8468 Facsimile: (505) 681-2513

ENGINEER STAMP & SIGNATURE	APPROVALS	ENGINEER	DATE	*****
	DRC CHAIRMAN	J. Waddell	8/19/13	APPROVED FOR CONSTRUCTION DATE 8/19/2013
	TRANSPORTATION	W. J. J. J.	8/19/13	
	WATER/WASTEWATER	W. J. J. J.	8/19/13	
	HYDROLOGY	W. J. J. J.	8/19/13	
	PARKS			
	CONST. MGMT.			
	CONST. COORD.			
	CITY PROJECT NO.			
			5498.91	SHEET 1-1, 1 of 15

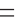
PROJECT NAME: NEAR HEIGHTS FLOOD CONTROL PROJECT NUMBER: 5498.91 PROJECT LIMITS: WASHINGTON AVE TO MONROE ST FROM MOUNTAIN ROAD TO SUMMER AVE SUBMITAL NUMBER: FINAL

INDEX OF SHEETS			
SHEET NUMBER SEQUENTIAL	DRAWING NUMBER	NUMBER OF SHEETS	SHEET DESCRIPTION
1 OF 15	1-1	1	COVER SHEET AND VICINITY MAP
2 OF 15	1-2	1	INDEX OF SHEETS AND LEGEND
3 OF 15	1-3	1	GENERAL NOTES
4 OF 15	1-4	1	SUMMARY OF QUANTITIES
5 OF 15	1-5	1	SURVEY CONTROL LAYOUT
SUBTOTAL =		5	
6 OF 15	2-1	1	REMOVALS
7 OF 15	2-2	1	EXISTING UTILITIES PLAN
8 OF 15	2-3	1	WATER SHUTOFF PLAN
9 OF 15	2-4	1	WATERLINE RELOCATION DETAILS
SUBTOTAL =		4	
10 OF 15	3-1	1	PROPOSED PROJECT LAYOUT
11 OF 15	3-2	1	SUMMER AVENUE PLAN AND PROFILE
12 OF 15	3-3	1	JEFFERSON STREET PLAN AND PROFILE
13 OF 15	3-4	1	ADAMS STREET PLAN AND PROFILE
SUBTOTAL =		4	
14 OF 15	4-1	1	PAVING DETAILS
15 OF 15	4-2	1	PAVING DETAILS
SUBTOTAL =		2	
TOTAL SHEETS =		15	

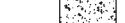
LEGEND

	FOUND CONTROL MONUMENT (AS NOTED)
	LIGHT POLE
	POWER POLE
	TELEPHONE MANHOLE
	SAS CLEAN OUT
	SAS MANHOLE
	EXISTING CURB INLET
	NEW CURB INLET
	STORM SEWER MANHOLE
	FIRE HYDRANT
	WATER VALVE
	WATER METER
	SIGN
	UNDERGROUND WATER LINE
	UNDERGROUND GAS LINE
	UNDERGROUND SAS LINE
	UNDERGROUND STORM DRAIN
	OVERHEAD POWER LINE
	CONCRETE HATCH



CALL NM ONE-CALL
SYSTEM SEVEN (7) DAYS
PRIOR TO ANY EXCAVATION



CITY OF ALBUQUERQUE
DEPARTMENT OF MUNICIPAL DEVELOPMENT
ENGINEERING DIVISION

NEAR HEIGHTS FLOOD CONTROL
INDEX OF SHEETS & LEGEND



ZONE MAP NO.
J-17
CITY PROJECT NO.
5498.91
SHEET NO.
1-2, 2 of 15

RECORD DRAWING

CONSULTANTS

Gannett Fleming West, Inc.

2155 LOUISIANA BLVD. NE
SUITE 7000
ALBUQUERQUE, NEW MEXICO 87110
505-265-8468

BENCH MARKS

PROJECT BENCHMARK IS A STANDARD CITY
OF ALBUQUERQUE SURVEY CONTROL 1 3/4
INCH ALUMINUM DISC EPOXYED TO CENTER
OF THE TOP OF A CONCRETE DROP INLET,
ON THE EAST SIDE OF SAN MATEO
BOULEVARD N.E., 17.9 FEET SOUTH OF THE
S.S.E. CURB P.C. AT SUMMER AVENUE, AND
STAMPED "ACS BM 24-J18. ELEVATION =
5,232.58 FEET (NAVD 1988 VERTICAL
DATUM).



SEAL

BY

DESCRIPTION
CONTRACTOR:

DATE

NO.

AS-BUILT INFORMATION

WORK STACKED BY:

INSPECTOR'S ACCEPTANCE BY:

FIELD VERIFICATION BY:

DRAWINGS CORRECTED BY:

DESIGNED BY: RJS

DRAWN BY: ARB

CHECKED BY: EJJH

DATE

APRIL 2013

THE CONTRACTOR SHALL PROVIDE INGRESS AND EGRESS TO LOCAL BUSINESSES AND RESIDENCES FOR THE DURATION OF THE PROJECT. THE CONTRACTOR SHALL ADVISE OF AND SCHEDULE ACCESS CLOSURES, AT LEAST 24 HOURS IN ADVANCE, WITH PROPERTY OWNERS AND THE CONSTRUCTION PROJECT MANAGER. NOTIFICATION OF PROPERTY OWNERS SHALL BE INCIDENTAL TO THE PROJECT AND NO MEASUREMENT OR PAYMENT SHALL BE MADE THEREFORE. HEAVY TRUCK TRAFFIC SHALL NOT BE DETOURED THROUGH RESIDENTIAL AREAS.

NO MATERIAL PITS HAVE BEEN DESIGNATED FOR THIS PROJECT. THE CONTRACTOR MAY OBTAIN SPECIFICATION BORROW OR SURFACING MATERIAL FROM ANY ACCEPTABLE SOURCE. COA SPECIFICATIONS REQUIRE A MINIMUM R VALUE 50 BORROW FOR ROADWAY AREAS.

THE CONTRACTOR SHALL CLEAN ALL EXISTING STRUCTURES THAT ARE TO REMAIN OPERATIONAL. STRUCTURES SHALL BE CLEAN AT THE TIME OF FINAL PROJECT ACCEPTANCE. THIS WORK SHALL BE CONSIDERED AS INCIDENTAL TO CONSTRUCTION. NO SEPARATE MEASUREMENT AND PAYMENT WILL BE MADE FOR CLEANING OF STRUCTURES.

SEVEN (7) WORKING DAYS PRIOR TO BEGINNING CONSTRUCTION, CONTRACTOR SHALL SUBMIT TO DMD, CONSTRUCTION COORDINATION DIVISION A DETAILED CONSTRUCTION SCHEDULE.

CONTRACTOR SHALL SUBMIT A TRAFFIC CONTROL PLAN TO DMD, CONSTRUCTION COORDINATION DIVISION FOR APPROVAL. TRAFFIC CONTROL PLAN SHALL COMPLY WITH THE LATEST EDITION OF THE MUTCD. AT LEAST TWO (2) WORKING DAYS PRIOR TO CONSTRUCTION, CONTRACTOR SHALL OBTAIN A BARRICADING PERMIT FROM THE DMD, CONSTRUCTION COORDINATION DIVISION. CONTRACTOR SHALL NOTIFY BARRICADE ENGINEER (924-3400) PRIOR TO OCCUPYING AN INTERSECTION. REFER TO SECTION 19 OF STANDARD SPECIFICATIONS. PREPARATION OF TRAFFIC CONTROL PLAN AND OBTAINING PERMITS SHALL BE INCIDENTAL TO THE PROJECT.

THE CONTRACTOR SHALL BE RESTRICTED TO THE USE OF 35 TON NON-VIBRATING ROLLER MAXIMUM TO OBTAIN THE REQUIRED COMPACTION IN PAVEMENT STRUCTURE, ROADWAY BACKFILL, EMBANKMENT, AND SUBGRADES IN URBAN AREAS WHERE THE USE OF HEAVIER EQUIPMENT COULD DAMAGE UNDERGROUND UTILITIES OR OTHER PERMANENT STRUCTURES.

VIBRATION MONITORING AND VIDEO TAPING SHALL BE PERFORMED IN AND AROUND ALL STRUCTURES AS DEFINED IN THIS GENERAL NOTE AND AS DIRECTED BY THE PROJECT MANAGER. "STRUCTURES" IS DEFINED AS BRIDGES, CULVERTS, CATCH BASINS, DROP INLETS, RETAINING WALLS, CRIBBING, MANHOLES, ENDWALLS, BUILDINGS, SEWERS, SERVICE PIPES, UNDER DRAINS, FOUNDATION PLANS, AND OTHER SUCH FEATURES THAT MAY BE ENCOUNTERED IN THE WORK. THE CONSTRUCTION AREA AND AREAS ADJACENT TO THE LIMITS OF CONSTRUCTION SHALL ALSO BE VIDEO TAPED. VIBRATION MONITORING, VIDEO-TAPING, AND RELATED WORK SHALL BE PERFORMED ACCORDING TO THE SPECIFICATIONS INCLUDED IN THE SUPPLEMENTAL TECHNICAL SPECIFICATIONS OF THE CONTRACT BOOK AND SHALL BE INCIDENTAL TO THE CONTRACT AND NO MEASUREMENT OR PAYMENT SHALL BE MADE THEREFORE.

ALL WORK DETAILED ON THESE PLANS TO BE PERFORMED, EXCEPT AS OTHERWISE STATED OR PROVIDED HEREON, SHALL BE CONSTRUCTED IN ACCORDANCE WITH CITY OF ALBUQUERQUE STANDARD SPECIFICATIONS FOR PUBLIC WORKS CONSTRUCTION, 1986 EDITION, UPDATE #8 AND WILL BE REFERRED TO HEREIN AS "STANDARD SPECIFICATIONS".

9. TWO (2) WORKING DAYS PRIOR TO ANY EXCAVATION, CONTRACTOR MUST CONTACT N.J. ONE-CALL SYSTEM, (505) 260-1990, FOR LOCATION OF EXISTING UTILITIES. THE UTILITIES SHOWN ON THESE PLANS MAY OR MAY NOT BE COMPLETE OR ACCURATE. IT IS THE SOLE RESPONSIBILITY OF THE CONTRACTOR TO IDENTIFY AND LOCATE HORIZONTALLY AND VERTICALLY ANY UTILITIES THAT MAY BE IMPACTED BY THEIR CONSTRUCTION ACTIVITIES. SEE SHEET 2-2 FOR ADDITIONAL UTILITIES NOTES.
10. ALL NEW STREET PAVING, CURB AND GUTTER, SIDEWALKS OR DRIVE PADS SHALL MATCH THE ELEVATIONS OF ABUTTING EXISTING AREAS AS SHOWN IN THE PLANS OR AS DIRECTED BY THE CITY CONSTRUCTION MANAGER.
11. THE CONTRACTOR SHALL COORDINATE HIS CONSTRUCTION ACTIVITIES WITH ALL OTHER CONTRACTORS AND UTILITY COMPANIES WORKING IN THE SAME AREA. THE CONTRACTOR MAY BE REQUIRED TO RESCHEDULE THEIR ACTIVITIES TO ALLOW ADDITIONAL CREWS TO PERFORM THEIR REQUIRED WORK. NO ADDITIONAL COMPENSATION OR ADDITIONAL CONTRACT DAYS WILL BE ALLOWED FOR DELAYS OR INCONVENIENCE CAUSED BY OTHER CONTRACTORS OR UTILITY COMPANY WORK CREWS.
12. WHEN ABUTTING NEW PAVEMENT TO EXISTING, CONTRACTOR SHALL SAW CUT, TO FULL PAVEMENT DEPTH, THE EXISTING PAVEMENT TO A NEAT VERTICAL STRAIGHT LINE AS REQUIRED TO REMOVE ANY BROKEN OR CRACKED PAVEMENT AND MATCH NEW TO EXISTING. TACK COAT SHALL BE APPLIED AT ALL COLD JOINTS OF PAVING OPERATIONS. TACK COAT FOR THIS PURPOSE SHALL BE INCIDENTAL TO THE CONTRACT AND NO MEASUREMENT OR PAYMENT WILL BE MADE THEREFORE.
13. THE CONTRACTOR SHALL ASSUME RESPONSIBILITY FOR ANY DAMAGE TO EXISTING PAVEMENTS, PAVEMENT MARKINGS, CURB AND GUTTER, LANDSCAPING OR SIDEWALK DURING CONSTRUCTION, APART FROM THOSE SECTIONS INDICATED FOR REMOVAL ON THE PLANS, AND SHALL REPAIR OR REPLACE PER CITY OF ALBUQUERQUE STANDARDS AT HIS OWN EXPENSE.
14. CONTRACTOR SHALL BE RESPONSIBLE FOR ACQUIRING, AT HIS OWN EXPENSE, ALL PERMITS NECESSARY FOR CONSTRUCTION.
15. CRITICAL INTERSECTION WORK SHALL NOT START UNTIL THE CONTRACTOR HAS ALL MATERIAL, EQUIPMENT, AND NECESSARY PERSONNEL ON-SITE. TRAFFIC CONTROL DEVICES SHALL NOT BE PLACED PREMATURELY.
16. PARKING OF CONSTRUCTION VEHICLES ON PRIVATE PROPERTY IS THE SOLE RESPONSIBILITY OF THE CONTRACTOR.
17. CONTRACTOR SHALL NOTIFY THE CITY SURVEYOR NOT LESS THAN SEVEN (7) DAYS PRIOR TO STARTING WORK IN ORDER THAT THE CITY SURVEYOR MAY TAKE THE NECESSARY MEASURES TO INSURE THE PRESERVATION OF SURVEY MONUMENTS. CONTRACTORS SHALL NOT DISTURB PERMANENT SURVEY MONUMENTS WITHOUT THE CONSENT OF THE CITY SURVEYOR AND SHALL NOTIFY THE CITY SURVEYOR AND BEAR THE EXPENSE OF REPLACING ANY THAT MAY BE DISTURBED WITHOUT PERMISSION. REPLACEMENT SHALL BE DONE ONLY BY THE CITY SURVEYOR. WHEN A CHANGE IS MADE IN THE FINISHED ELEVATIONS OF THE PAVEMENT OF ANY ROADWAY IN WHICH A PERMANENT SURVEY MONUMENT IS LOCATED, CONTRACTOR SHALL, AT HIS OWN EXPENSE, ADJUST THE MONUMENT COVER TO THE NEW GRADE UNLESS OTHERWISE SPECIFIED. REFER TO SECTION 4.4 OF THE GENERAL CONDITIONS OF THE STANDARD SPECIFICATIONS. IT IS THE CONTRACTOR'S RESPONSIBILITY TO LOCATE AND PROTECT SURVEY MONUMENTS WITHIN THE PROJECT AREA.

8. ALL TRENCHING AND SHORING ACTIVITIES MUST BE CARRIED OUT IN ACCORDANCE, AT A MINIMUM, WITH OSHA 29 CFR 1926.650 SUBPART P. ALL TRENCH EXCAVATION AND BACKFILL SHALL COMPLY WITH STATED DENSITY REQUIREMENTS AND COA STANDARD SPECIFICATION SECTION 701. ALL FINAL BACKFILL FOR TRENCHES WITHIN THE COA RIGHT-OF-WAY SHALL BE COMPACTED TO A MINIMUM OF 95% MAXIMUM DENSITY PER ASTM D-1557.
19. ANY EARTHWORK HAUL ON THIS PROJECT WILL BE CONSIDERED AS INCLUDED IN THE CONTRACT AND NO SEPARATE PAYMENT WILL BE MADE THEREFORE.
20. THE CONTRACTOR SHALL BE RESPONSIBLE FOR ALL REMOVALS REQUIRED TO COMPLETE THE PROJECT. REMOVALS OF CURB & GUTTER AND SIDEWALK SHALL BE TO THE NEAREST JOINT. ADDITIONAL REMOVALS NOT SHOWN ON THE PLANS WILL BE CONSIDERED AS INCLUDED IN THE CONTRACT AND NO SEPARATE PAYMENT WILL BE MADE THEREFORE. HAUL OF REMOVED MATERIALS SHALL BE INCIDENTAL TO THE REMOVAL ITEM FOR THAT MATERIAL.
21. THE CONSTRUCTION CLEAR ZONE FOR THIS PROJECT IS 10 FEET FROM THE EDGE OF DRIVING LANE. THE CONTRACTOR SHALL NOT STORE EQUIPMENT OR MATERIAL WITHIN THE CONSTRUCTION CLEAR ZONE UNLESS THE EQUIPMENT OR MATERIAL IS PROPERLY SHIELDED UTILIZING CURRENT SAFETY DESIGN AND INSTALLATION METHODS. THE SAFETY DESIGN FOR SHIELDING SHALL BE PROVIDED BY THE CONTRACTOR AND MUST BE APPROVED BY THE PROJECT MANAGER BEFORE IMPLEMENTING. THIS WORK, INCLUDING DESIGN, INSTALLATION, AND REMOVAL OF THE SHIELDING, SHALL BE CONSIDERED INCIDENTAL TO THE COMPLETION OF THE PROJECT AND NO SEPARATE MEASUREMENT OR PAYMENT WILL BE MADE THEREFORE.
22. THE CONTRACTOR SHALL MAINTAIN AN UP TO DATE SET OF AS-BUILT PLANS FOR THE PROJECT. THESE PLANS SHALL BE KEPT CURRENT, WITHIN TWO WEEKS, AT ALL TIMES AND SHALL BE SUBJECT TO REVIEW BY THE PROJECT MANAGER THROUGHOUT THE PROJECT AND WILL BE REVISED BY THE PROJECT MANAGER FOR ACCURACY AND COMPLETENESS AT LEAST ONCE EVERY 14 DAYS. THE FINAL AS-BUILT PLANS SHALL BE SUBMITTED TO THE PROJECT MANAGER FOR FINAL REVIEW AND APPROVAL PRIOR TO FINAL PAYMENT. THIS SHALL BE CONSIDERED INCIDENTAL TO THE COMPLETION OF THE PROJECT AND NO SEPARATE MEASUREMENT OR PAYMENT WILL BE MADE THEREFORE.
23. THE CONTRACTOR SHALL COORDINATE WITH THE WATER AUTHORITY SEVEN (7) DAYS IN ADVANCE OF PERFORMING WORK THAT WILL AFFECT THE PUBLIC WATER OR SANITARY SEWER INFRASTRUCTURE. WORK REQUIRING SHUTOFF OF FACILITIES DESIGNATED AS MASTER PLAN FACILITIES MUST BE COORDINATED WITH THE WATER AUTHORITY 14 DAYS IN ADVANCE OF PERFORMING SUCH WORK. ONLY WATER AUTHORITY CREWS ARE AUTHORIZED TO OPERATE PUBLIC VALVES. SHUTOFF REQUESTS MUST BE MADE ONLINE AT [HTTP://ABCWUA.ORG/CONTENT/VIEW/463/72/](http://abcwua.org/content/view/463/72/)
24. ALL WATER VALVE BOXES AND SEWER MANHOLES IN THE CONSTRUCTION AREA THAT REQUIRE ADJUSTMENT TO FINISHED GRADE UNDER THIS CONTRACT WILL BE PAID FOR AT CONTRACT UNIT PRICES. ADJUSTED WATER VALVE COLLARS SHALL BE INSTALLED PER STD. DWG 2326. IF WATER VALVE RING AND COVER DO NOT MATCH CURRENT STD. DWG. 2328, INSTALL NEW RING AND COVER PER STD. DWG 2328. IN ADDITION TO THE VALVE ADJUSTMENT, A SPHERICAL EMD SHALL BE INSTALLED.

25. UPON COMPLETION, THE PAVEMENT SHALL BE TRUE TO GRADE AND CROSS SECTION. EXCEPT ANY CHANGES OF GRADE, WHEN A 10' STRAIGHT EDGE IS LAID ON THE FINISHED SURFACE OF THE ROADWAY, THE SURFACE SHALL NOT VARY FROM THE EDGE OF THE STRAIGHT EDGE MORE THAN 3/16 INCH. AFTER THE COMPLETION OF THE FINAL ROLLING, THE SMOOTHNESS OF THE COURSE SHALL BE CHECKED, AND THE IRREGULARITIES THAT EXCEED SPECIFIED TOLERANCES AND OR RETAIN WATER ON THE SURFACE SHALL BE CORRECTED BY THE CONTRACTOR AT NO COST TO THE OWNER, AS DIRECTED BY THE ENGINEER.
26. CONTRACTOR SHALL BE RESPONSIBLE FOR PROVIDING AND MAINTAINING ALL CONSTRUCTION SIGNING UNTIL PROJECT HAS BEEN ACCEPTED BY THE COA.

1. IF CULTURAL MATERIALS ARE DISCOVERED DURING CONSTRUCTION, ALL WORK WILL CEASE AND THE CITY OF ALBUQUERQUE AND NEW MEXICO HISTORIC PRESERVATION DIVISION WILL BE NOTIFIED.
2. IF SUSPECTED HAZARDOUS MATERIALS ARE ENCOUNTERED DURING CONSTRUCTION, WORK WILL CEASE AT THAT LOCATION AND THE CITY OF ALBUQUERQUE WILL BE CONTACTED FOR PROPER TREATMENT OR DISPOSAL OF THOSE MATERIALS.
3. THE CONTRACTOR SHALL BE RESPONSIBLE FOR REPORTING AND CLEANUP OF SPILLS ASSOCIATED WITH PROJECT CONSTRUCTION AND SHALL REPORT AND RESPOND TO SPILLS OF HAZARDOUS MATERIALS SUCH AS GASOLINE, DIESEL, MOTOR OILS, SOLVENTS, CHEMICALS, TOXIC AND CORROSIVE SUBSTANCES, ETC. WHICH MAY BE A THREAT TO PUBLIC HEALTH OR THE ENVIRONMENT. THE CONTRACTOR SHALL BE RESPONSIBLE FOR REPORTING DISCOVERIES OF PAST SPILLS AND CURRENT SPILLS NOT ASSOCIATED WITH CONSTRUCTION. REPORTS SHALL BE MADE IMMEDIATELY TO THE NM ENVIRONMENT DEPARTMENT EMERGENCY RESPONSE AT 827-9329. NON-EMERGENCIES MAY BE REPORTED TO 428-2500.
4. TO AVOID THE SPREAD AND/OR INTRODUCTION OF STATE-LISTED NOXIOUS WEEDS TO THE PROJECT AREA, THE CONTRACTOR SHALL ENSURE THAT ALL EARTH MOVING EQUIPMENT IS CLEANED PRIOR TO OFFLOADING AND LEAVING THE PROJECT AREA.
5. THE CONTRACTOR SHALL PREPARE A STORM WATER POLLUTION PREVENTION PLAN (SWPPP) IN ACCORDANCE WITH THE NPDES GENERAL PERMIT ISSUED BY THE EPA. IF CONSTRUCTION TAKES PLACE BETWEEN THE MONTHS OF JUNE AND OCTOBER, THE CONTRACTOR MAY APPLY FOR A LOW EROSIONIVITY WAIVER (LEW). THE LEW APPLICATION IS MADE AS PART OF THE NOI PROCESS.

Name	Phones	Business
Chang, Peter	Office Phone: (505) 768-2598 Office Fax: (505) 768-3629	ABCWUA Engineer, Utility Engineering P.O. Box 1293 Albuquerque, NM 87103
pchang@abcwua.org		
Gurule, Andrew	Office Phone: (505) 241-0589 Cell Phone: (505) 208-8014 Office Fax: (505) 241-0559	PNM Electric Co. Mail Stop ES55 4201 Edith Blvd. NW Albuquerque, NM 87107
andrew.gurule@pnm.com		
Hoskins, Earl	Office Phone: (505) 697-3140 Office Fax: (505) 344-0091	NM Gas Co. Mail Stop GS66 4625 Edith Blvd. NE Albuquerque, NM 87107
earl.hoskins@nmgeo.com		
Uzcategui, John	Office Phone: (505) 842-2911 Office Fax: (505) 842-2890	AT&T Resource Supervisor 111 3rd Street NW Albuquerque, NM 87103
ju4329@att.com		
Harrison, Royal	Office Phone: (505) 938-7339 Office Fax: 938-7380	Time Warner Telecom Plant Manager 5411 Jefferson St. NE Suite 200 Albuquerque, NM 87109
Royal.Harrison@twtelecom.com		
Jaramillo, Rita	Office Phone: (505) 245-8352 Office Fax: (505) 245-6733 Cell Phone: (505) 385-4472	Qwest Manager- Engineering NM Engineering/Planning 400 Tijeras NW, Room 710 Albuquerque, NM 87102
rjarami@qwest.com		
Mortus, Mike	Office Phone: (505) 271-3649 Office Fax: (505) 761-0599 Cell Phone: (505) 269-4006	Comcast Project Manager 4611 Montbel Place NE Albuquerque, NM
Mike_Mortus@cable.comcast.com		



**CALL NM ONE-CALL
SYSTEM SEVEN (7) DAYS
PRIOR TO ANY EXCAVATION**



CITY OF ALBUQUERQUE
DEPARTMENT OF MUNICIPAL DEVELOPMENT
ENGINEERING DIVISION

NEAR HEIGHTS FLOOD CONTROL

GENERAL NOTES

DESIGN REVIEW COMMITTEE



CITY ENGINEER APPROVAL



ZONE MAP NO.

J-17

CITY PROJECT NO.

SHEET NO.

1-3, 3 of 15 |

RECORD DRAWING

Layout: 8/7/2013 3:21 PM BY: SMITH, RAYMOND J.
Last Saved: 8/7/2013 3:21 PM BY: SMITH, RAYMOND J.
K:\PROJECTS\56036\PRJ\DWG\PLANS\56036S001.DWG

BID ITEM #	ITEM ID NO.	ITEM DESCRIPTION	UNIT	ESTIMATED QUANTITY
1	4.010	CONSTRUCTION STAKING, COMPLETE	LS	1
2	6.010	CONSTRUCTION PROJECT SIGN AND PROJECT PUBLICITY PER SUPPLEMENTAL SPECIAL PROVISIONS SECTION 4, CIP.	EA	2
3	19.010	CONSTRUCTION TRAFFIC CONTROL & BARRICADING, COMPLETE	LS	1
4	340.01a	SIDEWALK, 4" THICK, PORTLAND CEMENT CONCRETE, INCL SUBGRADE COMPACTION (FOR QUANTITIES LESS THAN 35 SY), CIP SD 2430	SY	35
5	340.05a	CURB & GUTTER, STANDARD, PORTLAND CEMENT CONCRETE, INCL. SUBGRADE PREP (FOR QUANTITIES LESS THAN 300 LF), CIP SD 2415	LF	25
6	343.080	EXISTING CURB AND GUTTER OR VALLEY GUTTER, PC CONCRETE, REMOVE AND DISPOSE, COMPLETE	LF	60
7	343.090	EXISTING SIDEWALK AND/OR DRIVEPAD, SAWCUT, REMOVE AND DISPOSE, COMPL.	SY	35
8	343.11	EXISTING RESIDENTIAL ASPHALT PAVEMENT, REMOVE AND REPLACE, INCL 2" EXTRA THICKNESS, WITHOUT MACHINE LAYDOWN, WHERE SUBBASE MATERIAL CAN BE PROCESSED, ANY THICKNESS, CIP	SY	270
9	701.1	TRENCHING, BACKFILLING AND COMPACTION INCLUDING SHORING EQUIPMENT AND MAINTAINING ACCESS TO RESIDENCES AND/OR BUSINESSES FOR 18" TO 36" SEWER PIPE, GREATER THAN 8' AND THAN THAN OR EQUAL TO 12' TRENCH DEPTH, PIPE NOT INCLUDED.	LF	110
10	801.00X	8 INCH DUCTILE IRON WATERLINE, INCLUDING FITTINGS, RESTRAINED JOINTS, TRENCHING, BACKFILLING, COMPACTION, TESTING, DISINFECTION, MARKER TAPE AND EMDs, CIP. SD 2381	LF	50
11	801.059	NON-PRESSURIZED CONNECTION, EXISTING WATERLINE, ALL SIZES, INCL. FITTINGS, COMPL.	EA	4
12	802.3XX	EXISTING WATER SERVICE LINE REPLACEMENT & TRANSFER, INCLUDING TAPPING SADDLE & TUBING, ANY SIZE, CIP. SD 2362 OR 2363.	EA	4
13	910.005	18" REINFORCED CONCRETE PIPE, CLASS III, FURNISH AND PLACE IN OPEN TRENCH, CIP	LF	91
14	910.006	18" REINFORCED CONCRETE PIPE, CLASS IV, FURNISH AND PLACE IN OPEN TRENCH, CIP	LF	24
15	910.103	DRAINLINE REMOVAL AND DISPOSAL, 10" TO 18". TRENCHING INCLUDED WHEN REMOVAL IS IN CONJUNCTION WITH A NEW INSTALLATION	LF	45
16	915.040	CATCH BASIN, TYPE "C", DOUBLE GRATE, CIP. SD 2205 & 2220	EA	6
17	915.070	CATCH BASIN, EXISTING, REMOVE & DISPOSE, ANY TYPE, INCL CLEANUP, COMPL.	EA	4
18	920.130	MANHOLE, 6' DIA, TYPE C, LESS THAN 6' DEEP, CIP. SD 2101	EA	2
19	920.140	MANHOLE, 6' DIA, TYPE C OR E, 6'-10' DEEP, CIP. SD 2101 & 2102	EA	1
20	920.57	EXISTING MANHOLE, REMOVE AND DISPOSE, ALL DEPTHS, 4' DIA TO 6' DIA, CIP	EA	2
21	920.58x	LEAN FILL MATERIAL FOR; PLUGGING EXISTING CATCH BASINS AND LATERAL PIPES (ALL SIZES) INCLUDES REMOVAL OF INLET GRATE AND FRAME; FOR ENCASEMENT OF EXISTING SANITARY, SD 2140; FOR RELOCATION OF EXISTING WATERLINE S, SD 2381.	CY	50
		ALLOWANCES		
22	621.4.1	MOBILIZATION, COMPLETE (5%)	LS	1
23	621.4.2	DEMOBILIZATION, COMPLETE (5%)	LS	1
24	450.XX	PROJECT SIGN SCREEN	EA	2
25	18.6.1	UTILITY RELOCATION	1	ALLOW
26	13.2.2	LAB TESTING	1	ALLOW

NOTE:
1. SUMMARY OF QUANTITIES IS PROVIDED FOR CONTRACTOR'S INFORMATION ONLY.
2. PAYMENT ITEMS BASED ON COA CURRENT ON-CALL CONSTRUCTION CONTRACT
3. CONTRACTOR SHALL BE PAID FOR QUANTITIES CONSTRUCTED IN PLACE.

INCIDENTALS:
TACK COAT
EARTHWORK AND REMOVAL HAUL
VIBRATION MONITORING
NOTIFICATION OF PROPERTY OWNERS
ALL PERMITTING

GENERAL STORMDRAIN NOTES

- ALL STORM DRAIN CONSTRUCTION SHALL CONFORM TO THE APPLICABLE PROVISIONS OF APWA, NEW MEXICO STANDARD SPECIFICATIONS FOR PUBLIC WORKS CONSTRUCTION, 1987, WITH CURRENT REVISIONS, AND THE MANUFACTURER'S RECOMMENDATIONS FOR THE PRODUCT USED, EXCEPT AS OTHERWISE NOTED BELOW.
- MANHOLE FRAME & COVER ASSEMBLIES SHALL BE FURNISHED WITH GRATED COVERS SIMILAR TO NEENAH, TYPE C GRATE.
- STORM DRAIN PIPE MATERIALS SHALL CONFORM TO ONE OF THE FOLLOWING SPECIFICATIONS, OR AN APPROVED EQUAL:

TYPE OF PIPE	PIPE SPECIFICATION	JOINT SPEC.
REINFORCED CONCRETE PIPE	ASTM C 76	ASTM C 443
SPIRAL RIB CORRUGATED METAL PIPE *	ASTM A 780, ALUM. STEEL, TYPE 2, 16 GA. MIN.	ASTM C 443
PVC RIBBED GRAVITY SEWER PIPE	AASHTO M 304	ASTM D 3212
CORRUGATED POLYETHYLENE PIPE	AASHTO M 294, TYPE S	ASTM D 3212

* ALUMINIZED STEEL PIPE SHALL BE PAINTED WITH AN APPROVED PAINT WHERE IT WILL BE IN CONTACT WITH FRESH CONCRETE OR GROUT PRIOR TO PLACING THE CONCRETE OR GROUT.



CALL NM ONE-CALL
SYSTEM SEVEN (7) DAYS
PRIOR TO ANY EXCAVATION



CITY OF ALBUQUERQUE
DEPARTMENT OF MUNICIPAL DEVELOPMENT
ENGINEERING DIVISION

NEAR HEIGHTS FLOOD CONTROL

SUMMARY OF QUANTITIES

DESIGN REVIEW COMMITTEE

CITY ENGINEER APPROVAL

ZONE MAP NO.

J-17

CITY PROJECT NO.

5498.91

SHEET NO.

1-4, 4 of 15

RECORD DRAWING

CONSULTANTS

Gannett Fleming West, Inc.

Excellence Delivered As Promised

2155 LOUISIANA BLVD. NE
SUITE 7000
ALBUQUERQUE, NEW MEXICO 87110
505-265-8468

BENCH MARKS

PROJECT BENCHMARK IS A STANDARD CITY OF ALBUQUERQUE SURVEY CONTROL 1 3/4 INCH ALUMINUM DISC EPOXYED TO CENTER OF THE TOP OF A CONCRETE DROP INLET, ON THE EAST SIDE OF SAN MATEO OF THE BOULEVARD N.E., 17.9 FEET SOUTH OF S.S.E. CURB P.C. AT SUMMER AVENUE, AND STAMPED "ACS BM 24-J18. ELEVATION = 5,232.58 FEET (NAVD 1988 VERTICAL DATUM).



SEAL

BY

DESCRIPTION
CONTRACTOR:

DATE

NO.

DESIGNED BY: RJS

DRAWN BY: ARB

CHECKED BY: EJM

DATE

APRIL 2013

DATE

DATE

DATE

DATE

DATE

DATE

DATE

DATE

DATE

DATE

DATE

DATE

DATE

DATE

DATE

DATE

DATE

DATE

DATE

DATE

DATE

DATE

DATE

DATE

DATE

DATE

[illegible]

Layout1
Last Saved: 8/6/2013 11:41 AM BY: SMITH, RAYMOND J.
K:\PROJECTS\156036\PRJ\DWG\PLANS\156036JTD1.DWG

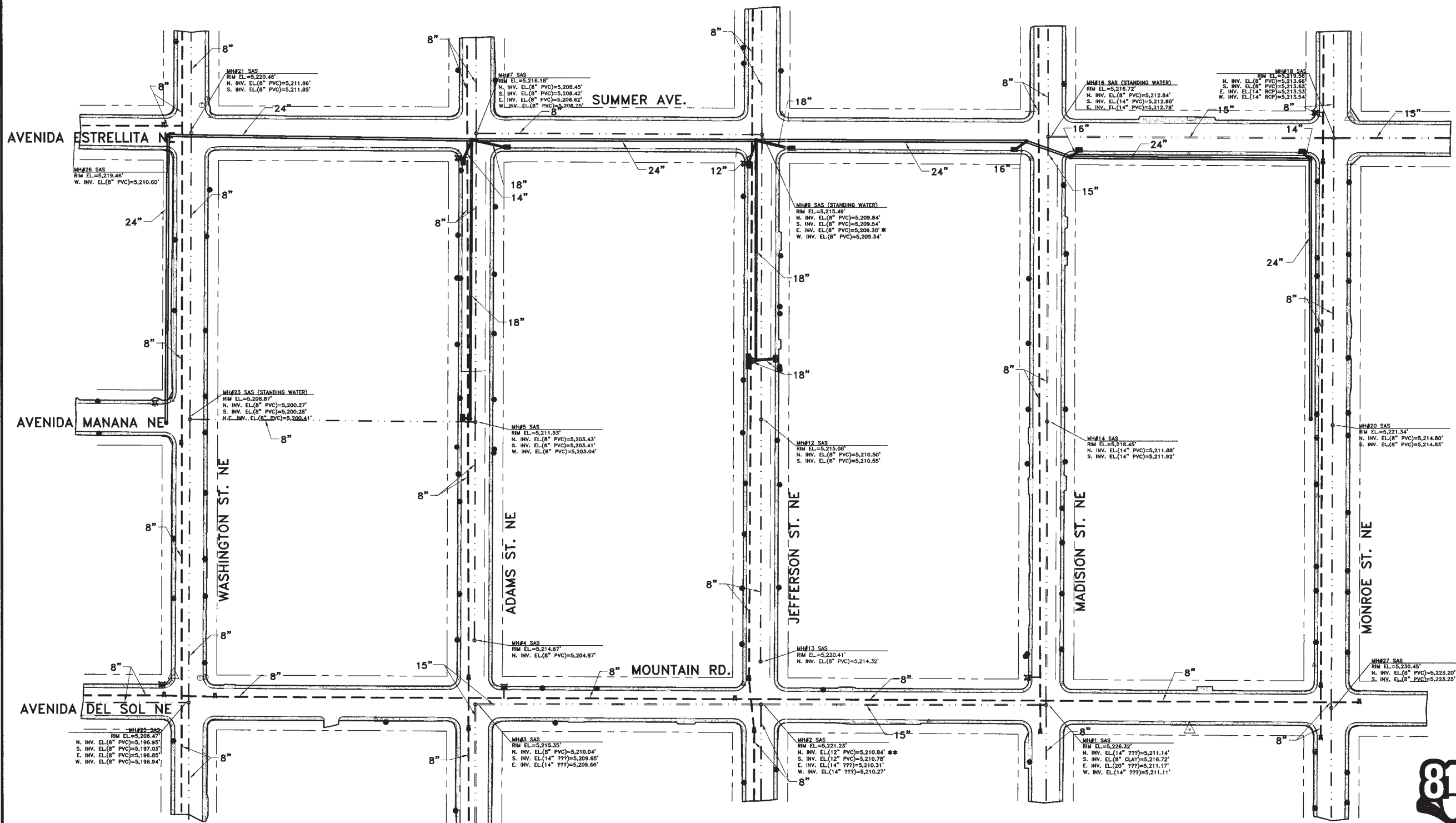

LEGEND

EX. STORM DRAIN (SIZE AS NOTED)	=====
EX. WATERLINE (SIZE AS NOTED)	-----
EX. SANITARY SEWER (SIZE AS NOTED)	- - - - -

NOTES:

*DISCREPANCY BETWEEN
SURVEY AND UTILITY MAPPING.
NO SAS LINE SHOWN GOING
EAST.

**DISCREPANCY BETWEEN
SURVEY AND UTILITY MAPPING.
NO SAS CONNECTION TO THE
NORTH IS SHOWN.

UTILITIES DISCLAIMER

1. EXISTING UTILITY INFORMATION SHOWN IS BASED ON BEST AVAILABLE DATA FROM TOPOGRAPHIC SURVEY AND INFORMATION PROVIDED BY UTILITY OWNER(S).
2. CONTRACTOR SHALL VERIFY BOTH HORIZONTAL AND VERTICAL LOCATIONS OF UTILITIES PRIOR TO CONSTRUCTION.
3. VERIFICATION OF UTILITIES SHALL BE INCIDENTAL TO THE PROJECT AND NO ADDITIONAL PAYMENT WILL BE MADE.
4. CONTRACTOR SHALL NOTIFY OWNER AND ENGINEER, IN WRITING, OF ANY CONFLICTS SO THAT THEY MAY BE RESOLVED WITH MINIMAL DELAY.

RECORD DRAWING



SCALE: 1" = 60'



CALL NM ONE-CALL
SYSTEM SEVEN (7) DAYS
PRIOR TO ANY EXCAVATION



CITY OF ALBUQUERQUE
DEPARTMENT OF MUNICIPAL DEVELOPMENT
ENGINEERING DIVISION

NEAR HEIGHTS FLOOD CONTROL
EXISTING UTILITIES PLAN



DESIGN REVIEW COMMITTEE	CITY ENGINEER APPROVAL	ZONE MAP NO.
		J-17
		CITY PROJECT NO.
		5498.91
		SHEET NO.
		2-2, 7 of 15

SEAL

BENCH MARKS

CONSULTANT'S



PROJECT BENCHMARK IS A STANDARD CITY
OF ALBUQUERQUE SURVEY CONTROL 1 3/4
INCH ALUMINUM DISC EPOXY TO CENTER
OF THE TOP OF A CONCRETE DROP INLET,
ON THE EAST SIDE OF SAN MATEO
BOULEVARD N.E., 17.9 FEET SOUTH OF THE
S.E. CURB P.C. AT SUMMER AVENUE, AND
STAMPED "ACS BM 24-J18. ELEVATION =
5,232.58 FEET (NAVD 1988 VERTICAL
DATUM).

Gannett Fleming West, Inc.
2155 LOUISIANA BLVD. NE
SUITE 7000
ALBUQUERQUE, NEW MEXICO 87110
505-265-8468



WATER SHUT-OFF PLAN

NOT TO SCALE

2-3 0804 8/6/2013 11:44 AM B:\SWT\BANKS\B_1\PROJECTS\5498\CRUMK\CAUD\PLANS\5498JUT02.DWG

RECORD DRAWING

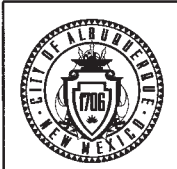

811
CALL NM ONE-CALL
SYSTEM SEVEN (7) DAYS
PRIOR TO ANY EXCAVATION

DESIGN REVIEW COMMITTEE		CITY ENGINEER APPROVAL	ZONE MAP NO.
			J-17
			CITY PROJECT NO.
			5498.91
			SHEET NO.
			2-3, 8 of 15

DESIGNED BY: RJS	
DRAWN BY: ARB	
CHECKED BY: E.JH	
DATE: APRIL 2013	
CITY OF ALBUQUERQUE DEPARTMENT OF MUNICIPAL DEVELOPMENT ENGINEERING DIVISION	
NEAR HEIGHTS FLOOD CONTROL	
WATER SHUTOFF PLAN	
PROJECT BENCHMARK IS A STANDARD CITY OF ALBUQUERQUE SURVEY CONTROL 1 3/4 INCH ALUMINUM DISC EPOXYED TO CENTER OF THE TOP OF A CONCRETE DROP INLET, ON THE EAST SIDE OF SAN MATEO BOULEVARD N.E., 17.9 FEET SOUTH OF THE S.S.E. CURB P.C. AT SUMMER AVENUE, AND STAMPED "ACS BM 24-J18. ELEVATION = 5,232.58 FEET (NAVD 1988 VERTICAL DATUM)".	
CONSULTANT'S Gannett Fleming West, Inc. Excellence Delivered At Reasonable Cost 2155 LOUISIANA BLVD. NE SUITE 7000 ALBUQUERQUE, NEW MEXICO 87110 505-265-8468	
BENCH MARKS	
SEAL 	
NO.	DATE
DESCRIPTION	BY
CONTRACTOR:	DATE:
WORK STACKED BY:	DATE:
INSPECTORS ACCEPTANCE BY:	DATE:
FIELD VERIFICATION BY:	DATE:
DRAWINGS CORRECTED BY:	DATE:

Layout1
Last Saved: 8/7/2013 9:03 AM By: SMITH, RAYMOND J.
K:\PROJECTS\96036\PRJ\WK CAD\PLANS\96036.LOT.DWG

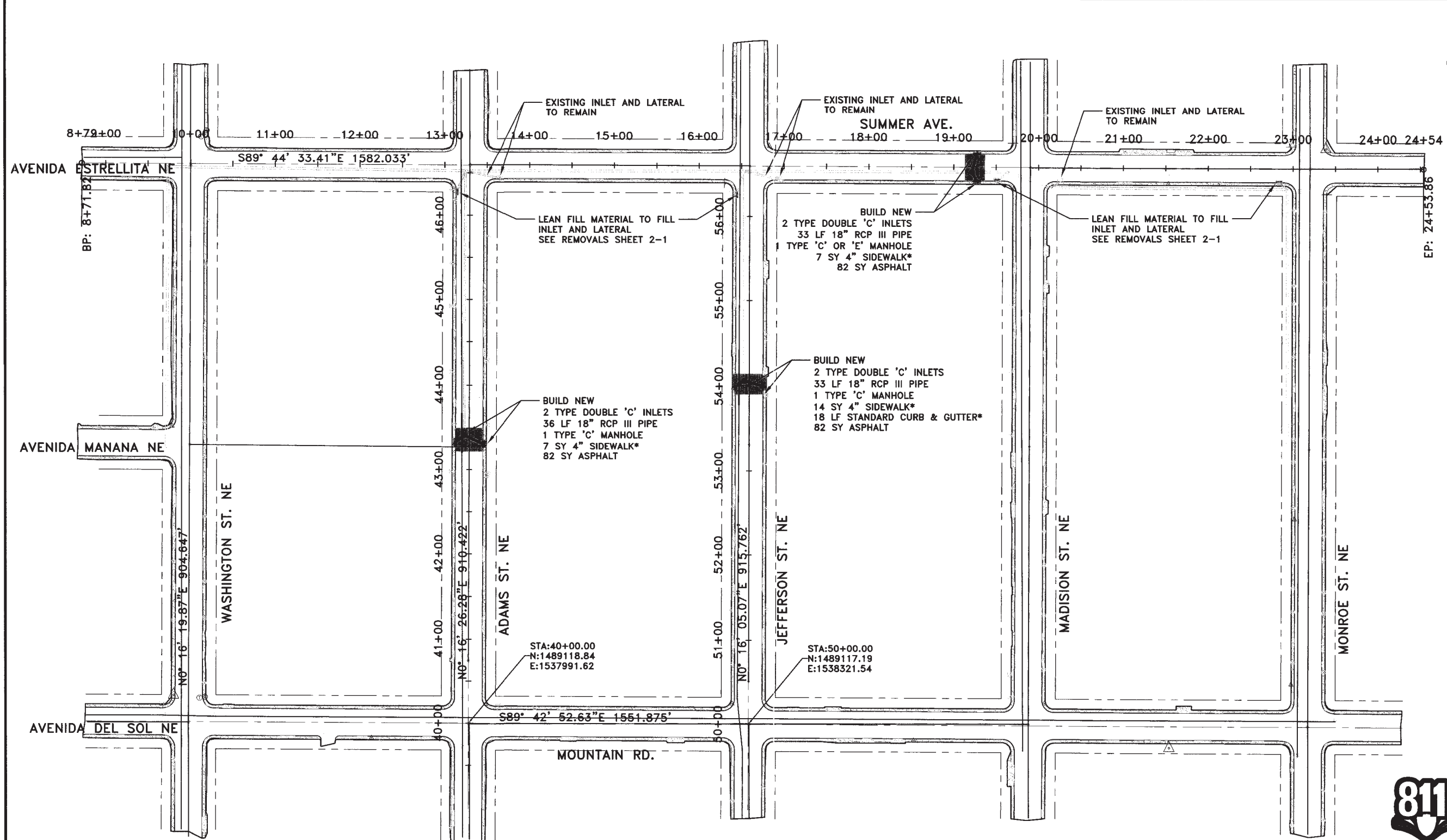

LEGEND

- EX. STORM DRAIN (SIZE AS NOTED)
- EX. WATERLINE (SIZE AS NOTED)
- EX. SANITARY SEWER (SIZE AS NOTED)
- NEW STORM DRAIN PIPE
- NEW CURB INLET
- NEW MANHOLE

COA STANDARD DRAWINGS

ITEM	DWG#
STANDARD CURB & GUTTER	2415A
SIDEWALK	2430
PAVEMENT SECTION	2465
TYPE DBL "C" INLET	2205
INLET GRATE	2220
TYPE "C" MANHOLE	2101
TYPE "E" MANHOLE	2102

NOTES:

- * APPROXIMATE QUANTITY. REMOVAL SHALL BE TO THE NEAREST JOINT.
- SEE SHEETS 3-2 TO 3-4 FOR STORM DRAINS.
- SEE SHEETS 4-1 TO 4-2 FOR CURB & GUTTER, SIDEWALK AND PAVEMENT.

RECORD DRAWING

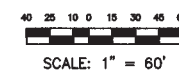

SCALE: 1" = 60'



CALL NM ONE-CALL
SYSTEM SEVEN (7) DAYS
PRIOR TO ANY EXCAVATION



CITY OF ALBUQUERQUE
DEPARTMENT OF MUNICIPAL DEVELOPMENT
ENGINEERING DIVISION

NEAR HEIGHTS FLOOD CONTROL
PROPOSED PROJECT LAYOUT



DESIGN REVIEW COMMITTEE
CITY ENGINEER APPROVAL
ZONE MAP NO.
J-17
CITY PROJECT NO.
5498.91
SHEET NO.
3-1, 10 of 15

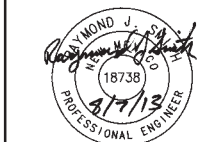

PROJECT BENCHMARK IS A STANDARD CITY OF ALBUQUERQUE SURVEY CONTROL 1 3/4 INCH ALUMINUM DISC EPOXYED TO CENTER OF THE TOP OF A CONCRETE DROP INLET, ON THE EAST SIDE OF SAN MATEO BOULEVARD N.E., 17.9 FEET SOUTH OF THE S.S.E. CURB P.C. AT SUMMER AVENUE, AND STAMPED "ACS BM 24-J18. ELEVATION = 5,232.58 FEET (NAVD 1988 VERTICAL DATUM).

CONSULTANTS
Gannett Fleming West, Inc.
Excellence Delivered At Every Step
2155 LOUISIANA BLVD., NE
SUITE 7000
ALBUQUERQUE, NEW MEXICO 87110
505-265-8468

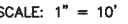

- | |
|------------------------------------|
| ZONE MAP NO.
J-17 |
| CITY PROJECT NO.
5498.91 |
| SHEET NO.
3-2, 11 of 15 |

DESIGNED BY:	RJS
DRAWN BY:	ARB
CHECKED BY:	EJH
DATE	APRIL 2013

JEFFERSON STREET AND MOUNTAIN
ROAD INTERSECTION
± 400' SOUTH

JEFFERSON STREET AND SUMMER
AVE INTERSECTION
± 250' NORTH

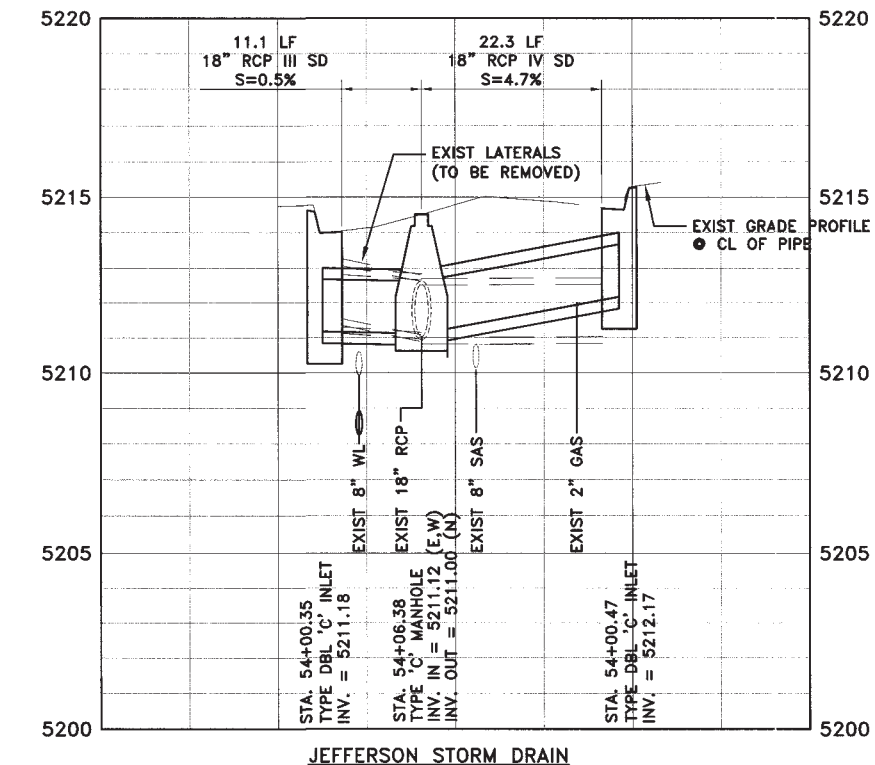
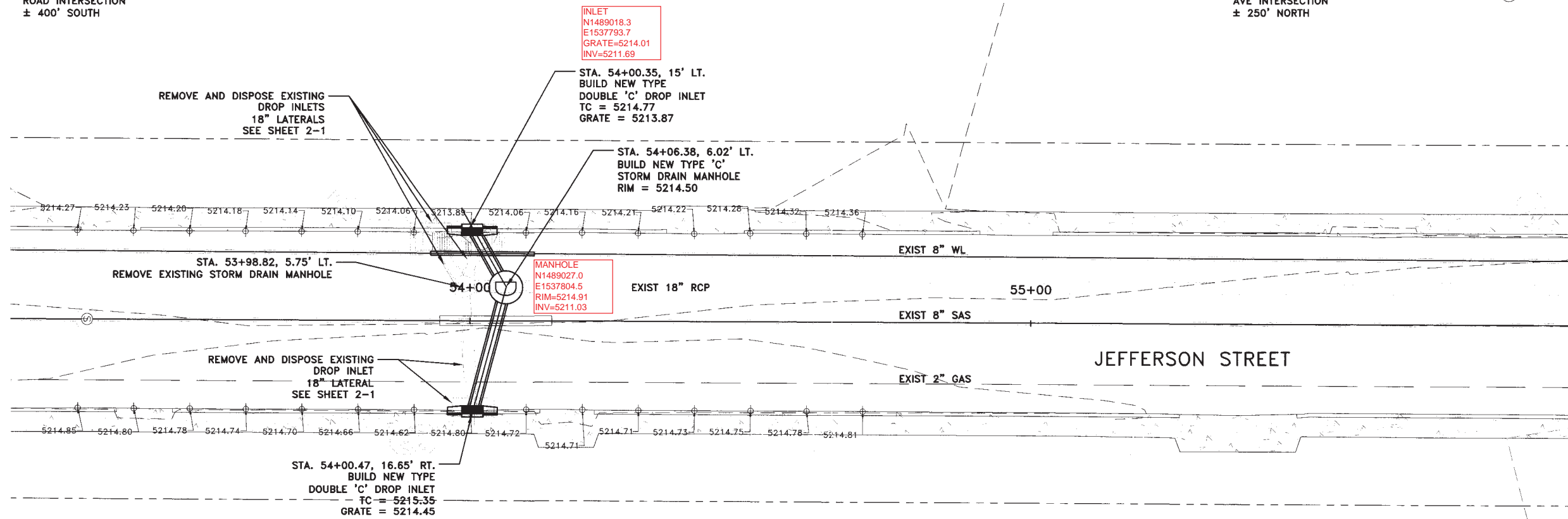

- NOTES:
1. SEE SHEET 2-1 FOR REMOVALS
 2. SEE SHEET 4-1 AND 4-2 FOR CURB & GUTTER, SIDEWALK AND PAVING.
 3. SEE SHEET 2-3 FOR UTILITY RELOCATION PLANS.
 4. SPOT ELEVATIONS SHOWN ARE FLOWLINE OF CURB.
 5. CONNECTION OF EXISTING STORM DRAIN TO NEW MANHOLE IS INCIDENTAL TO MANHOLE CONSTRUCTION.
 6. EXISTING 8" SANITARY LINE TO BE ENCASED IN LEAN FILL MATERIAL PER COA STD 2140, SEE SHEET 2-4.
 7. FOR INLET ON EAST SIDE OF JEFFERSON, DISTANCE FROM GRATE TO CROWN OF PIPE SHOULD BE 1'-0" (DIMENSION "G" ON SD 2205).

COA STANDARD DRAWINGS	
ITEM	DWG#
ENCASEMENT OF SAS	2140
STANDARD CURB & GUTTER	2415A
SIDEWALK	2430
PAVEMENT SECTION	2465
TYPE DBL "C" INLET	2205
INLET GRATE	2220
TYPE "C" MANHOLE	2101
TYPE "E" MANHOLE	2102



CALL NM ONE-CALL
SYSTEM SEVEN (7) DAYS
PRIOR TO ANY EXCAVATION

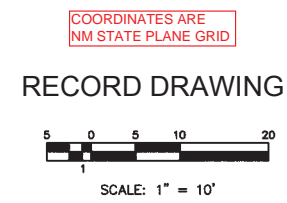

CITY OF ALBUQUERQUE
DEPARTMENT OF MUNICIPAL DEVELOPMENT
ENGINEERING DIVISION

NEAR HEIGHTS FLOOD CONTROL
JEFFERSON STREET
STORM DRAIN PLAN AND PROFILE

DESIGN REVIEW COMMITTEE	CITY ENGINEER APPROVAL	ZONE MAP NO.
		J-17
	CITY ENGINEER	CITY PROJECT NO.
		5498.91
		SHEET NO.
		3-3, 12 of 15

CONSULTANTS

Gannett Fleming West, Inc.
Excellence Delivered As Promised
2155 LOUISIANA BLVD. NE
SUITE 7000
ALBUQUERQUE, NEW MEXICO 87110
505-265-8468

BENCHMARK IS A STANDARD CITY
OF ALBUQUERQUE SURVEY CONTROL 1 3/4
INCH ALUMINUM DISC EPOXYED TO CENTER
OF THE TOP OF A CONCRETE DROP INLET,
ON THE EAST SIDE OF SAN MATEO
BOULEVARD N.E., 17.9 FEET SOUTH OF THE
S.S.E. CURB P.C. AT SUMMER AVENUE, AND
STAMPED "ACS BM 24-J18. ELEVATION =
5,232.58 FEET (NAVD 1988 VERTICAL
DATUM).



SEAL		BY		DATE	
	DESCRIPTION	CONTRACTOR	NO.	DATE	DATE
	AS-BUILT INFORMATION	CONTRACTOR	NO.	DATE	DATE
	WORK STACKED BY:	CONTRACTOR	NO.	DATE	DATE
	INSPECTOR'S ACCEPTANCE BY:	CONTRACTOR	NO.	DATE	DATE
	FIELD VERIFICATION BY:	CONTRACTOR	NO.	DATE	DATE
	DRAWINGS CORRECTED BY:	CONTRACTOR	NO.	DATE	DATE

DESIGNED BY: RJS
DRAWN BY: ARB
CHECKED BY: EJM
DATE: APRIL 2013

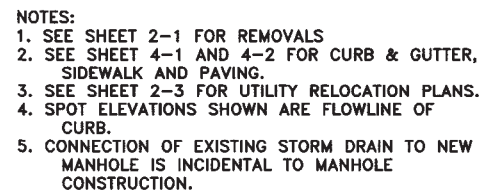
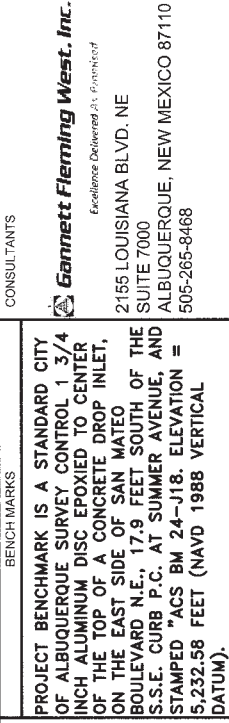

ITEM	DWG#
STANDARD CURB & GUTTER	2415A
SIDEWALK	2430
PAVEMENT SECTION	2465
TYPE DBL "C" INLET	2205
INLET GRATE	2220
TYPE "C" MANHOLE	2101
TYPE "E" MANHOLE	2102



**CALL NM ONE-CALL
SYSTEM SEVEN (7) DAYS
PRIOR TO ANY EXCAVATION**



CITY OF ALBUQUERQUE
DEPARTMENT OF MUNICIPAL DEVELOPMENT
ENGINEERING DIVISION

NEAR HEIGHTS FLOOD CONTROL
ADAMS STREET
STORM DRAIN PLAN AND PROFILE



ZONE MAP NO. J-17
CITY PROJECT NO. 5498.91
SHEET NO. 3-4, 13 of 15

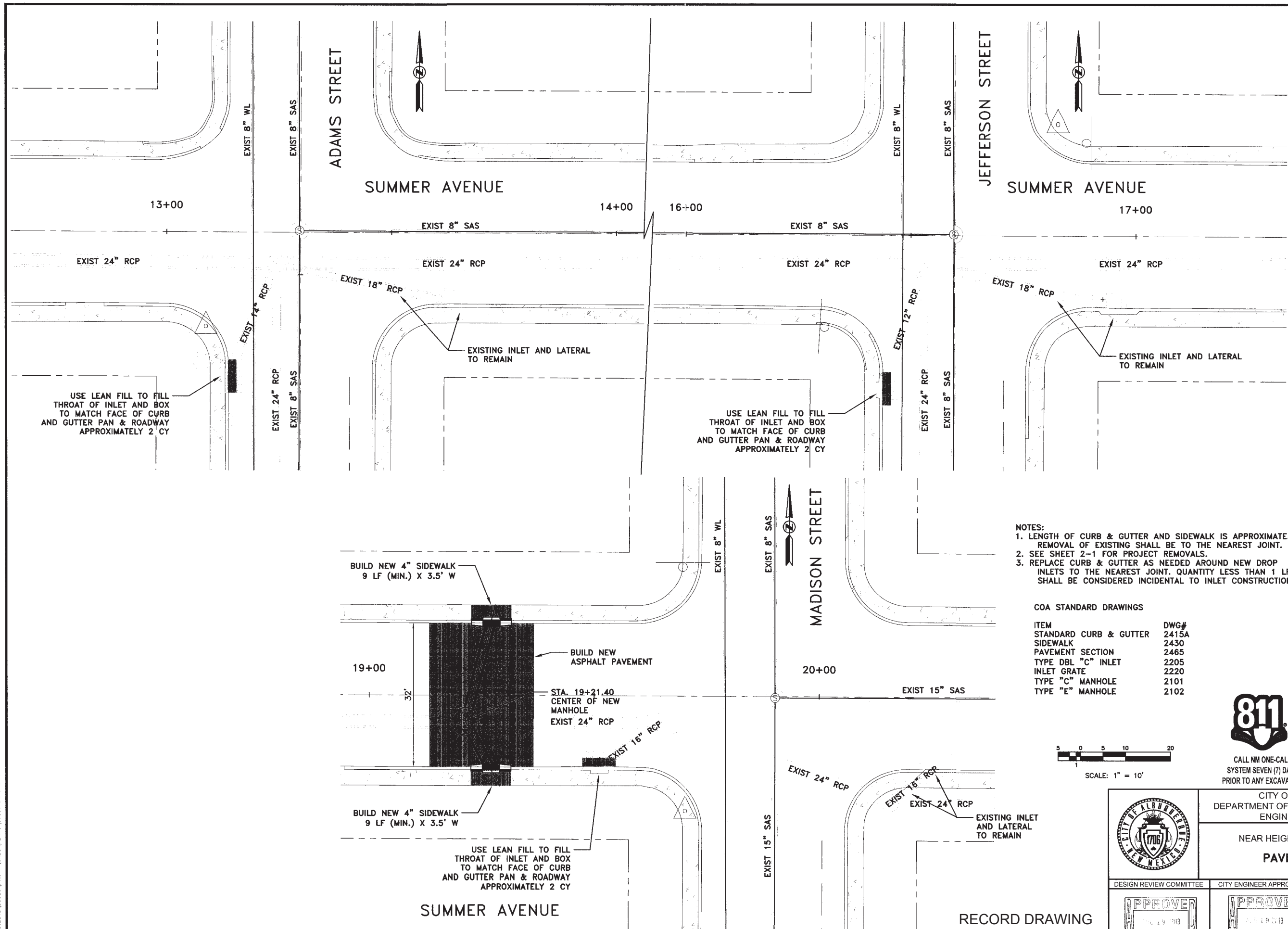

RECORD DRAWING

Gannett Fleming West, Inc.
Excellence Delivered™ All Overlaid

 2155 LOUISIANA BLVD. NE
SUITE 7000
ALBUQUERQUE, NEW MEXICO 87110
505-265-8468

PROJECT BENCHMARK IS A STANDARD CITY
OF ALBUQUERQUE SURVEY CONTROL 1 3/4
INCH ALUMINUM DISC EXPOISED TO CENTER
OF THE TOP OF A CONCRETE DROP INLET,
ON THE EAST SIDE OF SAN MATEO
BOULEVARD N.E., 17.9 FEET SOUTH OF THE
S.S. CURB P.C. AT SUMMER AVENUE, AND
DISTANCE STAMPED "ACS BM 24-J18. ELEVATION =
5,232.58 FEET (NAVD 1988 VERTICAL
DATUM).

[illegible]

DESIGNED BY:	RJS
DRAWN BY:	ARB
CHECKED BY:	EJH
DATE	APRIL 2013

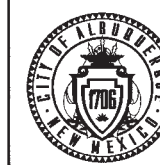

CITY OF ALBUQUERQUE
DEPARTMENT OF MUNICIPAL DEVELOPMENT
ENGINEERING DIVISION

NEAR HEIGHTS FLOOD CONTROL

PAVING DETAILS

DESIGN REVIEW COMMITTEE

CITY ENGINEER APPROVAL

ZONE MAP NO. _____

J-17

5498 91

SHEET NO. **4-1. 14 of 15**

4-2
Last Saved: 8/7/2013 4:30 PM By: SMITH, RAYMOND J.
K:\PROJECTS\5498.91\Drawings\4-2.dwg

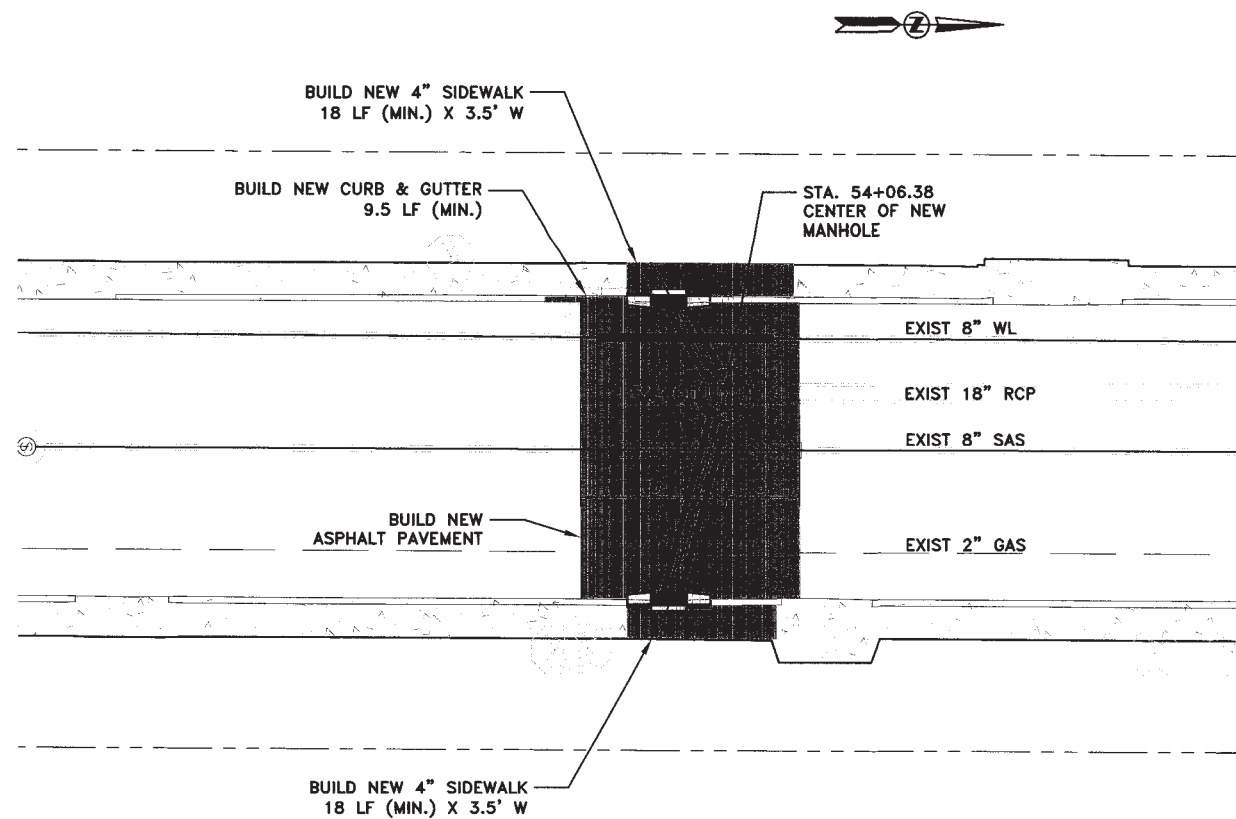

JEFFERSON STREET

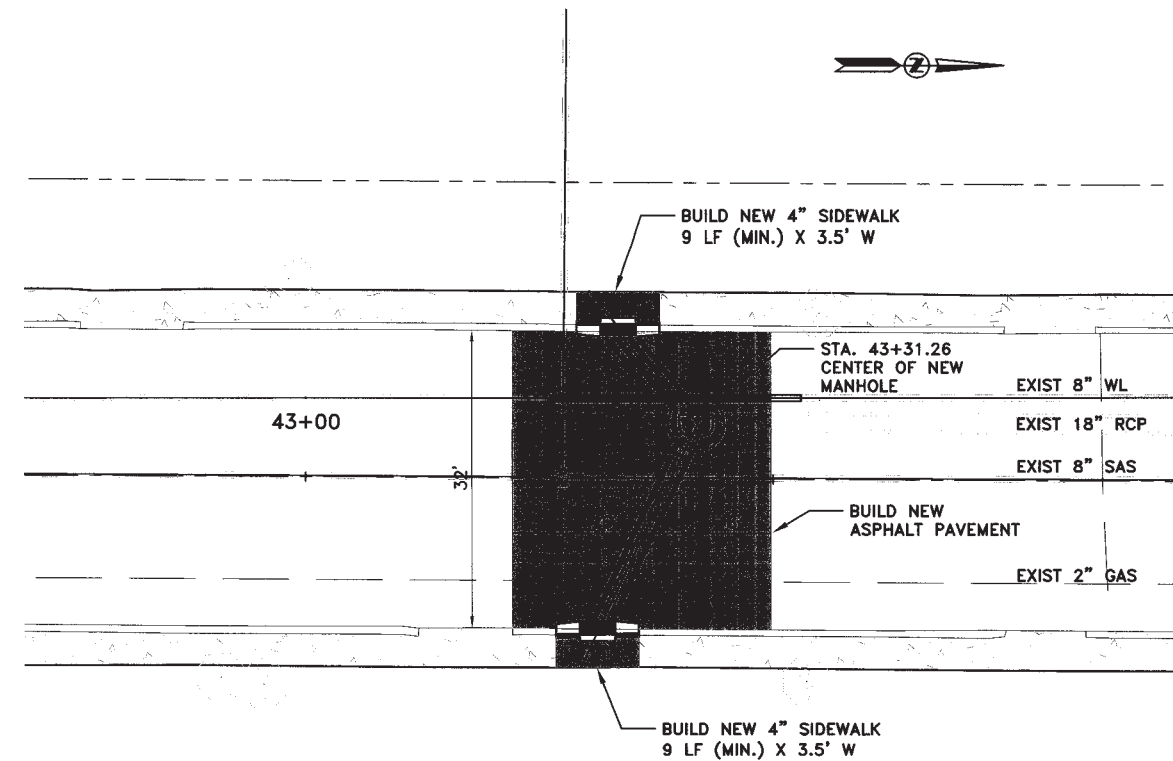

ADAMS STREET

- NOTES:
1. LENGTH OF CURB & GUTTER AND SIDEWALK IS APPROXIMATE. REMOVAL OF EXISTING SHALL BE TO THE NEAREST JOINT.
 2. SEE SHEET 2-1 FOR PROJECT REMOVALS.
 3. REPLACE CURB & GUTTER AS NEEDED AROUND NEW DROP INLETS TO THE NEAREST JOINT. QUANTITY LESS THAN 1 LF SHALL BE CONSIDERED INCIDENTAL TO INLET CONSTRUCTION.

COA STANDARD DRAWINGS

ITEM	DWG#
STANDARD CURB & GUTTER	2415A
SIDEWALK	2430
PAVEMENT SECTION	2465
TYPE DBL "C" INLET	2205
INLET GRATE	2220
TYPE "C" MANHOLE	2101
TYPE "E" MANHOLE	2102

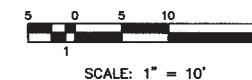

CALL NM ONE-CALL
SYSTEM SEVEN (7) DAYS
PRIOR TO ANY EXCAVATION

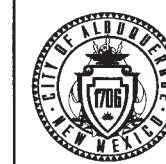

CITY OF ALBUQUERQUE
DEPARTMENT OF MUNICIPAL DEVELOPMENT
ENGINEERING DIVISION

NEAR HEIGHTS FLOOD CONTROL

PAVING DETAILS



DESIGN REVIEW COMMITTEE
CITY ENGINEER APPROVAL
ZONE MAP NO.
J-17
CITY PROJECT NO.
5498.91
SHEET NO.
4-2, 15 of 15

SEAL

BENCHMARK

PROJECT BENCHMARK IS A STANDARD CITY OF ALBUQUERQUE SURVEY CONTROL 1 3/4 INCH ALUMINUM DISC EPOXYED TO CENTER OF THE TOP OF A CONCRETE DROP INLET, ON THE EAST SIDE OF SAN MATEO BOULEVARD N.E., 17.9 FEET SOUTH OF THE S.S.E. CURB P.C. AT SUMMER AVENUE, AND STAMPED "ACS BM 24-J18. ELEVATION = 5,232.58 FEET (NAVD 1988 VERTICAL DATUM).

CONSULTANTS

Gannett Fleming West, Inc.
Excellence Delivered As Promised
2155 LOUISIANA BLVD. NE
SUITE 7000
ALBUQUERQUE, NEW MEXICO 87110
505-265-8468