

LANDSCAPE CONSTRUCTION PLANS
FOR
HIGH DESERT COMMUNITY
CORTADERIA EXTENSION SOUTH STREETScape
CITY PROJECT NO. 553581

INDEX

SHEET NUMBER	DESCRIPTION
1	TITLE SHEET
2	SIDEWALK LAYOUT AND DIMENSIONING PLAN
3	PLANTING PLAN
4	PLANTING PLAN
5	PLANTING PLAN
6	PLANTING PLAN
7	PLANTING PLAN
8	PLANTING AND CONSTRUCTION DETAILS
9	IRRIGATION PLAN
10	IRRIGATION PLAN
11	IRRIGATION PLAN
12	IRRIGATION PLAN
13	IRRIGATION PLAN
14	IRRIGATION DETAILS
15	IRRIGATION DETAILS

CONSTRUCTION NOTES:

1. ALL WORK DETAILED ON THESE PLANS AND PERFORMED UNDER THIS CONTRACT SHALL BE CONSTRUCTED IN ACCORDANCE WITH THE CITY OF ALBUQUERQUE STANDARD SPECIFICATIONS FOR PUBLIC WORKS CONSTRUCTION, LATEST EDITION.
2. THE CONTRACTOR SHALL ABIDE BY ALL LOCAL, STATE, AND FEDERAL LAWS, RULES AND REGULATIONS WHICH APPLY TO THE CONSTRUCTION OF THESE IMPROVEMENTS.
3. PRIOR TO CONSTRUCTION, THE CONTRACTOR SHALL EXCAVATE AND VERIFY THE HORIZONTAL AND VERTICAL LOCATIONS OF ALL POTENTIAL OBSTRUCTIONS. SHOULD A CONFLICT EXIST, THE CONTRACTOR SHALL NOTIFY THE CONSTRUCTION OBSERVER SO THAT THE CONFLICT CAN BE RESOLVED WITH A MINIMUM AMOUNT OF DELAY.
4. TWO (2) WORKING DAYS PRIOR TO ANY EXCAVATION, THE CONTRACTOR SHALL CONTACT LINE LOCATING SERVICE FOR LOCATION OF EXISTING UTILITIES.
5. ALL ELECTRICAL, TELEPHONE, CABLE TV, GAS AND OTHER UTILITIY LINES, CABLES, AND APPURTENANCES ENCOUNTERED DURING CONSTRUCTION THAT REQUIRE RELOCATION, SHALL BE COORDINATED WITH THAT UTILITY. THE CONTRACTOR SHALL BE RESPONSIBLE FOR COORDINATION OF ALL NECESSARY UTILITY ADJUSTMENTS. NO ADDITIONAL COMPENSATION WILL BE ALLOWED FOR DELAYS OR INCONVENIENCES CAUSED BY UTILITY COMPANY WORK CREWS. THE CONTRACTOR MAY BE REQUIRED TO RESCHEDULE HIS ACTIVITIES TO ALLOW UTILITY CREWS TO PERFORM THEIR REQUIRED WORK.
6. A DISPOSAL SITE FOR ALL EXCESS EXCAVATION MATERIAL, AND UNSUITABLE MATERIAL SHALL BE OBTAINED BY THE CONTRACTOR IN COMPLIANCE WITH APPLICABLE ENVIRONMENTAL REGULATIONS AND APPROVED BY THE CONSTRUCTION OBSERVER. ALL COSTS INCURRED IN OBTAINING A DISPOSAL SITE AND HAUL THERETO SHALL BE CONSIDERED INCIDENTAL TO THE PROJECT AND NO SEPARATE MEASUREMENT OR PAYMENT SHALL BE MADE.
7. THE CONTRACTOR IS RESPONSIBLE FOR PROTECTING THE EXISTING UTILITY LINES WITHIN THE CONSTRUCTION AREA. ANY DAMAGE TO EXISTING FACILITIES CAUSED BY CONSTRUCTION ACTIVITY SHALL BE REPAIRED OR REPLACED AT THE CONTRACTOR'S EXPENSE AND APPROVED BY THE CONSTRUCTION OBSERVER.
8. CONSTRUCTION ACTIVITY SHALL BE LIMITED TO THE PROPERTY AND/OR PROJECT LIMITS. ANY DAMAGE TO ADJACENT PROPERTIES RESULTING FROM THE CONSTRUCTION PROCESS IS THE RESPONSIBILITY OF THE CONTRACTOR. ANY COSTS INCURRED FOR REPAIRS SHALL BE THE COST OF THE CONTRACTOR.
9. OVERNIGHT PARKING OF CONSTRUCTION EQUIPMENT SHALL NOT OBSTRUCT DRIVEWAYS OR DESIGNATED TRAFFIC LANES. THE CONTRACTOR SHALL NOT STORE ANY EQUIPMENT OR MATERIAL WITHIN THE PUBLIC RIGHT-OF-WAY.
10. THE CONTRACTOR SHALL OBTAIN ALL THE NECESSARY PERMITS FOR THE PROJECT PRIOR TO COMMENCING CONSTRUCTION (I.E. BARRICADING, TOPSOIL DISTURBANCE AND EXCAVATION PERMITS, ETC.)
11. THE CONTRACTOR SHALL BE RESPONSIBLE TO REPLACE AT HIS EXPENSE ANY AND ALL PROPERTY CORNERS DESTROYED DURING CONSTRUCTION. ALL PROPERTY CORNERS MUST BE RESET BY A REGISTERED LAND SURVEYOR.
12. ALL PERMANENT PAVEMENT MARKING AND TRAFFIC SIGNING SHALL BE FURNISHED AND INSTALLED BY THE CONTRACTOR PER PLAN.
13. THE CONTRACTOR SHALL PREPARE A CONSTRUCTION TRAFFIC CONTROL AND SIGNING PLAN AND OBTAIN APPROVAL OF SUCH PLAN FROM THE CITY OF ALBUQUERQUE, TRAFFIC ENGINEERING DEPARTMENT, PRIOR TO BEGINNING ANY CONSTRUCTION WORK ON OR ADJACENT TO EXISTING STREETS.
14. ALL BARRICADES AND CONSTRUCTION SIGNING SHALL CONFORM TO APPLICABLE SECTIONS OF THE "MANUAL ON UNIFORM TRAFFIC CONTROL DEVICES" (MUTCD), U.S. DEPARTMENT OF TRANSPORTATION, LATEST EDITION.
15. THE CONTRACTOR SHALL MAINTAIN ALL CONSTRUCTION BARRICADES AND SIGNING AT ALL TIMES. THE CONTRACTOR SHALL VERIFY THE PROPER LOCATION OF ALL BARRICADING AT THE END AND BEGINNING OF EACH DAY.
16. ALL SAWCUT PAVEMENT SHALL HAVE A UNIFORM EDGE AND BE SPRAYED WITH TACK.
17. WHEN ABUTTING NEW CURB AND GUTTER TO EXISTING PAVEMENT, A 1' WIDE SECTION OF EXISTING PAVEMENT ADJACENT TO THE CURB AND GUTTER SHALL BE SAWCUT, REMOVED, AND REPLACED AS PER THE STANDARD SPECIFICATIONS.

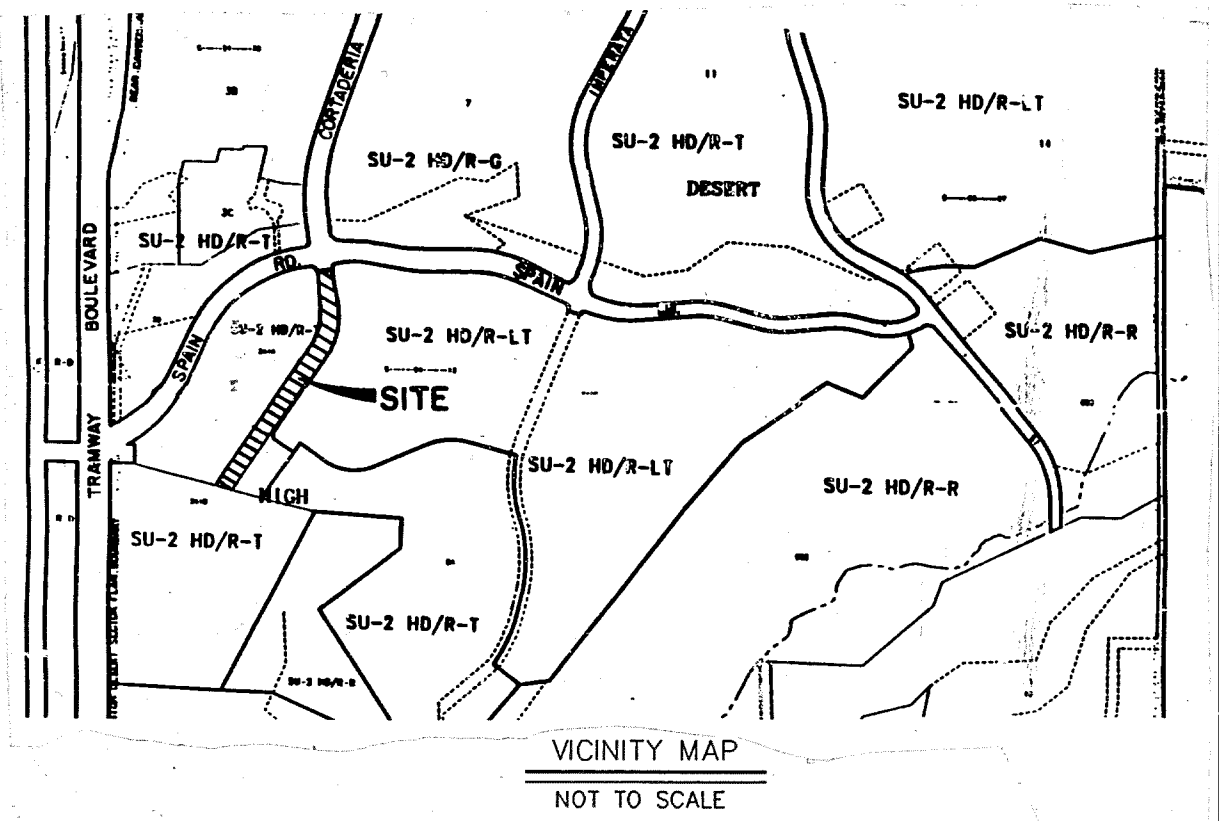

NOTICE TO CONTRACTORS

1. ALL STREET STRIPING ALTERED OR DESTROYED SHALL BE REPLACED IN KIND BY CONTRACTOR TO LOCATION AND IN KIND AS EXISTING OR AS INDICATED BY THIS PLAN SET.
2. CONTRACTOR SHALL NOTIFY THE ENGINEER NOT LESS THAN SEVEN (7) DAYS PRIOR TO STARTING WORK IN ORDER THAT THE CITY SURVEYOR MAY TAKE NECESSARY MEASURES TO INSURE THE PRESERVATION OF SURVEY MONUMENTS. CONTRACTOR SHALL NOT DISTURB PERMANENT SURVEY MONUMENTS WITHOUT THE CONSENT OF THE CITY SURVEYOR AND SHALL NOTIFY THE CITY SURVEYOR AND BEAR THE EXPENSE OF REPLACING ANY THAT MAY BE DISTURBED WITHOUT PERMISSION. REPLACEMENT SHALL BE DONE ONLY BY THE CITY SURVEYOR. WHEN A CHANGE IS MADE IN THE FINISHED ELEVATIONS OF THE PAVEMENT OF ANY ROADWAY IN WHICH A PERMANENT SURVEY MONUMENT IS LOCATED, CONTRACTOR SHALL, AT HIS OWN EXPENSE, ADJUST THE MONUMENT COVER TO THE NEW GRADE UNLESS OTHERWISE SPECIFIED.

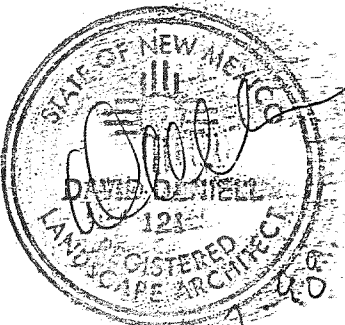

AS BUILT

THE FOLLOWING NOTES ALSO APPLY WHEN CHECKED

- ☐ ALL UTILITIES AND UTILITY SERVICE LINES SHALL BE INSTALLED PRIOR TO PAVING.
- ☐ BACKFILL COMPACTION SHALL BE ACCORDING TO SPECIFIED STREET USE.
- ☐ TACK COAT REQUIREMENTS SHALL BE DETERMINED BY THE CITY ENGINEER.
- ☐ SIDEWALKS AND WHEELCHAIR RAMPS WITHIN THE CURB RETURNS SHALL BE CONSTRUCTED WHEREVER A NEW CURB RETURN IS CONSTRUCTED.
- ☐ IF CURB IS DEPRESSED FOR A DRIVEPAD, THE DRIVEPAD SHALL BE CONSTRUCTED PRIOR TO ACCEPTANCE OF CURB AND GUTTER.
- ☐ ALL STORM DRAINAGE FACILITIES SHALL BE COMPLETED PRIOR TO FINAL ACCEPTANCE.
- ☒ THE REQUESTOR OR DEVELOPER SHALL BE RESPONSIBLE FOR REPAIR OR REPLACEMENT OF ALL CURB AND GUTTER OR SIDEWALK DAMAGED AFTER APPROVAL BY THE CITY ENGINEER OF WORK COMPLETED BY THE CONTRACTOR.

REV.	SHEETS	CITY ENGINEER	DATE	USER DEPARTMENT	DATE	USER DEPARTMENT	DATE
ENGINEERS STAMP & SIGNATURE		APPROVALS		ENGINEER	DATE	*****	
		DRC Chairman		<i>Patric N. Gay</i>	1-13-97	APPROVED FOR CONSTRUCTION	
		Transportation		<i>Patric N. Gay</i>	9-17-96		
		Water/Wastewater		<i>Patric N. Gay</i>	9-16-96		
		Hydrology		<i>Patric N. Gay</i>	9-17-96		
		Parks		<i>Patric N. Gay</i>	9-17-96		
Const. Mngmt.		<i>Patric N. Gay</i>	11-13-96	City Engineer		2/24/97	
NMUI							
CITY PROJECT NO.				553581		SHEET 1 OF 15	

BOHANNAN-HUSTON INC.
ENGINEERS • PLANNERS • PHOTOGRAMMETRISTS • SURVEYORS • LANDSCAPE ARCHITECTS
ALBUQUERQUE LAS CRUCES SANTA FE

26-15535-81 0197
26-15535-81 0197

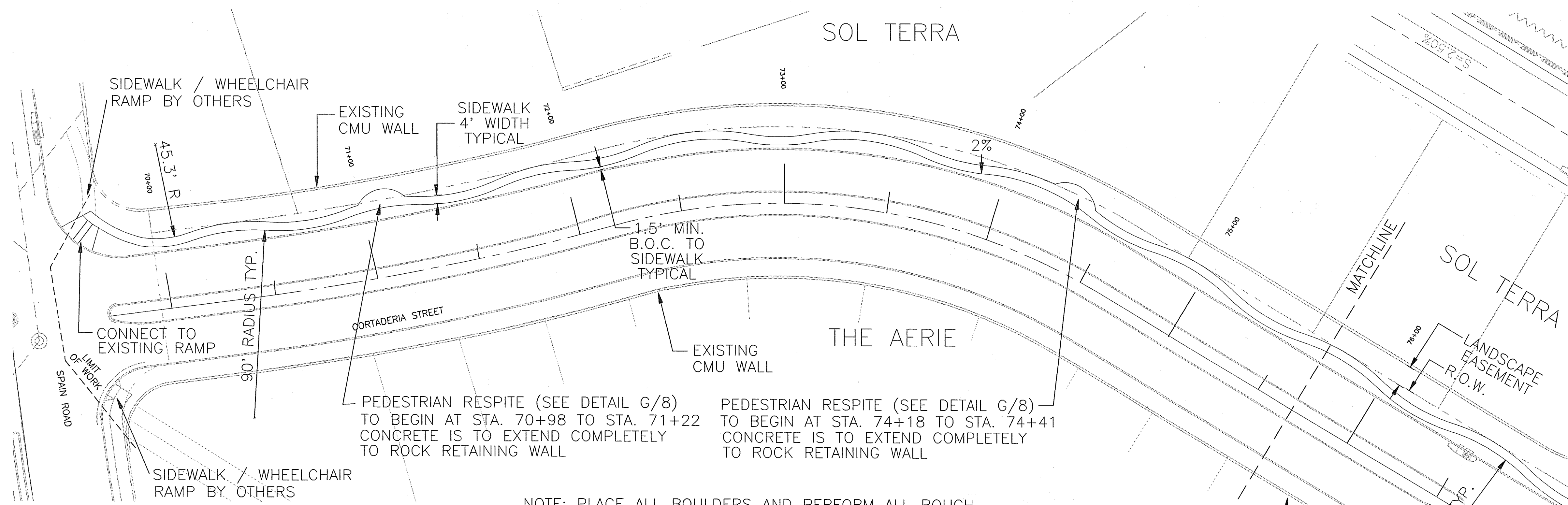

NOTE: PLACE ALL BOULDERS AND PERFORM ALL ROUGH GRADING, IRRIGATION TRENCHING, PIPE AND SLEEVING INSTALLATION, AND COMPACTION PRIOR TO ANY SIDEWALK INSTALLATION. CARE SHOULD BE TAKEN TO KEEP CONCRETE OFF BOULDERS AT TIME OF SIDEWALK INSTALLATION.

SCALE: 1" = 30'

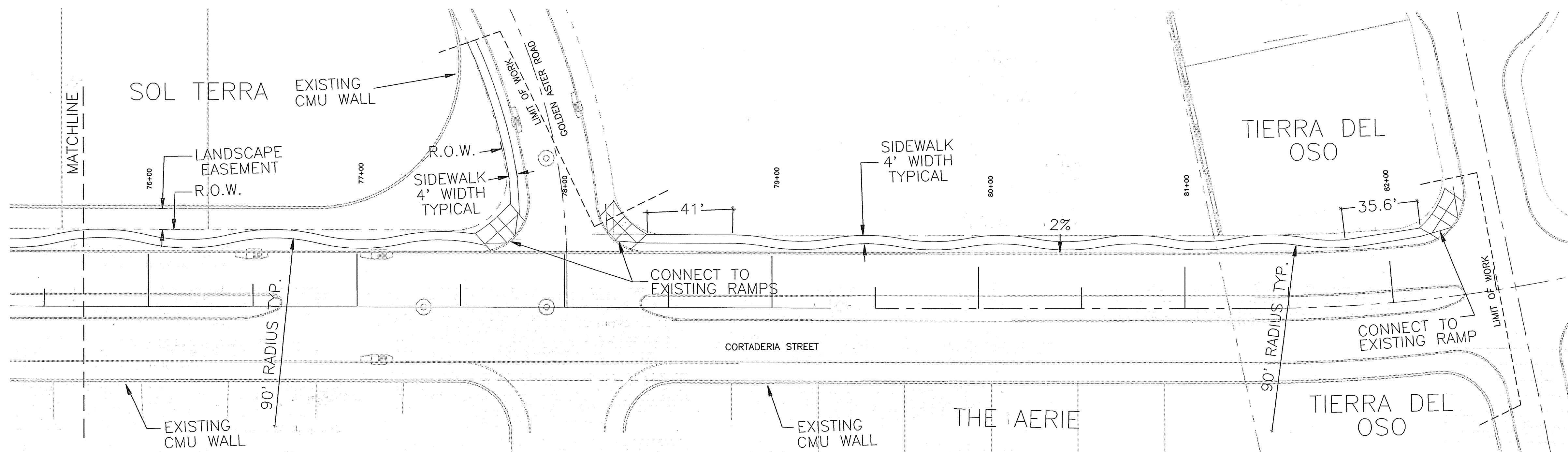
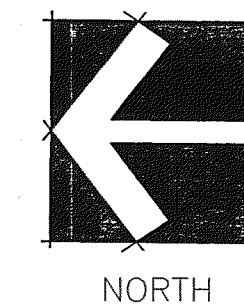

NOTE: PLACE ALL BOULDERS AND PERFORM ALL ROUGH GRADING, IRRIGATION TRENCHING, PIPE AND SLEEVING INSTALLATION, AND COMPACTION PRIOR TO ANY SIDEWALK INSTALLATION. CARE SHOULD BE TAKEN TO KEEP CONCRETE OFF BOULDERS AT TIME OF SIDEWALK INSTALLATION.

SCALE: 1" = 30'

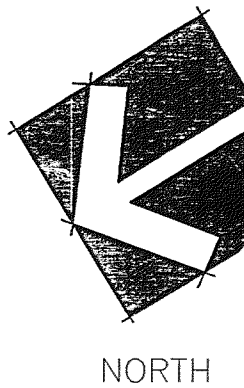

AS-BUILT INFORMATION		BENCH MARKS		SURVEY INFORMATION		ENGINEER'S SEAL		REVISIONS		DESIGNED BY: P. GAY		DRAWN BY: DP		CHECKED BY: P. GAY		DATE: 9/96		DATE: 9/96		DATE: 9/96	
CONTRACTOR	DATE	NO.	BY	NO.	BY	NO.	DATE	NO.	DATE	NO.	DATE	NO.	DATE	NO.	DATE	NO.	DATE	NO.	DATE	NO.	DATE

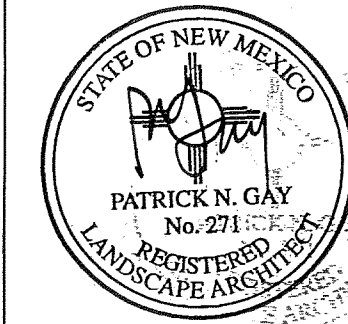

BOHANNAN-HUSTON INC.
ENGINEERS • PLANNERS • PHOTOGRAMMETRISTS • SURVEYORS • LANDSCAPE ARCHITECTS
ALBUQUERQUE LAS CRUCES SANTA FE

CITY OF ALBUQUERQUE
PUBLIC WORKS DEPARTMENT
ENGINEERING DEVELOPMENT GROUP

TITLE: HIGH DESERT STREETSCAPE
CORTADERIA EXTENSION
SIDEWALK LAYOUT AND DIMENSIONING PLAN

DESIGN REVIEW COMMITTEE	CITY ENGINEER APPROVAL	MO./DAY/YR.	MO./DAY/YR.
LAST DESIGN UPDATE			

CITY PROJECT NO. 553581 ZONE MAP NO. E-23, F-23 SHEET 2 OF 15

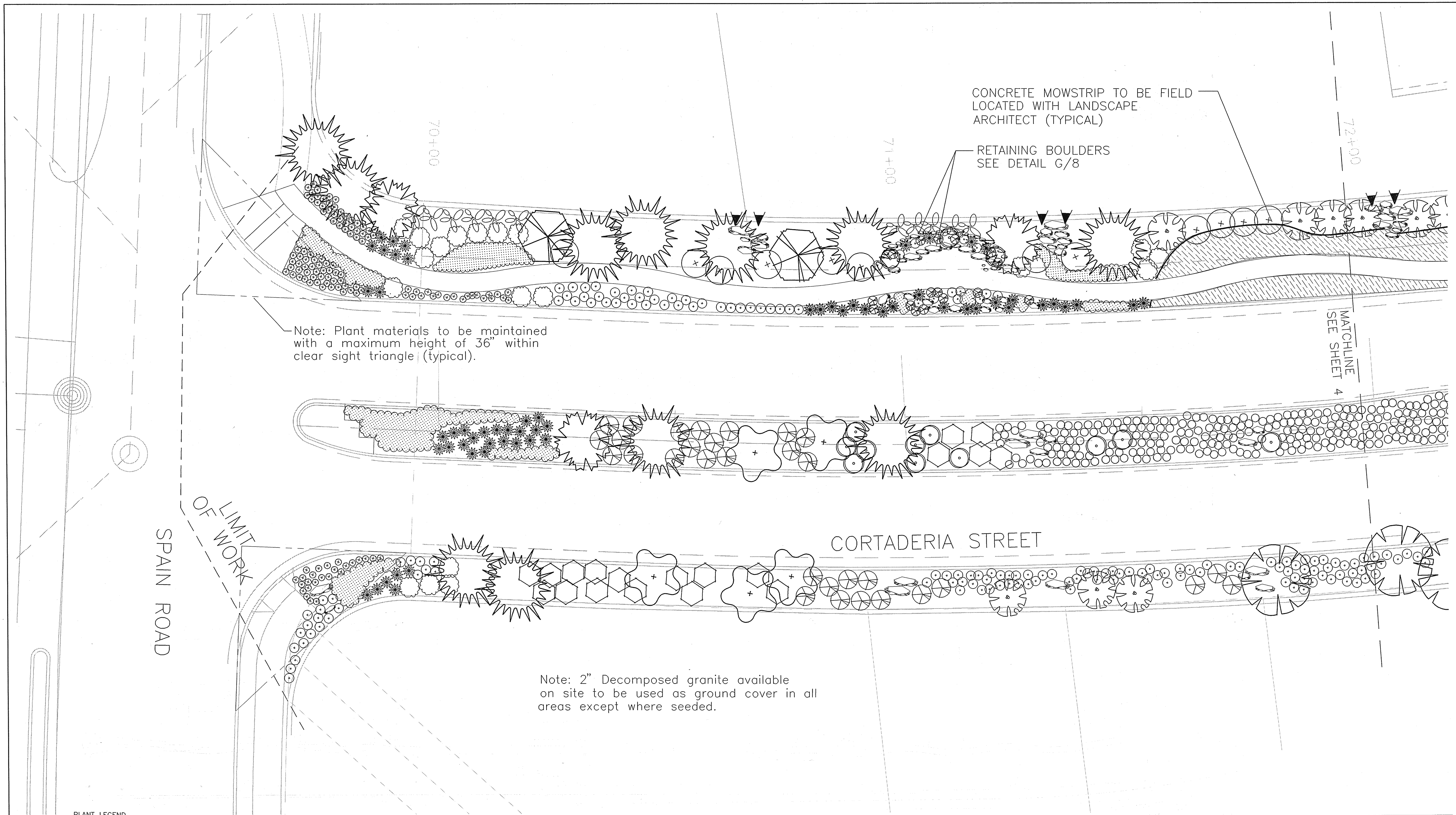

PLANT LEGEND

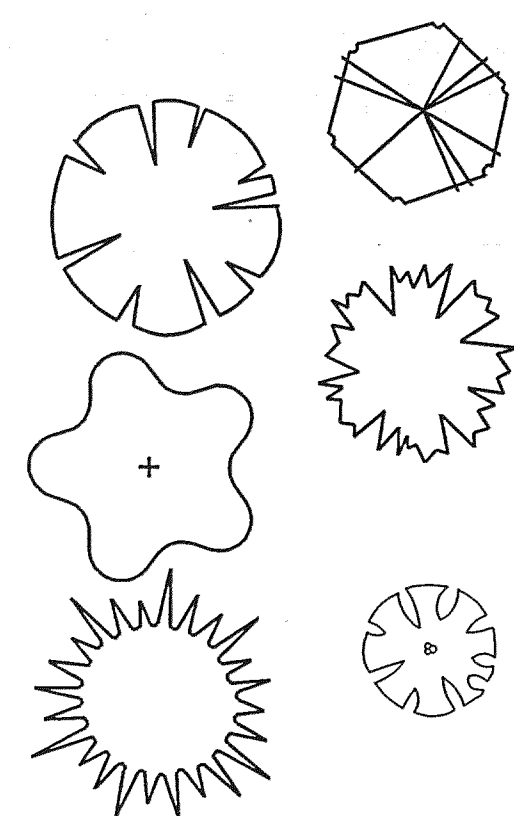

BOTANICAL NAME	COMMON NAME	SIZE/REMARKS
TREES		
Rhus lanceolata	Prairie Flameleaf Sumac	15 Gal.
Cercis reniformis 'Oklahoma'	Oklahoma Red Bud	2 1/2" Cal.
Pinus aristata	Bristlecone Pine	6' - 10' Ht.
Forestiera neomexicana	New Mexico Olive (Male Only)	8' - 10' Ht.
Cercocarpus ledifolius	Curl-leaf Mountain Mahogany	5 Gal.
Pinus edulis	Pinon Pine	10' - 12' Ht.

BOTANICAL NAME	COMMON NAME	SIZE/REMARKS
SHRUBS / VINES		
Rosa woodsii	Woods Rose	5 Gal.
Prunus besseyi	Sandcherry	5 Gal.
Buddleia davidii nana	Dwarf Butterfly Bush	5 Gal.
Ribes cereum	Wax Current	5 Gal.
Parthenocissus inserta	Woodbine	5 Gal.
Chamaebatia millefolium	Fernbush	5 Gal.
Hesperaloe parvifolia	Red Yucca	5 Gal.

BOTANICAL NAME	COMMON NAME	SIZE/REMARKS
PERENNIALS / GROUNDCOVERS		
Helictotrichon sempervirens	Blue Avena	1 Gal. 2' O.C.
Bouteloua gracilis	Blue Grama Grass	Seed
Bouteloua gracilis	Blue Grama Grass	1 Gal. 1' O.C.
Hymenoxys acaulis	Angelita Daisy	1 Gal. 18" O.C.
Artemisia stelleriana	Wormwood	1 Gal.
Verbena Bipinnatifida	Verbena Dakota	1 Gal.
OTHER SITE ELEMENTS		
Boulder (retaining boulder where noted)		
Existing Weep Hole		
Concrete Mowstrip		

SCALE: 1" = 10'

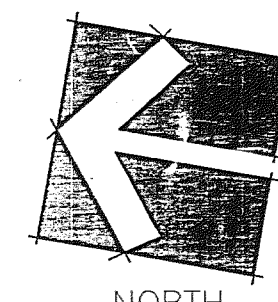

AS-BUILT INFORMATION		BENCH MARKS		SURVEY INFORMATION		ENGINEER'S SEAL	
CONTRACTOR	DATE			NO.	DATE		
DESIGNED BY	DATE			BY	DATE		
REVIEWED BY	DATE			REVISIONS	DATE		
FIELD ACCEPTANCE BY	DATE			DESIGN	DATE		
REMARKS	DATE						
CORRECTED BY	DATE						
MICRO-FILM INFORMATION	DATE						
RECORDED BY	DATE						
NO.							

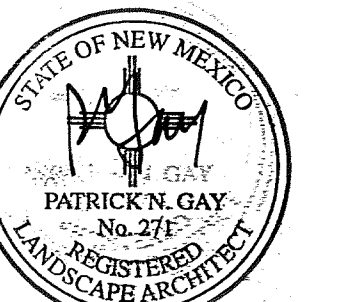

9/6/96

BOHANNAN-HUSTON INC. ENGINEERS • PLANNERS • PHOTOGRAMMETRISTS • SURVEYORS • LANDSCAPE ARCHITECTS ALBUQUERQUE LAS CRUCES SANTA FE			
CITY OF ALBUQUERQUE PUBLIC WORKS DEPARTMENT ENGINEERING DEVELOPMENT GROUP			
TITLE: HIGH DESERT STREETSCAPE CORTADERIA EXTENSION LANDSCAPE PLANTING PLAN			
DESIGN REVIEW COMMITTEE	CITY ENGINEER APPROVAL	MO./DAY/YR.	MO./DAY/YR.
APPROVED			
DESIGN REVIEW COMMITTEE			
CITY PROJECT NO.	ZONE MAP NO.	SHEET	OF
553581	E-23, F-23	3	15

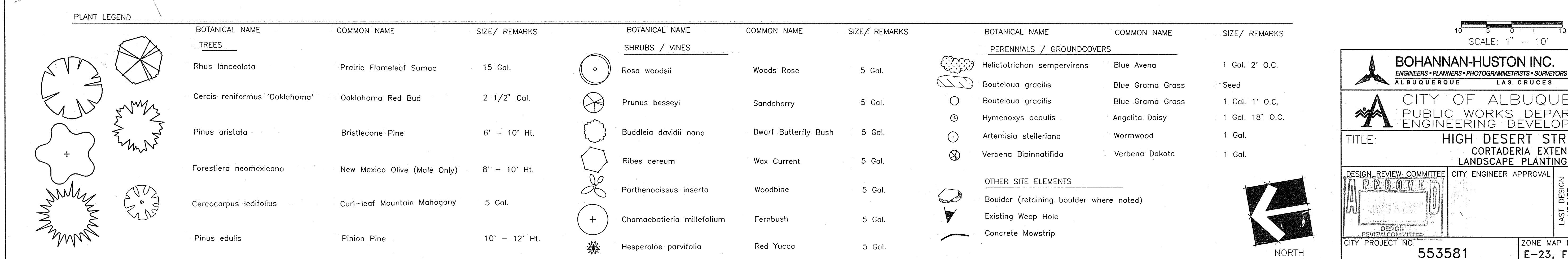

</

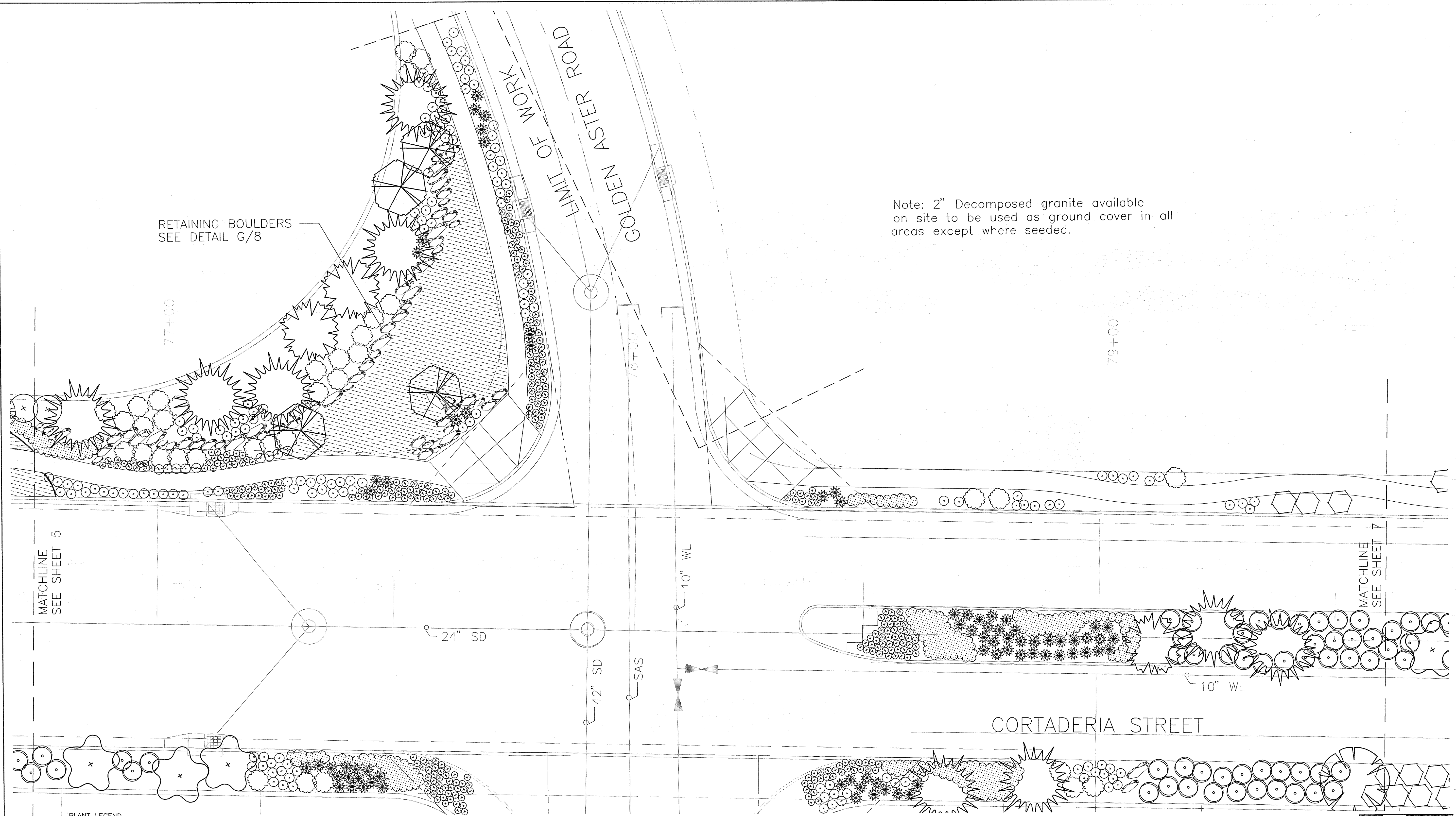

Note: 2" Decomposed granite available on site to be used as ground cover in all areas except where seeded.

PLANT LEGEND								
BOTANICAL NAME	COMMON NAME	SIZE/ REMARKS	BOTANICAL NAME	COMMON NAME	SIZE/ REMARKS	BOTANICAL NAME	COMMON NAME	SIZE/ REMARKS
TREES			SHRUBS / VINES			PERENNIALS / GROUNDCOVERS		
Rhus lanceolata	Prairie Flameleaf Sumac	15 Gal.	Rosa woodsii	Woods Rose	5 Gal.	Helictotrichon sempervirens	Blue Avena	1 Gal. 2' O.C.
Cercis reniformis 'Oklahoma'	Oklahoma Red Bud	2 1/2" Cal.	Prunus besseyi	Sandcherry	5 Gal.	Bouteloua gracilis	Blue Grama Grass	Seed
Pinus aristata	Bristlecone Pine	6' - 10' Ht.	Buddleia davidii nano	Dwarf Butterfly Bush	5 Gal.	Bouteloua gracilis	Blue Grama Grass	1 Gal. 1' O.C.
Forestiera neomexicana	New Mexico Olive (Male Only)	8' - 10' Ht.	Ribes cereum	Wax Current	5 Gal.	Hymenoxys acaulis	Angelita Daisy	1 Gal. 18" O.C.
Cercocarpus ledifolius	Curl-leaf Mountain Mahogany	5 Gal.	Parthenocissus inserta	Woodbine	5 Gal.	Artemisia stelleriana	Wormwood	1 Gal.
Pinus edulis	Pinion Pine	10' - 12' Ht.	Chamaebatia millefolium	Fernbush	5 Gal.	Verbena bipinnatifida	Verbena Dakota	1 Gal.
			Hesperaloe parvifolia	Red Yucca	5 Gal.	OTHER SITE ELEMENTS		
						Boulder (retaining boulder where noted)		
						Existing Weep Hole		
						Concrete Mowstrip		

ENGINEER'S SEAL		SURVEY INFORMATION		BENCH MARKS		AS-BUILT INFORMATION	
 9/6/96		NO.	BY	DATE	CONTRACTOR	DATE	
		REMARKS	REVISIONS	DESIGN	NO.	DATE	NO.
DESIGNED BY: P. GAY	DATE: 9/96						
DRAWN BY: DP	DATE: 9/96						
CHECKED BY: P. GAY	DATE: 9/96						

BOHANNAN-HUSTON INC.
 ENGINEERS • PLANNERS • PHOTOGRAMMETRISTS • SURVEYORS • LANDSCAPE ARCHITECTS
 ALBUQUERQUE LAS CRUCES SANTA FE

CITY OF ALBUQUERQUE
 PUBLIC WORKS DEPARTMENT
 ENGINEERING DEVELOPMENT GROUP

TITLE: HIGH DESERT STREETSCAPE
 CORTADERIA EXTENSION
 LANDSCAPE PLANTING PLAN

DESIGN-REVIEW-COMMITTEE	CITY ENGINEER APPROVAL	MO./DAY/YR.	MO./DAY/YR.

CITY PROJECT NO. **553581**
 ZONE MAP NO. **E-23, F-23**
 SHEET **6** OF **15**

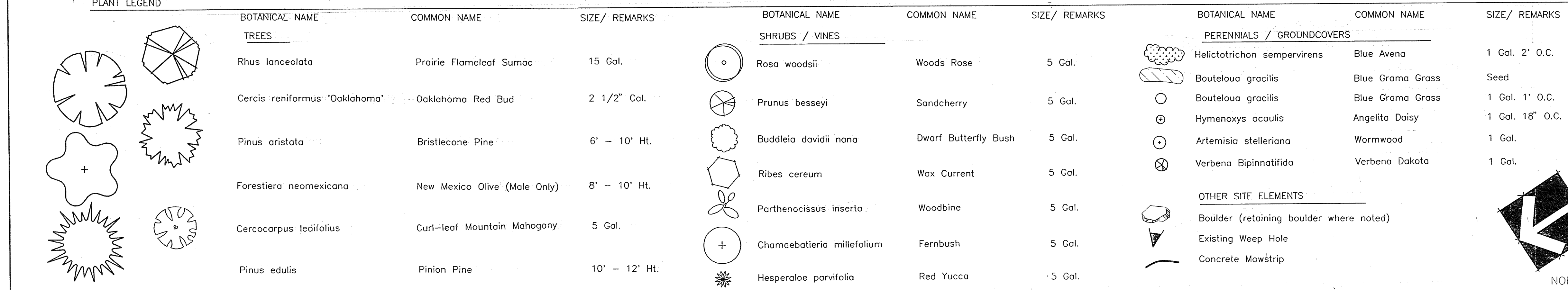

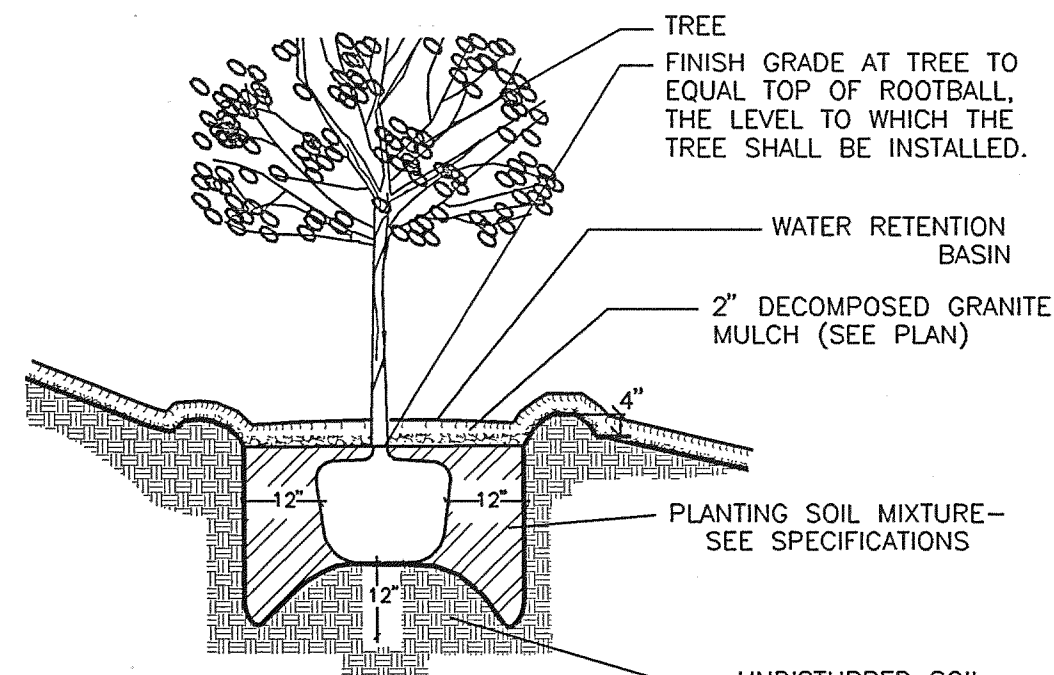

NOTE:
1. REMOVE ALL WIRE AND SYNTHETIC MATERIALS PRIOR TO BACKFILLING.
2. REMOVE BURLAP FROM TOP 1/3 OF ROOT BALL.
3. MINIMUM LEVEL AREA OF THE SPACE IN WHICH TO PLANT TREE SHALL BE THE SAME AS THE DIAMETER OF THE DRIP LINE OF THE TREE.
4. THE DEGREE OF SLOPE ABOVE AND BELOW THE PLANTED TREE SHALL NOT EXCEED THE PRE-EXISTING SLOPE.

A TREE PLANTING ON SLOPE
NOT TO SCALE

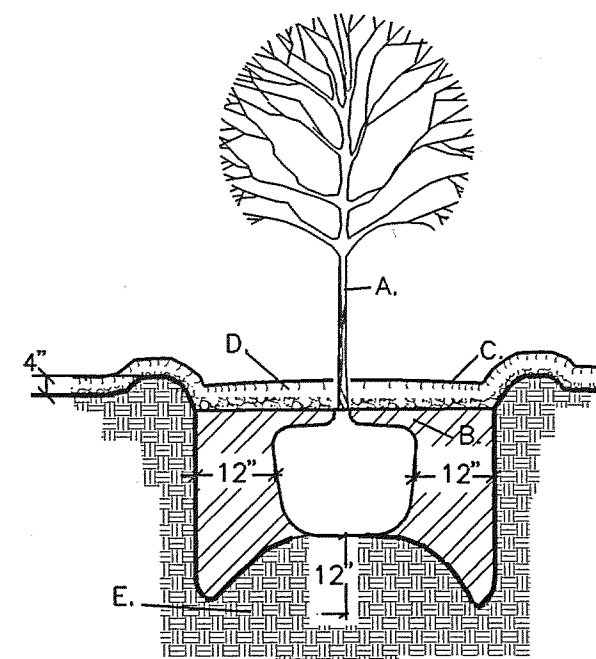

NOTE:
1. STABILIZE SOIL BELOW ROOT BALL PRIOR TO PLANTING TO PREVENT TREE FROM SETTLING.
2. TOP OF ROOTBALL INDICATES LEVEL AT WHICH TREE WAS GROWN AND DUG; THIS REPRESENTS THE LEVEL AT WHICH THE TREE SHOULD BE INSTALLED; THAT LEVEL MAY ONLY BE EXCEEDED BY A ONE INCH LAYER OF SOIL.
3. PRIOR TO BACKFILLING TREE, ALL WIRE, ROPE AND SYNTHETIC MATERIALS SHALL BE REMOVED FROM THE TREE AND THE PLANTING PIT.
4. PRIOR TO BACKFILLING, TOP 1/3 OF BURLAP SHALL BE CUT AWAY FROM THE ROOTBALL.

A. TREE.
B. PLANTING SOIL MIXTURE, (REF. SPECIFICATIONS)
C. WATER RETENTION BASIN.
D. 2" DECOMPOSED GRANITE MULCH, SEE PLAN.
E. UNDISTURBED SOIL.

B ISOLATED TREE PLANTING
NOT TO SCALE

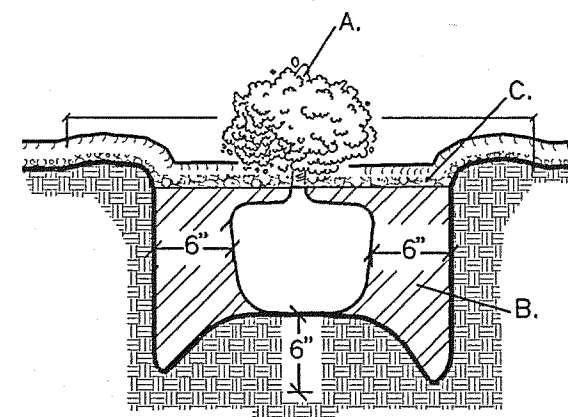

A. SHRUB.
B. PLANTING SOIL MIXTURE (REF. SPECIFICATIONS)
C. 2" DECOMPOSED GRANITE MULCH, SEE PLAN.

C ISOLATED SHRUB PLANTING
NOT TO SCALE

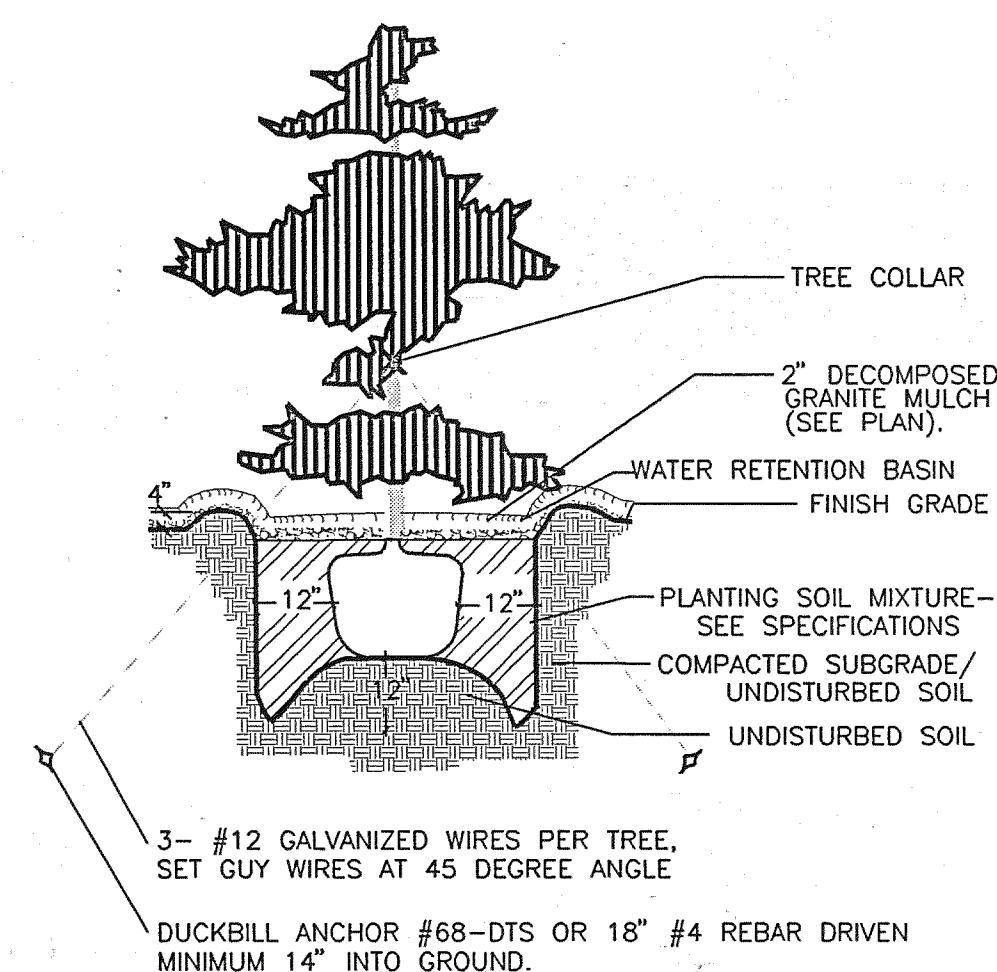

NOTE: REMOVE ALL WIRE AND SYNTHETIC MATERIALS FROM ROOTBALL PRIOR TO BACKFILLING. REMOVE BURLAP FROM TOP 1/3 OF ROOTBALL. GUY TREE AT THE DIRECTION OF THE OWNER'S REPRESENTATIVE.

D EVERGREEN TREE PLANTING
NOT TO SCALE

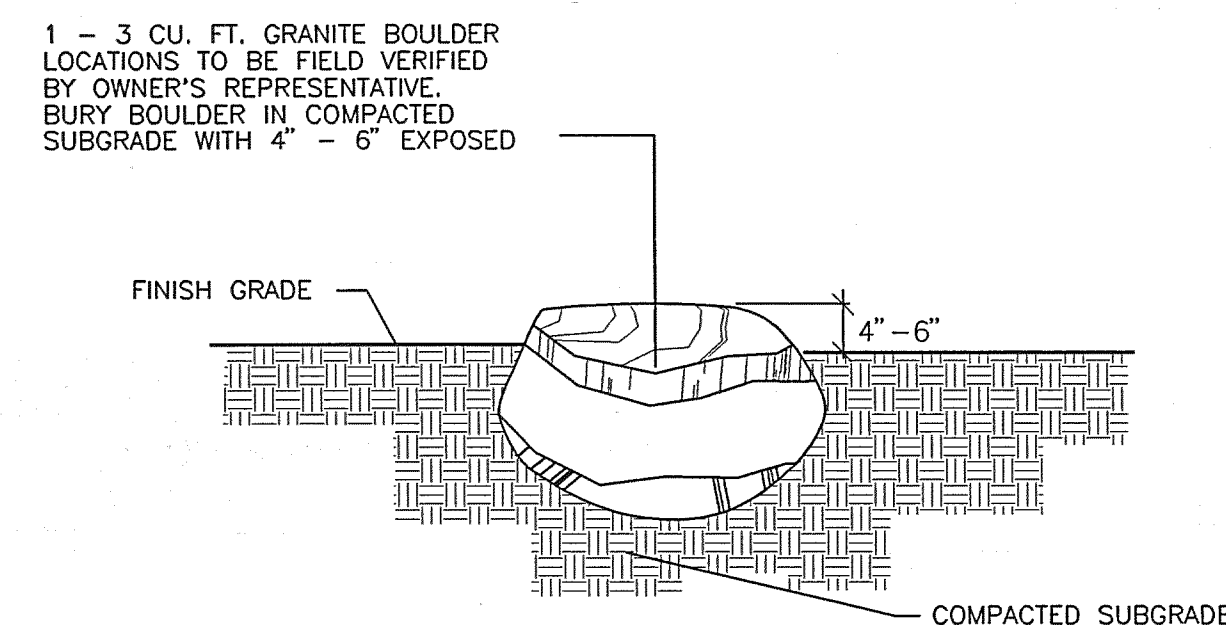

E BOULDER INSTALLATION AT GRADE
NOT TO SCALE

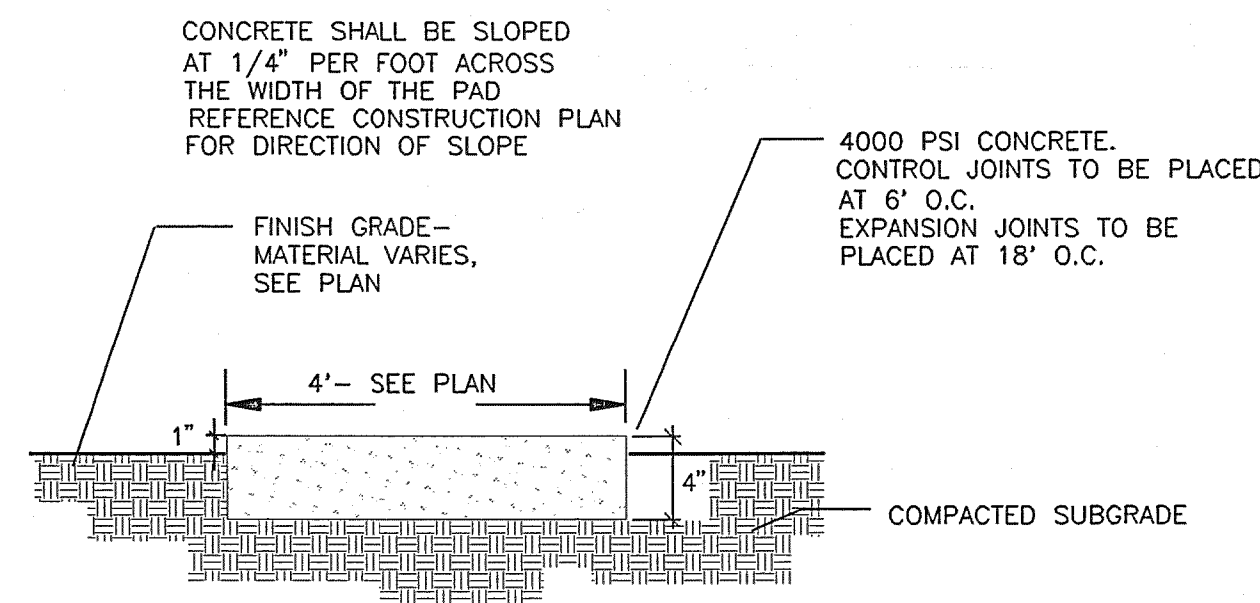

F CONCRETE SIDEWALK
NOT TO SCALE

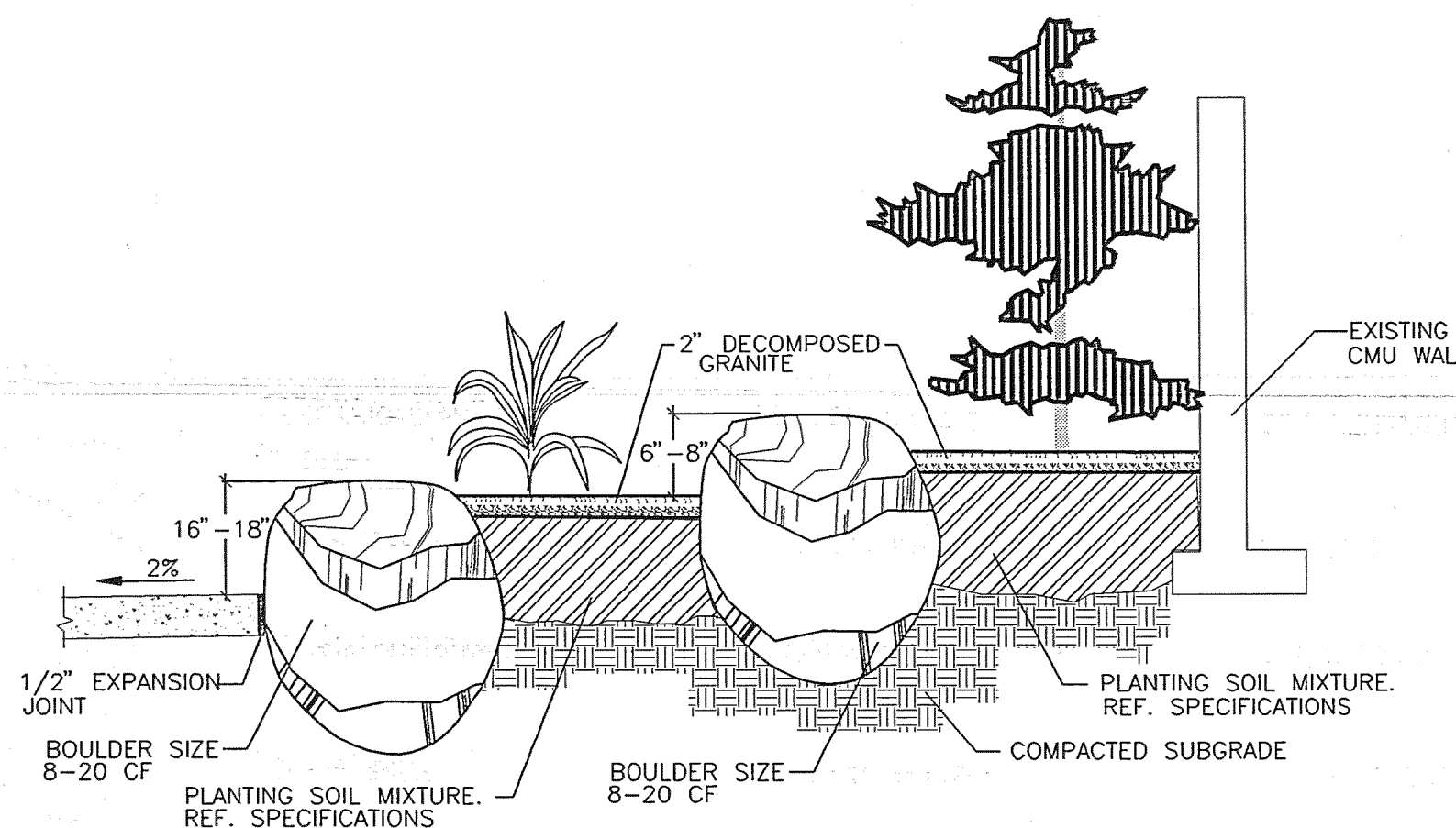

G BOULDER INSTALLATION AT PEDESTRIAN RESPITES (RETAINING)
NOT TO SCALE

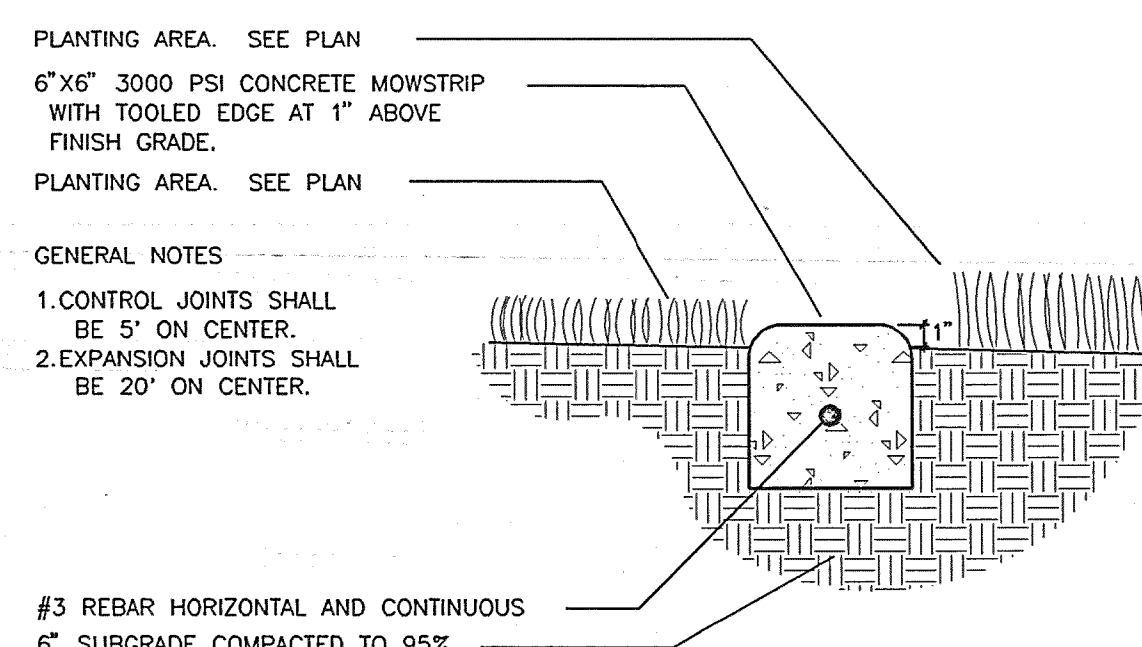

H CONCRETE EDGER
NOT TO SCALE

PLANT LIST

BOTANICAL NAME	COMMON NAME	SIZE	QUANTITY	REMARKS	MATURE HEIGHT
TREES					
Rhus lanceolata	Prairie Flameleaf Sumac	15 Gal.	9		15'
Cercis reniformis 'Oklahoma'	Oklahoma Red Bud	2 1/2" Cal.	10		20'
Pinus aristata	Bristlecone Pine	6' - 10' Ht.	13	B & B	20'
Forestiera neomexicana	New Mexico Olive (Male Only)	8' - 10' Ht.	25		15'
Cercocarpus ledifolius	Curl-leaf Mountain Mahogany	5 Gal.	43		12'
Pinus edulis	Pinion Pine	10' - 12' Ht.	38	B & B	25'
SHRUBS / VINES					
Rosa woodsii	Woods Rose	5 Gal.	43		3'
Prunus besseyi	Sandcherry	5 Gal.	78		4'
Buddleia davidii nana	Dwarf Butterfly Bush	5 Gal.	82		4'
Ribes cereum	Wax Current	5 Gal.	103		3'
Parthenocissus inserta	Woodbine	5 Gal.	18		VINE
Chamaebatia millefolium	Fernbush	5 Gal.	61		4'
Hesperaloe parvifolia	Red Yucca	5 Gal.	172		3'
PERENNIALS / GROUNDCOVERS					
Helictotrichon sempervirens	Blue Avena	1 Gal.	509	2' O.C.	2'
Bouteloua gracilis	Blue Grama Grass	Seed	4875 SF	Seed	18"
Bouteloua gracilis	Blue Grama Grass	1 Gal.	503	1' O.C.	18"
Hymenoxys acaulis	Angelita Daisy	1 Gal.	658	18" O.C.	18"
Artemisia stelleriana	Wormwood	1 Gal.	1204		12"
Verbena bipinnatifida	Verbena Dakota	1 Gal.	29		12"
SITE FURNISHINGS					
Landscape Boulders		1 - 3 CF	228		
Retaining Boulders		8 - 20 CF	138		

PLANTINGS

- PLANT MATERIAL SUBSTITUTIONS SHALL NOT BE MADE WITHOUT THE WRITTEN PERMISSION OF THE OWNER'S REPRESENTATIVE.
- PLANT MATERIAL QUALITY, SIZE AND CONDITION SHALL BE IN ACCORDANCE WITH AMERICAN STANDARD FOR NURSERY STOCK, 1990 EDITION, AS PUBLISHED BY THE AMERICAN ASSOCIATION OF NURSERYMEN.
- ALL PLANTS SHALL BE TYPICAL OF THEIR SPECIES OR VARIETY. ALL PLANTS SHALL HAVE NORMAL, WELL DEVELOPED BRANCHES AND VIGOROUS ROOT SYSTEMS. THEY SHALL BE SOUND, HEALTHY, VIGOROUS, FREE FROM DEFECTS, DISFIGURING KNOTS, ABRASIONS OF THE BARK, SUNSCALD INJURIES, PLANT DISEASES, INSECT EGGS, BORES AND ALL OTHER FORMS OF INFECTIONS.
- UNLESS OTHERWISE STATED ON THE DRAWINGS OR APPROVED BY OWNER'S REPRESENTATIVE, ALL PLANTS SHALL BE NURSERY GROWN AND SHALL BE TAGGED WITH NURSERY LABELS INDICATING SPECIES AND VARIETY.
- BALLED AND BURLAPPED PLANT MATERIAL SHALL HAVE A SOLID BALL OF EARTH OF MINIMUM SPECIFIED SIZE AND HELD IN PLACE SECURELY BY BURLAP AND A STOUT TWINE OR ROPE. BROKEN OR LOOSE BALLS WILL BE REJECTED.
- THE OWNER'S REPRESENTATIVE SHALL INSPECT ALL PLANT MATERIAL AT THE CONTRACTOR'S YARD PRIOR TO DELIVERY, DURING PLANTING AND AFTER PLANTING AT THE JOB SITE. AT THE OPTION OF THE CONTRACTOR, THE OWNER'S REPRESENTATIVE WILL INSPECT PLANT MATERIAL AT A WHOLESALE NURSERY OF THE CONTRACTOR'S CHOICE PRIOR TO DELIVERY OF MATERIALS TO THE CONTRACTOR'S YARD.
- THE OWNER'S REPRESENTATIVE SHALL BE THE JUDGE OF THE QUALITY AND ACCEPTABILITY OF ALL PLANT MATERIALS. ALL REJECTED MATERIAL SHALL BE IMMEDIATELY REMOVED FROM THE SITE AND REPLACED WITH ACCEPTABLE MATERIAL AT NO ADDITIONAL COST TO OWNER.
- ALL COLLECTED PLANTS MUST BE PRESENTED ON THE SITE AND SHALL BE IN ACCORDANCE WITH THE NEW MEXICO DEPARTMENT OF AGRICULTURE PLANT PROTECTION ACT, REGULATORY ORDER NO. 4, AND AMERICAN STANDARDS FOR NURSERY STOCK (1990 EDITION).

WARRANTY
ALL TREES, SHRUBS AND GROUNDCOVERS SHALL BE GUARANTEED FOR THE PERIOD OF ONE YEAR OR ONE GROWING SEASON, WHICHEVER COMES FIRST, BEGINNING ON THE DATE OF FINAL CONTRACT ACCEPTANCE.



BOHANNAN-HUSTON INC. ENGINEERS • PLANNERS • PHOTOGRAMMETRISTS • SURVEYORS • LANDSCAPE ARCHITECTS ALBUQUERQUE LAS CRUCES SANTA FE	
CITY OF ALBUQUERQUE PUBLIC WORKS DEPARTMENT ENGINEERING DEVELOPMENT GROUP	
TITLE: HIGH DESERT STREETSCAPE CORTADERIA EXTENSION LANDSCAPE PLANTING AND CONSTRUCTION DETAILS	
DESIGN REVIEW COMMITTEE APPROVED	CITY ENGINEER APPROVAL
CITY PROJECT NO. 553581	ZONE MAP NO. E-23, F-23
SHEET 8	OF 15

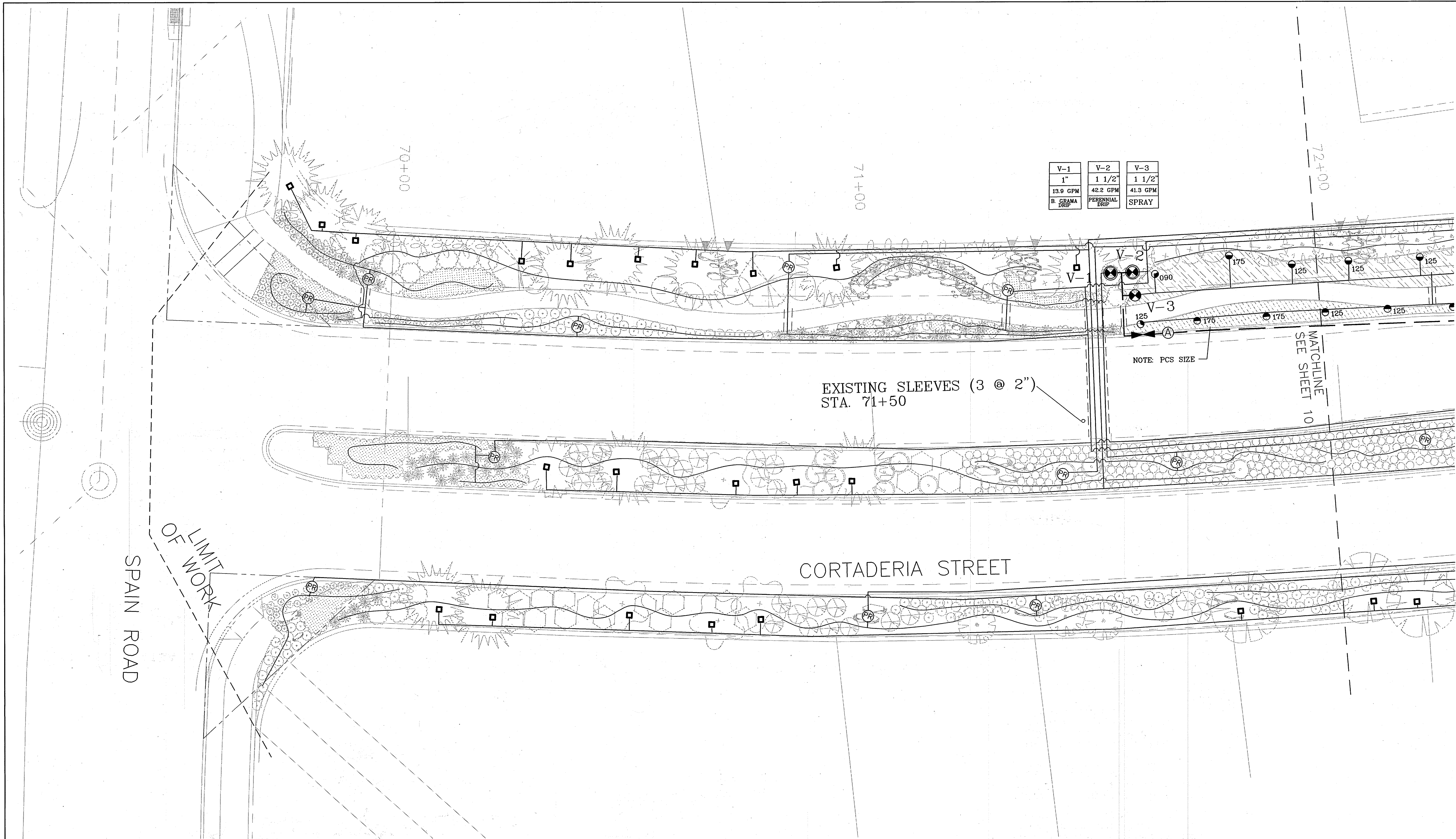

V-1	V-2	V-3
1"	1 1/2"	1 1/2"
13.9 GPM	42.2 GPM	41.3 GPM
B. GRAMA Drip	PERENNIAL Drip	SPRAY

EXISTING SLEEVES (3 @ 2")
STA. 71+50

NOTE: PCS SIZE

MATCHLINE
SEE SHEET 10

CORTADERIA STREET

SPAIN ROAD

LIMIT OF WORK

IRRIGATION LEGEND

- WATER METER M170, AS PER CITY OF ALBUQUERQUE
- SOLATROL LEIT 8000-2, XKIT 8724 CONTROLLER, AMTG 2035 ANTENNA MOUNTING COLUMN, LEMA 1521 SOLENOID, EXPANSION MODULE
- BERMAD 910-P, (SIZE AS PER DRAWING) MASTER VALVE WITH FEBCO 825Y, 1 1/2" RPA, W/ STRONGBOX ENCLOSURE
- WILKENS 1 1/2" 500YSBR PRESSURE REDUCING VALVE (INCLUDES "Y" STRAINER)
- CRISPIN UL 10.0-1" UNIVERSAL AIR RELIEF VALVE
- CHAMPION 100RS-100 MANUAL DRAIN ASSEMBLY
- RAINBIRD PEB DRIP CONTROL VALVE WITH FEBCO PF SERIES 14-1" Y-FILTER

- RAINBIRD PEB-(PRS WHERE NOTED)-B CONTROL VALVE
- SPEARS TRUE UNION SCH. 80 BALL VALVE
- SENNINGER PMR20LF 3/4" INLINE PRESSURE REGULATOR
- RAINBIRD POP UP BUBBLER 1803-5F-B-PCS-040, 0.4 GPM
- RAINBIRD 1812-15H-PCS-(SIZE AS PER PLAN)
- RAINBIRD 1812-15Q-PCS-(SIZE AS PER PLAN)
- MAINLINE (SIZE AS PER PLAN)
- LATERAL SCH 40 PVC (SIZE AS PER SIZING CHART)
- HARDIE E-2 DBK08 (2 GPH) EMITTER ON RAIN TUBE 1/2" POLY TUBING
- INSTALL TWO(2) EMITTERS PER SHRUB, TWO EMITTERS PER PERENNIAL, ONE EMITTER PER CONTAINERIZED BLUE GRAMMA.
- SLEEVE SCH 40 PVC, MIN. 2 SIZES LARGER THAN PIPE TO BE SLEEVED

NOTE: PLANS ARE DIAGRAMMATIC AND APPROXIMATE DUE TO SCALE OF DRAWINGS, WHERE EVER APPLICABLE, PLACE MAINLINE AND LATERAL PIPING WITHIN TWO(2) FEET OF FACE OF CURB (F.O.C.). ALL VALVES SHALL BE LOCATED IN PLANTING AREAS WHERE SHOWN AND ALL PIPING SHALL BE INSTALLED PRIOR TO PLANTING. NO TEES, ELLS OR OTHER TURNS IN PIPING SHALL BE LOCATED UNDER PAVING. CAP ALL ENDS HAND TIGHT PRIOR TO BACKFILL. ALL IRRIGATION SHALL BE INSTALLED WITHIN APPLICABLE RIGHT OF WAYS.

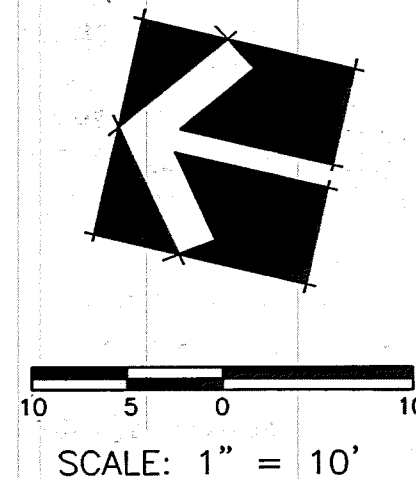

SCALE: 1" = 10'



CITY OF ALBUQUERQUE
PUBLIC WORKS DEPARTMENT
ENGINEERING DEVELOPMENT GROUP

TITLE: **HIGH DESERT STREETSCAPE
CORRIDOR EXTENSION
LANDSCAPE IRRIGATION PLAN**

DESIGN REVIEW COMMITTEE	CITY ENGINEER APPROVAL	MO./DAY/YR.	MO./DAY/YR.
CITY PROJECT NO.	ZONE MAP NO.	SHEET	OF
553581	E-23, F-23	9	15

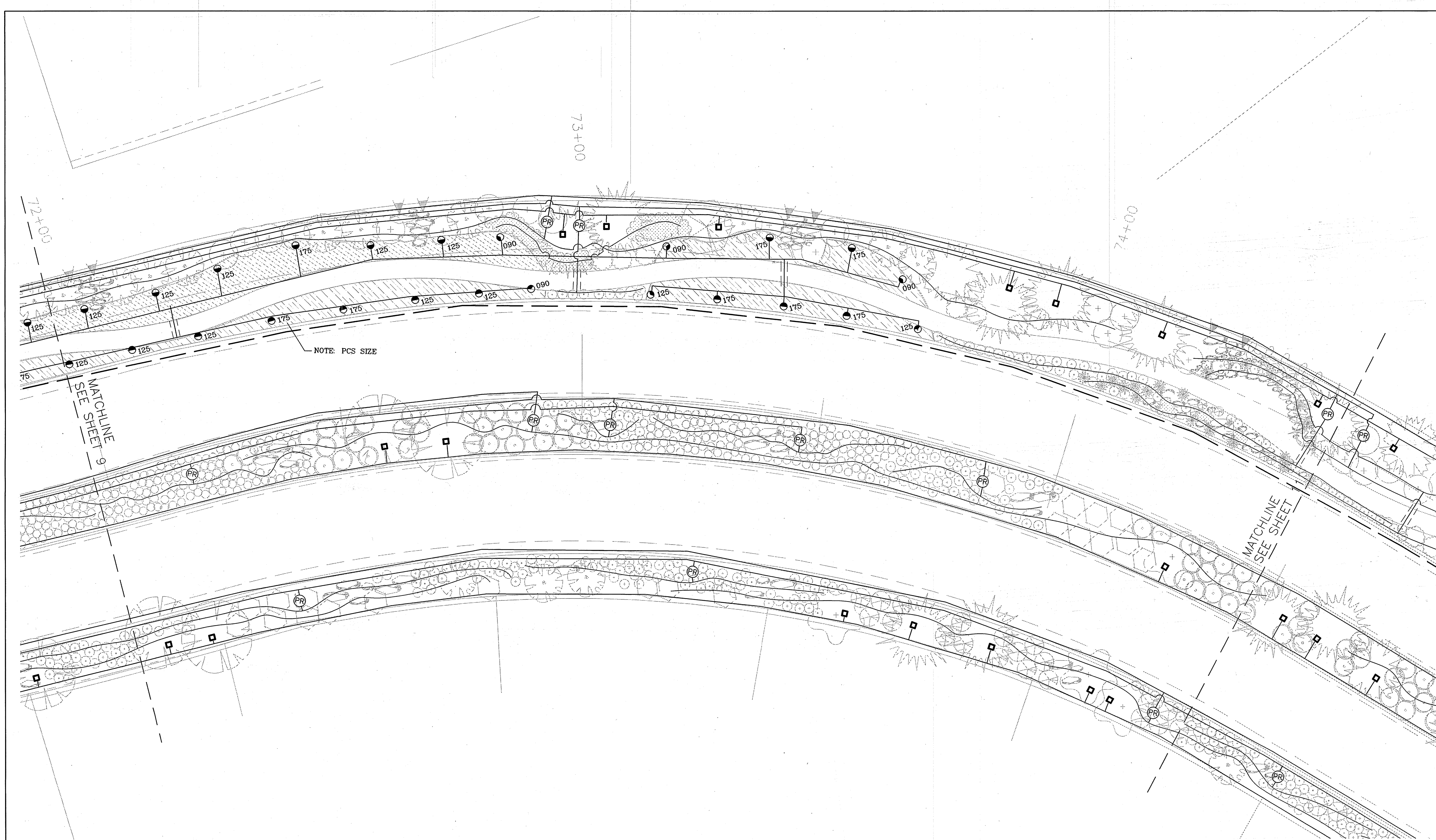

IRRIGATION LEGEND

- WATER METER M170, AS PER CITY OF ALBUQUERQUE
- SOLATROL LEIT 8000-2, XKIT 8724 CONTROLLER, AMTG 2035 ANTENNA MOUNTING COLUMN, LEMA 1521 SOLENOID, EXPANSION MODULE
- BERMAD 910-P, (SIZE AS PER DRAWING) MASTER VALVE WITH FEBCO 825Y, 1 1/2" RPA, W/ STRONGBOX ENCLOSURE
- WILKENS 1 1/2" 500YSR PRESSURE REDUCING VALVE (INCLUDES "Y" STRAINER)
- CRISPIN UL 10.0-1" UNIVERSAL AIR RELIEF VALVE
- CHAMPION 100RS-100 MANUAL DRAIN ASSEMBLY
- RAINBIRD PEB DRIP CONTROL VALVE WITH FEBCO PF SERIES 14-1" Y-FILTER

- RAINBIRD PEB-(PRS WHERE NOTED)-B CONTROL VALVE
- SPEARS TRUE UNION SCH. 80 BALL VALVE
- SENNINGER PMR20LF 3/4" INLINE PRESSURE REGULATOR
- RAINBIRD POP UP BUBBLER 1803-5F-B-PCS-040, 0.4 GPM
- RAINBIRD 1812-15H-PCS-(SIZE AS PER PLAN)
- RAINBIRD 1812-15Q-PCS-(SIZE AS PER PLAN)
- MAINLINE (SIZE AS PER PLAN)
- LATERAL SCH 40 PVC (SIZE AS PER SIZING CHART)
- HARDIE E-2 DBK08 (2 GPH) EMITTER ON RAINBIRD 1/2" POLY TUBING INSTALL TWO(2) EMITTERS PER SHRUB, TWO EMITTERS PER PERENNIAL, ONE EMITTER PER CONTAINERIZED BLUE GRAMMA.
- SLEEVE SCH 40 PVC, MIN. 2 SIZES LARGER THAN PIPE TO BE SLEEVED

NOTE: PLANS ARE DIAGRAMMATIC AND APPROXIMATE DUE TO SCALE OF DRAWINGS. WHERE EVER APPLICABLE, PLACE MAINLINE AND LATERAL PIPING WITHIN TWO(2) FEET OF FACE OF CURB (F.O.C.). ALL VALVES SHALL BE LOCATED IN PLANTING AREAS WHERE SHOWN AND ALL PIPING SHALL BE INSTALLED PRIOR TO PLANTING. NO TEES, ELLS OR OTHER TURNS IN PIPING SHALL BE LOCATED UNDER PAVING. CAP ALL ENDS HAND TIGHT PRIOR TO BACKFILL. ALL IRRIGATION SHALL BE INSTALLED WITHIN APPLICABLE RIGHT OF WAYS.

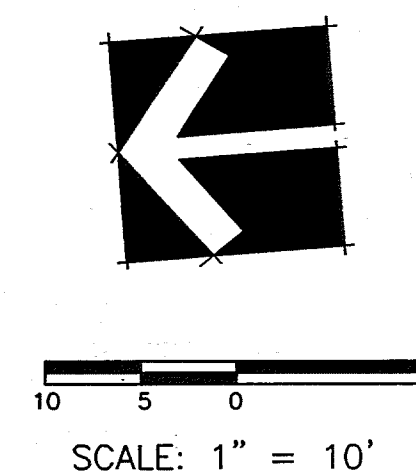

SCALE: 1" = 10'

		CITY OF ALBUQUERQUE PUBLIC WORKS DEPARTMENT ENGINEERING DEVELOPMENT GROUP	
TITLE: HIGH DESERT STREETSCAPE CORTADERIA EXTENSION LANDSCAPE PLANTING PLAN			
DESIGN REVIEW COMMITTEE	CITY ENGINEER APPROVAL	LAST DESIGN UPDATE	MO./DAY/YR.
CITY PROJECT NO. 553581	ZONE MAP NO. E-23, F-23	SHEET 10 OF 15	

20-5035-81 20-5035-81 11/10/97

				ENGINEER'S SEAL		SURVEY INFORMATION		BENCH MARKS		AS-BUILT INFORMATION	
						FIELD NOTES				CONTRACTOR HEADS UP	
						NO.		BY		DATE	
										WORK SPAWNED BY	
										DATE	
										ACCEPTANCE BY	
										DATE	
										FIELD VERIFICATION BY	
										DATE	
										CORRECTED BY	
										J.C.	
										DATE	
										MICRO-FILM INFORMATION	
										RECORDED BY	
										DATE	
										NO.	

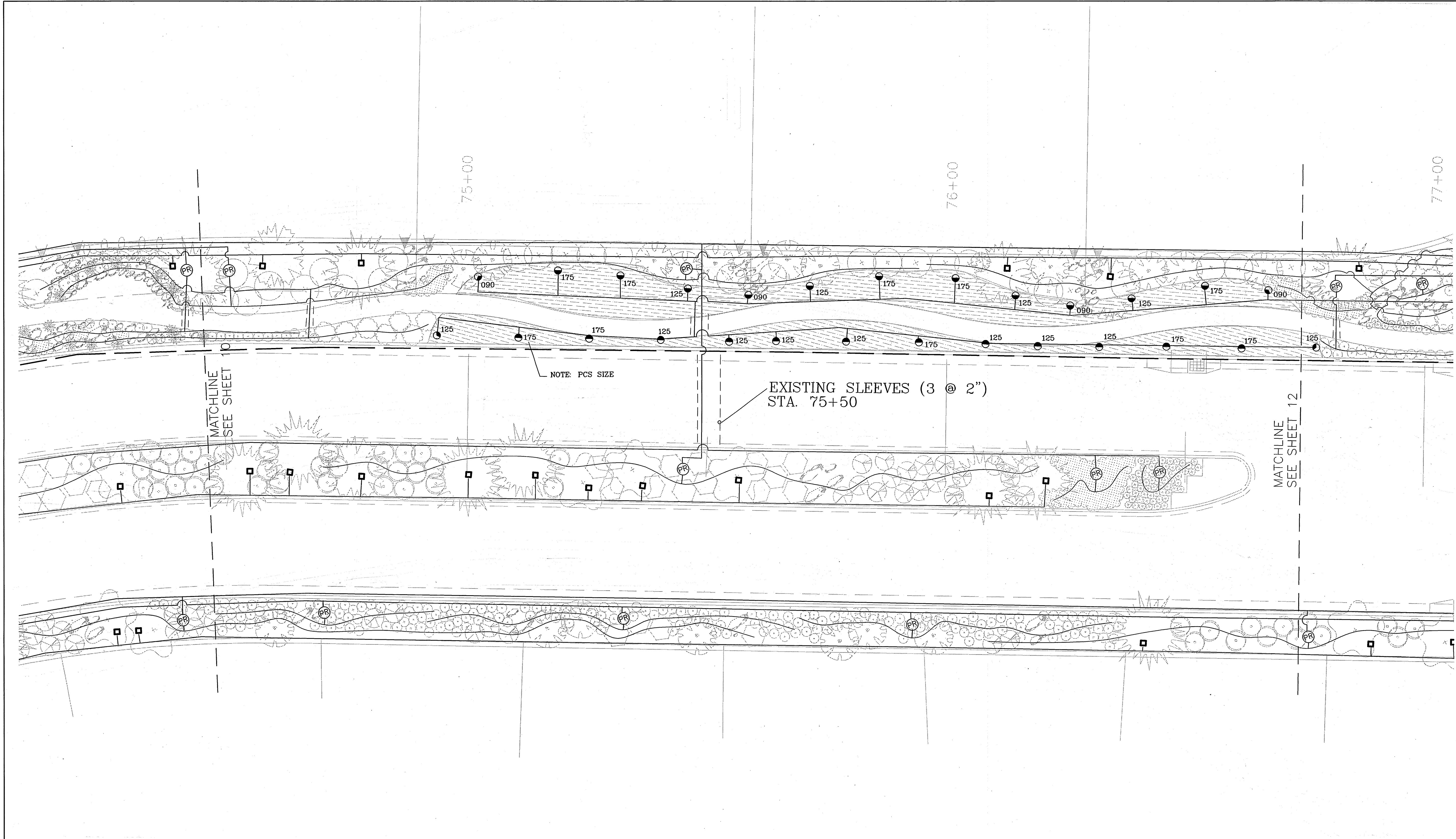

IRRIGATION LEGEND

- WATER METER M170, AS PER CITY OF ALBUQUERQUE
- SOLATROL LEIT 8000-2, XKIT 8724 CONTROLLER, AMTG 2035 ANTENNA MOUNTING COLUMN, LEMA 1521 SOLENOID, EXPANSION MODULE
- BERMAD 910-P, (SIZE AS PER DRAWING) MASTER VALVE WITH FEBCO 825Y, 1 1/2" RPA, W/ STRONGBOX ENCLOSURE
- WILKENS 1 1/2" 500YSBR PRESSURE REDUCING VALVE (INCLUDES "Y" STRAINER)
- CRISPIN UL 10.0-1" UNIVERSAL AIR RELIEF VALVE
- CHAMPION 100RS-100 MANUAL DRAIN ASSEMBLY
- RAINBIRD PEB DRIP CONTROL VALVE WITH FEBCO PF SERIES 14-1" Y-FILTER

- RAINBIRD PEB-(PRS WHERE NOTED)-B CONTROL VALVE
- SPEARS TRUE UNION SCH. 80 BALL VALVE
- SENNINGER PMR20LF 3/4" INLINE PRESSURE REGULATOR
- RAINBIRD POP UP BUBBLER 1803-5F-B-PCS-040, 0.4 GPM
- RAINBIRD 1812-15H-PCS-(SIZE AS PER PLAN)
- RAINBIRD 1812-15Q-PCS-(SIZE AS PER PLAN)
- MAINLINE (SIZE AS PER PLAN)
- LATERAL SCH 40 PVC (SIZE AS PER SIZING CHART)
- HARDIE E-2 DBK08 (2 GPH) EMITTER ON RAINBIRD 1/2" POLY TUBING-INSTALL TWO(2) EMITTERS PER SHRUB, TWO EMITTERS PER PERENNIAL, ONE EMITTER PER CONTAINERIZED BLUE GRAMMA.
- SLEEVE SCH 40 PVC, MIN. 2 SIZES LARGER THAN PIPE TO BE SLEEVED

NOTE: PLANS ARE DIAGRAMMATIC AND APPROXIMATE DUE TO SCALE OF DRAWINGS. WHERE EVER APPLICABLE, PLACE MAINLINE AND LATERAL PIPING WITHIN TWO(2) FEET OF FACE OF CURB (F.O.C.). ALL VALVES SHALL BE LOCATED IN PLANTING AREAS WHERE SHOWN AND ALL PIPING SHALL BE INSTALLED PRIOR TO PLANTING. NO TEES, ELLS OR OTHER TURNS IN PIPING SHALL BE LOCATED UNDER PAVING. CAP ALL ENDS HAND TIGHT PRIOR TO BACKFILL. ALL IRRIGATION SHALL BE INSTALLED WITHIN APPLICABLE RIGHT OF WAYS.

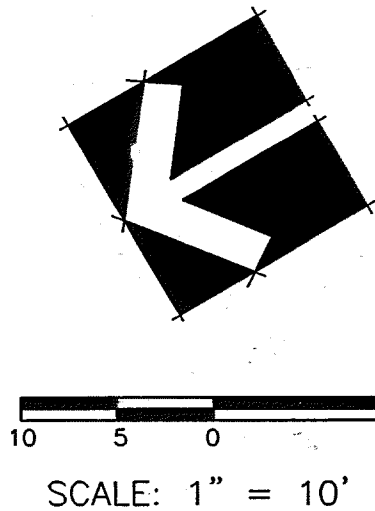

SCALE: 1" = 10'

		CITY OF ALBUQUERQUE PUBLIC WORKS DEPARTMENT ENGINEERING DEVELOPMENT GROUP	
TITLE: HIGH DESERT STREETSCAPE CORTADERIA EXTENSION LANDSCAPE PLANTING PLAN			
DESIGN REVIEW COMMITTEE	CITY ENGINEER APPROVAL	LAST DESIGN UPDATE	MO/DAY/YR.
CITY PROJECT NO.	ZONE MAP NO.	SHEET	OF
553581	E-23, F-23	11	15

--	--	--	--	--	--	--	--	--	--	--	--	--	--	--	--	--	--	--	--	--	--	--	--	--	--	--	--	--	--	--	--	--	--	--	--	--	--	--	--	--	--	--	--	--	--	--	--	--	--	--	--	--	--	--	--	--	--	--	--	--	--	--	--	--	--	--	--	--	--	--	--	--	--	--	--	--	--	--	--	--	--	--	--	--	--	--	--	--	--	--	--	--	--	--	--	--	--	--	--	--	--	--	--	--	--	--	--	--	--	--	--	--	--	--	--	--	--	--	--	--	--	--	--	--	--	--	--	--	--	--	--	--	--	--	--	--	--	--	--	--	--	--	--	--	--	--	--	--	--	--	--	--	--	--	--	--	--	--	--	--	--	--	--	--	--	--	--	--	--	--	--	--	--	--	--	--	--	--	--	--	--	--	--	--	--	--	--	--	--	--	--	--	--	--	--	--	--	--	--	--	--	--	--	--	--	--	--	--	--	--	--	--	--	--	--	--	--	--	--	--	--	--	--	--	--	--	--	--	--	--	--	--	--	--	--	--	--	--	--	--	--	--	--	--	--	--	--	--	--	--	--	--	--	--	--	--	--	--	--	--	--	--	--	--	--	--	--	--	--	--	--	--	--	--	--	--	--	--	--	--	--	--	--	--	--	--	--	--	--	--	--	--	--	--	--	--	--	--	--	--	--	--	--	--	--	--	--	--	--	--	--	--	--	--	--	--	--	--	--	--	--	--	--	--	--	--	--	--	--	--	--	--	--	--	--	--	--	--	--	--	--	--	--	--	--	--	--	--	--	--	--	--	--	--	--	--	--	--	--	--	--	--	--	--	--	--	--	--	--	--	--	--	--	--	--	--	--	--	--	--	--	--	--	--	--	--	--	--	--	--	--	--	--	--	--	--	--	--	--	--	--	--	--	--	--	--	--	--	--	--	--	--	--	--	--	--	--	--	--	--	--	--	--	--	--	--	--	--	--	--	--	--	--	--	--	--	--	--	--	--	--	--	--	--	--	--	--	--	--	--	--	--	--	--	--	--	--	--	--	--	--	--	--	--	--	--	--	--	--	--	--	--	--	--	--	--	--	--	--	--	--	--	--	--	--	--	--	--	--	--	--	--	--	--	--	--	--	--	--	--	--	--	--	--	--	--	--	--	--	--	--	--	--	--	--	--	--	--	--	--	--	--	--	--	--	--	--	--	--	--	--	--	--	--	--	--	--	--	--	--	--	--	--	--	--	--	--	--	--	--	--	--	--	--	--	--	--	--	--	--	--	--	--	--	--	--	--	--	--	--	--	--	--	--	--	--	--	--	--	--	--	--	--	--	--	--	--	--	--	--	--	--	--	--	--	--	--	--	--	--	--	--	--	--	--	--	--	--	--	--	--	--	--	--	--	--	--	--	--	--	--	--	--	--	--	--	--	--	--	--	--	--	--	--	--	--	--	--	--	--	--	--	--	--	--	--	--	--	--	--	--	--	--	--	--	--	--	--	--	--	--	--	--	--	--	--	--	--	--	--	--	--	--	--	--	--	--	--	--	--	--	--	--	--	--	--	--	--	--	--	--	--	--	--	--	--	--	--	--	--	--	--	--	--	--	--	--	--	--	--	--	--	--	--	--	--	--	--	--	--	--	--	--	--	--	--	--	--	--	--	--	--	--	--	--	--	--	--	--	--	--	--	--	--	--	--	--	--	--	--	--	--	--	--	--	--	--	--	--	--	--	--	--	--	--	--	--	--	--	--	--	--	--	--	--	--	--	--	--	--	--	--	--	--	--	--	--	--	--	--	--	--	--	--	--	--	--	--	--	--	--	--	--	--	--	--	--	--	--	--	--	--	--	--	--	--	--	--	--	--	--	--	--	--	--	--	--	--	--	--	--	--	--	--	--	--	--	--	--	--	--	--	--	--	--	--	--	--	--	--	--	--	--	--	--	--	--	--	--	--	--	--	--	--	--	--	--	--	--	--	--	--	--	--	--	--	--	--	--	--	--	--	--	--	--	--	--	--	--	--	--	--	--	--	--	--	--	--	--	--	--	--	--	--	--	--	--	--	--	--	--	--	--	--	--	--	--	--	--	--	--	--	--	--	--	--	--	--	--	--	--	--	--	--	--	--	--	--	--	--	--	--	--	--	--	--	--	--	--	--	--	--	--	--	--	--	--	--	--	--	--	--	--	--	--	--	--	--	--	--	--	--	--	--	--	--	--	--	--	--	--	--	--	--	--	--	--	--	--	--	--	--	--	--	--	--	--	--	--	--	--	--	--	--	--	--	--	--	--	--	--	--	--	--	--	--	--	--	--	--	--	--	--	--	--	--	--	--	--	--	--	--	--	--	--	--	--	--	--	--	--	--	--	--	--	--	--	--	--	--	--	--	--	--	--	--	--	--	--	--	--	--	--	--	--	--	--	--	--	--	--	--	--	--	--	--	--	--	--	--	--	--	--	--	--	--	--	--	--	--	--	--	--	--	--	--	--	--	--	--	--	--	--	--	--	--	--	--	--	--	--	--	--	--	--	--	--	--	--	--	--	--	--	--	--	--	--	--	--	--	--	--	--	--	--	--	--	--	--	--	--	--	--	--	--	--	--	--	--	--	--	--	--	--	--	--	--	--	--	--	--	--	--	--	--	--	--	--	--	--	--	--	--	--	--	--	--	--	--	--	--	--	--	--	--	--	--	--	--	--	--	--	--	--	--	--	--	--	--	--	--	--	--	--	--	--	--	--	--	--	--	--	--	--	--	--	--	--	--	--	--	--	--	--	--	--	--	--	--	--	--	--	--	--	--	--	--	--	--	--	--	--	--	--	--	--	--	--	--	--	--	--	--	--	--	--	--	--	--	--	--	--	--	--	--	--	--	--	--	--	--	--	--	--	--	--	--	--	--	--	--	--	--	--	--	--	--	--	--	--	--	--	--	--	--	--	--	--	--	--	--	--	--	--	--	--	--	--	--	--	--	--	--	--	--	--	--	--	--	--	--	--	--	--	--	--	--	--	--	--	--	--	--	--	--	--	--	--	--	--	--	--	--	--	--	--	--	--	--	--	--	--	--	--	--	--	--	--	--	--	--	--	--	--	--	--	--	--	--	--	--	--	--	--	--	--	--	--	--	--	--	--	--	--	--	--	--	--	--	--	--	--

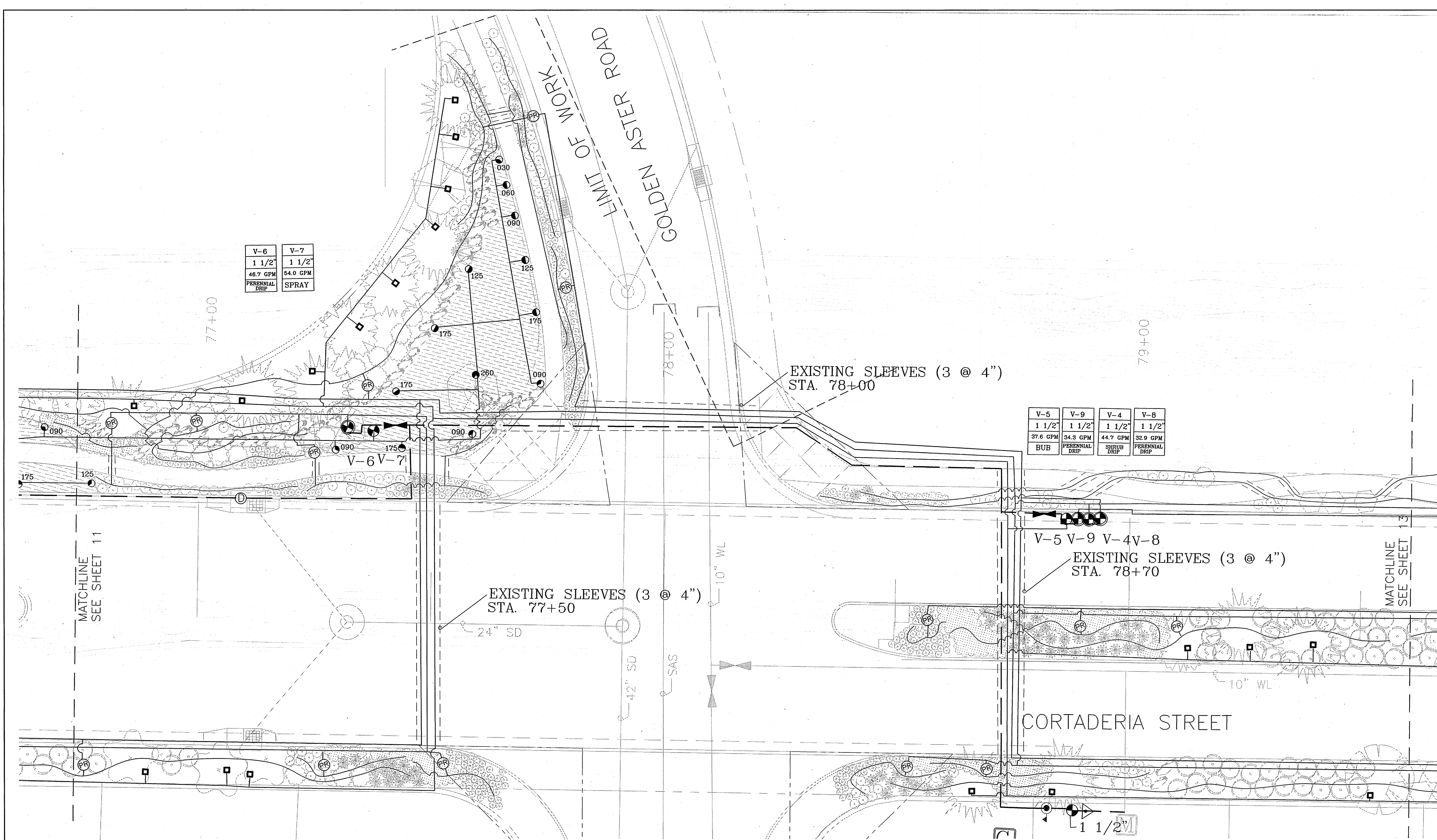

V-6	V-7
1 1/2"	1 1/2"
46.7 GPM	54.0 GPM
PERENNIAL DRIP	SPRAY

V-5	V-9	V-4	V-8
1 1/2"	1 1/2"	1 1/2"	1 1/2"
37.6 GPM	34.3 GPM	44.7 GPM	32.9 GPM
BUB	PERENNIAL DRIP	SHRUB DRIP	PERENNIAL DRIP

IRRIGATION LEGEND

- WATER METER M170, AS PER CITY OF ALBUQUERQUE
- SOLATROL LEIT 8000-2, XKIT 8724 CONTROLLER, AMTG 2035 ANTENNA MOUNTING COLUMN, LEMA 1521 SOLENOID, EXPANSION MODULE
- BERMAD 910-P, (SIZE AS PER DRAWING) MASTER VALVE WITH FEBCO 825Y, 1 1/2" RPA, W/ STRONGBOX ENCLOSURE
- WILKENS 1 1/2" 500YSBR PRESSURE REDUCING VALVE (INCLUDES "Y" STRAINER)
- CRISPIN UL 10.0-1" UNIVERSAL AIR RELIEF VALVE
- CHAMPION 100RS-100 MANUAL DRAIN ASSEMBLY
- RAINBIRD PEB DRIP CONTROL VALVE WITH FEBCO PF SERIES 14-1" Y-FILTER

- RAINBIRD PEB-(PRS WHERE NOTED)-B CONTROL VALVE
- SPEARS TRUE UNION SCH. 80 BALL VALVE
- SENNINGER PMR20LF 3/4" INLINE PRESSURE REGULATOR
- RAINBIRD POP UP BUBBLER 1803-5F-B-PCS-040, 0.4 GPM
- RAINBIRD 1812-15H-PCS-(SIZE AS PER PLAN)
- RAINBIRD 1812-15Q-PCS-(SIZE AS PER PLAN)
- MAINLINE (SIZE AS PER PLAN)
- LATERAL SCH 40 PVC (SIZE AS PER SIZING CHART)
- HARDIE E-2 DBK08 (2 GPH) EMITTER ON RAINTUBE 1/2" POLY TUBING INSTALL TWO(2) EMITTERS PER SHRUB; TWO EMITTERS PER PERENNIAL, ONE EMITTER PER CONTAINERIZED BLUE GRAMMA.
- SLEEVE SCH 40 PVC, MIN. 2 SIZES LARGER THAN PIPE TO BE SLEEVED

NOTE: PLANS ARE DIAGRAMMATIC AND APPROXIMATE DUE TO SCALE OF DRAWINGS. WHERE EVER APPLICABLE, PLACE MAINLINE AND LATERAL PIPING WITHIN TWO(2) FEET OF FACE OF CURB (F.O.C.). ALL VALVES SHALL BE LOCATED IN PLANTING AREAS WHERE SHOWN AND ALL PIPING SHALL BE INSTALLED PRIOR TO PLANTING. NO TEES, ELLS OR OTHER TURNS IN PIPING SHALL BE LOCATED UNDER PAVING. CAP ALL ENDS HAND TIGHT PRIOR TO BACKFILL. ALL IRRIGATION SHALL BE INSTALLED WITHIN APPLICABLE RIGHT OF WAYS.

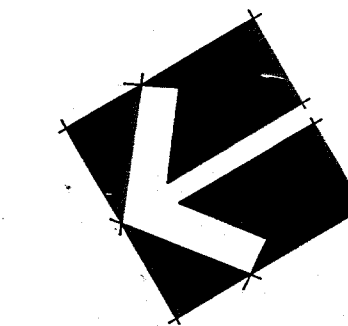

SCALE: 1" = 10'

CITY OF ALBUQUERQUE
PUBLIC WORKS DEPARTMENT
ENGINEERING DEVELOPMENT GROUP

TITLE: HIGH DESERT STREETSCAPE
CORTADERIA EXTENSION
LANDSCAPE PLANTING PLAN

DESIGN REVIEW COMMITTEE	CITY ENGINEER APPROVAL	MO./DAY/YR.	MO./DAY/YR.
CITY PROJECT NO. 553581	ZONE MAP NO. E-23, F-23	SHEET 12	OF 15

COPYRIGHT BOHANNAN-HUSTON, INC.
DATE: 8/23/96

26-5535-811 12291

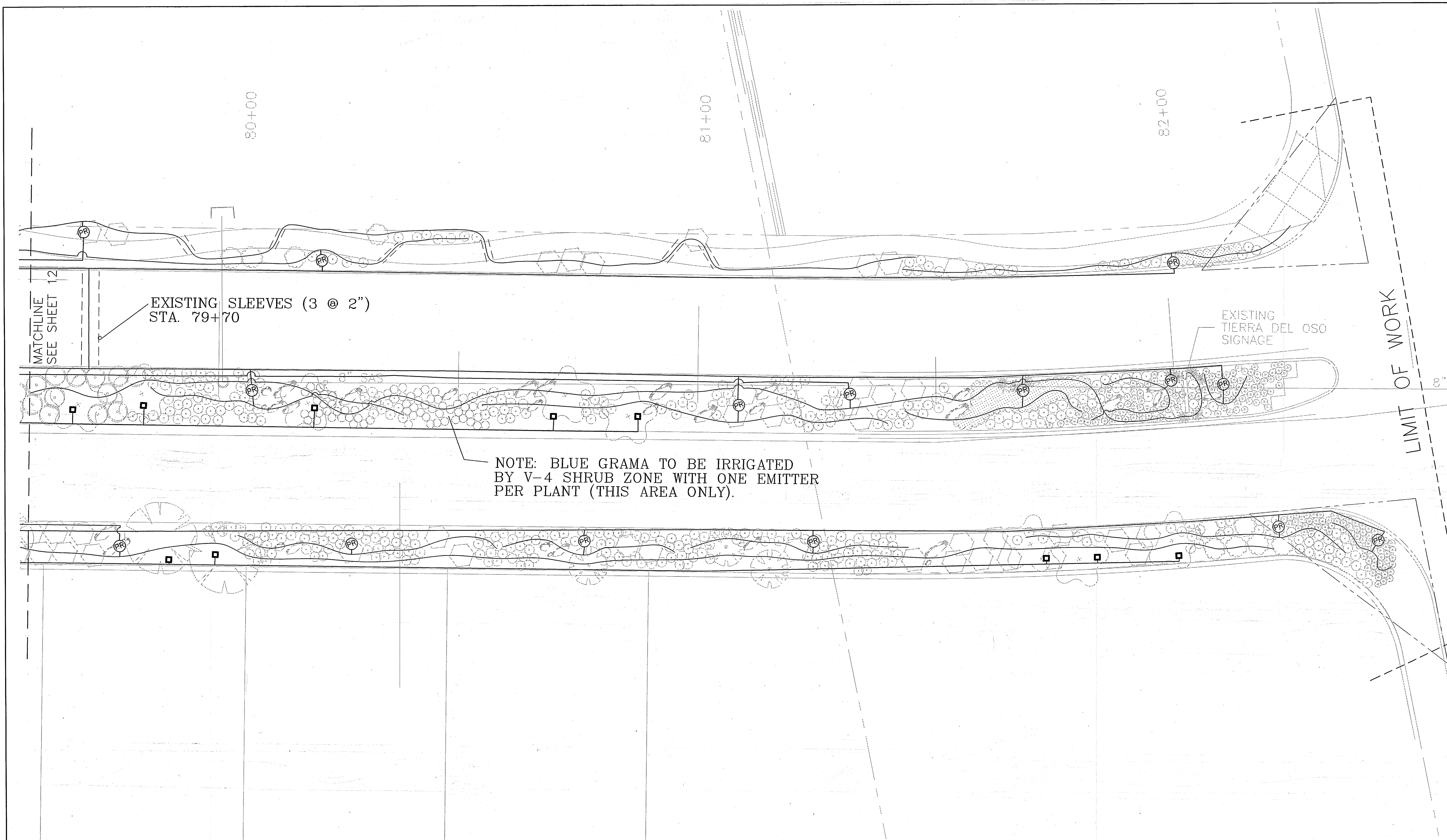

				ENGINEER'S SEAL		SURVEY INFORMATION		BENCH MARKS		AS-BUILT INFORMATION	
						FIELD NOTES				CONTRACTOR HEADS UP	
						NO.		BY		WORKED BY	
										DATE	
										INSPECTOR'S	
										ACCEPTANCE BY	
										DATE	
										VERIFICATION BY	
										DATE	
										CORRECTIONS	
										CORRECTED BY	
										J.C.	
										DATE	
										DATE — 97	
										MICRO—FILM INFORMATION	
										RECORDED BY	
										DATE	
										NO.	
		</									

IRRIGATION NOTES

- GENERAL
- WORK UNDER THIS SECTION CONSISTS OF INSTALLING A COMPLETE UNDERGROUND IRRIGATION SYSTEM AS SHOWN ON THESE PLANS, DETAILS AND SPECIFICATIONS. THE CONTRACTOR PERFORMING THIS WORK SHALL FURNISH ALL LABOR, EQUIPMENT, MATERIALS AND PERMITS NECESSARY FOR THE COMPLETION OF THE IRRIGATION SYSTEM, EXCEPT FOR THOSE COMPONENTS SPECIFIED TO BE FURNISHED BY OTHERS.
 - THE CONTRACTOR SHALL BE FAMILIAR WITH THESE PLANS, DETAILS AND SPECIFICATIONS AS THEY PERTAIN TO THE SITE. IT SHALL BE THE CONTRACTOR'S RESPONSIBILITY TO NOTIFY THE OWNER'S REPRESENTATIVE OF ANY ITEMS THAT ARE IN CONFLICT WITH THE PROPOSED CONTRACT.
 - EXISTING UTILITY LINES ARE TO BE BLUE STAKED PRIOR TO EXCAVATION FOR IRRIGATION LINES AND EQUIPMENT. CHECK AND FIELD VERIFY ALL SITE CONDITIONS, UTILITIES AND SERVICES PRIOR TO TRENCHING. CALL N.M. ONE CALL AT 260-1990 FOR BLUE STAKING.
 - RIGHT OF WAY VARIES BY STREET DESIGN. CONSTRUCTION AREAS ARE NOTED ON DRAWINGS. AT NO TIME SHALL CONTRACTOR PERFORM WORK OR DISTURB AREAS BEYOND RIGHT OF WAY LIMIT.
 - ALL PLANT MATERIALS SHALL BE IRRIGATED WITH AUTOMATIC IRRIGATION SYSTEMS AS PER PLANS, DETAILS AND SPECIFICATIONS UNLESS OTHERWISE INDICATED ON THE DRAWING.
 - WHERE TREES, LIGHT STANDARDS, ETC. ARE AN OBSTRUCTION OF PIPING AND DRIP EMITTERS, THEY SHALL BE ADJUSTED/ OR RELOCATED AS NECESSARY TO OBTAIN FULL COVERAGE WITHOUT EXCESSIVE OVERFLOW.
 - CONTRACTOR SHALL FLUSH ALL LINES PRIOR TO INSTALLING HEADS AND EMITTERS.
 - PLANS ARE DIAGRAMMATIC AND APPROXIMATE DUE TO SCALE OF DRAWINGS. WHERE EVER APPLICABLE, PLACE MAINLINE AND LATERAL PIPING WITHIN TWO(2') FEET OF FACE OF CURB(F.O.C) ALL VALVES SHALL BE LOCATED IN PLANTING AREAS WHERE SHOWN AND ALL PIPING SHALL BE INSTALLED PRIOR TO PLANTING. NO TEES, ELLS OR OTHER TURNS IN PIPING SHALL BE LOCATED UNDER PAVING. CAP ALL ENDS HAND TIGHT PRIOR TO BACKFILL. ALL IRRIGATION SHALL BE INSTALLED WITHIN APPLICABLE RIGHT OF WAYS.
 - COMPLY WITH REQUIREMENTS OF THE UNIFORM PLUMBING CODE AND ANY OTHER GOVERNMENTAL BODIES HAVING JURISDICTION.
 - REFER TO IRRIGATION DETAILS, SPECIFICATIONS AND MANUFACTURERS RECOMMENDATIONS FOR ALL INSTALLATION PROCEDURES NOT FULLY DESCRIBED ON THE IRRIGATION PLANS.
 - ALL BACKFILLING SHALL BE CLEAN MATERIAL FROM EXCAVATION. BACKFILLED TRENCH IS TO BE EVEN WITH EXISTING GRADES AFTER COMPACTION.
 - TRENCH BACKFILL MATERIAL SHALL BE COMPACTED TO 85% PROCTOR DENSITY.
 - ALL VALVES TO BE IN APPROVED VALVE BOXES. LOCATE VALVE BOXES IN GROUPS OF TWO OR THREE AND NEAR WALKWAYS WHEREVER POSSIBLE.
 - COORDINATE PROGRAMS TO AVOID STATION OVERLAP.

COMPONENTS AND PRODUCTS

- ALL COMPONENTS INSTALLED AS THE UNDERGROUND IRRIGATION SYSTEM ARE TO BE NEW AND IN GOOD WORKING ORDER AND WITHOUT FLAWS UNLESS OTHERWISE INDICATED ON THE PLANS, DETAILS AND SPECIFICATIONS.
- IF THE CONTRACT DRAWINGS AND/OR SPECIFICATIONS DO NOT THOROUGHLY DESCRIBE THE METHOD OR TECHNIQUES TO BE USED FOR INSTALLATION, THEN THE CONTRACTOR SHALL FOLLOW THE INSTALLATION METHODS RECOMMENDED BY THE MANUFACTURER.
- ALL PLANT MATERIALS INSTALLED SHALL HAVE THE AUTOMATIC IRRIGATION SYSTEM FULLY OPERABLE AT THE TIME OF PLANT INSTALLATION.

WARRANTY AND MAINTENANCE

- THE CONTRACTOR SHALL FURNISH A CERTIFICATE OF WARRANTY AND A GUARANTEE OF WORK AND MATERIALS FOR A ONE YEAR PERIOD FROM DATE OF FINAL ACCEPTANCE. FINAL PAYMENT FOR THE SYSTEM SHALL NOT BE MADE UNLESS THIS CERTIFICATE IS PRESENTED TO THE OWNER.
- THE CONTRACTOR SHALL MAINTAIN THE IRRIGATION SYSTEM, IN SATISFACTORY WORKING ORDER, DURING THE TIME OF CONTRACT WORK.
- THE CONTRACTOR SHALL BE LIABLE FOR ANY LOSS OR DAMAGE TO ANY WORK OR MATERIALS, SUPPLIES AND EQUIPMENT ON THE JOB SITE CAUSED BY THE CONTRACTOR, ITS EMPLOYEES OR ANY OTHER UNFORESEEN CAUSE UNTIL FINAL ACCEPTANCE OF PROJECT WITH THE OWNER'S REPRESENTATIVE.

IRRIGATION LEGEND

- | | | |
|--|---|--|
| | WATER METER M170 , AS PER CITY OF ALBUQUERQUE | BY OWNER |
| | SOLATROL LEIT 8000-2, XKIT 8724 CONTROLLER, AMTG 2035 ANTENNA MOUNTING COLUMN, LEMA 1521 SOLENOID. | INSTALL AS PER MANUFACTURERS SPECIFICATION |
| | BERMAD 910-P, (SIZE AS PER DRAWING) MASTER VALVE WITH FEBCO 825Y, 1 1/2" RPA, W/ STRONGBOX ENCLOSURE MODEL #SBBC-30 ALI. | SEE DETAIL A/14 |
| | CRISPIN UL 10.0-1" UNIVERSAL AIR RELIEF VALVE | SEE DETAIL I/15 |
| | CHAMPION 100RS-100 MANUAL DRAIN ASSEMBLY | SEE DETAIL G/15 |
| | WILKENS 1 1/2" 500YSBR PRESSURE REDUCING VALVE (INCLUDES "Y" STRAINER) | SEE DETAIL C/14 |
| | RAINBIRD PEB-(PRS IF NOTED)-B CONTROL VALVE | SEE DETAIL A/15 |
| | RAINBIRD PEB DRIP CONTROL VALVE W/ PEPCO PF SERIES 14-1" Y-FILTER | SEE DETAIL B/15 |
| | SENNINGER PMR20LF 3/4" INLINE PRESSURE REGULATOR | SEE DETAIL C/15 |
| | SPEARS TRUE UNION SCH. 80 BALL VALVE | |
| | HARDIE E-2 DBK08 (2 GPH) EMITTER ON RAINBIRD 1/2" POLY TUBING INSTALL TWO(2) EMITTERS PER SHRUB. TWO EMITTERS PER PERENNIAL ONE EMITTER PER CONTAINERIZED BLUE GRAMA. | |
| | RAINBIRD POP UP BUBBLER 1803-5F-B-PCS-040, 0.4 GPM | SEE DETAIL D/15 |
| | RAINBIRD1812-15H-PCS-(SIZE AS PER PLAN) | SEE DETAIL E/15 |
| | RAINBIRD1812-15Q-PCS-(SIZE AS PER PLAN) | SEE DETAIL E/15 |
| | MAINLINE (SIZE AS PER PLAN) | |
| | LATERAL SCH 40 PVC | |
| | SLEEVE SCH 40 PVC, EXISTING, ADD WHERE NOTED ON PLAN MIN. 2 SIZES LARGER THAN PIPE TO BE SLEEVED | |

NOTES

- ALL CONTROLLER WIRING UNDER PAVEMENT SHALL BE SLEEVED WITH EXISTING SCH 40 PVC. CONTROLLER STATIONS SHALL BE WIRED AS PER VALVE LEGEND.
- DEPTH OF BURY SHALL BE 28" TO 30" FOR CONSTANT PRESSURE MAINLINE. 18" TO 20" FOR MAINLINE DOWNSTREAM OF THE MASTERVALVE, AND 18" TO 20" FOR ALL LATERAL LINES.
- MANUAL DRAINS ARE TO BE FIELD LOCATED AND INSTALLED AT LOW POINTS IN THE MAINLINE AS DETERMINED BY FIELD SURVEY.
- ALL TESTING GAUGES AND VALVES AS INSTALLED SHALL BE LABELED AS PER VALVE STATIONS AS SHOWN ON THESE PLANS.
- VALVE BOXES SHALL BE INSTALLED IN PLACE PRIOR TO ANY PRESSURE TESTING TO ENSURE PROPER GRADING.
- EXISTING SLEEVE LOCATIONS AS SHOWN ARE SCHEMATIC. CONTRACTOR SHALL FIELD LOCATE ALL EXISTING SLEEVES.
- CONTRACTOR SHALL SIZE AND INSTALL ALL LATERAL PIPES AS PER PIPE SIZING CHART. ALL PIPE SIZING SHALL BE SUBMITTED TO AND APPROVED BY LANDSCAPE ARCHITECT PRIOR TO INSTALLATION. SEE PLANS.
- THE IRRIGATION SYSTEM IS DESIGNED FOR AN OPERATIONAL RANGE OF 85-100 PSI. CONTRACTOR SHALL FIELD VERIFY PRESSURE PRIOR TO INITIATION OF CONSTRUCTION. IF PRESSURES ARE NOT WITHIN THIS RANGE, CONTACT THE LANDSCAPE ARCHITECT FOR INSTRUCTION ON HOW TO PROCEED

PIPE SIZING CHART

LATERALS SHALL BE SCH. 40 PVC, SIZED AS INDICATED BELOW, UNLESS OTHERWISE NOTED ON DRAWINGS:

MAXIMUM DEMAND	PIPE SIZE
UP TO 4.0 GPM	1/2"
4.0 TO 8.0 GPM	3/4"
8.0 TO 12.0 GPM	1"
12.0 TO 22.0 GPM	1 1/4"
22.0 TO 38 GPM	1 1/2"
38.0 TO 50.0 GPM	2"
50.0 TO 70.0 GPM	2 1/2"

VALVE LEGEND

VALVE AND STATION NO.	
VALVE SIZE	
TOTAL GPM	
HEAD TYPE	

NOTE: ZONES BELOW 10 GPM NOT TO BE PROGRAMMED FIRST OR LAST ON AUTOMATIC CYCLE SEQUENCING

GENERAL NOTES

PROTECT RPA FROM FREEZING WITH POSITIVE HEAT SOURCE.

ELECTRICAL NOTES:

- CONTRACTOR SHALL BE RESPONSIBLE FOR PROVIDING, COORDINATING, AND INSTALLING ALL ELECTRICAL AND ELECTRICAL SUPPLIES NECESSARY FOR THE INSTALLATION AND OPERATION OF THE IRRIGATION SYSTEM SPECIFIED.
- CONTRACTOR SHALL INSTALL ELECTRICAL WORK IN COMPLIANCE WITH ALL APPLICABLE CODES, ORDINANCES AND REQUIREMENTS OF THE CITY OF ALBUQUERQUE, AND ALL OTHER GOVERNING BODIES HAVING JURISDICTION.

CONSTRUCTION NOTES

- | | |
|---|--|
| A. CURB STOP. | R. TEE WITH DRAIN. MINIMUM 8" ABOVE GRADE. BALL DRAIN, CHAMPION DV050 1/2" |
| B. SERVICE LINE, NO OUTLETS ALLOWED. | S. ELEC. OUTLET FOR HEAT PROTECTIVE TAPE |
| C. FINISH GRADE | T. REDUCED PRESSURE VACUUM BREAKER BACKFLOW PREVENTER (SEE LEGEND) |
| D. BROOK'S PRODUCTS INC. 1730 PB-18 BODY (ABS) VALVE BOX WITH 1730 BOLT DOWN COVER (ABS) AND TWO 8" EXTENSIONS. | U. PVC MIP ADAPTER |
| E. SPEARS TRUE UNION SCH. 80 PVC BALL VALVE | V. MAINLINE/LATERAL MAINLINE |
| F. 24" WIRE EXPANSION COIL | AA. 6 mm BLACK POLYETHYLENE. TAPE TO ALL INLET AND OUTLET LINES |
| G. 3M SKOTCHLOK OR EQUAL | BB. 4000 PSI CONCRETE PAD, 4" DEPTH |
| H. SCHEDULE 80 PVC CLOSE NIPPLE | CC. PIPE SHALL BE SLEEVED THROUGH CONCRETE PAD WITH SCH 40 PVC. |
| I. ELECTRIC VALVE (SEE PLAN /IRR. LEG.) | DD. ENCLOSURE (SEE PLAN/ IRRIGATION LEGEND) |
| J. SPEARS SCH 80 PVC UNION | EE. CONCRETE COLLAR |
| K. SCH 80 PVC NIPPLE | |
| L. 1 CUBIC FOOT 1" DIAMETER WASHED ROCK. | |
| M. 8" X 8" X 16" SOLID CMU BLOCK | |
| N. GALVANIZED ELL | |
| O. GALVANIZED NIPPLE | |
| P. GALVANIZED UNION, 4" ABOVE GRADE, MIN. | |

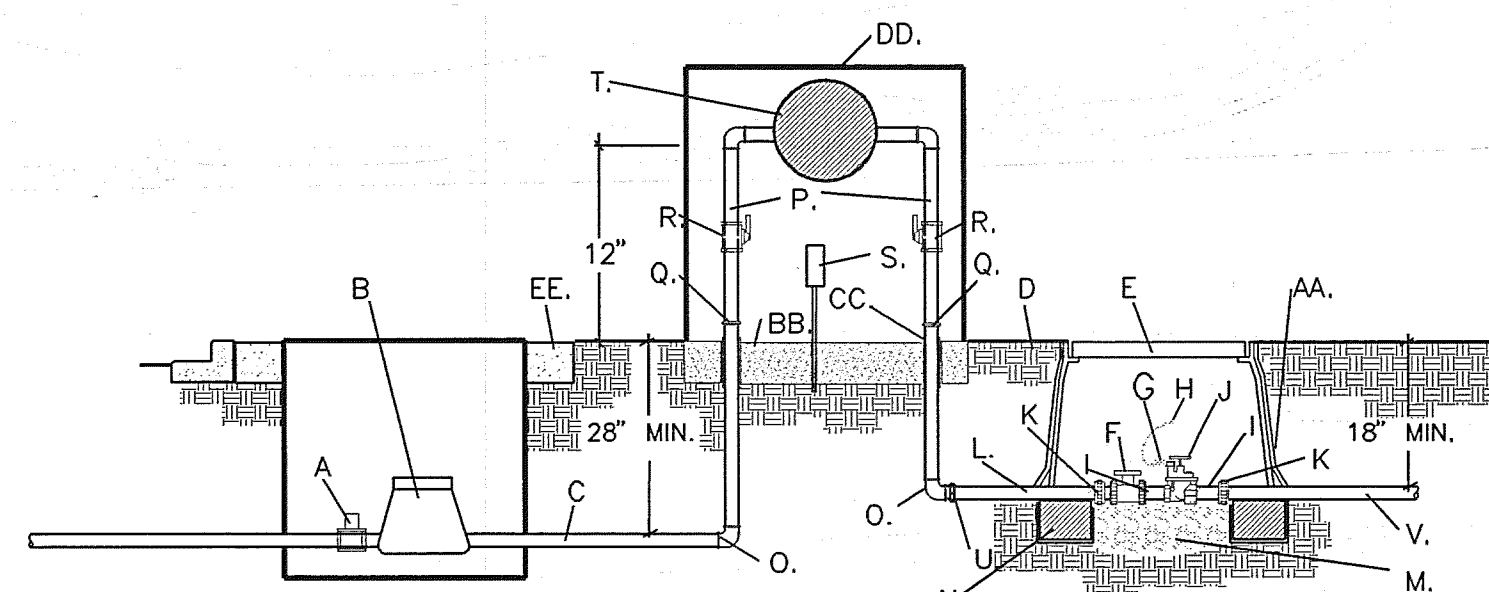

A IRRIGATION MASTER VALVE WITH REDUCED PRESSURE BACKFLOW PREVENTER NOT TO SCALE

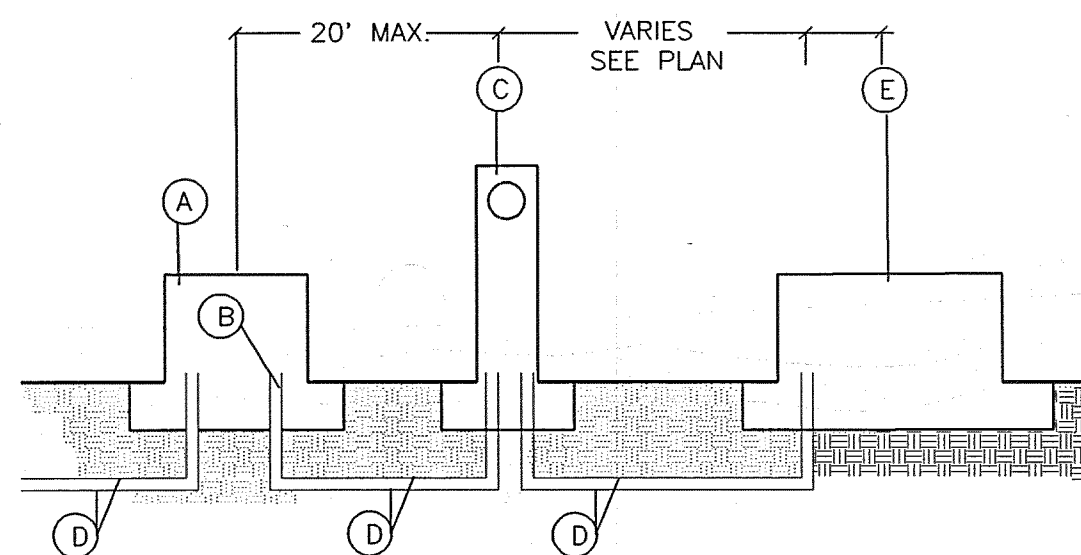

- | | |
|--|--|
| A. POWER TRANSFORMER, EXISTING | NOTE: ELECTRICAL SERVICE SHALL BE PROVIDED FOR THE IRRIGATION RPA HEAT TAPE. POWER SHALL BE PROVIDED FROM AN EXISTING TRANSFORMER. |
| B. SERVICE CONNECTION FOR IRRIGATION, COMPLETE | |
| C. METER PEDESTAL | |
| D. ELECTRICAL CONDUIT, 2" PVC | |
| E. IRRIGATION BACKFLOW PREVENTER ENCLOSURE (HEAT TAPE ELECTRICAL SOURCE) | |

B ELECTRIC SERVICE FOR IRRIGATION NOT TO SCALE

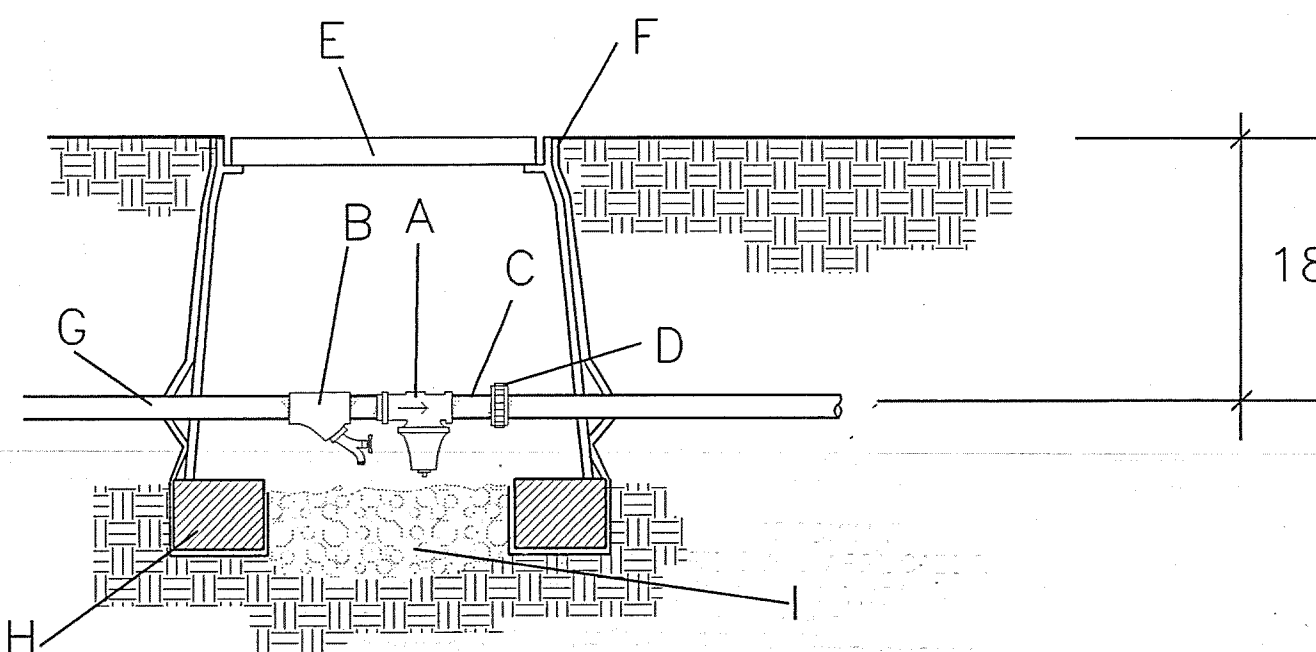

- | | |
|--|---|
| A. PRESSURE REDUCING VALVE (SEE LEGEND) | F. 6mm BLACK POLYETHYLENE. TAPE TO ALL INLET AND OUTLET LINES |
| B. WYE STRAINER | G. MAINLINE |
| C. SCH. 80 PVC NIPPLE | H. 8" X 8" X 16" SOLID CMU BLOCK |
| D. SCH. 80 PVC UNION | I. 2 CU. FT. 1" DIAMETER WASHED ROCK. |
| E. BROOK'S PRODUCTS INC. 1730 PB-18 BODY (ABS) VALVE BOX WITH 1730 BOLT DOWN COVER (ABS) AND (1) 8 INCH EXTENSION. | |

C MAINLINE PRESSURE REDUCING VALVE NOT TO SCALE

AS-BUILT INFORMATION		BENCH MARKS		SURVEY INFORMATION		ENGINEER'S SEAL	
CONTRACTOR	DATE	NO.	DATE	NO.	DATE	NO.	DATE
INSPECTOR'S	DATE	NO.	DATE	NO.	DATE	NO.	DATE
FIELD	DATE	NO.	DATE	NO.	DATE	NO.	DATE
VERIFICATION BY	DATE	NO.	DATE	NO.	DATE	NO.	DATE
CONNECTED BY	DATE	NO.	DATE	NO.	DATE	NO.	DATE
MICRO-FILM INFORMATION		REMARKS		REVISIONS		DESIGN	
RECORDED BY		NO. DATE		NO. DATE		NO. DATE	
NO.		NO.		NO.		NO.	

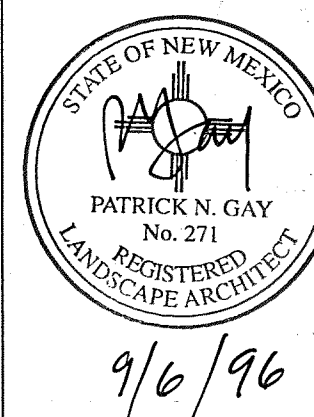

BOHANNAN-HUSTON INC. ENGINEERS • PLANNERS • PHOTOGRAMMETRISTS • SURVEYORS • LANDSCAPE ARCHITECTS ALBUQUERQUE LAS CRUCES SANTA FE	
CITY OF ALBUQUERQUE PUBLIC WORKS DEPARTMENT ENGINEERING DEVELOPMENT GROUP	
TITLE: HIGH DESERT STREETSCAPE CORTADERIA EXTENSION IRRIGATION DETAILS	
DESIGN-REVIEW-COMMITTEE	CITY ENGINEER APPROVAL
LAST DESIGN UPDATE	MO./DAY/YR.
CITY PROJECT NO. 553581	ZONE MAP NO. E-23, F-23
SHEET 14	OF 15

