

SCANNED BY  
MESA REPRO

JOB NO: F05-236-0086  
FILE: MALOY-TSDWG  
REV: 06/16/97 PG

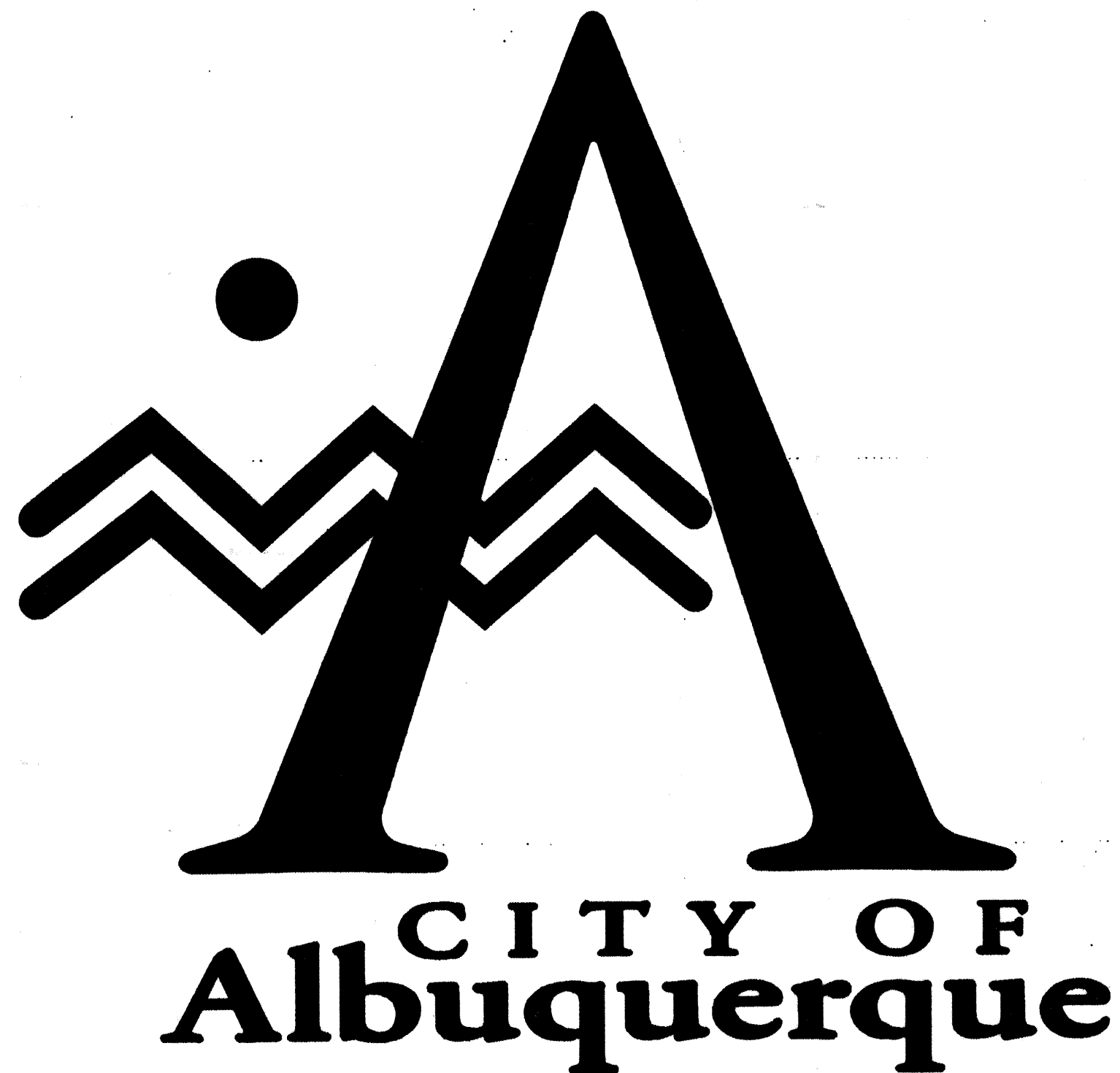

# MALOY MOBILE STORAGE PUBLIC INFRASTRUCTURE IMPROVEMENTS

## WATER

### INDEX OF DRAWINGS

SHEET	TITLE
1	TITLE SHEET, INDEX, GENERAL NOTES, LEGEND, AND ABBREVIATIONS
2	FIRE LINE AND SERVICE LINE INSTALLATION
3	TRAFFIC CONTROL
4	TRAFFIC CONTROL

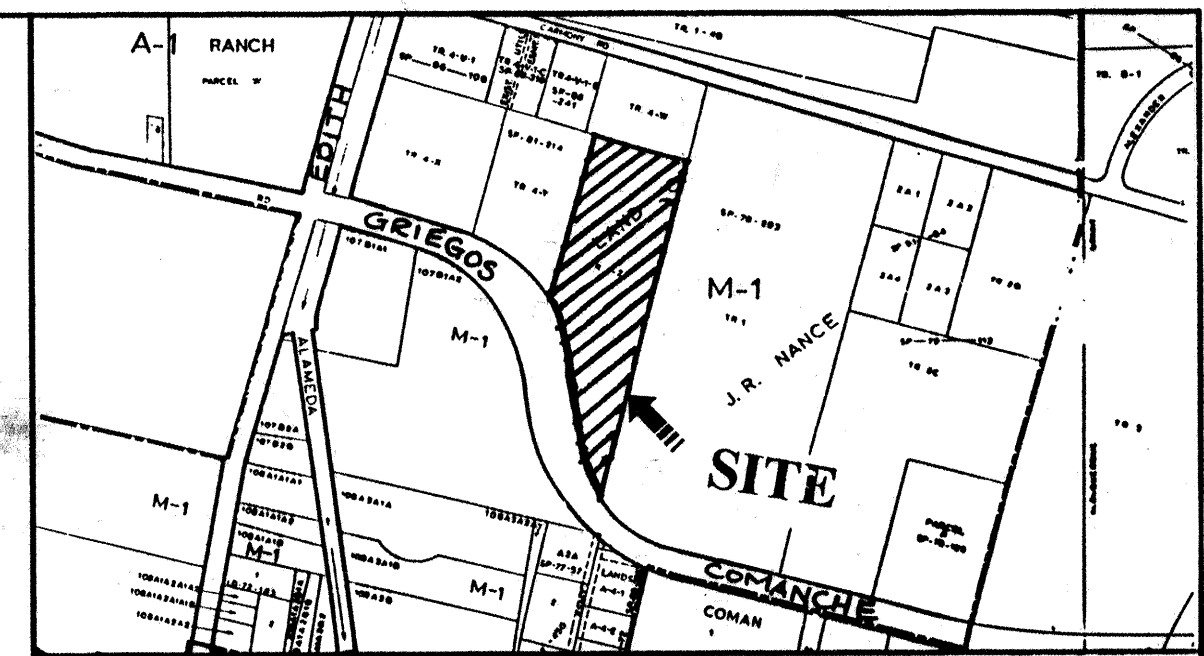
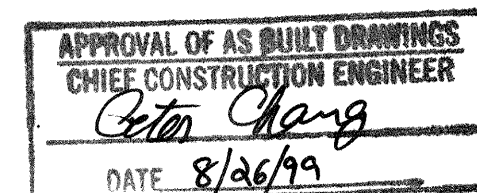

VICINITY MAP G-15

#### GENERAL NOTES

- AN EXCAVATION/CONSTRUCTION PERMIT WILL BE REQUIRED BEFORE BEGINNING ANY WORK WITHIN CITY RIGHT-OF-WAY.
- ALL WORK DETAILED ON THESE PLANS TO BE PERFORMED, EXCEPT AS OTHERWISE STATED OR PROVIDED HEREON, SHALL BE CONSTRUCTED IN ACCORDANCE WITH CITY OF ALBUQUERQUE STANDARD SPECIFICATIONS FOR PUBLIC WORKS CONSTRUCTION, 1986 EDITION AS REVISED THROUGH UPDATE #6.
- TWO WORKING DAYS PRIOR TO ANY EXCAVATION, CONTRACTOR MUST CONTACT LINE LOCATING SERVICE, (260-1990) FOR LOCATION OF EXISTING UTILITIES.
- PRIOR TO CONSTRUCTION, THE CONTRACTOR SHALL EXCAVATE AND VERIFY THE HORIZONTAL AND VERTICAL LOCATIONS OF ALL PERTINENT EXISTING UTILITIES. SHOULD A CONFLICT EXIST, THE CONTRACTOR SHALL NOTIFY THE ENGINEER SO THAT THE CONFLICT CAN BE RESOLVED WITH A MINIMUM AMOUNT OF DELAY.
- THREE WORKING DAYS PRIOR TO BEGINNING CONSTRUCTION THE CONTRACTOR SHALL SUBMIT TO THE CONSTRUCTION COORDINATION DIVISION A DETAILED CONSTRUCTION SCHEDULE. TWO WORKING DAYS PRIOR TO CONSTRUCTION, THE CONTRACTOR SHALL OBTAIN A BARRICADING PERMIT FROM THE CONSTRUCTION COORDINATION DIVISION. CONTRACTOR SHALL NOTIFY BARRICADE ENGINEER (765-2551) PRIOR TO OCCUPYING PUBLIC RIGHT-OF-WAY. SEE SECTION 19 OF THE SPECIFICATIONS.
- ALL STREET STRIPING ALTERED OR DESTROYED SHALL BE REPLACED WITH PLASTIC REFLECTORIZED PAVEMENT MARKINGS BY CONTRACTOR TO SAME LOCATION AS EXISTING, OR AS INDICATED BY THIS PLAN SET.
- CONTRACTOR SHALL COORDINATE WITH WATER SYSTEMS DIVISION (857-8200) FIVE WORKING DAYS IN ADVANCE OF ANY WORK THAT MAY AFFECT EXISTING PUBLIC WATER OR SEWER UTILITIES. EXISTING VALVES TO BE OPERATED BY CITY PERSONNEL ONLY. CONTRACTOR SHALL CONTACT THE WATER SYSTEMS DIVISION.
- CONTRACTOR SHALL RECORD DATA ON ALL UTILITY LINES AND ACCESSORIES AS REQUIRED BY THE CITY OF ALBUQUERQUE FOR THE PREPARATION OF AS CONSTRUCTED DRAWINGS. CONTRACTOR SHALL NOT COVER UTILITY LINES AND ACCESSORIES UNTIL ALL DATA HAS BEEN RECORDED.
- CONTRACTOR SHALL NOTIFY THE ENGINEER NOT LESS THAN SEVEN (7) DAYS PRIOR TO STARTING WORK IN ORDER THAT THE CITY SURVEYOR MAY TAKE NECESSARY MEASURES TO INSURE THE PRESERVATION OF SURVEY MONUMENTS. CONTRACTOR SHALL NOT DISTURB PERMANENT SURVEY MONUMENTS WITHOUT THE CONSENT OF THE CITY SURVEYOR AND SHALL NOTIFY THE CITY SURVEYOR AND BEAR THE EXPENSE OF REPLACING ANY THAT MAY BE DISTURBED.
- ANY WORK AFFECTING AN ARTERIAL ROADWAY REQUIRES TWENTY FOUR (24) HOUR CONSTRUCTION.

#### LEGEND

DESCRIPTION	EXISTING	NEW
ASPHALT		
WATER LINE	--- W ---	
GAS LINE	--- G ---	
SANITARY SEWER LINE	--- SAS ---	
EDGE OF ROAD	---	
PROPERTY LINE	---	
CONSTRUCTION BASE LINE		1+00

#### ABBREVIATIONS

LF = LINEAR FEET	STA = STATION
L = LEFT	RAD. = RADIUS
R = RIGHT	TYP. = TYPICAL
TC = TOP OF CURB	PC = POINT OF CURVATURE
FL = FLOWLINE	PT = POINT OF TANGENT
EXIST = EXISTING	TA = TOP OF ASPHALT



5639 JEFFERSON STREET N.E. • ALBUQUERQUE, NEW MEXICO 87109  
PHONE (505) 344-4080 • FAX (505) 343-8759

REV.	SHEETS	CITY ENGINEER	DATE	USER DEPARTMENT	DATE	USER DEPARTMENT	DATE
ENGINEER'S STAMP & SIGNATURE		APPROVALS	ENGINEER	DATE	*****		
		DRC Chairman	<i>Silvia J. Subhan</i>	7-1-97	APPROVED FOR CONSTRUCTION <i>Robert [Signature]</i> 2/12/98 City Engineer Date		
		Transportation	<i>R.W. Lane</i>	7-1-97			
		Water/Wastewater	<i>N/A [Signature]</i>	7/1/97			
		Hydrology	<i>N/A [Signature]</i>	7/1/97			
		C.I.P.	<i>[Signature]</i>				
		Constr. Mngmt.	<i>[Signature]</i>	1/26/98			
		City Project No.	570881		Sheet	1	OF 4

SCANNED BY  
MESA REPRO

JOB NO: F05-286-0086  
FILE: MALOY-WODWG  
REV: 6/16/97 PG

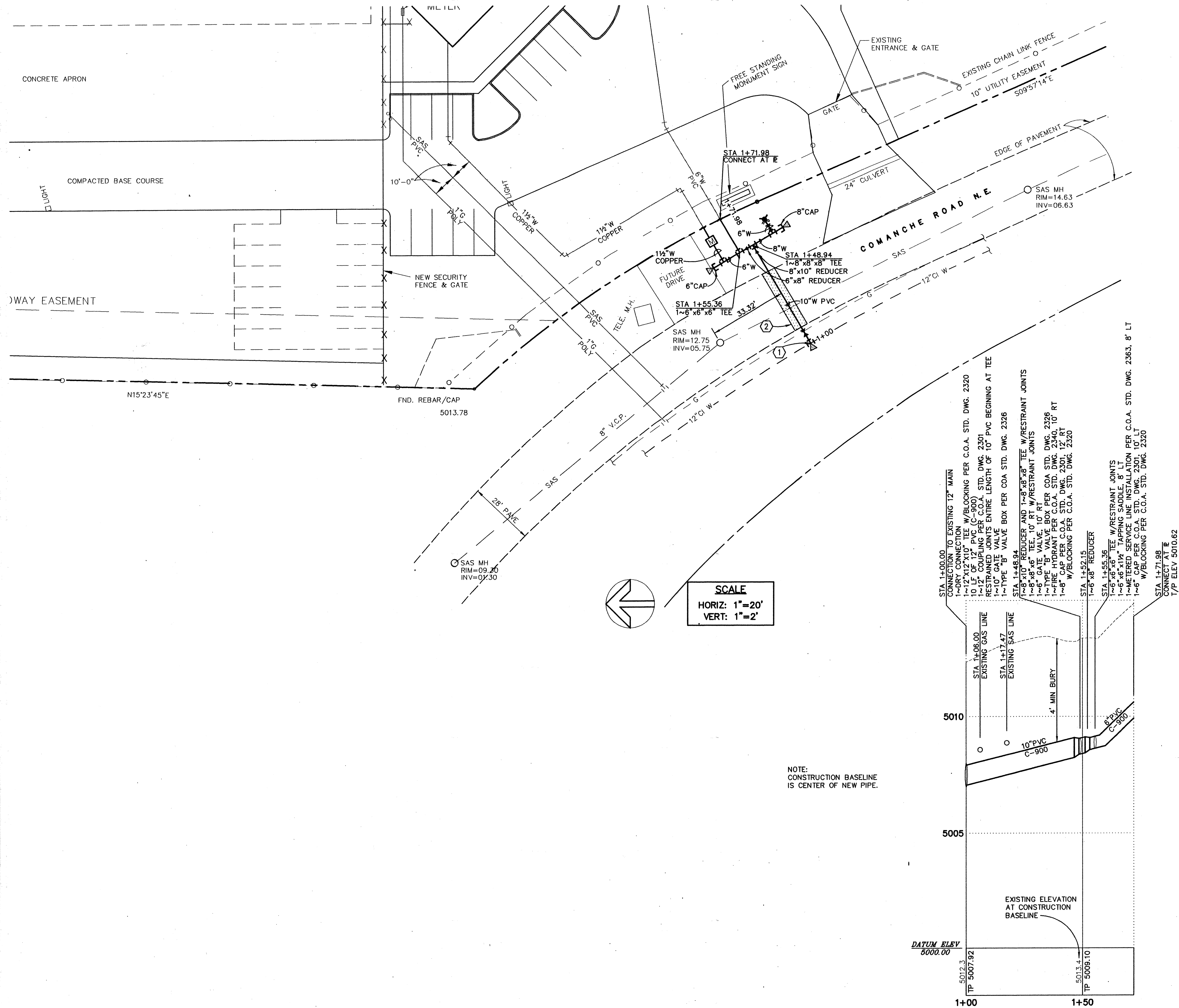

### KEYED NOTES

- COORDINATE NEW FIRE PROTECTION SERVICE CONNECTION WITH C.O.A. PUBLIC WORKS CUSTOMER SERVICE DEPARTMENT.
- REMOVE & REPLACE PAVEMENT PER C.O.A. STD. DWG 2465.

### VALVE SHUT OFF PLAN

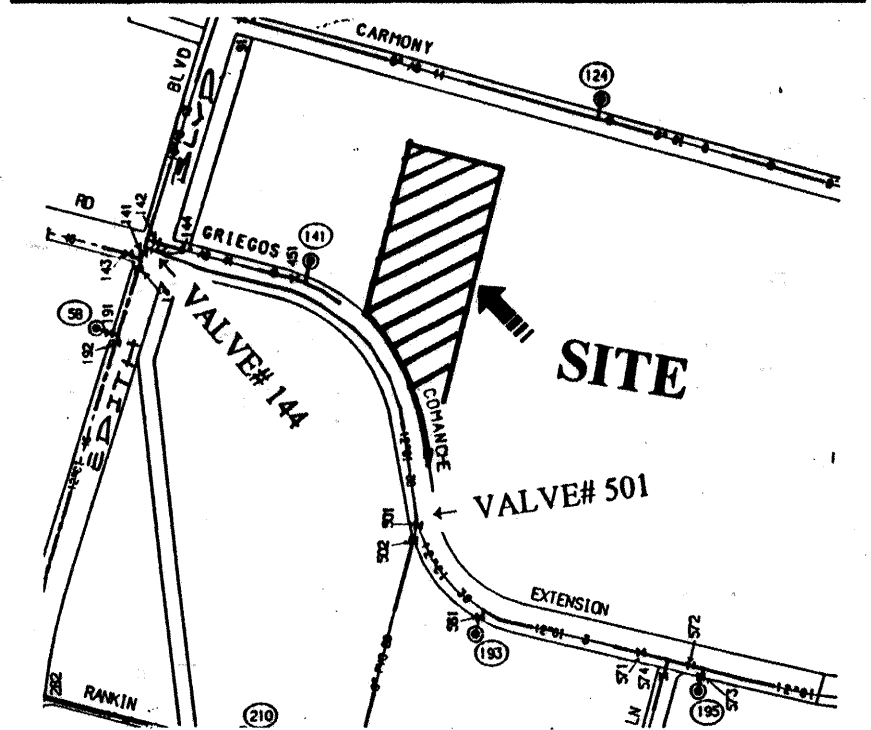

**WATER SHUTOFF REQUIREMENTS:**  
THE CONTRACTOR SHALL BE RESPONSIBLE FOR TIMING AND COORDINATION OF WATER SHUTOFF. AT LEAST FIVE (5) WORKING DAYS PRIOR TO CONSTRUCTION, CONTRACTOR SHALL CONTACT THE WATER SYSTEMS DIVISION, 857-8200, TO INITIATE IMPLEMENTATION OF THE NON-PRESSURIZED CONNECTION PLAN. IN ORDER TO COMPLETE THIS CONNECTION, THE FOLLOWING VALVES MUST BE CLOSED BY WATER SYSTEMS PERSONNEL:  
VALVES TO CLOSE: 144 AND 501



CITY OF ALBUQUERQUE  
PUBLIC WORKS DEPARTMENT  
ENGINEERING DEVELOPMENT GROUP

TITLE: MALOY MOBILE STORAGE  
FIRE LINE AND SERVICE LINE INSTALLATION

Design Review Committee	City Engineer Approval	Mo./Day/Yr.	Mo./Day/Yr.
APPROVED			
City Project No.	Zone Map No.	Sheet	Of

City Project No. 570881 Zone Map No. G-15 Sheet 2 Of 4

AS BUILT INFORMATION		BENCH MARKS		SURVEY INFORMATION		ENGINEER'S SEAL		REVISIONS		DESIGN	
CONTRACTOR	TLC Plumbing	BASE OF ELEVATION	ACS STA. 6-G15: ELEV.=4975.80	NO.	BY	DATE	NO.	DATE	BY	DATE	DATE
STARTED BY	Ally Surry	DATE	12/96	CONSERVE SURVEYING	CO. P.O. BOX 9, SAN	12/96	JOE P. KELLEY	6/23/97	DESIGNED BY	B. POKER	MAY 19, 1997
ACCEPTANCE BY	City Engineer	DATE	6/16/97	FIDEL, NEW MEXICO	87049, (505)552-9898	6/16/97	REVISIONS	DESIGN	DRAWN BY	C. PATTERSON	MAY 19, 1997
FIELD	DATE	DATE	DATE	RECORD	DATE	DATE	NO.	DATE	CHECKED BY	J. KELLEY	MAY 19, 1997
DRAWINGS	DATE	DATE	DATE	NO.	BY	DATE	NO.	DATE	NO.	DATE	DATE
CORRECTED BY	DATE	DATE	DATE	NO.	BY	DATE	NO.	DATE	NO.	DATE	DATE
MICRO-FILM INFORMATION	DATE	DATE	DATE	NO.	BY	DATE	NO.	DATE	NO.	DATE	DATE
RECORDED BY	DATE	DATE	DATE	NO.	BY	DATE	NO.	DATE	NO.	DATE	DATE



## CONSTRUCTION TRAFFIC CONTROL GENERAL NOTES

1. CONTRACTOR MUST OBTAIN FROM CONSTRUCTION COORDINATION AN EXCAVATION/BARRICADING PERMIT BEFORE ENGAGING IN ANY CONSTRUCTION, MAINTENANCE OR REPAIR WORK IN ANY OF THE CITY OF ALBUQUERQUE'S RIGHTS-OF-WAY. EMERGENCY WORK THAT WOULD PRESERVE LIFE OR PROPERTY IS EXCLUDED WITH THE UNDERSTANDING, THAT A PERMIT SHALL BE OBTAINED WITHIN 24 TO 48 HOURS.

2. CONTRACTOR SHALL AT THE TIME OF PERMIT REQUEST, SUBMIT FOR APPROVAL BY CONSTRUCTION COORDINATION, A TRAFFIC CONTROL PLAN DETAILING ALL EXISTING TOPOGRAPHY SUCH AS LANE WIDTHS, DRIVEWAYS, AND BUSINESS/RESIDENTIAL ACCESSES. THE TRAFFIC CONTROL PLAN SHALL INCLUDE ALL PHASES OF WORK AND SCHEDULES INVOLVED IN THE CONSTRUCTION PROJECT. ANY SEPARATE PHASES OF A CONSTRUCTION PROJECT SHALL BE GIVEN AN INDIVIDUAL PERMIT EACH. BLANKET PERMITS WILL NOT BE ISSUED.

3. THESE TYPICAL TRAFFIC CONTROL PLANS DO NOT REFLECT THE EXISTING TOPOGRAPHY SUCH AS DRIVEWAYS, LANE WIDTHS, AND BUSINESS/RESIDENTIAL ACCESSES. EVERY LOCATION THAT REQUIRES CONSTRUCTION TRAFFIC CONTROL SHALL HAVE A DETAILED TRAFFIC CONTROL PLAN SHOWING ALL EXISTING TOPOGRAPHY.

4. CONSTRUCTION SHALL NOT BEGIN UNLESS A TRAFFIC CONTROL PLAN HAS BEEN APPROVED AND VERIFIED BY CONSTRUCTION COORDINATION.

5. CONSTRUCTION COORDINATION SHALL BE NOTIFIED 48 HOURS PRIOR TO ANY TRAFFIC CONTROL CHANGES NEEDED BY CONTRACTOR, THAT WERE NOT PREVIOUSLY APPROVED. THESE TRAFFIC CONTROL CHANGES SHALL BE REQUESTED IN WRITING ACCOMPANIED WITH A TRAFFIC CONTROL PLAN REFLECTING SUCH CHANGES.

6. ALL CONSTRUCTION TRAFFIC CONTROL DEVICES SHALL COMPLY TO THE MANUAL ON UNIFORM TRAFFIC CONTROL DEVICES (MUTCD), LATEST EDITION. IT IS THE RESPONSIBILITY OF THE CONTRACTOR TO INSTALL, SERVICE AND MAINTAIN ALL TRAFFIC CONTROL DEVICES. TRAFFIC CONTROL DEVICES SHALL NOT BE REMOVED OR ALTERED IN ANY WAY WITHOUT THE APPROVAL OF CONSTRUCTION COORDINATION, PER SECTION 6A-4 OF THE MUTCD, LATEST EDITION.

7. THE CONSTRUCTION TRAFFIC CONTROL INITIAL SET-UP SHALL BE BY AN AMERICAN TRAFFIC SAFETY SERVICES ASSOCIATION (ATSSA) CERTIFIED WORKSITE TRAFFIC SUPERVISOR. THE MAINTENANCE AND SERVICING SHALL ALSO BE DONE BY AN ATSSA CERTIFIED WORKSITE TRAFFIC SUPERVISOR OR EQUIVALENT.

8. CONTRACTOR IS RESPONSIBLE TO MAINTAIN AND SERVICE ALL TRAFFIC CONTROL DEVICES 24 HOURS A DAY, 7 DAYS A WEEK THROUGHOUT LENGTH OF PROJECT. CONTRACTOR IS RESPONSIBLE THAT ALL TRAFFIC CONTROL DEVICES COMPLY WITH THE MUTCD, LATEST EDITION.

9. ALL ADVANCE WARNING SIGNS SHALL BE DOUBLE INDICATED WHENEVER THERE ARE MULTI-LANE TRAFFIC IN ANY ONE GIVEN DIRECTION AND THERE IS SUFFICIENT MEDIAN SPACE.

10. ALL BARRICADES IN ALL TAPERS AND TANGENTS SHALL BE PLACED APART, A DISTANCE MEASURED IN FEET, EQUAL TO THAT OF THE POSTED SPEED LIMIT. NO EXCEPTIONS UNLESS APPROVED BY CONSTRUCTION COORDINATION PER MUTCD SECTION 6A-4.

11. CONTRACTOR SHALL NOT BEGIN WORK BEFORE 7:00 A.M. OR END WORK AFTER 7:00 P.M. WITHOUT THE APPROVAL OF CONSTRUCTION COORDINATION.

12. CONTRACTOR IS RESPONSIBLE TO PROVIDE CONSTRUCTION COORDINATION, A WEEKLY LOG OF DAILY INSPECTIONS OF BARRICADE AND MAINTENANCE SCHEDULES ON PROJECTS THAT ARE OVER ONE WEEK DURATION.

13. EQUIPMENT OR MATERIALS SHALL NOT BE STORED WITHIN 15 FEET OF A TRAVELLED TRAFFIC LANE DURING NON-WORKING HOURS WITHOUT THE APPROVAL OF CONSTRUCTION COORDINATION.

14. CONTRACTOR SHALL PROVIDE AND MAINTAIN A SAFE AND ADEQUATE MEANS OF CHANNELIZING PEDESTRIAN TRAFFIC AROUND AND THROUGH THE CONSTRUCTION AREA.

15. CONTRACTOR IS RESPONSIBLE FOR OBLITERATION OF ANY CONFLICTING STRIPING AND RESPONSIBLE FOR ALL TEMPORARY STRIPING.

16. CONTRACTOR SHALL MAINTAIN ACCESS TO ALL FACILITIES, BUSINESSES AND/OR RESIDENTS AT ALL TIMES.

17. CONTRACTOR SHALL PROVIDE ACCESS SIGNS FOR BUSINESSES LOCATED WITHIN THE CONSTRUCTION AREA UNDER THE SUPERVISION OF CONSTRUCTION COORDINATION. EACH ACCESS SIGN SHALL HAVE 5 INCH, WHITE OPAQUE LETTERING ON BLUE REFLECTORIZED BACKGROUND. ACCESS SIGNS SHALL BE CONSIDERED INCIDENTAL TO THE BID AND NOT PART OF THE CONTRACT UNLESS OTHERWISE STATED. NO MORE THAN 3 BUSINESSES SHALL BE LISTED ON A ACCESS SIGN. SHOPPING CENTERS AND MALLS SHALL BE LISTED AS SUCH.

18. ALL ADVANCE WARNING SIGNS SHALL MEET THE MINIMUM REFLECTIVE INTENSITY REQUIREMENTS SET FORTH BY THE CITY OF ALBUQUERQUE. CONSTRUCTION COORDINATION SHALL DETERMINE ALL REQUIREMENTS AND APPROVE OR DISAPPROVE ANY ADVANCE WARNING SIGN PER SECTION 6A-4 OF THE MUTCD, LATEST EDITION.

19. 24 HOURS PRIOR TO OCCUPYING OR CLOSING OF A RIGHT-OF-WAY, CONTRACTOR SHALL NOTIFY: POLICE, FIRE DEPARTMENT, SCHOOLS, HOSPITALS, TRANSIT AUTHORITY, BUSINESSES AND/OR RESIDENTS THAT WILL BE AFFECTED BY THE CONSTRUCTION.

20. ANY FIELD ADJUSTMENTS SHALL BE APPROVED BY CONSTRUCTION COORDINATION.

21. EXCAVATIONS SHALL BE PLATED, TEMPORARILY PATCHED OR RESURFACED PRIOR TO OPENING OF TRAFFIC. A MINIMUM OF 11 FEET SHALL BE PROVIDED FOR TRAFFIC IN ANY GIVEN DIRECTION. CONTRACTOR IS RESPONSIBLE FOR ANY WORK INVOLVED IN SATISFYING THESE REQUIREMENTS.

22. CONTRACTOR SHALL AT ALL TIMES COMPLY WITH THE FOLLOWING:  
1. STANDARDS AND REQUIREMENTS SET FORTH IN THE MANUAL ON UNIFORM TRAFFIC CONTROL DEVICES, LATEST EDITION.  
2. THE CITY OF ALBUQUERQUE TRAFFIC CODE, LATEST EDITION.  
3. SECTION 19 OF THE CITY OF ALBUQUERQUE'S STANDARD SPECIFICATIONS FOR PUBLIC WORK CONSTRUCTION, AS WELL AS OTHER SECTIONS.

23. FAILURE TO COMPLY WITH ANY OF THE ABOVE MENTIONED, WILL BE ADEQUATE CAUSE TO CEASE ALL WORK ON ANY CONSTRUCTION PROJECT. WORK WILL NOT RESUME UNTIL ALL REQUIREMENTS ARE ADDRESSED AND APPROVED BY CONSTRUCTION COORDINATION.

24. ALL TRAFFIC CONTROL DEVICES SHALL BE KEPT IN NEW-CLEAN CONDITION. WASHING OF EQUIPMENT IS INCIDENTAL TO IT'S PLACEMENT AND MAINTENANCE.

25. TRAFFIC CONTROL STANDARDS APPLY ONLY WHERE THE CONSTRUCTION TRAFFIC CONTROL PLANS ARE NOT SPECIFIC.

26. ADVANCE WARNING SIGNS SHALL BE 36"x36" WITH SUPER ENGINEERING GRADE SHEETING OR BETTER.

### BERNALILLO COUNTY TRAFFIC CONTROL GENERAL NOTES

1. SUBJECT TO THE APPROVED TRAFFIC CONTROL PLAN, AT LEAST ONE LANE SHALL BE OPEN TO TRAFFIC AT ALL TIMES. CONTRACTOR SHALL PROVIDE PROPER SIGNAGE AND FLAGMEN AND SHALL MAINTAIN THE TRAFFIC LANES IN SUCH A MANNER AS TO ASSURE PROPER SAFETY TO THE TRAVELLING PUBLIC ON ALL AFFECTED ROADS. THE CONTRACTOR SHALL PROVIDE ACCESS TO PRIVATE AND PUBLIC PROPERTY AT ALL TIMES, EXCEPT WHEN GRADING, PAVING, EXCAVATION AND BACKFILL OPERATIONS ARE BEING CONDUCTED IMMEDIATELY IN FRONT OF THE PROPERTY, IN WHICH CASE ACCESS WILL NOT BE DENIED FOR MORE THAN 4 HOURS WITHOUT APPROVAL BY THE COUNTY.

2. TRAFFIC LANES PROVIDED DURING CONSTRUCTION SHALL BE MAINTAINED, IN SUCH A CONDITION UNDER ALL WEATHER CONDITIONS, SO AS TO PERMIT THE REASONABLE PASSAGE OF PASSENGER VEHICLES, AND SHALL BE KEPT GRADED AND SMOOTH, AND WATERED SEVERAL TIMES DAILY TO CONTROL DUST.

3. A DAILY TRAFFIC CONTROL LOG SHALL BE MAINTAINED BY THE CONTRACTOR REFLECTING THE TYPES AND LOCATIONS OF ALL TRAFFIC CONTROL DEVICES, SIGNS, BARRICADES, ETC. BEING USED ON THE PROJECT IN COMPLIANCE WITH THE APPROVED TRAFFIC CONTROL PLAN. THIS LOG SHALL BE SUBMITTED TO THE BERNALILLO COUNTY TRAFFIC CONTROL MANAGER UPON COMPLETION OF THE PROJECT CONSTRUCTION OR WHEN SO REQUESTED BY THE PROJECT OR THE BERNALILLO COUNTY TRAFFIC CONTROL MANAGER.

4. ALL NEW STREET PAVING ABUTTING EXISTING AREAS SHALL MATCH THE ELEVATIONS OF THOSE AREAS.

5. CONTRACTOR SHALL PROVIDE A WEEKLY CONSTRUCTION ACTIVITY SCHEDULE TO BERNALILLO COUNTY PUBLIC WORKS, DEPARTMENT, ATTN: HOSS FOSTER.

6. PROJECT IS SUBJECT TO THE REQUIREMENTS OF COUNTY ORDINANCE NO. 95-12 AND ORDINANCE NO. 83-28. THE CONTRACTOR IS RESPONSIBLE FOR ACQUIRING ALL PERMITS NECESSARY. CONTRACTOR SHALL CALL 848-1500 FOR MORE INFORMATION.

7. PRIOR TO CONSTRUCTION, THE CONTRACTOR SHALL CONTACT THE MIDDLE RIO GRANDE CONSERVANCY DISTRICT (MRGCD) AT 247-0234 TO PROVIDE NOTICE OF THE SCHEDULE FOR CONSTRUCTION AT THE MRGCD FACILITIES. ALL WORK TO BE PERFORMED IN THE MRGCD RIGHT-OF-WAY SHALL BE CLOSELY COORDINATED WITH MRGCD.

8. THE CONTRACTOR SHALL SUBMIT A TRAFFIC CONTROL PLAN TO THE COUNTY TRAFFIC CONTROL MANAGER AND TO THE NEW MEXICO STATE HIGHWAY AND TRANSPORTATION DEPARTMENT AT LEAST 48 HOURS PRIOR TO COMMENCEMENT OF WORK. TRAFFIC CONTROL PLANS SHALL BE PREPARED IN ACCORDANCE WITH MUTCD REQUIREMENTS AND BY CERTIFIED PERSONNEL AND MUST BE APPROVED PRIOR TO COMMENCEMENT OF WORK ON THE PROJECT. CALL 848-1504 FOR FURTHER INFORMATION.

9. THE CONTRACTOR SHALL FILE WEEKLY WRITTEN REPORT TO THE TRAFFIC CONTROL MANAGER DESCRIBING THE TRAFFIC CONTROL PLAN THAT WILL BE IN EFFECT FOR THE FOLLOWING WEEK.

### SIGN FACE DETAILS

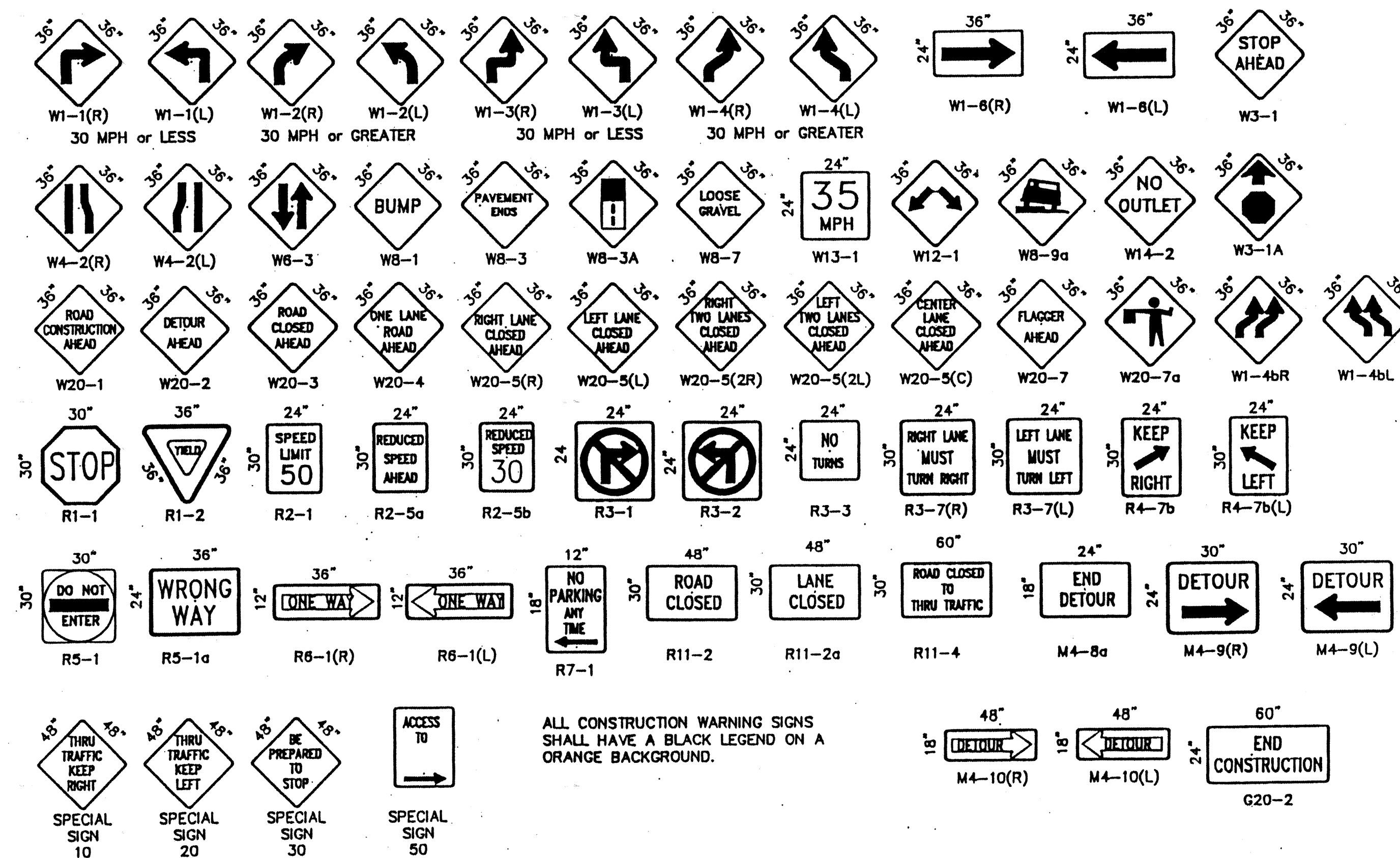

ALL CONSTRUCTION WARNING SIGNS SHALL HAVE A BLACK LEGEND ON A ORANGE BACKGROUND.

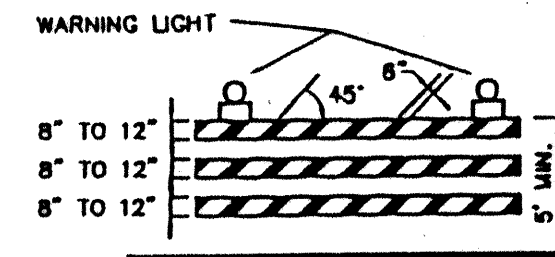

TYPE III BARRICADE

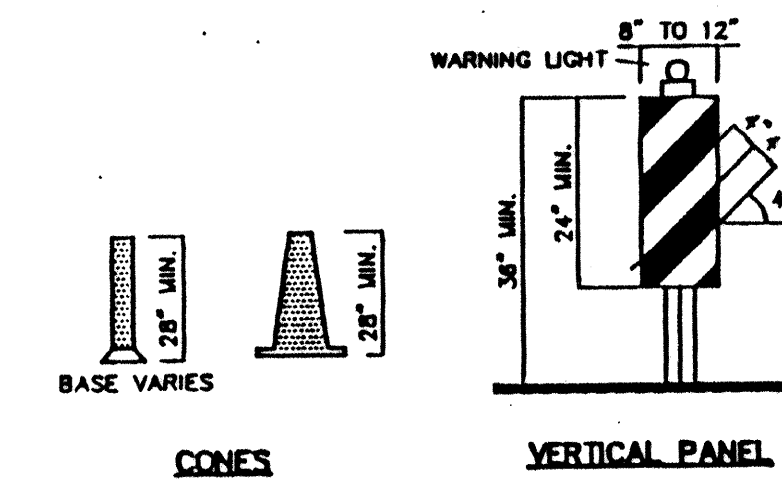

CONES

VERTICAL PANEL

HIGH LEVEL WARNING DEVICE

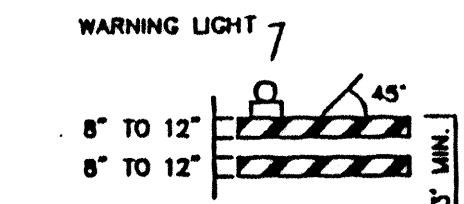

TYPE I BARRICADE COLLAPSIBLE

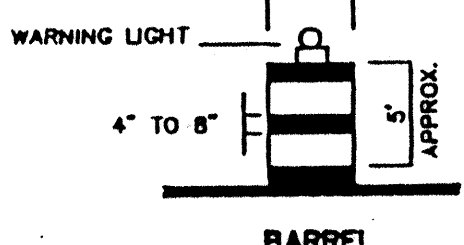

BARREL

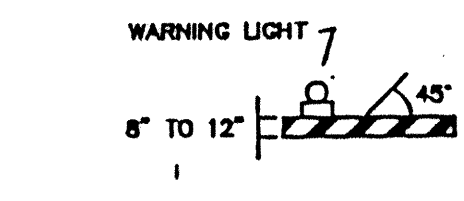

TYPE I BARRICADE COLLAPSIBLE

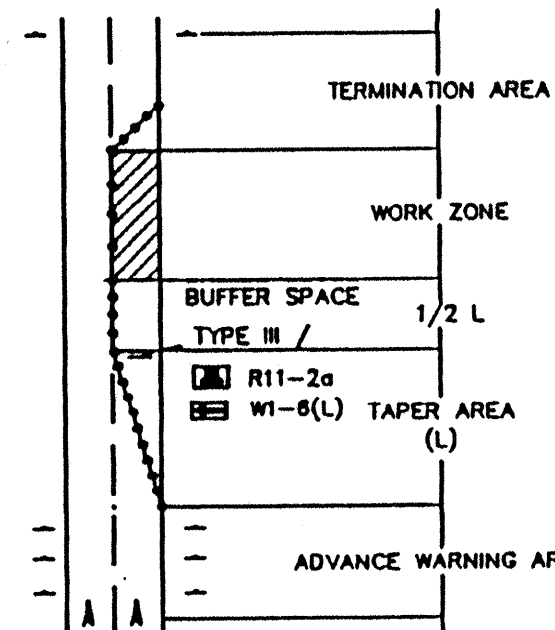

TRAFFIC CONTROL ELEMENTS

### LEGEND

- WORK AREA  
BARRICADE - TYPE I, TYPE II OR BARREL  
BARRICADE - TYPE III  
VERTICAL PANEL  
WARNING SIGN  
DISTANCE BETWEEN SIGNS - A DISTANCE MEASURED IN FEET EQUAL TO A VALUE OF TEN TIMES THE SPEED LIMIT OF THE STREET  
FLAGMAN POSITION  
SPACING BETWEEN BARRICADES - A DISTANCE MEASURED IN FEET EQUAL TO THE SPEED LIMIT OF THE STREET  
TAPER LENGTH - SEE CHART BELOW  
THE TANGENT LENGTH IS EQUAL TO THE TAPER LENGTH FOR A GIVEN STREET.

### TAPER REQUIREMENTS

SPEED LIMIT (MPH)	TAPER LENGTH (L) (FEET)			MINIMUM NUMBER OF DEVICES FOR TAPER	MAXIMUM DEVICE SPACING IN FEET	
	10' LANE	11' LANE	12' LANE		ALONG TAPER	AFTER TAPER
20	70	75	80	5	20	20
25	105	115	125	6	25	25
30	150	165	180	7	30	30
35	205	225	245	8	35	35
40	270	295	320	9	40	40
45	450	495	540	13	45	45
50	500	550	600	13	50	50
55	550	605	660	13	55	55

### RECOMMENDED SIGN SPACING(D) FOR ADVANCE WARNING SIGN SERIES

SPEED LIMIT (MPH)	MINIMUM DISTANCE IN FEET BETWEEN SIGNS	MINIMUM DISTANCE IN FEET FROM LAST SIGN TO TAPER
0-20	10 X SPEED LIMIT	10 X SPEED LIMIT
25-30	10 X SPEED LIMIT	10 X SPEED LIMIT
30-35	10 X SPEED LIMIT	10 X SPEED LIMIT
40-45	10 X SPEED LIMIT	10 X SPEED LIMIT
50-60	10 X SPEED LIMIT	10 X SPEED LIMIT

### TAPER CRITERIA

TYPE OF TAPER	TAPER LENGTH
UPSTREAM TAPER:	
MERGING TAPER	L MINIMUM
SHIFTING TAPER	1/2 L MINIMUM
SHOULDER TAPER	1/2 L MINIMUM
TWO-WAY TRAFFIC TAPER	100 FEET MAXIMUM
DOWNSIDE TAPERS	100 FEET PER LANE

### TAPER LENGTH COMPUTATION

SPEED LIMIT	L = WS <sup>2</sup> / 60
40 MPH OR LESS	L = WS <sup>2</sup> / 60
45 MPH OR GREATER	L = W X S

L = TAPER LENGTH  
W = WIDTH OF OFFSET IN FEET  
S = POSTED SPEED OR OFF-PEAK 85-PERCENTILE SPEED IN MPH

CITY OF ALBUQUERQUE PUBLIC WORKS DEPARTMENT ENGINEERING DEVELOPMENT GROUP			
TITLE: MALOY MOBILE STORAGE PUBLIC INFRASTRUCTURE IMPROVEMENTS SIGNING AND CONSTRUCTION TRAFFIC CONTROL STANDARDS			
DESIGN REVIEW COMMITTEE	CITY ENGINEER APPROVAL	NO. DATE/TH. NO. DATE/TH.	
LAST UPDATE		REVISIONS	
PROJECT NO. 570881		SHEET 3 OF 4	
MAP NO. G-15		DATE	
DRAWN BY C.O.A. STANDARDS		CHECKED BY	



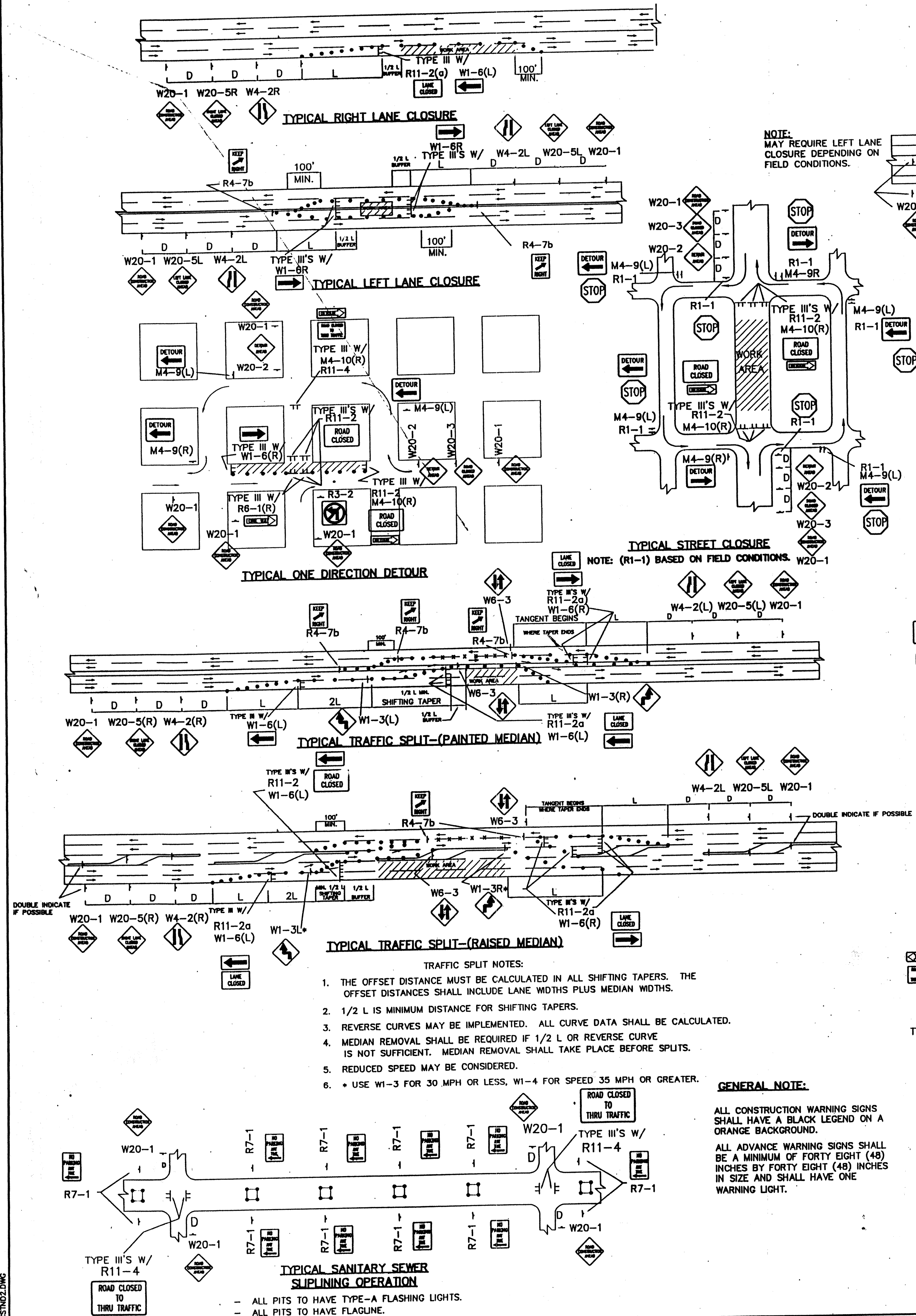

- TRAFFIC SPLIT NOTES:**
1. THE OFFSET DISTANCE MUST BE CALCULATED IN ALL SHIFTING TAPERS. THE OFFSET DISTANCES SHALL INCLUDE LANE WIDTHS PLUS MEDIAN WIDTHS.
  2. 1/2 L IS MINIMUM DISTANCE FOR SHIFTING TAPERS.
  3. REVERSE CURVES MAY BE IMPLEMENTED. ALL CURVE DATA SHALL BE CALCULATED.
  4. MEDIAN REMOVAL SHALL BE REQUIRED IF 1/2 L OR REVERSE CURVE IS NOT SUFFICIENT. MEDIAN REMOVAL SHALL TAKE PLACE BEFORE SPLITS.
  5. REDUCED SPEED MAY BE CONSIDERED.
  6. \* USE W1-3 FOR 30 MPH OR LESS, W1-4 FOR SPEED 35 MPH OR GREATER.

**GENERAL NOTE:**

ALL CONSTRUCTION WARNING SIGNS SHALL HAVE A BLACK LEGEND ON A ORANGE BACKGROUND.

ALL ADVANCE WARNING SIGNS SHALL BE A MINIMUM OF FORTY EIGHT (48) INCHES BY FORTY EIGHT (48) INCHES IN SIZE AND SHALL HAVE ONE WARNING LIGHT.

**AS BUILT INFORMATION**

CONTRACTOR	DATE	CONTRACTOR	DATE	CONTRACTOR	DATE

**BENCH MARKS**

CONTRACTOR	DATE	CONTRACTOR	DATE	CONTRACTOR	DATE

**SURVEY INFORMATION**

FIELD NOTES	DATE	NO.	BY

**ENGINEER'S SEAL**

RECEIVED  
CITY OF ALBUQUERQUE  
PUBLIC WORKS DEPARTMENT  
ENGINEERING DEVELOPMENT GROUP

**REVISIONS**

NO.	DATE	REVISIONS	BY

**DESIGNED BY** C.O.A. STANDARDS **DATE** **CHECKED BY** **DATE**

**CITY OF ALBUQUERQUE  
PUBLIC WORKS DEPARTMENT  
ENGINEERING DEVELOPMENT GROUP**

**TITLE: MALOY MOBILE STORAGE PUBLIC INFRASTRUCTURE IMPROVEMENTS  
TYPICAL TRAFFIC CONTROL & SIGNING EXAMPLES (REF. MUT.C.D.)**

DESIGN REVIEW COMMITTEE	CITY ENGINEER APPROVAL	LAST UPDATE	MO./DAY/YR.	NO./DAY/YR.

**PROJECT NO.** 570881 **MAP NO.** G-15 **SHEET** 4 **OF** 4