

• L E G E N D •

MATERIALS

CONCRETE  
RIP-RAP

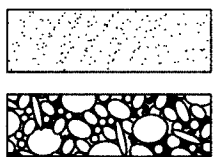

LINES

SUBDIVISION BOUNDARY  
PROPERTY LINE (PLAN)  
PROPERTY LINE (SECTION)  
CENTERLINE  
EASEMENT LINE  
MATCH LINE  
SECTION CUT LINE

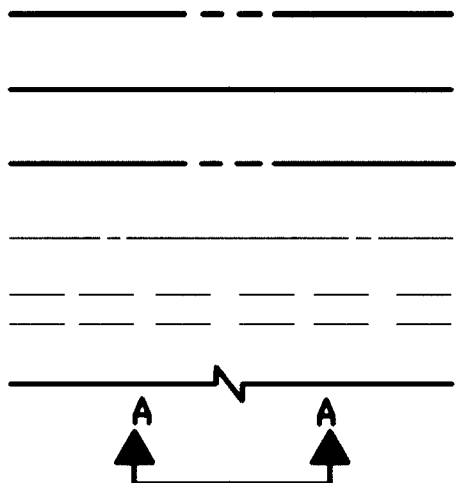

EARTHWORK

CONTOUR LINE  
SPOT ELEVATION  
PROJECT / PHASE BOUNDARY  
FLOWLINE  
DIRECTION OF FLOW

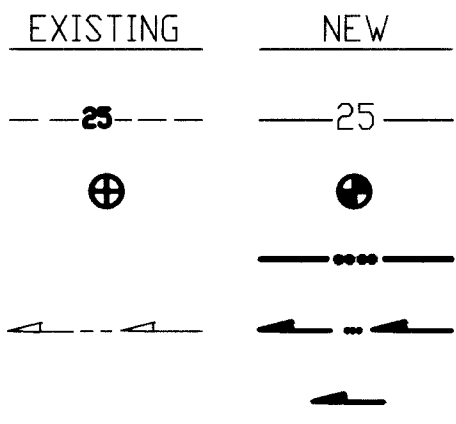

MISCELLANEOUS UTILITIES

GAS LINE  
UNDERGROUND TELEPHONE  
UNDERGROUND ELECTRICAL  
STORM DRAIN  
STORM DRAIN MANHOLE  
STORM DRAIN INLET

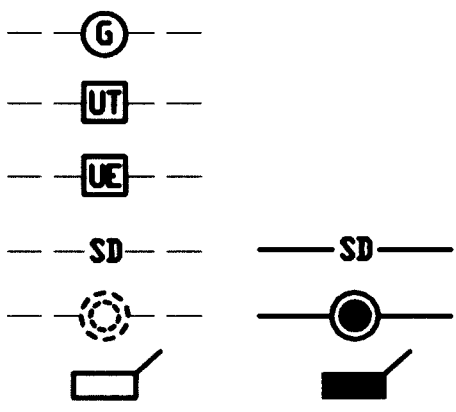

SANITARY SEWER

SANITARY SEWER LINE  
SANITARY SEWER MANHOLE  
SAS SERVICE CONNECTIONS  
SAS CAP OR PLUG  
ENCASEMENT

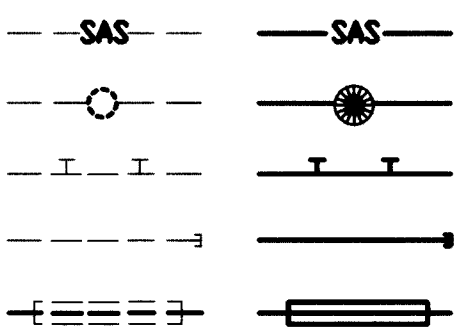

WATER

WATER LINE  
WATER SERVICE CONNECTIONS  
GATE VALVE  
FIRE HYDRANT  
BUTTERFLY VALVE  
REDUCER  
WATER PRESSURE ZONE BOUNDARY

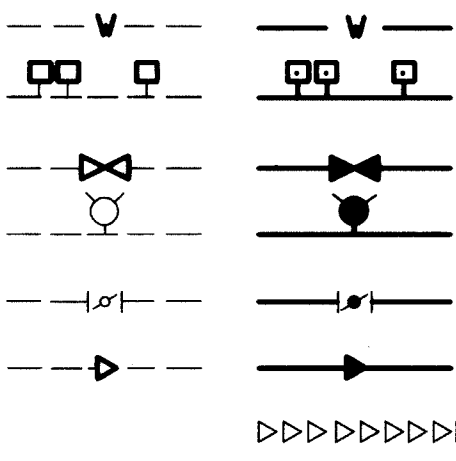

WATER FITTINGS

CAPS AND PLUGS  
ELBOW  
CROSS  
TEE

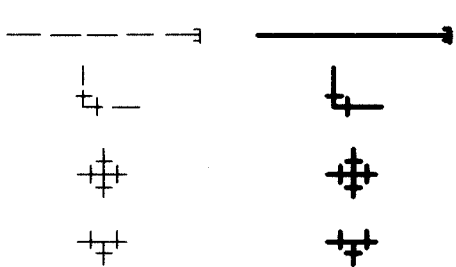

MISCELLANEOUS

CHAINLINK FENCE  
FIELD FENCE  
COMMON YARD WALL  
RETAINING WALL  
POWER OR TELEPHONE POLE

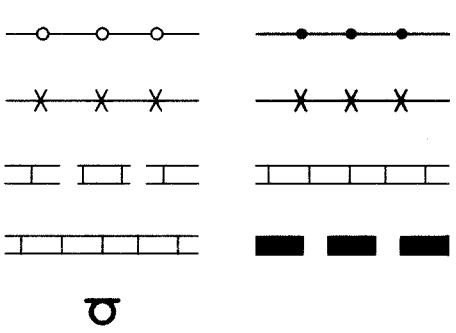

CONSTRUCTION PLANS  
for  
CARDINAL HEALTH  
PRIVATE FIRELINES  
ALBUQUERQUE, NEW MEXICO  
OCTOBER, 1997

INDEX OF DRAWINGS

SHEET	DESCRIPTION
1	COVER SHEET, VICINITY MAP, GENERAL NOTES, LEGEND AND INDEX OF DRAWINGS
2	GRADING PLAN
3	SITE PLAN
4	PRIVATE FIRELINES, PLAN & PROFILE
5	SIGNING AND CONSTRUCTION TRAFFIC CONTROL STANDARDS
6	TYPICAL TRAFFIC CONTROL AND SIGNING EXAMPLES (REF. M.U.T.C.D.)

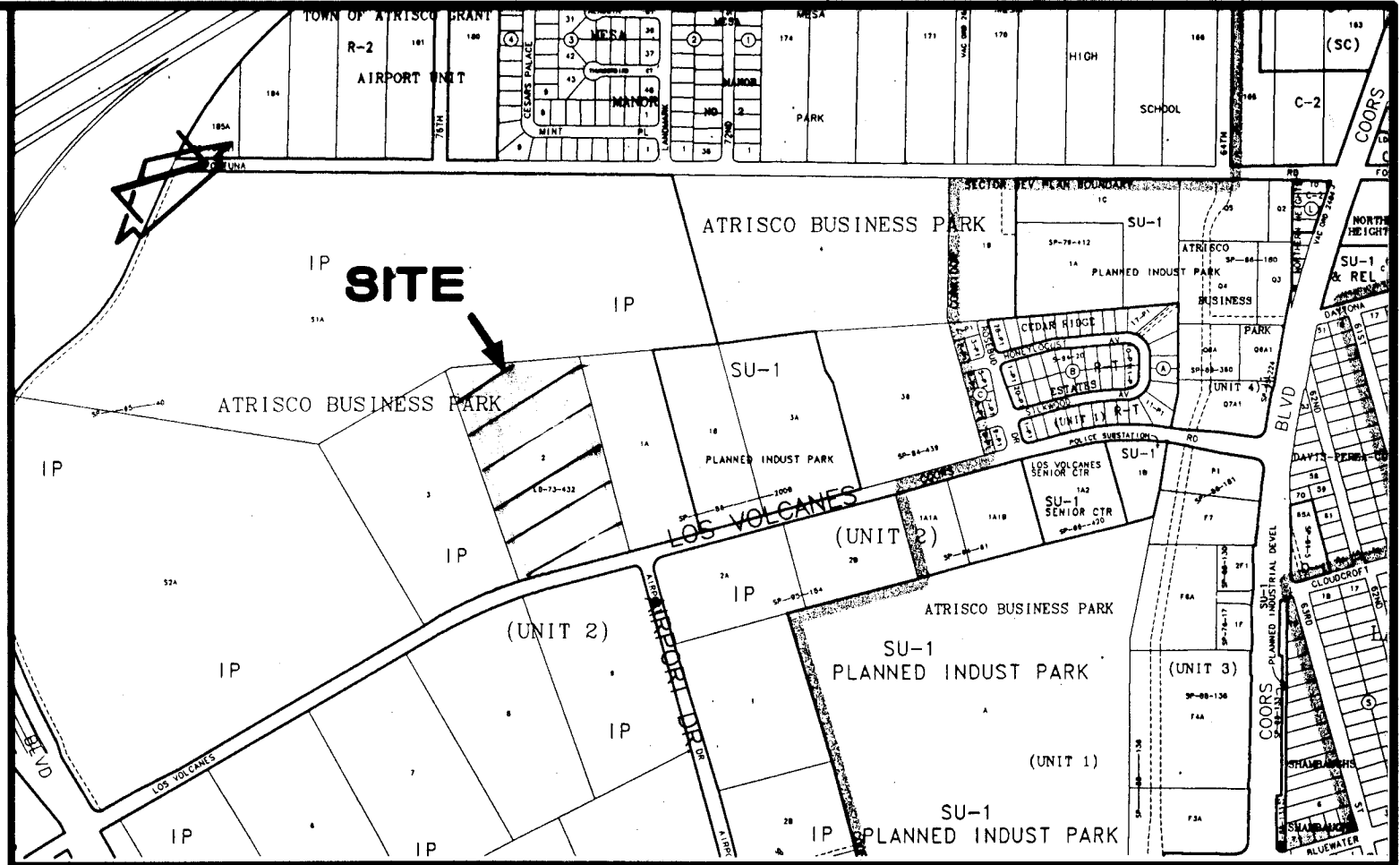

VICINITY MAP  
SCALE: 1" = 750'

J-10

GENERAL NOTES:

- ALL WORK DETAILED ON THESE PLANS TO BE PERFORMED UNDER CONTRACT SHALL, EXCEPT AS OTHERWISE STATED OR PROVIDED FOR HEREON, BE CONSTRUCTED IN ACCORDANCE WITH THE CITY OF ALBUQUERQUE STANDARD SPECIFICATIONS—PUBLIC WORKS CONSTRUCTION—1986 — UPDATE NO. 6.
- TWO (2) WORKING DAYS PRIOR TO ANY EXCAVATION, CONTRACTOR MUST CONTACT NEW MEXICO ONE CALL SYSTEM, 260-1990, (ALBUQUERQUE AREA), 1-800-321-ALERT (2537) (STATEWIDE) FOR LOCATION OF EXISTING UTILITIES.
- IF ANY UTILITY LINES, PIPELINES, OR UNDERGROUND UTILITY LINES ARE SHOWN ON THESE DRAWINGS, THEY ARE SHOWN IN AN APPROXIMATE MANNER ONLY, AND SUCH LINES MAY EXIST WHERE NONE ARE SHOWN. IF ANY SUCH EXISTING LINES ARE SHOWN, THE LOCATION IS BASED UPON INFORMATION PROVIDED BY THE OWNER OF SAID UTILITY, AND THE INFORMATION MAY BE INCOMPLETE, OR MAY BE OBSOLETE BY THE TIME CONSTRUCTION COMMENCES. THE ENGINEER HAS CONDUCTED ONLY PRELIMINARY INVESTIGATION OF THE LOCATION, DEPTH, SIZE, OR TYPE OF EXISTING UTILITY LINES, PIPELINES, OR UNDERGROUND UTILITY LINES. THIS INVESTIGATION IS NOT CONCLUSIVE, AND MAY NOT BE COMPLETE, THEREFORE, MAKES NO REPRESENTATION PERTAINING THERETO, AND ASSUMES NO RESPONSIBILITY OR LIABILITY THEREFOR. THE CONTRACTOR SHALL INFORM ITSELF OF THE LOCATION OF ANY UTILITY LINE, PIPELINE, OR UNDERGROUND UTILITY LINE IN OR NEAR THE AREA OF THE WORK IN ADVANCE OF AND DURING EXCAVATION WORK. THE CONTRACTOR IS FULLY RESPONSIBLE FOR ANY AND ALL DAMAGE CAUSED BY ITS FAILURE TO LOCATE, IDENTIFY AND PRESERVE ANY AND ALL EXISTING UTILITIES, PIPELINES, AND UNDERGROUND UTILITY LINES. IN PLANNING AND CONDUCTING EXCAVATION, THE CONTRACTOR SHALL COMPLY WITH STATE STATUTES, MUNICIPAL AND LOCAL ORDINANCES, RULES AND REGULATIONS, IF ANY, PERTAINING TO THE LOCATION OF THESE LINES AND FACILITIES.
- SHOULD A CONFLICT EXIST BETWEEN THESE PLANS AND ACTUAL FIELD CONDITIONS, THE CONTRACTOR SHALL PROMPTLY NOTIFY THE ENGINEER IN WRITING SO THAT THE CONFLICT CAN BE RESOLVED WITH A MINIMUM AMOUNT OF DELAY FOR ALL PARTIES.
- THE CONTRACTOR SHALL MAINTAIN ACCESS TO ADJACENT PROPERTIES DURING CONSTRUCTION.
- ALL WORK ON THIS PROJECT SHALL BE PERFORMED IN ACCORDANCE WITH APPLICABLE FEDERAL, STATE AND LOCAL LAWS, RULES AND REGULATIONS CONCERNING SAFETY AND HEALTH.
- ALL UTILITIES AND UTILITY SERVICE LINES SHALL BE INSTALLED PRIOR TO PAVING.
- BACKFILL COMPACTION SHALL BE ACCORDING TO SPECIFIED STREET USE.
- TACK COAT REQUIREMENTS SHALL BE DETERMINED DURING CONSTRUCTION BY THE PROJECT ENGINEER.
- SIDEWALKS AND WHEELCHAIR RAMPS WITHIN THE CURB RETURNS SHALL BE CONSTRUCTED WHEREVER A NEW CURB RETURN IS CONSTRUCTED.
- IF CURB IS DEPRESSED FOR A DRIVEPAD OR A HANDICAP RAMP, THE DRIVEPAD OR RAMP SHALL BE CONSTRUCTED PRIOR TO ACCEPTANCE OF THE CURB AND GUTTER.
- ALL STORM DRAINAGE FACILITIES SHALL BE COMPLETED PRIOR TO FINAL ACCEPTANCE.
- CONTRACTOR SHALL COORDINATE WITH THE WATER SYSTEM DIVISION FOR THE EXECUTION OF THE VALVE SHUT OFF PLAN, NOT LESS THAN FIVE (5) WORKING DAYS IN ADVANCE OF ANY WORK THAT MAY AFFECT THE EXISTING PUBLIC WATER UTILITIES. ONLY WATER SYSTEM DIVISION PERSONNEL SHALL OPERATE EXISTING VALVES. REFER TO SECTION 18 OF THE SPECIFICATION. THE WATER SYSTEM DIVISION PHONE NUMBER IS 857-8200.
- CONTRACTOR SHALL NOTIFY THE CITY SURVEYOR NOT LESS THAN SEVEN (7) DAYS PRIOR TO STARTING WORK IN ORDER THAT THE CITY SURVEYOR MAY TAKE NECESSARY MEASURES TO INSURE THE PRESERVATION OF SURVEY MONUMENTS. CONTRACTOR SHALL NOT DISTURB PERMANENT SURVEY MONUMENTS WITHOUT THE CONSENT OF THE CITY SURVEYOR AND SHALL NOTIFY THE CITY SURVEYOR AND BEAR THE EXPENSE OF REPLACING ANY THAT MAY BE DISTURBED WITHOUT PERMISSION. REPLACEMENT SHALL BE DONE ONLY BY THE CITY SURVEYOR. WHEN A CHANGE IS MADE IN THE FINISHED ELEVATION OF THE PAVEMENT OF ANY ROADWAY IN WHICH A PERMANENT SURVEY MONUMENT IS LOCATED, CONTRACTOR SHALL, AT HIS OWN EXPENSE, ADJUST THE MONUMENT COVER TO THE NEW GRADE UNLESS OTHERWISE SPECIFIED. REFER TO SECTION 4.4 OF THE SPECIFICATIONS.
- FIVE (5) WORKING DAYS PRIOR TO BEGINNING CONSTRUCTION THE CONTRACTOR SHALL SUBMIT TO THE CONSTRUCTION COORDINATION DIVISION A DETAILED CONSTRUCTION SCHEDULE. TWO (2) WORKING DAYS PRIOR TO CONSTRUCTION THE CONTRACTOR SHALL OBTAIN A BARRICADE PERMIT FROM THE CONSTRUCTION COORDINATION DIVISION. CONTRACTOR SHALL NOTIFY BARRICADE ENGINEER (768-2551) PRIOR TO OCCUPYING AN INTERSECTION. CONTRACTOR MUST REFER TO SECTION 19 OF THE STANDARD SPECIFICATION FOR TRAFFIC CONTROL.
- ALL STREET STRIPING ALTERED OR DESTROYED SHALL BE REPLACED WITH PLASTIC REFLECTORIZED STRIPING BY CONTRACTOR TO EXISTING LOCATION OR AS INDICATED BY THIS PLAN SET.
- CAUTION: THESE DRAWINGS DO NOT INCLUDE NECESSARY COMPONENTS FOR CONSTRUCTION SAFETY WHICH SHALL REMAIN THE RESPONSIBILITY OF THE CONTRACTOR.
- ALL WORK OCCURRING WITHIN AN ARTERIAL ROADWAY REQUIRES TWENTY-FOUR HOUR CONSTRUCTION.

2 3 4 5 6 7 8 9 10 11 12 13 14 15  
26-5780-81 01197

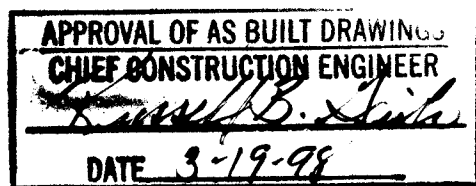
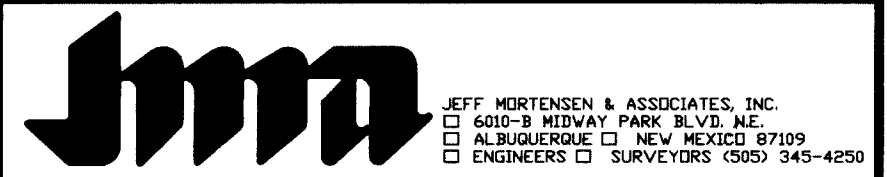

SCANNED BY  
BY LASON

960924

REV.	SHEETS	CITY ENGINEER	DATE	USER	DEPARTMENT	DATE	USER	DEPARTMENT	DATE
ENGINEERS STAMP & SIGNATURE		APPROVALS		ENGINEER		DATE	*****		
		DRC Chairman		Billy G. Goodley		10/13/97	APPROVED FOR CONSTRUCTION		
		Transportation		K. W. Kame		10-13-97			
		Water/Wastewater		K. W. Kame		10-13-97			
		Hydrology		K. W. Kame		10-15-97			
Const. Mngt.							City Engineer 2/1/98 Date		
City Project No.				578081				SHEET 1 OF 6	



SCALE: 1" = 750'

FIRM MAP

LEGAL DESCRIPTION

Lot 2 of Tract S-1, Unit 2, Atrisco Business Park  
Albuquerque, Bernalillo County, New Mexico.

**PROJECT BENCHMARK:**

Project Bench mark is Albuquerque City Survey Station "10 - K10" having a mean sea level, 1929 datum of 5142.790.

I.B.M.:

A temporary bench mark was established on the North bonnet bolt (marked with a chiseled " X ") of the fire hydrant located just south of the southerly property line and approximately 150 feet East of the Southwest property corner, Elevation being 5115.65.

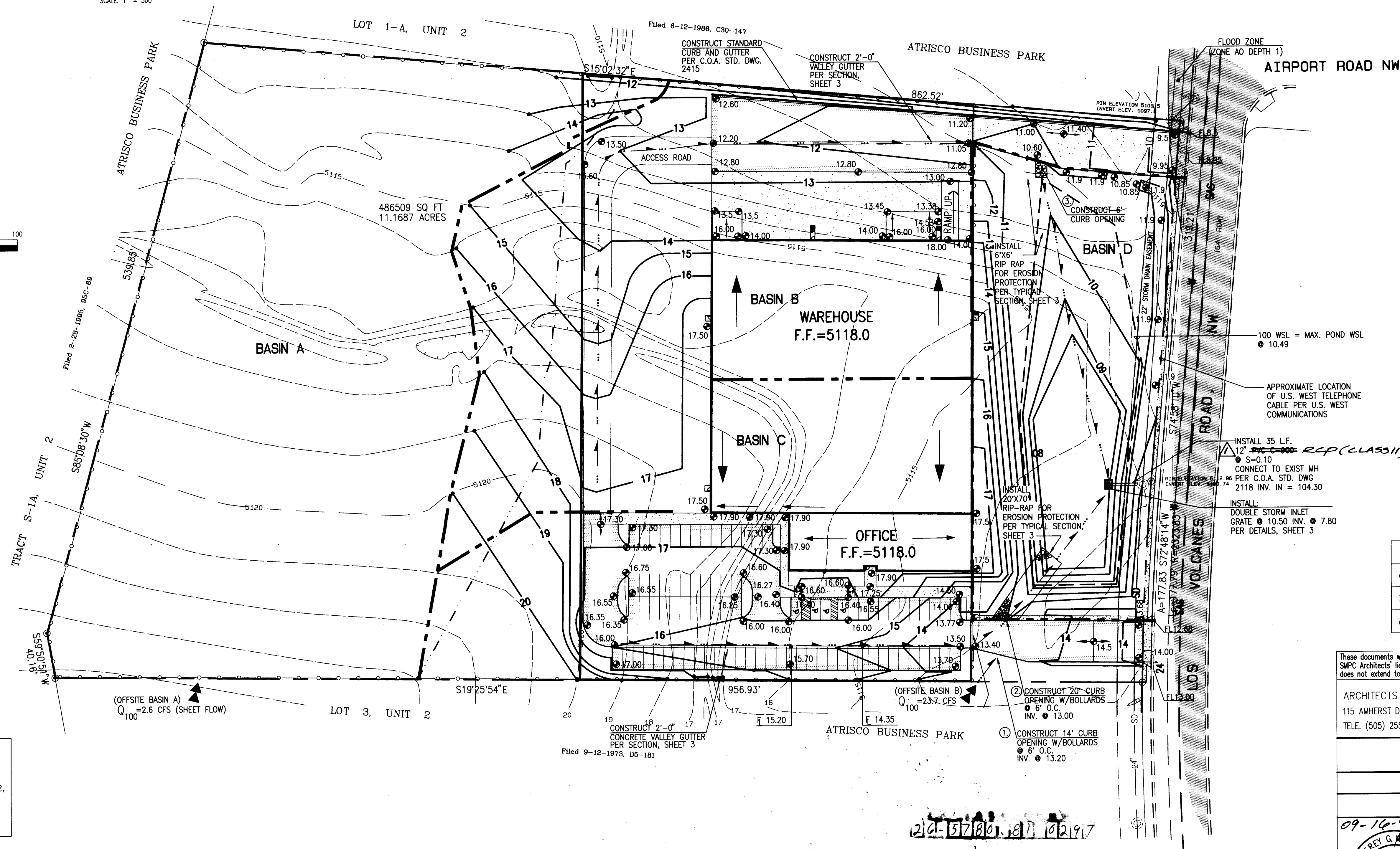
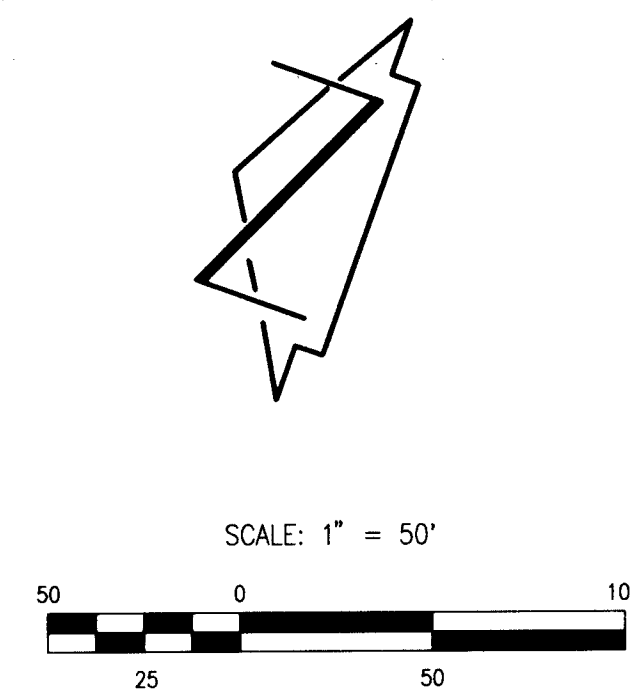
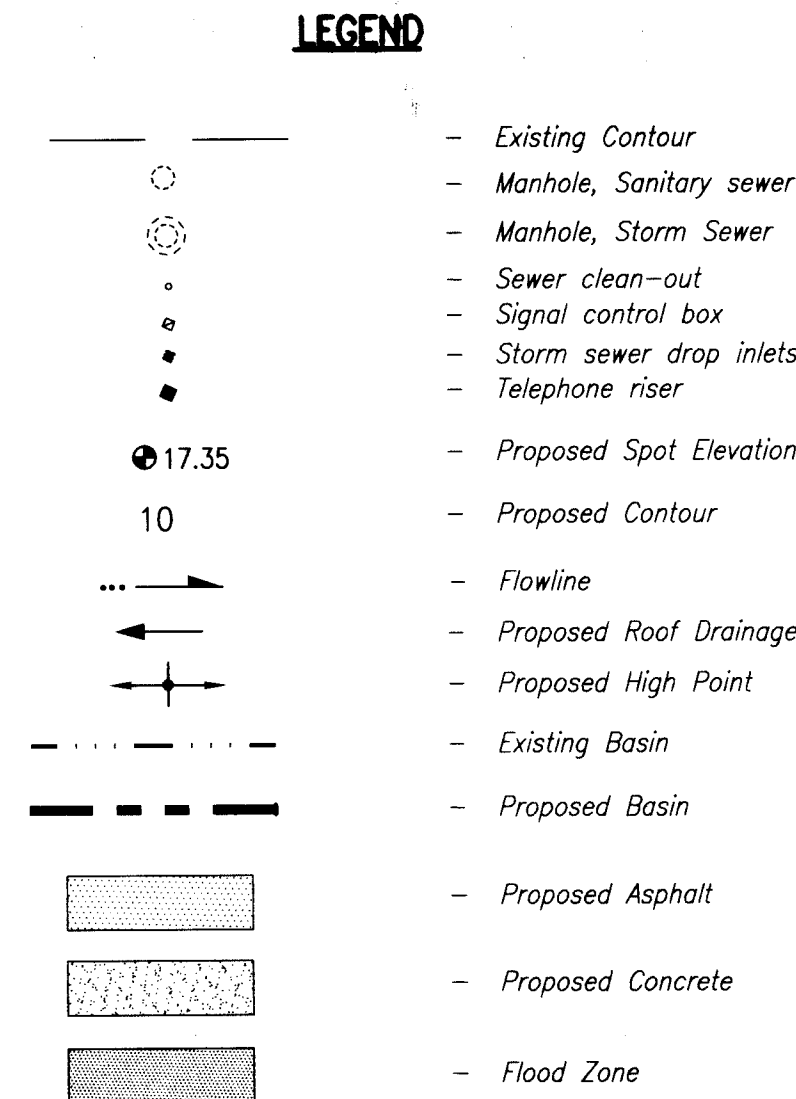

THIS IS NOT A TOPOGRAPHIC OR A BOUNDARY SURVEY. APPARENT PROPERTY CORNERS ARE SHOWN FOR ORIENTATION ONLY. BOUNDARY DATA AND TOPOGRAPHIC DATA SHOWN HEREON ARE FROM AN ARCHITECTURAL SURVEY OF LOT 2, TRACT S-1, UNIT 2, ATRISCO BUSINESS PARK, ALBUQUERQUE, NEW MEXICO PREPARED BY RONALD E. TYREE, N.M.P.S. 3516 DATED AUGUST, 1996.



JEFF MORTENSEN & ASSOCIATES, INC.  
☐ 6010-B MIDWAY PARK BLVD. N.E.  
☐ ALBUQUERQUE ☐ NEW MEXICO 87109  
☐ ENGINEERS ☐ SURVEYORS (505) 345-4250

1. Two (2) working days prior to any excavation, contractor must contact New Mexico One Call System 260-1990 \* 1-800-321-ALERT(2537), for location of existing utilities.
2. Prior to construction, the contractor shall excavate and verify the horizontal and vertical location of all potential obstructions. Should a conflict exist, the contractor shall notify the engineer in writing so that the conflict can be resolved with a minimum amount of delay.
3. All work on this project shall be performed in accordance with applicable federal, state and local laws, rules and regulations concerning construction safety and health.
4. All construction within public right-of-way shall be performed in accordance with applicable City of Albuquerque Standards and Procedures.
5. If any utility lines, pipelines, or underground utility lines are shown on these drawings, they are shown in an approximate manner only, and such lines may exist where none are shown. If any such existing lines are shown, the location is based upon information provided by the owner of said utility, and the information may be incomplete or may otherwise observe the time construction commences. The engineer has conducted only preliminary investigation of the location, depth, size, or type of existing utility lines, pipelines, or underground utility lines. This investigation is not conclusive, and may not be complete, therefore, makes no representation pertaining thereto, and assumes no responsibility or liability therefor. The contractor shall inform itself of the location of any utility line, pipeline, or underground utility line in or near the area of the work in advance of and during excavation work. The contractor is fully responsible for any and all damage caused by its failure to locate, identify and preserve any and all existing utility lines, pipelines, and underground utility lines. In planning and conducting excavation, the contractor shall comply with state statutes, municipal and local ordinances, rules and regulations, if any, pertaining to the location of these lines and facilities.
6. An Excavation/Construction Permit will be required before beginning any work within City right-of-way. An approved copy of these plans must be submitted at the time of application for this permit.
7. Backfill compaction shall be according to arterial street use.
8. Maintenance of these facilities shall be the responsibility of the owner of the property served.
9. The design of planters and landscaped areas is not part of this plan. All planters and landscaped areas adjacent to the building(s) shall be provided with positive drainage to avoid any ponding adjacent to the structure. For construction details, refer to landscaping plan.

### Erosion Control Measures

1. The contractor shall ensure that no soil erodes from the site into public right-of-way or onto private property. This can be achieved by constructing temporary berms at the property lines and wetting the soil to keep it from blowing.
2. The contractor shall promptly clean up any material excavated within the public right-of-way so that the excavated material is not susceptible to being washed down the street.
3. The contractor shall secure "Topsoil Disturbance Permit" prior to beginning construction.

APPROVALS	NAME	DATE
A.C.E./DESIGN		
INSPECTOR		
A.C.E./FIELD		

These documents were prepared for this specific project only. SMPC Architects' liability is limited to this specific project, and does not extend to reuse of these documents for other projects.

Copyright © 1997  
by SMPC Architects

ARCHITECTS • PLANNERS • INTERIOR DESIGNERS  
115 AMHERST DRIVE SE., ALBUQUERQUE, NEW MEXICO 87106  
TELE. (505) 255-8668 FAX (505) 268-6665



**SMPC**  
ARCHITECTS

## CARDINAL HEALTH

## GRADING PLAN

09-14-97

REY G. MORT

REGISTRATION NO. 8547

REGISTERED

100-27-  
215

5

PROJECT #: 960922

OWN BY: JYR

CHK BY: JGM
DATE: 08/06/07

DATE: 06/26/97	

11

256

EW

SCANNED BY  
BY LASON

26-5780, 81 0297

03-27-97

**#578081**

2 of 6









CONSTRUCTION TRAFFIC CONTROL GENERAL NOTES

1. CONTRACTOR MUST OBTAIN FROM CONSTRUCTION COORDINATION AN EXCAVATION/BARRICADING PERMIT BEFORE ENGAGING IN ANY CONSTRUCTION, MAINTENANCE OR REPAIR WORK IN ANY OF THE CITY OF ALBUQUERQUE'S RIGHTS-OF-WAY. EMERGENCY WORK THAT WOULD PRESERVE LIFE OR PROPERTY IS EXCLUDED WITH THE UNDERSTANDING, THAT A PERMIT SHALL BE OBTAINED WITHIN 24 TO 48 HOURS.

2. CONTRACTOR SHALL AT THE TIME OF PERMIT REQUEST, SUBMIT FOR APPROVAL BY CONSTRUCTION COORDINATION, A TRAFFIC CONTROL PLAN DETAILING ALL EXISTING TOPOGRAPHY SUCH AS LANE WIDTHS, DRIVEWAYS, AND BUSINESS/RESIDENTIAL ACCESSES. THE TRAFFIC CONTROL PLAN SHALL INCLUDE ALL PHASES OF WORK AND SCHEDULES INVOLVED IN THE CONSTRUCTION PROJECT. ANY SEPARATE PHASES OF A CONSTRUCTION PROJECT SHALL BE GIVEN AN INDIVIDUAL PERMIT EACH. BLANKET PERMITS WILL NOT BE ISSUED.

3. THESE TYPICAL TRAFFIC CONTROL PLANS DO NOT REFLECT THE EXISTING TOPOGRAPHY SUCH AS DRIVEWAYS, LANE WIDTHS, AND BUSINESS/RESIDENTIAL ACCESSES. EVERY LOCATION THAT REQUIRES CONSTRUCTION TRAFFIC CONTROL SHALL HAVE A DETAILED TRAFFIC CONTROL PLAN SHOWING ALL EXISTING TOPOGRAPHY.

4. CONSTRUCTION SHALL NOT BEGIN UNLESS A TRAFFIC CONTROL PLAN HAS BEEN APPROVED AND VERIFIED BY CONSTRUCTION COORDINATION.

5. CONSTRUCTION COORDINATION SHALL BE NOTIFIED 48 HOURS PRIOR TO ANY TRAFFIC CONTROL CHANGES NEEDED BY CONTRACTOR, THAT WERE NOT PREVIOUSLY APPROVED. THESE TRAFFIC CONTROL CHANGES SHALL BE REQUESTED IN WRITING ACCOMPANIED WITH A TRAFFIC CONTROL PLAN REFLECTING SUCH CHANGES.

6. ALL CONSTRUCTION TRAFFIC CONTROL DEVICES SHALL COMPLY TO THE MANUAL ON UNIFORM TRAFFIC CONTROL DEVICES (MUTCD), LATEST EDITION. IT IS THE RESPONSIBILITY OF THE CONTRACTOR TO INSTALL, SERVICE AND MAINTAIN ALL TRAFFIC CONTROL DEVICES. TRAFFIC CONTROL DEVICES SHALL NOT BE REMOVED OR ALTERED IN ANY WAY WITHOUT THE APPROVAL OF CONSTRUCTION COORDINATION, PER SECTION 6A-4 OF THE MUTCD, LATEST EDITION.

7. THE CONSTRUCTION TRAFFIC CONTROL INITIAL SET-UP SHALL BE BY AN AMERICAN TRAFFIC SAFETY SERVICES ASSOCIATION (ATSSA) CERTIFIED WORKSITE TRAFFIC SUPERVISOR. THE MAINTENANCE AND SERVICING SHALL ALSO BE DONE BY AN ATSSA CERTIFIED WORKSITE TRAFFIC SUPERVISOR OR EQUIVALENT.

8. CONTRACTOR IS RESPONSIBLE TO MAINTAIN AND SERVICE ALL TRAFFIC CONTROL DEVICES 24 HOURS A DAY, 7 DAYS A WEEK THROUGHOUT LENGTH OF PROJECT. CONTRACTOR IS RESPONSIBLE THAT ALL TRAFFIC CONTROL DEVICES COMPLY WITH THE MUTCD, LATEST EDITION.

9. ALL ADVANCE WARNING SIGNS SHALL BE DOUBLE INDICATED WHENEVER THERE ARE MULTI-LANE TRAFFIC IN ANY ONE GIVEN DIRECTION AND THERE IS SUFFICIENT MEDIAN SPACE.

10. ALL BARRICADES IN ALL TAPERS AND TANGENTS SHALL BE PLACED APART, A DISTANCE MEASURED IN FEET, EQUAL TO THAT OF THE POSTED SPEED LIMIT. NO EXCEPTIONS UNLESS APPROVED BY CONSTRUCTION COORDINATION PER MUTCD SECTION 6A-4.

11. CONTRACTOR SHALL NOT BEGIN WORK BEFORE 7:00 A.M. OR END WORK AFTER 7:00 P.M. WITHOUT THE APPROVAL OF CONSTRUCTION COORDINATION.

12. CONTRACTOR IS RESPONSIBLE TO PROVIDE CONSTRUCTION COORDINATION, A WEEKLY LOG OF DAILY INSPECTIONS OF BARRICADE AND MAINTENANCE SCHEDULES ON PROJECTS THAT ARE OVER ONE WEEK DURATION.

13. EQUIPMENT OR MATERIALS SHALL NOT BE STORED WITHIN 15 FEET OF A TRAVELLED TRAFFIC LANE DURING NON-WORKING HOURS WITHOUT THE APPROVAL OF CONSTRUCTION COORDINATION.

14. CONTRACTOR SHALL PROVIDE AND MAINTAIN A SAFE AND ADEQUATE MEANS OF CHANNELIZING PEDESTRIAN TRAFFIC AROUND AND THROUGH THE CONSTRUCTION AREA.

15. CONTRACTOR IS RESPONSIBLE FOR OBLITERATION OF ANY CONFLICTING STRIPING AND RESPONSIBLE FOR ALL TEMPORARY STRIPING.

16. CONTRACTOR SHALL MAINTAIN ACCESS TO ALL FACILITIES, BUSINESSES AND/OR RESIDENTS AT ALL TIMES.

17. CONTRACTOR SHALL PROVIDE ACCESS SIGNS FOR BUSINESSES LOCATED WITHIN THE CONSTRUCTION AREA UNDER THE SUPERVISION OF CONSTRUCTION COORDINATION. EACH ACCESS SIGN SHALL HAVE 5 INCH, WHITE OPAQUE LETTERING ON BLUE REFLECTORIZED BACKGROUND. ACCESS SIGNS SHALL BE CONSIDERED INCIDENTAL TO THE BID AND NOT PART OF THE CONTRACT UNLESS OTHERWISE STATED. NO MORE THAN 3 BUSINESSES SHALL BE LISTED ON A ACCESS SIGN. SHOPPING CENTERS AND MALLS SHALL BE LISTED AS SUCH.

18. ALL ADVANCE WARNING SIGNS SHALL MEET THE MINIMUM REFLECTIVE INTENSITY REQUIREMENTS SET FORTH BY THE CITY OF ALBUQUERQUE. CONSTRUCTION COORDINATION SHALL DETERMINE ALL REQUIREMENTS AND APPROVE OR DISAPPROVE ANY ADVANCE WARNING SIGN PER SECTION 6A-4 OF THE MUTCD, LATEST EDITION.

19. 24 HOURS PRIOR TO OCCUPYING OR CLOSING OF A RIGHT-OF-WAY, CONTRACTOR SHALL NOTIFY: POLICE, FIRE DEPARTMENT, SCHOOLS, HOSPITALS, TRANSIT AUTHORITY, BUSINESSES AND/OR RESIDENTS THAT WILL BE AFFECTED BY THE CONSTRUCTION.

20. ANY FIELD ADJUSTMENTS SHALL BE APPROVED BY CONSTRUCTION COORDINATION.

21. EXCAVATIONS SHALL BE PLATED, TEMPORARILY PATCHED OR RESURFACED PRIOR TO OPENING OF TRAFFIC. A MINIMUM OF 11 FEET SHALL BE PROVIDED FOR TRAFFIC IN ANY GIVEN DIRECTION. CONTRACTOR IS RESPONSIBLE FOR ANY WORK INVOLVED IN SATISFYING THESE REQUIREMENTS.

22. CONTRACTOR SHALL AT ALL TIMES COMPLY WITH THE FOLLOWING:  
1. STANDARDS AND REQUIREMENTS SET FORTH IN THE MANUAL ON UNIFORM TRAFFIC CONTROL DEVICES, LATEST EDITION.  
2. THE CITY OF ALBUQUERQUE TRAFFIC CODE, LATEST EDITION.  
3. SECTION 19 OF THE CITY OF ALBUQUERQUE'S STANDARD SPECIFICATIONS FOR PUBLIC WORK CONSTRUCTION, AS WELL AS OTHER SECTIONS.

23. FAILURE TO COMPLY WITH ANY OF THE ABOVE MENTIONED, WILL BE ADEQUATE CAUSE TO CEASE ALL WORK ON ANY CONSTRUCTION PROJECT. WORK WILL NOT RESUME UNTIL ALL REQUIREMENTS ARE ADDRESSED AND APPROVED BY CONSTRUCTION COORDINATION.

24. ALL TRAFFIC CONTROL DEVICES SHALL BE KEPT IN NEW-CLEAN CONDITION. WASHING OF EQUIPMENT IS INCIDENTAL TO IT'S PLACEMENT AND MAINTENANCE.

25. TRAFFIC CONTROL STANDARDS APPLY ONLY WHERE THE CONSTRUCTION TRAFFIC CONTROL PLANS ARE NOT SPECIFIC.

26. ADVANCE WARNING SIGNS SHALL BE 36"x36" WITH SUPER ENGINEERING GRADE SHEETING OR BETTER.

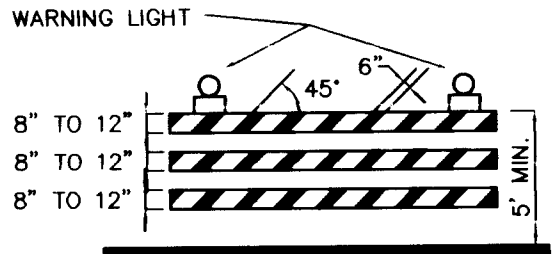

TYPE III BARRICADE

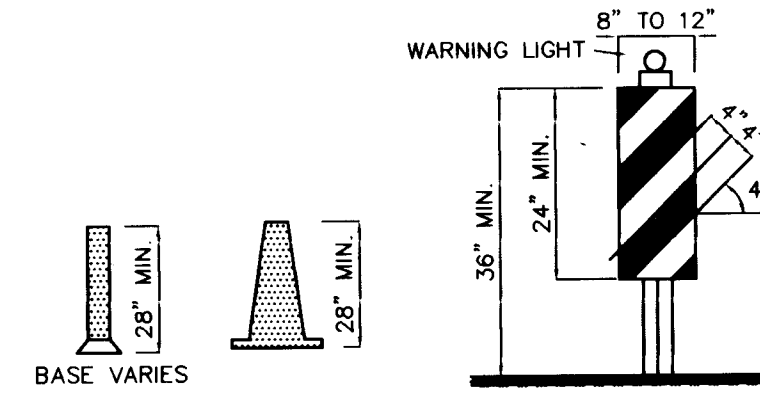

VERTICAL PANEL

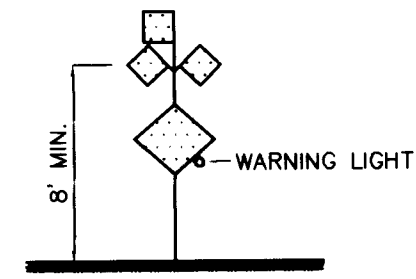

HIGH LEVEL WARNING DEVICE

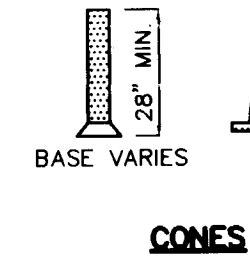

CONES

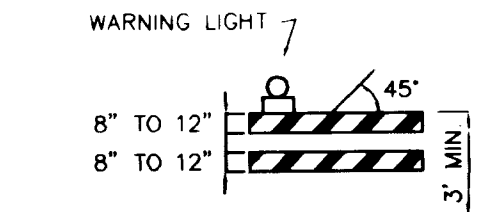

TYPE II BARRICADE COLLAPSIBLE

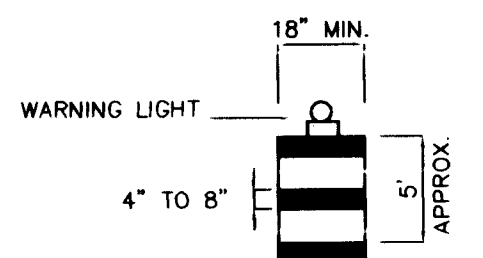

BARREL

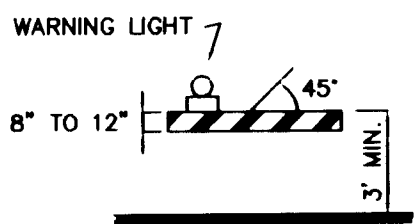

TYPE I BARRICADE COLLAPSIBLE

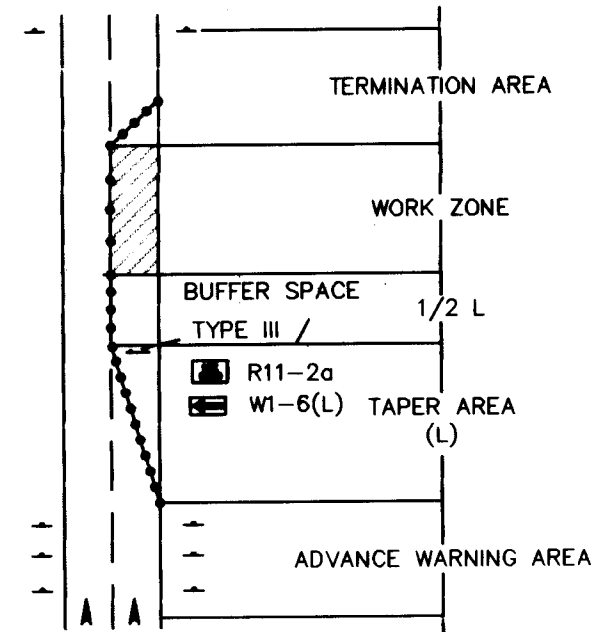

TRAFFIC CONTROL ELEMENTS

LEGEND

- WORK AREA  
BARRICADE - TYPE I, TYPE II, OR BARREL  
BARRICADE - TYPE III  
VERTICAL PANEL  
WARNING SIGN  
DISTANCE BETWEEN SIGNS - A DISTANCE MEASURED IN FEET EQUAL TO A VALUE OF TEN TIMES THE SPEED LIMIT OF THE STREET  
FLAGMAN POSITION  
SPACING BETWEEN BARRICADES- A DISTANCE MEASURED IN FEET EQUAL TO THE SPEED LIMIT OF THE STREET  
TAPER LENGTH - SEE CHART BELOW  
THE TANGENT LENGTH IS EQUAL TO THE TAPER LENGTH FOR A GIVEN STREET.

TAPER REQUIREMENTS

SPEED LIMIT (MPH)	TAPER LENGTH (L) (FEET)			MINIMUM NUMBER OF DEVICES FOR TAPER	MAXIMUM DEVICE SPACING IN FEET	
	10' LANE	11' LANE	12' LANE		ALONG TAPER	AFTER TAPER
20	70	75	80	5	20	20
25	105	115	125	6	25	25
30	150	165	180	7	30	30
35	205	225	245	8	35	35
40	270	295	320	9	40	40
45	450	495	540	13	45	45
50	500	550	600	13	50	50
55	550	605	660	13	55	55

RECOMMENDED SIGN SPACING(D) FOR ADVANCE WARNING SIGN SERIES

SPEED MILES PER HOUR	MINIMUM DISTANCE IN FEET	
	BETWEEN SIGNS	FROM LAST SIGN TO TAPER
0-20	10 X SPEED LIMIT	10 X SPEED LIMIT
25-30	10 X SPEED LIMIT	10 X SPEED LIMIT
30-35	10 X SPEED LIMIT	10 X SPEED LIMIT
40-45	10 X SPEED LIMIT	10 X SPEED LIMIT
50-60	10 X SPEED LIMIT	10 X SPEED LIMIT

TAPER CRITERIA

TYPE OF TAPER	TAPER LENGTH
UPSTREAM TAPER:	
MERGING TAPER	L MINIMUM
SHIFTING TAPER	1/2 L MINIMUM
SHOULDER TAPER	1/2 L MINIMUM
TWO WAY TRAFFIC TAPER	100 FEET MAXIMUM
DOWNSTREAM TAPERS	100 FEET PER LANE

TAPER LENGTH COMPUTATION

SPEED LIMIT	
40 MPH OR LESS	$L = \frac{WS^2}{60}$
45 MPH OR GREATER	$L = W \times S$
L = TAPER LENGTH W = WIDTH OF OFFSET IN FEET S = POSTED SPEED OR OFF-PEAK 85-PERCENTILE SPEED IN MPH	

SIGN FACE DETAILS

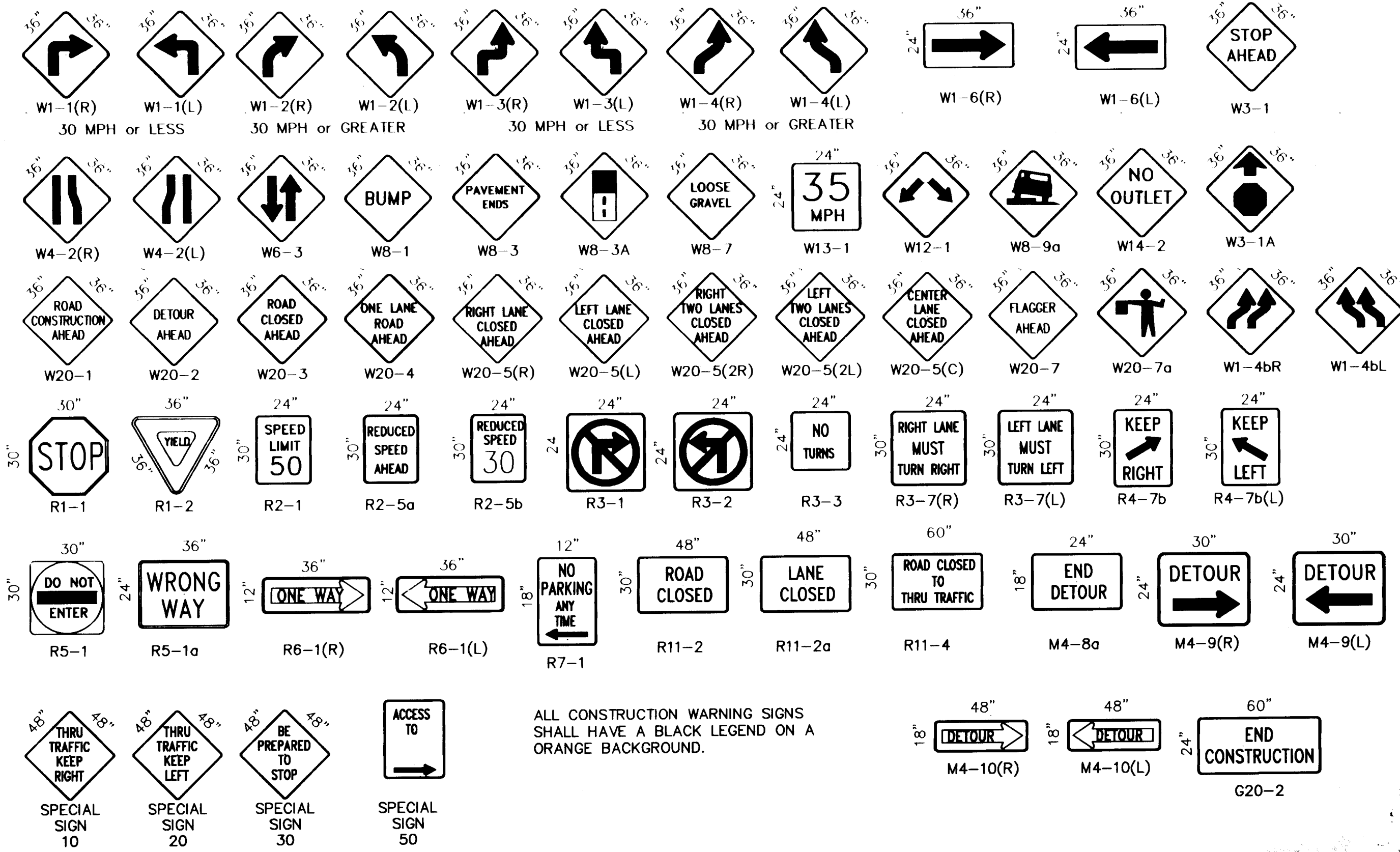

ALL CONSTRUCTION WARNING SIGNS SHALL HAVE A BLACK LEGEND ON A ORANGE BACKGROUND.

SCANNED BY LASON

AS BUILT INFORMATION		BENCH MARKS		SURVEY INFORMATION		ENGINEER'S SEAL	
CONTRACTOR	DATE	NO.	BY	NO.	BY	REMARKS	REVISIONS
STANDARD	DATE						
FIELD	DATE						
INVESTIGATION BY	DATE						
CORRECTED BY	DATE						
MICRO-FILM INFORMATION							
RECORDED BY	DATE						
NO.							

CITY OF ALBUQUERQUE PUBLIC WORKS DEPARTMENT ENGINEERING DEVELOPMENT GROUP			
TITLE: <b>CARDINAL HEALTH SIGNING AND CONSTRUCTION TRAFFIC CONTROL STANDARDS</b>			
DESIGN REVIEW COMMITTEE	CITY ENGINEER APPROVAL	LAST UPDATE	
		MO./DAY/YR.	
		MO./DAY/YR.	
		MO./DAY/YR.	
		MO./DAY/YR.	
PROJECT NO. <b>578081</b>	MAP NO. <b>J-10</b>	SHEET <b>5</b> OF <b>6</b>	





LOTS 2-A AND 2-B  
BOULEVARD VIEW SUBDIVISION  
LESS AND EXCEPTING THEREFROM THAT PORTION  
CONVEYED TO THE CITY OF ALBUQUERQUE, NEW MEXICO  
ALBUQUERQUE, BERNALILLO COUNTY, NEW MEXICO

# TINKER FIRE HYDRANT

## LEGAL DESCRIPTION:

Lots numbered Two-A (2-A) and Two-B (2-B) of the replat of the South Fifty (S.50) feet of Lot numbered One (1) and Lot numbered Two (2) of BOULEVARD VIEW SUBDIVISION as the same is shown and designated on said replat filed in the office of the County Clerk of Bernalillo County, New Mexico on January 11, 1984 in Map Book C23, Folio 3 LESS AND EXCEPTING THEREFROM that portion conveyed to the City of Albuquerque, New Mexico a municipal corporation by those certain documents recorded October 3, 1957 as document number 41991 and November 26, 1958 as document number 91676, records of Bernalillo County, New Mexico.

LIMITS OF CONSTRUCTION

TBM:  
CHISELED MARK IN CONC. @ WATER  
METER. ELEV = 4967.8360  
INSTALLED 1-3/4" WATER SERVICE LATERAL W/ BOX  
TO EXISTING 3" W/L

4' NORTH OF PROPERTY CORNER  
INSTALL 1~4" FH, 18" EAST OF BACK OF CURB  
W/RESTRAINED FITTINGS (FULL LENGTH)  
FLANGE ELEV=8" ABOVE EXISTING GRADE @ S/W  
1~NON-PRESSURE CONNECTION  
6" TEE W/BLOCKING  
1~6" GATE VALVE ON EXIST. MAIN LINE  
W/VLV BOX TYPE "A" & BLOCKING  
+/- 75~6" PVC WATERLINE W/ REST. JOINTS  
FIELD VERIFY LOCATION OF ALL  
UTILITIES WITHIN R/W  
ADJUST ALL UTILITIES AS NECESSARY  
EXTEND SIDEWALK TO 6' WIDE TO 8' NORTH OF PL

REMOVE & REPLACE:  
640 SF MINOR ARTERIAL PAVMENT IN ACCORD.  
WITH COA STD. DWG 240765  
16 LF STD. C & G IN ACCORD. WITH COA STD.  
DWG 2415  
72 SF SIDEWALK IN ACCORD WITH COA STD. DWG.  
2430, 2431, 2432

COORDINATE LOCATION OF EXISTING UTILITIES WITH  
JOE LUEHRING @ 768-3623 FOR "POT HOLEING"  
TO DETERMINE THE EXACT LOCATION OF EXIST. UTILITIES  
TO BE PAID FOR AND COORDINATED WITH THE OWNER.

## WATER SHUTOFF REQUIREMENTS:

The Contractor shall be responsible for timing and coordination  
of water shutoff. At least five (5) working days prior to  
construction, Contractor shall contact the Water System  
Division, B57-B200, to initiate implementation of the non-  
pressurized connection plan. In order to complete this  
connection, the following valves must be closed by Water  
Systems personnel:

## SHUT OFF VALVE #63 & VALVE #204 FOR W/L CONNECTION

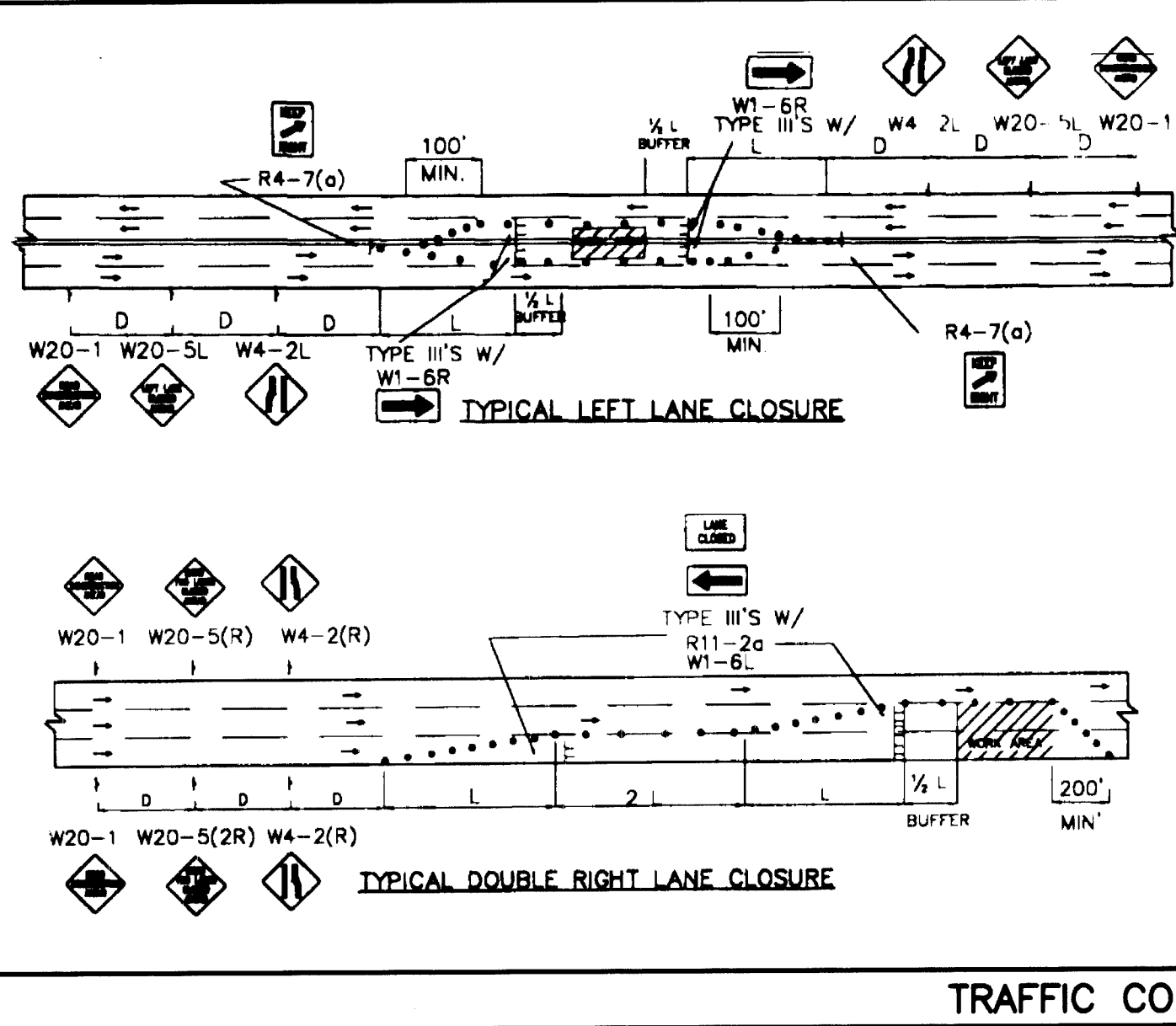
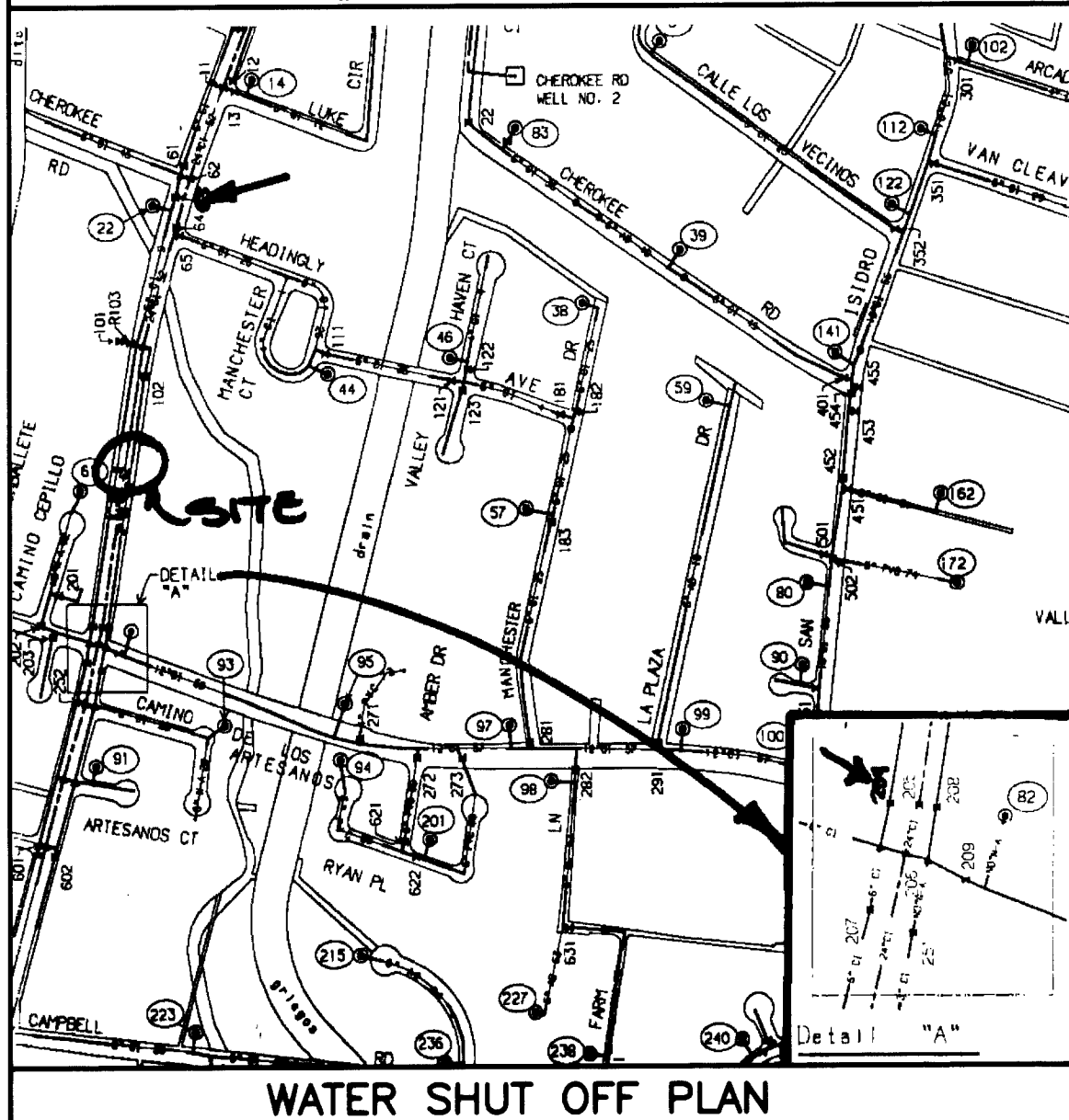

STANDARD TRAFFIC CONTROL NOTES (AS NUMBERED W/COA):

- CONTRACTOR MUST OBTAIN FROM CONSTRUCTION COORDINATOR AN  
EXCAVATION/BARRICADING PERMIT BEFORE ENGAGING IN ANY  
CONSTRUCTION, MAINTENANCE OR REPAIR WORK IN ANY OF THE CITY OF  
ALBUQUERQUE'S RIGHTS-OF-WAY. EMERGENCY WORK THAT WOULD  
PRESERVE LIFE OR PROPERTY IS EXCLUDED WITH THE UNDERSTANDING  
THAT A PERMIT SHALL BE OBTAINED WITHIN 24 HOURS.
- CONTRACTOR SHALL AT THE TIME OF PERMIT REQUEST, SUBMIT FOR  
APPROVAL BY CONSTRUCTION COORDINATION, A TRAFFIC CONTROL PLAN  
DETAILED ALL EXISTING TOPOGRAPHY SUCH AS LANE WIDTHS,  
DRIVEWAYS, AND BUSINESS/RESIDENTIAL ACCESSES. THE TRAFFIC  
CONTROL PLAN SHALL INCLUDE ALL PHASES OF WORK AND SCHEDULES  
INVOLVED IN THE CONSTRUCTION PROJECT. ANY SEPARATE PHASES OF  
A CONSTRUCTION PROJECT SHALL BE GIVEN AN INDIVIDUAL PERMIT  
EACH. BLANKET PERMITS WILL NOT BE ISSUED.
- ALL WORK IN ARTERIAL ROADWAYS SHALL BE ON A CONTINUOUS 24  
HOUR PER DAY BASIS UNTIL COMPLETED - OR - WORK SHALL BE FROM 9  
AM TO 3 PM FOR UP TO 3 DAYS. ALL LANES SHALL BE OPEN TO TRAFFIC  
BEFORE THE 9 AM TRAFFIC RUSH HOUR AND AFTER THE 3 PM TRAFFIC RUSH  
HOUR.
- CONTRACTOR SHALL MAINTAIN A GRAFFITI-FREE WORKSITE. ALL  
GRAFFITI SHALL BE PROMPTLY REMOVED FROM ALL EQUIPMENT, BOTH  
PERMANENT AND TEMPORARY.

TRACT "B"  
LAND DIVISION OF MRS. PAULA TORRES  
Filed 2/18/72, Bk. B6, Pg. 87

LOT 2-A  
9.728 SQ.FT±  
0.2233 ACRES±

LOT 2-B  
33.495 SQ.FT±  
0.7689 ACRES±

NOTE:  
Unless otherwise indicated, corners  
are set capped rebars "7002".

LOT 3  
BOULEVARD VIEW SUBDIVISION  
Filed 3/28/39, Bk. C, Pg. 173

BM.: ACS BEAST TABLET  
"10-G13-A"  
Elev. 4968.210'

2 3 4 5 6 7 8 9 10 11 12 13 14 15  
26-58818.01 10198

LEGEND  
--- PROPERTY LINE  
--- OVERHEAD POWER  
---SAS---SAS---SAS--- SEWER

McDowell Engineering Inc.  
7820 Beverly Hills Ave. NE  
Albuquerque, NM 87122  
Tele: (505) 828-2430

THESE DRAWINGS DO NOT INCLUDE NECESSARY  
COMPONENTS FOR THE CONSTRUCTION SAFETY WHICH  
SHALL REMAIN THE RESPONSIBILITY OF THE  
CONTRACTOR.

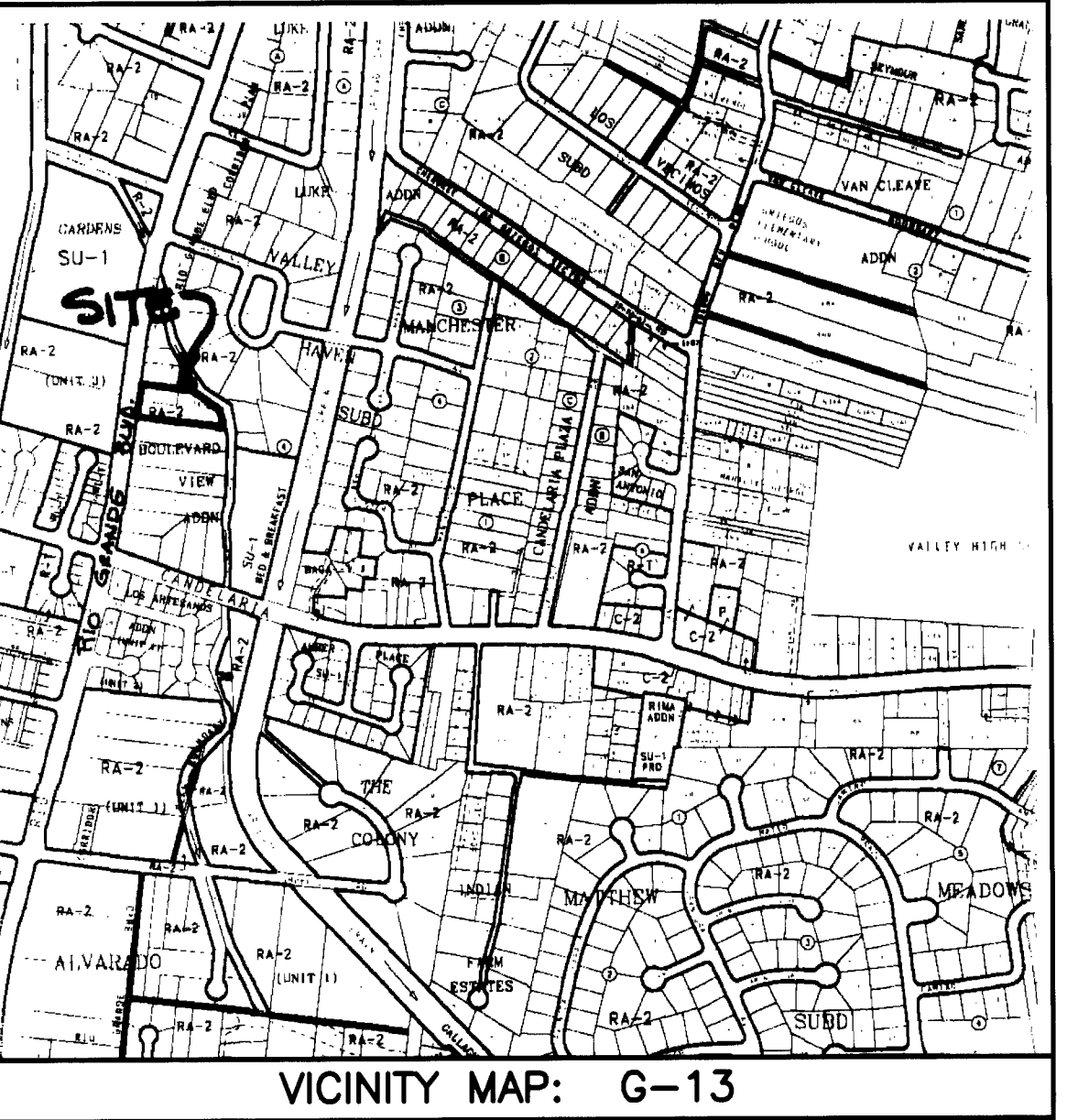
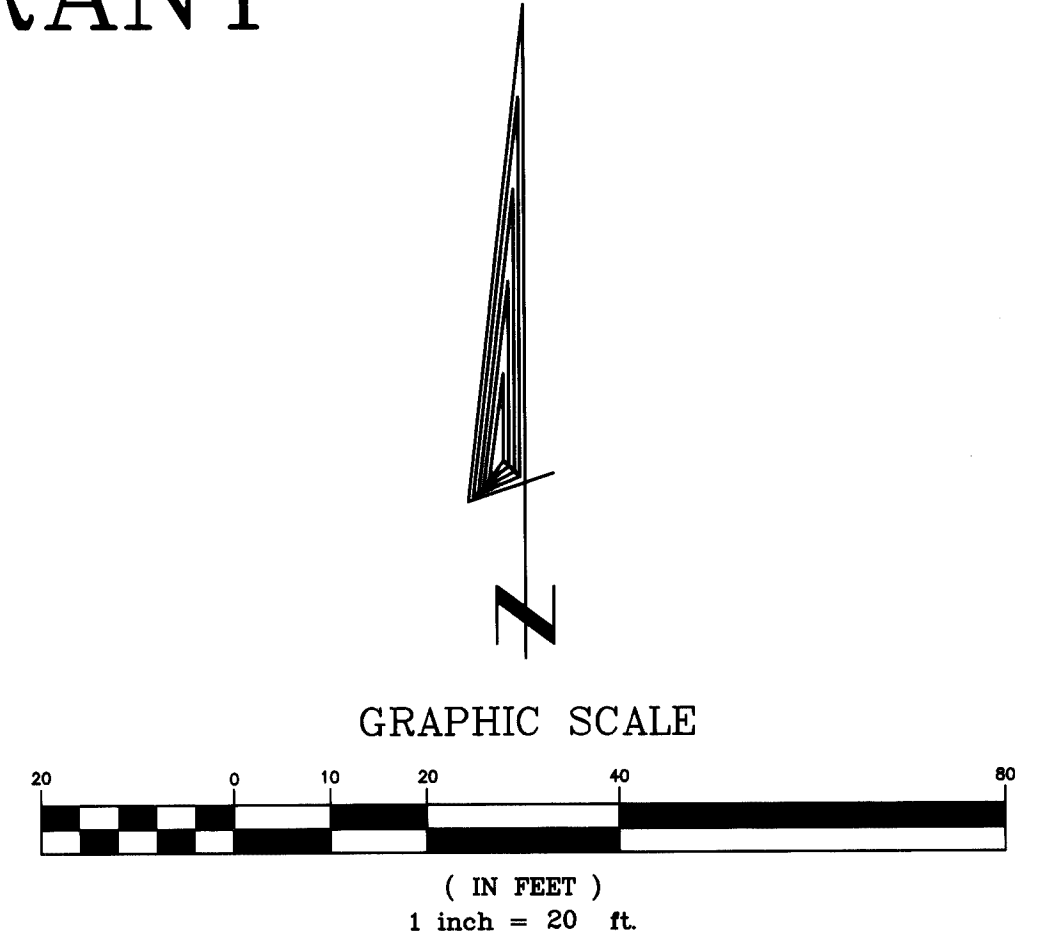

## GENERAL NOTES:

- ALL WORK DETAILED ON THESE PLANS TO BE PERFORMED UNDER CONTRACT SHALL, EXCEPT AS OTHERWISE STATED OR PROVIDED FOR HEREON, BE CONSTRUCTED IN ACCORDANCE WITH THE "CITY OF ALBUQUERQUE, STANDARD SPECIFICATIONS FOR PUBLIC WORKS CONSTRUCTION, 1986" (COA STD) WITH UPDATES THROUGH #6.
- TWO (2) WORKING DAYS PRIOR TO ANY EXCAVATION, CONTRACTOR MUST CONTACT NEW MEXICO ONE CALL SYSTEM, 260-1990, FOR LOCATION OF EXISTING UTILITIES.
- PRIOR TO CONSTRUCTION, THE CONTRACTOR SHALL EXCAVATE AND VERIFY THE HORIZONTAL AND VERTICAL LOCATIONS OF ALL OBSTRUCTIONS. SHOULD A CONFLICT EXIST, THE CONTRACTOR SHALL NOTIFY THE ENGINEER OR SURVEYOR SO THAT THE CONFLICT CAN BE RESOLVED WITH MINIMUM AMOUNT OF DELAY.
- IF ANY UTILITY LINES, PIPELINES, OR UNDERGROUND UTILITY LINES ARE SHOWN ON THESE DRAWINGS, THEY ARE SHOWN IN AN APPROXIMATE MANNER ONLY, AND SUCH LINES MAY EXIST WHERE NONE ARE SHOWN. IF ANY SUCH EXISTING LINES ARE SHOWN, THE LOCATION IS BASED UPON INFORMATION PROVIDED BY THE OWNER OF SAID UTILITY, AND THE INFORMATION MAY BE INCOMPLETE, OR MAY BE OBSOLETE BY THE TIME CONSTRUCTION COMMENCES. THE ENGINEER HAS UNDERTAKEN NO FIELD VERIFICATION OF THE LOCATION, DEPTH, SIZE, OR TYPE OF EXISTING UTILITY LINES, PIPELINES, OR UNDERGROUND UTILITY LINES. THE CONTRACTOR SHALL INFORM HIMSELF OF THE LOCATION OF ANY UTILITY LINE, PIPELINE, OR UNDERGROUND UTILITY LINE IN OR NEAR THE AREA OF THE WORK IN ADVANCE OF AND DURING EXCAVATION WORK. THE CONTRACTOR IS FULLY RESPONSIBLE FOR ANY AND ALL DAMAGE CAUSED BY HIS FAILURE TO LOCATE, IDENTIFY AND PRESERVE ANY AND ALL EXISTING UTILITIES, PIPELINES, AND UNDERGROUND UTILITY LINES. IN PLANNING AND CONDUCTING EXCAVATION, THE CONTRACTOR SHALL COMPLY WITH STATE STATUTES, MUNICIPAL AND LOCAL ORDINANCES, RULES AND REGULATIONS, IF ANY, PERTAINING TO THE LOCATION OF THESE LINES AND FACILITIES.
- SIDEWALKS AND WHEELCHAIR RAMPS WITHIN THE CURB RETURNS SHALL BE CONSTRUCTED WHEREVER A NEW CURB RETURN IS CONSTRUCTED.
- THE CONTRACTOR SHALL SECURE A "TOPSOIL DISTURBANCE PERMIT" PRIOR TO BEGINNING CONSTRUCTION.
- THE CONTRACTOR SHALL ASSIST THE ENGINEER/INSPECTOR IN THE RECORDING OF DATA ON ALL UTILITY LINES AND ACCESSORIES AS REQUIRED BY THE OWNERS FOR THE PREPARATION OF "RECORD DRAWINGS". THE CONTRACTOR SHALL NOT COVER UTILITY LINES AND ACCESSORIES UNTIL ALL DATA HAS BEEN RECORDED.
- REFERENCE MADE TO STANDARD DRAWINGS REFER TO CITY OF ALBUQUERQUE STANDARD DRAWINGS.
- ELECTRONIC MARKER DISCS SHALL BE PLACED IN ACCORDANCE WITH SECTION 170 OF THE CITY OF ALBUQUERQUE, STANDARD SPECIFICATIONS, PUBLIC WORKS CONSTRUCTION.
- ALL CONSTRUCTION WITHIN CITY RIGHT-OF-WAY OR EASEMENTS MUST BE DONE FROM APPROVED WORK ORDER DOCUMENTS FROM THE CITY OF ALBUQUERQUE AND PREPARED BY MCDOWELL ENGINEERING, INC.
- AN EXCAVATION/CONSTRUCTION PERMIT WILL BE REQUIRED BEFORE BEGINNING ANY WORK WITHIN CITY RIGHT-OF-WAY. AN APPROVED COPY OF THESE PLANS MUST BE SUBMITTED AT THE TIME OF APPLICATION FOR THIS PERMIT.
- THE CONTRACTOR SHALL BE RESPONSIBLE FOR DETERMINING, IN ADVANCE OF HIS CONSTRUCTION, IF OVERHEAD UTILITY LINES SUPPORT STRUCTURES, POLES, GUYS, ETC. ARE AN OBSTRUCTION TO CONSTRUCTION OPERATIONS. IF ANY OBSTRUCTION TO CONSTRUCTION OPERATIONS IS EVIDENT, THE CONTRACTOR SHALL BE RESPONSIBLE FOR COORDINATING WITH THE APPROPRIATE UTILITY OWNER TO REMOVE OR SUPPORT THE UTILITY OBSTRUCTION. ANY COST ASSOCIATED WITH THIS EFFORT SHALL BE THE RESPONSIBILITY OF THE CONTRACTOR.
- CONTRACTOR IS TO SUPPORT AND MAINTAIN THE INTEGRITY OF ALL UNDERGROUND TELEPHONE, ELECTRIC CABLES, AND CABLE TELEVISION UTILITIES AT NO ADDITIONAL COST TO THE OWNER. CABLE IS TO BE SUPPORTED EVERY 15' (MINIMUM). CONTRACTOR SHALL COORDINATE WITH AND MAKE NECESSARY PAYMENT (IF ANY) TO UTILITY OWNER FOR DE-ENERGIZATION OF CABLES OR SUPPORT OF CABLES BY THE UTILITY OWNER.
- FIVE (5) WORKING DAYS PRIOR TO BEGINNING CONSTRUCTION THE CONTRACTOR SHALL SUBMIT TO THE CONSTRUCTION CO-ORDINATION DIVISION A DETAILED CONSTRUCTION SCHEDULE. TWO (2) WORKING DAYS PRIOR TO CONSTRUCTION, THE CONTRACTOR SHALL OBTAIN A BARRICADING PERMIT FROM THE CONSTRUCTION CO-ORDINATION DIVISION. CONTRACTOR SHALL NOTIFY BARRICADE ENGINEER (768-2551) PRIOR TO OCCUPYING AN INTERSECTION. SEE SECTION 19 OF THE SPECIFICATIONS.
- ALL STREET STRIPING ALTERED OR DESTROYED SHALL BE REPLACED WITH PLASTIC REFLECTORIZED PAVEMENT MARKING BY CONTRACTOR TO EXISTING LOCATION OR AS INDICATED BY THIS PLAN SET.
- ANY WORK AFFECTING AN ARTERIAL ROADWAY REQUIRES 24 HOUR CONSTRUCTION.
- ANY EXISTING SURVEY MONUMENTATION DESTROYED DUE TO CONSTRUCTION SHALL BE REPLACED IN ACCORD. W/COA STDs.

DRB No.  
97-360  
COPYRIGHT

REV.	SHEETS	CITY ENGINEER	DATE	USER DEPARTMENT	DATE	USER DEPARTMENT	DATE
ENGINEERS STAMP & SIGNATURE		APPROVALS		ENGINEER	DATE	*****	
		DRC Chairman		R. W. Kane	1-5-98	APPROVED FOR CONSTRUCTION	
		Transportation		R. W. Kane	1-5-98	1-5-98	
		Water/Wastewater		R. W. Kane	1-5-98	1-5-98	
		Hydrology		R. W. Kane	1-5-98	1-5-98	
CIP		Constr. Mngmt.					
City Project No.				581881		Sheet 1 of 1	