

[illegible]

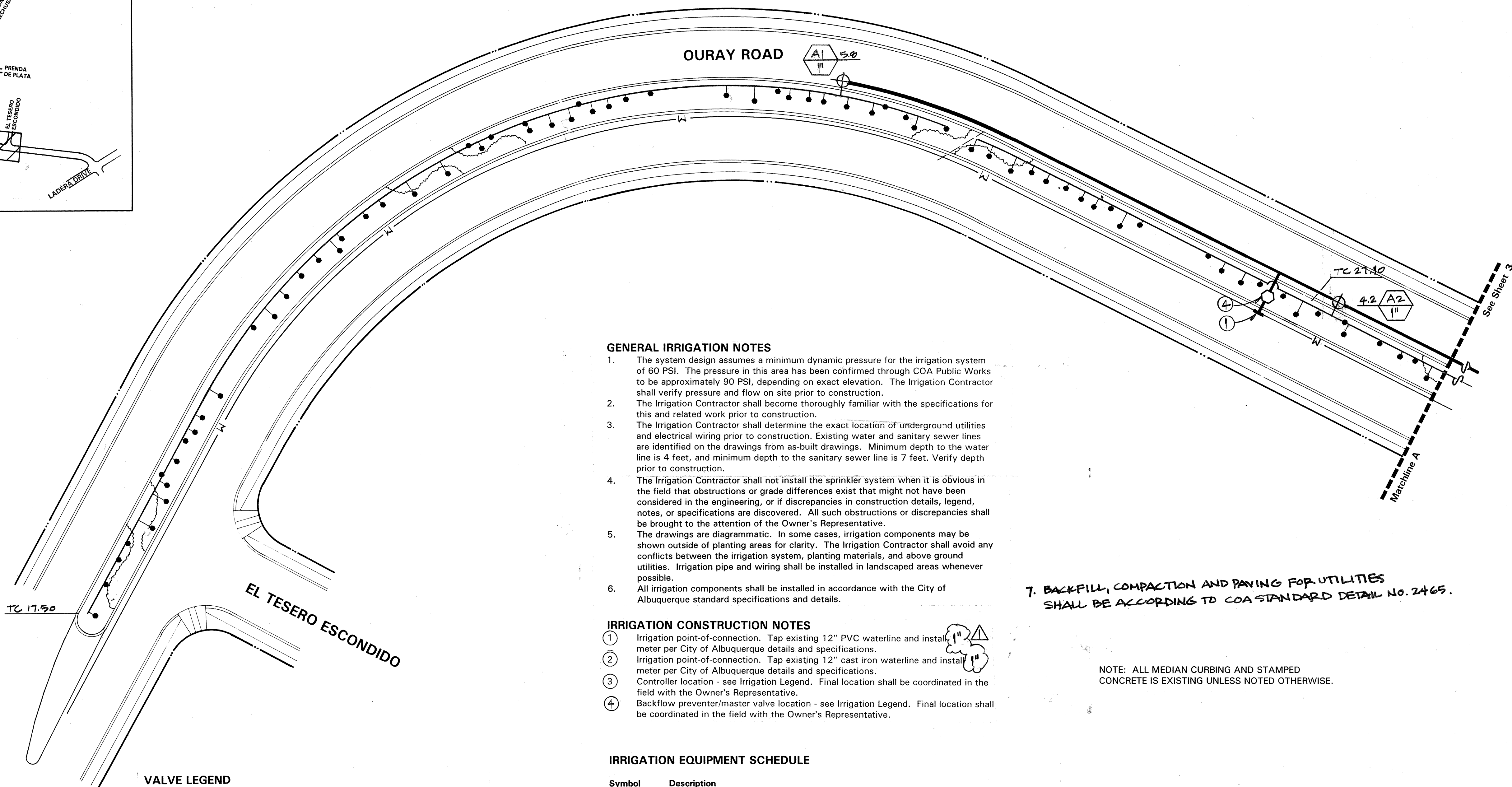

1. The system design assumes a minimum dynamic pressure for the irrigation system of 60 PSI. The pressure in this area has been confirmed through COA Public Works to be approximately 90 PSI, depending on exact elevation. The Irrigation Contractor shall verify pressure and flow on site prior to construction.
2. The Irrigation Contractor shall become thoroughly familiar with the specifications for this and related work prior to construction.
3. The Irrigation Contractor shall determine the exact location of underground utilities and electrical wiring prior to construction. Existing water and sanitary sewer lines are identified on the drawings from as-built drawings. Minimum depth to the water line is 4 feet, and minimum depth to the sanitary sewer line is 7 feet. Verify depth prior to construction.
4. The Irrigation Contractor shall not install the sprinkler system when it is obvious in the field that obstructions or grade differences exist that might not have been considered in the engineering, or if discrepancies in construction details, legend, notes, or specifications are discovered. All such obstructions or discrepancies shall be brought to the attention of the Owner's Representative.
5. The drawings are diagrammatic. In some cases, irrigation components may be shown outside of planting areas for clarity. The Irrigation Contractor shall avoid any conflicts between the irrigation system, planting materials, and above ground utilities. Irrigation pipe and wiring shall be installed in landscaped areas whenever possible.
6. All irrigation components shall be installed in accordance with the City of Albuquerque standard specifications and details.

IRRIGATION CONSTRUCTION NOTES

- 1 Irrigation point-of-connection. Tap existing 12" PVC waterline and install meter per City of Albuquerque details and specifications.
- 2 Irrigation point-of-connection. Tap existing 12" PVC waterline and install meter per City of Albuquerque details and specifications.
- 3 Controller location - see Irrigation Legend. Final location shall be coordinated in the field with the Owner's Representative.
- 4 Backflow preventer/master valve location - see Irrigation Legend. Final location shall be coordinated in the field with the Owner's Representative.

Symbol	Description
	Sleeving: Class 200 PVC (2 sizes larger than sleeved pipe)
	Mainline Pipe: 1-1/2" Schedule 40 PVC
	Lateral Pipe: Schedule 40 PVC (size as indicated on plans)
	Gate Valve Assembly (COA Detail 2706)
	Backflow Prevention Assembly: Febco 765-3/4" Pressure Vacuum Breaker w/3/4" Multi-Jet Master Meter Unit w/Master Valve (COA Detail 2702-C)
	Remote Control Valve Assembly: Rain Bird PEB-PRS-B Series, Hardie E2002 DC Latching Solenoid, Rain Bird RBY-100-200MX Wye Filter, and Rain Bird PSI-M30X Pressure Regulator (COA Detail
	Emitter Device: Rain Bird Xeri-Bird-8 Multi-Outlet Pressure Compensating Emission Device w/Rain Bird Xeri-Bug Emitters as defined below: <div style="margin-left: 40px;"> <p>Trees - (4) 2 gph Xeri-Bug XB-20 Emitters each</p> <p>5 Gal. Shrubs - (2) 1 gph Xeri-Bug XB-10 Emitters each</p> <p>1 Gal. Shrubs - (2) 1 gph Xeri-Bug XB-10 Emitters each</p> </div>
	Controller: Toro MIR5000 Scorpio DC Unit (8 station) in Stainless Steel Enclosure w/Dome Antenna and Hitney 10 watt Solar Panel w/Regulator
	Indicates Controller and Station Number Indicates Lateral Discharge in GPM
	Indicates Remote Control Valve Size in Inches

VALVE NO.	EMITTER TYPE	NOZZLE	VALVE SIZE	GPM
A1	Xeri-Bug	XB-10/XB-20	1"	5.8
A2	Xeri-Bug	XB-10/XB-20	1"	4.2
A3	Xeri-Bug	XB-10/XB-20	1"	3.0
B1	Xeri-Bug	XB-10/XB-20	1"	4.6
B2	Xeri-Bug	XB-10/XB-20	1"	8.9

CONTROLLER A					
PROGRAM	VALVES	PR CALC.	RUN TIME	CYCLES	TOTAL GPM
1	A1	NA	2 hours	1	5.8
2	A2	NA	2 hours	1	4.2
3	A3	NA	2 hours	1	3.0

PROGRAM	VALVES	PR CALC.	RUN TIME	CYCLES	TOTAL GPM
1	B1	NA	2 hours	1	4.6
2	B2	NA	2 hours	1	8.9

7. BACKFILL, COMPACTION AND PAVING FOR UTILITIES SHALL BE ACCORDING TO COA STANDARD DETAIL NO. 2465.

NOTE: ALL MEDIAN CURBING AND STAMPED CONCRETE IS EXISTING UNLESS NOTED OTHERWISE.

FOR INFORMATION ONLY

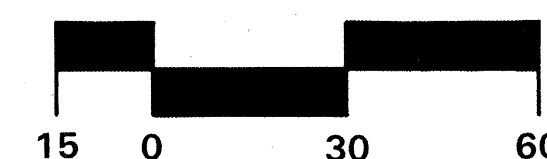

 PLANNING CONSENSUS	CONSULSUS PLANNING, INC. <i>Planning / Landscape Architecture</i> 924 Park Avenue SW Albuquerque, NM 87102 (505) 764-9801 Fax 842-5495			10-22-90				DATE	DESIGNED BY DRAWN BY CHECKED BY
								NO.	
<p align="center"> CITY OF ALBUQUERQUE CAPITAL IMPLEMENTATION PROGRAM LANDSCAPE ARCHITECTURE & CONSTRUCTION SERVICES </p>									
<p align="center"> TITLE: OURAY ROAD MEDIAN LANDSCAPE IMPROVEMENTS IRRIGATION PLAN </p>									
Design Review Committee		City Engineer Approval		Last Design Update	Mo. / Day / Yr.		Mo. / Day / Yr.		
City Project No. <div style="font-size: 1.5em; font-weight: bold;">5793.91</div>		Zone Map No. <div style="font-size: 1.5em; font-weight: bold;">G.H-10</div>		Sheet <div style="font-size: 1.5em; font-weight: bold;">2</div>		Of <div style="font-size: 1.5em; font-weight: bold;">11</div>			

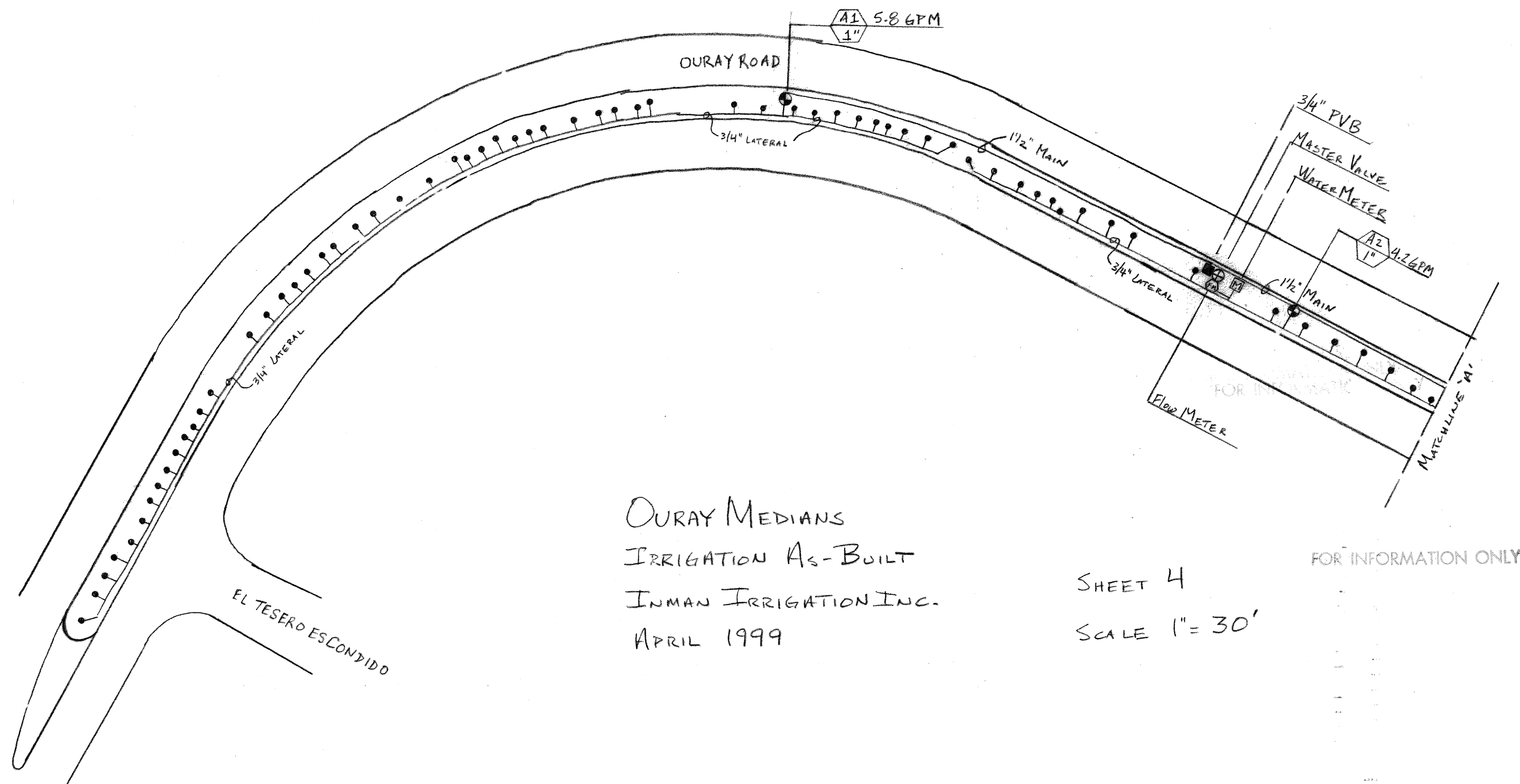

OURAY MEDIANS
 IRRIGATION AS-BUILT
 INMAN IRRIGATION INC.
 APRIL 1999

SHEET 4
 SCALE 1" = 30'

FOR INFORMATION ONLY

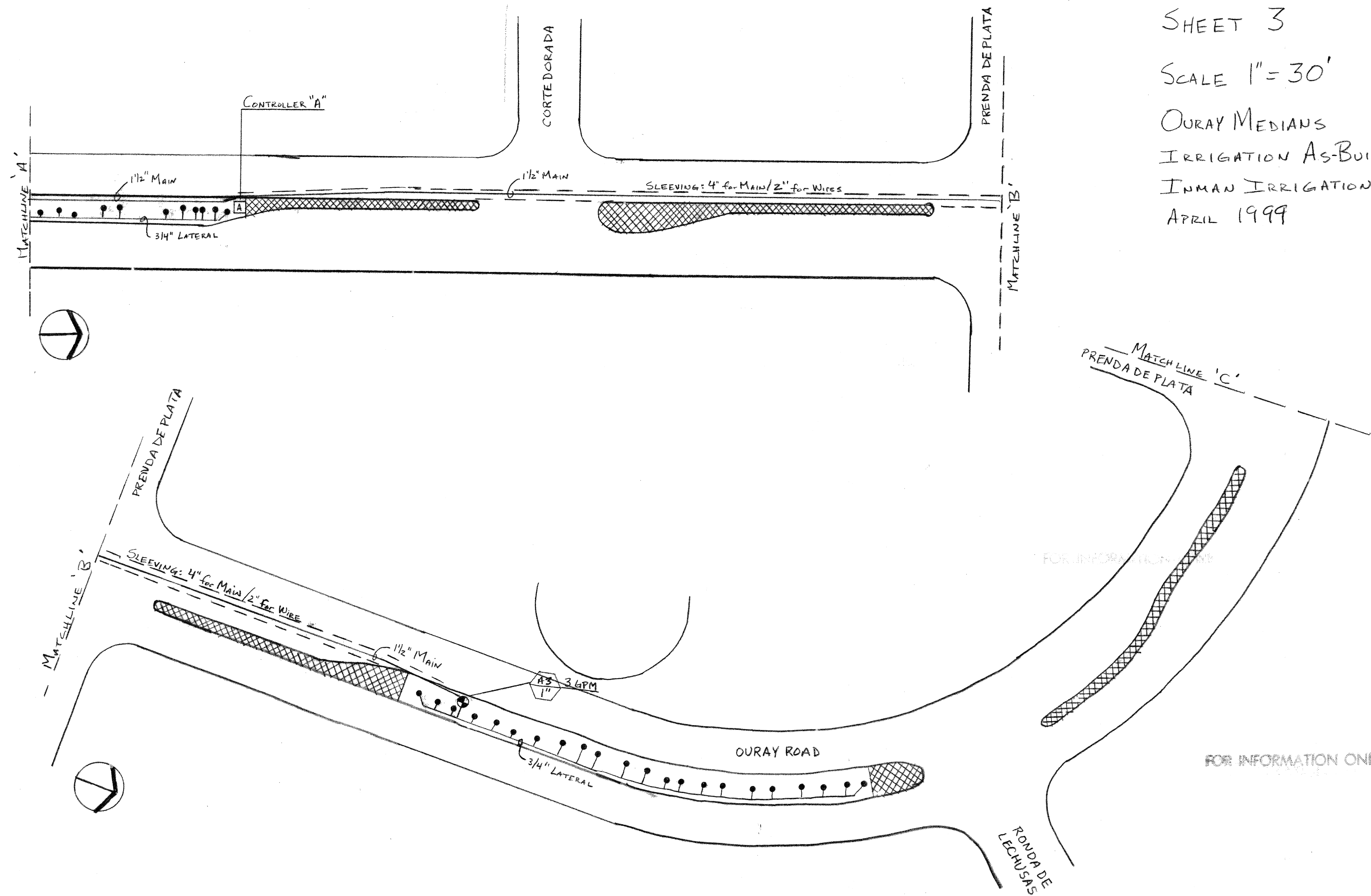

SHEET 3

SCALE 1" = 30'

OURAY MEDIANS
IRRIGATION AS-BUILT
INMAN IRRIGATION INC.
APRIL 1999

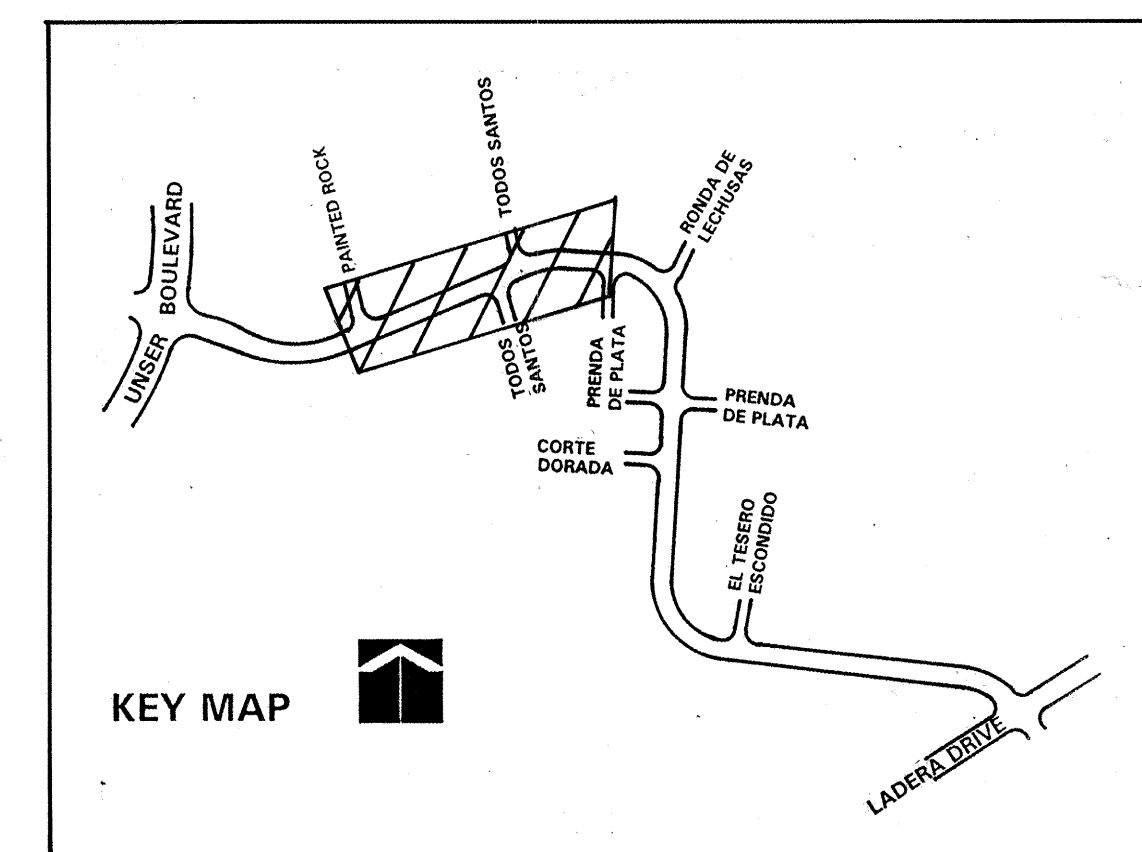

- ### IRRIGATION CONSTRUCTION NOTES
- 1 Irrigation point-of-connection. Tap existing 12" PVC waterline and install meter per City of Albuquerque details and specifications.
 - 2 Irrigation point-of-connection. Tap existing 12" cast iron waterline and install meter per City of Albuquerque details and specifications.
 - 3 Controller location - see Irrigation Legend. Final location shall be coordinated in the field with the Owner's Representative.
 - 4 Backflow preventer/master valve location - see Irrigation Legend. Final location shall be coordinated in the field with the Owner's Representative.

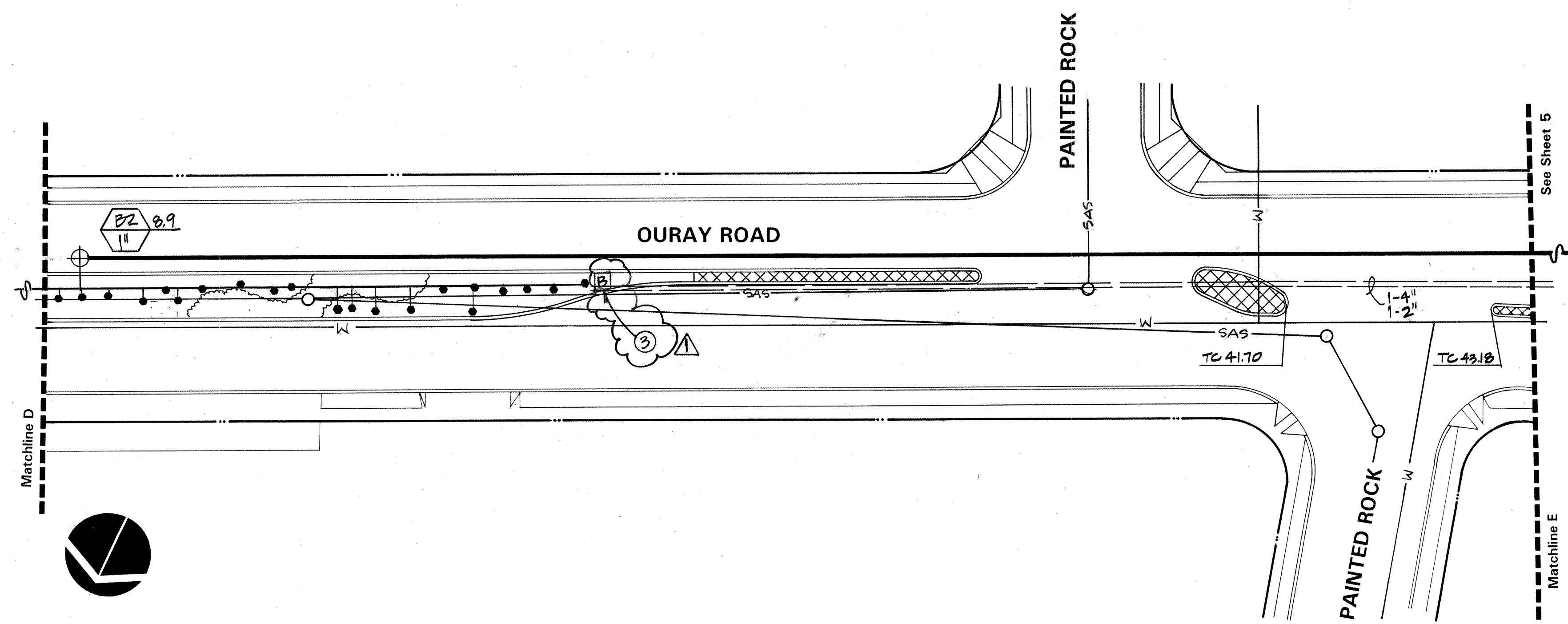

FOR INFORMATION ONLY

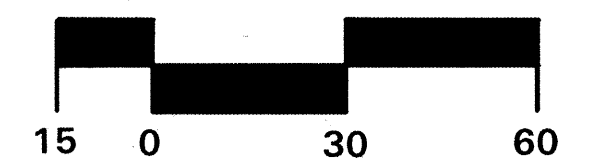

 CONSENSUS	PLANNING	CONSENSUS PLANNING, INC. <i>Planning / Landscape Architecture</i> 924 Park Avenue SW Albuquerque, NM 87102 (505) 764-9801 Fax 842-5495		10-22-20					NO. DATE	DESIGNED BY	DRAWN BY	CHECKED BY
CITY OF ALBUQUERQUE CAPITAL IMPLEMENTATION PROGRAM LANDSCAPE ARCHITECTURE & CONSTRUCTION SERVICES												
TITLE: OURAY ROAD MEDIAN LANDSCAPE IMPROVEMENTS IRRIGATION PLAN												
Design Review Committee		City Engineer Approval		Last Design Update	Mo. / Day / Yr.		Mo. / Day / Yr.					
City Project No.				Zone Map No.		Sheet		Of				
5793.91				G,H-10		4		11				

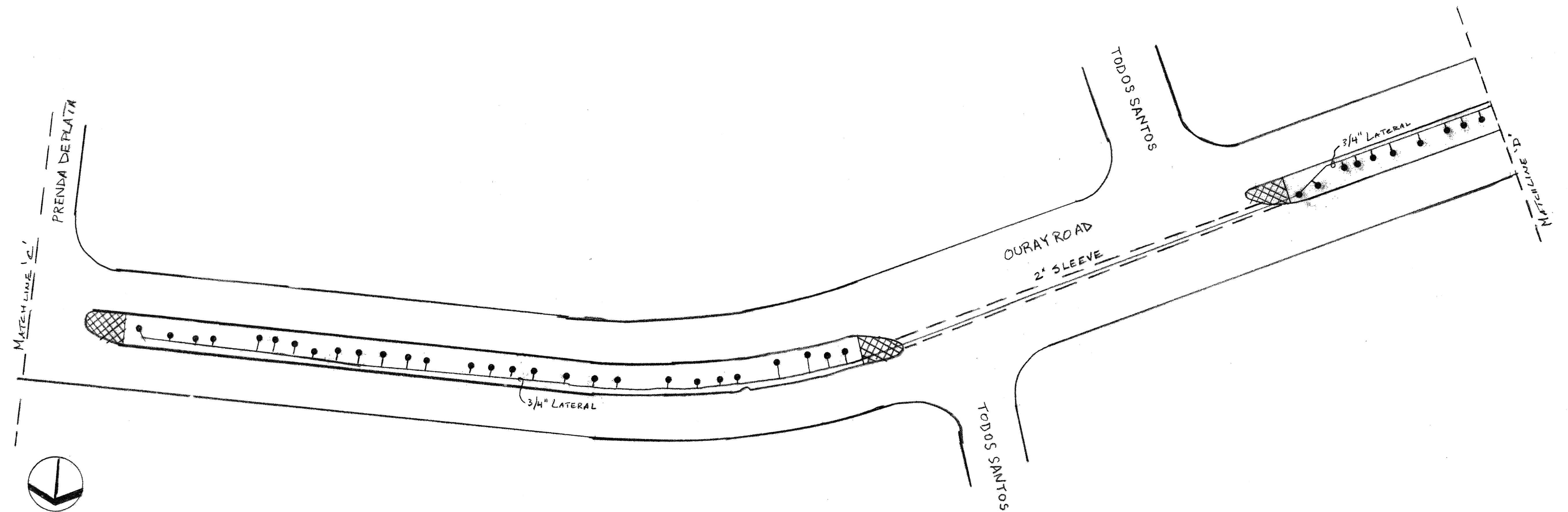

SHEET 2

SCALE 1" = 30'

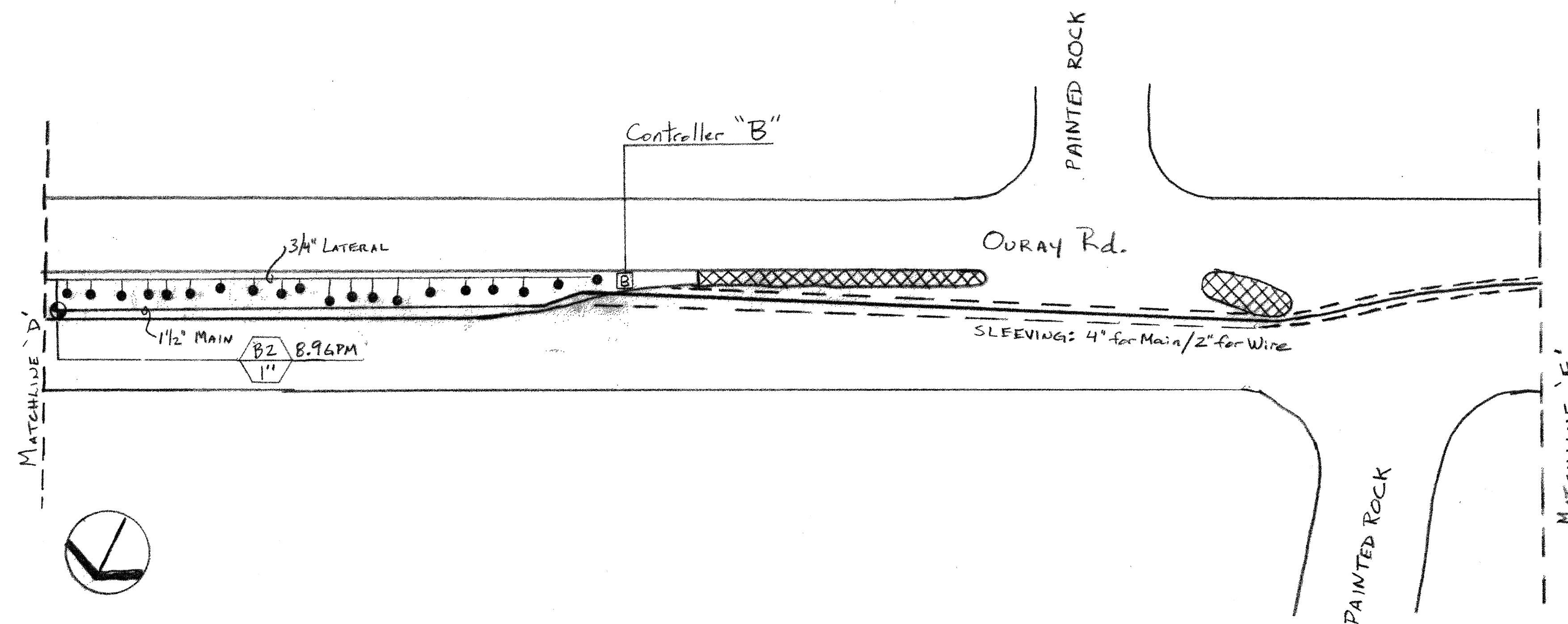

OURAY MEDIANS
IRRIGATION AS BUILT
INMAN IRRIGATION INC.
APRIL 1999

FOR INFORMATION ONLY

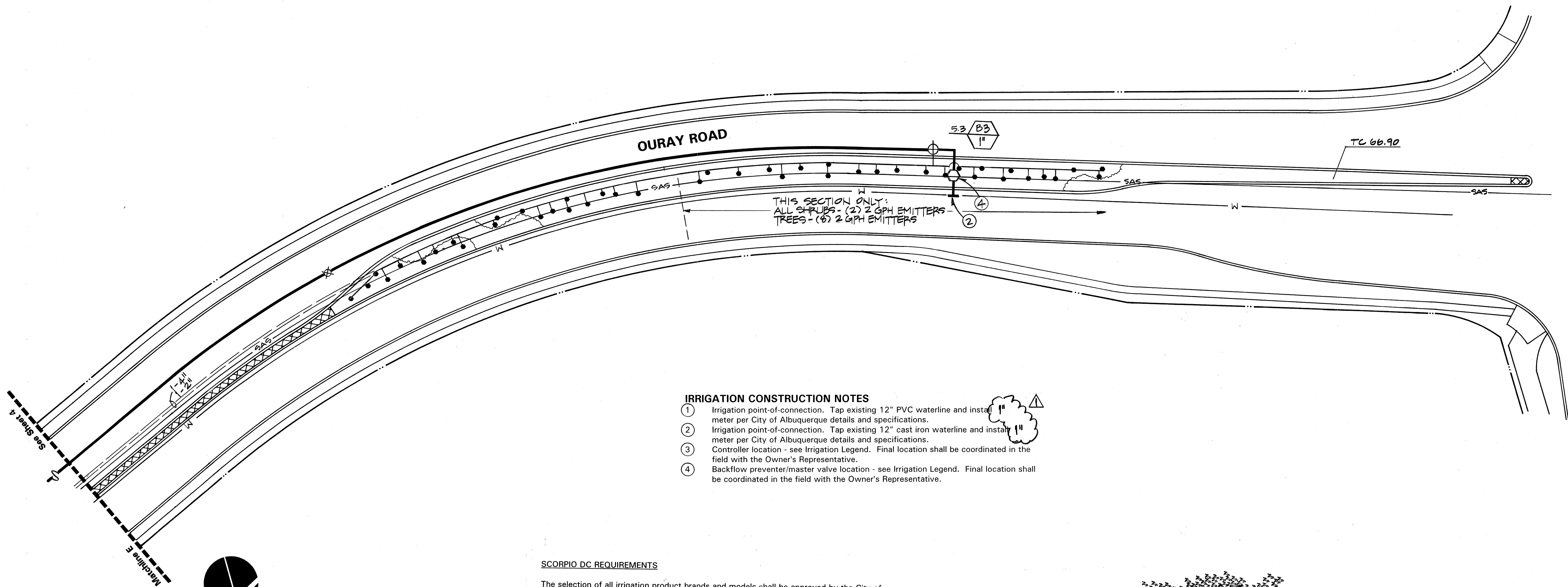

- IRRIGATION CONSTRUCTION NOTES**
1. Irrigation point-of-connection. Tap existing 12" PVC waterline and install meter per City of Albuquerque details and specifications.
 2. Irrigation point-of-connection. Tap existing 12" cast iron waterline and install meter per City of Albuquerque details and specifications.
 3. Controller location - see Irrigation Legend. Final location shall be coordinated in the field with the Owner's Representative.
 4. Backflow preventer/master valve location - see Irrigation Legend. Final location shall be coordinated in the field with the Owner's Representative.

SCORPIO DC REQUIREMENTS

The selection of all irrigation product brands and models shall be approved by the City of Albuquerque prior to the beginning of the project.

Wire:
A. Wire for the 24 volt wiring shall be solid copper wire, PVC insulated, UL approved underground feeder wire for direct burial in ground. Common wires shall be #12 white, except as noted on drawings. The wire shall be supplied in either 500' or 2,500' rolls. The control wires shall be #14 of any color other than white unless otherwise indicated on drawings.

B. All wire splices shall be made water-tight using 3M Scotchlok connectors.

Controller:
A. Motorola Scorpio DC, mounted in Toro stainless steel cabinet with external antenna.

B. Scorpio DC to operate as a remote unit to an Irrinet remote ready controller located at Laurelwood Park, with proper frequency installed by a certified Motorola Service Facility.

C. Scorpio DC requires a 10 watt solar panel with regulator as manufactured by Hitney, Inc.

D. Scorpio DC requires a 10 amp hour rechargeable battery.

E. Simpson Norton Corporation will provide technical service support at 800-727-5588.

F. One common wire to be installed per four (4) automatic remote valves.

G. Use Toro shielded communication cable between Master Meter flow meter and Scorpio DC.

H. Each ground resistance test must show 10 ohms or less. Testing will be done with a Biddle Megger earth ground resistance tester, no substitutes unless approved by Motorola.

Radio Communications:

A. When installing the Scorpio DC with the radio link to an Irrinet, the following services and procedures must be provided for by an authorized Motorola service provider:

1. A radio path evaluation to analyze the location with reference to the host irrinet.

Note: It is recommended that wire distance to the DC-valve solenoid not exceed 1,000' (300 m) on #14-1 UF wire and 1,200' (360 m) on #12-1 UF wire.

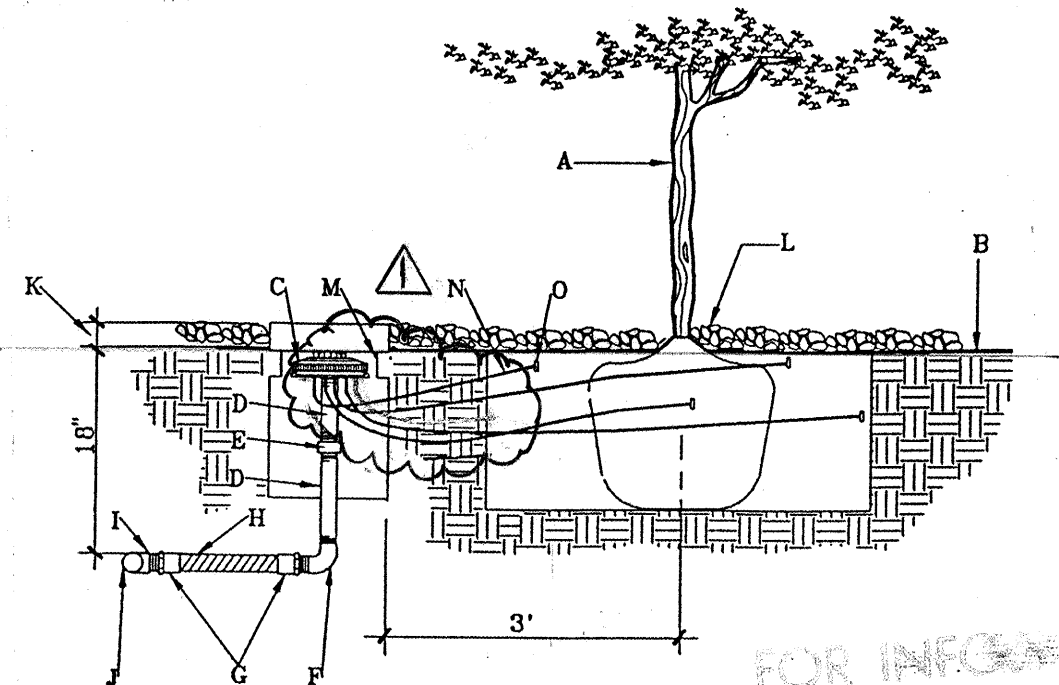

GENERAL NOTES:

1. LATERAL LINE PRESSURE TESTING SHALL BE COMPLETED PRIOR TO INSTALLATION OF FLEX PIPE ASSEMBLY. LATERAL LINE TESTING SHALL BE ACCOMPLISHED BY INSTALLING A PLUG IN THE OUTLET OF LATERAL LINE TEES AND ELLS.
2. BUBBLER SHALL ALWAYS BE INSTALLED ON THE UPHILL SIDE OF THE TREE.

CONSTRUCTION NOTES:

- A. TREE.
- B. FINISH GRADE.
- C. XERI-BIRD 8 MULTI-OUTLET EMITTER MODEL # XBD-81 (REFERENCE IRRIGATION LEGEND).
- D. SCH. 80 PVC NIPPLE.
- E. SCH. 40 PVC THREADED COUPLER.
- F. SCH. 40 PVC THREADED ELL.
- G. SCH. 40 PVC MIP ADAPTER.
- H. PVC FLEXIBLE VINYL PIPE, STD., IPS FROM AGRICULTURAL PRODUCTS INC. (818-768-2303).
- I. SCH. 40 PVC SXSXT TEE OR SXT ELL.
- J. LATERAL PIPE.
- K. TOP OF EMITTER BOX LID LEVEL WITH TOP OF MULCH OR MAX. 1" ABOVE TOP OF MULCH. SEE PLAN FOR TYPE OF MULCH.
- L. 4" MULCH. SEE PLAN FOR TYPE OF MULCH.
- M. XERI-BIRD SUBTERRANEAN EMITTER BOX MODEL # SEB-6.
- N. 1/4" VINYL DISTRIBUTION TUBING TO BE PLACED, 8" AROUND TREE, 2 AROUND SHRUBS.
- O. XERI-BIRD DIFFUSER BUG CAP MODEL # DBC-025.

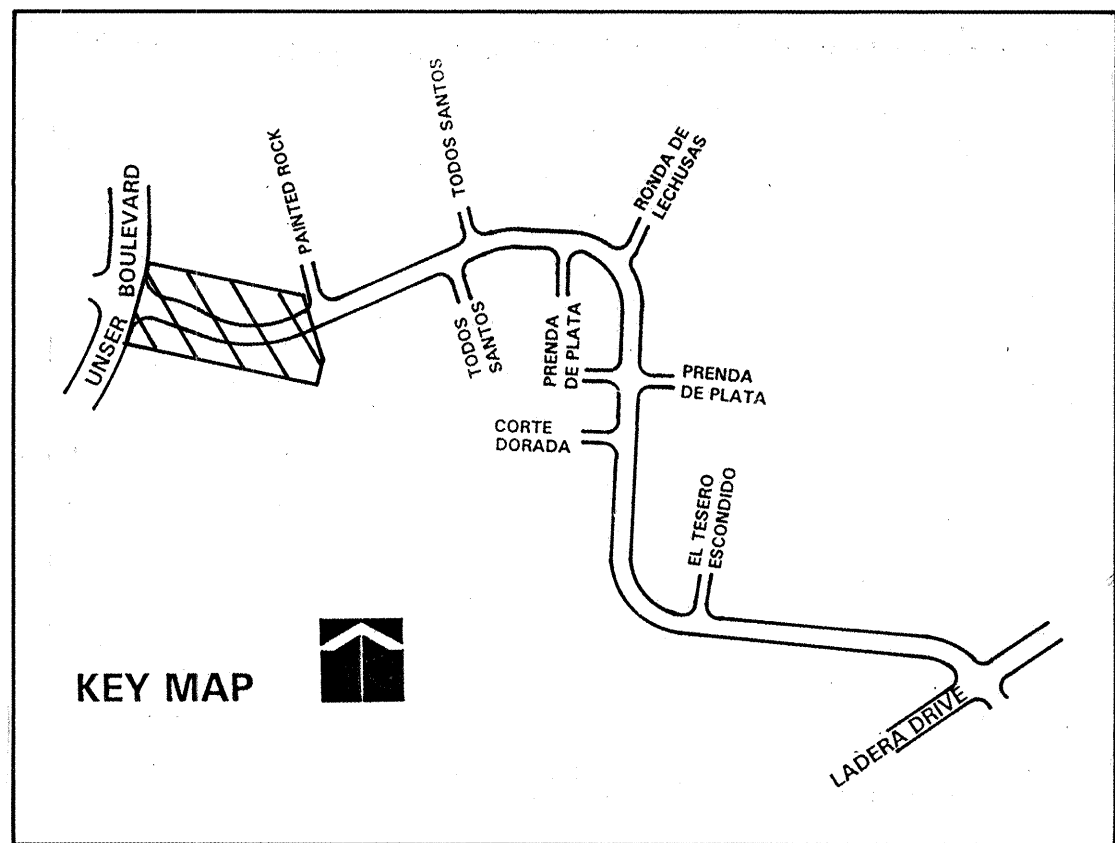

UNSER BOULEVARD

AS BUILT INFORMATION	
CONTRACTOR	
WORK STAGED BY	DATE
FIELD ACCEPTANCE BY	DATE
FIELD CORRECTION BY	DATE
DRAWINGS CORRECTED BY	DATE
MICRO-FILM INFORMATION	
RECORDED BY	DATE
NO.	

SURVEY INFORMATION	
FIELD NOTES	DATE
NO.	BY

ENGINEER'S SEAL	
STATE OF NEW MEXICO	
CHRISTOPHER J. GREEN	
234	
REGISTERED LANDSCAPE ARCHITECT	
6-18-198	

PARK MANAGEMENT COMMENTS	
CO	BY

REVISIONS	
NO.	DATE
DESIGNED BY	DATE
DRAWN BY	DATE
CHECKED BY	DATE

CONSENSUS PLANNING, INC.
Planning / Landscape Architecture
924 Park Avenue SW
Albuquerque, NM 87102
(505) 764-9801 Fax 842-5495

CITY OF ALBUQUERQUE
CAPITAL IMPLEMENTATION PROGRAM
LANDSCAPE ARCHITECTURE & CONSTRUCTION SERVICES

TITLE: OURAY ROAD MEDIAN LANDSCAPE IMPROVEMENTS
IRRIGATION PLAN

Design Review Committee City Engineer Approval

City Project No. **5793.91** Zone Map No. **G,H-10** Sheet **5** OF **11**

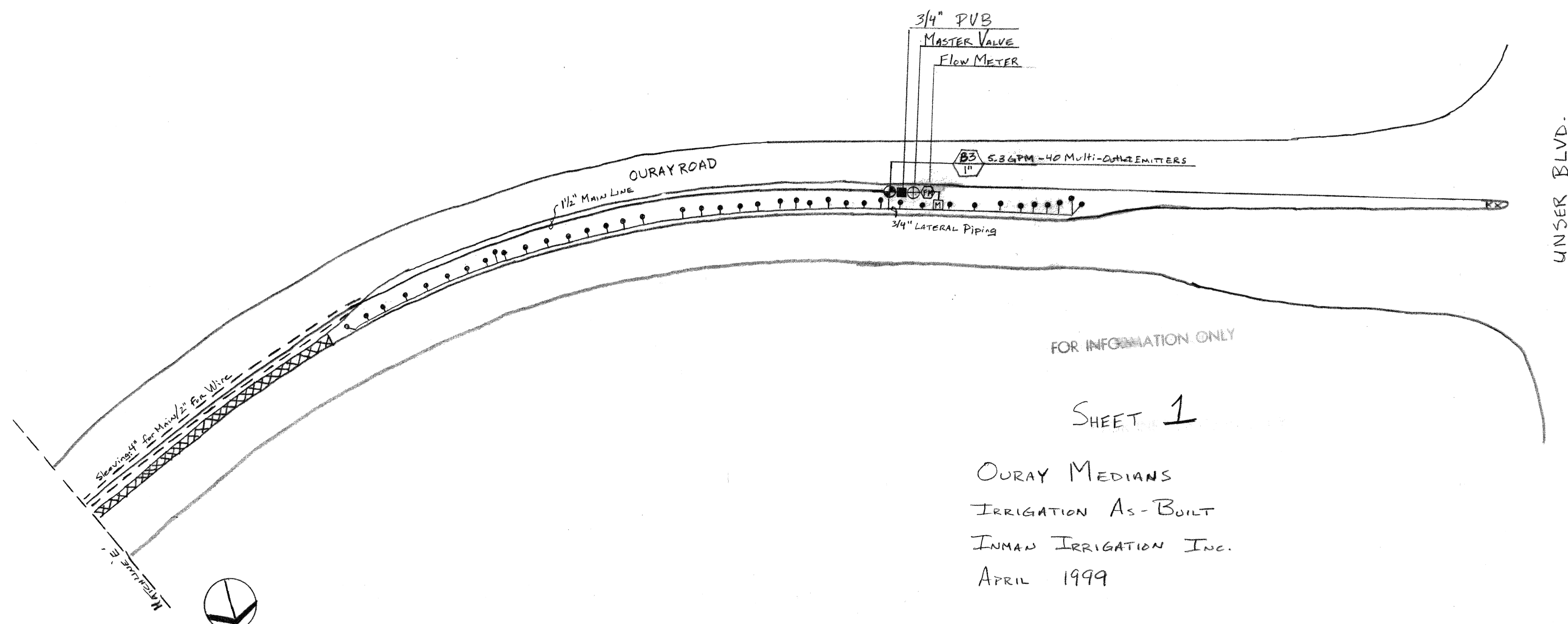

SHEET 1

OURAY MEDIANS
IRRIGATION AS-BUILT
INMAN IRRIGATION INC.
APRIL 1999

Scale 1" = 30'

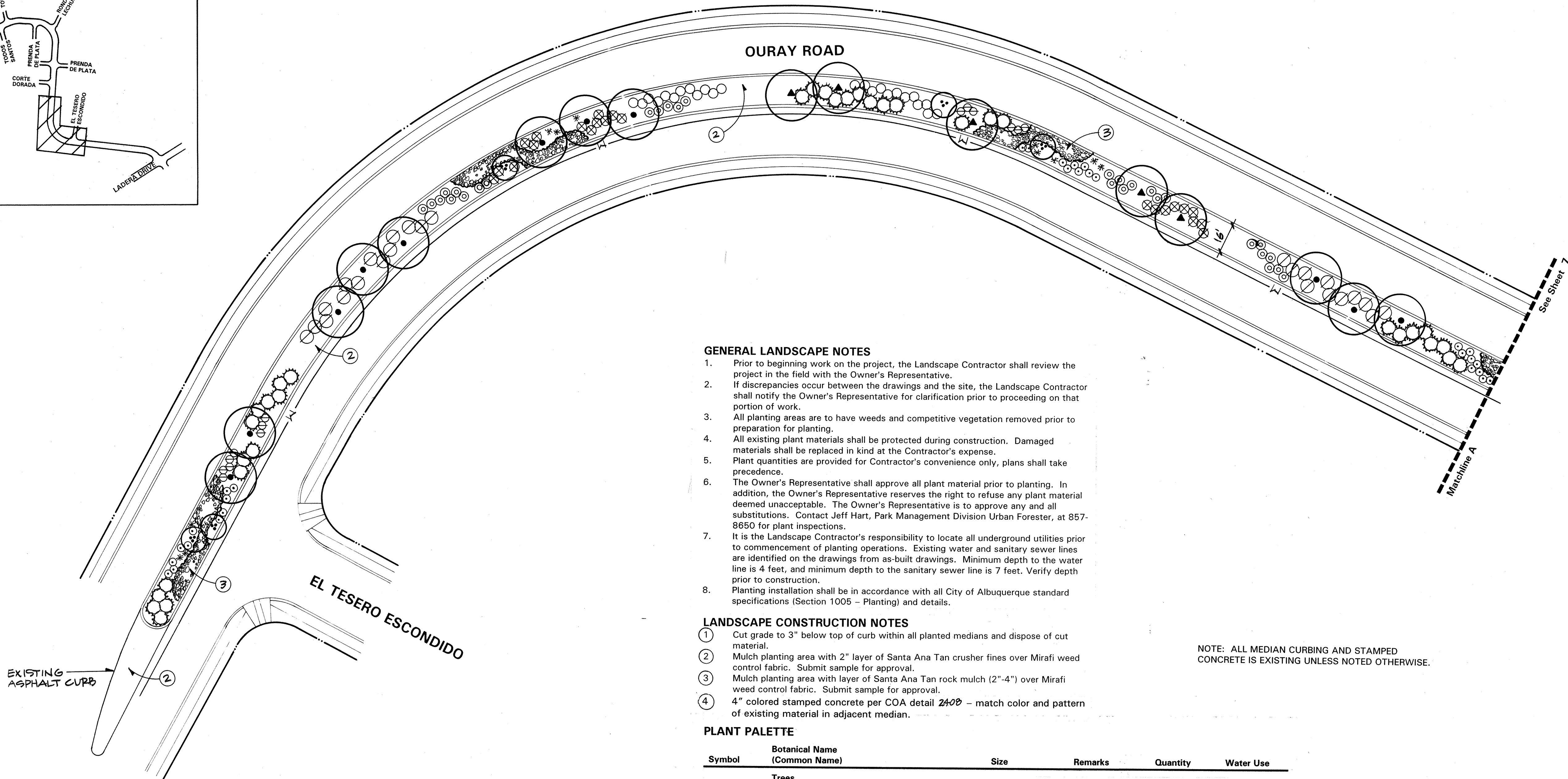
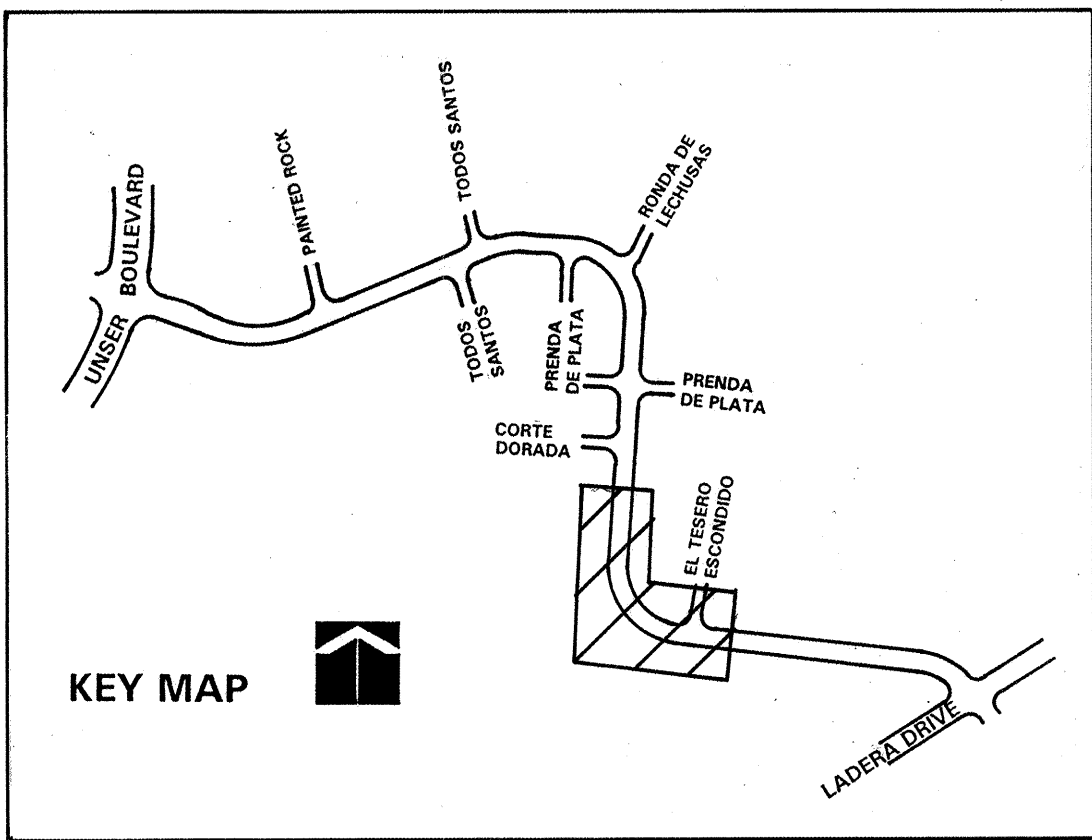

GENERAL LANDSCAPE NOTES

1. Prior to beginning work on the project, the Landscape Contractor shall review the project in the field with the Owner's Representative.
2. If discrepancies occur between the drawings and the site, the Landscape Contractor shall notify the Owner's Representative for clarification prior to proceeding on that portion of work.
3. All planting areas are to have weeds and competitive vegetation removed prior to preparation for planting.
4. All existing plant materials shall be protected during construction. Damaged materials shall be replaced in kind at the Contractor's expense.
5. Plant quantities are provided for Contractor's convenience only, plans shall take precedence.
6. The Owner's Representative shall approve all plant material prior to planting. In addition, the Owner's Representative reserves the right to refuse any plant material deemed unacceptable. The Owner's Representative is to approve any and all substitutions. Contact Jeff Hart, Park Management Division Urban Forester, at 857-8650 for plant inspections.
7. It is the Landscape Contractor's responsibility to locate all underground utilities prior to commencement of planting operations. Existing water and sanitary sewer lines are identified on the drawings from as-built drawings. Minimum depth to the water line is 4 feet, and minimum depth to the sanitary sewer line is 7 feet. Verify depth prior to construction.
8. Planting installation shall be in accordance with all City of Albuquerque standard specifications (Section 1005 - Planting) and details.

LANDSCAPE CONSTRUCTION NOTES

1. Cut grade to 3 inch below top of curb within all planted medians and dispose of cut material.
2. Mulch planting area with 2 inch layer of Santa Ana Tan crusher fines over Mirafi weed control fabric. Submit sample for approval.
3. Mulch planting area with layer of Santa Ana Tan rock mulch (2 inch-4 inch) over Mirafi weed control fabric. Submit sample for approval.
4. 4 inch colored stamped concrete per COA detail 2400 - match color and pattern of existing material in adjacent median.

NOTE: ALL MEDIAN CURBING AND STAMPED CONCRETE IS EXISTING UNLESS NOTED OTHERWISE.

PLANT PALETTE

Symbol	Botanical Name (Common Name)	Size	Remarks	Quantity	Water Use
Trees					
	Forestiera neomexicana (New Mexico Olive)	15 Gallon	Nursery Grown	19	Medium
	Fraxinus oxycarpa 'Raywood' (Raywood Ash)	1-1/2" B&B	12-14' Height 4-6' Spread	19	High
	Gleditsia triacanthos 'Skyline' (Skyline Honeylocust)	1-1/2" B&B	12-14' Height 4-6' Spread	21	High
Shrubs & Groundcovers					
	Baccharis 'Starn-Thompson' (Dwarf Coyotebush)	5 Gallon	4' o.c. 3' ht. x 4' spr.	86	Medium
	Chrysothamnus nauseosus (Chamisa)	1 Gallon	4' o.c. 4' ht. x 4' spr.	78	Low
	Cytisus x 'Lena' (Lena's Broom)	1 Gallon	4' o.c. 3' ht. x 3' spr.	44	Medium
	Hesperaloe parviflora (Red Yucca)	1 Gallon	4' o.c. min. 4' ht. x 3' spr.	39	Medium
	Juniperus sabina 'Buffalo' (Buffalo Juniper)	5 Gallon	6' o.c. 1' ht. x 8' spr.	104	Medium
	Perovskia atriplicifolia (Russian Sage)	1 Gallon	6' o.c. 3' ht. x 3' spr.	58	Medium
	Salvia greggii (Autumn Sage)	1 Gallon	3' o.c. 3' ht. x 3' spr.	76	Medium
	Chrysactinia mexicana (Damianita)	1 Gallon	2' o.c. 2' ht. x 2' spr.	97	Low

FOR INFORMATION ONLY 15 0 30 60

 **CONSENSUS PLANNING, INC.**
Planning / Landscape Architecture
924 Park Avenue SW
Albuquerque, NM 87102
(505) 764-9801 Fax 842-5495

CITY OF ALBUQUERQUE CAPITAL IMPLEMENTATION PROGRAM LANDSCAPE ARCHITECTURE & CONSTRUCTION SERVICES	
TITLE: OURAY ROAD MEDIAN LANDSCAPE IMPROVEMENTS PLANTING PLAN	
Design Review Committee	City Engineer Approval
City Project No. 5793.91	Zone Map No. G,H-10
Sheet 6	Of 11

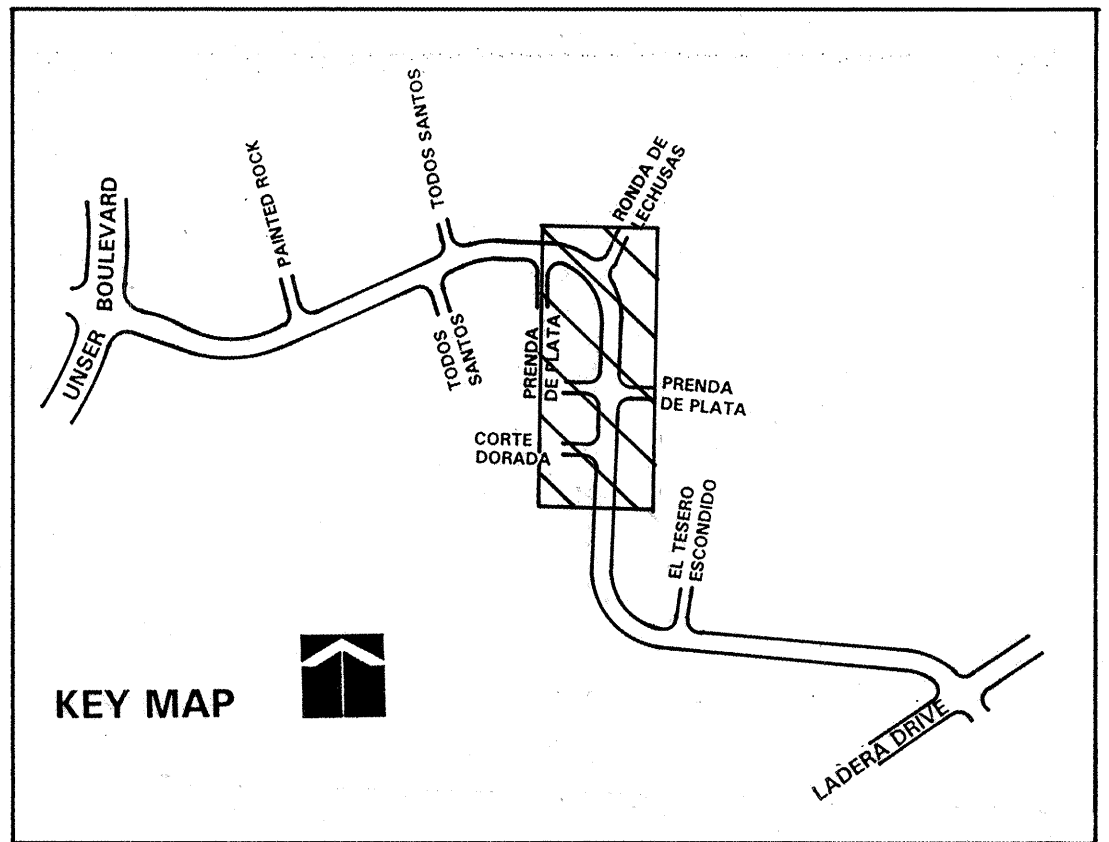
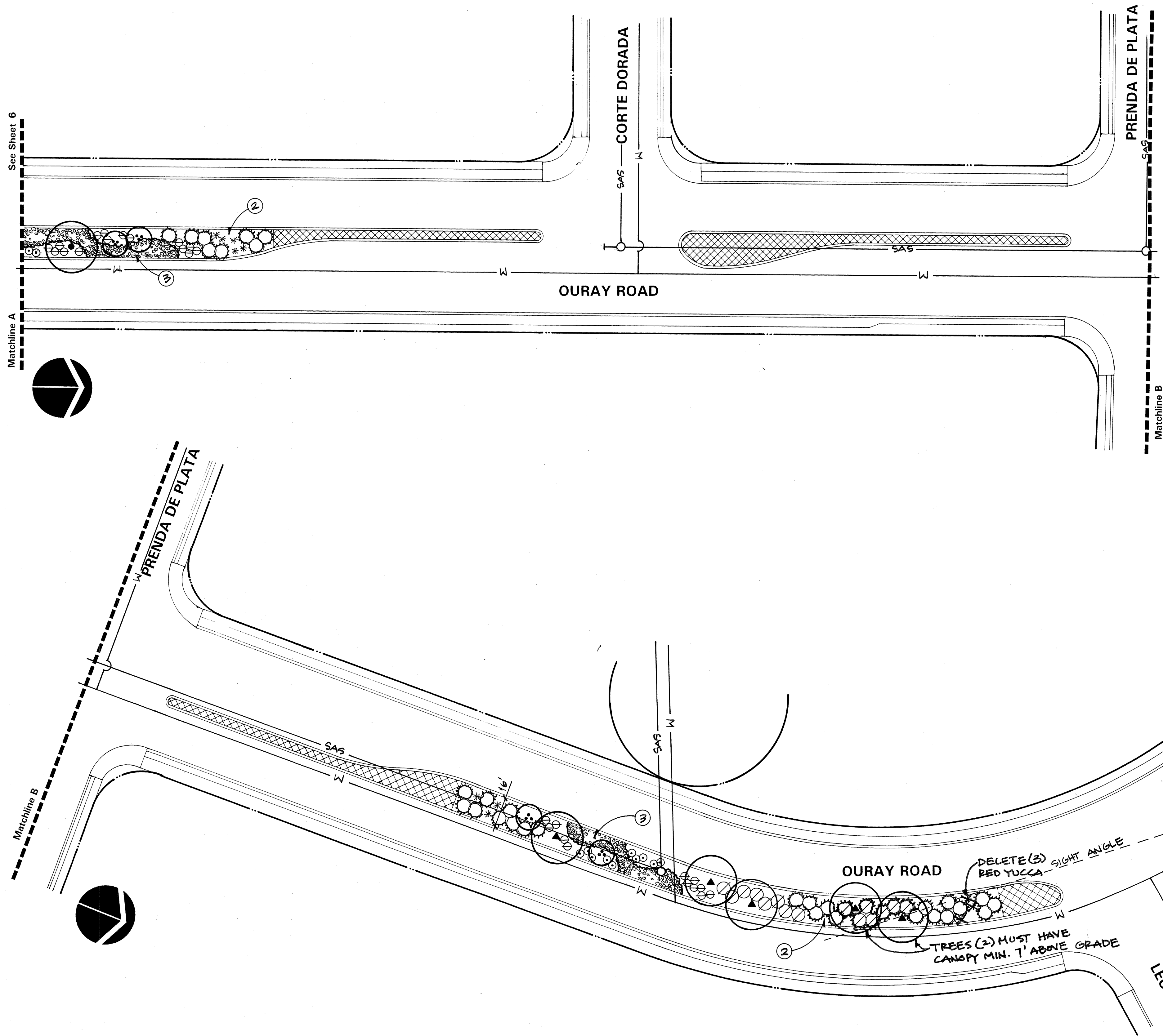

- LANDSCAPE CONSTRUCTION NOTES**
- 1 Cut grade to 3" below top of curb within all planted medians and dispose of cut material.
 - 2 Mulch planting area with 2" layer of Santa Ana Tan crusher fines over Mirafi weed control fabric. Submit sample for approval.
 - 3 Mulch planting area with layer of Santa Ana Tan rock mulch (2"-4") over Mirafi weed control fabric. Submit sample for approval.
 - 4 4" colored stamped concrete per COA detail 2408 - match color and pattern of existing material in adjacent median.

FOR INFORMATION ONLY

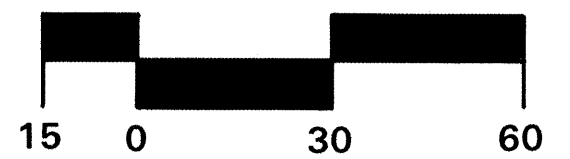

CONSENSUS PLANNING, INC.
 Planning / Landscape Architecture
 924 Park Avenue SW
 Albuquerque, NM 87102
 (505) 764-9801 Fax 842-5495

CITY OF ALBUQUERQUE
 CAPITAL IMPLEMENTATION PROGRAM
 LANDSCAPE ARCHITECTURE & CONSTRUCTION SERVICES

TITLE: OURAY ROAD MEDIAN LANDSCAPE IMPROVEMENTS PLANTING PLAN

Design Review Committee	City Engineer Approval	Rev. / Day / Yr.	Rev. / Day / Yr.

City Project No. **5793.91** Zone Map No. **G,H-10** Sheet **7** of **11**

AS BUILT INFORMATION			
CONTRACTOR	WORK	DATE	
	STAKED BY	DATE	
	ASPECT DATE	DATE	
	FIELD DATE	DATE	
	REVISION DATE	DATE	
	CORRECTED BY	DATE	
MICRO-FILM INFORMATION			
RECORDED BY	NO.	DATE	

BENCH MARKS			

SURVEY INFORMATION			
FIELD NOTES	NO.	BY	DATE

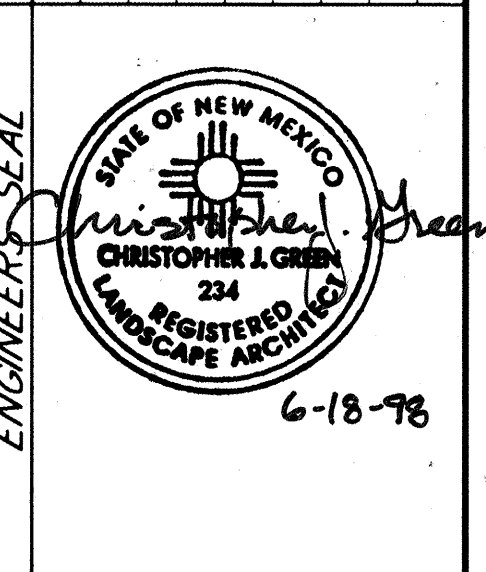

REVISIONS			
NO.	DATE	REMARKS	BY

DESIGNED BY	DATE	2/98
DRAWN BY	DATE	2/98
CHECKED BY	DATE	2/98

Matchline C
See Sheet 7
PRENDA DE PLATA

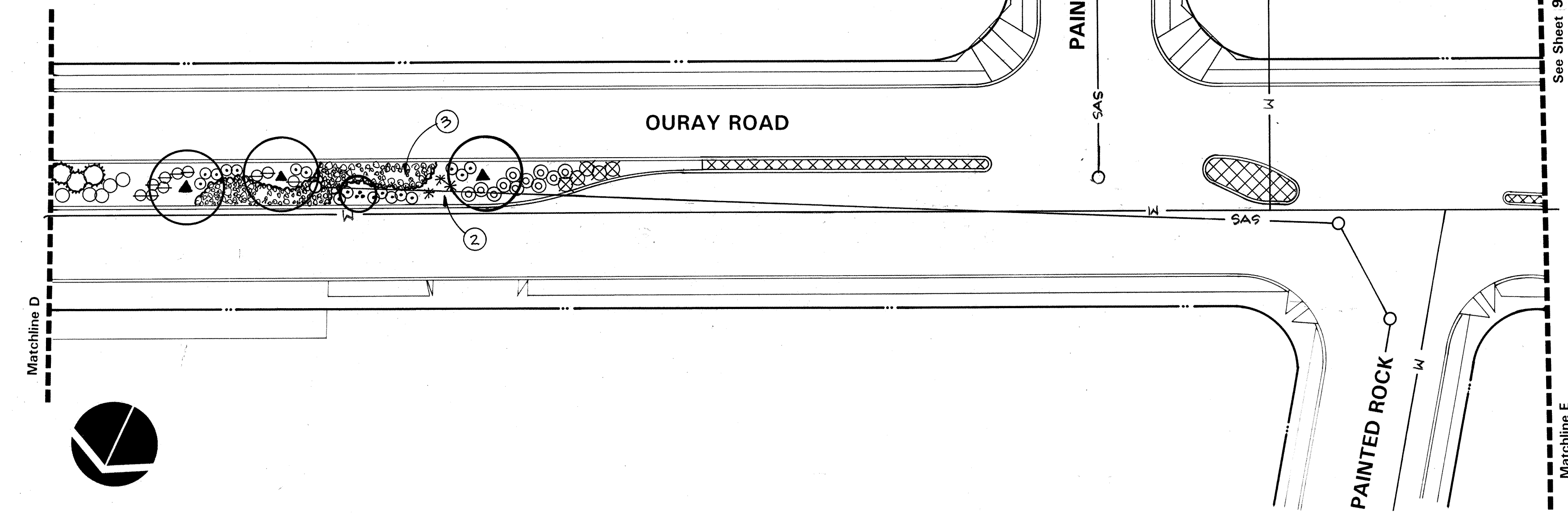
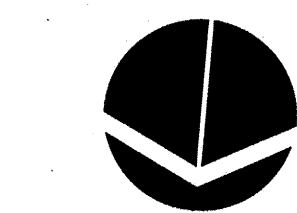

TODOS SANTOS
OURAY ROAD
TODOS SANTOS

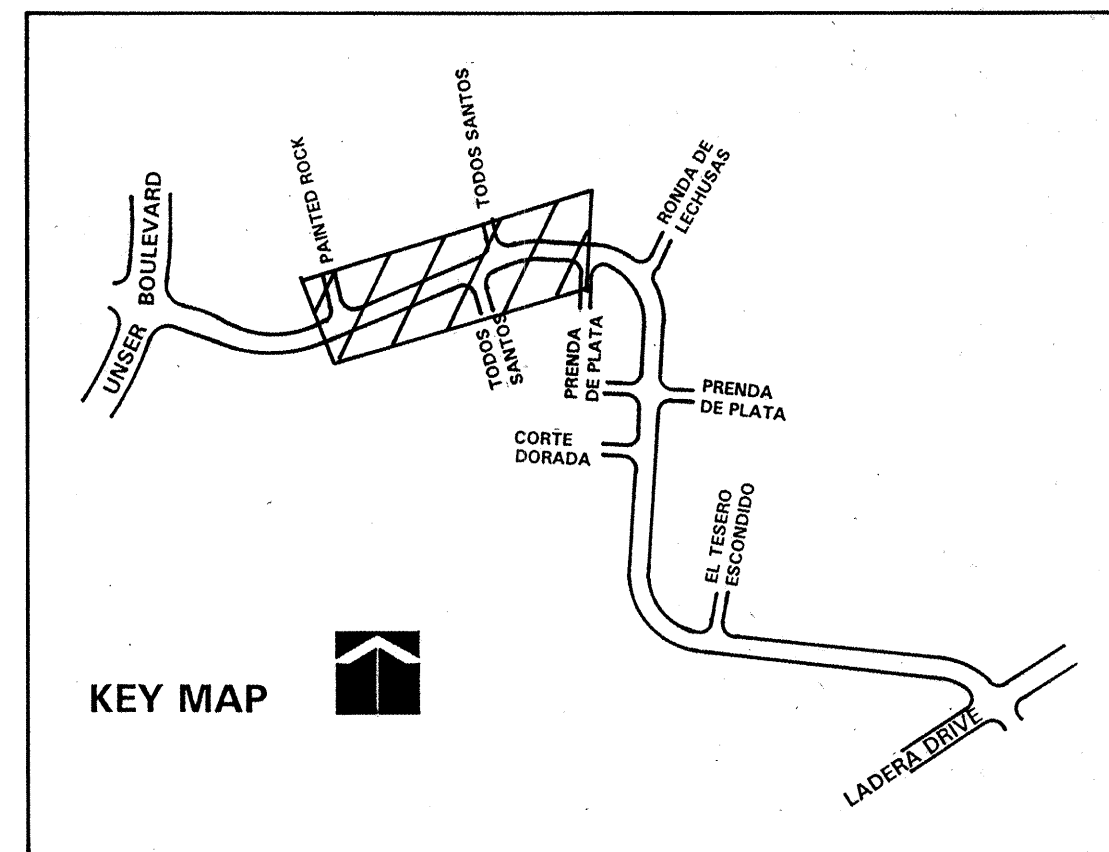

LANDSCAPE CONSTRUCTION NOTES

- 1 Cut grade to 3" below top of curb within all planted medians and dispose of cut material.
- 2 Mulch planting area with 2" layer of Santa Ana Tan crusher fines over Mirafi weed control fabric. Submit sample for approval.
- 3 Mulch planting area with layer of Santa Ana Tan rock mulch (2"-4") over Mirafi weed control fabric. Submit sample for approval.
- 4 4" colored stamped concrete per COA detail 24-08 - match color and pattern of existing material in adjacent median.

FOR INFORMATION ONLY

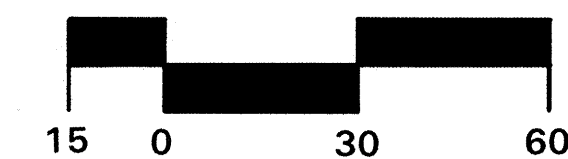

CONSENSUS PLANNING, INC.
Planning / Landscape Architecture
924 Park Avenue SW
Albuquerque, NM 87102
(505) 764-9801 Fax 842-5495

CITY OF ALBUQUERQUE CAPITAL IMPLEMENTATION PROGRAM LANDSCAPE ARCHITECTURE & CONSTRUCTION SERVICES	
TITLE: OURAY ROAD MEDIAN LANDSCAPE IMPROVEMENTS PLANTING PLAN	
Design Review Committee	City Engineer Approval
Last Design Update	
City Project No.	Zone Map No.
5793.91	G,H-10
Sheet	Of
8	11

F PROGRAM SECTION SERVICES									
CAPE IMPROVEMENTS AN									
Design Update	No. / Day / Yr.			No. / Day / Yr.					
								MICRO-FILM INFORMATION	
								RECORDED BY	
								NO.	
								</	

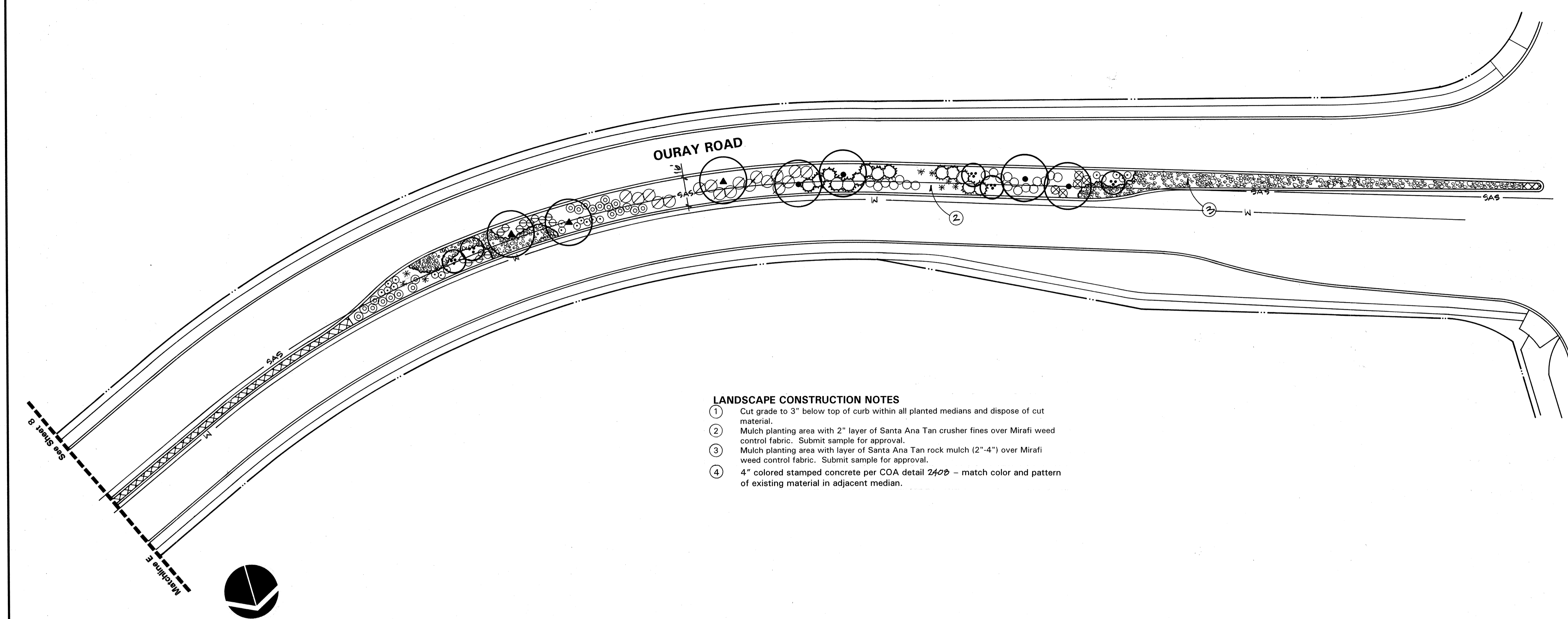

LANDSCAPE CONSTRUCTION NOTES

- ① Cut grade to 3" below top of curb within all planted medians and dispose of cut material.
- ② Mulch planting area with 2" layer of Santa Ana Tan crusher fines over Mirafi weed control fabric. Submit sample for approval.
- ③ Mulch planting area with layer of Santa Ana Tan rock mulch (2"-4") over Mirafi weed control fabric. Submit sample for approval.
- ④ 4" colored stamped concrete per COA detail 2400 - match color and pattern of existing material in adjacent median.

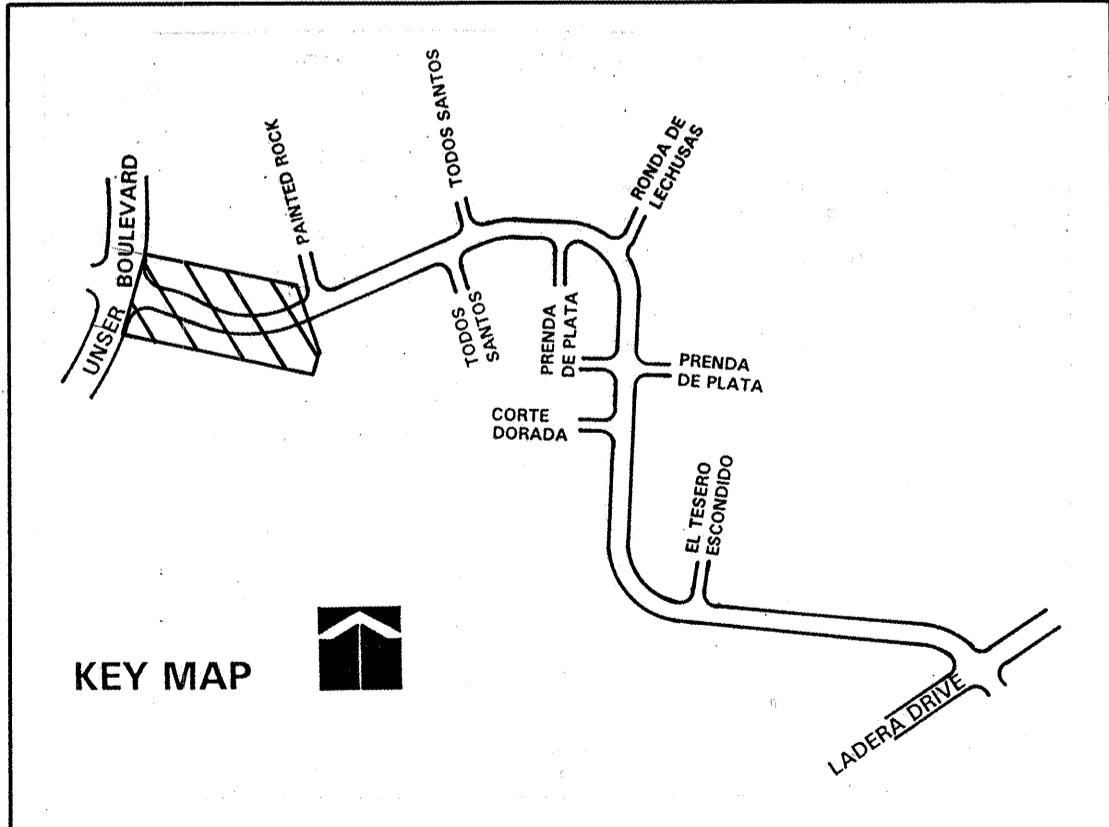

FOR INFORMATION ONLY

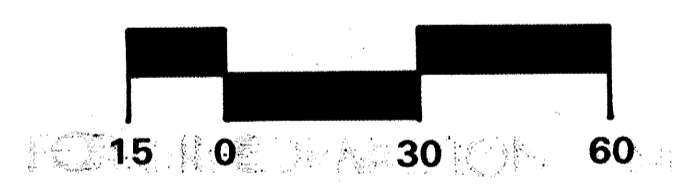

CONSensus PLANNING, INC.
Planning / Landscape Architecture
924 Park Avenue SW
Albuquerque, NM 87102
(505) 764-9801 Fax 842-5495

CITY OF ALBUQUERQUE
CAPITAL IMPLEMENTATION PROGRAM
LANDSCAPE ARCHITECTURE & CONSTRUCTION SERVICES

TITLE: **OURAY ROAD MEDIAN LANDSCAPE IMPROVEMENTS**
PLANTING PLAN

Design Review Committee	City Engineer Approval	Last Design Update	11/11/11	11/11/11

City Project No. **5793.91** Zone Map No. **G,H-10** Sheet **9** OF **11**

ENGINEER'S SEAL		SURVEY INFORMATION		BENCH MARKS		AS-BUILT INFORMATION	
		NO.	DATE	CONTRACTOR	DATE	WORK STAGED BY	DATE
						ACCEPTANCE BY	DATE
						FIELD LOCATION BY	DATE
						DRAWINGS CORRECTED BY	DATE
						RECORDED BY	DATE
						NO.	

CONSTRUCTION TRAFFIC CONTROL GENERAL NOTES

1. CONTRACTOR MUST OBTAIN FROM CONSTRUCTION COORDINATION AN EXCAVATION/BARRICADING PERMIT BEFORE ENGAGING IN ANY CONSTRUCTION, MAINTENANCE OR REPAIR WORK IN ANY OF THE CITY OF ALBUQUERQUE'S RIGHTS-OF-WAY. EMERGENCY WORK THAT WOULD PRESERVE LIFE OR PROPERTY IS EXCLUDED WITHIN THE UNDERSTANDING, THAT A PERMIT SHALL BE OBTAINED WITHIN 24 TO 48 HOURS.

2. CONTRACTOR SHALL AT THE TIME OF PERMIT REQUEST, SUBMIT FOR APPROVAL BY CONSTRUCTION COORDINATION, A TRAFFIC CONTROL PLAN DETAILING ALL EXISTING TOPOGRAPHY SUCH AS LANE WIDTHS, DRIVEWAYS, AND BUSINESS/RESIDENTIAL ACCESSES. THE TRAFFIC CONTROL PLAN SHALL INCLUDE ALL PHASES OF WORK AND SCHEDULES INVOLVED IN THE CONSTRUCTION PROJECT. ANY SEPARATE PHASES OF A CONSTRUCTION PROJECT SHALL BE GIVEN AN INDIVIDUAL PERMIT EACH. BLANKET PERMITS WILL NOT BE ISSUED.

3. THESE TYPICAL TRAFFIC CONTROL PLANS DO NOT REFLECT THE EXISTING TOPOGRAPHY SUCH AS DRIVEWAYS, LANE WIDTHS, AND BUSINESS/RESIDENTIAL ACCESSES. EVERY LOCATION THAT REQUIRES CONSTRUCTION TRAFFIC CONTROL SHALL HAVE A DETAILED TRAFFIC CONTROL PLAN SHOWING ALL EXISTING TOPOGRAPHY.

4. CONSTRUCTION SHALL NOT BEGIN UNLESS A TRAFFIC CONTROL PLAN HAS BEEN APPROVED AND VERIFIED BY CONSTRUCTION COORDINATION.

5. CONSTRUCTION COORDINATION SHALL BE NOTIFIED 48 HOURS PRIOR TO ANY TRAFFIC CONTROL CHANGES NEEDED BY CONTRACTOR, THAT WERE NOT PREVIOUSLY APPROVED. THESE TRAFFIC CONTROL CHANGES SHALL BE REQUESTED IN WRITING ACCOMPANIED WITH A TRAFFIC CONTROL PLAN REFLECTING SUCH CHANGES.

6. ALL CONSTRUCTION TRAFFIC CONTROL DEVICES SHALL COMPLY TO THE MANUAL ON UNIFORM TRAFFIC CONTROL DEVICES (MUTCD), LATEST EDITION. IT IS THE RESPONSIBILITY OF THE CONTRACTOR TO INSTALL, SERVICE AND MAINTAIN ALL TRAFFIC CONTROL DEVICES. TRAFFIC CONTROL DEVICES SHALL NOT BE REMOVED OR ALTERED IN ANY WAY WITHOUT THE APPROVAL OF CONSTRUCTION COORDINATION, PER SECTION 6A-4 OF THE MUTCD, LATEST EDITION.

7. THE CONSTRUCTION TRAFFIC CONTROL INITIAL SET-UP SHALL BE BY AN AMERICAN TRAFFIC SAFETY SERVICES ASSOCIATION (ATSSA) CERTIFIED WORKSITE TRAFFIC SUPERVISOR. THE MAINTENANCE AND SERVICING SHALL ALSO BE DONE BY AN ATSSA CERTIFIED WORKSITE TRAFFIC SUPERVISOR OR EQUIVALENT.

8. CONTRACTOR IS RESPONSIBLE TO MAINTAIN AND SERVICE ALL TRAFFIC CONTROL DEVICES 24 HOURS A DAY, 7 DAYS A WEEK THROUGHOUT LENGTH OF PROJECT. CONTRACTOR IS RESPONSIBLE THAT ALL TRAFFIC CONTROL DEVICES COMPLY WITH THE MUTCD, LATEST EDITION.

9. ALL ADVANCE WARNING SIGNS SHALL BE DOUBLE INDICATED WHENEVER THERE ARE MULTI-LANE TRAFFIC IN ANY ONE GIVEN DIRECTION AND THERE IS SUFFICIENT MEDIAN SPACE.

10. ALL BARRICADES IN ALL TAPERS AND TANGENTS SHALL BE PLACED APART, A DISTANCE MEASURED IN FEET, EQUAL TO THAT OF THE POSTED SPEED LIMIT. NO EXCEPTIONS UNLESS APPROVED BY CONSTRUCTION COORDINATION PER MUTCD SECTION 6A-4.

11. ALL WORK IN ARTERIAL ROADWAYS SHALL BE ON A CONTINUOUS 24-HOUR PER DAY BASIS UNTIL COMPLETED.

12. CONTRACTOR IS RESPONSIBLE TO PROVIDE CONSTRUCTION COORDINATION, A WEEKLY LOG OF DAILY INSPECTIONS OF BARRICADE AND MAINTENANCE SCHEDULES ON PROJECTS THAT ARE OVER ONE WEEK DURATION.

13. EQUIPMENT OR MATERIALS SHALL NOT BE STORED WITHIN 15 FEET OF A TRAVELLED TRAFFIC LANE DURING NON-WORKING HOURS WITHOUT THE APPROVAL OF CONSTRUCTION COORDINATION.

14. CONTRACTOR SHALL PROVIDE AND MAINTAIN A SAFE AND ADEQUATE MEANS OF CHANNELIZING PEDESTRIAN TRAFFIC AROUND AND THROUGH THE CONSTRUCTION AREA.

15. CONTRACTOR IS RESPONSIBLE FOR OBLITERATION OF ANY CONFLICTING STRIPING AND RESPONSIBLE FOR ALL TEMPORARY STRIPING.

16. CONTRACTOR SHALL MAINTAIN ACCESS TO ALL FACILITIES, BUSINESSES AND/OR RESIDENTS AT ALL TIMES.

17. CONTRACTOR SHALL PROVIDE ACCESS SIGNS FOR BUSINESSES LOCATED WITHIN THE CONSTRUCTION AREA UNDER THE SUPERVISION OF CONSTRUCTION COORDINATION. EACH ACCESS SIGN SHALL HAVE 5 INCH, WHITE OPAQUE LETTERING ON BLUE REFLECTORIZED BACKGROUND. ACCESS SIGNS SHALL BE CONSIDERED INCIDENTAL TO THE BID AND NOT PART OF THE CONTRACT UNLESS OTHERWISE STATED. NO MORE THAN 3 BUSINESSES SHALL BE LISTED ON A ACCESS SIGN. SHOPPING CENTERS AND MALLS SHALL BE LISTED AS SUCH.

18. ALL ADVANCE WARNING SIGNS SHALL MEET THE MINIMUM REFLECTIVE INTENSITY REQUIREMENTS SET FORTH BY THE CITY OF ALBUQUERQUE. CONSTRUCTION COORDINATION SHALL DETERMINE ALL REQUIREMENTS AND APPROVE OR DISAPPROVE ANY ADVANCE WARNING SIGN PER SECTION 6A-4 OF THE MUTCD, LATEST EDITION.

19. 48-HOURS PRIOR TO OCCUPYING OR CLOSING OF A RIGHT-OF-WAY, CONTRACTOR SHALL NOTIFY: POLICE, FIRE DEPARTMENT, SCHOOLS, HOSPITALS, TRANSIT AUTHORITY, BUSINESSES AND/OR RESIDENTS THAT WILL BE AFFECTED BY THE CONSTRUCTION.

20. ANY FIELD ADJUSTMENTS SHALL BE APPROVED BY CONSTRUCTION COORDINATION.

21. EXCAVATIONS SHALL BE PLATED, TEMPORARILY PATCHED OR RESURFACED PRIOR TO OPENING OF TRAFFIC. A MINIMUM OF 11 FEET SHALL BE PROVIDED FOR TRAFFIC IN ANY GIVEN DIRECTION. CONTRACTOR IS RESPONSIBLE FOR ANY WORK INVOLVED IN SATISFYING THESE REQUIREMENTS.

22. CONTRACTOR SHALL AT ALL TIMES COMPLY WITH THE FOLLOWING:
1. STANDARDS AND REQUIREMENTS SET FORTH IN THE MANUAL ON UNIFORM TRAFFIC CONTROL DEVICES, LATEST EDITION.
2. THE CITY OF ALBUQUERQUE TRAFFIC CODE, LATEST EDITION.
3. SECTION 19 OF THE CITY OF ALBUQUERQUE'S STANDARD SPECIFICATIONS FOR PUBLIC WORK CONSTRUCTION, AS WELL AS OTHER SECTIONS.

23. FAILURE TO COMPLY WITH ANY OF THE ABOVE MENTIONED, WILL BE ADEQUATE CAUSE TO CEASE ALL WORK ON ANY CONSTRUCTION PROJECT. WORK WILL NOT RESUME UNTIL ALL REQUIREMENTS ARE ADDRESSED AND APPROVED BY CONSTRUCTION COORDINATION.

24. ALL TRAFFIC CONTROL DEVICES SHALL BE KEPT IN NEW-CLEAN CONDITION. WASHING OF EQUIPMENT IS INCIDENTAL TO ITS PLACEMENT AND MAINTENANCE.

25. TRAFFIC CONTROL STANDARDS APPLY ONLY WHERE THE CONSTRUCTION TRAFFIC CONTROL PLANS ARE NOT SPECIFIC.

26. ADVANCE WARNING SIGNS SHALL BE 36"x36" WITH SUPER ENGINEERING GRADE SHEETING OR BETTER. MOUNTING HEIGHT AT TOP OF SIGN SHALL BE THE SAME AS FOR A 48-INCH SIGN AS INDICATED IN THE MUTCD.

27. CONTRACTOR SHALL MAINTAIN A GRAFFITI-FREE WORK SITE. CONTRACTOR SHALL PROMPTLY REMOVE ANY AND ALL GRAFFITI FROM ALL EQUIPMENT, WHETHER PERMANENT OR TEMPORARY.

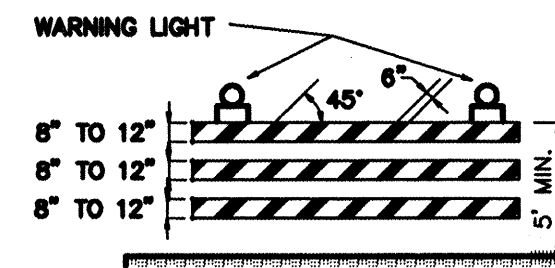

TYPE III BARRICADE

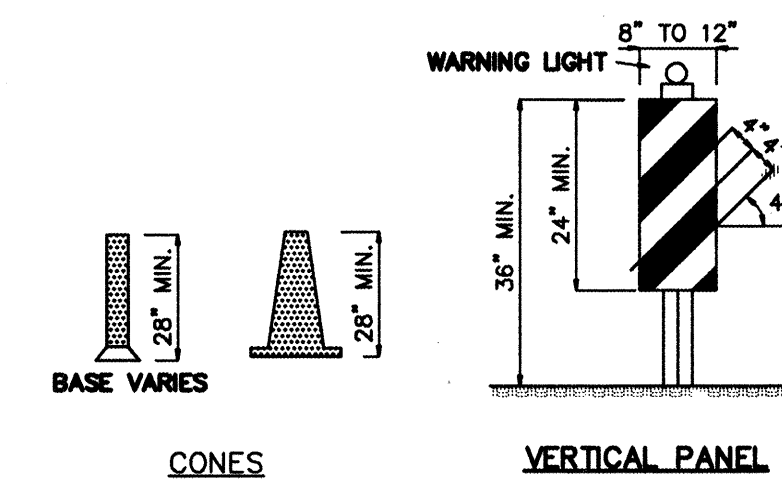

CONES

VERTICAL PANEL

HIGH LEVEL WARNING DEVICE

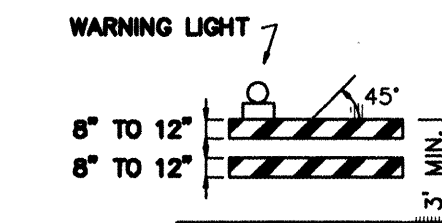

TYPE I BARRICADE

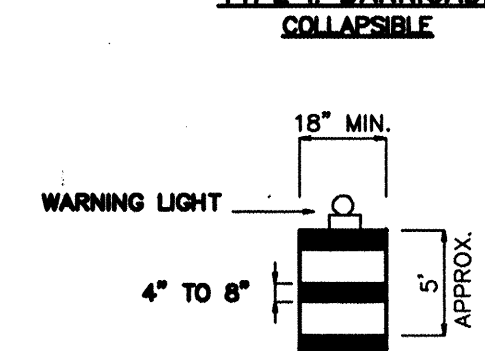

BARREL

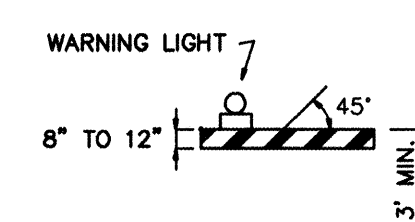

TYPE I BARRICADE

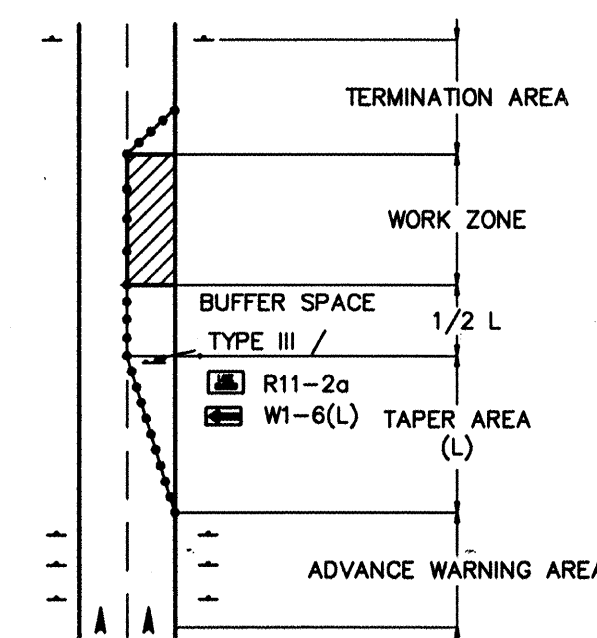

TRAFFIC CONTROL ELEMENTS

KEYED NOTES:

LEGEND

- WORK AREA
- BARRICADE - TYPE I, TYPE II, OR BARREL
- BARRICADE - TYPE III
- VERTICAL PANEL
- WARNING SIGN
- DISTANCE BETWEEN SIGNS - A DISTANCE MEASURED IN FEET EQUAL TO A VALUE OF TEN TIMES THE SPEED LIMIT OF THE STREET
- FLAGMAN POSITION
- SPACING BETWEEN BARRICADES- A DISTANCE MEASURED IN FEET EQUAL TO THE SPEED LIMIT OF THE STREET
- TAPER LENGTH - SEE CHART BELOW
- THE TANGENT LENGTH IS EQUAL TO THE TAPER LENGTH FOR A GIVEN STREET

TAPER REQUIREMENTS

SPEED LIMIT (MPH)	TAPER LENGTH (L) (FEET)			MINIMUM NUMBER OF DEVICES FOR TAPER	MAXIMUM DEVICE SPACING IN FEET	
	10' LANE	11' LANE	12' LANE		ALONG TAPER	AFTER TAPER
20	70	75	80	5	20	20
25	105	115	125	6	25	25
30	150	165	180	7	30	30
35	205	225	245	8	35	35
40	270	295	320	9	40	40
45	450	495	540	13	45	45
50	500	550	600	13	50	50
55	550	605	660	13	55	55

RECOMMENDED SIGN SPACING(D) FOR ADVANCE WARNING SIGN SERIES

SPEED MILES PER HOUR	MINIMUM DISTANCE BETWEEN SIGNS	MINIMUM DISTANCE FROM LAST SIGN TO TAPER
0-20	10 X SPEED LIMIT	10 X SPEED LIMIT
25-30	10 X SPEED LIMIT	10 X SPEED LIMIT
30-35	10 X SPEED LIMIT	10 X SPEED LIMIT
40-45	10 X SPEED LIMIT	10 X SPEED LIMIT
50-60	10 X SPEED LIMIT	10 X SPEED LIMIT

TAPER CRITERIA

TYPE OF TAPER	TAPER LENGTH
UPSTREAM TAPER:	
MERGING TAPER	L MINIMUM
SHIFTING TAPER	1/2 L MINIMUM
SHOULDER TAPER	1/2 L MINIMUM
TWO-WAY TRAFFIC TAPER	100 FEET MAXIMUM
DOWNSIDE TAPERS	100 FEET PER LANE

TAPER LENGTH COMPUTATION

SPEED LIMIT	L = WS ² / 60
40 MPH OR LESS	L = WS ² / 60
45 MPH OR GREATER	L = W X S

L = TAPER LENGTH
W = WIDTH OF OFFSET IN FEET
S = POSTED SPEED OR OFF-PEAK 85-PERCENTILE SPEED IN MPH

FOR INFORMATION ONLY

CONSENSUS PLANNING, INC.
Planning / Landscape Architecture
924 Park Avenue SW
Albuquerque, NM 87102
(505) 764-9801 Fax 842-5495

CITY OF ALBUQUERQUE
CAPITAL IMPLEMENTATION PROGRAM
LANDSCAPE ARCHITECTURE & CONSTRUCTION SERVICES

TITLE: OURAY ROAD MEDIAN LANDSCAPE IMPROVEMENTS
SIGNING AND CONSTRUCTION TRAFFIC CONTROL STANDARDS

Design Review Committee	City Engineer Approval	Update	No. / Day / Yr.	No. / Day / Yr.

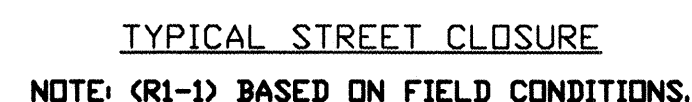
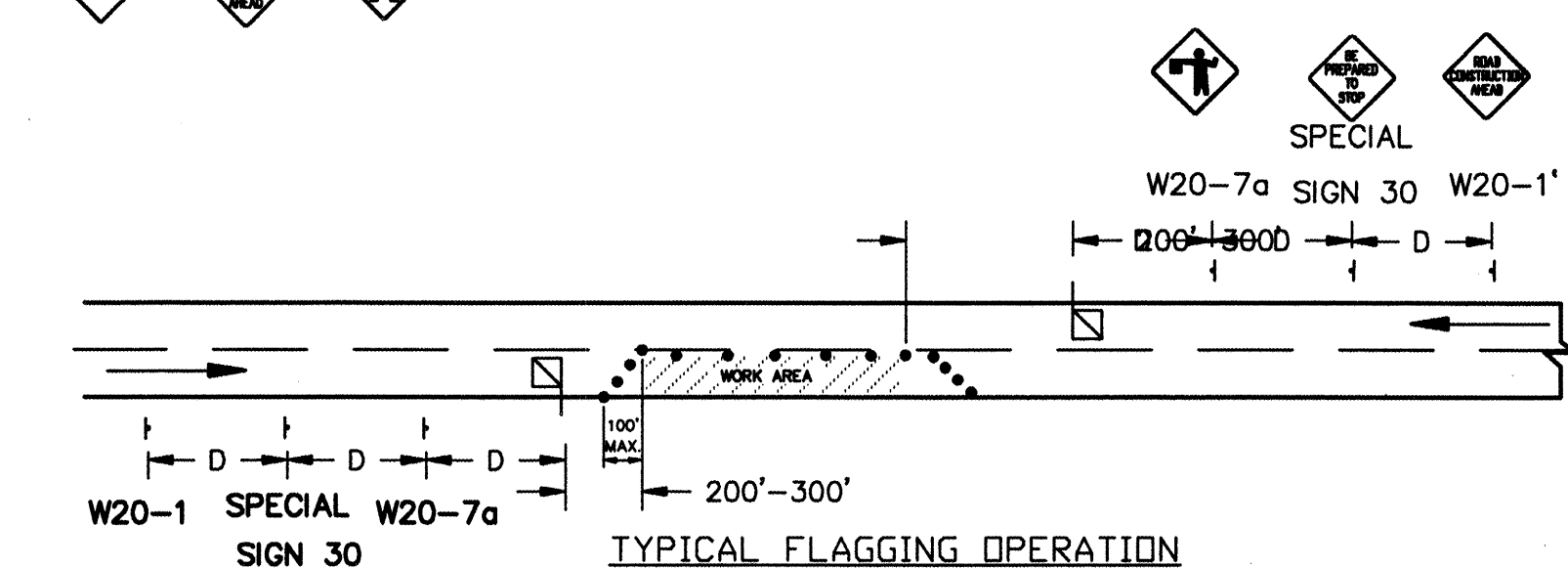
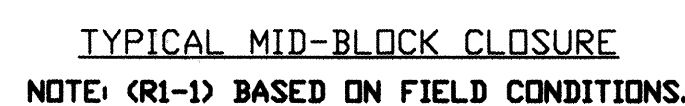
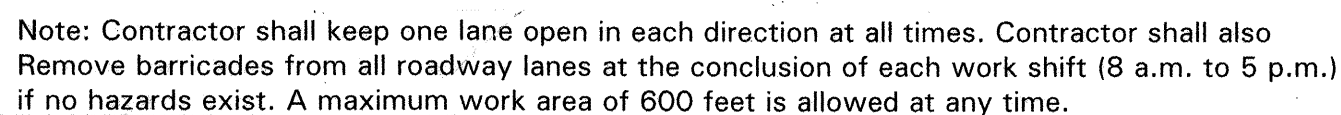

Note: Contractor shall coordinate barricading needs with Project #553291 - Rinconada Point Park Improvements. Barricade permits may not be issued until conflicts with other projects are resolved.

DATE		PROGRAM		CONSTRUCTION SERVICES		IMPROVEMENTS		AND SIGNING	
No. / Day / Yr.		No. / Day / Yr.		No. / Day / Yr.		No. / Day / Yr.		No. / Day / Yr.	
								</	