

PROJECT NO: C97304.B01.2400  
BHI-MAIN(97304)CDP/C01-STORM DRAIN(DWG)SD\_PNP.dwg  
REFERENCE JOB NO: 94143.40

**SECTION A-A TRENCH DETAIL**  
NOT TO SCALE  
THE CONTRACTOR IS RESPONSIBLE FOR, AND REQUIRED TO REPAIR ANY DAMAGE TO ANY EXISTING FACILITIES, INCLUDING THE EXISTING CMU WALL, THE EXISTING SANITARY SEWER LINES AND MANHOLES.

**NOTES:**  
AS-BUILT CONDITIONS ARE APPROXIMATE AND SHOULD BE FIELD VERIFIED.  
EXISTING RCP STORM DRAIN MAY BE REUSED PROVIDED JOINTS ARE IN GOOD CONDITION AND THE CITY INSPECTOR VERIFIES ACCEPTABILITY OF THE MATERIALS. NEW O-RINGS SHALL BE USED.  
ALL RCP SD PIPE INSTALLED IN THIS PROJECT SHALL BE CLASS IX.  
RIM ELEVATIONS OF THE TWO MANHOLES WITHIN THE APARTMENT SITE (TRACT L-1) SHALL BE COORDINATED (BY THE CONTRACTOR) WITH THE SITE GRADING PLAN.

FOR INFORMATION ONLY

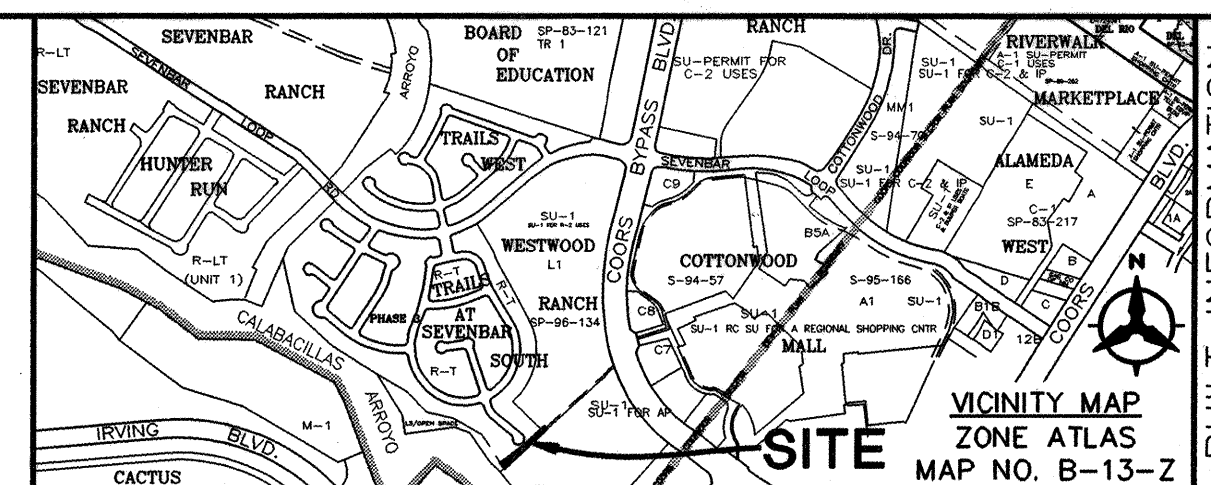

- NOTICE TO CONTRACTORS**
- ALL WORK DETAILED ON THESE PLANS TO BE PERFORMED UNDER CONTRACT SHALL, EXCEPT AS OTHERWISE STATED OR PROVIDED HEREON, BE CONSTRUCTED IN ACCORDANCE WITH THE CITY OF ALBUQUERQUE STANDARD SPECIFICATIONS FOR PUBLIC WORKS CONSTRUCTION, 1986 EDITION AND SHALL INCLUDE UPDATE No.6
  - TWO WORKING DAYS PRIOR TO ANY EXCAVATION, THE CONTRACTOR MUST CONTACT NEW MEXICO ONE CALL SYSTEM (260-1990) FOR LOCATION OF EXISTING UTILITIES.
  - PRIOR TO CONSTRUCTION, THE CONTRACTOR SHALL EXCAVATE AND VERIFY THE HORIZONTAL AND VERTICAL LOCATIONS OF ALL OBSTRUCTIONS. SHOULD A CONFLICT EXIST, THE CONTRACTOR SHALL NOTIFY THE ENGINEER OR SURVEYOR IMMEDIATELY SO THAT THE CONFLICT CAN BE RESOLVED WITH A MINIMUM AMOUNT OF DELAY.
  - FIVE (5) WORKING DAYS PRIOR TO BEGINNING CONSTRUCTION, THE CONTRACTOR SHALL SUBMIT TO CONSTRUCTION COORDINATION DIVISION A DETAILED CONSTRUCTION SCHEDULE. TWO (2) WORKING DAYS PRIOR TO CONSTRUCTION, THE CONTRACTOR SHALL OBTAIN A BARRICADING PERMIT FROM THE CONST. COORDINATION DIVISION. CONTRACTOR SHALL NOTIFY BARRICADE ENGINEER (768-2551) PRIOR TO OCCUPANCY AN INTERSECTION. REFER TO SECTION 19 OF THE GENERAL CONDITIONS OF THE STANDARD SPECIFICATIONS.
  - ALL STREET STRIPING ALTERED OR DESTROYED SHALL BE REPLACED W/ PLASTIC REFLECTORIZED PAVEMENT MARKING BY CONTRACTOR TO LOCATION AS EXISTING OR AS INDICATED BY THIS PLAN SET.
  - CONTRACTOR SHALL NOTIFY THE ENGINEER NOT LESS THAN SEVEN (7) DAYS PRIOR TO STARTING WORK IN ORDER THAT THE CITY SURVEYOR MAY TAKE NECESSARY MEASURES TO INSURE THE PRESERVATION OF PERMANENT SURVEY MONUMENTS. THE CONTRACTOR SHALL NOT DISTURB PERMANENT SURVEY MONUMENTS WITHOUT THE CONSENT OF THE CITY SURVEYOR AND SHALL NOTIFY THE CITY SURVEYOR AND BEAR THE EXPENSE OF REPLACING ANY THAT MAY BE DISTURBED WITHOUT PERMISSION. REPLACEMENT SHALL BE DONE ONLY BY THE CITY SURVEYOR. WHEN A CHANGE IS MADE IN THE FINISHED ELEVATIONS OF THE PAVEMENT OF ANY ROADWAY IN WHICH A PERMANENT SURVEY MONUMENT IS LOCATED, CONTRACTOR SHALL, AT HIS OWN EXPENSE, ADJUST THE MONUMENT COVER TO THE NEW GRADE UNLESS OTHERWISE SPECIFIED. REFER TO SECTION 4.4 OF THE GENERAL CONDITIONS OF THE STANDARD SPECIFICATIONS. ANY PERMANENT SURVEY MONUMENT LOCATED WITHIN 50' OF THE PROJECT LIMITS NOT SHOWN ON THE PLANS THAT IS DESTROYED DURING CONSTRUCTION WILL BE REPLACED AT DESIGNER'S EXPENSE.
  - ANY WORK WITHIN AN ARTERIAL ROADWAY REQUIRES TWENTY-FOUR HOUR CONSTRUCTION.
  - CONTRACTOR SHALL MAINTAIN A GRAFFITI - FREE WORK SITE. CONTRACTOR SHALL PROMPTLY REMOVE ANY GRAFFITI FROM ALL EQUIPMENT, WHETHER PERMANENT OR TEMPORARY.

- THE FOLLOWING NOTES ALSO APPLY WHEN CHECKED**
- ☐ ALL UTILITIES AND UTILITY SERVICE LINES SHALL BE INSTALLED PRIOR TO PAVING.
  - ☐ BACKFILL COMPACTION SHALL BE ACCORDING TO SPECIFIED STREET USE.
  - ☐ TACK COAT REQUIREMENTS SHALL BE DETERMINED BY THE CITY ENGINEER.
  - ☐ SIDEWALKS AND WHEELCHAIR RAMPS WITHIN THE CURB RETURNS SHALL BE CONSTRUCTED WHEREVER A NEW CURB RETURN IS CONSTRUCTED.
  - ☐ IF CURB IS DEEPENED FOR A DRIVEPAD, THE DRIVEPAD SHALL BE CONSTRUCTED PRIOR TO ACCEPTANCE OF CURB AND GUTTER.
  - ☒ ALL STORM DRAINAGE FACILITIES SHALL BE COMPLETED PRIOR TO FINAL ACCEPTANCE.
  - ☐ THE REQUESTOR OR DEVELOPER SHALL BE RESPONSIBLE FOR REPAIR OR REPLACEMENT OF ALL CURB AND GUTTER OR SIDEWALK DAMAGED AFTER APPROVAL BY THE CITY ENGINEER OF WORK COMPLETED BY THE CONTRACTOR.

**Bohannon & Huston**  
Engineers Planners Photogrammetrists Surveyors Landscape Architects  
Courtney One 7500 JEFFERSON NE Albuquerque NEW MEXICO 87109

WESTWOOD RANCH APARTMENTS OUTFALL STORM DRAIN RECONSTRUCTION					
REV.	SHEETS	CITY ENGINEER	DATE	USER DEPARTMENT	DATE
ENGINEERS STAMP & SIGNATURE		APPROVALS	ENGINEER	DATE	*****
		DRC Chairman	<i>Sally G. Sankley</i>	11-14-97	APPROVED FOR CONSTRUCTION
		Transportation	<i>R. D. Kane</i>	11-4-97	
		Water/Wastewater	<i>R. D. Kane</i>	11-7-97	
		Hydrology	<i>Anna C. Leger</i>	11-4-97	
		CIP	<i>Anna C. Leger</i>	11-4-97	
		Const. Mngmt.	<i>Anna C. Leger</i>	11-5-97	City Engineer Date
		City Project No.	Map No.	Sheet	Of
		580481	B-13	1	1

AS-BUILT INFORMATION		BENCH MARKS		SURVEY INFORMATION		FIELD NOTES		ENGINEER'S SEAL	
CONTRACTOR	DATE	INSPECTOR	DATE	U.S. DEPT. OF THE INTERIOR	DATE	BY	DATE	DATE	DATE
INSPECTOR	DATE	U.S. DEPT. OF THE INTERIOR	DATE	RIGHT-OF-WAY MARKER ("T" RAIL)	DATE	NO.	DATE	DATE	DATE
INSPECTOR	DATE	U.S. DEPT. OF THE INTERIOR	DATE	STA. 106+50, LOCATED ON THE EASTERLY	DATE	REMARKS	REVISIONS	DESIGN	DESIGN
INSPECTOR	DATE	U.S. DEPT. OF THE INTERIOR	DATE	RIGHT-OF-WAY OF NEW MEXICO STATE HWY. 14	DATE	No.	Date	DATE: 10/97	DATE: 10/97
INSPECTOR	DATE	U.S. DEPT. OF THE INTERIOR	DATE	SEA LEVEL - DATUM OF 1929	DATE	REMARKS	REVISIONS	DESIGN	DESIGN
INSPECTOR	DATE	U.S. DEPT. OF THE INTERIOR	DATE	ELEVATION = 6559.63'	DATE	REMARKS	REVISIONS	DESIGN	DESIGN