

WALGREENS LOMAS AND CARLISLE INFRASTRUCTURE IMPROVEMENTS

INDEX OF DRAWINGS

SHEET	TITLE
1	TITLE SHEET, INDEX, GENERAL NOTES, LEGEND, AND ABBREVIATIONS
2	PRELIMINARY PLAT
3	OVERALL SITE PLAN
4	CARLISLE TURN LANE/DRIVE ENTRANCE
5	CARLISLE FIRE HYDRANT RELOCATION
6	CARLISLE TRAFFIC SIGNAL RELOCATION
7	LOMAS AND AMHERST DRIVE ENTRANCES
8	SIGN AND CONSTRUCTION TRAFFIC CONTROL STANDARDS
9	TYPICAL TRAFFIC CONTROL & SIGNING EXAMPLES (REF. M.U.T.C.D.)

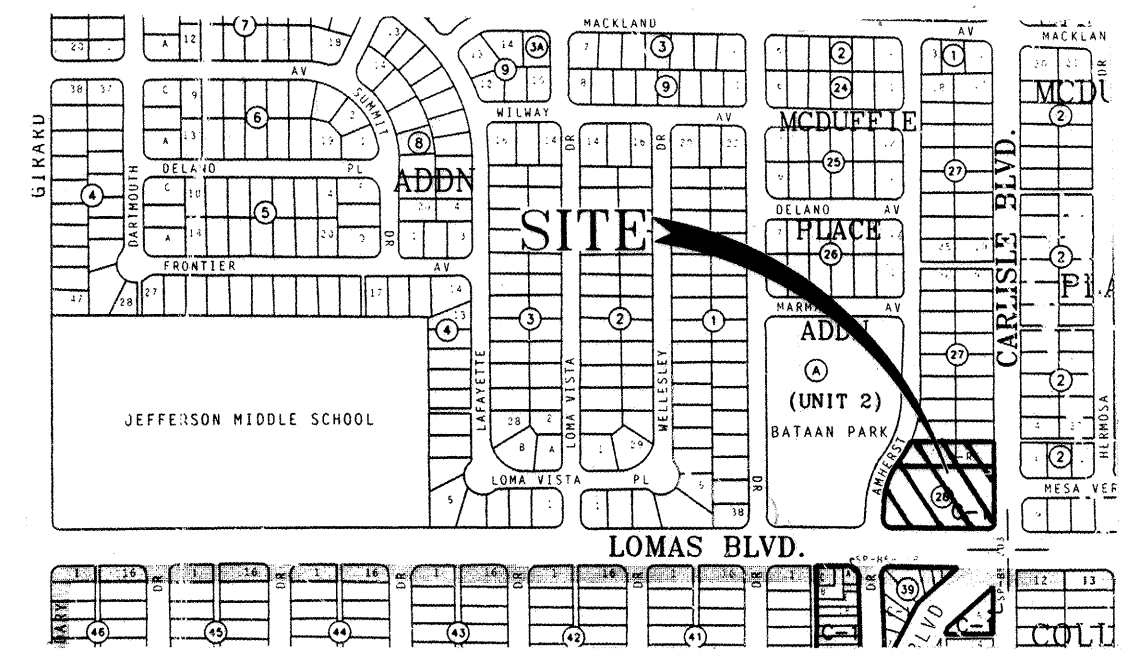

VICINITY MAP J-16-Z

GENERAL NOTES

1. AN EXCAVATION/CONSTRUCTION PERMIT WILL BE REQUIRED BEFORE BEGINNING ANY WORK WITHIN CITY RIGHT-OF-WAY.
2. ALL WORK DETAILED ON THESE PLANS TO BE PERFORMED, EXCEPT AS OTHERWISE STATED OR PROVIDED HEREON, SHALL BE CONSTRUCTED IN ACCORDANCE WITH CITY OF ALBUQUERQUE STANDARD SPECIFICATIONS FOR PUBLIC WORKS FOR PUBLIC WORKS CONSTRUCTION, 1986 EDITION AS REVISED THROUGH UPDATE #6.
3. TWO WORKING DAYS PRIOR TO ANY EXCAVATION, CONTRACTOR MUST CONTACT LINE LOCATING SERVICE, (260-1990) FOR LOCATION OF EXISTING UTILITIES.
4. PRIOR TO CONSTRUCTION, THE CONTRACTOR SHALL EXCAVATE AND VERIFY THE HORIZONTAL AND VERTICAL LOCATIONS OF ALL PERTINENT EXISTING UTILITIES. SHOULD A CONFLICT EXIST, THE CONTRACTOR SHALL NOTIFY THE ENGINEER SO THAT THE CONFLICT CAN BE RESOLVED WITH A MINIMUM AMOUNT OF DELAY.
5. FIVE WORKING DAYS PRIOR TO BEGINNING CONSTRUCTION THE CONTRACTOR SHALL SUBMIT TO THE CONSTRUCTION COORDINATION DIVISION A DETAILED CONSTRUCTION SCHEDULE. TWO WORKING DAYS PRIOR TO CONSTRUCTION, THE CONTRACTOR SHALL OBTAIN A BARRICADE PERMIT FROM THE CONSTRUCTION COORDINATION DIVISION. CONTRACTOR SHALL NOTIFY BARRICADE ENGINEER (765-2551) PRIOR TO OCCUPYING PUBLIC RIGHT-OF-WAY. SEE SECTION 19 OF THE SPECIFICATIONS.
6. ALL STREET STRIPING ALTERED OR DESTROYED SHALL BE REPLACED WITH PLASTIC REFLECTORIZED PAVEMENT MARKINGS BY CONTRACTOR TO SAME LOCATION AS EXISTING, OR AS INDICATED BY THIS PLAN SET.
7. CONTRACTOR SHALL COORDINATE WITH WATER SYSTEMS DIVISION (857-8200) FIVE WORKING DAYS IN ADVANCE OF ANY WORK THAT MAY AFFECT EXISTING PUBLIC WATER OR SEWER UTILITIES. EXISTING VALVES TO BE OPERATED BY CITY PERSONNEL ONLY. CONTRACTOR SHALL CONTACT THE WATER SYSTEMS DIVISION THREE DAYS PRIOR TO NEEDING VALVES TURNED ON OR OFF.
8. CONTRACTOR SHALL RECORD DATA ON ALL UTILITY LINES AND ACCESSORIES AS REQUIRED BY THE CITY OF ALBUQUERQUE FOR THE PREPARATION OF "AS CONSTRUCTED" DRAWINGS. CONTRACTOR SHALL NOT COVER UTILITY LINES AND ACCESSORIES UNTIL ALL DATA HAS BEEN RECORDED.
9. CONTRACTOR SHALL NOTIFY THE ENGINEER NOT LESS THAN SEVEN (7) DAYS PRIOR TO STARTING WORK IN ORDER THAT THE CITY SURVEYOR MAY TAKE NECESSARY MEASURES TO INSURE THE PRESERVATION OF SURVEY MONUMENTS. CONTRACTOR SHALL NOT DISTURB PERMANENT SURVEY MONUMENTS WITHOUT THE CONSENT OF THE CITY SURVEYOR AND SHALL NOTIFY THE CITY SURVEYOR AND BEAR THE EXPENSE OF REPLACING ANY THAT MAY BE DISTURBED.
10. ANY WORK AFFECTING AN ARTERIAL ROADWAY REQUIRES TWENTY FOUR (24) HOURS OF CONSTRUCTION.

LEGEND

DESCRIPTION	EXISTING	NEW
WATER VALVE		
FIRE HYDRANT		
SANITARY SEWER	--- SAS ---	--- SAS ---
WATER LINE	--- W ---	--- W ---
STORM DRAIN	--- SD ---	--- SD ---
CURB AND GUTTER	=====	=====
ASPHALT		
CONCRETE		
PROPERTY LINE	---	---
CONSTRUCTION BASE LINE	---	---
As-Built Elev.		

ABBREVIATIONS

A.D. = ALGEBRAIC DIFFERENCE	PT. = POINT OF TANGENT
DIA. = DIAMETER	PT.D. = RADIUS
DI. = DUCTILE IRON	RT. = RIGHT
EXIST = EXISTING	STA = STATION
FL = FLOWLINE	TA = TOP OF ASPHALT
INT = INTERSECTION	TC = TOP OF CURB
LF = LINEAR FEET	TP. = TOP OF PIPE
LT = LEFT	TP. = TYPICAL



5639 JEFFERSON STREET N.E. • ALBUQUERQUE, NEW MEXICO 87109
PHONE (505) 344-4080 • FAX (505) 343-8759

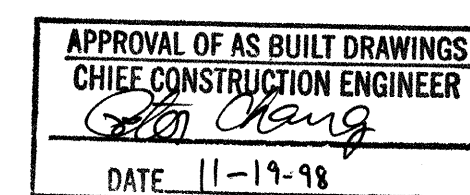

AS BUILT
DATE 8/7/98
Denny M. Miquel

REV.	SHEETS	CITY ENGINEER	DATE	USER DEPARTMENT	DATE	USER DEPARTMENT	DATE
ENGINEER'S STAMP & SIGNATURE	APPROVALS	ENGINEER	DATE	*****	APPROVED FOR CONSTRUCTION		
	DRC Chairman	Billy J. Zappala	7/30/98				
	Transportation	R. W. Kane	7/21/98				
	Water/Wastewater	R. W. Kane	6/16/98				
	Hydrology	R. W. Kane	6/16/98				
	C.I.P.	R. W. Kane	6/16/98				
	Constr. Mngmt.	R. W. Kane	6/16/98				
	Constr. Coord.	R. W. Kane	6/24/98				
	City Project No.	582482					
	Sheet	1	Of				

CANNED BY
FSA REPRO

JOB NO.: R21-125-5198
FILE: WAL-WOPP.DWG (06-09-98)
REV: 06-09-98 (RC)

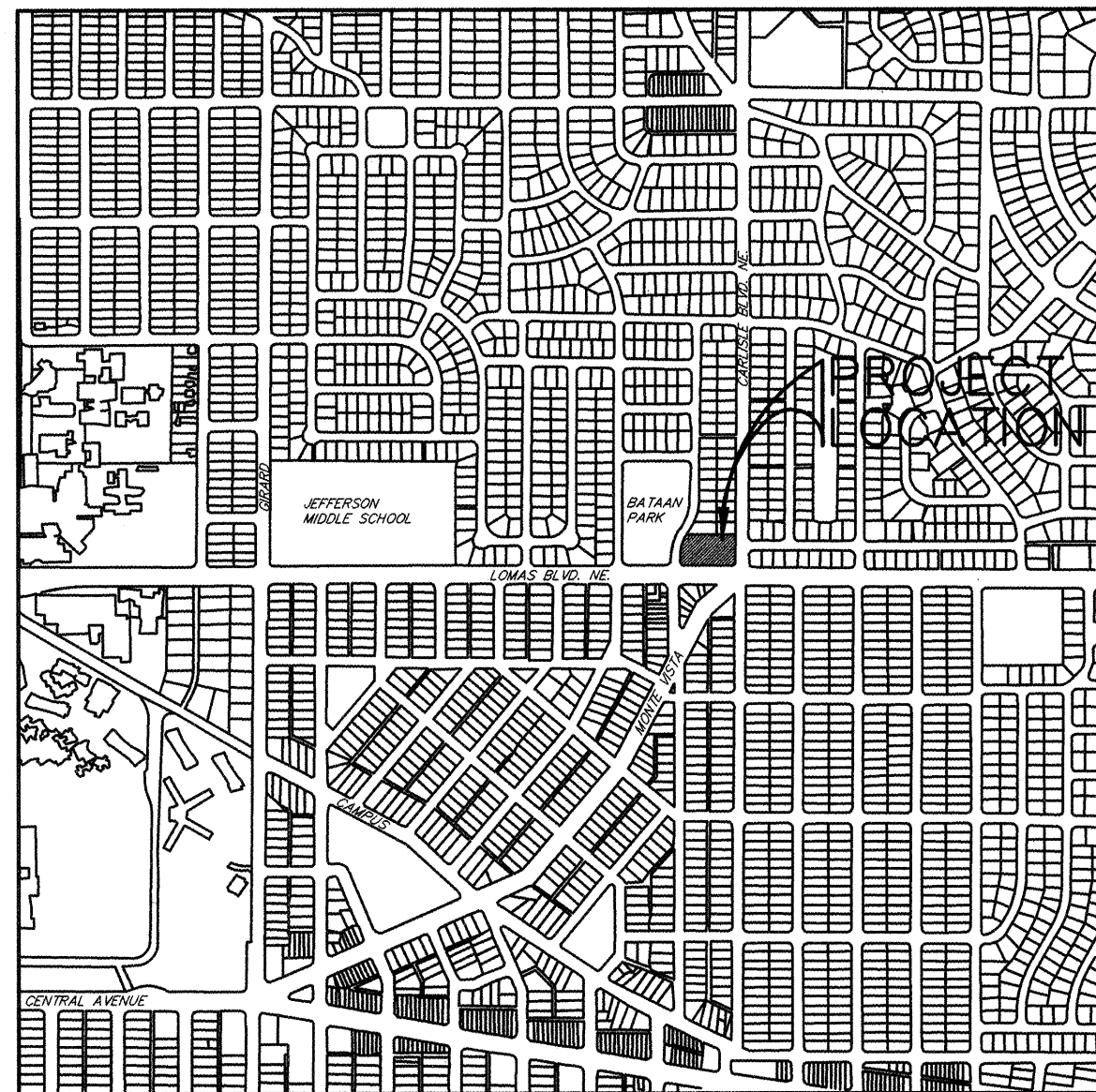

LOCATION MAP
ZONE ATLAS MAP No. J-16
SCALE: 1" = 1000'

NOTES

- THE PURPOSE OF THIS PLAT IS TO SUBDIVIDE AND DEDICATE THE CITY OF ALBUQUERQUE RIGHT-OF-WAY PARCELS.
- BEARINGS ARE BASED ON THE STATE PLANE GRID BEARING (NM CENTRAL ZONE).
- BASIS OF THE BOUNDARY IS THE RECORDED PLAT OF SECOND UNIT, McDUFFIE ADDITION, FILED APRIL 18, 1941, MAP BOOK C2, PAGE 16, AND DISTRICT COURT JUDGMENT NO. 84511, FILED DECEMBER 10, 1962.
- ALL BOUNDARY CORNERS ARE MARKED BY A REBAR WITH ALUMINUM CAP MARKED "AA & R LS 4071" UNLESS OTHERWISE INDICATED HEREON.
- ZONE ATLAS MAP No. J-16
- U.C.L.S. LOG No. 98060814430444
- PRIOR TO DEVELOPMENT, CITY OF ALBUQUERQUE WATER AND SANITARY SEWER SERVICE TO BLOCK 28A MUST BE VERIFIED AND COORDINATED WITH THE PUBLIC WORKS DEPARTMENT, CITY OF ALBUQUERQUE, VIA A REQUEST FOR A WATER & SANITARY SEWER AVAILABILITY STATEMENT.

FREE CONSENT STATEMENT

THE PLAT OF BLOCK 28A OF SECOND UNIT OF McDUFFIE PLACE AS SHOWN HEREON IS WITH THE FREE CONSENT OF AND IN ACCORDANCE WITH THE WISHES AND DESIRES OF THE UNDERSIGNED OWNERS AND/OR PROPRIETORS THEREOF. THE RIGHT OF WAY PARCELS SHOWN HERE ARE OWNED BY THE CITY OF ALBUQUERQUE IN FEE SIMPLE AND ARE DEDICATED TO THE PUBLIC USE FOREVER. THE UNDERSIGNED OWNERS AND/OR PROPRIETORS DO HEREBY GRANT THE PUBLIC EASEMENTS SHOWN HEREON FOR THE USES INDICATED, INCLUDING THE RIGHTS OF INGRESS AND EGRESS AND THE RIGHT TO TRIM INTERFERING TREES AND SHRUBS. THE UNDERSIGNED OWNERS AND/OR PROPRIETORS DO FREELY CONSENT TO ALL THE FOREGOING AND DO HEREBY REPRESENT THAT THEY ARE AUTHORIZED TO DO SO ACT.

C.A.P. II, A NEW MEXICO GENERAL PARTNERSHIP-OWNERS BLOCK 28A

BY: PETERSON PROPERTIES REAL ESTATE SERVICES, INC.,
A NEW MEXICO CORPORATION, MANAGING GENERAL PARTNER

BY: JAMES A. PETERSON
PRESIDENT, PETERSON PROPERTIES REAL ESTATE SERVICES, INC.,

ACKNOWLEDGEMENT

STATE OF NEW MEXICO }
COUNTY OF BERNALILLO } SS

THE FOREGOING INSTRUMENT WAS ACKNOWLEDGED BEFORE ME THIS _____ DAY
OF _____, 1996, BY JAMES A. PETERSON, PRESIDENT, PETERSON
PROPERTIES REAL ESTATE SERVICES, INC.

MY COMMISSION EXPIRES _____

NOTARY PUBLIC

DESCRIPTION

A certain tract of land situate within Section 15, Township 10 North, Range 3 East, N.M.P.M., in the City of Albuquerque, Bernalillo County, New Mexico, being and comprising all of Block numbered Twenty-eight (28) of the Second Unit of McDuffie Place, an Addition to the City of Albuquerque, New Mexico as the same is shown and designated on the Plat of said Addition, filed in the office of the County Clerk of Bernalillo County, New Mexico on April 18, 1941 in plat book C2, folio 16, EXCEPTING THEREFROM that portion taken for the widening of Lomas Boulevard NE, as described in Judgement No. 84511, filed in the Second Judicial District Court on December 10, 1962, all being more particularly described as follows:

Beginning at the southeasterly corner of the tract herein described being a point on the northerly right-of-way line of Lomas Boulevard NE, a point on curve, from whence the A.C.S. monument "13-K17" bears S34°19'15"E, a distance of 113.38 feet; thence from said point of beginning, along said northerly right-of-way,
N89°42'08"W, a distance of 85.23 feet to a point of curve; thence,
Westerly, a distance of 71.09 feet along the arc of a curve to the right having a radius of 768.57 feet, a central angle of 5°17'59" and a chord bearing N87°03'10"W, 80.32 feet to a point of tangency; thence,
Westerly, a distance of 80.35 feet along the arc of a curve bearing to the left having a radius of 868.57 feet, a central angle of 5°18'01" and a chord bearing N87°03'10"W, 80.32 feet to a point of tangency; thence,
N89°42'08"W, a distance of 76.82 feet to the southwest corner of the tract herein described, a point on the westerly line of said Block 28; thence, leaving said northerly right-of-way line,
N00°30'52"E, a distance of 35.15 feet along the said westerly line and the easterly right-of-way line of Amherst Drive NE to a point of curve; thence,
Northeasterly, a distance of 107.45 feet along the arc of a curve bearing to the right having a radius of 200.00 feet, a central angle of 30°47'00" and a chord bearing N15°54'22"E, 106.17 feet to a point of tangency; thence,
N31°17'52"E, a distance of 44.81 feet continuing along the said easterly line of Amherst Drive NE, to a point of curve; thence,
Northerly, a distance of 24.08 feet along the arc of a curve bearing to the left having a radius of 350.00 feet, a central angle of 3°56'29" and a chord bearing N29°19'38"E, 24.07 feet, continuing along said easterly line to the northwest corner of the tract herein described, a point common to the northwest corner of said Block 28; thence,
S89°29'08"E, a distance of 250.64 feet along the north line of said Block 28 to the northeast corner of the parcel herein described, a point common to the northeast corner of said Block 28; thence,
S00°30'52"W, a distance of 201.63 feet along the west right-of-way line of Carlisle Boulevard NE, to a point of curve; thence,
Southerly, a distance of 1.28 feet along the arc of a curve bearing to the right having a radius of 15.00 feet, a central angle of 4°54'26" and a chord bearing S02°58'08"W, 1.28 feet to the point of beginning of the tract herein described; containing 59027.10 square feet (1.3551 acre), more or less.

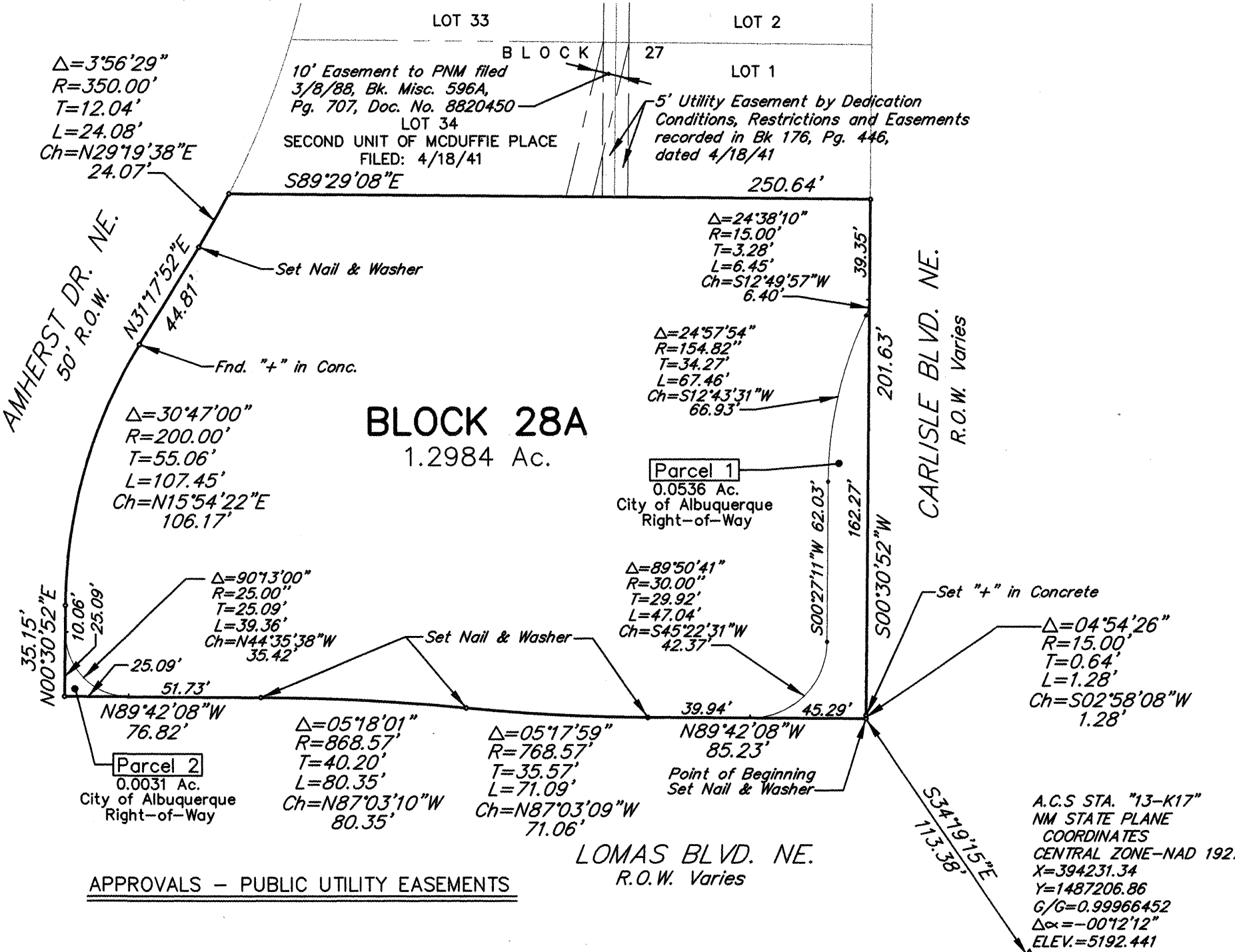

APPROVALS - PUBLIC UTILITY EASEMENTS

PNM ELECTRIC SERVICES DATE JONES INTERCABLE DATE

U.S. WEST COMMUNICATIONS DATE PNM GAS SERVICES DATE

PUBLIC UTILITY EASEMENTS SHOWN ON THIS PLAT GRANTED FOR THE COMMON AND JOINT USE OF:

A. PNM ELECTRIC SERVICES FOR INSTALLATION, MAINTENANCE, AND SERVICE OF UNDERGROUND AND OVERHEAD ELECTRICAL LINES, TRANSFORMERS, AND OTHER EQUIPMENT AND RELATED FACILITIES REASONABLY NECESSARY TO PROVIDE ELECTRICAL SERVICE.

B. U.S. WEST COMMUNICATIONS FOR THE INSTALLATION, MAINTENANCE, AND SERVICE OF SUCH LINES, CABLE, AND OTHER RELATED EQUIPMENT AND FACILITIES REASONABLY NECESSARY TO PROVIDE COMMUNICATION SERVICES, INCLUDING BUT NOT LIMITED TO GROUND PEDESTALS AND CLOSURES.

C. PNM GAS SERVICES FOR THE INSTALLATION, MAINTENANCE, AND SERVICE OF SUCH LINES, AND OTHER RELATED EQUIPMENT AND FACILITIES REASONABLY NECESSARY TO PROVIDE GAS SERVICE.

D. JONES INTERCABLE FOR THE INSTALLATION, MAINTENANCE, AND SERVICE OF SUCH LINES, AND OTHER RELATED EQUIPMENT AND FACILITIES REASONABLY NECESSARY TO PROVIDE CABLE TV SERVICE.

INCLUDED IS THE RIGHT TO BUILD, REBUILD, CONSTRUCT, RECONSTRUCT, LOCATE, RELOCATE, CHANGE, REMOVE, MODIFY, RENEW, OPERATE, AND MAINTAIN FACILITIES FOR THE PURPOSES DESCRIBED ABOVE, TOGETHER WITH FREE ACCESS TO, FROM, AND OVER SAID EASEMENTS, INCLUDING SUFFICIENT WORKING AREA SPACE FOR ELECTRIC TRANSFORMERS, WITH THE RIGHT AND PRIVILEGE TO TRIM AND REMOVE TREES, SHRUBS OR BUSHES WHICH INTERFERE WITH THE PURPOSES SET FORTH HEREIN. NO BUILDING, SIGN, POOL (ABOVE-GROUND OR SUBSURFACE), HOT TUB, CONCRETE OR WOOD DECKING, OR OTHER STRUCTURE SHALL BE ERECTED OR CONSTRUCTED ON SAID EASEMENTS, NOR SHALL ANY WELL BE DRILLED OR OPERATED THEREON. OWNERS SHALL BE SOLELY RESPONSIBLE FOR CORRECTING ANY VIOLATIONS OF THE NATIONAL ELECTRIC SAFETY CODE BY CONSTRUCTION OF POOLS, DECKING, OR ANY STRUCTURES ADJACENT TO OR NEAR EASEMENTS SHOWN ON THIS PLAT.

PLAT OF BLOCK 28A SECOND UNIT OF McDUFFIE PLACE ALBUQUERQUE, NEW MEXICO JUNE, 1998

THIS IS TO CERTIFY THAT TAXES ARE CURRENT

AND PAID ON UPC # _____

PROPERTY OWNER OF RECORD: _____

BERNALILLO COUNTY TREASURER'S OFFICE: _____

APPROVALS

CITY SURVEYOR, CITY OF ALBUQUERQUE
PUBLIC WORKS DEPARTMENT DATE

PROPERTY MANAGEMENT, CITY OF ALBUQUERQUE DATE

TRAFFIC ENGINEER, CITY OF ALBUQUERQUE
PUBLIC WORKS DEPARTMENT DATE

PARKS AND RECREATION DEPARTMENT,
CITY OF ALBUQUERQUE DATE

UTILITY DEVELOPMENT DIVISION, CITY OF
ALBUQUERQUE PUBLIC WORKS DEPARTMENT DATE

ALBUQUERQUE METROPOLITAN ARROYO
FLOOD CONTROL AUTHORITY DATE

CITY ENGINEER, CITY OF ALBUQUERQUE
PUBLIC WORKS DEPARTMENT DATE

APPROVAL AS SPECIFIED BY THE ALBUQUERQUE SUBDIVISION ORDINANCE

CHAIRMAN, ALBUQUERQUE/BERNALILLO COUNTY
DEVELOPMENT REVIEW BOARD DATE

CASE No. DRB _____

PLAT No. _____

SURVEYOR'S CERTIFICATION

I, GAYLE D. JEWELL, A REGISTERED LAND SURVEYOR UNDER THE LAWS OF THE STATE OF NEW MEXICO, DO HEREBY CERTIFY THAT THIS PLAT WAS PREPARED BY ME OR UNDER MY SUPERVISION, SHOWS ALL EASEMENTS OF RECORD, MEETS THE MINIMUM REQUIREMENTS FOR MONUMENTATION AND SURVEYS OF THE ALBUQUERQUE SUBDIVISION ORDINANCE, AND IS TRUE AND CORRECT TO THE BEST OF MY KNOWLEDGE AND BELIEF.

GAYLE D. JEWELL N.M.P.L.S. No. 4071

DATE



98-0010

CHAVEZ • GRIEVES
CONSULTING ENGINEERS, INC.

5639 JEFFERSON STREET N.E. • ALBUQUERQUE, NEW MEXICO 87109
PHONE (505) 344-4080 • FAX (505) 343-8759

CITY OF ALBUQUERQUE
PUBLIC WORKS DEPARTMENT
ENGINEERING DEVELOPMENT GROUP

TITLE: PRELIMINARY PLAT

Design Review Committee City Engineer Approval

City Project No. 582482

Zone Map No. J-16-Z

Sheet 2 Of 9

AS BUILT INFORMATION	
CONTRACTOR	Franklin
STARTED BY	Walker
INSPECTOR'S	DATE 9/98
FIELD	DATE 10/98
VERIFICATION	DATE 10/98
CORRECTED BY	DATE 10/98
MICRO-FILM INFORMATION	
RECORDED BY	DATE
NO.	DATE

BENCH MARKS	
ACS BRASS CAP STAMPED "ACS 13-K17"	
LOCATED SOUTHEAST CORNER OF LOMAS BLVD AND CARLISLE BLVD. ELEV. = 5192.441	

SURVEY INFORMATION	
FIELD NOTES	DATE
BY	ANDREWS, ASBURY AND ROBERTS INC.
NO.	ALBUQUERQUE NM
8/27/97	

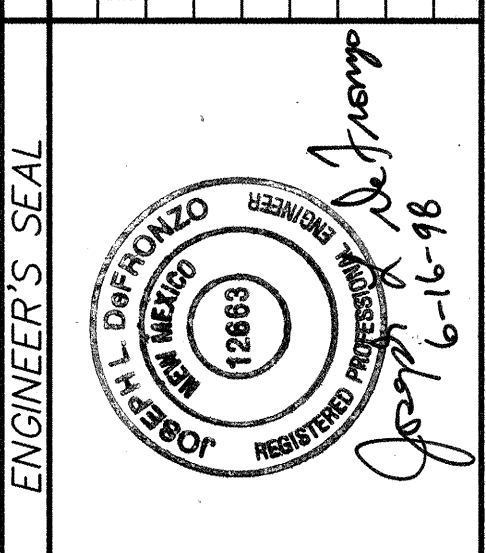

REMARKS	
NO. DATE	BY
DESIGN	DATE 06-98
REVISIONS	DATE 06-98
DESIGNED BY J. ALARID	DATE 06-98
DRAWN BY R. CASASUS	DATE 06-98
CHECKED BY K. HOFFMAN	DATE 06-98

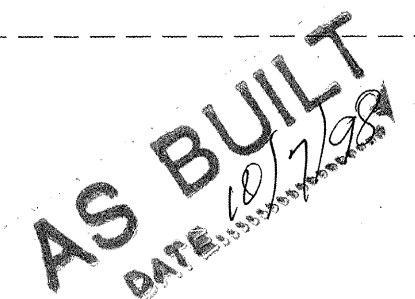

- EXISTING TRAFFIC INTERCONNECT DELETED.
NEW INTERCONNECT LOCATED NORTH OF NEW
SIDEWALK ON LOMAS.



 <p>DESIGN REVIEW COMMITTEE APPROVE JUL 30 1998 DESIGN REVIEW COMMITTEE</p>	City Engineer Approval	Last Design Update	Mo./Day/Yr.	Mo./Day/Yr.
City Project No.	582482	Zone Map No. J-16-Z	Sheet 3	Of 9

[illegible]

JOB NO.: R21-125-5198
FILE: WAL-WOTL.DWG (04-29-98)
REV: 06-30-98 (RC)

DESIGNED BY
J. ALARID

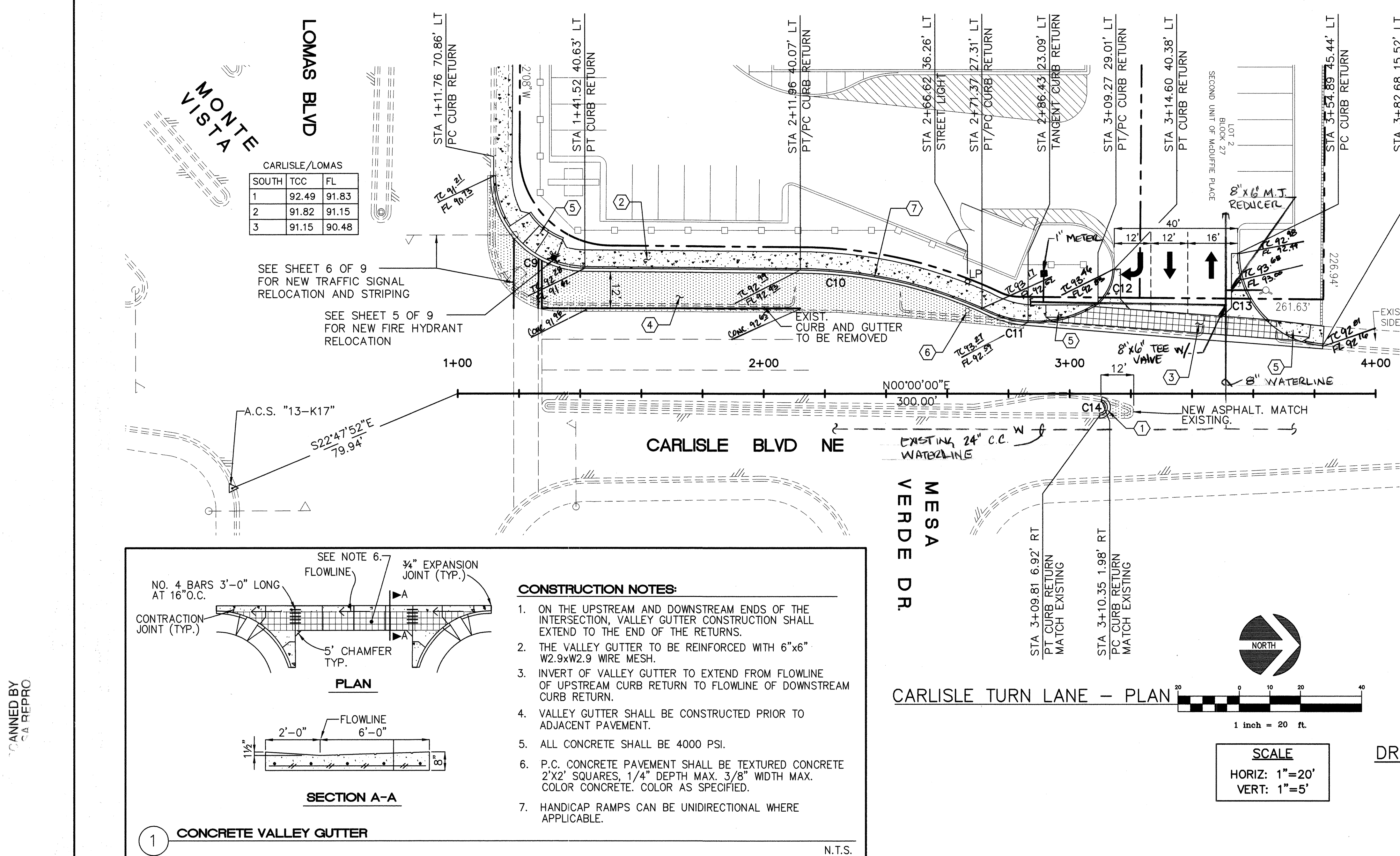

KEYED NOTES

1. INSTALL NEW MEDIAN CURB AND GUTTER PER COA STD DWG 2415.
2. INSTALL NEW 6" CONCRETE SIDEWALK PER COA STD DWG 2430.
3. INSTALL NEW CONCRETE VALLEY GUTTER PER DETAIL 1 THIS SHEET.
4. INSTALL NEW ~~ASPHALT~~ ^{CONCRETE} PAVEMENT PER DETAIL 1 THIS SHEET.
5. INSTALL NEW HANDICAP RAMP PER COA STD DWG 2426.
6. EXISTING STREET LIGHT TO BE RELOCATED BY THE PUBLIC SERVICE COMPANY OF NEW MEXICO. SEE THIS SHEET FOR NEW LOCATION.
7. INSTALL NEW CONCRETE STANDARD CURB AND GUTTER PER COA STD DWG 2415.

CURVE TABLE - AT FACE OF CURB

CURVE	RADIUS	LENGTH	TANGENT	CHORD
C9	30.00'	47.11'	29.99'	42.42'
C10	150.00'	63.45'	32.21'	62.98'
C11	37.34'	39.79'	22.02'	37.93'
C12	15.01'	36.59'	40.88'	28.18'
C13	30.00'	44.91'	27.87'	40.83'
C14	2.50'	7.34'	24.10'	4.97'

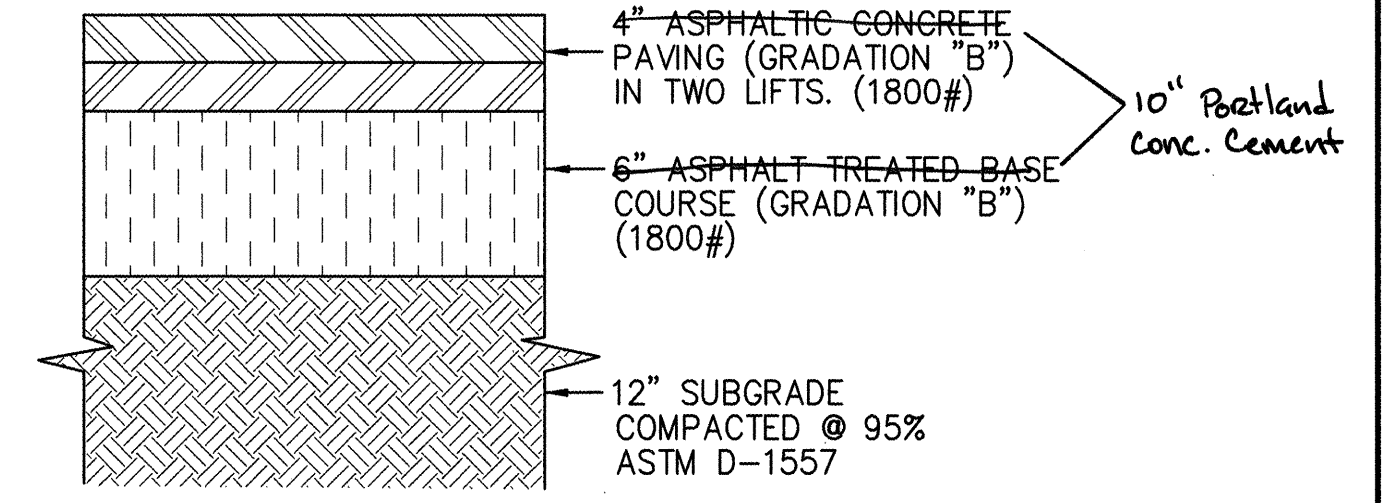

1 PAVEMENT SECTION

N.T.S.

CONSTRUCTION NOTES:

1. ON THE UPSTREAM AND DOWNSTREAM ENDS OF THE INTERSECTION, VALLEY GUTTER CONSTRUCTION SHALL EXTEND TO THE END OF THE RETURNS.
2. THE VALLEY GUTTER TO BE REINFORCED WITH 6"x6" W2.9xW2.9 WIRE MESH.
3. INVERT OF VALLEY GUTTER TO EXTEND FROM FLOWLINE OF UPSTREAM CURB RETURN TO FLOWLINE OF DOWNSTREAM CURB RETURN.
4. VALLEY GUTTER SHALL BE CONSTRUCTED PRIOR TO ADJACENT PAVEMENT.
5. ALL CONCRETE SHALL BE 4000 PSI.
6. P.C. CONCRETE PAVEMENT SHALL BE TEXTURED CONCRETE 2'x2' SQUARES, 1/4" DEPTH MAX. 3/8" WIDTH MAX. COLOR CONCRETE. COLOR AS SPECIFIED.
7. HANDICAP RAMPS CAN BE UNIDIRECTIONAL WHERE APPLICABLE.

CARLISLE TURN LANE - PLAN

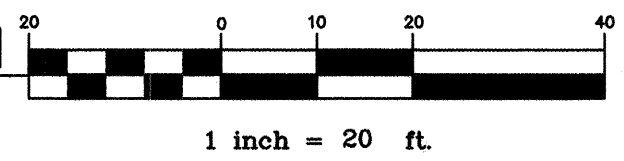

SCALE
HORIZ: 1"=20'
VERT: 1"=5'

DRIVEPAD ELEVATIONS

CARLISLE ENTRANCE		
NORTH	TCC	FL
1	92.28	92.28
2	92.99	92.41
3	92.94	92.40

SOUTH		
TCC	FL	
1	94.32	93.78
2	93.69	93.69
3	93.60	93.60

* QUARTER POINT ELEVATIONS FROM APPROVED GRADING AND DRAINAGE PLAN DATED 3/4/98.

TRAFFIC CONTROL NOTES

1. CONTRACTOR TO PERFORM AS MUCH WORK AS POSSIBLE BEHIND EXISTING CURB AND GUTTER PRIOR TO EFFECTING TRAFFIC ON EITHER LOMAS OR CARLISLE BOULEVARDS.
2. ALL WORK INVOLVING LANE CLOSURES ON EITHER LOMAS BOULEVARD OR CARLISLE BOULEVARD SHALL BE PERFORMED EITHER BETWEEN THE HOURS OF 9:00 A.M. TO 3:00 P.M., OR ON A CONTINUOUS 24-HOUR PER DAY BASIS. IF WORK IS TO LAST MORE THAN THREE CONSECUTIVE 9-3 DAYS, THEN 24-HOUR WORK IS REQUIRED. ALL CLOSED LANES SHALL BE OPENED TO TRAFFIC AT THE CONCLUSION OF EVERY WORK SHIFT.
3. ONLY SINGLE-LANE CLOSURES ARE ALLOWED ON EITHER CARLISLE OR LOMAS. NO MORE THAN ONE LANE OF TRAFFIC SHALL BE ALLOWED TO BE CLOSED AT ANY TIME.
4. CONTRACTOR WILL BE ALLOWED NO MORE THAN FOURTEEN CALENDAR DAYS TO COMPLETE ALL WORK INVOLVING LANE CLOSURE ON LOMAS AND CARLISLE.

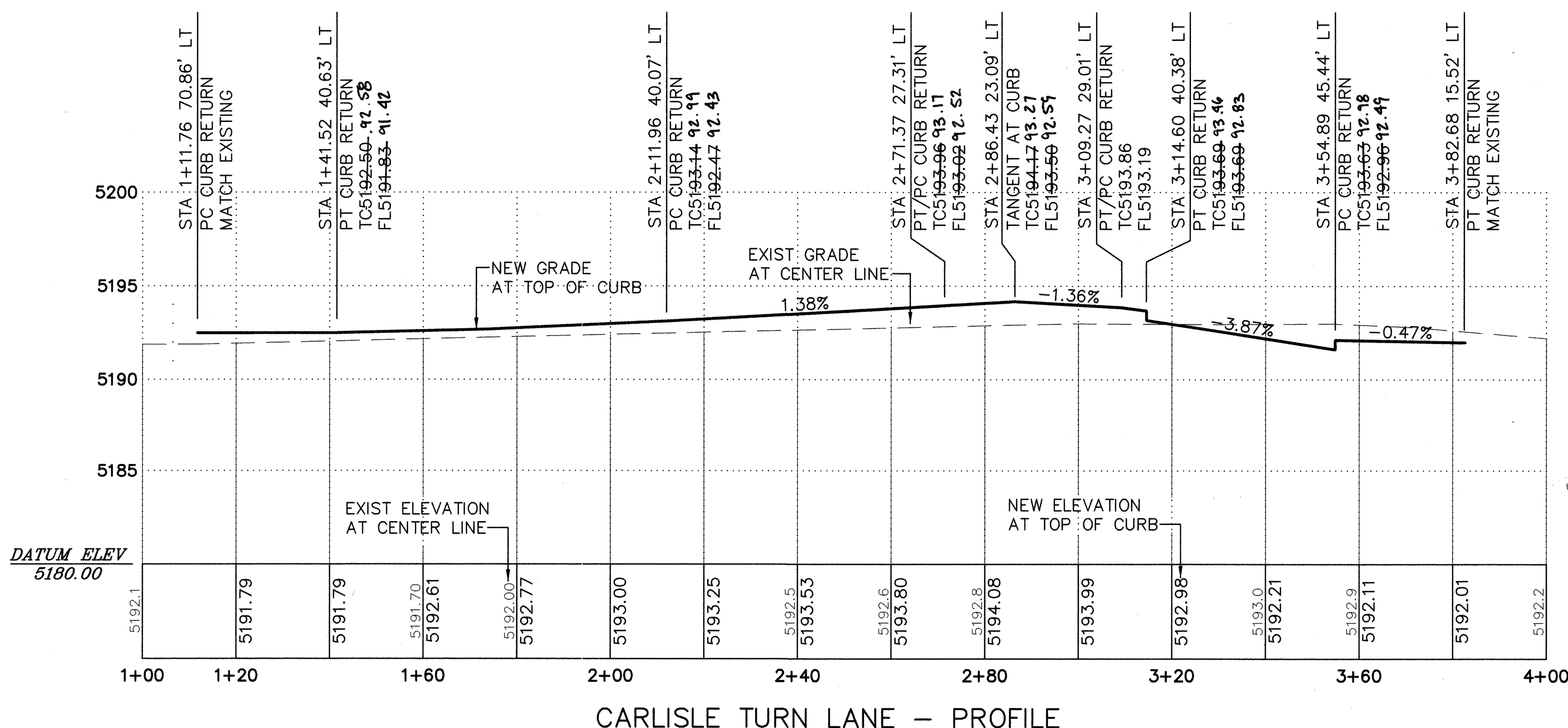

CARLISLE TURN LANE - PROFILE

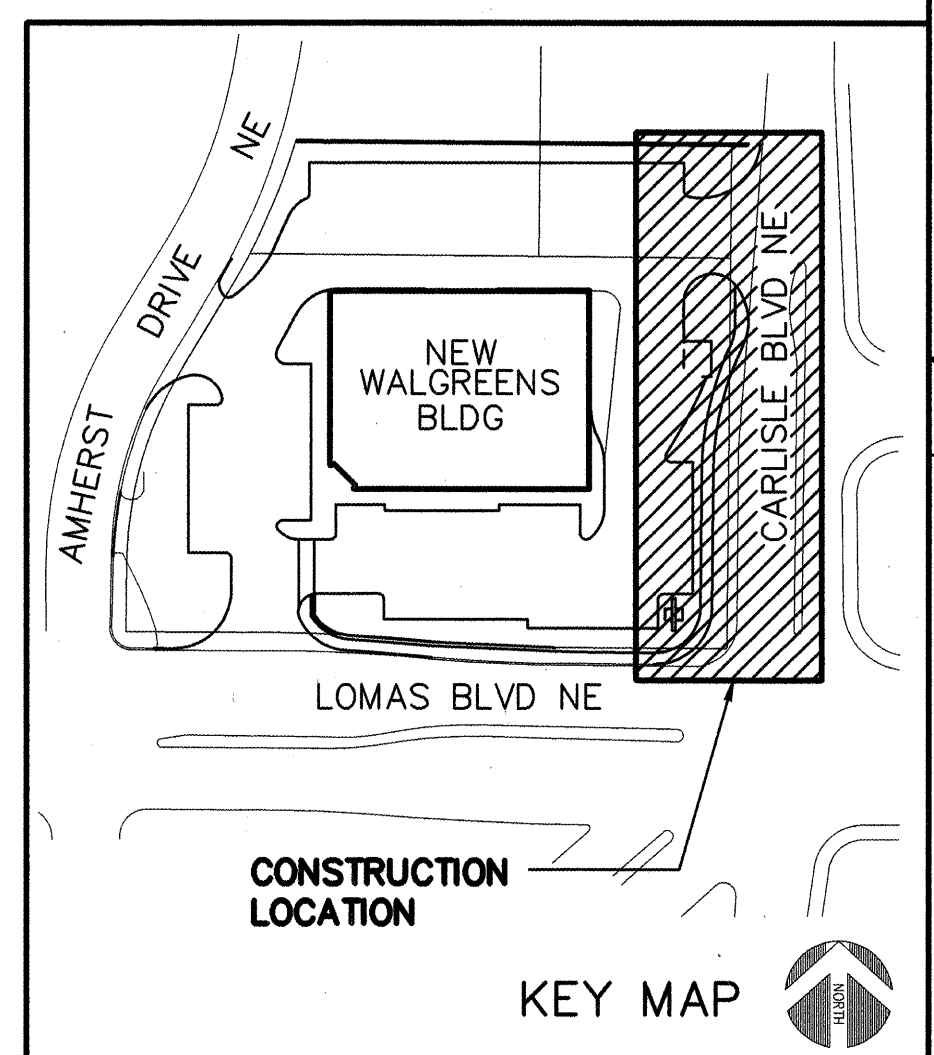

CHAVEZ • GRIEVES
CONSULTING ENGINEERS, INC.
5639 JEFFERSON STREET N.E. • ALBUQUERQUE, NEW MEXICO 87109
PHONE (505) 344-4080 • FAX (505) 343-8759

CITY OF ALBUQUERQUE
PUBLIC WORKS DEPARTMENT
ENGINEERING DEVELOPMENT GROUP

TITLE: **WALGREENS LOMAS AND CARLISLE
CARLISLE TURN LANE/ DRIVE ENTRANCE**

Design Review Committee	City Engineer Approval	Mo./Day/Yr.	Mo./Day/Yr.
APPROVED JUL 30 1998			
DESIGN REVIEW COMMITTEE			
City Project No.	Zone Map No.	Sheet	Of
582482	J-16-Z	4	9

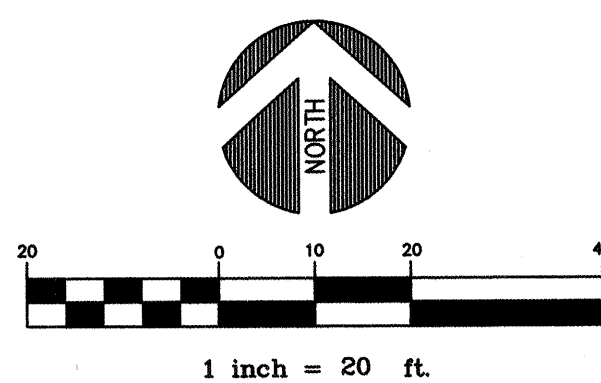

CARLISLE FIRE HYDRANT RELOCATION – PLAN

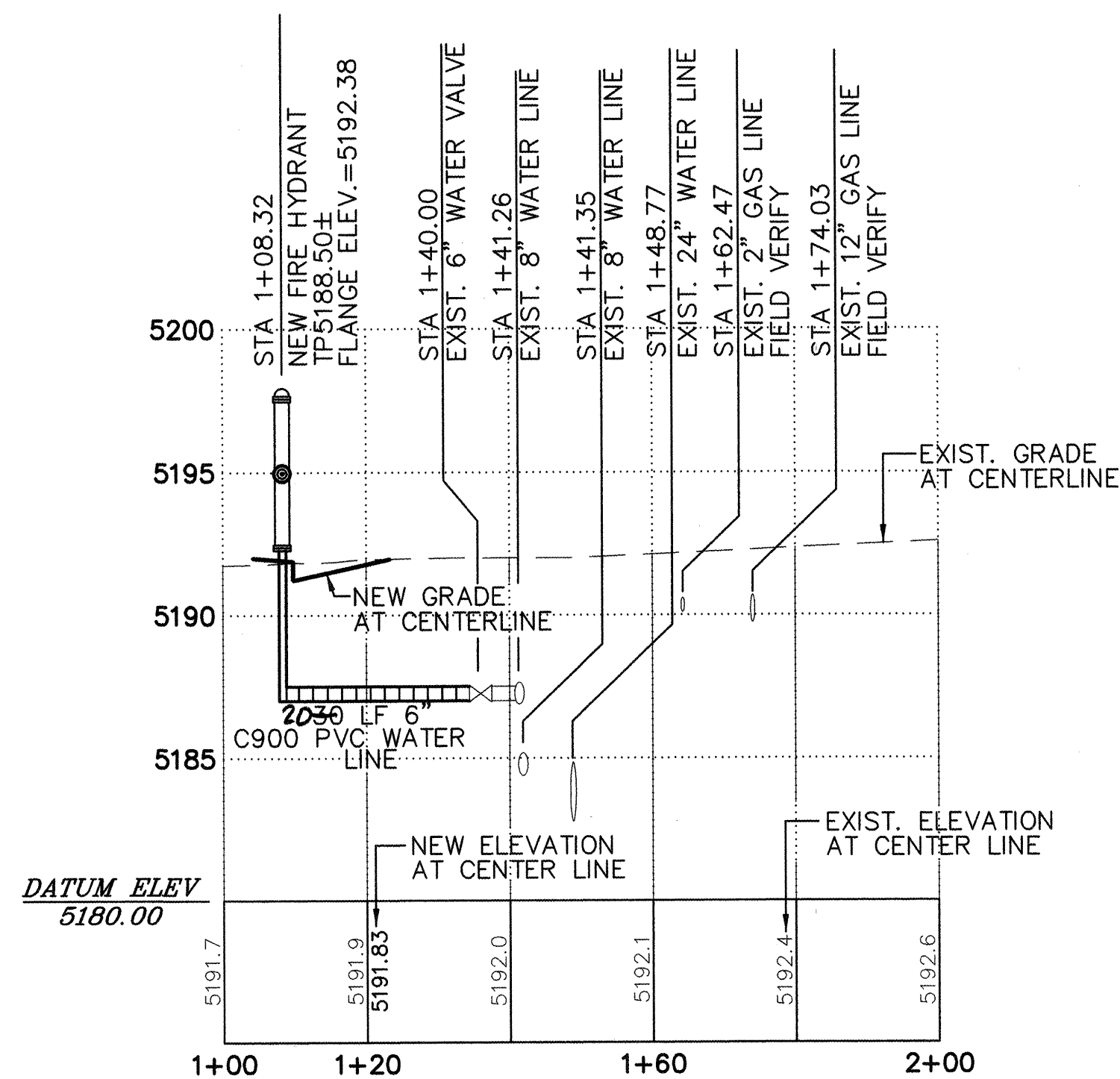

CARLISLE FIRE HYDRANT RELOCATION – PROFILE

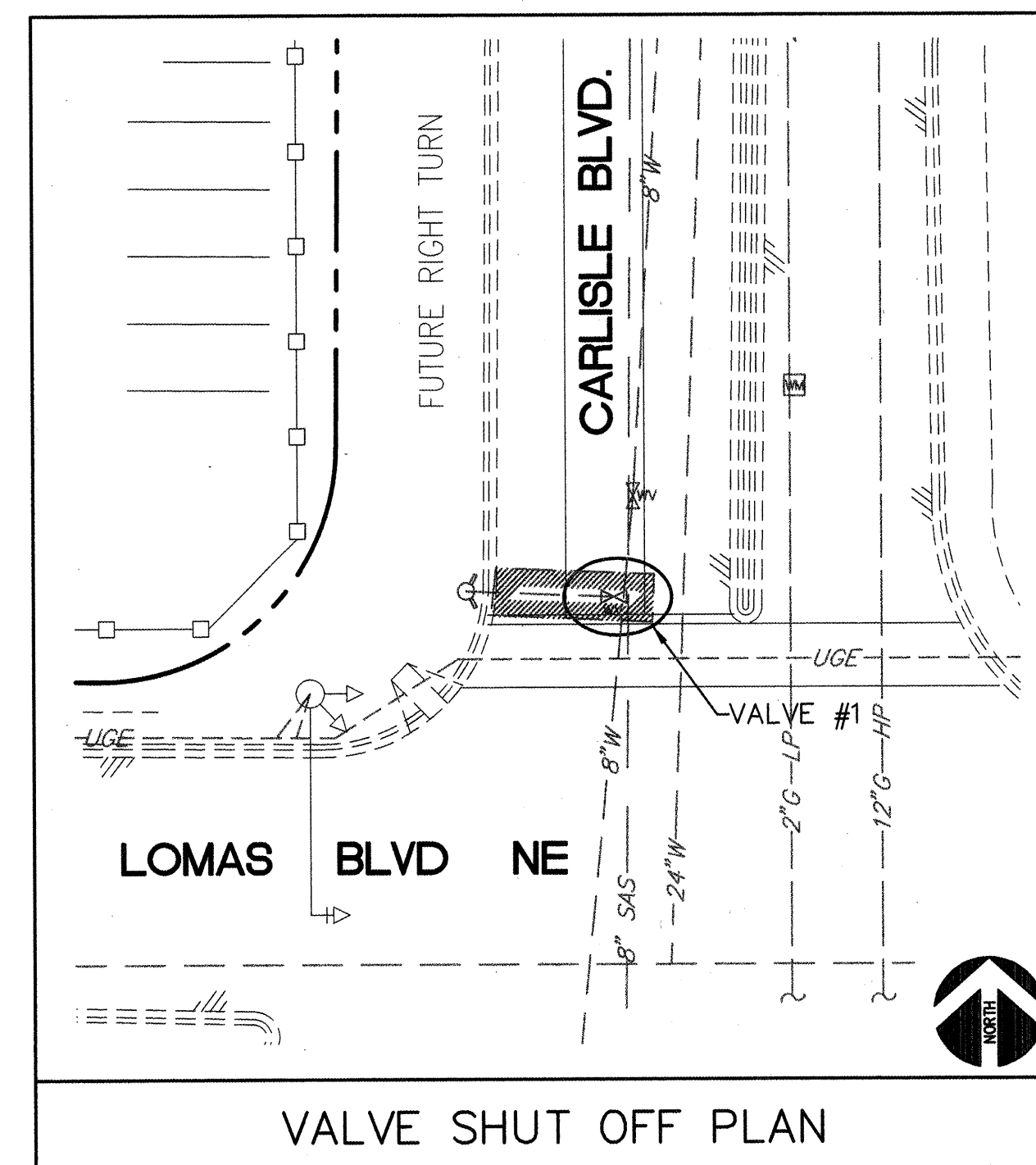

WATER SHUTOFF REQUIREMENTS:

THE CONTRACTOR SHALL BE RESPONSIBLE FOR TIMING AND COORDINATION OF WATER SHUTOFF. AT LEAST FIVE (5) WORKING DAYS PRIOR TO CONSTRUCTION, CONTRACTOR SHALL CONTACT THE WATER SYSTEMS DIVISION, 857-8200, TO INITIATE IMPLEMENTATION OF THE NON-PRESSURIZED CONNECTION PLAN. IN ORDER TO COMPLETE THIS CONNECTION, THE FOLLOWING VALVE MUST BE CLOSED BY WATER SYSTEMS PERSONNEL:
VALVE TO CLOSE: NUMBER ONE (#1) AS SHOWN

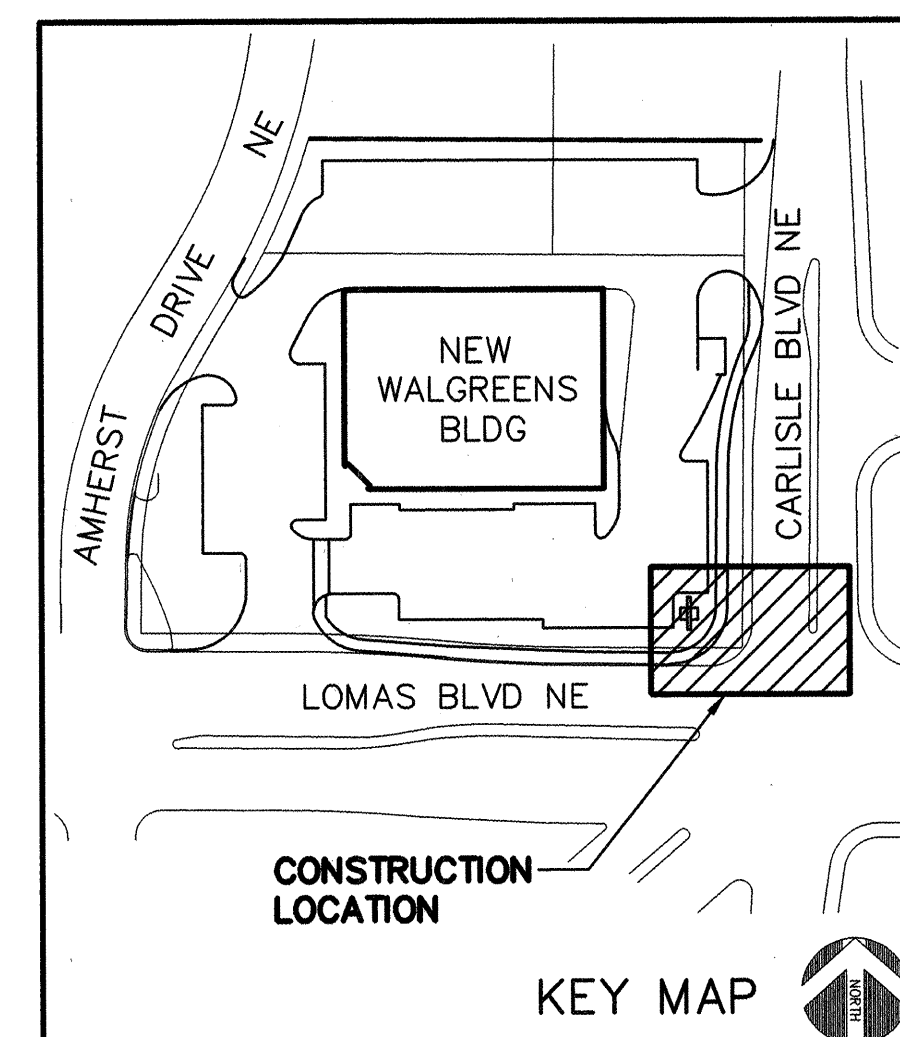

 **CHAVEZ • GRIEVES**
CONSULTING ENGINEERS, INC.
5639 JEFFERSON STREET N.E. • ALBUQUERQUE, NEW MEXICO 87109
PHONE (505) 344-4080 • FAX (505) 343-8759

CITY OF ALBUQUERQUE
PUBLIC WORKS DEPARTMENT
ENGINEERING DEVELOPMENT GROUP

TITLE: WALGREENS LOMAS AND CARLISLE
CARLISLE FIRE HYDRANT RELOCATION

Design Review Committee 		City Engineer Approval		Last Design Update	Mo./Day/Yr.	Mo./Day/Yr.
City Project No. 582482		Zone Map No. J-16-7		Sheet 5	Of 9	



1. COORDINATE WITH COA PERSONNEL TO ESTABLISH A COLOR CODE PRIOR TO CONSTRUCTION.
2. USE EXISTING OPTICOM CABLE IN NEW TRAFFIC SIGNAL. IF CABLE LENGTH IS TOO SHORT THEN NEW CABLE WILL HAVE TO BE PULLED TO CONTROL PANEL AT CORNER OF MONTE VISTA AND CARLISLE. SPLICES ARE NOT ALLOWED.

SIGNAL HEAD DETAIL



MA1	60'(MASTARM/POLE)	57'	1-5C	MCC	14	SIGNAL(1M)
		47'	1-5C	MCC	14	SIGNAL(2M)
		25'	1-7C	MCC	14	SIGNAL(1B)
		25'	1-7C	MCC	14	SIGNAL(2B)
		47'	1-5C	MCC	14	PED HEAD(PS1)
		20'	1-LL1	MCC	14	PED PUSH BUTTON (PPB1)
		40'	1-3C	MCC	20	OPTICOM DETECTOR
		57'	1-1C	THHN	8	NEUTRAL
		57'	1-1C	BARE	8	GROUND



- 1 REMOVE EXISTING DETECTOR LOOPS
- 2 EXISTING CONDUITS/ CABLES TO BE REMOVED.
- 3 EXISTING TRAFFIC INTERCONNECT. CONTRACTOR TO USE EXTREME CAUTION DURING CONSTRUCTION TO ENSURE THAT NO DAMAGE IS DONE TO EXISTING INTERCONNECT. IF EXISTING CABLE IS DAMAGED DURING CONSTRUCTION. THE CONTRACTOR IS RESPONSIBLE FOR SUPPLYING AND INSTALLING NEW CABLE UP TO NEXT EXISTING SPLICE CABINET TO THE WEST. NO SPLICES ALLOWED.
- 4 INSTALL NEW TRAFFIC SIGNAL PULL BOX PER COA STD DWG 2520.
- 5 INSTALL NEW TRAFFIC SIGNAL MAST ARM FOUNDATION PER COA INTERIM STANDARD SPECIFICATIONS FOR SIGNAL CONSTRUCTION. 1-35' MASTARM.
- 6 INSTALL NEW TRAFFIC LOOP DETECTOR CONDUIT STUBOUT PER COA STD. DWG 2522.
- 7 INSTALL NEW 4" REFLECTORIZED WHITE TRAFFIC LANE STRIPE 88' FROM STOP BAR.
- 8 INSTALL NEW PEDESTRIAN/ VEHICLE STOP BAR STRIPING. MATCH EXISTING STRIPING
- 9 INSTALL FOUR LOOP CONNECTIONS PER COA INTERIM STANDARD SPECIFICATIONS FOR LOOP CONNECTIONS.
- 10 EXISTING DETECTOR LOOP CABLES FROM CONTROL CABINET (CC1) TO PULL BOX (EX1) WILL HAVE TO BE REMOVED AND REPLACED FROM THREE (DL) CABLES TO FOUR (DL) CABLES.

ALL SIGNAL WORK MUST COMPLY WITH COA INTERM STANDARD SPECIFICATIONS FOR SIGNAL CONSTRUCTION.

* FOR TRAFFIC SIGN INSTALLATION AND MOUNTING. CONTACT THE TRAFFIC ENGINEER AT (505) 857-7000.

[illegible]

AS BUILT
DATE 10/7/98

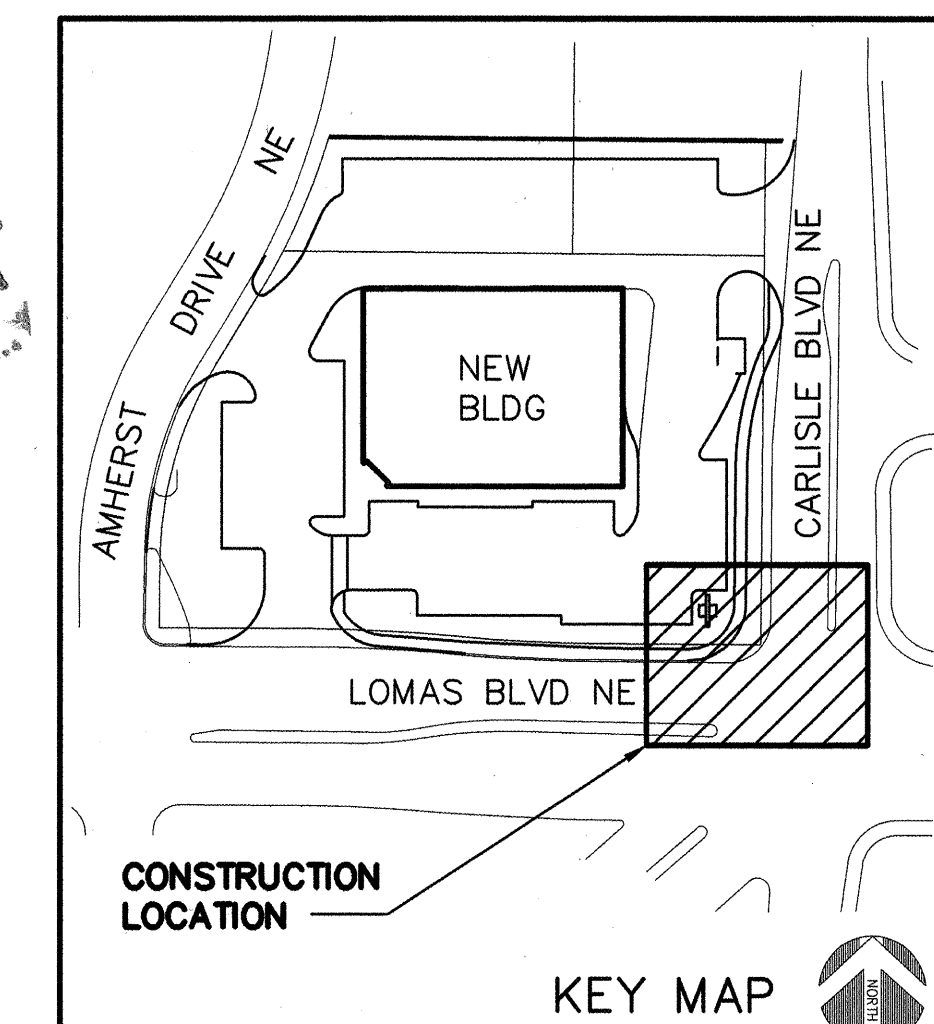
CHAVEZ • GRIEVES
 CONSULTING ENGINEERS, INC.

5639 JEFFERSON STREET N.E. • ALBUQUERQUE, NEW MEXICO 87109
PHONE (505) 344-4080 • FAX (505) 343-8759

CITY OF ALBUQUERQUE
PUBLIC WORKS DEPARTMENT
ENGINEERING DEVELOPMENT GROUP

TITLE: WALGREENS LOMAS AND CARLISLE
CARLISLE TRAFFIC SIGNAL RELOCATION

Design Review Committee

City Engineer Approval

APPROVED

JUL 30 1998

DESIGN
REVIEW COMMITTEE

City Project No.

582482

Zone Map No.
J-16-Z

Sheet 6

9

JOB NO.: R21-125-5198
FILE: WAL-WOFT.DWG (04-29-98)
REV: 06-29-98 (RC)

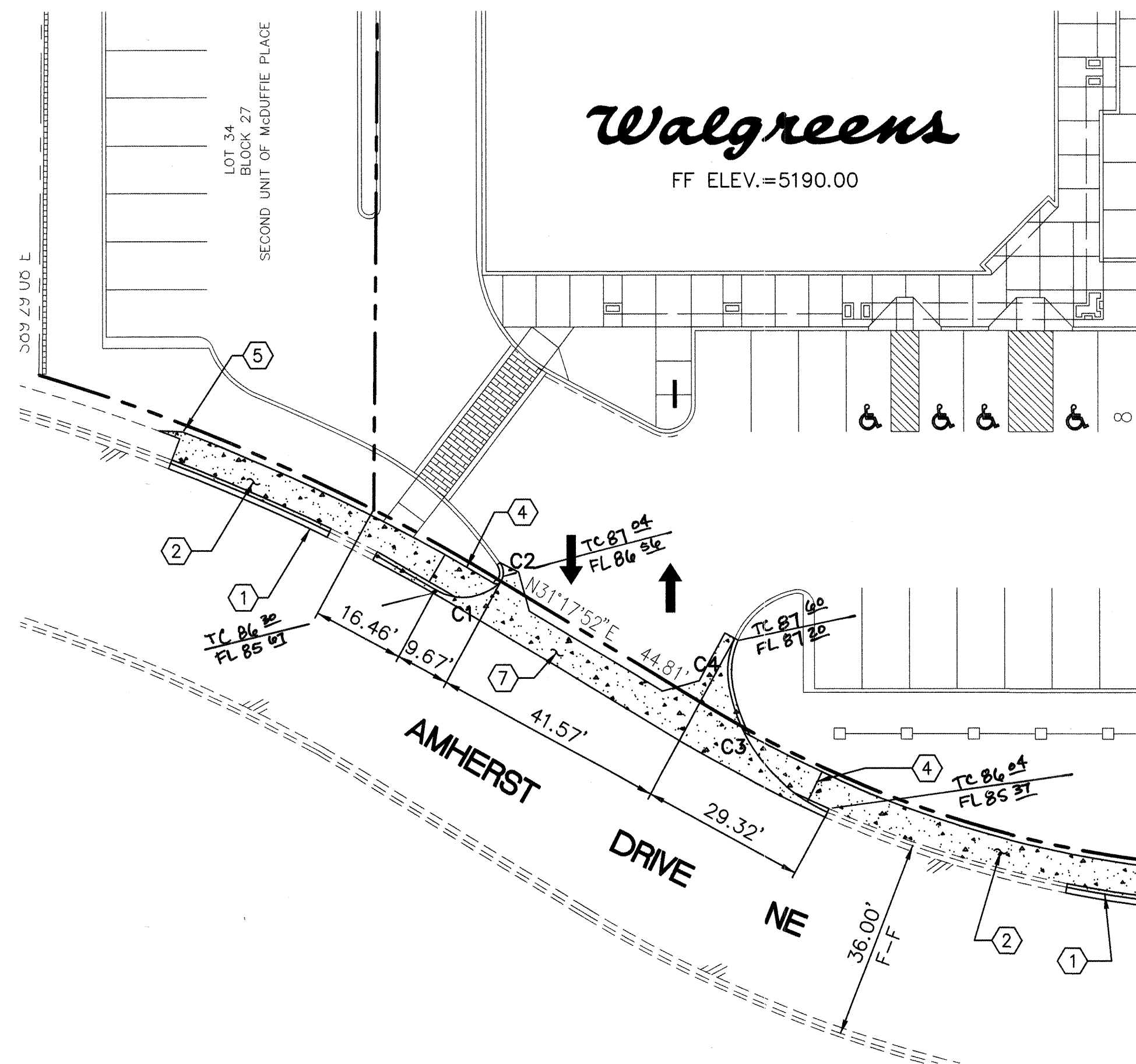

AMHERST DRIVE ENTRANCE - PLAN

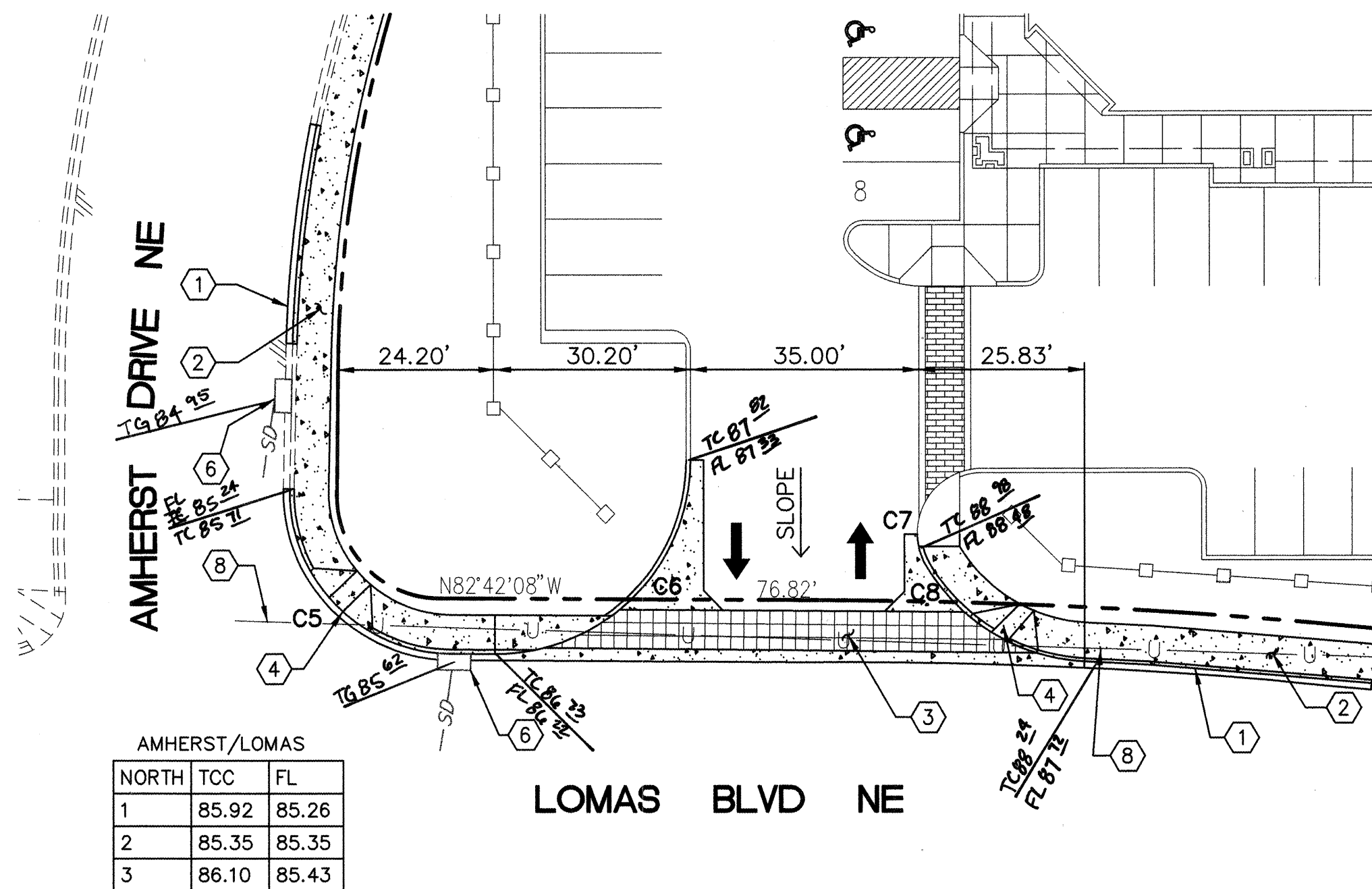
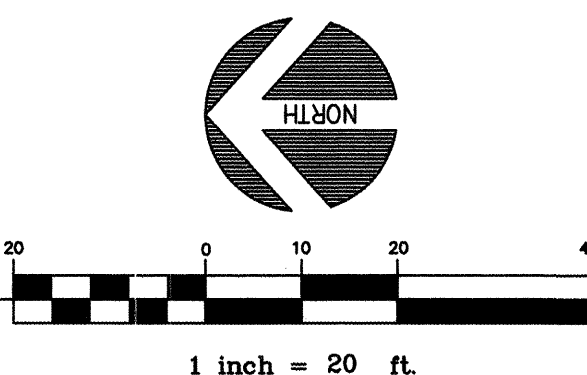

AMHERST/LOMAS		
NORTH	TCC	FL
1	85.92	85.26
2	85.35	85.35
3	86.10	85.43

LOMAS DRIVE ENTRANCE - PLAN

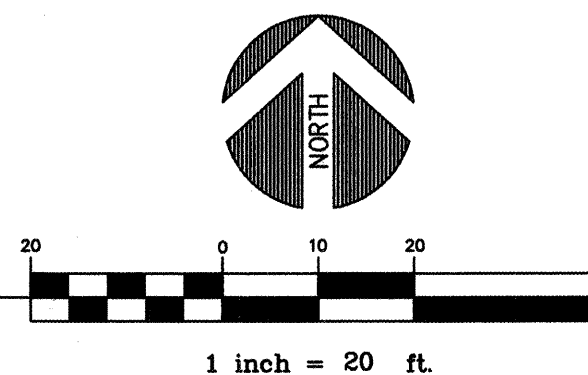

TRAFFIC CONTROL NOTES

- CONTRACTOR TO PERFORM AS MUCH WORK AS POSSIBLE BEHIND EXISTING CURB AND GUTTER PRIOR TO EFFECTING TRAFFIC ON EITHER LOMAS OR CARLISLE BOULEVARDS.
- ALL WORK INVOLVING LANE CLOSURES ON EITHER LOMAS BOULEVARD OR CARLISLE BOULEVARD SHALL BE PERFORMED EITHER BETWEEN THE HOURS OF 9:00 A.M. TO 3:00 P.M., OR ON A CONTINUOUS 24-HOUR PER DAY BASIS. IF WORK IS TO LAST MORE THAN THREE CONSECUTIVE 9-3 DAYS, THEN 24-HOUR WORK IS REQUIRED. ALL CLOSED LANES SHALL BE OPENED TO TRAFFIC AT THE CONCLUSION OF EVERY WORK SHIFT.
- ONLY SINGLE-LANE CLOSURES ARE ALLOWED ON EITHER CARLISLE OR LOMAS. NO MORE THAN ONE LANE OF TRAFFIC SHALL BE ALLOWED TO BE CLOSED AT ANY TIME.
- CONTRACTOR WILL BE ALLOWED NO MORE THAN FOURTEEN CALENDAR DAYS TO COMPLETE ALL WORK INVOLVING LANE CLOSURE ON LOMAS AND CARLISLE.

CURVE DATA - AT FACE OF CURB

CURVE	RADIUS	LENGTH	TANGENT	CHORD
C1	10.00'	11.68'	6.61'	11.03'
C2	3.00'	4.71'	2.99'	4.24'
C3	30.00'	29.68'	16.18'	28.48'
C4	15.00'	22.96'	14.41'	20.78'
C5	25.00'	39.62'	25.35'	35.60'
C6	30.00'	47.32'	30.20'	42.57'
C7	10.00'	20.99'	17.42'	17.35'
C8	30.00'	29.83'	16.28'	28.61'

KEYED NOTES

- INSTALL NEW CONCRETE STANDARD CURB AND GUTTER PER COA STD DWG 2415.
- INSTALL NEW 6' CONCRETE SIDEWALK PER COA STD DWG 2430.
- INSTALL NEW CONCRETE VALLEY GUTTER PER DETAIL 1 SHEET 4 OF 9.
- INSTALL NEW HANDICAP RAMP PER COA STD DWG 2426.
- TRANSITION FROM 6' SIDEWALK TO 4' SIDEWALK IN 5'.
- INSURE PROPER DRAINAGE TO EXISTING STORM INLETS.
- INSTALL NEW CONCRETE VALLEY GUTTER PER COA STD DWG 2420.
- EXISTING TRAFFIC INTERCONNECT. CONTRACTOR TO USE EXTREME CAUTION DURING CONSTRUCTION TO ENSURE THAT NO DAMAGE IS DONE TO EXISTING INTERCONNECT. IF EXISTING CABLE IS DAMAGED DURING CONSTRUCTION, THE CONTRACTOR IS RESPONSIBLE FOR SUPPLYING AND INSTALLING NEW CABLE UP TO NEXT EXISTING SPLICE CABINET TO THE WEST. NO SPLICES ALLOWED.

DRIVEPAD ELEVATIONS

AMHERST ENTRANCE			LOMAS ENTRANCE		
NORTH	TCC	FL	WEST	TCC	FL
1	85.76	85.76	1	86.22	86.22
2	85.97	85.97	2	87.14	86.56
3	86.18	86.18	3	87.45	86.91
SOUTH			EAST		
NORTH	TCC	FL	WEST	TCC	FL
1	86.92	86.38	1	87.17	87.63
2	86.01	86.01	2	87.60	87.60
3	85.64	85.64	3	88.20	87.57

* QUARTER POINT ELEVATIONS FROM APPROVED GRADING AND DRAINAGE PLAN DATED 3/4/98.

AS BUILT
DATE: 10/17/98

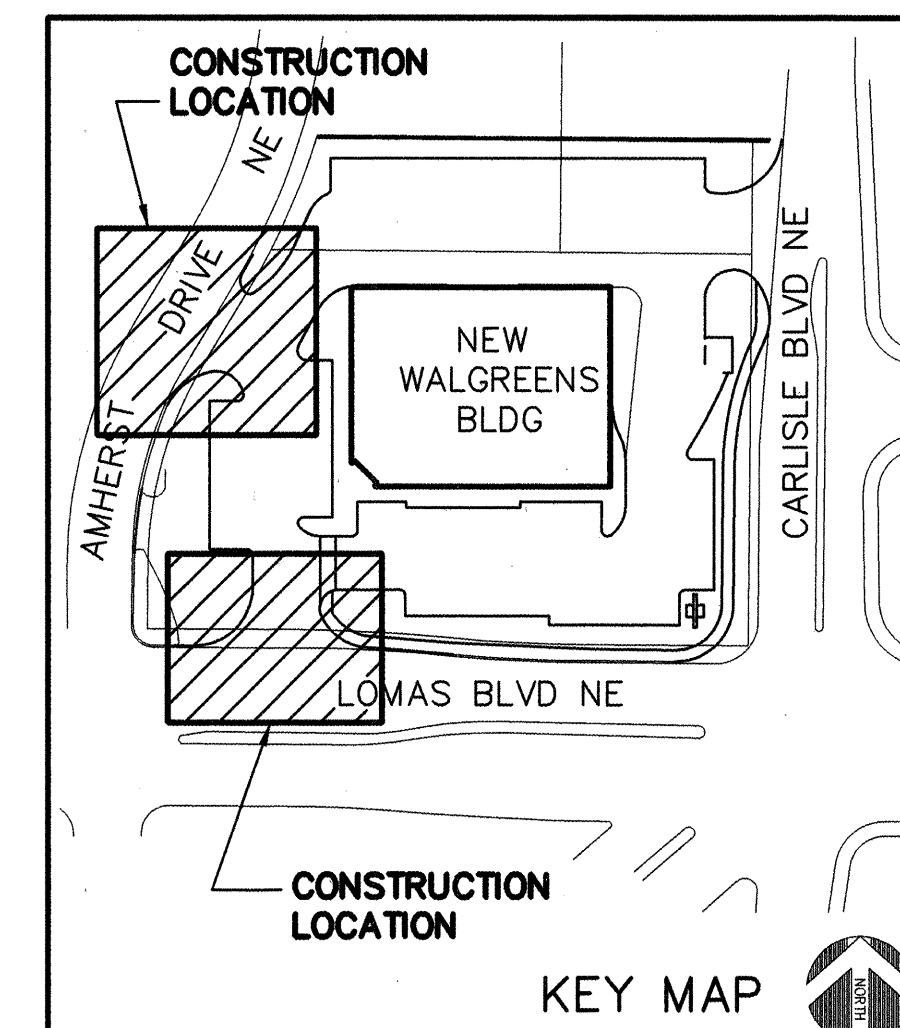

CITY OF ALBUQUERQUE
PUBLIC WORKS DEPARTMENT
ENGINEERING DEVELOPMENT GROUP

TITLE: WALGREENS LOMAS AND CARLISLE LOMAS AND AMHERST DRIVE ENTRANCES

Design Review Committee	City Engineer Approval	Mo./Day/Yr.	Mo./Day/Yr.
JUL 30 1998			
DESIGN REVIEW COMMITTEE			
City Project No.	Zone Map No.	Sheet	Of
582482	J-16-Z	7	9

AS BUILT INFORMATION		BENCH MARKS		SURVEY INFORMATION		ENGINEER'S SEAL	
CONTRACTOR	WORK STARTED BY	DATE	DATE	NO.	DATE	BY	REMARKS
	ACCEPTANCE BY	DATE	DATE	ANDREWS, ASBURY AND ROBERTS INC.	8/27/97		
	FIELD REVISIONS BY	DATE	DATE	ALBUQUERQUE NM			
	DRAWINGS CORRECTED BY	DATE	DATE				
	RECORDED BY	DATE	DATE				
	NO.						

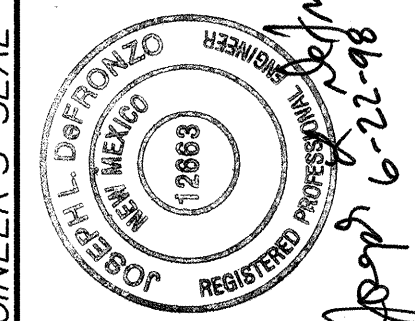

DATE: 6-22-98

DESIGNED BY	DATE	06-98
DRAWN BY	DATE	06-98
CHECKED BY	DATE	06-98

CONSTRUCTION TRAFFIC CONTROL GENERAL NOTES

1. CONTRACTOR MUST OBTAIN FROM CONSTRUCTION COORDINATION AN EXCAVATION/BARRICADING PERMIT BEFORE ENGAGING IN ANY CONSTRUCTION, MAINTENANCE OR REPAIR WORK IN ANY OF THE CITY OF ALBUQUERQUE'S RIGHTS-OF-WAY. EMERGENCY WORK THAT WOULD PRESERVE LIFE OR PROPERTY IS EXCLUDED WITH THE UNDERSTANDING, THAT A PERMIT SHALL BE OBTAINED WITHIN 24 TO 48 HOURS.

2. CONTRACTOR SHALL AT THE TIME OF PERMIT REQUEST, SUBMIT FOR APPROVAL BY CONSTRUCTION COORDINATION, A TRAFFIC CONTROL PLAN DETAILING ALL EXISTING TOPOGRAPHY SUCH AS LANE WIDTHS, DRIVEWAYS, AND BUSINESS/RESIDENTIAL ACCESSES. THE TRAFFIC CONTROL PLAN SHALL INCLUDE ALL PHASES OF WORK AND SCHEDULES INVOLVED IN THE CONSTRUCTION PROJECT. ANY SEPARATE PHASES OF A CONSTRUCTION PROJECT SHALL BE GIVEN AN INDIVIDUAL PERMIT EACH. BLANKET PERMITS WILL NOT BE ISSUED.

3. THESE TYPICAL TRAFFIC CONTROL PLANS DO NOT REFLECT THE EXISTING TOPOGRAPHY SUCH AS DRIVEWAYS, LANE WIDTHS, AND BUSINESS/RESIDENTIAL ACCESSES. EVERY LOCATION THAT REQUIRES CONSTRUCTION TRAFFIC CONTROL SHALL HAVE A DETAILED TRAFFIC CONTROL PLAN SHOWING ALL EXISTING TOPOGRAPHY.

4. CONSTRUCTION SHALL NOT BEGIN UNLESS A TRAFFIC CONTROL PLAN HAS BEEN APPROVED AND VERIFIED BY CONSTRUCTION COORDINATION.

5. CONSTRUCTION COORDINATION SHALL BE NOTIFIED 48 HOURS PRIOR TO ANY TRAFFIC CONTROL CHANGES NEEDED BY CONTRACTOR, THAT WERE NOT PREVIOUSLY APPROVED. THESE TRAFFIC CONTROL CHANGES SHALL BE REQUESTED IN WRITING ACCOMPANIED WITH A TRAFFIC CONTROL PLAN REFLECTING SUCH CHANGES.

6. ALL CONSTRUCTION TRAFFIC CONTROL DEVICES SHALL COMPLY TO THE MANUAL ON UNIFORM TRAFFIC CONTROL DEVICES (MUTCD), LATEST EDITION. IT IS THE RESPONSIBILITY OF THE CONTRACTOR TO INSTALL, SERVICE AND MAINTAIN ALL TRAFFIC CONTROL DEVICES. TRAFFIC CONTROL DEVICES SHALL NOT BE REMOVED OR ALTERED IN ANY WAY WITHOUT THE APPROVAL OF CONSTRUCTION COORDINATION, PER SECTION 6A-4 OF THE MUTCD, LATEST EDITION.

7. THE CONSTRUCTION TRAFFIC CONTROL INITIAL SET-UP SHALL BE BY AN AMERICAN TRAFFIC SAFETY SERVICES ASSOCIATION (ATSSA) CERTIFIED WORKSITE TRAFFIC SUPERVISOR. THE MAINTENANCE AND SERVICING SHALL ALSO BE DONE BY AN ATSSA CERTIFIED WORKSITE TRAFFIC SUPERVISOR OR EQUIVALENT.

8. CONTRACTOR IS RESPONSIBLE TO MAINTAIN AND SERVICE ALL TRAFFIC CONTROL DEVICES 24 HOURS A DAY, 7 DAYS A WEEK THROUGHOUT LENGTH OF PROJECT. CONTRACTOR IS RESPONSIBLE THAT ALL TRAFFIC CONTROL DEVICES COMPLY WITH THE MUTCD, LATEST EDITION.

9. ALL ADVANCE WARNING SIGNS SHALL BE DOUBLE INDICATED WHENEVER THERE ARE MULTI-LANE TRAFFIC IN ANY ONE GIVEN DIRECTION AND THERE IS SUFFICIENT MEDIAN SPACE.

10. ALL BARRICADES IN ALL TAPERS AND TANGENTS SHALL BE PLACED APART, A DISTANCE MEASURED IN FEET, EQUAL TO THAT OF THE POSTED SPEED LIMIT. NO EXCEPTIONS UNLESS APPROVED BY CONSTRUCTION COORDINATION PER MUTCD SECTION 6A-4.

11. CONTRACTOR SHALL NOT BEGIN WORK BEFORE 7:00 A.M. OR END WORK AFTER 7:00 P.M. WITHOUT THE APPROVAL OF CONSTRUCTION COORDINATION.

12. CONTRACTOR IS RESPONSIBLE TO PROVIDE CONSTRUCTION COORDINATION, A WEEKLY LOG OF DAILY INSPECTIONS OF BARRICADE AND MAINTENANCE SCHEDULES ON PROJECTS THAT ARE OVER ONE WEEK DURATION.

13. EQUIPMENT OR MATERIALS SHALL NOT BE STORED WITHIN 15 FEET OF A TRAVELLED TRAFFIC LANE DURING NON-WORKING HOURS WITHOUT THE APPROVAL OF CONSTRUCTION COORDINATION.

14. CONTRACTOR SHALL PROVIDE AND MAINTAIN A SAFE AND ADEQUATE MEANS OF CHANNELIZING PEDESTRIAN TRAFFIC AROUND AND THROUGH THE CONSTRUCTION AREA.

15. CONTRACTOR IS RESPONSIBLE FOR OBLITERATION OF ANY CONFLICTING STRIPING AND RESPONSIBLE FOR ALL TEMPORARY STRIPING.

16. CONTRACTOR SHALL MAINTAIN ACCESS TO ALL FACILITIES, BUSINESSES AND/OR RESIDENTS AT ALL TIMES.

17. CONTRACTOR SHALL PROVIDE ACCESS SIGNS FOR BUSINESSES LOCATED WITHIN THE CONSTRUCTION AREA UNDER THE SUPERVISION OF CONSTRUCTION COORDINATION. EACH ACCESS SIGN SHALL HAVE 5 INCH, WHITE OPAQUE LETTERING ON BLUE REFLECTORIZED BACKGROUND. ACCESS SIGNS SHALL BE CONSIDERED INCIDENTAL TO THE BID AND NOT PART OF THE CONTRACT UNLESS OTHERWISE STATED. NO MORE THAN 3 BUSINESSES SHALL BE LISTED ON A ACCESS SIGN. SHOPPING CENTERS AND MALLS SHALL BE LISTED AS SUCH.

18. ALL ADVANCE WARNING SIGNS SHALL MEET THE MINIMUM REFLECTIVE INTENSITY REQUIREMENTS SET FORTH BY THE CITY OF ALBUQUERQUE. CONSTRUCTION COORDINATION SHALL DETERMINE ALL REQUIREMENTS AND APPROVE OR DISAPPROVE ANY ADVANCE WARNING SIGN PER SECTION 6A-4 OF THE MUTCD, LATEST EDITION.

19. 24 HOURS PRIOR TO OCCUPYING OR CLOSING OF A RIGHT-OF-WAY, CONTRACTOR SHALL NOTIFY: POLICE, FIRE DEPARTMENT, SCHOOLS, HOSPITALS, TRANSIT AUTHORITY, BUSINESSES AND/OR RESIDENTS THAT WILL BE AFFECTED BY THE CONSTRUCTION.

20. ANY FIELD ADJUSTMENTS SHALL BE APPROVED BY CONSTRUCTION COORDINATION.

21. EXCAVATIONS SHALL BE PLATED, TEMPORARILY PATCHED OR RESURFACED PRIOR TO OPENING OF TRAFFIC. A MINIMUM OF 11 FEET SHALL BE PROVIDED FOR TRAFFIC IN ANY GIVEN DIRECTION. CONTRACTOR IS RESPONSIBLE FOR ANY WORK INVOLVED IN SATISFYING THESE REQUIREMENTS.

22. CONTRACTOR SHALL AT ALL TIMES COMPLY WITH THE FOLLOWING:
1. STANDARDS AND REQUIREMENTS SET FORTH IN THE MANUAL ON UNIFORM TRAFFIC CONTROL DEVICES, LATEST EDITION.
2. THE CITY OF ALBUQUERQUE TRAFFIC CODE, LATEST EDITION.
3. SECTION 19 OF THE CITY OF ALBUQUERQUE'S STANDARD SPECIFICATIONS FOR PUBLIC WORK CONSTRUCTION, AS WELL AS OTHER SECTIONS.

23. FAILURE TO COMPLY WITH ANY OF THE ABOVE MENTIONED, WILL BE ADEQUATE CAUSE TO CEASE ALL WORK ON ANY CONSTRUCTION PROJECT. WORK WILL NOT RESUME UNTIL ALL REQUIREMENTS ARE ADDRESSED AND APPROVED BY CONSTRUCTION COORDINATION.

24. ALL TRAFFIC CONTROL DEVICES SHALL BE KEPT IN NEW-CLEAN CONDITION. WASHING OF EQUIPMENT IS INCIDENTAL TO ITS PLACEMENT AND MAINTENANCE.

25. TRAFFIC CONTROL STANDARDS APPLY ONLY WHERE THE CONSTRUCTION TRAFFIC CONTROL PLANS ARE NOT SPECIFIC.

26. ADVANCE WARNING SIGNS SHALL BE 36"x36" WITH SUPER ENGINEERING GRADE SHEETING OR BETTER.

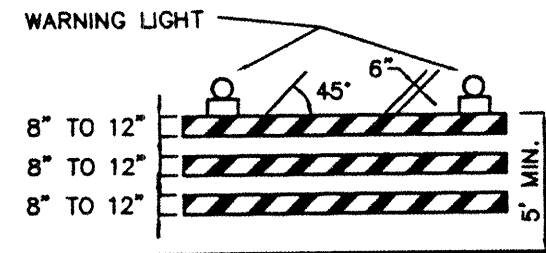

TYPE III BARRICADE

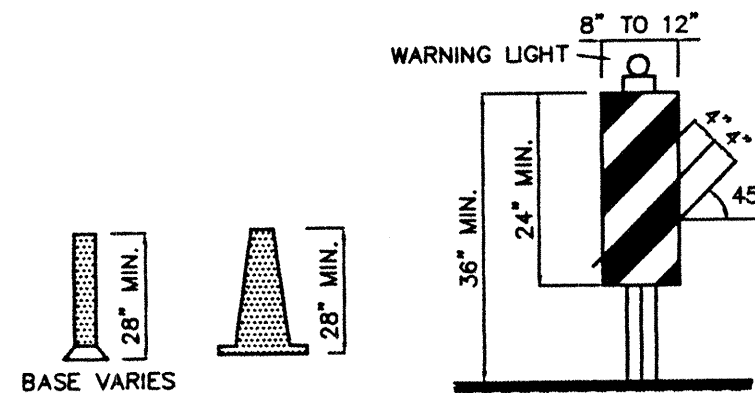

VERTICAL PANEL

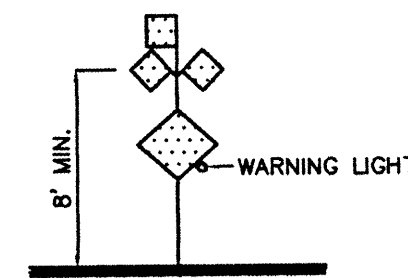

HIGH LEVEL WARNING DEVICE

CONES

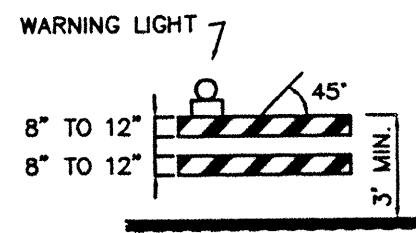

TYPE II BARRICADE COLLAPSIBLE

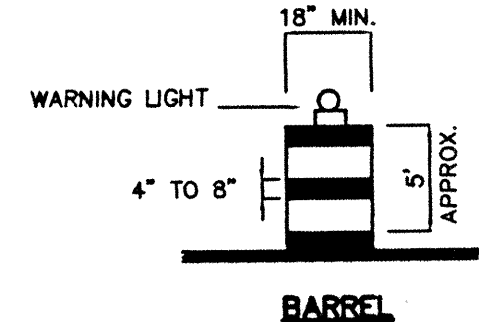

BARREL

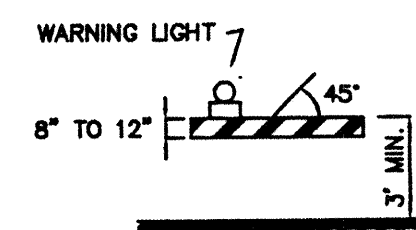

TYPE I BARRICADE COLLAPSIBLE

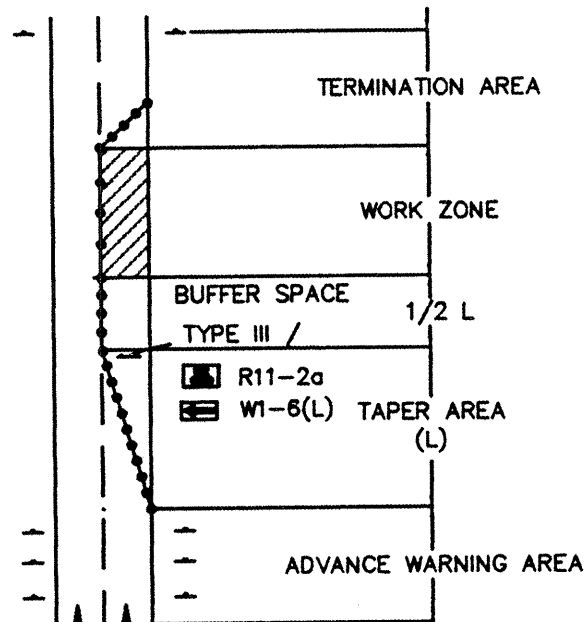

TRAFFIC CONTROL ELEMENTS

LEGEND

- WORK AREA
- BARRICADE - TYPE I, TYPE II, OR BARREL
- BARRICADE - TYPE III
- VERTICAL PANEL
- WARNING SIGN
- DISTANCE BETWEEN SIGNS - A DISTANCE MEASURED IN FEET EQUAL TO A VALUE OF TEN TIMES THE SPEED LIMIT OF THE STREET
- FLAGMAN POSITION
- SPACING BETWEEN BARRICADES- A DISTANCE MEASURED IN FEET EQUAL TO THE SPEED LIMIT OF THE STREET
- TAPER LENGTH - SEE CHART BELOW
- THE TANGENT LENGTH IS EQUAL TO THE TAPER LENGTH FOR A GIVEN STREET.

TAPER REQUIREMENTS

SPEED LIMIT (MPH)	TAPER LENGTH (L) (FEET)			MINIMUM NUMBER OF DEVICES FOR TAPER	MAXIMUM DEVICE SPACING IN FEET	
	10' LANE	11' LANE	12' LANE		ALONG TAPER	AFTER TAPER
20	70	75	80	5	20	20
25	105	115	125	6	25	25
30	150	165	180	7	30	30
35	205	225	245	8	35	35
40	270	295	320	9	40	40
45	450	495	540	13	45	45
50	500	550	600	13	50	50
55	550	605	660	13	55	55

RECOMMENDED SIGN SPACING(D) FOR ADVANCE WARNING SIGN SERIES

SPEED MILES PER HOUR	MINIMUM DISTANCE IN FEET	
	BETWEEN SIGNS	FROM LAST SIGN TO TAPER
0-20	10 X SPEED LIMIT	10 X SPEED LIMIT
25-30	10 X SPEED LIMIT	10 X SPEED LIMIT
30-35	10 X SPEED LIMIT	10 X SPEED LIMIT
40-45	10 X SPEED LIMIT	10 X SPEED LIMIT
50-60	10 X SPEED LIMIT	10 X SPEED LIMIT

TAPER CRITERIA

TYPE OF TAPER	TAPER LENGTH
UPSTREAM TAPER:	
MERGING TAPER	L MINIMUM
SHIFTING TAPER	1/2 L MINIMUM
SHOULDER TAPER	1/2 L MINIMUM
TWO-WAY TRAFFIC TAPER	100 FEET MAXIMUM
DOWNSTREAM TAPERS	100 FEET PER LANE

TAPER LENGTH COMPUTATION

SPEED LIMIT	
40 MPH OR LESS	$L = \frac{WS^2}{60}$
45 MPH OR GREATER	$L = W \times S$
L = TAPER LENGTH	
W = WIDTH OF OFFSET IN FEET	
S = POSTED SPEED OR OFF-PEAK 85-PERCENTILE SPEED IN MPH	

SIGN FACE DETAILS

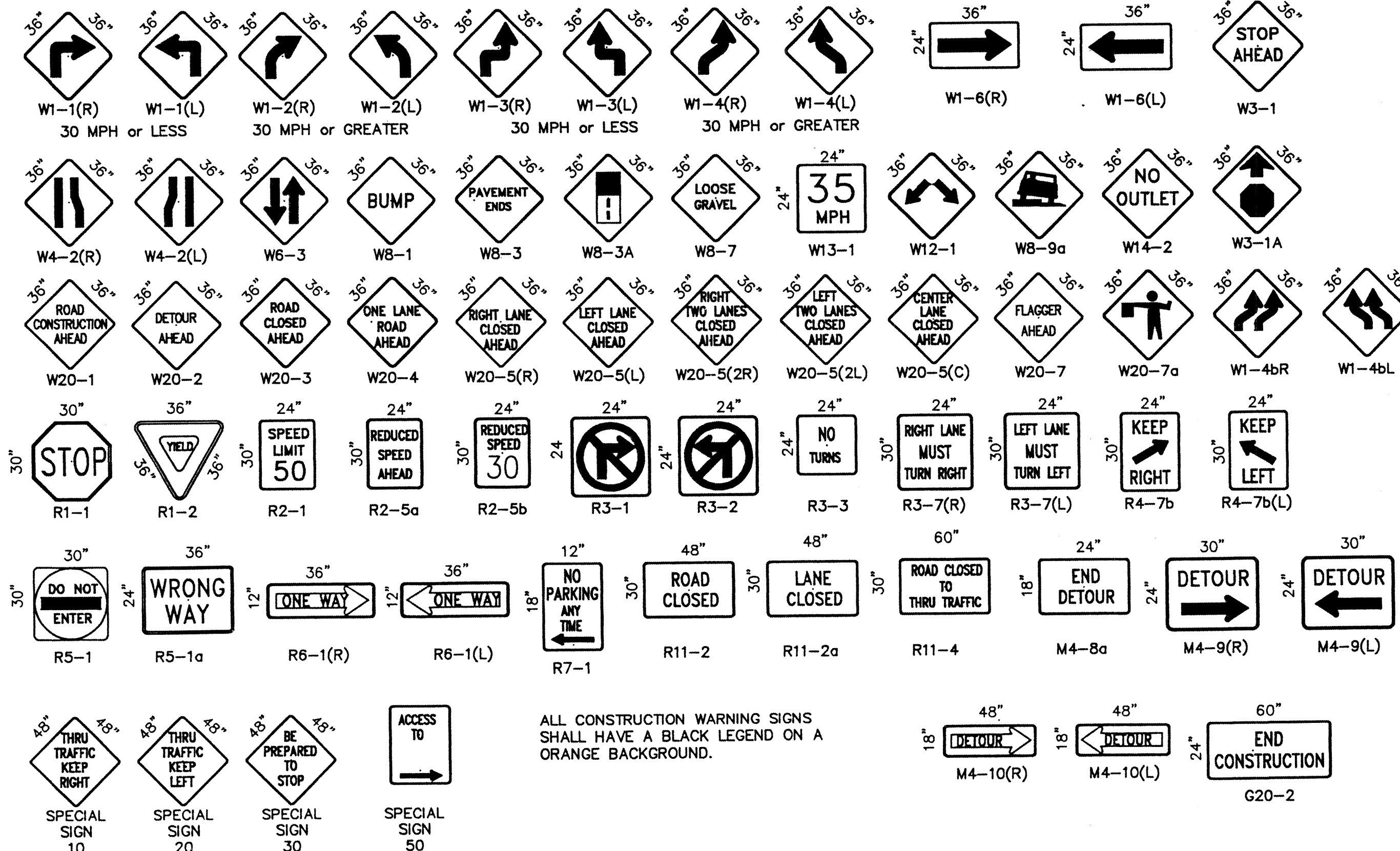

ALL CONSTRUCTION WARNING SIGNS SHALL HAVE A BLACK LEGEND ON A ORANGE BACKGROUND.

AS BUILT INFORMATION		BENCH MARKS		SURVEY INFORMATION		ENGINEER'S SEAL	
CONTRACTOR	DATE	NO.	BY	NO.	BY	REMARKS	NO. DATE
WORK	DATE	NO.	BY	NO.	BY	REVISIONS	NO. DATE
ACCEPTANCE BY	DATE	NO.	BY	NO.	BY	DESIGN	NO. DATE
VERIFICATION BY	DATE	NO.	BY	NO.	BY	STANDARDS	NO. DATE
CHECKED BY	DATE	NO.	BY	NO.	BY	C.O.A.	NO. DATE

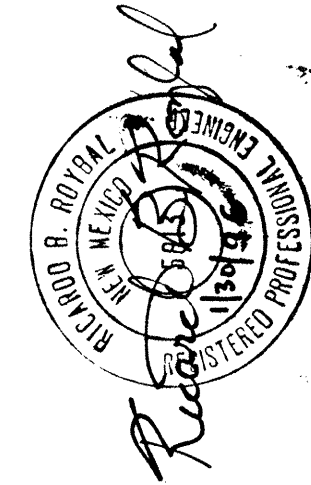

CITY OF ALBUQUERQUE PUBLIC WORKS DEPARTMENT ENGINEERING DEVELOPMENT GROUP			
TITLE: WALGREENS LOMAS AND CARLISLE SIGNING AND CONSTRUCTION TRAFFIC CONTROL STANDARDS			
DESIGN REVIEW COMMITTEE	CITY ENGINEER APPROVAL	LAST UPDATE	
CDA Standard		MO./DAY/YR.	
PROJECT NO. 582482		SHEET 8 OF 9	
MAP NO. J-16		DATE	

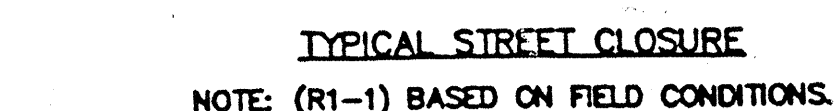
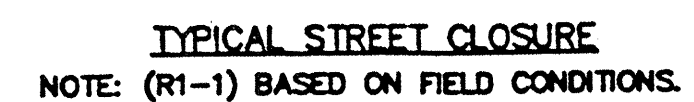
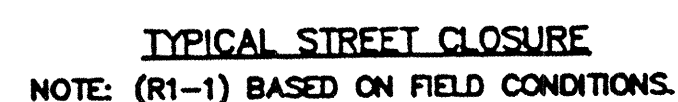
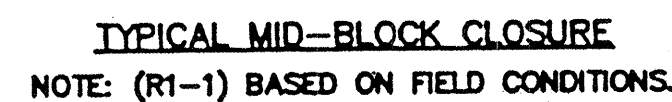
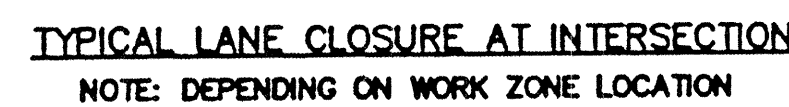
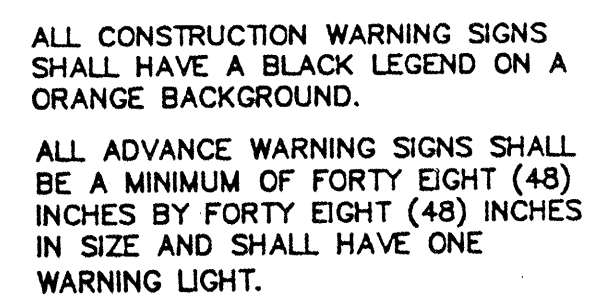
[illegible]