

CITY OF ALBUQUERQUE

100% SUBMITTAL

GIBSON BOULEVARD ENHANCEMENT PROJECT
CARLISLE BOULEVARD TO SAN MATEO BOULEVARD

TPE-7701 (20)

CN9859

CITY PROJECT NO. 5871.91

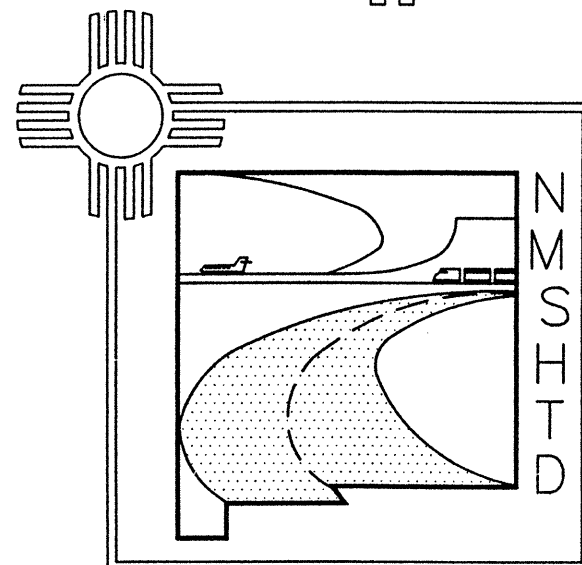
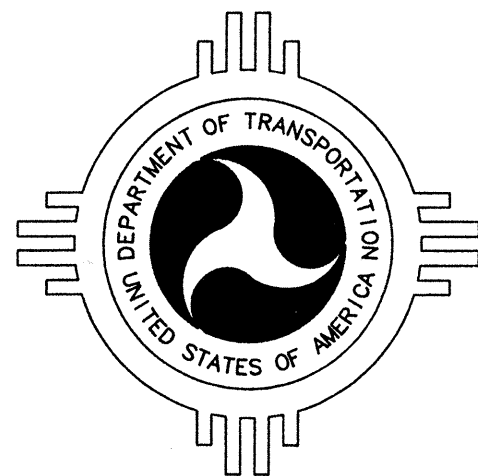

TPE-7701 (20) - CN9859
CITY PROJECT NO.

GIBSON BOULEVARD ENHANCEMENT PROJECT
CARLISLE BLVD. TO SAN MATEO BLVD.

BERNALILLO COUNTY

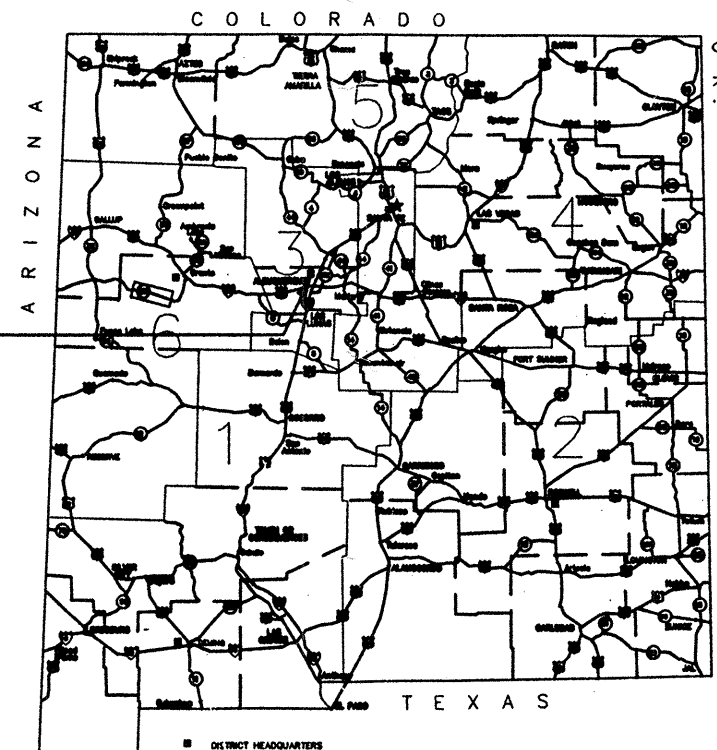

MEXICO

N.M. PROJECT NO. TPE-7701 (20)
CN9859

AVID ENGINEERING
CIVIL - STRUCTURAL - TRANSPORTATION
5801 OBAMA RD. NE - Suite 200
ALBUQUERQUE, NM 87105
PH. (505) 861-5551

WILSON & CO.
ENGINEERS AND ARCHITECTS
4115 INDIAN SCHOOL RD NE
SUITE 200
ALBUQUERQUE, NM
PH. 254-4000 FAX 254-4000

MORROW & COMPANY, LTD.
LANDSCAPE ARCHITECTS
210 E. 10th, S.E.
ALBUQUERQUE, N.M. 87102
PH. 255-2000 FAX 255-2007

REV.	SHEETS	CITY ENGINEER	DATE	USER DEPARTMENT	DATE	USER DEPARTMENT	DATE
ENGINEERS STAMP & SIGNATURE		APPROVALS		ENGINEERS		DATE	
		DRG Chairman		Billie H. Hanks		8/5/98	
		Transportation		J. H. Hanks		7-13-98	
		Water/Wastewater		J. H. Hanks		7-13-98	
		Hydrology		J. H. Hanks		7-24-98	
		CIP		J. H. Hanks		7-24-98	
		Constr. Mngmt.		J. H. Hanks		7-24-98	
		Constr. Coord.		J. H. Hanks		7-24-98	
		City Project No.		5871.91		Sheet	
						1-1	

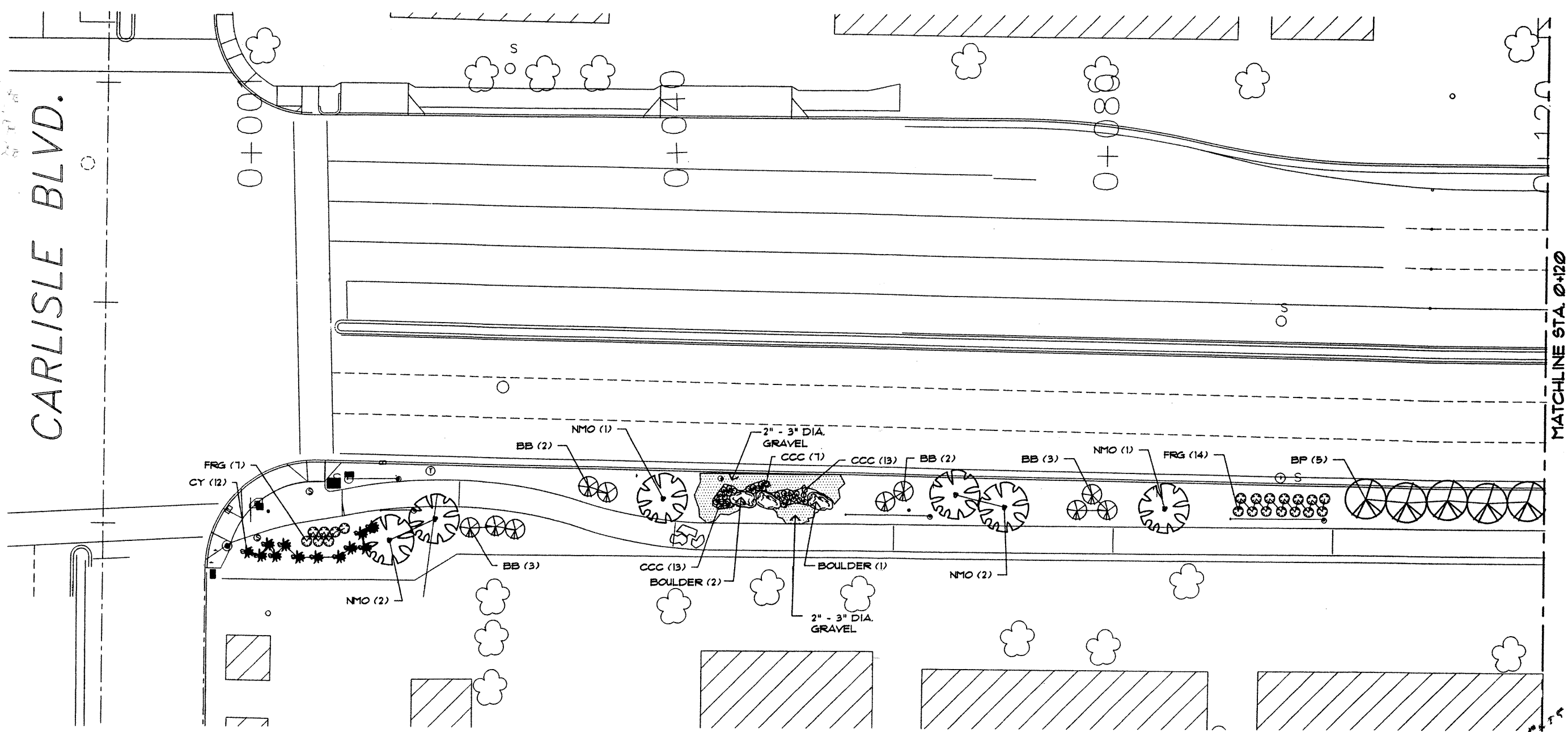

PLANT LIST

SYMBOL	COMMON NAME	BOTANICAL NAME	QUANTITY	SIZE		REMARKS
				INSTALLED	MATURE	
<u>TREES</u>						
DW	Desert Willow	Chilopsis linearis	11	12'-14' ht.	25' ht. and spd.	Multi-trunk 30" Box or B & B
HL	Honey Locust	Gleditsia trisacanthos inermis 'Shademaster'	25	2" cal, 10'-12' ht.	30' ht., 25' spd.	30" Box or B & B
MA	Modesto Ash	Fraxinus velutina 'Modesto'	44	2" cal, 12'-14' ht.	30' ht. and spd.	30" Box or B & B
NMO	New Mexico Olive	Forestiera neomexicana	35	5'-7' ht.	15' ht. and spd.	15 gallon
V	Vitex	Vitex agnus-castus	14	5'-7' ht.	15' ht. and spd.	15 gallon
<u>SHRUBS</u>						
AP	Apache Plume	Fallugia paradoxa	63	min. 18" ht. and spd.	6' ht. and spd.	5 gallon
BP	Bird of Paradise	Caesalpinia gilliesii	7	5'-7' ht.	10' ht. and spd.	15 gallon
BMS	Blue Mist Spirea	Caryopteris clandonensis 'Dark Knight'	213	min. 12" ht. and spd.	4' ht. and spd.	5 gallon
BB	Butterfly Bush	Buddleia davidii	33	min. 18" ht. and spd.	6' ht. and spd.	5 gallon
CS	Cherry Sage	Salvia greggii	62	min. 12" ht. and spd.	30" ht. and spd.	5 gallon
CY	Coralflower Yucca	Hesperaloe parviflora	230	min. 12" ht. and spd.	4' ht. and spd.	5 gallon
DC	Dwarf Chamisa	Chrysothamnus nauseosus nauseosus	253	min. 12" ht. and spd.	4' ht. and spd.	5 gallon
FG	Fountain Grass	Pennisetum alopecuroides	17	min. 12" ht. and spd.	30" ht. and spd.	5 gallon
FRG	Feather Reed Grass	Calamagrostis 'Karl Forester'	40	min. 8" ht.	4' ht., 2' spd.	1 gallon (plant 3 plants per symbol)
LB	Lens's Broom	Cytisus hybrid 'Lens'	13	min. 12" ht. and spd.	4' ht. and spd.	5 gallon
M	Miscanthus	Miscanthus sinensis	60	min. 12" ht.	6' ht. and spd.	5 gallon
SC	Shrubby Cinquefoil	Potentilla fruticosa	63	min. 12" ht. and spd.	30" ht. and spd.	5 gallon
STG	Silky Thread Grass	Stipa tenuifolia	140	min. 6" ht.	10" ht. and spd.	1 gallon

PLANTING AND LANDSCAPE NOTES

- TREES SHALL BE INSTALLED PER C.O.A. DUG 2115 (SIMILAR - SEE PLANTING NOTE 9). TREES IN MEDIAN SHALL BE PLANTED NO CLOSER THAN 6' FROM B.O.C. SHRUBS SHALL BE INSTALLED PER C.O.A. DUG 2115 (SIMILAR - SEE PLANTING NOTE 9).
- C.O.A. DUGS 2115 AND 2116 SHALL BE REVISED AS FOLLOWS: REFERENCE TO REMOVAL OF EXISTING SOIL AND INSTALLED PLANTING SOIL MIXTURE SHALL BE DELETED. PRIOR TO PLANTING, CONTRACTOR SHALL INSTALL 4" DEPTH OF PLANTING SOIL MIXTURE PER 1005.33 THROUGHOUT THE LANDSCAPE AREA AND SHALL ROTOTILL TO A MINIMUM DEPTH OF 6". BACKFILL AT TREES AND SHRUBS WILL REQUIRE NO ADDITIONAL AMENDMENTS.
- IN CASE OF DISCREPANCY IN PLANT QUANTITIES SHOWN ON THE PLANT LIST AND THOSE SHOWN ON THE PLANTING PLANS, THE QUANTITIES SHOWN ON THE PLAN SHALL GOVERN.
- QUANTITIES SHOWN ON THE PLANT LIST ARE ESTIMATES ONLY. CONTRACTOR SHALL VERIFY ALL QUANTITIES PRIOR TO BID AND INSTALLATION. NO ADDITIONAL PAYMENT WILL BE MADE FOR ANY DISCREPANCIES IN QUANTITIES BETWEEN THE PLANTING PLAN AND THE PLANT LIST.
- A 2' WIDTH OF 3" DEPTH CRUSHER FINES SHALL BE INSTALLED ON EACH SIDE OF THE TRAIL, CONTINUOUS, EXCEPT WHERE SLOPES EXCEED 1:3. SEE DETAILS A/5-11 AND B/5-11.
- A 3" DEPTH OF 3/4" DIA. 'SANTA ANA TAN' CRUSHED GRAVEL MULCH WITH WEED BARRIER UNDER SHALL BE INSTALLED THROUGHOUT ALL SHRUB BEDS (EXCEPT AT 2" - 3" GRAVEL AND WHERE SLOPE EXCEEDS 1:3). WEED BARRIER SHALL BE MIN. 4 OZ. WOVEN, NEEDLE PUNCHED POLYPROPYLENE (DEWITT OR EQUAL). OVERLAY ENDS 3". TURN DOWN PERIMETER EDGES 6". GRAVEL SHALL NOT ENCRoACH ONTO THE 2' WIDTH OF CRUSHER FINES ON EACH SIDE OF TRAIL. SEE DETAIL A/5-11.
- 2" - 3" DIA. GRAVEL SHALL BE 3" DEPTH 'SANTA ANA TAN' WITH WEED BARRIER UNDER. WEED BARRIER SHALL BE MIN. 4 OZ. WOVEN, NEEDLE PUNCHED POLYPROPYLENE (DEWITT OR EQUAL). OVERLAY ENDS 3". TURN DOWN PERIMETER EDGES 6".
- THE CONTRACTOR SHALL PRUNE LOWER BRANCHES OF DECIDUOUS TREES TO 8 FEET ABOVE FINISH GRADE.
- IF THERE IS A DISCREPANCY IN THE FIELD OR NURSERY TREES BETWEEN THE CONTAINER SIZE CALLED OUT UNDER 'REMARKS' AND THE CALIFER AND HEIGHT CALLED OUT UNDER 'SIZE', THE SPECIFIED TREE MUST MEET THE CALIFER AND HEIGHT REQUIREMENTS SPECIFIED UNDER 'SIZE'. EVEN IF THE LARGER CONTAINER SIZE IS REQUIRED TO MEET THESE SPECIFICATIONS, AT NO ADDITIONAL COST TO THE OWNER.
- BOULDERS SHALL BE 18 CF-21 CF MOSS ROCK, BURIED WITH 1/3-1/2 OF MASS BELOW GRADE PER DETAIL A/5-16.

- CONTRACTOR SHALL REMOVE EXISTING SOIL THROUGHOUT PLANTING AREAS INTENDING TO A DEPTH OF 30" AND REPLACE WITH CLEAN FILL.
- STAMPED CONCRETE SHALL BE BOTANITE, CAFFUCINO CREAM, CCC61 OR EQUIVALENT (2 1/2 LBS PER BAG OF CEMENT), STAMPED WITH BOTANICAN CANYON STONE OR EQUIVALENT PATTERN.
- MINIMUM CLEARANCES FROM TRAIL:
BOULDERS: 3'-0"
TREE CENTERS: 3'-0"

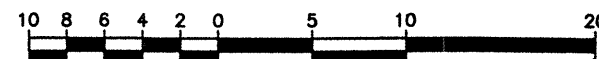

SCALE: 1:200



WILSON & CO.
ENGINEERS AND ARCHITECTS
4715 INDIAN SCHOOL RD NE
SUITE 200
ALBUQUERQUE, NM
PH. 254-4000 FAX 254-4005

MORROW & COMPANY, LTD.
LANDSCAPE ARCHITECTS
310 La Veta N.E.
Albuquerque, N.M. 87102
PH. 254-357-0200 FAX 254-357-0207

CITY OF ALBUQUERQUE
PUBLIC WORKS DEPARTMENT
ENGINEERING DEVELOPMENT GROUP

TITLE: GIBSON BOULEVARD ENHANCEMENT PROJECT
CARLISLE BLVD. TO SAN MATEO BLVD.
PLANTING PLAN, PLANT LIST AND PLANTING NOTES

Design Review Committee	City Engineer Approval	Mo/Day/Yr	Mo/Day/Yr
APPROVED	APPROVED		
DESIGNED BY EAC	DRAWN BY ECR	DATE 7/2/98	DATE 7/2/98
CHECKED BY	ECR		

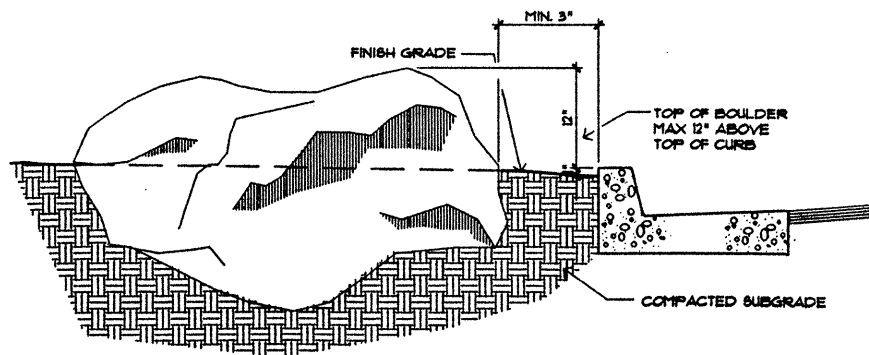
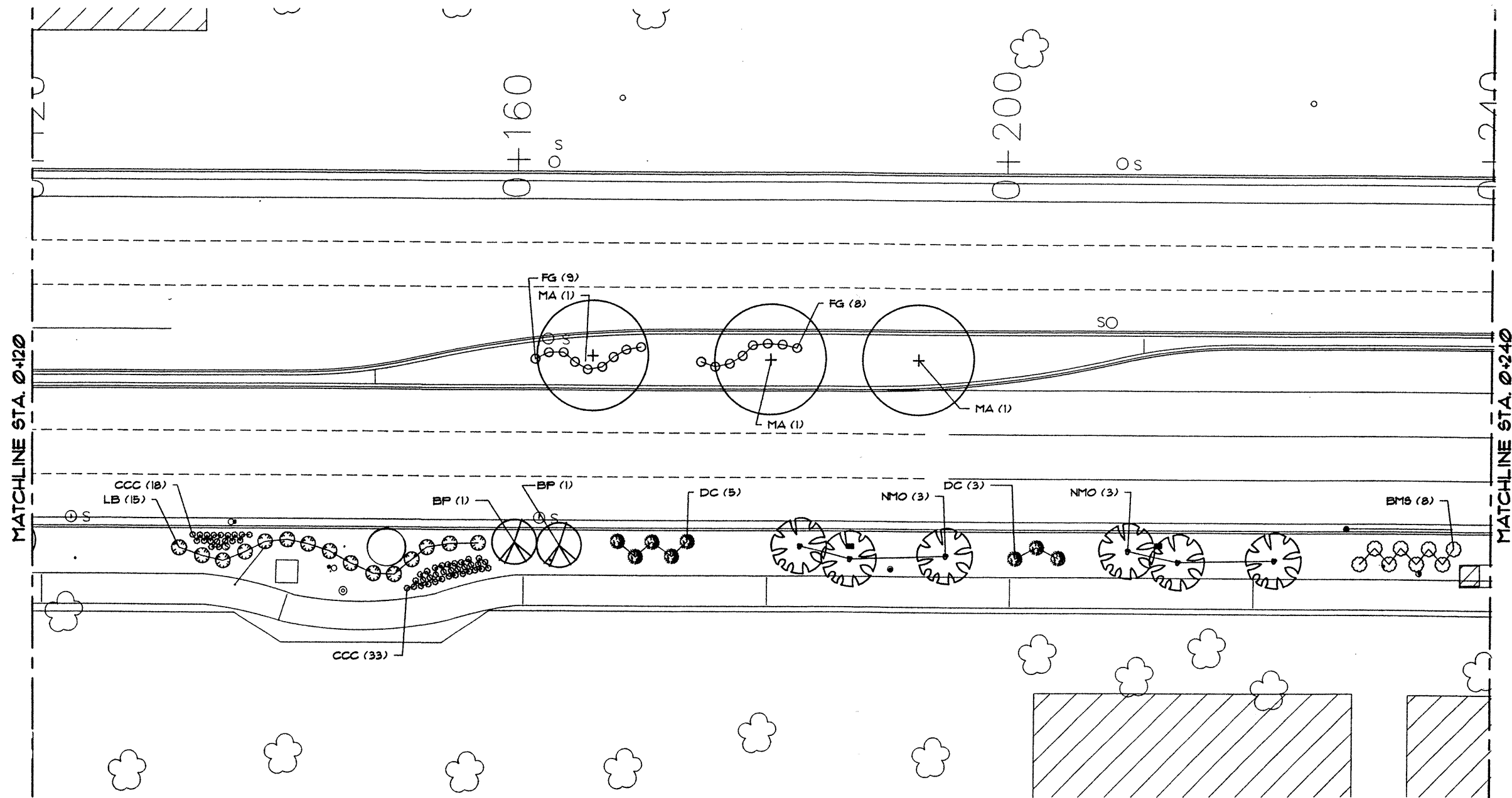

NOTE:
1/3 TO 1/2 OF ROCK SHALL BE BURIED.

A
5-16
LANDSCAPE BOULDER
MCD-0091 11/2/95 N.T.S.

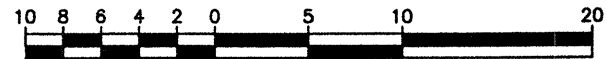

SCALE: 1:200

WILSON & CO.
ENGINEERS AND ARCHITECTS
4715 INDIAN SCHOOL RD NE
SUITE 200
ALBUQUERQUE, NM
PH: 254-4000 FAX: 254-4095
MORROW & COMPANY, LTD.
LANDSCAPE ARCHITECTS
510 La Placa, N.E.
ALBUQUERQUE, N.M. 87106
PH: 254-200-2000 FAX: 254-200-2007

CITY OF ALBUQUERQUE
PUBLIC WORKS DEPARTMENT
ENGINEERING DEVELOPMENT GROUP

TITLE: GIBSON BOULEVARD ENHANCEMENT PROJECT
CARLISLE BLVD. TO SAN MATEO BLVD.
PLANTING PLAN

Design Review Committee

City Engineer

Mo/Day/Yr.

AUG - 6 1998

Mo/Day/Yr.

AS BUILT INFORMATION

CONTRACTOR	DATE
DESIGNED BY	DATE
APPROVED BY	DATE
FIELD CHECKED BY	DATE
REVISIONS BY	DATE
COMMENTS BY	DATE

BENCH MARKS

SURVEY INFORMATION

FIELD NOTES

NO.

ENGINEER'S SEAL



REVISIONS

DESIGN

DESIGNED BY EAC

DRAWN BY RHT

CHECKED BY ECR

DATE 7/2/98

DATE 7/2/98

DATE 7/2/98

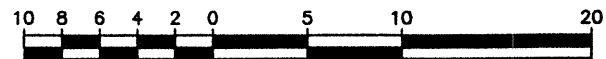
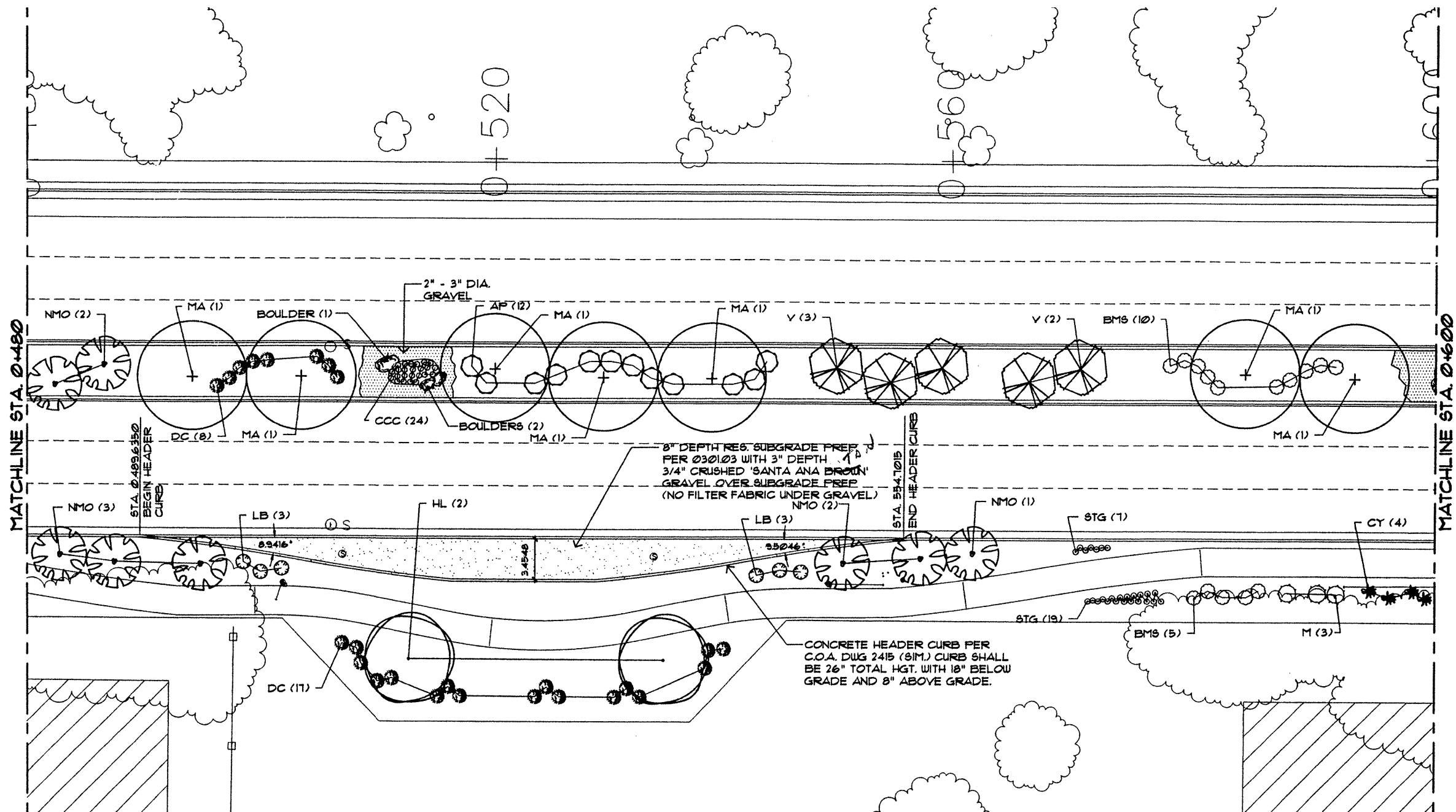

SCALE: 1/200

WILSON & CO.
ENGINEERS AND ARCHITECTS
 4715 INDIAN SCHOOL RD NE
 SUITE 200
 ALBUQUERQUE, NM
 PH. 254-4000 FAX 254-4055

MORROW & COMPANY, LTD.
LANDSCAPE ARCHITECTS
 210 La Veta N.E.
 Albuquerque, N.M. 87106
 PH. 808 340-2200 FAX 808 340-0057

CITY OF ALBUQUERQUE PUBLIC WORKS DEPARTMENT ENGINEERING DEVELOPMENT GROUP			
TITLE: GIBSON BOULEVARD ENHANCEMENT PROJECT CARLISLE BLVD. TO SAN MATEO BLVD. PLANTING PLAN			
DESIGNED BY EAC	DRAWN BY RHT	DATE 7/2/98	DATE 7/2/98
Design Review Committee 		City Engineer Approval CITY ENGINEER	
Local Design Updates 		Mo/Day/Yr. Mo/Day/Yr.	

ENGINEER'S SEAL		SURVEY INFORMATION		BENCH MARKS		AS BUILT INFORMATION	
		FIELD NOTES NO. BY DATE		CONSTRUCTION NO. BY DATE		AS BUILT INFORMATION NO. BY DATE	
REVISIONS NO. DATE DESIGN DATE 7/2/98		NO. BY DATE		NO. BY DATE		NO. BY DATE	

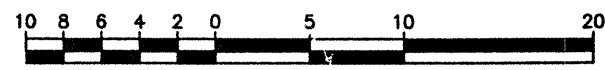
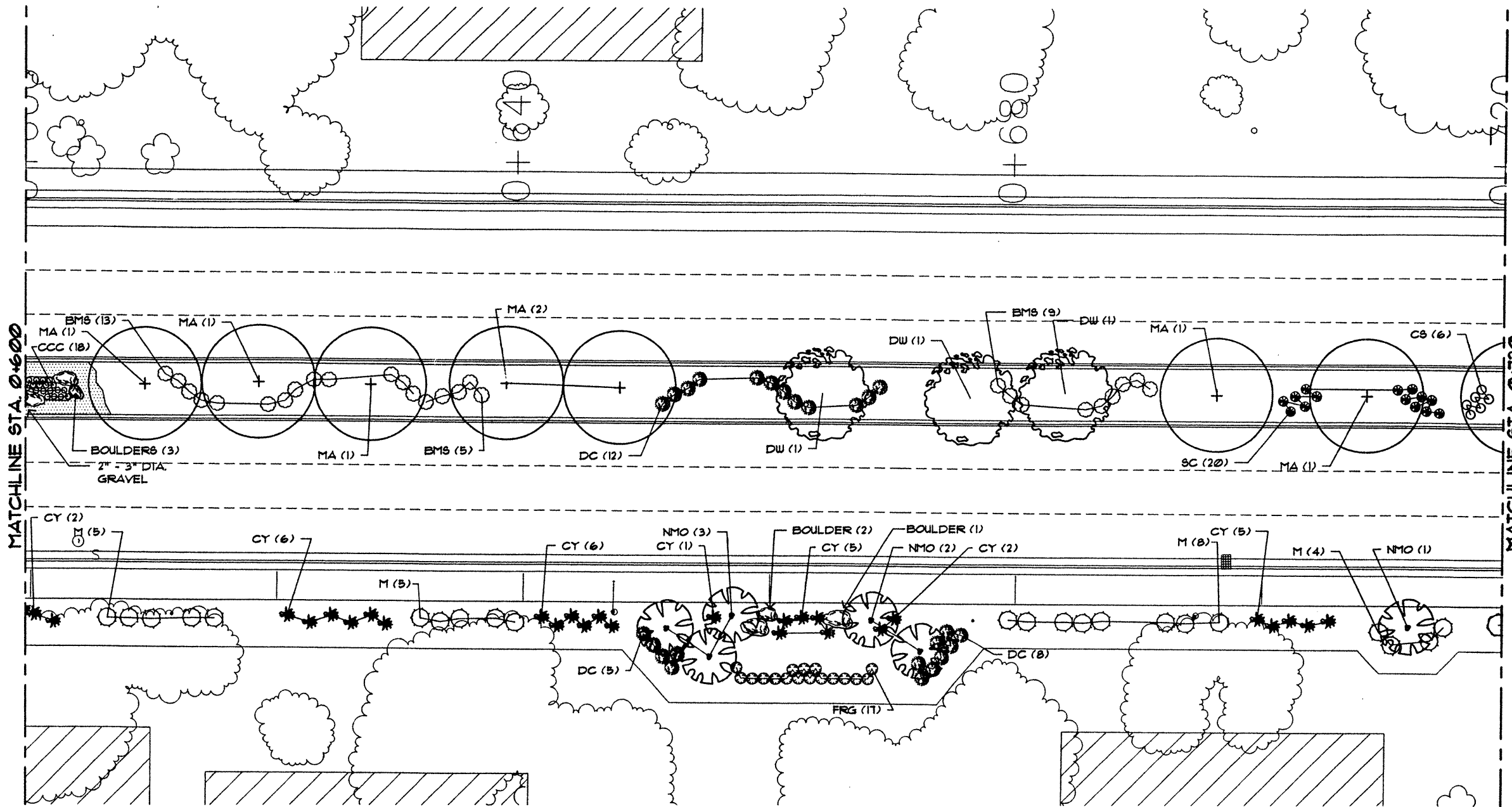

SCALE: 1:200

WILSON & CO.
ENGINEERS AND ARCHITECTS
4115 INDIAN SCHOOL RD NE
SUITE 200
ALBUQUERQUE, NM
PH: 254-4000 FAX: 254-4055

MORROW & COMPANY, LTD.
LANDSCAPE ARCHITECTS
210 La Veta S.E.
Albuquerque, N.M. 87106
PH: 505-825-2266 FAX: 505-825-9037

CITY OF ALBUQUERQUE PUBLIC WORKS DEPARTMENT ENGINEERING DEVELOPMENT GROUP			
TITLE: GIBSON BOULEVARD ENHANCEMENT PROJECT CARLISLE BLVD. TO SAN MATEO BLVD. PLANTING PLAN			
Design Review Committee AUG - 5 1998 DESIGN REVIEW COMMITTEE	APPROVE AUG - 6 1998 CITY ENGINEER	Mo/Day/Yr.	Mo/Day/Yr.
DESIGNED BY EAC	DRAWN BY RHT	CHECKED BY ECR	

ENGINEER'S SEAL				SURVEY INFORMATION				BENCH MARKS				AS BUILT INFORMATION			
				FIELD NOTES											
				BY											
				DATE											
				NO.											

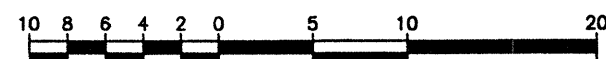
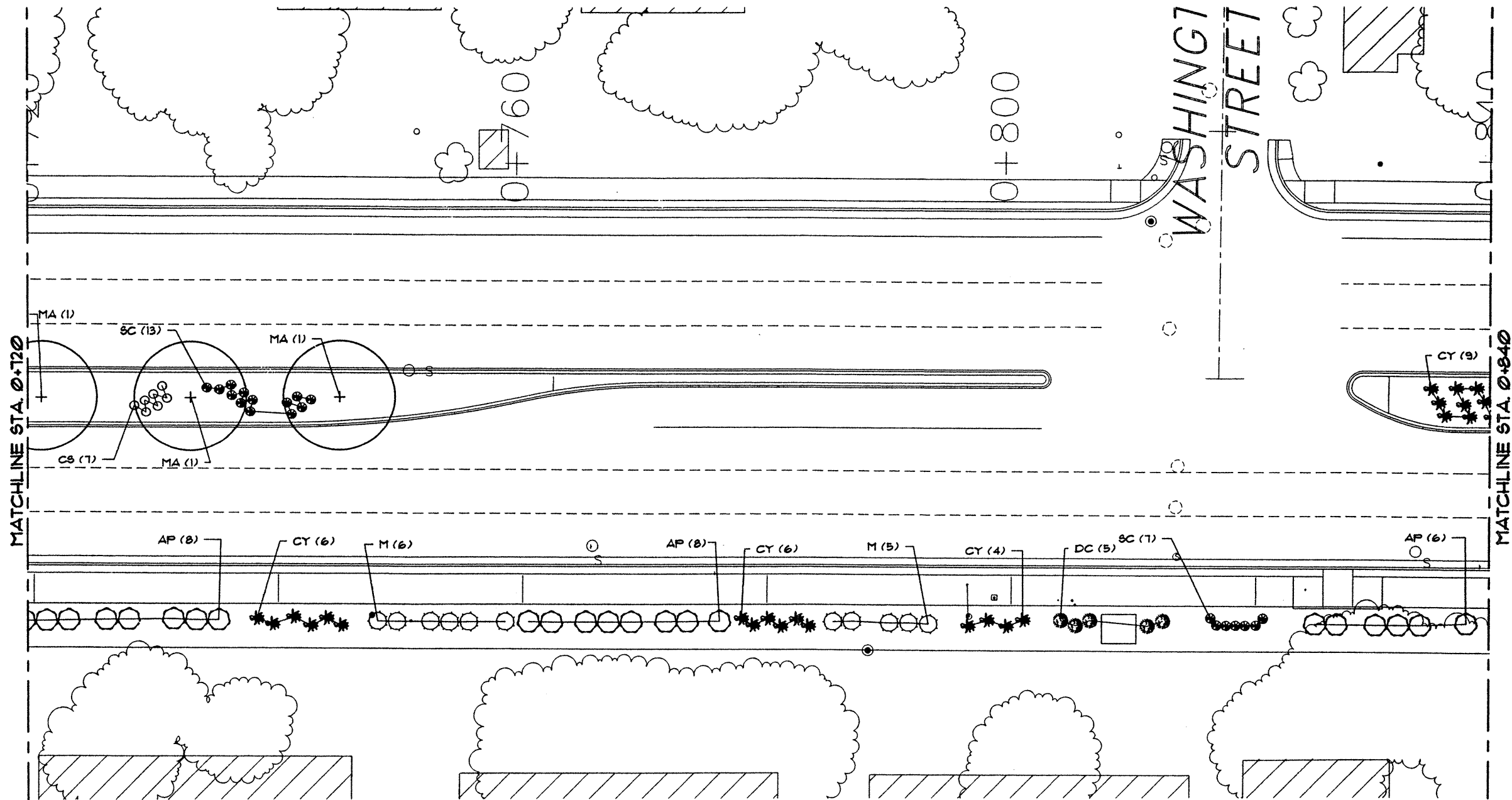

SCALE: 1:200

WILSON & CO.
ENGINEERS AND ARCHITECTS
4715 INDIAN SCHOOL RD NE
SUITE 200
ALBUQUERQUE, NM
PH: 254-4000 FAX 254-4085

MORROW & COMPANY, LTD.
LANDSCAPE ARCHITECTS
210 La Villa N.E.
ALBUQUERQUE, N.M. 87102
PH: 254-267-2000 FAX: 254-267-2007

CITY OF ALBUQUERQUE PUBLIC WORKS DEPARTMENT ENGINEERING DEVELOPMENT GROUP	
TITLE: GIBSON BOULEVARD ENHANCEMENT PROJECT CARLISLE BLVD. TO SAN MATEO BLVD. PLANTING PLAN	
DESIGNED BY: EAC	DATE: 7/2/98
DRAWN BY: RHT	DATE: 7/2/98
CHECKED BY: FCR	DATE: 7/5/98
REVISIONS	DATE
1. DESIGN	7/2/98

SURVEY INFORMATION		BENCH MARKS		AS BUILT INFORMATION	
FIELD NOTES				CONTRACTOR	
NO.	BY	DATE		WORK	DATE
				DESIGNED BY	DATE
				APPROVED BY	DATE
				FIELD	DATE
				RECORD BY	DATE
				REVISION	DATE
				CORRECTED BY	DATE
				MICRO-FILM INFORMATION	
				RECORDED BY	DATE
				IN.	

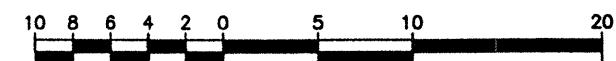
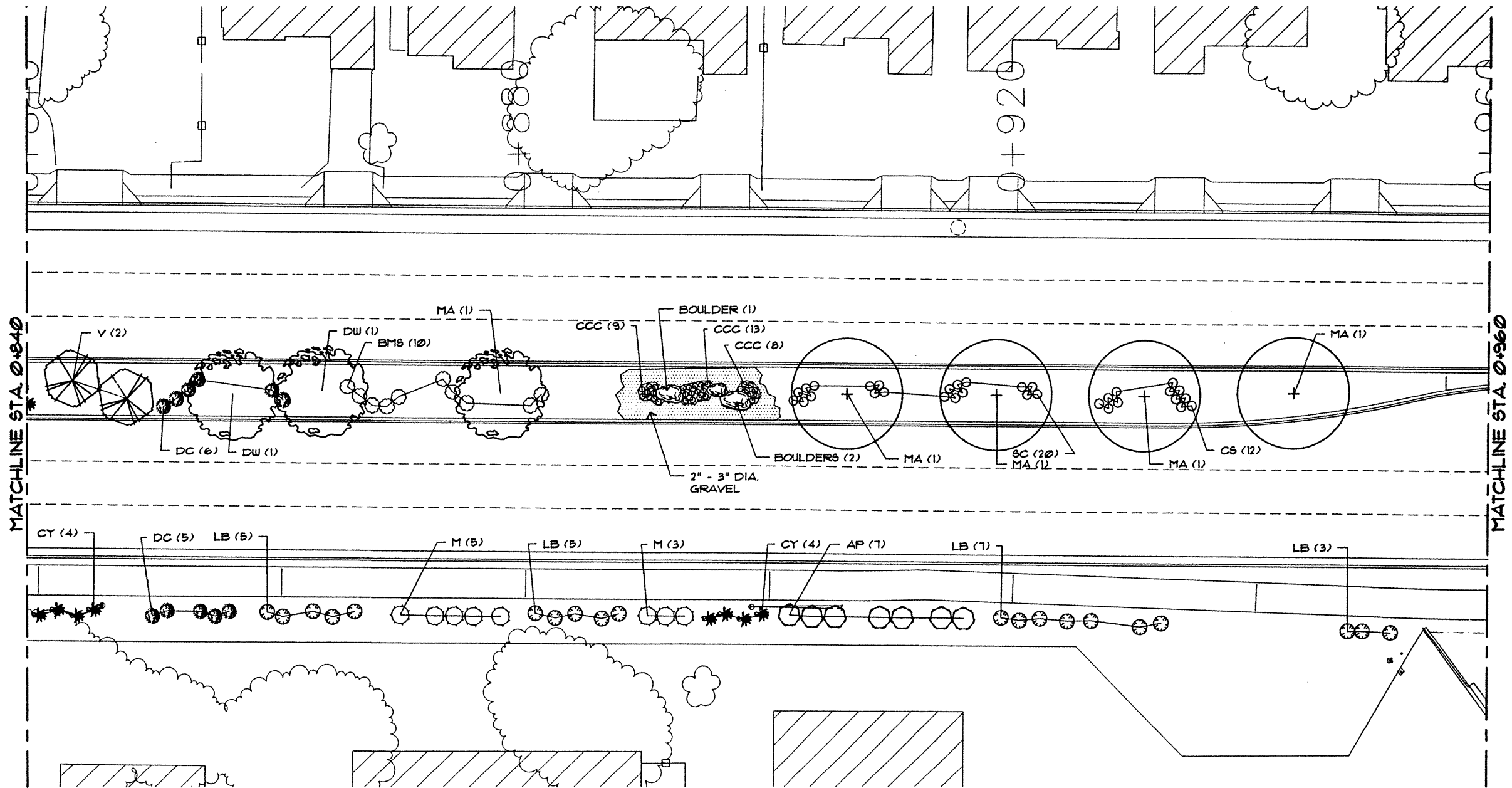

SCALE: 1:200

WILSON & CO.
ENGINEERS AND ARCHITECTS
4715 INDIAN SCHOOL RD NE
SUITE 200
ALBUQUERQUE, NM
PH. 254-4000 FAX 254-4000

MORROW & COMPANY, LTD.
LANDSCAPE ARCHITECTS
210 La Vela N.E.
Albuquerque, N.M. 87106
PH. 505-262-2266 FAX 505-262-0887

CITY OF ALBUQUERQUE
PUBLIC WORKS DEPARTMENT
ENGINEERING DEVELOPMENT GROUP

TITLE: GIBSON BOULEVARD ENHANCEMENT PROJECT
CARLISLE BLVD. TO SAN MATEO BLVD.
PLANTING PLAN

Design Review Committee APPROVED AUG - 5 1998	City Engineer Approval APPROVED AUG - 6 1998 CITY ENGINEER	Mo/Dav/Yr. Mo/Dav/Yr.
---	---	--------------------------

N.M. PROJECT NO. IPE-7701 (20) CITY PROJECT NO. ZONE MAP NO. SHEET

ENGINEER'S SEAL		SURVEY INFORMATION		BENCH MARKS		AS BUILT INFORMATION	
		FIELD NOTES		DATE		DATE	
		NO.	BY	NO.	DATE	NO.	DATE
REMARKS		REVISIONS		DESIGN		MICRO-FILM INFORMATION	
NO.		DATE		BY		DATE	
DESIGNED BY EAC		DATE 7/2/98		DRAWN BY		DATE	

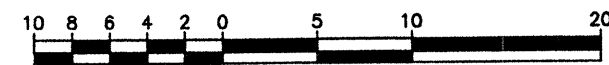
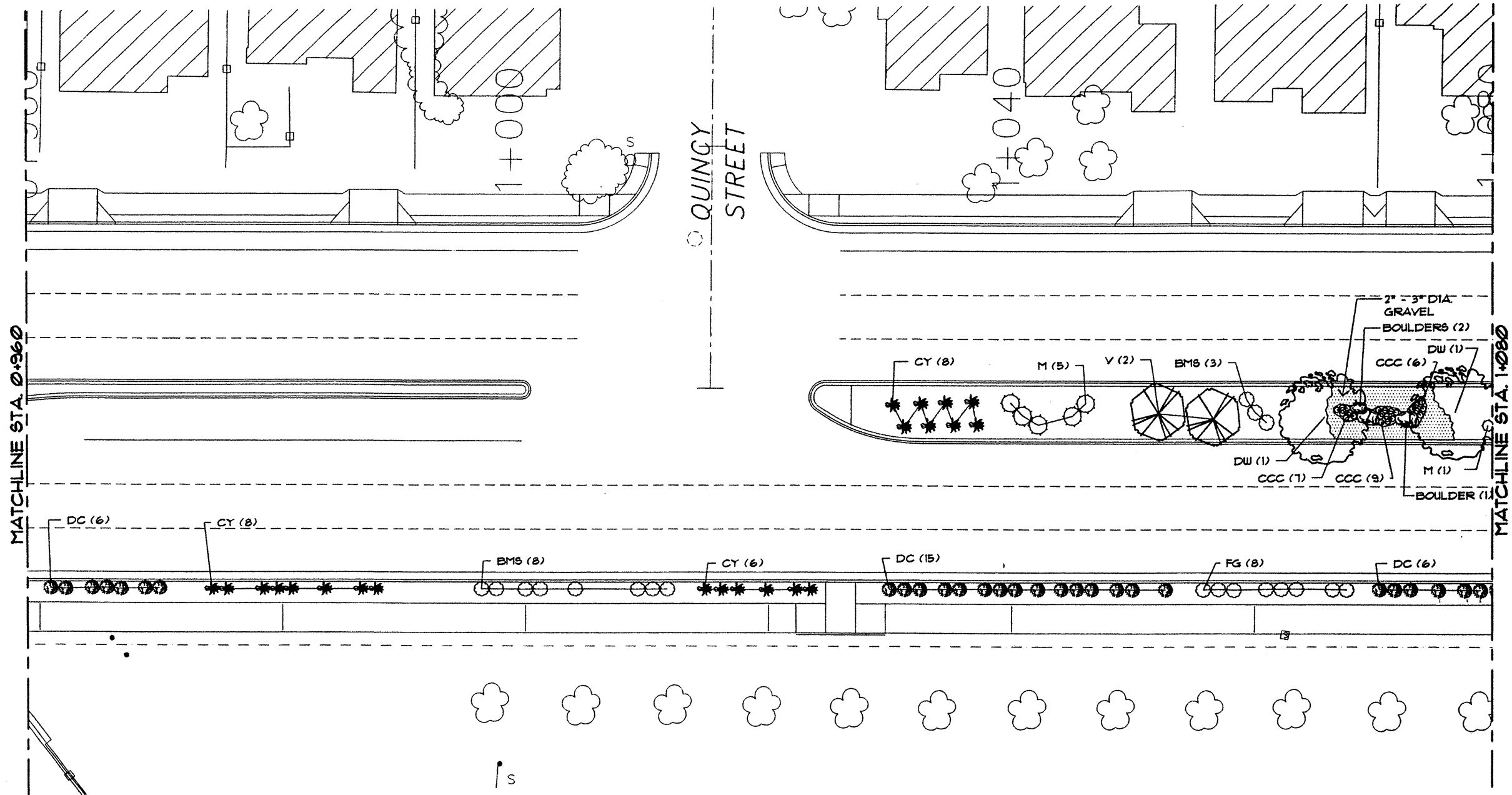

SCALE: 1:200

WILSON & CO.
ENGINEERS AND ARCHITECTS
4715 INDIAN SCHOOL RD NE
SUITE 200
ALBUQUERQUE, NM
PH: 254-4000 FAX: 254-4005

MORROW & COMPANY, LTD.
LANDSCAPE ARCHITECTS
210 La Tijera N.E.
ALBUQUERQUE, N.M. 87108
PH: 505 265-2500 FAX: 505 265-0007

CITY OF ALBUQUERQUE
PUBLIC WORKS DEPARTMENT
ENGINEERING DEVELOPMENT GROUP

TITLE: GIBSON BOULEVARD ENHANCEMENT PROJECT
CARLISLE BLVD. TO SAN MATEO BLVD.
PLANTING PLAN

Design Review Committee AUG - 5 1998 DESIGN REVIEW COMMITTEE	City Engineer Approval AUG - 6 1998 CITY ENGINEER	Mg/Day/Yr	Mg/Day/Yr

SURVEY INFORMATION		BENCH MARKS		AS BUILT INFORMATION	
FIELD NOTES				CONTRACTOR	
NO.	BY	DATE		WORK DESIGNED BY	DATE
				REVISIONS BY	DATE
				FIELD VERIFICATION BY	DATE
				CONTRACTOR BY	DATE
				MICRO-FILM INFORMATION	
				RECORDED BY	DATE



DESIGNED BY EAC
DRAWN BY RLT
DATE 7/2/98
DATE 7/13/98

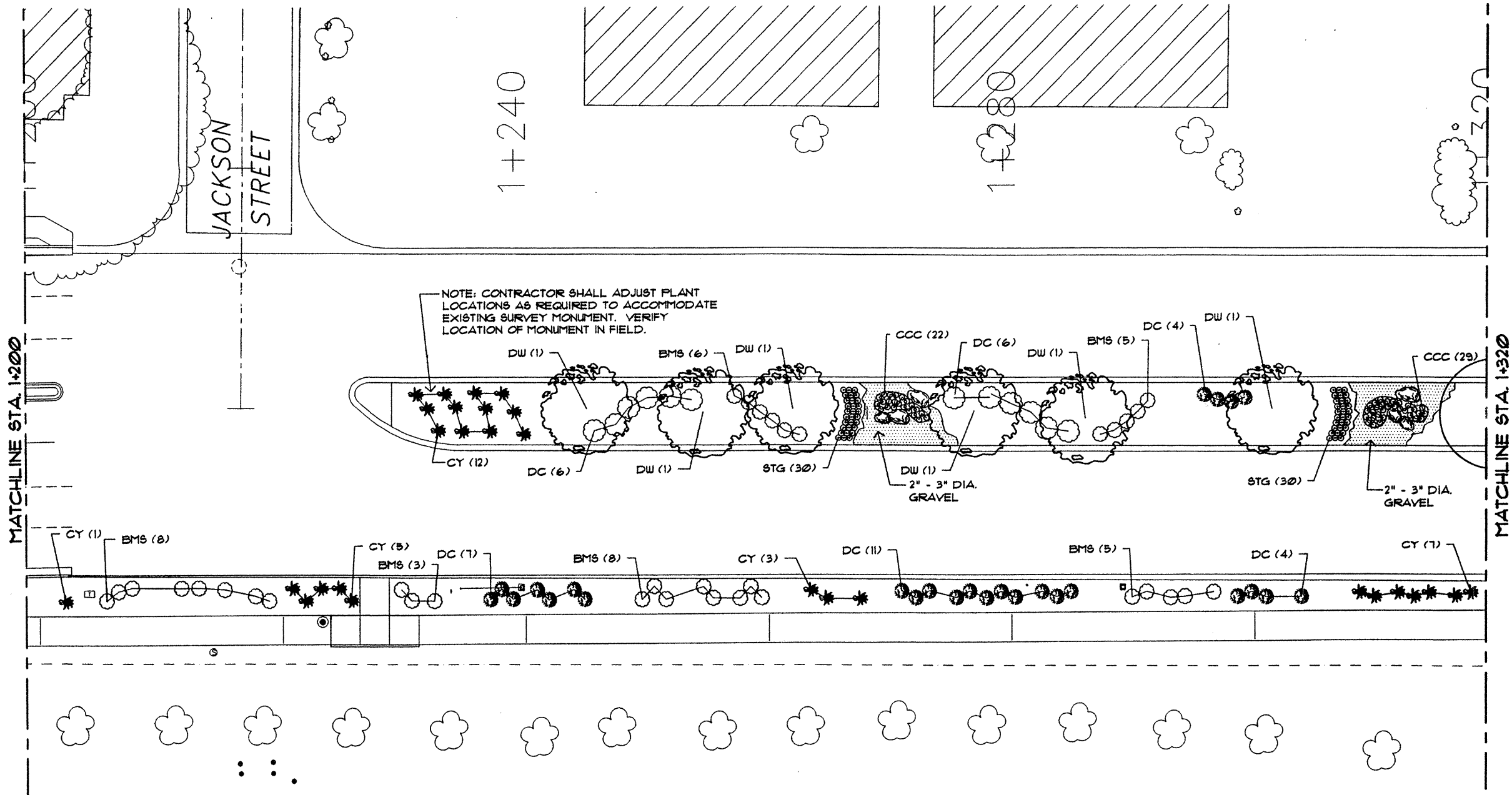

NOTE: CONTRACTOR SHALL ADJUST PLANT LOCATIONS AS REQUIRED TO ACCOMMODATE EXISTING SURVEY MONUMENT. VERIFY LOCATION OF MONUMENT IN FIELD.

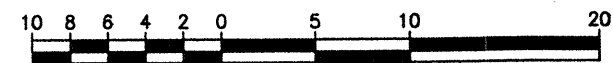

SCALE: 1:200

WILSON & CO.
ENGINEERS AND ARCHITECTS
4715 INDIAN SCHOOL RD NE
SUITE 200
ALBUQUERQUE, NM
PH: 254-4000 FAX 254-4055

MORROW & COMPANY, LTD.
LANDSCAPE ARCHITECTS
210 La Veta N.E.
Albuquerque, N.M. 87102
PH: 505-262-2266 FAX: 505-262-2227

CITY OF ALBUQUERQUE
PUBLIC WORKS DEPARTMENT
ENGINEERING DEVELOPMENT GROUP

TITLE: GIBSON BOULEVARD ENHANCEMENT PROJECT
CARLISLE BLVD. TO SAN MATEO BLVD.
PLANTING PLAN

DESIGN REVIEW COMMITTEE	CITY ENGINEER APPROVAL	Mo/Day/Yr	Mo/Day/Yr
APPROVE AUG - 5 1998	APPROVE AUG - 6 1998		
DESIGN REVIEW COMMITTEE	CITY ENGINEER		

ENGINEER'S SEAL		SURVEY INFORMATION		BENCH MARKS		AS BUILT INFORMATION	
	NO.	DATE	FIELD NOTES			CONTRACTOR	DATE
			BY	DATE			

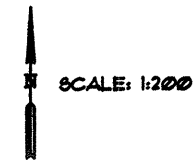
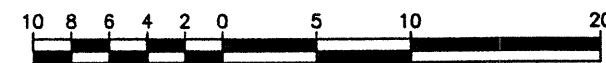
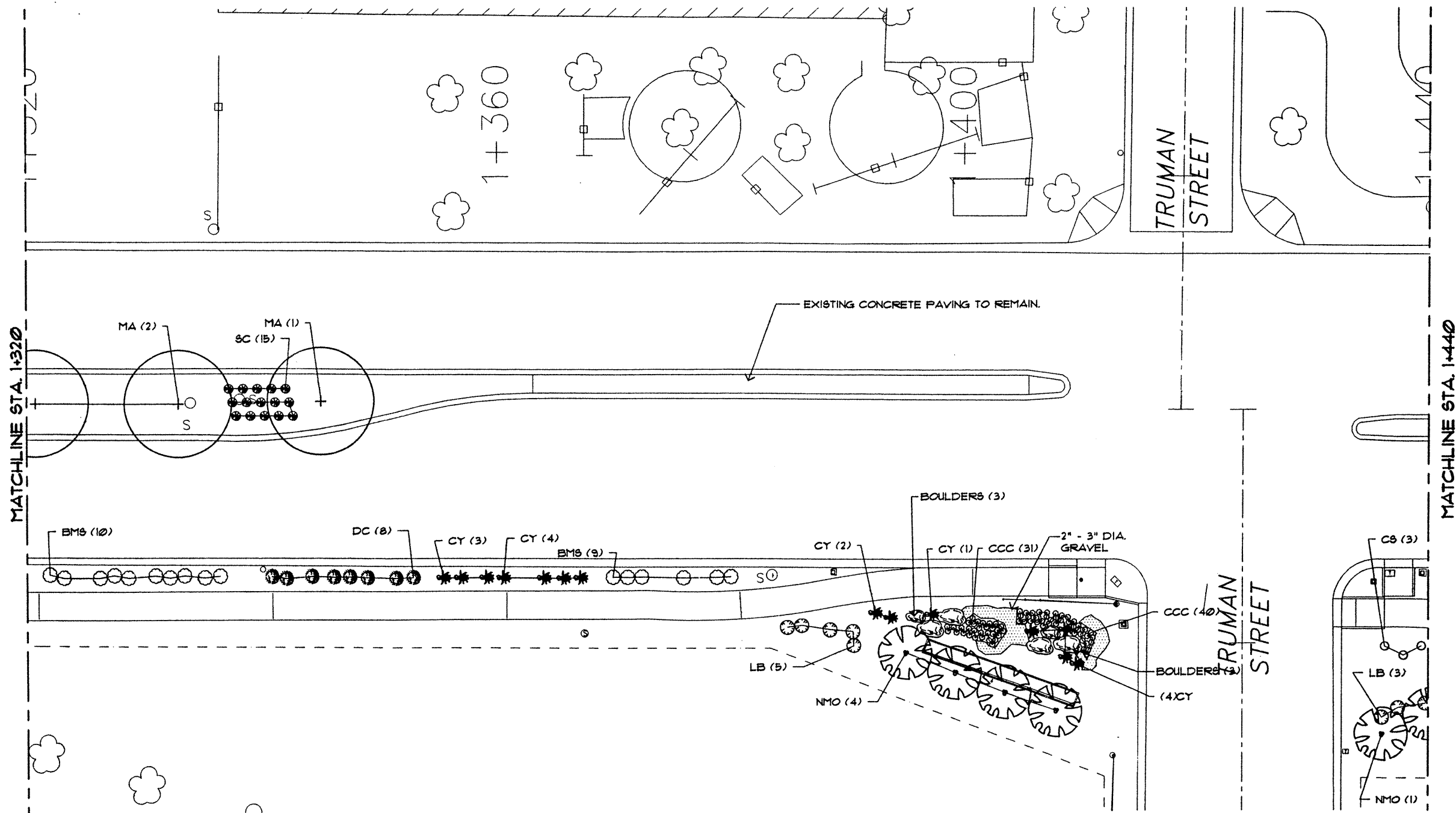

WILSON & CO.
ENGINEERS AND ARCHITECTS
4115 INDIAN SCHOOL RD NE
SUITE 200
ALBUQUERQUE, NM
PH. 254-4000 FAX 254-4055

MORROW & COMPANY, LTD.
LANDSCAPE ARCHITECTS
210 La Veta N.E.
Albuquerque, N.M. 87106
PH. 505 262-2200 FAX 505 262-9057

CITY OF ALBUQUERQUE PUBLIC WORKS DEPARTMENT ENGINEERING DEVELOPMENT GROUP	
TITLE: GIBSON BOULEVARD ENHANCEMENT PROJECT CARLISLE BLVD. TO SAN MATEO BLVD. PLANTING PLAN	
DESIGN REVIEW COMMITTEE APPROVED AUG - 5 1998	CITY ENGINEER APPROVED AUG - 6 1998
DESIGNED BY EAC	DATE 7/2/98
DRAWN BY RHT	DATE 7/2/98

--	--	--	--	--	--	--	--	--	--	--	--	--	--	--	--	--	--	--	--	--	--	--	--	--	--	--	--	--	--	--	--	--	--	--	--	--	--	--	--	--	--	--	--	--	--	--	--	--	--	--	--	--	--	--	--	--	--	--	--	--	--	--	--	--	--	--	--	--	--	--	--	--	--	--	--	--	--	--	--	--	--	--	--	--	--	--	--	--	--	--	--	--	--	--	--	--	--	--	--	--	--	--	--	--	--	--	--	--	--	--	--	--	--	--	--	--	--	--	--	--	--	--	--	--	--	--	--	--	--	--	--	--	--	--	--	--	--	--	--	--	--	--	--	--	--	--	--	--	--	--	--	--	--	--	--	--	--	--	--	--	--	--	--	--	--	--	--	--	--	--	--	--	--	--	--	--	--	--	--	--	--	--	--	--	--	--	--	--	--	--	--	--	--	--	--	--	--	--	--	--	--	--	--	--	--	--	--	--	--	--	--	--	--	--	--	--	--	--	--	--	--	--	--	--	--	--	--	--	--	--	--	--	--	--	--	--	--	--	--	--	--	--	--	--	--	--	--	--	--	--	--	--	--	--	--	--	--	--	--	--	--	--	--	--	--	--	--	--	--	--	--	--	--	--	--	--	--	--	--	--	--	--	--	--	--	--	--	--	--	--	--	--	--	--	--	--	--	--	--	--	--	--	--	--	--	--	--	--	--	--	--	--	--	--	--	--	--	--	--	--	--	--	--	--	--	--	--	--	--	--	--	--	--	--	--	--	--	--	--	--	--	--	--	--	--	--	--	--	--	--	--	--	--	--	--	--	--	--	--	--	--	--	--	--	--	--	--	--	--	--	--	--	--	--	--	--	--	--	--	--	--	--	--	--	--	--	--	--	--	--	--	--	--	--	--	--	--	--	--	--	--	--	--	--	--	--	--	--	--	--	--	--	--	--	--	--	--	--	--	--	--	--	--	--	--	--	--	--	--	--	--	--	--	--	--	--	--	--	--	--	--	--	--	--	--	--	--	--	--	--	--	--	--	--	--	--	--	--	--	--	--	--	--	--	--	--	--	--	--	--	--	--	--	--	--	--	--	--	--	--	--	--	--	--	--	--	--	--	--	--	--	--	--	--	--	--	--	--	--	--	--	--	--	--	--	--	--	--	--	--	--	--	--	--	--	--	--	--	--	--	--	--	--	--	--	--	--	--	--	--	--	--	--	--	--	--	--	--	--	--	--	--	--	--	--	--	--	--	--	--	--	--	--	--	--	--	--	--	--	--	--	--	--	--	--	--	--	--	--	--	--	--	--	--	--	--	--	--	--	--	--	--	--	--	--	--	--	--	--	--	--	--	--	--	--	--	--	--	--	--	--	--	--	--	--	--	--	--	--	--	--	--	--	--	--	--	--	--	--	--	--	--	--	--	--	--	--	--	--	--	--	--	--	--	--	--	--	--	--	--	--	--	--	--	--	--	--	--	--	--	--	--	--	--	--	--	--	--	--	--	--	--	--	--	--	--	--	--	--	--	--	--	--	--	--	--	--	--	--	--	--	--	--	--	--	--	--	--	--	--	--	--	--	--	--	--	--	--	--	--	--	--	--	--	--	--	--	--	--	--	--	--	--	--	--	--	--	--	--	--	--	--	--	--	--	--	--	--	--	--	--	--	--	--	--	--	--	--	--	--	--	--	--	--	--	--	--	--	--	--	--	--	--	--	--	--	--	--	--	--	--	--	--	--	--	--	--	--	--	--	--	--	--	--	--	--	--	--	--	--	--	--	--	--	--	--	--	--	--	--	--	--	--	--	--	--	--	--	--	--	--	--	--	--	--	--	--	--	--	--	--	--	--	--	--	--	--	--	--	--	--	--	--	--	--	--	--	--	--	--	--	--	--	--	--	--	--	--	--	--	--	--	--	--	--	--	--	--	--	--	--	--	--	--	--	--	--	--	--	--	--	--	--	--	--	--	--	--	--	--	--	--	--	--	--	--	--	--	--	--	--	--	--	--	--	--	--	--	--	--	--	--	--	--	--	--	--	--	--	--	--	--	--	--	--	--	--	--	--	--	--	--	--	--	--	--	--	--	--	--	--	--	--	--	--	--	--	--	--	--	--	--	--	--	--	--	--	--	--	--	--	--	--	--	--	--	--	--	--	--	--	--	--	--	--	--	--	--	--	--	--	--	--	--	--	--	--	--	--	--	--	--	--	--	--	--	--	--	--	--	--	--	--	--	--	--	--	--	--	--	--	--	--	--	--	--	--	--	--	--	--	--	--	--	--	--	--	--	--	--	--	--	--	--	--	--	--	--	--	--	--	--	--	--	--	--	--	--	--	--	--	--	--	--	--	--	--	--	--	--	--	--	--	--	--	--	--	--	--	--	--	--	--	--	--	--	--	--	--	--	--	--	--	--	--	--	--	--	--	--	--	--	--	--	--	--	--	--	--	--	--	--	--	--	--	--	--	--	--	--	--	--	--	--	--	--	--	--	--	--	--	--	--	--	--	--	--	--	--	--	--	--	--	--	--	--	--	--	--	--	--	--	--	--	--	--	--	--	--	--	--	--	--	--	--	--	--	--	--	--	--	--	--	--	--	--	--	--	--	--	--	--	--	--	--	--	--	--	--	--	--	--	--	--	--	--	--	--	--	--	--	--	--	--	--	--	--	--	--	--	--	--	--	--	--	--	--	--	--	--	--	--	--	--	--	--	--	--	--	--	--	--	--	--	--	--	--	--	--	--	--	--	--	--	--	--	--	--	--	--	--	--	--	--	--	--	--	--	--	--	--	--	--	--	--	--	--	--	--	--	--	--	--	--	--	--	--	--	--	--	--	--	--	--	--	--	--	--	--	--	--	--	--	--	--	--	--	--	--	--	--	--	--	--	--	--	--	--	--	--	--	--	--	--	--	--	--	--	--	--	--	--	--	--	--	--	--	--	--	--	--	--	--	--	--	--	--	--	--	--	--	--	--	--	--	--	--	--	--	--	--	--	--	--	--	--	--	--	--	--	--	--	--	--	--	--	--	--	--	--	--	--	--	--	--	--	--	--	--	--	--	--	--	--	--	--	--	--	--	--	--	--	--	--	--	--	--	--	--	--	--	--	--	--	--	--	--	--	--	--	--	--	--	--	--	--	--	--	--	--	--	--	--	--	--	--	--	--	--	--	--	--	--	--	--	--	--	--	--	--	--	--	--	--	--	--	--	--	--	--	--	--	--	--	--	--	--	--	--	--	--	--	--	--	--	--	--	--	--	--	--	--	--	--	--	--	--	--	--	--	--	--	--	--	--	--	--	--	--	--	--	--	--	--	--	--	--	--	--	--	--	--	--	--	--	--	--	--	--	--	--	--	--	--	--	--	--	--	--	--	--	--	--	--	--	--	--	--	--	--	--	--	--	--	--	--	--	--	--	--	--	--	--	--	--	--	--	--	--	--	--	--	--	--	--	--	--	--	--	--	--	--	--	--	--	--	--	--	--	--	--	--	--	--	--	--	--	--	--	--	--	--	--	--	--	--	--	--	--	--	--	--	--	--	--	--	--	--	--	--	--	--	--	--	--	--	--	--	--	--	--	--	--	--	--	--	--	--	--	--	--	--	--	--	--	--	--	--

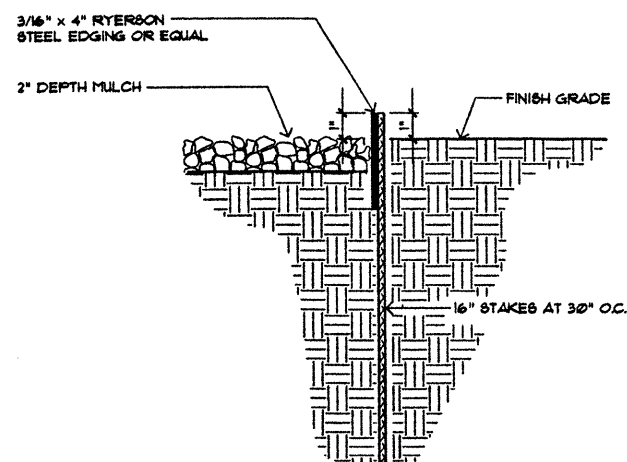

NTB



N.M. PROJECT NO. IPE-7701 (20)

CITY PROJECT NO. 5871 01	ZONE MAP NO. 115 16 & 17	SHEET 5-27
-----------------------------	-----------------------------	---------------

[illegible]

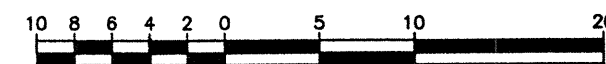
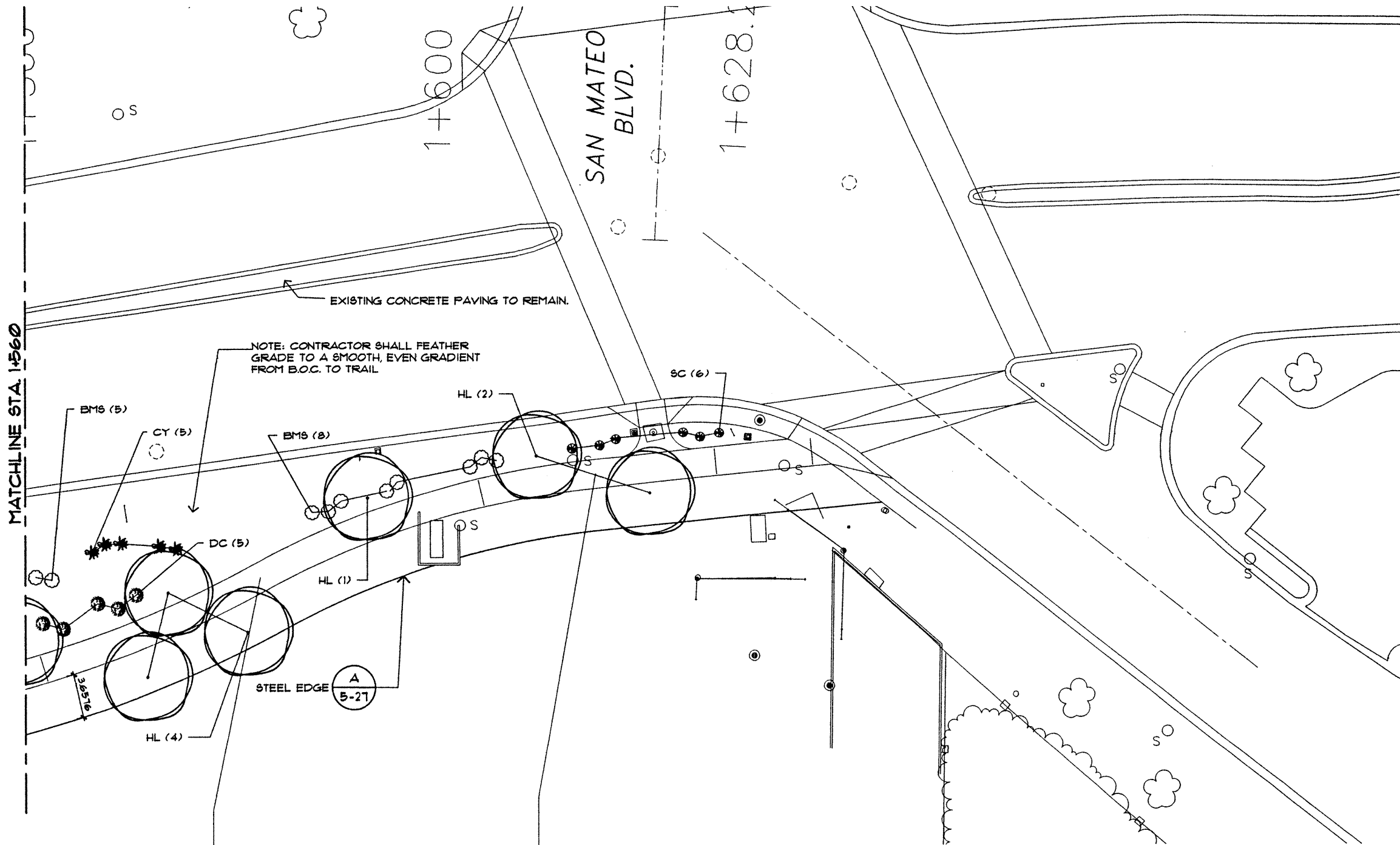

SCALE: 1:200

WILSON & CO.
ENGINEERS AND ARCHITECTS
4115 INDIAN SCHOOL RD NE
SUITE 200
ALBUQUERQUE, NM
PH. 254-4000 FAX 254-4005

MORROW & COMPANY, LTD.
LANDSCAPE ARCHITECTS
210 La Vela N.E.
Albuquerque, N.M. 87106
PH. 254-2300 FAX 254-2305

CITY OF ALBUQUERQUE PUBLIC WORKS DEPARTMENT ENGINEERING DEVELOPMENT GROUP	
TITLE: GIBSON BOULEVARD ENHANCEMENT PROJECT CARLISLE BLVD. TO SAN MATEO BLVD. PLANTING PLAN	
City Engineer Approval APPROVE AUG - 5 1998 DESIGN REVIEW CITY ENGINEER	City Engineer Approval APPROVE AUG - 6 1998 CITY ENGINEER
City Engineer Approval APPROVE AUG - 5 1998 DESIGN REVIEW CITY ENGINEER	City Engineer Approval APPROVE AUG - 6 1998 CITY ENGINEER
City Engineer Approval APPROVE AUG - 5 1998 DESIGN REVIEW CITY ENGINEER	City Engineer Approval APPROVE AUG - 6 1998 CITY ENGINEER
City Engineer Approval APPROVE AUG - 5 1998 DESIGN REVIEW CITY ENGINEER	City Engineer Approval APPROVE AUG - 6 1998 CITY ENGINEER

ENGINEER'S SEAL		SURVEY INFORMATION		BENCH MARKS		AS BUILT INFORMATION	
		FIELD NOTES					
		NO.	BY	DATE		NO.	BY
		REMARKS		DATE		REMARKS	
		NO.	DATE	BY		NO.	DATE
		DESIGN		DATE		DESIGN	
		NO.	DATE	BY		NO.	DATE
		REVISIONS		DATE		REVISIONS	
		NO.	DATE	BY		NO.	DATE
		DESIGNED BY EAC		DATE 7/2/98		DESIGNED BY EAC	
		NO.	DATE	BY		NO.	DATE

CONSTRUCTION TRAFFIC CONTROL GENERAL NOTES

1. CONTRACTOR MUST OBTAIN FROM CONSTRUCTION COORDINATION AN EXCAVATION/BARRICADING PERMIT BEFORE ENGAGING IN ANY CONSTRUCTION, MAINTENANCE OR REPAIR WORK IN ANY OF THE CITY OF ALBUQUERQUE'S RIGHTS-OF-WAY. EMERGENCY WORK THAT WOULD PRESERVE LIFE OR PROPERTY IS EXCLUDED WITH THE UNDERSTANDING THAT A PERMIT SHALL BE OBTAINED WITHIN 24 TO 48 HOURS.

2. CONTRACTOR SHALL AT THE TIME OF PERMIT REQUEST, SUBMIT FOR APPROVAL BY CONSTRUCTION COORDINATION, A TRAFFIC CONTROL PLAN DETAILING ALL EXISTING TOPOGRAPHY SUCH AS LANE WIDTHS, DRIVEWAYS, AND BUSINESS/RESIDENTIAL ACCESSES. THE TRAFFIC CONTROL PLAN SHALL INCLUDE ALL PHASES OF WORK AND SCHEDULES INVOLVED IN THE CONSTRUCTION PROJECT. ANY SEPARATE PHASES OF A CONSTRUCTION PROJECT SHALL BE GIVEN AN INDIVIDUAL PERMIT EACH. BLANKET PERMITS WILL NOT BE ISSUED.

3. THESE TYPICAL TRAFFIC CONTROL PLANS DO NOT REFLECT THE EXISTING TOPOGRAPHY SUCH AS DRIVEWAYS, LANE WIDTHS, AND BUSINESS/RESIDENTIAL ACCESSES. EVERY LOCATION THAT REQUIRES CONSTRUCTION TRAFFIC CONTROL SHALL HAVE A DETAILED TRAFFIC CONTROL PLAN SHOWING ALL EXISTING TOPOGRAPHY.

4. CONSTRUCTION SHALL NOT BEGIN UNLESS A TRAFFIC CONTROL PLAN HAS BEEN APPROVED AND VERIFIED BY CONSTRUCTION COORDINATION.

5. CONSTRUCTION COORDINATION SHALL BE NOTIFIED 48 HOURS PRIOR TO ANY TRAFFIC CONTROL CHANGES NEEDED BY CONTRACTOR, THAT WERE NOT PREVIOUSLY APPROVED. THESE TRAFFIC CONTROL CHANGES SHALL BE REQUESTED IN WRITING ACCOMPANIED WITH A TRAFFIC CONTROL PLAN REFLECTING SUCH CHANGES.

6. ALL CONSTRUCTION TRAFFIC CONTROL DEVICES SHALL COMPLY TO THE MANUAL ON UNIFORM TRAFFIC CONTROL DEVICES (MUTCD), LATEST EDITION. IT IS THE RESPONSIBILITY OF THE CONTRACTOR TO INSTALL, SERVICE AND MAINTAIN ALL TRAFFIC CONTROL DEVICES. TRAFFIC CONTROL DEVICES SHALL NOT BE REMOVED OR ALTERED IN ANY WAY WITHOUT THE APPROVAL OF CONSTRUCTION COORDINATION, PER SECTION 6A-4 OF THE MUTCD, LATEST EDITION.

7. THE CONSTRUCTION TRAFFIC CONTROL INITIAL SET-UP SHALL BE BY AN AMERICAN TRAFFIC SAFETY SERVICES ASSOCIATION (ATSSA) CERTIFIED WORKSITE TRAFFIC SUPERVISOR. THE MAINTENANCE AND SERVICING SHALL ALSO BE DONE BY AN ATSSA CERTIFIED WORKSITE TRAFFIC SUPERVISOR OR EQUIVALENT.

8. CONTRACTOR IS RESPONSIBLE TO MAINTAIN AND SERVICE ALL TRAFFIC CONTROL DEVICES 24 HOURS A DAY, 7 DAYS A WEEK THROUGHOUT LENGTH OF PROJECT. CONTRACTOR IS RESPONSIBLE THAT ALL TRAFFIC CONTROL DEVICES COMPLY WITH THE MUTCD, LATEST EDITION.

9. ALL ADVANCE WARNING SIGNS SHALL BE DOUBLE INDICATED WHENEVER THERE ARE MULTI-LANE TRAFFIC IN ANY ONE GIVEN DIRECTION AND THERE IS SUFFICIENT MEDIAN SPACE.

10. ALL BARRICADES IN ALL TAPERS AND TANGENTS SHALL BE PLACED APART, A DISTANCE MEASURED IN FEET, EQUAL TO THAT OF THE POSTED SPEED LIMIT. NO EXCEPTIONS UNLESS APPROVED BY CONSTRUCTION COORDINATION PER MUTCD SECTION 6A-4.

11. CONTRACTOR SHALL NOT BEGIN WORK BEFORE 7:00 A.M. OR END WORK AFTER 7:00 P.M. WITHOUT THE APPROVAL OF CONSTRUCTION COORDINATION.

12. CONTRACTOR IS RESPONSIBLE TO PROVIDE CONSTRUCTION COORDINATION, A WEEKLY LOG OF DAILY INSPECTIONS OF BARRICADE AND MAINTENANCE SCHEDULES ON PROJECTS THAT ARE OVER ONE WEEK DURATION.

13. EQUIPMENT OR MATERIALS SHALL NOT BE STORED WITHIN 15 FEET OF A TRAVELLED TRAFFIC LANE DURING NON-WORKING HOURS WITHOUT THE APPROVAL OF CONSTRUCTION COORDINATION.

14. CONTRACTOR SHALL PROVIDE AND MAINTAIN A SAFE AND ADEQUATE MEANS OF CHANNELIZING PEDESTRIAN TRAFFIC AROUND AND THROUGH THE CONSTRUCTION AREA.

15. CONTRACTOR IS RESPONSIBLE FOR OBLITERATION OF ANY CONFLICTING STRIPING AND RESPONSIBLE FOR ALL TEMPORARY STRIPING.

16. CONTRACTOR SHALL MAINTAIN ACCESS TO ALL FACILITIES, BUSINESSES AND/OR RESIDENTS AT ALL TIMES.

17. CONTRACTOR SHALL PROVIDE ACCESS SIGNS FOR BUSINESSES LOCATED WITHIN THE CONSTRUCTION AREA UNDER THE SUPERVISION OF CONSTRUCTION COORDINATION. EACH ACCESS SIGN SHALL HAVE 5 INCH, WHITE OPAQUE LETTERING ON BLUE REFLECTORIZED BACKGROUND. ACCESS SIGNS SHALL BE CONSIDERED INCIDENTAL TO THE BID AND NOT PART OF THE CONTRACT UNLESS OTHERWISE STATED. NO MORE THAN 3 BUSINESSES SHALL BE LISTED ON A ACCESS SIGN SHOPPING CENTERS AND MALLS SHALL BE LISTED AS SUCH.

18. ALL ADVANCE WARNING SIGNS SHALL MEET THE MINIMUM REFLECTIVE INTENSITY REQUIREMENTS SET FORTH BY THE CITY OF ALBUQUERQUE. CONSTRUCTION COORDINATION SHALL DETERMINE ALL REQUIREMENTS AND APPROVE OR DISAPPROVE ANY ADVANCE WARNING SIGN PER SECTION 6A-4 OF THE MUTCD, LATEST EDITION.

19. 24 HOURS PRIOR TO OCCUPYING OR CLOSING OF A RIGHT-OF-WAY, CONTRACTOR SHALL NOTIFY: POLICE, FIRE DEPARTMENT, SCHOOLS, HOSPITALS, TRANSIT AUTHORITY, BUSINESSES AND/OR RESIDENTS THAT WILL BE AFFECTED BY THE CONSTRUCTION.

20. ANY FIELD ADJUSTMENTS SHALL BE APPROVED BY CONSTRUCTION COORDINATION.

21. EXCAVATIONS SHALL BE PLATED, TEMPORARILY PATCHED OR RESURFACED PRIOR TO OPENING OF TRAFFIC. A MINIMUM OF 11 FEET SHALL BE PROVIDED FOR TRAFFIC IN ANY GIVEN DIRECTION. CONTRACTOR IS RESPONSIBLE FOR ANY WORK INVOLVED IN SATISFYING THESE REQUIREMENTS.

22. CONTRACTOR SHALL AT ALL TIMES COMPLY WITH THE FOLLOWING:
1. STANDARDS AND REQUIREMENTS SET FORTH IN THE MANUAL ON UNIFORM TRAFFIC CONTROL DEVICES, LATEST EDITION.
2. THE CITY OF ALBUQUERQUE TRAFFIC CODE, LATEST EDITION.
3. SECTION 19 OF THE CITY OF ALBUQUERQUE'S STANDARD SPECIFICATIONS FOR PUBLIC WORK CONSTRUCTION, AS WELL AS OTHER SECTIONS.

23. FAILURE TO COMPLY WITH ANY OF THE ABOVE MENTIONED, WILL BE ADEQUATE CAUSE TO CEASE ALL WORK ON ANY CONSTRUCTION PROJECT. WORK WILL NOT RESUME UNTIL ALL REQUIREMENTS ARE ADDRESSED AND APPROVED BY CONSTRUCTION COORDINATION.

24. ALL TRAFFIC CONTROL DEVICES SHALL BE KEPT IN NEW-CLEAN CONDITION. WASHING OF EQUIPMENT IS INCIDENTAL TO ITS PLACEMENT AND MAINTENANCE.

25. TRAFFIC CONTROL STANDARDS APPLY ONLY WHERE THE CONSTRUCTION TRAFFIC CONTROL PLANS ARE NOT SPECIFIC.

26. ADVANCE WARNING SIGNS SHALL BE 36"x36" WITH SUPER ENGINEERING GRADE SHEETING OR BETTER.

27. REGULATORY SIGNING SHALL BE PROVIDED TO REDUCE SPEED LIMITS TO 30 MPH THROUGH ALL CONSTRUCTION ZONES WHEN BARRICADING IS PRESENT.

SPECIAL PROJECT TRAFFIC CONTROL NOTES

1. CONTRACTOR SHALL NOT CLOSE MORE THAN ONE LANE AT A TIME IN THE SAME DIRECTION ON GIBSON BLVD.
2. A TYPICAL RIGHT LANE CLOSURE (SEE SHT. 6-2) ON EASTBOUND GIBSON BLVD, SHALL BE THE BARRICADING PROCEDURE FOR THE TRAIL CONSTRUCTION.
3. A TYPICAL LEFT LANE CLOSURE (SEE SHT. 6-2) SHALL BE THE BARRICADING PROCEDURE FOR THE MEDIAN LANDSCAPING CONSTRUCTION.
4. NO LANE CLOSURES ON EASTBOUND GIBSON BLVD SHALL BE PLACED BETWEEN 6:00 AM AND 9:00 AM, HOLIDAYS THEN FRIDAYS.
5. NO LANE CLOSURES ON WESTBOUND GIBSON BLVD SHALL BE PLACED BETWEEN 3:30 PM AND 7:00 PM, HOLIDAYS THEN FRIDAYS.
6. CONTRACTOR SHALL NOT CLOSE ANY EXISTING MEDIAN OPENINGS OR LEFT TURN LANES ON GIBSON BLVD AT ANY TIME.
7. CONTRACTOR SHALL NOT BARRICADE MORE THAN 1320 FT. (1/4 MI) AT A TIME.
8. CONTRACTOR SHALL PROMPTLY REMOVE ALL BARRICADES AND ADVANCE WARNING SIGNS IMMEDIATELY AFTER COMPLETING EACH WORK SHIFT.
9. ONLY BARRELS WILL BE ALLOWED FOR TRAFFIC CONTROL BARRICADES. TYPE I BARRICADES, CONES, OR VERTICAL PANELS WILL NOT BE ALLOWED.

SIGN FACE DETAILS

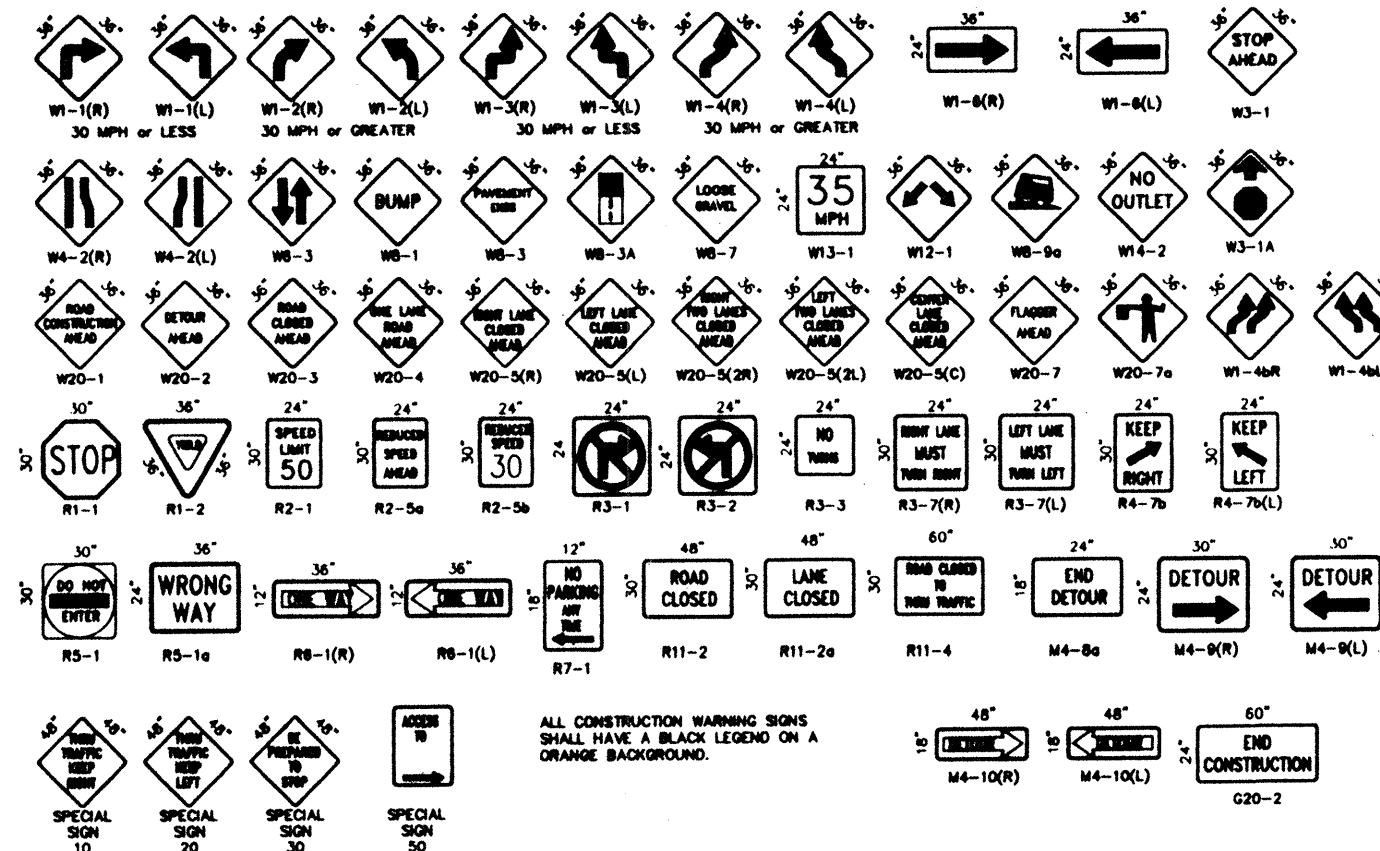

ALL CONSTRUCTION WARNING SIGNS SHALL HAVE A BLACK LEGEND ON A ORANGE BACKGROUND.

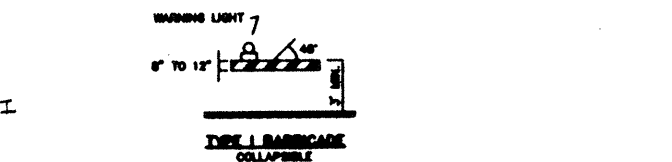
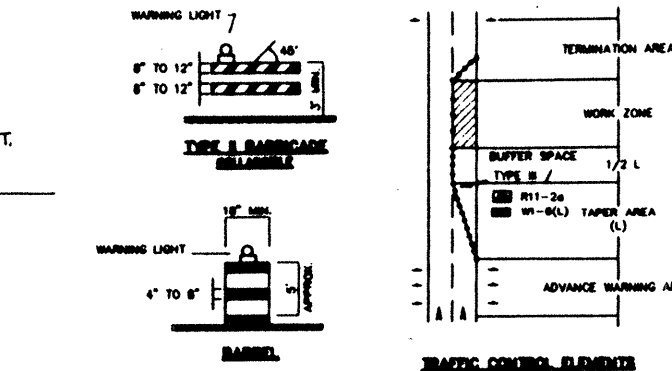
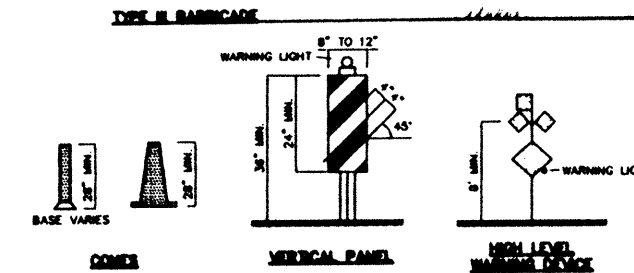
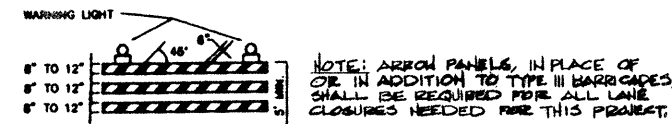

LEGEND

WORK AREA
BARRICADE - TYPE II BARREL
BARRICADE - TYPE III
VERTICAL PANEL (NOTE: VERTICAL PANELS WILL NOT BE ALLOWED ON THIS PROJECT)
WARNING SIGN
DISTANCE BETWEEN SIGNS - A DISTANCE MEASURED IN FEET EQUAL TO A VALUE OF TEN TIMES THE SPEED LIMIT OF THE STREET
FLAGMAN POSITION
SPACING BETWEEN BARRICADES - A DISTANCE MEASURED IN FEET EQUAL TO THE SPEED LIMIT OF THE STREET
TAPER LENGTH - SEE CHART BELOW
THE TANGENT LENGTH IS EQUAL TO THE TAPER LENGTH FOR A GIVEN STREET.

TAPER REQUIREMENTS

SPEED LIMIT (MPH)	TAPER LENGTH (L) (FEET)			MINIMUM NUMBER OF DEVICES FOR TAPER	MAXIMUM DEVICE SPACING IN FEET	
	10' LANE	11' LANE	12' LANE		BEFORE TAPER	AFTER TAPER
20	70	75	80	5	20	20
25	105	115	125	6	25	25
30	150	165	180	7	30	30
35	205	225	245	8	35	35
40	270	295	320	9	40	40
45	450	495	540	13	45	45
50	500	550	600	13	50	50
55	550	605	660	13	55	55

RECOMMENDED SIGN SPACING(D) FOR ADVANCE WARNING SIGN SERIES

SPEED MILES PER HOUR	MINIMUM DISTANCE BETWEEN SIGNS	MINIMUM DISTANCE FROM LAST SIGN TO TAPER
0-20	10 X SPEED LIMIT	10 X SPEED LIMIT
25-30	10 X SPEED LIMIT	10 X SPEED LIMIT
30-35	10 X SPEED LIMIT	10 X SPEED LIMIT
40-45	10 X SPEED LIMIT	10 X SPEED LIMIT
50-60	10 X SPEED LIMIT	10 X SPEED LIMIT

TAPER CRITERIA

TYPE OF TAPER	TAPER LENGTH
UPSTREAM TAPER:	
MERGING TAPER	L MINIMUM
SHIFTING TAPER	1/2 L MINIMUM
SHOULDER TAPER	1/2 L MINIMUM
TWO-WAY TRAFFIC TAPER	100 FEET MAXIMUM
DOWNSTREAM TAPERS	100 FEET PER LANE

TAPER LENGTH COMPUTATION

SPEED LIMIT	L = W x S
40 MPH OR LESS	L = W x 80
45 MPH OR GREATER	L = W x S

L = TAPER LENGTH
W = WIDTH OF OFFSET IN FEET
S = POSTED SPEED OR OFF-PEAK 85-PERCENTILE SPEED IN MPH

CITY OF ALBUQUERQUE
PUBLIC WORKS DEPARTMENT
ENGINEERING DEVELOPMENT GROUP

TITLE: GIBSON BOULEVARD ENHANCEMENT PROJECT
SIGNING AND CONSTRUCTION TRAFFIC CONTROL STANDARDS

DESIGN REVIEW COMMITTEE: AUG - 5 1998
CITY ENGINEER: AUG - 6 1998

PROJECT: MAP: SHEET: 2