

# CONSTRUCTION PLANS

FOR

## McDONALD'S RESTAURANT

### UTILITY IMPROVEMENTS

CITY OF ALBUQUERQUE  
WATER & SEWER IMPROVEMENTS  
NEW MEXICO  
AUGUST 1998

*EW*

#### INDEX TO DRAWINGS

1. TITLE SHEET
2. UTILITY IMPROVEMENTS PLAN & PROFILE  
COORS BOULEVARD  
STA 10+00 TO STA 15+04.79
3. SITE SPECIFIC TRAFFIC CONTROL PLANS
4. SIGNING AND CONSTRUCTION TRAFFIC CONTROL STANDARDS
5. TYPICAL TRAFFIC CONTROL AND SIGNING EXAMPLES (REF. M.U.T.C.D.)

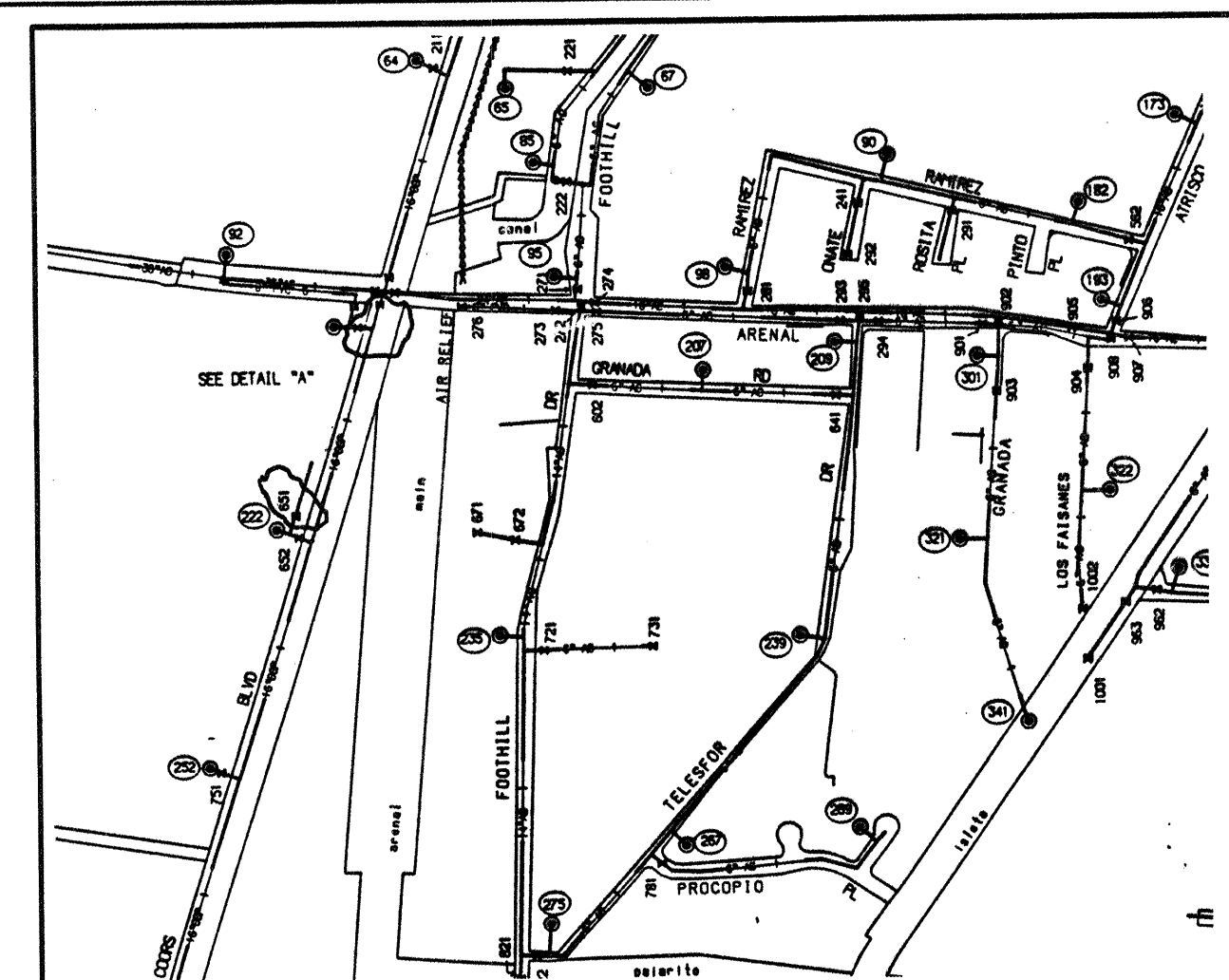

WATER SHUTOFF PLAN VALVE #651, SOME VALVES UNNUMBERED

- NOTES:
1. ONLY WATER SYSTEMS PERSONNEL ARE AUTHORIZED TO OPERATE VALVES.
  2. NOTIFY CITY OF ALBUQUERQUE, WATER SYSTEMS DIVISION (PHONE 857-8200) FIVE (5) WORKING DAYS IN ADVANCE OF NEEDING EXECUTION OF THE WATER SHUT OFF PLAN
  3. APPROXIMATE SHUT OFF TIME WILL BE 24 HOURS.
  4. SHUTOFF THE VALVES INDICATED IN THE ABOVE PLAN

APPROVAL OF AS BUILT DRAWINGS  
CHIEF CONSTRUCTION ENGINEER  
*Edo Chang*  
DATE 5-27-99

TERRA WEST, LLC  
EXPRESSLY RESERVES THE COMMON LAW COPYRIGHT AND  
OTHER PROPERTY RIGHTS IN THESE PLANS. THESE PLANS  
ARE NOT TO BE REPRODUCED, CHANGED OR COPIED IN  
ANY MANNER WHATSOEVER, NOR ARE THEY TO BE ASSIGNED  
TO ANY THIRD PARTY WITHOUT OBTAINING THE EXPRESS  
WRITTEN PERMISSION AND CONSENT OF TERRA WEST  
DEVELOPMENT MANAGEMENT SERVICES.

RECORD DRAWING  
DATE: 4-6-99 DRAFTED BY: R.W. KANE  
TERRA WEST DEV.  
THESE RECORD DRAWINGS HAVE BEEN PREPARED,  
IN PART, ON THE BASIS OF INFORMATION COMPILED  
AND FURNISHED BY OTHERS. THE ENGINEER WILL  
NOT BE RESPONSIBLE FOR ANY ERRORS OR OMISSIONS  
WHICH HAVE BEEN INCORPORATED INTO THE  
DOCUMENT AS A RESULT.

TERRA WEST, LLC  
4421 MCLEOD ROAD, N.E., SUITE D  
ALBUQUERQUE, NEW MEXICO 87109  
(505)883-7592



VICINITY MAP ZONE ATLAS M-11-Z

#### NOTICE TO CONTRACTORS

1. ALL WORK DETAILED ON THESE PLANS TO BE PERFORMED UNDER CONTRACT SHALL, EXCEPT AS OTHERWISE STATED OR PROVIDED FOR HEREON, BE CONSTRUCTED IN ACCORDANCE WITH THE CITY OF ALBUQUERQUE STANDARD SPECIFICATIONS FOR PUBLIC WORKS CONSTRUCTION, 1988 EDITION THROUGH (UPDATE #7)
2. TWO WORKING DAYS PRIOR TO ANY EXCAVATION, THE CONTRACTOR MUST CONTACT NEW MEXICO ONE CALL SYSTEM (280-1990) FOR LOCATION OF EXISTING UTILITIES.
3. ANY WORK AFFECTING AN ARTERIAL ROADWAY REQUIRES 24-HOUR CONSTRUCTION.
4. PRIOR TO CONSTRUCTION, THE CONTRACTOR SHALL EXCAVATE AND VERIFY THE HORIZONTAL AND VERTICAL LOCATIONS OF ALL OBSTRUCTIONS. SHOULD A CONFLICT EXIST, THE CONTRACTOR SHALL NOTIFY THE ENGINEER OR SURVEYOR IMMEDIATELY SO THAT THE CONFLICT CAN BE RESOLVED WITH A MINIMUM AMOUNT OF DELAY.
5. FIVE (5) WORKING DAYS PRIOR TO BEGINNING OF CONSTRUCTION, THE CONTRACTOR SHALL SUBMIT TO THE CONSTRUCTION COORDINATIONS DIVISION A DETAILED CONSTRUCTION SCHEDULE. TWO (2) WORKING DAYS PRIOR TO CONSTRUCTION, THE CONTRACTOR SHALL OBTAIN A BARRICADING PERMIT FROM THE CONST. COORDINATION DIVISION. CONTRACTOR SHALL NOTIFY BARRICADE ENGINEER (768-2551) PRIOR TO O.C. OPENING AN INTERSECTION. REFER TO STANDARD SPECIFICATIONS.
6. ALL STREET STRIPING ALTERED OR DESTROYED SHALL BE REPLACED WITH PLASTIC REFLECTORIZED PAVEMENT MARKINGS BY THE CONTRACTOR TO LOCATION AS EXISTING OR AS INDICATED BY THIS PLAN SET.
7. CONTRACTOR SHALL NOTIFY THE ENGINEER NOT LESS THAN SEVEN (7) DAYS PRIOR TO STARTING WORK IN ORDER THAT THE ENGINEER MAY TAKE NECESSARY MEASURES TO INSURE THE PRESERVATION OF SURVEY MONUMENTS. CONTRACTOR SHALL NOT DISTURB PERMANENT SURVEY MONUMENTS WITHOUT THE CONSENT OF THE ENGINEER AND SHALL NOTIFY THE ENGINEER AND BEAR THE EXPENSE OF REPLACING ANY THAT MAY BE DISTURBED WITHOUT PERMISSION. REPLACEMENT SHALL BE DONE ONLY BY THE CITY SURVEYOR. WHEN A CHANGE IS MADE IN THE FINISHED ELEVATIONS OF THE PAVEMENT OF ANY ROADWAY IN WHICH A PERMANENT SURVEY MONUMENT IS LOCATED, CONTRACTOR SHALL, AT HIS OWN EXPENSE, ADJUST THE MONUMENT COVER TO THE NEW GRADE UNLESS OTHERWISE SPECIFIED. REFER TO SECTION 4.4 OF THE GENERAL CONDITIONS OF THE STANDARD SPECIFICATIONS. ANY PERMANENT SURVEY MONUMENT LOCATED WITHIN 50' OF THIS PROJECT THAT IS NOT SHOWN ON THE PLAN AND IS DESTROYED DURING CONSTRUCTION WILL BE REPLACED AT THE DESIGNER'S EXPENSE.

THE FOLLOWING NOTES ALSO APPLY WHEN CHECKED

- ☐ ALL UTILITIES AND UTILITY SERVICE LINES SHALL BE INSTALLED PRIOR TO PAVING.
- ☐ BACKFILL COMPACTION SHALL BE ACCORDING TO SPECIFIED STREET USE.
- ☐ TACK COAT REQUIREMENTS SHALL BE DETERMINED BY THE CITY ENGINEER.
- ☐ SIDEWALKS AND WHEELCHAIR RAMPS WITHIN THE CURB RETURNS SHALL BE CONSTRUCTED WHEREVER A NEW CURB RETURN IS CONSTRUCTED.
- ☐ IF CURB IS DEPRESSED FOR A DRIVEPAD, THE DRIVEPAD SHALL BE CONSTRUCTED PRIOR TO ACCEPTANCE OF CURB AND GUTTER.
- ☐ ALL STORM DRAINAGE FACILITIES SHALL BE COMPLETED PRIOR TO FINAL ACCEPTANCE.

REV	SHEETS	CITY ENGINEER	DATE	USER DEPT.	DATE	USER DEPT.	DATE
1	1	APPROVED FOR CONSTRUCTION					
2	2	APPROVED FOR CONSTRUCTION					
3	3	APPROVED FOR CONSTRUCTION					
4	4	APPROVED FOR CONSTRUCTION					
5	5	APPROVED FOR CONSTRUCTION					
6	6	APPROVED FOR CONSTRUCTION					
7	7	APPROVED FOR CONSTRUCTION					
8	8	APPROVED FOR CONSTRUCTION					
9	9	APPROVED FOR CONSTRUCTION					
10	10	APPROVED FOR CONSTRUCTION					
11	11	APPROVED FOR CONSTRUCTION					
12	12	APPROVED FOR CONSTRUCTION					
13	13	APPROVED FOR CONSTRUCTION					
14	14	APPROVED FOR CONSTRUCTION					
15	15	APPROVED FOR CONSTRUCTION					
16	16	APPROVED FOR CONSTRUCTION					
17	17	APPROVED FOR CONSTRUCTION					
18	18	APPROVED FOR CONSTRUCTION					
19	19	APPROVED FOR CONSTRUCTION					
20	20	APPROVED FOR CONSTRUCTION					
21	21	APPROVED FOR CONSTRUCTION					
22	22	APPROVED FOR CONSTRUCTION					
23	23	APPROVED FOR CONSTRUCTION					
24	24	APPROVED FOR CONSTRUCTION					
25	25	APPROVED FOR CONSTRUCTION					
26	26	APPROVED FOR CONSTRUCTION					
27	27	APPROVED FOR CONSTRUCTION					
28	28	APPROVED FOR CONSTRUCTION					
29	29	APPROVED FOR CONSTRUCTION					
30	30	APPROVED FOR CONSTRUCTION					
31	31	APPROVED FOR CONSTRUCTION					
32	32	APPROVED FOR CONSTRUCTION					
33	33	APPROVED FOR CONSTRUCTION					
34	34	APPROVED FOR CONSTRUCTION					
35	35	APPROVED FOR CONSTRUCTION					
36	36	APPROVED FOR CONSTRUCTION					
37	37	APPROVED FOR CONSTRUCTION					
38	38	APPROVED FOR CONSTRUCTION					
39	39	APPROVED FOR CONSTRUCTION					
40	40	APPROVED FOR CONSTRUCTION					
41	41	APPROVED FOR CONSTRUCTION					
42	42	APPROVED FOR CONSTRUCTION					
43	43	APPROVED FOR CONSTRUCTION					
44	44	APPROVED FOR CONSTRUCTION					
45	45	APPROVED FOR CONSTRUCTION					
46	46	APPROVED FOR CONSTRUCTION					
47	47	APPROVED FOR CONSTRUCTION					
48	48	APPROVED FOR CONSTRUCTION					
49	49	APPROVED FOR CONSTRUCTION					
50	50	APPROVED FOR CONSTRUCTION					
51	51	APPROVED FOR CONSTRUCTION					
52	52	APPROVED FOR CONSTRUCTION					
53	53	APPROVED FOR CONSTRUCTION					
54	54	APPROVED FOR CONSTRUCTION					
55	55	APPROVED FOR CONSTRUCTION					
56	56	APPROVED FOR CONSTRUCTION					
57	57	APPROVED FOR CONSTRUCTION					
58	58	APPROVED FOR CONSTRUCTION					
59	59	APPROVED FOR CONSTRUCTION					
60	60	APPROVED FOR CONSTRUCTION					
61	61	APPROVED FOR CONSTRUCTION					
62	62	APPROVED FOR CONSTRUCTION					
63	63	APPROVED FOR CONSTRUCTION					
64	64	APPROVED FOR CONSTRUCTION					
65	65	APPROVED FOR CONSTRUCTION					
66	66	APPROVED FOR CONSTRUCTION					
67	67	APPROVED FOR CONSTRUCTION					
68	68	APPROVED FOR CONSTRUCTION					
69	69	APPROVED FOR CONSTRUCTION					
70	70	APPROVED FOR CONSTRUCTION					
71	71	APPROVED FOR CONSTRUCTION					
72	72	APPROVED FOR CONSTRUCTION					
73	73	APPROVED FOR CONSTRUCTION					
74	74	APPROVED FOR CONSTRUCTION					
75	75	APPROVED FOR CONSTRUCTION					
76	76	APPROVED FOR CONSTRUCTION					
77	77	APPROVED FOR CONSTRUCTION					
78	78	APPROVED FOR CONSTRUCTION					
79	79	APPROVED FOR CONSTRUCTION					
80	80	APPROVED FOR CONSTRUCTION					
81	81	APPROVED FOR CONSTRUCTION					
82	82	APPROVED FOR CONSTRUCTION					
83	83	APPROVED FOR CONSTRUCTION					
84	84	APPROVED FOR CONSTRUCTION					
85	85	APPROVED FOR CONSTRUCTION					
86	86	APPROVED FOR CONSTRUCTION					
87	87	APPROVED FOR CONSTRUCTION					
88	88	APPROVED FOR CONSTRUCTION					
89	89	APPROVED FOR CONSTRUCTION					
90	90	APPROVED FOR CONSTRUCTION					
91	91	APPROVED FOR CONSTRUCTION					
92	92	APPROVED FOR CONSTRUCTION					
93	93	APPROVED FOR CONSTRUCTION					
94	94	APPROVED FOR CONSTRUCTION					
95	95	APPROVED FOR CONSTRUCTION					
96	96	APPROVED FOR CONSTRUCTION					
97	97	APPROVED FOR CONSTRUCTION					
98	98	APPROVED FOR CONSTRUCTION					
99	99	APPROVED FOR CONSTRUCTION					
100	100	APPROVED FOR CONSTRUCTION					







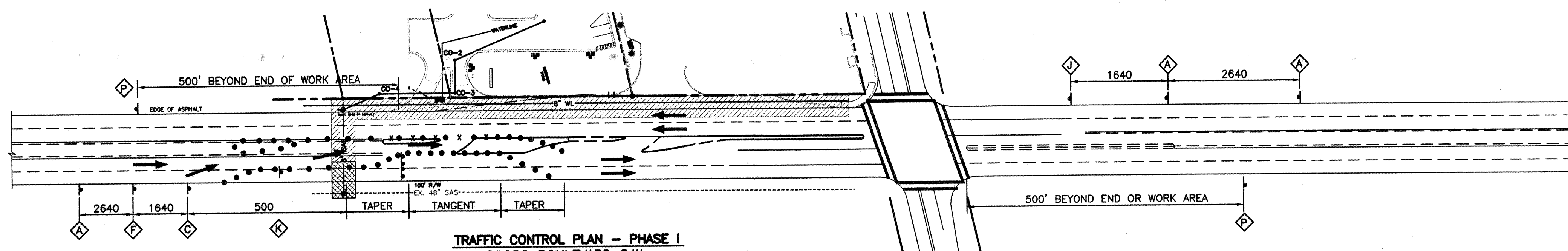

TRAFFIC CONTROL PLAN - PHASE I  
COORS BOULEVARD S.W.

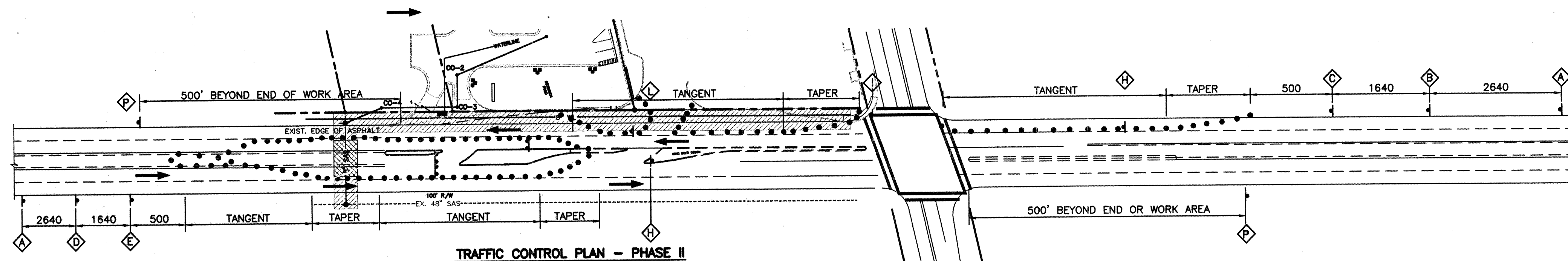

TRAFFIC CONTROL PLAN - PHASE II  
COORS BOULEVARD S.W.

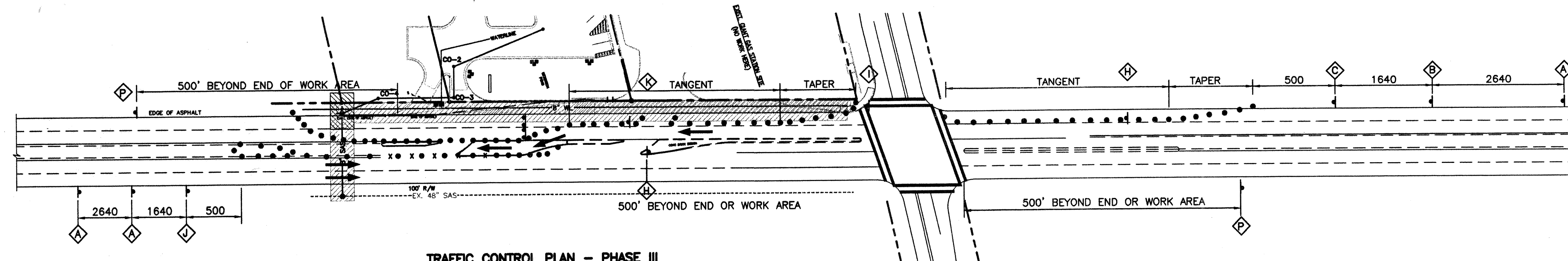

TRAFFIC CONTROL PLAN - PHASE III  
COORS BOULEVARD S.W.

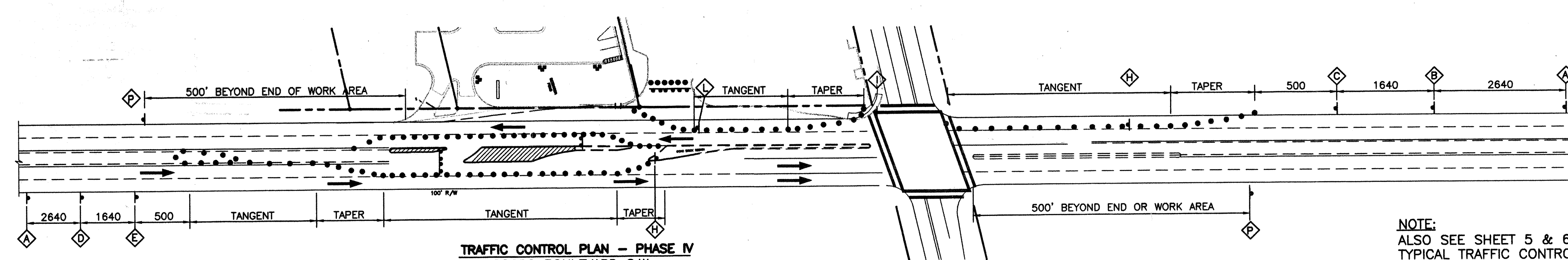

TRAFFIC CONTROL PLAN - PHASE IV  
COORS BOULEVARD S.W.

NOTE:  
ALSO SEE SHEET 5 & 6 FOR  
TYPICAL TRAFFIC CONTROL  
DETAILS AND SIGNING.

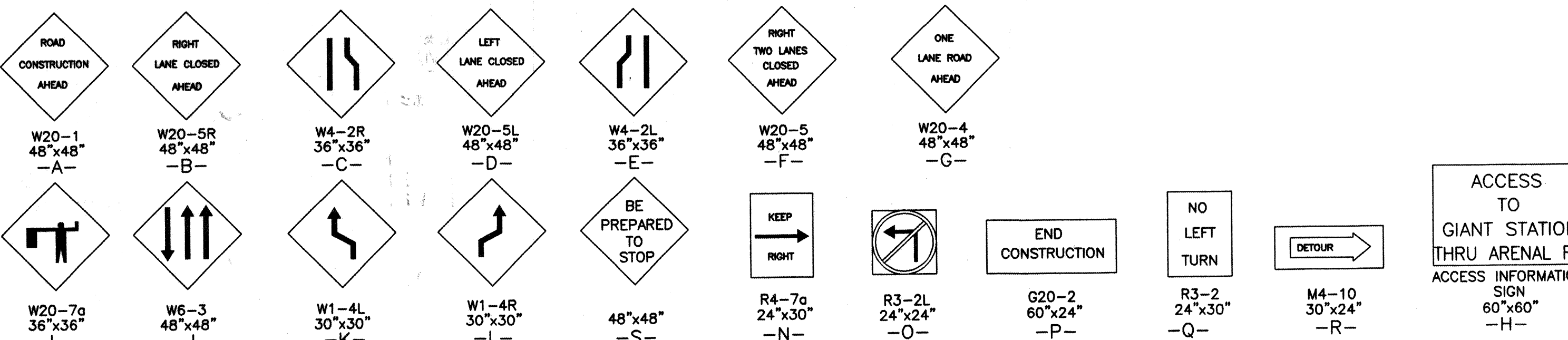

NOTE: ARROW DIRECTION  
TO BE ADJUSTED AS  
NEEDED.

SPEED LIMIT (MPH)	TAPER LENGTH (FEET)			MAXIMUM DISTANCE BETWEEN DEVICES (FEET)	MINIMUM NUMBER OF DEVICES REQUIRED
	10' LANE	11' LANE	12' LANE		
25	104	115	125	25	6
30	150	165	185	30	7
35	204	225	245	35	8
40	267	293	320	40	9
45	450	495	540	45	13
50	500	550	600	50	13
55	550	605	660	55	13

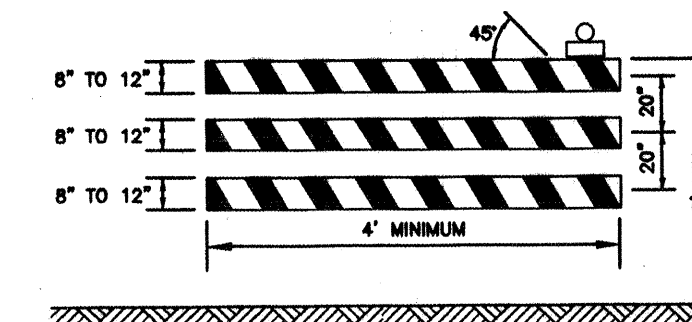

TYPE III BARRICADE

NOTE: FLASHING OR STEADY BURN WARNING LIGHTS  
SHOULD BE USED ON BARRICADES, PANELS, AND  
DRUMS AS NEEDED.

### LEGEND

- WORK AREA
- TRAFFIC SIGN & QUANTITY (SEE THIS SHEET FOR DESIGNATION)
- BARRICADE - TYPE I, TYPE II, OR BARREL
- BARRICADE - TYPE III
- VERTICAL PANEL
- WARNING SIGN
- DISTANCE BETWEEN SIGNS-A DISTANCE MEASURED IN FEET EQUAL TO A VALUE OF TEN TIMES THE SPEED LIMIT OF THE STREET
- FLAGMAN POSITION
- SPACING BETWEEN BARRICADES-A DISTANCE MEASURED IN FEET EQUAL TO THE SPEED LIMIT OF THE STREET

TAPER LENGTH - ON CHART AT LEFT

TANGENT LENGTH - IS EQUAL TO THE TAPER LENGTH FOR A GIVEN STREET

### NOTES

- ALL ADVANCE WARNING SIGNS ARE TO BE DOUBLE INDICATED WHENEVER MEDIANS ARE PRESENT.
- TRANSFORMATION FROM EXISTING SIGNALS TO SPAN WIRE IS TO OCCUR AT OFF PEAK HOURS.
- THIS IS A STANDARD TRAFFIC CONTROL PLAN AND SOME TRAFFIC CONTROL SITUATIONS MAY BE SHOWN THAT ARE NOT REQUIRED ON THIS PARTICULAR PROJECT.

<b>TIERRA WEST, LLC</b> 4421 McLEOD ROAD, N.E., SUITE D ALBUQUERQUE, NEW MEXICO 87109 (505)883-7592					
COUNTY OF BERNALILLO PUBLIC WORKS DEPARTMENT ENGINEERING GROUP					
TITLE: <b>McDONALD'S RESTAURANT</b> SITE SPECIFIC TRAFFIC CONTROL PLANS COORS BLVD. STA: 10+00.00 TO STA: 15+04.79					
APPROVALS	ENGINEER	DATE	APPROVALS	ENGINEER	DATE
DRC CHAIRMAN			WATER		
TRANSPORTATION			WASTE WATER		
HYDROLOGY					
PROJECT NO.	594781	MAP NO.	M-11-Z	SHEET	3 OF 5

AS BUILT INFORMATION		BENCH MARKS		SURVEY INFORMATION		ENGINEER'S SEAL	
CONTRACTOR	DATE	ACS	DATE	NO.	DATE	NO.	DATE
INSPECTOR	DATE	FIELD	DATE	BY	DATE	BY	DATE
STAKED BY	DATE	FIELD	DATE	REMARKS	DATE	REMARKS	DATE
FIELD	DATE	FIELD	DATE	DESIGN	DATE	DESIGN	DATE
FIELD	DATE	FIELD	DATE	DESIGNED BY	DATE	DESIGNED BY	DATE
FIELD	DATE	FIELD	DATE	DRAWN BY	DATE	DRAWN BY	DATE
FIELD	DATE	FIELD	DATE	CHECKED BY	DATE	CHECKED BY	DATE



# CONSTRUCTION TRAFFIC CONTROL GENERAL NOTES

1. CONTRACTOR MUST OBTAIN FROM CONSTRUCTION COORDINATION AN EXCAVATION/BARRICADING PERMIT BEFORE ENGAGING IN ANY CONSTRUCTION, MAINTENANCE OR REPAIR WORK IN ANY OF THE CITY OF ALBUQUERQUE'S RIGHTS-OF-WAY. EMERGENCY WORK THAT WOULD PRESERVE LIFE OR PROPERTY IS EXCLUDED WITH THE UNDERSTANDING, THAT A PERMIT SHALL BE OBTAINED WITHIN 24 TO 48 HOURS.

2. CONTRACTOR SHALL AT THE TIME OF PERMIT REQUEST, SUBMIT FOR APPROVAL BY CONSTRUCTION COORDINATION, A TRAFFIC CONTROL PLAN DETAILING ALL EXISTING TOPOGRAPHY SUCH AS LANE WIDTHS, DRIVEWAYS, AND BUSINESS/RESIDENTIAL ACCESSES. THE TRAFFIC CONTROL PLAN SHALL INCLUDE ALL PHASES OF WORK AND SCHEDULES INVOLVED IN THE CONSTRUCTION PROJECT. ANY SEPARATE PHASES OF A CONSTRUCTION PROJECT SHALL BE GIVEN AN INDIVIDUAL PERMIT EACH. BLANKET PERMITS WILL NOT BE ISSUED.

3. THESE TYPICAL TRAFFIC CONTROL PLANS DO NOT REFLECT THE EXISTING TOPOGRAPHY SUCH AS DRIVEWAYS, LANE WIDTHS, AND BUSINESS/RESIDENTIAL ACCESSES. EVERY LOCATION THAT REQUIRES CONSTRUCTION TRAFFIC CONTROL SHALL HAVE A DETAILED TRAFFIC CONTROL PLAN SHOWING ALL EXISTING TOPOGRAPHY.

4. CONSTRUCTION SHALL NOT BEGIN UNLESS A TRAFFIC CONTROL PLAN HAS BEEN APPROVED AND VERIFIED BY CONSTRUCTION COORDINATION.

5. CONSTRUCTION COORDINATION SHALL BE NOTIFIED 48 HOURS PRIOR TO ANY TRAFFIC CONTROL CHANGES NEEDED BY CONTRACTOR, THAT WERE NOT PREVIOUSLY APPROVED. THESE TRAFFIC CONTROL CHANGES SHALL BE REQUESTED IN WRITING ACCOMPANIED WITH A TRAFFIC CONTROL PLAN REFLECTING SUCH CHANGES.

6. ALL CONSTRUCTION TRAFFIC CONTROL DEVICES SHALL COMPLY TO THE MANUAL ON UNIFORM TRAFFIC CONTROL DEVICES (MUTCD), LATEST EDITION. IT IS THE RESPONSIBILITY OF THE CONTRACTOR TO INSTALL, SERVICE AND MAINTAIN ALL TRAFFIC CONTROL DEVICES. TRAFFIC CONTROL DEVICES SHALL NOT BE REMOVED OR ALTERED IN ANY WAY WITHOUT THE APPROVAL OF CONSTRUCTION COORDINATION, PER SECTION 6A-4 OF THE MUTCD, LATEST EDITION.

7. THE CONSTRUCTION TRAFFIC CONTROL INITIAL SET-UP SHALL BE BY AN AMERICAN TRAFFIC SAFETY SERVICES ASSOCIATION (ATSSA) CERTIFIED WORKSITE TRAFFIC SUPERVISOR. THE MAINTENANCE AND SERVICING SHALL ALSO BE DONE BY AN ATSSA CERTIFIED WORKSITE TRAFFIC SUPERVISOR OR EQUIVALENT.

8. CONTRACTOR IS RESPONSIBLE TO MAINTAIN AND SERVICE ALL TRAFFIC CONTROL DEVICES 24 HOURS A DAY, 7 DAYS A WEEK THROUGHOUT LENGTH OF PROJECT. CONTRACTOR IS RESPONSIBLE THAT ALL TRAFFIC CONTROL DEVICES COMPLY WITH THE MUTCD, LATEST EDITION.

9. ALL ADVANCE WARNING SIGNS SHALL BE DOUBLE INDICATED WHENEVER THERE ARE MULTI-LANE TRAFFIC IN ANY ONE GIVEN DIRECTION AND THERE IS SUFFICIENT MEDIAN SPACE.

10. ALL BARRICADES IN ALL TAPERS AND TANGENTS SHALL BE PLACED APART, A DISTANCE MEASURED IN FEET, EQUAL TO THAT OF THE POSTED SPEED LIMIT. NO EXCEPTIONS UNLESS APPROVED BY CONSTRUCTION COORDINATION PER MUTCD SECTION 6A-4.

11. ALL WORK IN ARTERIAL ROADWAYS SHALL BE ON A CONTINUOUS 24 HOUR PER DAY BASIS UNTIL COMPLETED.

12. CONTRACTOR IS RESPONSIBLE TO PROVIDE CONSTRUCTION COORDINATION, A WEEKLY LOG OF DAILY INSPECTIONS OF BARRICADE AND MAINTENANCE SCHEDULES ON PROJECTS THAT ARE OVER ONE WEEK DURATION.

13. EQUIPMENT OR MATERIALS SHALL NOT BE STORED WITHIN 15 FEET OF A TRAVELLED TRAFFIC LANE DURING NON-WORKING HOURS WITHOUT THE APPROVAL OF CONSTRUCTION COORDINATION.

14. CONTRACTOR SHALL PROVIDE AND MAINTAIN A SAFE AND ADEQUATE MEANS OF CHANNELIZING PEDESTRIAN TRAFFIC AROUND AND THROUGH THE CONSTRUCTION AREA.

15. CONTRACTOR IS RESPONSIBLE FOR OBLITERATION OF ANY CONFLICTING STRIPING AND RESPONSIBLE FOR ALL TEMPORARY STRIPING.

16. CONTRACTOR SHALL MAINTAIN ACCESS TO ALL FACILITIES, BUSINESSES AND/OR RESIDENTS AT ALL TIMES.

17. CONTRACTOR SHALL PROVIDE ACCESS SIGNS FOR BUSINESSES LOCATED WITHIN THE CONSTRUCTION AREA UNDER THE SUPERVISION OF CONSTRUCTION COORDINATION. EACH ACCESS SIGN SHALL HAVE 5 INCH, WHITE OPAQUE LETTERING ON BLUE REFLECTORIZED BACKGROUND. ACCESS SIGNS SHALL BE CONSIDERED INCIDENTAL TO THE BID AND NOT PART OF THE CONTRACT UNLESS OTHERWISE STATED. NO MORE THAN 3 BUSINESSES SHALL BE LISTED ON A ACCESS SIGN. SHOPPING CENTERS AND MALLS SHALL BE LISTED AS SUCH.

18. ALL ADVANCE WARNING SIGNS SHALL MEET THE MINIMUM REFLECTIVE INTENSITY REQUIREMENTS SET FORTH BY THE CITY OF ALBUQUERQUE. CONSTRUCTION COORDINATION SHALL DETERMINE ALL REQUIREMENTS AND APPROVE OR DISAPPROVE ANY ADVANCE WARNING SIGN PER SECTION 6A-4 OF THE MUTCD, LATEST EDITION.

19. 48 HOURS PRIOR TO OCCUPYING OR CLOSING OF A RIGHT-OF-WAY, CONTRACTOR SHALL NOTIFY: POLICE, FIRE DEPARTMENT, SCHOOLS, HOSPITALS, TRANSIT AUTHORITY, BUSINESSES AND/OR RESIDENTS THAT WILL BE AFFECTED BY THE CONSTRUCTION.

20. ANY FIELD ADJUSTMENTS SHALL BE APPROVED BY CONSTRUCTION COORDINATION.

21. EXCAVATIONS SHALL BE PLATED, TEMPORARILY PATCHED OR RESURFACED PRIOR TO OPENING OF TRAFFIC. A MINIMUM OF 11 FEET SHALL BE PROVIDED FOR TRAFFIC IN ANY GIVEN DIRECTION. CONTRACTOR IS RESPONSIBLE FOR ANY WORK INVOLVED IN SATISFYING THESE REQUIREMENTS.

22. CONTRACTOR SHALL AT ALL TIMES COMPLY WITH THE FOLLOWING:  
1. STANDARDS AND REQUIREMENTS SET FORTH IN THE MANUAL ON UNIFORM TRAFFIC CONTROL DEVICES, LATEST EDITION.  
2. THE CITY OF ALBUQUERQUE TRAFFIC CODE, LATEST EDITION.  
3. SECTION 19 OF THE CITY OF ALBUQUERQUE'S STANDARD SPECIFICATIONS FOR PUBLIC WORK CONSTRUCTION, AS WELL AS OTHER SECTIONS.

23. FAILURE TO COMPLY WITH ANY OF THE ABOVE MENTIONED, WILL BE ADEQUATE CAUSE TO CEASE ALL WORK ON ANY CONSTRUCTION PROJECT. WORK WILL NOT RESUME UNTIL ALL REQUIREMENTS ARE ADDRESSED AND APPROVED BY CONSTRUCTION COORDINATION.

24. ALL TRAFFIC CONTROL DEVICES SHALL BE KEPT IN NEW-CLEAN CONDITION. WASHING OF EQUIPMENT IS INCIDENTAL TO ITS PLACEMENT AND MAINTENANCE.

25. TRAFFIC CONTROL STANDARDS APPLY ONLY WHERE THE CONSTRUCTION TRAFFIC CONTROL PLANS ARE NOT SPECIFIC.

26. ADVANCE WARNING SIGNS SHALL BE 36"x36" MIN. WITH SUPER ENGINEERING GRADE SHEETING OR BETTER. MOUNTING HEIGHT AT TOP OF SIGN SHALL BE THE SAME AS FOR A 48" SIGN AS INDICATED IN THE M.U.T.C.D. 3

27. CONTRACTOR SHALL MAINTAIN A GRAFFITI-FREE WORKSITE. ALL GRAFFITI SHALL BE PROMPTLY REMOVED FROM ALL EQUIPMENT, BOTH PERMANENT AND TEMPORARY. 4

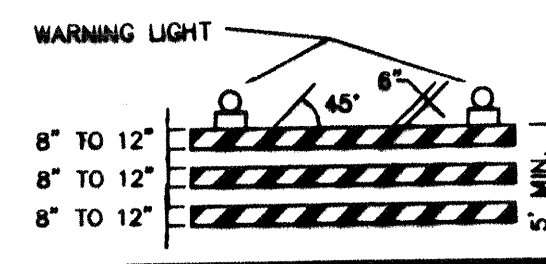

TYPE III BARRICADE

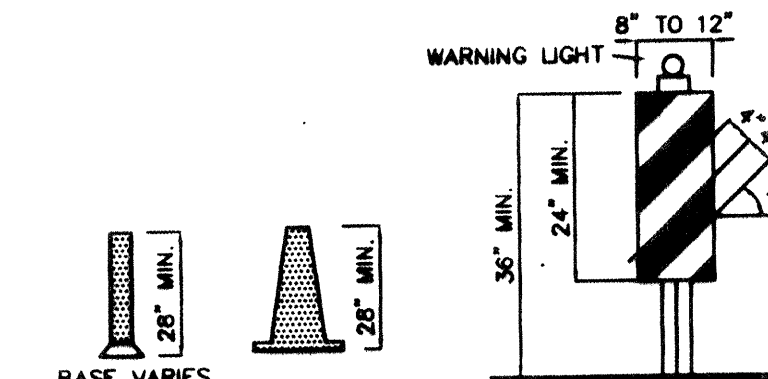

TYPE II BARRICADE



TYPE I BARRICADE

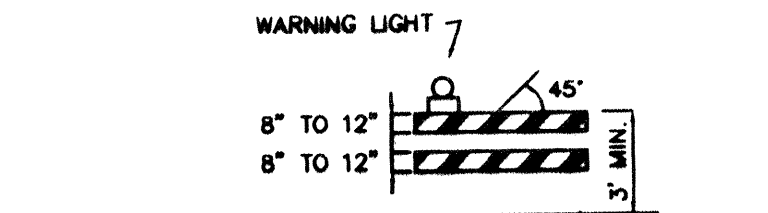

TYPE I BARRICADE

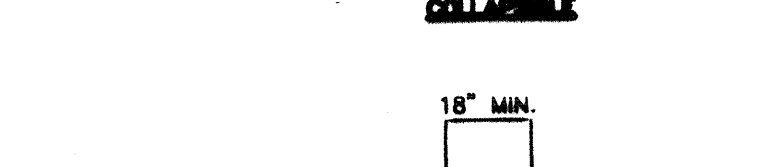

TYPE I BARRICADE

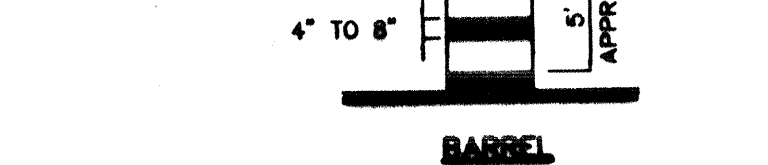

TYPE I BARRICADE

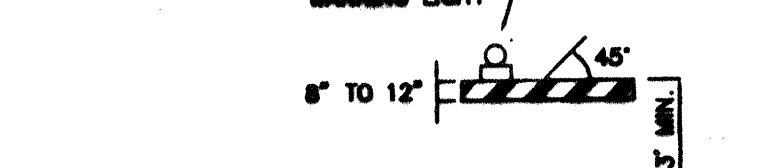

TYPE I BARRICADE



TYPE I BARRICADE

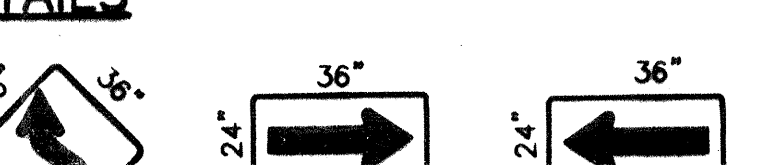

TYPE I BARRICADE

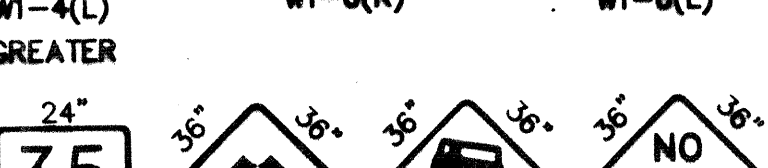

TYPE I BARRICADE

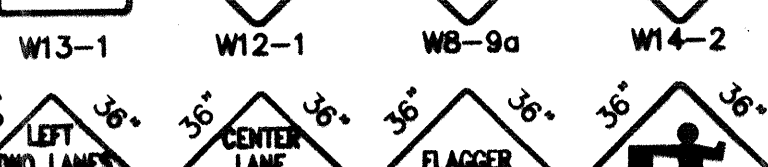

TYPE I BARRICADE

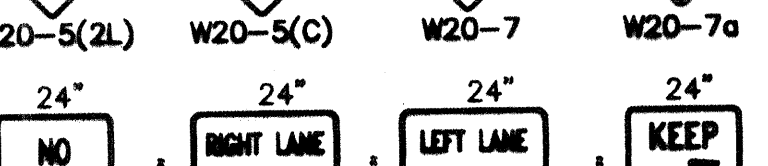

TYPE I BARRICADE

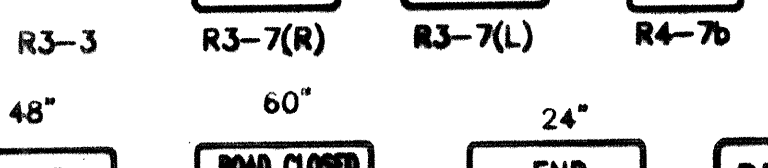

TYPE I BARRICADE

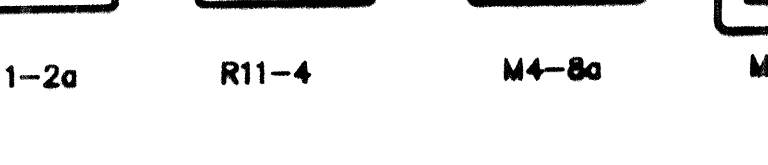

TYPE I BARRICADE

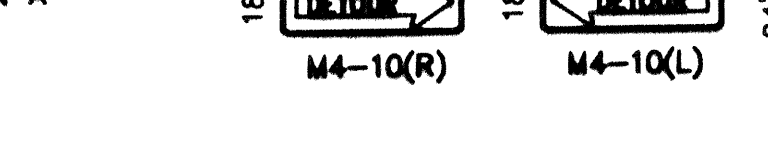

TYPE I BARRICADE



TYPE I BARRICADE

## LEGEND

WORK AREA  
BARRICADE - TYPE I, TYPE II, OR BARREL  
BARRICADE - TYPE III  
VERTICAL PANEL  
WARNING SIGN  
DISTANCE BETWEEN SIGNS - A DISTANCE MEASURED IN FEET EQUAL TO A VALUE OF TEN TIMES THE SPEED LIMIT OF THE STREET  
FLAGMAN POSITION  
SPACING BETWEEN BARRICADES - A DISTANCE MEASURED IN FEET EQUAL TO THE SPEED LIMIT OF THE STREET  
TAPER LENGTH - SEE CHART BELOW  
THE TANGENT LENGTH IS EQUAL TO THE TAPER LENGTH FOR A GIVEN STREET.

## TAPER REQUIREMENTS

SPEED LIMIT (MPH)	TAPER LENGTH (L) (FEET)			MINIMUM NUMBER OF DEVICES FOR TAPER	MAXIMUM DEVICE SPACING IN FEET	
	10' LANE	11' LANE	12' LANE		ALONG TAPER	AFTER TAPER
20	70	75	80	5	20	20
25	105	115	125	6	25	25
30	150	165	180	7	30	30
35	205	225	245	8	35	35
40	270	295	320	9	40	40
45	450	495	540	13	45	45
50	500	550	600	13	50	50
55	550	605	660	13	55	55

## RECOMMENDED SIGN SPACING(D) FOR ADVANCE WARNING SIGN SERIES

SPEED LIMIT (MPH)	MINIMUM DISTANCE BETWEEN SIGNS	MINIMUM DISTANCE FROM LAST SIGN TO TAPER
0-20	10 X SPEED LIMIT	10 X SPEED LIMIT
25-30	10 X SPEED LIMIT	10 X SPEED LIMIT
30-35	10 X SPEED LIMIT	10 X SPEED LIMIT
40-45	10 X SPEED LIMIT	10 X SPEED LIMIT
50-60	10 X SPEED LIMIT	10 X SPEED LIMIT

## TAPER CRITERIA

TYPE OF TAPER	TAPER LENGTH
UPSTREAM TAPER:	
MERGING TAPER	L MINIMUM
SHIFTING TAPER	1/2 L MINIMUM
SHOULDER TAPER	1/2 L MINIMUM
TWO-WAY TRAFFIC TAPER	100 FEET MAXIMUM
DOWNSTREAM TAPERS	100 FEET PER LANE

## TAPER LENGTH COMPUTATION

SPEED LIMIT  
40 MPH OR LESS  $L = \frac{WS^2}{60}$   
45 MPH OR GREATER  $L = W \times S$   
L = TAPER LENGTH  
W = WIDTH OF OFFSET IN FEET  
S = POSTED SPEED OR OFF-PEAK 85-PERCENTILE SPEED IN MPH

## SIGN FACE DETAILS

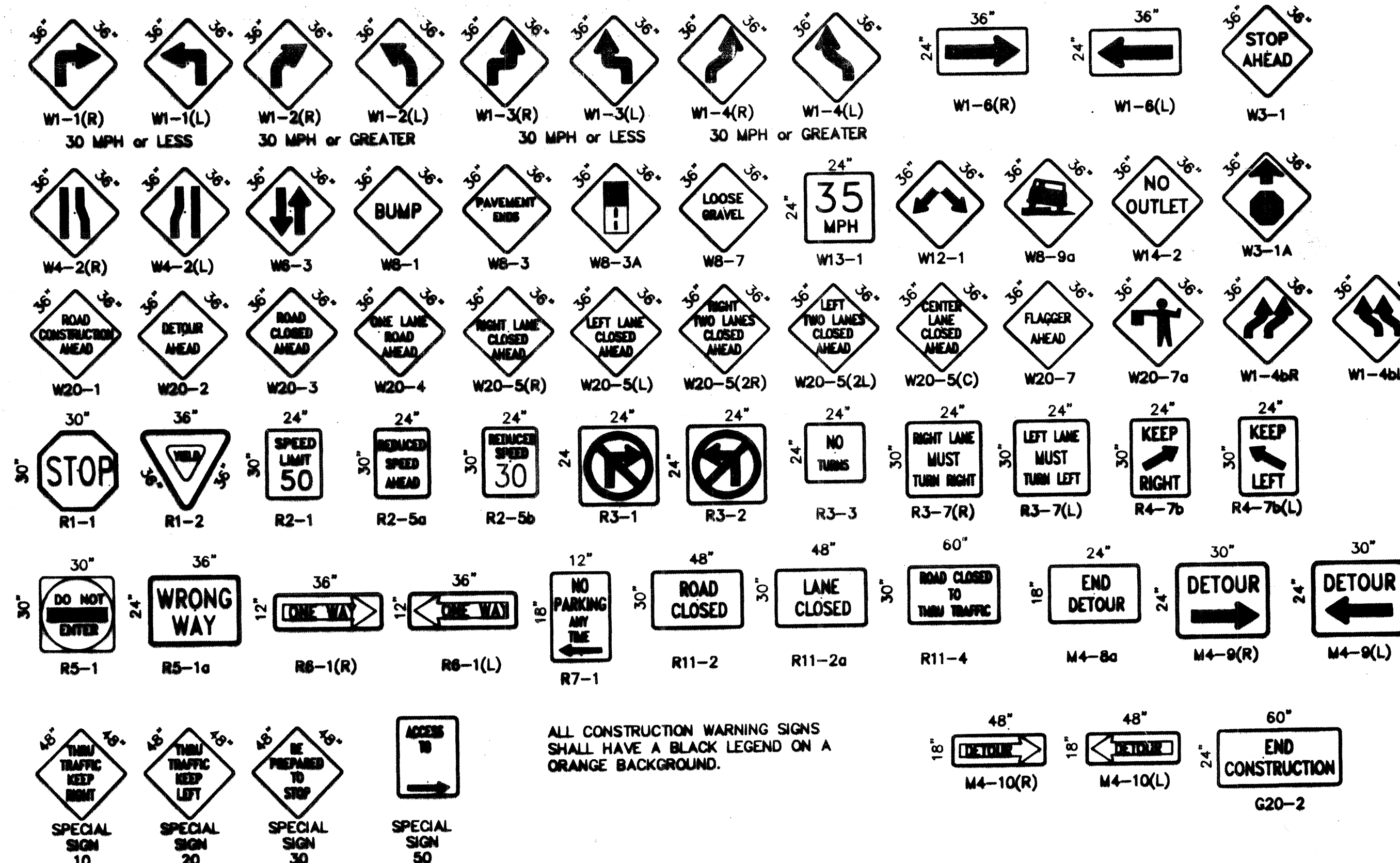

ALL CONSTRUCTION WARNING SIGNS SHALL HAVE A BLACK LEGEND ON A ORANGE BACKGROUND.

CITY OF ALBUQUERQUE PUBLIC WORKS DEPARTMENT ENGINEERING DEVELOPMENT GROUP			
TITLE: <b>SIGNING AND CONSTRUCTION TRAFFIC CONTROL STANDARDS</b>			
DESIGN REVIEW COMMITTEE	CITY ENGINEER APPROVAL	LAST UPDATE	
PROJECT NO. 594781	MAP NO. M-11	SHEET 4 OF 5	



