

LANDSCAPE CONSTRUCTION PLANS
FOR

TRES PLACITAS PARK

CITY PROJECT NO. 616491

CLASS I CONSTRUCTION (NOT FOR BID)

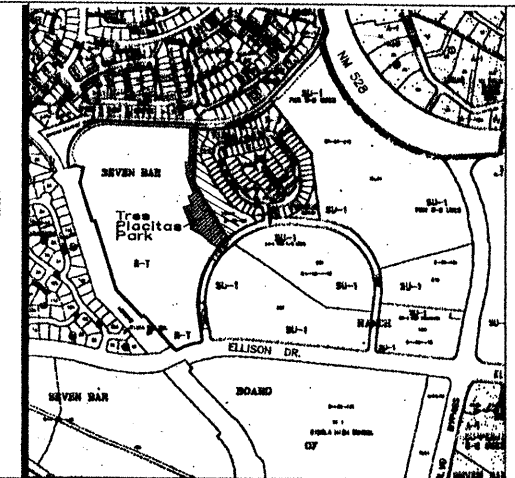

VICINITY MAP ZONE ATLAS A-13

NOTICE TO CONTRACTORS

- ALL WORK DETAILED ON THESE PLANS TO BE PERFORMED UNDER TAB SHALL, EXCEPT AS OTHERWISE STATED OR PROVIDED FOR HEREON, SHALL BE CONSTRUCTED IN ACCORDANCE WITH THE CITY OF ALBUQUERQUE STANDARD SPECIFICATIONS FOR PUBLIC WORKS CONSTRUCTION, LATEST EDITION.
- TWO WORKING DAYS PRIOR TO ANY EXCAVATION, THE CONTRACTOR MUST CONTACT NEW MEXICO ONE CALL SYSTEM (260-1990) FOR LOCATION OF EXISTING UTILITIES.
- PRIOR TO CONSTRUCTION, THE CONTRACTOR SHALL EXCAVATE AND VERIFY THE HORIZONTAL AND VERTICAL LOCATIONS OF ALL OBSTRUCTIONS. SHOULD A CONFLICT EXIST, THE CONTRACTOR SHALL NOTIFY THE ENGINEER OR SURVEYOR IMMEDIATELY SO THAT THE CONFLICT CAN BE RESOLVED WITH A MINIMUM AMOUNT OF DELAY.
- FIVE (5) WORKING DAYS PRIOR TO BEGINNING CONSTRUCTION, THE CONTRACTOR SHALL SUBMIT TO CONSTRUCTION COORDINATION DIVISION A DETAILED CONSTRUCTION SCHEDULE. TWO (2) WORKING DAYS PRIOR TO CONSTRUCTION, THE CONTRACTOR SHALL OBTAIN A BARRICADE PERMIT FROM THE CONST. COORDINATION DIVISION. CONTRACTOR SHALL NOTIFY BARRICADE ENGINEER (768-2551) PRIOR TO OCCUPYING AN INTERSECTION. REFER TO SECTION 19 OF THE GENERAL CONDITIONS OF THE STANDARD SPECIFICATIONS.
- CONTRACTOR SHALL NOTIFY THE ENGINEER NOT LESS THAN SEVEN (7) DAYS PRIOR TO STARTING WORK IN ORDER THAT THE ENGINEER MAY TAKE NECESSARY MEASURES TO INSURE THE PRESERVATION OF SURVEY MONUMENTS. CONTRACTOR SHALL NOT DISTURB PERMANENT SURVEY MONUMENTS WITHOUT THE CONSENT OF THE ENGINEER AND SHALL NOTIFY THE ENGINEER AND BEAR THE EXPENSE OF REPLACING ANY THAT MAY BE DISTURBED WITHOUT PERMISSION. REPLACEMENT SHALL BE DONE ONLY BY THE CITY SURVEYOR. WHEN A CHANGE IS MADE IN THE FINISHED ELEVATIONS OF THE PAVEMENT OF ANY ROADWAY IN WHICH A PERMANENT SURVEY MONUMENT IS LOCATED, CONTRACTOR SHALL, AT HIS OWN EXPENSE, ADJUST THE MONUMENT COVER TO THE NEW GRADE UNLESS OTHERWISE SPECIFIED. REFER TO SECTION 4.4 OF THE GENERAL CONDITIONS OF THE STANDARD SPECIFICATIONS.

THE FOLLOWING NOTES ALSO APPLY WHEN CHECKED

- ☐ ALL UTILITIES AND UTILITY SERVICE LINES SHALL BE INSTALLED PRIOR TO PAVING.
- ☐ BACKFILL COMPACTION SHALL BE ACCORDING TO SPECIFIED STREET USE.
- ☐ TACK COAT REQUIREMENTS SHALL BE DETERMINED BY THE CITY ENGINEER.
- ☒ SIDEWALKS AND WHEELCHAIR RAMPS WITHIN THE CURB RETURNS SHALL BE CONSTRUCTED WHEREVER A NEW CURB RETURN IS CONSTRUCTED.
- ☐ IF CURB IS DEPRESSED FOR A DRIVEPAD, THE DRIVEPAD SHALL BE CONSTRUCTED PRIOR TO ACCEPTANCE OF CURB AND GUTTER.
- ☒ ALL STORM DRAINAGE FACILITIES SHALL BE COMPLETED PRIOR TO FINAL ACCEPTANCE.
- ☒ THE REQUESTOR OR DEVELOPER SHALL BE RESPONSIBLE FOR REPAIR OR REPLACEMENT OF ALL CURB AND GUTTER OR SIDEWALK DAMAGED AFTER APPROVAL BY THE CITY ENGINEER OF WORK COMPLETED BY THE CONTRACTOR.

INDEX TO DRAWINGS

SHEET NUMBER	DESCRIPTION
1.	TITLE SHEET
2.	CONCEPTUAL MASTER PLAN
3.	GRADING PLAN
4.	CONSTRUCTION AND LAYOUT PLAN
5.	CONSTRUCTION AND LAYOUT PLAN (PLAY AREA)
6.	PLANTING PLAN
7.	IRRIGATION PLAN
8.	CITY STANDARD TRAFFIC SPECIFICATIONS
9.	CITY STANDARD TRAFFIC SPECIFICATIONS

NOTES:

Prior to the start of construction, the locations of all existing utility lines shall be marked. Verify locations with the city of Albuquerque and Public Utilities. Prior to construction, contractor shall contact line locating service (260-1990) for locating utilities. Contact Water Line Maintenance (267-8200) for waterline locations within median.

THE HILLTOP
LANDSCAPE ARCHITECTS AND CONTRACTORS
7909 Edith Blvd. N.E.
ALBUQUERQUE, NEW MEXICO 87103
(505)898-9690



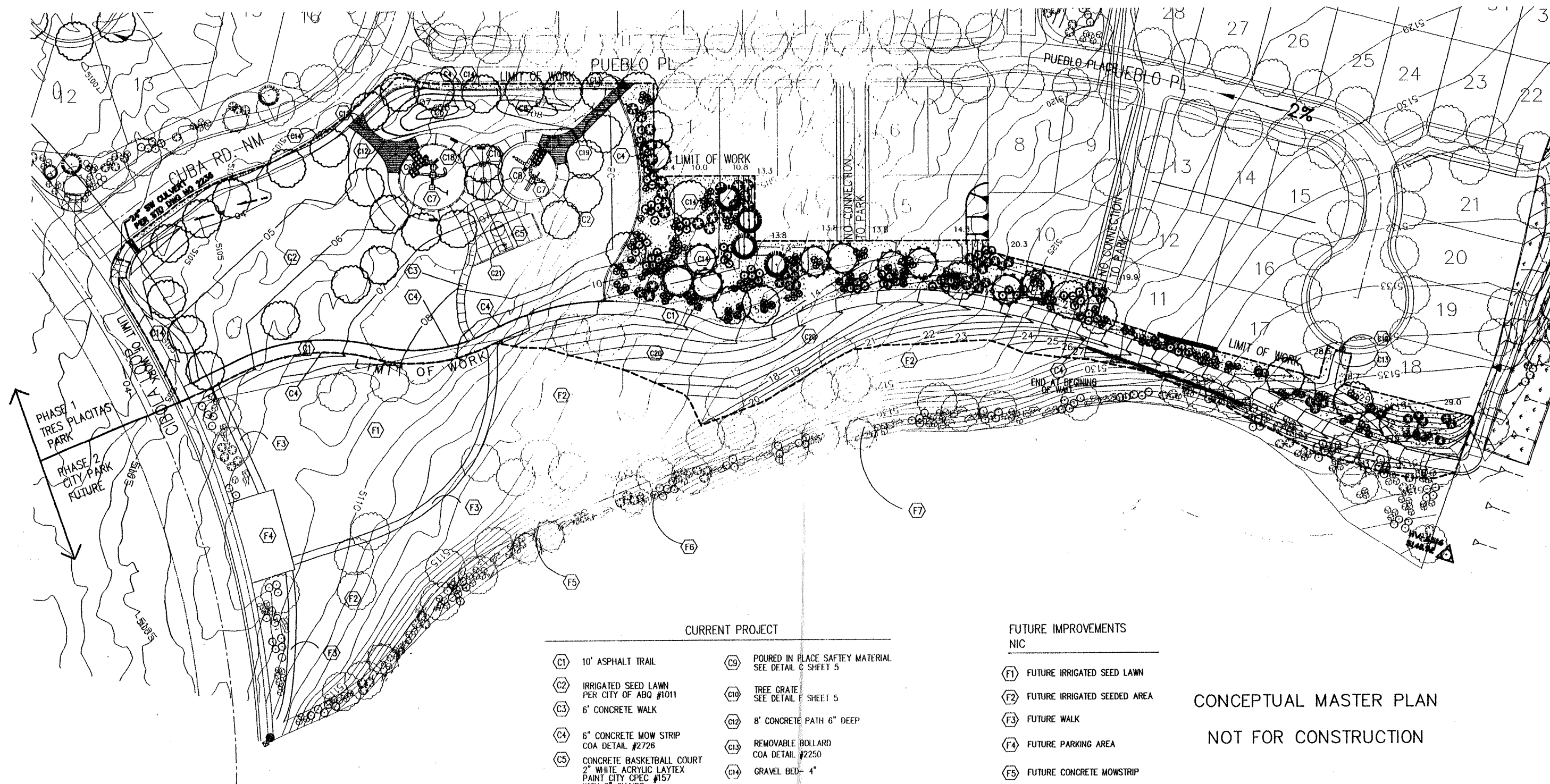



REV	SHEETS	CITY ENGINEER	DATE	USER DEPT.	DATE	USER DEPT.	DATE
ENGINEERS STAMP & SIGNATURE		APPROVALS:		ENGINEER		DATE	
		DRC Chairman		11-19-99		APPROVED FOR CONSTRUCTION	
		Transportation		9-10-99			
		Water/Wastewater		9-10-99			
		Hydrology		9-10-99			
		Parks		9-10-99			
Constr. Mngmt.							
NM UTIL							
CITY PROJECT NO.		616491		SHEET		1 OF 9	

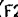

CURRENT PROJECT



- | | | | |
|------|--|-------|---|
| (C1) | 10' ASPHALT TRAIL | (C9) | POURED IN PLACE SAFETY MATERIAL
SEE DETAIL C SHEET 5 |
| (C2) | IRRIGATED SEED LAWN
PER CITY OF ABO #1011 | (C10) | TREE GRATE
SEE DETAIL F SHEET 5 |
| (C3) | 6' CONCRETE WALK | (C12) | 8' CONCRETE PATH 6" DEEP |
| (C4) | 6" CONCRETE MOW STRIP
COA DETAIL #2726 | (C13) | REMOVABLE BOLLARD
COA DETAIL #2250 |
| (C5) | CONCRETE BASKETBALL COURT
2" WHITE ACRYLIC LAYTEX
PAINT CITY SPEC #157
WITH 2" CHAIRS
SEE ENLARGEMENT SHEET 4 OF 9 | (C14) | GRAVEL BED- 4" |
| (C6) | 2'-3" SOD BERM
PER CITY OF ABO #1010 | (C16) | BENCHES
SEE DETAIL A,B SHEET 5 |
| (C7) | SAND PLAY AREA | (C17) | EXPANSION JOINT CITY STD. # 2729 |
| (C8) | 18" SEAT WALL
SEE DETAIL G SHEET 5 | (C18) | TURN DOWN
COA DETAIL #2728 |
| | | (C19) | 18" SIDEWALK CULVERT
COA DETAIL #2236 |
| | | (C20) | CRIMPED STRAW / NATIVE SEED
SCARED AREAS
COA SPEC #1012 |
| | | (C21) | BASKETBALL GOAL
PW ATHLETIC COMPANY
MODEL # 1515 |

FUTURE IMPROVEMENTS
NIC

-  FUTURE IRRIGATED SEED LAWN
-  FUTURE IRRIGATED SEED AREA
-  FUTURE WALK
-  FUTURE PARKING AREA
-  FUTURE CONCRETE MOWSTRIP
-  FUTURE GRAVEL BED AREA
-  FUTURE PLANT MATERIAL

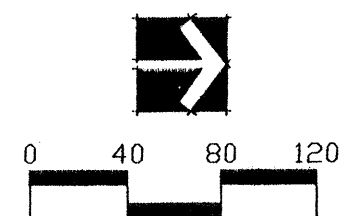
CONCEPTUAL MASTER PLAN
NOT FOR CONSTRUCTION

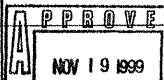

		CITY OF ALBUQUERQUE Parks and Recreation Dept.		DESIGN	DRAWING
APPROVE NOV 19 1999 DESIGN TITLE REVIEW COMMITTEE		TRES PLACITAS PARK CONCEPTUAL MASTER PLAN			
		CITY ENGINEER APPROVAL APPROVE NOV 19 1999 CITY ENGINEER	LAST DESIGN UPDATE	MO./DAY/YR. 	MO./DAY/YR.
CITY PROJECT NO. 616491		ZONE MAP NO. 4-13	SHEET 2 OF 9		

[illegible]

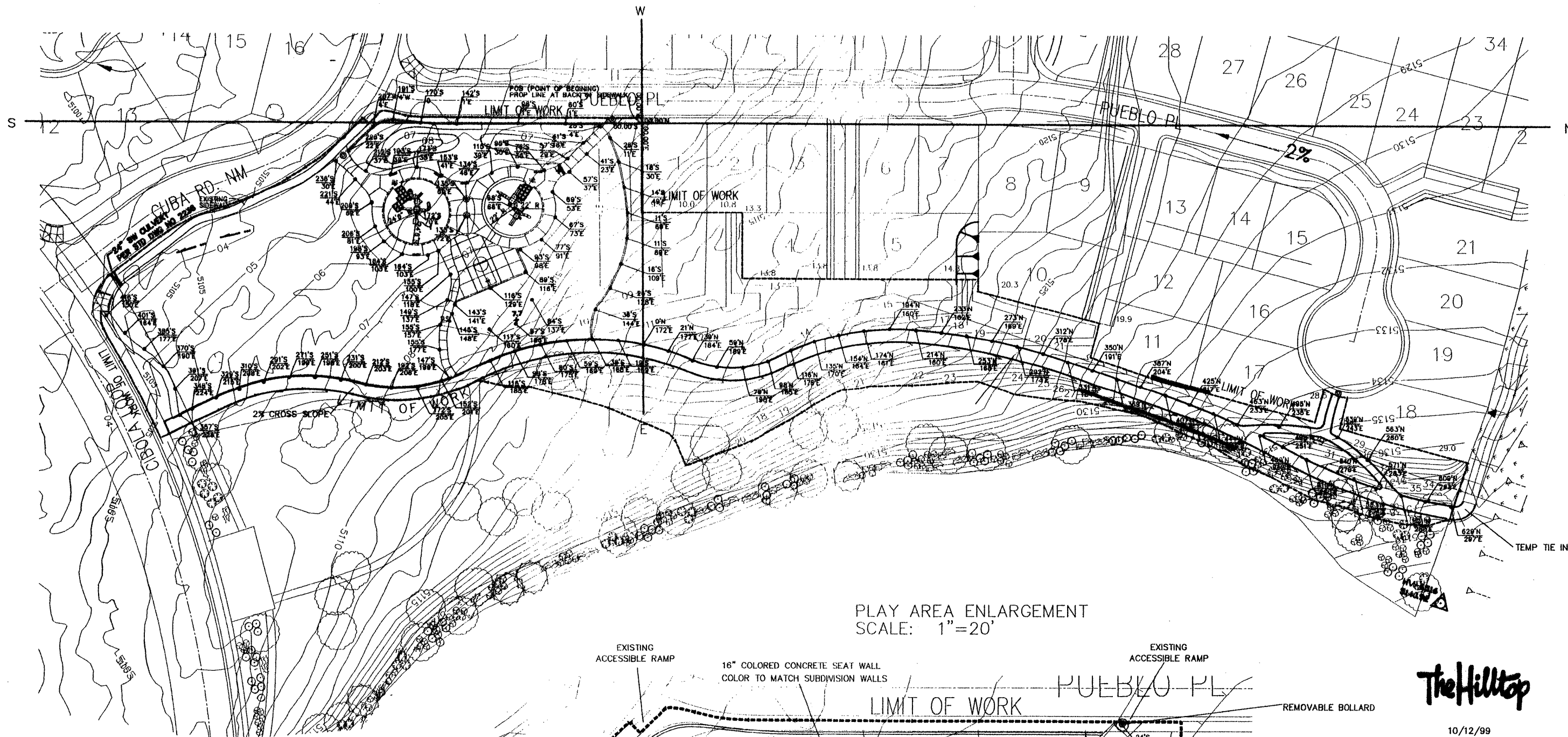

PLAY AREA ENLARGEMENT
SCALE: 1"=20'

Elevation Information:
The surveyor selected to perform the layout work uses a total station system. The electronic data is uploaded from their computer system and is used in the field to set all necessary points.

Note:
ALL WALKS HAVE A 2% CROSS SLOPE

Note:
CONTRACTOR IS RESPONSIBLE FOR OBTAINING AND UTILIZING THE CITY STANDARD SPECIFICATIONS FOR PUBLIC WORK CONSTRUCTION

Note:
SUBSTITUTIONS OR CHANGES TO DRAWINGS DURING CONSTRUCTION MUST BE REVIEWED & APPROVED BY PARKS AND REC. DEPT. CONTACT PERSON DURING CONSTRUCTION: RICK TRUJILLO, 857-8664

Notes:
10' ASPHALT WALK BY FAMILY HOUSING DEVELOPMENT. PER CITY STANDARD DWG 2415

ALL DIMENSIONS SHALL BE READ FROM THE DRAWING. DIMENSIONS SHALL NOT BE SCALED. IN CASE OF DISCREPANCY CONTACT THE LANDSCAPE ARCHITECT AT (505) 898-9690

BOLLARDS
ALL BOLLARDS WILL BE PLACED 1'0" BEHIND CURB. AND OFFSET TO ONE SIDE TO ALLOW FOR CLEAR 36" PEDESTRIAN TRAFFIC CURB. CITY STANDARD DWG. #2250

ASPHALT TRIAL TO BE INSTALLED USING CITY STANDARD DWG 2415

- 1 EXPANSION JOINT AS PER CITY SPEC #
- 2 COLD KEY CONTROL JOINT TYPICAL IN COURT AREA PER CITY OF ABQ #1011 SEE DETAIL H5

COURT NOTE:
COURT SHALL HAVE A 2% CROSS SLOPE

TheHilltop

10/12/99

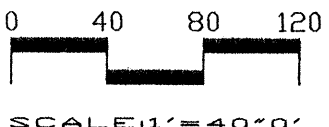

APPROVE NOV 19 1999 DESIGN REVIEW COMMITTEE		CITY OF ALBUQUERQUE Parks and Recreation Dept.	
APPROVE NOV 19 1999 CITY ENGINEER		TRES PLACITAS PARK CONSTRUCTION PLAN	
CITY PROJECT NO. 616491	ZONE MAP NO. A-13	SHEET 4	OF 9

BENCH DETAIL

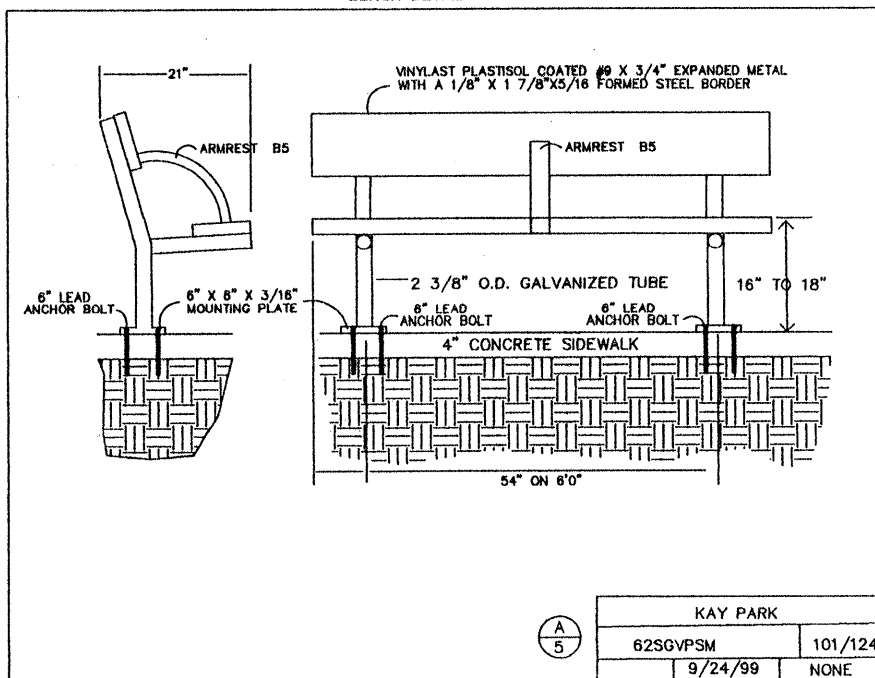

PLAY AREA EQUIPMENT
5-12 YEARS OLD
LANDSCAPE STRUCTURES INC.

PLAY AREA EQUIPMENT
2-5 YEARS OLD
LANDSCAPE STRUCTURES INC.

ARM REST FOR ALL BENCHES

ARM REST TO BE INSTALLED
IN CENTER OF BENCH

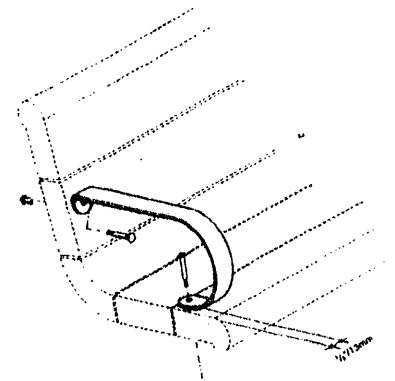

NOTE: Arm Rests Are Sold Individually.

114767 Arm Rest

SAFETY MATERIAL

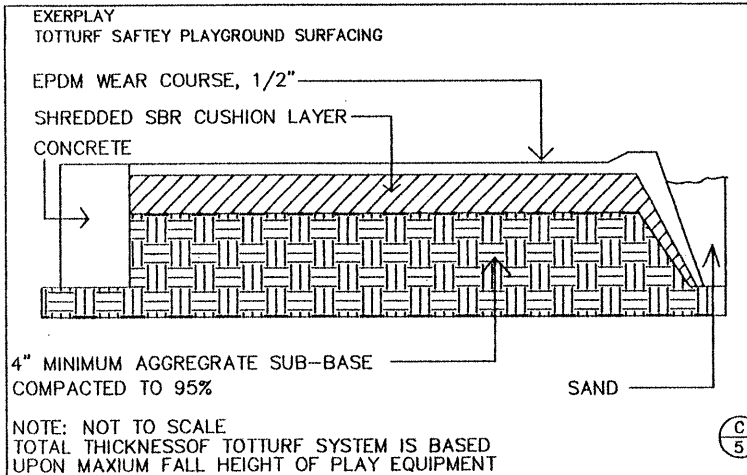

RETAINING WALL
AS PER CITY OF ABQ PROJECT 6069.81

TREE GRATE DETAIL

R-8833 180° ROUND

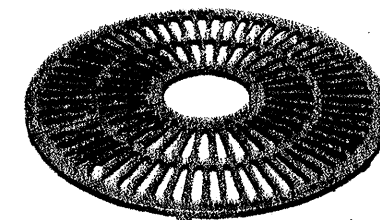

Standard 180° round with two sections per unit. Simple geometric pattern. Non-expandable. Available with fabricated steel angle frame, if required.
Weight per set - 265 pounds.

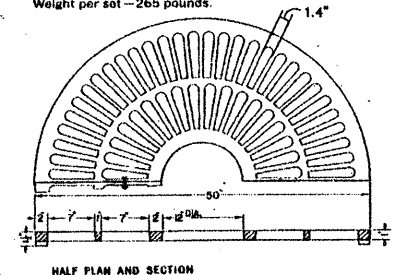

LAYSTRUCTURE COMPONENTS

- POSTS/ARCHES**
- 4 111397C 106" POST
 - 2 111397D 98" POST
 - 1 111397E 90" POST
 - 1 111397F 82" POST
- DECKS**
- 2 121948A KICK PLATE FOR 8" RISE
 - 1 121949A KICK PLATE FOR 8" RISE - TRI DK
 - 2 111237A SQUARE TENDERDECK
 - 1 119977A TRANSITION HANDBAR
 - 2 117495A TRIANGULAR TENDERDECK
- ERMALINE PANELS**
- 1 111300A BALL MAZE PANEL
 - 2 111299A HOUSE PANEL
- LIDES**
- 1 121331A DOUBLE POLY SLIDE 32" DECK
 - 1 111222A TUNNEL SLIDE 40" DECK
- ATTACHMENTS/CONNECTORS**
- 1 123293A COZY CLIMBER W/PERM HANDHOLDS
 - 1 119981A STEP DECK D.B.

Phase 1: Weight & Cost of Playstructure Items
Concrete: 21.10 cu-ft, Footings: 15
Labor: 13.00 Man-Hours

- POSTS/ARCHES**
- 4 111397C 106" POST
 - 2 111397D 98" POST
 - 1 111397E 90" POST
 - 1 111397F 82" POST

- DECKS**
- 1 121948A KICK PLATE FOR 8" RISE
 - 1 121949A KICK PLATE FOR 8" RISE - TRI DK
 - 1 111237A SQUARE TENDERDECK
 - 2 117495A TRIANGULAR TENDERDECK

- ERMALINE PANELS**
- 1 111299A HOUSE PANEL
 - 1 111293A TIC-TAC-TOE PANEL

- LIDES**
- 1 121331B DOUBLE POLY SLIDE 40" DECK
 - 1 111222A RL SLIDE 32" DECK

- ATTACHMENTS/CONNECTORS**
- 1 116664A CHINNING BAR
 - 1 118098B CRAWL TUNNEL "S" W/INCLN
 - 1 111278 STEP LADDER 40" DECK
 - 1 115198D TALK TUBE (NO POST)
 - 1 115198A TALK TUBE (NO POST)
 - 1 111362A TALK TUBE 50" TUBING KXT

Phase 2: Weight & Cost of Playstructure Items
Concrete: 18.55 cu-ft, Footings: 14
Labor: 18.25 Man-Hours

LAYSTRUCTURE COMPONENTS

- POSTS**
- 8 1114040 132" STEEL POST
 - 2 111404P 124" STEEL POST
 - 1 111404Q 116" STEEL POST
 - 3 111404S 100" STEEL POST
 - 1 111404T 92" STEEL POST
 - 4 111403H 182" STEEL POST FOR ROOF
- ROOFS**
- 1 118110A SQUARE POLY ROOF STD LOGO
- DECKS**
- 1 121948A KICK PLATE FOR 8" RISE
 - 1 111228A SQUARE TENDERDECK
 - 1 112471A TRANSFER STEP
 - 1 122197A TRIANGULAR TENDERDECK 90 DEG
- ENCLOSURES**
- 1 120901A CRAB BAR
 - 4 112275A HANDLOOP ASSEMBLY
 - 1 111276A RAIL ASSEMBLY
- ERMALINE PANELS**
- 1 115228A DRIVER (DECK MOUNT)
 - 1 115254A STORE FRONT PANEL
- LIDES**
- 1 111414F SLIDEWINDER 72" DECK
 - 1 123338B WAVE POLY SLIDE 72" DECK
- LIMBERS**
- 1 125688A TRI-DECK LOOP ARCH 40" DECK
 - 1 116249A VERTICAL LADDER 24" DECK
 - 1 122915A WAVE CLIMBER - SINGLE 48"
- OVERHEAD EVENTS**
- 1 111467A 2" 'S' RING BRIDGE RIGHT
 - 1 120872A SWING OUT

Weight & Cost of Playstructure Items
Concrete: 53.50 cu-ft, Footings: 31
Labor: 60.25 Man-Hours

- ATTACHMENTS/CONNECTORS**
- 2 115375A DECK TO DECK STEPS (2 STEPS)
 - 1 120710A DISC CLIMBER 8" D.B.
 - 1 120711A DISC CLIMBER 16" D.B.
 - 1 123393B FIREPOLE W/PERM 48" DECK

Weight & Cost of Playstructure Items
Concrete: 53.50 cu-ft, Footings: 31
Labor: 60.25 Man-Hours

INDEPENDENT COMPONENTS

BASKETBALL COURT DETAIL

- 1 6X6, 10X10 WMM
- 2 4,000 psi concrete
- 3 2" CHAIR
- 4 LEVELING COURSE OF FINE GRADE MATERIAL
- 5 EXISTING SUBGRADE
- 6 EXPANSION JOINT
- 7 (2) #4'S, CONT. IN 4000 psi CONCRETE HEADER

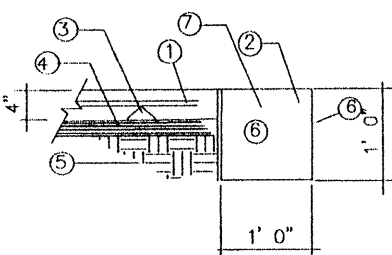

NOTES

- 1. NO SOILS TESTS PROVIDED
- 2. CONTRACTOR SHALL BE RESPONSIBLE FOR SITE PREPARATION INCLUDING EXCAVATION, COMPACTION AND BACKFILL
- 3. REINFORCING BARS SHALL HAVE STANDARD DEFORMATIONS AND A YIELD STRENGTH OF 40,000 PSI
- 4. CONCRETE STRENGTH (f') 2500 PSI @ 30 DAYS
- 5. ALTERNATE VERTICAL REINFORCING BARS MAY BE TERMINATED AT MID-HEIGHT OF RETAINER AS MEASURED FROM LOWER FINISH GRADE.

TRES PLACITAS PARK RETAINING WALL
TRACT B&S SEVEN BAR
ALBUQUERQUE, NM

52-801

LOVATO MASONRY
OCTOBER 11, 1999

52-801

HALL ENGINEERING COMPANY INC.
ENGINEERING - SURVEYING - PLANNING - CONSTRUCTION
1118 2ND ST. NW, ALBUQUERQUE, NEW MEXICO 87102
PHONE (505) 848-7822 FAX (505) 848-7825

SCALE: 1" = 10' 0"

The Hilltop

10/13/99

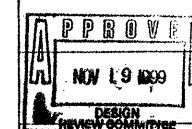

CITY OF ALBUQUERQUE
Parks and Recreation Dept.

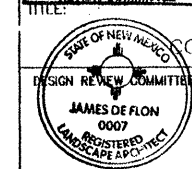

TRES PLACITAS PARK
CONSTRUCTION PLAN - PLAY AREAS

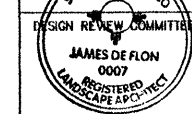

CITY ENGINEER

CITY PROJECT NO. 616491 ZONE MAP NO. A-13 SHEET 5 OF 9

