

ABBREVIATIONS

- A = AIR LINE  
AD = AREA DRAIN  
AIP = ABANDONED IN PLACE  
BLDG = BUILDING  
BM = BENCHMARK  
CATV = CABLE TELEVISION LINE  
CIP = CAST IRON PIPE  
CMP = CORRUGATED METAL PIPE  
CMPA = CORRUGATED METAL PIPE ARCH  
CO = CLEANOUT  
COA = CITY OF ALBUQUERQUE  
CONC = CONCRETE  
CL = CENTERLINE  
DIA = DIAMETER  
DIP = DUCTILE IRON PIPE  
DTL = DETAIL  
DWG = DRAWING  
EG = EXISTING GRADE  
ELEC. = ELECTRIC  
EL = ELEVATION  
EX = EXISTING  
FF = FINISHED FLOOR ELEVATION  
FG = FINISHED GRADE  
FH = FIRE HYDRANT  
FL = FLOW LINE  
G = GAS PIPE  
GM = GAS METER  
GV = GATE VALVE  
HI PT = HIGH POINT  
INV = INVERT ELEVATION  
LF = LINEAL FEET  
LP = LIGHT POLE  
L/S = LANDSCAPING  
MH = MANHOLE  
NG = NATURAL GROUND  
OE = OVERHEAD ELECTRIC LINE  
OT = OVERHEAD TELEPHONE LINE  
PB = ELECTRICAL PULL BOX  
PCC = PORTLAND CEMENT CONCRETE  
PP = POWER POLE  
PROP = PROPOSED  
PVC = POLYVINYL CHLORIDE PIPE  
RCP = REINFORCED CONCRETE PIPE  
R/W = RIGHT-OF-WAY  
S = SLOPE  
SAS = SANITARY SEWER  
SD = STORM DRAIN  
STA = STATION  
STD = STANDARD  
SW = SIDEWALK  
T = TELEPHONE  
TA = TOP OF ASPHALT PAVEMENT  
TAC = TOP OF ASPHALT CURB  
TC = TOP OF CONCRETE SLAB (PAVEMENT)  
TCC = TOP OF CONCRETE CURB  
TS = TOP OF SIDEWALK  
TW = TOP OF WALL  
TYP = TYPICAL  
UE = UNDERGROUND ELECTRIC  
UT = UNDERGROUND TELEPHONE  
W = WATER  
WM = WATER METER  
WV = WATER VALVE

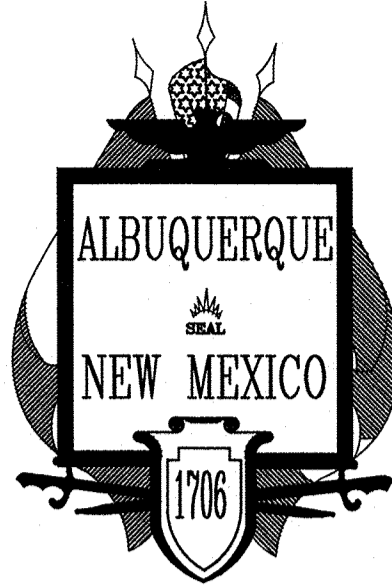

ENGINEERS CERTIFICATION

I, Ron E. Hensley, NMPE 21850, of the firm THE Group, a Registered Professional Engineer in the State of New Mexico, do hereby certify, to the best of my knowledge and belief, that the infrastructure installed as part of this project has been inspected by me or by a qualified person under my direct supervision, and has been constructed in accordance with the plans and specifications approved by the City Engineer and that the original design intent of the approved plans has been met, except as noted by me on the as-built construction drawings. This Certification is based on site inspections by me or personnel under my direction.

Ron E. Hensley, NMPE No. 21850



3/18/21  
Date

CITY OF ALBUQUERQUE, NEW MEXICO

ST. JOSEPH'S ON THE RIO GRANDE  
NAZARETH CENTER  
PAVING IMPROVEMENTS

APPROVED RECORD DRAWINGS

City Inspector	Tim Sims
Contractor	SDV Construction
Construction Engineer	Jim Roeder
Date	4/8/2021

INDEX TO DRAWINGS

SHEET No.	DESCRIPTION
1	COVER SHEET AND INDEX TO DRAWINGS
2-3	PLAT
4-5	GRADING AND DRAINAGE PLAN
6-7	ATRISCO BLVD. - PAVING PLAN AND PROFILE

LEGEND

NEW CURB AND GUTTER & SIDEWALK	EX SAS MANHOLE	8" SAS	PROPOSED SANITARY SEWER LINE
EX CURB AND GUTTER & SIDEWALK	PROP SAS MANHOLE	SAS	EX SANITARY SEWER LINE
PROP FIRE HYDRANT	PROP WATER METER	6" W	PROPOSED WATER LINE
PROP WATER VALVE	PROPOSED SANITARY SEWER SERVICE	8" W	EX WATER LINE
PROPERTY LINE	(S 83°39'25" W) RECORD BEARING AND DISTANCES	N 00°07'27" W	MEASURED BEARING AND DISTANCES

UTILITY COMPANY CONTACTS

ALBUQUERQUE BERNALILLO COUNTY  
WATER UTILITY AUTHORITY  
DAVID GUTIERREZ, PE  
City/County Government Center  
One Civic Plaza NW  
Albuquerque, New Mexico, 87102  
(505) 768-2588

PNM  
Shel Compton  
4201 Edith Blvd. NE  
Mail Stop ES55  
Albuquerque, New Mexico 87107  
(505) 241-514

NEW MEXICO GAS CO.  
Earl Hoskins  
P.O. Box 87500  
Albuquerque, New Mexico 87109  
(505) 241-7759 / 401-7542  
Earl.Hoskins@nmgeo.com

QWEST COMMUNICATIONS  
Don Dovelos  
400 Tijeras Ave. NW, Suite 520  
Albuquerque, New Mexico 87102  
(505) 245-8967

AT&T  
111 Third St., NW  
Albuquerque, NM 87107  
(505) 842-2806

COMCAST CABLE  
Robert Martinez  
4611 Montbel Pl. NE  
Albuquerque, NM 87107  
(505) 761-8221  
Robert.Martinez@cable.comcast.com

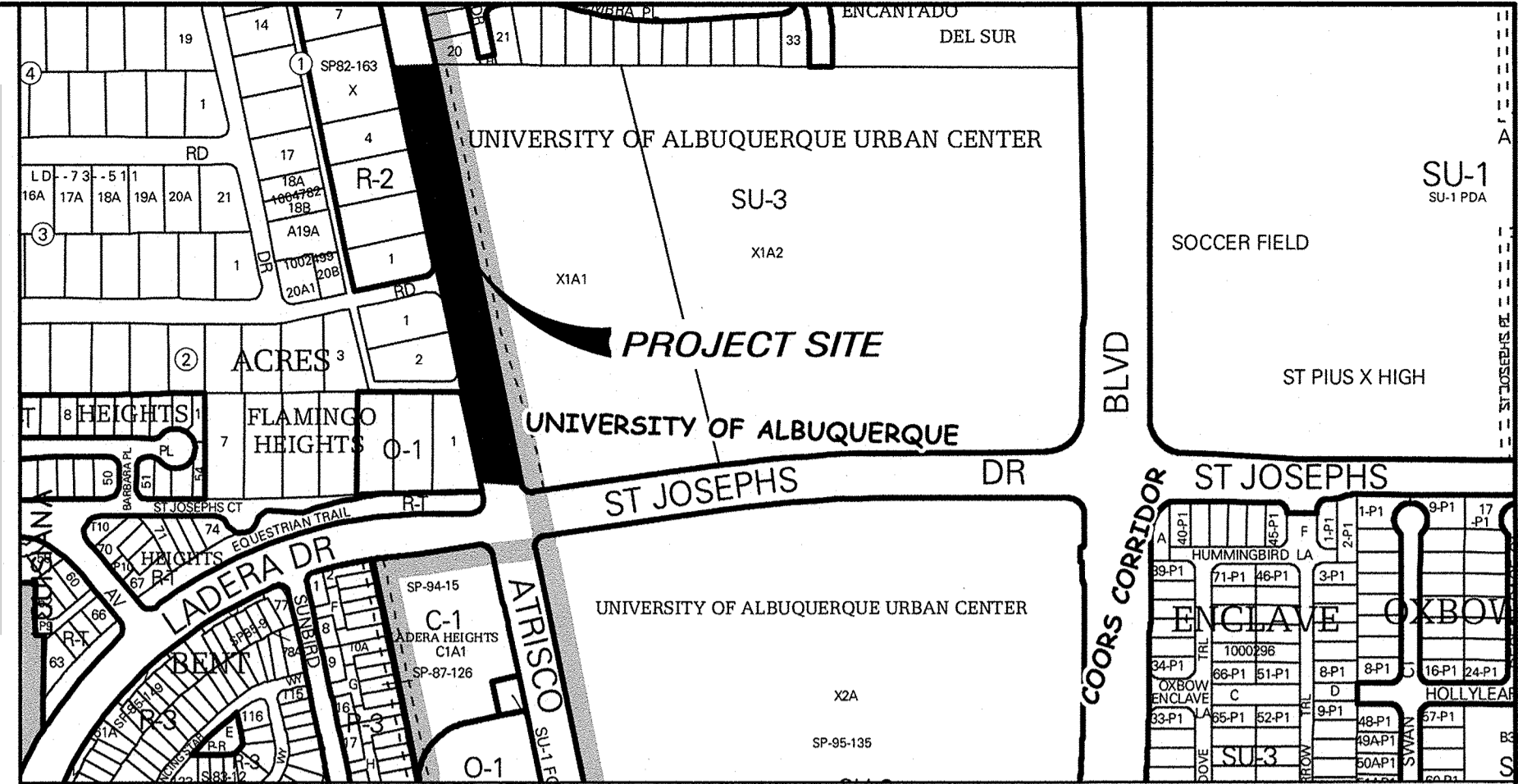

VICINITY MAP  
ZONE ATLAS: G-11  
SCALE: NONE

GENERAL NOTES  
NOTICE TO CONTRACTORS

- ALL WORK DETAILED ON THESE PLANS, EXCEPT AS OTHERWISE STATED OR PROVIDED HEREON, SHALL BE CONSTRUCTED IN ACCORDANCE WITH CITY OF ALBUQUERQUE STANDARD SPECIFICATIONS FOR PUBLIC WORKS CONSTRUCTION, 1986 EDITION THROUGH UPDATE #3, AND WILL BE REFERRED TO HEREIN AS "STANDARD SPECIFICATIONS".
- ALL CONSTRUCTION WITHIN CITY RIGHT-OF-WAY OR EASEMENTS MUST BE DONE FROM APPROVED WORK ORDER DOCUMENTS ISSUED BY THE CITY.
- ALL WORK ON THIS PROJECT SHALL BE PERFORMED IN ACCORDANCE WITH APPLICABLE FEDERAL, STATE, AND LOCAL LAWS, ORDINANCES, RULES, AND REGULATIONS CONCERNING CONSTRUCTION SAFETY AND HEALTH.
- CONTRACTOR SHALL ASSUME THE SOLE AND COMPLETE RESPONSIBILITY FOR THE JOB SITE CONDITIONS DURING THE COURSE OF CONSTRUCTION OF THIS PROJECT, INCLUDING SAFETY OF ALL PERSONS AND PROPERTY. THIS REQUIREMENT SHALL APPLY CONTINUOUSLY AND NOT BE LIMITED TO NORMAL WORKING HOURS. CONTRACTOR SHALL DEFEND, INDEMNIFY, AND HOLD HARMLESS THE OWNER AND ENGINEER FROM ANY AND ALL LIABILITY REAL OR ALLEGED, IN CONNECTION WITH THE PERFORMANCE OF WORK ON THIS PROJECT, EXCEPT LIABILITY ARISING FROM THE SOLE NEGLIGENCE OF THE OWNER OR ENGINEER.
- ALL EXCAVATION, TRENCHING, AND SHORING ACTIVITIES MUST BE ACCOMPLISHED IN ACCORDANCE WITH OSHA 29CFR 1926.650 SUBPART P.
- AN EXCAVATION/CONSTRUCTION PERMIT WILL BE REQUIRED BEFORE BEGINNING ANY WORK WITHIN CITY RIGHT-OF-WAY.
- CONTRACTOR SHALL NOTIFY THE CONSTRUCTION ENGINEER (OR PROJECT MANAGER) NOT LESS THAN SEVEN (7) DAYS PRIOR TO STARTING WORK IN ORDER THAT THE CITY SURVEYOR MAY TAKE NECESSARY MEASURES TO INSURE THE PRESERVATION OF SURVEY MONUMENTS. CONTRACTOR SHALL NOT DISTURB PERMANENT SURVEY MONUMENTS WITHOUT THE CONSENT OF THE CITY SURVEYOR AND SHALL NOTIFY THE CITY SURVEYOR AND BEAR THE EXPENSE OF REPLACING ANY THAT MAY BE DISTURBED WITHOUT PERMISSION. ONLY THE CITY SURVEYOR SHALL REPLACE SURVEY MONUMENTS. WHEN A CHANGE IS MADE IN THE FINISHED ELEVATIONS OF THE PAVEMENT OF ANY ROADWAY IN WHICH A PERMANENT SURVEY MONUMENT IS LOCATED, CONTRACTOR SHALL, AT HIS OWN EXPENSE, ADJUST THE MONUMENT COVER TO THE NEW GRADE UNLESS OTHERWISE SPECIFIED. REFER TO STANDARD SPECIFICATIONS SECTION 4.4.
- TWO (2) WORKING DAYS PRIOR TO ANY EXCAVATION, CONTRACTOR MUST CONTACT NEW MEXICO ONE CALL SYSTEM (280-1990) FOR LOCATION OF EXISTING UTILITIES.
- CONTRACTOR SHALL ASSIST THE ENGINEER/INSPECTOR IN THE RECORDING OF DATA ON ALL UTILITY LINES AND ACCESSORIES AS REQUIRED BY THE CITY OF ALBUQUERQUE FOR THE PREPARATION OF AS-BUILT DRAWINGS. CONTRACTOR SHALL NOT COVER UTILITY LINES AND ACCESSORIES UNTIL ALL DATA HAS BEEN RECORDED.
- CONTRACTOR SHALL ASSUME FINANCIAL RESPONSIBILITY FOR ANY DAMAGE TO EXISTING PAVEMENT, PAVEMENT MARKINGS, SIGNAGE, CURB AND GUTTER, HANDICAP RAMPS, AND SIDEWALK DURING CONSTRUCTION APART FROM THOSE SECTIONS INDICATED FOR REMOVAL ON THE PLANS, AND SHALL REPAIR OR REPLACE, PER THE STANDARD SPECIFICATIONS, ANY SUCH DAMAGE.
- CONTRACTOR SHALL MAINTAIN A GRAFFITI-FREE WORK SITE. CONTRACTOR SHALL PROMPTLY REMOVE ANY AND ALL GRAFFITI FROM EQUIPMENT, WHETHER PERMANENT OR TEMPORARY.
- CONTRACTOR SHALL BE RESPONSIBLE TO PROVIDE AND MAINTAIN ALL CONSTRUCTION SIGNING UNTIL THE PROJECT HAS BEEN ACCEPTED BY THE CITY AND OTHER JURISDICTIONAL AUTHORITIES WHERE APPLICABLE.
- PRIOR TO CONSTRUCTION, THE CONTRACTOR SHALL EXCAVATE AND VERIFY THE HORIZONTAL AND VERTICAL LOCATIONS OF ALL OBSTRUCTIONS AND EXISTING PAVEMENT. SHOULD A CONFLICT EXIST, THE CONTRACTOR SHALL NOTIFY THE ENGINEER OR SURVEYOR SO THAT THE CONFLICT CAN BE RESOLVED WITH A MINIMUM OF DELAY.
- THE CONTRACTOR SHALL PROVIDE AND MAINTAIN ALL CONSTRUCTION SIGNAGE UNTIL THE PROJECT HAS BEEN ACCEPTED BY THE CITY.
- THE CONTRACTOR SHALL COORDINATE WITH THE WATER AUTHORITY SEVEN (7) DAYS IN ADVANCE OF PERFORMING WORK THAT WILL AFFECT THE PUBLIC WATER OR SANITARY SEWER INFRASTRUCTURE. WORK REQUIRING SHUTOFF OF FACILITIES DESIGNATED AS MASTER PLAN FACILITIES MUST BE COORDINATED WITH THE WATER AUTHORITY 14 DAYS IN ADVANCE OF PERFORMING SUCH WORK. ONLY WATER AUTHORITY CREWS ARE AUTHORIZED TO OPERATE PUBLIC VALVES. SHUTOFF REQUESTS MUST BE MADE ONLINE AT [http://dcwma.org/WATER\\_SHUT\\_OFF\\_AND\\_TURN\\_ON\\_PROCEEDURES.ASPX](http://dcwma.org/WATER_SHUT_OFF_AND_TURN_ON_PROCEEDURES.ASPX)
- CONTRACTOR SHALL SECURE A "TOPSOIL DISTURBANCE PERMIT" PRIOR TO BEGINNING CONSTRUCTION.
- THE CONTRACTOR SHALL BE RESPONSIBLE FOR REPAIR, OR REMOVAL AND REPLACEMENT, OF ANY PAVEMENT, PAVEMENT MARKINGS, CURB AND GUTTER, DRIVEPADS, SIDEWALK, WHEELCHAIR RAMP, SIGNAGE OR ANY OTHER EXISTING IMPROVEMENTS DAMAGED BY THE CONTRACTOR'S OPERATIONS.

THE FOLLOWING NOTES ALSO APPLY WHEN CHECKED

- ☒ ALL UTILITIES AND UTILITY SERVICE LINES SHALL BE INSTALLED PRIOR TO PAVING.
- ☒ BACKFILL COMPACTION SHALL BE ACCORDING TO SPECIFIED STREET USE.
- ☐ TACK COAT REQUIREMENTS SHALL BE DETERMINED BY THE ENGINEER.
- ☒ SIDEWALK AND WHEELCHAIR RAMPS WITHIN THE CURB RETURNS SHALL BE CONSTRUCTED WHEREVER A NEW CURB RETURN IS CONSTRUCTED.
- ☐ IF CURB IS DEEPRESSED FOR A DRIVEPAD, THE DRIVEPAD SHALL BE CONSTRUCTED PRIOR TO ACCEPTANCE OF CURB AND GUTTER.
- ☒ ALL STORM DRAINAGE FACILITIES SHALL BE COMPLETED PRIOR TO FINAL ACCEPTANCE.



300 BRANDING IRON RD. SE  
RIO RANCHO, NEW MEXICO 87124  
Phone: (505) 410-1622

REV.	SHEETS	CITY ENGINEER	DATE	USER DEPARTMENT	DATE	USER DEPARTMENT	DATE
ENGINEERS STAMP & SIGNATURE	APPROVALS	ENGINEER	DATE	*****	*****	*****	*****
	DRC CHAIRMAN		8/10/2020	APPROVED FOR CONSTRUCTION			
	TRANSPORTATION		6/10/2020				
	WATER/WASTEWATER	N/A					
	HYDROLOGY		3/9/20				
	AMAFCA						
	CONSTR. MGMT.						
	CONSTR. COORD.						
	CITY PROJECT NO.	622384					
	SHEET	OF					
	1	7					

TRACT X-1-A1  
UNIVERSITY OF ALBUQUERQUE  
URBAN CENTERSITUATE WITHIN  
THE TOWN OF ALBUQUERQUE GRANT  
PROJECTED SECTION 2  
TOWNSHIP 10 NORTH, RANGE 2 EAST  
NEW MEXICO PRINCIPAL MERIDIAN  
CITY OF ALBUQUERQUE  
BERNALILLO COUNTY, NEW MEXICO  
DECEMBER, 2017

## UTILITY DISCLAIMER

SOURCE INFORMATION FROM PLANS AND MARKINGS HAVE BEEN COMBINED WITH OBSERVED EVIDENCE OF UTILITIES TO DEVELOP A VIEW OF THOSE UNDERGROUND UTILITIES. HOWEVER, LACKING EXCAVATION, THE EXACT LOCATION OF UNDERGROUND FEATURES CANNOT BE ACCURATELY, COMPLETELY AND RELIABLY DEPICTED, WHERE ADDITIONAL OR MORE DETAILED INFORMATION IS REQUIRED, THE CLIENT IS ADVISED THAT EXCAVATION MAY BE NECESSARY.

NMB11 LOCATE REQUEST TICKET NUMBER: 17NV210124, CREATION DATE: 11/21/17.

THERE MAY BE PRIVATE UNDERGROUND UTILITY LINES NOT WITHIN DOCUMENTED EASEMENTS THAT WERE NOT MARKED OUT BY UTILITY LINE-SPOTTING COMPANIES NOTIFIED BY NMB11.

THIS PROJECT WAS CALLED IN TO NMB11 AS A "DESIGN LOCATE". SOME UTILITY LINE-SPOTTING COMPANIES NOTIFIED BY NMB11, CONSIDER "DESIGN LOCATE" CALLS AS LOW PROBABILITY AND IN SOME CASES DELAY RESPONSE, PARTIALLY COMPLETE OR NOT RESPOND AT ALL.

THE RETAINING OF A PRIVATE UTILITY LINE-SPOTTING COMPANY MAY BE NECESSARY FOR COMPLETE UTILITY LINE-SPOTTING OF A SUBJECT PROPERTY.

ANY PIPE SIZES OR MATERIAL TYPES SHOWN HEREON WERE DERIVED FROM ASBUILT PLANS AS PROVIDED BY THE VARIOUS UTILITY COMPANIES.

SURV-TEK, INC. MAKES NO REPRESENTATION THAT SAID INFORMATION IS CURRENT OR CORRECT.

ARCHITECT, ENGINEER, AND CONTRACTOR WILL BE RESPONSIBLE FOR VERIFICATION OF SAID INFORMATION DURING THEIR DESIGN PROCESS.

QUALIFIED SUBSURFACE UTILITY ENGINEERING (SUE) SERVICES MAY BE REQUIRED FOR OBTAINING INACCESSIBLE UTILITY DATA AND MUNICIPAL AUTHORIZATION AND PERMITTING FOR TRAFFIC BLOCKING AND BARRICADE PLANS.

UTILITIES LABELED WITH AN ASTERISK (\*) ARE DERIVED AND/OR TRANSCRIBED FROM PROVIDED PLANS AND MUST BE VERIFIED BY THE APPROPRIATE UTILITY.

UTILITIES LABELED WITH A POUND SIGN (#) ARE ASSUMED LOCATIONS OF UNDERGROUND UTILITIES AND MUST BE VERIFIED BY THE APPROPRIATE UTILITY.

## LEGAL DESCRIPTION

Tract X-1-A1, University of Albuquerque Urban Center, as the same is shown and designated on the plat entitled "PLAT OF TRACTS X-1-A1 & X-1-A2, UNIVERSITY OF ALBUQUERQUE URBAN CENTER, ALBUQUERQUE, BERNALILLO COUNTY, NEW MEXICO, FEBRUARY 1998", filed in the office of the County Clerk of Bernalillo County, New Mexico, on March 12, 1998, in Plot Book 98C, Page 68.

## GENERAL NOTES

- Bearings are New Mexico State Plane Grid Bearings (Central Zone - NAD 83).
- Distances are ground.
- Distances along curved lines are arc lengths.
- Record Plat or Deed bearings and distances, where they differ from those established by this field survey, are shown in parentheses ( ).
- All corners found in place and held were tagged with a brass disk stamped "HUGG L.S. 9750 or HUGG L.S. 11808" unless otherwise indicated hereon.
- All corners that were set are either a 5/8" rebar with cap stamped "HUGG L.S. 9750 or HUGG L.S. 11808" or a concrete nail with brass disk stamped "HUGG L.S. 9750 or HUGG L.S. 11808" unless otherwise indicated hereon.
- Vertical Datum is based upon the Albuquerque Control Survey Monument "8-011", Elevation = 5116.009 feet (NAVD 1988).
- Contour interval is one foot.
- Field surveys were performed during the months of November and December, 2017.
- Documents used in the preparation of this survey are as follows:
  - Plat entitled "PLAT OF TRACTS X-1-A1 & X-1-A2, UNIVERSITY OF ALBUQUERQUE URBAN CENTER, ALBUQUERQUE, BERNALILLO COUNTY, NEW MEXICO, FEBRUARY 1998", filed in the office of the County Clerk of Bernalillo County, New Mexico, on March 12, 1998, in Plot Book 98C, Page 68.
- No title report was provided for this property. Any possible easements, conditions or restrictions that may be disclosed by such a report are not shown on this survey.

FOR INFORMATION ONLY

**GND, LLC**  
CONSULTING ENGINEERS11033 Dreamy Way Dr. NW  
Albuquerque, NM 87114  
Phone: (505) 264-0472CITY OF ALBUQUERQUE  
PUBLIC WORKS DEPARTMENT  
ENGINEERING DEVELOPMENT GROUP  
**ST. JOSEPH'S ON THE RIO GRANDE NAZARETH CENTER**DESIGN REVIEW COMMITTEE CITY ENGINEER APPROVAL  
LAST DESIGN UPDATE  
Mo./DAY/YR. Mo./DAY/YR.  
FOR INFORMATION ONLY  
CITY PROJECT No. **622384** ZONE MAP No. **G-11** SHEET **2** OF **7**

## LEGEND

- ③ Storm Drain Manhole
- ③ Sanitary Sewer Manhole
- S/S Sanitary Sewer Line
- SD Storm Drain Line
- SDI Storm Drain Inlet
- P\* Power Pole w/Underground feed
- GUY Wire
- O.U. Overhead Utility
- E.U. Underground Electric line
- C.U. Underground Communications Line
- G.U. Underground Gas Line
- W.U. Underground Water Line
- S.S.C. Sanitary Sewer Clean-out
- W.M. Water Meter
- W.V. Water Valve
- H.M. Hydrant
- E.P. Electric Pedestal
- E.T. Electric Transformer
- U.P. Utility Panel
- T.B. Traffic Box
- T.P. Telephone Pedestal
- O.T.L.P. Overhead Traffic Light Pole
- T.L.P. Traffic Light Post
- U.B. Utility Box
- U.V. Utility Vault
- F. Fence
- L.P. Light Pole
- B. Bollard
- C.S. Concrete Symbol
- R.D. Roof Drain
- G.V. Gas Valve
- G.L.M.P. Gas Line Marker Post
- H.P.S. Handicap Parking Sign
- W.M. Water Manhole
- E.M. Electric Manhole
- C.M. Communications Manhole
- H.S.P. Handicap Parking Space
- A.C. Air Conditioner
- H.B. Hot Box
- R.T.M. Raised Truncated Dome Mat
- C.P. Control Point

## KEYED EASEMENTS

- Bicycle Path, Open Space Trail Link And Landscape Easement granted by plat filed March 12, 1998, in Plot Book 98C, Page 68.
- 10' Utility Easement granted by plat filed November 17, 1987, Volume C35, Page 29.
- 20' City of Albuquerque Permanent Utility Easement, Doc.# 76 15317, Filed: 3/18/78 (Misc.468-165) as shown on plat filed March 12, 1998, in Plot Book 98C, Page 68.
- Centerline Existing Power Line (Agreement Between Fred White & PNM, Letter Dated June 22, 1954) as shown on plat filed March 12, 1998, in Plot Book 98C, Page 68.
- Existing Public Waterline Easement granted to the City of Albuquerque by Document filed May 6, 2000 in Book AS, Page 444 as Document No. 200044618

## KEYED INVERT DATA

- Sanitary Sewer MH\*  
Rim= 5113.26'  
Inv= Inaccessible
- Sanitary Sewer MH  
Rim= 5113.72'  
Inv= 5096.6' (CL)
- Sanitary Sewer MH  
Rim= 5115.15'  
Inv= 5096.6' (CL)
- Storm Drain MH\*  
Rim= 5113.23'  
Inv= Inaccessible
- Storm Drain MH  
Rim= 5113.12'  
Inv= Inaccessible, Underground utility lines obstructing Mt
- Storm Drain MH  
Rim= 5115.07'  
Inv= 5107.1' (S)  
Inv= 5107.1' (E)
- Storm Drain Inlet  
Top of Grate= 5111.65'  
Inv= 5109.45' (NE)
- 30" Storm Drain  
Inv= 5108.1'
- 8" Pipe  
Inv= 5110.8'
- Storm Drain Inlet  
Top of Grate= 5111.77'  
Inv= 5108.9' (S)  
Inv= 5112.5' (N)
- 18" SD  
Inv= 5112.1'  
Unable to determine out
- Storm Drain  
30"x18" Oval RCP  
Inv= 5108.7'

## FLOOD ZONE DETERMINATION

The subject property, as shown hereon, appears to lie within "ZONE X" (areas determined to be outside the 0.2% annual chance floodplain) as shown on National Flood Insurance Program Flood Insurance Rate Map 35001C0114H, Map Revised August 16, 2012.

## GRAPHIC SCALE

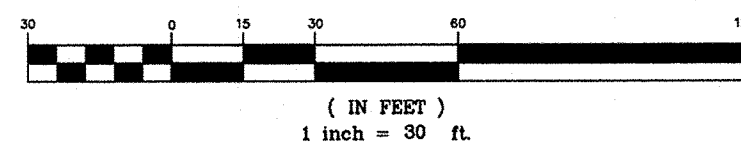

## CURVE TABLE

CURVE	LENGTH	RADIUS	TANGENT	CHORD	CHORD BEARING	DELTA
CT	37.64'	25.00'	23.42'	34.19'	N54°52'07"W	86°16'06"

TOPOGRAPHIC AND BOUNDARY SURVEY OF  
TRACT X-1-A1  
UNIVERSITY OF ALBUQUERQUE  
URBAN CENTER  
SITUATE WITHIN  
THE TOWN OF ALBUQUERQUE GRANT  
PROJECTED SECTION 2  
TOWNSHIP 10 NORTH, RANGE 2 EAST  
NEW MEXICO PRINCIPAL MERIDIAN  
CITY OF ALBUQUERQUE  
BERNALILLO COUNTY, NEW MEXICO  
DECEMBER, 2017

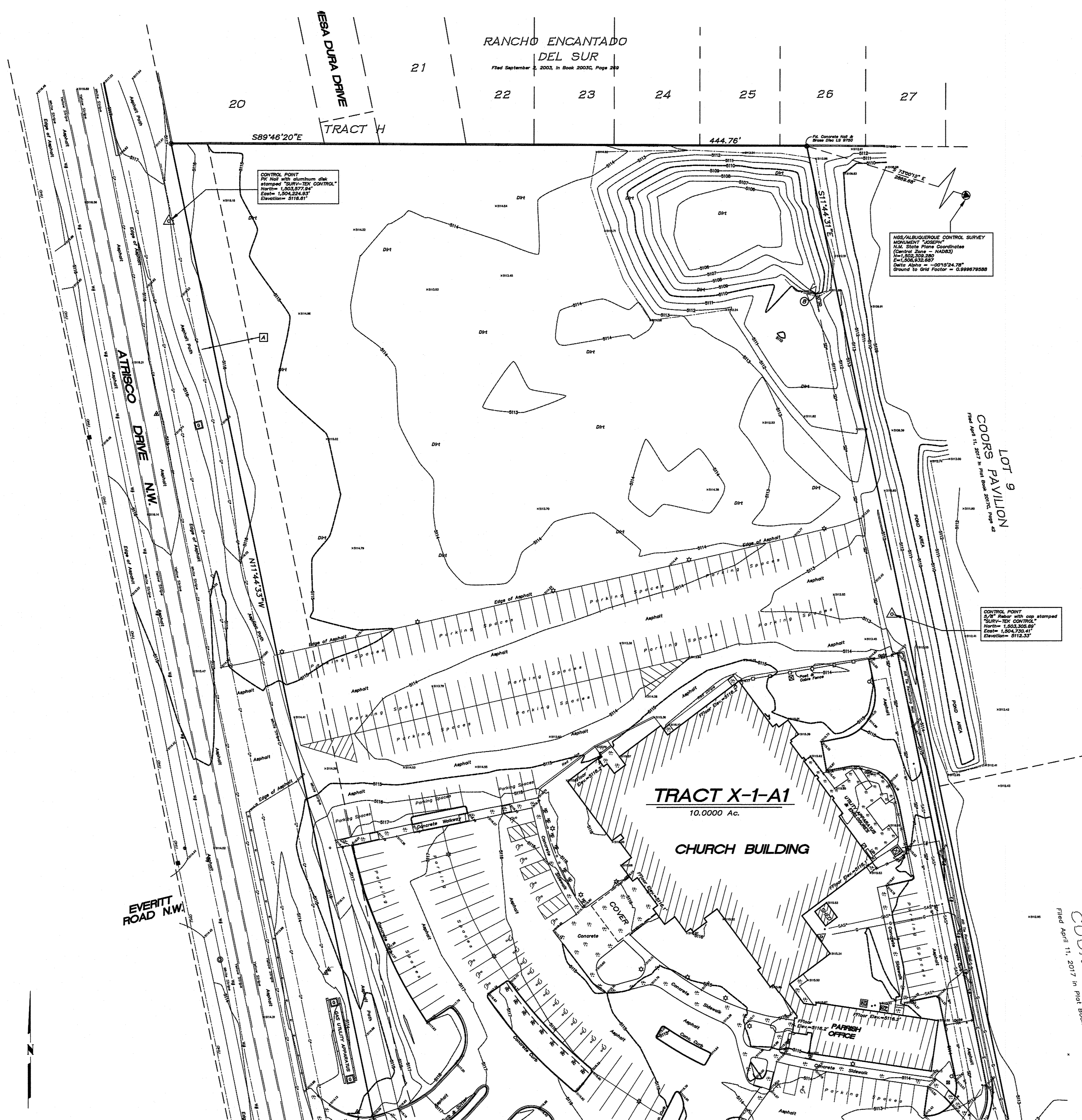

- KEYED EASEMENTS**
- A Bicycle Path, Open Space Trail Link And Landscape Easement granted by plat filed March 12, 1998, in Plat Book 98C, Page 68.
  - 10' Utility Easement granted by plat filed November 17, 1987, Volume C35, Page 29.
  - 20' City Of Albuquerque Permanent Utility Easement, Doc# 76 15317, Filed: 3/18/76 (Mac-163) as shown on plat filed March 12, 1998, in Plat Book 98C, Page 68.
  - Centerline Existing Power Line (Agreement Between Fred White & PNM, Letter Dated June 22, 1954) as shown on plat filed March 12, 1998, in Plat Book 98C, Page 68.
  - Existing Public Waterline Easement granted to the City of Albuquerque by Document filed May 8, 2000 in Book A5, Page 4444 as Document No. 200044618

- KEYED INVERT DATA**
- 1 Sanitary Sewer MH\*  
Rim= 5113.28'  
Inv.= Inaccessible
  - 2 Sanitary Sewer MH  
Rim= 5113.22'  
Inv.= 5096.6' (CL)
  - 3 Sanitary Sewer MH  
Rim= 5115.15'  
Inv.= 5099.6' (CL)
  - 4 Storm Drain MH\*  
Rim= 5113.23'  
Inv.= Inaccessible
  - 5 Storm Drain MH  
Rim= 5113.12'  
Inv.= Inaccessible
  - 6 Storm Drain MH  
Rim= 5115.07'  
Inv.= 5102.1' (S)  
Inv.= 5107.1' (E)
  - 7 Storm Drain Inlet  
Top of Grate= 5111.65'  
Inv.= 5109.45' (NE)
  - 8 30" Storm Drain  
Rim= 5108.1'  
Inv.= 5110.8'
  - 9 8" Pipe  
Rim= 5111.77'  
Inv.= 5108.9' (S)  
Inv.= 5112.5' (N)
  - 10 Storm Drain Inlet  
Top of Grate= 5111.77'  
Inv.= 5108.9' (S)  
Inv.= 5112.5' (N)
  - 11 18" SD  
Rim= 5112.1'  
Inv.= Unable to determine outlet
  - 12 Storm Drain  
30"x18" Oval RCP  
Inv.= 5108.7'

- LEGEND**
- Storm Drain Manhole
  - Sanitary Sewer Manhole
  - Manhole Unknown Utility
  - Sanitary Sewer Line
  - Storm Drain Line
  - Storm Drain Inlet
  - Power Pole
  - Underground feed
  - Guy Wire
  - Overhead Utility
  - Underground Electric line
  - Underground Communications Line
  - Underground Gas Line
  - Underground Water Line
  - Sanitary Sewer Clean-out
  - Water Meter
  - Water Valve
  - Hydrant
  - Cable Pedestal
  - Electric Pedestal
  - Electric Transformer
  - Utility Panel
  - Traffic Box
  - Telephone Pedestal
  - Overhead Traffic Light Pole
  - Traffic Light Post
  - Utility Box
  - Utility Vault
  - Fence
  - Light Pole
  - Ballast
  - Concrete Symbol
  - Roof Drain
  - Gas Meter
  - Gas Valve
  - Gas Line Marker Post
  - Handicap Parking Sign
  - Well
  - Open Manhole
  - Water Manhole
  - Electric Manhole
  - Communications Manhole
  - Handicap Parking Space
  - Air Conditioner
  - Hot Box
  - Raised Truncated Dome Mat
  - Control Point

FOR INFORMATION ONLY  
**GND, LLC**  
CONSULTING ENGINEERS  
11032 Desany Way Dr. NW  
Albuquerque, NM 87114  
Phone: (505) 264-9472

ENGINEER'S SEAL		SURVEY INFORMATION		BENCH MARKS		AS BUILT INFORMATION	
NO.		BY		DATE		CONTRACTOR	

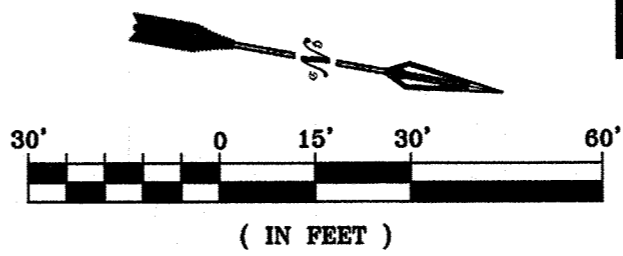

A	Bicycle Path, Open Space Trail Link And Landscape Easement granted by plat filed March 12, 1998, in Plat Book 98C, Page 68.
B	10' Utility Easement granted by plat filed November 17, 1987, Volume C35, Folio 29.
C	20' City of Albuquerque Permanent Utility Easement, Doc. # 76 15317, Filed: 3/18/76 (Misc.488-165) as shown on plat filed March 12, 1998, in Plat Book 98C, Page 68.
D	Existing Public Waterline Easement granted to the City of Albuquerque by Document filed May 8, 2000, in Book A5, Page 4444 as Document No. 200044618

# NOTES

THE ENGINEER HAS UNDERTAKEN LIMITED FIELD VERIFICATION OF THE LOCATION, DEPTH, SIZE, OR TYPE OF EXISTING UNDERGROUND UTILITY LINES, MAKES NO REPRESENTATION PERTAINING THERETO AND ASSUMES NO RESPONSIBILITY OR LIABILITY THEREFORE. THE CONTRACTOR SHALL INFORM THE ENGINEER OF THE LOCATION OF ANY EXISTING UTILITY IN THE AREA OF THE WORK IN ADVANCE OF AND DURING EXCAVATION WORK. THE CONTRACTOR IS FULLY RESPONSIBLE FOR ANY AND ALL DAMAGE CAUSED BY ITS FAILURE TO LOCATE, IDENTIFY, AND PRESERVE ANY AND ALL EXISTING UTILITY LINES. THE CONTRACTOR SHALL COMPLY WITH STATE STATUTES, MUNICIPAL AND LOCAL ORDINANCES, RULES AND REGULATIONS PERTAINING TO THE LOCATION OF THESE LINES AND FACILITIES IN CONNECTION WITH CONDUCTING EXCAVATION, WHETHER BY CALLING OR BY NOTIFYING THE UTILITIES, COMPLYING WITH "BLUE STAKES" PROCEDURES, OR OTHERWISE.

THESE DRAWINGS DO NOT INCLUDE NECESSARY COMPONENTS FOR CONSTRUCTION SAFETY WHICH SHALL REMAIN THE RESPONSIBILITY OF THE CONTRACTOR.

THIS DOCUMENT, AND THE IDEAS AND DESIGNS INCORPORATED HEREIN, ARE INTENDED FOR USE ON THIS PROJECT AND IS NOT TO BE USED, IN WHOLE OR IN PART, FOR ANY OTHER PROJECT WITHOUT THE WRITTEN AUTHORIZATION OF GND ENGINEERING, LLC IN THE EVENT OF ANY FUTURE USE, THE USER ASSUMES ALL RESPONSIBILITY AND LIABILITY WHICH RESULTS.

1. NO WORK SHALL BE PERFORMED IN PUBLIC RIGHT OF WAY WITHOUT AN APPROVED CITY WORK ORDER
2. ALL WORK DETAILED ON THESE PLANS TO BE PERFORMED UNDER THIS CONTRACT SHALL, EXCEPT AS OTHERWISE STATED OR PROVIDED HEREIN, BE CONSTRUCTED IN ACCORDANCE WITH THE CITY OF ALBUQUERQUE STANDARD SPECIFICATIONS FOR PUBLIC WORKS CONSTRUCTION, 1986 EDITION, UPDATE NO. 8.
3. THE EROSION PROTECTION SPECIFIED ON THIS PLAN IS THE MINIMUM RECOMMENDED. THE OWNER IS ENCOURAGED TO INCORPORATE EROSION RESISTANT LANDSCAPING ON AREAS WHERE EROSION MAY OCCUR SUCH AS SLOPES AND SWALES. THE OWNER IS RESPONSIBLE FOR THE INSTALLATION AND MAINTENANCE OF ALL EROSION CONTROL FEATURES NECESSARY TO PRESERVE THE DESIGN INTENT OF THE GRADING PLAN.
4. THE DRAINAGE INFRASTRUCTURE SHOWN ON THIS PLAN IS THE RESPONSIBILITY OF THE PROPERTY OWNER.
5. ALL DISTURBED AREAS OUTSIDE THE BUILDING PAD MUST BE RESEED OR LANDSCAPED
6. TWO (2) WORKING DAYS PRIOR TO ANY EXCAVATION, CONTRACTOR MUST CONTACT LINE LOCATING SERVICE, (260-1990) FOR LOCATION OF EXISTING UTILITIES.
7. PRIOR TO CONSTRUCTION, THE CONTRACTOR SHALL EXCAVATE AND VERIFY THE HORIZONTAL AND VERTICAL LOCATIONS OF ALL OBSTRUCTIONS AND EXISTING PAVEMENT. SHOULD A CONFLICT EXIST, THE CONTRACTOR SHALL NOTIFY THE ENGINEER OR SURVEYOR SO THAT THE CONFLICT CAN BE RESOLVED WITH A MINIMUM OF DELAY.

1. CONTRACTOR IS RESPONSIBLE FOR OBTAINING A TOPSOIL DISTURBANCE PERMIT PRIOR TO BEGINNING WORK.
2. CONTRACTOR IS RESPONSIBLE FOR MAINTAINING RUN-OFF ON SITE DURING CONSTRUCTION.
3. CONTRACTOR IS RESPONSIBLE FOR CLEANING ALL SEDIMENT THAT GETS INTO EXISTING RIGHT-OF-WAY.
4. REPAIR OF DAMAGED FACILITIES AND CLEANUP OF SEDIMENT ACCUMULATIONS ON ADJACENT PROPERTIES AND IN PUBLIC FACILITIES IS THE RESPONSIBILITY OF THE CONTRACTOR.
5. ALL EXPOSED EARTH SURFACES MUST BE PROTECTED FROM WIND AND WATER EROSION PRIOR TO FINAL (CITY) ACCEPTANCE OF ANY PROJECT.

### LEGEND

Legend:

- TOP OF CURB ELEVATION
- BOTTOM OF CURB ELEVATION
- EL=11.28 PROPOSED ELEVATION
- 66.33 EXISTING ELEVATION
- GRADE BREAK
- EXISTING CONTOUR
- EXISTING CONTOUR
- PROPOSED EASEMENT
- 4.00% PROPOSED GRADE
- EXISTING WALL
- PROPOSED WALL

CITY OF ALBUQUERQUE  
PUBLIC WORKS DEPARTMENT  
ENGINEERING DEVELOPMENT GROUP  
**ST. JOSEPH'S ON THE RIO GRANDE NAZARETH CENTER**  
SITE GRADING & DRAINAGE  
CONCEPTUAL GRADING PLAN

DESIGN REVIEW COMMITTEE	CITY ENGINEER APPROVAL	LAST DESIGN UPDATE	Mo./DAY/YR.	Mo./DAY/YR.
FOR INFORMATION ONLY				

AS BUILT INFORMATION	
CONTRACTOR	
STAKED BY	DATE
INSPECTOR'S	DATE
ACCEPTANCE BY	DATE
FIELD	DATE
EXPLANATION BY	DATE
DRAWINGS	DATE
CORRECTED BY	DATE
MICRO-FILM INFORMATION	
RECORDED BY	DATE
NO.	

<b>BENCH MARKS</b>	
C	
S	
E	
N	
L	
G	
F	
A	

[illegible]

ENGINEER'S SEAL  
NOT FOR CONSTRUCTION

RON E. HENSLEY  
NEW MEXICO  
218500  
REGISTERED PROFESSIONAL ENGINEER  
H. J. [Signature]  
JUNE 12, 2018

NO.		DATE	REMARKS	BY
<b>REVISIONS</b>				
<b>DESIGN</b>				
DESIGNED BY		REH	DATE DEC. 2017	
DRAWN BY		REH	DATE DEC. 2017	
CHECKED BY		REH	DATE JUN. 2019	
APPROVED BY		REH	DATE JUN. 2019	

JUNE 12, 2018

DATE DEC. 2017  
DATE MAY 2018

**A** Bicycle Path, Open Space Trail Link And Landscape Easement granted by plat filed March 12, 1998, in Plat Book 98C, Page 68.

GENERAL NOTES:

1. NO WORK SHALL BE PERFORMED IN PUBLIC RIGHT OF WAY WITHOUT AN APPROVED CITY WORK ORDER
2. ALL WORK DETAILED ON THESE PLANS TO BE PERFORMED UNDER THIS CONTRACT SHALL, EXCEPT AS OTHERWISE STATED OR PROVIDED HEREIN, BE CONSTRUCTED IN ACCORDANCE WITH THE CITY OF ALBUQUERQUE STANDARD SPECIFICATIONS FOR PUBLIC WORKS CONSTRUCTION, 1986 EDITION, UPDATE NO. 8.
3. THE EROSION PROTECTION SPECIFIED ON THIS PLAN IS THE MINIMUM RECOMMENDED. THE OWNER IS ENCOURAGED TO INCORPORATE EROSION RESISTANT LANDSCAPING ON AREAS WHERE EROSION MAY OCCUR SUCH AS SLOPES AND SWALES. THE OWNER IS RESPONSIBLE FOR THE INSTALLATION AND MAINTENANCE OF ALL EROSION CONTROL FEATURES NECESSARY TO PRESERVE THE DESIGN INTENT OF THE GRADING PLAN.
4. THE DRAINAGE INFRASTRUCTURE SHOWN ON THIS PLAN IS THE RESPONSIBILITY OF THE PROPERTY OWNER.
5. ALL DISTURBED AREAS OUTSIDE THE BUILDING PAD MUST BE RESEDED OR LANDSCAPED
6. TWO (2) WORKING DAYS PRIOR TO ANY EXCAVATION, CONTRACTOR MUST CONTACT LINE LOCATING SERVICE, (260-1990) FOR LOCATION OF EXISTING UTILITIES.
7. PRIOR TO CONSTRUCTION, THE CONTRACTOR SHALL EXCAVATE AND VERIFY THE HORIZONTAL AND VERTICAL LOCATIONS OF ALL OBSTRUCTIONS AND EXISTING PAVEMENT. SHOULD A CONFLICT EXIST, THE CONTRACTOR SHALL NOTIFY THE ENGINEER OR SURVEYOR SO THAT THE CONFLICT CAN BE RESOLVED WITH A MINIMUM OF DELAY.

[illegible]

**FOR INFORMATION ONLY**

***GND, LLC***  
CONSULTING ENGINEERS

11032 Dreamy Way Dr. NW  
Albuquerque, NM 87114  
Phone: (505)-264-0472

CITY OF ALBUQUERQUE  
PUBLIC WORKS DEPARTMENT  
ENGINEERING DEVELOPMENT GROUP  
**ST. JOSEPH'S ON THE RIO GRANDE NAZARETH CENTER**  
**SITE GRADING & DRAINAGE**  
CONCEPTUAL GRADING PLAN

FOR INFORMATION ONLY

DRB No.	CITY PROJECT No.	ZONE MAP NO. <b>G-11-Z</b>	SHEET <b>2</b>	OF <b>2</b>
---------	------------------	-------------------------------	-------------------	----------------

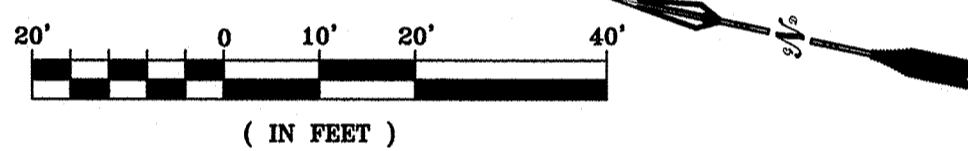
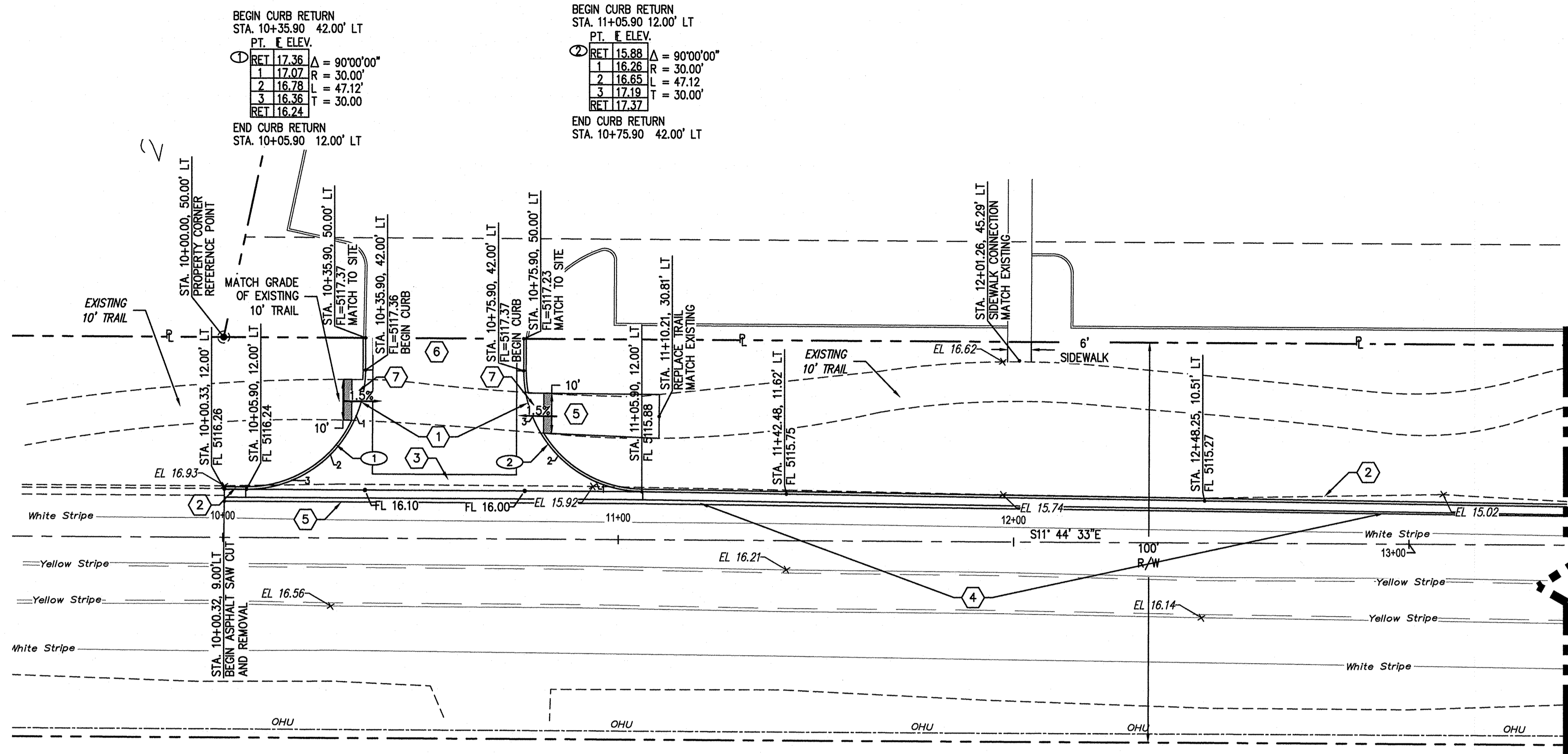

ATRISCO BLVD.

GENERAL NOTES  
NOTICE TO CONTRACTORS

PAVING

- REMOVAL OF EXISTING CURB & GUTTER AND SIDEWALKS SHALL BE TO THE NEAREST JOINT.
- ANY DAMAGE TO THE EXISTING CURB & GUTTER, PAVEMENT, SIDEWALKS, STRIPING, AND SIGNAGE DURING CONSTRUCTION SHALL BE REPLACED AT THE CONTRACTOR'S EXPENSE.
- OVERNIGHT PARKING OF CONSTRUCTION EQUIPMENT SHALL NOT OBSTRUCT DRIVEWAYS OR DESIGNATED TRAFFIC LANES. THE CONTRACTOR SHALL NOT STORE ANY EQUIPMENT OR MATERIAL WITHIN THE PUBLIC RIGHT-OF-WAY.
- CURB AND GUTTER, SIDEWALKS, AND DRIVE PADS SHALL MATCH THE LINE AND GRADE OF ABUTTING EXISTING AREAS AS SHOWN ON THE PLANS OR AS DIRECTED BY THE PROJECT ENGINEER.
- THE SUBGRADE PREP SHALL EXTEND ONE FOOT BEYOND THE FREE EDGE OF NEW CURB AND GUTTER AND SIDEWALK.
- CONTRACTOR TO TEST SUBGRADE R-VALUE PRIOR TO CONSTRUCTION. IN THE EVENT THE R-VALUE IS LESS THAN 50, REMOVE 2 FEET OF SUBGRADE MATERIAL AND IMPORT MATERIAL WITH R-VALUE GREATER THAN 50 OR CONTACT THE ENGINEER IMMEDIATELY SO THE PAVEMENT SECTION CAN BE MODIFIED.
- AT ALL PAVEMENT REMOVAL AND REPLACEMENTS, SAW-CUT EDGES SHALL BE STRAIGHT AND CLEAN, AND LONGITUDINAL JOINTS SHALL NOT BE PLACED WITHIN WHEEL PATHS. PATCHES SHALL BE REGULAR AND SQUARE OR RECTANGULAR, WITH FOUR STRAIGHT SIDES. FINISHED PAVEMENT SURFACE SHALL BE FLUSH WITH EXISTING PAVEMENT SURFACE, WITH NO SPILLOVER OF ASPHALT OR TACK COAT. CARE MUST BE TAKEN TO AVOID DAMAGING THE INTEGRITY OR APPEARANCE OF SURROUNDING PAVEMENTS; IF DAMAGED, THE ENTIRE SURFACE PATCH MUST BE EXPANDED TO COVER DAMAGES.
- CONTRACTOR WILL ENSURE THE ASPHALT HAS A SMOOTH, UNIFORM EDGE WHEN REMOVING AND REPLACING CURB AND GUTTER. IF THE ASPHALT EDGE IS NOT SMOOTH AND UNIFORM, CONTRACTOR WILL SAW CUT AND REPLACE A ONE-FOOT STRIP OF ASPHALT ALONG THE FULL SECTION BEING REPLACED; REFER TO C.O.A. STANDARD DRAWING # 2465 WITH THE APPROPRIATE PAVING SECTION BASED ON ROADWAY CLASSIFICATION.
- BACKFILL COMPACTION SHALL BE ACCORDING TO SPECIFIED STREET USE.
- TACK COAT REQUIREMENTS SHALL BE DETERMINED BY THE ENGINEER.
- UNLESS SPECIFICALLY NOTED, SIDEWALKS AND WHEELCHAIR RAMPS WITHIN THE CURB RETURNS SHALL BE CONSTRUCTED WHEREVER A NEW CURB RETURN IS CONSTRUCTED.
- THE CONTRACTOR SHALL BE RESPONSIBLE FOR REPAIR, OR REMOVAL AND REPLACEMENT, OF ANY PAVEMENT, PAVEMENT MARKINGS, CURB AND GUTTER, DRIVEPADS, SIDEWALK, WHEELCHAIR RAMP, SIGNAGE OR ANY OTHER EXISTING IMPROVEMENTS DAMAGED BY THE CONTRACTOR'S OPERATIONS.

UTILITIES

- ALL UTILITIES AND UTILITY SERVICE LINES SHALL BE INSTALLED PRIOR TO PAVING.
- ALL UTILITIES AND UTILITY SERVICE LINES SHALL BE INSTALLED PRIOR TO PAVING. EXISTING VALVES AND MANHOLES SHALL NOT BE BURIED OR PAVED OVER BUT RIMS SHALL BE ADJUSTED TO MATCH NEW GRADE PER COA STANDARD DRAWINGS 2460 AND 2461.
- ALL SANITARY SEWER LINE STATIONING REFERS TO SANITARY SEWER CENTERLINE STATIONING. EXCEPT WHEN PROFILED WITHIN A PROPOSED OR EXISTING STREET, WHERE STREET STATIONING SHALL GOVERN.
- ALL FINAL BACKFILL FOR TRENCHES SHALL BE COMPACTED TO A MINIMUM OF 95% MAXIMUM DENSITY PER ASTM D-1557 AND AS DIRECTED BY STANDARD SPECIFICATIONS SECTION 701.14.2 AND STANDARD DRAWING NUMBER 2465.
- ALL PUBLIC WATER LINES MUST BE A MINIMUM OF 18" ABOVE SANITARY SEWER LINES AT ALL CROSSINGS.
- ELECTRONIC MARKER SPHERES (EMS) WILL BE PLACED ACCORDING TO SECTION OF THE CITY OF ALBUQUERQUE SPECIFICATIONS FOR PUBLIC WORKS CONSTRUCTION, 1986 EDITION AS REVISED THROUGH UPDATE #9.
- THE CONTRACTOR SHALL INSTALL TRACER WIRE FOR ALL WATER AND SANITARY SEWER LINES.
- CONTRACTOR IS TO INSTALL A 4"x4"x5' POST AND EMS AT THE END OF EACH SANITARY SEWER SERVICE.

PAVING CONSTRUCTION NOTES	
I.D.#	DESCRIPTION
1	BUILD PCC CURB RETURN WITH TRAIL OPENING PER COA STD. DTL. 2426
2	BUILD PCC STANDARD CURB & GUTTER, PER COA STD. DTL. 2415A
3	BUILD PCC VALLEY GUTTER, PER COA STD. DTL. 2420
4	SAW CUT REMOVE AND REPLACE ASPHALT, PER DTL. SHEET 7
5	REPLACE 10' ASPHALT PATH PER SECTION SHEET 7 AND COA STD. DTL. 2415B
6	PLACE ASPHALT PER SECTION SHEET 7
7	PLACE PCC 10' SIDEWALK WITH ADA DETECTIBLE WARNING SURFACE CAST IN PLACE TYPE FULL WIDTH

AS BUILT INFORMATION	
CONTRACTOR	DATE
WORK ORDER BY	DATE
INSPECTOR'S ACCEPTANCE BY	DATE
VERIFICATION BY	DATE
DRAWING DATE	DATE
MICRO-FILM INFORMATION	
RECORDED BY	DATE
NO.	

BENCH MARKS	
THE BENCHMARK IS LOCATED IN THE NORTHWEST AREA OF THE EXISTING PARKING. THE STATION IS A. A PK NAIL W/ ALUMINUM DISK SET IN THE ASPHALT, STAMPED "SURV-TEK CONTROL".	
X=1504434.23 Y=1502824.62 (NAD 83)	
ELEV=5116.61 (NAD 1988)	

SURVEY INFORMATION	
FIELD NOTES	DATE
NO.	BY

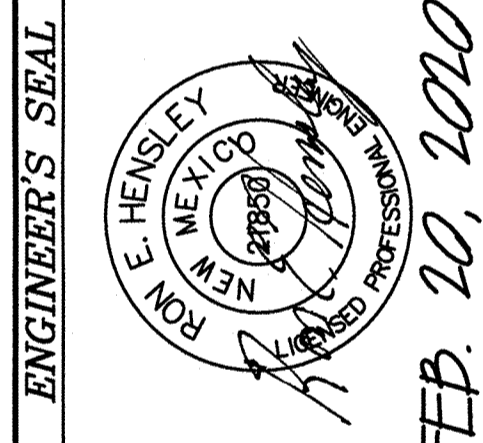

DESIGNED BY	REH	DATE DEC. 2017
DRAWN BY	REH	DATE DEC. 2017
CHECKED BY	REH	DATE FEB. 2020

**GND, LLC**  
CONSULTING ENGINEERS  
11032 Dreamy Way Dr. NW  
Albuquerque, NM 87114  
Phone: (505) 264-0472

CITY OF ALBUQUERQUE PUBLIC WORKS DEPARTMENT ENGINEERING DEVELOPMENT GROUP	
ST. JOSEPH'S ON THE RIO GRANDE NAZARETH CENTER ATRISCO BLVD. PAVING IMPROVEMENTS	
DESIGN REVIEW COMMITTEE	CITY ENGINEER APPROVAL
Mo./DAY/YR.	Mo./DAY/YR.
June 10, 2020	
LAST DESIGN UPDATE	
DRB No.	CITY PROJECT No. 622384
ZONE MAP No. G-11	SHEET 6 OF 7

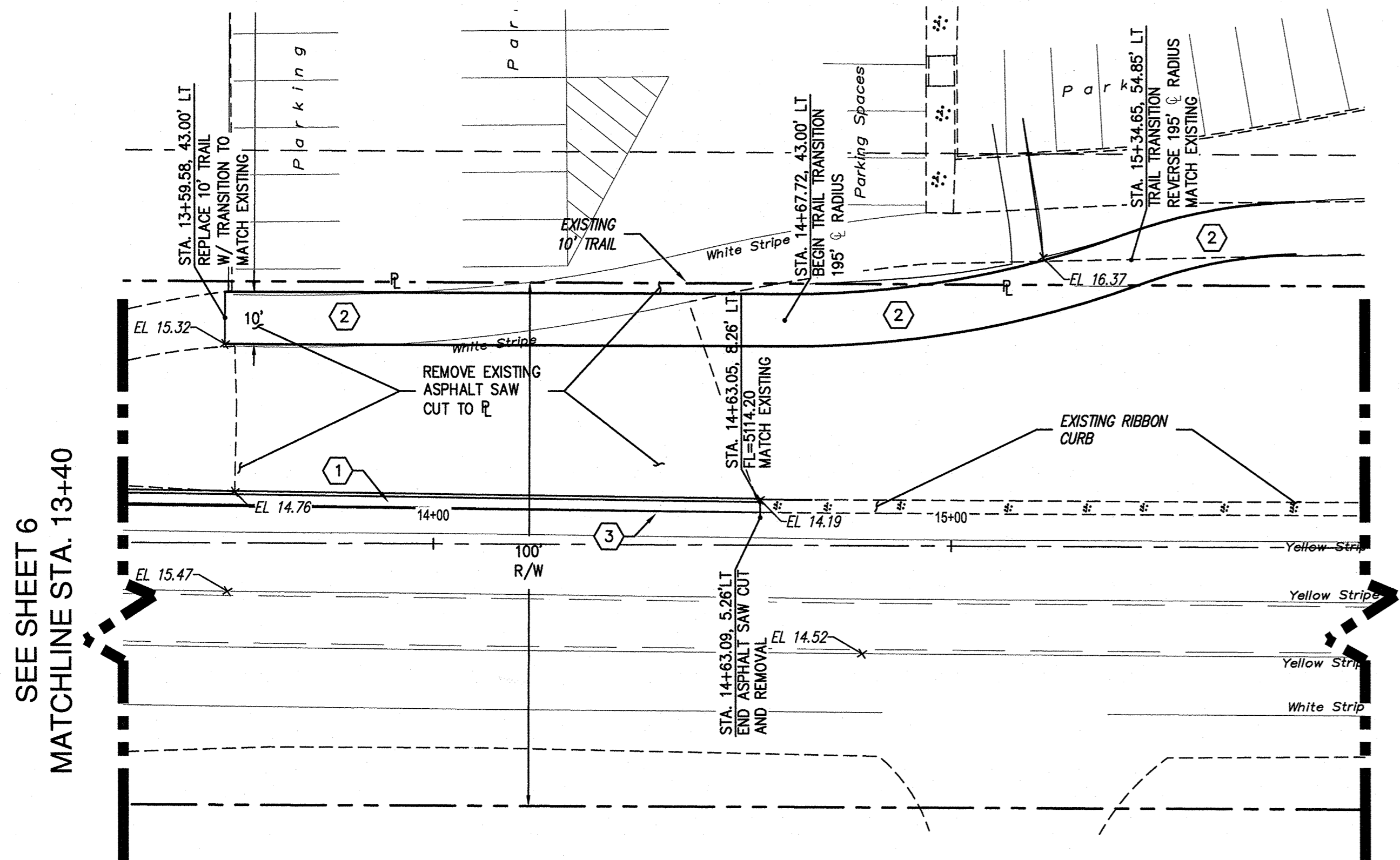

SEE SHEET 6  
MATCHLINE STA. 13+40

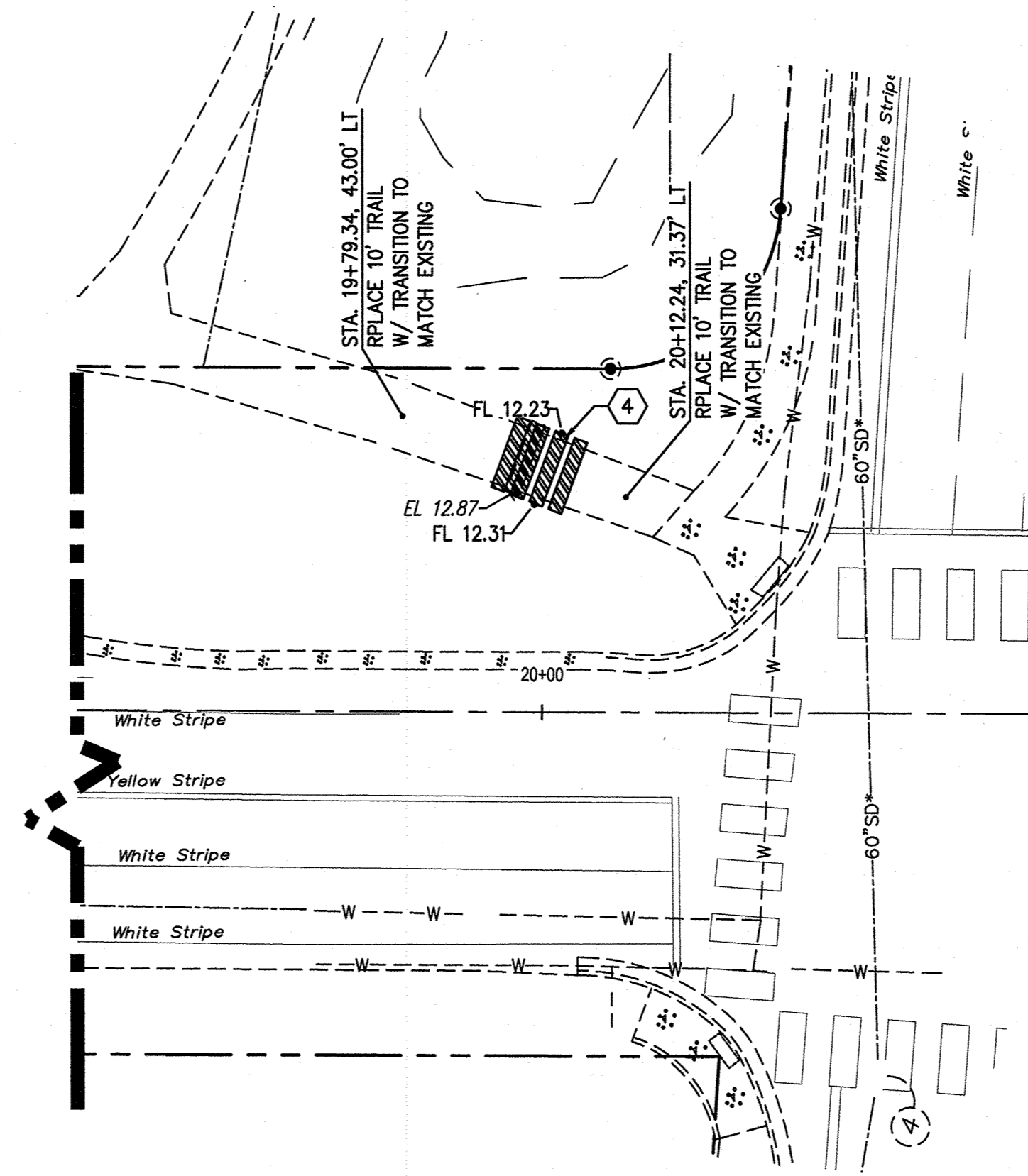

**ATRISCO BLVD.**

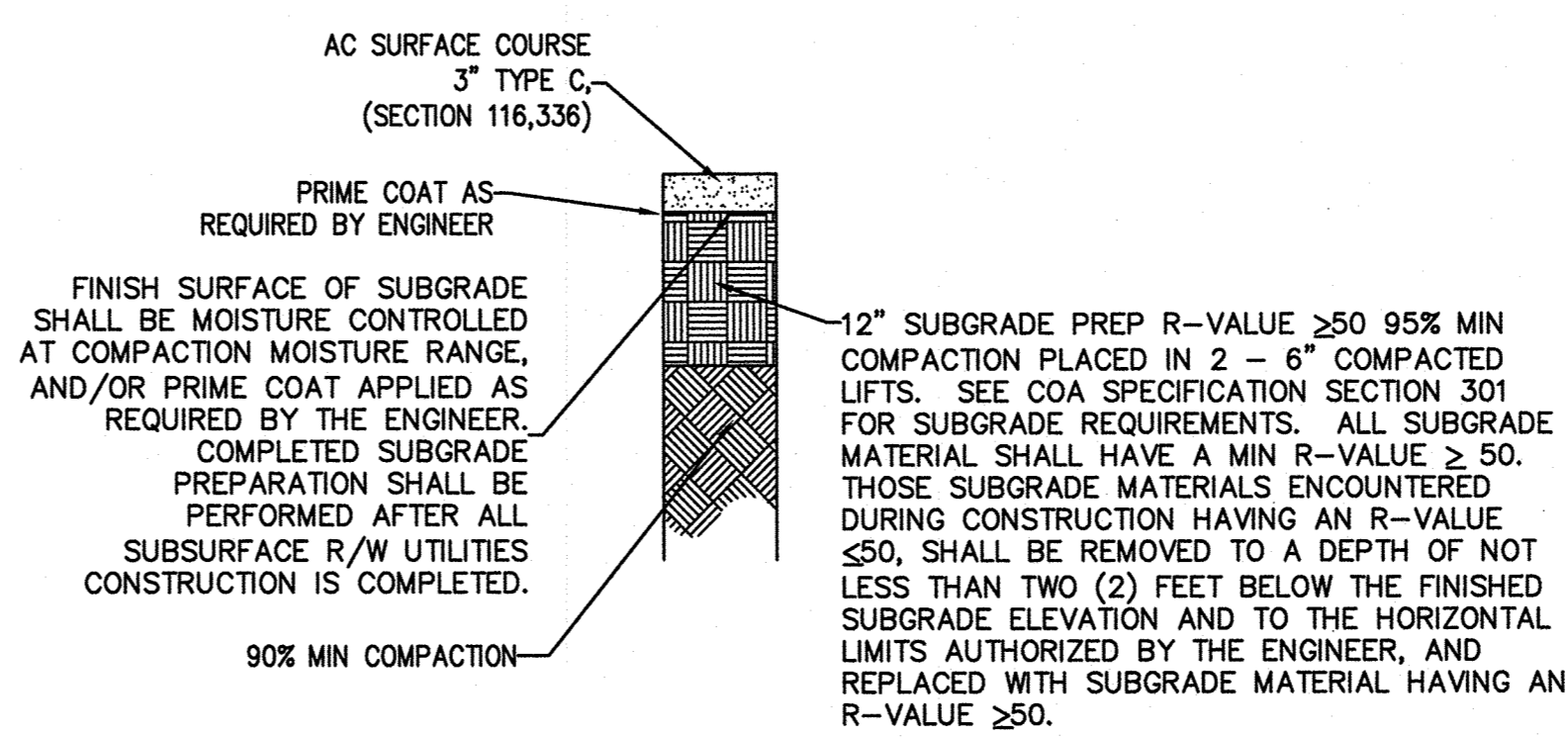
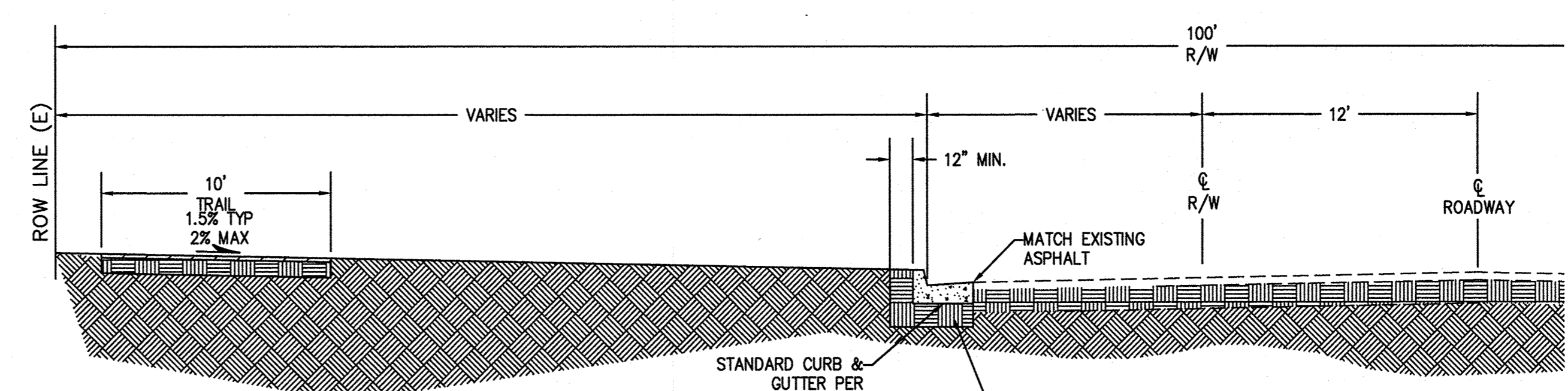
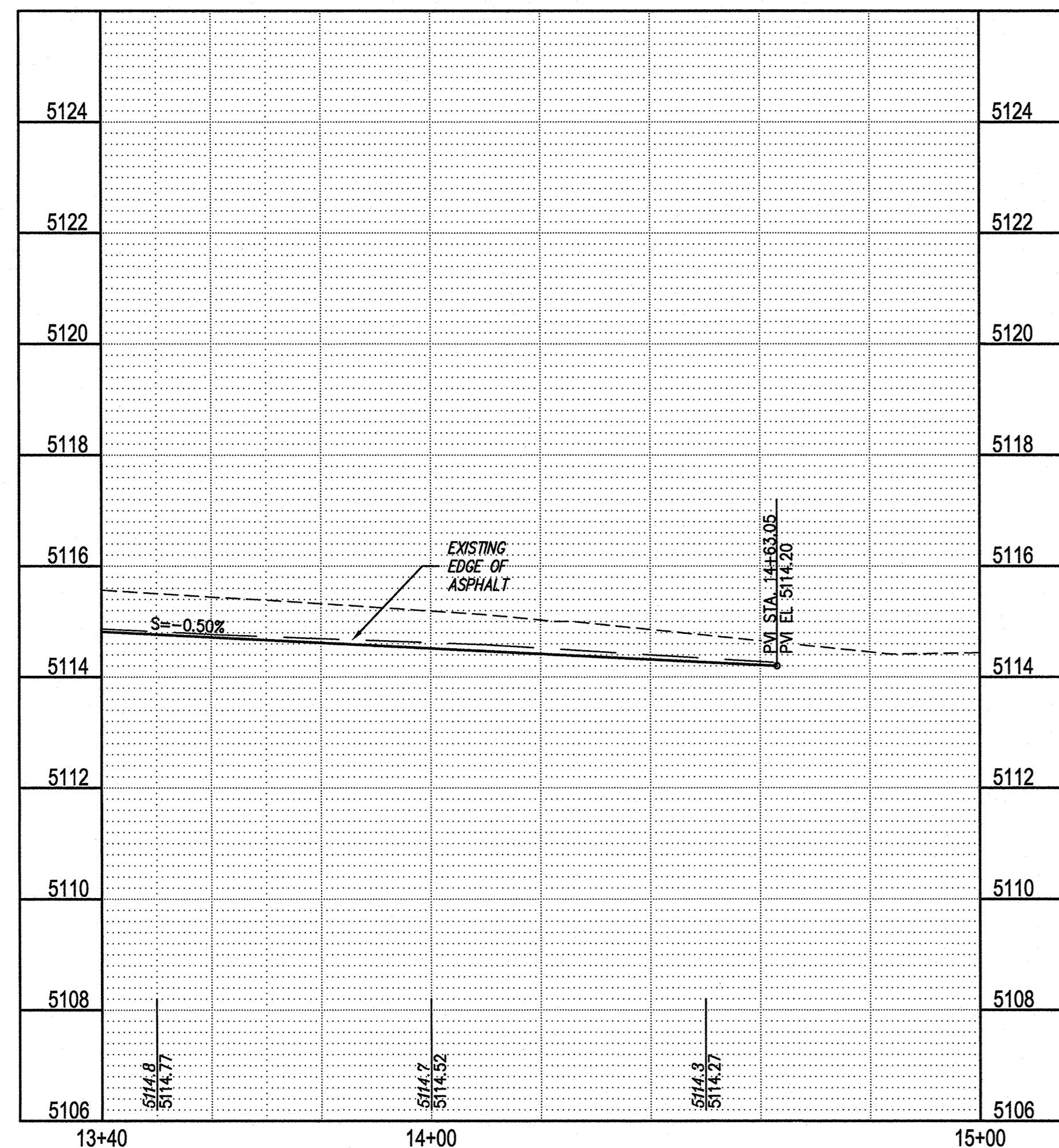

**ASPHALT SECTION**  
PER COA STD DWG 2405A

PAVING CONSTRUCTION NOTES	
I.D.#	DESCRIPTION
1	BUILD PCC STANDARD CURB & GUTTER, PER COA STD. DTL. 2415A
2	REPLACE 10' ASPHALT PATH PER SECTION THIS SHEET AND COA STD. DTL. 2415B
3	SAW CUT REMOVE AND REPLACE ASPHALT, PER DTL. THIS SHEET
4	BUILD 4 - 2' SIDEWALK CULVERTS PER COA STD. DTL. 2236

AS BUILT INFORMATION	
CONTRACTOR	DATE
INSPECTOR'S	DATE
FIELD	DATE
VERIFICATION BY	DATE
CORRECTED BY	DATE
MICRO-FILM INFORMATION	
RECORDED BY	DATE
NO.	

BENCH MARKS	
THE BENCHMARK IS LOCATED IN THE NORTHWEST AREA OF THE EXISTING PARKING. THE STATION IS A . A PK NAIL W/ ALUMINUM DISK SET IN THE ASPHALT, STAMPED "SURV-TEK CONTROL."	
X=1504434.23 Y=1502824.62 (NAD 83)	
ELEV=5116.61 (NAVD 1988)	

ENGINEER'S SEAL	
NO.	DATE
BY	

DESIGNED BY	REH	DATE DEC. 2017
DRAWN BY	REH	DATE DEC. 2017
CHECKED BY	REH	DATE FEB. 2020

CITY OF ALBUQUERQUE PUBLIC WORKS DEPARTMENT ENGINEERING DEVELOPMENT GROUP	
<b>ST. JOSEPH'S ON THE RIO GRANDE NAZARETH CENTER</b>	
<b>ATRISCO BLVD. IMPROVEMENTS</b>	
PAVING AND UTILITY CONNECTIONS	
DESIGN REVIEW COMMITTEE	QTY ENGINEER APPROVAL
Mo./DAY/YR.	Mo./DAY/YR.
LAST DESIGN UPDATE	
June 10, 2023	
CITY PROJECT No.	622384
ZONE MAP NO.	G-11
SHEET	7
OF	7

**GND, LLC**  
CONSULTING ENGINEERS  
11032 Decatur Way Dr. NW  
Albuquerque, NM 87114  
Phone: (505) 264-0472