

OCTOBER 27, 1999  
CONSTRUCTION DOCUMENTS  
CLASS II CONSTRUCTION

LANDSCAPE IMPROVEMENTS  
LOMAS MEDIANS AT EUBANK  
FIRST TWO MEDIANS EAST OF EUBANK BLVD.

INDEX OF DRAWINGS

TITLE	SHEET NO.	SEQUENCE
COVER SHEET	C	1 OF 6
IRRIGATION AND REMOVAL PLAN	L-1	2 OF 6
PLANTING AND PAVING PLAN	L-2	3 OF 6
DETAILS AND NOTES	L-3	4 OF 6
SIGNING AND CONSTRUCTION TRAFFIC CONTROL STANDARDS	T1	5 OF 6
TYPICAL TRAFFIC CONTROL AND SIGNING EXAMPLES (REF. M.U.T.C.D.)	T2	6 OF 6

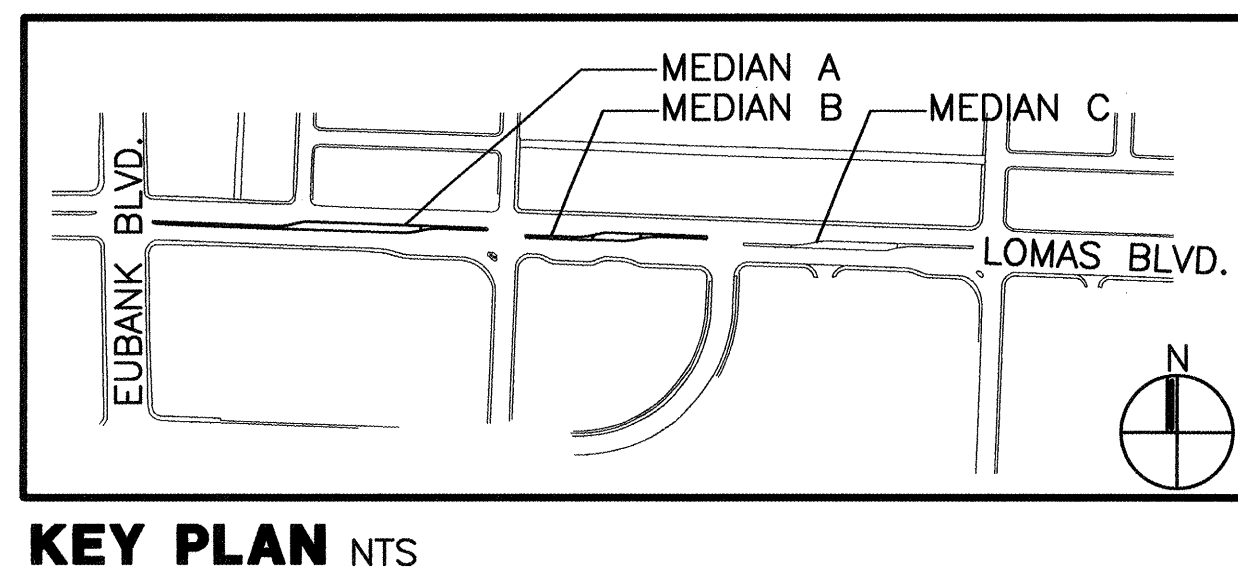

KEY PLAN NTS

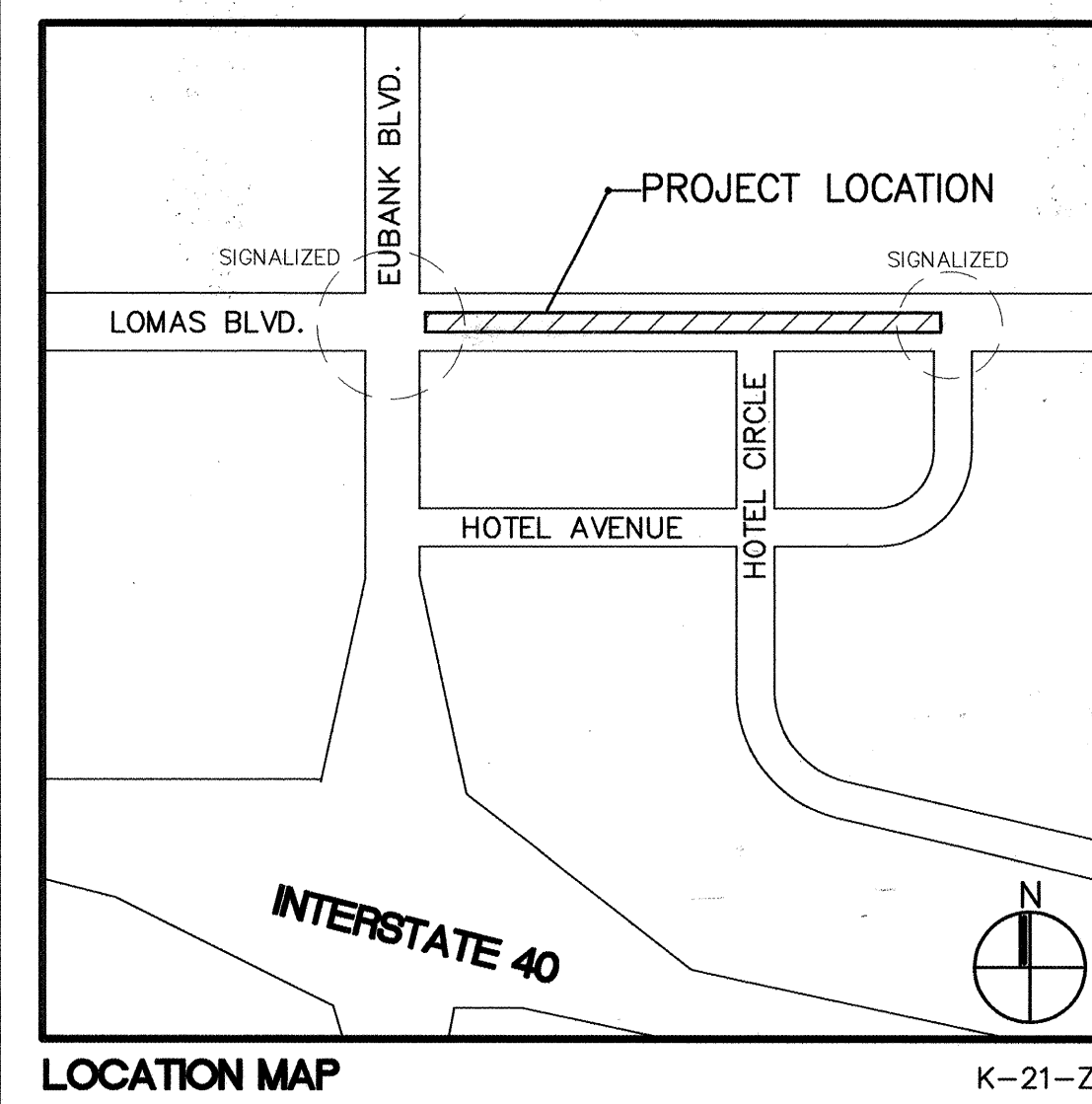

- GENERAL NOTES**
1. AN EXCAVATION/CONSTRUCTION PERMIT WILL BE REQUIRED BEFORE BEGINNING ANY WORK WITHIN CITY RIGHT-OF-WAY.
  2. ALL WORK DETAILED ON THESE PLANS TO BE PERFORMED UNDER CONTRACT SHALL, EXCEPT AS OTHERWISE STATED OR PROVIDED, FOR HEREON, BE CONSTRUCTED IN ACCORDANCE WITH THE CITY OF ALBUQUERQUE STANDARD SPECIFICATIONS FOR PUBLIC WORKS CONSTRUCTION, 1986 ED. AND SHALL INCLUDE UPDATE NO.6
  3. TWO WORKING DAYS PRIOR TO ANY EXCAVATION, THE CONTRACTOR MUST CONTACT NEW MEXICO ONE CALL SYSTEM (260-1990) FOR LOCATION OF EXISTING UTILITIES.
  4. PRIOR TO CONSTRUCTION, THE CONTRACTOR SHALL EXCAVATE AND VERIFY THE HORIZONTAL AND VERTICAL LOCATIONS OF ALL OBSTRUCTIONS. SHOULD A CONFLICT EXIST, THE CONTRACTOR SHALL NOTIFY THE ENGINEER OR SURVEYOR IMMEDIATELY SO THAT THE CONFLICT CAN BE RESOLVED WITH A MINIMUM AMOUNT OF DELAY.
  5. FIVE (5) WORKING DAYS PRIOR TO BEGINNING CONSTRUCTION, THE CONTRACTOR SHALL SUBMIT TO CONSTRUCTION COORDINATION DIVISION A DETAILED CONSTRUCTION SCHEDULE. TWO (2) WORKING DAYS PRIOR TO CONSTRUCTION, THE CONTRACTOR SHALL OBTAIN A BARRICADING PERMIT FROM THE CONST. COORDINATION DIVISION. CONTRACTOR SHALL NOTIFY BARRICADE ENGINEER (768-2551) PRIOR TO OCCUPYING AN INTERSECTION. REFER TO SECTION 19 OF THE GENERAL CONDITIONS OF THE STANDARD SPECIFICATIONS.
  6. ALL STREET STRIPING ALTERED OR DESTROYED SHALL BE REPLACED WITH PLASTIC REFLECTORIZED PAVEMENT MARKING BY CONTRACTOR TO LOCATION AS EXISTING OR AS INDICATED BY THIS PLAN SET.
  7. CONTRACTOR SHALL COORDINATE WITH WATER SYSTEMS DIVISION (857-8200) FIVE WORKING DAYS IN ADVANCE OF ANY WORK THAT MAY AFFECT EXISTING PUBLIC WATER OR SEWER UTILITIES. EXISTING VALVES TO BE OPERATED BY CITY PERSONNEL ONLY. CONTRACTOR SHALL CONTACT THE WATER SYSTEMS DIVISION THREE DAYS PRIOR TO NEEDING VALVES TURNED ON OR OFF.
  8. CONTRACTOR SHALL RECORD DATA ON ALL UTILITY LINES AND ACCESSORIES AS REQUIRED BY THE CITY OF ALBUQUERQUE FOR THE PREPARATION OF "AS CONSTRUCTED" DRAWINGS. CONTRACTOR SHALL NOT COVER UTILITY LINES AND ACCESSORIES UNTIL ALL DATA HAS BEEN RECORDED.
  9. CONTRACTOR SHALL NOTIFY THE ENGINEER NOT LESS THAN SEVEN (7) DAYS PRIOR TO STARTING WORK, IN ORDER THAT THE ENGINEER MAY TAKE NECESSARY MEASURES TO INSURE THE PRESERVATION OF SURVEY MONUMENTS. CONTRACTOR SHALL NOT DISTURB PERMANENT SURVEY MONUMENTS WITHOUT THE CONSENT OF THE ENGINEER AND SHALL NOTIFY THE ENGINEER AND BEAR THE EXPENSE OF REPLACING ANY THAT MAY BE DISTURBED WITHOUT PERMISSION. REPLACEMENT SHALL BE DONE ONLY BY THE CITY OF ALBUQUERQUE SURVEY SECTION. WHEN A CHANGE IS MADE IN THE FINISH ELEVATION OF THE PAVEMENT OF ANY ROADWAY IN WHICH A PERMANENT SURVEY MONUMENT IS LOCATED, CONTRACTOR SHALL, AT HIS OWN EXPENSE, ADJUST THE MONUMENT COVER TO NEW GRADE, UNLESS OTHERWISE SPECIFIED.

FOR INFORMATION ONLY

**DESIGNWORKSHOP**  
901 Rio Grande NW  
Suite E130  
Albuquerque, NM  
87104  
(Tel.) 505.243.8333  
(Fax) 505.243.8337

SET NUMBER: \_\_\_\_\_

--	--	--	--	--	--	--	--	--	--	--	--	--	--	--	--	--	--	--	--	--	--	--	--	--	--	--	--	--	--	--	--	--	--	--	--	--	--	--	--	--	--	--	--	--	--	--	--	--	--	--	--	--	--	--	--	--	--	--	--	--	--	--	--	--	--	--	--	--	--	--	--	--	--	--	--	--	--	--	--	--	--	--	--	--	--	--	--	--	--	--	--	--	--	--	--	--	--	--	--	--	--	--	--	--	--	--	--	--	--	--	--	--	--	--	--	--	--	--	--	--	--	--	--	--	--	--	--	--	--	--	--	--	--	--	--	--	--	--	--	--	--	--	--	--	--	--	--	--	--	--	--	--	--	--	--	--	--	--	--	--	--	--	--	--	--	--	--	--	--	--	--	--	--	--	--	--	--	--	--	--	--	--	--	--	--	--	--	--	--	--	--	--	--	--	--	--	--	--	--	--	--	--	--	--	--	--	--	--	--	--	--	--	--	--	--	--	--	--	--	--	--	--	--	--	--	--	--	--	--	--	--	--	--	--	--	--	--	--	--	--	--	--	--	--	--	--	--	--	--	--	--	--	--	--	--	--	--	--	--	--	--	--	--	--	--	--	--	--	--	--	--	--	--	--	--	--	--	--	--	--	--	--	--	--	--	--	--	--	--	--	--	--	--	--	--	--	--	--	--	--	--	--	--	--	--	--	--	--	--	--	--	--	--	--	--	--	--	--	--	--	--	--	--	--	--	--	--	--	--	--	--	--	--	--	--	--	--	--	--	--	--	--	--	--	--	--	--	--	--	--	--	--	--	--	--	--	--	--	--	--	--	--	--	--	--	--	--	--	--	--	--	--	--	--	--	--	--	--	--	--	--	--	--	--	--	--	--	--	--	--	--	--	--	--	--	--	--	--	--	--	--	--	--	--	--	--	--	--	--	--	--	--	--	--	--	--	--	--	--	--	--	--	--	--	--	--	--	--	--	--	--	--	--	--	--	--	--	--	--	--	--	--	--	--	--	--	--	--	--	--	--	--	--	--	--	--	--	--	--	--	--	--	--	--	--	--	--	--	--	--	--	--	--	--	--	--	--	--	--	--	--	--	--	--	--	--	--	--	--	--	--	--	--	--	--	--	--	--	--	--	--	--	--	--	--	--	--	--	--	--	--	--	--	--	--	--	--	--	--	--	--	--	--	--	--	--	--	--	--	--	--	--	--	--	--	--	--	--	--	--	--	--	--	--	--	--	--	--	--	--	--	--	--	--	--	--	--	--	--	--	--	--	--	--	--	--	--	--	--	--	--	--	--	--	--	--	--	--	--	--	--	--	--	--	--	--	--	--	--	--	--	--	--	--	--	--	--	--	--	--	--	--	--	--	--	--	--	--	--	--	--	--	--	--	--	--	--	--	--	--	--	--	--	--	--	--	--	--	--	--	--	--	--	--	--	--	--	--	--	--	--	--	--	--	--	--	--	--	--	--	--	--	--	--	--	--	--	--	--	--	--	--	--	--	--	--	--	--	--	--	--	--	--	--	--	--	--	--	--	--	--	--	--	--	--	--	--	--	--	--	--	--	--	--	--	--	--	--	--	--	--	--	--	--	--	--	--	--	--	--	--	--	--	--	--	--	--	--	--	--	--	--	--	--	--	--	--	--	--	--	--	--	--	--	--	--	--	--	--	--	--	--	--	--	--	--	--	--	--	--	--	--	--	--	--	--	--	--	--	--	--	--	--	--	--	--	--	--	--	--	--	--	--	--	--	--	--	--	--	--	--	--	--	--	--	--	--	--	--	--	--	--	--	--	--	--	--	--	--	--	--	--	--	--	--	--	--	--	--	--	--	--	--	--	--	--	--	--	--	--	--	--	--	--	--	--	--	--	--	--	--	--	--	--	--	--	--	--	--	--	--	--	--	--	--	--	--	--	--	--	--	--	--	--	--	--	--	--	--	--	--	--	--	--	--	--	--	--	--	--	--	--	--	--	--	--	--	--	--	--	--	--	--	--	--	--	--	--	--	--	--	--	--	--	--	--	--	--	--	--	--	--	--	--	--	--	--	--	--	--	--	--	--	--	--	--	--	--	--	--	--	--	--	--	--	--	--	--	--	--	--	--	--	--	--	--	--	--	--	--	--	--	--	--	--	--	--	--	--	--	--	--	--	--	--	--	--	--	--	--	--	--	--	--	--	--	--	--	--	--	--	--	--	--	--	--	--	--	--	--	--	--	--	--	--	--	--	--	--	--	--	--	--	--	--	--	--	--	--	--	--	--	--	--	--	--	--	--	--	--	--	--	--	--	--	--	--	--	--	--	--	--	--	--	--	--	--	--	--	--	--	--	--	--	--	--	--	--	--	--	--	--	--	--	--	--	--	--	--	--	--	--	--	--	--	--	--	--	--	--	--	--	--	--	--	--	--	--	--	--	--	--	--	--	--	--	--	--	--	--	--	--	--	--	--	--	--	--	--	--	--	--	--	--	--	--	--	--	--	--	--	--	--	--	--	--	--	--	--	--	--	--	--	--	--	--	--	--	--	--	--	--	--	--	--	--	--	--	--	--	--	--	--	--	--	--	--	--	--	--	--	--	--	--	--	--	--	--	--	--	--	--	--	--	--	--	--	--	--	--	--	--	--	--	--	--	--	--	--	--	--	--	--	--	--	--	--	--	--	--	--	--	--	--	--	--	--	--	--	--	--	--	--	--	--	--	--	--	--	--	--	--	--	--	--	--	--	--	--	--	--	--	--	--	--	--	--	--	--	--	--	--	--	--	--	--	--	--	--	--	--	--	--	--	--	--	--	--	--	--	--	--	--	--	--	--	--	--	--	--	--	--	--	--	--	--	--	--	--	--	--	--	--	--	--	--	--	--	--	--	--	--	--	--	--	--	--	--	--	--	--	--	--	--	--	--	--	--	--	--	--	--	--	--	--	--	--	--	--	--	--	--	--	--	--	--	--	--	--	--	--	--	--	--	--	--	--	--	--	--	--	--	--	--	--	--	--	--	--	--	--	--	--	--	--	--	--	--	--	--	--	--	--	--	--	--	--	--	--	--	--	--	--	--	--	--	--	--	--	--	--	--	--	--	--	--	--	--	--	--	--	--	--	--	--	--	--	--	--	--	--	--	--	--	--	--	--	--	--	--	--	--	--	--	--	--	--	--	--	--	--	--	--	--	--	--	--	--	--	--	--	--	--	--	--	--	--	--	--	--	--	--	--	--	--	--	--	--	--	--	--	--	--	--	--	--	--	--	--	--	--	--	--	--	--	--	--	--	--	--	--	--	--	--	--	--

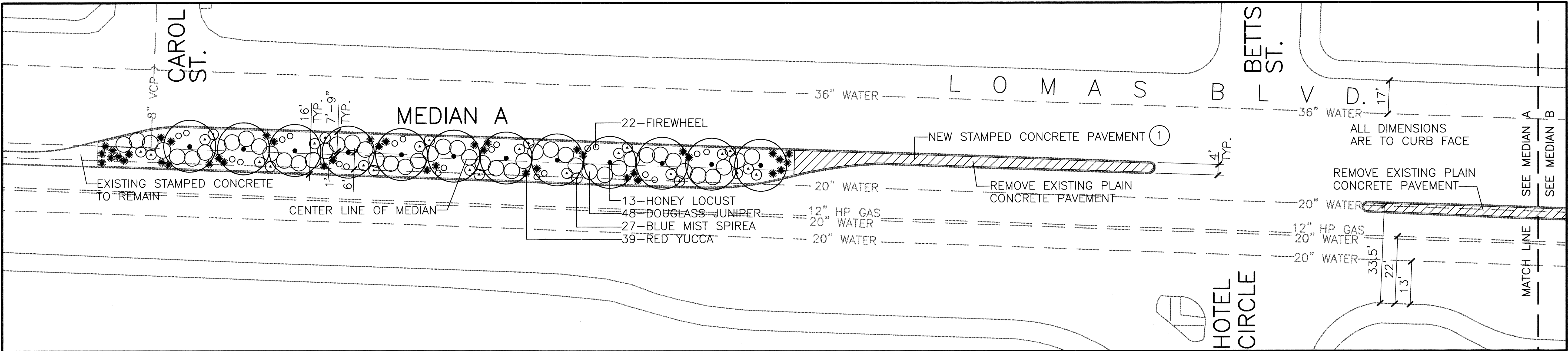

PLANTING PLAN - MEDIAN A 1"=20'

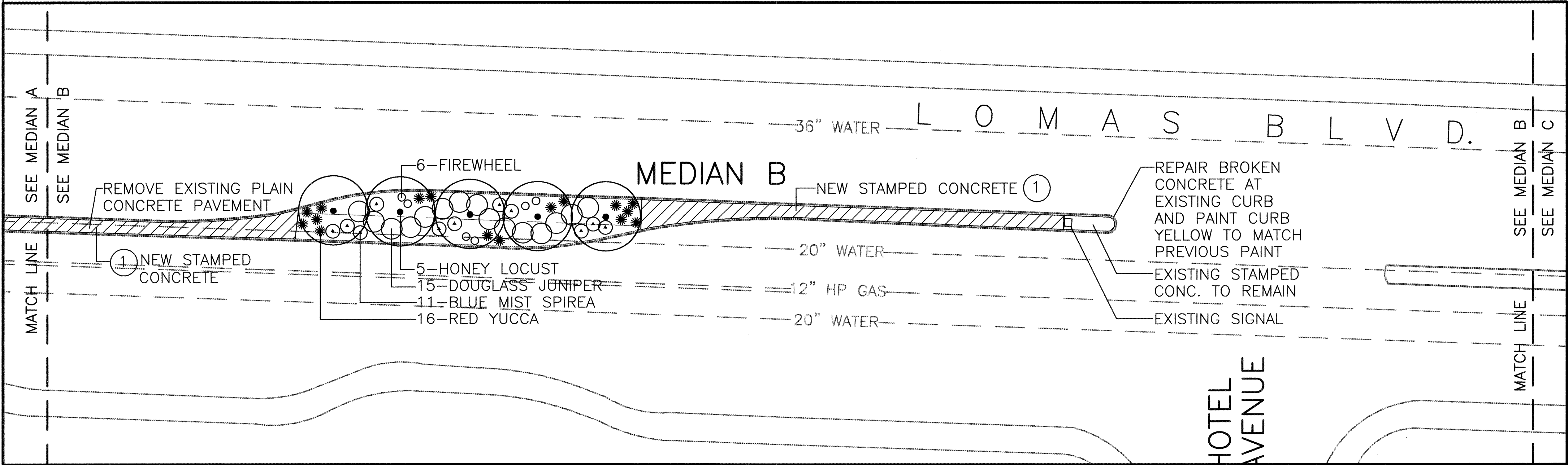

PLANTING PLAN - MEDIAN B 1"=20'

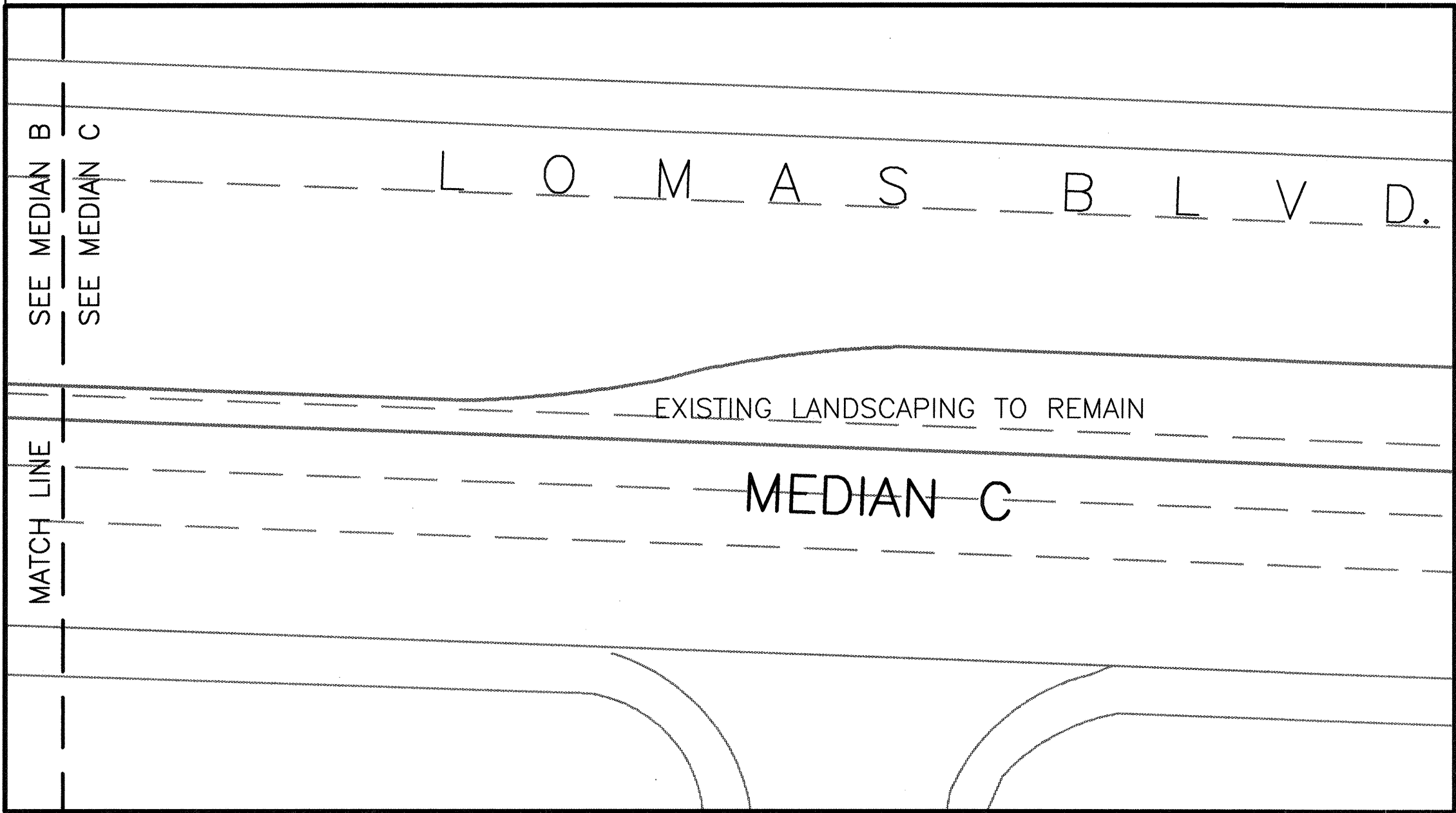

EXISTING MEDIAN (NO PLANTING) 1"=20'

PLANTING SCHEDULE

SYM	APPROX. QUANTITY	BOTANICAL NAME	COMMON NAME	SIZE	COND	EMITTER SCHEDULE PER PLANT	MATURE SIZE
TREES							
●	17	GLEDITSIA TRIACANTHOS 'INERMIS'	INERMIS HONEY LOCUST	2" CALIPER	B&B	4 - 1 GAL. PER HOUR EA.	35 FEET HIGH 25 FEET WIDE
SHRUBS							
○	28	GALLARDIA GRANDIFLORA	FIREWHEEL	1 GAL	CONTAINER	1 - 1 GAL. PER HOUR EA.	1 FOOT HIGH 1.5 FEET WIDE
⊙	38	CARYOPTERIS CLANDONENSIS	BLUE MIST SPIREA	5 GAL	CONTAINER	2 - 1 GAL. PER HOUR EA.	4 FEET HIGH 4 FEET WIDE
○	63	JUNIPERUS HORIZONTALIS 'DOUGLASHII'	DOUGLAS JUNIPER	5 GAL	CONTAINER	2 - 1 GAL. PER HOUR EA.	1 FOOT HIGH 8 FEET WIDE
●	58	HESPERALOE PARVIFLORA	RED YUCCA	5 GAL	CONTAINER	1 - 1 GAL. PER HOUR EA.	1.5 FEET HIGH 3 FEET WIDE

PAVING SCHEDULE

- 1 CROSS HATCHED AREA DENOTE 3000 PSI PORTLAND CEMENT CONCRETE PAVING. COLOR TO BE DAVIS "FRANCISCAN RED" B-14 SEALED WITH ACRYLIC SEALER. INSTALL PER CITY STANDARD DRAWING 2408 - CONCRETE MEDIAN PAVING SECTION, RUNNING BOND PATTERN.

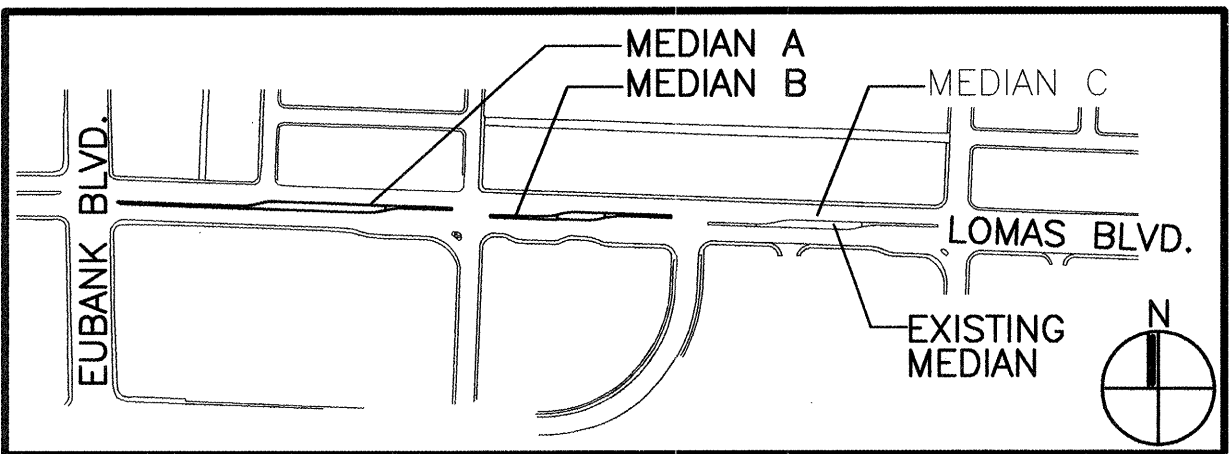

KEY PLAN NTS

FOR INFORMATION ONLY

**DESIGNWORKSHOP**  
901 Rio Grande NW  
Suite E130  
Albuquerque, NM 87104  
(Tel.) 505.243.8333  
(Fax) 505.243.8337

CITY OF ALBUQUERQUE  
PUBLIC WORKS DEPARTMENT  
ENGINEERING DEVELOPMENT GROUP

TITLE: LOMAS MEDIANS LANDSCAPE AT EUBANK BLVD.  
PLANTING AND PAVING PLAN

Design Review Committee OCT 4 1999	City Engineer Approval OCT 4 1999	Mo./Day/Yr.	Mo./Day/Yr.
DESIGN REVIEW COMMITTEE	CITY ENGINEER	City Project No. 626791	Zone Map No. K-21-Z
Sheet 2 Of 6		L-1	





COA STANDARD DRAWING REFERENCE

- 1 INSTALL TREE IN PLANTER PER CITY STANDARD DRAWING 2715.
- 2 INSTALL ISOLATED SHRUB IN PLANTER PER CITY STANDARD DRAWING 2717.

GENERAL IRRIGATION NOTES:

- 1. LOCATIONS OF IRRIGATION LINES, VALVES, HEADS, AND ALL OTHER RELATED IRRIGATION APPURTENANCES SHOWN ON THESE DRAWINGS ARE DIAGRAMMATIC ONLY.
- 2. STAKE ALL UTILITIES, INCLUDING SEWER AND DRAINAGE PRIOR TO ANY EXCAVATION FOR IRRIGATION.
- 3. MAINLINE IS TO BE BURIED A MINIMUM OF 42". THE LATERAL LINES ARE TO BE BURIED A MINIMUM OF 18".
- 4. ALL IRRIGATION PIPE UNDER PAVEMENT TO BE PLACED IN A SLEEVE TWO SIZES LARGER THAN THE PIPE BEING SLEEVED, OR THE COMBINED DIAMETERS OF THE PIPES BEING SLEEVED. COORDINATE WITH CONCRETE WORK TO PLACE SLEEVES UNDER PAVEMENT.
- 5. CONTRACTOR IS RESPONSIBLE FOR VERIFYING THAT SUFFICIENT PRESSURE IS AVAILABLE AT THE SOURCE FOR THE SYSTEM TO OPERATE AS DESIGNED AT THE SPECIFIED PRESSURE.

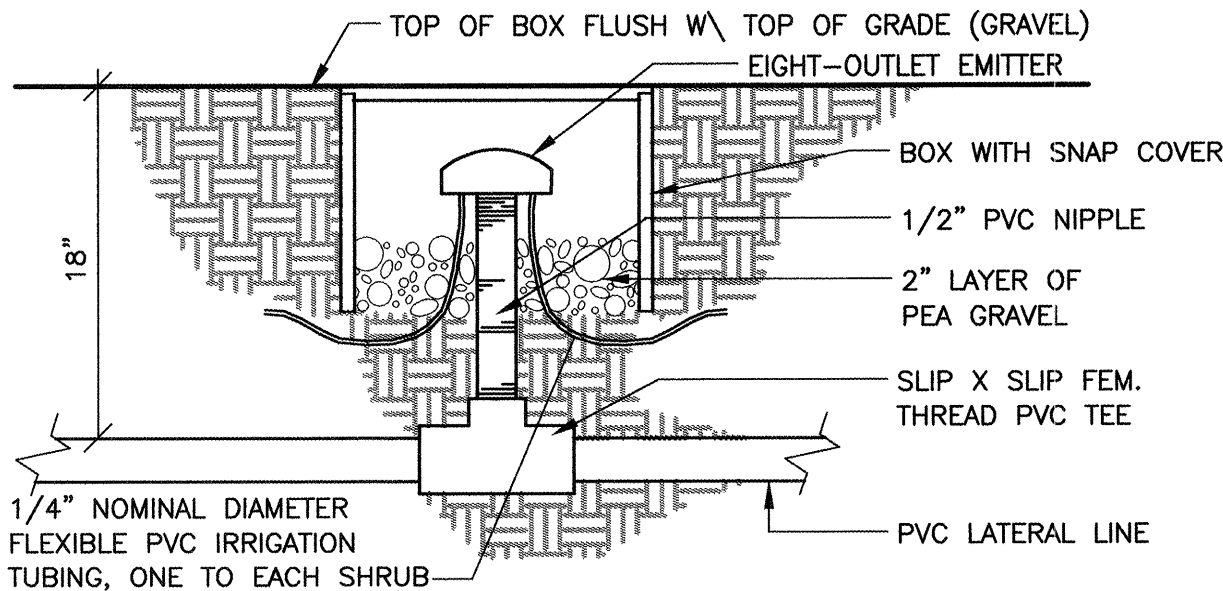

NOTE:  
RAINBIRD XERIBIRD XBD-80  
8-OUTLET THREADED EMITTER ON RISER IN BOX  
INSTALL WITH:  
RAINBIRD DT-025 1/4" VINYL DISTRIBUTION TUBING  
RAINBIRD DBC-025 BUG CAP  
NDS-108 BC-S, SAND COLORED VALVE BOX WITH SCREW IN LID  
  
(UNLESS NOTED OTHERWISE) ONE XBD-80 PER  
6-8 SHRUBS  
RAINBIRD RYB-100-150  
1" WYE FILTER, 150 MESH

1 EIGHT-OUTLET DRIP EMITTER

NTS

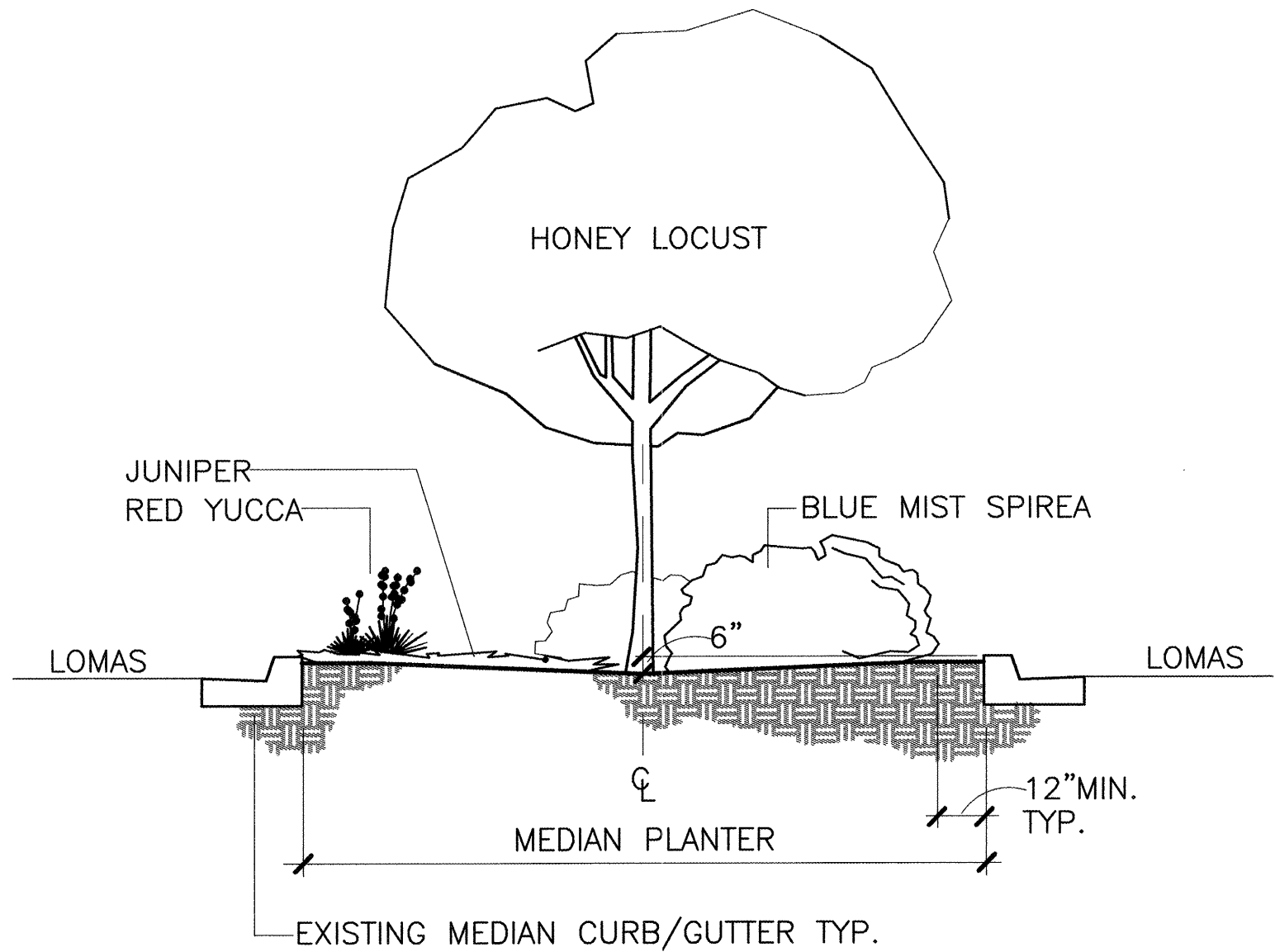

2 MEDIAN PLANTER SECTION

NTS

PLANTING NOTES:

- 1 AMENDED SOIL IS TO BE PLANTING SOIL AS SPECIFIED IN THE C.O.A. STD. SPECIFICATIONS MIXED WITH EXISTING SOIL FROM THE EXCAVATION OF THE PLANTING PIT. MIX 1 PART PLANTING MIX TO 2 PARTS EXISTING SOIL FOR BACKFILL.
- 2 ALL SHRUB AND TREE PLANTING AREAS ARE TO RECEIVE 3/4" SANTA FE BROWN GRAVEL PLACED 3 INCHES DEEP ON THE SOIL SURFACE.
- 3 PRUNE THE LOWER BRANCHES OF TREES TO PROVIDE AS THE MOST CLEARANCE WITHOUT IMPAIRING THE TREE'S ASTHETIC VALUE (COA PARK MANAGEMENT STAFF TO DIRECT PRUNING).

GENERAL PLANTING NOTES:

- 1 ALL PLANT MATERIAL SHALL CONFORM TO THE SIZES GIVEN IN THE PLANT LIST AND SHALL BE NURSERY GROWN IN ACCORDANCE WITH THE 'AMERICAN STANDARD FOR NURSERY STOCK', LATEST EDITION.
- 2 ALL PLANTING SHALL BE IN ACCORDANCE WITH STANDARD AMERICAN NURSERYMEN PROCEDURES AND SPECIFICATIONS.
- 3 ALL PLANT MATERIAL IS SUBJECT TO FINAL APPROVAL BY LANDSCAPE ARCHITECT. OBTAIN APPROVAL FROM THE OWNER OR LANDSCAPE ARCHITECT BEFORE MAKING ANY SUBSTITUTIONS OR CHANGES.
- 4 DRAWN PLANS TAKE PRECEDENCE OVER PLANT LIST PROVIDED AND BOTANICAL NAMES SHALL TAKE PRECEDENCE OVER COMMON NAMES IF ANY DISCREPANCY OCCURS.
- 5 LOCATION AND ORIENTATION OF ALL TREES MUST BE APPROVED BY THE LANDSCAPE ARCHITECT PRIOR TO INSTALLATION. CONTRACTOR TO STAKE TREE LOCATIONS FOR APPROVAL PRIOR TO PLACEMENT OF TREES.
- 6 CONTRACTOR SHALL VERIFY THE CORRECT LOCATION OF ALL UNDERGROUND UTILITIES IN THE FIELD PRIOR TO INSTALLATION OF ANY PLANT MATERIAL OR OR IRRIGATION SYSTEMS.

FOR INFORMATION ONLY

**DESIGNWORKSHOP**  
901 Rio Grande NW  
Suite E130  
Albuquerque, NM 87104  
(Tel.) 505.243.8333  
(Fax) 505.243.8337

CITY OF ALBUQUERQUE PUBLIC WORKS DEPARTMENT ENGINEERING DEVELOPMENT GROUP			
TITLE: LOMAS MEDIANS LANDSCAPE AT EUBANK BLVD. DETAILS, NOTES, AND SCHEDULES			
Design-Review-Committee APPROVED OCT 4 1999 DESIGN REVIEW COMMITTEE	City Engineer Approval APPROVED OCT 4 1999 CITY ENGINEER	Mo./Day/Yr. Mo./Day/Yr.	Mo./Day/Yr. Mo./Day/Yr.
City Project No. 626791	Zone Map No. K-21-Z	Sheet L-3	Of 6



## CONSTRUCTION TRAFFIC CONTROL GENERAL NOTES

1. CONTRACTOR MUST OBTAIN FROM CONSTRUCTION COORDINATION AN EXCAVATION/BARRICADING PERMIT BEFORE ENGAGING IN ANY CONSTRUCTION, MAINTENANCE OR REPAIR WORK IN ANY OF THE CITY OF ALBUQUERQUE'S RIGHTS-OF-WAY. EMERGENCY WORK THAT WOULD PRESERVE LIFE OR PROPERTY IS EXCLUDED WITH THE UNDERSTANDING, THAT A PERMIT SHALL BE OBTAINED WITHIN 24 TO 48 HOURS.

2. CONTRACTOR SHALL AT THE TIME OF PERMIT REQUEST, SUBMIT FOR APPROVAL BY CONSTRUCTION COORDINATION, A TRAFFIC CONTROL PLAN DETAILING ALL EXISTING TOPOGRAPHY SUCH AS LANE WIDTHS, DRIVEWAYS, AND BUSINESS/RESIDENTIAL ACCESSES. THE TRAFFIC CONTROL PLAN SHALL INCLUDE ALL PHASES OF WORK AND SCHEDULES INVOLVED IN THE CONSTRUCTION PROJECT. ANY SEPARATE PHASES OF A CONSTRUCTION PROJECT SHALL BE GIVEN AN INDIVIDUAL PERMIT EACH. BLANKET PERMITS WILL NOT BE ISSUED.

3. THESE TYPICAL TRAFFIC CONTROL PLANS DO NOT REFLECT THE EXISTING TOPOGRAPHY SUCH AS DRIVEWAYS, LANE WIDTHS, AND BUSINESS/RESIDENTIAL ACCESSES. EVERY LOCATION THAT REQUIRES CONSTRUCTION TRAFFIC CONTROL SHALL HAVE A DETAILED TRAFFIC CONTROL PLAN SHOWING ALL EXISTING TOPOGRAPHY.

4. CONSTRUCTION SHALL NOT BEGIN UNLESS A TRAFFIC CONTROL PLAN HAS BEEN APPROVED AND VERIFIED BY CONSTRUCTION COORDINATION.

5. CONSTRUCTION COORDINATION SHALL BE NOTIFIED 48 HOURS PRIOR TO ANY TRAFFIC CONTROL CHANGES NEEDED BY CONTRACTOR, THAT WERE NOT PREVIOUSLY APPROVED. THESE TRAFFIC CONTROL CHANGES SHALL BE REQUESTED IN WRITING ACCOMPANIED WITH A TRAFFIC CONTROL PLAN REFLECTING SUCH CHANGES.

6. ALL CONSTRUCTION TRAFFIC CONTROL DEVICES SHALL COMPLY TO THE MANUAL ON UNIFORM TRAFFIC CONTROL DEVICES (MUTCD), LATEST EDITION. IT IS THE RESPONSIBILITY OF THE CONTRACTOR TO INSTALL, SERVICE AND MAINTAIN ALL TRAFFIC CONTROL DEVICES. TRAFFIC CONTROL DEVICES SHALL NOT BE REMOVED OR ALTERED IN ANY WAY WITHOUT THE APPROVAL OF CONSTRUCTION COORDINATION, PER SECTION 6A-4 OF THE MUTCD, LATEST EDITION.

7. THE CONSTRUCTION TRAFFIC CONTROL INITIAL SET-UP SHALL BE BY AN AMERICAN TRAFFIC SAFETY SERVICES ASSOCIATION (ATSSA) CERTIFIED WORKSITE TRAFFIC SUPERVISOR. THE MAINTENANCE AND SERVICING SHALL ALSO BE DONE BY AN ATSSA CERTIFIED WORKSITE TRAFFIC SUPERVISOR OR EQUIVALENT.

8. CONTRACTOR IS RESPONSIBLE TO MAINTAIN AND SERVICE ALL TRAFFIC CONTROL DEVICES 24 HOURS A DAY, 7 DAYS A WEEK THROUGHOUT LENGTH OF PROJECT. CONTRACTOR IS RESPONSIBLE THAT ALL TRAFFIC CONTROL DEVICES COMPLY WITH THE MUTCD, LATEST EDITION.

9. ALL ADVANCE WARNING SIGNS SHALL BE DOUBLE INDICATED WHENEVER THERE ARE MULTI-LANE TRAFFIC IN ANY ONE GIVEN DIRECTION AND THERE IS SUFFICIENT MEDIAN SPACE.

10. ALL BARRICADES IN ALL TAPERS AND TANGENTS SHALL BE PLACED APART, A DISTANCE MEASURED IN FEET, EQUAL TO THAT OF THE POSTED SPEED LIMIT. NO EXCEPTIONS UNLESS APPROVED BY CONSTRUCTION COORDINATION PER MUTCD SECTION 6A-4.

11. ALL WORK IN ARTERIAL ROADWAYS SHALL BE ON A CONTINUOUS 24 HOUR PER DAY BASIS UNTIL COMPLETED.

12. CONTRACTOR IS RESPONSIBLE TO PROVIDE CONSTRUCTION COORDINATION, A WEEKLY LOG OF DAILY INSPECTIONS OF BARRICADE AND MAINTENANCE SCHEDULES ON PROJECTS THAT ARE OVER ONE WEEK DURATION.

13. EQUIPMENT OR MATERIALS SHALL NOT BE STORED WITHIN 15 FEET OF A TRAVELLED TRAFFIC LANE DURING NON-WORKING HOURS WITHOUT THE APPROVAL OF CONSTRUCTION COORDINATION.

14. CONTRACTOR SHALL PROVIDE AND MAINTAIN A SAFE AND ADEQUATE MEANS OF CHANNELIZING PEDESTRIAN TRAFFIC AROUND AND THROUGH THE CONSTRUCTION AREA.

15. CONTRACTOR IS RESPONSIBLE FOR OBLITERATION OF ANY CONFLICTING STRIPING AND RESPONSIBLE FOR ALL TEMPORARY STRIPING.

16. CONTRACTOR SHALL MAINTAIN ACCESS TO ALL FACILITIES, BUSINESSES AND/OR RESIDENTS AT ALL TIMES.

17. CONTRACTOR SHALL PROVIDE ACCESS SIGNS FOR BUSINESSES LOCATED WITHIN THE CONSTRUCTION AREA UNDER THE SUPERVISION OF CONSTRUCTION COORDINATION. EACH ACCESS SIGN SHALL HAVE 5 INCH, WHITE OPAQUE LETTERING ON BLUE REFLECTORIZED BACKGROUND. ACCESS SIGNS SHALL BE CONSIDERED INCIDENTAL TO THE BID AND NOT PART OF THE CONTRACT UNLESS OTHERWISE STATED. NO MORE THAN 3 BUSINESSES SHALL BE LISTED ON A ACCESS SIGN. SHOPPING CENTERS AND MALLS SHALL BE LISTED AS SUCH.

18. ALL ADVANCE WARNING SIGNS SHALL MEET THE MINIMUM REFLECTIVE INTENSITY REQUIREMENTS SET FORTH BY THE CITY OF ALBUQUERQUE. CONSTRUCTION COORDINATION SHALL DETERMINE ALL REQUIREMENTS AND APPROVE OR DISAPPROVE ANY ADVANCE WARNING SIGN PER SECTION 6A-4 OF THE MUTCD, LATEST EDITION.

19. 48 HOURS PRIOR TO OCCUPYING OR CLOSING OF A RIGHT-OF-WAY, CONTRACTOR SHALL NOTIFY: POLICE, FIRE DEPARTMENT, SCHOOLS, HOSPITALS, TRANSIT AUTHORITY, BUSINESSES AND/OR RESIDENTS THAT WILL BE AFFECTED BY THE CONSTRUCTION.

20. ANY FIELD ADJUSTMENTS SHALL BE APPROVED BY CONSTRUCTION COORDINATION.

21. EXCAVATIONS SHALL BE PLATED, TEMPORARILY PATCHED OR RESURFACED PRIOR TO OPENING OF TRAFFIC. A MINIMUM OF 11 FEET SHALL BE PROVIDED FOR TRAFFIC IN ANY GIVEN DIRECTION. CONTRACTOR IS RESPONSIBLE FOR ANY WORK INVOLVED IN SATISFYING THESE REQUIREMENTS.

22. CONTRACTOR SHALL AT ALL TIMES COMPLY WITH THE FOLLOWING:  
1. STANDARDS AND REQUIREMENTS SET FORTH IN THE MANUAL ON UNIFORM TRAFFIC CONTROL DEVICES, LATEST EDITION.  
2. THE CITY OF ALBUQUERQUE TRAFFIC CODE, LATEST EDITION.  
3. SECTION 19 OF THE CITY OF ALBUQUERQUE'S STANDARD SPECIFICATIONS FOR PUBLIC WORK CONSTRUCTION, AS WELL AS OTHER SECTIONS.

23. FAILURE TO COMPLY WITH ANY OF THE ABOVE MENTIONED, WILL BE ADEQUATE CAUSE TO CEASE ALL WORK ON ANY CONSTRUCTION PROJECT. WORK WILL NOT RESUME UNTIL ALL REQUIREMENTS ARE ADDRESSED AND APPROVED BY CONSTRUCTION COORDINATION.

24. ALL TRAFFIC CONTROL DEVICES SHALL BE KEPT IN NEW-CLEAN CONDITION. WASHING OF EQUIPMENT IS INCIDENTAL TO ITS PLACEMENT AND MAINTENANCE.

25. TRAFFIC CONTROL STANDARDS APPLY ONLY WHERE THE CONSTRUCTION TRAFFIC CONTROL PLANS ARE NOT SPECIFIC.

26. ADVANCE WARNING SIGNS SHALL BE 36"x36" MIN. WITH SUPER ENGINEERING GRADE SHEETING OR BETTER. MOUNTING HEIGHT AT TOP OF SIGN SHALL BE THE SAME AS FOR A 48" SIGN AS INDICATED IN THE MUTCD.

27. CONTRACTOR SHALL MAINTAIN A GRAFFITI-FREE WORKSITE. ALL GRAFFITI SHALL BE PROMPTLY REMOVED FROM ALL EQUIPMENT, BOTH PERMANENT AND TEMPORARY.

### SPECIAL PROJECT TRAFFIC CONTROL NOTES

- NO LANE CLOSURES WILL BE ALLOWED ON WESTBOUND LOMAS BLVD. FROM 6:00 A.M. TO 9:00 A.M., MONDAY THROUGH FRIDAYS.
- NO LANE CLOSURES WILL BE ALLOWED ON EASTBOUND LOMAS BLVD. FROM 3:00 P.M. TO 7:00 P.M., MONDAY THROUGH FRIDAYS.

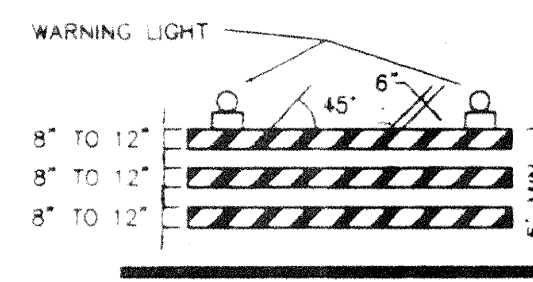

TYPE III BARRICADE

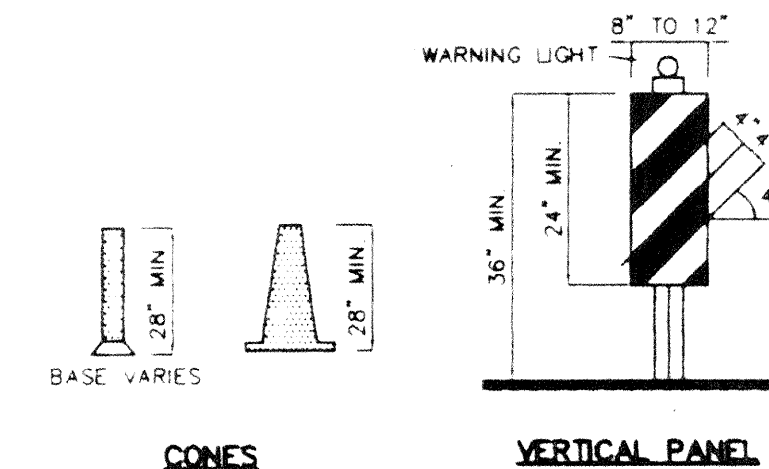

VERTICAL PANEL

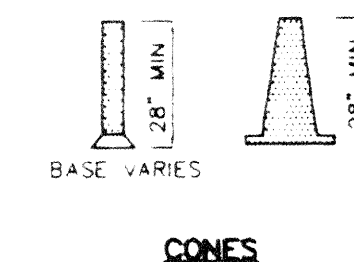

CONES

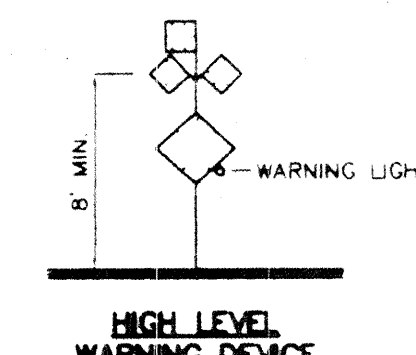

HIGH LEVEL WARNING DEVICE

**LEGEND**

WORK AREA
BARRICADE - TYPE I, TYPE II, OR BARREL
BARRICADE - TYPE III
VERTICAL PANEL
WARNING SIGN
DISTANCE BETWEEN SIGNS - A DISTANCE MEASURED IN FEET EQUAL TO A VALUE OF TEN TIMES THE SPEED LIMIT OF THE STREET
FLAGMAN POSITION
SPACING BETWEEN BARRICADES - A DISTANCE MEASURED IN FEET EQUAL TO THE SPEED LIMIT OF THE STREET
TAPER LENGTH - SEE CHART BELOW

THE TANGENT LENGTH IS EQUAL TO THE TAPER LENGTH FOR A GIVEN STREET.

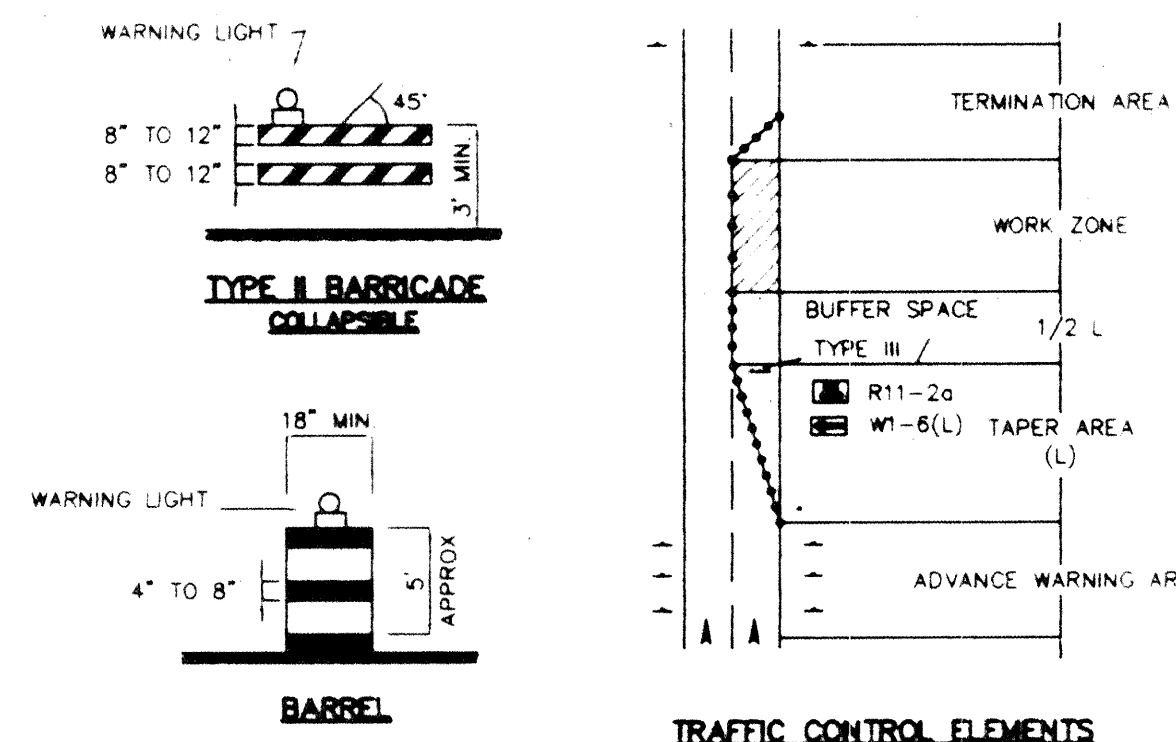

TRAFFIC CONTROL ELEMENTS

### TAPER REQUIREMENTS

SPEED LIMIT (MPH)	TAPER LENGTH (L) (FEET)			MINIMUM NUMBER OF DEVICES FOR TAPER	MAXIMUM DEVICE SPACING IN FEET	
	10' LANE	11' LANE	12' LANE		ALONG TAPER	AFTER TAPER
20	70	75	80	5	20	20
25	105	115	125	6	25	25
30	150	165	180	7	30	30
35	205	225	245	8	35	35
40	270	295	320	9	40	40
45	450	495	540	13	45	45
50	500	550	600	13	50	50
55	550	605	660	13	55	55

### RECOMMENDED SIGN SPACING(D) FOR ADVANCE WARNING SIGN SERIES

SPEED LIMIT (MPH)	MINIMUM DISTANCE IN FEET BETWEEN SIGNS	FROM LAST SIGN TO TAPER
0-20	10 X SPEED LIMIT	10 X SPEED LIMIT
25-30	10 X SPEED LIMIT	10 X SPEED LIMIT
30-35	10 X SPEED LIMIT	10 X SPEED LIMIT
40-45	10 X SPEED LIMIT	10 X SPEED LIMIT
50-60	10 X SPEED LIMIT	10 X SPEED LIMIT

### TAPER CRITERIA

TYPE OF TAPER	TAPER LENGTH
UPSTREAM TAPER:	
MERGING TAPER	L MINIMUM
SHIFTING TAPER	1/2 L MINIMUM
SHOULDER TAPER	1/2 L MINIMUM
TWO-WAY TRAFFIC TAPER	100 FEET MAXIMUM
DOWNSIDE TAPERS	100 FEET PER LANE

### TAPER LENGTH COMPUTATION

SPEED LIMIT	L = $\frac{WS^2}{60}$
40 MPH OR LESS	
45 MPH OR GREATER	L = W x S

L = TAPER LENGTH  
W = WIDTH OF OFFSET IN FEET  
S = POSTED SPEED OR OFF-PEAK 85-PERCENTILE SPEED IN MPH

### SIGN FACE DETAILS

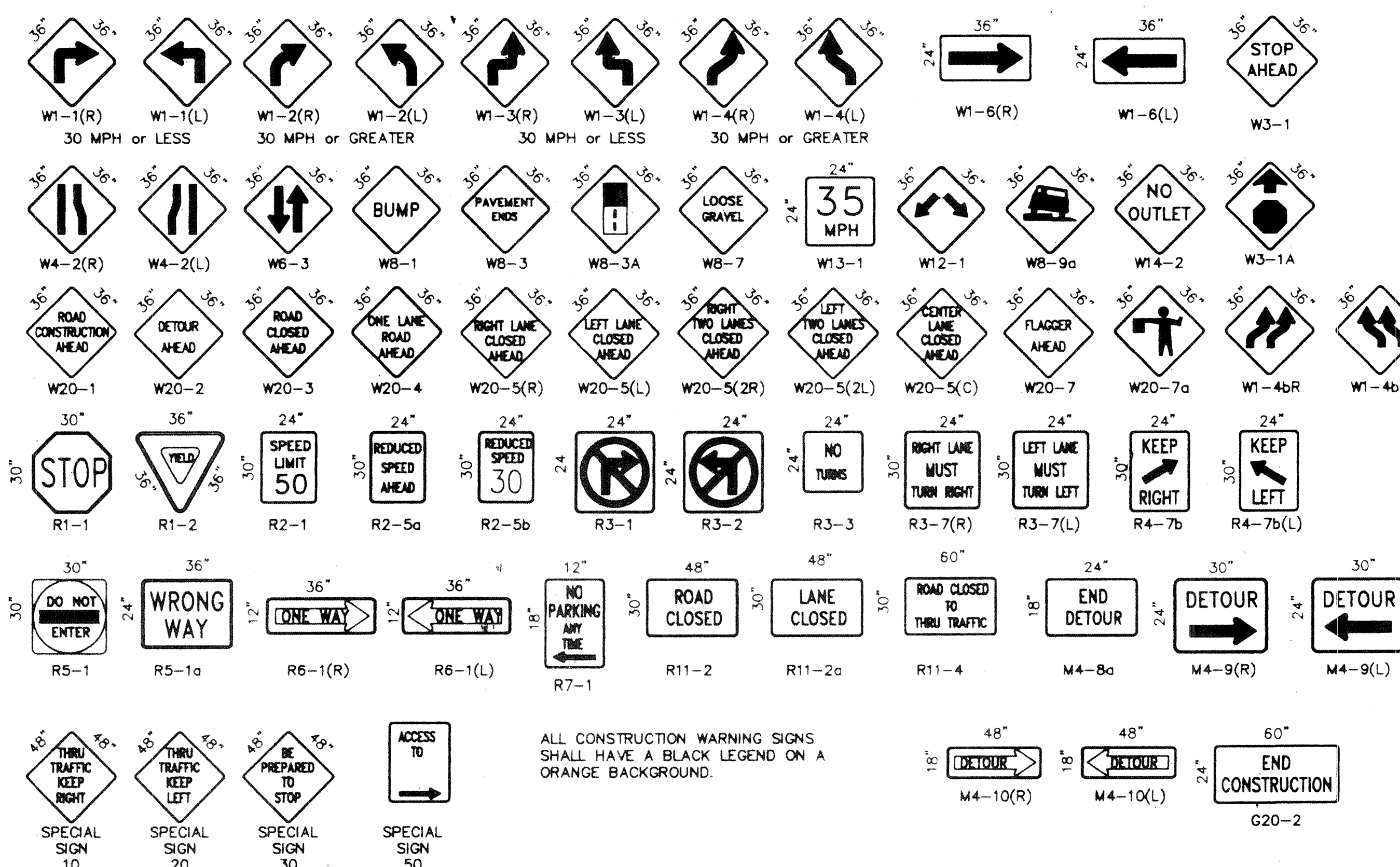

ALL CONSTRUCTION WARNING SIGNS SHALL HAVE A BLACK LEGEND ON A ORANGE BACKGROUND.

FOR INFORMATION ONLY  
FOR INFORMATION ONLY

CITY OF ALBUQUERQUE  
PUBLIC WORKS DEPARTMENT  
ENGINEERING DEVELOPMENT GROUP

TITLE: **SIGNING AND CONSTRUCTION TRAFFIC CONTROL STANDARDS**

DESIGN REVIEW COMMITTEE: **COA**

CITY ENGINEER APPROVAL: **STD.**

PROJECT NO. \_\_\_\_\_ MAP NO. \_\_\_\_\_ SHEET **5** OF **6**

DATE: \_\_\_\_\_

REVISIONS: \_\_\_\_\_

DESIGNED BY: \_\_\_\_\_ DATE: \_\_\_\_\_

DRAWN BY: C.O.A. STANDARDS

CHECKED BY: \_\_\_\_\_



