

PUBLIC WATER & SEWER
IMPROVEMENT PLANS
FOR
XRANM
5800 JEFFERSON ST NE
ALBUQUERQUE, NM

AUGUST 2022

PREPARED FOR
JEFFERSON 25 XRAY QOZB, LLC.
303 ROMA NW # 200
ALBUQUERQUE, NM

PREPARED BY
SCOTT M McGEE
790 TRAMWAY LANE NE #10C
ALBUQUERQUE, NM 87122

INDEX TO DRAWINGS

SHEET NO.

TITLE

- | | |
|---|----------------------------------|
| 1 | COVER SHEET |
| 2 | SITE UTILITY PLAN |
| 3 | SEWER REPLACEMENT PLAN & PROFILE |

SURVEYOR'S CERTIFICATION

I, BRIAN J. MARTINEZ, A DULY QUALIFIED, REGISTERED, PROFESSIONAL LAND SURVEYOR UNDER THE LAWS OF THE STATE OF NEW MEXICO, DO HEREBY CERTIFY THAT THE "AS-BUILT" INFORMATION SHOWN ON THESE DRAWINGS WAS OBTAINED FROM FIELD CONSTRUCTION AND "AS-BUILT" SURVEYS PERFORMED BY ME OR UNDER MY SUPERVISION, THAT THE "AS-BUILT" INFORMATION SHOWN ON THESE DRAWINGS WAS ADDED BE ME OR UNDER MY SUPERVISION, AND THAT THIS "AS-BUILT" INFORMATION IS TRUE AND CORRECT TO THE BEST OF MY KNOWLEDGE AND BELIEF. CARTESIAN SURVEYS IS NOT RESPONSIBLE FOR ANY OF THE DESIGN CONCEPTS, CALCULATIONS, ENGINEERING, OR INTENT OF THE RECORDED DRAWINGS.

Brian J. Martinez 1/30/23
BRIAN J. MARTINEZ, NMS 18374

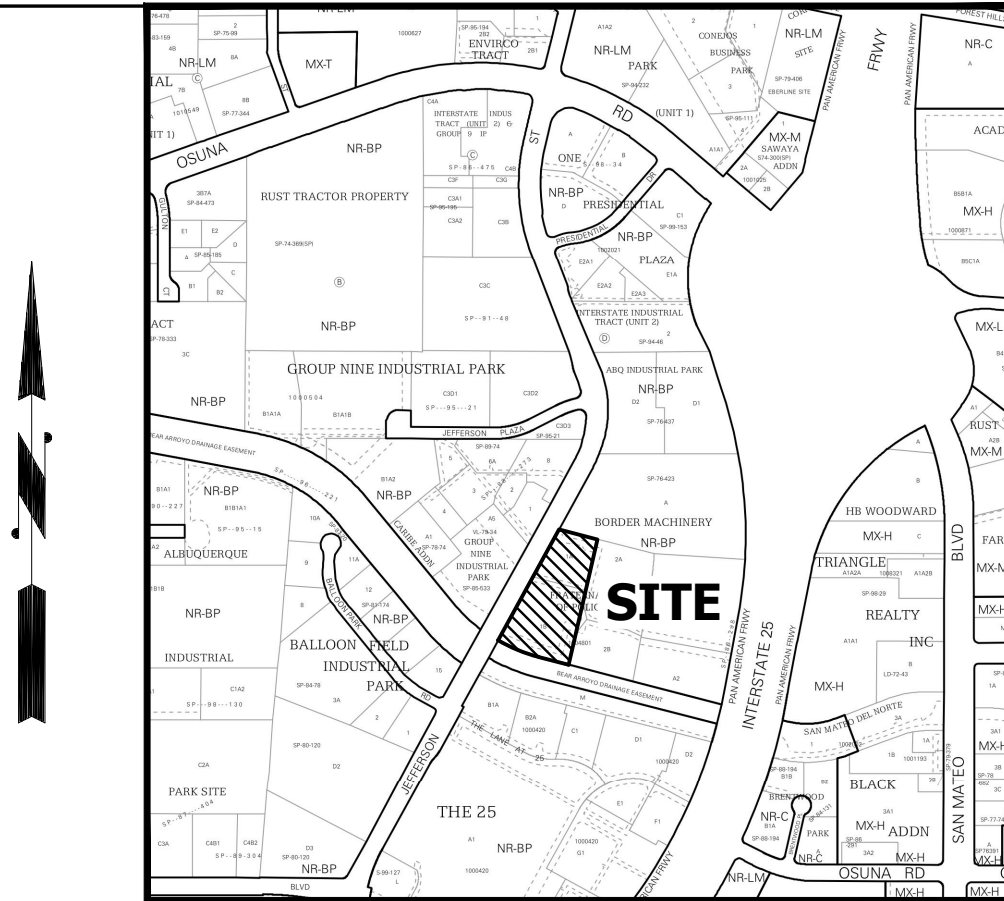

VICINITY MAP E-17

GENERAL NOTES

- ALL WORK DETAILED ON THESE PLANS, EXCEPT AS OTHERWISE STATED OR PROVIDED HEREON, SHALL BE CONSTRUCTED IN ACCORDANCE WITH ABCWUA STANDARD SPECIFICATIONS, 2020.
 - ALL WORK ON THIS PROJECT SHALL BE PERFORMED IN ACCORDANCE WITH APPLICABLE FEDERAL, STATE, AND LOCAL LAWS, ORDINANCES, RULES, AND REGULATIONS CONCERNING CONSTRUCTION SAFETY AND HEALTH.
 - CONTRACTOR SHALL ASSUME THE SOLE AND COMPLETE RESPONSIBILITY FOR THE JOB SITE CONDITIONS DURING THE COURSE OF CONSTRUCTION OF THIS PROJECT, INCLUDING SAFETY OF ALL PERSONS AND PROPERTY. THIS REQUIREMENT SHALL APPLY CONTINUOUSLY AND NOT BE LIMITED TO NORMAL WORKING HOURS. CONTRACTOR SHALL DEFEND, INDEMNIFY, AND HOLD HARMLESS THE OWNER AND ENGINEER FROM ANY AND ALL LIABILITY REAL OR ALLEGED, IN CONNECTION WITH THE PERFORMANCE OF WORK ON THIS PROJECT, EXCEPT LIABILITY ARISING FROM THE SOLE NEGLIGENCE OF THE OWNER OR ENGINEER.
 - AN EXCAVATION/CONSTRUCTION PERMIT WILL BE REQUIRED BEFORE BEGINNING ANY WORK WITHIN CITY RIGHT-OF-WAY.
 - CONTRACTOR SHALL NOTIFY THE CONSTRUCTION ENGINEER (OR PROJECT MANAGER) NOT LESS THAN SEVEN (7) DAYS PRIOR TO STARTING WORK IN ORDER THAT THE CITY SURVEYOR MAY TAKE NECESSARY MEASURES TO INSURE THE PRESERVATION OF SURVEY MONUMENTS. CONTRACTOR SHALL NOT DISTURB PERMANENT SURVEY MONUMENTS WITHOUT THE CONSENT OF THE CITY SURVEYOR AND SHALL NOTIFY THE CITY SURVEYOR AND BEAR THE EXPENSE OF REPLACING ANY THAT MAY BE DISTURBED WITHOUT PERMISSION. ONLY THE CITY SURVEYOR SHALL REPLACE SURVEY MONUMENTS. WHEN A CHANGE IS MADE IN THE FINISHED ELEVATIONS OF THE PAVEMENT OF ANY ROADWAY IN WHICH A PERMANENT SURVEY MONUMENT IS LOCATED, CONTRACTOR SHALL, AT HIS OWN EXPENSE, ADJUST THE MONUMENT COVER TO THE NEW GRADE UNLESS OTHERWISE SPECIFIED. REFER TO STANDARD SPECIFICATIONS SECTION 4.4.
 - EXISTING UTILITY LINE LOCATIONS ARE SHOWN IN AN APPROXIMATE MANNER ONLY, AND LINES MAY EXIST WHERE NONE ARE SHOWN. TWO (2) WORKING DAYS PRIOR TO ANY EXCAVATION, CONTRACTOR SHALL CONTACT NEW MEXICO ONE CALL SYSTEM (811) FOR LOCATION OF EXISTING UTILITIES. CONTRACTOR SHALL THEN EXCAVATE AND VERIFY THE HORIZONTAL AND VERTICAL LOCATIONS OF ALL PERTINENT EXISTING UTILITIES AND/OR OBSTRUCTIONS. SHOULD A CONFLICT EXIST, THE CONTRACTOR SHALL NOTIFY THE ENGINEER SO THE CONFLICT CAN BE RESOLVED WITH A MINIMUM AMOUNT OF DELAY. CONTRACTOR SHALL THEN COORDINATE RELOCATION OF UTILITY LINES WITH UTILITY COMPANIES AS REQUIRED. ANY DAMAGE CAUSED BY FAILURE TO LOCATE, IDENTIFY, AND PRESERVE ANY EXISTING UTILITIES IS THE FULL RESPONSIBILITY OF THE CONTRACTOR.
 - CONTRACTOR SHALL ASSIST THE ENGINEER/INSPECTOR IN THE RECORDING OF DATA ON ALL UTILITY LINES AND ACCESSORIES AS REQUIRED BY THE CITY OF ALBUQUERQUE FOR THE PREPARATION OF "AS BUILT" DRAWINGS. CONTRACTOR SHALL NOT COVER UTILITY LINES AND ACCESSORIES UNTIL ALL DATA HAS BEEN RECORDED.
 - CONTRACTOR SHALL ASSUME FINANCIAL RESPONSIBILITY FOR ANY DAMAGE TO EXISTING PAVEMENT, PAVEMENT MARKINGS, SIGNAGE, CURB AND GUTTER, HANDICAP RAMPS, AND SIDEWALK DURING CONSTRUCTION APART FROM THOSE SECTIONS INDICATED ON THE PLANS, AND SHALL REPAIR OR REPLACE, PER THE STANDARD SPECIFICATIONS, ANY SUCH DAMAGE.
 - CONTRACTOR SHALL MAINTAIN A GRAFFITI-FREE WORK SITE. CONTRACTOR SHALL PROMPTLY REMOVE ANY AND ALL GRAFFITI FROM EQUIPMENT, WHETHER PERMANENT OR TEMPORARY.
 - CONTRACTOR SHALL BE RESPONSIBLE TO PROVIDE AND MAINTAIN ALL CONSTRUCTION SIGNING UNTIL THE PROJECT HAS BEEN ACCEPTED BY THE CITY AND OTHER JURISDICTIONAL AUTHORITIES WHERE APPLICABLE.
 - CONSTRUCTION ACTIVITY SHALL BE LIMITED TO THE PROPERTY AND/OR PROJECT LIMITS SHOWN. ANY DAMAGE TO ADJACENT PROPERTIES RESULTING FROM THE CONSTRUCTION PROCESS IS THE RESPONSIBILITY OF THE CONTRACTOR, INCLUDING ANY SUCH COSTS INCURRED.
 - REMOVALS SHALL BE DISPOSED OF OFF-SITE AND SHALL BE THE RESPONSIBILITY OF THE CONTRACTOR.
- WATER & SEWER**
- ALL WORK REGARDING PUBLIC WATER AND PUBLIC SANITARY SEWER INFRASTRUCTURE DETAILED ON THESE PLANS TO BE PERFORMED UNDER THIS CONTRACT SHALL, EXCEPT AS OTHERWISE STATED OR PROVIDED HEREON, BE CONSTRUCTED IN ACCORDANCE WITH WATER AUTHORITY STANDARD SPECIFICATIONS. PLANS SHALL FOLLOW THE MOST CURRENT UPDATE WHICH CAN BE FOUND ONLINE AT [HTTP://WWW.ABCWUA.ORG/FOR_BUILDERS.ASPX](http://www.abcwua.org/for_builders.aspx)
 - ALL UTILITIES AND UTILITY SERVICE LINES SHALL BE INSTALLED PRIOR TO PAVING. EXISTING VALVES AND MANHOLES SHALL NOT BE BURIED OR PAVED OVER BUT RIMS SHALL BE ADJUSTED TO MATCH NEW GRADE PER COA STANDARD DRAWINGS 2460 AND 2461.
 - NON-RESIDENTIAL USERS SHALL COORDINATE WITH THE WATER AUTHORITY
- PRETREATMENT ENGINEER TO ENSURE THE PROPER IMPROVEMENTS ARE IN PLACE FOR THE DEVELOPMENT FOR DISCHARGE INTO THE PUBLIC SANITARY SEWER COLLECTION SYSTEM.
- NON-RESIDENTIAL USERS SHALL COORDINATE WITH THE WATER AUTHORITY CROSS CONNECTION SECTION TO ENSURE THE PROPER IMPROVEMENTS ARE IN PLACE FOR THE TO ENSURE PROPER BACKFLOW CONTAINMENT IS IN PLACE FOR THE WATER SYSTEM.
 - MANHOLE RIMS, FIRE HYDRANT ELEVATIONS, AND FLANGE ELEVATIONS SHOWN ARE APPROXIMATE. CONTRACTOR SHALL FIELD VERIFY AND ADJUST TO FINAL PAVEMENT OR SURFACE GRADES.
 - THE CONTRACTOR SHALL COORDINATE WITH THE WATER AUTHORITY SEVEN (7) DAYS IN ADVANCE OF PERFORMING WORK THAT WILL AFFECT THE PUBLIC WATER OR SANITARY SEWER INFRASTRUCTURE. WORK REQUIRING SHUTOFF OF FACILITIES DESIGNATED AS MASTER PLAN FACILITIES MUST BE COORDINATED WITH THE WATER AUTHORITY 14 DAYS IN ADVANCE OF PERFORMING SUCH WORK. ONLY WATER AUTHORITY CREWS ARE AUTHORIZED TO OPERATE PUBLIC VALVES. SHUTOFF REQUESTS MUST BE MADE ONLINE AT [HTTP://WWW.ABCWUA.ORG/WATER_SHUT_OFF_AND_TURN_ON_PROCEURES.ASPX](http://www.abcwua.org/water_shut_off_and_turn_on_procedures.aspx)
 - PROPOSED WATERLINE MATERIALS SHALL BE PVC PIPE MEETING AWWA C-900/DR18 REQUIREMENTS (6" - 12") OR DUCTILE IRON PIPE MEETING AWWA C-150 REQUIREMENTS (6" - 48").
 - ALL WATERLINE FITTINGS, VALVES, BENDS, TEES, CROSSES, AND APPURTENANCES SHALL HAVE RESTRAINED JOINTS UNLESS OTHERWISE NOTED ON THE PLANS. THE JOINT RESTRAINT REQUIREMENTS SHOULD BE DELINEATED WITHIN A JOINT RESTRAINT TABLE.
 - ALL SANITARY SEWER LINE STATIONING REFERS TO SANITARY SEWER CENTERLINE STATIONING. EXCEPT WHEN PROFILED WITHIN A PROPOSED OR EXISTING STREET, WHERE STREET STATIONING SHALL GOVERN.
 - ALL PROPOSED SANITARY SEWER SLOPES SHALL BE VERIFIED DURING CONSTRUCTION TO MEET THE APPROVED DESIGN. AS-BUILT SLOPES SHALL BE RECORDED FOR EACH LINE SEGMENT.
 - ALL FINAL BACKFILL FOR TRENCHES SHALL BE COMPACTED TO A MINIMUM OF 95% MAXIMUM DENSITY (PER ASTM D-1557) AND AS DIRECTED BY STANDARD SPECIFICATIONS SECTION 701.14.2 AND STANDARD DRAWING NUMBER 2465.
 - ELECTRONIC MARKER SPHERES (EMS) WILL BE PLACED ACCORDING TO THE CITY OF ALBUQUERQUE SPECIFICATIONS FOR PUBLIC WORKS CONSTRUCTION, 1986 EDITION AS REVISED THROUGH UPDATE #9. THE CONTRACTOR SHALL INSTALL A 4" X 4" X5" POST AND EMS AT THE END OF EACH SANITARY SEWER SERVICE.
 - TRACER WIRE SHALL BE INCLUDED FOR ALL PUBLIC WATER AND SEWER MAINS AND FOR WATER SERVICES IN ACCORDANCE WITH WATER AUTHORITY DETAILS.
 - CONTRACTOR SHALL PROVIDE THE PROPOSED HYDRO TESTING PLANS TO THE WUA INSPECTORS FOR APPROVAL PRIOR TO BEGINNING TESTING OPERATIONS.
 - AT UTILITY CROSSINGS, WHERE LESS THAN 18" OF VERTICAL SEPARATION FROM STORM DRAIN PIPING OR STRUCTURES IS PROPOSED, LEAN FILL CONSTRUCTION (PER SECTION 207 OF THE STANDARD SPECIFICATIONS) SHALL BE USED TO PROTECT THE WATER OR SEWER LINE. LEAN FILL SHALL EXTEND A PERPENDICULAR DISTANCE OF 5 FEET ON EACH SIDE OF THE STORM PIPE OR STRUCTURE.
 - ALL DESIGNS AND CONSTRUCTION OF ANY UNDERGROUND UTILITIES SHALL COMPLY WITH ADMINISTRATIVE INSTRUCTION NO. 9 FOR WORK NEARBY OR AFFECTING SAN JUAN CHAMA TRANSMISSION LINES AND APPURTENANCES. INFORMATION SHALL BE PROVIDED TO THE WATER AUTHORITY ONE (1) MONTH IN ADVANCE OF THE CONSTRUCTION START DATE. INFORMATION CAN BE FOUND AT [HTTP://WWW.ABCWUA.ORG/FOR_BUILDERS.ASPX](http://www.abcwua.org/for_builders.aspx)
 - ALL WATER AND SANITARY SEWER INFRASTRUCTURE SHALL BE CONSTRUCTED UTILIZING MATERIALS LISTED IN THE APPROVED PRODUCTS LIST AND BE CONSTRUCTED PER THE MOST CURRENT WATER AUTHORITY STANDARD DETAILS AND SPECIFICATIONS. MATERIAL SUBMITTALS SHALL BE PROVIDED PRIOR TO CONSTRUCTION FOR THE WATER AUTHORITY ENGINEER TO REVIEW PRIOR TO THE START OF CONSTRUCTION. INFORMATION CAN BE FOUND AT [HTTP://WWW.ABCWUA.ORG/FOR_BUILDERS.ASPX](http://www.abcwua.org/for_builders.aspx)
 - ALL COMMERCIAL/INDUSTRIAL SITES PROPOSING DISCHARGE INTO THE PUBLIC SANITARY SEWER COLLECTION SYSTEM MUST COORDINATE WITH THE WATER AUTHORITY PRETREATMENT ENGINEER PRIOR TO APPROVAL OF SERVICE. THIS MUST TAKE PLACE: PRETREATMENT@ABCWUA.ORG
 - ALL SITES PROPOSING TO ACQUIRE WATER SERVICE FROM THE PUBLIC WATER DISTRIBUTION SYSTEM SHALL COORDINATE WITH THE WATER AUTHORITY CROSS-CONNECTION PREVENTION AND CONTROL SECTION AT 505-289-3465 OR 505-289-3454 AND EMAIL @ BACKFLOW@ABCWUA.ORG
 - THE CONTRACTOR SHALL RECORD THE MATERIALS UTILIZED FOR WATER SERVICE CONNECTIONS INCLUDING THE PUBLIC SERVICE LINE AND THE PRIVATE SERVICE LINE. THE MATERIALS USED FOR CONSTRUCTION SHALL BE NOTED ON THE PLANS.
- OTHER COMMON NOTES**
- ALL EXCAVATION, TRENCHING, AND SHORING ACTIVITIES MUST BE ACCOMPLISHED IN ACCORDANCE WITH OSHA 29CFR 1926.650 SUBPART P.
 - WHEN DISTURBING MORE THAN ¼ ACRES, CONTRACTOR SHALL SECURE A "TOPSOIL DISTURBANCE PERMIT" PRIOR TO BEGINNING CONSTRUCTION.
 - IN ADVANCE OF CONSTRUCTION, CONTRACTOR SHALL DETERMINE IF OVERHEAD UTILITY LINES, SUPPORT STRUCTURES, POLES, GUYS, ETC. ARE AN OBSTRUCTION TO CONSTRUCTION OPERATIONS. IF ANY OBSTRUCTION TO CONSTRUCTION OPERATIONS IS EVIDENT, CONTRACTOR SHALL BE RESPONSIBLE FOR COORDINATING WITH THE APPROPRIATE UTILITY OWNER TO REMOVE OR SUPPORT THE UTILITY OBSTRUCTION. ANY COST ASSOCIATED WITH THIS EFFORT SHALL BE THE RESPONSIBILITY OF CONTRACTOR.
 - PNM WILL PROVIDE AT NO COST TO THE CITY OR THE CONTRACTOR THE REQUIRED PERSONNEL FOR INSPECTION OR OBSERVATION DEEMED NECESSARY BY PNM WHILE THE CONTRACTOR IS EXPOSING PNM'S CABLES. HOWEVER, THE CONTRACTOR SHALL BE CHARGED THE TOTAL COST ASSOCIATED WITH REPAIRS TO ANY DAMAGED CABLES OR FOR ANY COST ASSOCIATED WITH SUPPORTING OR RELOCATING THE POLES AND CABLES DURING CONSTRUCTION.
 - CONTRACTOR SHALL SUPPORT AND PROTECT ALL EXISTING, UNDERGROUND UTILITY LINES WHICH BECOME EXPOSED DURING CONSTRUCTION. PAYMENT FOR SUPPORTING WORK SHALL BE INCIDENTAL TO WATERLINE AND/OR SEWER LINE COSTS.
 - CONTRACTOR IS TO SUPPORT, PROTECT, AND MAINTAIN THE INTEGRITY OF ALL UNDERGROUND TELEPHONE, ELECTRIC CABLES AND CABLE TELEVISION UTILITIES AT NO ADDITIONAL COST TO THE OWNER. CABLE IS TO BE SUPPORTED AT A MAXIMUM SPACING OF FIFTEEN (15) FEET. CONTRACTOR SHALL COORDINATE WITH AND MAKE NECESSARY PAYMENT (IF ANY) TO UTILITY OWNER FOR DE-ENERGIZATION OF CABLES OR SUPPORT OF CABLES BY THE UTILITY OWNER.
 - CONTRACTOR SHALL PROMPTLY CLEAN UP ANY MATERIAL EXCAVATED WITHIN THE PUBLIC RIGHT-OF-WAY OR PRIVATE ROADWAY BASEMENTS TO PREVENT ANY EXCAVATED MATERIAL BEING WASHED DOWN THE STREET OR INTO ANY PUBLIC DRAINAGE FACILITY.
 - CONTRACTOR SHALL CONDUCT ALL WORK IN A MANNER WHICH WILL MINIMIZE INTERFERENCE WITH LOCAL TRAFFIC.
 - ALL EXISTING SIGNS, MARKERS, DELINEATORS, ETC., WITHIN THE CONSTRUCTION LIMITS SHALL BE REMOVED, STORED AND RE-SET BY THE CONTRACTOR.
 - DISPOSAL SITE FOR ALL EXCESS EXCAVATION MATERIAL AND UNSUITABLE MATERIAL SHALL BE ARRANGED BY THE CONTRACTOR IN COMPLIANCE WITH ALL APPLICABLE ENVIRONMENTAL REGULATIONS. NO SEPARATE MEASUREMENT OR PAYMENT WILL BE MADE FOR COSTS ASSOCIATED WITH OBTAINING A DISPOSAL SITE AND HAUL THERE TO.
 - IF CULTURAL RESOURCES, SUCH AS HISTORIC OR PREHISTORIC ARTIFACTS, OR HUMAN REMAINS ARE DISCOVERED DURING EXCAVATION OR CONSTRUCTION, WORK SHALL CEASE AND THE CONSTRUCTION ENGINEER SHALL NOTIFY THE COUNTY OFFICE OF THE MEDICAL EXAMINER (ME) AT (505) 272-3053. IF THE ME DETERMINES THAT HUMAN REMAINS ARE NOT PRESENT, THE CONSTRUCTION ENGINEER SHALL NOTIFY THE STATE HISTORIC PRESERVATION OFFICER (SHPO) AT 827-6320.

WATER AUTHORITY APPROVAL
OF RECORD DRAWINGS

THIS SET OF DRAWINGS IS ACCEPTED FOR RECORD
PURPOSES BY:

Andre Houle DATE: 02/01/23
Andre Houle, NMPE

W U A 6 3 2 4 . 6 6 - 2 0 2 3

ABCWUA Approval: 01/30/23

ABCWUA Availability #210918

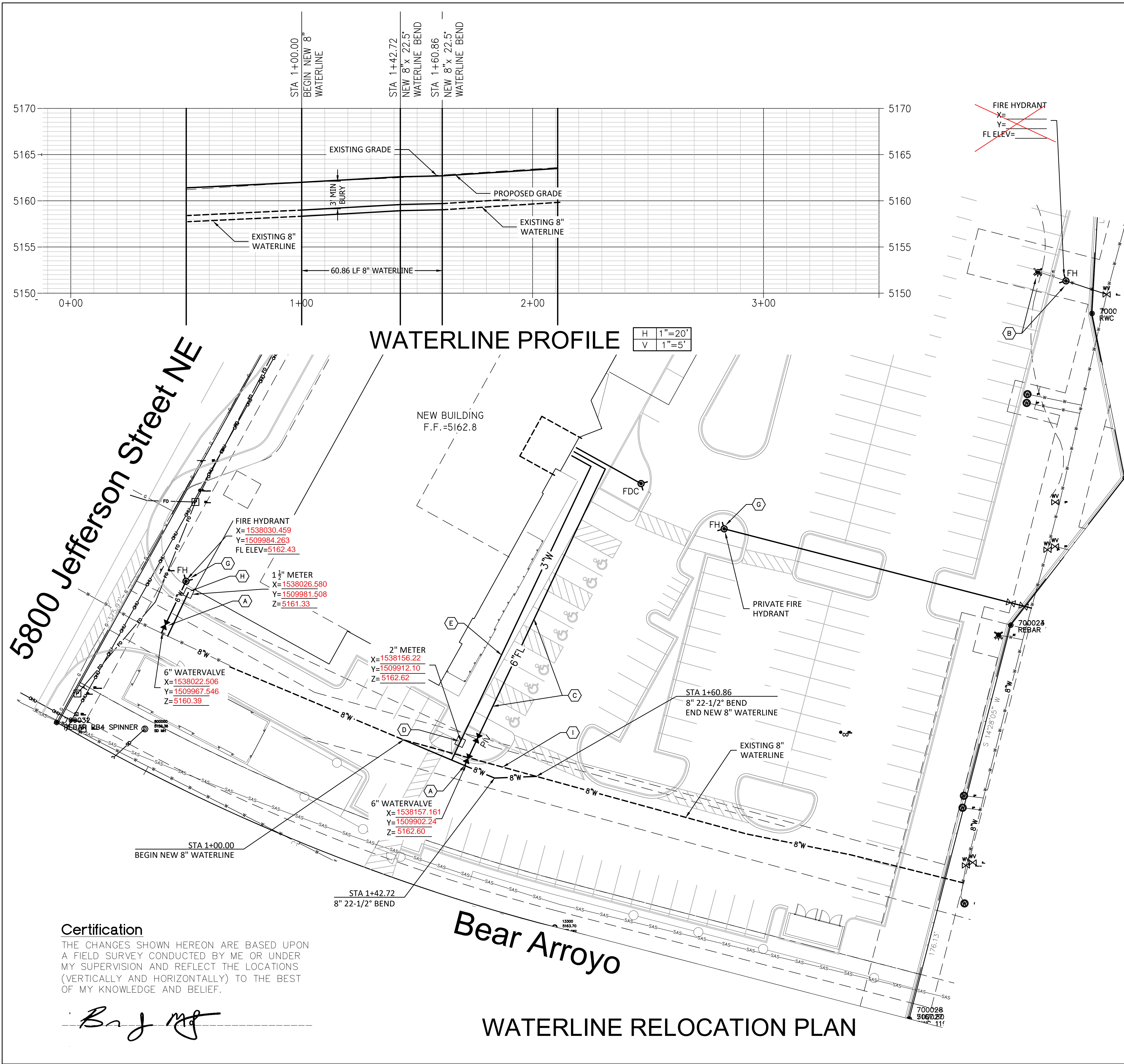

- KEYED NOTES**
- NEW 8x6" TEE, 6" GATE VALVE, AND VALVE BOX PER STD DWG NOS. 2326 & 2329 WITH PRESSURE CONNECTION. INSTALL NEW 6" WATER TO NEW FIRE HYDRANT.
 - RELOCATE EXISTING FIRE HYDRANT WITHIN EXISTING EASEMENT AS SHOWN.
 - NEW 6-INCH FIRELINE TO BUILDING WITH 8x6" TEE, 6" GATE VALVE AND VALVE BOX PER STD DWG NOS. 2326 & 2329, 6" PVC WATERLINE, AND PRESSURE CONNECTION.
 - NEW 2-INCH WATER SERVICE PER STD DWG NO 2363.
 - EXTEND 3" WATER TO BUILDING FROM WATER METER.
 - REROUTED PUBLIC SEWER BY ABWUA WORK ORDER.
 - INSTALL NEW PRIVATE FIRE HYDRANT AS SHOWN PER STD DWG NO 2340.
 - NEW 1 1/2-INCH WATER SERVICE FOR IRRIGATION PER STD DWG NO 2363.
 - REMOVE AND DISPOSE OF EXISTING 8" WATER LINE.
- GENERAL NOTE**
- ABCWUA UTILITY: GENERAL CONTRACTOR'S RESPONSIBILITIES INCLUDE TO COORDINATE AND PAY FOR WATER AND SANITARY SEWER SERVICE CONNECTIONS, TAPS, METERS, UEC CHARGES, AND ALL DOCUMENTATION REQUIREMENTS AND DIRECT PAYMENT.

Certification
THE CHANGES SHOWN HEREON ARE BASED UPON A FIELD SURVEY CONDUCTED BY ME OR UNDER MY SUPERVISION AND REFLECT THE LOCATIONS (VERTICALLY AND HORIZONTALLY) TO THE BEST OF MY KNOWLEDGE AND BELIEF.

[Signature]

WATERLINE RELOCATION PLAN

AS BUILT INFORMATION		BENCH MARK		SURVEY INFORMATION		REVISIONS/REMARKS		DESIGNED BY:		DATE:	
CONTRACTOR	DATE:	CITY OF ALBUQUERQUE ACS MONUMENT "SC 27 26 34 35 1965"	DATE:	FIELD NOTES	DATE:	NO.	DATE:	SM	EJS	05/19/2022	05/19/2022
WORK STAKED BY	DATE:	NAD 1983 Central Zone	DATE:	BY	DATE:						
INSPECTOR'S APPROVAL	DATE:	X=1534564.674 Y=1508397.94 U.S. Survey Feet	DATE:	CARTESIAN SURVEYING	DATE:						
FIELD VERIFICATION BY	DATE:	ELEV. = 5113.117 (NAVD 1988)	DATE:	JUNE, 2021	DATE:						
DRAWING CORRECTED BY	DATE:		DATE:		DATE:						
MICRO-FILM INFORMATION	DATE:		DATE:		DATE:						
RECORDED BY	DATE:		DATE:		DATE:						
NO.											

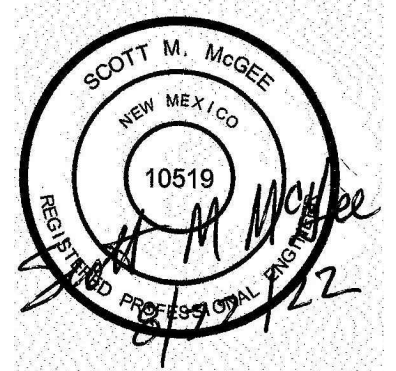



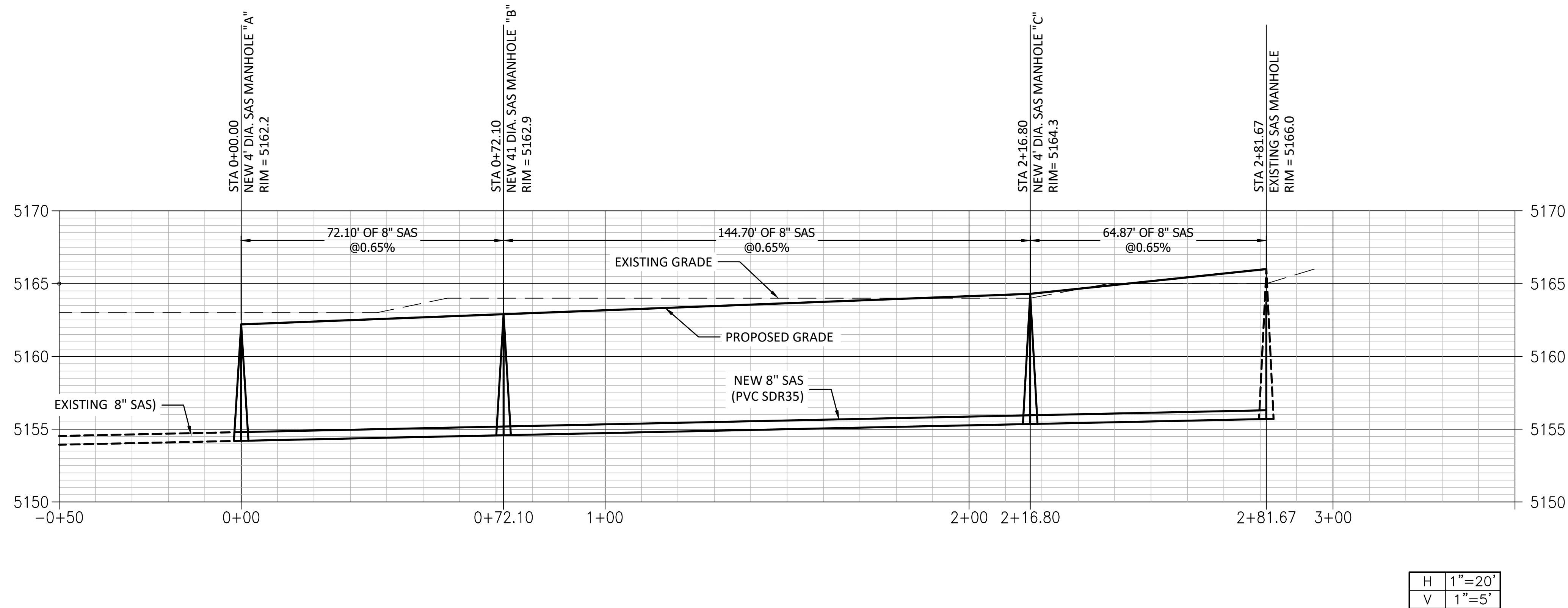









ALBUQUERQUE BERNALILLO COUNTY WATER AUTHORITY			
TITLE: XRAM-BC JEFFERSON 5900 JEFFERSON ST. NE ALBUQUERQUE, NEW MEXICO 87109			
DESIGN REVIEW COMMITTEE	CITY ENGINEER APPROVAL	PRO. / DAY / YR.	PRO. / DAY / YR.
CITY PROJECT NO.	ZONE MAP NO.	SHEET:	OF
632466	E-17-Z	2	3



THE CHANGES SHOWN HEREON ARE BASED UPON
A FIELD SURVEY CONDUCTED BY ME OR UNDER
MY SUPERVISION AND REFLECT THE LOCATIONS
(VERTICALLY AND HORIZONTALLY) TO THE BEST
OF MY KNOWLEDGE AND BELIEF.

B. J. mg

Legend

	SAS		NEW SANITARY SEWER LINE
	8" W		NEW WATER LINE WITH SIZE
	CO		CLEANOUT
	PIV		POST INDICATOR VALVE
	FH		NEW FIRE HYDRANT
	8" SAS		EXISTING SAS MANHOLE
	8" SAS		NEW SAS MANHOLE

NO.	DATE	REVISIONS/REMARKS	BY	SURVEY INFORMATION	BENCH MARK	AS BUILT INFORMATION
				FIELD NOTES BY CARTESIAN SURVEYING JUNE, 2021	City of Albuquerque ACS Monument "SC_27_26_34_35_1965" NAD 1983 Central Zone X=1534564.674 Y=1508397.94; U.S. Survey Feet ELEV. = 5113.117 (NAVD 1988)	CONTRACTOR DATE: WORK STARTED BY DATE: INSPECTOR'S APPROVAL DATE: FIELD VERIFICATION BY DATE: DRAWING CORRECTED BY DATE: MICRO-FILM INFORMATION RECORDED BY DATE: NO.
DESIGNED BY:	SM	DATE:	05/19/2022			
DRAWN BY:	EJS	DATE:	05/19/2022			
CHECKED BY:	SM	DATE:	05/19/2022			

<p align="center">ALBUQUERQUE BERNALILLO COUNTY WATER AUTHORITY</p>			
<p>TITLE: XTRANM-BC JEFFERSON 5900 JEFFERSON ST. NE ALBUQUERQUE, NEW MEXICO 87109</p>			
<p>DESIGN REVIEW COMMITTEE</p>	<p>CITY ENGINEER APPROVAL</p>	<p>LAST DESIGN UPDATE</p>	<p>MSD / DAY / YR.</p>
			<p>MSD / DAY / YR.</p>
			<p> </p>
			<p> </p>
			<p> </p>
<p>CITY PROJECT NO.</p>	<p>ZONE MAP NO.</p>	<p>SHEET:</p>	<p>OF</p>
<p align="center">632466</p>	<p align="center">E-17-Z</p>	<p align="center">3</p>	<p align="center">3</p>