



ALAMOSA SKATE PARK

AS-BUILT DRAWINGS

JUNE 7, 2017

SITE

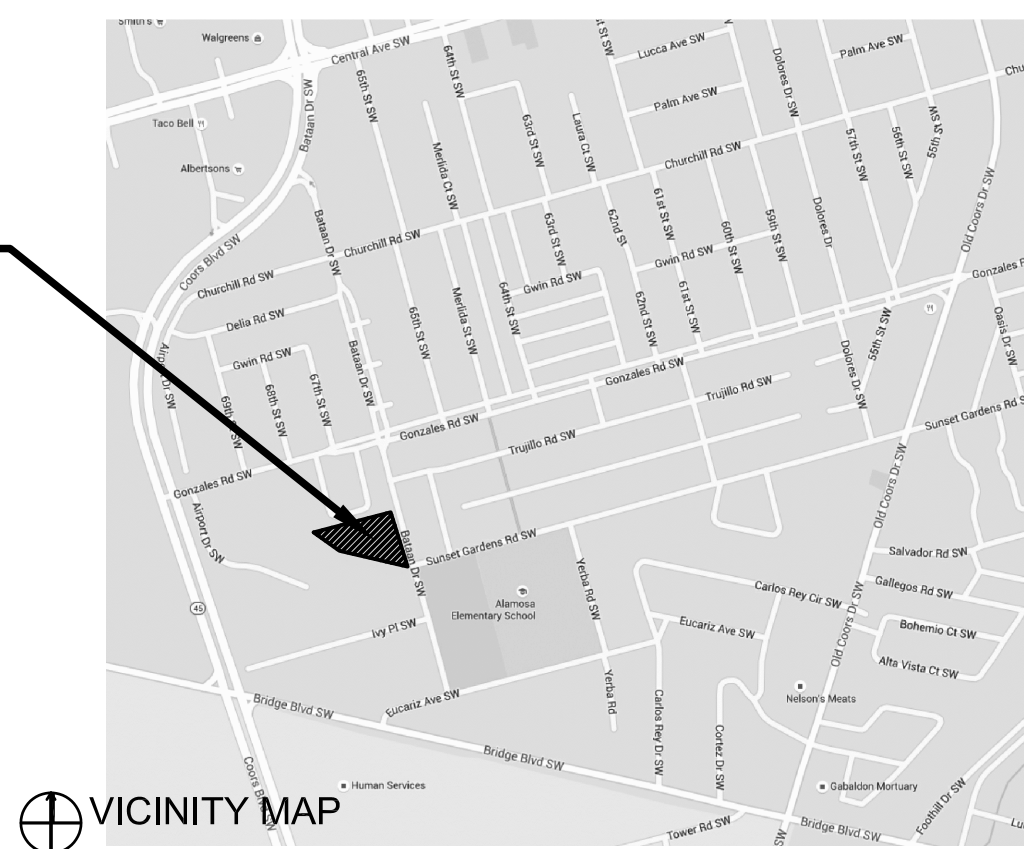

CITY OF ALBUQUERQUE

PARKS & RECREATION DEPARTMENT

Strategic Planning and Design

Date of Record Drawings:
Parks & Recreation Department - Owner

Property Information

Property Address: 6900 Gonzales SW
Albuquerque, NM 87121
Zone : L-11
Renovated Park Acres: 0.9
Existing Turf Acres: 0.17
Revised Turf Acres: 0.06

Index of Drawings

1. Cover Sheet
2. General Notes
3. Demolition Plan
4. Grading Plan
5. Construction Plan
6. Irrigation Plan
7. Planting Plan
8. Construction Details

Legal Description

TRACT A CORRECTED PLAT OF TRACT A
ALAMOSA CTR

RECORD DRAWINGS June 2017
This set of Record Documents consists of corrected plans showing the reported location of the work, conforming to the construction records provided by the Contractor. While the information submitted by the Contractor and incorporated by the Landscape Architect into the Record Documents is assumed to be reliable, the Landscape Architect has not verified the accuracy and/or completeness of the information and shall not be responsible for any errors or omissions which may be incorporated herein as a result. Those relying on these Record Documents are advised to obtain independent verification of their accuracy before applying it for any purpose.



LANDSCAPE ARCHITECTS
Morrow Reardon Wilkinson Miller, Ltd.
mrwmla.com 505 268 2266

REV.	SHEETS	CITY ENGINEER	USER DEPARTMENT	DATE	USER DEPARTMENT	DATE
ENGINEER'S STAMP & SIGNATURE		APPROVED	ENGINEER	DATE		
		PROJECT # 658780			SHEET 1 OF 8	

AS-BUILT DRAWINGS
DATE: 6/7/2017

ALAMOSA SKATE PARK

PROJECT # 658780

RECORD DRAWINGS
DATE: JUNE 7, 2017

GENERAL NOTES

1. THE CONTRACTOR SHALL NOTIFY THE LANDSCAPE ARCHITECT NOT LESS THAN SEVEN (7) DAYS PRIOR TO STARTING WORK, IN ORDER THAT THE CITY SURVEY SECTION MAY TAKE NECESSARY MEASURES TO INSURE THE PRESERVATION OF SURVEY MONUMENTS. CONTRACTOR SHALL NOT DISTURB PERMANENT SURVEY MONUMENTS WITHOUT THE CONSENT OF THE CITY SURVEYOR AND SHALL NOTIFY THE CITY SURVEYOR AND BEAR THE EXPENSE OF REPLACING ANY THAT MAY BE DISTURBED WITHOUT PERMISSION. REPLACEMENT SHALL BE DONE ONLY BY THE CITY OF ALBUQUERQUE SURVEY SECTION.
2. ALL WORK DETAILED ON THESE PLANS TO BE PERFORMED UNDER CONTRACT SHALL, EXCEPT AS OTHERWISE STATED OR PROVIDED, FOR HEREON, BE CONSTRUCTED IN ACCORDANCE WITH THE CITY OF ALBUQUERQUE STANDARD SPECIFICATIONS FOR PUBLIC WORKS CONSTRUCTION, 1986 ED. INCLUDING UPDATE NO. 9.
3. THE CONTRACTOR SHALL BE RESPONSIBLE FOR DISPOSING OF ALL DEBRIS, INCLUDING, BUT NOT LIMITED TO HAZARDOUS WASTE AT DISPOSAL SITES APPROVED BY GOVERNMENTAL AGENCIES REGULATING THE DISPOSAL OF SUCH MATERIALS.
4. SUBGRADE PREPARATION UNDER SIDEWALKS, AND SUBGRADE AND SUBBASE PREPARATION UNDER CURB AND GUTTER SHALL BE INCIDENTAL TO THE CONSTRUCTION OF SUCH, AND NO DIRECT PAYMENT SHALL BE MADE FOR THOSE ITEMS OF WORK.
5. THE CONTRACTOR SHALL EXERCISE CARE TO AVOID DISTURBING ANY EXISTING UNDERGROUND UTILITIES. IT SHALL BE HIS RESPONSIBILITY TO COORDINATE WITH THE UTILITY COMPANIES IN ORDER TO PREVENT ANY SERVICE DISRUPTION. SEE SECTION 18 "UTILITIES", CITY OF ALBUQUERQUE, STANDARD SPECIFICATIONS FOR CONTRACTOR REQUIREMENTS.
6. REMOVAL OF EXISTING CURB AND GUTTER OR SIDEWALK SHALL BE TO THE NEAREST SUITABLE JOINT UNLESS OTHERWISE DIRECTED BY THE LANDSCAPE ARCHITECT.
7. THE CONTRACTOR SHALL NOTIFY THE NEW MEXICO ONE CALL SYSTEM 260-1990 TWO (2) WORKING DAYS PRIOR TO COMMENCING WORK IN NEW AREAS.
8. PRIOR TO CONSTRUCTION, THE CONTRACTOR SHALL EXCAVATE AND VERIFY THE HORIZONTAL AND VERTICAL LOCATIONS OF ALL OBSTRUCTIONS. SHOULD A CONFLICT EXIST BETWEEN THE FIELD INFORMATION AND THE PLANS, THE CONTRACTOR SHALL NOTIFY THE LANDSCAPE ARCHITECT SO THE CONFLICT CAN BE RESOLVED WITH MINIMUM AMOUNT OF DELAY.
9. AN EXCAVATION / CONSTRUCTION PERMIT WILL BE REQUIRED BEFORE BEGINNING ANY WORK WITHIN THE CITY RIGHT-OF-WAY.
10. ALL NEW SIDEWALKS, AND CURB AND GUTTERS, ABUTTING EXISTING AREAS SHALL MATCH THE ELEVATION OF THOSE AREAS.
11. ALL UTILITY LINES WHICH ARE NOT SPECIFICALLY DESIGNATED TO BE REMOVED AND REPLACED ON THE PLANS, SHALL BE MAINTAINED IN SERVICE. SHORING, SHEETING AND OTHER MEANS OF SUPPORT SHALL BE EMPLOYED BY THE CONTRACTOR TO PREVENT DAMAGE OR LOSS OF THESE EXISTING UTILITIES AND THESE SHORING, SHEETING, AND SUPPORTS ARE CONSIDERED INCIDENTAL TO THIS PROJECT. ANY DAMAGE TO EXISTING UTILITIES SHALL PROMPTLY BE REPAIRED AT THE CONTRACTOR'S EXPENSE.
12. THE CONTRACTOR SHALL ASSUME RESPONSIBILITY FOR ANY DAMAGE TO EXISTING COA INFRASTRUCTURE (C & G, PAVING, ETC.) DURING CONSTRUCTION, APART FROM THOSE SECTIONS INDICATED FOR REMOVAL ON THE PLANS, AND SHALL REPAIR OR REPLACE SAME AT HIS OWN EXPENSE.
13. THE CONTRACTOR SHALL BE RESPONSIBLE FOR SECURING NPDES PERMITS REQUIRED BY APPLICABLE CITY, STATE, AND FEDERAL REGULATIONS.
14. CONTRACTOR SHALL RECORD DATA ON ALL IRRIGATION AND ELECTRICAL LINES INSTALLED BELOW-GRADE FOR THE PREPARATION OF "AS CONSTRUCTED" DRAWINGS. CONTRACTOR SHALL NOT COVER LINES AND ACCESSORIES UNTIL ALL DATA HAS BEEN RECORDED.
15. THE CONTRACTOR SHALL COORDINATE WITH THE WATER AUTHORITY SEVEN (7) DAYS IN ADVANCE OF PERFORMING WORK THAT WILL AFFECT THE PUBLIC WATER OR SANITARY SEWER INFRASTRUCTURE. WORK REQUIRING SHUTOFF OF WELL COLLECTORS, TRANSMISSION LINES, OR FACILITIES DESIGNATED AS MASTER PLAN FIELDS MUST BE COORDINATED WITH THE WATER AUTHORITY 14 DAYS IN ADVANCE OF PERFORMING SUCH WORK. ONLY WATER AUTHORITY CREWS ARE AUTHORIZED TO OPERATE PUBLIC VALVES. SHUTOFF REQUESTS MUST BE MADE ONLINE AT http://www.abcwjw.org/WATER_SHUT_OFF_AND_TURN_ON_PROCEDURES.ASPX.
16. CONTRACTOR SHALL PROVIDE AND MAINTAIN ALL CONSTRUCTION SIGNING UNTIL THE PROJECT HAS BEEN FINAL ACCEPTED BY THE CITY.
17. CONTRACTOR SHALL MAINTAIN A GRAFFITI-FREE WORK SITE. CONTRACTOR SHALL PROMPTLY REMOVE ANY AND ALL GRAFFITI FROM EQUIPMENT, WHETHER PERMANENT OR TEMPORARY.
18. CONTRACTOR SHALL ERECT TEMPORARY CHAIN LINK CONSTRUCTION FENCE. SUCH FENCE SHALL BE MAINTAINED THROUGHOUT THE DURATION OF THE CONSTRUCTION PERIOD AND REMOVED ONLY UPON FINAL ACCEPTANCE OF THE PROJECT BY THE CITY.
19. CONTRACTOR SHALL INSTALL ALL FURNISHINGS, FENCES, SPORTS EQUIPMENT, SHADE STRUCTURES, AND OTHER MISCELLANEOUS SITE FURNISHINGS WITH TAMPER PROOF HARDWARE UNLESS OTHERWISE NOTED ON THE PLANS. IN LIEU OF TAMPER PROOF HARDWARE, CONTRACTOR MAY SPOT WELD OR LIQUID WELD HARDWARE UPON PRIOR APPROVAL BY THE OWNER. CONTRACTOR SHALL PROVIDE A SUBMITTAL FOR TAMPER PROOF HARDWARE AND/OR LIQUID WELD PRODUCTS. CONTRACTOR SHALL PAINT TO MATCH ANY SPOT WELDS. CONTRACTOR SHALL CUT OFF BOLT ENDS THAT EXTEND BEYOND 2 THREADS PAST THE NUT. ALL PLAY AREA EQUIPMENT SHALL BE INSTALLED WITH THE MANUFACTURER'S RECOMMENDED HARDWARE.
20. CONTRACTOR SHALL KEEP SITE CLEAN AND FREE OF ALL DEBRIS.

RECORD DRAWINGS

June 2017

This set of Record Documents consists of corrected plans showing the reported location of the work, conforming to the construction records provided by the Contractor. While the information submitted by the Contractor and incorporated by the Landscape Architect into the Record Documents is assumed to be reliable, the Landscape Architect has not verified the accuracy and/or completeness of the information and shall not be responsible for any errors or omissions which may be incorporated herein as a result. Those relying on these Record Documents are advised to obtain independent verification of their accuracy before applying it for any purpose.



CITY OF ALBUQUERQUE
STRATEGIC PLANNING AND DESIGN
PARKS AND RECREATION DEPARTMENT

ALAMOSA SKATE PARK
GENERAL NOTES

Design Review Committee	City Engineer Approval	Last Design Update	Mo./Day/Yr.	Mo./Day/Yr.
City Project No. 658780		Zone Map No. K-11	Sheet 2 of 8	

AS-BUILT DRAWINGS
DATE: JUNE 7, 2017

ALAMOSA SKATE PARK

DATE 1/03/2017
PROJECT# 658780

RECORD DRAWINGS
DATE: 06/07/2017

A. ALL EXISTING IRRIGATION SYSTEM MAINLINE AND LATERAL LINES DOWNSTREAM OF CUT AND CAPPED LINES SHALL BE ABANDONED IN PLACE.

B. ANY AND ALL GRADE LEVEL AND ABOVE GRADE LEVEL IRRIGATION EQUIPMENT (RISERS, FITTINGS, SPRINKLERS, VALVE BOXES, ETC.) DOWNSTREAM OF CAPPED LATERAL SHALL BE REMOVED. WHERE SPECIFICALLY SHOWN ON THE PLAN, CAREFULLY REMOVE AND RETURN UNDAMAGED IRRIGATION EQUIPMENT TO OWNER.

C. CONTRACTOR SHALL FILL AND COMPACT ALL VOIDS CREATED BY DEMOLITION WORK WITH CLEAN BACKFILL MATERIAL WHICH SHALL BE APPROVED BY OWNER PRIOR TO BACKFILL OPERATIONS.

D. CONTRACTOR SHALL PROTECT EXISTING UTILITIES FROM DAMAGE. ANY DAMAGE TO EXISTING UTILITIES SHALL BE REPAIRED BY THE CONTRACTOR AT NO ADDITIONAL COST TO THE OWNER.

E. TWO WORKING DAYS PRIOR TO ANY EXCAVATION, THE CONTRACTOR SHALL CONTACT NEW MEXICO ONE CALL SYSTEM (1-800-321-2537) FOR LOCATION OF EXISTING UTILITIES.

F. CONTRACTOR SHALL TAKE ALL NECESSARY PRECAUTIONS TO ENSURE NO DAMAGE OCCURS TO EXISTING SURFACES, SIGNS, AND PAVEMENT TO REMAIN AND ITEMS TO BE SALVAGED. ANY DAMAGE TO ITEMS TO REMAIN OR TO BE SALVAGED RESULTING FROM CONSTRUCTION OPERATIONS SHALL BE REPAIRED AND/OR REPLACED AT NO ADDITIONAL COST TO THE OWNER.

G. ALL AREAS ADJACENT TO THE SITE SHALL BE MAINTAINED IN A CLEAN CONDITION, MUD AND DUST FREE AT ALL TIMES.

June 2017

This set of Record Documents consists of corrected plans showing the reported location of the work, conforming to the construction record provided by the Contractor. Where the information submitted by the Contractor is not incorporated by the Landscape Architect into the Record Documents is assumed to be reliable, the Landscape Architect has not verified the accuracy and/or completeness of the information and shall not be responsible for reliance on or on any other information incorporated herein as a result. Those relying on these Record Documents are advised to obtain independent verification of their accuracy before applying it for any purpose.

	EXISTING CONCRETE PAVING – SEE KEYED NOTE #3.
	EXISTING TURF TO BE REMOVED – SEE KEYED NOTE #17.
	EXISTING COBBLE TO BE REMOVED – SEE KEYED NOTE #4.
	EXISTING PLANTINGS AND MULCH TO BE REMOVED – SEE KEYED NOTE #10.
	EXISTING COBBLE TO REMAIN
	EXISTING CRUSHER FINES TO BE REMOVED – SEE KEYED NOTE #12.
	EXISTING TURF TO REMAIN – SEE KEYED NOTE #5.
	EXISTING AREA TO BE CLEARED AND GRUBBED – SEE KEYED NOTE #8.
	EXISTING MOWCURE TO BE REMOVED – SEE KEYED NOTE #1.

1. REMOVE AND DISPOSE OF EXISTING 6" CONCRETE MOWCURB.
2. REMOVE AND DISPOSE OF BENCH. GRIND BOLTS TO BE FLUSH WITH TOP OF CONCRETE.
3. REMOVE AND DISPOSE EXISTING CONCRETE PAD.
4. REMOVE AND SALVAGE EXISTING COBBLE FOR RE-USE.
5. EXISTING TURF GRASS TO REMAIN.
6. REMOVE AND SALVAGE EXISTING PLAYGROUND EXERCISE EQUIPMENT.
7. EXISTING RETAINING WALL TO REMAIN.
8. CONTRACTOR SHALL CLEAR AND GRUB NATURAL AND MAN MADE OBJECTIONABLE MATERIAL, DISPOSE OF DEBRIS AND DELIVER SALVAGEABLE ITEMS AS REQUIRED AND AS NOTED PER PLAN.
9. REMOVE AND RELOCATE EXISTING BOULDER.
10. REMOVE EXISTING PLANTINGS AND GRAVEL MULCH.
11. REMOVE AND SALVAGE EXISTING SIGN.
12. REMOVE AND DISPOSE EXISTING CRUSHER FINES.
13. EXISTING LIGHT POLE TO REMAIN.
14. REMOVE AND SALVAGE EXISTING VALVE AND VALVE BOX.
15. EXISTING VALVE AND VALVE BOX TO REMAIN.
16. CUT AND CAP EXISTING LATERAL LINE IN PLACE. SEE DEMOLITION GENERAL NOTES A AND B.
17. EXISTING TURF GRASS TO BE REMOVED.
18. EXISTING TREE TO BE REMOVED.
19. EXISTING FENCE PANEL TO BE REMOVED AND RELOCATED TO CURRENT OPENING OF GATE ENTRANCE TO PARK.
20. EXISTING TREE TO REMAIN.
21. EXISTING MOW CURB TO REMAIN.

[illegible]

AS-BUILT DRAWINGS
DATE: JUNE 7, 2017

ALAMOSA SKATE PARK

DATE 1/03/2017
PROJECT# 658780

RECORD DRAWINGS
DATE: 06/07/2017

(A1) DEMOLITION PLAN
SCALE: 1"=20'-0"

SCALE: 1"=20'-0"

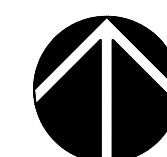

- A. GRADING OF BERMS IS SHOWN APPROXIMATELY. REVIEW GRADING, SHAPING AND LOCATION OF BERMS IN THE FIELD WITH LANDSCAPE ARCHITECT PRIOR TO FINAL INSTALLATION.
- B. CONTRACTOR SHALL REVIEW POTENTIAL PONDING AREAS WITH LANDSCAPE ARCHITECT FOR DETERMINATION OF ANY ADJUSTMENTS TO BERM LOCATION AND CONFIGURATION.
- C. BOTTOM OF BERM ELEVATION SHALL BE TOP OF EXISTING FINISH GRADE.
- D. CONTOURS SHOWN FOR BERMS REPRESENT A 1'-0" RISE IN ELEVATION. NO CONTOURS SHOWN ON THIS PLAN REPRESENT DEPRESSIONS.
- E. GRADES SHALL BE VERIFIED BY SURVEYOR PRIOR TO ANY INSTALLATION OF CONSTRUCTION ITEMS.
- F. ALL EXISTING AND PROPOSED GRADES SHALL BE FIELD VERIFIED BY A SURVEYOR PRIOR TO CONSTRUCTION.

FG	FINISH GRADE
TW	TOP OF WALK
TCW	TOP OF CONCRETE WALL
TRW	TOP READY-ROCK WALL
TMC	TOP OF MOWCURB
ETCW	TOP OF EXISTING CONCRETE WALL
ME	MATCH EXISTING

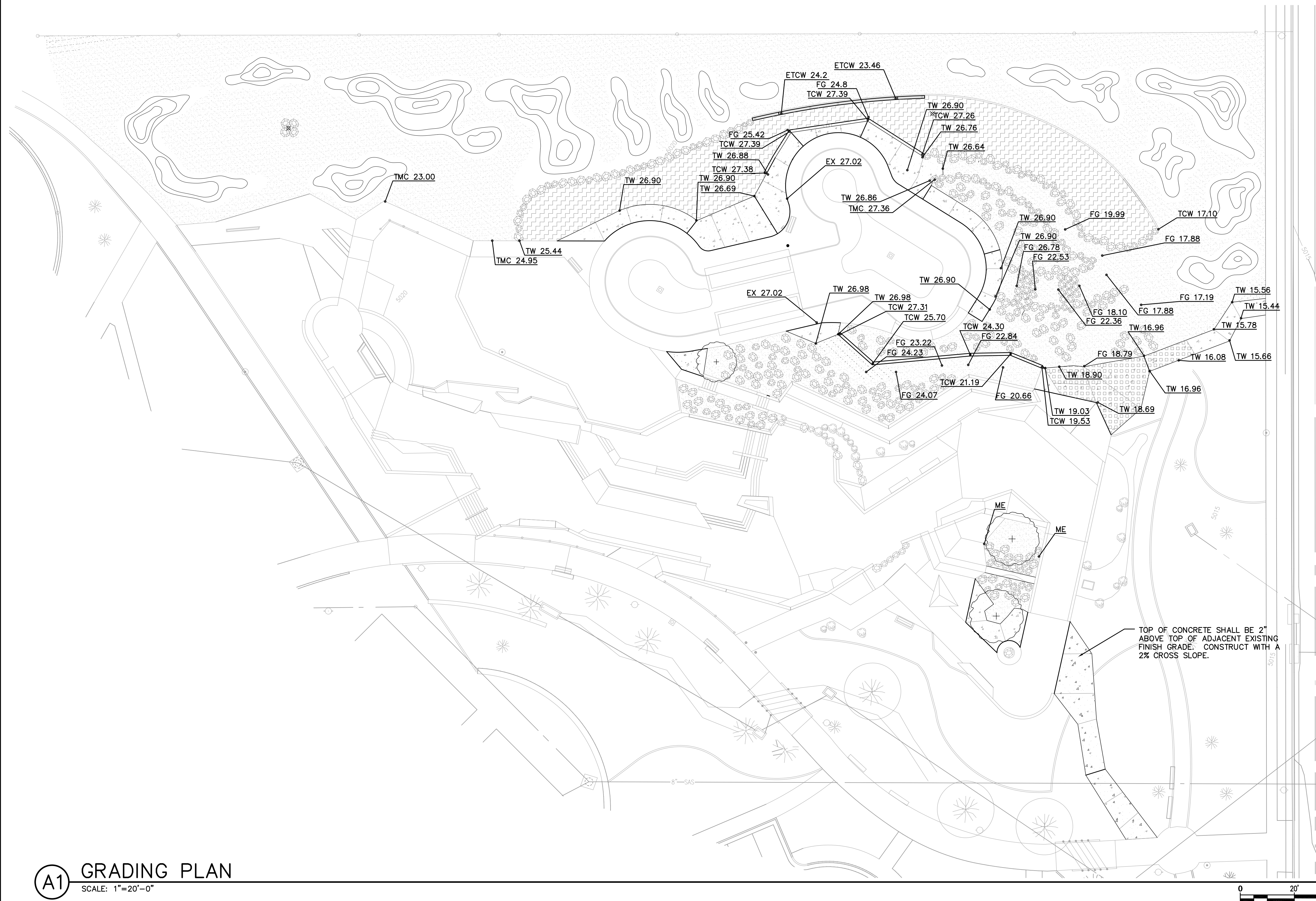

RECORD DRAWINGS June 2017

This set of Record Documents consists of corrected plans showing the reported location of the work, conforming to the construction records provided by the Contractor. While the information submitted by the Contractor and incorporated by the Landscape Architect into the Record Documents is assumed to be reliable, the Landscape Architect has not verified the accuracy and/or completeness of the information and shall not be responsible for any errors or omissions which may be discovered. As a result, users relying on these Record Documents are advised to obtain independent verification of their accuracy before applying it for any purpose.



LANDSCAPE ARCHITECTS
Morrow Reardon Wilkinson Miller, Ltd.
mrwmla.com 505 268 2266

CITY OF ALBUQUERQUE
STRATEGIC PLANNING AND DESIGN
PARKS AND RECREATION DEPARTMENT

ALAMOSA SKATE PARK
GRADING PLAN

Design Review Committee

City Engineer Approval

Last Design Update

Mo./Day/Yr.

Mo./Day/Yr.

City Project No.
658

Zone Map No.	K-11
--------------	------

Sheet 4 of 3

AS-BUILT DRAWINGS
DATE: JUNE 7, 2017

ALAMOSA SKATE PARK

DATE 1/03/2017
PROJECT# 658780

RECORD DRAWINGS
DATE: 06/07/2017

CONSTRUCTION KEYED NOTES

1. CONSTRUCT BMX SURFACE BERM PER DETAIL 2/8 AND CONSTRUCTION GENERAL NOTE A.
2. CONSTRUCT RETAINING WALL PER DETAIL 3/8.
3. CONSTRUCT BOULDER EDGER TO ACCOMMODATE GRADE CHANGES.
4. CONSTRUCT 4" DEPTH CONCRETE PAVING PER DETAIL 8/8. CONTROL JOINTS SHALL BE SAWCUT AND JOINTS BETWEEN POURS SHALL BE KEYWAY JOINTS AS SHOWN ON PLAN. DOWEL JOINTS SHALL BE INSTALLED WHERE NEW CONCRETE ABUTS EXISTING. CONSTRUCT THICKENED EDGE PER DETAIL 7/8.
5. CONSTRUCT BOULDER STEP FEATURES.
6. CONSTRUCT STONE STEPS PER DETAIL 1/8.
7. INSTALL PLATED RE-USED COBBLE. GROUT SOLID ALL SPACES BETWEEN COBBLE THROUGHOUT.
8. INSTALL REMOVED EXISTING FENCE PANEL.
9. EXISTING TREE TO REMAIN.
10. EXISTING LIGHT POLE TO REMAIN.
11. NATURAL DIRT SURFACE. CONTRACTOR SHALL WATER AND COMPACT EXISTING DIRT SURFACE TO A UNIFORM GRADE. SURFACE SHALL BE FREE OF ROCKS, VOIDS, ROOTS, VEGETATION, TRASH OR OTHER MISCELLANEOUS MATERIAL THAT PREVENTS LEVEL COMPACTION.
12. KEY WAY JOINT SEE DETAIL 6/8.
13. SAWCUT JOINT SEE DETAIL 8/8.
14. DOWELED JOINT SEE DETAIL 7/8.
15. 1" DIAMETER EYE BOLTS ANCHORED INTO TOP OF CONCRETE RETAINING WALL.
16. EXISTING MOWCUBS TO REMAIN.
17. INSTALL 18-27" OF BOULDER. INSTALL TO A MINIMUM BURY DEPTH OF 8".
18. INSTALL RELOCATED COBBLE.
19. CONSTRUCT 6" DEPTH CONCRETE PAVING ON SLOPE PER DETAIL 9/8. CONTROL JOINTS SHALL BE SAWCUT AND JOINTS BETWEEN POURS SHALL BE KEYWAY JOINTS AS SHOWN ON PLAN. DOWEL JOINTS SHALL BE INSTALLED WHERE NEW CONCRETE ABUTS EXISTING. CONSTRUCT EDGE SIMILAR PER DETAIL 7/8.

CONSTRUCTION GENERAL NOTES

- A. COMPACTED DIRT BMX SURFACE SHALL BE A "ROCK FREE LOAM HAVING A COMPOSITION OF 80% CLAY AND 20% SAND". SURFACING SHALL BE INSTALLED AND COMPACTED IN 6" LIFTS. MATERIALS SHALL BE UNIFORMLY MIXED WITH MINIMAL CLODS.

HATCH LEGEND

- 4" THICK CONCRETE - SEE KEYED NOTE #4.
- CONCRETE PAVEMENT WITH CONCRETE COBBLE THROUGHOUT - SEE KEYED NOTE #7.
- NATURAL DIRT SURFACE - SEE KEYED NOTE #11.
- BMX SURFACE BERM - SEE KEYED NOTE #1.
- RELOCATE SALVAGED COBBLE.
- 6" THICK CONCRETE - SEE KEYED NOTE #19.



RECORD DRAWINGS June 2017

This set of Record Documents consists of corrected plans showing the reported location of the work, conforming to the construction records provided by the Contractor. While the information submitted by the Contractor and incorporated by the Landscape Architect into the Record Documents is assumed to be reliable, the Landscape Architect has not verified the accuracy and/or completeness of the information and shall not be responsible for any errors or omissions which may be incorporated herein as a result. Those relying on these Record Documents are advised to obtain independent verification of their accuracy before applying it for any purpose.

MRWM
LANDSCAPE ARCHITECTS
Morrow Reardon Wilkinson Miller, Ltd.
mrwmia.com 505 268 2266



CITY OF ALBUQUERQUE
STRATEGIC PLANNING AND DESIGN
PARKS AND RECREATION DEPARTMENT

ALAMOSA SKATE PARK
CONSTRUCTION PLAN

Design Review Committee

City Engineer Approval

Last Design Update

Mo./Day/Yr.

Mo./Day/Yr.

City Project No.
658780

Zone Map No.
K-11

Sheet
5 of 8

NO. BY DATE

DATE

DATE

DATE

DATE

DATE

DATE

BENCH MARKS

AS-BUILT INFORMATION

CONTRACTOR

DATE

DATE

DATE

DATE

DATE

DATE

ARCHITECTURAL SEAL

REVISIONS

REMARKS

BY

DATE

DATE

DATE

DATE

DATE

NO. DATE

DATE

DATE

DATE

DATE

DATE

DATE

DATE

AS-BUILT INFORMATION

CONTRACTOR

DATE

DATE

DATE

DATE

DATE

DATE

AS-BUILT DRAWINGS

DATE: JUNE 7, 2017

DATE: JUNE 7, 2017

DATE: JUNE 7, 2017

DATE: JUNE 7, 2017

DATE: JUNE 7, 2017

DATE: JUNE 7, 2017

DATE: JUNE 7, 2017

RECORD DRAWINGS

DATE: 06/07/2017

DATE: 06/07/2017

DATE: 06/07/2017

DATE: 06/07/2017

DATE: 06/07/2017

DATE: 06/07/2017

DATE: 06/07/2017

PROJECT# 658780

PROJECT# 658780

PROJECT# 658780

PROJECT# 658780

PROJECT# 658780

PROJECT# 658780

PROJECT# 658780

PROJECT# 658780

.....	EXISTING MAINLINE.		PRESSURE COMPENSATING BUBBLER ASSEMBLIES, RAINBIRD 1400 SERIES WITH CHECK VALVE AND RWS. INSTALL AS FOLLOWS:
-----	LATERAL PIPING, SCH. 40, BELL END, SOLVENT WELD PVC, SIZE AS SHOWN ON PLAN. DEPTH OF BURY, 18". LATERAL PIPE CONVEYING LESS THAN 5 GPM SHALL BE 3/4".		MODEL NO. GPM PSI
		•	RWS-B-C-1401 .25 30
		◆	RWS-B-C-1402 .50 (2 PER VERTICAL SHRUB) 30 REFERENCE DETAIL 5/8
		▲	RWS-B-C-1402 .50 (3 PER TREE) 30 REFERENCE DETAILS 4/8
④	EXISTING VALVE.	┐	SOLVENT WELD PVC CAP, SIZE PER LINE SIZE.
		[C]	EXISTING CONTROLLER TO BE RELOCATED.
		△	EXISTING BUBBLERS AT EXISTING TREE TO BE RE-USED. TIE INTO EXISTING LATERAL PER PLAN.

- A. CONTRACTOR SHALL FURNISH ALL LABOR, MATERIALS AND EQUIPMENT NECESSARY TO CONSTRUCT PROPOSED IRRIGATION SYSTEM IN ACCORDANCE WITH PLANS, WRITTEN SPECIFICATIONS AND DETAILS.
- B. FOR PVC IRRIGATION PIPING AND EQUIPMENT REFERENCE SPECIFICATION SECTION 1001 - LANDSCAPE IRRIGATION SYSTEM.
- C. IRRIGATION MAIN AND LATERAL LINES ARE SHOWN SCHEMATICALLY.
- D. UNLESS OTHERWISE NOTED ON THE PLAN, ANY IRRIGATION EQUIPMENT SHOWN IN LANDSCAPE AREAS IS FOR GRAPHIC CLARITY ONLY. ALL EQUIPMENT SHALL BE LOCATED IN ADJACENT OPEN AREAS.
- E. VALVE BOXES IN MULCH AREAS SHALL BE TANK WITH TAN BOLT-DOWN LIDS.
- F. IRRIGATION SYSTEM WAS DESIGNED AT A MINIMUM STATIC PRESSURE OF 60 PSI AT THE POINT OF CONNECTION. CONTRACTOR SHALL VERIFY ACTUAL PSI AND DELIVER RESULTS TO LANDSCAPE ARCHITECT PRIOR TO CONSTRUCTION. IN THE EVENT THE ACTUAL PSI IS LESS THAN 60 PSI THE CONTRACTOR SHALL RECEIVE DIRECTION FROM LANDSCAPE ARCHITECT REGARDING DESIGN MODIFICATIONS IF NECESSARY.

1. EXISTING CONTROLLER. PROVIDE PULL BOX AT THIS LOCATION FOR SPLICED WIRES.
2. NEW LOCATION OF EXISTING CONTROLLER.
3. TIE INTO EXISTING LATERAL LINE WITH NEW LATERAL LINE TO FEED EXISTING BUBBLERS.



Diagram illustrating the components of a valve identification tag:

- Valve ID Number (V-1)
- Valve Size (1")
- Valve Gallons Per Minute (25.5-GPM)

RECORD DRAWINGS June 2017

This set of Record Documents consists of corrected plans showing the reported location of the work, conforming to the construction records provided by the Contractor. While the information submitted by the Contractor and incorporated by the Landscape Architect into the Record Documents is assumed to be reliable, the Landscape Architect has not verified the accuracy and/or completeness of the information and shall not be responsible for any errors or omissions which may be incorporated herein as results. Those relying on these Record Documents are advised to obtain independent verification of their accuracy before applying it for any purpose.



LANDSCAPE ARCHITECTS
Morrow Reardon Wilkinson Miller, Ltd.
mrwmla.com 505 268 2266



CITY OF ALBUQUERQUE
STRATEGIC PLANNING AND DESIGN
PARKS AND RECREATION DEPARTMENT

ALAMOSA SKATE PARK
IRRIGATION PLAN

Design Review Committee

City Engineer Approval

Last Design Update

Mo./Day/Yr.

--	--

--	--

--	--

Sheet

--	--

City Project No. 658

Zone Map No.
K-11

Sheet

6 of 8

(A1) IRRIGATION PLAN
SCALE: 1"=20'-0"

SCALE: 1"=20'-0"

AS-BUILT DRAWINGS
DATE: JUNE 7, 2017

ALAMOSA SKATE PARK

DATE 1/05/2017
PROJECT# 658780

RECORD DRAWINGS
DATE: 06/07/2017

PLANTING NOTES

- A. IN CASE OF DISCREPANCY IN PLANT QUANTITIES SHOWN ON THE PLANT LEGEND AND THOSE SHOWN ON THE PLANTING PLAN, THE QUANTITIES SHOWN ON THE PLAN SHALL GOVERN. CONTRACTOR SHALL VERIFY ALL QUANTITIES PRIOR TO BID AND INSTALLATION. NO ADDITIONAL PAYMENT WILL BE MADE FOR ANY DISCREPANCIES IN QUANTITIES BETWEEN THE PLANTING PLAN AND THE PLANT LIST.
- B. CONTRACTOR SHALL PRUNE LOWER BRANCHES OF DECIDUOUS TREES AS DIRECTED BY LANDSCAPE ARCHITECT IN THE FIELD.
- C. TREES SHALL BE INSTALLED PER COA DETAIL #2714.
- D. SHRUBS SHALL BE INSTALLED PER COA DETAIL #2716.
- E. IF THERE IS A DISCREPANCY IN THE FIELD OR NURSERY BETWEEN THE CONTAINER SIZE CALLED OUT UNDER "REMARKS" AND HEIGHT & SPREAD CALLED OUT UNDER "SIZE", THE SPECIFIED PLANT MUST MEET HEIGHT & SPREAD REQUIREMENTS SPECIFIED UNDER "SIZE", EVEN IF A LARGER CONTAINER SIZE IS REQUIRED TO MEET THESE SPECIFICATIONS, AT NO ADDITIONAL COST TO THE OWNER.
- F. TREES INSTALLED WITHIN COMPACTED DIRT BMX SURFACE AREAS SHALL HAVE A 4" DEPTH OF SHREDDED WOOD MULCH WITHIN A 6' DIAMETER AREA AT THE BASE OF EACH TREE.

PLANT LEGEND

COMMON NAME	BOTANICAL NAME	QTY	INSTALLED SIZE	REMARKS	MATURE SIZE
TREES					
COLUMNAR OAK	QUERCUS ROBUR 'FASTIGIATA'	6	6'-8' HT.	B&B	25' HT. X 10' SPD.
LACEBARK ELM	ULMUS PARVIFOLIA 'EMER II' (ALLEE)	6	2" CA., 12'-14' HT.	B&B	30' HT X 25' SPD.
SENSATION BOX ELDER	ACER NEGUNDO 'SENSATION'	6	2" CAL., 10'-12' HT.	24" BOX	30' HT. X 25' SPD.
SKYROCKET JUNIPER	JUNIPERUS 'SKYROCKET'	6	6'-8' HT.	15 GA, MULTI	15' HT. X 8' SPD.
SHRUBS/GROUNDCOVERS/GRASSES/PERENNIALS					
APACHE PLUME	FALLUGIA PARADOXA	0	MIN. 18" HT.	5 GALLON	5' HT. X 5' SPD.
BEAR GRASS	NOLINA TEXANA	18	MIN. 18" HT.	5 GALLON	3' HT. & SPD.

HATCH LEGEND

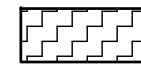
 EXISTING COBBLE TO REMAIN



A1 PLANTING PLAN
SCALE: 1"=20'-0"

RECORD DRAWINGS June 2017
This set of Record Documents consists of corrected plans showing the reported location of the work, conforming to the construction records provided by the Contractor. While the information submitted by the Contractor and incorporated by the Landscape Architect into the Record Documents is assumed to be reliable, the Landscape Architect has not verified the accuracy and/or completeness of the information and shall not be responsible for any errors or omissions which may be incorporated herein as a result. Those relying on these Record Documents are advised to obtain independent verification of their accuracy before applying it for any purpose.

 MRWM LANDSCAPE ARCHITECTS Morrow Reardon Wilkinson Miller, Ltd. mrwmia.com 505 268 2266	
 CITY OF ALBUQUERQUE STRATEGIC PLANNING AND DESIGN PARKS AND RECREATION DEPARTMENT	
ALAMOSA SKATE PARK PLANTING PLAN	
Design Review Committee	City Engineer Approval
City Project No. 658780	Zone Map No. K-11
Sheet 7 of 8	RECORD DRAWINGS DATE: 06/07/2017

ARCHITECTURAL SEAL		SURVEY INFORMATION		BENCH MARKS		AS-BUILT INFORMATION		
		FIELD NOTES						
		NO.	BY					DATE
REVISIONS		REMARKS		BY		MICRO-FILM INFORMATION		
DESIGNED BY: GM		DATE 1/05/2017						
DRAWN BY: AT		DATE 1/05/2017						
CHECKED BY: GM		DATE 1/05/2017						

AS-BUILT DRAWINGS
DATE: JUNE 7, 2017

ALAMOSA SKATE PARK

PROJECT# 658780

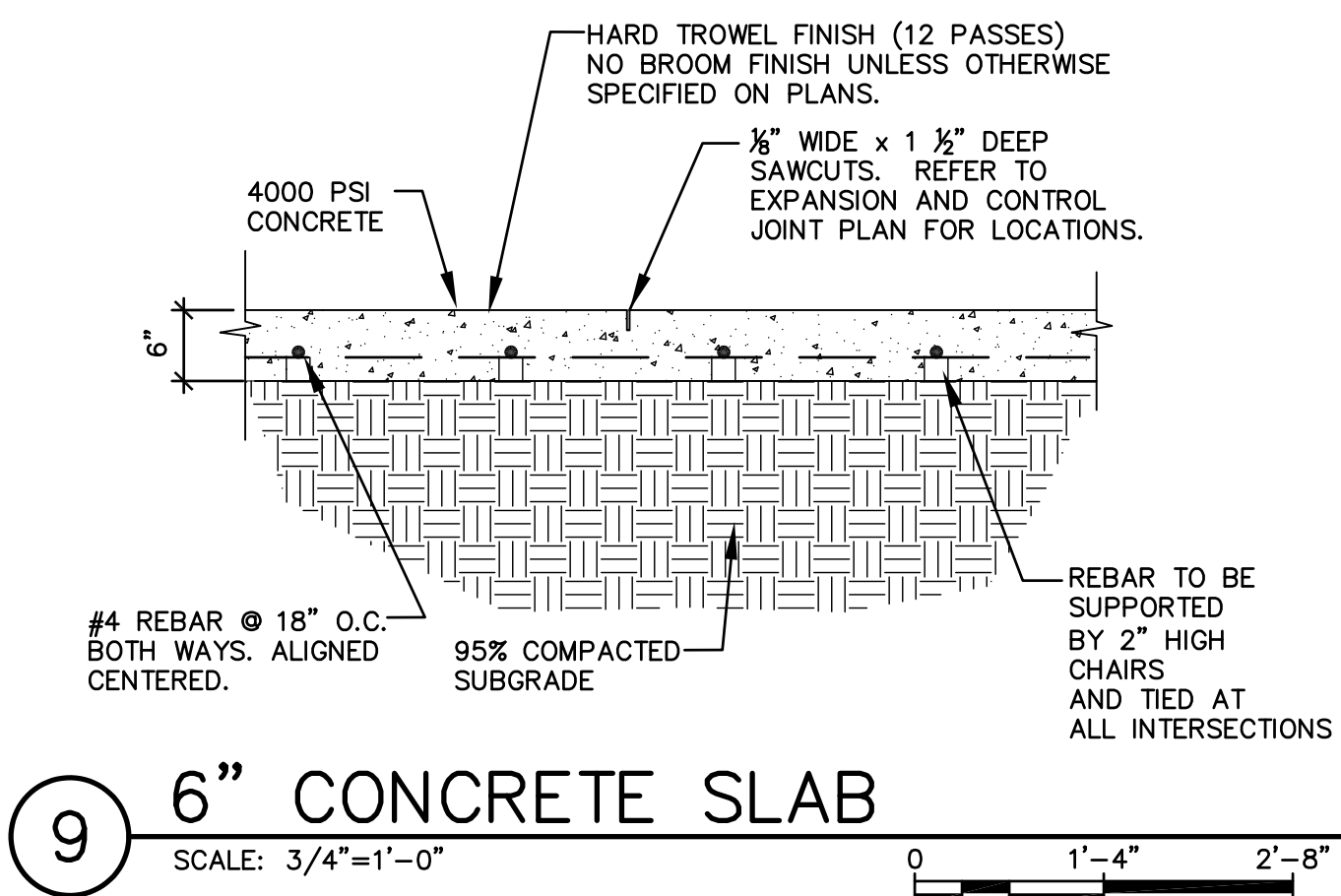

9 6" CONCRETE SLAB
SCALE: 3/4"=1'-0"

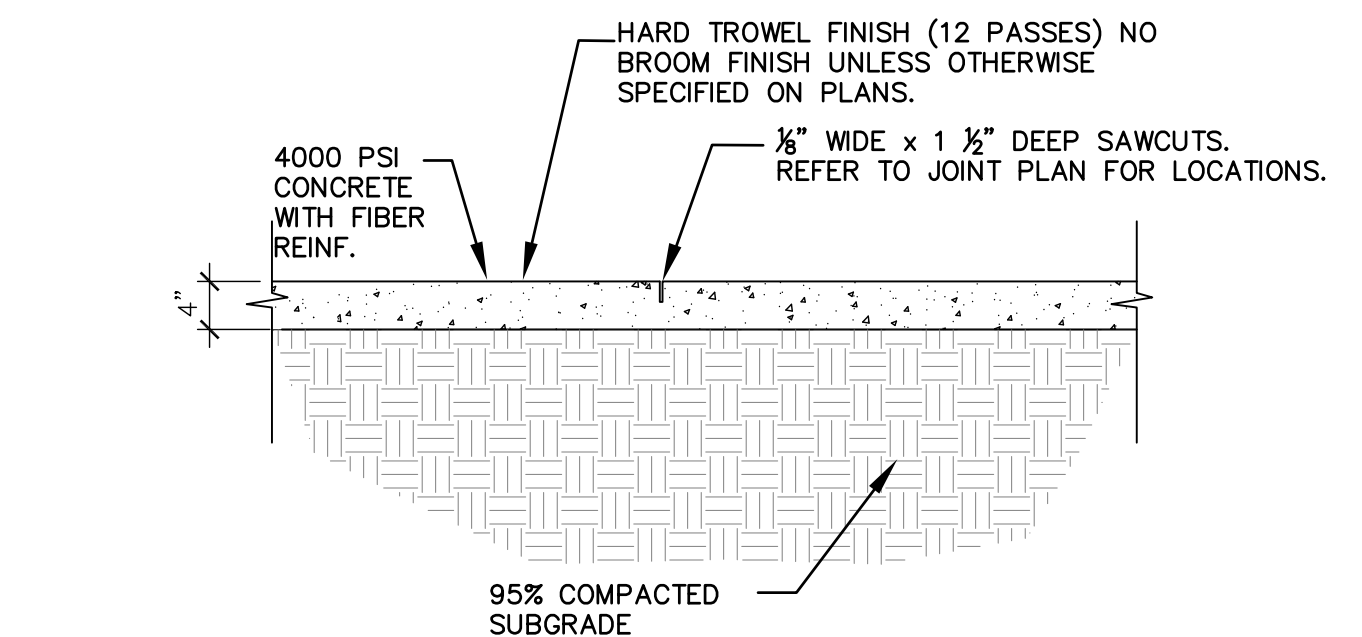

4 4" CONCRETE SLAB
SCALE: 3/4"=1'-0"

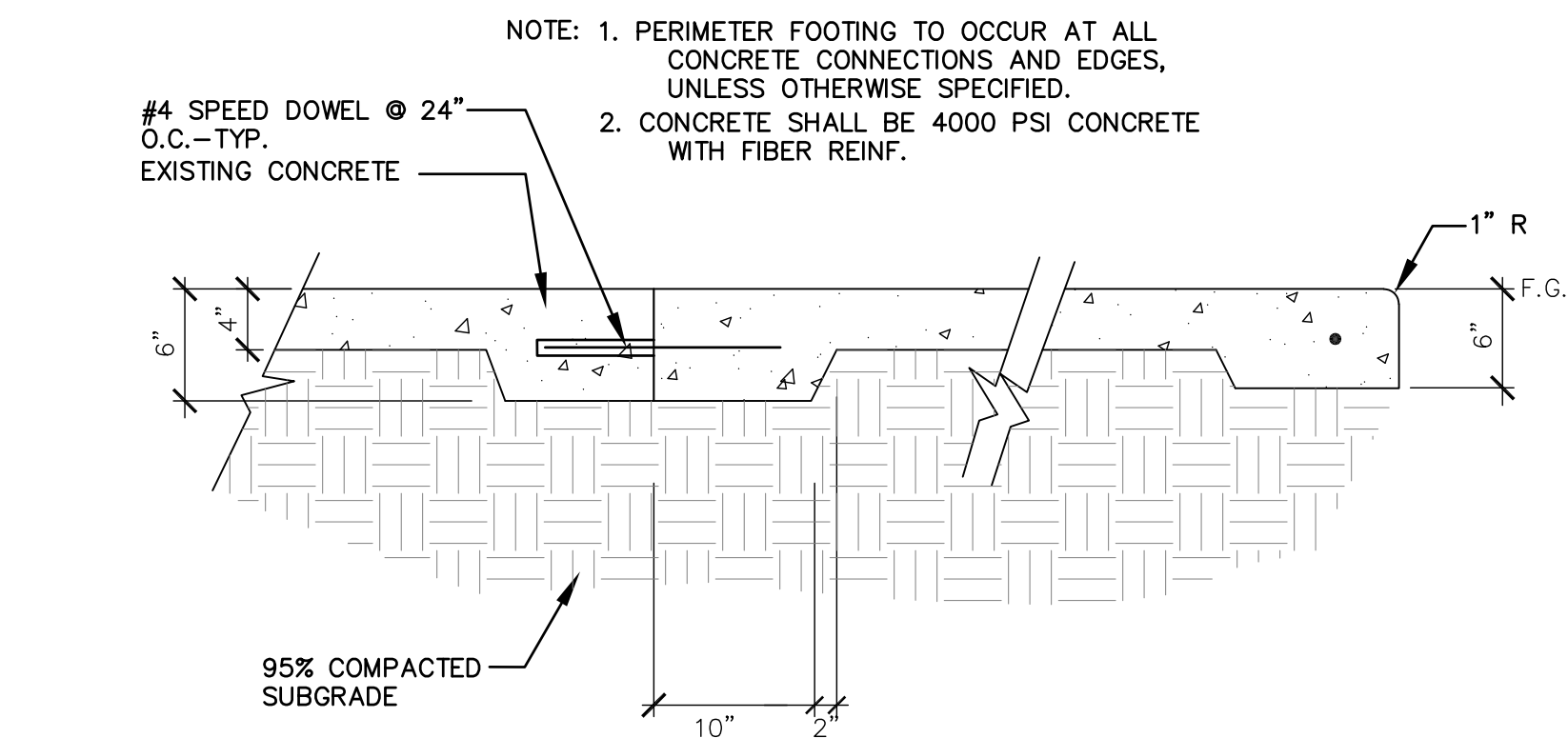

7 DOWEL COLD JOINT AND PERIMETER FOOTING
SCALE: 1"=1'-0"

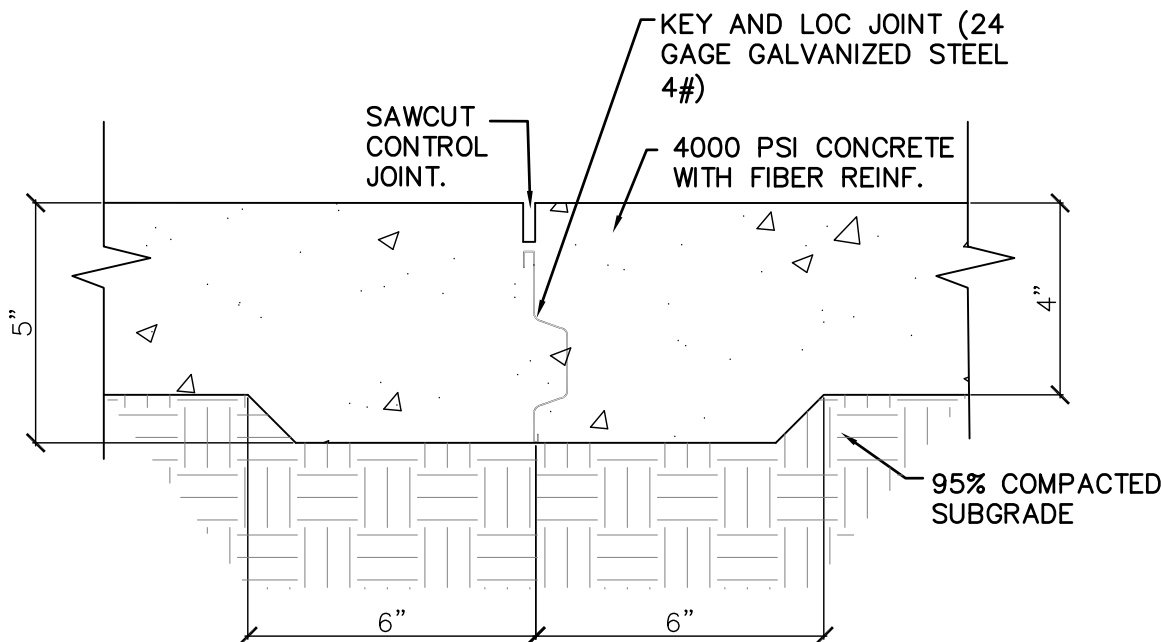

6 KEYWAY JOINT
SCALE: 3"=1'-0"

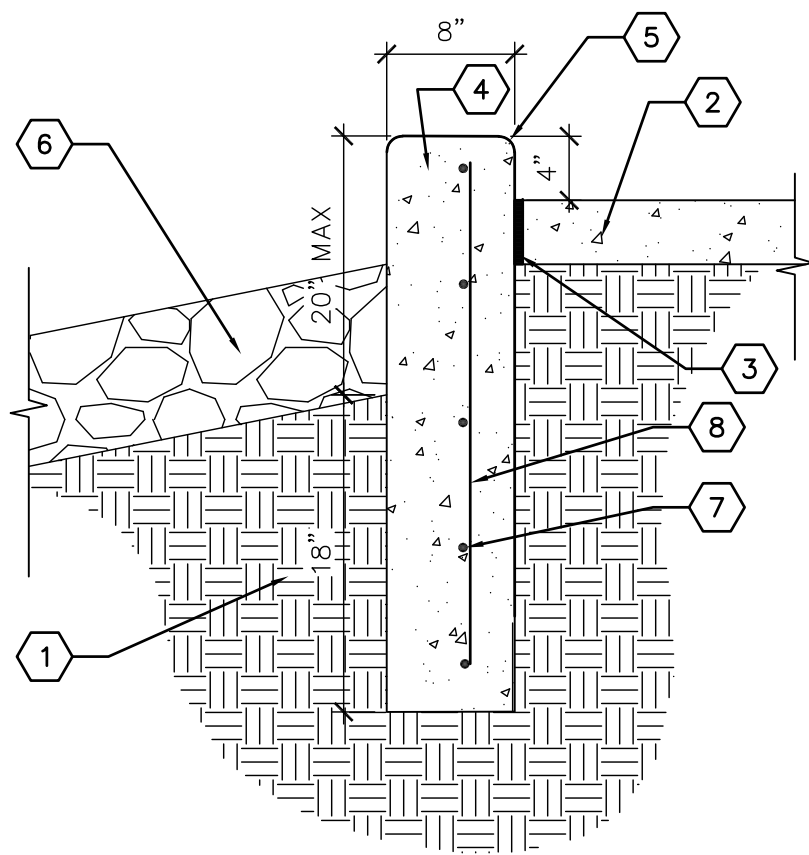

KEYED NOTES

1. COMPACTED SUBGRADE TO 95%
2. CONCRETE PAVING. SEE PLAN.
3. 1/2" FELT EXPANSION JOINT.
4. 3000 PSI CAST-IN-PLACE CONCRETE.
5. TOOLED EDGE, 1/2" RADIUS.
6. EXISTING COBBLE TO REMAIN. SEE PLAN.
7. #4 HORIZONTAL AND CONTINUOUS REBAR AT 12 O.C.
8. #4 VERTICAL REBAR AT 18" O.C. CENTERED IN WALL.

GENERAL NOTES

1. THE FINISH SURFACES OF THE WALLS SHALL BE FREE OF HONEYCOMB PATTERNS AND SHARP OR ROUGH EDGES. EXPOSED, UNIFORMLY-SPACED, SNAP TIE INDENTIONS WILL BE ACCEPTABLE.
2. RUBBING OR PATCHING OF EXPOSED WALL SURFACES IS NOT ACCEPTABLE
3. INSTALL VERTICAL EXPANSION JOINT IN WALL 20' O.C. PER DETAIL D1/LS504.
4. SEE GRADING PLAN FOR TOP AND BOTTOM OF WALL ELEVATIONS.

3 8" WIDE CONCRETE RETAINING WALL
SCALE: 1"=1'-0"

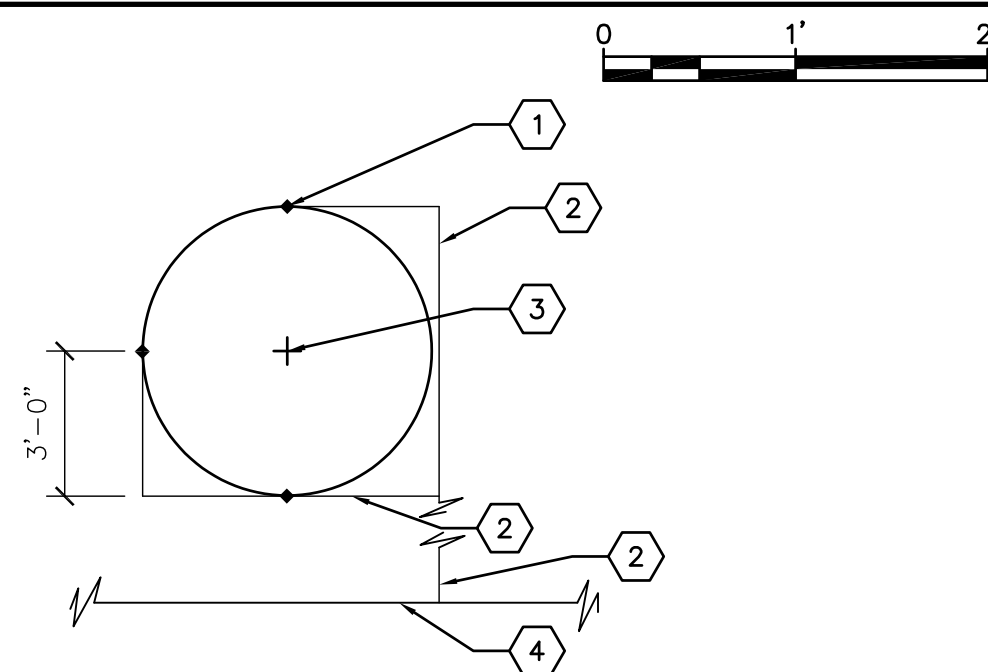

KEYED NOTES

1. BUBBLER - SEE IRRIGATION LEGEND. 3/TREE, TYP.
2. 3/4" LATERAL.
3. TREE CENTER.
4. LATERAL. SEE PLAN.

4 BUBBLER LAYOUT AT TREES
SCALE: N.T.S.

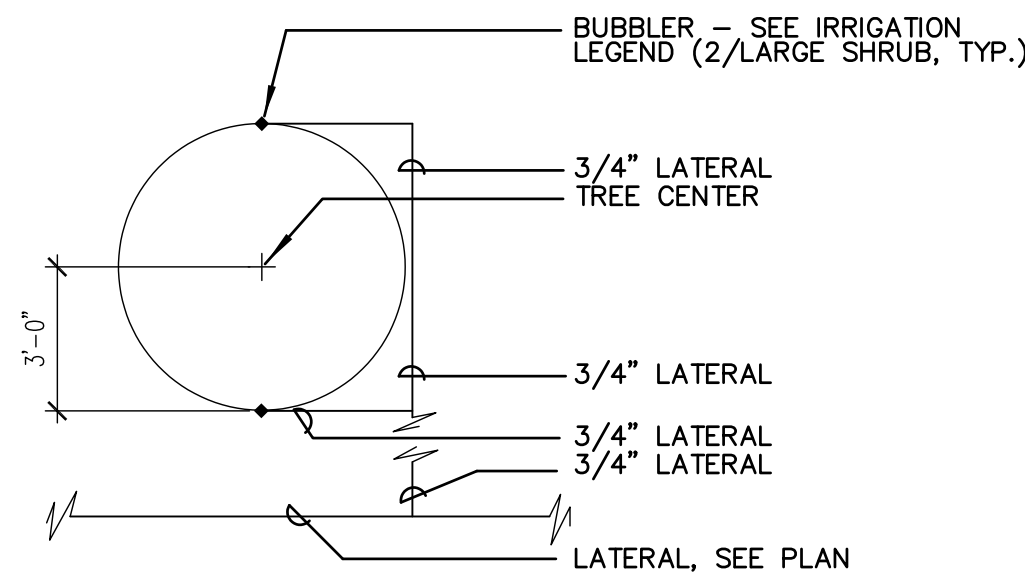

5 BUBBLER LAYOUT AT LARGE SHRUBS
SCALE: 1/4"=1'-0"

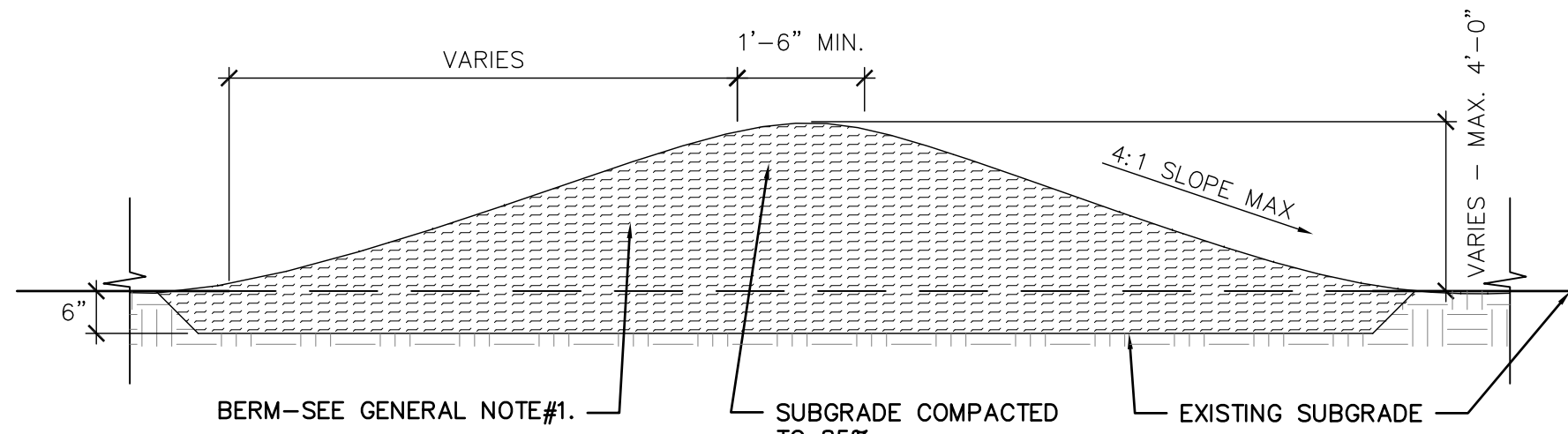

GENERAL NOTES

1. SOIL FOR BERMS SHALL BE BMX SURFACE. SEE CONSTRUCTION GENERAL NOTE A ON SHEET 5.
2. SOIL SHALL BE A ROCK-FREE LOAM HAVING A COMPOSITION OF 80% CLAY AND 20% SAND.
3. BERM LOCATION, GRADING AND CONFIGURATION SHALL BE REVIEWED BY LANDSCAPE ARCHITECT.

2 BERM
SCALE: 1/2" = 1'-0"

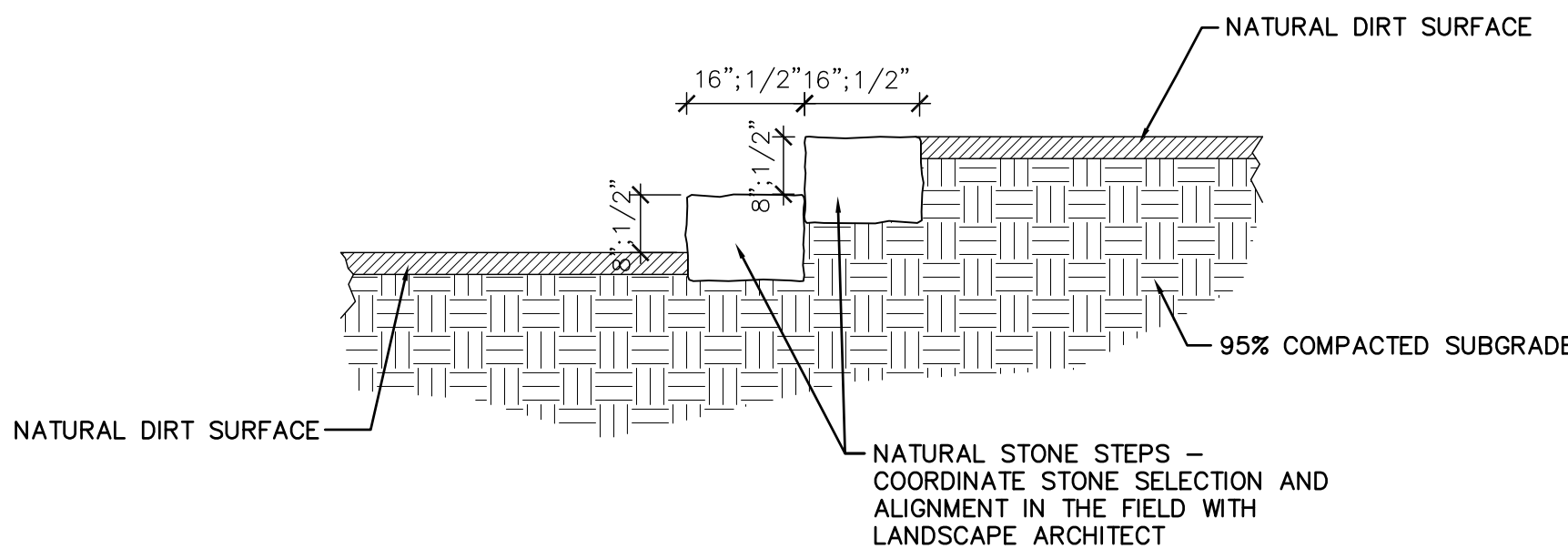

STONE STEPS

SCALE: 1/2" = 1'-0"

RECORD DRAWINGS June 2017
This set of Record Documents consists of corrected plans showing the reported location of the work, conforming to the construction records provided by the Contractor. While the information submitted by the Contractor and incorporated by the Landscape Architect into the Record Documents is assumed to be reliable, the Landscape Architect has not verified the accuracy and/or completeness of the information and shall not be responsible for any errors or omissions which may be incorporated herein as a result. Those relying on these Record Documents are advised to obtain independent verification of their accuracy before applying it for any purpose.

MRWM LANDSCAPE ARCHITECTS Morrow Reardon Wilkinson Miller, Ltd. mrwmla.com 505 268 2266	
CITY OF ALBUQUERQUE STRATEGIC PLANNING AND DESIGN PARKS AND RECREATION DEPARTMENT	
ALAMOSA SKATE PARK CONSTRUCTION DETAILS	
Design Review Committee	City Engineer Approval
City Project No. 658780	Zone Map No. K-11
Sheet 8 of 8	RECORD DRAWINGS DATE: 06/07/2017