

CITY OF ALBUQUERQUE  
NEW MEXICO

CITY PROJECT # 6783-02

CONSTRUCTION PLANS

FOR

VARIOUS TRAILS 2002

INDEX OF SHEETS

DESCRIPTION	SHEET NO.	DESCRIPTION	SHEET NO.
TITLE SHEET & INDEX	1 (29 of 35)	SKYVIEW TRAIL	
VICINITY MAPS, & GENERAL NOTES	2 (30 of 35)	STA. BOP 10+00 TO 18+00	13
ABBREVIATIONS AND LEGEND	3 (31 of 35)	STA. 18+00 TO 26+00	14
TYPICAL SECTIONS		STA. 26+00 TO 34+00	15
BICYCLE TRAIL TYPICAL SECTIONS	4 (32 of 35)	STA. 34+00 TO 42+00	16
PLAN & PROFILE SHEETS		STA. 42+00 TO 50+00	17
ATRISCO TRAIL		STA. 50+00 TO 53+80 EOP	18
STA. BOP 10+00 TO 18+00	5	MISCELLANEOUS DETAILS	
STA. 18+00 TO 21+00	6	EAGLE RANCH TRAIL DETAILS	19
STA. 37+00 TO 42+00 EOP	7	CURB RAMP & DRIVEWAY DETAILS	20
EAGLE RANCH TRAIL		BOLLARD AND STRIPING DETAILS	21
STA. BOP 10+00 TO 18+00	8	RUNDOWN CROSSING AND HANDRAIL DETAILS	22
STA. 18+00 TO 25+78.95	9	MISCELLANEOUS DETAILS	23
STA. 37+00 TO 47+00	10	DETECTABLE WARNING SURFACE	24
STA. 47+00 TO 55+00	11		
STA. 55+00 TO 62+00 EOP	12		

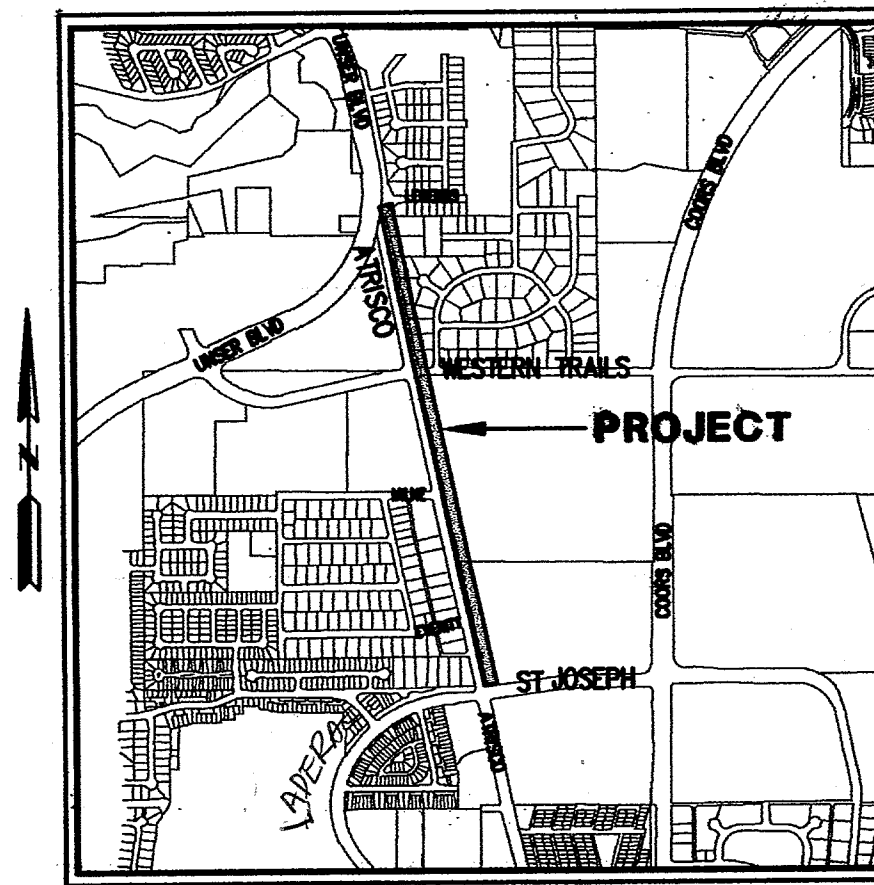

ATRISCO TRAIL LOCATION MAP

SCALE: 1"=375'  
ZONE ATLAS MAP No. F-11 & G-11

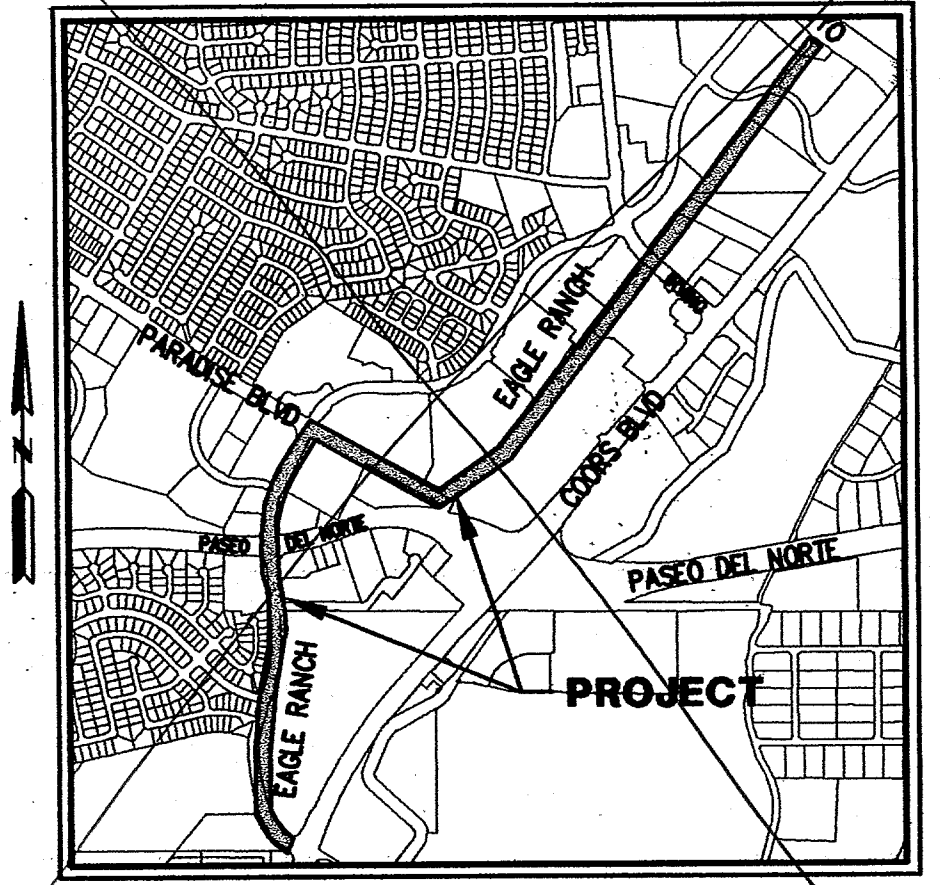

EAGLE RANCH TRAIL LOCATION MAP

SCALE: 1"=375'  
ZONE ATLAS MAP No. C-13

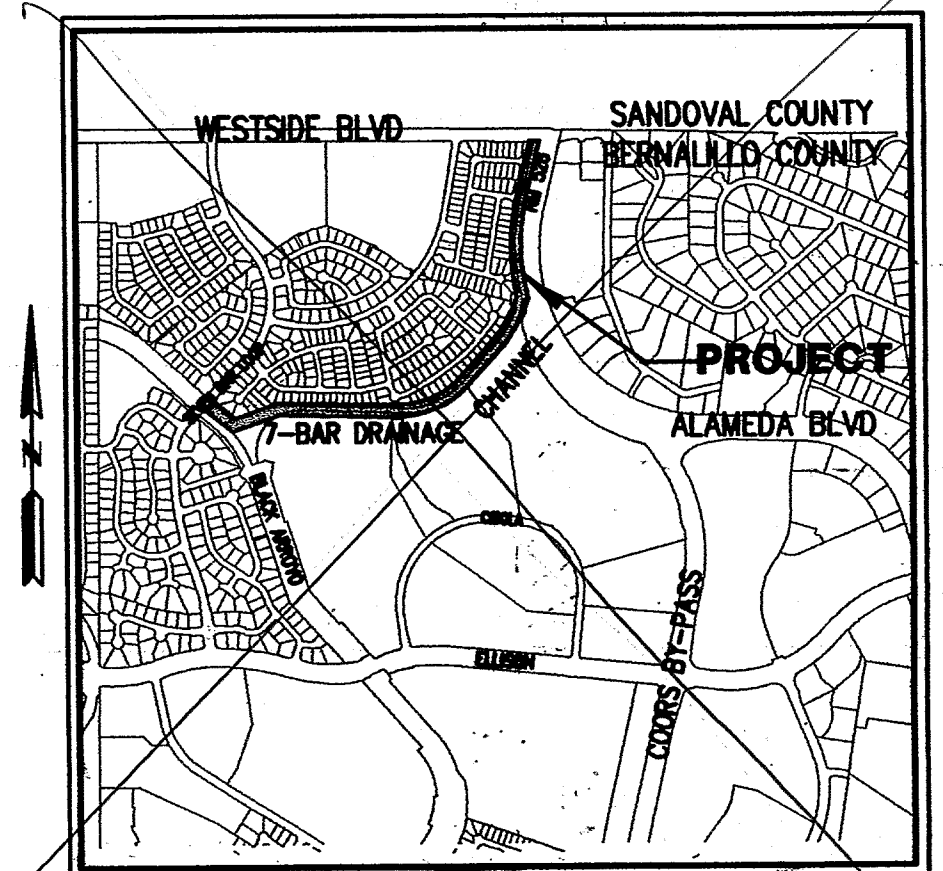

SKYVIEW TRAIL LOCATION MAP

SCALE: 1"=375'  
ZONE ATLAS MAP No. A-13

APPROVED FOR CONSTRUCTION WITHIN  
AMAFCA RIGHT-OF-WAY:

*Signature* 12-13-04  
(FOR AMAFCA) DATE

**LARKIN GROUP INC.**  
CONSULTING ENGINEERS AND SURVEYORS  
8500 MENAUL BLVD. NE A-440  
ALBUQUERQUE, NEW MEXICO 87112  
(505) 275-7500 FAX (505) 275-0748

REV.	SHEETS	CITY ENGINEER	DATE	USER DEPARTMENT	DATE	USER DEPARTMENT	DATE
ENGINEER'S STAMP & SIGNATURE		APPROVALS	ENGINEER	DATE	*****		
		DRC Chairman	<i>Signature</i>	11-02-05	APPROVED FOR CONSTRUCTION		
		Transportation	<i>Signature</i>	9/13/05			
		Water/Wastewater	<i>Signature</i>	6/12/05			
		Hydrology	<i>Signature</i>	1-13-05			
		Parks					
		Constr. Mngmt.			City Engineer <i>Signature</i> 11-02-05 Date		
City Project No.		678302		Sheet 29 Of 35			

SET NUMBER



[illegible]





AC	ASBESTOS CEMENT
ADJUST	ADJUST
ASPH	ASPHALT
BC	BACK OF CURB
BLDG.	BUILDING
BM	BENCH MARK
BOP	BEGINNING OF PROJECT
CATV	CABLE TELEVISION
CF	CUBIC FEET
C & G	CURB AND GUTTER
CH	CHORD
CI	CAST IRON
CIP	CAST IRON PIPE
CL or	CENTERLINE
COA	CITY OF ALBUQUERQUE
CONC	CONCRETE
CULV.	CULVERT
CY	CUBIC YARD
DIA	DIAMETER
DIP	DUCTILE IRON PIPE
DWG.	DRAWING
E	EAST
EA	EACH
EL or ELEV	ELEVATION
ELEC	ELECTRIC
EP	EDGE OF PAVEMENT
EOP	END OF PROJECT
ESMT.	EASEMENT
EX or EXIST	EXISTING
FC	FACE OF CURB
F/F	FACE TO FACE
FG	FINISHED GRADE
FF	FINISHED FLOOR
FH	FIRE HYDRANT
FL or	FLOW LINE
G	GAS LINE
GR	GRADE
H	HEIGHT
HORIZ	HORIZONTAL
L	LENGTH OF ARC
LB	POUNDS
Lc	LENGTH OF CHORD
LF	LINEAR FEET
LT	LEFT
LIN	LINEAR
LIP	LIP OF GUTTER
MAX	MAXIMUM
MH	MANHOLE
MJ	MECHANICAL JOINT
MIN	MINIMUM
MO	MIDDLE ORDINATE
MON	MONUMENT
N	NORTH
OC	ON CENTER
PB	PULLBOX
PC	POINT OF CURVATURE
PCCR	POINT OF COMPOUND CURVATURE
PH	POTHOLE
PI	POINT OF INTERSECTION
PL or	PROPERTY LINE
PP	POWER POLE
PTRC	POINT OF REVERSE CURVATURE
POB	POINT OF BEGINNING
PROP	PROPERTY
PT	POINT OF TANGENCY
PVMT	PAVEMENT
PVC	POLYVINYL CHLORIDE
R	RADIUS
RT.	RIGHT
ROW or R/W	RIGHT OF WAY
SAS	SANITARY SEWER
S	SOUTH
SL	STREET LIGHT
STA	STATION
STD	STANDARD
SY	SQUARE YARD
SW	SIDEWALK
T	TANGENT
TC	TOP OF CURB
TELE	TELEPHONE
TP	TOP OF PIPE
TSPB	TRAFFIC SIGNAL PULLBOX
TYP	TYPICAL
UG	UNDERGROUND
VC	VERTICAL CURVE
VERT	VERTICAL
VF	VERTICAL FOOT
VHP	VERY HIGH PRESSURE
VPC	VERTICAL POINT OF CURVATURE
VPI	VERTICAL POINT OF INTERSECTION
VPT	VERTICAL POINT OF TANGENCY
W or WL	WATER LINE

	EXISTING CONTOUR		EXISTING TRAFFIC SIGNAL
	PROPOSED CONTOUR		PEDESTAL POLE
	EXIST. SPOT ELEVATION		EXISTING TRAFFIC SIGN MASTARM
	PROPERTY LINE/RIGHT-OF-WAY		UTILITY POLE W/ GUY WIRE
	CONSTRUCTION BASELINE		EXISTING/ RELOCATED LIGHT POLE W/ MASTARM
	EASEMENT LINE		EXISTING LIGHT POLE
	FOUND PROPERTY CORNER		EXISTING SIGN
	SURVEY CONTROL POINT		NEW SIGN
	EXISTING CURB & GUTTER		WATER METER
	NEW CURB & GUTTER		GAS RISER
	EDGE OF PAVEMENT		TELEPHONE RISER
	NEW PAVEMENT		TELEVISION RISER
	COLD MIX-IN-PLACE RECYCLING		SPRINKLER/IRRIGATION VALVE
	OVERLAY PAVEMENT		EXIST. PULLBOX
	EDGE OF EXISTING CONCRETE		TRAFFIC SIGNAL PULLBOX
	EXISTING CONCRETE		EXISTING BUSHES
	EXISTING BUILDING		EXISTING TREE
	EXISTING WALL		
	EXISTING BOLLARD		SECTION
	PROPOSED BOLLARD		
	EXISTING SANITARY SEWER LINE		
	EXISTING WATER LINE W/ VALVE & HYDRANT		
	EXISTING GAS LINE W/ VALVE		
	EXISTING OVERHEAD ELECTRIC LINE		
	EXISTING UNDERGROUND ELECTRIC LINE		
	EXISTING UNDERGROUND TELEPHONE LINE		
	EXISTING FENCE		

<div><b>LARKIN GROUP</b>, INC. CONSULTING ENGINEERS AND SURVEYORS 8900 MENAUL BLVD., NE #1-442 ALBUQUERQUE, NEW MEXICO 87112 (505) 275-7200 FAX (505) 275-0748</div>																					
CITY OF ALBUQUERQUE DEPARTMENT OF MUNICIPAL DEVELOPMENT TRANSPORTATION DIVISION																					
VARIOUS TRAILS 2002 ABBREVIATIONS AND LEGEND																					
DESIGN REVIEW COMMITTEE				City Engineer Approval				Mo./Day/Yr.		Mo./Day/Yr.											
<div style="text-align:center;"><b>APPROVED</b> <b>NOV - 2 2005</b> <b>DESIGN REVIEW COMMITTEE</b></div>				<div style="text-align:center;"><b>APPROVED</b> <b>NOV - 2 2005</b> <b>CITY ENGINEER</b></div>																	
Project No.				Zone Map No.				Sheet													
678302								31										35			

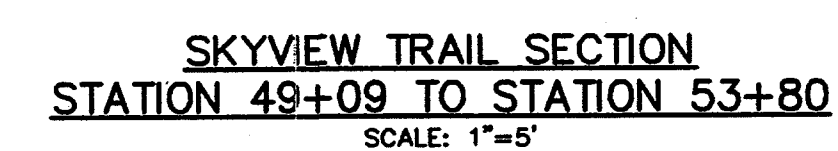
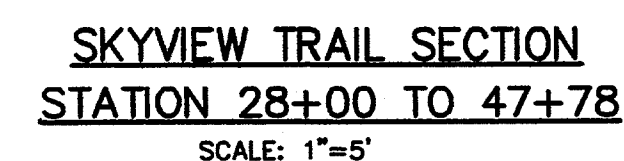
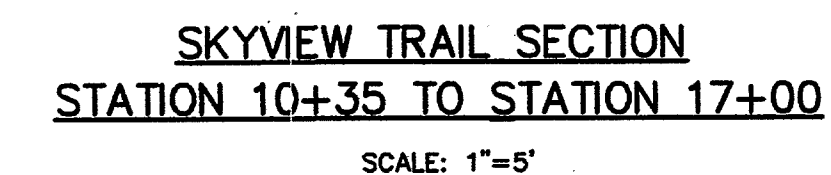
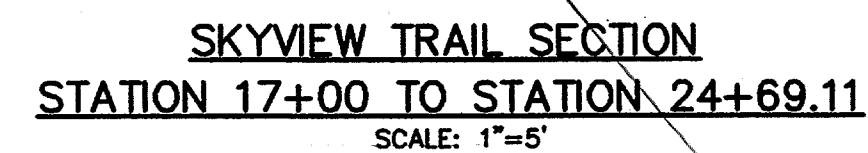
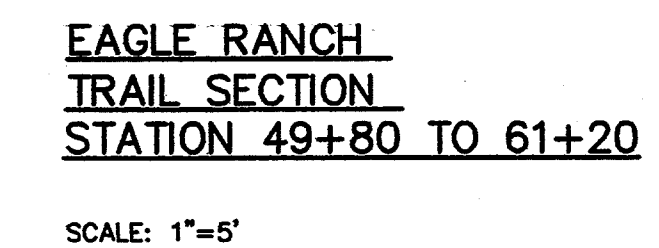
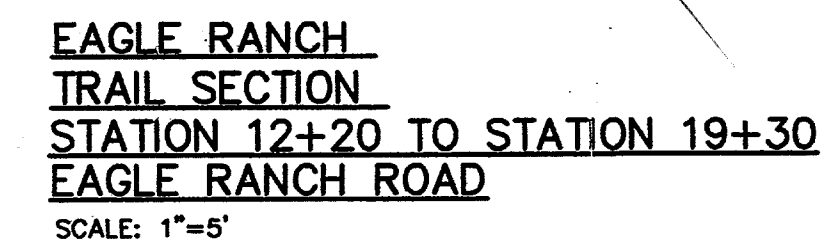
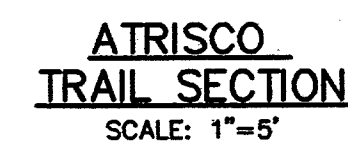



 <b>LARKIN GROUP</b> <small>INC.</small> CONSULTING ENGINEERS AND SURVEYORS 3500 MENAUL BLVD. NE A-440 ALBUQUERQUE, NEW MEXICO 87112 (505) 275-7200 FAX (505) 275-0748	4	3	2	1	NO.	DATE	A R	DESIGNED BY: J.W. DRAWN BY: K.H. CHECKED BY: R.L.
CITY OF ALBUQUERQUE DEPARTMENT OF MUNICIPAL DEVELOPMENT TRANSPORTATION DIVISION  <b>VARIOUS TRAILS</b>  <b>2002</b>  <b>BICYCLE TRAIL TYPICAL SECTIONS</b>								
Design Date: 01/15/03 <div style="border: 2px solid black; padding: 10px; text-align: center;"> <b>APPROVE</b>            NOV - 2 2005            DESIGN          REVIEW COMMITTEE       </div>	City Engineer Approval <div style="border: 2px solid black; padding: 10px; text-align: center;"> <b>APPROVE</b>            NOV - 2 2005            CITY ENGINEER       </div>				Mo./Day/Yr.       	Mo./Day/Yr.       		
Project No. <b>678302</b>		Zone Map No.		Sheet <b>32</b> of <b>35</b>				



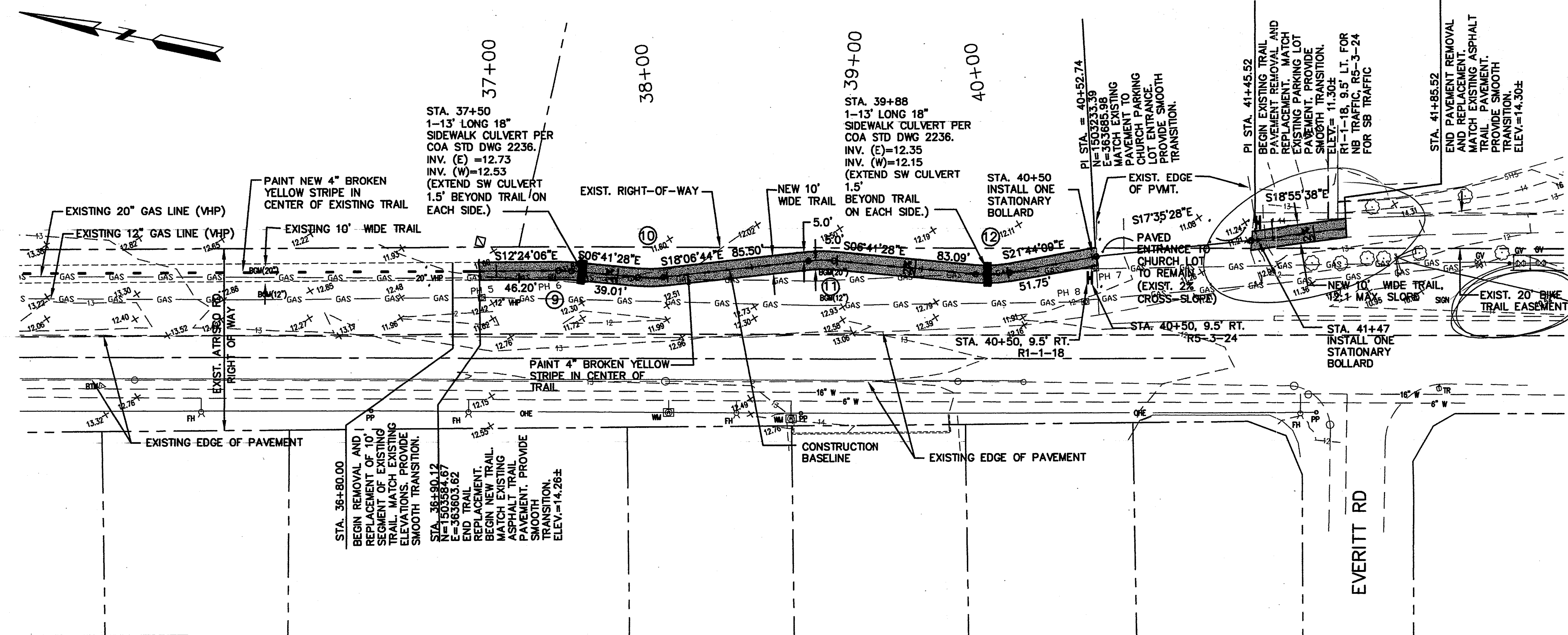

CONSTRUCTION BASELINE CURVE DATA:			
9	$\Delta=5^{\circ}42'39''$ PC STA. 37+36.32 PI STA. 37+40.06 PT STA. 37+43.80 R=75.00' L=7.48' CH=509'32'47"E Lc=7.47'	11	$\Delta=11^{\circ}25'16''$ PC STA. 38+83.25 PI STA. 38+90.75 PT STA. 38+98.20 R=75.00' L=14.95' CH=512'24'06"E Lc=14.93'
10	$\Delta=11^{\circ}25'16''$ PC STA. 37+82.80 PI STA. 37+90.30 PT STA. 37+97.75 R=75.00' L=14.95' CH=512'24'06"E Lc=14.93'	12	$\Delta=15^{\circ}02'41''$ PC STA. 39+81.30 PI STA. 39+91.20 PT STA. 40+00.99 R=75.00' L=19.69' CH=514'12'49"E Lc=19.64'

this is outside the "apparent" RM, what documented permission do we have to construct this? Easement? Still valid?

NOTE OF CAUTION:  
EXISTING VERY HIGH PRESSURE GAS LINES ARE SHALLOW. POTHOLE DATA LISTED ON THESE PLANS IS FOR INFORMATION ONLY. CONTRACTOR SHALL BE RESPONSIBLE FOR VERIFYING THE HORIZONTAL AND VERTICAL GAS LINE LOCATION PRIOR TO INSTALLATION OF BOLLARDS AND SIGN POSTS. MINIMUM HORIZONTAL CLEARANCE BETWEEN THE GAS LINE AND ANY SIGN POST/BOLLARD IS 3'.

ABASTO POTHOLE LOCATIONS				
SYMBOL	UTILITY	DIAMETER	DEPTH TO TP	PAVEMENT THICKNESS
PH 5	GAS (METALLIC)	12"	52"	—
PH 6	GAS (METALLIC)	20"	34"	—
PH 7	GAS (METALLIC)	20"	43"	—
PH 8	GAS (METALLIC)	12"	36"	—

PLAN  
SCALE 1"=40'

ATRISCO TRAIL



PROFILE  
SCALE 1"=40' HORIZ  
1"=5' VERT.

ENGINEER'S SEAL

NO. DATE BY

REMARKS

DESIGN

NO. DATE BY

DESIGNED BY: J.W. DATE: DEC. 2004

DRAWN BY: K.H./P.R. DATE: DEC. 2004

CHECKED BY: R.L. DATE: DEC. 2004

LARKIN GROUP INC.

CONSULTING ENGINEERS AND SURVEYORS

8500 MENAUL BLVD., NE #440

ALBUQUERQUE, NEW MEXICO 87112

(505) 875-7200 FAX (505) 875-0768

CITY OF ALBUQUERQUE

DEPARTMENT OF MUNICIPAL DEVELOPMENT

TRANSPORTATION DIVISION

TITLE: VARIOUS TRAILS 2002

ATRISCO TRAIL PLAN & PROFILE - STA 37+00 TO STA 42+00 EOP

APPROVED NOV - 2 2005

DESIGN REVIEW COMMITTEE

CITY ENGINEER

Project No. 678302 Zone Map No. G-11

Sheet 33 of 35



**PLAN**  
**SCALE: 1" = 10'**

**SKYVIEW TRAIL  
SEVEN BAR LOOP ROAD DRIVEWAY DETAIL**

**PLAN**  
SCALE: 1" = 10'

### ATRISCO/WESTERN TRAIL CURB RAMP DETAIL

**PLAN**  
**SCALE: 1" = 20'**

## SKYVIEW TRAIL WALKWAY CONNECTIONS

**NOTES:**

1. GRADE TO DRAIN FROM SIDEWALK CULVERT TO EXISTING DROP INLET.
2. SEE SHEET 22 FOR INLET REPLACEMENT.

**PLAN**  
**SCALE: 1" = 20'**

**SKYVIEW TRAIL WALKWAY CONNECTIONS**  
**STA. 52+00**

**NOTES:**

1. GRADE TO DRAIN FROM SIDEWALK CULVERT TO EXISTING DROP INLET.
2. SEE SHEET 22 FOR INLET REPLACEMENT.

[illegible]



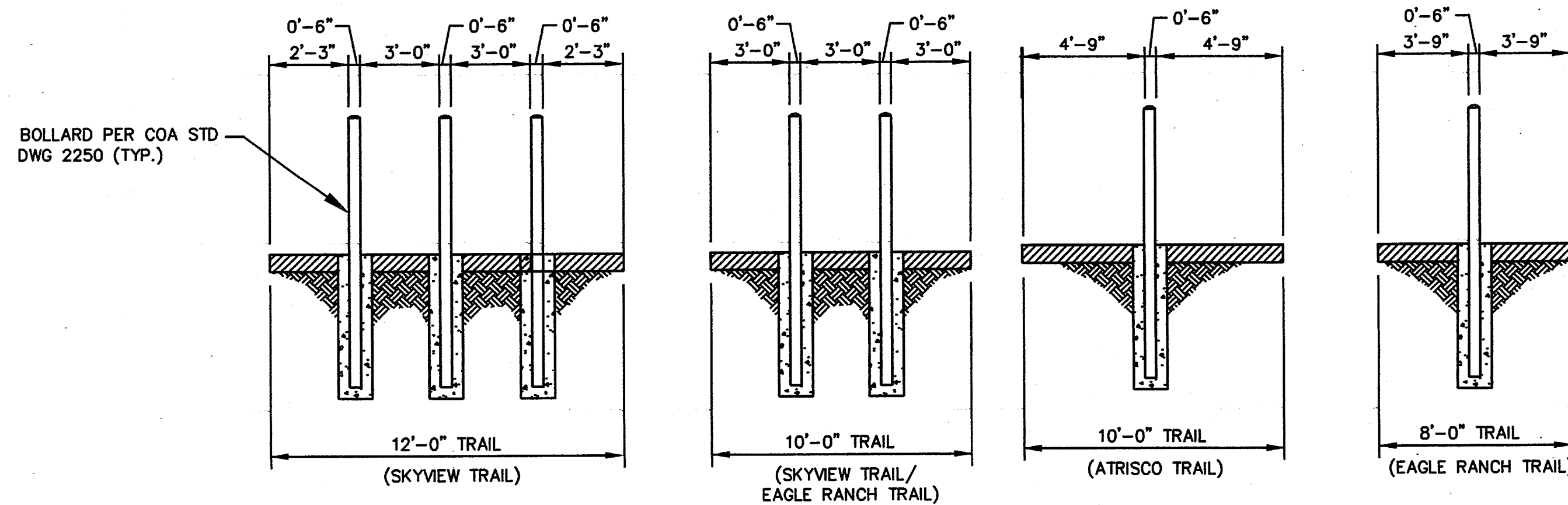

### TYPICAL BOLLARD DETAILS

NT&  
NOTE: SEE TRAIL PLANS FOR LOCATION OF BOLLARDS.  
SEE PLANS FOR CALL-OUTS OF STATIONARY OR REMOVABLE POSTS.

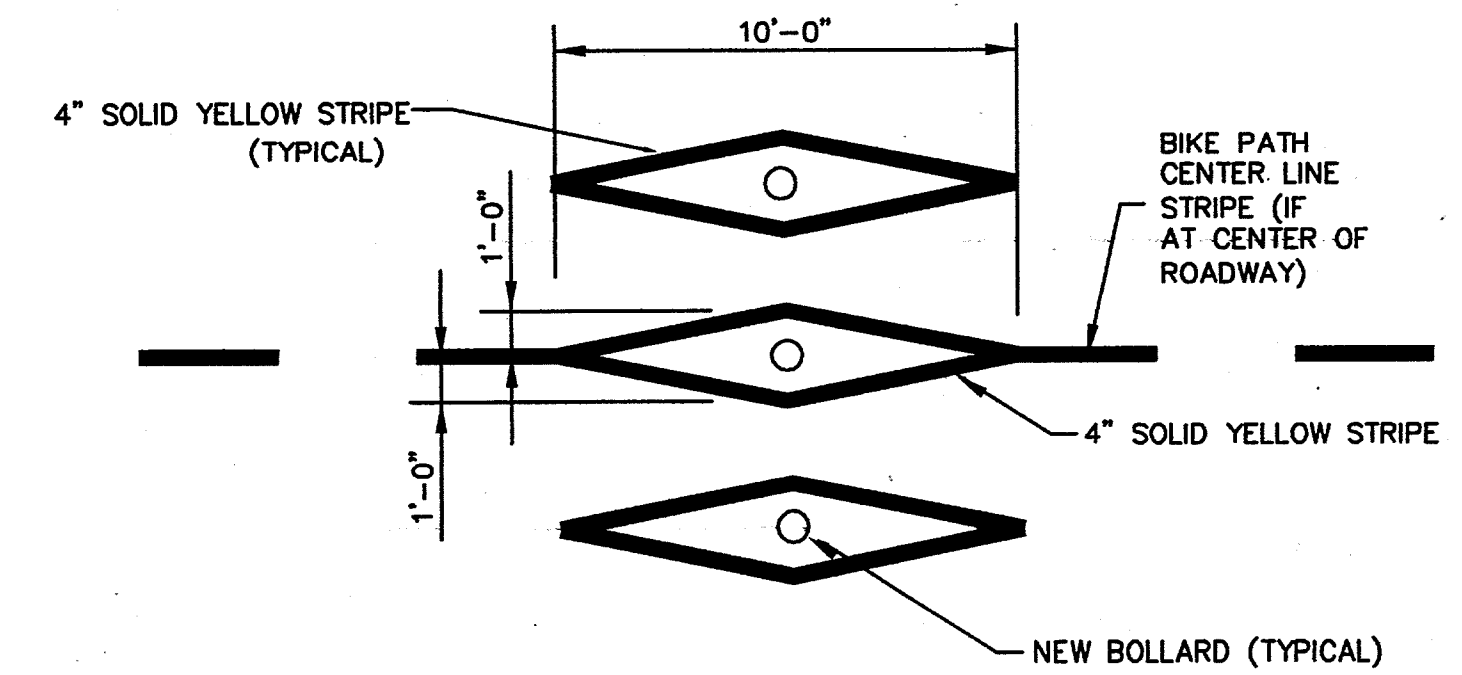

### DETAIL FOR STRIPING AT BOLLARDS

NT&

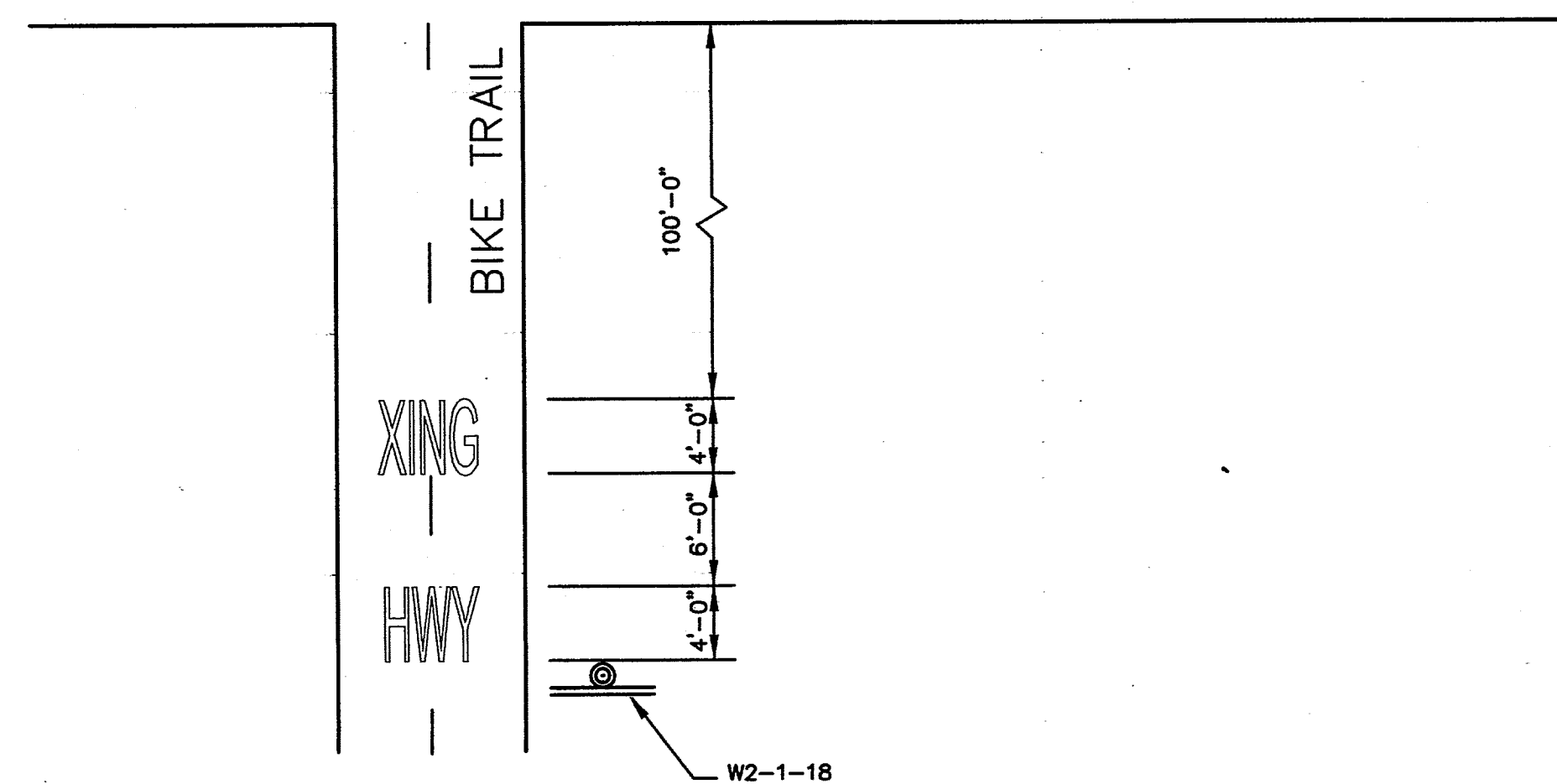
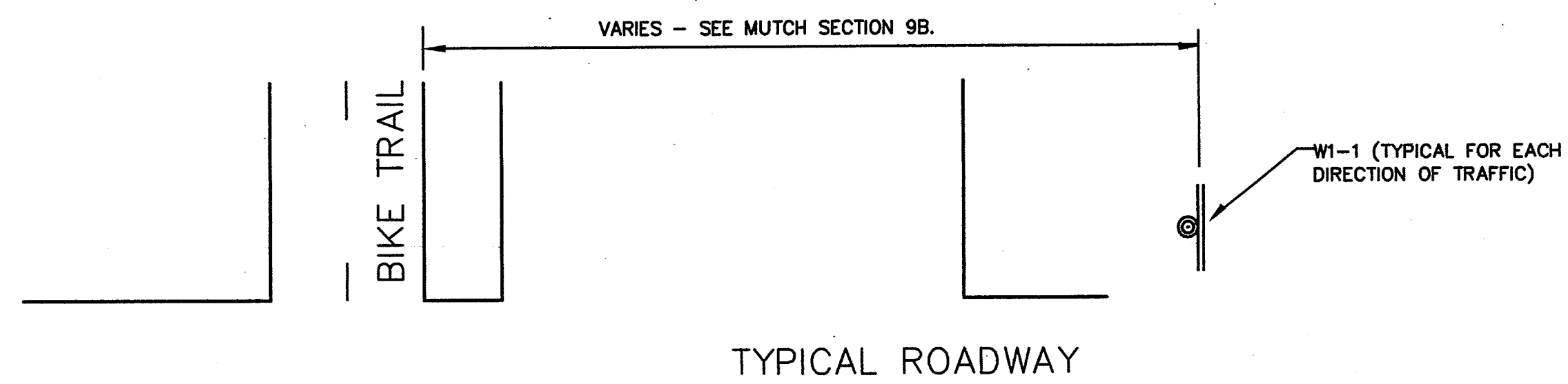
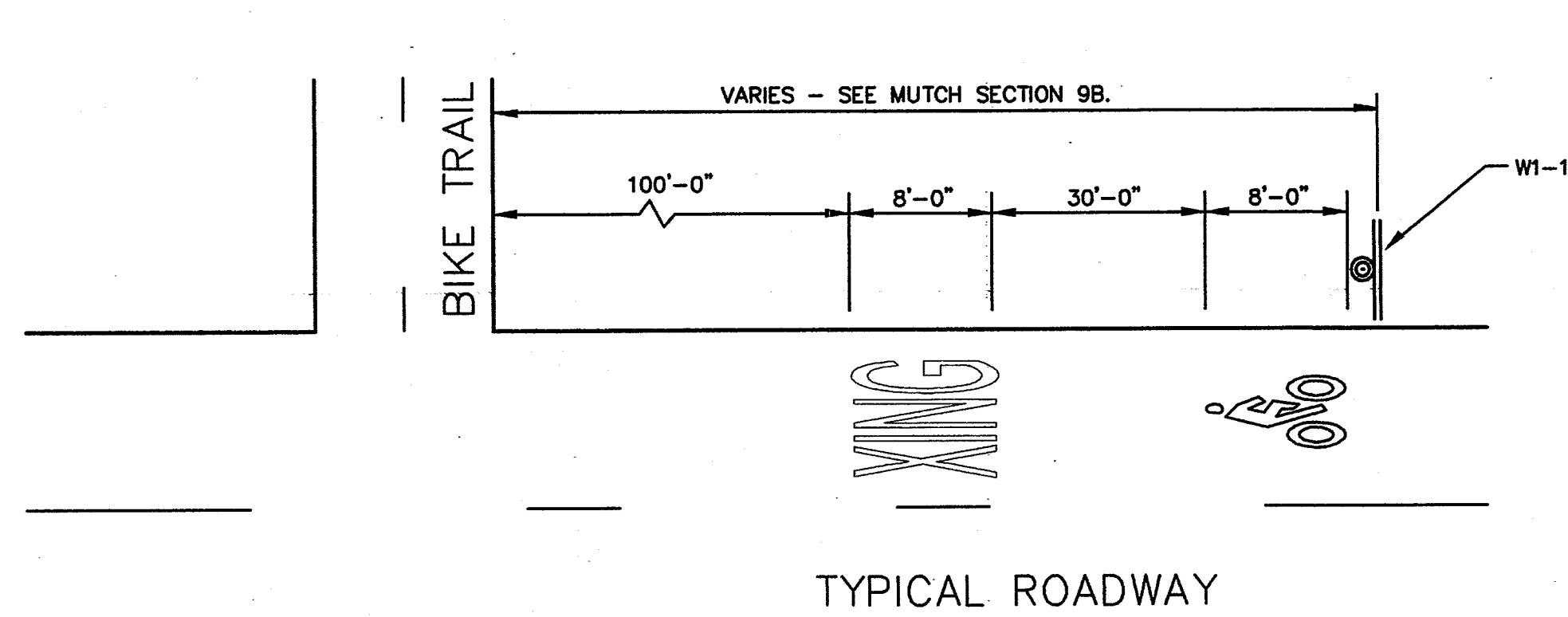

### TYPICAL MIDBLOCK TYPE PATH CROSSING

NT&

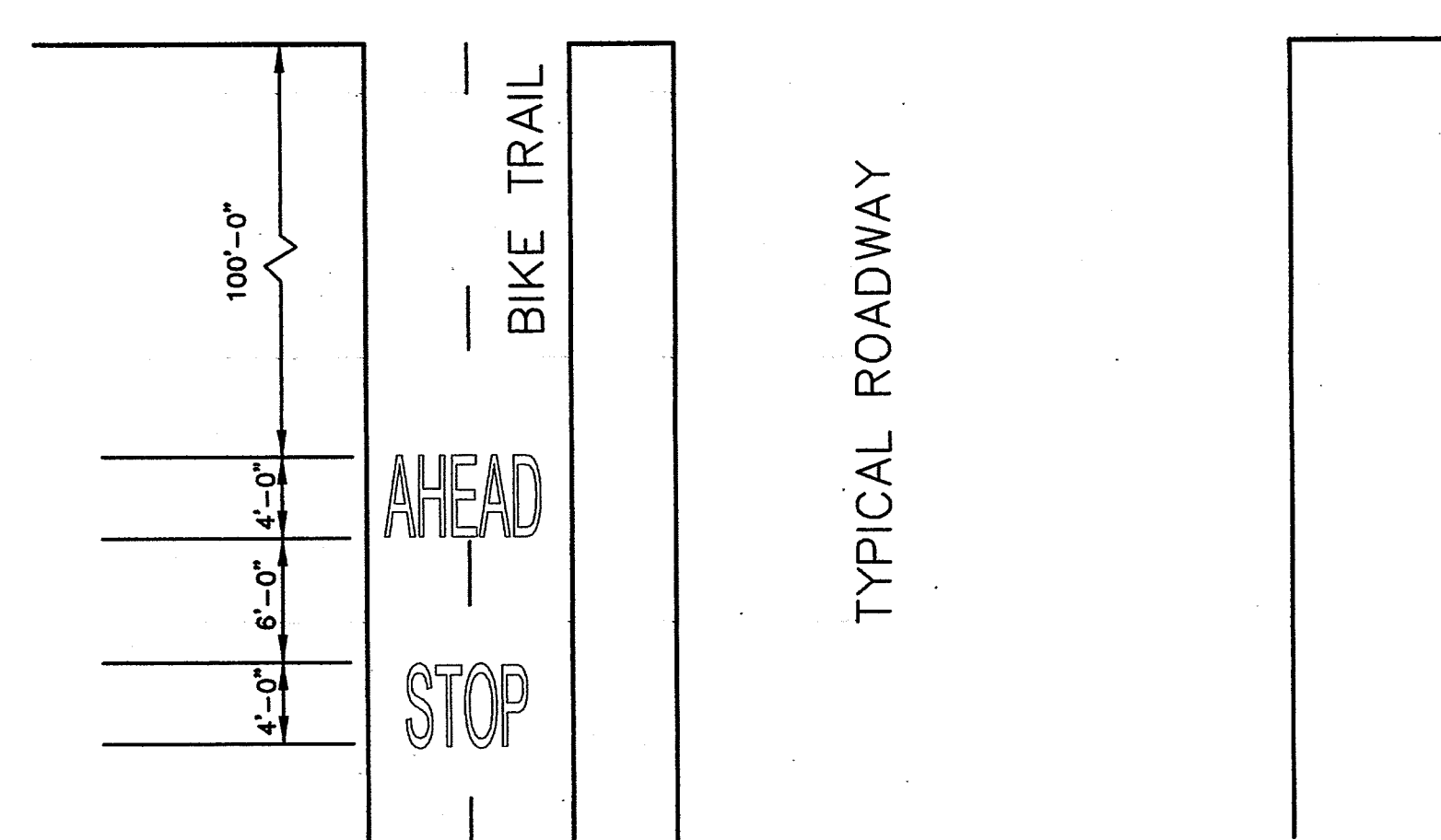

### INTERSECTION PATH CROSSING (SIGNALIZED INTERSECTION)

NT&

AS BUILT INFORMATION				BENCH MARKS				SURVEY INFORMATION				ENGINEER'S SEAL			
CONTRACTOR	DATE	INSPECTOR'S NAME	DATE	NO.	DATE	BY	DATE	NO.	DATE	BY	DATE	NO.	DATE	BY	DATE
MICRO-FILM INFORMATION															
RECORDED BY	DATE	RECORDED BY	DATE												
RECORDED BY	DATE	RECORDED BY	DATE												

NO.	DATE	REMARKS	BY
1			
2			
3			
4			

DESIGNED BY: J.W. DATE: DEC. 2004  
DRAWN BY: K.H. DATE: DEC. 2004  
CHECKED BY: R.L. DATE: DEC. 2004

**LARKIN GROUP, INC.**  
CONSULTING ENGINEERS AND SURVEYORS  
3300 MENAUL BLVD. NE #440  
ALBUQUERQUE, NEW MEXICO 87112  
(505) 275-7900 FAX (505) 275-0748

CITY OF ALBUQUERQUE  
DEPARTMENT OF MUNICIPAL DEVELOPMENT  
TRANSPORTATION DIVISION

**VARIOUS TRAILS  
2002  
BOLLARD AND STRIPING DETAILS**

APPROVED	DATE	Mo./Day/Yr.	Mo./Day/Yr.
NOV - 2 2005			
DESIGN REVIEW COMMITTEE			
APPROVED	DATE	Mo./Day/Yr. <td>Mo./Day/Yr. </td>	Mo./Day/Yr.
NOV - 2 2005			
CITY ENGINEER			

Project No. 678302 Zone Map No. A-13 Sheet 35 of 35