

## PUBLIC FIRE LINE INSTALLATION



TRACT D-1 THE 25 SUBDIVISION  
RESIDENCE INN BY MARRIOTT 4331 THE 25 WAY

1. An excavation/barricade permit will be required before beginning any work within City, County, or Village right-of-way. An approved copy of these plans must be submitted at the time of application for these permits.
2. All work detailed on these plans to be done, except as otherwise stated or provided hereon, will be constructed in accordance with "City of Albuquerque Interim Standard Specification for Public Works Construction, 1986," latest revision.
3. Two working days prior to any excavation, the contractor must contact Line Locating Service, 260-1990, for location of existing utilities.
4. Prior to construction, the contractor will excavate and verify the horizontal and vertical locations of all construction. Should a conflict exist, the contractor will notify the Construction Engineer so that the conflict can be resolved with a minimum amount of delay.
5. The contractor will be responsible for coordinating the water shutoff with the Water Division seven working days prior to construction.
6. The contractor will be responsible for performing soil density tests as required by the City of Albuquerque.

APPROVALS FOR	NAME	DATE	TITLE OF PROJECT: MARRIOTT @ 25	
DESIGN: UTILITY DEVELOPMENT	Nancy S. Husman	3/22/02	INFORMATION ONLY	
CONSTRUCTION: CONSTRUCTION ENGINEER				
ACCEPTANCE: CONSTRUCTION INSPECTOR				

# CITY OF ALBUQUERQUE

## PUBLIC FIRE LINE INSTALLATION

### SITE DETAIL

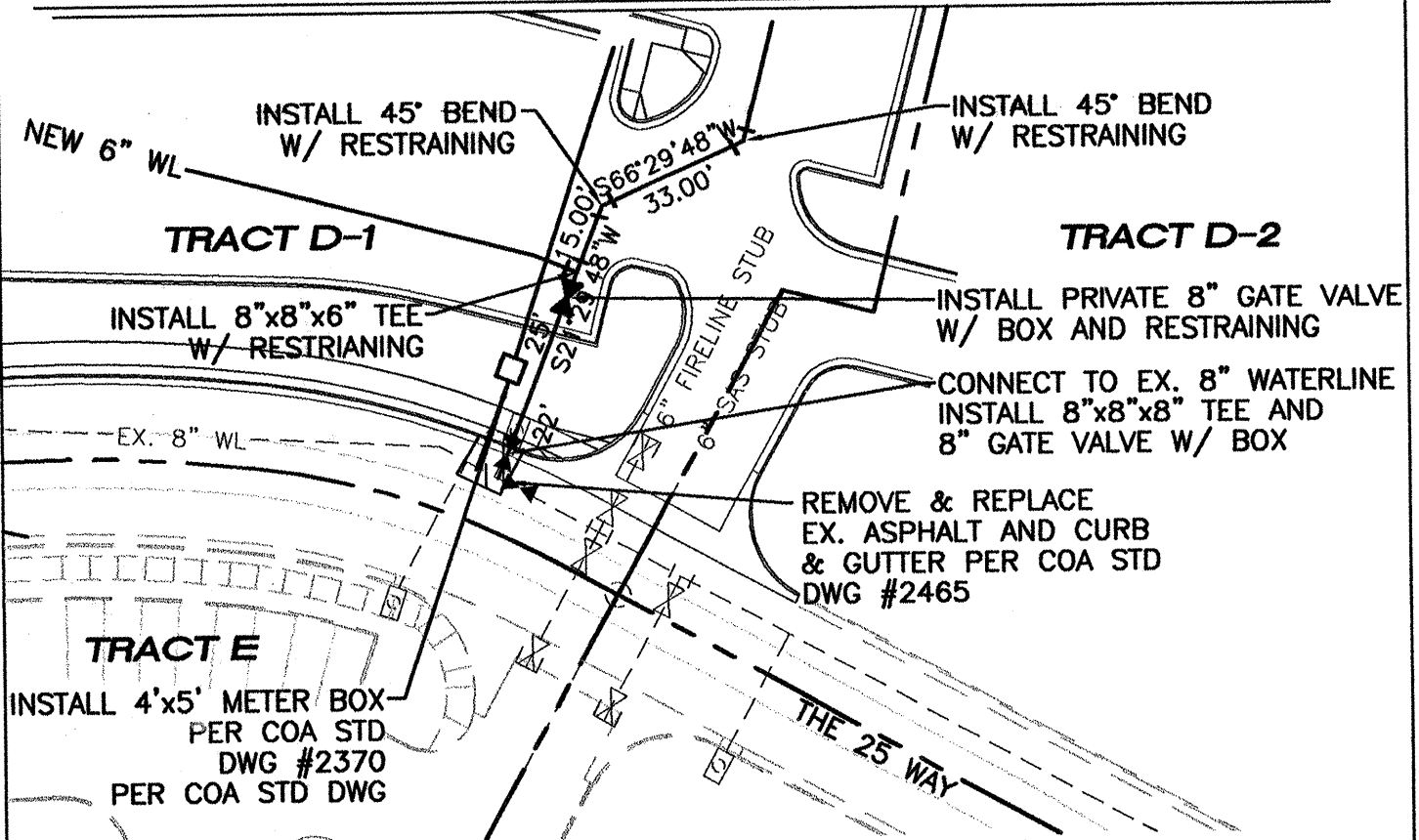

**OWNER:**  
 DEWEY WEAVER  
 ALBUQUERQUE LODGING, LLC  
 401 CONSTITUTION  
 WEST MONROE, LA  
 (318) 325-5561

**CONTRACTOR:**  
 AL GRANT  
 GRANT & ASSOCIATES  
 8905 WASHINGTON  
 856-1333

**RONALD R. BOHANNAN**  
 TIERRA WEST, LLC  
 8509 JEFFERSON NE  
 858-3100

**SCANNED BY**  
**MESA REPRO**

FOR INFORMATION ONLY

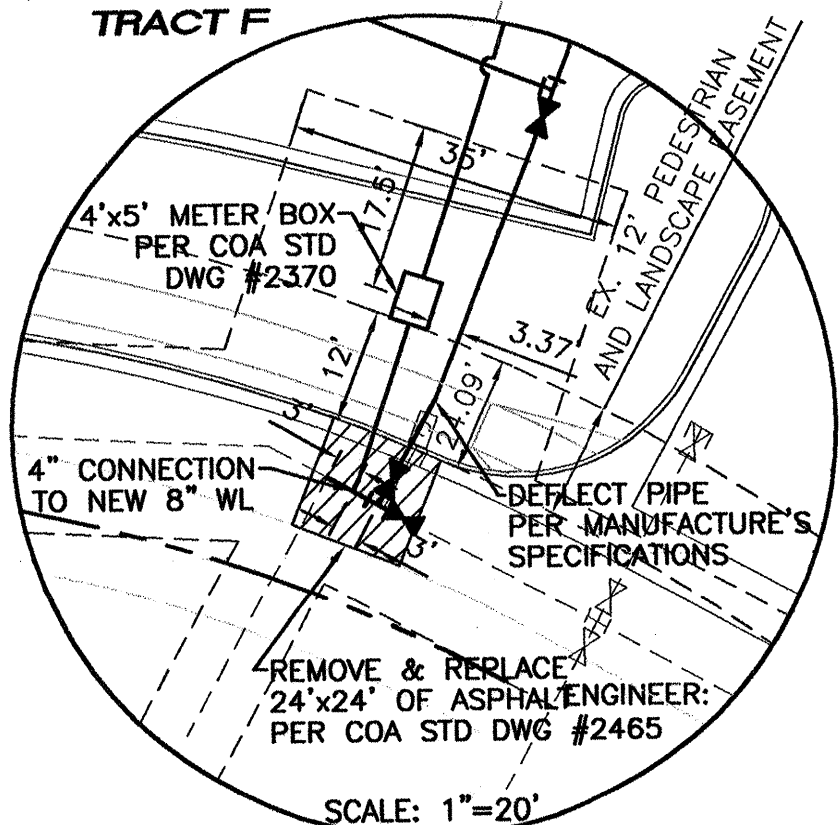

**DETAIL "A"**

PROJECT NO. 684581  
 SHEET 2 OF 3

ZONE ATLAS  
 E-17

TITLE:

MARRIOTT @ 25



