



# COMANCHE PARK - PHASE 1

## CITY OF ALBUQUERQUE DEPARTMENT OF MUNICIPAL DEVELOPMENT

### PARK AND MEDIAN DESIGN DIVISION

November 21, 2003

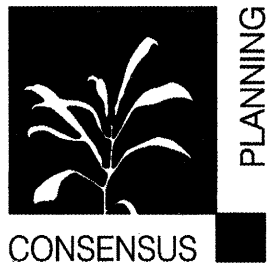
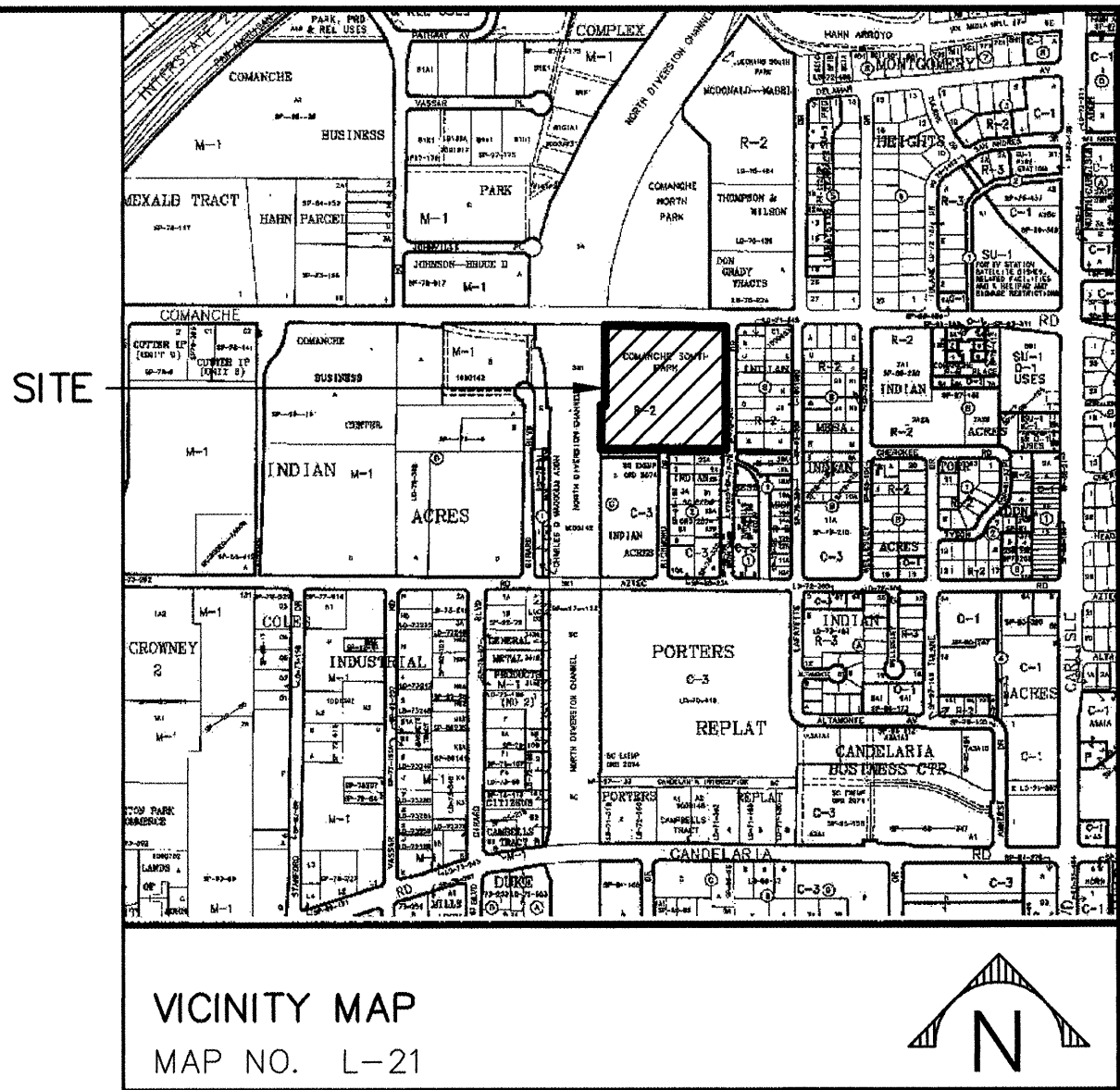

## CONSENSUS PLANNING, INC.

PLANNING / LANDSCAPE ARCHITECTURE  
924 PARK AVENUE SW ALBUQUERQUE, NM 87102 (505) 764-9801

### Property Information

Legal Description: Comanche Park South, C, Indian Acres  
Meter Address: 3713 Bryn Mawr Drive NE  
Zoning: R-2  
Total Site Area: 7.0 acres  
Total Landscape Area: 0 SF  
Total Turf Area: 0 SF (0.0 acres)  
Proposed Parking: 98 Spaces

### Consultants

Civil Engineering  
Smith Engineering Company  
6400 Uptown Blvd. NE, Suite 500E  
Albuquerque, New Mexico 87110  
(505) 884-0700

Electrical Engineering  
CME, Inc.  
6400 Uptown Blvd. NE, Suite 500E  
Albuquerque, New Mexico 87110  
(505) 884-8868

### Index of Drawings

General  
1 Cover Sheet  
2 General Notes

Site  
3 Site Plan  
4 Site Details

Landscape  
5 Irrigation Plan

Civil  
6 Civil Site Plan  
7 Grading Plan  
8 Civil Details  
9 Retaining Wall Details  
10 Field Retaining Wall Detail  
11 Signing and Traffic Control Standards  
12 Typical Traffic Control and Signing

Electrical  
13 Electrical Plan

### UTILITY COMPANY CONTACTS

**PNM-ELECTRIC**  
4201 Edith Boulevard NE  
Albuquerque, New Mexico 87107  
(505) 241-0525

**PNM-GAS**  
4625 Edith Boulevard NE  
Albuquerque, New Mexico 87107  
(505) 241-7745

**QWEST**  
201 Third Street NW, Suite 700  
Albuquerque, New Mexico 87103  
(505) 245-8706

**COMCAST**  
4611 Montbel Place NE  
Albuquerque, NM 87107  
(505) 761-6235

**CITY OF ALBUQUERQUE  
UTILITY DEVELOPMENT**  
P.O. Box 1293  
Albuquerque, New Mexico 87103  
(505) 768-2719



|   |        |                  |          |                 |                           |                 |      |
|---|--------|------------------|----------|-----------------|---------------------------|-----------------|------|
| REV.  | SHEETS | CITY ENGINEER    | DATE     | USER DEPARTMENT | DATE                      | USER DEPARTMENT | DATE |
| ENGINEERS STAMP & SIGNATURE   |        | APPROVED         | ENGINEER | DATE            | APPROVED FOR CONSTRUCTION |                 |      |
|  |        | DRC Chairman     |          |                 |                           |                 |      |
|   |        | Transportation   |          |                 |                           |                 |      |
|   |        | Water/Wastewater |          |                 |                           |                 |      |
|   |        | Hydrology        |          |                 |                           |                 |      |
|   |        | C.I.P.           |          |                 |                           |                 |      |
|   |        | Constr. Mngmt.   |          |                 | CITY ENGINEER             |                 | DATE |
|   |        | Constr. Coord.   |          |                 |                           |                 |      |
| 11-21-03  |        | PROJECT NUMBER   |          | 713991          |                           | SHEET 1 OF 13   |      |



[illegible]



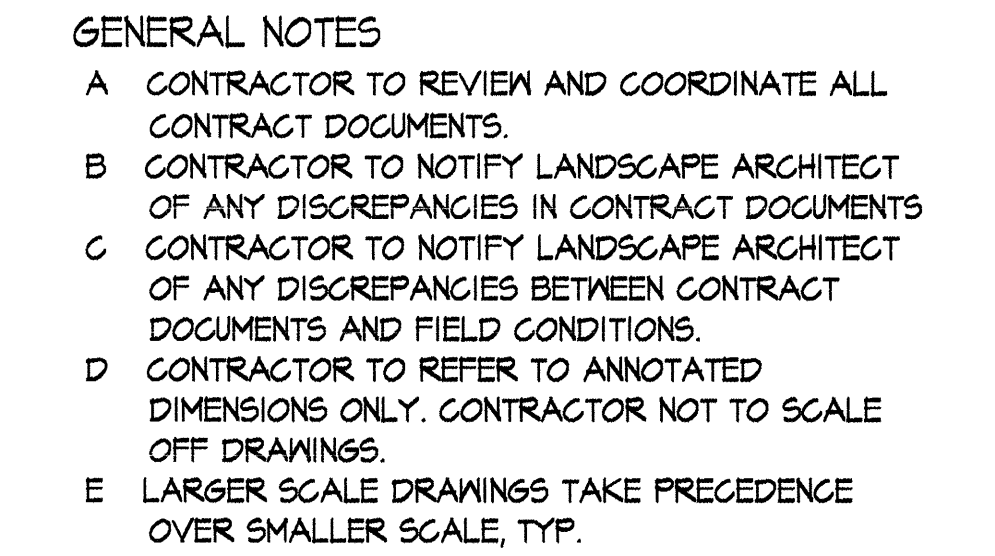

- 1 EXISTING TRANSFORMER TO REMAIN. RAISE AS NECESSARY TO FINISH GRADE OF NEW SIDEWALK.
- 2 EXISTING WATER METER TO REMAIN. RAISE BOX AS NECESSARY TO FINISH GRADE OF NEW SIDEWALK.
- 3 EXISTING CURB AND GUTTER TO REMAIN.
- 4 PROPERTY
- 5 LIMIT OF LICENSE AGREEMENT BETWEEN COA AND AMAFCA.
- 6 APPROXIMATE LOCATION OF UNDERGROUND SAS LINE AS SCALED FROM COA UTILITY MAPS.
- 7 APPROXIMATE LOCATION OF UNDERGROUND WATERLINE AS SCALED FROM COA UTILITY MAPS.
- 8 CURB AND GUTTER - SEE CIVIL DWGS.
- 9 CONCRETE SIDEWALK, C.O.A. STANDARD DWG. NO. 2430.
- 10 PARKING AREA - 4" DEPTH COMPACTED BASE COURSE.
- 11 HANDICAP PARKING AREA - SEE DETAIL ON SHEET 4.
- 12 REFUSE ENCLOSURE - SEE DETAIL ON SHEET 4.
- 13 6" CHAIN LINK FENCE PER COA STANDARDS.
- 14 4" CONCRETE SLAB FOR BLEACHERS.
- 15 TYPICAL SCOREKEEPER'S BOOTH - 6' X 10' - 8' HT. CHAIN LINK EXTERIOR W/STANDING SEAM METAL ROOF - SEE DETAIL ON SHEET 4.
- 16 TYPICAL DUSOT - 8' X 32' - 8' HT. CHAIN LINK EXTERIOR W/STANDING SEAM METAL ROOF - SEE DETAIL ON SHEET 4.
- 17 TYPICAL BATTING CASE - 14' X 60' - 12' HT. CHAIN LINK EXTERIOR W/CHAIN LINK ROOF - SEE DETAIL ON SHEET 4.
- 18 TYPICAL BALLFIELD LAYOUT - SEE DETAIL ON SHEET 4.
- 19 20' FOUL POLE.
- 20 CONCRETE LOW-FLOW CHANNEL - SEE CIVIL DWGS.
- 21 RETAINING WALLS - SEE CIVIL DWGS.
- 22 BULLPEN - 6' CHAIN LINK ENCLOSURE W/3' OPENING.
- 23 EXISTING SPEED HUMP.

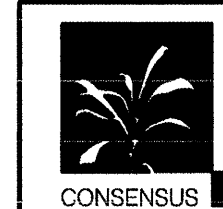

**PLANNING**  
**CONSENSUS PLANNING, INC.**  
*Planning / Landscape Architecture*  
924 Park Avenue SW  
Albuquerque, NM 87102  
(505) 764-9801 Fax 842-5495  
e-mail: [cp@consensusplanning.com](mailto:cp@consensusplanning.com)

CITY OF ALBUQUERQUE  
DEPARTMENT OF MUNICIPAL DEVELOPMENT  
PARK AND MEDIAN DESIGN DIVISION

**TITLE:** COMANCHE PARK - PHASE 1

## SITE PLAN

|                         |                        |                      |                 |                 |
|-------------------------|------------------------|----------------------|-----------------|-----------------|
| Design Review Committee | City Engineer Approval | Last Design Update   | No. / Day / Yr. | No. / Day / Yr. |
|                         |                        |                      |                 |                 |
|                         |                        |                      |                 |                 |
|                         |                        |                      |                 |                 |
|                         |                        |                      |                 |                 |
|                         |                        |                      |                 |                 |
| City Project No.        | 713991                 | Zone Map No.<br>G-16 | Sheet 3         | Of 13           |

|                               |      |
|-------------------------------|------|
| <b>AS BUILT INFORMATION</b>   |      |
| CONTRACTOR                    | DATE |
| WORK                          | DATE |
| INSPECTOR'S                   | DATE |
| ACCEPTANCE BY                 | DATE |
| FIELD                         | DATE |
| VERIFICATION BY               | DATE |
| <b>MICRO-FILM INFORMATION</b> |      |
| RECORDED BY                   | DATE |
| NO.                           |      |

## BENCH MARKS

SURVEY INFORMATION

**ENGINEERS SEAL**



1-21-03

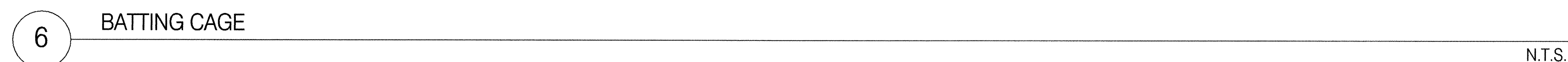
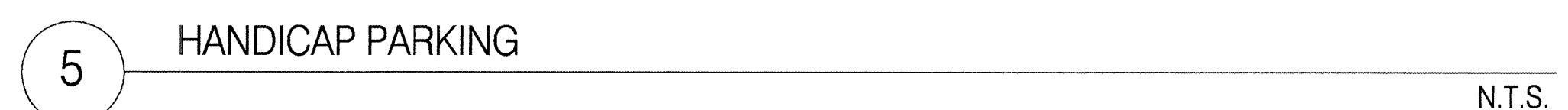
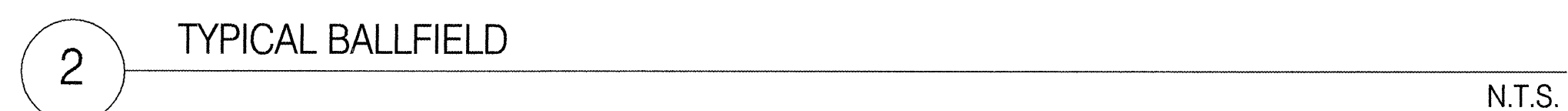
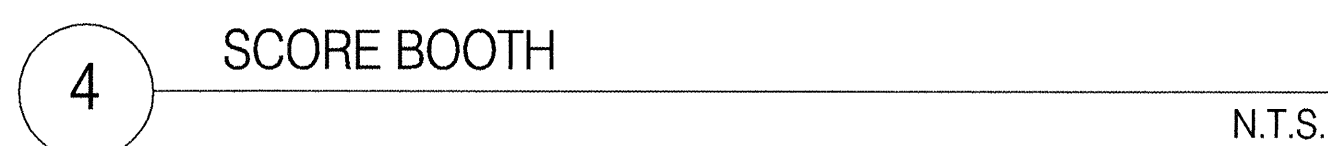
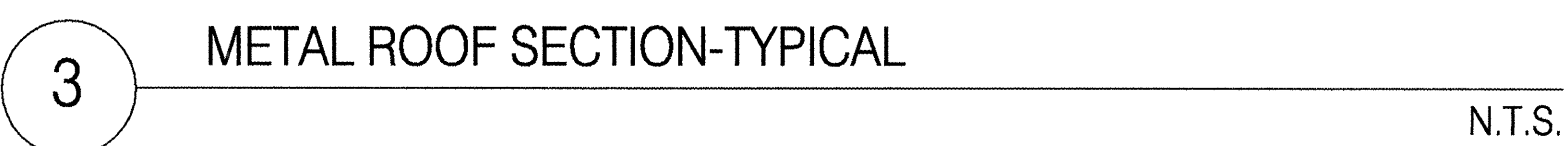
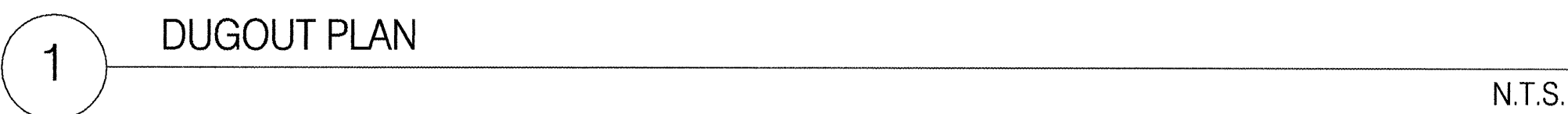

|   |                 |  |  |                        |  |  |  |                    |             |                 |  |                    |                 |                   |
|---|-----------------|--|--|------------------------|--|--|--|--------------------|-------------|-----------------|--|--------------------|-----------------|-------------------|
|          | <b>PLANNING</b> | <b>CONSENSUS PLANNING, INC.</b><br><i>Planning / Landscape Architecture<br/>924 Park Avenue SW<br/>Albuquerque, NM 87102<br/>(505) 764-9801 Fax 842--5495<br/>e-mail: cp@consensusplanning.com</i> |  |                        |  |  |  | <b>No.</b>         | <b>Date</b> |                 |  | <b>DESIGNED BY</b> | <b>DRAWN BY</b> | <b>CHECKED BY</b> |
|   |                 |  |  |                        |  |  |  |                    |             |                 |  |                    |                 |                   |
|   |                 |  |  |                        |  |  |  |                    |             |                 |  |                    |                 |                   |
|   |                 |  |  |                        |  |  |  |                    |             |                 |  |                    |                 |                   |
|   |                 |  |  |                        |  |  |  |                    |             |                 |  |                    |                 |                   |
|   |                 |  |  |                        |  |  |  |                    |             |                 |  |                    |                 |                   |
| CITY OF ALBUQUERQUE<br>DEPARTMENT OF MUNICIPAL DEVELOPMENT<br>PARK AND MEDIAN DESIGN DIVISION |                 |  |  |                        |  |  |  |                    |             |                 |  |                    |                 |                   |
| TITLE: COMANCHE PARK - PHASE 1<br><br>SITE DETAILS  |                 |  |  |                        |  |  |  |                    |             |                 |  |                    |                 |                   |
| Design Review Committee   |                 |  |  | City Engineer Approval |  |  |  | Last Design Update |             | Mo. / Day / Yr. |  | Mo. / Day / Yr.    |                 |                   |
|   |                 |  |  |                        |  |  |  |                    |             |                 |  |                    |                 |                   |
|   |                 |  |  |                        |  |  |  |                    |             |                 |  |                    |                 |                   |
|   |                 |  |  |                        |  |  |  |                    |             |                 |  |                    |                 |                   |
|   |                 |  |  |                        |  |  |  |                    |             |                 |  |                    |                 |                   |
| City Project No.<br><br>713991  |                 |  |  | Zone Map No.<br>G-16   |  |  |  | Sheet<br>4         |             | Of<br>13        |  |                    |                 |                   |



1







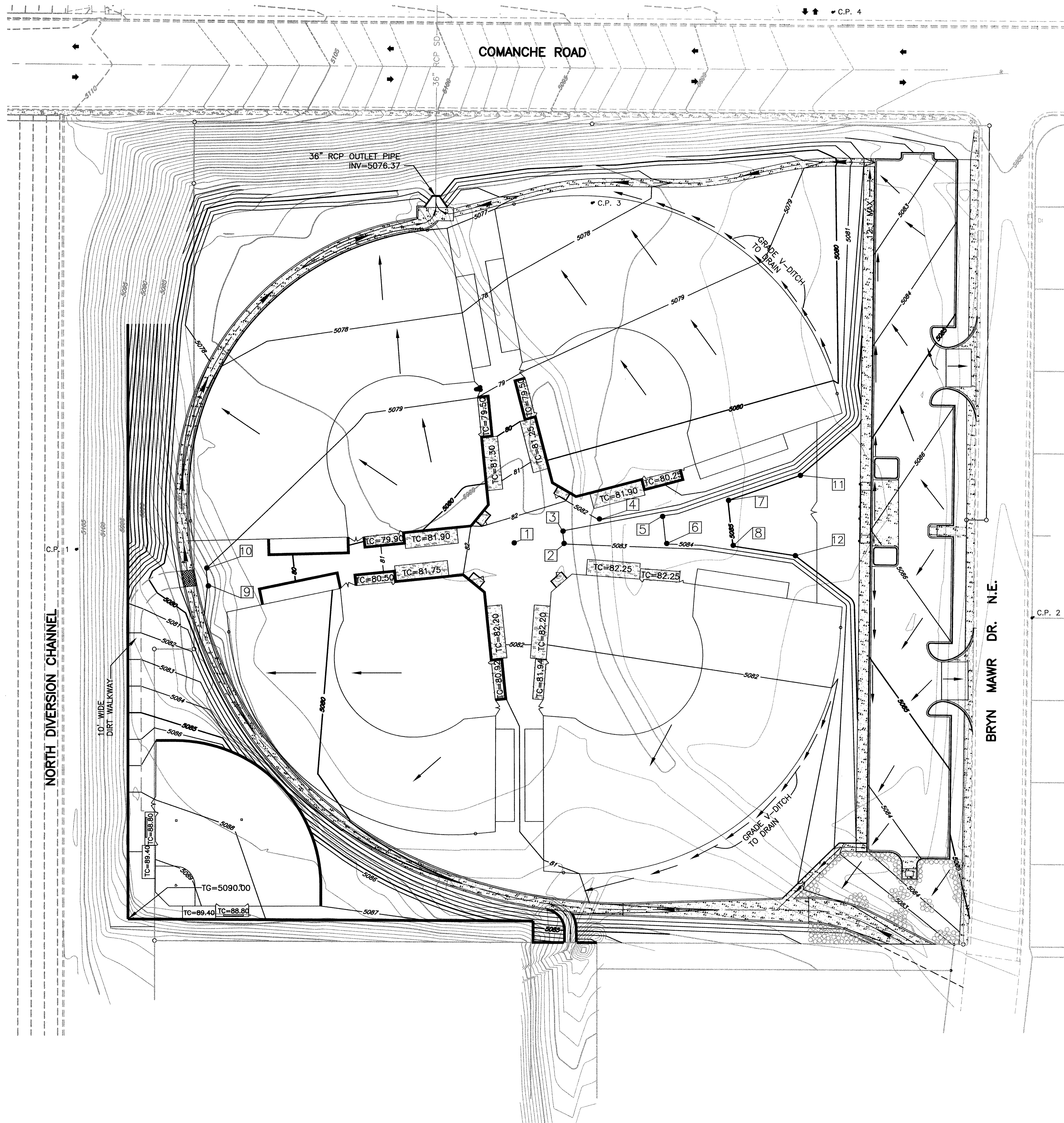

LOCAL SURVEY CONTROL INFORMATION

| POINT NUMBER | NORTHING   | EASTING   | ELEVATION | DESCRIPTION   |
|--------------|------------|-----------|-----------|---------------|
| CP-1         | 1500608.70 | 392062.18 | 5106.37   | NAIL          |
| CP-2         | 1500557.19 | 392783.78 | 5086.83   | CHISELED "+"  |
| CP-3         | 1500870.12 | 392451.74 | 5079.25   | NAIL          |
| CP-4         | 1501013.31 | 392633.43 | 5087.55   | NAIL & SHINER |

POINT DATA

| NO. | DESC.      | ELEV.   | EASTING   | NORTHING   |
|-----|------------|---------|-----------|------------|
| 1   | TOP GROUND | 5082.50 | 392392.45 | 1500613.85 |
| 2   | TOP GROUND | 5083.00 | 392430.55 | 1500612.88 |
| 3   | TOP GROUND | 5083.00 | 392429.25 | 1500622.80 |
| 4   | TOP GROUND | 5082.00 | 392456.79 | 1500631.12 |
| 5   | TOP GROUND | 5084.00 | 392505.11 | 1500634.26 |
| 6   | TOP GROUND | 5084.00 | 392507.30 | 1500612.95 |
| 7   | TOP GROUND | 5085.00 | 392554.20 | 1500645.80 |
| 8   | TOP GROUND | 5085.00 | 392557.92 | 1500611.27 |
| 9   | TOP GROUND | 5079.00 | 392161.35 | 1500582.04 |
| 10  | TOP GROUND | 5079.00 | 392160.12 | 1500594.20 |
| 11  | TOP GROUND | 5085.00 | 392605.16 | 1500604.02 |
| 12  | TOP GROUND | 5085.00 | 392608.96 | 1500664.72 |

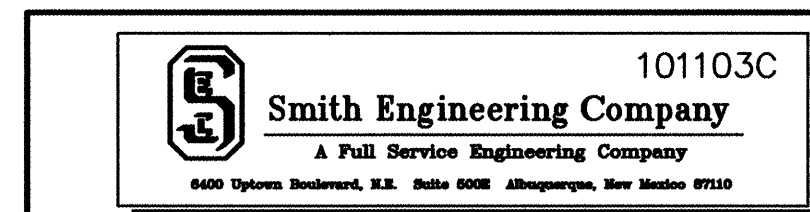
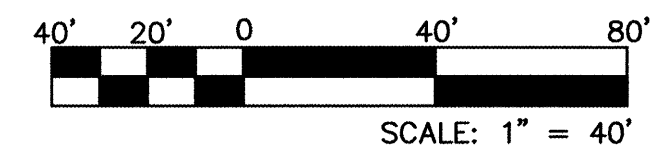

|   |                        |                    |       |
|---|------------------------|--------------------|-------|
| CITY OF ALBUQUERQUE<br>DEPARTMENT OF MUNICIPAL DEVELOPMENT<br>PARK AND MEDIAN DESIGN DIVISION |                        |                    |       |
| TITLE: COMANCHE PARK - PHASE 1<br>GRADING PLAN  |                        |                    |       |
| Design Review Committee   | City Engineer Approval | Last Design Update |       |
|   |                        |                    |       |
| City Project No. 713991   | Zone Map No. G-16      | Sheet 7            | Of 13 |

|                 |  |                    |  |                        |  |                      |  |
|-----------------|--|--------------------|--|------------------------|--|----------------------|--|
| ENGINEER'S SEAL |  | SURVEY INFORMATION |  | BENCH MARKS            |  | AS BUILT INFORMATION |  |
| [Seal]          |  | FIELD NOTES        |  | CONTRACTOR             |  | WORK BY              |  |
| NO. DATE        |  | BY DATE            |  | NO.                    |  | DATE                 |  |
| REMARKS         |  | BY                 |  | INSPECTOR'S            |  | DATE                 |  |
| DESIGN          |  | BY                 |  | ACCEPTANCE BY          |  | DATE                 |  |
| DESIGNED BY DLA |  | DATE 08/03         |  | VERIFICATION BY        |  | DATE                 |  |
| DRAWN BY MAC    |  | DATE 08/03         |  | DRAWINGS BY            |  | DATE                 |  |
| CHECKED BY DLA  |  | DATE 08/03         |  | MICRO-FILM INFORMATION |  | RECORDED BY          |  |
|                 |  |                    |  | NO.                    |  | DATE                 |  |



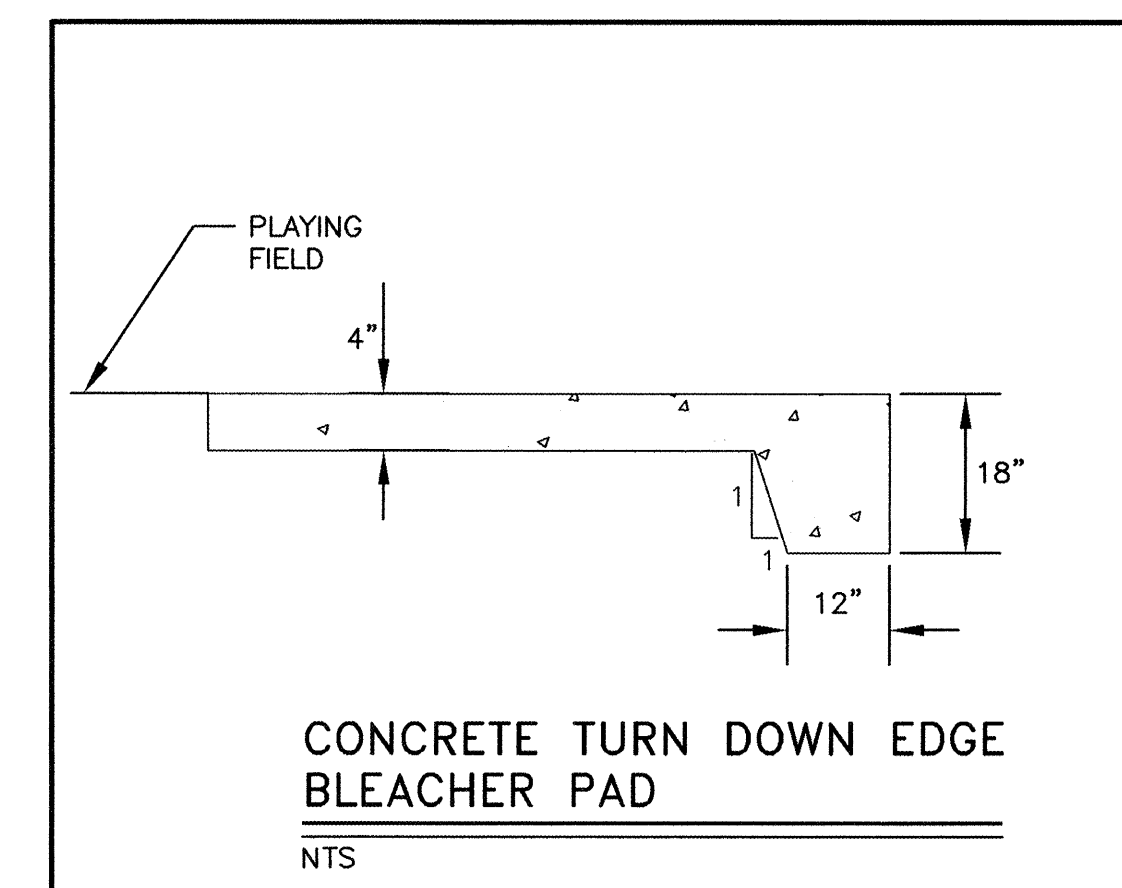
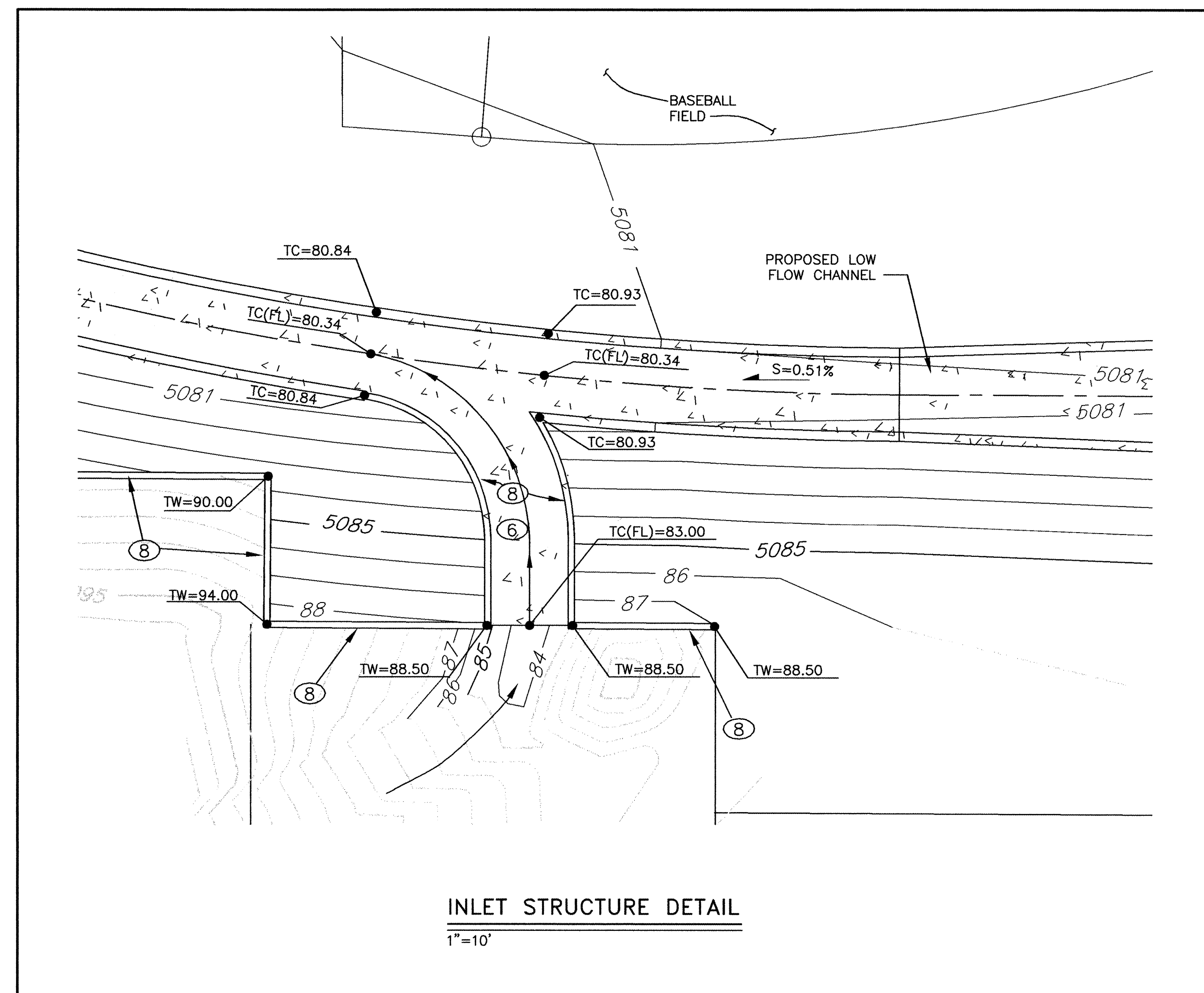
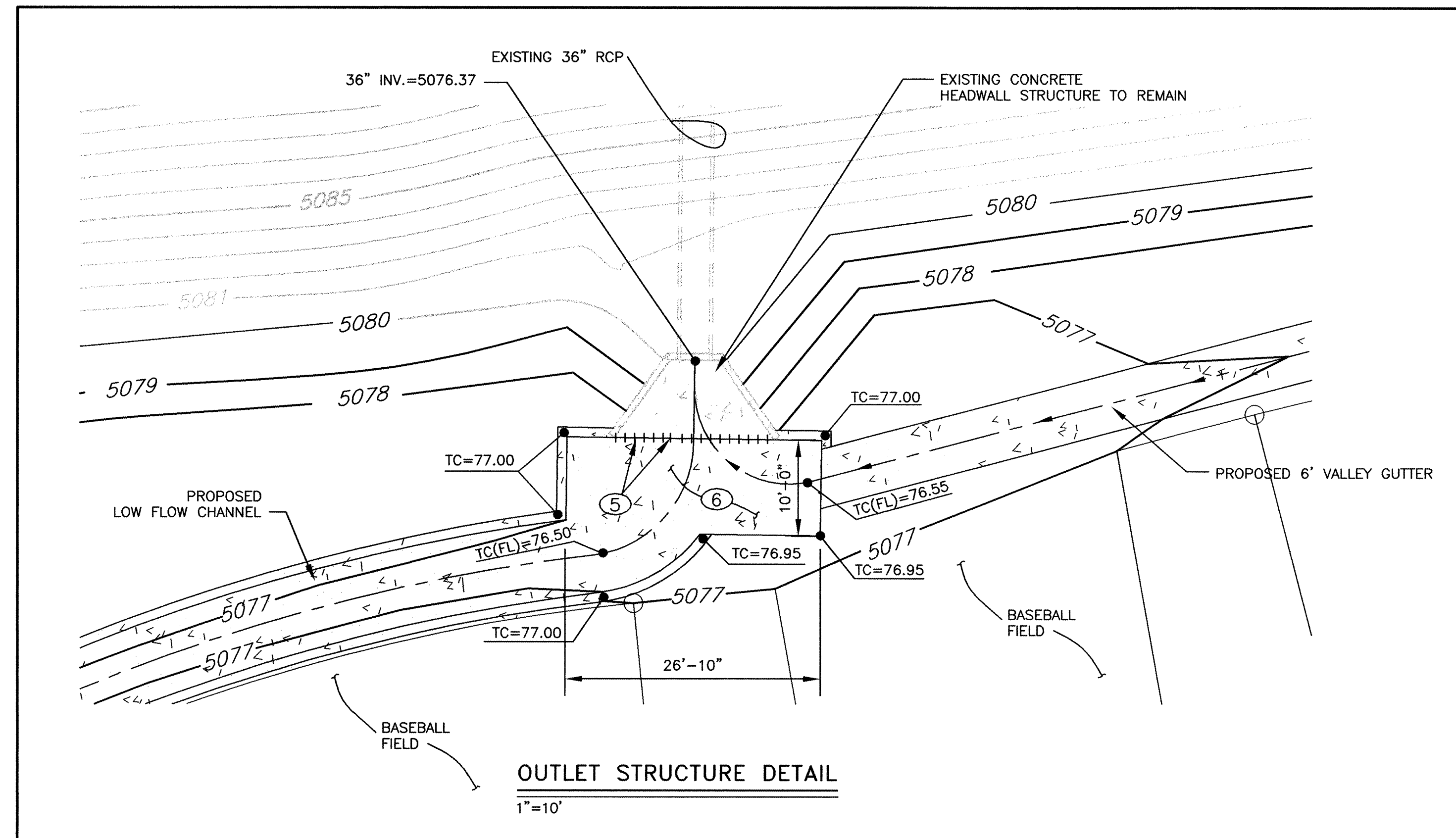

○ KEYED NOTES:

- ① NEW 6" SIDEWALK PER COA STD. DWG. NO.2430.
- ② REMOVE EXISTING CURB & GUTTER AND REPLACE WITH VALLEY GUTTER PER COA STD. DWG. 2420.
- ③ CONSTRUCT WHEELCHAIR CURB ACCESS RAMP PER COA STANDARD DWG. 2426.  
SEE DETAIL THIS SHEET.
- ④ NEW MEDIAN CURB & GUTTER PER COA STD. DWG. NO 2415.
- ⑤ #5 DOWEL @ 12" O.C., EPOXY INTO EXISTING CONCRETE TYPICAL. USE SIMPSON ET22 EPOXY SYSTEM OR EQUIVALENT.  
DOWEL DEPTH = 6" (MIN)
- ⑥ 8" THICK PORTLAND CEMENT CONCRETE WITH 6" X 6" X NO. 6 GA. WIRE MESH ON 12" SUBGRADE PER. @ 95% COMPACTION.  
(SEE LOW FLOW CHANNEL DETAIL).
- ⑦ NOT USED.
- ⑧ SEE SHEET 9 FOR RETAINING WALL INFORMATION.

[illegible]



START WALL 4

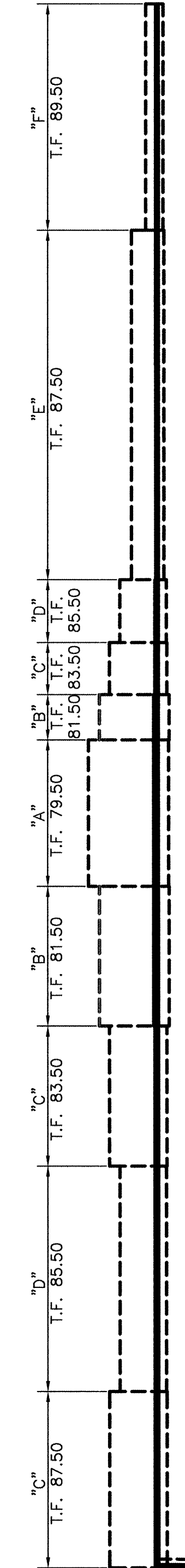

RETAINING WALL PLAN  
SCALE: 1" = 30'

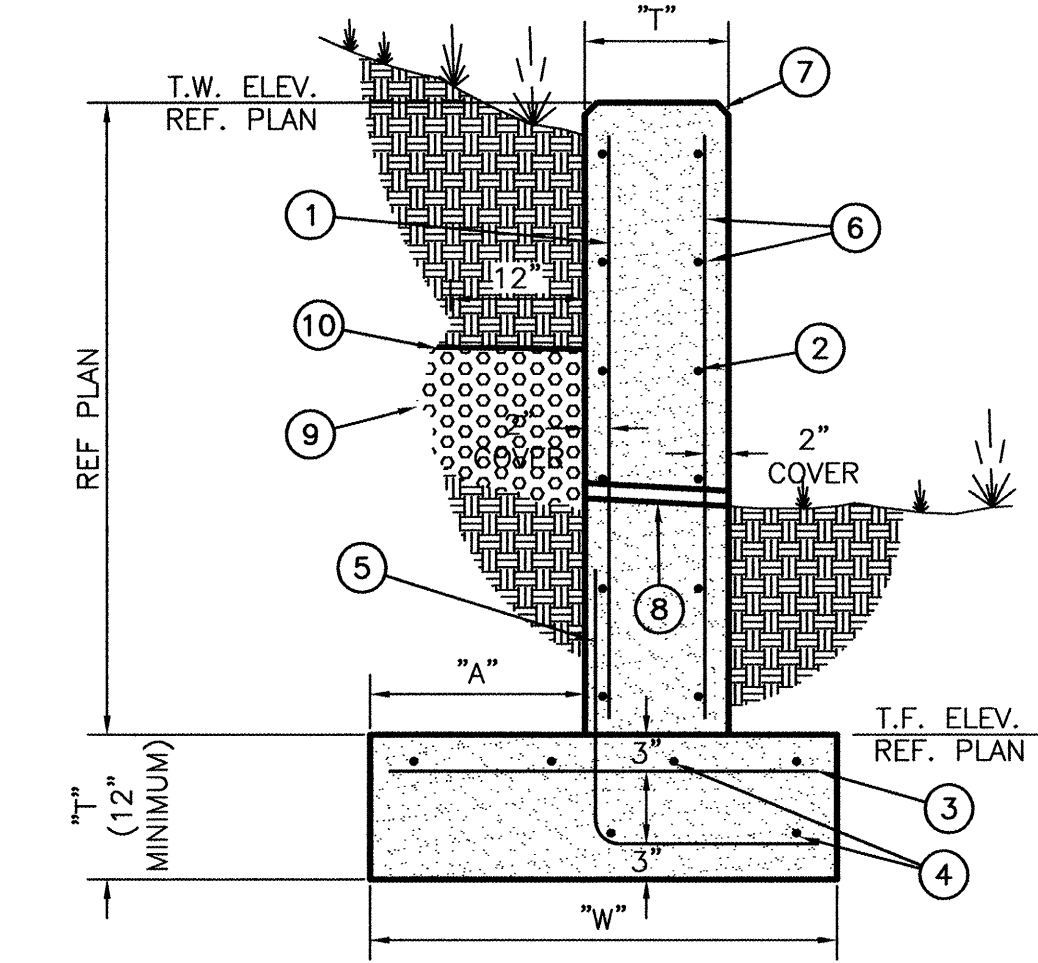

TYPE I RETAINING WALL DETAIL  
3/4" = 1'

KEYED NOTES

1. VERTICAL BARS
2. HORIZONTAL BARS
3. TRANSVERSE BARS
4. LONGITUDINAL BARS
5. DOWELS (PROVIDE 40 DIAMETER LAP TO VERT REINF.)
6. #5 @ 18" O.C. EACH WAY
7. 3/4" CHAMFER - TYPICAL
8. 1 1/2" DIAMETER PVC WEEP HOLES AT 8'-0" O.C.
9. GRANULAR FILL
10. FILTER FABRIC

| TYPE I RETAINING WALL SCHEDULE |     |         |        |               |                 |               |                 |                   |  |
|--------------------------------|-----|---------|--------|---------------|-----------------|---------------|-----------------|-------------------|--|
| MARK                           | "T" | "A"     | "W"    | VERTICAL BARS | HORIZONTAL BARS | DOWELS        | TRANSVERSE BARS | LONGITUDINAL BARS |  |
| A                              | 16" | 19'-4"  | 23'-0" | #7 @ 9" O.C.  | #8 @ 12" O.C.   | #9 @ 9" O.C.  | #9 @ 9" O.C.    | (10) - #8 CONT.   |  |
| B                              | 16" | 16'-10" | 20'-0" | #6 @ 9" O.C.  | #7 @ 12" O.C.   | #9 @ 9" O.C.  | #9 @ 9" O.C.    | (9) - #8 CONT.    |  |
| C                              | 12" | 14'-0"  | 16'-6" | #5 @ 9" O.C.  | #6 @ 12" O.C.   | #7 @ 9" O.C.  | #7 @ 9" O.C.    | (8) - #7 CONT.    |  |
| D                              | 12" | 11'-0"  | 13'-4" | #6 @ 10" O.C. | #5 @ 12" O.C.   | #6 @ 10" O.C. | #6 @ 10" O.C.   | (7) - #7 CONT.    |  |
| E                              | 8"  | 7'-8"   | 9'-4"  | #5 @ 10" O.C. | #4 @ 12" O.C.   | #5 @ 10" O.C. | #5 @ 10" O.C.   | (6) - #6 CONT.    |  |
| F                              | 8"  | 3'-7"   | 5'-0"  | #5 @ 18" O.C. | #4 @ 12" O.C.   | #5 @ 18" O.C. | #5 @ 18" O.C.   | (5) - #5 CONT.    |  |
| G                              | 8"  | 1'-10"  | 3'-0"  | #5 @ 18" O.C. | #4 @ 12" O.C.   | #5 @ 18" O.C. | #5 @ 18" O.C.   | (5) - #5 CONT.    |  |

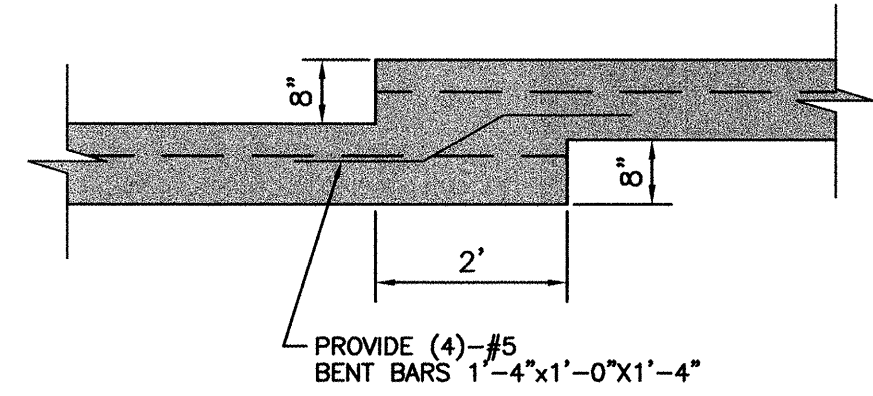

STEP FOOTING DETAIL  
1/2" = 1'

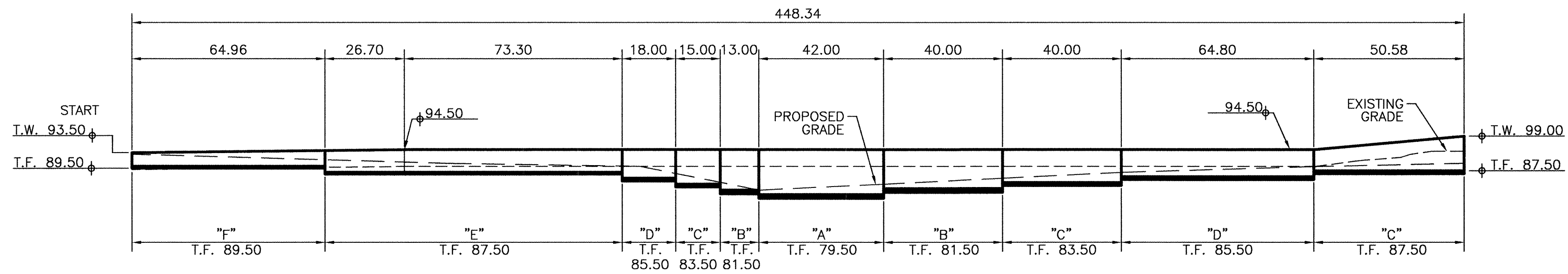

WALL 4  
SCALE: 1" = 30'

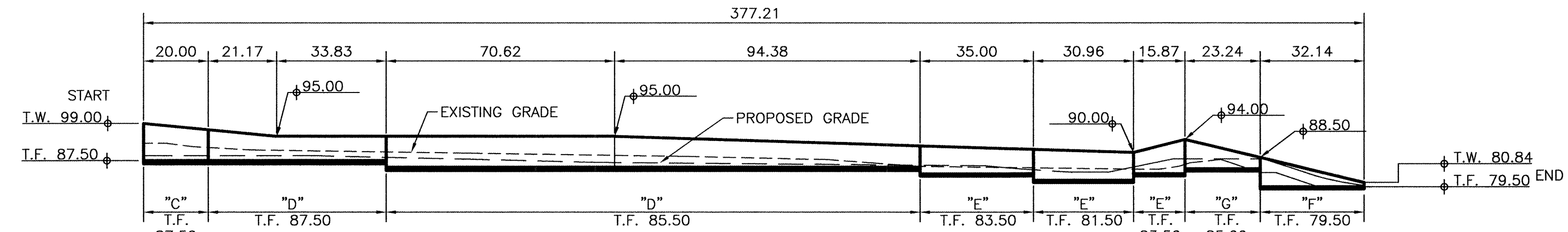

WALL 5  
SCALE: 1" = 30'

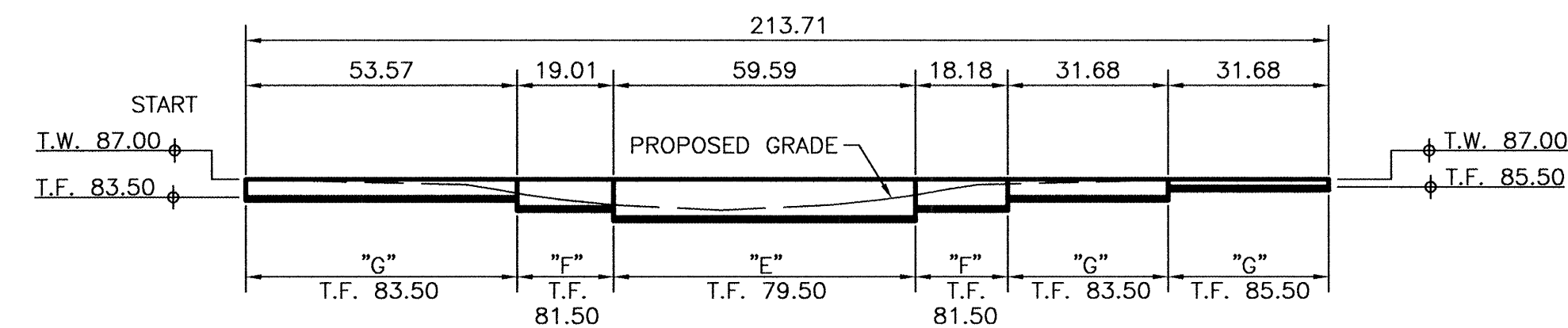

WALL 6  
SCALE: 1" = 30'

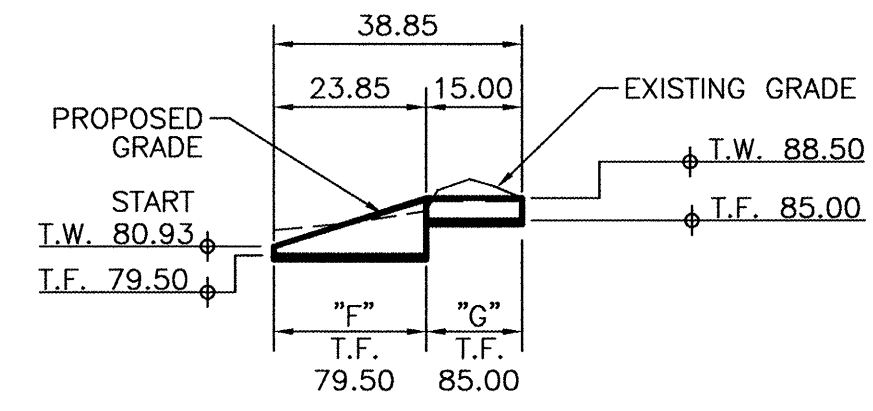

WALL 7  
SCALE: 1" = 30'

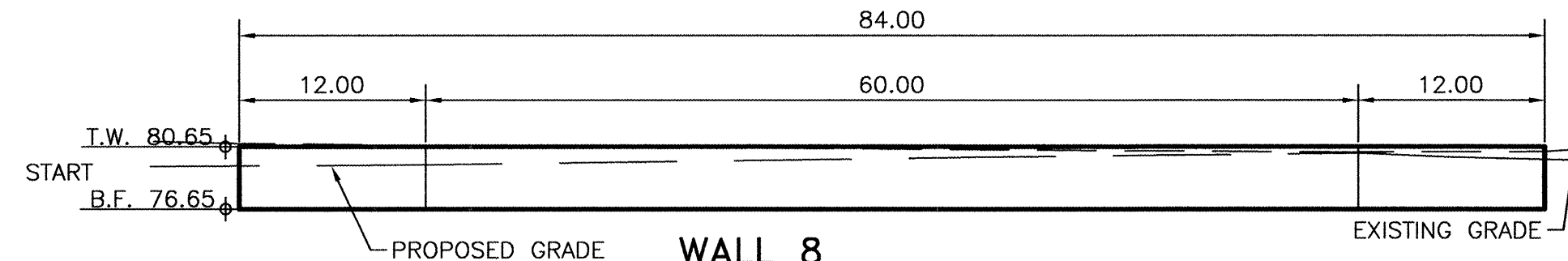

WALL 8  
SCALE: 1" = 10'

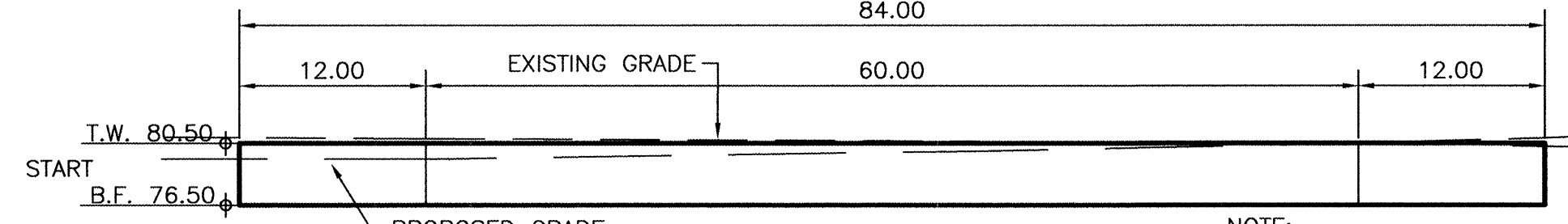

WALL 9  
SCALE: 1" = 10'

NOTE:  
WALL 8 AND WALL 9  
UTILIZE THE TYPE II  
RETAINING WALL DETAIL.  
SEE SHEET 10.

| AS BUILT INFORMATION   |      | BENCH MARKS            |      | SURVEY INFORMATION     |      | ENGINEER'S SEAL        |      | REVISIONS              |      | DESIGN                 |      | CITY OF ALBUQUERQUE    |      |
|------------------------|------|------------------------|------|------------------------|------|------------------------|------|------------------------|------|------------------------|------|------------------------|------|
| CONTRACTOR             | DATE | WORK BY                | DATE | FIELD NOTES            | DATE | NO.                    | BY   | NO.                    | DATE | DESIGNED BY            | DATE | DESIGNED BY            | DATE |
| INSPECTOR'S            | DATE | ACCEPTANCE BY          | DATE |                        |      |                        |      |                        |      | DRAWN BY               | DATE | DRAWN BY               | DATE |
| VERIFICATION BY        | DATE | DRAWING BY             | DATE |                        |      |                        |      |                        |      | CHECKED BY             | DATE | CHECKED BY             | DATE |
| MICRO-FILM INFORMATION |      | MICRO-FILM INFORMATION |      | MICRO-FILM INFORMATION |      | MICRO-FILM INFORMATION |      | MICRO-FILM INFORMATION |      | MICRO-FILM INFORMATION |      | MICRO-FILM INFORMATION |      |
| NO.                    | DATE | NO.                    | DATE | NO.                    | DATE | NO.                    | DATE | NO.                    | DATE | NO.                    | DATE | NO.                    | DATE |

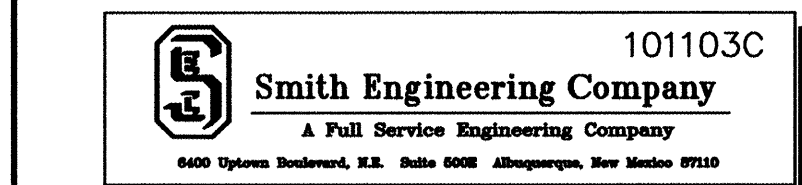

|   |                        |  |        |
|---|------------------------|--|--------|
| CITY OF ALBUQUERQUE<br>DEPARTMENT OF MUNICIPAL DEVELOPMENT<br>PARK AND MEDIAN DESIGN DIVISION |                        | TITLE:<br>COMANCHE PARK - PHASE 1<br>RETAINING WALL DETAIL |        |
| Design Review Committee   | City Engineer Approval | City Project No.   | 713991 |
| Zone Map No.  | G-16                   | Sheet  | 9      |
| Of  | 13                     |  |        |



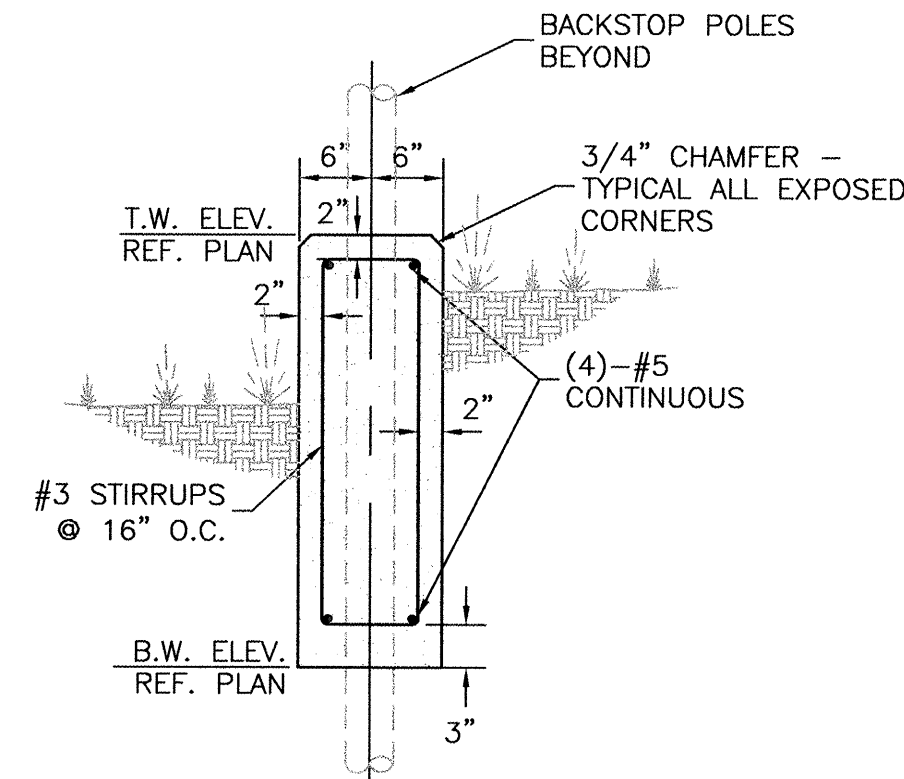

TYPE II RETAINING WALL DETAIL  
3/4" - 1'

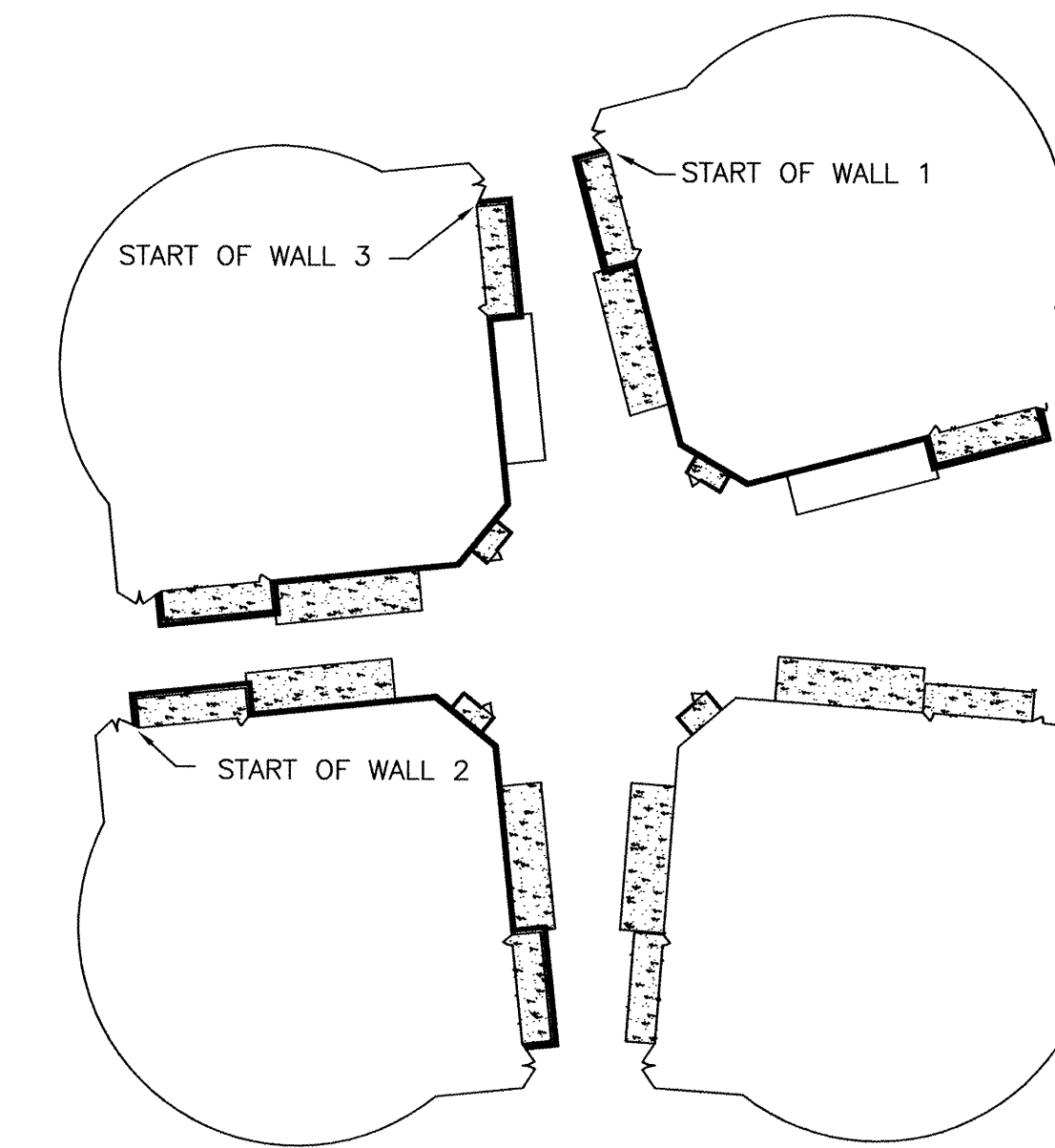

TYPE II RETAINING WALL PLAN

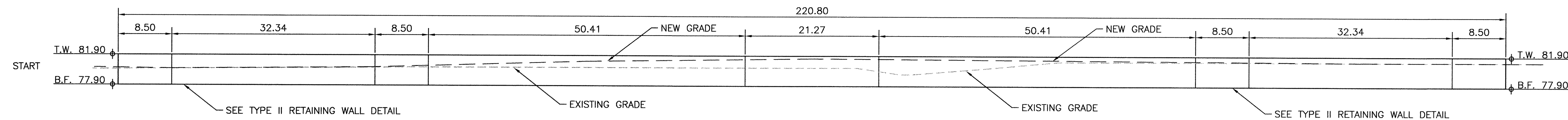

WALL 1  
1"=10'

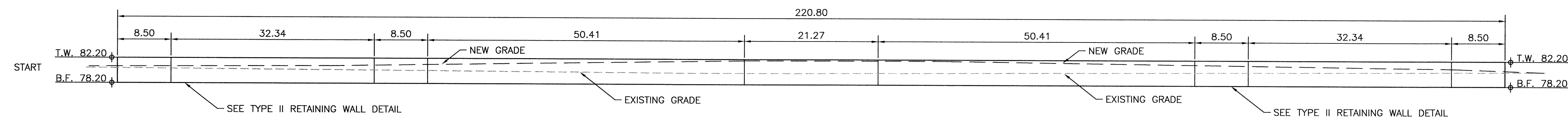

WALL 2  
1"=10'

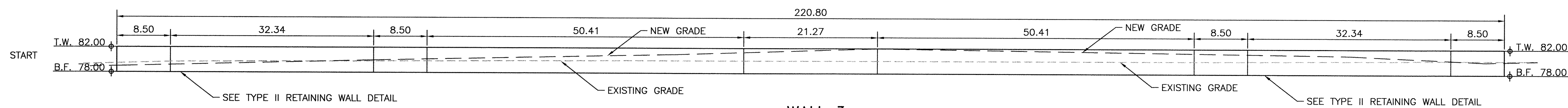

WALL 3  
1"=10'

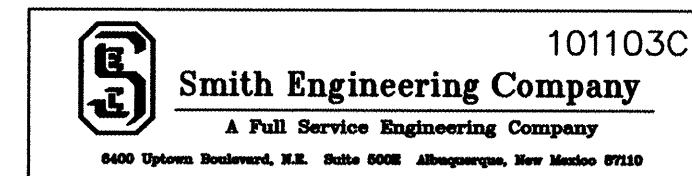

|   |                        |                    |       |
|---|------------------------|--------------------|-------|
| CITY OF ALBUQUERQUE<br>DEPARTMENT OF MUNICIPAL DEVELOPMENT<br>PARK AND MEDIAN DESIGN DIVISION |                        |                    |       |
| TITLE: COMANCHE PARK - PHASE 1<br>FIELD RETAINING WALL DETAIL                                 |                        |                    |       |
| Design Review Committee   | City Engineer Approval | Last Design Update |       |
| City Project No. 713991   | Zone Map No. G-16      | Sheet 10           | Of 13 |

| AS BUILT INFORMATION   |                       |      |  |
|------------------------|-----------------------|------|--|
| CONTRACTOR             | WORKS                 | DATE |  |
|                        | STAGED BY             | DATE |  |
|                        | ACCEPTANCE BY         | DATE |  |
|                        | FIELD VERIFICATION BY | DATE |  |
|                        | DRAWINGS CORRECTED BY | DATE |  |
| MICRO-FILM INFORMATION |                       |      |  |
|                        | RECORDED BY           | DATE |  |
|                        | NO.                   |      |  |

| BENCH MARKS |      |
|-------------|------|
| NO.         | DATE |
|             |      |
|             |      |
|             |      |
|             |      |

| SURVEY INFORMATION |      |
|--------------------|------|
| FIELD NOTES        | DATE |
| NO.                | BY   |
|                    |      |
|                    |      |
|                    |      |
|                    |      |

| ENGINEERS SEAL |      |
|----------------|------|
| NO.            | DATE |
|                |      |
|                |      |
|                |      |
|                |      |

| REVISIONS |      |
|-----------|------|
| NO.       | DATE |
|           |      |
|           |      |
|           |      |
|           |      |

| DESIGN      |      |
|-------------|------|
| DESIGNED BY | DATE |
| DRAWN BY    | DATE |
| CHECKED BY  | DATE |
|             |      |
|             |      |



CONSTRUCTION TRAFFIC CONTROL GENERAL NOTES

1. CONTRACTOR MUST OBTAIN FROM CONSTRUCTION COORDINATION AN EXCAVATION/BARRICADING PERMIT BEFORE ENGAGING IN ANY CONSTRUCTION, MAINTENANCE OR REPAIR WORK IN ANY OF THE CITY OF ALBUQUERQUE'S RIGHTS-OF-WAY. EMERGENCY WORK THAT WOULD PRESERVE LIFE OR PROPERTY IS EXCLUDED WITH THE UNDERSTANDING, THAT A PERMIT SHALL BE OBTAINED WITHIN 24 TO 48 HOURS.

2. CONTRACTOR SHALL AT THE TIME OF PERMIT REQUEST, SUBMIT FOR APPROVAL BY CONSTRUCTION COORDINATION, A TRAFFIC CONTROL PLAN DETAILING ALL EXISTING TOPOGRAPHY SUCH AS LANE WIDTHS, DRIVEWAYS, AND BUSINESS/RESIDENTIAL ACCESSES. THE TRAFFIC CONTROL PLAN SHALL INCLUDE ALL PHASES OF WORK AND SCHEDULES INVOLVED IN THE CONSTRUCTION PROJECT. ANY SEPARATE PHASES OF A CONSTRUCTION PROJECT SHALL BE GIVEN AN INDIVIDUAL PERMIT EACH. BLANKET PERMITS WILL NOT BE ISSUED.

3. THESE TYPICAL TRAFFIC CONTROL PLANS DO NOT REFLECT THE EXISTING TOPOGRAPHY SUCH AS DRIVEWAYS, LANE WIDTHS, AND BUSINESS/RESIDENTIAL ACCESSES. EVERY LOCATION THAT REQUIRES CONSTRUCTION TRAFFIC CONTROL SHALL HAVE A DETAILED TRAFFIC CONTROL PLAN SHOWING ALL EXISTING TOPOGRAPHY.

4. CONSTRUCTION SHALL NOT BEGIN UNLESS A TRAFFIC CONTROL PLAN HAS BEEN APPROVED AND VERIFIED BY CONSTRUCTION COORDINATION.

5. CONSTRUCTION COORDINATION SHALL BE NOTIFIED 48 HOURS PRIOR TO ANY TRAFFIC CONTROL CHANGES NEEDED BY CONTRACTOR, THAT WERE NOT PREVIOUSLY APPROVED. THESE TRAFFIC CONTROL CHANGES SHALL BE REQUESTED IN WRITING ACCOMPANIED WITH A TRAFFIC CONTROL PLAN REFLECTING SUCH CHANGES.

6. ALL CONSTRUCTION TRAFFIC CONTROL DEVICES SHALL COMPLY TO THE MANUAL ON UNIFORM TRAFFIC CONTROL DEVICES (MUTCD), LATEST EDITION. IT IS THE RESPONSIBILITY OF THE CONTRACTOR TO INSTALL, SERVICE AND MAINTAIN ALL TRAFFIC CONTROL DEVICES. TRAFFIC CONTROL DEVICES SHALL NOT BE REMOVED OR ALTERED IN ANY WAY WITHOUT THE APPROVAL OF CONSTRUCTION COORDINATION, PER SECTION 6A-4 OF THE MUTCD, LATEST EDITION.

7. THE CONSTRUCTION TRAFFIC CONTROL INITIAL SET-UP SHALL BE BY AN AMERICAN TRAFFIC SAFETY SERVICES ASSOCIATION (ATSSA) CERTIFIED WORKSITE TRAFFIC SUPERVISOR. THE MAINTENANCE AND SERVICING SHALL ALSO BE DONE BY AN ATSSA CERTIFIED WORKSITE TRAFFIC SUPERVISOR OR EQUIVALENT.

8. CONTRACTOR IS RESPONSIBLE TO MAINTAIN AND SERVICE ALL TRAFFIC CONTROL DEVICES 24 HOURS A DAY, 7 DAYS A WEEK THROUGHOUT LENGTH OF PROJECT. CONTRACTOR IS RESPONSIBLE THAT ALL TRAFFIC CONTROL DEVICES COMPLY WITH THE MUTCD, LATEST EDITION.

9. ALL ADVANCE WARNING SIGNS SHALL BE DOUBLE INDICATED WHENEVER THERE ARE MULTI-LANE TRAFFIC IN ANY ONE GIVEN DIRECTION AND THERE IS SUFFICIENT MEDIAN SPACE.

10. ALL BARRICADES IN ALL TAPERS AND TANGENTS SHALL BE PLACED APART, A DISTANCE MEASURED IN FEET, EQUAL TO THAT OF THE POSTED SPEED LIMIT. NO EXCEPTIONS UNLESS APPROVED BY CONSTRUCTION COORDINATION PER MUTCD SECTION 6A-4.

11. ALL WORK IN ARTERIAL ROADWAYS SHALL BE ON A CONTINUOUS 24-HOUR PER DAY BASIS UNTIL COMPLETED.

12. CONTRACTOR IS RESPONSIBLE TO PROVIDE CONSTRUCTION COORDINATION, A WEEKLY LOG OF DAILY INSPECTIONS OF BARRICADE AND MAINTENANCE SCHEDULES ON PROJECTS THAT ARE OVER ONE WEEK DURATION.

13. EQUIPMENT OR MATERIALS SHALL NOT BE STORED WITHIN 15 FEET OF A TRAVELED TRAFFIC LANE DURING NON-WORKING HOURS WITHOUT THE APPROVAL OF CONSTRUCTION COORDINATION.

14. CONTRACTOR SHALL PROVIDE AND MAINTAIN A SAFE AND ADEQUATE MEANS OF CHANNELIZING PEDESTRIAN TRAFFIC AROUND AND THROUGH THE CONSTRUCTION AREA.

15. CONTRACTOR IS RESPONSIBLE FOR OBLITERATION OF ANY CONFLICTING STRIPING AND RESPONSIBLE FOR ALL TEMPORARY STRIPING.

16. CONTRACTOR SHALL MAINTAIN ACCESS TO ALL FACILITIES, BUSINESSES AND/OR RESIDENTS AT ALL TIMES.

17. CONTRACTOR SHALL PROVIDE ACCESS SIGNS FOR BUSINESSES LOCATED WITHIN THE CONSTRUCTION AREA UNDER THE SUPERVISION OF CONSTRUCTION COORDINATION. EACH ACCESS SIGN SHALL HAVE 5 INCH, WHITE OPAQUE LETTERING ON BLUE REFLECTORIZED BACKGROUND. ACCESS SIGNS SHALL BE CONSIDERED INCIDENTAL TO THE BID AND NOT PART OF THE CONTRACT UNLESS OTHERWISE STATED. NO MORE THAN 3 BUSINESSES SHALL BE LISTED ON A ACCESS SIGN. SHOPPING CENTERS AND MALLS SHALL BE LISTED AS SUCH.

18. ALL ADVANCE WARNING SIGNS SHALL MEET THE MINIMUM REFLECTIVE INTENSITY REQUIREMENTS SET FORTH BY THE CITY OF ALBUQUERQUE. CONSTRUCTION COORDINATION SHALL DETERMINE ALL REQUIREMENTS AND APPROVE OR DISAPPROVE ANY ADVANCE WARNING SIGN PER SECTION 6A-4 OF THE MUTCD, LATEST EDITION.

19. 48-HOURS PRIOR TO OCCUPYING OR CLOSING OF A RIGHT-OF-WAY, CONTRACTOR SHALL NOTIFY: POLICE, FIRE DEPARTMENT, SCHOOLS, HOSPITALS, TRANSIT AUTHORITY, BUSINESSES AND/OR RESIDENTS THAT WILL BE AFFECTED BY THE CONSTRUCTION.

20. ANY FIELD ADJUSTMENTS SHALL BE APPROVED BY CONSTRUCTION COORDINATION.

21. EXCAVATIONS SHALL BE PLATED, TEMPORARILY PATCHED OR RESURFACED PRIOR TO OPENING OF TRAFFIC. A MINIMUM OF 11 FEET SHALL BE PROVIDED FOR TRAFFIC IN ANY GIVEN DIRECTION. CONTRACTOR IS RESPONSIBLE FOR ANY WORK INVOLVED IN SATISFYING THESE REQUIREMENTS.

22. CONTRACTOR SHALL AT ALL TIMES COMPLY WITH THE FOLLOWING:  
1. STANDARDS AND REQUIREMENTS SET FORTH IN THE MANUAL ON UNIFORM TRAFFIC CONTROL DEVICES, LATEST EDITION.  
2. THE CITY OF ALBUQUERQUE TRAFFIC CODE, LATEST EDITION.  
3. SECTION 19 OF THE CITY OF ALBUQUERQUE'S STANDARD SPECIFICATIONS FOR PUBLIC WORK CONSTRUCTION, AS WELL AS OTHER SECTIONS.

23. FAILURE TO COMPLY WITH ANY OF THE ABOVE MENTIONED, WILL BE ADEQUATE CAUSE TO CEASE ALL WORK ON ANY CONSTRUCTION PROJECT. WORK WILL NOT RESUME UNTIL ALL REQUIREMENTS ARE ADDRESSED AND APPROVED BY CONSTRUCTION COORDINATION.

24. ALL TRAFFIC CONTROL DEVICES SHALL BE KEPT IN NEW-CLEAN CONDITION. WASHING OF EQUIPMENT IS INCIDENTAL TO IT'S PLACEMENT AND MAINTENANCE.

25. TRAFFIC CONTROL STANDARDS APPLY ONLY WHERE THE CONSTRUCTION TRAFFIC CONTROL PLANS ARE NOT SPECIFIC.

26. ADVANCE WARNING SIGNS SHALL BE 36"x36" WITH SUPER ENGINEERING GRADE SHEETING OR BETTER. MOUNTING HEIGHT AT TOP OF SIGN SHALL BE THE SAME AS FOR A 48-INCH SIGN AS INDICATED IN THE MUTCD.

27. CONTRACTOR SHALL MAINTAIN A GRAFFITI-FREE WORK SITE. CONTRACTOR SHALL PROMPTLY REMOVE ANY AND ALL GRAFFITI FROM ALL EQUIPMENT, WHETHER PERMANENT OR TEMPORARY.

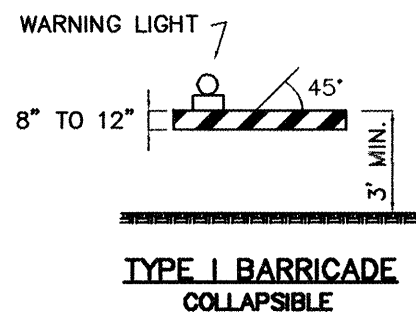
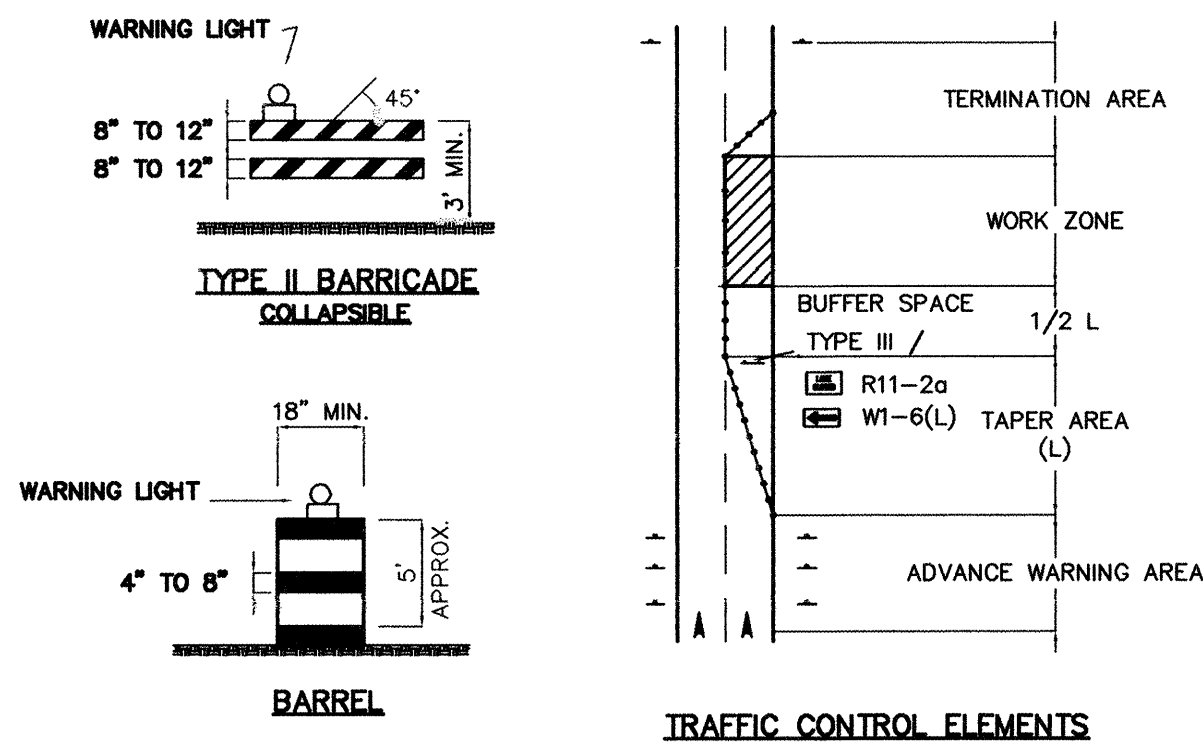
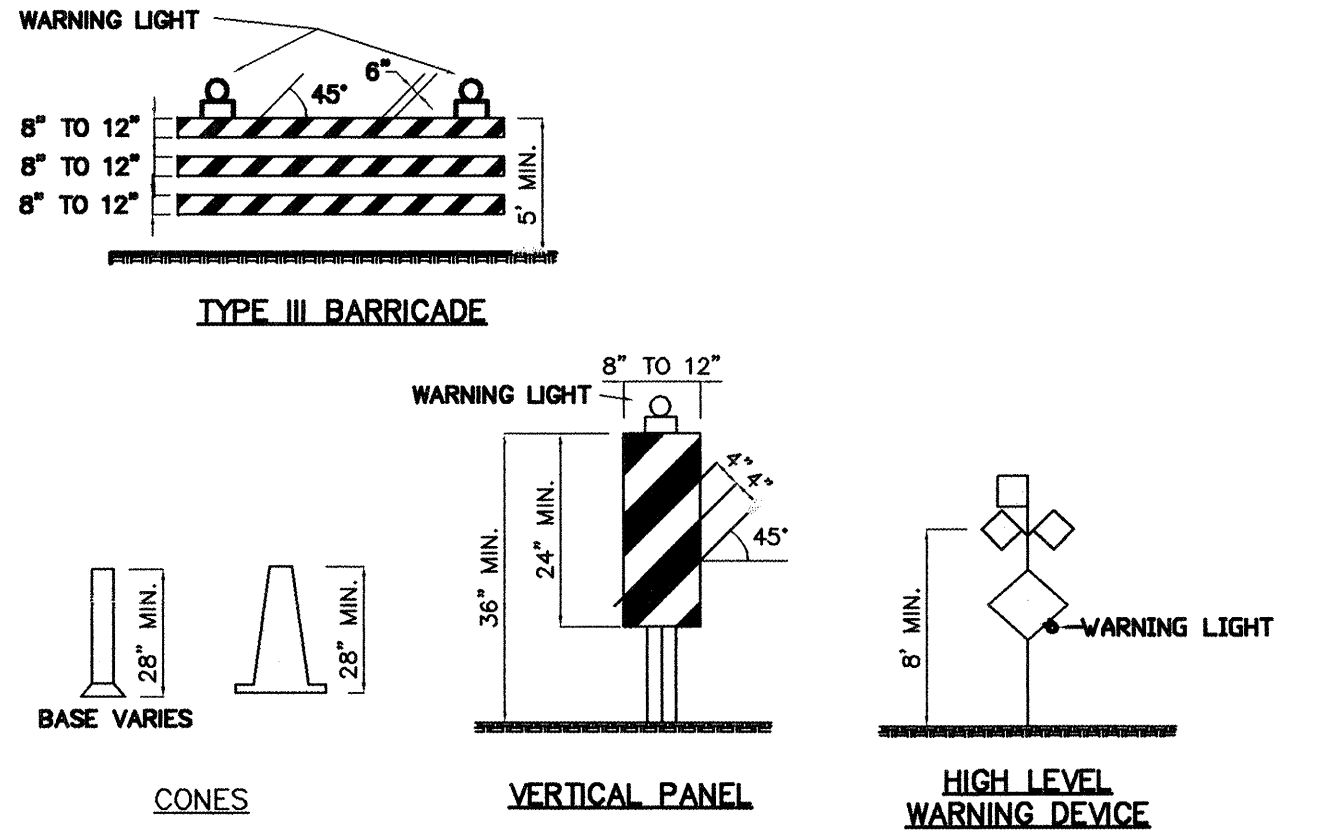

LEGEND:

- TRAFFIC FLOW
- TRAFFIC CONTROL WARNING SIGN
- TRAFFIC CONTROL BARREL
- TRAFFIC CONTROL TYPE III BARRICADE
- EXISTING CURB-AND-GUTTER
- EXISTING STRIPING
- ONSITE CONSTRUCTION ZONE
- VERTICAL PANEL SIGN W/ SUPPORT
- ARROW BOARD

TAPER REQUIREMENTS

| SPEED LIMIT (MPH) | TAPER LENGTH (L) (FEET) |          |          | MINIMUM NUMBER OF DEVICES FOR TAPER | MAXIMUM DEVICE SPACING IN FEET |             |
|-------------------|-------------------------|----------|----------|-------------------------------------|--------------------------------|-------------|
|                   | 10' LANE                | 11' LANE | 12' LANE |                                     | ALONG TAPER                    | AFTER TAPER |
| 20                | 70                      | 75       | 80       | 5                                   | 20                             | 20          |
| 25                | 105                     | 115      | 125      | 6                                   | 25                             | 25          |
| 30                | 150                     | 165      | 180      | 7                                   | 30                             | 30          |
| 35                | 205                     | 225      | 245      | 8                                   | 35                             | 35          |
| 40                | 270                     | 295      | 320      | 9                                   | 40                             | 40          |
| 45                | 450                     | 495      | 540      | 13                                  | 45                             | 45          |
| 50                | 500                     | 550      | 600      | 13                                  | 50                             | 50          |
| 55                | 550                     | 605      | 660      | 13                                  | 55                             | 55          |

RECOMMENDED SIGN SPACING(D) FOR ADVANCE WARNING SIGN SERIES

| SPEED MILES PER HOUR | MINIMUM DISTANCE IN FEET BETWEEN SIGNS | FROM LAST SIGN TO TAPER |
|----------------------|--|-------------------------|
| 0-20                 | 10 X SPEED LIMIT                       | 10 X SPEED LIMIT        |
| 25-30                | 10 X SPEED LIMIT                       | 10 X SPEED LIMIT        |
| 30-35                | 10 X SPEED LIMIT                       | 10 X SPEED LIMIT        |
| 40-45                | 10 X SPEED LIMIT                       | 10 X SPEED LIMIT        |
| 50-60                | 10 X SPEED LIMIT                       | 10 X SPEED LIMIT        |

TAPER CRITERIA

| TYPE OF TAPER         | TAPER LENGTH      |
|-----------------------|-------------------|
| UPSTREAM TAPER:       |                   |
| MERGING TAPER         | L MINIMUM         |
| SHIFTING TAPER        | 1/2 L MINIMUM     |
| SHOULDER TAPER        | 1/2 L MINIMUM     |
| TWO-WAY TRAFFIC TAPER | 100 FEET MAXIMUM  |
| DOWNSTREAM TAPERS     | 100 FEET PER LANE |

TAPER LENGTH COMPUTATION

| SPEED LIMIT  |                       |
|--|-----------------------|
| 40 MPH OR LESS   | $L = \frac{WS^2}{60}$ |
| 45 MPH OR GREATER  | $L = W \times S$      |
| L = TAPER LENGTH<br>W = WIDTH OF OFFSET IN FEET<br>S = POSTED SPEED OR OFF-PEAK 85-PERCENTILE SPEED IN MPH |                       |

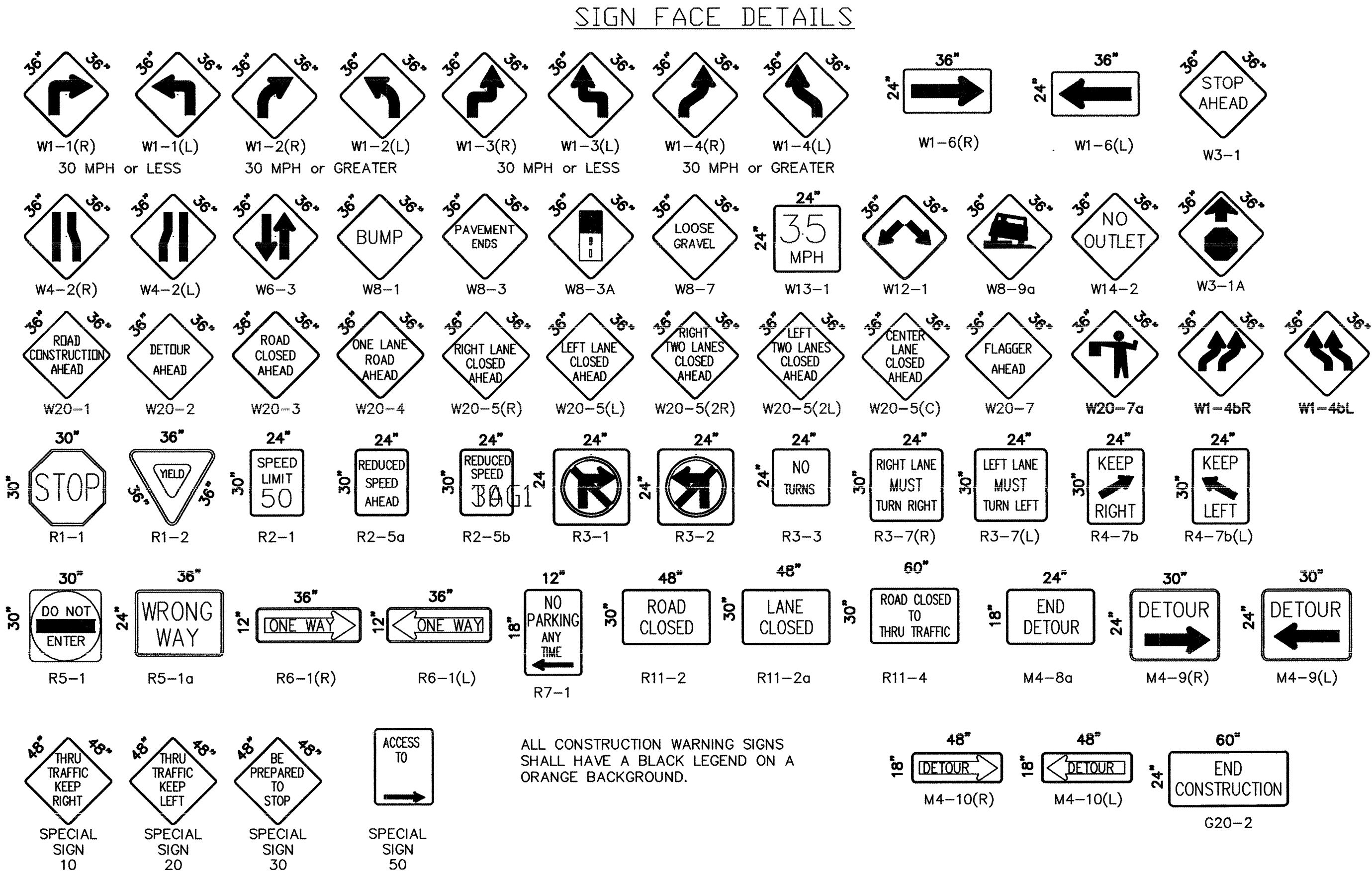

ALL CONSTRUCTION WARNING SIGNS SHALL HAVE A BLACK LEGEND ON A ORANGE BACKGROUND.

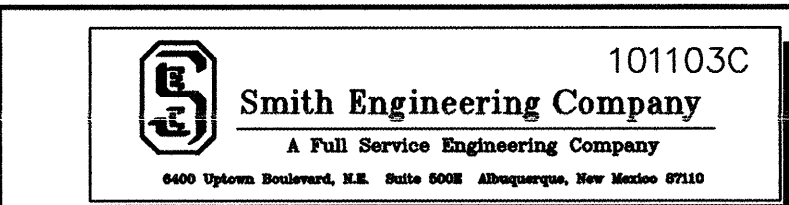

CITY OF ALBUQUERQUE  
DEPARTMENT OF MUNICIPAL DEVELOPMENT  
PARK AND MEDIAN DESIGN DIVISION

TITLE: COMANCHE PARK - PHASE 1  
SIGNING & TRAFFIC CONTROL STANDARDS

Design Review Committee: City Engineer Approval

C.O.A. STD.

City Project No. 713991 Zone Map No. G-16 Sheet 11 Of 13



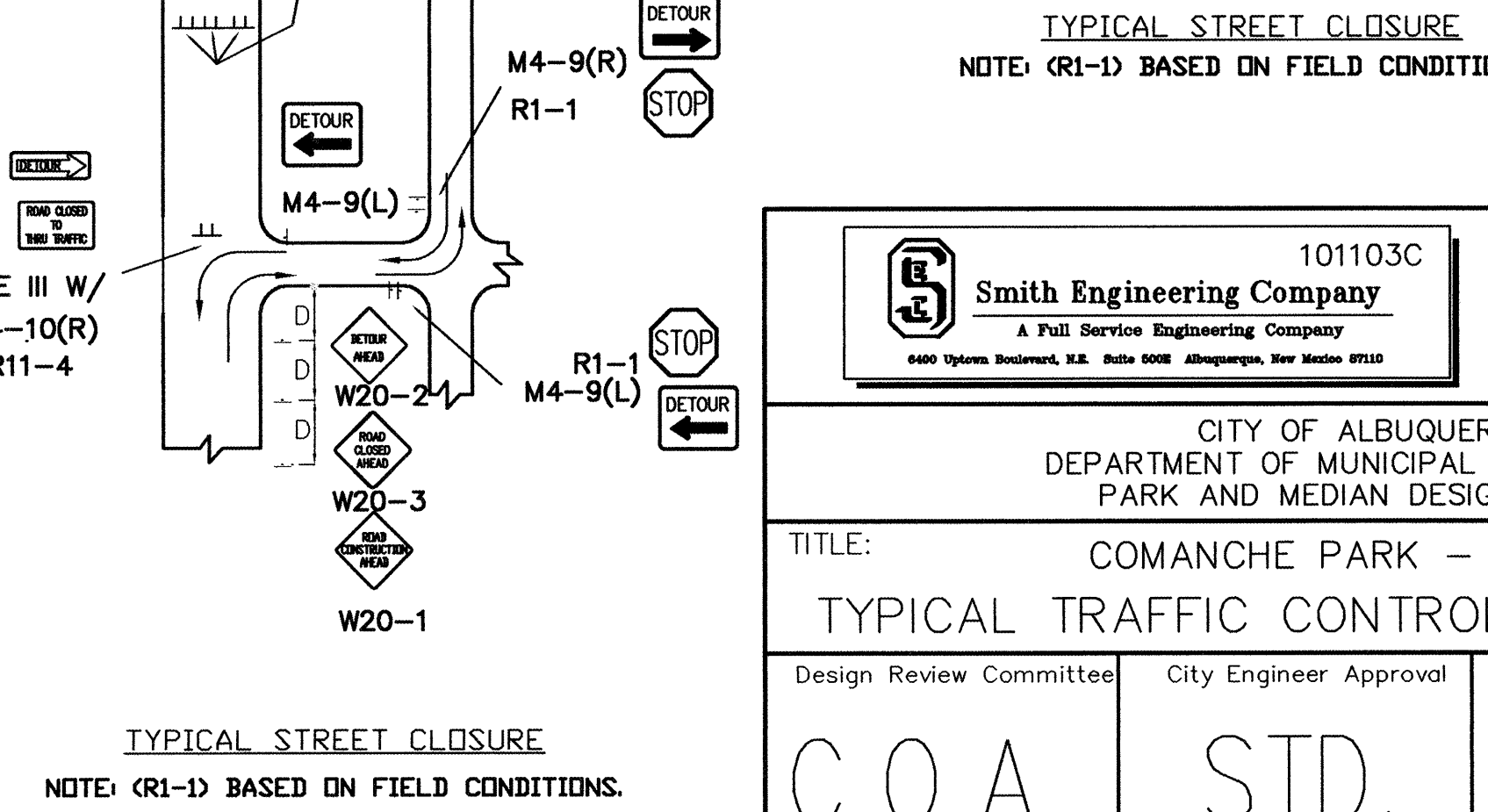

|                        |  |  |  |  |  |  |  |  |  |                               |  |  |  |  |  |  |  |  |  |    |                 |  |  |  |  |  |  |  |  |  |                    |  |  |  |  |  |  |  |  |  |             |  |  |  |  |  |  |  |  |  |                      |  |  |  |  |  |  |  |  |  |  |  |  |  |  |  |  |  |  |  |  |  |  |  |  |  |  |  |  |  |  |  |  |  |  |  |  |  |  |  |  |  |  |  |  |  |  |  |  |  |  |  |  |  |  |  |  |  |  |  |  |  |  |  |  |  |  |  |  |  |  |  |  |  |  |  |  |  |  |  |  |  |  |  |  |  |  |  |  |  |  |  |  |  |  |  |  |  |  |  |  |  |  |  |  |  |  |  |  |  |  |  |  |  |  |  |  |  |  |  |  |  |  |  |  |  |  |  |  |  |  |  |  |  |  |  |  |  |  |  |  |  |  |  |  |  |  |  |  |  |  |  |  |  |  |  |  |  |  |  |  |  |  |  |  |  |  |  |  |  |  |  |  |  |  |  |  |  |  |  |  |  |  |  |  |  |  |  |  |  |  |  |  |  |  |  |  |  |  |  |  |  |  |  |  |  |  |  |  |  |  |  |  |  |  |  |  |  |  |  |  |  |  |  |  |  |  |  |  |  |  |  |  |  |  |  |  |  |  |  |  |  |  |  |  |  |  |  |  |  |  |  |  |  |  |  |  |  |  |  |  |  |  |  |  |  |  |  |  |  |  |  |  |  |  |  |  |  |  |  |  |  |  |  |  |  |  |  |  |  |  |  |  |  |  |  |  |  |  |  |  |  |  |  |  |  |  |  |  |  |  |  |  |  |  |  |  |  |  |  |  |  |  |  |  |  |  |  |  |  |  |  |  |  |  |  |  |  |  |  |  |  |  |  |  |  |  |  |  |  |  |  |  |  |  |  |  |  |  |  |  |  |  |  |  |  |  |  |  |  |  |  |  |  |  |  |  |  |  |  |  |  |  |  |  |  |  |  |  |  |  |  |  |  |  |  |  |  |  |  |  |  |  |  |  |  |  |  |  |  |  |  |  |  |  |  |  |  |  |  |  |  |  |  |  |  |  |  |  |  |  |  |  |  |  |  |  |  |  |  |  |  |  |  |  |  |  |  |  |  |  |  |  |  |  |  |  |  |  |  |  |  |  |  |  |  |  |  |  |  |  |  |  |  |  |  |  |  |  |  |  |  |  |  |  |  |  |  |  |  |  |  |  |  |  |  |  |  |  |  |  |  |  |  |  |  |  |  |  |  |  |  |  |  |  |  |  |  |  |  |  |  |  |  |  |  |  |  |  |  |  |  |  |  |  |  |  |  |  |  |  |  |  |  |  |  |  |  |  |  |  |  |  |  |  |  |  |  |  |  |  |  |  |  |  |  |  |  |  |  |  |  |  |  |  |  |  |  |  |  |  |  |  |  |  |  |  |  |  |  |  |  |  |  |  |  |  |  |  |  |  |  |  |  |  |  |  |  |  |  |  |  |  |  |  |  |  |  |  |  |  |  |  |  |  |  |  |  |  |  |  |  |  |  |  |  |  |  |  |  |  |  |  |  |  |  |  |  |  |  |  |  |  |  |  |  |  |  |  |  |  |  |  |  |  |  |  |  |  |  |  |  |  |  |  |  |  |  |  |  |  |  |  |  |  |  |  |  |  |  |  |  |  |  |  |  |  |  |  |  |  |  |  |  |  |  |  |  |  |  |  |  |  |  |  |  |  |  |  |  |  |  |  |  |  |  |  |  |  |  |  |  |  |  |  |  |  |  |  |  |  |  |  |  |  |  |  |  |  |  |  |  |  |  |  |  |  |  |  |  |  |  |  |  |  |  |  |  |  |  |  |  |  |  |  |  |  |  |  |  |  |  |  |  |  |  |  |  |  |  |  |  |  |  |  |  |  |  |  |  |  |  |  |  |  |  |  |  |  |  |  |  |  |  |  |  |  |  |  |  |  |  |  |  |  |  |  |  |  |  |  |  |  |  |  |  |  |  |  |  |  |  |  |  |  |  |  |  |  |  |  |  |  |  |  |  |  |  |  |  |  |  |  |  |  |  |  |  |  |  |  |  |  |  |  |  |  |  |  |  |  |  |  |  |  |  |  |  |  |  |  |  |  |  |  |  |  |  |  |  |  |  |  |  |  |  |  |  |  |  |  |  |  |  |  |  |  |  |  |  |  |  |  |  |  |  |  |  |  |  |  |  |  |  |  |  |  |  |  |  |  |  |  |  |  |  |  |  |  |  |  |  |  |  |  |  |  |  |  |  |  |  |  |  |  |  |  |  |  |  |  |  |  |  |  |  |  |  |  |  |  |  |  |  |  |  |  |  |  |  |  |  |  |  |  |  |  |  |  |  |  |  |  |  |  |  |  |  |  |  |  |  |  |  |  |  |  |  |  |  |  |  |  |  |  |  |  |  |  |  |  |  |  |  |  |  |  |  |  |  |  |  |  |  |  |  |  |  |  |  |  |  |  |  |  |  |  |  |  |  |  |  |  |  |  |  |  |  |  |  |  |  |  |  |  |  |  |  |  |  |  |  |  |  |  |  |  |  |  |  |  |  |  |
|------------------------|--|--|--|--|--|--|--|--|--|-------------------------------|--|--|--|--|--|--|--|--|--|----|-----------------|--|--|--|--|--|--|--|--|--|--------------------|--|--|--|--|--|--|--|--|--|-------------|--|--|--|--|--|--|--|--|--|----------------------|--|--|--|--|--|--|--|--|--|--|--|--|--|--|--|--|--|--|--|--|--|--|--|--|--|--|--|--|--|--|--|--|--|--|--|--|--|--|--|--|--|--|--|--|--|--|--|--|--|--|--|--|--|--|--|--|--|--|--|--|--|--|--|--|--|--|--|--|--|--|--|--|--|--|--|--|--|--|--|--|--|--|--|--|--|--|--|--|--|--|--|--|--|--|--|--|--|--|--|--|--|--|--|--|--|--|--|--|--|--|--|--|--|--|--|--|--|--|--|--|--|--|--|--|--|--|--|--|--|--|--|--|--|--|--|--|--|--|--|--|--|--|--|--|--|--|--|--|--|--|--|--|--|--|--|--|--|--|--|--|--|--|--|--|--|--|--|--|--|--|--|--|--|--|--|--|--|--|--|--|--|--|--|--|--|--|--|--|--|--|--|--|--|--|--|--|--|--|--|--|--|--|--|--|--|--|--|--|--|--|--|--|--|--|--|--|--|--|--|--|--|--|--|--|--|--|--|--|--|--|--|--|--|--|--|--|--|--|--|--|--|--|--|--|--|--|--|--|--|--|--|--|--|--|--|--|--|--|--|--|--|--|--|--|--|--|--|--|--|--|--|--|--|--|--|--|--|--|--|--|--|--|--|--|--|--|--|--|--|--|--|--|--|--|--|--|--|--|--|--|--|--|--|--|--|--|--|--|--|--|--|--|--|--|--|--|--|--|--|--|--|--|--|--|--|--|--|--|--|--|--|--|--|--|--|--|--|--|--|--|--|--|--|--|--|--|--|--|--|--|--|--|--|--|--|--|--|--|--|--|--|--|--|--|--|--|--|--|--|--|--|--|--|--|--|--|--|--|--|--|--|--|--|--|--|--|--|--|--|--|--|--|--|--|--|--|--|--|--|--|--|--|--|--|--|--|--|--|--|--|--|--|--|--|--|--|--|--|--|--|--|--|--|--|--|--|--|--|--|--|--|--|--|--|--|--|--|--|--|--|--|--|--|--|--|--|--|--|--|--|--|--|--|--|--|--|--|--|--|--|--|--|--|--|--|--|--|--|--|--|--|--|--|--|--|--|--|--|--|--|--|--|--|--|--|--|--|--|--|--|--|--|--|--|--|--|--|--|--|--|--|--|--|--|--|--|--|--|--|--|--|--|--|--|--|--|--|--|--|--|--|--|--|--|--|--|--|--|--|--|--|--|--|--|--|--|--|--|--|--|--|--|--|--|--|--|--|--|--|--|--|--|--|--|--|--|--|--|--|--|--|--|--|--|--|--|--|--|--|--|--|--|--|--|--|--|--|--|--|--|--|--|--|--|--|--|--|--|--|--|--|--|--|--|--|--|--|--|--|--|--|--|--|--|--|--|--|--|--|--|--|--|--|--|--|--|--|--|--|--|--|--|--|--|--|--|--|--|--|--|--|--|--|--|--|--|--|--|--|--|--|--|--|--|--|--|--|--|--|--|--|--|--|--|--|--|--|--|--|--|--|--|--|--|--|--|--|--|--|--|--|--|--|--|--|--|--|--|--|--|--|--|--|--|--|--|--|--|--|--|--|--|--|--|--|--|--|--|--|--|--|--|--|--|--|--|--|--|--|--|--|--|--|--|--|--|--|--|--|--|--|--|--|--|--|--|--|--|--|--|--|--|--|--|--|--|--|--|--|--|--|--|--|--|--|--|--|--|--|--|--|--|--|--|--|--|--|--|--|--|--|--|--|--|--|--|--|--|--|--|--|--|--|--|--|--|--|--|--|--|--|--|--|--|--|--|--|--|--|--|--|--|--|--|--|--|--|--|--|--|--|--|--|--|--|--|--|--|--|--|--|--|--|--|--|--|--|--|--|--|--|--|--|--|--|--|--|--|--|--|--|--|--|--|--|--|--|--|--|--|--|--|--|--|--|--|--|--|--|--|--|--|--|--|--|--|--|--|--|--|--|--|--|--|--|--|--|--|--|--|--|--|--|--|--|--|--|--|--|--|--|--|--|--|--|--|--|--|--|--|--|--|--|--|--|--|--|--|--|--|--|--|--|--|--|--|--|--|--|--|--|--|--|--|--|--|--|--|--|--|--|--|--|--|--|--|--|--|--|--|--|--|--|--|--|--|--|--|--|--|--|--|--|--|--|--|--|--|--|--|--|--|--|--|--|--|--|--|--|--|--|--|--|--|--|--|--|--|--|--|--|--|--|--|--|--|--|--|--|--|--|--|--|--|--|--|--|--|--|--|--|--|--|--|--|--|--|--|--|--|--|--|--|--|--|--|--|--|--|--|--|--|--|--|--|--|--|--|--|--|--|--|--|--|--|--|--|--|--|--|--|--|--|--|--|--|--|--|--|--|--|--|--|--|--|--|--|--|--|--|--|--|--|--|--|--|--|--|--|--|--|--|--|--|--|--|--|--|--|--|--|--|--|--|--|--|--|--|--|--|--|--|--|--|--|--|--|--|--|--|--|--|
| PHASE 1<br>AND SIGNING |  |  |  |  |  |  |  |  |  | SHEET DEVELOPMENT<br>DIVISION |  |  |  |  |  |  |  |  |  | \$ | ENGINEER'S SEAL |  |  |  |  |  |  |  |  |  | SURVEY INFORMATION |  |  |  |  |  |  |  |  |  | BENCH MARKS |  |  |  |  |  |  |  |  |  | AS-BUILT INFORMATION |  |  |  |  |  |  |  |  |  |  |  |  |  |  |  |  |  |  |  |  |  |  |  |  |  |  |  |  |  |  |  |  |  |  |  |  |  |  |  |  |  |  |  |  |  |  |  |  |  |  |  |  |  |  |  |  |  |  |  |  |  |  |  |  |  |  |  |  |  |  |  |  |  |  |  |  |  |  |  |  |  |  |  |  |  |  |  |  |  |  |  |  |  |  |  |  |  |  |  |  |  |  |  |  |  |  |  |  |  |  |  |  |  |  |  |  |  |  |  |  |  |  |  |  |  |  |  |  |  |  |  |  |  |  |  |  |  |  |  |  |  |  |  |  |  |  |  |  |  |  |  |  |  |  |  |  |  |  |  |  |  |  |  |  |  |  |  |  |  |  |  |  |  |  |  |  |  |  |  |  |  |  |  |  |  |  |  |  |  |  |  |  |  |  |  |  |  |  |  |  |  |  |  |  |  |  |  |  |  |  |  |  |  |  |  |  |  |  |  |  |  |  |  |  |  |  |  |  |  |  |  |  |  |  |  |  |  |  |  |  |  |  |  |  |  |  |  |  |  |  |  |  |  |  |  |  |  |  |  |  |  |  |  |  |  |  |  |  |  |  |  |  |  |  |  |  |  |  |  |  |  |  |  |  |  |  |  |  |  |  |  |  |  |  |  |  |  |  |  |  |  |  |  |  |  |  |  |  |  |  |  |  |  |  |  |  |  |  |  |  |  |  |  |  |  |  |  |  |  |  |  |  |  |  |  |  |  |  |  |  |  |  |  |  |  |  |  |  |  |  |  |  |  |  |  |  |  |  |  |  |  |  |  |  |  |  |  |  |  |  |  |  |  |  |  |  |  |  |  |  |  |  |  |  |  |  |  |  |  |  |  |  |  |  |  |  |  |  |  |  |  |  |  |  |  |  |  |  |  |  |  |  |  |  |  |  |  |  |  |  |  |  |  |  |  |  |  |  |  |  |  |  |  |  |  |  |  |  |  |  |  |  |  |  |  |  |  |  |  |  |  |  |  |  |  |  |  |  |  |  |  |  |  |  |  |  |  |  |  |  |  |  |  |  |  |  |  |  |  |  |  |  |  |  |  |  |  |  |  |  |  |  |  |  |  |  |  |  |  |  |  |  |  |  |  |  |  |  |  |  |  |  |  |  |  |  |  |  |  |  |  |  |  |  |  |  |  |  |  |  |  |  |  |  |  |  |  |  |  |  |  |  |  |  |  |  |  |  |  |  |  |  |  |  |  |  |  |  |  |  |  |  |  |  |  |  |  |  |  |  |  |  |  |  |  |  |  |  |  |  |  |  |  |  |  |  |  |  |  |  |  |  |  |  |  |  |  |  |  |  |  |  |  |  |  |  |  |  |  |  |  |  |  |  |  |  |  |  |  |  |  |  |  |  |  |  |  |  |  |  |  |  |  |  |  |  |  |  |  |  |  |  |  |  |  |  |  |  |  |  |  |  |  |  |  |  |  |  |  |  |  |  |  |  |  |  |  |  |  |  |  |  |  |  |  |  |  |  |  |  |  |  |  |  |  |  |  |  |  |  |  |  |  |  |  |  |  |  |  |  |  |  |  |  |  |  |  |  |  |  |  |  |  |  |  |  |  |  |  |  |  |  |  |  |  |  |  |  |  |  |  |  |  |  |  |  |  |  |  |  |  |  |  |  |  |  |  |  |  |  |  |  |  |  |  |  |  |  |  |  |  |  |  |  |  |  |  |  |  |  |  |  |  |  |  |  |  |  |  |  |  |  |  |  |  |  |  |  |  |  |  |  |  |  |  |  |  |  |  |  |  |  |  |  |  |  |  |  |  |  |  |  |  |  |  |  |  |  |  |  |  |  |  |  |  |  |  |  |  |  |  |  |  |  |  |  |  |  |  |  |  |  |  |  |  |  |  |  |  |  |  |  |  |  |  |  |  |  |  |  |  |  |  |  |  |  |  |  |  |  |  |  |  |  |  |  |  |  |  |  |  |  |  |  |  |  |  |  |  |  |  |  |  |  |  |  |  |  |  |  |  |  |  |  |  |  |  |  |  |  |  |  |  |  |  |  |  |  |  |  |  |  |  |  |  |  |  |  |  |  |  |  |  |  |  |  |  |  |  |  |  |  |  |  |  |  |  |  |  |  |  |  |  |  |  |  |  |  |  |  |  |  |  |  |  |  |  |  |  |  |  |  |  |  |  |  |  |  |  |  |  |  |  |  |  |  |  |  |  |  |  |  |  |  |  |  |  |  |  |  |  |  |  |  |  |  |  |  |  |  |  |  |  |  |  |  |  |  |  |  |  |  |  |  |  |  |  |  |  |  |  |  |  |  |  |  |  |  |  |  |  |  |  |  |  |  |  |  |  |  |  |  |  |  |  |  |  |  |  |  |  |  |  |  |  |  |  |  |  |  |  |  |  |  |  |  |  |  |  |  |  |  |  |  |  |  |  |  |  |  |  |  |
|                        |  |  |  |  |  |  |  |  |  |                               |  |  |  |  |  |  |  |  |  |    |                 |  |  |  |  |  |  |  |  |  |                    |  |  |  |  |  |  |  |  |  |             |  |  |  |  |  |  |  |  |  |                      |  |  |  |  |  |  |  |  |  |  |  |  |  |  |  |  |  |  |  |  |  |  |  |  |  |  |  |  |  |  |  |  |  |  |  |  |  |  |  |  |  |  |  |  |  |  |  |  |  |  |  |  |  |  |  |  |  |  |  |  |  |  |  |  |  |  |  |  |  |  |  |  |  |  |  |  |  |  |  |  |  |  |  |  |  |  |  |  |  |  |  |  |  |  |  |  |  |  |  |  |  |  |  |  |  |  |  |  |  |  |  |  |  |  |  |  |  |  |  |  |  |  |  |  |  |  |  |  |  |  |  |  |  |  |  |  |  |  |  |  |  |  |  |  |  |  |  |  |  |  |  |  |  |  |  |  |  |  |  |  |  |  |  |  |  |  |  |  |  |  |  |  |  |  |  |  |  |  |  |  |  |  |  |  |  |  |  |  |  |  |  |  |  |  |  |  |  |  |  |  |  |  |  |  |  |  |  |  |  |  |  |  |  |  |  |  |  |  |  |  |  |  |  |  |  |  |  |  |  |  |  |  |  |  |  |  |  |  |  |  |  |  |  |  |  |  |  |  |  |  |  |  |  |  |  |  |  |  |  |  |  |  |  |  |  |  |  |  |  |  |  |  |  |  |  |  |  |  |  |  |  |  |  |  |  |  |  |  |  |  |  |  |  |  |  |  |  |  |  |  |  |  |  |  |  |  |  |  |  |  |  |  |  |  |  |  |  |  |  |  |  |  |  |  |  |  |  |  |  |  |  |  |  |  |  |  |  |  |  |  |  |  |  |  |  |  |  |  |  |  |  |  |  |  |  |  |  |  |  |  |  |  |  |  |  |  |  |  |  |  |  |  |  |  |  |  |  |  |  |  |  |  |  |  |  |  |  |  |  |  |  |  |  |  |  |  |  |  |  |  |  |  |  |  |  |  |  |  |  |  |  |  |  |  |  |  |  |  |  |  |  |  |  |  |  |  |  |  |  |  |  |  |  |  |  |  |  |  |  |  |  |  |  |  |  |  |  |  |  |  |  |  |  |  |  |  |  |  |  |  |  |  |  |  |  |  |  |  |  |  |  |  |  |  |  |  |  |  |  |  |  |  |  |  |  |  |  |  |  |  |  |  |  |  |  |  |  |  |  |  |  |  |  |  |  |  |  |  |  |  |  |  |  |  |  |  |  |  |  |  |  |  |  |  |  |  |  |  |  |  |  |  |  |  |  |  |  |  |  |  |  |  |  |  |  |  |  |  |  |  |  |  |  |  |  |  |  |  |  |  |  |  |  |  |  |  |  |  |  |  |  |  |  |  |  |  |  |  |  |  |  |  |  |  |  |  |  |  |  |  |  |  |  |  |  |  |  |  |  |  |  |  |  |  |  |  |  |  |  |  |  |  |  |  |  |  |  |  |  |  |  |  |  |  |  |  |  |  |  |  |  |  |  |  |  |  |  |  |  |  |  |  |  |  |  |  |  |  |  |  |  |  |  |  |  |  |  |  |  |  |  |  |  |  |  |  |  |  |  |  |  |  |  |  |  |  |  |  |  |  |  |  |  |  |  |  |  |  |  |  |  |  |  |  |  |  |  |  |  |  |  |  |  |  |  |  |  |  |  |  |  |  |  |  |  |  |  |  |  |  |  |  |  |  |  |  |  |  |  |  |  |  |  |  |  |  |  |  |  |  |  |  |  |  |  |  |  |  |  |  |  |  |  |  |  |  |  |  |  |  |  |  |  |  |  |  |  |  |  |  |  |  |  |  |  |  |  |  |  |  |  |  |  |  |  |  |  |  |  |  |  |  |  |  |  |  |  |  |  |  |  |  |  |  |  |  |  |  |  |  |  |  |  |  |  |  |  |  |  |  |  |  |  |  |  |  |  |  |  |  |  |  |  |  |  |  |  |  |  |  |  |  |  |  |  |  |  |  |  |  |  |  |  |  |  |  |  |  |  |  |  |  |  |  |  |  |  |  |  |  |  |  |  |  |  |  |  |  |  |  |  |  |  |  |  |  |  |  |  |  |  |  |  |  |  |  |  |  |  |  |  |  |  |  |  |  |  |  |  |  |  |  |  |  |  |  |  |  |  |  |  |  |  |  |  |  |  |  |  |  |  |  |  |  |  |  |  |  |  |  |  |  |  |  |  |  |  |  |  |  |  |  |  |  |  |  |  |  |  |  |  |  |  |  |  |  |  |  |  |  |  |  |  |  |  |  |  |  |  |  |  |  |  |  |  |  |  |  |  |  |  |  |  |  |  |  |  |  |  |  |  |  |  |  |  |  |  |  |  |  |  |  |  |  |  |  |  |  |  |  |  |  |  |  |  |  |  |  |  |  |  |  |  |  |  |  |  |  |  |  |  |  |  |  |  |  |  |  |  |  |  |  |  |  |  |  |  |  |  |  |  |  |  |  |  |  |  |  |  |  |  |  |  |  |  |  |  |  |  |  |  |  |  |  |  |  |  |  |  |  |  |  |





SCALE: 1" = 40'-0"

## KEYED NOTES

- 1 PROVIDE AND INSTALL WEATHERPROOF DUPLEX RECEPTACLE ON 3'-0" SQUARE PRESSURE TREATED WOOD POST WITH CONCRETE BASE. EXTEND EMT DOWN POST UNDERGROUND TO PANEL "A". COORDINATE ROUTING IN FIELD WITH EXISTING CONDITIONS. PROVIDE TRENCH AND BACKFILL.
- 2 PROVIDE AND INSTALL 1" EMPTY CONDUIT CAPPED AND MARKED IN-1" W/CON SHOWN FOR FUTURE SCOREBOARD CONNECTIONS. EXTEND CONDUIT WITH PULL STRING TO PANEL INDICATED. PROVIDE TRENCH AND BACKFILL. COORDINATE ROUTING WITH EXISTING FIELD CONDITIONS.
- 3 PROVIDE IN-GROUND PULL BOX MIN. 18" DEEP X 18" SQUARE WITH LOCKABLE LID. INSTALL WP DUPLEX RECEPTACLE IN BOX. UTILIZE WEATHERPROOF J-BOX. EXTEND CONDUIT AND WIRE TO PANEL AND ROUT INDICATED. CONNECT AS REQUIRED. COORDINATE ROUTING WITH EXISTING CONDITIONS IN FIELD. PROVIDE TRENCH AND BACKFILL.
- 4 PANEL "A". MOUNT TO UNISTRUT SUPPORT FRAME WITH CONCRETE BASE. SEE PANEL SCHEDULE.
- 5 TEMPORARY CONCESSIONS TRAILER LOCATION. EXTEND CONDUIT AND WIRE AS INDICATED TO TRAILER MOUNTED DISCONNECT AND CONNECT AS REQUIRED.
- 6 EXISTING PAD MOUNT TRANSFORMER. COORDINATE EXACT LOCATION IN FIELD WITH PNM.
- 7 EXTEND 3/4" CONDUIT WITH (3) #6+1#10 GROUND AND CONNECT AS REQUIRED.
- 8 PROVIDE AND INSTALL 1#3 COPPER SERVICE GROUND IN 1" CONDUIT TO 5/8"x10'-0" COPPER GROUND ROD PER NEC ARTICLE #250.
- 9 3 #4/0 + 1 #2 GROUND IN 2" CONDUIT.

A. ALL BRANCH CIRCUITS CONDUCTORS TO BE #10 THWN UNLESS OTHERWISE NOTED.



SCALE: NONE

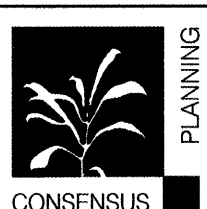
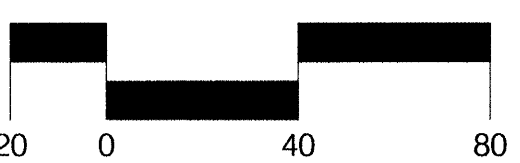

**CONSENSUS PLANNING, INC.**  
Planning / Landscape Architecture  
924 Park Avenue SW  
Albuquerque, NM 87102  
(505) 764-9801 Fax 842-5495  
e-mail: [cp@consensusplanning.com](mailto:cp@consensusplanning.com)

CITY OF ALBUQUERQUE  
DEPARTMENT OF MUNICIPAL DEVELOPMENT  
AND MEDIAN DESIGN DIVISION

TITLE: COMANCHE PARK - PHASE 1

## SITE UTILITIES PLAN

Design Review Committee

**City Engineer Approval**

|                    |  |  |  |  |
|--------------------|--|--|--|--|
| East design update |  |  |  |  |
|--------------------|--|--|--|--|

City Project No.

|              |      |
|--------------|------|
| Zone Map No. | G-16 |
|--------------|------|

Sheet 13 Of 13