

2 3 4 5 6 7 8 9 10 11 12 13 14 15
26-11227-18-106

CONSTRUCTION PLANS FOR GIBSON BLVD. IMPROVEMENTS ALBUQUERQUE, NEW MEXICO

INDEX

SHEET NO.	DESCRIPTION
1	COVER SHEET
2	OVERALL PAVING PLAN
3 - 4	PAVING PLAN AND PROFILE SHEETS
5	OVERALL UTILITY PLAN
6	UTILITY PLAN AND PROFILE SHEETS
7	STRIPING PLAN
8	MISCELLANEOUS DETAILS

PAVING PLANS

SHEET NO.	DESCRIPTION
3	GIBSON BLVD. STA. 14+10.48 - 25+00 PLAN AND PROFILE
4	GIBSON BLVD. STA. 25+00 - 33+83.43 PLAN AND PROFILE

UTILITY PLANS

SHEET NO.	DESCRIPTION
6	GIBSON BLVD. STA. 14+10.48 - 25+00 PLAN AND PROFILE

SURVEYOR'S CERTIFICATION

"I, Timothy Aldrich, a duly qualified Registered Professional Land Surveyor under the laws of the State of New Mexico, do hereby certify that the 'as-built' information shown on these drawings was obtained from field construction and 'as-built' surveys performed by me or under my supervision, that the 'as-built' information shown on these drawings was added to the 'as-built' information under my supervision, and that this 'as-built' information is the best of my knowledge and belief. I am not aware of any error or omission in the design concepts, calculations, engineering or intent of the drawings."

Timothy Aldrich, P.S. No. 7719 Date 12-1-06

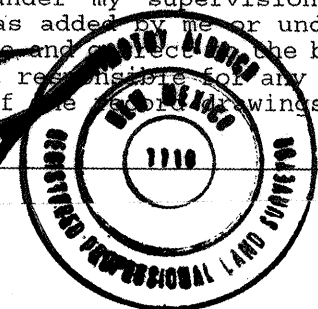

CERTIFICATE OF SUBSTANTIAL COMPLIANCE ON PLANS

I, Mark Goodwin, NMPE 8948, of the firm Mark Goodwin & Associates, P.A., a Registered Professional Engineer in the State of New Mexico, do hereby certify, to the best of my knowledge and belief, that the infrastructure installed as part of this project has been inspected by me or by a qualified person under my direct supervision, and has been constructed in accordance with the plans and specifications approved by the City Engineer and that the original design intent of the approved plans has been met, except as noted by me on the as-built construction drawings. This Certification is based on site inspections by me or personnel under my direction, and survey information provided by ALS, Inc., NMPS number 7719.

Mark Goodwin NMPE 8948

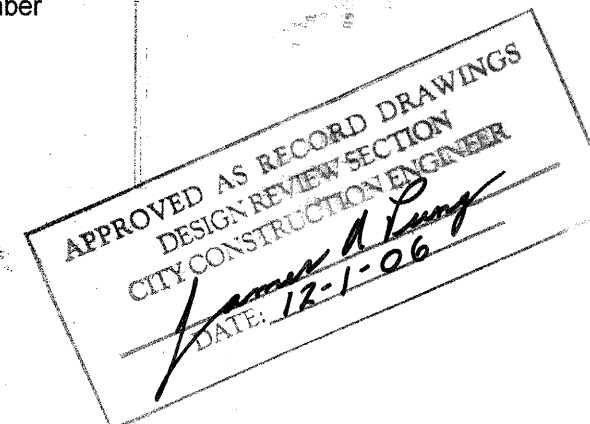
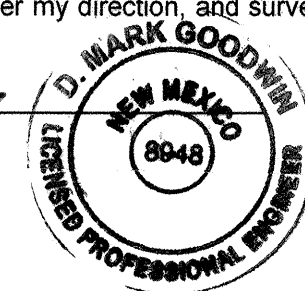

CONSTRUCTION NOTES:

1. THE CONTRACTOR SHALL ABIDE BY ALL LOCAL, STATE, AND FEDERAL LAWS, RULES AND REGULATIONS WHICH APPLY TO THE CONSTRUCTION OF THESE IMPROVEMENTS.
2. PRIOR TO CONSTRUCTION, CONTRACTOR SHALL EXCAVATE AND VERIFY THE HORIZONTAL AND VERTICAL LOCATIONS OF ALL POTENTIAL OBSTRUCTIONS. SHOULD A CONFLICT EXIST, THE CONTRACTOR SHALL NOTIFY THE ENGINEER OR CONSTRUCTION OBSERVER SO THAT THE CONFLICT CAN BE RESOLVED WITH A MINIMUM AMOUNT OF DELAY.
3. ALL ELECTRICAL, TELEPHONE, CABLE TV, GAS AND OTHER UTILITY LINES, CABLES AND APPURTENANCES ENCOUNTERED DURING CONSTRUCTION THAT REQUIRE RELOCATION, SHALL BE COORDINATED WITH THAT UTILITY. THE CONTRACTOR SHALL BE RESPONSIBLE FOR COORDINATION OF ALL NECESSARY UTILITY ADJUSTMENTS. NO ADDITIONAL COMPENSATION WILL BE ALLOWED FOR DELAYS OR INCONVENIENCES CAUSED BY UTILITY COMPANY WORK CREWS. THE CONTRACTOR MAY BE REQUIRED TO RESCHEDULE HIS ACTIVITIES TO ALLOW UTILITY CREWS TO PERFORM THEIR REQUIRED WORK.
4. DISPOSAL SITE FOR ALL EXCESS EXCAVATION MATERIAL, AND UNSUITABLE MATERIAL SHALL BE OBTAINED BY THE CONTRACTOR IN COMPLIANCE WITH APPLICABLE ENVIRONMENTAL REGULATIONS AND APPROVED BY THE CONSTRUCTION OBSERVER. ALL COSTS INCURRED IN OBTAINING A DISPOSAL SITE AND HAUL THERE TO SHALL BE CONSIDERED INCIDENTAL TO THE PROJECT AND NOT SEPARATE MEASUREMENT OR PAYMENT SHALL BE MADE.

5. THE CONTRACTOR IS RESPONSIBLE FOR PROTECTING THE EXISTING UTILITY LINES WITHIN THE CONSTRUCTION AREA. ANY DAMAGE TO EXISTING FACILITIES CAUSED BY CONSTRUCTION ACTIVITY SHALL BE REPAIRED OR REPLACED AT THE CONTRACTOR'S EXPENSE AND APPROVED BY THE CONSTRUCTION OBSERVER.
6. CONSTRUCTION ACTIVITY SHALL BE LIMITED TO THE PROPERTY AND/OR PROJECT LIMITS. ANY DAMAGE TO ADJACENT PROPERTIES RESULTING FROM THE CONSTRUCTION PROCESS IS THE RESPONSIBILITY OF THE CONTRACTOR. ANY COSTS INCURRED FOR REPAIRS SHALL BE THE COST OF THE CONTRACTOR.
7. OVERNIGHT PARKING OF CONSTRUCTION EQUIPMENT SHALL NOT OBSTRUCT DRIVEWAYS OR DESIGNATED TRAFFIC LANES. THE CONTRACTOR SHALL NOT STORE ANY EQUIPMENT OR MATERIAL WITHIN THE PUBLIC RIGHT-OF-WAY.
8. THE CONTRACTOR SHALL OBTAIN ALL THE NECESSARY PERMITS FOR THE PROJECT PRIOR TO COMMENCING CONSTRUCTION (I.E. BARRICADING, SURFACE DISTURBANCE).
9. THE CONTRACTOR SHALL BE RESPONSIBLE TO REPLACE AT HIS EXPENSE ANY AND ALL PROPERTY CORNERS DESTROYED DURING CONSTRUCTION. ALL PROPERTY CORNERS MUST BE RESET BY A REGISTERED LAND SURVEYOR.
10. ALL PERMANENT PAVEMENT MARKING AND TRAFFIC SIGNING SHALL BE FURNISHED BY THE CONTRACTOR PER PLAN.

11. THE CONTRACTOR SHALL FOLLOW THE CONSTRUCTION TRAFFIC CONTROL AND SIGNING PLAN PROVIDED HEREIN. THE CONTRACTOR SHALL COORDINATE WITH THE CITY OF ALBUQUERQUE, TRAFFIC ENGINEERING DEPARTMENT, PRIOR TO BEGINNING ANY CONSTRUCTION WORK ON OR ADJACENT TO EXISTING STREETS.
12. ALL BARRICADES AND CONSTRUCTION SIGNING SHALL CONFORM TO APPLICABLE SECTIONS OF THE "MANUAL OF UNIFORM TRAFFIC CONTROL DEVICES" (MUTCD), U.S. DEPARTMENT OF TRANSPORTATION, LATEST EDITION.
13. THE CONTRACTOR SHALL MAINTAIN ALL CONSTRUCTION BARRICADES AND SIGNING AT ALL TIMES. THE CONTRACTOR SHALL VERIFY THE PROPER LOCATION OF ALL BARRICADING AT THE END AND BEGINNING OF EACH DAY.
14. ALL SAWCUT PAVEMENT SHALL HAVE A UNIFORM EDGE AND BE SPRAYED WITH TACK.
15. WHEN ABUTTING NEW CURB AND GUTTER TO EXISTING PAVEMENT, A 1" WIDE SECTION OF EXISTING PAVEMENT ADJACENT TO THE CURB AND GUTTER SHALL BE SAWCUT, REMOVED, AND REPLACED AS PER THE STANDARD SPECIFICATIONS.
16. THE CONTRACTOR SHALL ASSUME RESPONSIBILITY FOR ANY DAMAGE TO EXISTING PAVEMENTS, PAVEMENT MARKINGS, CURB & GUTTER, DRIVE PADS, WHEELCHAIR RAMPS, AND SIDEWALK DURING CONSTRUCTION, APART FROM THOSE SECTIONS INDICATED FOR REMOVAL ON THE PLANS AND SHALL REPAIR OR REPLACE PER COA STANDARDS, AT HIS OWN EXPENSE.

17. FOR STORM DRAIN CONSTRUCTION, RCP PIPE JOINTS SHALL NOT BE GROUTED PRIOR TO FINAL INSPECTION. FINAL INSPECTION WILL DETERMINE JOINTS TO BE GROUTED FOR FINAL ACCEPTANCE OF THE CONSTRUCTION.
18. ALL EXCAVATION, TRENCHING, AND SHORING ACTIVITIES MUST BE CARRIED-OUT IN ACCORDANCE WITH OSHA 29 CFR 1926.650 SUBPART P.

Bohannon & Huston
Court yard | 7500 Jefferson St. NE Albuquerque, NM 87109-4335
ENGINEERING & SPATIAL DATA & ADVANCED TECHNOLOGIES

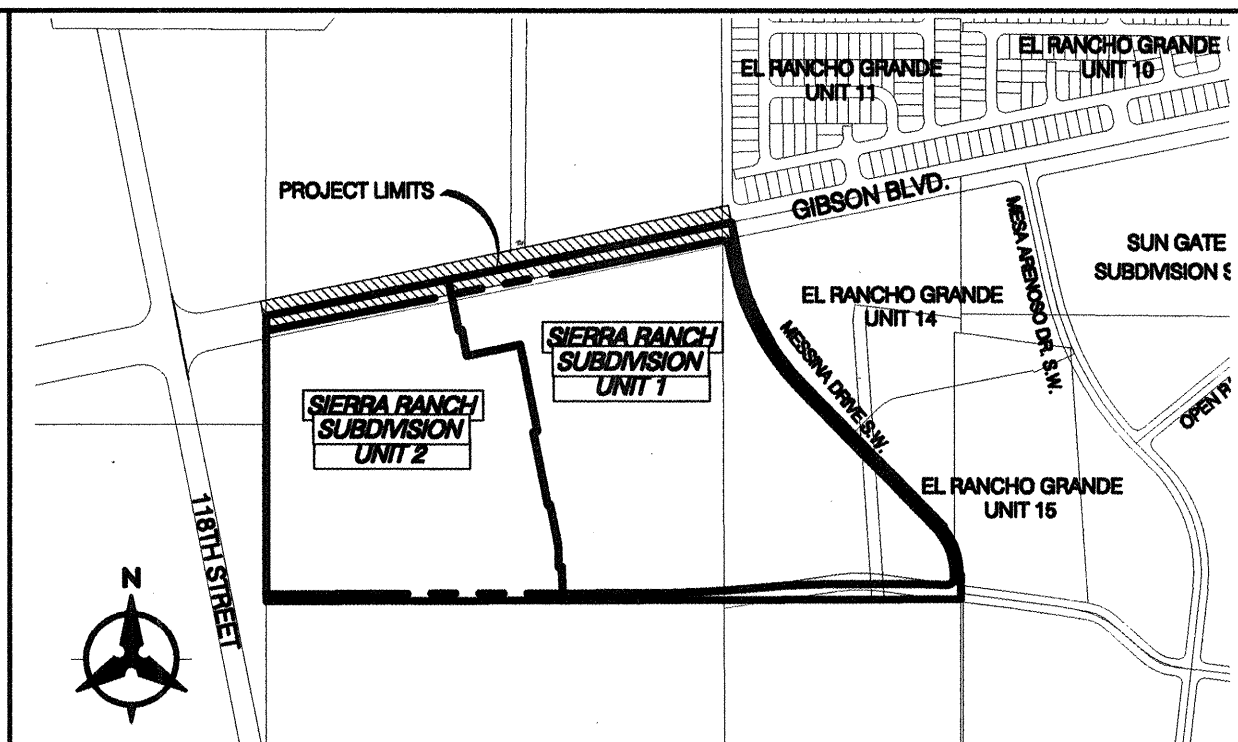

VICINITY MAP
N-9-Z

NOTICE TO CONTRACTORS

1. AN EXCAVATION/CONSTRUCTION PERMIT WILL BE REQUIRED BEFORE BEGINNING ANY WORK WITHIN THE CITY RIGHT-OF-WAY.
2. ALL WORK DETAILED ON THESE PLANS TO BE PERFORMED UNDER CONTRACT SHALL, EXCEPT AS OTHERWISE STATED OR PROVIDED FOR HEREON, BE CONSTRUCTED IN ACCORDANCE WITH THE CITY OF ALBUQUERQUE STANDARD SPECIFICATIONS FOR PUBLIC WORKS CONSTRUCTION, 1986 EDITION AS REVISED THROUGH UPDATE #7.
3. TWO WORKING DAYS PRIOR TO ANY EXCAVATION, THE CONTRACTOR MUST CONTACT NEW MEXICO ONE CALL SYSTEM (260-1990) FOR LOCATION OF EXISTING UTILITIES.
4. PRIOR TO CONSTRUCTION, THE CONTRACTOR SHALL EXCAVATE AND VERIFY THE HORIZONTAL AND VERTICAL LOCATIONS OF ALL OBSTRUCTIONS. SHOULD A CONFLICT EXIST, THE CONTRACTOR SHALL NOTIFY THE ENGINEER IMMEDIATELY SO THAT THE CONFLICT CAN BE RESOLVED WITH A MINIMUM AMOUNT OF DELAY.
5. FIVE (5) WORKING DAYS PRIOR TO BEGINNING CONSTRUCTION, THE CONTRACTOR SHALL SUBMIT TO CONSTRUCTION COORDINATION DIVISION A DETAILED CONSTRUCTION SCHEDULE. TWO (2) WORKING DAYS PRIOR TO THE START OF CONSTRUCTION, THE CONTRACTOR SHALL OBTAIN A BARRICADING PERMIT FROM THE CONSTRUCTION COORDINATION DIVISION. CONTRACTOR SHALL NOTIFY THE CONSTRUCTION COORDINATION ENGINEER (924-3400) PRIOR TO OCCUPYING AN INTERSECTION. REFER TO SECTION 19 OF THE GENERAL CONDITIONS OF THE STANDARD SPECIFICATIONS.
6. ALL WORK EFFECTING ARTERIAL ROADWAYS REQUIRES TWENTY-FOUR HOUR CONSTRUCTION.
7. ALL STREET STRIPING ALTERED OR DESTROYED SHALL BE REPLACED WITH PLASTIC REFLECTORIZED PAVEMENT MARKING BY CONTRACTOR TO THE SAME LOCATION AS WAS EXISTING, OR AS INDICATED BY THIS PLAN SET.
8. CONTRACTOR SHALL NOTIFY THE ENGINEER NOT LESS THAN SEVEN (7) DAYS PRIOR TO STARTING WORK IN ORDER THAT THE CITY SURVEYOR MAY TAKE NECESSARY MEASURES TO INSURE THE PRESERVATION OF SURVEY MONUMENTS. CONTRACTOR SHALL NOT DISTURB PERMANENT SURVEY MONUMENTS WITHOUT THE CONSENT OF THE CITY SURVEYOR AND SHALL NOTIFY THE CITY SURVEYOR AND BEAR THE EXPENSE OF REPLACING ANY THAT MAY BE DISTURBED WITHOUT PERMISSION. REPLACEMENT SHALL BE DONE ONLY BY THE CITY SURVEYOR. WHEN A CHANGE IS MADE IN THE FINISHED ELEVATIONS OF THE PAVEMENT OF ANY ROADWAY IN WHICH A PERMANENT SURVEY MONUMENT IS LOCATED, CONTRACTOR SHALL, AT HIS OWN EXPENSE, ADJUST THE MONUMENT COVER TO THE NEW GRADE UNLESS OTHERWISE SPECIFIED. REFER TO SECTION 4.4 OF THE GENERAL CONDITIONS OF THE STANDARD SPECIFICATIONS.
9. CONTRACTOR SHALL RECORD DATA ON ALL UTILITY LINES AND ACCESSORIES AS REQUIRED BY THE CITY OF ALBUQUERQUE FOR THE PREPARATION OF "AS CONSTRUCTED" DRAWINGS. CONTRACTOR SHALL NOT COVER UTILITY LINES AND ACCESSORIES UNTIL ALL DATA HAS BEEN RECORDED.
10. CONTRACTOR SHALL MAINTAIN A GRAFFITI-FREE WORK SITE. CONTRACTOR SHALL PROMPTLY REMOVE ANY GRAFFITI FROM ALL EQUIPMENT, WHETHER PERMANENT OR TEMPORARY.
11. CONTRACTOR SHALL COORDINATE WITH THE CITY OF ALBUQUERQUE WATER UTILITY DIVISION (857-8200) SEVEN (7) WORKING DAYS IN ADVANCE OF ANY WORK THAT MAY AFFECT EXISTING PUBLIC WATER OR SEWER UTILITIES. EXISTING VALVES TO BE OPERATED BY CITY PERSONNEL ONLY. CONTRACTOR SHALL CONTACT THE WATER SYSTEMS DIVISION SEVEN (7) WORKING DAYS PRIOR TO NEEDING VALVES TURNED ON OR OFF.

THE FOLLOWING NOTES ALSO APPLY WHEN CHECKED

- ☒ ALL UTILITIES AND UTILITY SERVICE LINES SHALL BE INSTALLED PRIOR TO PAVING.
- ☒ BACKFILL COMPACTION SHALL BE ACCORDING TO SPECIFIED STREET USE.
- ☒ SIDEWALKS AND WHEELCHAIR RAMPS WITHIN THE CURB RETURNS SHALL BE CONSTRUCTED WHEREVER A NEW CURB RETURN IS CONSTRUCTED.
- ☒ IF CURB IS DEEPENED FOR A DRIVEPAD, THE DRIVEPAD SHALL BE CONSTRUCTED PRIOR TO ACCEPTANCE OF CURB AND GUTTER.
- ☒ ALL STORM DRAINAGE FACILITIES SHALL BE COMPLETED PRIOR TO FINAL ACCEPTANCE.
- ☒ THE REQUESTOR OR DEVELOPER SHALL BE RESPONSIBLE FOR REPAIR OR REPLACEMENT OF ALL CURB AND GUTTER OR SIDEWALK DAMAGED AFTER APPROVAL BY THE CITY ENGINEER OF WORK COMPLETED BY THE CONTRACTOR.

DRB #1003429

REV.	SHEETS	CITY ENGINEER	DATE	USER DEPARTMENT	DATE	USER DEPARTMENT	DATE
ENGINEERS STAMP & SIGNATURE		APPROVALS	ENGINEER	DATE	*****		
		DRC Chairman	James H. Lee	2-2-05	APPROVED FOR CONSTRUCTION		
		Transportation	James H. Lee	7/6/05			
		Water/Wastewater	James H. Lee	7/6/2005			
		Hydrology	James H. Lee	7/6/05			
		Parks	James H. Lee	7/6/05			
		Const. Coord.	James H. Lee	7-7-05	City Engineer Date 1-16-06		
		Cons. Mgmt.	James H. Lee	12-1-06			
		City Project No.	722785		Sheet	Of	
					1	8	

SCANNED BY
PLANNING

FUTURE GIBSON BLVD.
(NOT IN THIS CONTRACT)

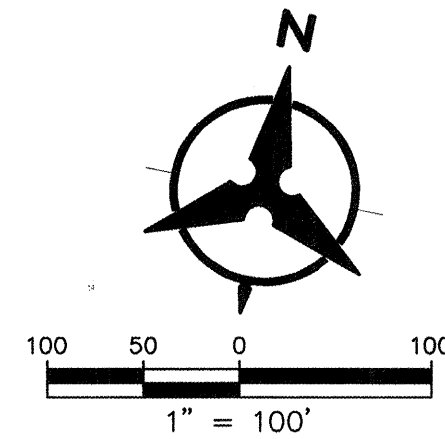

GENERAL NOTES

1. THE CONTRACTOR SHALL FIELD VERIFY ALL EXISTING UTILITY LOCATIONS AND NOTIFY THE ENGINEER IMMEDIATELY OF ANY DISCREPANCIES.
2. ALL CURVE DATA AND DIMENSIONS REFER TO FACE OF CURB UNLESS OTHERWISE SPECIFIED.
3. GRADE ELEVATIONS, WHERE NOTED, ARE FOR FLOWLINE OF CURB UNLESS OTHERWISE SPECIFIED.
4. CONTRACTOR IS RESPONSIBLE FOR REPAIR AND/OR REPLACEMENT OF ALL UTILITY CONDUITS AND EXISTING LINES.
5. ANY ADDITIONAL GRADING REQUIRED TO MATCH PROPOSED STREET GRADES SHALL BE INCIDENTAL TO PAVING ITEMS.
6. CONTRACTOR SHALL PARK EQUIPMENT AND VEHICLES AS NOT TO INTERFERE WITH NORMAL ACTIVITIES OF RESIDENTS OR OTHER CONTRACTORS ON SITE.
7. ANY DAMAGE TO THE EXISTING FACILITIES, (C&G), PAVEMENT, CONDUITS, LANDSCAPING, UTILITY LINES, ETC.) DURING CONSTRUCTION SHALL BE REPLACED AT THE CONTRACTORS' EXPENSE.
8. REMOVAL OF THE EXISTING C&G SHALL BE AS PER COA STD. DWG. 2415 (SAWCUT ONLY).
9. WHEELCHAIR RAMPS SHALL BE CONSTRUCTED PRIOR TO ACCEPTANCE OF CURB & GUTTER.
10.  DENOTES CROWN TRANSITION PER COA STD DWG. 2401.
11. FOR CURB RETURN & QUARTER POINT ELEV INFO REFER TO INDIVIDUAL PAVING SHEETS.
12. MH RIMS & CATCH BASIN INLET ELEVATIONS ARE APPROXIMATE. CONTRACTOR SHALL FIELD VERIFY AND ADJUST TO FINAL PAVEMENT ELEVATIONS.
13. CONTRACTOR SHALL FIELD VERIFY ALL EXISTING UTILITIES AND TRANSMISSION GAS LINES. CONTRACTOR SHALL COORDINATE RELOCATION OF UTILITY LINES WITH UTILITY COMPANIES AS REQUIRED.

NOTE:

SEE SHEET 38 FOR STREET SECTION.

KEYED NOTES

- A. SEE SHEET 38 FOR RESIDENTIAL PAVEMENT SECTION.
B. SEE SHEET 38 FOR RESIDENTIAL PAVEMENT SECTION.

LEGEND

- EXISTING R/W LINE
- EXISTING CURB & GUTTER
- PROPOSED R/W LINE
- PROPERTY LINE
- PROPOSED STANDARD CURB & GUTTER
- PROPOSED MOUNTABLE CURB & GUTTER
- PROPOSED SUBDIVISION BOUNDARY
- EASEMENT
- PROPOSED STREET LIGHT
- PROPOSED STORM DRAIN MANHOLE
- PROPOSED STORM DRAIN INLET
- PROPOSED FIRE HYDRANT
- PROPOSED MAIN VALVE
- PROPOSED SAS MANHOLE
- PROPOSED WHEELCHAIR RAMP
- PROPOSED UNIDIRECTIONAL WHEELCHAIR RAMP

CERTIFICATE OF SUBSTANTIAL COMPLIANCE ON PLANS

I, Mark Goodwin, NMPE 8948, of the firm Mark Goodwin & Associates, P.A., a Registered Professional Engineer in the State of New Mexico, do hereby certify, to the best of my knowledge and belief, that the infrastructure installed as part of this project has been inspected by me or by a qualified person under my direct supervision, and has been constructed in accordance with the plans and specifications approved by the City Engineer and that the original design intent of the approved plans has been met, except as noted by me on the as-built construction drawings. This Certification is based on site inspections by me or personnel under my direction, and survey information provided by ALS, Inc., NMPS number 7719.

Mark Goodwin
Mark Goodwin NMPE 8948

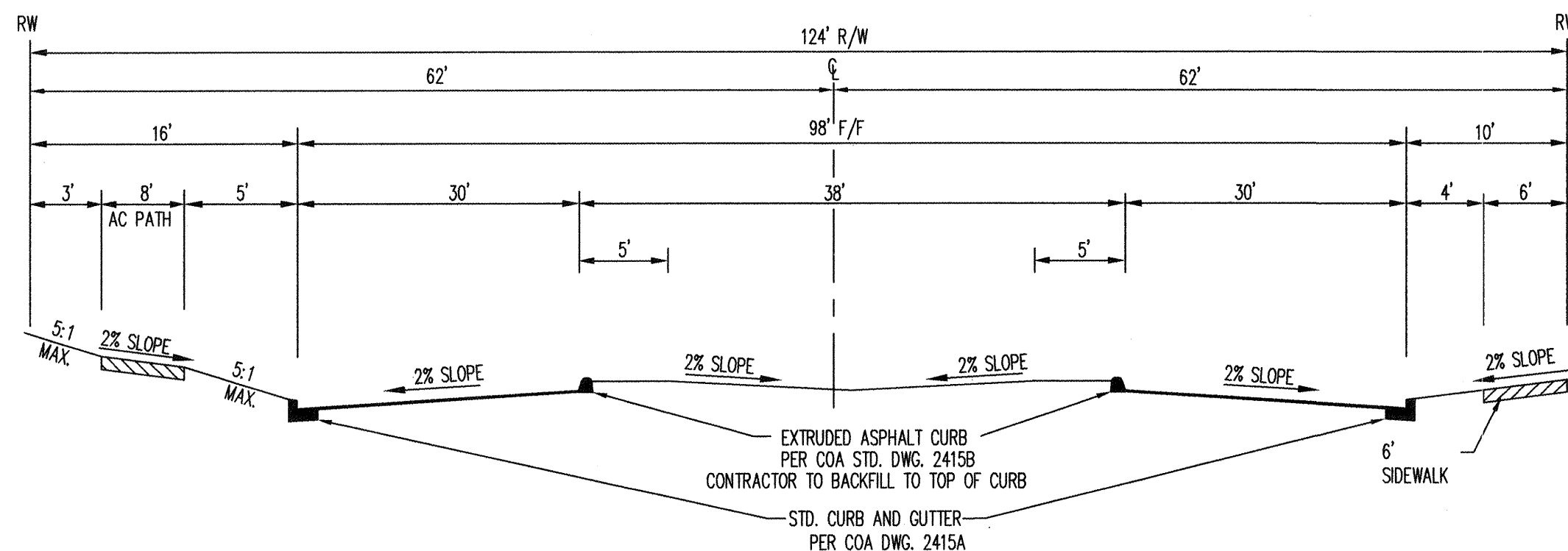
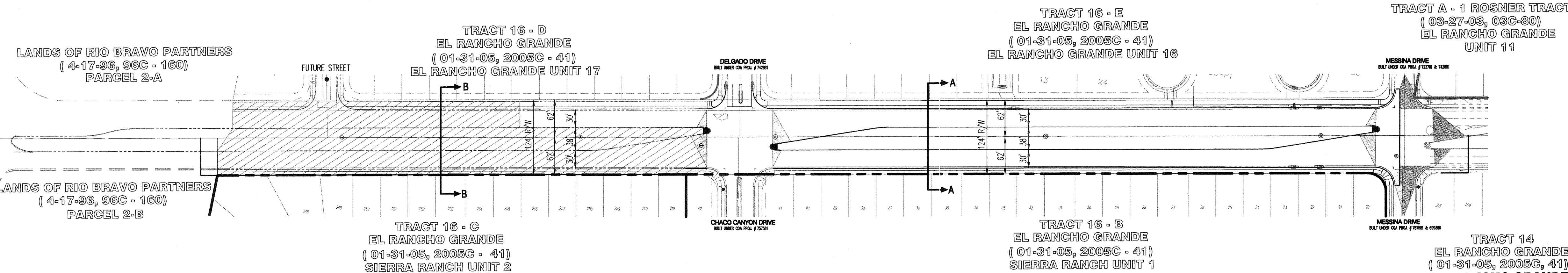
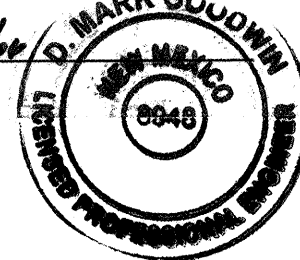

TYPICAL SECTION A - A
NOT TO SCALE

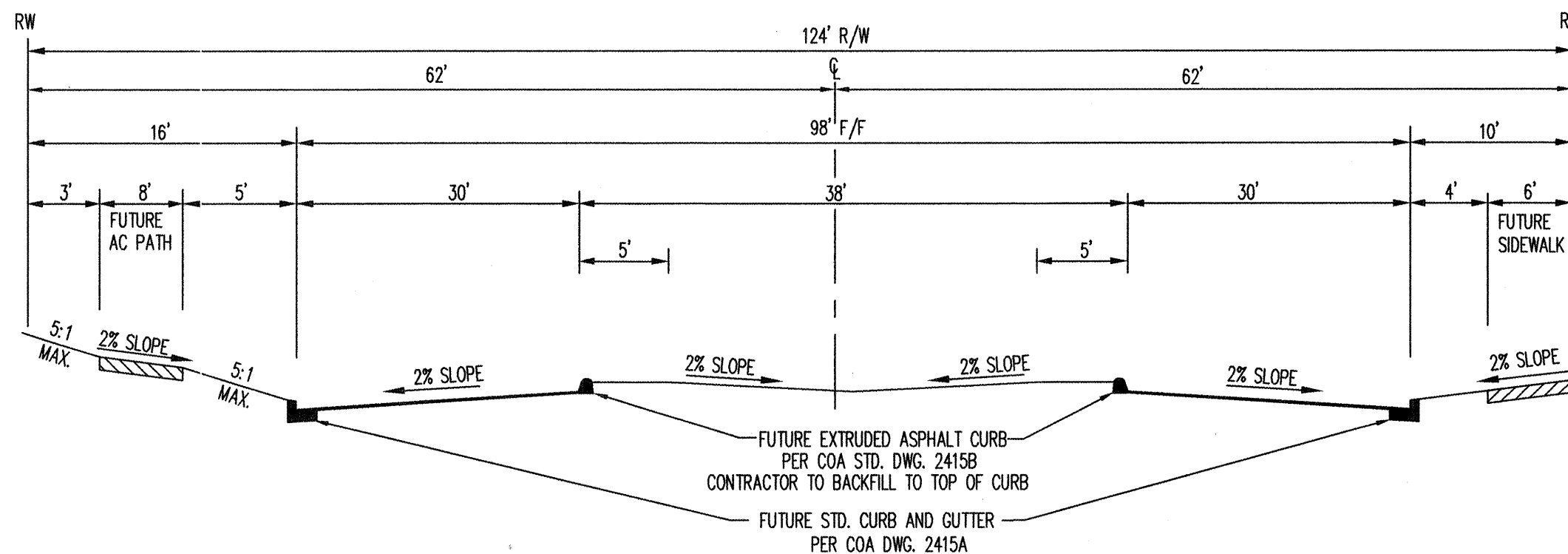

FUTURE TYPICAL SECTION B - B
NOT TO SCALE

AS-BUILT INFORMATION		BENCH MARKS		SURVEY INFORMATION		ENGINEER'S SEAL		REVISIONS		DESIGN		DATE	
CONTRACTOR	NEW CONSTRUCTION	ACS BRASS TABLET STAMPED "TRANS"	DATE	NO.	BY	DATE	NO.	DATE	BY	DATE	BY	DATE	BY
INSPECTOR	ALS	Geographic Position (NAD 1927)	DATE										
ACCEPTANCE BY	ALS	N.M. State Plane Coordinates (Central Zone)	DATE										
VERIFICATION BY	ALS	X = 354,899.45 Y = 1,471,822.67	DATE										
CONTRACTOR	ALS	Ground-to-Grid Factor = 0.99967921	DATE										
RECORDED BY	ALS	ΔC = -00'16.42"	DATE										
NO.		SLD 1929 Elevation = 5118.43	NO.										

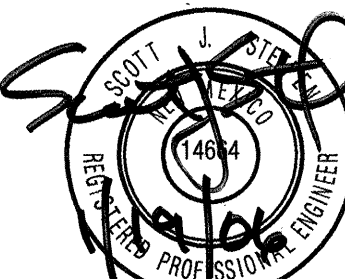

Bohannon & Huston

Courtyard | 7800 Jefferson St. NE Albuquerque, NM 87109-4396
ENGINEERING • SPATIAL DATA • ADVANCED TECHNOLOGIES



CITY OF ALBUQUERQUE
PUBLIC WORKS DEPARTMENT

GIBSON BLVD IMPROVEMENTS
OVERALL PAVING
PLAN

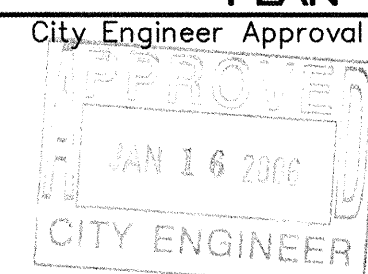
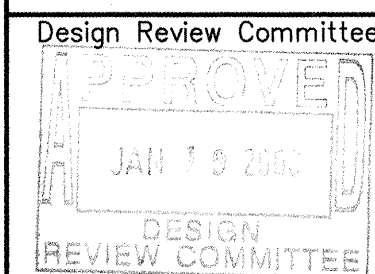

Last Design Update

City Project No.

722785

Zone Map No.

N - 9

Sheet

Of

2

8

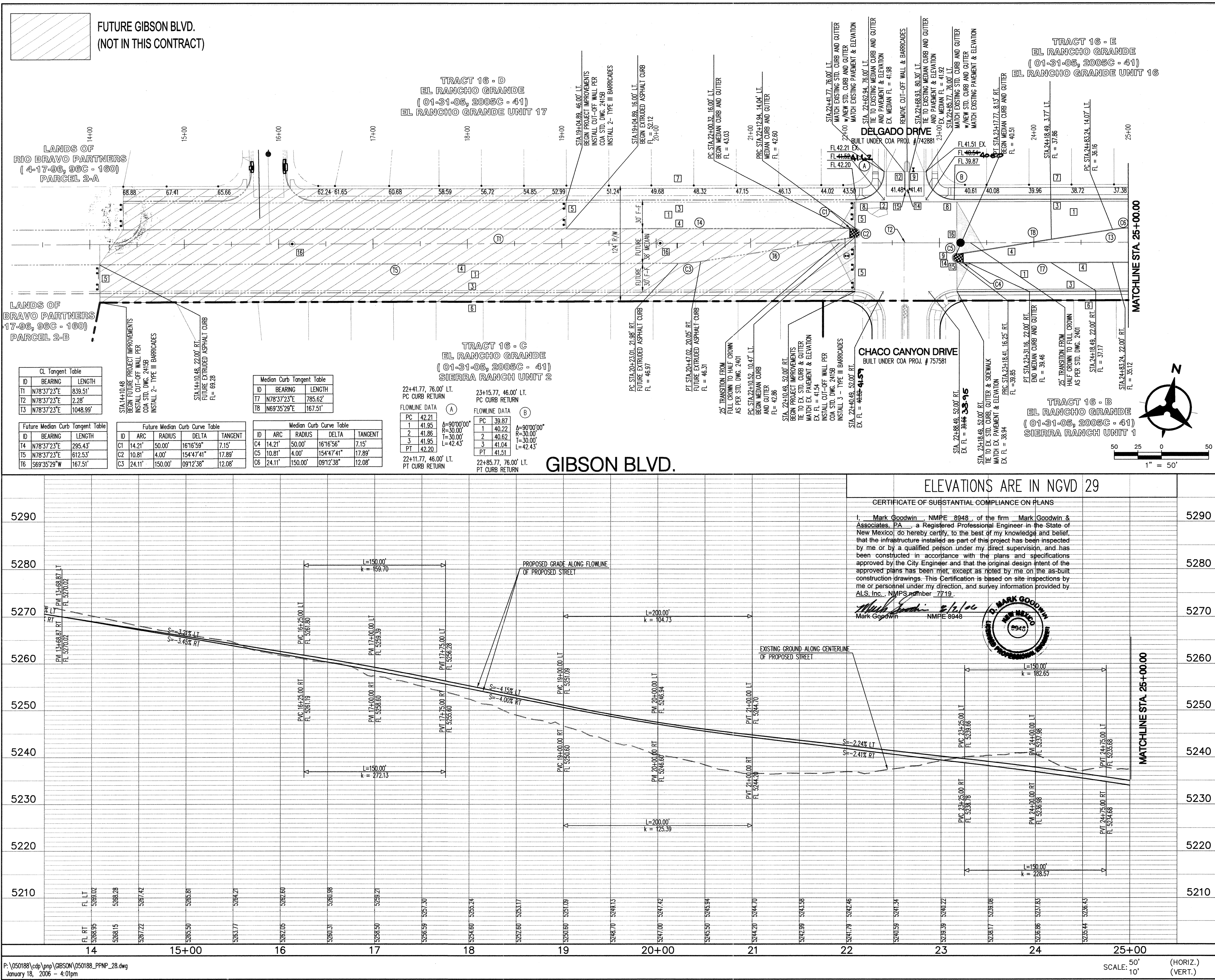

- ### NOTES
1. THE CONTRACTOR SHALL FIELD VERIFY ALL EXISTING UTILITY LOCATIONS AND NOTIFY THE ENGINEER IMMEDIATELY OF ANY DISCREPANCIES.
 2. ALL CURB RETURN RADII SHALL BE 25' UNLESS OTHERWISE SPECIFIED.
 3. ALL CURVE DATA AND DIMENSIONS REFER TO FACE OF CURB UNLESS OTHERWISE SPECIFIED.
 4. GRADE ELEVATIONS, WHERE NOTED, ARE FOR FLOWLINE OF CURB UNLESS OTHERWISE SPECIFIED.
 5. CONTRACTOR IS TO INSTALL A 4" x 4" x 5' POST AND END AT THE END OF EACH SANITARY SEWER SERVICE.
 6. CONTRACTOR IS RESPONSIBLE FOR REPAIR AND/OR REPLACEMENT OF ALL UTILITY CONDUITS AND EXISTING LINES.
 7. ANY ADDITIONAL GRADING REQUIRED TO MATCH PROPOSED STREET GRADES SHALL BE INCIDENTAL TO PAVING ITEMS.
 8. CONTRACTOR SHALL PROVIDE THE INSPECTORS, (CITY AND PRIVATE) WITH THE PROPOSED HYDROSTATIC TESTING PLAN. THE PLAN MUST BE APPROVED BEFORE TESTING OPERATIONS BEGIN.
 9. CONTRACTOR SHALL PARK EQUIPMENT AND VEHICLES AS NOT TO INTERFERE WITH NORMAL ACTIVITIES OF RESIDENTS OR OTHER CONTRACTORS ON SITE.
 10. ANY DAMAGE TO THE EXISTING FACILITIES (CURB & GUTTER, PAVEMENT, CONDUITS, LANDSCAPING, UTILITY LINES ETC.) DURING CONSTRUCTION SHALL BE REPLACED AT THE CONTRACTORS' EXPENSE.
 11. REMOVAL OF THE EXISTING CURB & GUTTER SHALL BE PER COA STD. DWG. 2415 (SANCUT ONLY).
 12. WHEELCHAIR RAMPS SHALL BE CONSTRUCTED PRIOR TO ACCEPTANCE OF CURB & GUTTER.

- ### KEYED NOTES
1. BUILD ARTERIAL PAVEMENT PER ARTERIAL SECTION, SHEET 8.
 2. INSTALL 6" CONCRETE VALLEY GUTTER PER COA STD. DWG. 2420.
 3. BUILD STD. CURB & GUTTER PER COA STD. DWG. 2415A.
 4. BUILD EXTRUDED ASPHALT CURB PER COA STD. DWG. 2415B.
 5. EDGE OF PROPOSED ASPHALT.
 6. BUILD 6' SIDEWALK PER COA STD. DWG. 2430.
 7. BUILD 8' ASPHALT PATH PER COA STD. DWG. 2415B & DETAIL SHEET 8.
 8. INSTALL SPECIAL HANDICAP RAMP 'B' SHEET 8.
 9. BUILD MEDIAN CURB & GUTTER PER COA STD. DWG. 2415B.
 - * 10. BUILD CONCRETE MEDIAN PAVING PER COA STD. DWG. 2408.
 - * 11. INSTALL HANDICAP RAMP PER HANDICAP RAMP DETAIL 'B'. SEE SHEET 8.
 12. BUILD RESIDENTIAL PAVEMENT PER RESIDENTIAL SECTION, SHEET 8.
 - * 13. BUILD TEMPORARY PAVEMENT PER TEMPORARY SECTION, SHEET 13.
 14. INSTALL 4" STAMPED CONCRETE 10' BACK FROM MEDIAN NOSE BAJA RED, RUNNING BOND PATTERN.
 15. PAINT MEDIAN NOSE REFLECTIVE YELLOW.
 16. ADJUST MANHOLE TO GRADE.
- * NOT USED THIS SHEET.

Bohannon & Huston
 Courtyard | 7500 Jefferson St NE Albuquerque, NM 87109-4395
 ENGINEERING • SPATIAL DATA • ADVANCED TECHNOLOGIES

CITY OF ALBUQUERQUE
PUBLIC WORKS DEPARTMENT

GIBSON BLVD. IMPROVEMENTS
PAVING PLAN AND PROFILE
STA. 14+10.48 - 25+00

Design Review Committee	City Engineer Approval	Mo./Day/Yr.	Mo./Day/Yr.
APPROVED JAN 19 2006 DESIGN REVIEW COMMITTEE	APPROVED JAN 16 2006 CITY ENGINEER		
City Project No.	Zone Map No.	Sheet	Of
722785	N - 9	3	8

AS-BUILT INFORMATION		BENCH MARKS		SURVEY INFORMATION		ENGINEER'S SEAL	
CONTRACTOR	DATE	INSPECTOR	DATE	NO.	BY	REMARKS	REVISIONS
NEW CONSTRUCTION	DATE	ACCEPTANCE BY	DATE				
		Geographic Position (NAD 1927)					
		N.M. State Plane Coordinates (Central Zone)					
		X= 354,899.45 Y= 1,471,822.67					
		Ground-to-Grid Factor = 0.99967921					
		ΔG = -00'16.42"					
		SLD 1929 Elevation = 5118.43					

CERTIFICATE OF SUBSTANTIAL COMPLIANCE ON PLANS

I, Mark Goodwin, NMPE 8948, of the firm Mark Goodwin & Associates, P.A., a Registered Professional Engineer in the State of New Mexico, do hereby certify, to the best of my knowledge and belief, that the infrastructure installed as part of the project described herein was designed and constructed in accordance with the plans and specifications approved by me or by a qualified person under my direct supervision, and has been constructed in accordance with the plans and specifications approved by me or by a qualified person under my direct supervision. This Certificate is based on the site inspections by me or personnel under my direction, and survey information provided by ALS, Inc., NMPS number 7719.

Mark Goodwin
NMPE 8948

ID	BEARING	LENGTH
19	N78°37'23"E	790.37'
110	S69°35'29"W	167.51'

ID	ARC	RADIUS	DELTA	TANGENT
C7	24.11'	150.00'	09°12'38"	12.08'
C8	10.81'	4.00'	154°47'41"	17.89'
C9	14.21'	50.00'	16°16'56"	7.15'

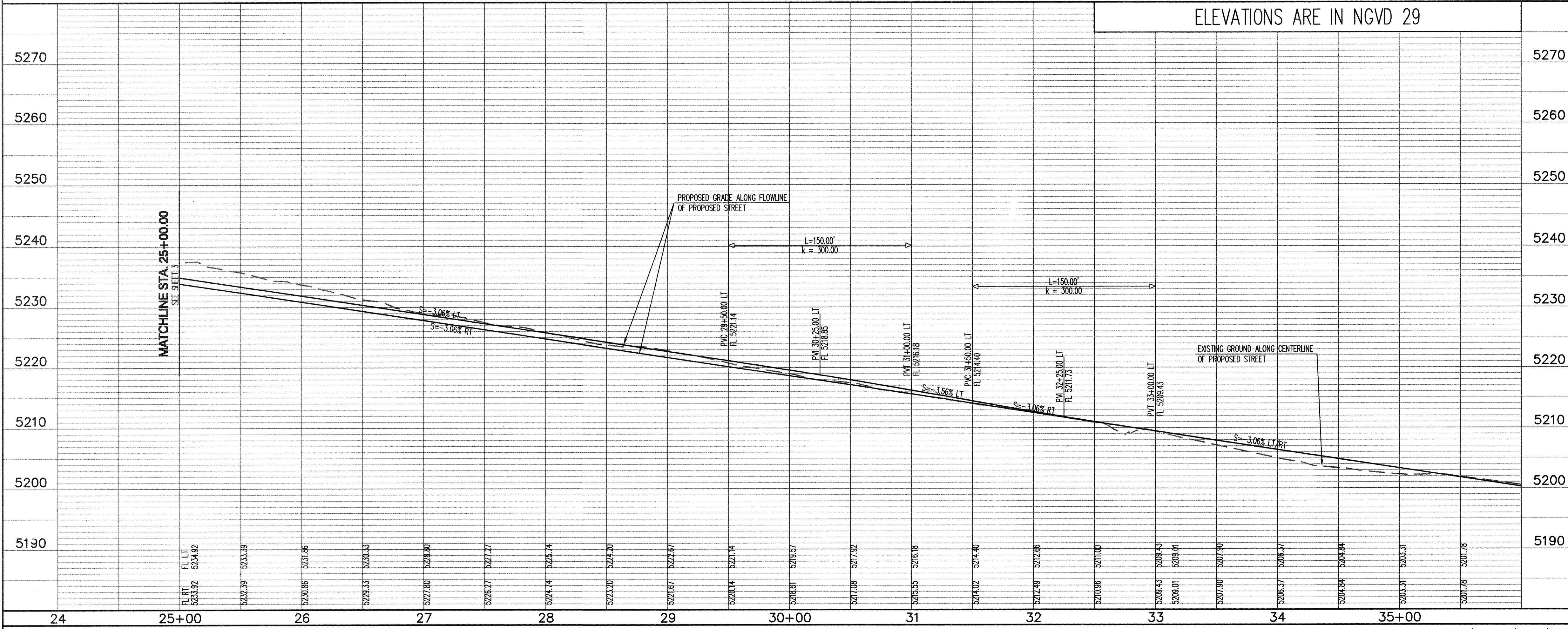
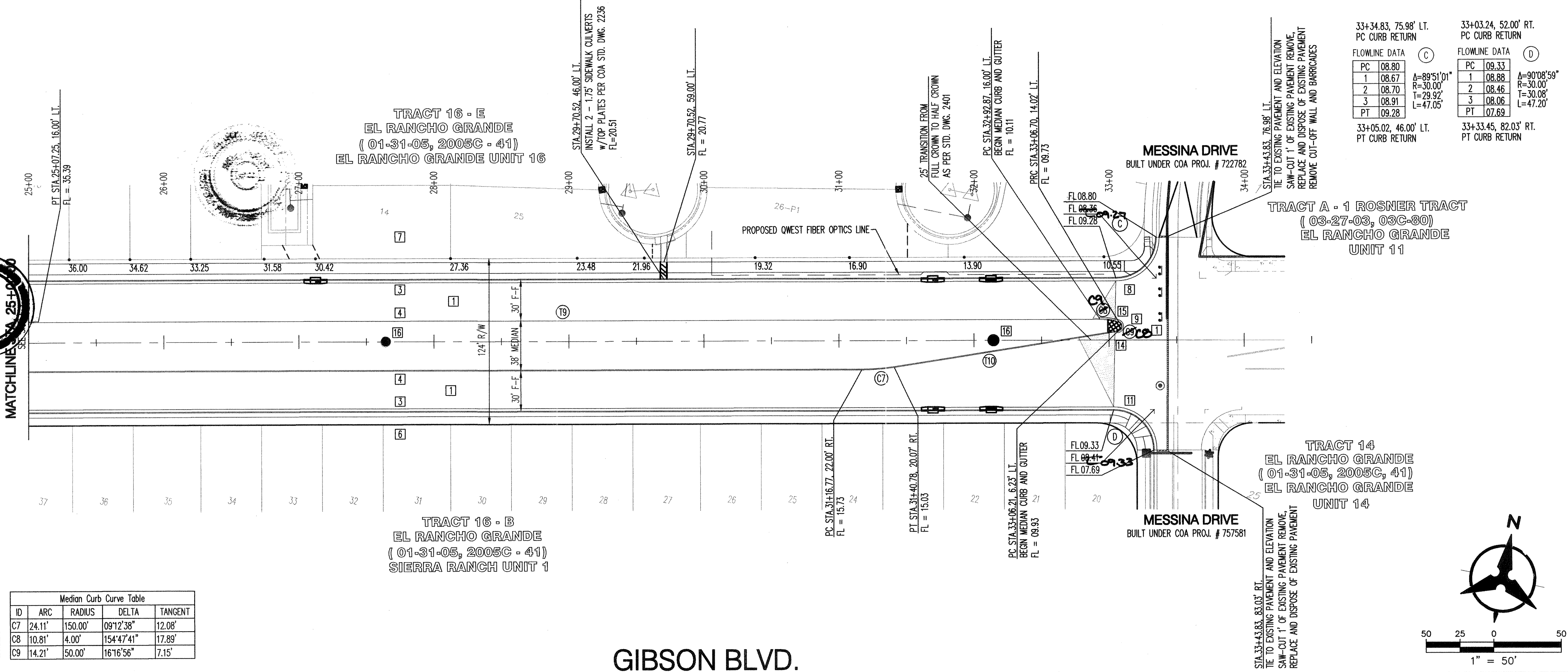

NOTES

- THE CONTRACTOR SHALL FIELD VERIFY ALL EXISTING UTILITY LOCATIONS AND NOTIFY THE ENGINEER IMMEDIATELY OF ANY DISCREPANCIES.
- ALL CURB RETURN RADI SHALL BE 25' UNLESS OTHERWISE SPECIFIED.
- ALL CURVE DATA AND DIMENSIONS REFER TO FACE OF CURB UNLESS OTHERWISE SPECIFIED.
- GRADE ELEVATIONS, WHERE NOTED, ARE FOR FLOWLINE OF CURB UNLESS OTHERWISE SPECIFIED.
- CONTRACTOR IS TO INSTALL A 4"x 4" 5' POST AND EMD AT THE END OF EACH SANITARY SEWER SERVICE.
- CONTRACTOR IS RESPONSIBLE FOR REPAIR AND/OR REPLACEMENT OF ALL UTILITY CONDUITS AND EXISTING LINES.
- ANY ADDITIONAL GRADING REQUIRED TO MATCH PROPOSED STREET GRADES SHALL BE INCIDENTAL TO PAVING ITEMS.
- CONTRACTOR SHALL PROVIDE THE INSPECTORS, (CITY AND PRIVATE) WITH THE PROPOSED HYDROSTATIC TESTING PLAN. THE PLAN MUST BE APPROVED BEFORE TESTING OPERATIONS BEGIN.
- CONTRACTOR SHALL PARK EQUIPMENT AND VEHICLES AS NOT TO INTERFERE WITH NORMAL ACTIVITIES OF RESIDENTS OR OTHER CONTRACTORS ON SITE.
- ANY DAMAGE TO THE EXISTING FACILITIES (CURB & GUTTER, PAVEMENT, CONDUITS, LANDSCAPING, UTILITY LINES ETC.) DURING CONSTRUCTION SHALL BE REPLACED AT THE CONTRACTORS' EXPENSE.
- REMOVAL OF THE EXISTING CURB & GUTTER SHALL BE PER COA STD. DWG. 2415 (SAW-CUT ONLY).
- WHEELCHAIR RAMPS SHALL BE CONSTRUCTED PRIOR TO ACCEPTANCE OF CURB & GUTTER.

KEYED NOTES

- BUILD ARTERIAL PAVEMENT PER ARTERIAL SECTION, SHEET 8.
- INSTALL 6" CONCRETE VALLEY GUTTER PER COA STD. DWG. 2420.
- BUILD STD. CURB & GUTTER PER COA STD. DWG. 2415A.
- BUILD EXTRUDED ASPHALT CURB PER COA STD. DWG. 2415B.
- EDGE OF PROPOSED ASPHALT.
- BUILD 6' SIDEWALK PER COA STD. DWG. 2430.
- BUILD 8' ASPHALT PATH PER COA STD. DWG. 2415B & DETAIL SHEET 8.
- INSTALL SPECIAL HANDICAP RAMP 'B' SHEET 8.
- BUILD MEDIAN CURB & GUTTER PER COA STD. DWG. 2415B.
- BUILD CONCRETE MEDIAN PAVING PER COA STD DWG. 2408.
- INSTALL HANDICAP RAMP PER HANDICAP RAMP DETAIL 'B'. SEE SHEET 8.
- BUILD RESIDENTIAL PAVEMENT PER RESIDENTIAL SECTION, SHEET 8.
- BUILD TEMPORARY PAVEMENT PER TEMPORARY SECTION, SHEET 13.
- INSTALL 4" STAMPED CONCRETE 10' BACK FROM MEDIAN NOSE BAJA RED, RUNNING BOND PATTERN. PER COA STD DWG 2408
- PAINT MEDIAN NOSE REFLECTIVE YELLOW.
- ADJUST MANHOLE TO GRADE.

* NOT USED THIS SHEET.

Bohannon & Huston
Courtney | 7800 Jefferson St. NE Albuquerque, NM 87109-4395
ENGINEERING & SPATIAL DATA & ADVANCED TECHNOLOGIES

CITY OF ALBUQUERQUE
PUBLIC WORKS DEPARTMENT
GIBSON BLVD. IMPROVEMENTS
PAVING PLAN AND PROFILE
STA. 25+00 - 33+83.43

Design Review Committee	City Engineer Approval	Mo./Day/Yr.	Mo./Day/Yr.
City Project No.	Zone Map No.	Sheet	Of
722785	N - 9	4	8

AS-BUILT INFORMATION

CONTRACTOR	DATE
New Construction	2005
STAMPED BY	DATE
ALS	2/2/05
INSPECTOR'S FIELD	DATE
ALS	2/2/05
VERIFICATION BY	DATE
ALS	2/2/05
CORRECTED BY	DATE
ALS	2/2/05
MICROFILM INFORMATION	DATE
RECORDED BY	DATE
NO.	5118.43

SURVEY INFORMATION

FIELD NOTES	DATE
BY	
NO.	

ENGINEER'S SEAL

REMARKS	By
DESIGN	
REVISIONS	
DATE: 03/21/05	DATE: 03/21/05
Drawn By: BJG	Checked By: SJS

CERTIFICATE OF SUBSTANTIAL COMPLIANCE ON PLANS

I, Mark Goodwin, NMPE #8948, of the firm Mark Goodwin & Associates, PA, a Registered Professional Engineer in the State of New Mexico, do hereby certify, to the best of my knowledge and belief, that the infrastructure installed as part of this project has been inspected by me or by a qualified person under my direct supervision, and has been constructed in accordance with the plans and specifications approved by the City Engineer and that the original design intent of the approved plans has been met, except as noted by none of the as-built construction drawings. This Certification is based on site inspections by me or personnel under my direct supervision information provided by ALS, Inc., NMPS number 7719.



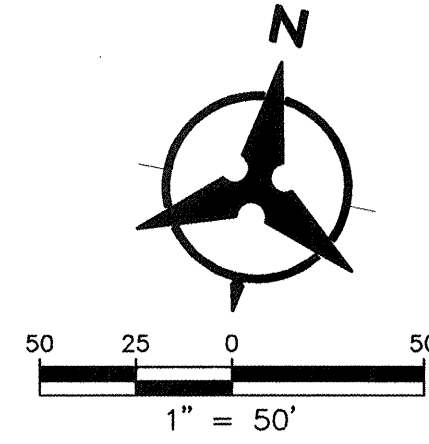

















Mark Goodwin NMPE 8948



GENERAL NOTES

1. THE CONTRACTOR SHALL FIELD VERIFY ALL EXISTING UTILITY LOCATIONS AND NOTIFY THE ENGINEER IMMEDIATELY OF ANY DISCREPANCIES.
2. ALL CURVE DATA AND DIMENSIONS ARE CALCULATED FROM CENTERLINE OF PIPE OR MANHOLE. ALL SAS & SD SLOPES ARE CALCULATED TO TRUE PIPE DIMENSIONS FROM INVERT TO INVERT. (PAY ITEMS ARE SHOWN IN PARENTESIS)
3. GRADE ELEVATIONS, WHERE NOTED, ARE FOR FLOWLINE OF CURB UNLESS OTHERWISE SPECIFIED.
4. CONTRACTOR IS TO INSTALL A 4" x 4" x 5' POST AND END AT THE END OF EACH SANITARY SEWER SERVICE.
5. CONTRACTOR IS RESPONSIBLE FOR REPAIR AND/OR REPLACEMENT OF ALL UTILITY CONDUITS AND EXISTING LINES.
6. CONTRACTOR SHALL PROVIDE THE INSPECTORS WITH THE PROPOSED TESTING PLAN. THE PLAN MUST BE APPROVED BEFORE TESTING OPERATIONS BEGIN.
7. CONTRACTOR SHALL PARK EQUIPMENT AND VEHICLES AS NOT TO INTERFERE WITH NORMAL ACTIVITIES OF RESIDENTS OR OTHER CONTRACTORS ON SITE.
8. ANY DAMAGE TO THE EXISTING FACILITIES (CURB & GUTTER, PAVEMENT, CONDUITS, LANDSCAPING, UTILITY LINES, ETC.) DURING CONSTRUCTION SHALL BE REPLACED AT THE CONTRACTORS' EXPENSE.
9. MH RIMS & CATCH BASIN INLET ELEVATIONS, VALVE BOXES, ARY, FIRE HYDRANT & FLANGE ELEVATIONS ARE APPROXIMATE. CONTRACTOR SHALL FIELD VERIFY AND ADJUST TO FINAL PAVEMENT GRADES.
10. SAS STATIONING FOLLOWS CL OF ROAD UNLESS OTHERWISE NOTED.
11. STATIONING OF DROP INLET IS TO MIDDLE OF DOWN HILL GRATE AT FACE OF CURB.
12. ALL EXCAVATION, TRENCHING AND SHORING ACTIVITIES MUST BE CARRIED-OUT IN ACCORDANCE WITH OSHA 29 CFR 1926.650 SUBPART P.

LEGEND

	PROPERTY LINE
	NEW EASEMENT
	EXISTING SANITARY SEWER
	EXISTING WATER LINE
	EXISTING STORM DRAIN
	EXISTING WATER METER
	EXISTING CAP
	EXISTING VALVE
	EXISTING FIRE HYDRANT
	EXISTING SANITARY SEWER MANHOLE
	EXISTING STORM DRAIN
	PROPOSED SANITARY SEWER
	PROPOSED WATER LINE
	PROPOSED VALVE
	PROPOSED HYDRANT
	PROPOSED CAP
	PROPOSED WATER METER
	PROPOSED SANITARY SEWER MANHOLE
	PROPOSED STORM DRAIN
	PROPOSED STREET LIGHT

[illegible]

Bohannon ▲ Huston INC.

Courtyard | 7500 Jefferson St. NE Albuquerque, NM 87109-4335
ENGINEERING ▲ SPATIAL DATA ▲ ADVANCED TECHNOLOGIES



CITY OF ALBUQUERQUE
PUBLIC WORKS DEPARTMENT

GIBSON BLVD. IMPROVEMENTS OVERALL UTILITY PLAN

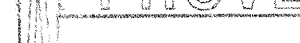
Design Review Committee	City Engineer Approval	Last Design Update	Mo./Day/Yr.	Mo./Day/Yr.
				

City Project No.	722785	Zone Map No.	N - 9	Sheet	5	Of	8
------------------	--------	--------------	-------	-------	---	----	---

MATERIALS:

SAS LINE: SDR-35 PVC
WATER LINE: C900-PVC

WATER SHUT-OFF PLAN:

FOR CONNECTION	VALVE CLOSED
DELGADO DRIVE	VALVE #1
CHACO CANYON DRIVE	VALVE #2

CONTRACTOR WILL BE RESPONSIBLE FOR FLUSHING,
DISINFECTING, AND TESTING THE LINES AS REQUIRED
BY THE CITY OF ALBUQUERQUE.

WATER SHUT-OFF REQUIREMENTS

CONTRACTOR WILL BE RESPONSIBLE FOR THE TIMING AND COORDINATION OF THE WATER SHUT-OFF REQUIREMENTS IN CONJUNCTION WITH THE COMPLETION OF CONNECTIONS, AT LEAST SEVEN (7) WORKING DAYS PRIOR TO CONSTRUCTION. THE CONTRACTOR SHALL CONTACT THE CITY OF ALBUQUERQUE (857-8200) TO INITIATE IMPLEMENTATION OF THIS WATER SHUT-OFF PLAN. CONTRACTOR SHALL NOT OPERATE VALVES ON THE PROJECT.

LANDS OF RIO BRAVO PARTNERS
(4-17-96, 96C - 160)
PARCEL 2-B

TRACT 16 - D
EL RANCHO GRANDE
(01-31-05, 2005C - 41)
EL RANCHO GRANDE UNIT 17

TRACT 16 - C
EL RANCHO GRANDE
(01-31-05, 2005C - 41)
SIERRA RANCH UNIT 2

P:\050188\cdp\general\GIBSON\050188_OUTIL.dwg
July 06, 2005 - 10:52am

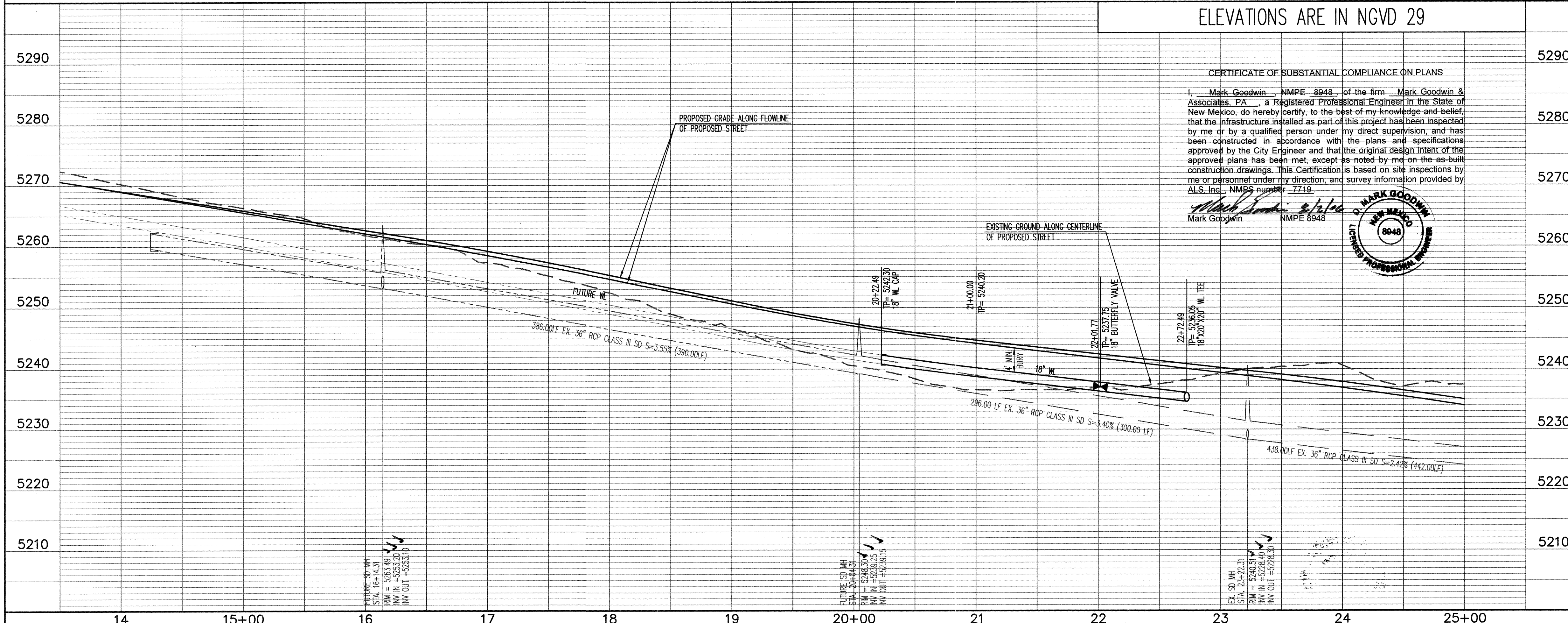
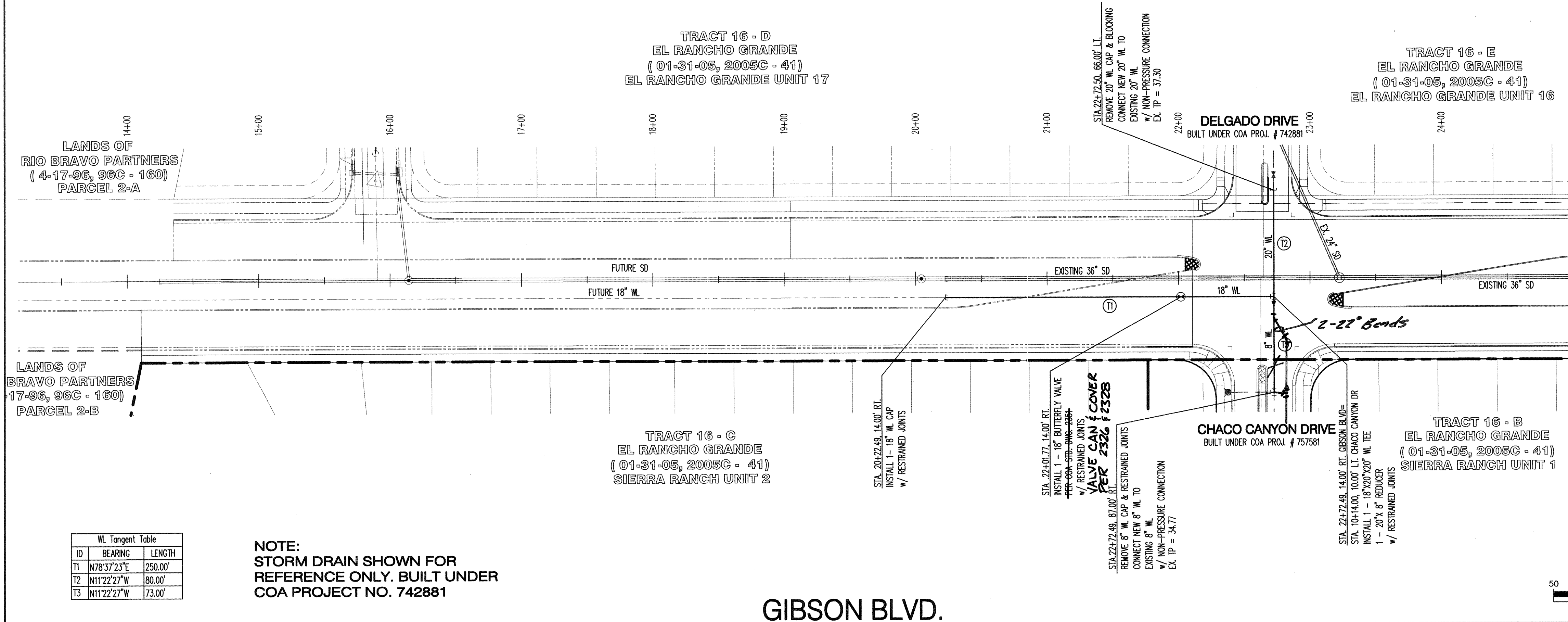

- GENERAL NOTES**
- THE CONTRACTOR SHALL FIELD VERIFY ALL EXISTING UTILITY LOCATIONS AND NOTIFY THE ENGINEER IMMEDIATELY OF ANY DISCREPANCIES.
 - ALL CURVE DATA AND DIMENSIONS ARE CALCULATED FROM CENTERLINE OF PIPE OR MANHOLE. ALL SAS & SD SLOPES ARE CALCULATED TO TRUE PIPE DIMENSIONS FROM INVERT TO INVERT. (PAY ITEMS ARE SHOWN IN PARENTHESES)
 - GRADE ELEVATIONS, WHERE NOTED, ARE FOR FLOWLINE OF STANDARD CURB UNLESS OTHERWISE SPECIFIED.
 - CONTRACTOR IS TO INSTALL A 4" X 4" X 5' POST AND EMD AT THE END OF EACH SANITARY SEWER SERVICE.
 - CONTRACTOR IS RESPONSIBLE FOR REPAIR AND/OR REPLACEMENT OF ALL UTILITY CONDUITS AND EXISTING LINES.
 - CONTRACTOR SHALL PROVIDE THE INSPECTORS WITH THE PROPOSED TESTING PLAN. THE PLAN MUST BE APPROVED BEFORE TESTING OPERATIONS BEGIN.
 - CONTRACTOR SHALL PARK EQUIPMENT AND VEHICLES AS NOT TO INTERFERE WITH NORMAL ACTIVITIES OF RESIDENTS OR OTHER CONTRACTORS ON SITE.
 - ANY DAMAGE TO THE EXISTING FACILITIES (CURB & GUTTER, PAVEMENT, CONDUITS, LANDSCAPING, UTILITY LINES, ETC.) DURING CONSTRUCTION SHALL BE REPLACED AT THE CONTRACTOR'S EXPENSE.
 - MH RIMS & CATCH BASIN INLET ELEVATIONS, FIRE HYDRANT & FLANGE ELEVATIONS ARE APPROXIMATE. CONTRACTOR SHALL FIELD VERIFY AND ADJUST TO FINAL PAVEMENT GRADES.
 - SAS STATIONING FOLLOWS CL OF ROAD UNLESS OTHERWISE NOTED.
 - STATIONING OF DROP INLET IS TO MIDDLE OF DOWN HILL GRATE AT FACE OF CURB.
 - FLOWLINE ELEVATIONS FOR DROP INLETS ARE PROJECTED FROM FLOWLINE OF STANDARD CURB TO MIDDLE OF DOWNHILL GRATE.
 - FOR STORM DRAIN CONSTRUCTION: ALL RCP JOINTS SHALL NOT BE GROUTED PRIOR TO FINAL INSPECTION. FINAL INSPECTION SHALL DETERMINE WHICH JOINTS ARE TO BE GROUTED FOR FINAL ACCEPTANCE OF THE CONSTRUCTION.

AS-BUILT INFORMATION		BENCH MARKS		SURVEY INFORMATION		ENGINEER'S SEAL	
CONTRACTOR	DATE	STAMPED "TRANS"	DATE	NO.	BY	REMARKS	By
AS	AS	AS	AS			DESIGN	
INSPECTOR'S	DATE	Geographic Position (NAD 1927)				REVISIONS	
FIELD	DATE	N.M. State Plane Coordinates (Central Zone)				DESIGN	
CHECKED BY	DATE	X = 354,899.45 Y = 1,471,822.67					
CORRECTED BY	DATE	Ground-to-Grid Factor = 0.99967921					
MICRO-FILM INFORMATION		1:10 = -0016'42"					
RECORDED BY	DATE	SLD 1929 Elevation = 5118.43					
NO.							

Bohannon & Huston
Courtney I 7500 Jefferson St. NE Albuquerque, NM 87108-4395
ENGINEERING & SPATIAL DATA & ADVANCED TECHNOLOGIES

CITY OF ALBUQUERQUE
PUBLIC WORKS DEPARTMENT

GIBSON BLVD. IMPROVEMENTS
UTILITY PLAN AND PROFILE
STA. 14+10.48 - 25+00

Design Review Committee	City Engineer Approval	Mo./Day/Yr.	Mo./Day/Yr.
APPROVED	APPROVED		
DESIGN REVIEW COMMITTEE	CITY ENGINEER		

City Project No. 722785 Zone Map No. N - 9 Sheet 6 Of 8

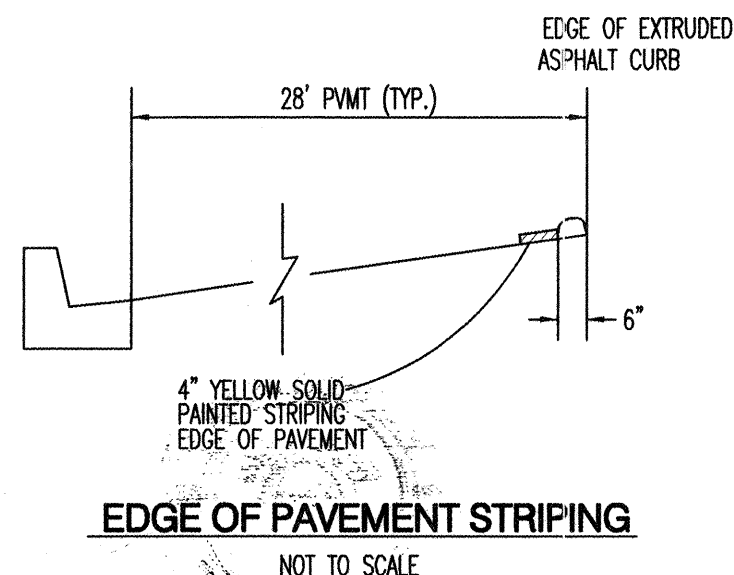
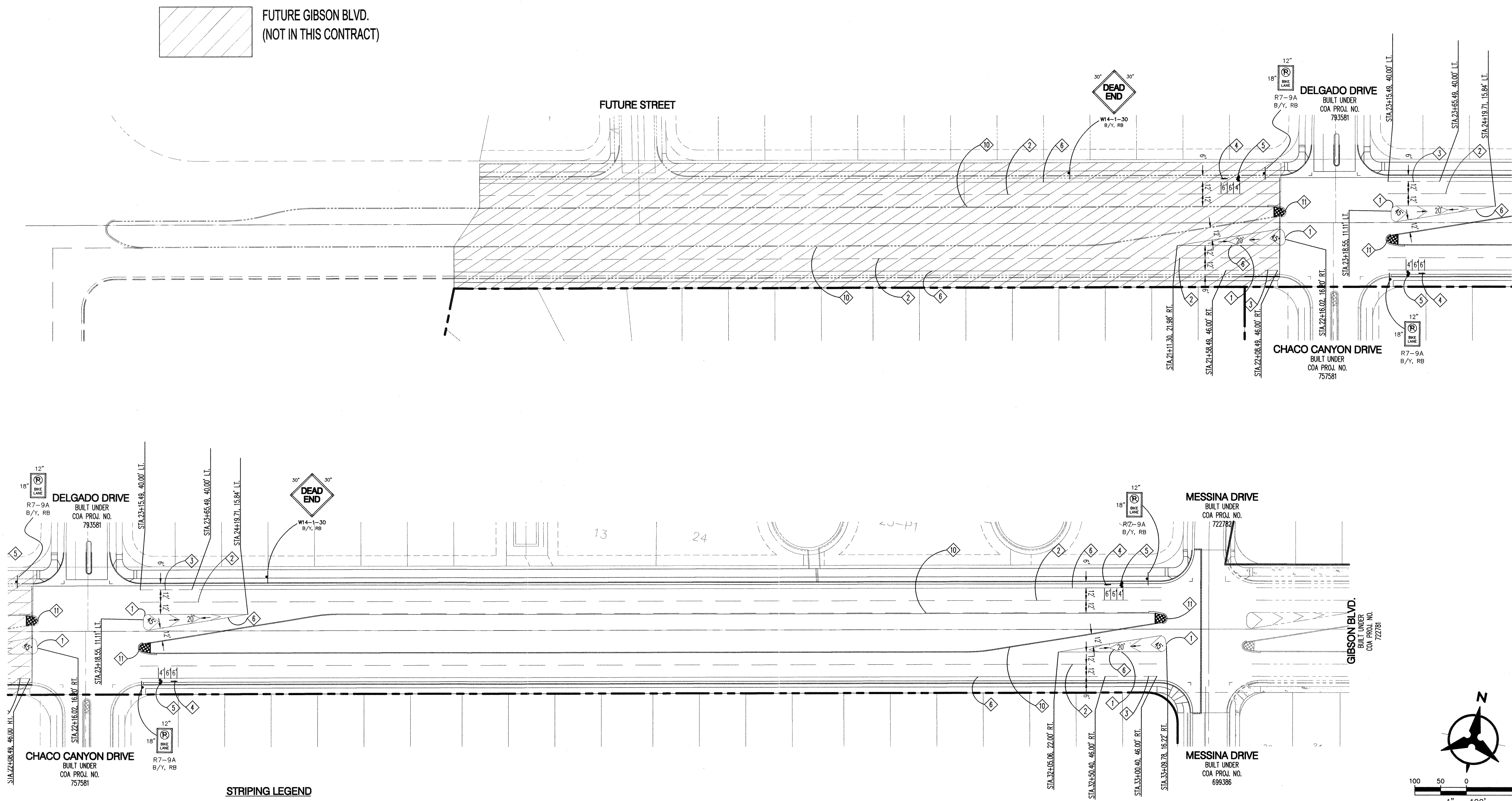

- KEYED NOTES**
- ERADICATE EXISTING STRIPING BY WATER BLASTING OR SURFACE PLANING OF THE ROADWAY TO A MAXIMUM DEPTH OF .25 INCHES AND FOR A WIDTH EQUAL TO TWO TIMES THE WIDTH OF STRIPE TO BE REMOVED.
 - CONTACT ANDREW GALLEGOS AT COA TRAFFIC OPERATIONS PRIOR TO STRIPING AND SIGNING (857-8004)

CERTIFICATE OF SUBSTANTIAL COMPLIANCE ON PLANS

I, Mark Goodwin, NMPE 8948, of the firm Mark Goodwin & Associates, P.A., a Registered Professional Engineer in the State of New Mexico, do hereby certify, to the best of my knowledge and belief, that the infrastructure installed as part of this project has been inspected by me or by a qualified person under my direct supervision, and has been constructed in accordance with the plans and specifications approved by the City Engineer and that the original design intent of the approved plans has been met, except as noted by me on the as-built construction drawings. This Certification is based on site inspections by me or personnel under my direction, and survey information provided by ALS, Inc., NMPS number 7719.

Mark Goodwin 8/1/05 NMPE 8948

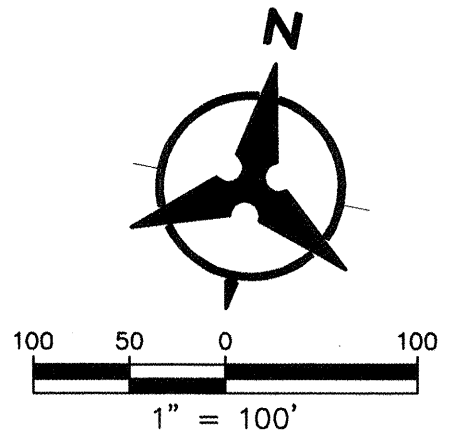

Bohannon & Huston

Courtyard I 7800 Jefferson St. NE Albuquerque, NM 87109-4395

ENGINEERING • SPATIAL DATA • ADVANCED TECHNOLOGIES

CITY OF ALBUQUERQUE PUBLIC WORKS DEPARTMENT	
GIBSON BLVD. IMPROVEMENTS STRIPING PLAN	
Design Review Committee APPROVED DESIGN REVIEW COMMITTEE	City Engineer Approval APPROVED CITY ENGINEER
City Project No. 722785	Zone Map No. N - 9
Sheet 7	Of 8

ENGINEER'S SEAL		SURVEY INFORMATION		BENCH MARKS		AS-BUILT INFORMATION	
	No. _____ By _____ Date _____	No. _____ By _____ Date _____	No. _____ By _____ Date _____	No. _____ By _____ Date _____	No. _____ By _____ Date _____	No. _____ By _____ Date _____	No. _____ By _____ Date _____

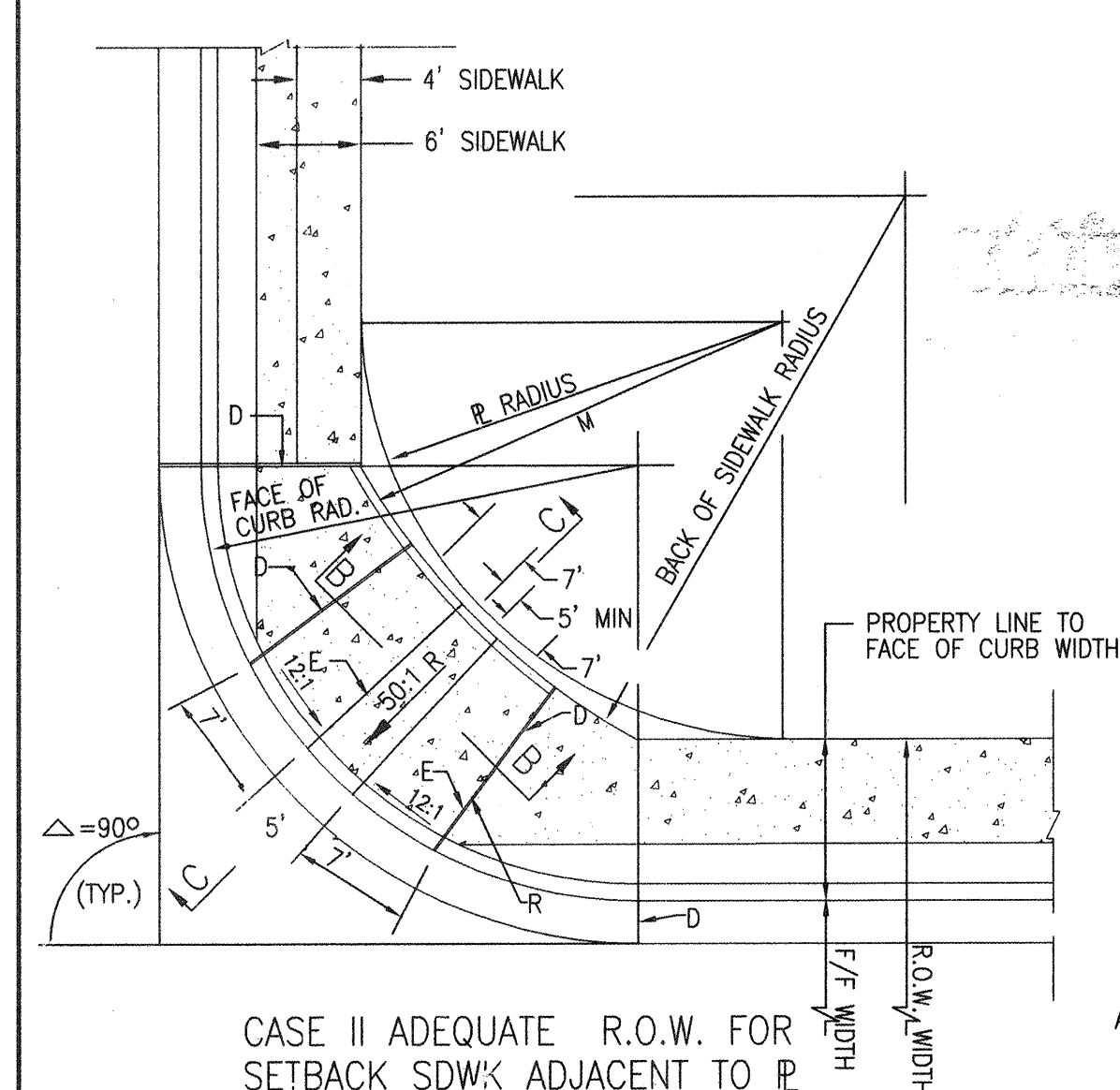

HANDICAP RAMP DETAIL

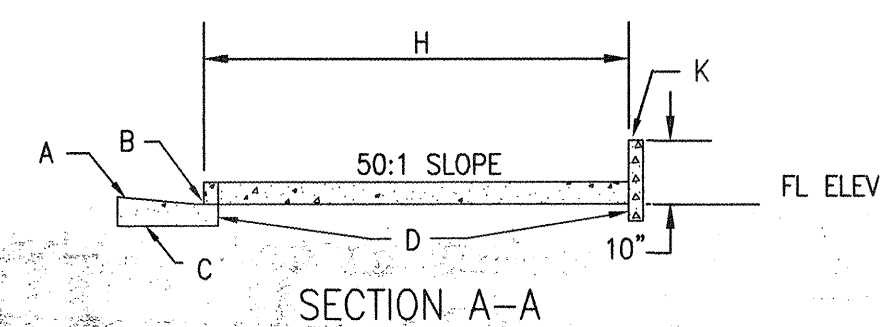

△	R RAD	CURB RAD	R CURB WIDTH	BACK SW RAD
90°	25'	25'	4'	25'
90°	30'	25'	4'	30'
90°	25'	30'	4'	25'
90°	30'	30'	4'	30'

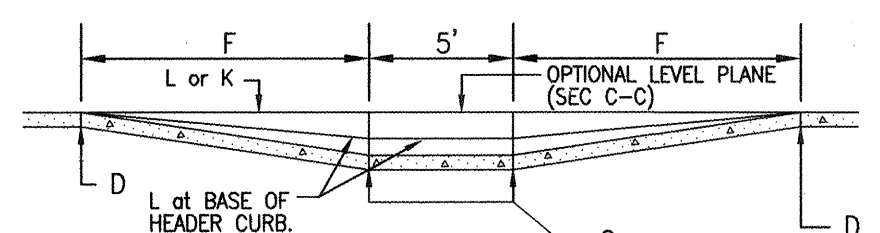

SECTION B-B

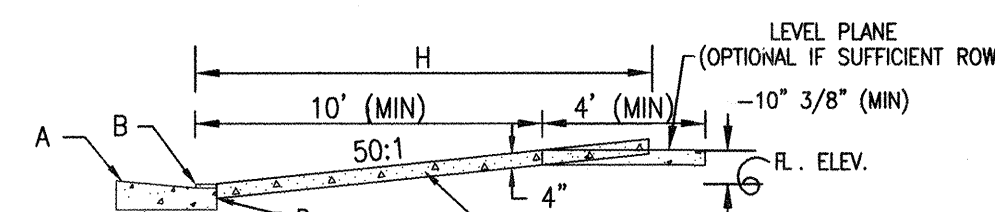

SECTION C-C CASE II

GENERAL NOTES:

1. CURB ACCESS RAMPS ARE NORMALLY TO BE LOCATED AT THE CENTER OF THE RETURN OR AS DIRECTED BY THE CITY TRAFFIC ENGINEER.
2. SURFACE TEXTURE OF CURB ACCESS RAMPS SHALL BE OBTAINED BY HEAVY BROOMING. (TEXTURE DEPTH .035"), TRANSVERSE TO THE SLOPE OF THE RAMP.
3. GUTTER FLOW-LINE PROFILE SHALL BE MAINTAINED THROUGH THE AREA OF THE RAMP. DRAINAGE CATCH BASIN STRUCTURES SHALL NOT BE PLACED IN LINE WITH RAMPS.
4. WIDTH OF SIDEWALK AND RAMP MUST BE MAINTAINED AT A MINIMUM OF 5'-0" THROUGH ENTIRE RAMP LENGTH.

CONSTRUCTION NOTES:

- A. SLOPE OF GUTTER DEPENDENT ON REQUIREMENTS FOR VALLEY GUTTER.
- B. 1/4" LIP ABOVE FLOW LINE (VERTICAL). SEE STD. DWG 2415
- C. CURB & GUTTER. (SEE STD. DWG 2415 - GUTTER AT THE CURB ACCESS RAMP).
- D. 1/2" EXPANSION JOINT.
- E. PARALLEL LINES - TOP AND BOTTOM OF RAMP.
- F. 12:1 MAX. SLOPE AT FACE OF CURB. (SEE STD. DWG 2418)
- G. CONTRACTION (DUMMY) JOINT.
- H. VARIES WITH AVAILABLE R.O.W.
- J. VARIABLE.
- K. HEADER CURB, SEE DWG. 2415.
- L. BACK OF SIDEWALK.
- M. BACK OF SIDEWALK RADIUS TO BE ESTABLISHED AS TO MAXIMUM 3'-0" OF RAMP WITH MINIMUM OF MORE THROUGHOUT. (SEE STD. DWG 2440 (NOTE 5) IF LESS THAN 3'-0" IS AVAILABLE DUE TO UNTIMELY UNSOLVABLE CONSTRAINTS.
- N. 4 1/2" MAX.
- P. ANY PRIVATE LANDSCAPING AND OR IRRIGATION SHALL BE RESTRICTED TO DRYER CONDITION. SHOULD ANY PRIVATE IMPROVEMENT NEED TO BE REMOVED, OWNER MUST BE NOTIFIED
- R. 12:1 SLOPE MAXIMUM ON RAMP.

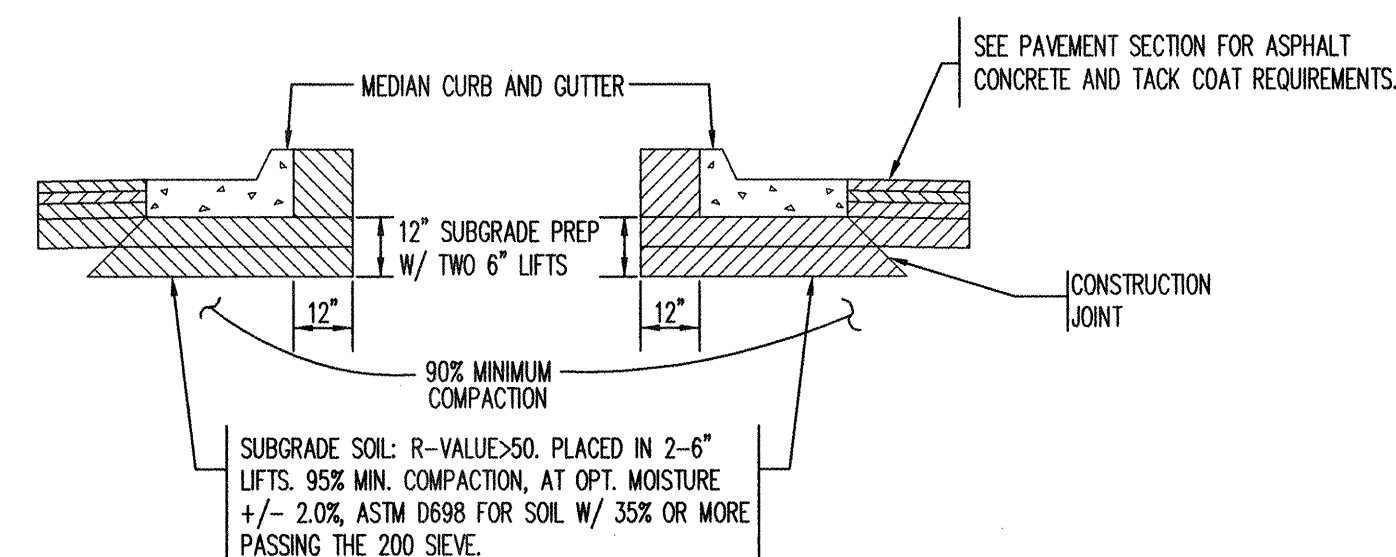

MEDIAN CURB AND GUTTER
NOT TO SCALE

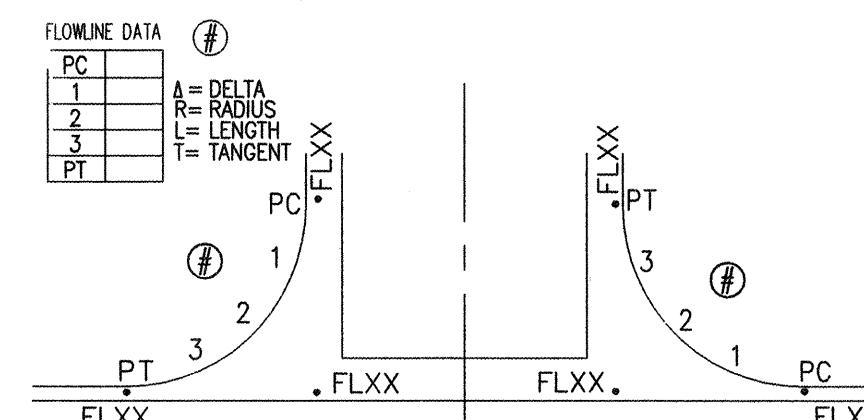

TYPICAL INTERSECTION RETURNS DETAIL

NOT TO SCALE

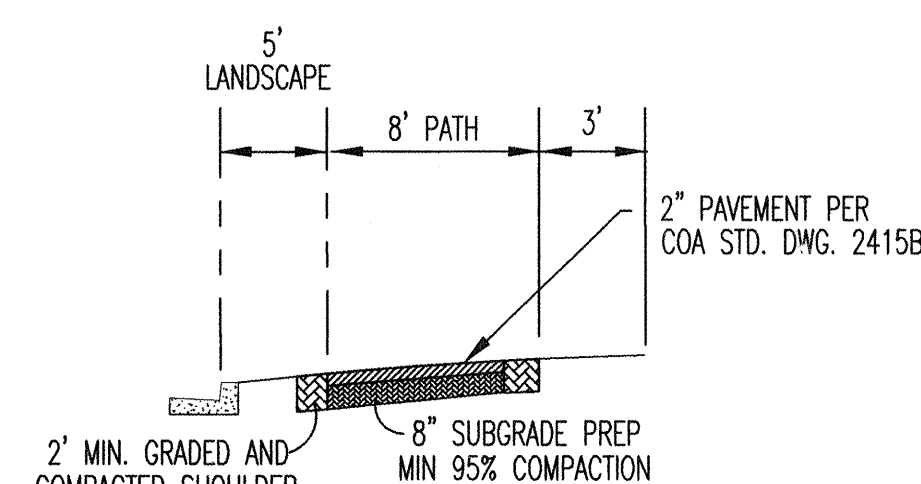

NOTE:
PEDESTRIAN TRAIL HORIZ RADII SHALL BE A MIN. 130' R

8' PEDESTRIAN TRAIL SECTION
NOT TO SCALE

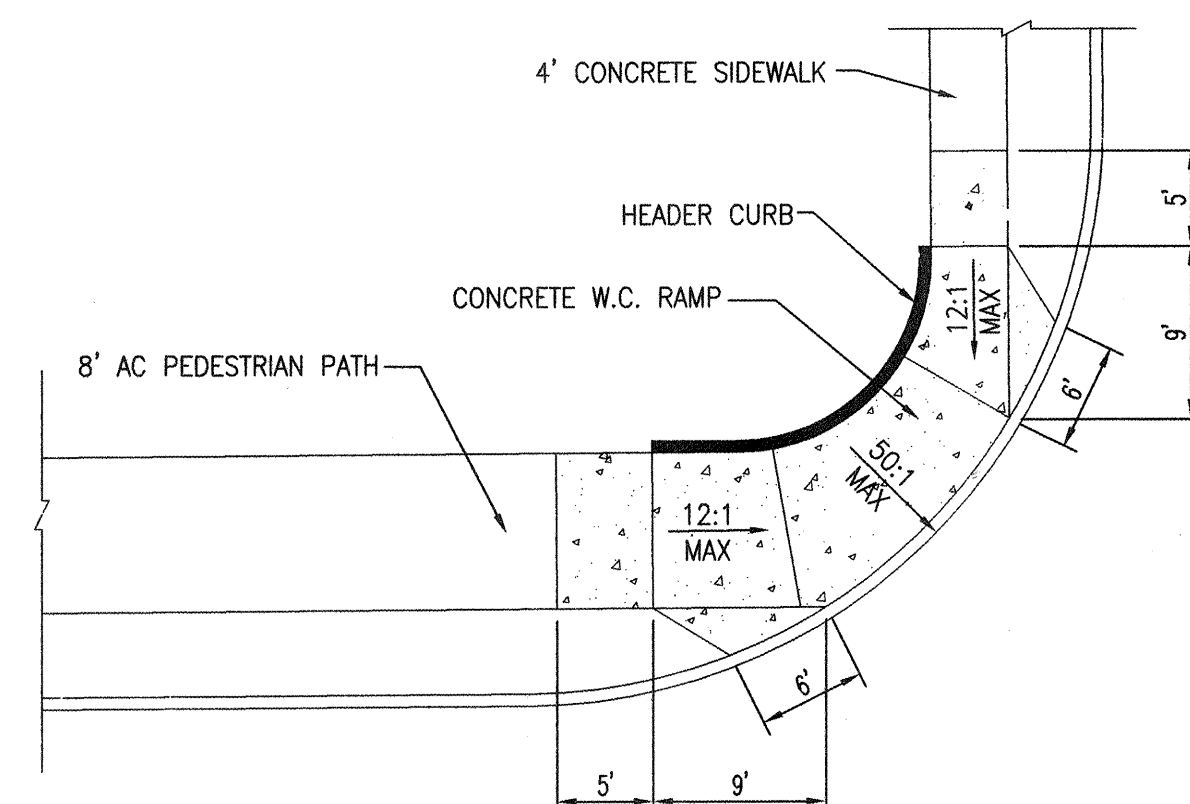

HANDICAP RAMP DETAIL 'B'
N.T.S.

FINISH SURFACES OF SUBGRADE SHALL BE MOISTURE CONTROLLED. THE COMPACTION MOISTURE RANGE, OR A PRIME COAT APPLIED AS REQUIRED BY THE ENGINEER UNTIL NEXT/ FINAL SURFACING IS COMPLETED. SUBGRADE PREPARATION SHALL BE PERFORMED AFTER ALL SUBSURFACE R/W UTILITIES CONSTRUCTION ARE COMPLETED.

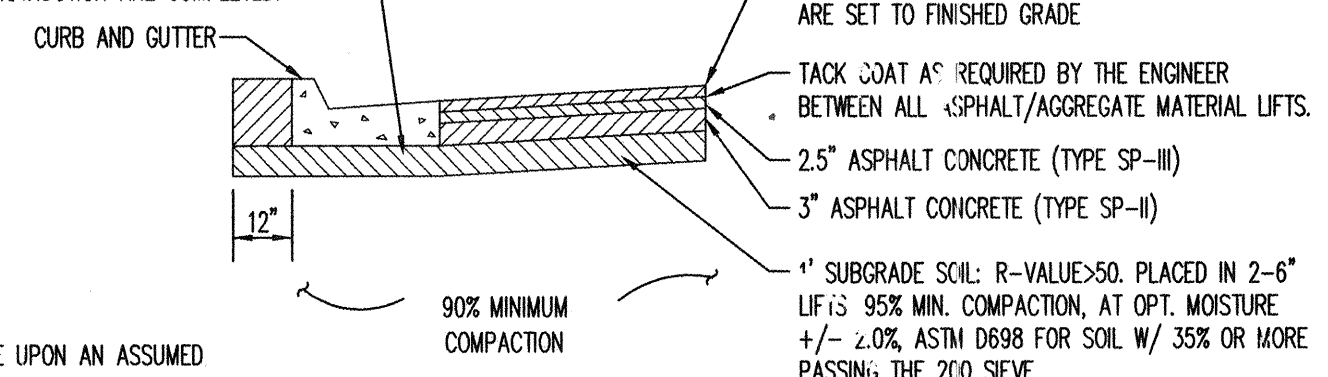

NOTE:

PAVEMENT SECTION DESIGNED BASE UPON AN ASSUMED R-VALUE OF 50 OR GREATER.

SOIL NOT HAVING THE MINIMUM R-VALUE OF 50 SHALL BE REMOVED TO A DEPTH OF 2 FEET AND REPLACED BY THE CONTRACTOR WITH SUITABLE MATERIAL OR A PAVEMENT SECTION SHALL BE DESIGNED BY THE CONSULTANT ACCOMMODATING THE EXISTING R-VALUE PER COA STANDARD SPECS.

FINISH SURFACES OF SUBGRADE SHALL BE MOISTURE CONTROLLED AT THE COMPACTION MOISTURE RANGE, OR A PRIME COAT APPLIED AS REQUIRED BY THE ENGINEER UNTIL NEXT/ FINAL SURFACING IS COMPLETED. SUBGRADE PREPARATION SHALL BE PERFORMED AFTER ALL SUBSURFACE R/W UTILITIES CONSTRUCTION ARE COMPLETED.

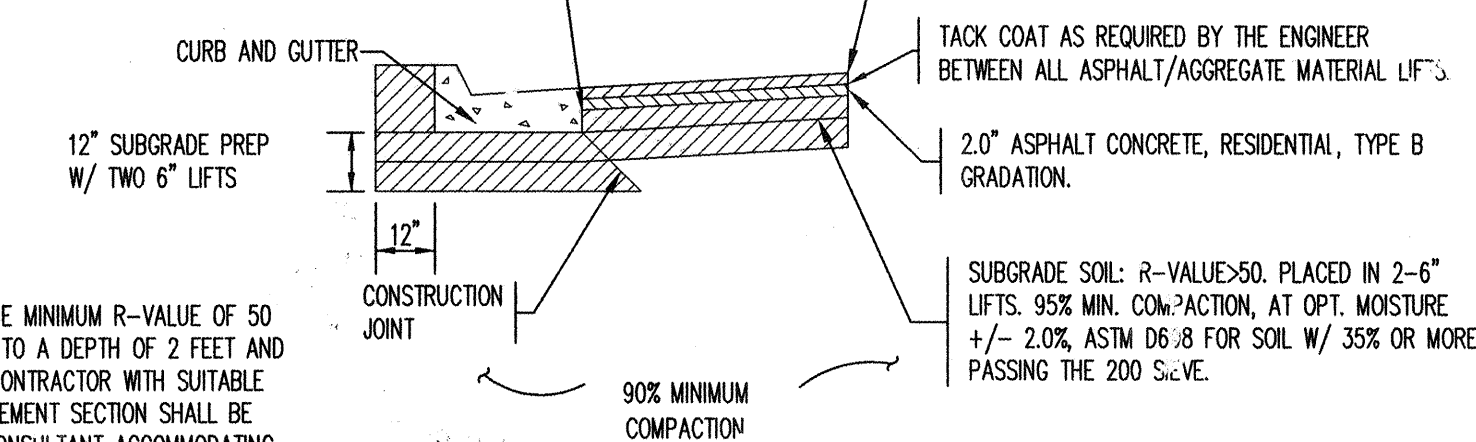

NOTE:
SOIL NOT HAVING THE MINIMUM R-VALUE OF 50 SHALL BE REMOVED TO A DEPTH OF 2 FEET AND REPLACED BY THE CONTRACTOR WITH SUITABLE MATERIAL OR A PAVEMENT SECTION SHALL BE DESIGNED BY THE CONSULTANT ACCOMMODATING THE EXISTING R-VALUE PER COA STANDARD SPECS.

2.0" ASPHALT CONCRETE TYPICAL FINISH COURSE
PLACED AFTER ALL MANHOLE & VALVE COVERS/RINGS
ARE SET TO GRADE, RESIDENTIAL, TYPE B GRADATION.

2.0" ASPHALT CONCRETE, RESIDENTIAL, TYPE B GRADATION.

SUBGRADE SOIL: R-VALUE>50. PLACED IN 2-6" LIFTS. 95% MIN. COMPACTION, AT OPT. MOISTURE +/- 2.0%, ASTM D698 FOR SOIL W/ 35% OR MORE PASSING THE 200 SIEVE.

RESIDENTIAL PAVEMENT SECTION
4" ASPHALT

ARTERIAL PAVEMENT SECTION - GIBSON BLVD.

PER COA PROJECT NO. 722781
NOT TO SCALE

CERTIFICATE OF SUBSTANTIAL COMPLIANCE ON PLANS

I, Mark Goodwin, NMPE #8948, of the firm Mark Goodwin & Associates, PA, a Registered Professional Engineer in the State of New Mexico, do hereby certify, to the best of my knowledge and belief, that the infrastructure installed as part of this project has been inspected by me or by a qualified person under my direct supervision, and has been constructed in accordance with the plans and specifications approved by the City Engineer and that the original design intent of the approved plans has been met, except as noted by me on the as-built construction drawings. This Certification is based on site inspections by me or personnel under my direction, and survey information provided by ALS Inc. NMES number 7719.

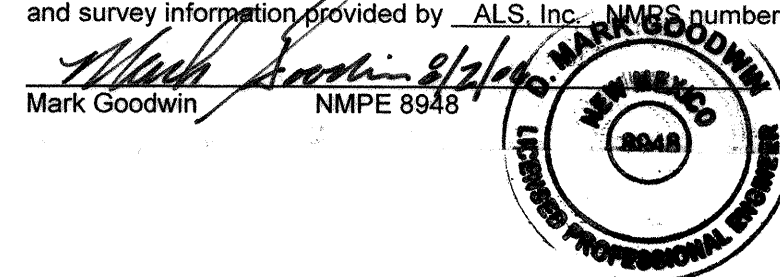



Bohannon ▲ Huston

Courtyard I 7500 Jefferson St. NE Albuquerque, NM 87109-4335
ENGINEERING ▴ SPATIAL DATA ▴ ADVANCED TECHNOLOGIES



CITY OF ALBUQUERQUE
PUBLIC WORKS DEPARTMENT

GIBSON BLVD. IMPROVEMENTS
MISCELLANEOUS DETAILS

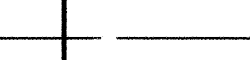
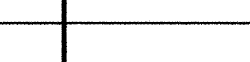
Design Review Committee		City Engineer Approval		Last Design Update		Mo./Day/Yr.		Mo./Day/Yr.	
									
City Project No. 722785				Zone Map No. N - 9		Sheet 8		Of 8	

ENGINEER'S SEAL		SURVEY INFORMATION		BENCH MARKS		AS-BUILT INFORMATION	
		FIELD NOTES					
No.	Date	No.	BY	DATE		CONTRACTOR	DATE
						WORKS BY AKS	08/10
						INSPECTOR'S ACCEPTANCE BY MISHA	DATE 8/10
						VERIFICATION BY AKS	DATE 9/10
						DRAWINGS CORRECTED BY AKS	DATE 9/10
						MICROFILM INFORMATION	
						RECORDED BY	DATE
						No.	



SJS
PROFESSIONAL ENGINEER
STATE OF CALIFORNIA
LICENSE NO. 14654
EXPIRES 12/31/2007

Designed By:	SJS	DATE:	03/05
Drawn By:	BUG	DATE:	03/05