

SCANNED BY
PLANNING

2 3 4 5 6 7 8 9 10 11 12 13 14 15
2009-12-14 16:18:11

CONSTRUCTION PLANS FOR UNM BBER PARKING STRUCTURE YALE INFRASTRUCTURE ALBUQUERQUE, NEW MEXICO

INDEX

SHEET NUMBER

1

DESCRIPTION

COVER SHEET

PUBLIC PAVING PLANS

SHEET NUMBER

2

DESCRIPTION

YALE AND LAS LOMAS UTILITY PLAN

CONSTRUCTION NOTES

1. THE CONTRACTOR SHALL ABIDE BY ALL LOCAL, STATE, AND FEDERAL LAWS, RULES AND REGULATIONS WHICH APPLY TO THE CONSTRUCTION OF THESE IMPROVEMENTS.

2. PRIOR TO CONSTRUCTION, CONTRACTOR SHALL EXCAVATE AND VERIFY THE HORIZONTAL AND VERTICAL LOCATIONS OF ALL POTENTIAL OBSTRUCTIONS. SHOULD A CONFLICT EXIST, THE CONTRACTOR SHALL NOTIFY THE ENGINEER OR CONSTRUCTION OBSERVER SO THAT THE CONFLICT CAN BE RESOLVED WITH A MINIMUM AMOUNT OF DELAY.

3. ALL ELECTRICAL, TELEPHONE, CABLE TV, GAS AND OTHER UTILITY LINES, CABLES AND APPURTENANCES ENCOUNTERED DURING CONSTRUCTION THAT REQUIRE RELOCATION, SHALL BE COORDINATED WITH THAT UTILITY. THE CONTRACTOR SHALL BE RESPONSIBLE FOR COORDINATION OF ALL NECESSARY UTILITY ADJUSTMENTS. NO ADDITIONAL COMPENSATION WILL BE ALLOWED FOR DELAYS OR INCONVENIENCES CAUSED BY UTILITY COMPANY WORK CREWS. THE CONTRACTOR MAY BE REQUIRED TO RESCHEDULE HIS ACTIVITIES TO ALLOW UTILITY CREWS TO PERFORM THEIR REQUIRED WORK.

4. DISPOSAL SITE FOR ALL EXCESS EXCAVATION MATERIAL, AND UNSUITABLE MATERIAL SHALL BE OBTAINED BY THE CONTRACTOR IN COMPLIANCE WITH APPLICABLE ENVIRONMENTAL REGULATIONS AND APPROVED BY THE CONSTRUCTION OBSERVER. ALL COSTS INCURRED IN OBTAINING A DISPOSAL SITE AND HAUL THERE TO SHALL BE CONSIDERED INCIDENTAL TO THE PROJECT AND NO SEPARATE MEASUREMENT OR PAYMENT SHALL BE MADE.

5. THE CONTRACTOR IS RESPONSIBLE FOR PROTECTING THE EXISTING UTILITY LINES WITHIN THE CONSTRUCTION AREA. ANY DAMAGE TO EXISTING FACILITIES CAUSED BY CONSTRUCTION ACTIVITY SHALL BE REPAIRED OR REPLACED AT THE CONTRACTOR'S EXPENSE AND APPROVED BY THE CONSTRUCTION OBSERVER.

6. CONSTRUCTION ACTIVITY SHALL BE LIMITED TO THE PROPERTY AND/OR PROJECT LIMITS. ANY DAMAGE TO ADJACENT PROPERTIES RESULTING FROM THE CONSTRUCTION PROCESS IS THE RESPONSIBILITY OF THE CONTRACTOR. ANY COSTS INCURRED FOR REPAIRS SHALL BE THE COST OF THE CONTRACTOR.

7. OVERNIGHT PARKING OF CONSTRUCTION EQUIPMENT SHALL NOT OBSTRUCT DRIVEWAYS OR DESIGNATED TRAFFIC LANES. THE CONTRACTOR SHALL NOT STORE ANY EQUIPMENT OR MATERIAL WITHIN THE PUBLIC RIGHT-OF-WAY.

8. THE CONTRACTOR SHALL OBTAIN ALL THE NECESSARY PERMITS FOR THE PROJECT PRIOR TO COMMENCING CONSTRUCTION (I.E. BARRICADING, SURFACE DISTURBANCE).

9. THE CONTRACTOR SHALL BE RESPONSIBLE TO REPLACE AT HIS EXPENSE ANY AND ALL PROPERTY CORNERS DESTROYED DURING CONSTRUCTION. ALL PROPERTY CORNERS MUST BE RESET BY A REGISTERED LAND SURVEYOR.

10. ALL PERMANENT PAVEMENT MARKING AND TRAFFIC SIGNING SHALL BE FURNISHED BY THE CONTRACTOR PER PLAN.

11. THE CONTRACTOR SHALL FOLLOW THE COA STANDARD CONSTRUCTION, TRAFFIC CONTROL AND SIGNING PLAN PROVIDED IN THE COA STANDARD SPECIFICATIONS. THE CONTRACTOR SHALL COORDINATE WITH THE CITY OF ALBUQUERQUE, CONSTRUCTION COORDINATION DEPARTMENT, PRIOR TO BEGINNING ANY CONSTRUCTION WORK ON OR ADJACENT TO EXISTING STREETS.

12. ALL BARRICADES AND CONSTRUCTION SIGNING SHALL CONFORM TO APPLICABLE SECTIONS OF THE "MANUAL ON UNIFORM TRAFFIC CONTROL DEVICES" (MUTCD), FEDERAL HIGHWAY ADMINISTRATION, LATEST EDITION.

13. THE CONTRACTOR SHALL MAINTAIN ALL CONSTRUCTION BARRICADES AND SIGNING AT ALL TIMES. THE CONTRACTOR SHALL VERIFY THE PROPER LOCATION OF ALL BARRICADING AT THE END AND BEGINNING OF EACH DAY AS PER STANDARD SPECIFICATIONS.

14. ALL SAWCUT PAVEMENT SHALL HAVE A UNIFORM EDGE AND BE SPRAYED WITH TACK.

15. WHEN ABUTTING NEW CURB AND GUTTER TO EXISTING PAVEMENT, A 1' WIDE SECTION OF EXISTING PAVEMENT ADJACENT TO THE CURB AND GUTTER SHALL BE SAWCUT, REMOVED, AND REPLACED AS PER THE COA STANDARD SPECIFICATIONS.

16. THE CONTRACTOR SHALL ASSUME RESPONSIBILITY FOR ANY DAMAGE TO EXISTING PAVEMENTS, PAVEMENT MARKINGS, CURB & GUTTER, DRIVE PADS, WHEELCHAIR RAMPS, AND SIDEWALK DURING CONSTRUCTION, APART FROM THOSE SECTIONS INDICATED FOR REMOVAL ON THE PLANS AND SHALL REPAIR OR REPLACE PER COA STANDARDS, AT HIS OWN EXPENSE.

17. ALL EXCAVATION, TRENCHING, AND SHORING ACTIVITIES MUST BE CARRIED-OUT IN ACCORDANCE WITH OSHA 29 CFR 1926.650 SUBPART P.

CERTIFICATE OF SUBSTANTIAL COMPLIANCE ON PLANS

I, Matthew A. Santistevan of the firm of Bohannon Huston, Inc., a Registered Professional Engineer in the State of New Mexico, do hereby certify, to the best of my knowledge and belief, that the infrastructure installed as shown on these drawings (UNM BBER Parking Structure Yale Infrastructure, City Project No. 724688) has been inspected by me or by a qualified person under my direct supervision and has been constructed in accordance with the plans and specifications and that the original design intent of the approved plans has been met, except as noted by me on the as-built construction drawings. This Certification is based on site inspections by me or personnel under my direction and survey information provided by the contractor, Custom Grading, Inc., and their surveyor, William F. Brewster, RPS 10855.

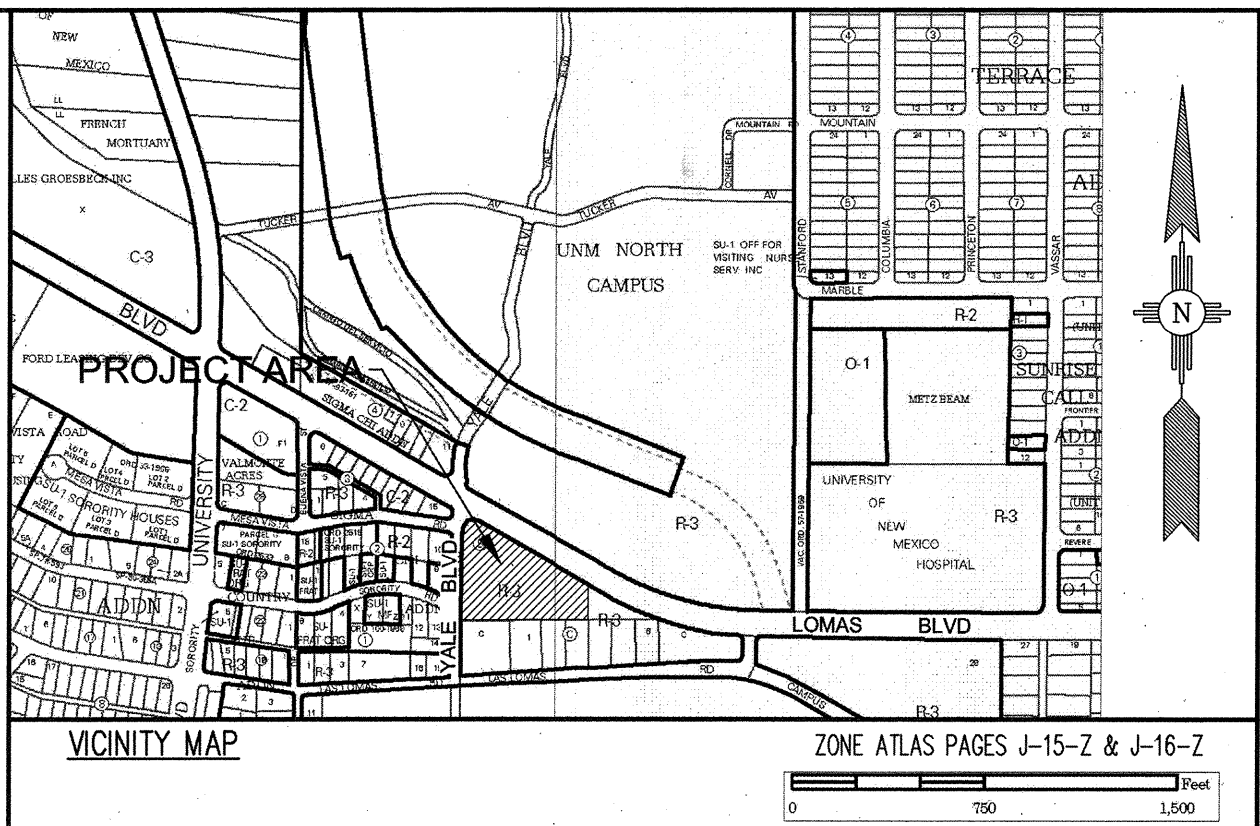
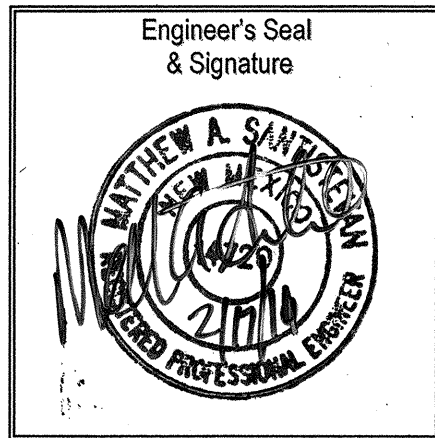

NOTICE TO CONTRACTORS

1. AN EXCAVATION/CONSTRUCTION PERMIT WILL BE REQUIRED BEFORE BEGINNING ANY WORK WITHIN THE CITY RIGHT-OF-WAY.
2. ALL WORK DETAILED ON THESE PLANS TO BE PERFORMED UNDER CONTRACT SHALL, EXCEPT AS OTHERWISE STATED OR PROVIDED FOR HEREON, BE CONSTRUCTED IN ACCORDANCE WITH THE CITY OF ALBUQUERQUE STANDARD SPECIFICATIONS FOR PUBLIC WORKS CONSTRUCTION, 1986 EDITION AS REVISED THROUGH UPDATE #7 INCLUDING AMENDMENT NO. ONE.
3. TWO WORKING DAYS PRIOR TO ANY EXCAVATION, THE CONTRACTOR MUST CONTACT NEW MEXICO ONE CALL SYSTEM (260-1990) FOR LOCATION OF EXISTING UTILITIES.
4. SEVEN (7) WORKING DAYS PRIOR TO BEGINNING CONSTRUCTION, THE CONTRACTOR SHALL SUBMIT TO CONSTRUCTION COORDINATION DIVISION A DETAILED CONSTRUCTION SCHEDULE. TWO (2) WORKING DAYS PRIOR TO THE START OF CONSTRUCTION, THE CONTRACTOR SHALL OBTAIN A BARRICADING PERMIT FROM THE CONSTRUCTION COORDINATION DIVISION. CONTRACTOR SHALL NOTIFY THE CONSTRUCTION COORDINATION ENGINEER (924-3400) PRIOR TO OCCUPYING AN INTERSECTION. REFER TO SECTION 19 OF THE GENERAL CONDITIONS OF THE STANDARD SPECIFICATIONS.
5. ALL WORK EFFECTING ARTERIAL ROADWAYS REQUIRES TWENTY-FOUR HOUR CONSTRUCTION.
6. ALL STREET STRIPING ALTERED OR DESTROYED SHALL BE REPLACED WITH PLASTIC REFLECTORIZED PAVEMENT MARKING BY CONTRACTOR TO THE SAME LOCATION AS WAS EXISTING, OR AS INDICATED BY THIS PLAN SET.
7. CONTRACTOR SHALL NOTIFY THE ENGINEER NOT LESS THAN SEVEN (7) DAYS PRIOR TO STARTING WORK IN ORDER THAT THE CITY SURVEYOR MAY TAKE NECESSARY MEASURES TO INSURE THE PRESERVATION OF SURVEY MONUMENTS. CONTRACTOR SHALL NOT DISTURB PERMANENT SURVEY MONUMENTS WITHOUT THE CONSENT OF THE CITY SURVEYOR AND SHALL NOTIFY THE CITY SURVEYOR AND BEAR THE EXPENSE OF REPLACING ANY THAT MAY BE DISTURBED WITHOUT PERMISSION. REPLACEMENT SHALL BE DONE ONLY BY THE CITY SURVEYOR. WHEN A CHANGE IS MADE IN THE FINISHED ELEVATIONS OF THE PAVEMENT OF ANY ROADWAY IN WHICH A PERMANENT SURVEY MONUMENT IS LOCATED, CONTRACTOR SHALL, AT HIS OWN EXPENSE, ADJUST THE MONUMENT COVER TO THE NEW GRADE UNLESS OTHERWISE SPECIFIED. REFER TO SECTION 4.4 OF THE GENERAL CONDITIONS OF THE STANDARD SPECIFICATIONS.
8. CONTRACTOR SHALL RECORD DATA ON ALL UTILITY LINES AND ACCESSORIES AS REQUIRED BY THE CITY OF ALBUQUERQUE FOR THE PREPARATION OF "AS CONSTRUCTED" DRAWINGS. CONTRACTOR SHALL NOT COVER UTILITY LINES AND ACCESSORIES UNTIL ALL DATA HAS BEEN RECORDED.
9. CONTRACTOR SHALL MAINTAIN A GRAFFITI-FREE WORK SITE. CONTRACTOR SHALL PROMPTLY REMOVE ANY GRAFFITI FROM ALL EQUIPMENT, WHETHER PERMANENT OR TEMPORARY.
10. CONTRACTOR SHALL COORDINATE WITH THE ABCWUA (505-768-2500) SEVEN (7) WORKING DAYS IN ADVANCE OF ANY WORK THAT MAY AFFECT EXISTING PUBLIC WATER OR SEWER UTILITIES. EXISTING VALVES TO BE OPERATED BY ABCWUA PERSONNEL ONLY. CONTRACTOR SHALL CONTACT THE ABCWUA SEVEN (7) WORKING DAYS PRIOR TO NEEDING VALVES TURNED ON OR OFF.
11. CONTRACTOR SHALL BE RESPONSIBLE FOR PROVIDING AND MAINTAINING ALL CONSTRUCTION SIGNING UNTIL PROJECT HAS BEEN ACCEPTED BY THE COA.

THE FOLLOWING NOTES ALSO APPLY WHEN CHECKED

- ☒ ALL UTILITIES AND UTILITY SERVICE LINES SHALL BE INSTALLED PRIOR TO PAVING.
- ☐ BACKFILL COMPACTION SHALL BE ACCORDING TO SPECIFIED STREET USE.
- ☐ TACK COAT REQUIREMENTS SHALL BE DETERMINED BY THE ENGINEER.
- ☐ SIDEWALKS AND WHEELCHAIR RAMPS WITHIN THE CURB RETURNS SHALL BE CONSTRUCTED WHEREVER A NEW CURB RETURN IS CONSTRUCTED.
- ☐ IF CURB IS DERESSED FOR A DRIVEPAD, THE DRIVEPAD SHALL BE CONSTRUCTED PRIOR TO ACCEPTANCE OF CURB AND GUTTER.
- ☐ ALL STORM DRAINAGE FACILITIES SHALL BE COMPLETED PRIOR TO FINAL ACCEPTANCE.
- ☒ THE REQUESTOR OR DEVELOPER SHALL BE RESPONSIBLE FOR REPAIR OR REPLACEMENT OF ALL CURB AND GUTTER OR SIDEWALK DAMAGED AFTER APPROVAL BY THE CITY ENGINEER OF WORK COMPLETED BY THE CONTRACTOR.

RECORD DRAWINGS

NOTE: IT IS THE CONTRACTOR'S RESPONSIBILITY TO CONDUCT FIELD INVESTIGATIONS AND DETERMINE/VERIFY ACTUAL LOCATIONS OF EXISTING UTILITIES AND IMPROVEMENTS

APPROVED AS RECORD DRAWINGS
DESIGN REVIEW SECTION
CITY CONSTRUCTION ENGINEER
Matthew A. Santistevan
DATE: 09/15/09

Bohannon & Huston

Courtyard I 7500 Jefferson St. NE Albuquerque, NM 87109-4335
ENGINEERING • SPATIAL DATA • ADVANCED TECHNOLOGIES

REV.	SHEETS	CITY ENGINEER	DATE	USER DEPARTMENT	DATE	USER DEPARTMENT	DATE
ENGINEERS STAMP & SIGNATURE	APPROVALS	ENGINEER	DATE	*****	DATE	*****	DATE
Michael Balaskovits	DRC Chairman	Michael Balaskovits	4-6-10	APPROVED FOR CONSTRUCTION			
	Transportation	Michael Balaskovits	12-7-09				
	Water/Wastewater	Michael Balaskovits	12-7-09				
	Hydrology	Michael Balaskovits	12-7-09				
	Parks						
	Const. Mngmt.						
	Const. Coord.						
DRB CASE NUMBER	CITY PROJECT NO.			SHEET	OF		
N/A	724688			1	2		

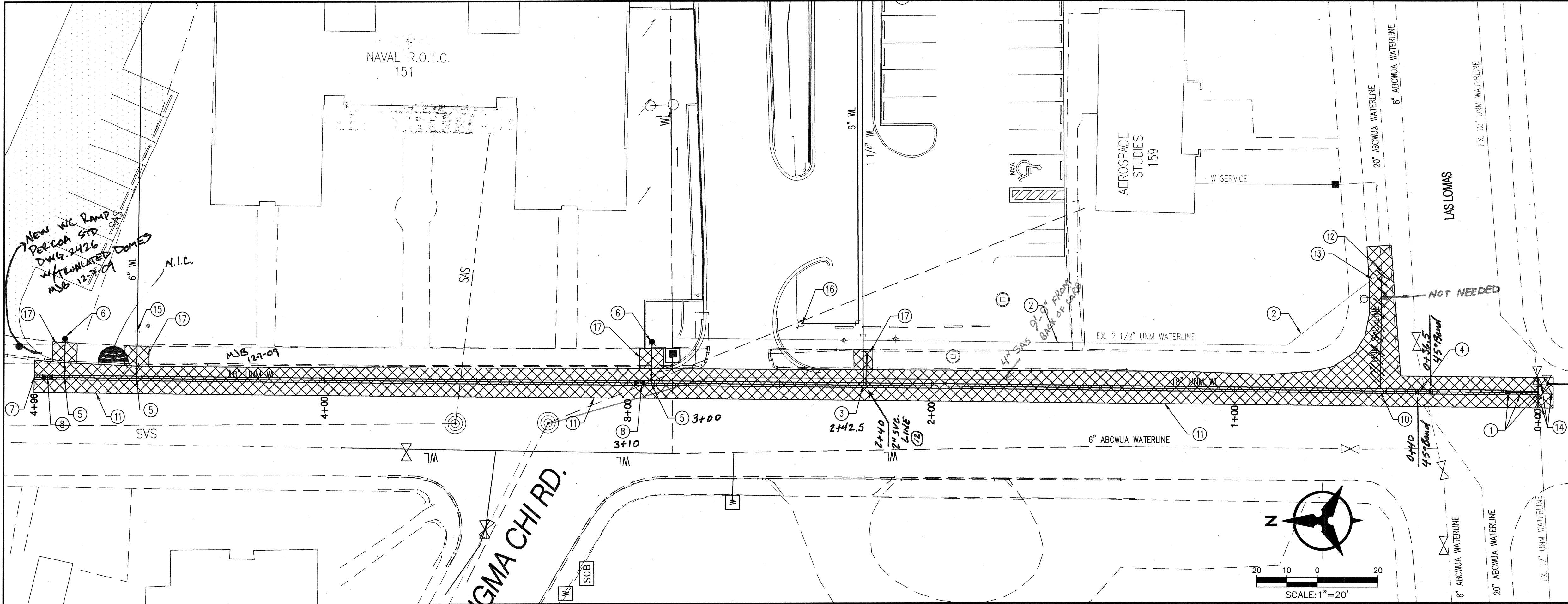

WATER NOTE:

THE DEMOLITION AND THE CONSTRUCTION OF THE WATERLINE SHALL BE CLOSELY COORDINATED WITH UNM AND FORD UTILITIES TO ENSURE THE NAVAL ROTC AND AEROSPACE STUDIES BUILDING HAVE CONTINUED SERVICE. THE CONTRACTOR SHALL GIVE UNM FACILITIES PLANNING SUFFICIENT TIME TO PREPARE THESE BUILDINGS FOR TEMPORARY OUTAGES DURING THE CONSTRUCTION. THE CONTRACTOR SHALL NOTIFY THE ENGINEER AND UNM OF ANY DISCREPANCIES. CONTRACTOR SHALL COORDINATE RECONNECTION TO EXISTING WATER SERVICE LINES FOR THESE TWO BUILDINGS WITH UNM FACILITIES PLANNING.

NOTICE TO CONTRACTORS:

EXISTING UTILITIES SHOWN AT THE INTERSECTION OF LAS LOMAS AND YALE BLVD ARE BASED ON AN EXISTING SURVEY PROVIDED BY UNM. CONTRACTOR SHALL POthOLE FOR EXISTING UTILITIES AND NOTIFY THE ENGINEER OF ANY DISCREPANCIES. ALL EXISTING UTILITIES SHALL BE AS-BUILT ON DRAWINGS WITH COORDINATES AND ELEVATIONS.

IN ADDITION, THE CONTRACTOR SHALL PROVIDE COORDINATES AND ELEVATIONS OF THE NEW 18" UNM WATERLINE EVERY 20'.

YALE BOULEVARD

TOP OF PIPE ELEVATIONS:			
0+00 - 10" Tee	5153.12	2+40	5141.03
0+05.5 - 10x12 Red	5153.12	2+60	5139.79
0+10	"	2+80	5138.71
0+20	5152.41	3+00	5137.69
0+36.5 - 45°	5152.41	3+20	5136.74
0+40 - 45°	5149.65	3+40	5135.88
0+60	5148.91	3+60	5135.30
0+80	5148.66	3+80	5134.78
1+00	5148.65	4+00	5134.23
1+20	5148.63	4+20	5133.48
1+40	5147.95	4+40	5132.57
1+60	5146.69	4+60	5131.92
1+80	5144.31	4+80	5130.90
2+00	5142.81	4+96 - Cap	5129.89
2+20	5142.31		

Certified As-Builts:

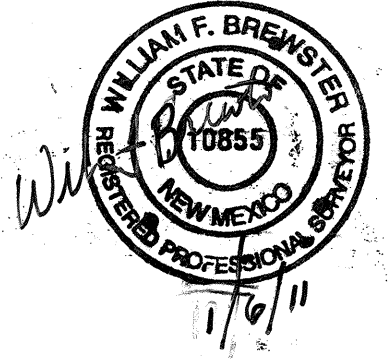

RESTRAINED JOINT TABLE

MECHANICAL JOINTS (C900-PVC)	LENGTH OF RESTRAINED JOINTS
12"x12"x12" TEE	72" (BRANCH)
18"x18"x6" TEE	35" (BRANCH)
6" GATE VALVE/CAP	55"
12" GATE VALVE/CAP	65"
18" BUTTERFLY VALVE/CAP	92"
18"x12" REDUCER	50"
18" 45° VERTICAL BEND	36" UPPER/10' LOWER

MATERIALS:

WATER LINE: C900-PVC OR 18" DUCTILE IRON PIPE (18" MAINLINE)

- NOTE:
- RESTRAINED JOINTS ANALYZED WITH TYPE SM SOIL, 1.5 SAFETY FACTOR, 3 FT MIN BURY, TRENCH TYPE 4, AND WITH 150 PSI MAX PRESSURE.
 - ALL MECHANICAL JOINTS SHALL BE RESTRAINED AT THE FITTING.
 - ALL SERVICE/FIRE LINES SHALL BE RESTRAINED THE ENTIRE DISTANCE FROM THE FITTING TO THE CAP.
 - THE CONTRACTOR SHALL RESTRAIN ALL FIRE HYDRANT JOINTS FROM THE TEE ON THE MAIN TO THE FIRE HYDRANT FLANGE.
 - THE CONTRACTOR SHALL PROVIDE A MINIMUM PIPE LENGTH OF 20 LF FROM ALL MECHANICAL JOINTS. UNLESS SPECIFIED DIFFERENTLY IN THE PLANS, ALL PIPE JOINTS WITHIN 20 LF OF A MJ SHALL BE RESTRAINED AT THE CONTRACTORS EXPENSE.
 - THE CONTRACTOR SHALL RESTRAIN ALL PIPE JOINTS TO THE SPECIFIED DISTANCE LISTED IN THE RESTRAINED JOINT TABLE (THIS SHEET).
 - THE CONTRACTOR SHALL TREAT CONNECTIONS TO EXISTING LINES AS A CAP WHEN CALCULATING RESTRAINING LENGTH.

RECORD DRAWINGS

UTILITY KEYED NOTES

- CONNECT TO EXISTING 12" UNM WATERLINE. INSTALL 1-1/2" X 1/2" X 1/2" TEE, 1-1/2" GATE VALVE (W/BOX & LID PER COA STD DWG 2326), & 1-1/2" X 1/2" REDUCER W/RESTRAINED JOINTS. CONTRACTOR SHALL COORDINATE WATER SHUT-OFF WITH UNM FPD AND FORD UTILITIES.
- ABANDON EXISTING 2" UNM WATERLINE IN PLACE.
- INSTALL 1 1/4" DUCTILE IRON SERVICE SADDLE, CORP STOP, AND SERVICE LINE. EXTEND 1 1/4" SERVICE LINE TO 5' BEYOND BACK OF SIDEWALK FOR FUTURE CONNECTION. (SEE PRIVATE ONSITE PLANS FOR CONTINUATION).
- CONTRACTOR SHALL PROVIDE THE NECESSARY VERTICAL FITTING W/ RESTRAINED JOINTS TO ENSURE THE NEW 18" UNM WATERLINE IS CONSTRUCTED BELOW THE EXISTING COA WATERLINES. THE CONTRACTOR SHALL PROVIDE LEAN FILL 10' IN EITHER DIRECTION OF THE CROSSING FROM SPRING LINE TO SPRING LINE.
- INSTALL 18"x18"x6" TEE W/ RESTRAINED JOINTS, 1-6" GATE VALVE W/ BOX & LID PER COA STD DWG 2326.
- INSTALL UNM FIRE HYDRANT COMPLETE W/ RESTRAINED JOINTS, PER COA STD DWG 2340.
- INSTALL 18" CAP FOR FUTURE USE W/ RESTRAINED JOINTS.
- INSTALL 18" BUTTERFLY VALVE PER COA STANDARD DRAWING 2352 W/ RESTRAINED JOINTS AND BOX & LID PER COA STD DWG 2326.
- INSTALL 9"x9"x3" TEE W/ RESTRAINED JOINTS, 1-3" VALVE W/ BOX & LID PER COA STD DWG 2326.
- INSTALL 2" DUCTILE IRON SERVICE SADDLE, CORP STOP, AND SERVICE LINE. EXTEND 2" SERVICE LINE TO EXISTING AEROSPACE STUDIES SERVICE LINE. CONTRACTOR SHALL CONFIRM EXISTING SERVICE SIZE AND LOCATION PRIOR TO TAPPING THE NEW 18" WATERLINE.
- REMOVE AND REPLACE ASPHALT PAVEMENT PER COA STD DWG 2465 (MAJOR LOCAL). CONTRACTOR SHALL PROTECT EXISTING CURB AND GUTTER IN PLACE.
- CONTRACTOR SHALL CONNECT EXISTING SERVICE TO NEW 2" SERVICE LINE AND PROVIDE REDUCERS AS NECESSARY. *Moved to 2+40.*
- CAP EXISTING 2 1/2" WATERLINE AND ABANDON IN PLACE.
- CONTRACTOR SHALL PROTECT EXISTING VALVES IN PLACE.
- EXTEND 6" WATERLINE TO 5' BEYOND BACK OF SIDEWALK FOR FUTURE CONNECTION. (SEE PRIVATE ONSITE PLANS FOR CONTINUATION).
- NOT APART OF THIS WORK ORDER SEE PRIVATE ONSITE PLANS FOR DETAILS.
- REMOVE & REPLACE SIDEWALK AND STANDARD CURB AND GUTTER PER COA STD DWG 2415A. CONTRACTOR SHALL MATCH EXISTING GRADES.

LEGEND

- PROPERTY LINE
- EXISTING EASEMENT
- SAS EXISTING SANITARY SEWER
- W EXISTING WATER LINE
- EXISTING WATER METER
- EXISTING CAP
- EXISTING VALVE
- EXISTING FIRE HYDRANT
- EXISTING SANITARY SEWER MANHOLE
- EXISTING STORY DRAIN MANHOLE
- EXISTING INLET
- PROPOSED EASEMENT
- SAS PROPOSED SANITARY SEWER LINE
- PROPOSED SANITARY SEWER MANHOLE
- PROPOSED CLEANOUT
- WL PROPOSED WATER LINE
- PROPOSED VALVE
- FL PROPOSED FIRE LINE
- PROPOSED HYDRANT
- PROPOSED CAP
- REMOVE & REPLACE ASPHALT PAVING SAW-CUT TO A STRAIGHT EDGE
- REMOVE & DISPOSE OF EXISTING UTILITY LINE

**CITY OF ALBUQUERQUE
PUBLIC WORKS DEPARTMENT**

**UNM BBER PARKING STRUCTURE PUBLIC INFRASTRUCTURE
YALE AND LAS LOMAS
UTILITY PLAN**

Design Review Committee APPROVED APR 03 2010 DESIGN REVIEW COMMITTEE	City Engineer Approval APPROVED JUL 07 2010 CITY ENGINEER	Mo./Day/Yr. ____/____/____	Mo./Day/Yr. ____/____/____
--	---	-------------------------------	-------------------------------

City Project No. 724688	Zone Map No. J15 - J16	Sheet 2	Of 2
-----------------------------------	----------------------------------	-------------------	----------------