

CONSTRUCTION PLANS
FOR
ECKERD DRUG STORE
CENTRAL AVENUE & SAN MATEO BLVD.
ALBUQUERQUE, NEW MEXICO

CERTIFICATE OF SUBSTANTIAL COMPLIANCE ON PLANS

I, William L. Vreeke, P.E., of the firm of Bohannon Huston, Inc., a Registered Professional Engineer in the State of New Mexico, do hereby certify, to the best of my knowledge and belief, that the infrastructure installed as part of this project (Eckerd Drug Store, Central/San Mateo) has been inspected by me or by a qualified person under my direct supervision and has been constructed in accordance with the plans and specifications approved by the City Engineer and that the original design intent of the approved plans has been met, except as noted by me on the as-built construction drawings. This Certification is based on site inspections by me or personnel under my direction and survey information provided by the contractor, Jaynes Corporation, and their surveyor, John L. Miers, NMPS 12447.

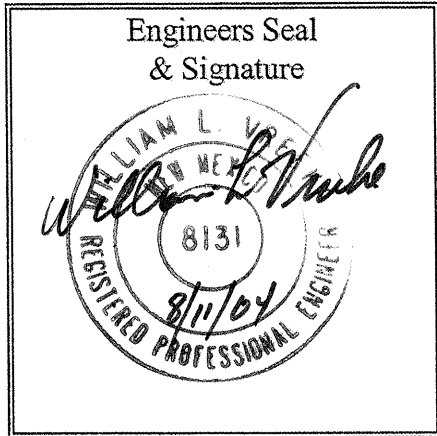

INDEX

SHEET NUMBER	DESCRIPTION
1	COVER SHEET
2	SAN MATEO BLVD. DEMOLITION PLAN & PROFILE
3	SAN MATEO BLVD. PAVING PLAN & PROFILE
4	TRUMAN ST. PLAN & PROFILE

SURVEYOR'S CERTIFICATION WITH VERIFICATION

I, John L. Miers, NMPS 12447, of the firm Rhombus P.A., INC. (RHOMBUS), hereby certify that the as-built information shown on these drawings was obtained from field construction and surveys performed by me or under my supervision, was added by me or under my supervision, and is true and correct to the best of my knowledge and belief. Jaynes Corporation, RHOMBUS, and I are not responsible for any of the design concepts, calculations, engineering, or intent of the record drawings



John L. Miers, NMPS 12447 DATE 5-24-04

CONSTRUCTION NOTES:

- THE CONTRACTOR SHALL ABIDE BY ALL LOCAL, STATE, AND FEDERAL LAWS, RULES AND REGULATIONS WHICH APPLY TO THE CONSTRUCTION OF THESE IMPROVEMENTS.
- PRIOR TO CONSTRUCTION, CONTRACTOR SHALL EXCAVATE AND VERIFY THE HORIZONTAL AND VERTICAL LOCATIONS OF ALL POTENTIAL OBSTRUCTIONS. SHOULD A CONFLICT EXIST, THE CONTRACTOR SHALL NOTIFY THE ENGINEER OR CONSTRUCTION OBSERVER SO THAT THE CONFLICT CAN BE RESOLVED WITH A MINIMUM AMOUNT OF DELAY.
- ALL ELECTRICAL, TELEPHONE, CABLE TV, GAS AND OTHER UTILITY LINES, CABLES AND APPURTENANCES ENCOUNTERED DURING CONSTRUCTION THAT REQUIRE RELOCATION, SHALL BE COORDINATED WITH THAT UTILITY. THE CONTRACTOR SHALL BE RESPONSIBLE FOR COORDINATION OF ALL NECESSARY UTILITY ADJUSTMENTS. NO ADDITIONAL COMPENSATION WILL BE ALLOWED FOR DELAYS OR INCONVENIENCES CAUSED BY UTILITY COMPANY WORK CREWS. THE CONTRACTOR MAY BE REQUIRED TO RESCHEDULE HIS ACTIVITIES TO ALLOW UTILITY CREWS TO PERFORM THEIR REQUIRED WORK.
- DISPOSAL SITE FOR ALL EXCESS EXCAVATION MATERIAL, AND UNSUITABLE MATERIAL SHALL BE OBTAINED BY THE CONTRACTOR IN COMPLIANCE WITH APPLICABLE ENVIRONMENTAL REGULATIONS AND APPROVED BY THE CONSTRUCTION OBSERVER. ALL COSTS INCURRED IN OBTAINING A DISPOSAL SITE AND HAUL THERETO SHALL BE CONSIDERED INCIDENTAL TO THE PROJECT AND NO SEPARATE MEASUREMENT OR PAYMENT SHALL BE MADE.
- THE CONTRACTOR IS RESPONSIBLE FOR PROTECTING THE EXISTING UTILITY LINES WITHIN THE CONSTRUCTION AREA. ANY DAMAGE TO EXISTING FACILITIES CAUSED BY CONSTRUCTION ACTIVITY SHALL BE REPAIRED OR REPLACED AT THE CONTRACTOR'S EXPENSE AND APPROVED BY THE CONSTRUCTION OBSERVER.
- CONSTRUCTION ACTIVITY SHALL BE LIMITED TO THE PROPERTY AND/OR PROJECT LIMITS. ANY DAMAGE TO ADJACENT PROPERTIES RESULTING FROM THE CONSTRUCTION PROCESS IS THE RESPONSIBILITY OF THE CONTRACTOR. ANY COSTS INCURRED FOR REPAIRS SHALL BE THE COST OF THE CONTRACTOR.
- OVERNIGHT PARKING OF CONSTRUCTION EQUIPMENT SHALL NOT OBSTRUCT DRIVEWAYS OR DESIGNATED TRAFFIC LANES. THE CONTRACTOR SHALL NOT STORE ANY EQUIPMENT OR MATERIAL WITHIN THE PUBLIC RIGHT-OF-WAY.
- THE CONTRACTOR SHALL OBTAIN ALL THE NECESSARY PERMITS FOR THE PROJECT PRIOR TO COMMENCING CONSTRUCTION (I.E. BARRICADING, SURFACE DISTURBANCE)
- THE CONTRACTOR SHALL BE RESPONSIBLE TO REPLACE AT HIS EXPENSE ANY AND ALL PROPERTY CORNERS DESTROYED DURING CONSTRUCTION. ALL PROPERTY CORNERS MUST BE RESET BY A REGISTERED LAND SURVEYOR.
- ALL PERMANENT PAVEMENT MARKING AND TRAFFIC SIGNING SHALL BE FURNISHED BY THE CONTRACTOR PER PLAN.
- THE CONTRACTOR SHALL FOLLOW THE CONSTRUCTION TRAFFIC CONTROL AND SIGNING PLAN PROVIDED HEREIN. THE CONTRACTOR SHALL COORDINATE WITH THE CITY OF ALBUQUERQUE, TRAFFIC ENGINEERING DEPARTMENT, PRIOR TO BEGINNING ANY CONSTRUCTION WORK ON OR ADJACENT TO EXISTING STREETS.
- ALL BARRICADES AND CONSTRUCTION SIGNING SHALL CONFORM TO APPLICABLE SECTIONS OF THE "MANUAL OF UNIFORM TRAFFIC CONTROL DEVICES" (MUTCD), U.S. DEPARTMENT OF TRANSPORTATION, LATEST EDITION.
- THE CONTRACTOR SHALL MAINTAIN ALL CONSTRUCTION BARRICADES AND SIGNING AT ALL TIMES. THE CONTRACTOR SHALL VERIFY THE PROPER LOCATION OF ALL BARRICADING AT THE END AND BEGINNING OF EACH DAY.
- ALL SAWCUT PAVEMENT SHALL HAVE A UNIFORM EDGE AND BE SPRAYED WITH TACK.
- WHEN ABUTTING NEW CURB AND GUTTER TO EXISTING PAVEMENT, A 1' WIDE SECTION OF EXISTING PAVEMENT ADJACENT TO THE CURB AND GUTTER SHALL BE SAWCUT, REMOVED, AND REPLACED AS PER THE STANDARD SPECIFICATIONS.
- THE CONTRACTOR SHALL ASSUME RESPONSIBILITY FOR ANY DAMAGE TO EXISTING PAVEMENTS, PAVEMENT MARKINGS, CURB & GUTTER, DRIVE PADS, WHEELCHAIR RAMPS, AND SIDEWALK DURING CONSTRUCTION, APART FROM THOSE SECTIONS INDICATED FOR REMOVAL ON THE PLANS AND SHALL REPAIR OR REPLACE PER COA STANDARDS, AT HIS OWN EXPENSE.
- FOR STORM DRAIN CONSTRUCTION, RCP PIPE JOINTS SHALL NOT BE GROUTED PRIOR TO FINAL INSPECTION. FINAL INSPECTION WILL DETERMINE JOINTS TO BE GROUTED FOR FINAL ACCEPTANCE OF THE CONSTRUCTION.
- ALL EXCAVATION, TRENCHING, AND SHORING ACTIVITIES MUST BE CARRIED-OUT IN ACCORDANCE WITH OSHA 29 CFR 1926.650 SUBPART P.

APPROVED AS RECORD DRAWINGS
DESIGN REVIEW SECTION
CITY CONSTRUCTION ENGINEER
DATE: 5/24/04

Bohannon Huston
Courtney I 7800 Jefferson St. NE Albuquerque, NM 87109-4335
ENGINEERING • SPATIAL DATA • ADVANCED TECHNOLOGIES

1 2 3 4 5 6 7 8 9 10 11 12 13 14 15
26 7249.81 0104

REV.	SHEETS	CITY ENGINEER	DATE	USER DEPARTMENT	DATE	USER DEPARTMENT	DATE
ENGINEERS STAMP & SIGNATURE		APPROVALS	ENGINEER	DATE	*****		
		DRC Chairman	<u>[Signature]</u>	<u>12-23-03</u>	APPROVED FOR CONSTRUCTION <u>[Signature]</u> City Engineer Date <u>4-28-04</u>		
		Transportation	<u>[Signature]</u>	<u>12/17/03</u>			
		Water/Wastewater	<u>[Signature]</u>	<u>12/17/03</u>			
		Hydrology	<u>[Signature]</u>	<u>12/17/03</u>			
		Parks	<u>[Signature]</u>	<u>12-23-03</u>			
		Const. Coord.	<u>[Signature]</u>	<u>12-23-03</u>			
City Project No.		724981			Sheet 1 Of 4		

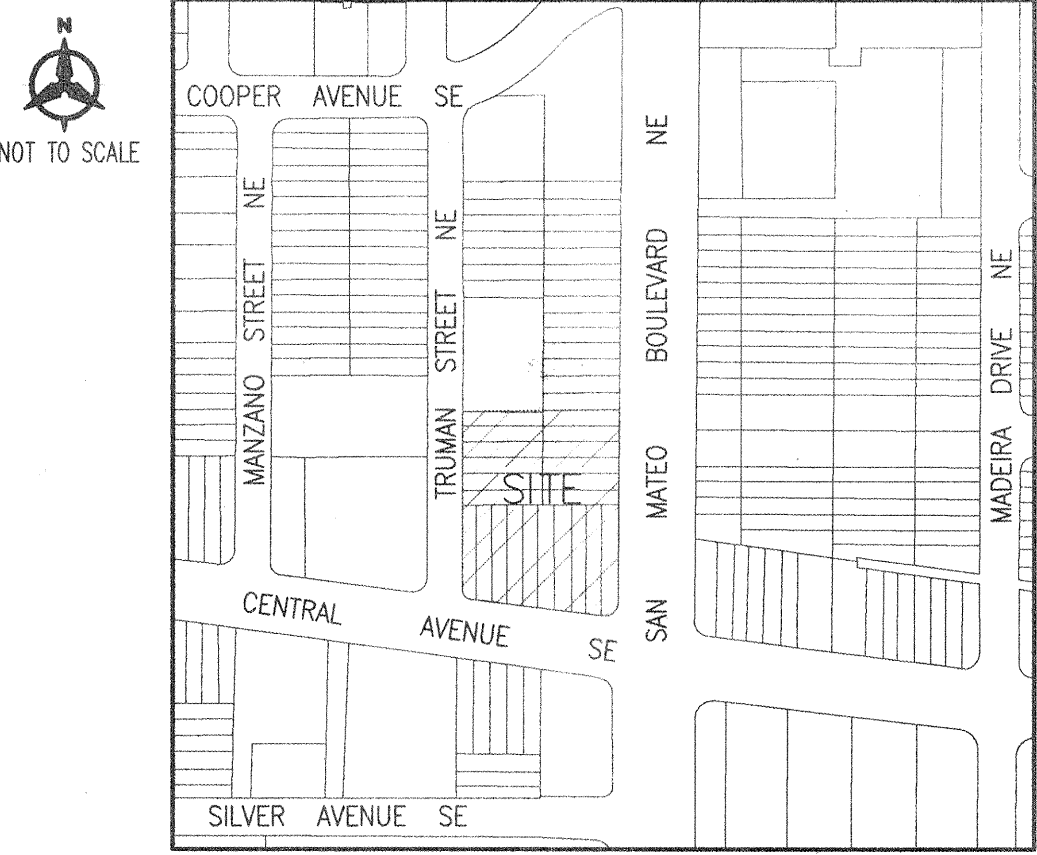

VICINITY MAP
ZONE ATLAS INDEX MAP No. K-17-Z

NOTICE TO CONTRACTORS

- AN EXCAVATION/CONSTRUCTION PERMIT WILL BE REQUIRED BEFORE BEGINNING ANY WORK WITHIN THE CITY RIGHT-OF-WAY.
- ALL WORK DETAILED ON THESE PLANS TO BE PERFORMED UNDER CONTRACT SHALL, EXCEPT AS OTHERWISE STATED OR PROVIDED FOR HEREON, BE CONSTRUCTED IN ACCORDANCE WITH THE CITY OF ALBUQUERQUE STANDARD SPECIFICATIONS FOR PUBLIC WORKS CONSTRUCTION, 1986 EDITION AS REVISED THROUGH UPDATE #7.
- TWO WORKING DAYS PRIOR TO ANY EXCAVATION, THE CONTRACTOR MUST CONTACT NEW MEXICO ONE CALL SYSTEM (260-1990) FOR LOCATION OF EXISTING UTILITIES.
- PRIOR TO CONSTRUCTION, THE CONTRACTOR SHALL EXCAVATE AND VERIFY THE HORIZONTAL AND VERTICAL LOCATIONS OF ALL OBSTRUCTIONS, SHOULD A CONFLICT EXIST. THE CONTRACTOR SHALL NOTIFY THE ENGINEER IMMEDIATELY SO THAT THE CONFLICT CAN BE RESOLVED WITH A MINIMUM AMOUNT OF DELAY.
- FIVE (5) WORKING DAYS PRIOR TO BEGINNING CONSTRUCTION, THE CONTRACTOR SHALL SUBMIT TO CONSTRUCTION COORDINATION DIVISION A DETAILED CONSTRUCTION SCHEDULED. TWO (2) WORKING DAYS PRIOR TO THE START OF CONSTRUCTION, THE CONTRACTOR SHALL OBTAIN A BARRICADING PERMIT FROM THE CONSTRUCTION COORDINATION DIVISION. CONTRACTOR SHALL NOTIFY THE CONSTRUCTION COORDINATION ENGINEER (924-3400) PRIOR TO OCCUPYING AN INTERSECTION. REFER TO SECTION 19 OF THE GENERAL CONDITIONS OF THE STANDARD SPECIFICATIONS.
- ALL WORK EFFECTING ARTERIAL ROADWAYS REQUIRES TWENTY-FOUR HOUR CONSTRUCTION.
- ALL STREET STRIPING ALTERED OR DESTROYED SHALL BE REPLACED WITH PLASTIC REFLECTORIZED PAVEMENT MARKING BY CONTRACTOR TO THE SAME LOCATION AS WAS EXISTING, OR AS INDICATED BY THIS PLAN SET.
- CONTRACTOR SHALL NOTIFY THE ENGINEER NOT LESS THAN SEVEN (7) DAYS PRIOR TO STARTING WORK IN ORDER THAT THE CITY SURVEYOR MAY TAKE NECESSARY MEASURES TO INSURE THE PRESERVATION OF SURVEY MONUMENTS. CONTRACTOR SHALL NOT DISTURB PERMANENT SURVEY MONUMENTS WITHOUT THE CONSENT OF THE CITY SURVEYOR AND SHALL NOTIFY THE CITY SURVEYOR AND BEAR THE EXPENSE OF REPLACING ANY THAT MAY BE DISTURBED WITHOUT PERMISSION. REPLACEMENT SHALL BE DONE ONLY BY THE CITY SURVEYOR. WHEN A CHANGE IS MADE IN THE FINISHED ELEVATIONS OF THE PAVEMENT OF ANY ROADWAY IN WHICH A PERMANENT SURVEY MONUMENT IS LOCATED, CONTRACTOR SHALL, AT HIS OWN EXPENSE, ADJUST THE MONUMENT COVER TO THE NEW GRADE UNLESS OTHERWISE SPECIFIED. REFER TO SECTION 4.4 OF THE GENERAL CONDITIONS OF THE STANDARD SPECIFICATIONS.
- CONTRACTOR SHALL RECORD DATA ON ALL UTILITY LINES AND ACCESSORIES AS REQUIRED BY THE CITY OF ALBUQUERQUE FOR THE PREPARATION OF "AS CONSTRUCTED" DRAWINGS. CONTRACTOR SHALL NOT COVER UTILITY LINES AND ACCESSORIES UNTIL ALL DATA HAS BEEN RECORDED.
- CONTRACTOR SHALL MAINTAIN A GRAFFITI-FREE WORK SITE. CONTRACTOR SHALL PROMPTLY REMOVE ANY GRAFFITI FROM ALL EQUIPMENT, WHETHER PERMANENT OR TEMPORARY.
- CONTRACTOR SHALL COORDINATE WITH THE CITY OF ALBUQUERQUE WATER UTILITY DIVISION (857-8200) SEVEN (7) WORKING DAYS IN ADVANCE OF ANY WORK THAT MAY AFFECT EXISTING PUBLIC WATER OR SEWER UTILITIES. EXISTING VALVES TO BE OPERATED BY CITY PERSONNEL ONLY. CONTRACTOR SHALL CONTACT THE WATER SYSTEMS DIVISION SEVEN (7) WORKING DAYS PRIOR TO NEEDING VALVES TURNED ON OR OFF.

THE FOLLOWING NOTES ALSO APPLY WHEN CHECKED

- ☒ ALL UTILITIES AND UTILITY SERVICE LINES SHALL BE INSTALLED PRIOR TO PAVING.
- ☒ BACKFILL COMPACTION SHALL BE ACCORDING TO SPECIFIED STREET USE.
- ☒ SIDEWALKS AND WHEELCHAIR RAMPS WITHIN THE CURB RETURNS SHALL BE CONSTRUCTED WHEREVER A NEW CURB RETURN IS CONSTRUCTED.
- ☒ IF CURB IS DEPRESSIONED FOR A DRIVEPAD, THE DRIVEPAD SHALL BE CONSTRUCTED PRIOR TO ACCEPTANCE OF CURB AND GUTTER.
- ☒ ALL STORM DRAINAGE FACILITIES SHALL BE COMPLETED PRIOR TO FINAL ACCEPTANCE.
- ☒ THE REQUESTOR OR DEVELOPER SHALL BE RESPONSIBLE FOR REPAIR OR REPLACEMENT OF ALL CURB AND GUTTER OR SIDEWALK DAMAGED AFTER APPROVAL BY THE CITY ENGINEER OF WORK COMPLETED BY THE CONTRACTOR.

SCANNED BY
MESA REPRO

UTILITY NOTES

1. THIS CONTRACTOR SHALL BE RESPONSIBLE FOR THE COMPLETE INSTALLATION OF ALL WORK RELATED TO MECHANICAL UTILITIES AS SHOWN ON THIS PLAN INCLUDING: TRENCHING, BACKFILL, SUPPORTS, CLEANOUT PADS, SERVICE STOPS AND BOXES, SERVICE LINES, TESTING, CLEANING, AND STERILIZING. ANY WORK NOT ACCEPTED BY THE ARCHITECT OR ENGINEER DUE TO IMPROPER WORKMANSHIP OR LACK OF PROPER COORDINATION SHALL BE REMOVED AND CORRECTLY INSTALLED AT THE CONTRACTOR'S EXPENSE, AS DIRECTED.
2. MINIMUM DEPTHS OF COVER SHALL BE: 36" FOR WATERLINES AND 48" FOR SEWER, EXCEPT AT BUILDING CONNECTION.
3. ALL WORK DETAILED ON THESE PLANS TO BE PERFORMED UNDER CONTRACT SHALL, EXCEPT AS OTHERWISE STATED OR PROVIDED OF HEREON, BE CONSTRUCTED IN ACCORDANCE WITH THE IAPMO UNIFORM PLUMBING CODE, LATEST EDITION.
4. UTILITY LINES SHALL BE INSTALLED PRIOR TO PAVEMENT, CURB AND GUTTER, AND/OR SIDEWALK, AS APPLICABLE.
5. ROUGH GRADING OF SITE (+0.5') SHALL BE COMPLETED PRIOR TO INSTALLATION OF UTILITY LINES.
6. CONTRACTOR WILL BE RESPONSIBLE FOR CONNECTIONS TO BUILDING DRAIN LINES AND ALL NECESSARY FITTINGS.

7. ALL VALVES SHALL BE ANCHORED PER COA STANDARD DWG. 2333.
8. FIRE LINES SHALL USE PIPE MATERIALS UNDERWRITERS LABORATORIES LISTED AND APPROVED FOR FIRE SERVICE.
9. CONTRACTOR SHALL BE RESPONSIBLE FOR ALL WATER METER, FIRE LINE, AND SEWER HOOKUP FEES FOR INSTALLATIONS. OWNER SHALL BE RESPONSIBLE FOR UTILITY EXPANSION CHARGES, PRORATA AND OTHER SPECIAL ASSESSMENTS.
10. CONTRACTOR SHALL VERIFY INVERTS AND LOCATIONS OF EXISTING WATER/SAS LINES PRIOR TO BEGINNING WORK. ALL CONFLICTS SHALL BE BROUGHT TO ATTENTION OF THE ENGINEER AND RESOLVED PRIOR TO BEGINNING WORK.
11. PROVIDE BOLLARDS TO PROTECT METER, AS PER PNM & UPC REQUIREMENTS.

SIGNING AND TRAFFIC CONTROL NOTES:

1. ALL LANE CLOSURES IN SAN MATEO BLVD. OR CENTRAL AVE. SHALL BE ASSESSED ROAD USAGE FEES OF \$0.01 PER SQUARE FOOT OF BARRICADED AREA PER DAY.
2. CONTRACTOR SHALL PERFORM AS MUCH AS POSSIBLE BEHIND THE EXISTING CURB PRIOR TO AFFECTING TRAFFIC ON SAN MATEO BLVD. OR CENTRAL AVE.
3. ONLY SINGLE LANE CLOSURES IN SAN MATEO BLVD. WILL BE ALLOWED BETWEEN 6:00 A.M. AND 8:00 P.M. DOUBLE LANE CLOSURES WILL ONLY BE ALLOWED ON SAN MATEO BLVD. BETWEEN THE HOURS FROM 8:00 P.M. TO 6:00 A.M.
4. WHEN CONTRACTOR HAS ANY LANE CLOSED ON SAN MATEO BLVD. OR CENTRAL AVE. CONTRACTOR MUST WORK, AT A MINIMUM BETWEEN 7:00 A.M. AND 10:00 P.M. DAILY.
5. APPROVAL OF REQUESTS FOR EXCAVATION AND/OR BARRICADE PERMITS ON EITHER SAN MATEO BLVD. OR CENTRAL AVE. MAY BE DENIED OR DELAYED DUE TO CONFLICTS WITH OTHER PROJECTS IN THE VICINITY, OR OTHER TRAFFIC CONCERNS.

SAN MATEO BOULEVARD

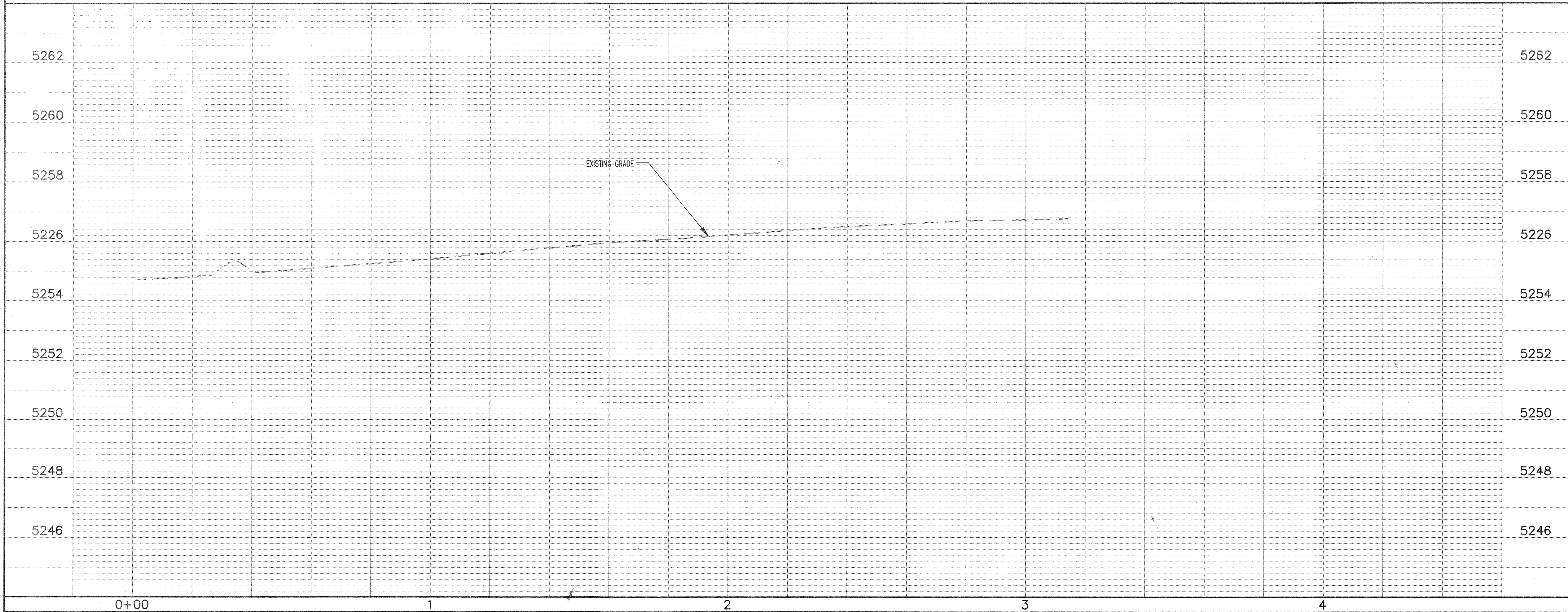

SCALE: 1"=20' (HORIZ.)
1"=2' (VERT.)

NOTES

1. THE CONTRACTOR SHALL FIELD VERIFY ALL EXISTING UTILITY LOCATIONS AND NOTIFY THE ENGINEER IMMEDIATELY OF ANY DISCREPANCIES.
2. CONTRACTOR IS RESPONSIBLE FOR REPAIR AND/OR REPLACEMENT OF ALL UTILITY CONDUITS AND EXISTING LINES.
3. ANY ADDITIONAL GRADING REQUIRED TO MATCH PROPOSED STREET GRADES SHALL BE INCIDENTAL TO PAVING ITEMS.
4. CONTRACTOR SHALL PROVIDE THE INSPECTORS, (CITY OR PRIVATE) WITH THE PROPOSED HYDROSTATIC TESTING PLAN. THE PLAN MUST BE APPROVED BEFORE TESTING OPERATIONS BEGIN.
5. CONTRACTOR SHALL PARK EQUIPMENT AND VEHICLES AS NOT TO INTERFERE WITH NORMAL ACTIVITIES OF RESIDENTS OR OTHER CONTRACTOR'S ON SITE.
6. ANY DAMAGE TO THE EXISTING FACILITIES (CURB & GUTTER, PAVEMENT, CONDUITS, LANDSCAPING, UTILITY LINES, ETC.) DURING CONSTRUCTION SHALL BE REPLACED AT THE CONTRACTOR'S EXPENSE.
7. REMOVAL OF THE EXISTING CURB & GUTTER SHALL BE AS PER COA STD. DWG. 2415A. (SAW CUT ONLY)
8. REMOVE EXISTING MEDIAN CURB TO NEAREST CONTROL JOINT EITHER SIDE OF UTILITY TRENCH.

SURVEYOR'S CERTIFICATION WITH VERIFICATION

I, John L. Miers, NMPS 12447, of the firm Rhombus P.A., INC. (RHOMBUS), hereby certify that the as-built information shown on these drawings was obtained from field construction and surveys performed by me or under my supervision, was added by me or under my supervision, and is true and correct to the best of my knowledge and belief. Jaynes Corporation, RHOMBUS, and I are not responsible for any of the design concepts, calculations, engineering, or intent of the record drawings.

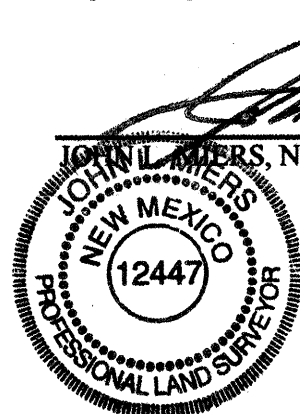

LEGEND

- DEMOLITION OF ASPHALT
- DEMOLITION OF SIDEWALK

26 7249-81 0204

Bohannon & Huston
Courtyard | 7500 Jefferson St. NE Albuquerque, NM 87109-4335
ENGINEERING & SPATIAL DATA & ADVANCED TECHNOLOGIES



CITY OF ALBUQUERQUE
PUBLIC WORKS DEPARTMENT

INFRASTRUCTURE IMPROVEMENTS AT CENTRAL AND SAN MATEO
DEMOLITION PLAN & PROFILE
SAN MATEO BOULEVARD

Design Review Committee	City Engineer Approval	Mo./Day/Yr.	Mo./Day/Yr.
DESIGN REVIEW COMMITTEE	CITY ENGINEER		

City Project No. 724981 Zone Map No. K-17-Z Sheet 2 of 4

SCANNED BY
MESA REPRO

NOTE:
PAVEMENT SECTIONS
SHOWN ON THIS SHEET
ARE BASED ON
R-VALUE OF 50.

PAVEMENT SECTIONS MATCHES
THAT USED FOR STATE OF NEW
MEXICO N.M.P. U-034-(16) &
U-034-(18).

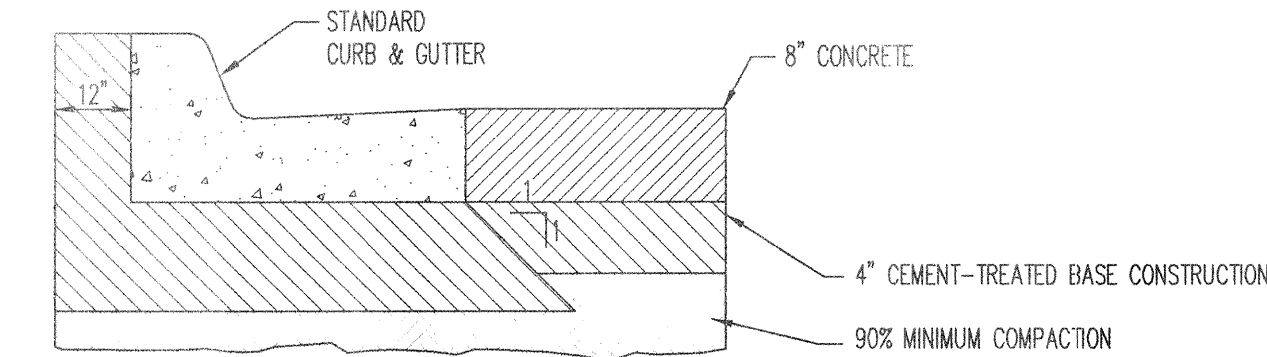

PAVEMENT SECTION FOR SAN MATEO BLVD.
NOT TO SCALE

SAN MATEO BOULEVARD

SURVEYOR'S CERTIFICATION WITH VERIFICATION

I, John L. Miers, NMPS 12447, of the firm Rhombus P.A., INC. (RHOMBUS), hereby certify that the as-built information shown on these drawings was obtained from field construction and surveys performed by me or under my supervision, and is true and correct to the best of my knowledge and belief. Jaynes Corporation, RHOMBUS, and I are not responsible for any of the design concepts, calculations, engineering, or intent of the record drawings



JOHN L. MIERS, NMPS 12447

DATE

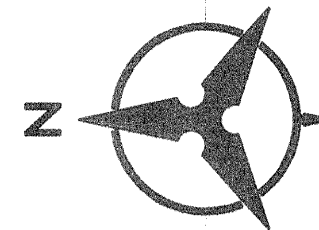

SCALE 1"=20'

CENTRAL AVE.

NOTES

1. THE CONTRACTOR SHALL FIELD VERIFY ALL EXISTING UTILITY LOCATIONS AND NOTIFY THE ENGINEER IMMEDIATELY OF ANY DISCREPANCIES.
2. CONTRACTOR IS RESPONSIBLE FOR REPAIR AND/OR REPLACEMENT OF ALL UTILITY CONDUITS AND EXISTING LINES.
3. ANY ADDITIONAL GRADING REQUIRED TO MATCH PROPOSED STREET GRADES SHALL BE INCIDENTAL TO PAVING ITEMS.
4. CONTRACTOR SHALL PROVIDE THE INSPECTORS, (CITY OR PRIVATE) WITH THE PROPOSED HYDROSTATIC TESTING PLAN. THE PLAN MUST BE APPROVED BEFORE TESTING OPERATIONS BEGIN.
5. CONTRACTOR SHALL PARK EQUIPMENT AND VEHICLES AS NOT TO INTERFERE WITH NORMAL ACTIVITIES OF RESIDENTS OR OTHER CONTRACTOR'S ON SITE.
6. ANY DAMAGE TO THE EXISTING FACILITIES (CURB & GUTTER, PAVEMENT, CONDUITS, LANDSCAPING, UTILITY LINES, ETC.) DURING CONSTRUCTION SHALL BE REPLACED AT THE CONTRACTOR'S EXPENSE.
7. REMOVAL OF THE EXISTING CURB & GUTTER SHALL BE AS PER COA STD. DWG. 2415A. (SAW CUT ONLY)
8. REMOVE EXISTING MEDIAN CURB TO NEAREST CONTROL JOINT EITHER SIDE OF UTILITY TRENCH.

RESTRAINING JOINT TABLE:

1. ALL MECHANICAL JOINTS SHALL BE RESTRAINED AT THE FITTING.
2. THE CONTRACTOR SHALL PROVIDE A MINIMUM PIPE LENGTH OF 20 LF IN EACH DIRECTION OF THE MAIN LINE FROM ALL TEES. ALL PIPE JOINTS WITHIN 20 LF ALONG THE MAIN LINE OF TEE SHALL BE RESTRAINED AT THE CONTRACTOR'S EXPENSE.
3. THE CONTRACTOR SHALL RESTRAIN ALL PIPE JOINTS IN THE SPECIFIED DISTANCE LISTED IN THE TABLE. (SEE NOTE 2 ABOVE)
4. THE CONTRACTOR SHALL RESTRAIN ALL FIRE HYDRANT LINES AND FIRE SERVICE LINES (6" & 8" STUB-OUTS TO LOTS) FROM THE TEE ON THE MAIN TO THE FIRE HYDRANT FLANGE OR CAP.

MECHANICAL JOINTS	LENGTH OF RESTRAINED JOINTS			
	(6")	(8")	(10")	(12")
11.25" H. BEND	2'	3'	3'	3'
22.50" H. BEND	4'	5'	6'	7'
45" H. BEND	8'	11'	13'	16'
90" H. BEND	20'	26'	31'	39'
GATE VALVE	55'	72'	86'	102'
BUTTERFLY VALVE	---	---	---	---
* REDUCER (6")	---	30'	53'	74'
CAPS	45'	59'	72'	85'

* REDUCER- ASSUMES SMALLER PIPE IS 6" LARGER PIPE IS AS SHOWN IN THE TABLE.

KEYED NOTES:

- [1] MATCH TO EXISTING CURB.
- [2] SIDEWALK CULVERT

* NOT IN USE THIS SHEET

LEGEND

- NEW ASPHALT CONCRETE PAVEMENT
- NEW CONCRETE SIDEWALK

2+16.51 AS-BUILT STATION
54.32 AS-BUILT ELEV

22 7249.81 0304

Bohannon & Huston

Courtyard I 7500 Jefferson St. NE Albuquerque, NM 87109-4335
ENGINEERING & SPATIAL DATA & ADVANCED TECHNOLOGIES



**CITY OF ALBUQUERQUE
PUBLIC WORKS DEPARTMENT**

**INFRASTRUCTURE IMPROVEMENTS AT CENTRAL AND SAN MATEO
PAVING PLAN & PROFILE
SAN MATEO BOULEVARD**

Design Review Committee	City Engineer Approval	Mo./Day/Yr.	Mo./Day/Yr.
APPROVED DESIGN REVIEW COMMITTEE	APPROVED CITY ENGINEER		

City Project No.	Zone Map No.	Sheet	Of
724981	K-17-Z	3	4

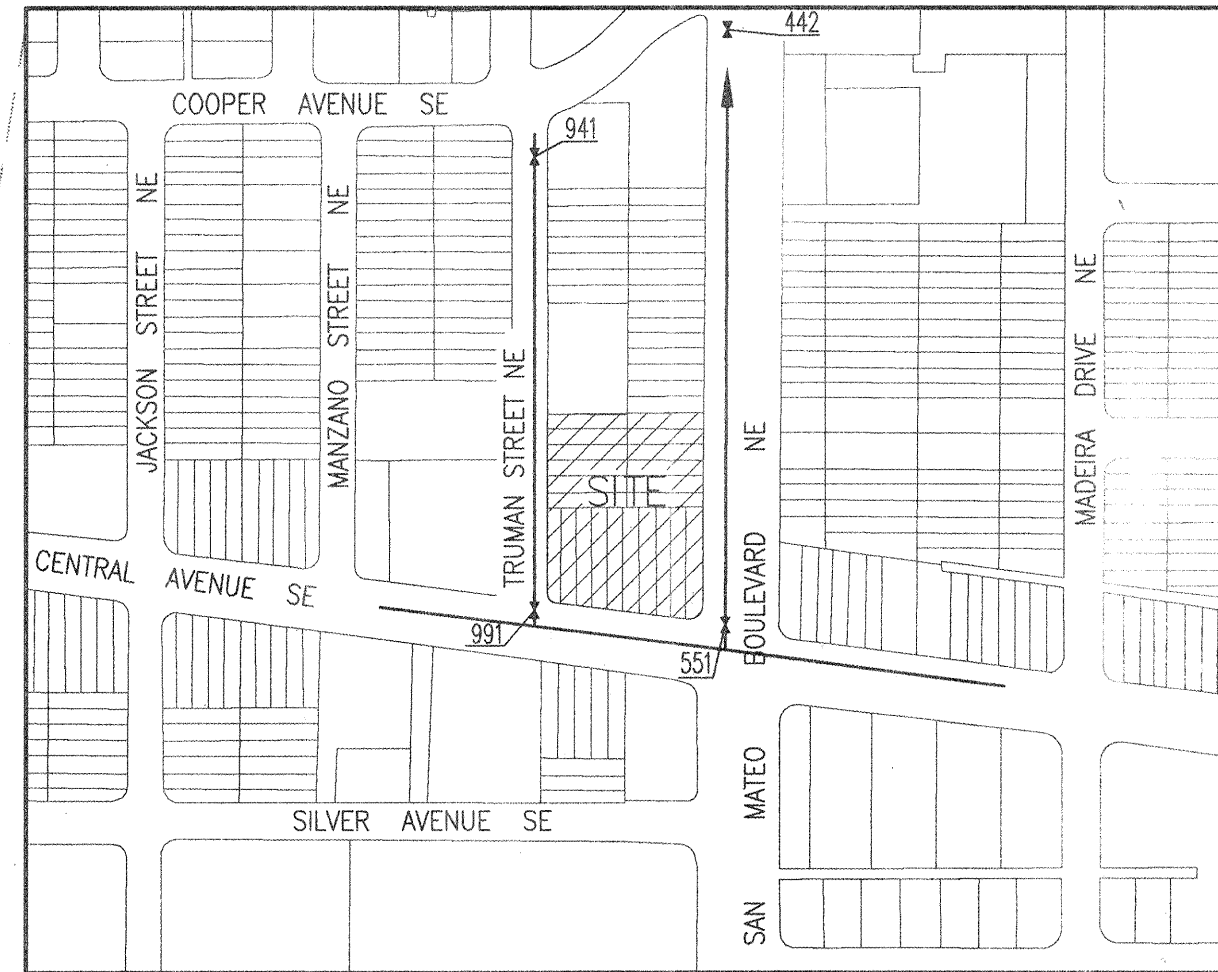

1. CONTRACTOR SHALL FIELD VERIFY ALL EXISTING UTILITY LOCATIONS AND NOTIFY THE ENGINEER IMMEDIATELY OF ANY DISCREPANCIES.
2. CONTRACTOR IS RESPONSIBLE FOR REPAIR AND/OR REPLACEMENT OF ALL UTILITY CONDUITS AND EXISTING LINES.
3. ANY ADDITIONAL GRADING REQUIRED TO MATCH PROPOSED STREET GRADES SHALL BE INCIDENTAL TO PAVING ITEMS.
4. CONTRACTOR SHALL PROVIDE THE INSPECTORS, (CITY OR PRIVATE) WITH THE PROPOSED HYDROSTATIC TESTING PLAN. THE PLAN MUST BE APPROVED BEFORE TESTING OPERATIONS BEGIN.
5. CONTRACTOR SHALL PARK EQUIPMENT AND VEHICLES AS NOT TO INTERFERE WITH NORMAL ACTIVITIES OF RESIDENTS OR OTHER CONTRACTOR'S ON SITE.
6. ANY DAMAGE TO THE EXISTING FACILITIES (CURB & GUTTER, PAVEMENT, CONDUITS, LANDSCAPING, UTILITY LINES, ETC.) DURING CONSTRUCTION SHALL BE REPLACED AT THE CONTRACTOR'S EXPENSE.
7. REMOVAL OF THE EXISTING CURB & GUTTER SHALL BE AS PER COA STD. DWG. 2415A. (SAW CUT ONLY)
8. REMOVE EXISTING MEDIAN CURB TO NEAREST CONTROL JOINT EITHER SIDE OF UTILITY TRENCH.

I, John L. Miers, NMPS 12447, of the firm Rhombus P.A., INC. (RHOMBUS), hereby certify that the as-built information shown on these drawings was obtained from field construction and surveys performed by me or under my supervision, was added by me or under my supervision, and is true and correct to the best of my knowledge and belief. Jaynes Corporation, RHOMBUS, and I are not responsible for any of the design concepts, calculations, engineering, or intent of the record drawings

JOHN L. MIERS, NMPS 12447

4/24/04
DATE

 **Bohannon**  **Huston** INC.

100 Jefferson St. NE Albuquerque, NM 87109-4335

ENGINEERING ■ SPATIAL DATA ■ ADVANCED TECHNOLOGIES

CITY OF ALBUQUERQUE
PUBLIC WORKS DEPARTMENT

INFRASTRUCTURE IMPROVEMENTS AT CEN PAVING PLAN & PRO TRUMAN AVENUE

City Project No.	Zone Map No.
------------------	--------------

724981 | K-17-

PUL JOB NO. 030324

BRI JOB NO. 030324

AS-BUILT INFORMATION	DATE <i>5/1/04</i>
CONTRACTOR <i>Taylor's Corp</i>	DATE <i>5/1/04</i>
WORK	DATE <i>5/1/04</i>
INSPECTOR'S	DATE <i>5/1/04</i>
ACCEPTANCE BY <i>BHI</i>	DATE <i>5/1/04</i>
VERIFICATION BY <i>CT</i>	DATE <i>5/1/04</i>
TRAININGS	DATE <i>5/1/04</i>
CORRECTED BY <i>Taylor's Corp</i>	DATE <i>5/1/04</i>
MICRO-FILM INFORMATION	DATE
RECORDED BY	DATE
NO.	

[illegible]

BENCH MARK	ACS Brass Cap stamped "6-1184 ACS"
Geographic Position (NAD 1927)	
N.M. State Plane Coordinates (Central Zone)	
X= 395,545.00 Y= 1,483,892.49	
Ground-to-Grid Factor= 0.99966021	
$\alpha_s = -0011^{\circ}14''$	
NAVD 29 Elevation = 5247.329	

[illegible]

ENGINEER'S SEAL

[Signature]

GLASSBORO, NEW JERSEY 07033
14771
REGISTERED PROFESSIONAL ENGINEER
NEW JERSEY
12-17-83

[illegible][illegible]

	DATE:
	DATE:
	DATE:

[illegible]

MARK
ONS
N3

REVISION DESIGN

RE [

GSB
KJW
BJS

Date
By:
y:
By:

					No. [
--	--	--	--	--	-------

				Z				D	D	C
EROLIE										

ERQUE MENT

RAL AND SAN MATEO
ILE

Mo./Day/Yr.	Mo./Day/Yr.

Sheet	Of
4	4

OCT. 03

10. *Journal of the American Medical Association*, 2000; 284: 2689-2695.

5262	<p>All waterlines were constructed of C-900 pipe. All sanitary sewer mains were constructed of SDR-35. All sanitary sewer services were constructed of SDR-26.</p>														5262
5260															5260
5258															5258
5226															5226
5254															5254
5252															5252
5250															5250
5248															5248
5246															5246
<div style="display: flex; justify-content: space-between;"> <div> <p>1 2 3 4 5 6 7 8 9 10 11 12 13 14</p> <p>26 7249.81 040</p> </div> <div> <p>5+00</p> </div> </div>															

SCALE: 1"=20' (HORIZ.)
1"=2' (VERT.)

P:\030324\cdp\pnp\030324_PAVE-PNP02.dwg
December 17, 2003 - 11:53am