

2 3 4 5 6 7 8 9 10 11 12 13 14 15  
30-7314 JTF 2012

SCANNED BY  
PLANNING

# CONSTRUCTION PLANS FOR GOODWILL INDUSTRIES DECELERATION LANE

PAVING AND UTILITY IMPROVEMENTS

CITY OF ALBUQUERQUE  
NEW MEXICO  
MARCH 2004

## INDEX TO DRAWINGS

1. TITLE SHEET
2. GRADING AND DRAINAGE PLAN
3. DECELERATION LANE IMPROVEMENT

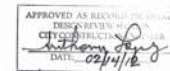

\* Field verified ON 02-14-2012  
NOT AS-BUILT DRAWINGS

## TRAFFIC CONTROL PLAN

USE COA TRAFFIC CONTROL PLAN.  
USE TYPICAL RIGHT LANE CLOSURE  
FOR CONSTRUCTION.

For Information Only



VICINITY MAP ZONE ATLAS F-18-Z

N.T.S. NOTICE TO CONTRACTORS SCALE NONE

1. ALL WORK DETAILED ON THESE PLANS TO BE PERFORMED UNDER CONTRACT SHALL EXCEPT AS OTHERWISE STATED OR PROVIDED FOR HEREON, BE CONSTRUCTED IN ACCORDANCE WITH THE CITY OF ALBUQUERQUE STANDARD SPECIFICATIONS FOR PUBLIC WORKS CONSTRUCTION, 1988 EDITION (UPDATE #7)

2. TWO WORKING DAYS PRIOR TO ANY EXCAVATION, THE CONTRACTOR MUST CONTACT NEW MEXICO ONE CALL SYSTEM (260-1990) FOR LOCATION OF EXISTING UTILITIES.

3. ANY WORK AFFECTING AN ARTERIAL ROADWAY REQUIRES 24-HOUR CONSTRUCTION.

4. PRIOR TO CONSTRUCTION, THE CONTRACTOR SHALL EXAMINE AND VERIFY THE HORIZONTAL AND VERTICAL LOCATIONS OF ALL OBSTRUCTIONS. SHOULD A CONFLICT EXIST, THE CONTRACTOR SHALL NOTIFY THE ENGINEER OR SURVEYOR IMMEDIATELY SO THAT THE CONFLICT CAN BE RESOLVED WITH A MINIMUM AMOUNT OF DELAY.

5. FIVE (5) WORKING DAYS PRIOR TO BEGINNING OF CONSTRUCTION, THE CONTRACTOR SHALL SUBMIT TO CONSTRUCTION COORDINATION DIVISION A DETAILED CONSTRUCTION SCHEDULE. TWO (2) WORKING DAYS PRIOR TO CONSTRUCTION, THE CONTRACTOR SHALL OBTAIN A BARRICADE PERMIT FROM THE CONST. COORDINATION DIVISION. CONTRACTOR SHALL NOTIFY BARRICADE ENGINEER (924-3400) PRIOR TO OCCUPYING AN INTERSECTION. REFER TO STANDARD SPECIFICATIONS.

6. ALL STREET STRIPING ALTERED OR DESTROYED SHALL BE REPLACED WITH PLASTIC REFLECTORIZED PAVEMENT MARKINGS BY THE CONTRACTOR TO LOCATION AS EXISTING OR AS INDICATED BY THIS PLAN SET.

7. CONTRACTOR SHALL NOTIFY THE ENGINEER NOT LESS THAN SEVEN (7) DAYS PRIOR TO STARTING WORK IN ORDER THAT THE ENGINEER MAY TAKE NECESSARY MEASURES TO INSURE THE PRESERVATION OF SURVEY MONUMENTS. CONTRACTOR SHALL NOT DISTURB PERMANENT SURVEY MONUMENTS WITHOUT THE CONSENT OF THE ENGINEER AND SHALL NOTIFY THE ENGINEER AND BEAR THE EXPENSE OF REPLACING ANY THAT MAY BE DISTURBED WITHOUT PERMISSION. REPLACEMENT SHALL BE DONE ONLY BY THE CITY SURVEYOR. WHEN A CHANGE IS MADE IN THE FIELD ELEVATIONS OF THE PAVEMENT ON ANY ROADWAY IN WHICH A PERMANENT SURVEY MONUMENT IS LOCATED, CONTRACTOR SHALL, AT HIS OWN EXPENSE, ADJUST THE MONUMENT COVER TO THE NEW GRADE UNLESS OTHERWISE SPECIFIED. REFER TO SECTION 4.4 OF THE GENERAL CONDITIONS OF THE STANDARD SPECIFICATIONS. ANY PERMANENT SURVEY MONUMENT LOCATED WITHIN 50' OF THIS PROJECT THAT IS NOT SHOWN ON THE PLAN AND IS DESTROYED DURING CONSTRUCTION WILL BE REPLACED AT THE DESIGNER'S EXPENSE.

8. FOR STORM DRAIN CONSTRUCTION, RCP PIPE JOINTS SHALL NOT BE GROUTED PRIOR TO FINAL INSPECTION. FINAL INSPECTION WILL DETERMINE JOINTS TO BE GROUTED FOR FINAL ACCEPTANCE OF THE CONSTRUCTION.

THE FOLLOWING NOTES ALSO APPLY WHEN CHECKED  
☐ ALL UTILITIES AND UTILITY SERVICE LINES SHALL BE INSTALLED PRIOR TO PAVING.

☒ BACKFILL COMPACTION SHALL BE ACCORDING TO SPECIFIED STREET USE.

☐ TACK COAT REQUIREMENTS SHALL BE DETERMINED BY THE DESIGN ENGINEER.

☐ SIDEWALKS AND WHEELCHAIR RAMPS WITHIN THE CURB RETURN SHALL BE CONSTRUCTED WHEREVER A NEW CURB RETURN IS CONSTRUCTED.

☐ IF CURB IS DEPRESSSED FOR A DRIVEPAD, THE DRIVEPAD SHALL BE CONSTRUCTED PRIOR TO ACCEPTANCE OF CURB AND GUTTER.

☒ ALL STORM DRAINAGE FACILITIES SHALL BE COMPLETED PRIOR TO FINAL ACCEPTANCE.



4616 ANASHEIM AVE., NE  
ALBUQUERQUE, NEW MEXICO 87113  
(505) 999-4570

REV.	SHEETS	CITY ENGINEER	DATE	USER DEPT.	DATE	USER DEPT.	DATE
ENGINEERS STAMP & SIGNATURE		APPROVALS		ENGINEER		DATE	
				DEC Chairman		3/11/04	
				Transportation		3/11/04	
				Water/Wastewater		3/11/04	
				Hydrology		3/11/04	
				C.I.P.		3/11/04	
				Constr. Coord.		4-12-04	
				CITY PROJECT NO.		731481	
				SHEET		1 OF 3	

SCANNED BY  
PLANNING

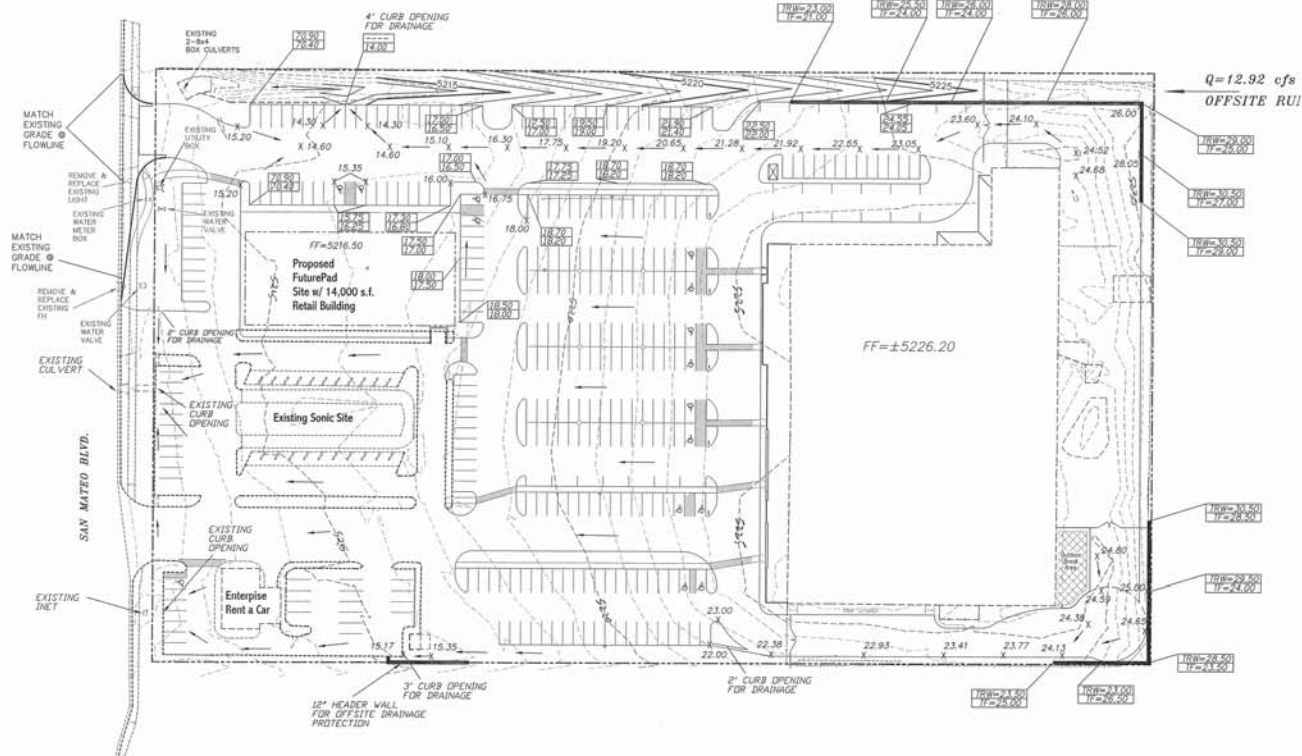

#### LEGEND

	EXISTING S&S MANHOLE
	EXISTING METER
	EXISTING VALVE W/BOX
	EXISTING FIRE HYDRANT
	EXISTING SANITARY SEWER LINE
	EXISTING WATER LINE
	EXISTING CURB & GUTTER
	PROPOSED CURB & GUTTER
	EXISTING CONTOUR (MAJOR)
	EXISTING CONTOUR (MINOR)
	BOUNDARY LINE
	EASEMENT
	LIMITS OF TOP OF EXISTING SLOPE
	PROPOSED SIDEWALK
	PROPOSED GRADE
	TOP OF RETAINING WALL
	TOP OF FOOTING
	PROPOSED SPOT ELEVATION
	EXISTING GRADE
	EXISTING POWER LINES
	EXISTING FENCE

#### GRADING NOTE

THE AREAS WITH SPOT ELEVATION ARE THE AREAS WHERE THE GRADES ARE PROPOSED TO CHANGE. OTHER AREAS WITHOUT THE SPOT ELEVATIONS WILL MATCH THE EXISTING TOP OF ASPHALT ELEVATION.

#### GENERAL NOTES:

1. ADD 5200 TO SPOT ELEVATIONS TO SHOW TRUE ELEVATION.
2. CONTOUR INTERVAL IS ONE (1) FOOT.
3. ELEVATIONS ARE BASED ON CITY OF ALBUQUERQUE CONTROL STATION HAVING AN ELEVATION OF 5200.56 FEET ABOVE SEA LEVEL.
4. UTILITIES SHOWN HEREON ARE IN THEIR APPROXIMATE LOCATION BASED ONLY ON ABOVE GROUND EVIDENCE FOUND IN THE FIELD AND AS-BUILT INFORMATION PROVIDED BY THE CLIENT. UTILITIES SHOWN HEREON, WHETHER INDICATED AS ABANDONED OR NOT, SHALL BE VERIFIED BY OTHERS FOR EXACT LOCATION AND/OR DEPTH PRIOR TO EXCAVATION OR DESIGN CONSIDERATIONS.
5. THIS IS NOT A BOUNDARY SURVEY, BEARINGS ARE ASSUMED, DISTANCES AND FOUND PROPERTY CORNERS ARE FOR INFORMATIONAL PURPOSES ONLY.
6. SLOPES ARE AT 4:1 MAXIMUM.

#### EROSION CONTROL PLAN AND POLLUTION PREVENTION NOTES

1. CONTRACTOR IS RESPONSIBLE FOR OBTAINING A TOPSOIL DISTURBANCE PERMIT PRIOR TO BEGINNING WORK.
2. CONTRACTOR IS RESPONSIBLE FOR CLEANING ALL SEDIMENT OUT OF EXISTING RIGHT-OF-WAY.
3. CONTRACTOR IS RESPONSIBLE FOR MAINTAINING ALL STORM RUNOFF ON SITE.
4. REPAIR OF DAMAGED FACILITIES AND CLEAN-UP OF SEDIMENT ACCUMULATION ON ADJACENT PROPERTIES AND IN PUBLIC FACILITIES IS THE RESPONSIBILITY OF THE CONTRACTOR.
5. ALL EXPOSED EARTH SURFACES MUST BE PROTECTED FROM WIND AND WATER EROSION PRIOR TO FINAL ACCEPTANCE OF ANY PROJECT.
6. ALL THE DISTURBED AREAS MUST BE REVEGETATED.

For Information Only



GRAPHIC SCALE

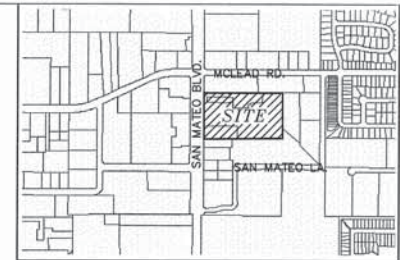

VICINITY MAP:

F-18-Z

#### LEGAL DESCRIPTION:

REFER TO PLAN ENTITLED "REPLAY OF TRACTS A-1, A-2 & A-3 LAND OF GOODWILL INDUSTRIES" ALBUQUERQUE, BERNALILLO COUNTY, NEW MEXICO, ALBUQUERQUE, BERNALILLO COUNTY, NEW MEXICO, FILED IN THE OFFICE OF THE COUNTY CLERK OF BERNALILLO COUNTY ON FEBRUARY 10, 1986, IN VOLUME C29, FOLIO 108.

ELEVATION DATUM IS BASED ON NVD 1929 FROM ACS MONUMENT "S-F18". ELEVATION (FEET) = 5209.56

#### NOTICE TO CONTRACTORS

1. AN EXCAVATION/CONSTRUCTION PERMIT WILL BE REQUIRED BEFORE BEGINNING ANY WORK WITHIN CITY RIGHT-OF-WAY.
2. ALL WORK DETAILED ON THESE PLANS TO BE PERFORMED, EXCEPT AS OTHERWISE STATED OR PROVIDED HEREON, SHALL BE CONSTRUCTED IN ACCORDANCE WITH CITY OF ALBUQUERQUE INTERIM STANDARD SPECIFICATIONS FOR PUBLIC WORKS CONSTRUCTION, 1985.
3. TWO WORKING DAYS PRIOR TO ANY EXCAVATION, CONTRACTOR MUST CONTACT LINE LOCATING SERVICE, 765-1234, FOR LOCATION OF EXISTING UTILITIES.
4. PRIOR TO CONSTRUCTION, THE CONTRACTOR SHALL EXCAVATE AND VERIFY THE HORIZONTAL AND VERTICAL LOCATIONS OF ALL CONSTRUCTIONS. SHOULD A CONFLICT EXIST, THE CONTRACTOR SHALL NOTIFY THE ENGINEER SO THAT THE CONFLICT CAN BE RESOLVED WITH A MINIMUM AMOUNT OF DELAY.
5. BACKFILL COMPACTION SHALL BE ACCORDING TO TRAFFIC/STREET USE.
6. MAINTENANCE OF THESE FACILITIES SHALL BE THE RESPONSIBILITY OF THE OWNER OF THE PROPERTY SERVED.
7. WORK ON ARTERIAL STREETS SHALL BE PERFORMED ON A 24-HOUR BASIS.

FOR INFORMATION ONLY



SHAJIAR BIAZAR  
P.E. #13479



ADVANCED  
ENGINEERING  
and CONSULTING, LLC

10201 SNOWFLAKE CT., NW  
ALBUQUERQUE, NEW MEXICO 87114  
(505) 899-5570

GOODWILL INDUSTRIES GRADING AND DRAINAGE PLAN			
DRAWING:	DRAWN BY:	DATE:	SHEET #
200347-GR.DWG	SBH	09-16-03	2 OF 3



SCANNED BY  
PLANNING

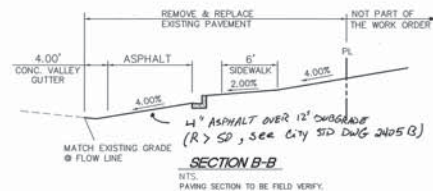
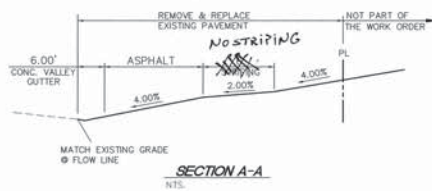

NOTES:

1. NEW UNIDIRECTIONAL WHEELCHAIR RAMP PER COA STD. DWG. #2426.
2. NEW 4' VALLEY GUTTER PER COA STD. DWG. #2421.
3. NEW 6' SIDEWALK PER COA STD. DWG. #2430.
4. REMOVE & REPLACE EXISTING SIDEWALK.
5. STANDARD CURB PER COA STD. DWG. #2415A.
6. NEW DRIVE WAY ENTRANCE PER COA STD. DWG. #2426.
7. NEW 6' VALLEY GUTTER PER COA STD. DWG. #2420.
8. STRIPING
9. NEW 6' SIDEWALK TRANSITION PER COA STD. DWG. #2432.

WATER SHUTOFF NOTES:

1. ONLY C.O.A. WATER SYSTEMS PERSONNEL ARE AUTHORIZED TO OPERATE VALVES.
2. NOTIFY CITY OF ALBUQUERQUE, WATER SYSTEMS DIVISION (PHONE 857-8200) SEVEN (7) WORKING DAYS IN ADVANCE OF NEEDING EXECUTION OF THE WATER SHUT OFF PLAN.
3. APPROXIMATE SHUT OFF TIME WILL BE 24 HOURS.
4. SHUTOFF VALVES INDICATED ON THE PLAN BELOW (→).

WATER SHUTOFF PLAN

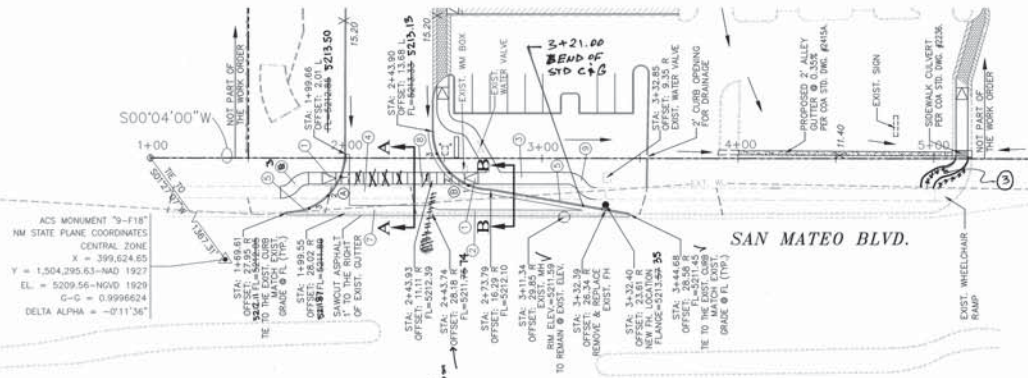

CURVE	LENGTH	RADIUS	DELTA	TANGENT	CHORD	CHORD DIRECT
A	47.13	30.00	90°00'11"	30.00	42.43	S44°30'45"E
B	46.98	30.00	89°43'18"	29.85	42.32	S45°08'21"W

QUARTER POINTS

FL	ELEV.
1	12.65
2	12.45
3	12.25

For Information Only

SCALE: HORIZ. 1"=30'  
VERT. 1"= 3'

SPECIAL PROJECT TRAFFIC CONTROL NOTES:

- 1- ONLY NORTHBOUND SINGLE RIGHT LANE CLOSURES ON SAN MATEO BLVD. WILL BE ALLOWED FOR CONSTRUCTION OF THIS PROJECT.
- 2- ARTERIAL / COLLECTOR ROAD USAGE FEES OF \$0.01 PER SQUARE FOOT OF BARRICADED AREA PER DAY WILL BE ASSESSED ON ALL LANE CLOSURES IN SAN MATEO BLVD.
- 3- CONTRACTOR MUST PERFORM AS MUCH WORK AS POSSIBLE BEHIND THE EXISTING CURB AND GUTTER PRIOR TO EFFECTING TRAFFIC ON SAN MATEO BLVD.
- 4- LANE CLOSURES ON SAN MATEO BLVD. WILL ONLY BE ALLOWED BETWEEN THE HOURS FROM 9:00 A.M. TO 3:00 P.M. DAILY. IF THE LANE CLOSURES REMAIN IN PLACE DUE TO SAFETY CONCERNS (i.e. DROP-OFFS), THEN THE CONTRACTOR MUST WORK CONTINUOUSLY, 24-HOURS PER DAY, UNTIL THE LANE IS RE-OPENED TO TRAFFIC.

NOTE:

- CONTRACTOR TO FIELD VERIFY EXISTING ASPHALT AND MATCH IT DURING REPLACEMENT OF NEW ASPHALT.
- ELEVATION DATUM IS BASED ON NGVD 1929 FROM ACS MONUMENT "9-F18", ELEVATION (FEET) = 5209.56.
- ADJUST MH RIMS AND VALVE CANS AS REQUIRED.

SAN MATEO BLVD.  
STA: 1+00.00 TO 6+90.70

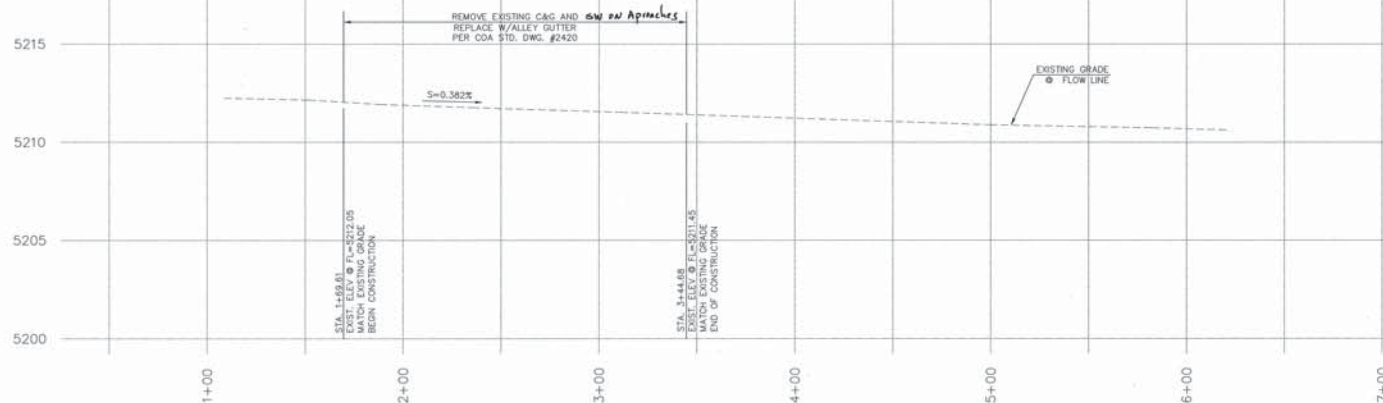

4410 ANABERB AVE. NE  
ALBUQUERQUE, NEW MEXICO 87113  
(505) 899-5576

CITY OF ALBUQUERQUE  
PUBLIC WORKS DEPARTMENT  
ENGINEERING GROUP

GOODWILL INDUSTRIES  
DECELERATION LANE

DESIGNED BY: SB	DATE: 01-04	CHECKED BY: SB	DATE: 01-04
REMARKS: REVISIONS	NO.	DATE	BY
CITY PROJECT NO. 731481			
ZONE MAP NO. F-18-Z			
SHEET 3 OF 3			