

File Path: P:\00000445\045 WESTERN TRAIL\ Plot Date: 01-04-2013
File Name: 090044SH_1_A8.DWG Plot Time: 3:34 pm

LEGEND

MATERIALS

CONCRETE
RIP-RAP

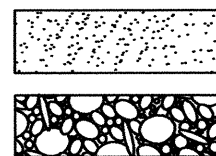

LINES

SUBDIVISION BOUNDARY
PROPERTY LINE (PLAN)
PROPERTY LINE (SECTION)
CENTERLINE
EASEMENT LINE
MATCH LINE
SECTION CUT LINE

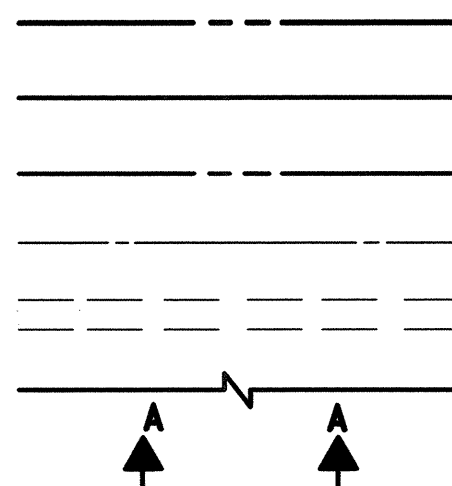

EARTHWORK

CONTOUR LINE
SPOT ELEVATION
PROJECT / PHASE BOUNDARY
FLOWLINE
DIRECTION OF FLOW

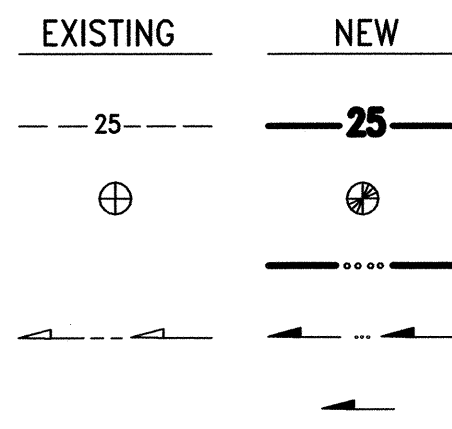

MISCELLANEOUS UTILITIES

GAS LINE
UNDERGROUND TELEPHONE
UNDERGROUND ELECTRICAL
STORM DRAIN
STORM DRAIN MANHOLE
STORM DRAIN INLET

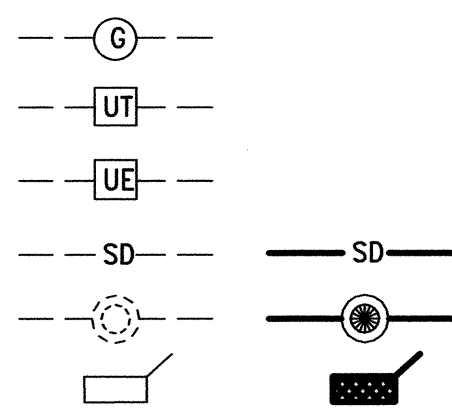

SANITARY SEWER

SANITARY SEWER LINE
SANITARY SEWER MANHOLE
SAS SERVICE CONNECTIONS
SAS CAP OR PLUG
ENCASEMENT

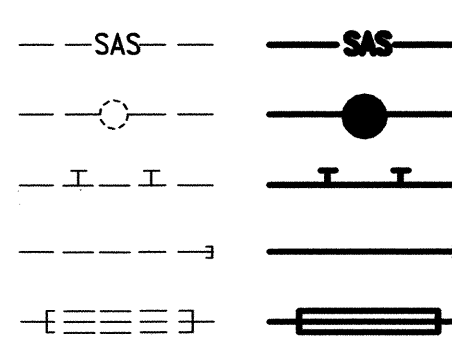

WATER

WATER LINE
WATER SERVICE CONNECTIONS
GATE VALVE
FIRE HYDRANT
BUTTERFLY VALVE
REDUCER
WATER PRESSURE ZONE BOUNDARY

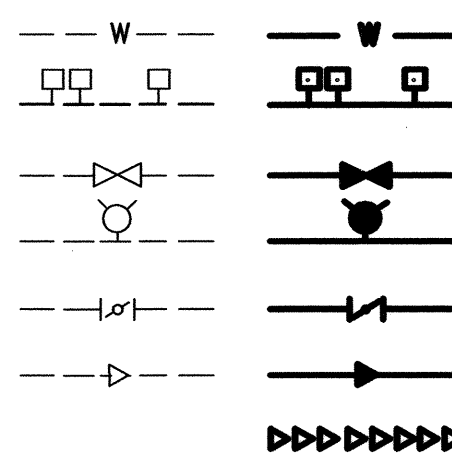

WATER FITTINGS

CAPS AND PLUGS
ELBOW
CROSS
TEE

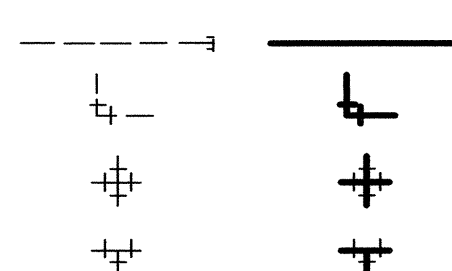

MISCELLANEOUS

CHAINLINK FENCE
FIELD FENCE
COMMON YARD WALL
RETAINING WALL
POWER OR TELEPHONE POLE

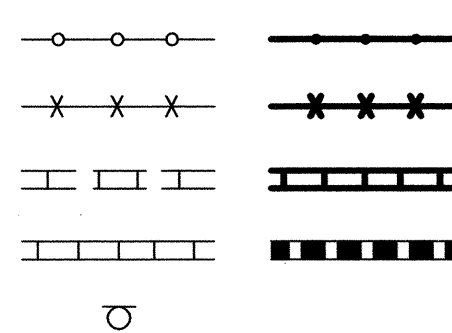

1 2 3 4 5 6 7 8 9 10 11 12 13 14 15
2 6 - 7 3 2 6 . 8 5 - 2 0 1 3

SCANNED BY
PLANNING



RECORD DRAWING

CONSTRUCTION PLANS

for

WESTERN TRAIL PAVING IMPROVEMENTS

AT

CHAPARRAL ELEMENTARY SCHOOL

ALBUQUERQUE, NEW MEXICO

MARCH, 2012

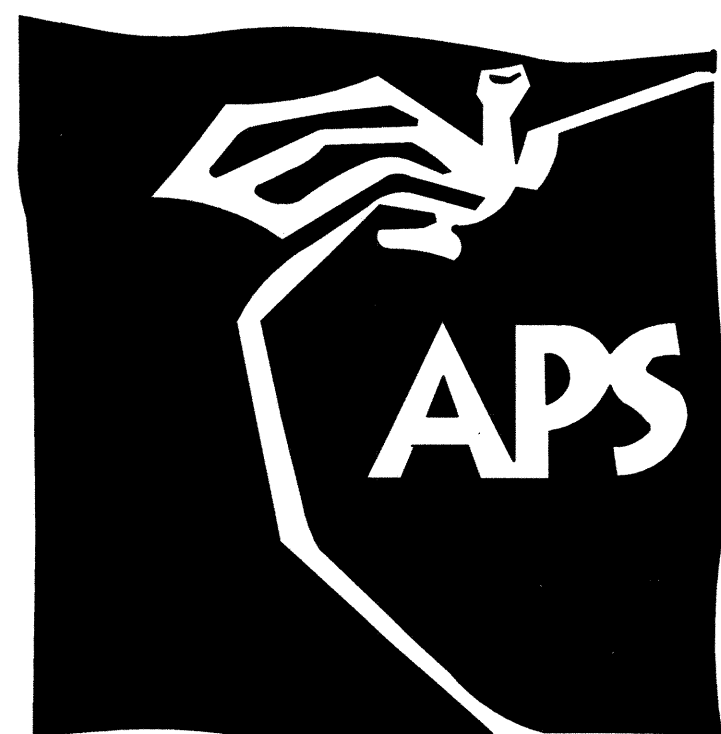

CERTIFICATE OF SUBSTANTIAL COMPLIANCE

I, JEFFREY G. MORTENSEN, NMPE 8547, OF THE FIRM HIGH MESA CONSULTING GROUP, HEREBY CERTIFY THAT THE INFRASTRUCTURE CONSTRUCTED AS PART OF THIS PROJECT HAS BEEN INSPECTED BY ME OR PERSONNEL UNDER MY DIRECT SUPERVISION AND, TO THE BEST OF MY KNOWLEDGE AND BELIEF, HAS BEEN CONSTRUCTED IN ACCORDANCE WITH THE PLANS AND SPECIFICATIONS AND THE ORIGINAL DESIGN INTENT OF THE CITY ENGINEER APPROVED PLANS DATED 03 - 22 - 2012. THE RECORD INFORMATION EDITED ONTO THIS ORIGINAL DESIGN DOCUMENT HAS BEEN OBTAINED BY ME OR UNDER MY DIRECT SUPERVISION AS SUPPLEMENTAL SITE DATA COMBINED WITH RECORD INFORMATION OBTAINED FROM THE AS-BUILT SURVEY DATED 07 - 30 - 2012 PERFORMED UNDER THE DIRECT SUPERVISION OF CHARLES G. CALA, JR., NMPS 11184, OF THE FIRM HIGH MESA CONSULTING GROUP, AND IS TRUE AND CORRECT TO THE BEST OF MY KNOWLEDGE AND BELIEF. THIS RECORD INFORMATION IS NOT NECESSARILY COMPLETE AND INTENDED ONLY TO VERIFY SUBSTANTIAL COMPLIANCE OF THE DESIGN INTENT OF THIS PROJECT. THOSE RELYING ON THIS DOCUMENT ARE ADVISED TO OBTAIN INDEPENDENT VERIFICATION OF ITS ACCURACY BEFORE USING IT FOR ANY OTHER PURPOSE. THIS CERTIFICATION IS SUBMITTED IN SUPPORT OF A REQUEST FOR ACCEPTANCE OF THE PROJECT BY THE CITY OF ALBUQUERQUE.

JEFFREY G. MORTENSEN, NMPE 8547

01-08-2013

DATE



INDEX OF DRAWINGS

SHEET

DESCRIPTION

1	VICINITY MAP, GENERAL NOTES, LEGEND AND INDEX OF DRAWINGS
2-3	PLAT OF RECORD (FOR INFORMATION ONLY)
4	OVERALL PLAN (FOR ORIENTATION ONLY)
5	OVERALL PAVING PLAN (FROM CPN 732683)
6	DECELERATION LANE (FROM CPN 732683)
7	LEFT TURNBAY (FROM CPN 732683)
8	SCHOOL BUSBAY PLAN AND PROFILE
9	SCHOOL BUSBAY SECTIONS AND DETAILS
10	DRAINAGE PLAN AND CALCULATIONS



RECORD DRAWING

APPROVED AS RECORD DRAWINGS/
DESIGN REVIEW SECTION
CITY CONSTRUCTION ENGINEER
DATE: 2-14-2013

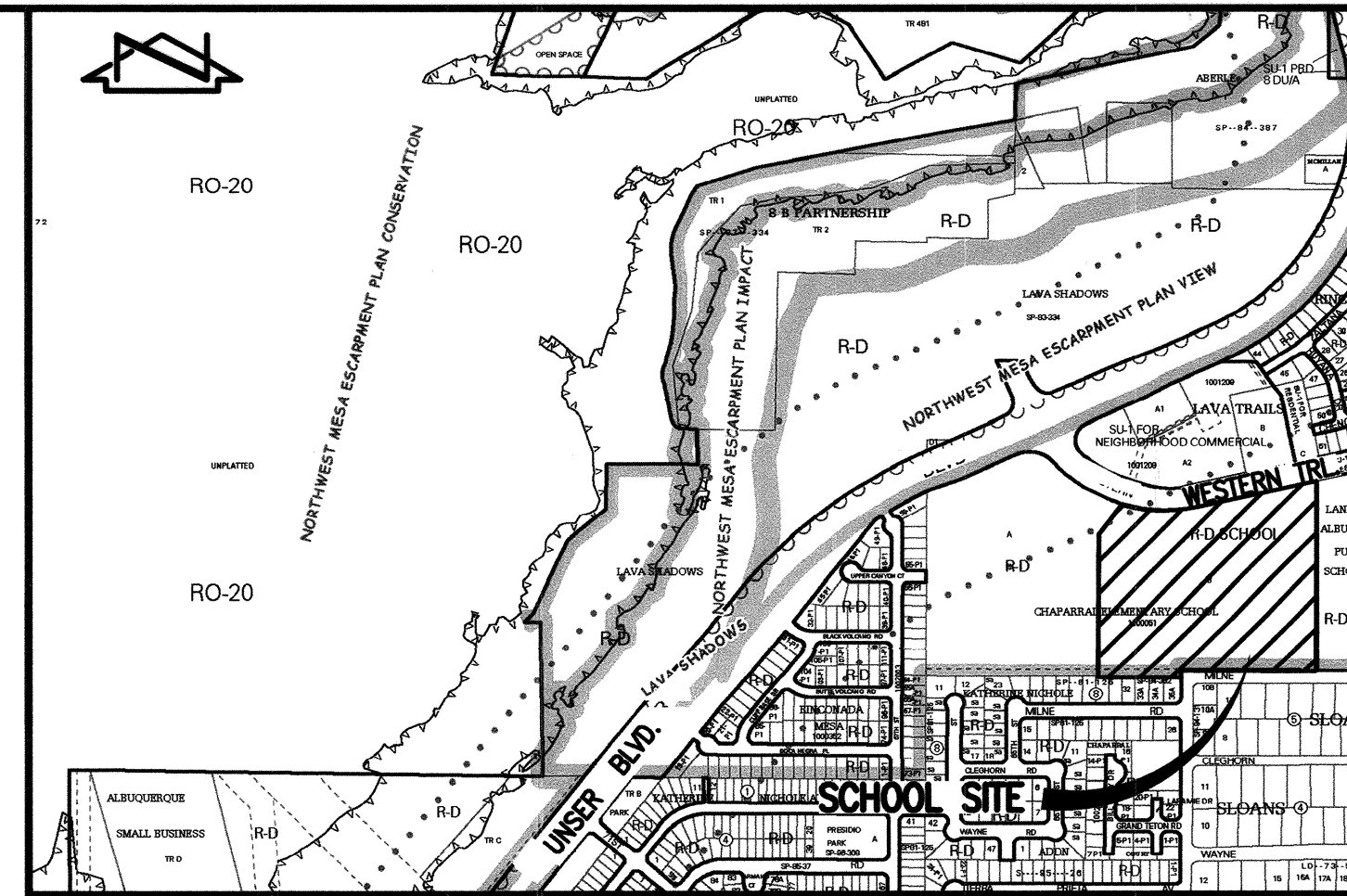

VICINITY MAP

SCALE: 1" = 750'

F-10

GENERAL NOTES

- ALL WORK DETAILED ON THESE PLANS TO BE PERFORMED UNDER CONTRACT SHALL, EXCEPT AS OTHERWISE STATED OR PROVIDED FOR HEREON, BE CONSTRUCTED IN ACCORDANCE WITH THE CITY OF ALBUQUERQUE STANDARD SPECIFICATIONS- PUBLIC WORKS CONSTRUCTION-1986-UPDATE NO. 8.
- TWO (2) WORKING DAYS PRIOR TO ANY EXCAVATION, CONTRACTOR MUST CONTACT NEW MEXICO ONE CALL SYSTEM, 260-1990, FOR DESIGNATION (LINE-SPOTTING) OF EXISTING PUBLIC UTILITIES AND EXISTING UTILITIES OWNED AND OPERATED BY ALBUQUERQUE PUBLIC SCHOOLS.
- IF ANY UTILITY LINES, PIPELINES, OR UNDERGROUND UTILITY LINES ARE SHOWN ON THESE DRAWINGS, THEY ARE SHOWN IN AN APPROXIMATE MANNER ONLY, AND SUCH LINES MAY EXIST WHERE NONE ARE SHOWN. IF ANY SUCH EXISTING LINES ARE SHOWN, THE LOCATION IS BASED UPON INFORMATION PROVIDED BY THE OWNER OF SAID UTILITY, AND THE INFORMATION MAY BE INCOMPLETE, OR MAY BE OBSOLETE BY THE TIME CONSTRUCTION COMMENCES. THE ENGINEER HAS CONDUCTED ONLY PRELIMINARY INVESTIGATION OF THE LOCATION, DEPTH, SIZE, OR TYPE OF EXISTING UTILITY LINES, PIPELINES, OR UNDERGROUND UTILITY LINES. THIS INVESTIGATION IS NOT CONCLUSIVE, AND MAY NOT BE COMPLETE, THEREFORE, MAKES NO REPRESENTATION PERTAINING THERETO, AND ASSUMES NO RESPONSIBILITY OR LIABILITY THEREFOR. THE CONTRACTOR SHALL INFORM ITSELF OF THE LOCATION OF ANY UTILITY LINE, PIPELINE, OR UNDERGROUND UTILITY LINE IN OR NEAR THE AREA OF THE WORK ADVANCE OF AND DURING EXCAVATION WORK. THE CONTRACTOR IS FULLY RESPONSIBLE FOR ANY AND ALL DAMAGE CAUSED BY ITS FAILURE TO LOCATE, IDENTIFY AND PRESERVE ANY AND ALL EXISTING UTILITIES, PIPELINES, AND UNDERGROUND UTILITY LINES. IN PLANNING AND CONDUCTING EXCAVATION, THE CONTRACTOR SHALL COMPLY WITH STATE STATUTES, MUNICIPAL AND LOCAL ORDINANCES, RULES AND REGULATIONS, IF ANY, PERTAINING TO THE LOCATION OF THESE LINES AND FACILITIES.
- SHOULD A CONFLICT EXIST BETWEEN THESE PLANS AND ACTUAL FIELD CONDITIONS, THE CONTRACTOR SHALL PROMPTLY NOTIFY THE ENGINEER IN WRITING SO THAT THE CONFLICT CAN BE RESOLVED WITH A MINIMUM AMOUNT OF DELAY FOR ALL PARTIES.
- THE CONTRACTOR SHALL MAINTAIN ACCESS TO ADJACENT PROPERTIES DURING CONSTRUCTION.
- ALL WORK ON THIS PROJECT SHALL BE PERFORMED IN ACCORDANCE WITH APPLICABLE FEDERAL, STATE AND LOCAL LAWS, RULES AND REGULATIONS CONCERNING SAFETY AND HEALTH.
- ALL UTILITIES AND UTILITY SERVICE LINES SHALL BE INSTALLED PRIOR TO PAVING.
- BACKFILL COMPACTION SHALL BE ACCORDING TO SPECIFIED STREET USE OR PER COA STANDARD DRAWING 2465, WHICHEVER IS MORE STRINGENT.
- TACK COAT REQUIREMENTS SHALL BE DETERMINED DURING CONSTRUCTION BY THE PROJECT ENGINEER.
- SIDEWALKS AND WHEELCHAIR RAMPS WITHIN THE CURB RETURNS SHALL BE CONSTRUCTED WHEREVER A NEW CURB RETURN IS CONSTRUCTED.
- IF CURB IS DEEPENED FOR A DRIVEPAD OR A HANDICAP RAMP, THE DRIVEPAD OR RAMP SHALL BE CONSTRUCTED PRIOR TO ACCEPTANCE OF THE CURB AND GUTTER.
- ALL STORM DRAINAGE FACILITIES SHALL BE COMPLETED PRIOR TO FINAL ACCEPTANCE.
- THE CONTRACTOR SHALL COORDINATE WITH THE WATER AUTHORITY SEVEN (7) DAYS IN ADVANCE OF PERFORMING WORK THAT WILL AFFECT THE PUBLIC WATER OR SANITARY SEWER INFRASTRUCTURE. WORK REQUIRING SHUTOFF OF FACILITIES DESIGNATED AS MASTER PLAN FACILITIES MUST BE COORDINATED WITH THE WATER AUTHORITY 14 DAYS IN ADVANCE OF PERFORMING SUCH WORK. ONLY WATER AUTHORITY CREWS ARE AUTHORIZED TO OPERATE PUBLIC VALVES. SHUTOFF REQUESTS MUST BE MADE ONLINE AT <http://abcwua.org/content/view/full/729/>.
- CONTRACTOR SHALL NOTIFY THE CITY SURVEYOR NOT LESS THAN SEVEN (7) DAYS PRIOR TO STARTING WORK IN ORDER THAT THE CITY SURVEYOR MAY TAKE NECESSARY MEASURES TO INSURE THE PRESERVATION OF SURVEY MONUMENTS. CONTRACTOR SHALL NOT DISTURB PERMANENT SURVEY MONUMENTS WITHOUT THE CONSENT OF THE CITY SURVEYOR AND SHALL NOTIFY THE CITY SURVEYOR AND BEAR THE EXPENSE OF REPLACING ANY THAT MAY BE DISTURBED WITHOUT PERMISSION. REPLACEMENT SHALL BE DONE ONLY BY THE CITY SURVEYOR. WHEN A CHANGE IS MADE IN THE FINISHED ELEVATION OF THE PAVEMENT OF ANY ROADWAY IN WHICH A PERMANENT SURVEY MONUMENT IS LOCATED, CONTRACTOR SHALL, AT HIS OWN EXPENSE, ADJUST THE MONUMENT COVER TO THE NEW GRADE UNLESS OTHERWISE SPECIFIED. REFER TO SECTION 4.4 OF THE SPECIFICATIONS.
- SEVEN (7) WORKING DAYS PRIOR TO BEGINNING CONSTRUCTION THE CONTRACTOR SHALL SUBMIT TO THE CONSTRUCTION COORDINATION DIVISION A DETAILED CONSTRUCTION SCHEDULE. TWO (2) WORKING DAYS PRIOR TO CONSTRUCTION THE CONTRACTOR SHALL OBTAIN A BARRICADE PERMIT FROM THE CONSTRUCTION COORDINATION DIVISION. CONTRACTOR SHALL NOTIFY BARRICADE ENGINEER (924-3400) PRIOR TO OCCUPYING AN INTERSECTION. CONTRACTOR MUST REFER TO SECTION 19 OF THE STANDARD SPECIFICATION FOR TRAFFIC CONTROL.
- ALL STREET STRIPING ALTERED OR DESTROYED SHALL BE REPLACED WITH PLASTIC REFLECTORIZED STRIPING BY CONTRACTOR TO EXISTING LOCATION OR AS INDICATED BY THIS PLAN SET. FINAL STRIPING TO BE REVIEWED BY TRAFFIC OPERATIONS, DMD. COORDINATE REVIEW BY TRAFFIC OPERATIONS THROUGH CONSTRUCTION ENGINEER, DRC/CONSTRUCTION SECTION, COA PLANNING DEPARTMENT.
- CAUTION: THESE DRAWINGS DO NOT INCLUDE NECESSARY COMPONENTS FOR CONSTRUCTION SAFETY WHICH SHALL REMAIN THE RESPONSIBILITY OF THE CONTRACTOR. ALL EXCAVATION, TRENCHING AND SHORING ACTIVITIES MUST BE CARRIED-OUT IN ACCORDANCE WITH OSHA 29 CFR 1926, SUBPART P-EXCAVATIONS.
- ANY WORK OCCURRING WITHIN AN ARTERIAL ROADWAY REQUIRES TWENTY-FOUR HOUR CONSTRUCTION.
- CONTRACTOR SHALL MAINTAIN A GRAFFITI-FREE WORK SITE. CONTRACTOR SHALL PROMPTLY REMOVE ANY AND ALL GRAFFITI FROM EQUIPMENT, WHETHER PERMANENT OR TEMPORARY.
- WHEN APPLICABLE, CONTRACTOR SHALL, ON BEHALF OF THE OWNER AND OPERATORS, SECURE "TOPSOIL DISTURBANCE PERMIT" FROM THE CITY AND/OR FILE A NOTICE OF INTENT (N.O.I.) WITH THE EPA PRIOR TO BEGINNING CONSTRUCTION.
- CONTRACTOR SHALL BE RESPONSIBLE FOR PROVIDING AND MAINTAINING ALL CONSTRUCTION SIGNING UNTIL THE PROJECT HAS BEEN ACCEPTED BY THE CITY OF ALBUQUERQUE.
- ALL FILL SHALL BE CLEAN, FREE FROM VEGETATION, DEBRIS, AND OTHER DELETERIOUS MATERIALS, AND SHALL NOT BE CONTAMINATED WITH HYDROCARBONS OR OTHER CHEMICAL CONTAMINANTS.

2009.004.4

HIGH MESA Consulting Group 6010-B MIDWAY PARK BLVD. NE • ALBUQUERQUE, NEW MEXICO 87109 PHONE: 505.345.4250 • FAX: 505.345.4254 • www.highmesacog.com									
REV.	SHEETS	CITY ENGINEER	DATE	USER	DEPARTMENT	DATE	USER	DEPARTMENT	DATE
ENGINEERS STAMP & SIGNATURE		APPROVALS		ENGINEER		DATE	*****		
		DRC Chairman		[Signature]		4/12/12	APPROVED FOR CONSTRUCTION		
		Transportation		[Signature]		4/12/12			
		Water/Wastewater		[Signature]		4-2-12			
		Hydrology		[Signature]		4/12/12			
C.I.P.									
Const. Mngmt.									
Const. Coord.									
City Project No. 732685				SHEET 1 OF 10					

03-22-2012

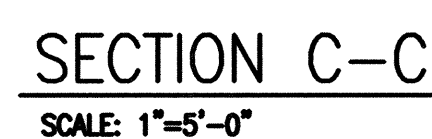

EXISTING 54" RCP STORM DRAIN

City Project No.	732685	Zone Map No.	E-10	Sheet	9	Of	10
------------------	--------	--------------	------	-------	---	----	----

RECORD DRAWING
FOR CERTIFICATION, SEE SHEET 1

APPROVED AS RECORD DRAWINGS
DESIGN REVIEW SECTION
CITY CONSTRUCTION ENGINEER

DATE: _____

File Path:	P:\DWG\2009\DWG\ESTERN TOWNS.DWG	Plot Date:	01-04-2013
File Name:	090044SH_9_AB.DWG	Plot Time:	3:54 pm

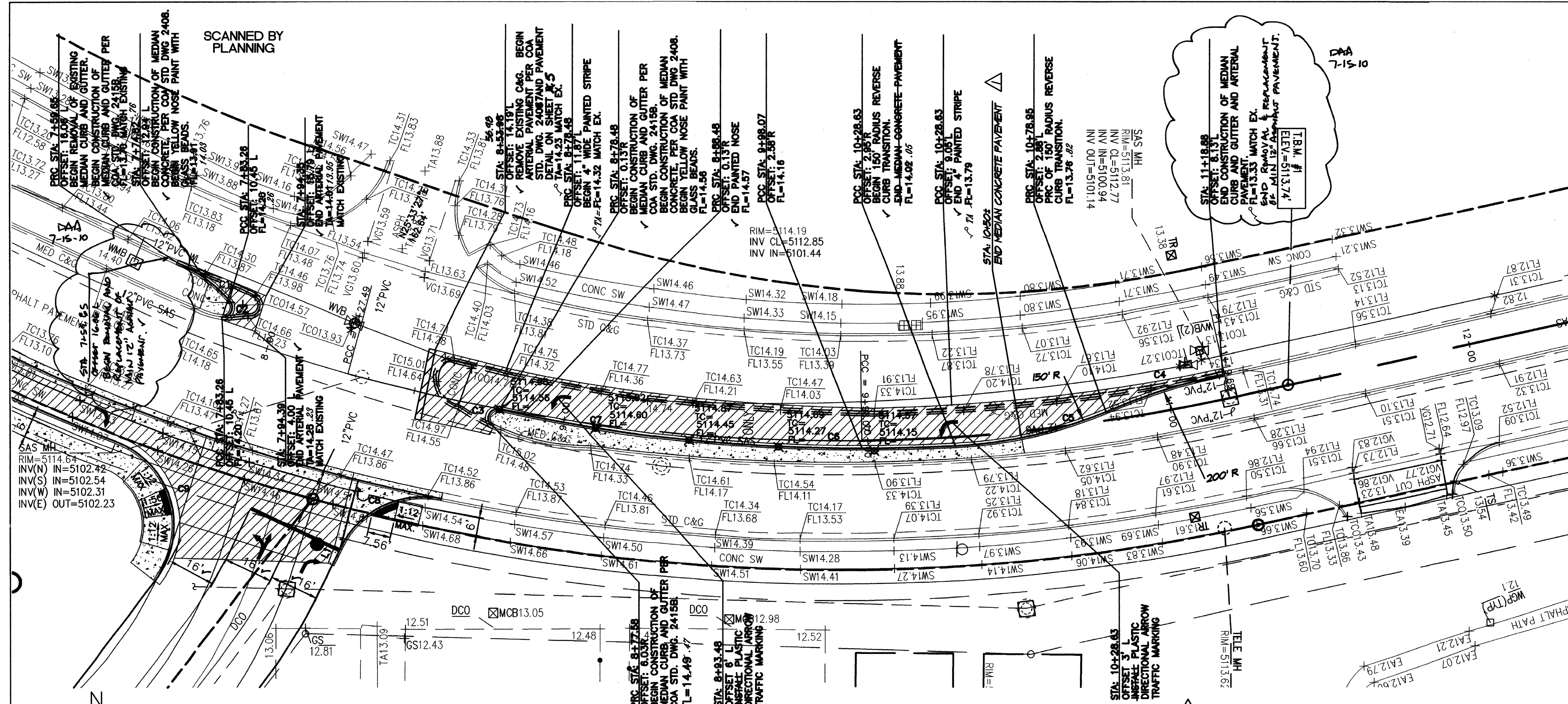

LINE TABLE		
LINE	LENGTH	BEARING
L1	6.00	N25°33'27"E

PAVEMENT STRIPING & MARKINGS:
ALL STRIPING AND PAVEMENT MARKINGS
SPECIFIED HEREON SHALL BE WHITE
THERMOPLASTIC; PAINT IS ONLY ALLOWED
FOR MEDIAN NOSES AND THE NEW PRIVATE
ENTRANCE.

CURVE TABLE				
CURVE	LENGTH	RADIUS	TANGENT	DELTA
C1	21.38	50.00	10.86	24°30'03"
C2	7.43	3.00	8.70	141°56'26"
C3	8.86	3.00	31.99	169°17'12"
C4	38.60	200.00	19.36	11°03'31"
C5	52.49	150.00	26.52	20°03'02"
C6	87.34	594.84	43.75	8°24'45"
C7	63.30	489.17	31.70	7°24'53"
C8	39.94	30.00	23.55	76°16'17"
C9	55.68	30.00	40.07	106°21'44"
C10	106.99	645.00	53.62	9°30'15"
C11	54.02	150.00	27.30	20°37'58"
C12	33.17	150.00	16.65	12°40'05"

LEGEND

NEW ASPHALT PAVING
PER DETAIL ON SHEET

CONCRETE FOR SIDEWALKS,
DRIVEPADS AND MEDIAN NOSE

SUB DIVISION BOUNDARY

LOT LINE

STREET CENTERLINE

EDGE OF EXIST. PAVEMENT

EXISTING STORM DRAIN

ROADWAY CENTER LINE

EXISTING FEATURES:

TRAFFIC SIGN

FIRE HYDRANT

EXISTING MANHOLE

WATER VALVE

NOTE TO CONTRACTOR:
WHEEL CHAIR RAMPS WITHIN PUBLIC RIGHT OF WAY
WILL REQUIRE TRUNCATED DOMES (DETECTABLE WARNING
SURFACE).
TRUNCATED DOMES:
- DESIGN PER CURRENT ADA GUIDELINES.
- SUBMIT SPECS TO CITY CONSULTANT ENGINEER
FOR EVALUATION PRIOR TO CONSTRUCTION.

2000.004.4

The Design Group
ARCHITECTS • PLANNERS • INTERIOR DESIGN
202 CENTRAL AVENUE SE SUITE 200
ALBUQUERQUE, NEW MEXICO 87102
PHONE: 505.242.6880 FAX: 505.242.6881

CITY OF ALBUQUERQUE
PUBLIC WORKS DEPARTMENT
ENGINEERING GROUP

TITLE: APS SCHOOL ON WHEELS
IMPROVEMENTS FOR MEDIAN ACCESS ON WESTERN TRAIL NW
WESTERN TRAIL PLAN and PROFILE

DESIGNED BY: DAVID A. AUBE, P.E.
DATE: 4-28-10

DRAWN BY: DAA
DATE: 4-28-10

CHECKED BY: DAA
DATE: 4-28-10

REVISIONS

DATE 4-28-10

DATE 4-28-10

DATE 4-28-10

APPROVED AS RECORD DRAWINGS
DESIGN REVIEW SECTION
CITY CONSTRUCTION ENGINEER

DATE:

APPROVED
DESIGN REVIEW COMMITTEE
APR 12 2012

APPROVED
CITY ENGINEER
JUN 04 2012

City Project No. 732685

Zone Map F-10-Z

Sheet 7 of 10

RECORD DRAWING
FOR CERTIFICATION, SEE SHEET 1

WESTERN TRAIL PROFILE

SCALE: 1" = 20'-0" HORIZ.
1" = 4'-0" VERT.

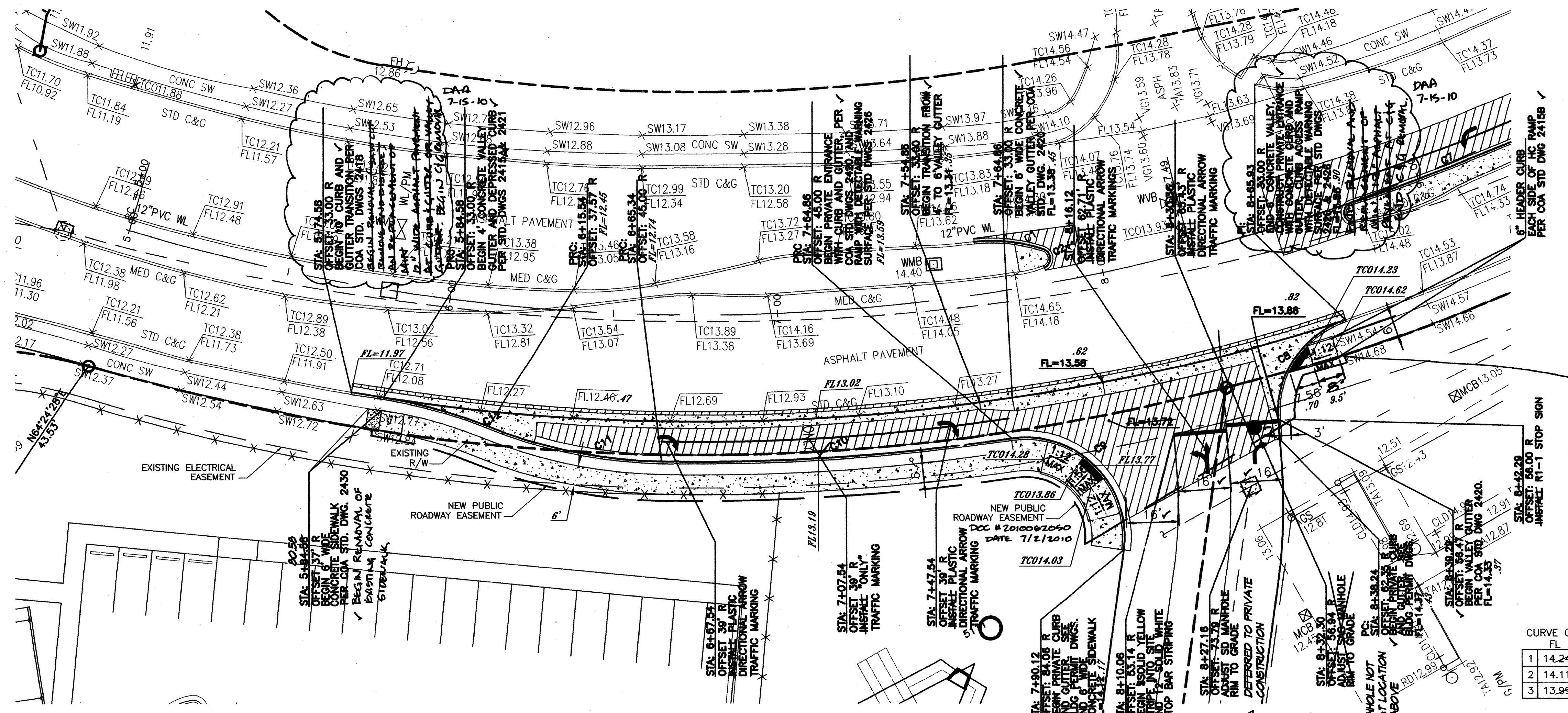

LINE TABLE		
LINE	LENGTH	BEARING
L1	6.00	N25°33'27"E





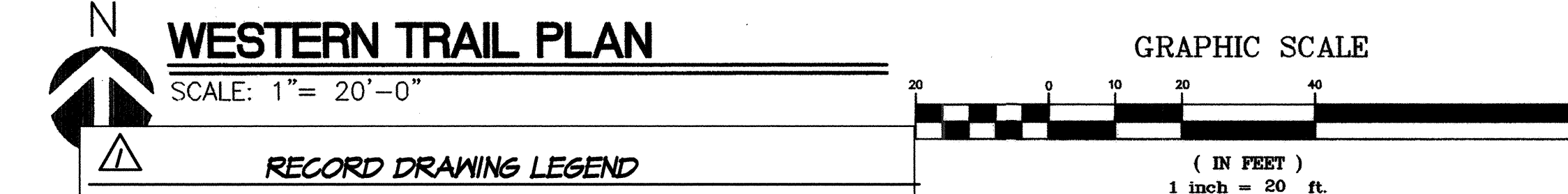



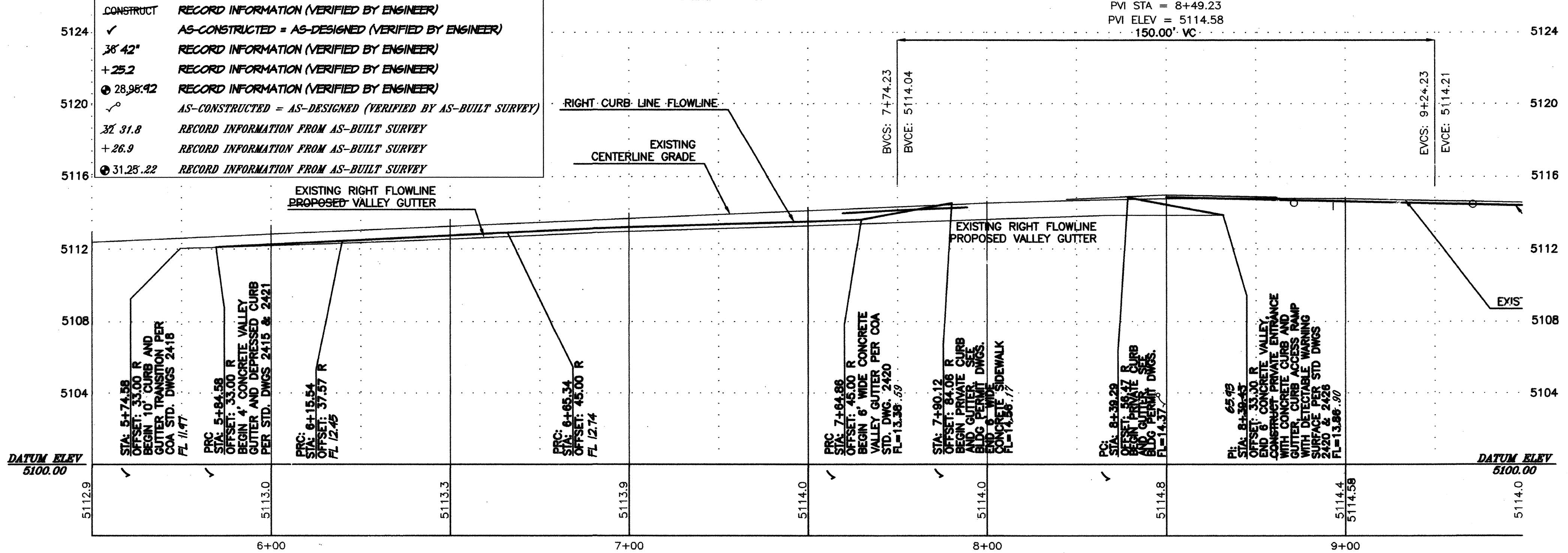

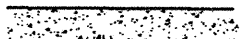
PAVEMENT STRIPING & MARKINGS:
ALL STRIPING AND PAVEMENT MARKINGS SPECIFIED HEREON SHALL BE WHITE THERMOPLASTIC; PAINT IS ONLY ALLOWED FOR MEDIAN NOSES AND THE NEW PRIVATE ENTRANCE.

CURVE TABLE				
CURVE	LENGTH	RADIUS	TANGENT	DELTA
C1	21.38	50.00	10.86	24°30'03"
C2	7.43	3.00	8.70	141°56'26"
C3	8.86	3.00	31.99	169°17'12"
C4	38.60	200.00	19.36	11°03'31"
C5	52.49	150.00	26.52	20°03'02"
C6	87.34	594.84	43.75	8°24'45"
C7	63.30	489.17	31.70	7°24'53"
C8	39.94	30.00	23.55	76°16'17"
C9	55.69	30.00	40.07	106°21'44"
C10	106.99	645.00	53.62	9°30'15"
C11	54.02	150.00	27.30	20°37'58"
C12	33.17	150.00	16.65	12°40'05"



 RECORD DRAWING LEGEND	
	<div>CONSTRUCT</div> <div>RECORD INFORMATION (VERIFIED BY ENGINEER)</div>
5124	<div>✓</div> <div>AS-CONSTRUCTED = AS-DESIGNED (VERIFIED BY ENGINEER)</div>
	<div>38" 42"</div> <div>RECORD INFORMATION (VERIFIED BY ENGINEER)</div>
	<div>+ 25.2</div> <div>RECORD INFORMATION (VERIFIED BY ENGINEER)</div>
5120	<div>⊕ 28.98:42</div> <div>RECORD INFORMATION (VERIFIED BY ENGINEER)</div>
	<div>∞</div> <div>AS-CONSTRUCTED = AS-DESIGNED (VERIFIED BY AS-BUILT SURVEY)</div>
	<div>32 31.8</div> <div>RECORD INFORMATION FROM AS-BUILT SURVEY</div>
	<div>+ 26.9</div> <div>RECORD INFORMATION FROM AS-BUILT SURVEY</div>
5116	<div>⊕ 31.25 :.22</div> <div>RECORD INFORMATION FROM AS-BUILT SURVEY</div>



LEGEND	
	NEW ASPHALT PAVING PER DETAIL ON SHEET 5
	CONCRETE FOR SIDEWALKS, DRIVEPADS AND MEDIAN NOSE
	SUB DIVISION BOUNDARY
	LOT LINE
	STREET CENTERLINE
	EDGE OF EXIST. PAVEMENT
	EXISTING STORM DRAIN
	ROADWAY CENTER LINE
EXISTING FEATURES:	
	TRAFFIC SIGN
	WV FIRE HYDRANT
	EXISTING MANHOLE

NOTE TO CONTRACTOR:
WHEEL CHAIR RAMPS WITHIN PUBLIC RIGHT OF WAY
WILL REQUIRE TRUNCATED DOMES (DETECTABLE WARNING
SURFACE).

TRUNCATED DOMES:

- DESIGN PER CURRENT ADA GUIDELINES.
- SUBMIT SPECS TO ~~ANY~~ CONSULTANT ENGINEER
FOR EVALUATION PRIOR TO CONSTRUCTION.

[illegible]

2009.004.4



THE DESIGN GROUP
 ARCHITECTS • PLANNERS • INTERIOR DESIGN
 202 CENTRAL AVENUE SE SUITE 200
 ALBUQUERQUE, NEW MEXICO 87102
 PHONE: 505.242.6880 FAX: 505.242.6881

CITY OF ALBUQUERQUE PUBLIC WORKS DEPARTMENT ENGINEERING GROUP									
TITLE: APS SCHOOL ON WHEELS IMPROVEMENTS FOR MEDIAN ACCESS ON WESTERN TRAIL NW WESTERN TRAIL PLAN and PROFILE									

Design Review Committee		City Engineer Approval		Last Design Update	Mo./Day/Yr.	Mo./Day/Yr.
APPROVED 11/17/20 DESIGN REVIEW COMMITTEE		APPROVED JUN 08/21 CITY ENGINEER				
City Project No.	732685	Zone Map	E-10-7	Sheet	6	Of 10

01-03-2013

RECORD DRAWING
FOR CERTIFICATION, SEE SHEET 1

APPROVED AS RECORD DRAWINGS
DESIGN REVIEW SECTION
CITY CONSTRUCTION ENGINEER

DATE: _____

APPROVED
APR 19 2012
DESIGN
REVIEW COMMITTEE

SCANNED BY
PLANNING

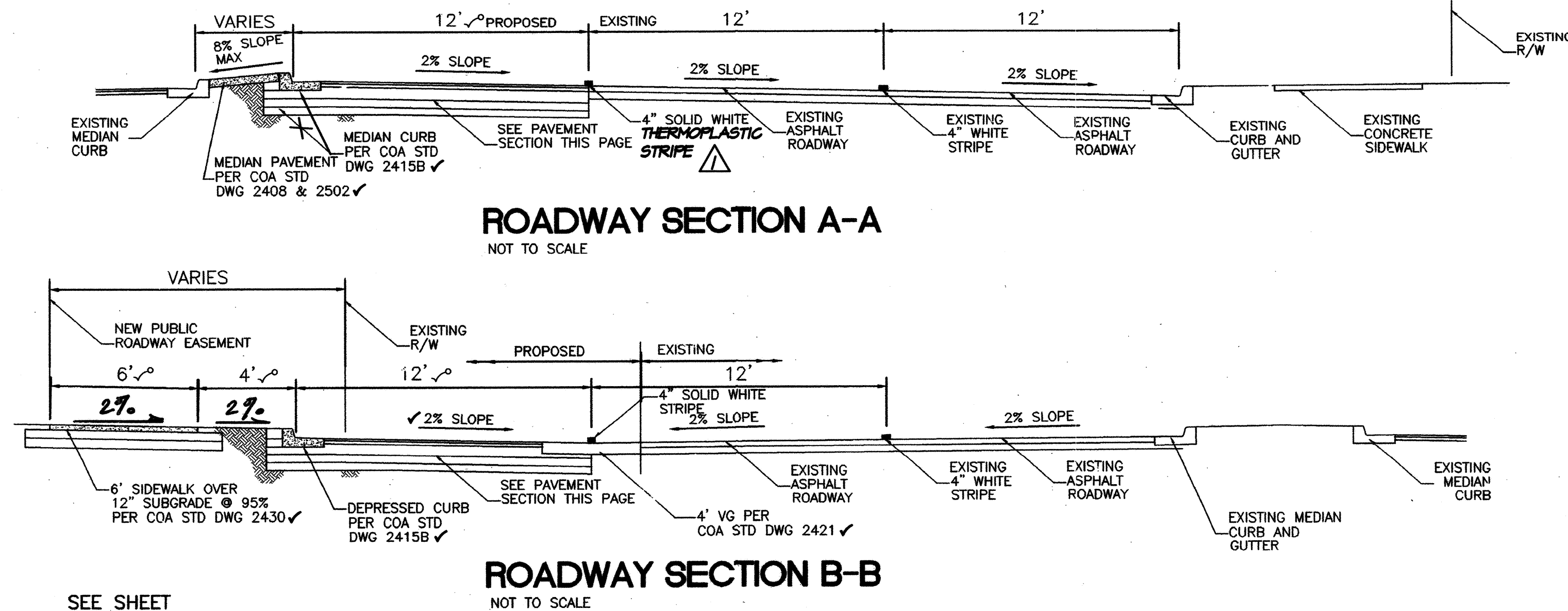
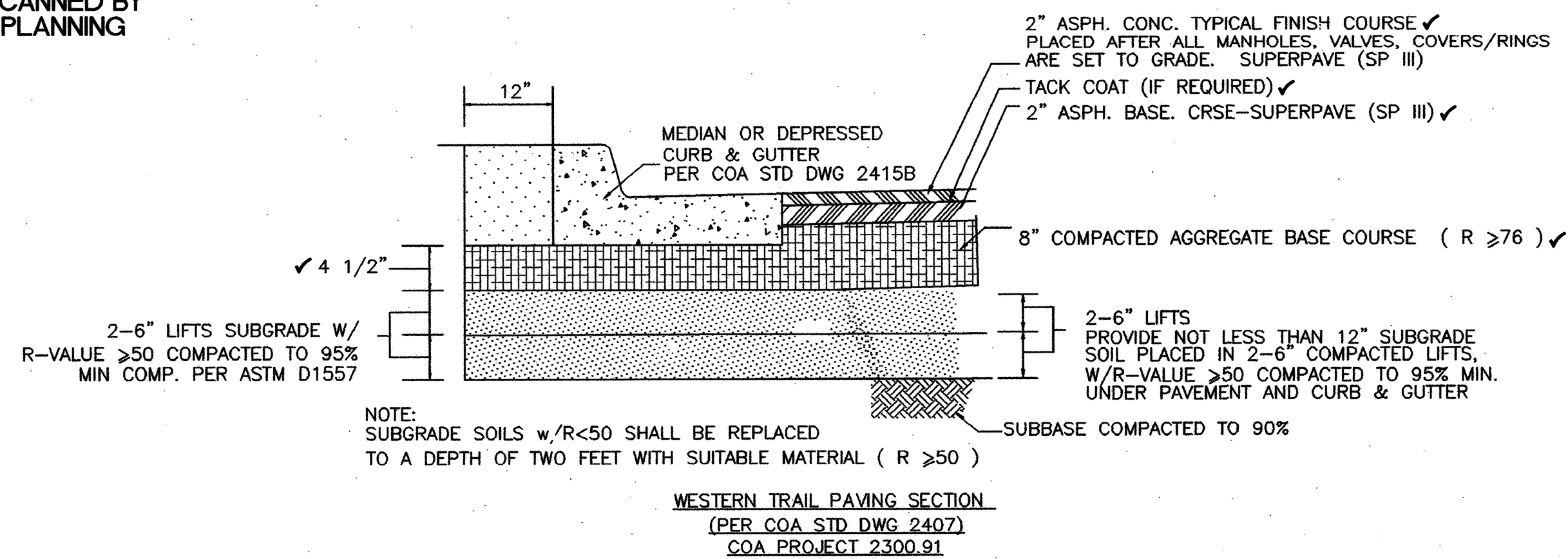

PAVEMENT STRIPING & MARKINGS:
ALL STRIPING AND PAVEMENT MARKINGS
SPECIFIED HEREON SHALL BE WHITE
THERMOPLASTIC; PAINT IS ONLY ALLOWED
FOR MEDIAN NOSES AND THE NEW PRIVATE
ENTRANCE.

RECORD DRAWING LEGEND	
CONSTRUCT	RECORD INFORMATION (VERIFIED BY ENGINEER)
✓	AS-CONSTRUCTED = AS-DESIGNED (VERIFIED BY ENGINEER)
36° 42"	RECORD INFORMATION (VERIFIED BY ENGINEER)
+ 25.2	RECORD INFORMATION (VERIFIED BY ENGINEER)
⊕ 28.95.42	RECORD INFORMATION (VERIFIED BY ENGINEER)
✓	AS-CONSTRUCTED = AS-DESIGNED (VERIFIED BY AS-BUILT SURVEY)
32° 31.8	RECORD INFORMATION FROM AS-BUILT SURVEY
+ 26.9	RECORD INFORMATION FROM AS-BUILT SURVEY
⊕ 31.28°.22	RECORD INFORMATION FROM AS-BUILT SURVEY

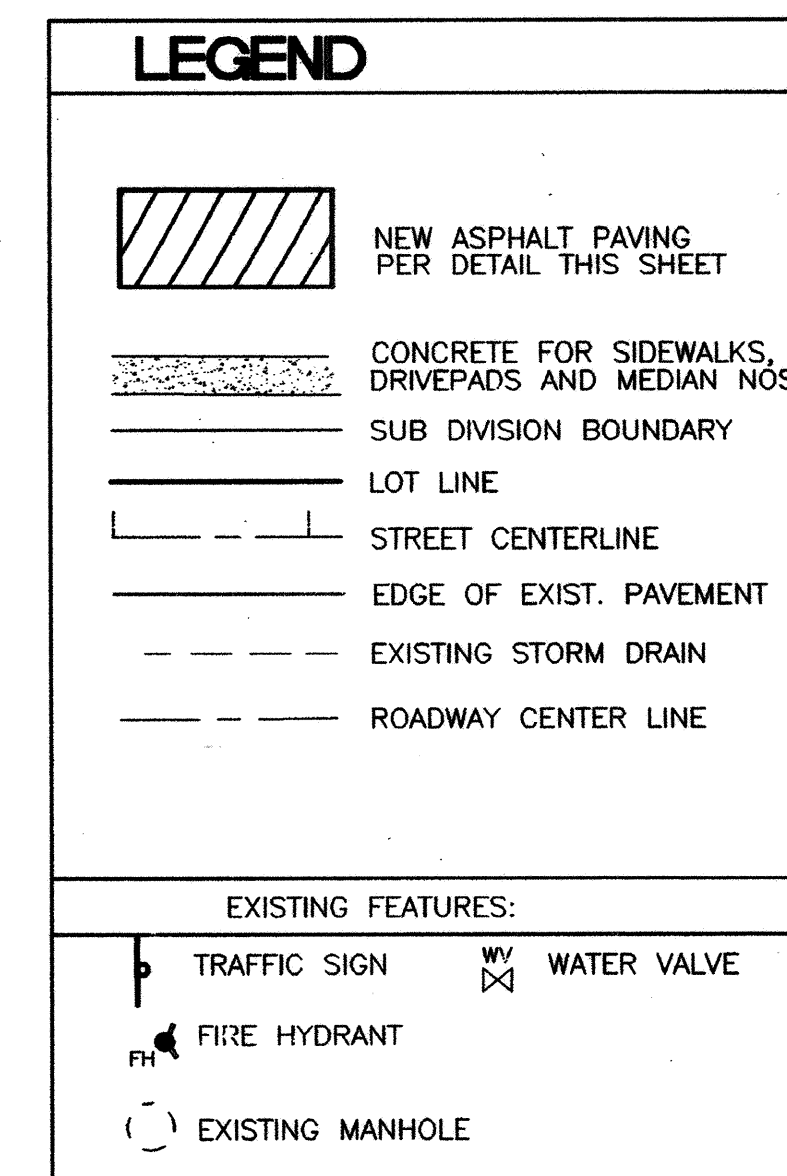

NOTE TO CONTRACTOR:
WHEEL CHAIR RAMPS WITHIN PUBLIC RIGHT OF WAY
WILL REQUIRE TRUNCATED DOMES (DETECTABLE WARNING
SURFACE).

TRUNCATED DOMES:

- DESIGN PER CURRENT ADA GUIDELINES.
- SUBMIT SPECS TO THE CONSULTANT AND CONSTRUCTION
ENGINEER FOR EVALUATION PRIOR TO CONSTRUCTION.

2009.004.4



THE DESIGN GROUP
 ARCHITECTS • PLANNERS • INTERIOR DESIGN
 202 CENTRAL AVENUE SE SUITE 200
 ALBUQUERQUE, NEW MEXICO 87102
 PHONE: 505.242.6880 FAX: 505.242.6881

CITY OF ALBUQUERQUE PUBLIC WORKS DEPARTMENT ENGINEERING GROUP	
TITLE: IMPROVEMENTS	APS SCHOOL ON WHEELS FOR MEDIAN ACCESS ON WESTERN TRAIL NW OVERALL PAVING PLAN

Design Review Committee	City Engineer Approval	Last Design Update	Mo./Day/Yr.	Mo./Day/Yr.
APPROVED DEC 17 2010 DESIGN REVIEW COMMITTEE	APPROVED DEC 14 2012 CITY ENGINEER			

City Project No. 732685 Zone Map E-10-7 Sheet 5 Of 10



OVERALL PAVING PLAN

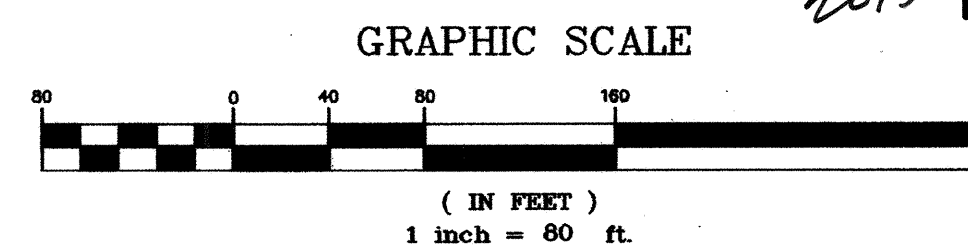

RECORD DRAWING
FOR CERTIFICATION, SEE SHEET 1

APPROVED AS RECORD DRAWING
DESIGN REVIEW SECTION
CITY CONSTRUCTION ENGINEER

DATE: _____

APPROVED
APR 12 2012
DESIGN
REVIEW COMMITTEE

File Path:	P:\DWG\2008\004\4\DWG\WESTERN THALS.dwg	Plot Date:	01-04-2013
File Name:	090044SH_5_AB.DWG	Plot Time:	2:40 pm

PLAT OF
TRACTS A AND B, SCHOOL
CHAPARRAL ELEMENTARY SCHOOL
ALBUQUERQUE, NEW MEXICO
DECEMBER, 1999

200003106
Page 2 of 3
8/11/2008 8:17:08 PM
Jeff D. Mortensen Bern. Co. PLT

COUNTY CLERK FILING DATA

SCANNED BY
PLANNING

Notes:

- A boundary survey was performed in January, 1999. Property corners were found or set as indicated.
- All distances are ground distances.
- Site located within Section 34, Township 11 North, Range 2 East, N.M.P.M.
- Bearings are New Mexico State Plane Grid Bearings, Central Zone.
- Record bearings and distances are shown in parenthesis.
- No public street mileage was created by this plat.
- The purpose of this plat is to:
 - Create Tracts A and B, Chaparral Elementary School from Tracts A-1 and B-1, Lands of Albuquerque Public Schools.
 - Grant the private access and public utility easement as shown.
- Prior to development, City of Albuquerque Water and Sanitary Sewer Department, City of Albuquerque, New Mexico, and the City of Albuquerque, New Mexico, coordinated with the Public Works Department, City of Albuquerque, New Mexico, via a request for a water and sanitary sewer availability statement.
- The following documents and instruments were used for the performance and preparation of this plat:
 - Plat of Katherine-Nichole Addition filed April 29, 1982, Book C19, Page 131, Records of Bernalillo County, New Mexico.
 - Plat of Lava Shadows filed November 17, 1983, Book C22, Page 123, Records of Bernalillo County, New Mexico.
 - Plat of Lands of Albuquerque Public Schools filed February 23, 1995, Book 95C, Page 67, Records of Bernalillo County, New Mexico.
 - Pending Plat of Unser Boulevard South - Phase II prepared by Greiner, Inc. (unrecorded)
 - ALTA/A.C.S.M. Land Title Survey prepared by Jeff Mortensen & Associates, Inc. dated August 26, 1999 (unrecorded).
 - ALTA/A.C.S.M. Land Title Survey prepared by Jeff Mortensen & Associates, Inc. dated September 27, 1999 (unrecorded).
 - Plat of Katherine-Nichole Addition filed April 27, 1981, Book C18, Page 63, Records of Bernalillo County, New Mexico.
 - Plat of Katherine-Nichole Addition filed August 31, 1984, Book C24, Page 190, Records of Bernalillo County, New Mexico.
 - Plat of Sloan's Acres filed May 19, 1955, Book C3, Page 10, Records of Bernalillo County, New Mexico.
 - Plat of Sloan's Acres filed August 29, 1995, Book 95C, Page 327, Records of Bernalillo County, New Mexico.

BOUNDARY TABLES

LINE	DIRECTION	DISTANCE
BL1	S 00°03'53" W	30.00'

CURVE	RADIUS	LENGTH	CHORD	BEARING	DELTA
BC1	1731.34'	16.99'	16.99'	N 64°38'44" E	00°33'44"
(BC1)	1731.34'	17.03'	17.03'	N 64°38'46" E	00°33'49"
BC2	135.00'	166.16'	155.87'	S 78°23'47" E	70°31'10"
(BC2)	135.00'	165.98'	155.72'	S 78°25'48" E	70°26'36"
BC3	843.00'	684.10'	634.08'	S 72°47'45" E	58°10'34"
BC4	843.00'	350.98'	348.82'	S 58°50'40" E	31°18'23"
BC5	843.00'	313.14'	310.08'	S 88°23'57" E	27°54'11"
(BC5)	843.00'	313.17'	310.08'	S 88°26'03" E	27°54'19"

EASEMENT TABLE

LINE	DIRECTION	DISTANCE
E1	N 32°48'49" W	37.60'
E2	N 29°07'00" W	232.50'
E3	N 01°22'00" W	171.70'
E4	N 82°21'00" E	128.00'
E5	S 01°03'00" W	12.30'
E6	N 00°06'00" W	30.00'
E7	S 00°08'00" E	61.00'

EASEMENT KEYED NOTES

- 10' PALM AND M.S.T. EASEMENT GRANTED BY DOCUMENT DATED 11-15-1983 (UNRECORDED)
- 30' WATER AND SANITARY SEWER EASEMENT GRANTED BY PLAT C20-172
- APPROXIMATE LOCATION OF FUTURE PRIVATE ACCESS AND PUBLIC UTILITY EASEMENT (WATER, SANITARY SEWER, ELECTRIC, COMMUNICATION AND GAS) GRANTED BY THIS PLAT TO SERVE TRACT B. ULTIMATE ALIGNMENT TO BE DETERMINED IN CONJUNCTION WITH SUBSEQUENT PLATTING/DEVELOPMENT OF TRACT A. MAINTENANCE SHALL BE THE RESPONSIBILITY OF THE OWNER OF TRACT A.
- 7' PUBLIC UTILITY EASEMENT GRANTED BY PLAT C19-131 (OFFSITE)

MONUMENTATION KEYED NOTES

- SET #5 REBAR W/CAP STAMPED "NEW MEXICO PS 11184"
- FOUND #5 REBAR W/CAP STAMPED "GREINER INC. NMPLS 3517". TAGGED W/WASHER STAMPED "NMPS 11184"
- FOUND 1" IRON PIPE, TAGGED W/WASHER STAMPED "NMPS 11184"
- FOUND #5 REBAR (NO I.D.), TAGGED W/WASHER STAMPED "NMPS 11184"
- FOUND 1" IRON PIPE
- FOUND BLM BRASS CAP STAMPED "SM"
- SET CHISELED "+" IN CONCRETE
- COULD NOT SET
- SET ASPHALT NAIL W/WASHER STAMPED "NMPS 11184"
- FOUND #4 REBAR (NO I.D.), TAGGED W/WASHER STAMPED "NMPS 11184"
- FOUND 1" IRON PIPE, TAGGED WITH WASHER STAMPED "NMPS 11184"

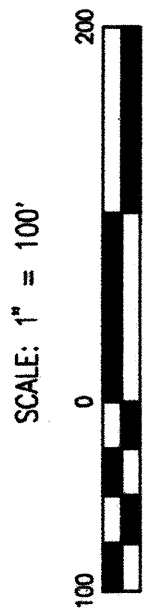
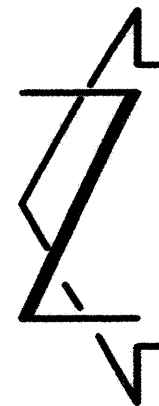
JEFF MORTENSEN & ASSOCIATES, INC.
6000-B MIDWAY PARK BLVD. N.E.
ALBUQUERQUE, NEW MEXICO 87109
ENGINEERS SURVEYORS (505) 345-4250
JOB #991811 PTSCALE: 1" = 100'
NOTE: FOR BOUNDARY AND EASEMENT TABLES
EASEMENT AND MONUMENTATION KEYED
NOTES SEE SHEET 2 OF 3

PLAT OF
TRACTS A AND B, SCHOOL
CHAPARRAL ELEMENTARY SCHOOL
ALBUQUERQUE, NEW MEXICO
DECEMBER, 1999

COUNTY CLERK FILING DATA

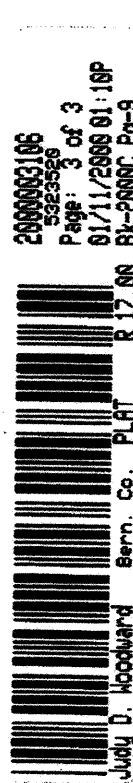
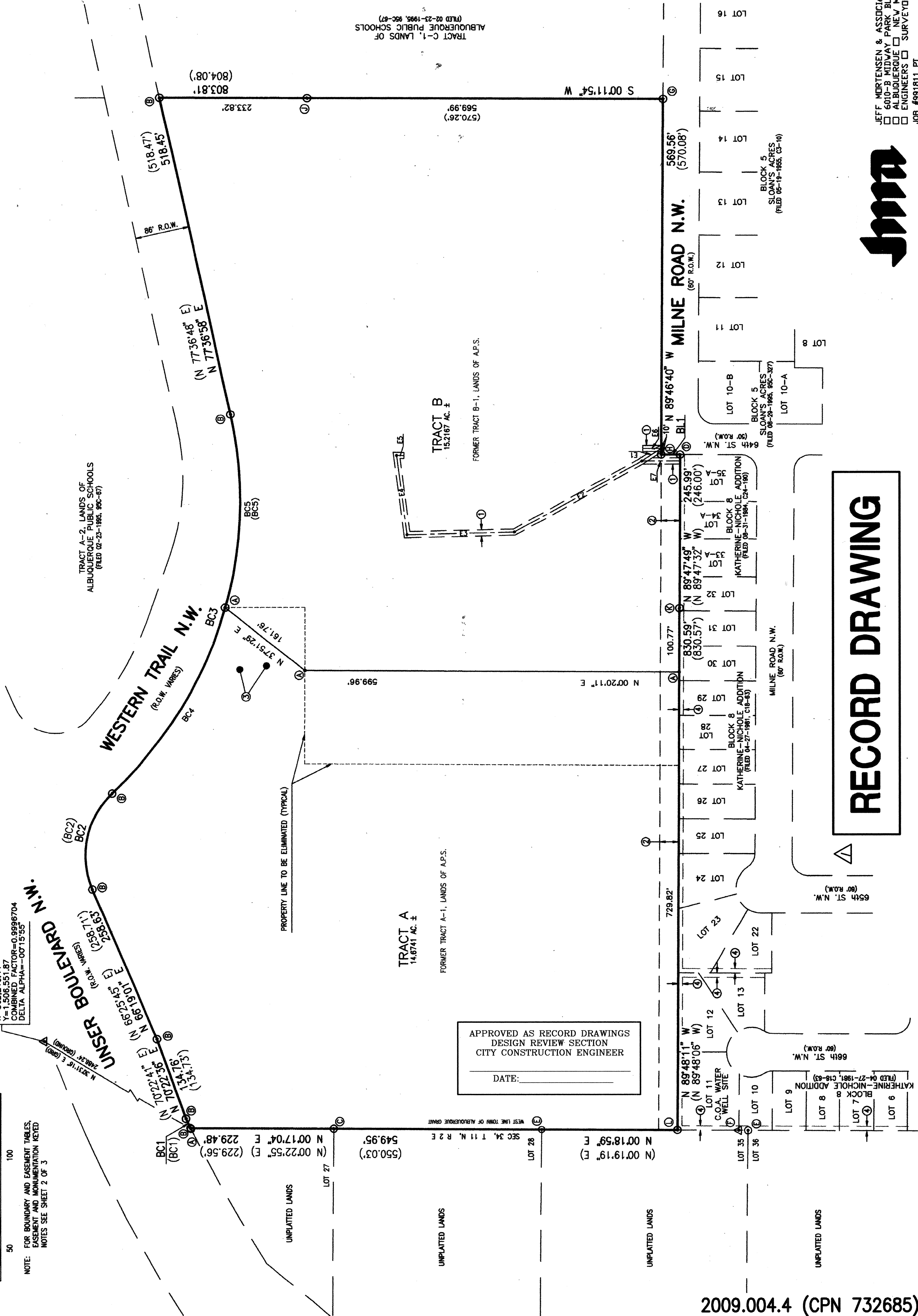
200003106
Page 3 of 3
8/11/2008 8:17:08 PM
Jeff D. Mortensen Bern. Co. PLT

RECORD DRAWING

JEFF MORTENSEN & ASSOCIATES, INC.
6000-B MIDWAY PARK BLVD. N.E.
ALBUQUERQUE, NEW MEXICO 87109
ENGINEERS SURVEYORS (505) 345-4250
JOB #991811 PT

Judy D. Woodward Bern. Co. PLAT R 12.00

Prod # 1000051

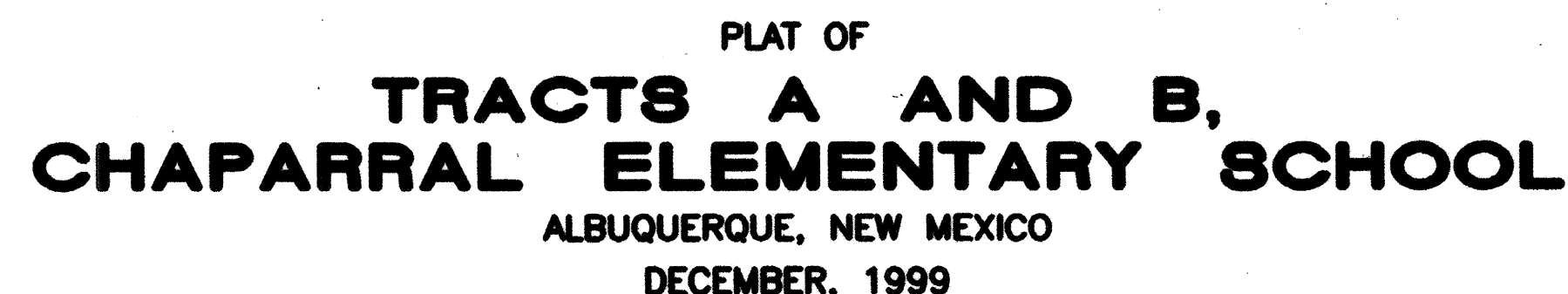

A certain tract of land located within the Corporate Limits of the City of Albuquerque, New Mexico, comprising Tracts A-1 and B-1, Lands of Albuquerque Public Schools, as the same is shown and designated on the plat filed in the Office of the County Clerk of Bernalillo County, New Mexico on February 23, 1995, Book 95C, Page 67, and being more particularly described as follows:

Beginning at the northeast corner of the parcel herein described, being the northeast corner of said Tract B-1, also being the northwest corner of Tract C-1, of said Lands of Albuquerque Public Schools, and also being a point on the south right-of-way line of Western Trails N.W.; thence S 00°11'54" W a distance of 803.81 feet to the southeast corner of the parcel herein described, being the southeast corner of said Tract B-1, also being the southwest corner of said Tract C-1, also being a point on the north right-of-way line of Western Trails N.W.; thence N 89°46'40" W a distance of 569.56 feet to the point of intersection of the north right-of-way line of Milne Road N.W. with the west right-of-way line of 64th Street N.W.; thence S 00°03'53" W a distance of 30.00 feet along said west right-of-way line to an angle point on the south boundary of said Tract B-1, being the northeast corner of Lot 35-A, Block 8, Katherine-Nicole Addition, as the same is shown and designated on the plat filed in the Office of the County Clerk of Bernalillo County, New Mexico, on August 31, 1984, Book C24, Page 139; thence N 89°47'49" W a distance of 245.99 feet, to a point on the north property line of Lot 32, Block 8, Katherine-Nicole Addition, as the same is shown and designated on the plat filed in the Office of the County Clerk of Bernalillo County, New Mexico on April 27, 1981, Book C18, Page 63; thence N 89°48'11" W a distance of 830.59 feet to the southwest corner of the parcel herein described, being the southwest corner of said Tract A-1, also being the northwest corner of Lot 1, Block 8, of said Katherine-Nicole Addition, and also being a point on the east property line of Lot 35, Township 11 North, Range 2 East, N.M.P.M.; thence N 00°18'59" E a distance of 549.95 feet to an angle point in the west boundary of said Tract A-1, also being the southeast corner of Lot 27, Township 11 North, Range 2 East, N.M.P.M., also being the northeast corner of Lot 28, Section 34, Township 11 North, Range 2 East, N.M.P.M.; thence N 00°17'04" E a distance of 229.48 feet to the northwest corner of the parcel herein described, being the northwest corner of said Tract A-1, also being a point on the southeast right-of-way line of said Boulevard W.; thence along an arc of a curve to the right with DELTA = 60°34'44", R = 731.4 feet and a Chord Bearing = N 64°38'44" E, Chord Length = 16.99 feet) along said southeast right-of-way line; thence N 70°22'36" E a distance of 134.76 feet along said southeast right-of-way line; thence N 66°19'01" E a distance of 258.63 feet along said southeast right-of-way line; thence along an arc of a curve to the right with DELTA = 70°31'10", R = 135.00 feet, L = 166.16 feet (Chord Bearing = S 78°23'47" E, Chord Length = 155.87 feet) to a point of reverse curvature on the southwest right-of-way line of Western Trail N.W.; thence along an arc of a curve to the left with DELTA = 54°34'44" R = 643.00 feet, L = 100.00 feet (Chord Bearing = S 72°42'40" E, Chord Length = 634.98 feet) along said southwest right-of-way line; thence N 77°36'58" E a distance of 518.45 feet to the point of beginning and containing 29,890.08 acres more or less.

James S. [Signature]	1/3/2000
PLANNING DIRECTOR, CITY OF ALBUQUERQUE, NEW MEXICO	DATE
Roger J. [Signature]	12-27-99
UTILITY DEVELOPMENT, CITY OF ALBUQUERQUE, NEW MEXICO	DATE
Frank J. [Signature]	12-27-99
CITY ENGINEER, CITY OF ALBUQUERQUE, NEW MEXICO	DATE
Frank J. [Signature]	12-27-99
A.M.A.F.C.A.	DATE
Michael [Signature]	12-27-99
TRANSPORTATION DEVELOPMENT, CITY OF ALBUQUERQUE, NEW MEXICO	DATE
+ Recreation Dept Janet [Signature]	12-28-99
PARKS DESIGN & DEVELOPMENT, C.M.P., CITY OF ALBUQUERQUE, NEW MEXICO	DATE
Ph B. [Signature]	12/21/99
CITY SURVEYOR, CITY OF ALBUQUERQUE, NEW MEXICO	DATE

SCALE: 1" = 750'

The subdivision hereon is with the free consent and in accordance with the desires of the undersigned owner and does hereby grant the easements as shown, including the rights of ingress and egress and the right to trim interfering trees.



Michael J. Vigil, Chief Business Officer,
Albuquerque Public Schools

12-17-99
Date

STATE OF NEW MEXICO)
COUNTY OF BERNALILLO): SS

This instrument was acknowledged before me on this 17th day of December, 1999, by Michael J. Vigil, Chief Business Officer, Albuquerque Public Schools.

Chasen O. Edwards
Notary Public

 OFFICIAL SEAL
Charles O. Atwood
NOTARY PUBLIC
STATE OF NEW MEXICO
My Commission Expires: 7-30-2007

THIS IS TO CERTIFY THAT TAXES ARE CURRENT AND
PAID ON UPC #: 1-010-061-470-091 40660
PROPERTY OWNER OF RECORD:

PROPERTY OWNER OF RECORD:
NM Board of Education
SERNALILLO COUNTY TREASURER'S OFFICE:
Josephine M. Serna
1-11-00

SURVEYORS CERTIFICATION

I, Charles G. Cala, Jr., a registered Professional Surveyor under the laws of the State of New Mexico do hereby certify: that I conducted and am responsible for this plat; that the survey shows all easements made known to me by this owner, utility companies, or other parties expressing an interest; that the survey meets the minimum requirement for Monumentation and surveys of the Albuquerque Subdivision Ordinance; that the survey complies with the minimum standards for surveying in the State of New Mexico, and is true and correct to the best of my knowledge and belief.

Charles G. Cala, Jr.
Charles G. Cala, Jr., NMFS 11184

12-15-1999
Date



JEFF MORTENSEN & ASSOCIATES, INC.
☐ 6010-B MIDWAY PARK BLVD. N.E.
☐ ALBUQUERQUE ☐ NEW MEXICO 87109
☐ ENGINEERS ☐ SURVEYORS (505) 345-4250
 JOB #991811 PT

SHEET 1 OF 3

**PLAT OF RECORD
WESTERN TRAIL PAVING IMPROVEMENTS
CHAPARRAL ELEMENTARY SCHOOL**

DESIGNED BY <u>N/A</u> DRAWN BY <u>N/A</u> APPROVED BY <u>N/A</u>	NO.	DATE	BY	REVISIONS	JOB NO.
		04/12	B.E.E.	RECORD DRAWING	2009.004.4
					DATE
					03-2012
					SHEET 2 OF 10

HIGH MESA Consulting Group

6010-B MIDWAY PARK BLVD. NE • ALBUQUERQUE, NEW MEXICO 87109
PHONE: 505.345.4250 • FAX: 505.345.4254 • www.highmesacq.com

File Path:	P:\DWG\2009\04\126\WESTERN TOWNS.DWG	Plot Date:	01-04-2013
File Name:	090044SH_2_AB.DWG	Plot Time:	1:58 pm

DRAINAGE PLAN

I. INTRODUCTION AND EXECUTIVE SUMMARY

THIS PROJECT, LOCATED ON THE NORTHWEST MESA OF THE ALBUQUERQUE METROPOLITAN AREA, REPRESENTS A MODIFICATION TO AN EXISTING SCHOOL SITE WITHIN AN INFILL AREA. THE SCHOOL SITE IS LOCATED ON THE SOUTH SIDE OF WESTERN TRAIL NW BETWEEN UNSER BLVD NW AND ATRISCO DRIVE NW. THE SITE IS DEVELOPED AS AN ALBUQUERQUE PUBLIC SCHOOLS ELEMENTARY SCHOOL. THE PROJECT LIES AT THE NORTHEAST CORNER OF THE SCHOOL CAMPUS. THE PROPOSED IMPROVEMENTS CONSIST OF A NEW PAVED BUSBAY AND NEW PRIVATE STORM DRAIN CONNECTION TO AN EXISTING PUBLIC STORM INLET. ALL PROPOSED IMPROVEMENTS LIE WITHIN BASIN 4-B AS DEFINED BY THE 2009 MASTER DRAINAGE PLAN (MDP), F10/D005.

THE PROPOSED DRAINAGE CONCEPT FOR THE NEW BUSBAY IS FREE DISCHARGE TO THE EXISTING 48" PUBLIC STORM DRAIN WITHIN WESTERN TRAIL NW VIA A NEW PRIVATE STORM DRAIN CONNECTION; THE 48" PUBLIC STORM DRAIN DISCHARGES TO THE LADERA BASIN 16 SOUTH SUMP, A PUBLIC DETENTION POND. THIS PLAN WILL MAINTAIN THE CONCEPT OF FREE DISCHARGE FROM THE SCHOOL CAMPUS TO THE LADERA BASIN 16 SOUTH SUMP PER THE APPROVED 2009 MDP.

THIS SUBMITTAL IS MADE IN SUPPORT OF WORK ORDER AND GRADING AND PAVING PERMIT APPROVALS.

II. PROJECT DESCRIPTION

AS SHOWN BY THE VICINITY MAP, THE SCHOOL SITE IS LOCATED ON THE SOUTH SIDE OF WESTERN TRAIL NW, BETWEEN UNSER BLVD NW AND ATRISCO DRIVE NW. THE PROJECT SITE IS LOCATED AT THE NORTHEAST CORNER OF THE SCHOOL CAMPUS, ALONG WESTERN TRAIL NW, AND IMMEDIATELY ADJACENT TO THE LADERA BASIN 16 SOUTH SUMP. THE CURRENT LEGAL DESCRIPTION IS TRACT B, CHAPARRAL ELEMENTARY SCHOOL. AS SHOWN BY PANEL 114 OF 825 OF THE NATIONAL FLOOD INSURANCE PROGRAM FLOOD INSURANCE RATE MAPS PUBLISHED BY FEMA FOR BERNALILLO COUNTY, NEW MEXICO, DATED SEPTEMBER 26, 2008, THIS SITE DOES NOT LIE WITHIN A DESIGNATED FLOOD HAZARD ZONE. THIS SITE DOES, HOWEVER, LIE IMMEDIATELY ADJACENT TO AN AE DESIGNATED FLOOD HAZARD ZONE THAT COINCIDES WITH THE LADERA BASIN 16 SOUTH SUMP, A PUBLIC DETENTION POND. THE PROJECT SITE IS CURRENTLY ALLOWED FREE DISCHARGE TO THE PUBLIC DETENTION POND.

III. BACKGROUND DOCUMENTS & RESEARCH

THE PREPARATION OF THIS SUBMITTAL RELIED UPON THE FOLLOWING DOCUMENTS:

A. CHAPARRAL ELEMENTARY SCHOOL DRAINAGE PLAN PREPARED BY HIGH MESA CONSULTING GROUP (FORMERLY TOM MANN & ASSOCIATES) DATED MARCH 09, 1983. THE 1983 DRAINAGE PLAN ESTABLISHED THAT FREE DISCHARGE OF DEVELOPED RUNOFF FROM THE SCHOOL SITE INTO THE LADERA BASIN 16 SOUTH SUMP IS PERMISSIBLE. THE 1983 PLAN PROVIDES THE BASIS FOR THE FREE DISCHARGE OF RUNOFF FROM THE SITE TO THE LADERA BASIN 16 SOUTH SUMP.

B. TOPOGRAPHIC SURVEY PREPARED BY HIGH MESA CONSULTING GROUP, NMPS 11184, DATED APRIL 6, 2009. THE SURVEY PROVIDES THE EXISTING CONDITIONS FOR THIS PROJECT.

C. MASTER DRAINAGE PLAN PREPARED BY HIGH MESA CONSULTING GROUP, NMPE 8547, DATED JUNE 15, 2009. THE APPROVED 2009 PLAN DEFINES THE EXISTING BASINS OF THE SCHOOL SITE AND ALLOWS FOR FREE DISCHARGE OF DEVELOPED RUNOFF FROM THE SITE TO THE LADERA BASIN 16 SOUTH SUMP, A PUBLIC DETENTION POND. THE PROPOSED WORK LIES ENTIRELY WITHIN BASIN 4-B.

D. CHAPARRAL ELEMENTARY SCHOOL TRACK AND FIELD IMPROVEMENTS PLAN PREPARED BY HIGH MESA CONSULTING GROUP, NMPE 8547, DATED DECEMBER 23, 2011. THE PLAN DEFINES THE PROPOSED TRACK AND FIELD IMPROVEMENTS WITHIN BASIN 4-B DIRECTLY SOUTH OF THIS NEW BUSBAY, TO BE CONSTRUCTED PRIOR TO OR CONCURRENT WITH THE NEW BUSBAY. THE 2011 APPROVED PLAN REAFFIRMS THAT CONTINUED FREE DISCHARGE FROM THE TRACK AND FIELD (SOUTH PORTION OF BASIN 4-B) VIA SURFACE FLOW TO THE LADERA BASIN 16 SOUTH SUMP IS PERMISSIBLE.

IV. EXISTING CONDITIONS

THE PROJECT SITE LIES WITHIN THE NORTHERLY PORTION OF BASIN 4-B AT THE NORTHEAST CORNER OF THE SCHOOL CAMPUS. THE PROJECT SITE CONSISTS OF THE EXISTING GRAVEL BUSBAY AND EXISTING ASPHALT PATH. THE BUSBAY CONNECTS TO WESTERN TRAIL NW VIA TWO EXISTING PRIVATE ENTRANCES. RUNOFF FROM THE PROJECT SITE GENERALLY SHEETFLOWS TO THE SOUTH AND EAST ACROSS BASIN 4-B TO FREE DISCHARGE DIRECTLY TO THE LADERA BASIN 16 SOUTH SUMP.

THERE ARE NO APPARENT OFFSITE FLOWS IMPACTING THE PROJECT SITE. WESTERN TRAIL NW TO THE NORTH IS A FULLY DEVELOPED PUBLIC STREET WITH ASPHALT PAVING, CURB AND GUTTER, SIDEWALK, AND A PUBLIC STORM DRAIN. IT APPEARS THAT THE WESTERN TRAIL NW IMPROVEMENTS PLUS EXISTING WATERBLOCKS AT THE TWO PRIVATE ENTRANCES ARE SUFFICIENT TO CONTAIN OFFSITE FLOWS WITHIN WESTERN TRAIL NW. THE LADERA BASIN 16 SOUTH SUMP IS TOPOGRAPHICALLY LOWER THAN THE SITE APPEARS TO CONTAIN ITS FLOW WITHOUT IMPACT TO THE SITE.

V. DEVELOPED CONDITIONS

THE PROPOSED IMPROVEMENTS CONSIST OF A PERMANENT BUSBAY FOR SCHOOL BUSES COMPLETE WITH CURB AND GUTTER, CONCRETE SIDEWALK AND FENCING. THE NEW BUSBAY WILL CONNECT TO WESTERN TRAIL NW VIA THE EXISTING PRIVATE ENTRANCES TO UNDERGO SLIGHT MODIFICATION; THE EXISTING WATERBLOCKS WILL NOT BE LOWERED. THE PAVED BUSBAY WILL INCLUDE A NEW PRIVATE STORM INLET WITH 12" RCP STORM DRAIN CONNECTION TO THE BACK OF AN EXISTING PUBLIC STORM INLET WITHIN WESTERN TRAIL NW.

THE PROPOSED IMPROVEMENTS WILL DIVIDE BASIN 4-B INTO SUB-BASINS 4-B-NORTH AND 4-B-SOUTH. SUB-BASIN 4-B-NORTH WILL CONSIST OF THE NEW BUSBAY IMPROVEMENTS, WHILE SUB-BASIN 4-B-SOUTH WILL CONSIST OF THE REMAINDER OF BASIN 4-B, WHICH INCLUDES THE NEW TRACK AND FIELD REFERENCED IN THE BACKGROUND DOCUMENTS ABOVE.

SUB BASIN 4-B-NORTH WILL DRAIN TO A SUMP CONDITION ALONG THE SOUTH CURB LINE OF THE NEW BUSBAY. A PRIVATE STORM INLET IS PROPOSED AT THIS LOCATION TO COLLECT THE DEVELOPED RUNOFF GENERATED BY THE NEW IMPROVEMENTS. FROM THIS POINT, RUNOFF WILL DISCHARGE NORTH VIA 12" RCP PRIVATE STORM DRAIN AND CONNECT TO THE BACK OF AN EXISTING PUBLIC TYPE "A" STORM INLET IN THE SOUTH CURB LINE OF WESTERN TRAIL NW. THE EXISTING PUBLIC STORM INLET ALSO LIES IN A SUMP CONDITION WITH A GRATE ELEVATION APPROXIMATELY 0.1 FEET LOWER THAN THE PROPOSED GRATE ELEVATION OF THE NEW PRIVATE STORM INLET, THEREBY MITIGATING POTENTIAL SURGE IMPACTS OF PUBLIC RUNOFF ONTO PRIVATE PROPERTY.

IT SHOULD BE FURTHER NOTED THAT THE NEW PRIVATE STORM DRAIN CONNECTION TO THE EXISTING PUBLIC STORM DRAIN SYSTEM LIES AT THE BOTTOM OF THE WATERSHED, IMMEDIATELY UPSTREAM OF THE LADERA BASIN 16 SOUTH SUMP DISCHARGE POINT. AS A RESULT, THE PEAK DISCHARGE FROM THE PROPOSED BUSBAY WILL PASS LONG BEFORE THE PEAK OF THE UPSTREAM WATERSHED, THAT EXTENDS WEST TO UNSER BLVD. IN CONCLUSION, THE MINOR INCREASE IN RUNOFF (1.7 CFS) GENERATED BY THE NEW BUSBAY AND DISCHARGED INTO THE WESTERN TRAIL PUBLIC STORM DRAIN WILL HAVE LITTLE TO NO IMPACT ON THE CAPACITY OF THAT MUCH LARGER EXISTING SYSTEM.

SUB-BASIN 4-B-SOUTH CONSISTS OF THE REMAINDER OF BASIN 4-B INCLUDING THE NEW TRACK AND FIELD IMPROVEMENTS PLAN DATED 12-23-2011 AND APPROVED 12-30-2011. DRAINAGE FROM SUB-BASIN 4-B-SOUTH WILL SHEETFLOW FROM WEST TO EAST PER THE 2011 PLAN TO FREE DISCHARGE DIRECTLY TO THE LADERA BASIN 16 SOUTH SUMP.

THE PROJECT WILL NOT AFFECT OFFSITE FLOWS. THEREFORE, NO OFFSITE FLOWS ARE ANTICIPATED.

VI. GRADING PLAN

THE GRADING PLAN SHOWS 1.) EXISTING GRADES INDICATED BY SPOT ELEVATIONS AND CONTOURS AT 1'-0" INTERVALS, 2.) PROPOSED GRADES FOR THE TRACK AND FIELD TAKEN FROM THE PLAN DATED 12-23-2011 3.) PROPOSED GRADES INDICATED BY SPOT ELEVATIONS AND CONTOURS AT 1'-0" INTERVALS, 4.) THE LIMIT AND CHARACTER OF THE EXISTING IMPROVEMENTS, 5.) THE LIMIT AND CHARACTER OF THE PROPOSED TRACK AND FIELD TAKEN FROM THE PLAN DATE 12-23-2011, 6.) THE LIMIT AND CHARACTER OF THE PROPOSED IMPROVEMENTS, AND 7.) CONTINUITY BETWEEN EXISTING AND PROPOSED GRADES.

VII. CALCULATIONS

THE CALCULATIONS CONTAINED HEREON ANALYZE THE EXISTING AND DEVELOPED CONDITIONS FOR THE 100-YEAR, 6-HOUR RAINFALL EVENT FOR THE PROJECT SITE. THE PROCEDURE FOR 40 ACRE AND SMALLER BASINS, AS SET FORTH IN THE REVISION OF SECTION 22.2, HYDROLOGY OF THE DEVELOPMENT PROCESS MANUAL, VOLUME 2, DESIGN CRITERIA, DATED JANUARY, 1993, HAS BEEN USED TO QUANTIFY THE PEAK RATE OF DISCHARGE AND VOLUME OF RUNOFF GENERATED. AS DEMONSTRATED BY THESE CALCULATIONS, THE PROPOSED IMPROVEMENTS WILL RESULT IN A MINOR INCREASE IN THE PEAK RATE OF DISCHARGE AND VOLUME OF RUNOFF GENERATED BY THIS PROJECT SITE. THE PROPOSED STORM DRAIN CAPACITY WAS CALCULATED USING MANNING'S EQUATION. THE PROPOSED STORM INLET CAPACITY WAS CALCULATED USING THE ORIFICE EQUATION. AS DEMONSTRATED BY THE CALCULATIONS HEREIN, THE 12" RCP PRIVATE STORM DRAIN AND THE PRIVATE STORM INLET HAVE SUFFICIENT CAPACITY TO DISCHARGE THE PEAK DISCHARGE FROM SUB-BASIN B-4-NORTH ($Q_{100} = 1.7$ CFS) IN THE DEVELOPED CONDITION.

VIII. CONCLUSIONS

THE FOLLOWING CONCLUSIONS HAVE BEEN ESTABLISHED AS A RESULT OF THE EVALUATIONS AND ANALYSES CONTAINED HEREIN:

1. THE SITE DOES NOT LIE WITHIN A DESIGNATED FLOOD HAZARD ZONE.
2. THE FREE DISCHARGE OF DEVELOPED RUNOFF FROM THIS SITE TO THE LADERA BASIN 16 SOUTH SUMP IS CONSISTENT WITH PRIOR SUBMITTALS AS LISTED ABOVE.
3. SUB-BASIN 4-B-NORTH (THE PROJECT SITE) WILL NO LONGER SHEETFLOW DIRECTLY TO THE LADERA BASIN 16 SOUTH SUMP, BUT WILL DISCHARGE TO THE LADERA BASIN 16 SOUTH SUMP VIA PRIVATE SD CONNECTION TO THE EXISTING PUBLIC STORM DRAIN IN WESTERN TRAIL NW.
4. THE NEW PRIVATE 12" RCP STORM DRAIN HAS SUFFICIENT CAPACITY ($Q_{12" SD} = 5.1$ CFS) TO DISCHARGE THE DEVELOPED PEAK DISCHARGE FROM SUB-BASIN 4-B-NORTH ($Q_{100} = 1.7$ CFS).
5. THE NEW PRIVATE STORM INLET HAS SUFFICIENT CAPACITY ($Q_{INLET} = 33.8$ CFS) TO DISCHARGE THE DEVELOPED PEAK DISCHARGE FROM SUB-BASIN 4-B-NORTH ($Q_{100} = 1.7$ CFS).
6. SUB-BASIN 4-B-SOUTH WILL CONTINUE TO FREE DISCHARGE VIA SHEETFLOW DIRECTLY TO THE LADERA BASIN 16 SOUTH SUMP PER THE 2011 APPROVED TRACK & FIELD IMPROVEMENTS PLAN. THE TRACK & FIELD SHALL BE CONSTRUCTED PRIOR TO OR IN CONCURRENCE WITH THE NEW BUSBAY.
7. THE PROPOSED IMPROVEMENTS WILL RESULT IN A MINOR INCREASE IN PEAK DISCHARGE AND VOLUME OF RUNOFF GENERATED BY AND DISCHARGING FROM THE SITE DUE TO A MINOR INCREASE IN IMPERVIOUS LAND TREATMENT. IT IS NOTED THAT THE 2011 TRACK AND FIELD IMPROVEMENTS PLAN TO SUB-BASIN 4-B-SOUTH WILL RESULT IN A MINOR DECREASE OF RUNOFF GENERATED BY AND DISCHARGING FROM THE SITE.
8. THE PROPOSED IMPROVEMENTS WILL NOT ADVERSELY IMPACT DOWNSTREAM PROPERTIES OR CONDITIONS

CALCULATIONS

I. SITE CHARACTERISTICS

A. PRECIPITATION ZONE = 1

B. $P_{8,100} = P_{360} = 2.20$

C. TOTAL PROJECT AREA (A_T) = 18,425 SF
0.42 AC

D. EXISTING LAND TREATMENT

1. SUB-BASIN 4-B-NORTH (PROJECT SITE)
AREA = 18,425 SF = 0.42 AC

TREATMENT	AREA (SF/AC)	%
C	18,425 / 0.42	100

E. DEVELOPED LAND TREATMENT

1. SUB-BASIN 4-B-NORTH
AREA = 18,425 SF = 0.42 AC

TREATMENT	AREA (SF/AC)	%
C	4,875 / 0.11	26
D	13,550 / 0.31	74

II. HYDROLOGY

A. EXISTING CONDITION

1. SUB-BASIN 4-B-NORTH

a. VOLUME

$$E_w = (E_p A_A + E_p A_B + E_c A_C + E_D A_D) / A_T$$
$$E_w = ((0.44 * 0.00) + (0.67 * 0.00) + (0.99 * 0.42) + (1.97 * 0.00)) / 0.42 = 0.99 \text{ IN}$$
$$V_{100} = (E_w / 12) A_T = (0.99 / 12) 0.42 = 0.0349 \text{ AC-FT} = 1,520 \text{ CF}$$

b. PEAK DISCHARGE

$$Q_p = Q_{pA} A_A + Q_{pB} A_B + Q_{pC} A_C + Q_{pD} A_D$$
$$Q_p = Q_{100} = ((1.29 * 0.00) + (2.03 * 0.00) + (2.87 * 0.42) + (4.37 * 0.00)) = 1.2 \text{ CFS}$$

B. DEVELOPED CONDITION

1. SUB-BASIN 4-B-NORTH

a. VOLUME

$$E_w = (E_p A_A + E_p A_B + E_c A_C + E_D A_D) / A_T$$
$$E_w = ((0.44 * 0.00) + (0.67 * 0.00) + (0.99 * 0.11) + (1.97 * 0.31)) / 0.42 = 1.71 \text{ IN}$$
$$V_{100} = (E_w / 12) A_T = (1.71 / 12) 0.42 = 0.0599 \text{ AC-FT} = 2,630 \text{ CF}$$

b. PEAK DISCHARGE

$$Q_p = Q_{pA} A_A + Q_{pB} A_B + Q_{pC} A_C + Q_{pD} A_D$$
$$Q_p = Q_{100} = ((1.29 * 0.00) + (2.03 * 0.00) + (2.87 * 0.11) + (4.37 * 0.31)) = 1.7 \text{ CFS}$$

c. 12" RCP STORM DRAIN CAPACITY (USING MANNING'S EQUATION)

$$Q_{12" SD} = 1.49 n * A * R^{2/3} * S^{1/2}$$
$$n = 0.013$$
$$A = 0.79 \text{ SF}$$
$$P = 3.14 \text{ FT}$$
$$R = A/P = 0.79 / 3.14 = 0.25 \text{ FT}$$
$$S = 0.0200 \text{ FT/FT}$$
$$Q_{12" SD} = 1.49 * 0.013 * 0.79 * 0.25^{2/3} * 0.0200^{1/2}$$

$$Q_{12" SD} = 5.1 \text{ CFS} > Q_{100} = 1.7 \text{ CFS} \therefore \text{OK}$$

d. SINGLE 'C' STORM INLET CAPACITY (USING ORIFICE EQUATION)

$$Q_{INLET} = C * A * (2 * g * h)^{1/2}$$
$$C = 0.8$$
$$A = 8.6 \text{ SF}$$
$$g = 32.2 \text{ FT/SEC}$$
$$h = 0.67 \text{ FT}$$
$$Q_{INLET} = 0.6 * 8.6 * (2 * 32.2 * 0.67)^{1/2}$$

$$Q_{INLET} = 33.8 \text{ CFS} > Q_{100} = 1.7 \text{ CFS} \therefore \text{OK}$$

C. COMPARISON

1. DEV SUB-BASIN 4-B-NORTH - EXIST SUB-BASIN 4-B-NORTH

a. VOLUME
 $\Delta V_{100} = 2630 - 1520 = 1,110 \text{ CF}$ (INCREASE)

b. PEAK DISCHARGE
 $\Delta Q_{100} = 1.7 - 1.2 = 0.5 \text{ CFS}$ (INCREASE)

SCANNED BY
PLANNING

CONSTRUCTION NOTES

1. TWO (2) WORKING DAYS PRIOR TO ANY EXCAVATION, CONTRACTOR MUST CONTACT NEW MEXICO ONE CALL SYSTEM 260-1990 FOR DESIGNATION (LINE-SPOTTING) OF EXISTING PUBLIC UTILITIES AND EXISTING UTILITIES OWNED AND OPERATED BY ALBUQUERQUE PUBLIC SCHOOLS.
2. PRIOR TO CONSTRUCTION, THE CONTRACTOR SHALL EXCAVATE AND VERIFY THE HORIZONTAL AND VERTICAL LOCATION OF ALL POTENTIAL OBSTRUCTIONS. SHOULD A CONFLICT EXIST, THE CONTRACTOR SHALL NOTIFY THE ENGINEER IN WRITING SO THAT THE CONFLICT CAN BE RESOLVED WITH A MINIMUM AMOUNT OF DELAY. THE CONTRACTOR SHALL BE RESPONSIBLE FOR ALL INTERPRETATIONS IT MAKES WITHOUT FIRST CONTACTING THE ENGINEER AS REQUIRED ABOVE.
3. ALL WORK ON THIS PROJECT SHALL BE PERFORMED IN ACCORDANCE WITH APPLICABLE FEDERAL, STATE AND LOCAL LAWS, RULES AND REGULATIONS CONCERNING CONSTRUCTION SAFETY AND HEALTH.
4. ALL CONSTRUCTION WITHIN PUBLIC RIGHT-OF-WAY SHALL BE PERFORMED IN ACCORDANCE WITH APPLICABLE C.O.A. STANDARDS AND PROCEDURES.
5. IF ANY UTILITY LINES, PIPELINES, OR UNDERGROUND UTILITY LINES ARE SHOWN ON THESE DRAWINGS, THEY ARE SHOWN IN AN APPROXIMATE MANNER ONLY, AND SUCH LINES MAY EXIST WHERE NONE ARE SHOWN. IF ANY SUCH EXISTING LINES ARE SHOWN, THE LOCATION IS BASED UPON INFORMATION PROVIDED BY THE OWNER OF SAID UTILITY, AND THE INFORMATION MAY BE INCOMPLETE, OR MAY BE OBSOLETE BY THE TIME CONSTRUCTION COMMENCES. THE ENGINEER HAS CONDUCTED ONLY PRELIMINARY INVESTIGATION OF THE LOCATION, DEPTH, SIZE, OR TYPE OF EXISTING UTILITY LINES, PIPELINES, OR UNDERGROUND UTILITY LINES. THIS INVESTIGATION IS NOT CONCLUSIVE, AND MAY NOT BE COMPLETE. THEREFORE, MAKES NO REPRESENTATION PERTAINING THERETO, AND ASSUMES NO RESPONSIBILITY OR LIABILITY THEREOF. THE CONTRACTOR SHALL INFORM ITSELF OF THE LOCATION OF ANY UTILITY LINE, PIPELINE, OR UNDERGROUND UTILITY LINE IN OR NEAR THE AREA OF THE WORK IN ADVANCE OF AND DURING EXCAVATION WORK. THE CONTRACTOR IS FULLY RESPONSIBLE FOR ANY AND ALL DAMAGE CAUSED BY ITS FAILURE TO LOCATE, IDENTIFY AND PRESERVE ANY AND ALL EXISTING UTILITIES, PIPELINES, AND UNDERGROUND UTILITY LINES. IN PLANNING AND CONDUCTING EXCAVATION, THE CONTRACTOR SHALL COMPLY WITH STATE STATUTES, MUNICIPAL AND LOCAL ORDINANCES, RULES AND REGULATIONS, IF ANY, PERTAINING TO THE LOCATION OF THESE LINES AND FACILITIES.

EROSION NOTES

1. THIS PLAN ADDRESSES GENERAL AND SPECIFIC MEASURES FOR CONSTRUCTION PHASE EROSION AND DUST CONTROL. REFER TO THE GRADING AND DRAINAGE PLAN PREPARED BY HIGH MESA CONSULTING GROUP, FOR GRADING NOTES AND INFORMATION.
2. THE CONTRACTOR SHALL ENSURE THAT NO SOIL ERODES FROM THE SITE INTO PUBLIC RIGHT-OF-WAY OR ONTO PRIVATE PROPERTY.
3. THE CONTRACTOR SHALL PROMPTLY CLEAN UP ANY MATERIAL EXCAVATED WITHIN THE PUBLIC RIGHT-OF-WAY SO THAT THE EXCAVATED MATERIAL IS NOT SUSCEPTIBLE TO BEING WASHED DOWN THE STREET.
4. CONCRETE TRUCKS SHALL BE SENT BACK TO PLANT FOR WASHING. THE WASHING OF CONCRETE TRUCKS SHALL NOT BE PERMITTED ON THIS SITE.

PHASING PLAN

IT IS PROPOSED TO CONSTRUCT SEVERAL SITE IMPROVEMENT PROJECTS ON THE CHAPARRAL ELEMENTARY SCHOOL SITE IN ADVANCE OF A LARGER KINDERGARTEN CLASSROOM ADDITION. THE PROPOSED CLASSROOM ADDITION WILL REQUIRE THE DEMOLITION OF A NUMBER OF SITE IMPROVEMENTS NECESSARY TO THE OPERATION OF THE SCHOOL SITE WHILE THE NEW WORK IS UNDER CONSTRUCTION. AS A RESULT, SEVERAL EARLY WORK PROJECTS ARE BEING DESIGNED AND CONSIDERED FOR CONSTRUCTION. THE SCHOOL BUSBAY, ONE OF THOSE PROJECTS, IS CURRENTLY A TEMPORARY GRAVEL FACILITY. IT IS DESIRED TO CONSTRUCT A PERMANENT BUSBAY FOR SCHOOL BUSES TO INTEGRATE WITH THE GRADING AND DRAINAGE OF THE NEW TRACK AND FIELD AS WELL AS THE OVERALL TRAFFIC CIRCULATION PLAN FOR THE SITE UNDER FULL BUILD-OUT.

THE EARLY WORK PROJECTS WILL BE CONSTRUCTED IN PHASES, THE SEQUENCING OF WHICH IS CONTINGENT UPON AVAILABLE FUNDING. THE TENTATIVE PRIORITY AND THEREFORE SEQUENCE FOR CONSTRUCTION IS LISTED BELOW:

1. TRACK AND FIELD IMPROVEMENTS, 12-22-2011 (F10/D005)
2. PUBLIC WATER LINE EXTENSIONS, 02-29-2012 (CPN 732684)
3. PARENT DROP-OFF AND PARKING LOT EXPANSION, 10-08-2010 (F10/D005)
4. WESTERN TRAIL IMPROVEMENTS (CPN 732685)

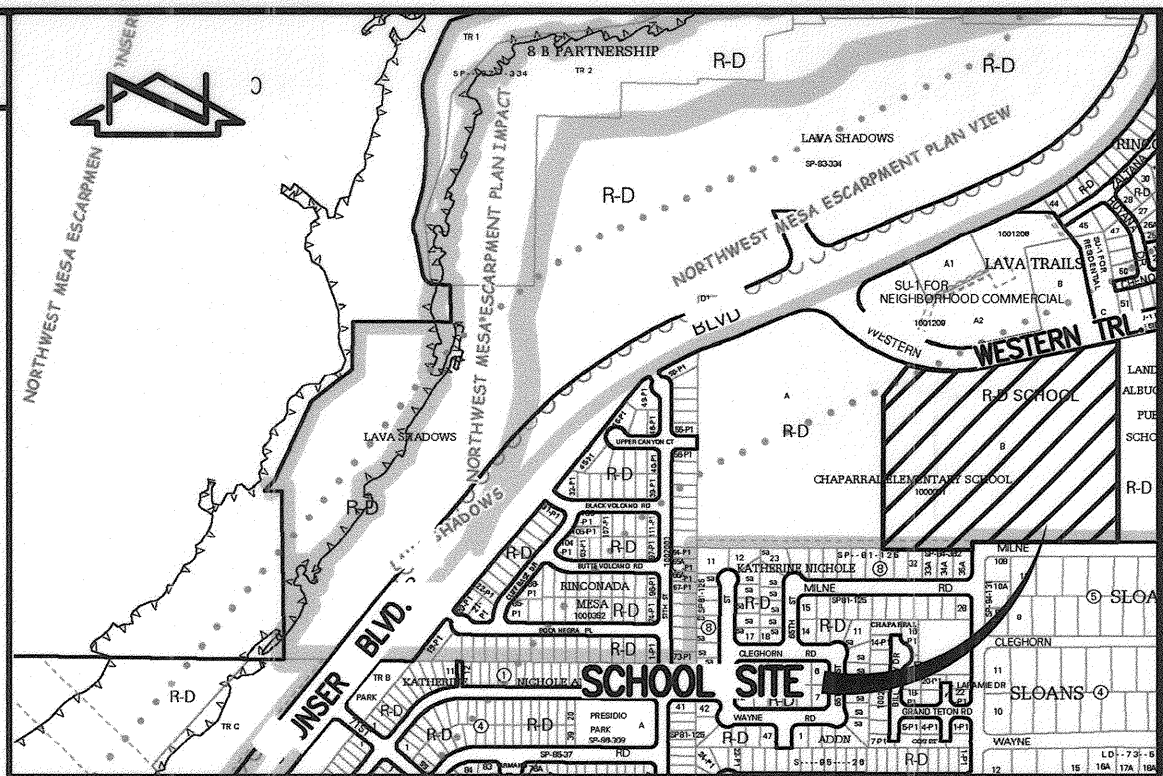

VICINITY MAP

SCALE: 1" = 750'

F-10

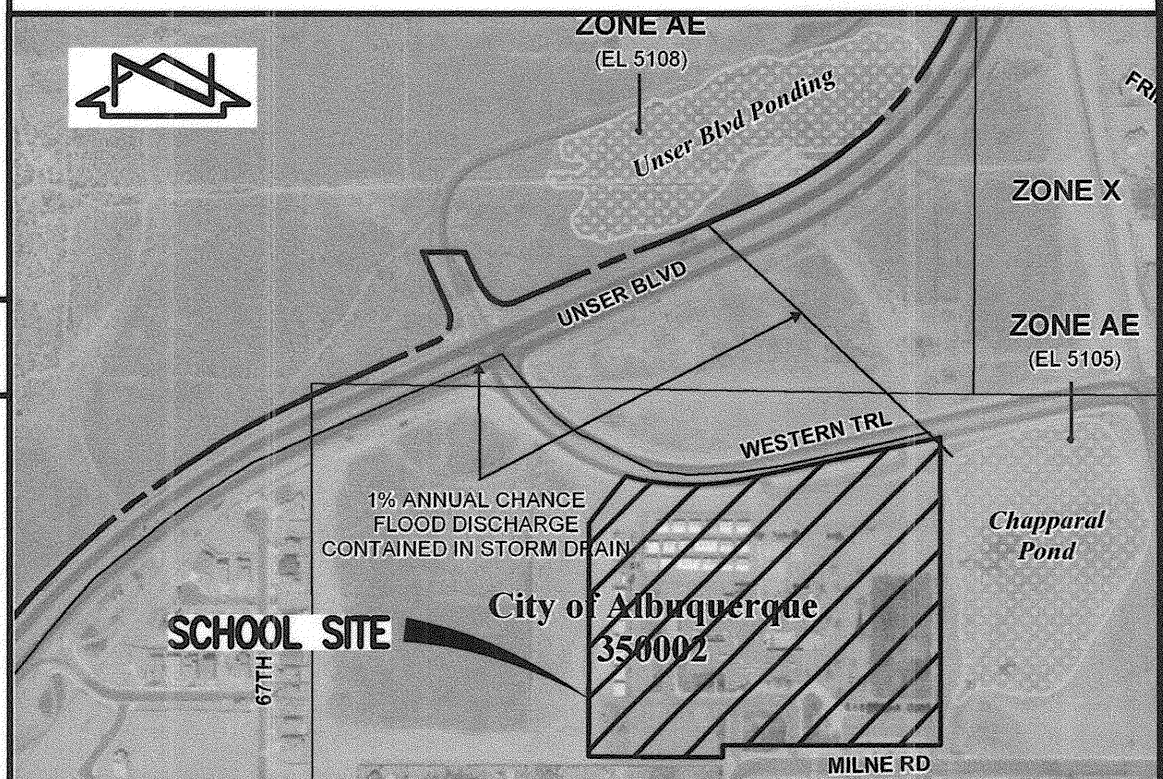

F.I.R.M.

SCALE: 1" = 500'

PANEL 114 OF 825

DATE 09-26-2008

LEGAL DESCRIPTION

TRACTS A AND B, CHAPARRAL ELEMENTARY SCHOOL, ALBUQUERQUE, NEW MEXICO, AS THE SAME IS SHOWN AND DESIGNATED ON THE PLAT FILED IN THE OFFICE OF THE COUNTY CLERK OF BERNALILLO COUNTY, NEW MEXICO ON JANUARY 11, 2000, BOOK 2000C, PAGE 9.

BENCHMARKS

PROJECT BENCHMARK

CITY OF ALBUQUERQUE SURVEY CONTROL 1 3/4" METALLIC DISK STAMPED "ACS BM, 15-F11", EPOXIED TO TOP OF CURB 5.20 FEET SOUTH OF THE SSE CURB RETURN OF ATRISCO ROAD N.W. AND WESTERN TRAIL N.W. ELEVATION = 5110.03 FEET (NAVD 88)

TEMPORARY BENCHMARK #1 (T.B.M.)

A SPIKE WITH JMA CONTROL CAP STAMPED "NMPS #11184", LOCATED IN MEDIAN OF WESTERN TRAIL N.W. NORTH OF TRACT B. ELEVATION = 5113.74 FEET (NAVD 88)

TEMPORARY BENCHMARK #2 (T.B.M.)

A CHISELED "C" ON TOP OF STORM INLET LOCATED AT THE SE INTERSECTION OF UNSER BOULEVARD N.W. AND WESTERN TRAIL N.W. ELEVATION = 5111.62 FEET (NAVD 88)

TEMPORARY BENCHMARK #3 (T.B.M.)

A CHISELED "+" LOCATED AT THE SE PROPERTY CORNER, TRACT B. ELEVATION = 5109.70 FEET (NAVD 88)

APPROVED AS RECORD DRAWINGS
DESIGN REVIEW SECTION
CITY CONSTRUCTION ENGINEER
DATE: 01-03-2013



RECORD DRAWING

CITY PROJECT No. 732685

DESIGNED BY	J.G.M.	NO.	DATE	BY	REVISIONS	JOB NO.
DRAWN BY	E.J.S.	1	04/12	B.E.E.	RECORD DRAWING	2009.004.4
APPROVED BY	J.G.M.					DATE 03-2012
						SHEET 10 OF 10

HIGH MESA Consulting Group

6010-B MIDWAY PARK BLVD. NE • ALBUQUERQUE, NEW MEXICO 87109
PHONE: 505.345.4250 • FAX: 505.345.4254 • www.highmesacg.com

DRAINAGE PLAN AND CALCULATIONS WESTERN TRAIL PAVING IMPROVEMENTS CHAPARRAL ELEMENTARY SCHOOL

File Path: P:\090445H\10-AB.DWG Plot Date: 01-04-2013 Plot Time: 3:56 pm