

## ABBREVIATIONS

A	=	AIR LINE
AD	=	AREA DRAIN
ALP	=	ABANDONED IN PLACE
BLDG	=	BUILDING
BM	=	BENCHMARK
CATV	=	CABLE TELEVISION LINE
CIP	=	CAST IRON PIPE
CMP	=	CORRUGATED METAL PIPE
CMPA	=	CORRUGATED METAL PIPE ARCH
CO	=	CLEANOUT
COA	=	CITY OF ALBUQUERQUE
CONC	=	CONCRETE
CL	=	CENTERLINE
DIA	=	DIAMETER
DIP	=	DUCTILE IRON PIPE
DTL	=	DETAIL
DWG	=	DRAWING
EG	=	EXISTING GRADE
ELEC.	=	ELECTRIC
ELEV	=	ELEVATION
EX	=	EXISTING
FF	=	FINISHED FLOOR ELEVATION
FG	=	FINISHED GRADE
FH	=	FIRE HYDRANT
FL	=	FLOW LINE
G	=	GAS PIPE
GM	=	GAS METER
GV	=	GATE VALVE
HI PT	=	HIGH POINT
INV	=	INVERT ELEVATION
LF	=	LINEAL FEET
LP	=	LIGHT POLE
L/S	=	LANDSCAPING
MH	=	MANHOLE
NG	=	NATURAL GROUND
OE	=	OVERHEAD ELECTRIC LINE
OT	=	OVERHEAD TELEPHONE LINE
PB	=	ELECTRICAL PULL BOX
PCC	=	PORTLAND CEMENT CONCRETE
PP	=	POWER POLE
PROP	=	PROPOSED
PVC	=	POLYVINYL CHLORIDE PIPE
RCP	=	REINFORCED CONCRETE PIPE
R/W	=	RIGHT-OF-WAY
S	=	SLOPE
SAS	=	SANITARY SEWER
SD	=	STORM DRAIN
STA	=	STATION
STD	=	STANDARD
SW	=	SIDEWALK
T	=	TELEPHONE
TA	=	TOP OF ASPHALT PAVEMENT
TAC	=	TOP OF ASPHALT CURB
TC	=	TOP OF CONCRETE SLAB (PAVEMENT)
TCC	=	TOP OF CONCRETE CURB
TS	=	TOP OF SIDEWALK
TW	=	TOP OF WALL
TYP	=	TYPICAL
UE	=	UNDERGROUND ELECTRIC
UT	=	UNDERGROUND TELEPHONE
W	=	WATER
WM	=	WATER METER
WV	=	WATER VALVE

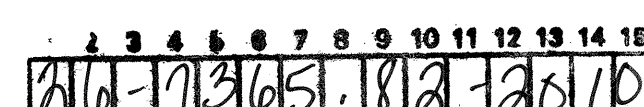

## NMEFCU LAMONICA/COORS

CITY OF ALBUQUERQUE,  
IMPROVEMENTS FOR PAVING,  
ON LAMONICA ROAD S.W.

## INDEX TO DRAWINGS

SHEET NO.	DESCRIPTION
1	COVER SHEET AND INDEX TO DRAWINGS
2	PLAT
3	LAMONICA DEMOLITION AND GRADING PLANS
4	LAMONICA PAVING PLAN AND PROFILE
5	LAMONICA STRIPING PLAN
6	UTILITY EXTENSION PLAN AND PROFILE
6a	TRAFFIC LIGHT WIRING AS-BUILT

I, David Aube of the firm The Hartman + Majewski Design Group, hereby certify that this project is in substantial compliance with, and in accordance with the design intent of the Public Work Order Plans dated 9-23-08.

The record information presented hereon is not necessarily complete and intended only to verify substantial compliance of this project. Those relying on the record documents are advised to obtain independent verification of its accuracy before using it for any other purpose.

## LEGEND

=====	NEW CURB AND GUTTER & SIDEWALK
=====	EX CURB AND GUTTER & SIDEWALK
●	PROP FIRE HYDRANT
✕	PROP WATER VALVE
=====	PROPERTY LINE
●	EX SAS MANHOLE
●	PROP SAS MANHOLE
■	PROP WATER METER

(S 83°39'25" W) RECORD BEARING AND DISTANCES

— SS —	PROPOSED SANITARY SEWER LINE
— EX SAS —	EX SANITARY SEWER LINE
— DWS —	PROPOSED WATER LINE
— EX WL —	EX WATER LINE

N 00°07'27" W MEASURED BEARING AND DISTANCES



3-16-2010

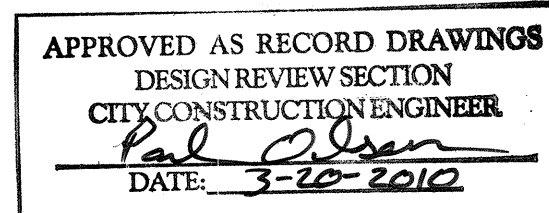

## GENERAL NOTES

- ALL WORK DETAILED ON THESE PLANS TO BE PERFORMED, EXCEPT AS OTHERWISE STATED OR PROVIDED HEREON, SHALL BE CONSTRUCTED IN ACCORDANCE WITH CITY OF ALBUQUERQUE STANDARD SPECIFICATIONS FOR PUBLIC WORKS CONSTRUCTION, 1986 EDITION (UPDATE #7 INCLUDING AMENDMENT 1) THROUGH MOST RECENT UPDATE (#7) AND WILL BE REFERRED TO HEREIN AS "STANDARD SPECIFICATIONS".
- ALL CONSTRUCTION WITHIN CITY RIGHT-OF-WAY OR EASEMENTS MUST BE DONE FROM APPROVED WORK ORDER DOCUMENTS FROM THE CITY.
- ALL WORK ON THIS PROJECT SHALL BE PERFORMED IN ACCORDANCE WITH APPLICABLE FEDERAL, STATE, AND LOCAL LAWS, ORDINANCES, RULES, AND REGULATIONS CONCERNING CONSTRUCTION SAFETY AND HEALTH.
- CONTRACTOR AGREES THAT HE SHALL ASSUME THE SOLE AND COMPLETE RESPONSIBILITY FOR THE JOB SITE CONDITIONS DURING THE COURSE OF CONSTRUCTION OF THIS PROJECT, INCLUDING SAFETY OF ALL PERSONS AND PROPERTY. THIS REQUIREMENT SHALL APPLY CONTINUOUSLY AND NOT BE LIMITED TO NORMAL WORKING HOURS. CONTRACTOR SHALL DEFEND, INDEMNIFY, AND HOLD HARMLESS THE OWNER AND ENGINEER FROM ANY AND ALL LIABILITY REAL OR ALLEGED, IN CONNECTION WITH THE PERFORMANCE OF WORK ON THIS PROJECT, EXCEPT LIABILITY ARISING FROM THE SOLE NEGLIGENCE OF THE OWNER OR ENGINEER.
- ALL EXCAVATION, TRENCHING, AND SHORING ACTIVITIES MUST BE ACCOMPLISHED IN ACCORDANCE WITH OSHA 29CFR 1926.650 SUBPART F.
- AN EXCAVATION/CONSTRUCTION PERMIT WILL BE REQUIRED BEFORE BEGINNING ANY WORK WITHIN CITY RIGHT-OF-WAY.
- CONTRACTOR SHALL SECURE A "TOPSOIL DISTURBANCE PERMIT" PRIOR TO BEGINNING CONSTRUCTION (IF REQUIRED BY CITY OF ALBUQUERQUE PUBLIC WORKS).
- PERMIT REQUESTS MAY BE DENIED OR DELAYED DUE TO CONFLICTS WITH OTHER PROJECTS IN THE AREA.
- CONTRACTOR SHALL NOTIFY THE ENGINEER NOT LESS THAN SEVEN (7) DAYS PRIOR TO STARTING WORK IN ORDER THAT THE CITY SURVEYOR MAY TAKE NECESSARY MEASURES TO INSURE THE PRESERVATION OF SURVEY MONUMENTS. CONTRACTOR SHALL NOT DISTURB PERMANENT SURVEY MONUMENTS WITHOUT THE CONSENT OF THE CITY SURVEYOR AND SHALL NOTIFY THE CITY SURVEYOR AND BEAR THE EXPENSE OF REPLACING ANY THAT MAY BE DISTURBED WITHOUT PERMISSION. ONLY THE CITY SURVEYOR SHALL REPLACE SURVEY MONUMENTS. WHEN A CHANGE IS MADE IN THE FINISHED ELEVATIONS OF THE PAVEMENT OF ANY ROADWAY IN WHICH A PERMANENT SURVEY MONUMENT IS LOCATED, CONTRACTOR SHALL, AT HIS OWN EXPENSE, ADJUST THE MONUMENT COVER TO THE NEW GRADE UNLESS OTHERWISE SPECIFIED. REFER TO STANDARD SPECIFICATIONS SECTION 4.4.
- CONTRACTOR SHALL COORDINATE WITH WATER AUTHORITY (857-8200) SEVEN (7) WORKING DAYS PRIOR TO ANY WORK THAT MAY AFFECT EXISTING CITY PUBLIC WATER OR SEWER UTILITIES. CONTRACTOR SHALL BE RESPONSIBLE FOR TIMING AND COORDINATION OF WATER SHUTOFF. EXISTING ABCWA VALVES TO BE OPERATED BY WATER AUTHORITY PERSONNEL ONLY.
- SEVEN (7) WORKING DAYS PRIOR TO BEGINNING CONSTRUCTION, CONTRACTOR SHALL SUBMIT TO CONSTRUCTION COORDINATION DIVISION A DETAILED CONSTRUCTION SCHEDULE. TWO (2) WORKING DAYS PRIOR TO CONSTRUCTION, CONTRACTOR SHALL OBTAIN A BARRICADING PERMIT FROM THE CONSTRUCTION COORDINATION DIVISION. CONTRACTOR SHALL NOTIFY BARRICADE ENGINEER (924-3400) PRIOR TO OCCUPYING AN INTERSECTION. REFER TO SECTION 19 OF STANDARD SPECIFICATIONS.
- CONTRACTOR SHALL DETERMINE IN ADVANCE OF HIS CONSTRUCTION IF OVERHEAD UTILITY LINES, SUPPORT STRUCTURES, POLES, GUYS, ETC. ARE AN OBSTRUCTION TO CONSTRUCTION OPERATIONS. IF ANY OBSTRUCTION TO CONSTRUCTION OPERATIONS IS EVIDENT, CONTRACTOR SHALL BE RESPONSIBLE FOR COORDINATING WITH THE APPROPRIATE UTILITY OWNER TO REMOVE OR SUPPORT THE UTILITY OBSTRUCTION. ANY COST ASSOCIATED WITH THIS EFFORT SHALL BE THE RESPONSIBILITY OF CONTRACTOR.
- PNM WILL PROVIDE AT NO COST TO THE CITY OR THE CONTRACTOR THE REQUIRED PERSONNEL FOR INSPECTION OR OBSERVATION DEEMED NECESSARY BY PNM WHILE THE CONTRACTOR IS EXPOSING PNM'S CABLES. HOWEVER, THE CONTRACTOR SHALL BE CHARGED THE TOTAL COST ASSOCIATED WITH REPAIRS TO ANY DAMAGED CABLES OR FOR ANY COST ASSOCIATED WITH SUPPORTING OR RELOCATING THE POLES AND CABLES DURING CONSTRUCTION.
- TWO (2) WORKING DAYS PRIOR TO ANY EXCAVATION, CONTRACTOR MUST CONTACT NEW MEXICO ONE CALL SYSTEM (260-1990) FOR LOCATION OF EXISTING UTILITIES.
- PRIOR TO CONSTRUCTION, CONTRACTOR SHALL EXCAVATE AND VERIFY THE HORIZONTAL AND VERTICAL LOCATIONS OF ALL PERTINENT EXISTING UTILITIES AND/OR OBSTRUCTIONS. SHOULD A CONFLICT EXIST, THE CONTRACTOR SHALL NOTIFY THE ENGINEER SO THE CONFLICT CAN BE RESOLVED WITH A MINIMUM AMOUNT OF DELAY.
- EXISTING UTILITY LINE LOCATION ARE SHOWN IN AN APPROXIMATE MANNER ONLY AND SUCH LINES MAY EXIST WHERE NONE ARE SHOWN. THE LOCATION OF ANY SUCH EXISTING LINES IS BASED UPON INFORMATION PROVIDED BY THE UTILITY COMPANY, THE OWNER, OR BY OTHERS, AND THE INFORMATION MAY BE INCOMPLETE OR MAY BE OBSOLETE BY THE TIME CONSTRUCTION COMMENCES.
- THE ENGINEER HAS UNDERTAKEN NO FIELD VERIFICATION OF THE LOCATION, DEPTH, SIZE, OR TYPE OF EXISTING UNDERGROUND UTILITY LINES, MAKES NO REPRESENTATION PERTAINING THERETO, AND ASSUMES NO RESPONSIBILITY OR LIABILITY THEREFOR. CONTRACTOR SHALL INFORM ITSELF OF THE LOCATION OF ANY UTILITY LINE IN OR NEAR THE AREA OF THE WORK IN ADVANCE OF AND DURING EXCAVATION WORK. CONTRACTOR IS FULLY RESPONSIBLE FOR ANY AND ALL DAMAGE CAUSED BY ITS FAILURE TO LOCATE, IDENTIFY, AND PRESERVE ANY AND ALL EXISTING UTILITIES.
- CONTRACTOR SHALL SUPPORT ALL EXISTING, UNDERGROUND UTILITY LINES WHICH BECOME EXPOSED DURING CONSTRUCTION. PAYMENT FOR SUPPORTING WORK SHALL BE INCIDENTAL TO WATERLINE AND/OR SEWER LINE COSTS.
- CONTRACTOR IS TO SUPPORT AND MAINTAIN THE INTEGRITY OF ALL UNDERGROUND TELEPHONE, ELECTRIC CABLES AND CABLE TELEVISION UTILITIES AT NO ADDITIONAL COST TO THE OWNER. CABLE IS TO BE SUPPORTED AT A MAXIMUM OF EVERY FIFTEEN (15) FEET. CONTRACTOR SHALL COORDINATE WITH AND MAKE NECESSARY PAYMENT (IF ANY) TO UTILITY OWNER FOR DE-ENERGIZATION OF CABLES OR SUPPORT OF CABLES BY THE UTILITY OWNER.
- CONTRACTOR SHALL ASSIST THE ENGINEER/INSPECTOR IN THE RECORDING OF DATA ON ALL UTILITY LINES AND ACCESSORIES AS REQUIRED BY THE CITY OF ALBUQUERQUE FOR THE PREPARATION OF "AS CONSTRUCTED" DRAWINGS. CONTRACTOR SHALL NOT COVER UTILITY LINES AND ACCESSORIES UNTIL ALL DATA HAS BEEN RECORDED.
- ALL UTILITIES AND UTILITY SERVICE LINES SHALL BE INSTALLED PRIOR TO PAVING.
- ALL FINAL BACKFILL FOR TRENCHES SHALL BE COMPACTED TO A MINIMUM OF 95% MAXIMUM DENSITY PER ASTM D-1557 AND AS DIRECTED BY STANDARD SPECIFICATIONS SECTION 301.4 AND STANDARD DRAWING NUMBER 2465.
- CONTRACTOR SHALL PROMPTLY CLEAN UP ANY MATERIAL EXCAVATED WITHIN THE PUBLIC RIGHT-OF-WAY OR PRIVATE ROADWAY EASEMENTS SO THAT THE EXCAVATED MATERIAL IS NOT SUSCEPTIBLE TO BEING WASHED DOWN THE STREET OR INTO ANY PUBLIC DRAINAGE FACILITY.

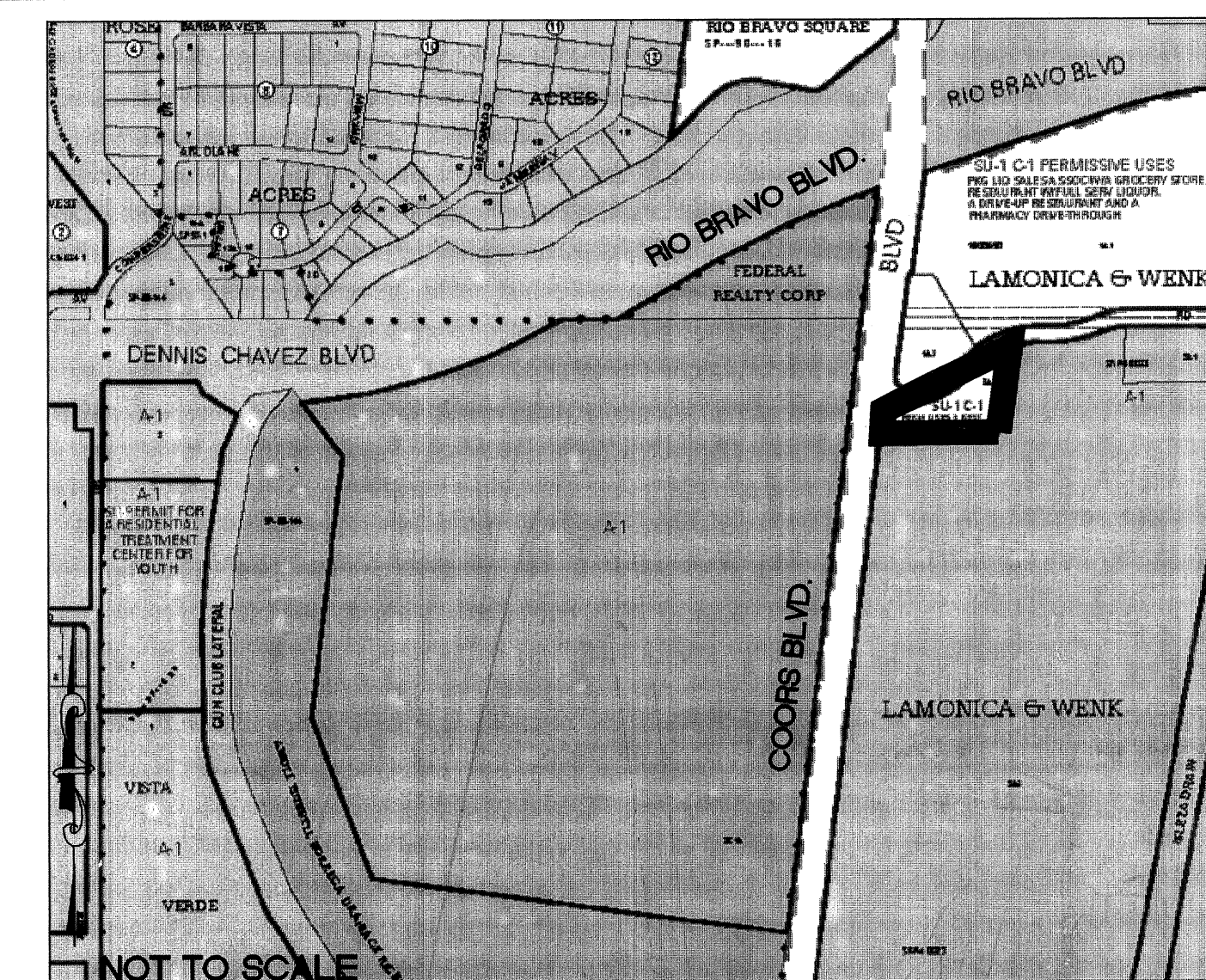

VICINITY MAP

ZONE ATLAS  
P-10-Z

- REMOVALS SHALL BE DISPOSED OF OFF-SITE AND SHALL BE THE RESPONSIBILITY OF THE CONTRACTOR.
- CONTRACTOR SHALL DISPOSE OF ALL UNSUITABLE MATERIAL IN AN ENVIRONMENTALLY ACCEPTABLE MANNER AT A LOCATION ACCEPTABLE TO THE PROJECT MANAGER. THERE WILL BE NO DIRECT COMPENSATION FOR THIS WORK.
- CONTRACTOR SHALL CONDUCT HIS OPERATIONS IN A MANNER WHICH WILL MINIMIZE INTERFERENCE WITH LOCAL TRAFFIC.
- ANY WORK AFFECTING AN ARTERIAL ROADWAY REQUIRES TWENTY-FOUR (24) HOURS OF CONSTRUCTION.
- ALL EXISTING SIGNS, MARKERS, DELINEATORS, ETC., WITHIN THE CONSTRUCTION LIMITS SHALL BE REMOVED, STORED AND RE-SET BY THE CONTRACTOR.
- WHEN ABUTTING EXISTING PAVEMENT TO NEW, SAW CUT EXISTING PAVEMENT TO A STRAIGHT EDGE AND AT A RIGHT ANGLE, OR AS APPROVED BY THE FIELD ENGINEER. REMOVAL OF BROKEN OR CRACKED PAVEMENT WILL ALSO BE REQUIRED.
- REMOVAL OF EXISTING CURB AND GUTTER OR SIDEWALK SHALL BE TO THE NEAREST JOINT OR SAW CUT.
- AT HIS OWN EXPENSE, CONTRACTOR SHALL ASSUME RESPONSIBILITY FOR ANY DAMAGE TO EXISTING PAVEMENT, PAVEMENT MARKINGS, CURB AND GUTTER, HANDICAP RAMPS, AND SIDEWALK DURING CONSTRUCTION APART FROM THOSE SECTIONS INDICATED FOR REMOVAL ON THE PLANS AND SHALL REPAIR OR REPLACE, PER STANDARD SPECIFICATIONS.
- ALL STREET STRIPING, ALTERED OR DESTROYED, SHALL BE REPLACED WITH PLASTIC REFLECTORIZED PAVEMENT MARKINGS BY CONTRACTOR TO SAME LOCATION AS EXISTING, OR AS INDICATED BY THIS PLAN SET.
- CONTRACTOR SHALL MAINTAIN A GRAFFITI-FREE WORK SITE. CONTRACTOR SHALL PROMPTLY REMOVE ANY AND ALL GRAFFITI FROM EQUIPMENT, WHETHER PERMANENT OR TEMPORARY.
- ELECTRONIC MARKER SPHERES (EMS) WILL BE PLACED ACCORDING TO SECTION 170 OF THE CITY OF ALBUQUERQUE STANDARD SPECIFICATIONS FOR PUBLIC WORKS CONSTRUCTION, 1986 EDITION AS REVISED THROUGH UPDATE #7.
- THE CONTRACTOR WILL BE RESPONSIBLE FOR DISPOSING OF ALL DEBRIS, INCLUDING, NOT LIMITED TO HAZARDOUS WASTE AT DISPOSAL SITES APPROVED BY GOVERNMENTAL AGENCIES REGULATING THE DISPOSAL OF SUCH MATERIALS.
- CONTRACTOR SHALL BE RESPONSIBLE FOR PROVIDING AND MAINTAINING ALL CONSTRUCTION SIGNING UNTIL PROJECT HAS BEEN ACCEPTED BY THE CITY.

DRB NO. 1000650

REV.	SHEETS	CITY ENGINEER	DATE	USER DEPT.	DATE	USER DEPT.	DATE
ENGINEER'S SEAL		APPROVALS		ENGINEER		DATE	
		DRC CHAIRMAN		11-26-08		APPROVED FOR CONSTRUCTION  CITY ENGINEER DATE 12-04-08	
		TRANSPORTATION		10-14-08			
		WATER/WASTEWATER		9-29-08			
		HYDROLOGY		9-29-08			
PARKS							
CONSTR. MANAGER							
PROJECT NO. 736582				SHEET 1 OF 6			



SCANNED BY  
PLANNING

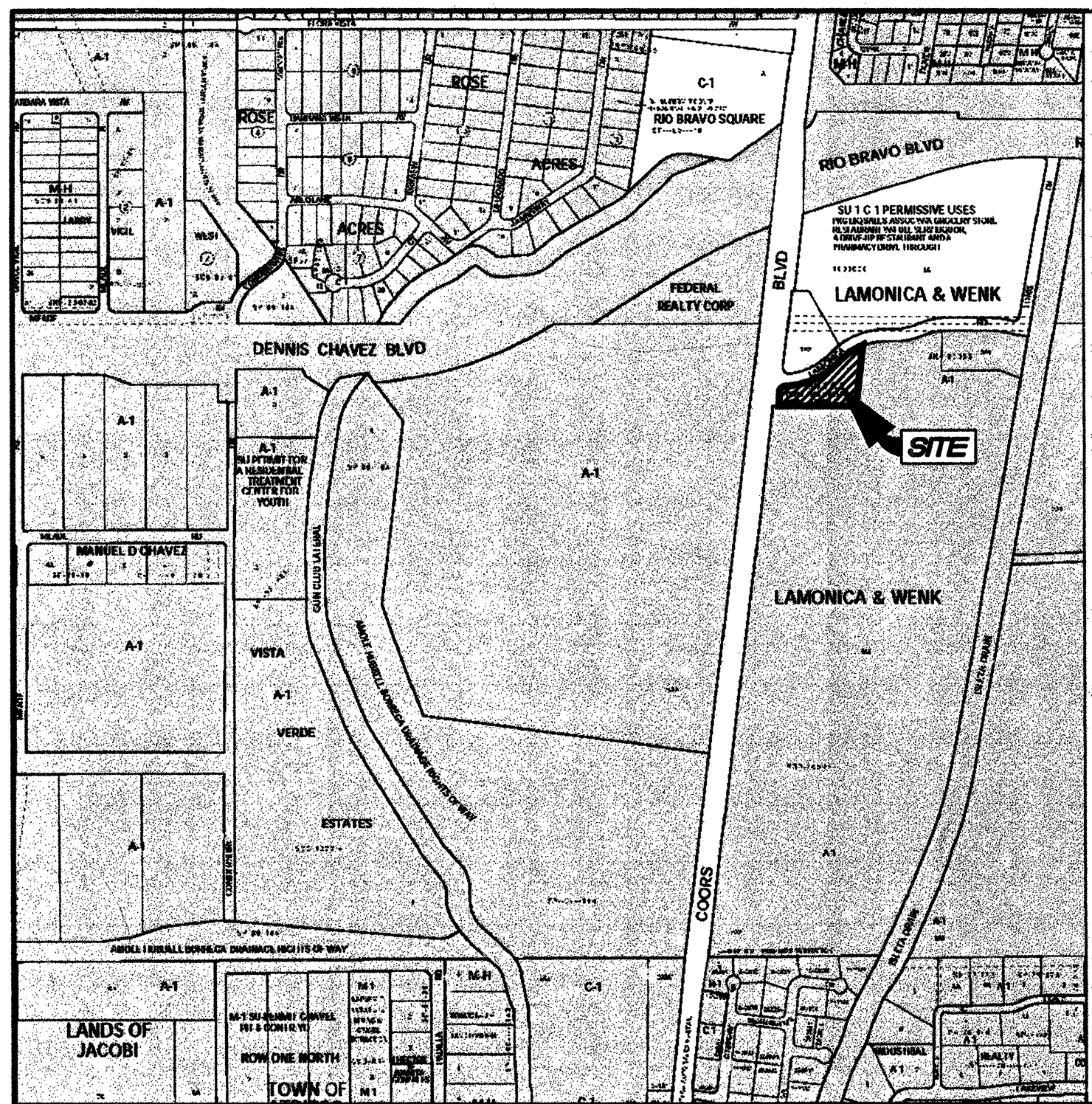

VICINITY MAP  
Not To Scale

CURVE TABLE					
CURVE	LENGTH	RADIUS	TANGENT	CHORD	CHORD BEARING
C1	42.03'	30.00'	25.30'	38.68'	N47°05'56"E
C2	305.26'	410.00'	160.10'	298.26'	N65°54'25"E
C3	142.93'	350.00'	72.47'	141.93'	N56°16'38"E

Existing utility line locations are shown in an approximate manner only, and such lines may or may not exist where shown or not shown. The location of any such existing lines is based on information provided by the utility companies, the owner, visual surface indications or others, and the information may be incomplete or may be obsolete by the time this survey is completed. All utilities should be field verified and spotted by the contractor(s) prior to commencement of any construction.

ALTA/ACSM. LAND TITLE SURVEY OF  
TRACT 2-A  
LANDS OF LAMONICA AND WENK  
WITHIN  
THE TOWN OF ATRISCO GRANT  
IN  
PROJECTED SECTION 10, TOWNSHIP 9 NORTH, RANGE 2 EAST  
NEW MEXICO PRINCIPAL MERIDIAN  
CITY OF ALBUQUERQUE  
BERNALILLO COUNTY, NEW MEXICO

APRIL, 2005  
REVISED MAY 31, 2005

GENERAL NOTES

- Bearings are grid based upon the New Mexico State Plane Coordinate System, Central Zone (NAD 27) and related to grid at the Albuquerque Control Survey Monument "3-P10".
- Distances are ground.
- Distances along curved lines are arc lengths.
- Record Plat or Deed bearings and distances, where they differ from those established by this field survey, are shown in parenthesis ( ).
- All corners found in place and held were tagged with a brass disk stamped "HUGG L.S. 9750" unless otherwise indicated hereon.
- All corners that were set are either a 5/8" rebar with cap stamped "HUGG L.S. 9750" or a concrete nail with brass disk stamped "HUGG L.S. 9750" unless otherwise indicated hereon.
- Vertical datum is based upon the Albuquerque Control Survey Benchmark "3-P10", Elevation = 4935.735 (NGVD29)
- Contour interval is one foot.
- Field surveys were performed during the month of April, 2005.
- Documents used in the preparation of this survey are as follows:

- Plat entitled "PLAT OF TRACTS 1-A, 2-A AND 3-A, LANDS OF LAMONICA AND WENK, ALBUQUERQUE, BERNALILLO COUNTY, NEW MEXICO, DECEMBER 1989", filed January 3, 1990, in Volume 90C, Folio 1, records of Bernalillo County, New Mexico.
- Plat entitled "BULK LAND PLAT OF TRACTS 1-A-1 AND 1-A-2, LANDS OF LAMONICA & WENK, ALBUQUERQUE, BERNALILLO COUNTY, NEW MEXICO, SEPTEMBER 2003", filed December 5, 2003, in Volume 2003C, Folio 365, records of Bernalillo County, New Mexico.
- Plat entitled "CORRECTED PLAT OF TRACTS 1, 2 AND 3, LANDS OF LAMONICA AND WENK, ALBUQUERQUE, BERNALILLO COUNTY, NEW MEXICO, AUGUST 1989", filed October 4, 1989, in Volume C40, Folio 2, records of Bernalillo County, New Mexico.
- Plat entitled "PLAT OF TRACTS 1 AND 2, LANDS OF LAMONICA AND WENK, ALBUQUERQUE, BERNALILLO COUNTY, NEW MEXICO, 1989", filed September 8, 1989, in Volume C39, Folio 177, records of Bernalillo County, New Mexico.
- Plat entitled "PLAT FOR TRACT 3-A-1 & 3-A-2, LANDS OF LAMONICA & WENK, WITHIN THE TOWN OF ATRISCO GRANT, PROJECTED SECTION 10, TOWNSHIP 9 NORTH, RANGE 2 EAST, NMPM, BERNALILLO COUNTY, NEW MEXICO, JANUARY, 2004", filed August 18, 2004, in Volume 2004C, Folio 244, records of Bernalillo County, New Mexico.
- Unfiled survey entitled "PLAT OF SURVEY OF TRACTS 2-A, 3-A, A PORTION OF 1-A AND INCLUDING A DEDICATED ROAD ACCORDING TO ABSTRACT OF TITLE, LANDS OF LAMONICA AND WENK, PROJ. SEC. 10, T. 9 N., R. 2 E., NMPM, BERNALILLO COUNTY, NEW MEXICO, MAY, 1995", prepared by Clint Sherrill, NMPS No. 5953 for Clint Sherrill & Assoc., Albuquerque, New Mexico.
- Title Report prepared for this property by LandAmerica Albuquerque Title, Commitment for Title Insurance No. 252259SD, dated March 28, 2005.

- This property is subject to all exceptions pertaining to this property as listed in SCHEDULE B - SECTION II of the Title Report prepared for this property by LandAmerica Albuquerque Title, Commitment for Title Insurance No. 252259SD, dated March 28, 2005.
  - The above described Title Commitment was used in defining easements as shown hereon. Circled numbers by the easement description correspond to the Title Commitment's Schedule B Section II item number. Where possible, said easements have been plotted.
  - Existing utility line locations are shown in an approximate manner only, and such lines may or may not exist where shown or not shown. The location of any such existing lines is based on visual surface indications, and the information may be incomplete or may be obsolete by the time this survey is completed. All utilities should be field verified and spotted by the contractor(s) prior to commencement of any construction.
  - The wet utility as-built for Lamonica Road S.W. are not available as of the date of this survey.
  - City of Albuquerque Zone Atlas Page: P-10-Z
  - This property is currently zoned "SU-1 C-1 PERM USES & REST W/FULL SERV LOT" per the City of Albuquerque Zone Atlas, dated February 1, 2005.
- The information shown hereon and/or contained within this note is not intended to imply conformance to applicable zoning ordinance or restriction. The Minimum Standard Detail Requirements for ALTA/ACSM Land Title Surveys 1999, Table A, Optional Survey Responsibilities and Specifications states "the surveyor cannot make a certification on the basis of an interpretation" with respect to an interpretation of a zoning ordinance or restriction.
- There is no observable evidence of earth moving work, building construction or building additions within recent months.
  - There is no observable evidence of this site having been used as a solid waste dump, sump or sanitary landfill.

LEGAL DESCRIPTION

Tract numbered Two-A (2-A) of the Plat of Tracts 1-A, 2-A and 3-A, LANDS OF LAMONICA AND WENK, Albuquerque, Bernalillo County, New Mexico, as the same is shown and designated on the plat thereof, filed in the office of the County Clerk of Bernalillo County, New Mexico, on January 3, 1990, in Plat Book 90C, Page 1.

FLOOD ZONE DETERMINATION

The subject property (as shown hereon) lies within Zone "X" (areas determined to be outside the 0.2% annual chance floodplain.) in accordance with the National Flood Insurance Program Rate Map No. 35001C0359 E, Effective Date 11-19-03.

SCHEDULE B - SECTION II (EXCEPTIONS)

As listed in SCHEDULE B - SECTION II of the Title Report prepared for this property by LandAmerica Albuquerque Title, Commitment for Title Insurance No. 252259SD, dated March 28, 2005.

- Reservations contained in Patent from United States of America, recorded in Book 35, page 91, records of Bernalillo County, New Mexico. (Affects Property - Unplotted)
- Restrictions and notes recorded in Plat Book C39, page 177; in Plat Book C40, page 2 and in Plat Book 90C, page 1, records of Bernalillo County, New Mexico, but omitted any restriction based on race, color, religion or national origin to the extent such covenants, conditions or restrictions violate 42 USC 3604. (Affects Property - Unplotted)
- Temporary Construction Easement recorded in Book A84, page 1916, records of Bernalillo County, New Mexico. (Affects Property - Plotted Hereon)

SURVEYORS CERTIFICATION

I, Russ P. Hugg, New Mexico Professional Surveyor Number 9750, hereby certify to New Mexico Educators Federal Credit Union, John Black and A. Wade Black, as Trustees of The Albert J. Black and Mary J. Black Revocable Trust dated December 11, 1985; Commonwealth Land Title Insurance Company and LandAmerica Albuquerque Title, that to the best of my professional knowledge, information and belief that this map or plat and the Survey on which it is based were made (i) in accordance with "Minimum Standard Detail Requirements for ALTA/ACSM/NSPS Land Title Surveys," jointly established and adopted by ALTA, ACSM and NSPS in 1999, and includes Items 1, 2, 3, 4, 5, 8, 10, 11(c), 11(b), 14 and 16 of Table A, specifically defined therein; (ii) pursuant to the Accuracy Standards as adopted by ALTA/ACSM/NSPS and in effect on the date of this certification; (iii) the undersigned further certifies that the Positional Uncertainties resulting from the survey measurements made on the survey do not exceed the allowable Positional Tolerances; and (iv) in accordance with the current Minimum Standards for Land Surveying adopted by the New Mexico Board of Registration for Professional Engineers and Land Surveyors.

Russ P. Hugg  
NMPS No. 9750  
April 18, 2005  
REVISED MAY 31, 2005



**SURV TEK, INC.**





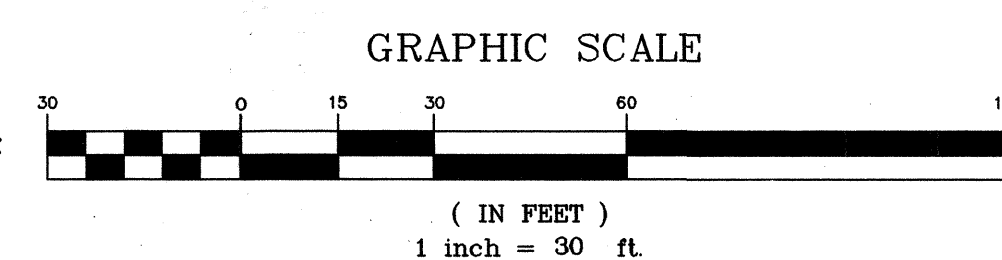
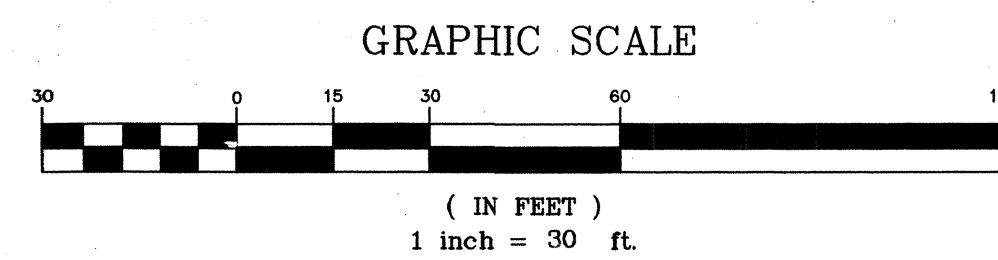
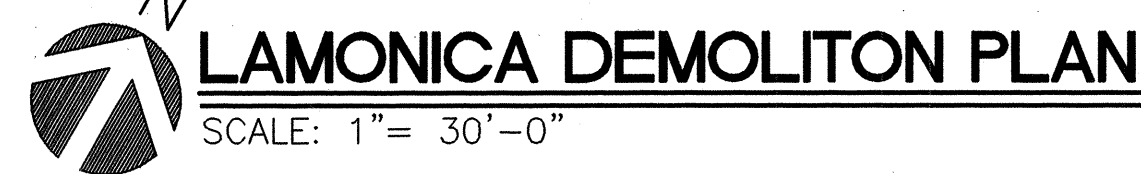











Consulting Surveyors  
9884 Valley View Drive N.W. Albuquerque, New Mexico 87114 Fax: 505-897-5377  
Phone: 505-897-5388





RECORD DRAWING ELEVATIONS PROVIDED  
BY RUSS HUGG NMP# 9750.

# LEGEND

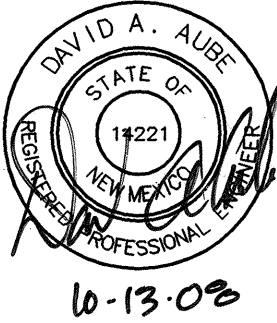

	COLLECTOR STREET ASPHALT PAVING PER COA STD 2465
	COLLECTOR STREET ASPHALT PAVING FOR UTILITY PATROL PER COA STD 2465
	CONCRETE FOR SIDEWALKS, DRIVEPADS AND MEDIAN N
	SUB DIVISION BOUNDARY
	LOT LINE
	STREET CENTERLINE
 — SAS	EXISTING SANITARY SEWER
 — WL	EXISTING WATER LINE
 — SAS	PROPOSED SANITARY SEWER
 6" WL	PROPOSED WATER LINE
	PROPOSED VALVE
	PROPOSED HYDRANT
	PROPOSED WATER METER
	PROPOSED SANITARY SEWER MANHOLE
EXISTING FEATURES:	
	TRAFFIC SIGN
	FIRE HYDRANT
	EXISTING MANHOLE

NOTE:  
SEE SHEET 4 FOR CURB RETURN  
QUARTER POINT TABLES.



**dg** **THE DESIGN GROUP**  
 ARCHITECTS • PLANNERS • INTERIOR DESIGN  
 202 CENTRAL AVENUE SE SUITE 200  
 ALBUQUERQUE, NEW MEXICO 87102  
 PHONE: 505.242.6880 FAX: 505.242.6881

CITY OF ALBUQUERQUE PUBLIC WORKS DEPARTMENT ENGINEERING GROUP	
TITLE:	NEW MEXICO EDUCATORS FEDERAL CREDIT UNION LAMONICA DEMOLITION AND GRADING PLAN

Design Review Committee 		City Engineer Approval 		Last Design Update	Mo./Day/Yr.		Mo./Day/Yr.	
City Project No. 736582		Zone Map P-10-7		Sheet 3		Of 6		

RECORD DRAWINGS
-----------------



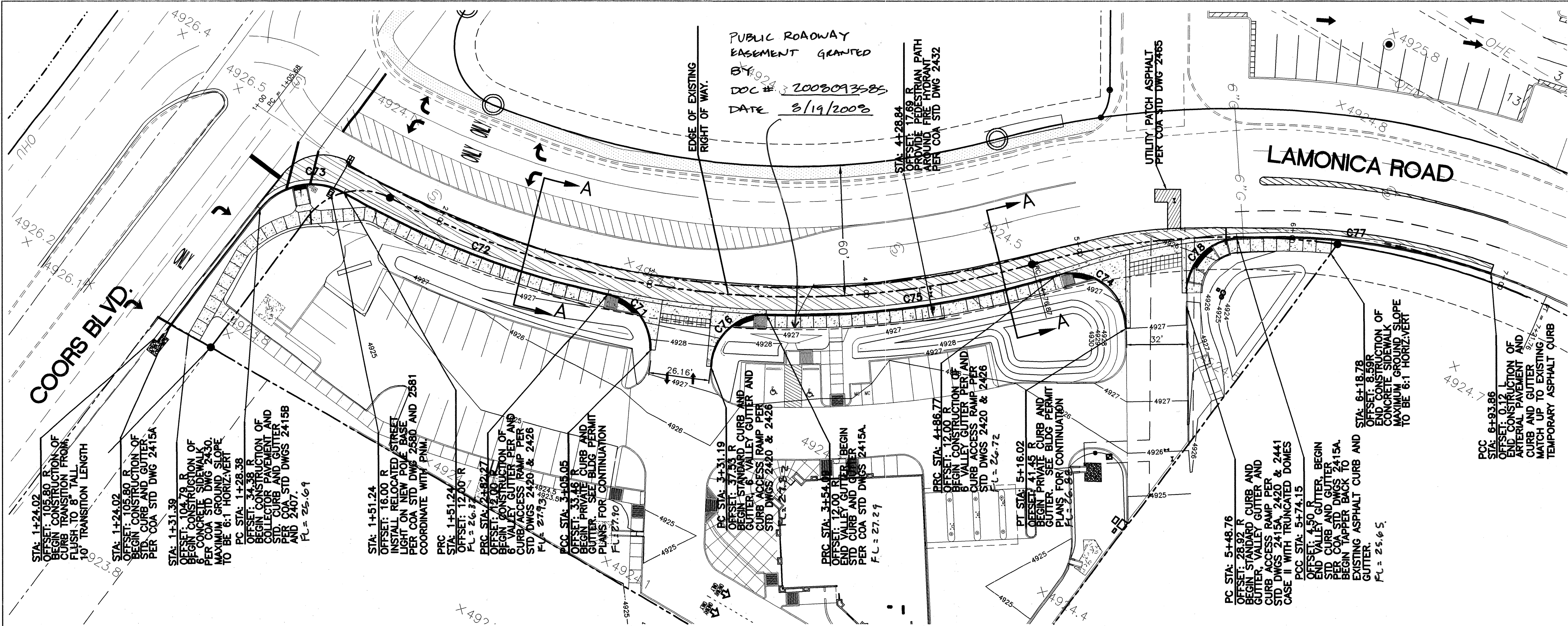

NOTE TO CONTRACTOR:  
WHEEL CHAIR RAMPS WITHIN PUBLIC RIGHT OF WAY  
WILL REQUIRE TRUNCATED DOMES (DETECTABLE WARNING  
SURFACE).

TRUNCATED DOMES:  
- DESIGN PER CURRENT ADA GUIDELINES.  
- SUBMIT SPECS TO CONSTRUCTION ENGINEER  
FOR EVALUATION PRIOR TO CONSTRUCTION.

SEE ENLARGED DETAILS OF WHEEL CHAIR RAMPS WITHIN  
PUBLIC RIGHT OF WAY ON SHEET 5 OF THIS PLAN SET.

LINE TABLE		
LINE	LENGTH	BEARING
L48	53.56	S54°31'25"W

CURVE TABLE				
CURVE	LENGTH	RADIUS	TANGENT	DELTA
C71	35.02	25.00	21.07	80°15'32"
C72	134.91	418.00	68.05	18°29'31"
C73	35.94	30.00	21.88	82°22'31"
C74	46.41	25.00	33.39	106°21'16"
C75	136.17	418.00	68.69	18°39'55"
C76	39.10	25.00	24.83	89°36'22"
C77	119.27	300.00	60.43	22°46'46"
C78	37.89	25.00	23.65	86°49'35"

## LAMONICA PAVING PLAN

SCALE: 1" = 30'-0"

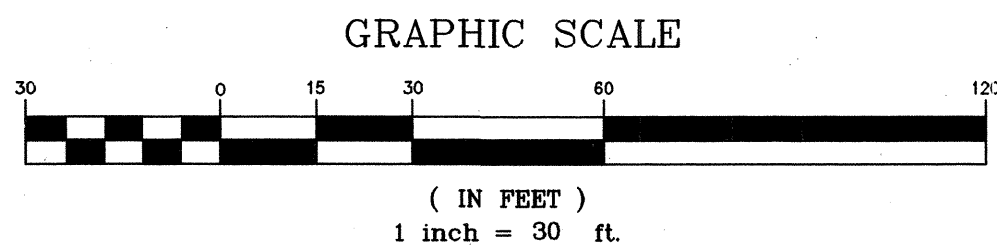

CURVE	FL
CURVE C71	1 27.42 2 27.53 3 27.64 PC=27.31 PT=27.75 PI=27.20
CURVE C73	1 25.97 2 26.06 3 26.15 PC=26.88 PT=26.24 PI=26.30
CURVE C74	1 26.32 2 26.51 3 26.69 PC=26.14 PT=26.88 PI=25.89
CURVE C76	1 27.37 2 27.24 3 27.10 PC=27.50 PT=26.97 PI=27.11
CURVE C78	1 26.31 2 26.05 3 25.78 PC=26.58 PT=25.51 PI=25.68

## LEGEND

- COLLECTOR STREET ASPHALT PAVING PER COA STD 2407
- COLLECTOR STREET ASPHALT PAVING FOR UTILITY PATCH PER COA STD 2465
- CONCRETE FOR SIDEWALKS, DRIVEPADS AND MEDIAN NOSE
- SUB DIVISION BOUNDARY
- LOT LINE
- STREET CENTERLINE
- EXISTING SANITARY SEWER
- EXISTING WATER LINE
- PROPOSED SANITARY SEWER
- PROPOSED WATER LINE
- PROPOSED VALVE
- PROPOSED HYDRANT
- PROPOSED WATER METER
- PROPOSED SANITARY SEWER MANHOLE
- EXISTING FEATURES:
  - TRAFFIC SIGN
  - FIRE HYDRANT
  - EXISTING MANHOLE
  - WATER VALVE

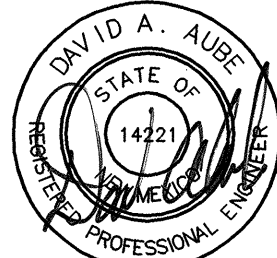

RECORD DRAWINGS

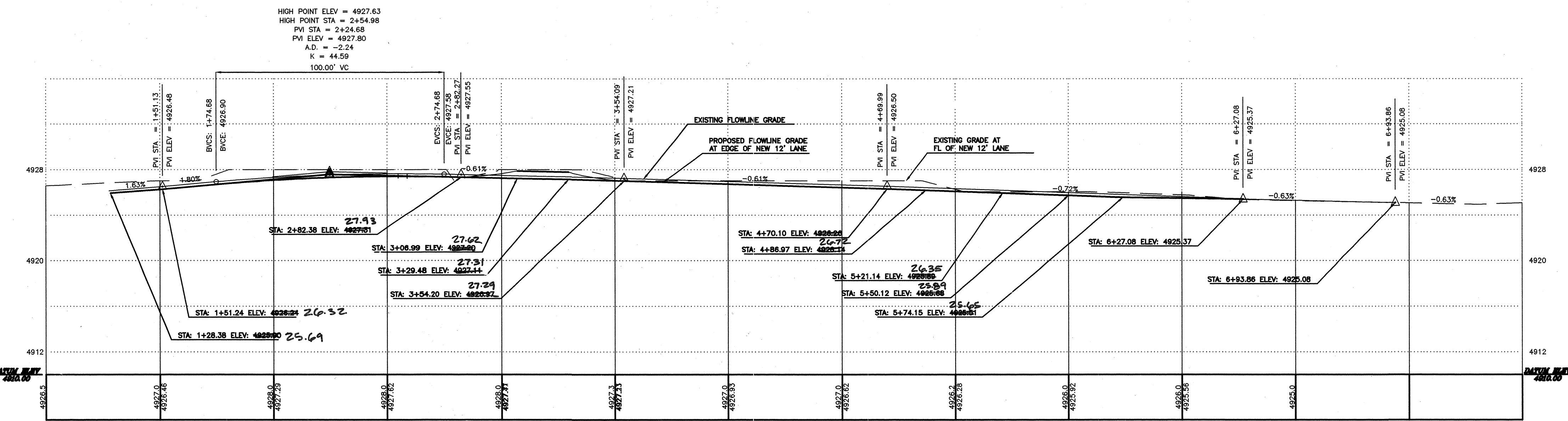

## LAMONICA PAVING PROFILE

SCALE: 1" = 30'-0" HORIZ, 1" = 6' VERT.

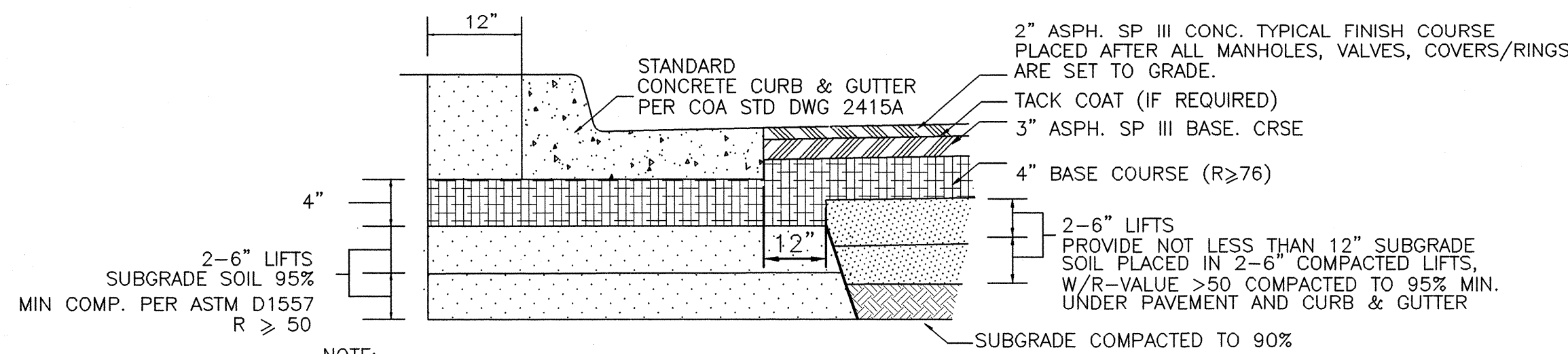
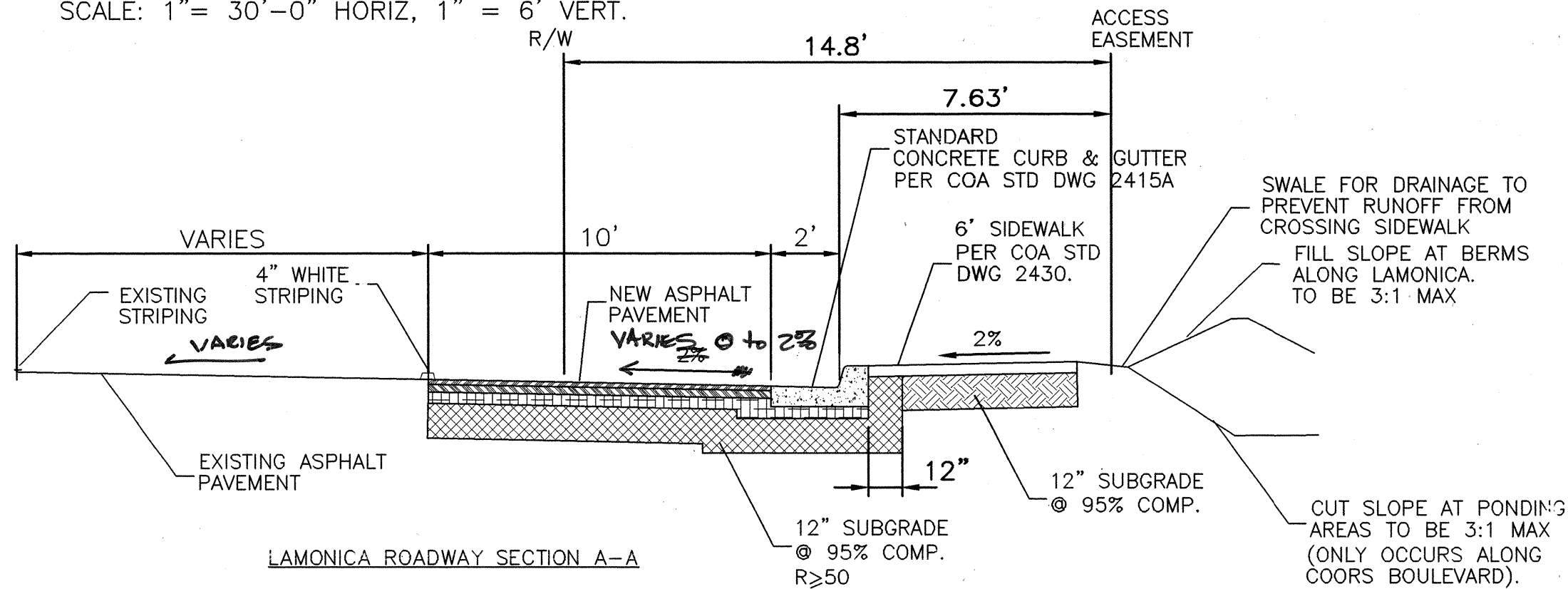

NOTE:  
SUBGRADE SOILS w/R<50 SHALL BE REPLACED  
TO A DEPTH OF TWO FEET WITH SUITABLE MATERIAL ( R > 50 )

LAMONICA PAVING SECTION COLLECTOR STREET  
PER COA PROJECT 736581

**THE DESIGN GROUP**  
ARCHITECTS • PLANNERS • INTERIOR DESIGN  
202 CENTRAL AVENUE SE SUITE 200  
ALBUQUERQUE, NEW MEXICO 87102  
PHONE: 505.242.6880 FAX: 505.242.6881

CITY OF ALBUQUERQUE  
PUBLIC WORKS DEPARTMENT  
ENGINEERING GROUP

TITLE: NEW MEXICO EDUCATORS FEDERAL CREDIT UNION  
LAMONICA PAVING PLAN AND PROFILE

Design Review Committee	City Engineer Approval	Mo./Day/Yr.	Mo./Day/Yr.
APPROVED NOV 26 2008 DESIGN REVIEW COMMITTEE	APPROVED DEC 04 2008 CITY ENGINEER		

City Project No. 736582 Zone Map P-10-Z Sheet 4 of 6



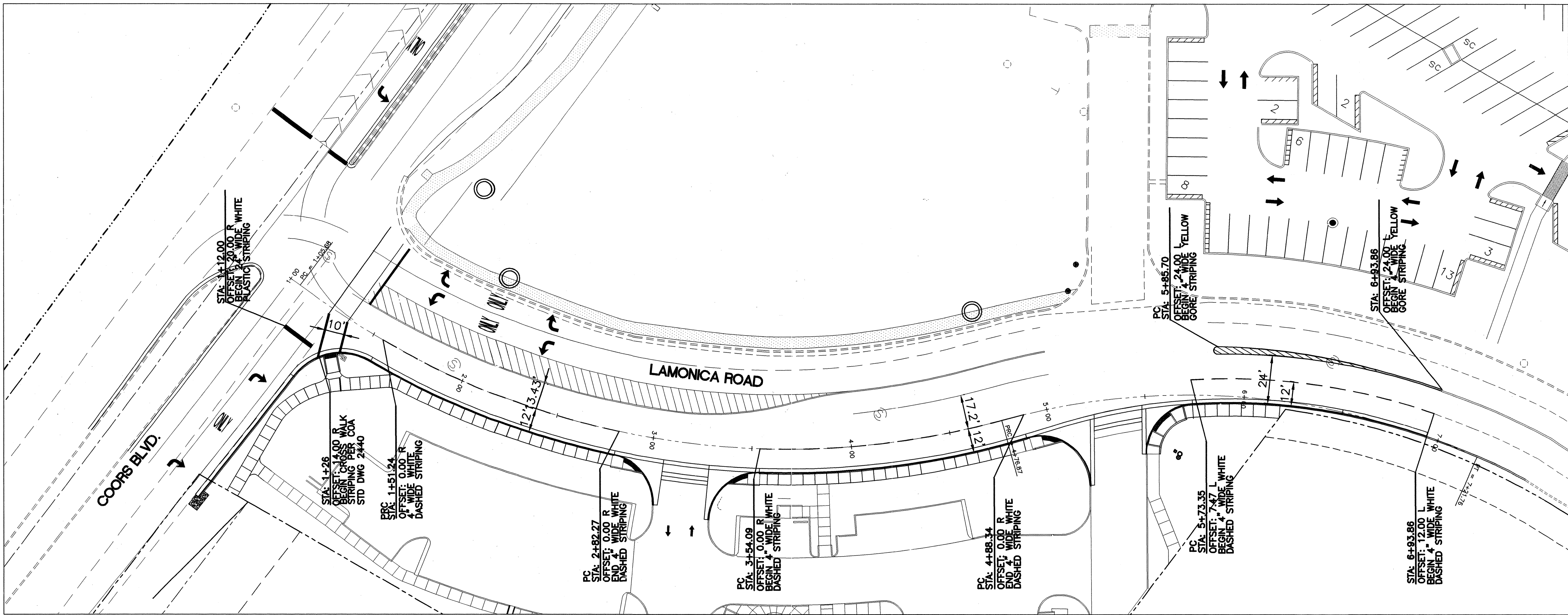

**LAMONICA STRIPING PLAN**  
SCALE: 1" = 30'-0"

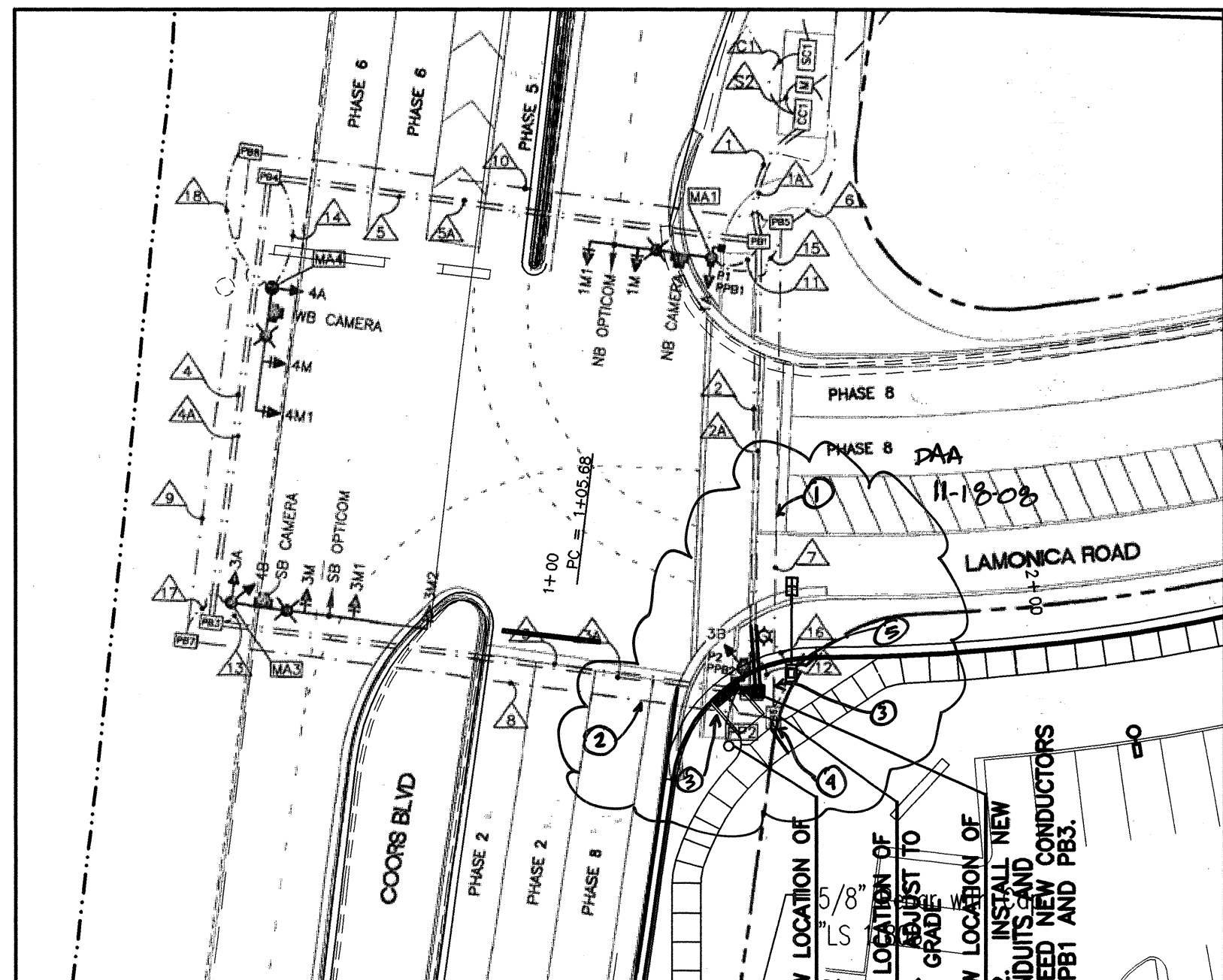
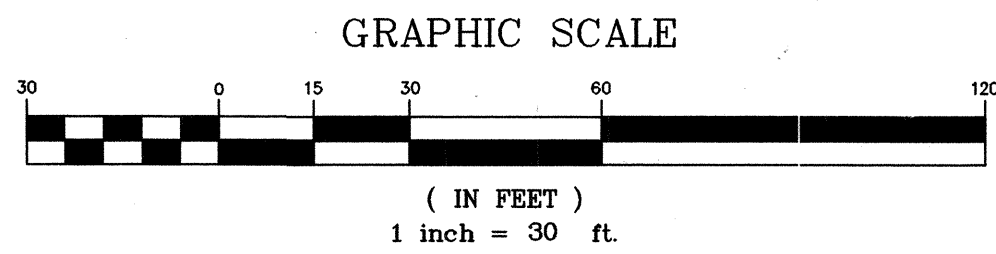

**SIGNAL RELOCATION PLAN**  
SCALE: 1" = 30'-0"  
\* SEE KEYED NOTES AT RIGHT. DAA 11-18-08

**SIGNAL POLES AND MASTARMS**

ID#	TYPE	STATION	OFFSET	EXISTING MOUNTING HEIGHT	EXISTING MOUNTING ARM
MA1	MASTARM 25' TYPE III	-	- LT	40'	17.5'
PP2	PEDESTRIAN POLE 13'	-	- LT	-	-
MA3	MASTARM 40' TYPE III	-	- RT	40'	17.5'
MA4	MASTARM 25' TYPE III	-	- RT	40'	17.5'
CC1	CONTROLLER	-	- LT	-	-

**SYMBOL KEY**

- MA1 SIGNAL & CABINET ID
- NEW CONDUIT RUN ID
- CONDUIT RUN ID (POWER SERVICE)
- CONDUIT RUN ID (INTERCONNECT)

**FLASH CONDITION \***

RED HEADS 1A,1M,1M1  
3A,3B,3M,3M1,3M2  
4A,4B,4M,4M1

**INITIALIZATION**

ALL RED, THEN PHASE 2 AND 6 GREEN

**TYPICAL SIGNAL FACE LENS ARRANGEMENTS**

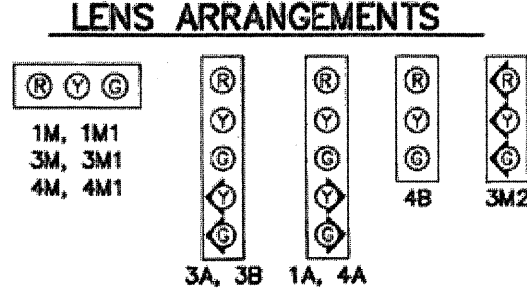

**ABBREVIATIONS**

MA1	MASTARM NUMBER
PP1	PEDESTAL POLE NUMBER
PPB1	PEDESTRIAN PUSH BUTTON NUMBER
CC1	CONTROL CABINET NUMBER
SC1	SPLICE CABINET NUMBER
PB1	PULL BOX NUMBER (SIGNALS)
PB1	PULL BOX NUMBER (POWER)
PB1	PULL BOX NUMBER (INTERCONNECT)
DL1(1)	DETECTOR LOOP PHASE # (LOOP #)
3A	SIGNAL HEAD NUMBER
P1	PEDESTRIAN SIGNAL NUMBER
BP	BACK PLATE
EC	EXTENDED CALL LOOP DETECTOR
SD	SYSTEM LOOP DETECTOR
MH1	TRAFFIC MANHOLE NUMBER
M	METER

COORDINATE WITH TRAFFIC OPERATIONS FOR ALL WORK ON PEDESTRIAN TRAFFIC SIGNAL AND PULL BOXES.

PULL BOX #2 (PB2) IS LARGE.

CONDUITS EXTENSIONS ARE TO BE CONNECTED TO EXISTING CONDUITS. MATCH MATERIAL AND DIAMETER. INSTALL NEW CONDUCTORS TO MATCH EXISTING BETWEEN PULL BOXES #2 TO PB1 AND PB3. NO SPLICES IN CONDUCTORS WILL BE PERMITTED.

**KEYED NOTES**  
FOR SIGNAL RELOCATION PLAN

- EXISTING CONDUIT. PULL NEW CONDUCTORS FROM PB6 TO PBS.
- EXISTING CONDUIT. PULL NEW CONDUCTORS FROM PB6 TO PB7.
- CONNECT NEW CONDUITS TO EXISTING. PLACE CONDUITS WITH LARGE RADIUS SWEEPS. MATCH CONDUIT SIZE. EXTEND FROM EXISTING CONDUIT TO NEW PULL BOX. PULL BOX #6 TO BE RELOCATED. INSTALL PULL BOX PER COA STD DWG 2550 (STANDARD SIZE).
- INSTALL RELOCATED LIGHT POLE ON NEW POLE BASE PER COA STD DWG 2581.

DAA 11-18-08.

**LEGEND**

- COLLECTOR STREET ASPHALT PAVING PER COA STD 2407
- COLLECTOR STREET ASPHALT PAVING FOR UTILITY PATCH PER COA STD 2465
- CONCRETE FOR SIDEWALKS, DRIVEPADS AND MEDIAN NOSE
- SUB DIVISION BOUNDARY
- LOT LINE
- STREET CENTERLINE
- EXISTING SANITARY SEWER
- EXISTING WATER LINE
- PROPOSED SANITARY SEWER
- PROPOSED WATER LINE
- PROPOSED VALVE
- PROPOSED HYDRANT
- PROPOSED WATER METER
- PROPOSED SANITARY SEWER MANHOLE

**EXISTING FEATURES:**

- TRAFFIC SIGN
- FIRE HYDRANT
- EXISTING MANHOLE
- WATER VALVE

**THE DESIGN GROUP**  
ARCHITECTS • PLANNERS • INTERIOR DESIGN  
202 CENTRAL AVENUE SE SUITE 200  
ALBUQUERQUE, NEW MEXICO 87102  
PHONE: 505.242.6880 FAX: 505.242.6881

CITY OF ALBUQUERQUE  
PUBLIC WORKS DEPARTMENT  
ENGINEERING GROUP

TITLE: NEW MEXICO EDUCATORS FEDERAL CREDIT UNION  
LAMONICA STRIPING PLAN and SIGNAL RELOCATION

Design Review Committee	City Engineer Approval	No./Day/Yr.	No./Day/Yr.
APPROVED NOV 9 2008 DESIGN REVIEW COMMITTEE	APPROVED DEC 4 2008 CITY ENGINEER		
City Project No.	Zone Map	Sheet	Of

736582

P-10-Z

5 of 6

AS-BUILT INFORMATION		BENCH MARK		SURVEY INFORMATION		FIELD NOTES		NO.		BY		DATE	
CONTRACTOR	CUSTOM GRADING	A.C.S. MONUMENT	"3-P10"	NO.		NO.		NO.		NO.		NO.	
WORK	STAKED BY	STANDARD	A.S.C.S. ALUMINUM CAP	NO.		NO.		NO.		NO.		NO.	
INSPECTOR'S	DATE	NEW MEXICO	STATE PLANE COORDINATES	NO.		NO.		NO.		NO.		NO.	
APPROVED BY	DATE	(CENTRAL ZONE-N.A.D. 1927)		NO.		NO.		NO.		NO.		NO.	
VERIFICATION BY	DATE	X360.733.56		NO.		NO.		NO.		NO.		NO.	
DRAWINGS	DATE	Y=1462.437.48		NO.		NO.		NO.		NO.		NO.	
CORRECTIONS	DATE	GRID TO GROUND FACTOR=0.9996831		NO.		NO.		NO.		NO.		NO.	
MICRO-FILM INFORMATION	DATE	DELTA ALPHA ANGLE=0°16'01"		NO.		NO.		NO.		NO.		NO.	
RECORDED BY	DATE	ELE=4935.735 (NVD 29)		NO.		NO.		NO.		NO.		NO.	
RECORDED BY	DATE			NO.		NO.		NO.		NO.		NO.	

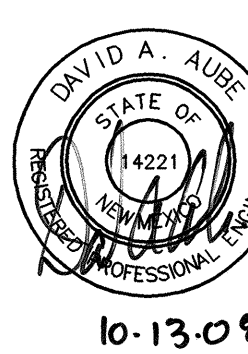

10-13-08

REVISIONS		BY		DATE	
NO.	DATE	NO.	DATE	NO.	DATE
1	5-21-08				
2	5-21-08				
3	5-21-08				
4	5-21-08				
5	5-21-08				
6	5-21-08				
7	5-21-08				
8	5-21-08				
9	5-21-08				
10	5-21-08				
11	5-21-08				
12	5-21-08				
13	5-21-08				
14	5-21-08				
15	5-21-08				
16	5-21-08				
17	5-21-08				
18	5-21-08				
19	5-21-08				
20	5-21-08				
21	5-21-08				
22	5-21-08				
23	5-21-08				
24	5-21-08				
25	5-21-08				
26	5-21-08				
27	5-21-08				
28	5-21-08				
29	5-21-08				
30	5-21-08				
31	5-21-08				
32	5-21-08				
33	5-21-08				
34	5-21-08				
35	5-21-08				
36	5-21-08				
37	5-21-08				
38	5-21-08				
39	5-21-08				
40	5-21-08				
41	5-21-08				
42	5-21-08				
43	5-21-08				
44	5-21-08				
45	5-21-08				
46	5-21-08				
47	5-21-08				
48	5-21-08				
49	5-21-08				
50	5-21-08				
51	5-21-08				
52	5-21-08				
53	5-21-08				
54	5-21-08				
55	5-21-08				
56	5-21-08				
57	5-21-08				
58	5-21-08				
59	5-21-08				
60	5-21-08				
61	5-21-08				
62	5-21-08				
63	5-21-08				
64	5-21-08				
65	5-21-08				
66	5-21-08				
67	5-21-08				
68	5-21-08				
69	5-21-08				
70	5-21-08				
71	5-21-08				
72	5-21-08				
73	5-21-08				
74	5-21-08				
75	5-21-08				
76	5-21-08				
77	5-21-08				
78	5-21-08				
79	5-21-08				
80	5-21-08				
81	5-21-08				
82	5-21-08				
83	5-21-08				
84	5-21-08				
85	5-21-08				
86	5-21-08				
87	5-21-08				
88	5-21-08				
89	5-21-08				
90	5-21-08				
91	5-21-08				
92	5-21-08				
93	5-21-08				
94	5-21-08				
95	5-21-08				
96	5-21-08				
97	5-21-08				
98	5-21-08				
99	5-21-08				
100	5-21-08				



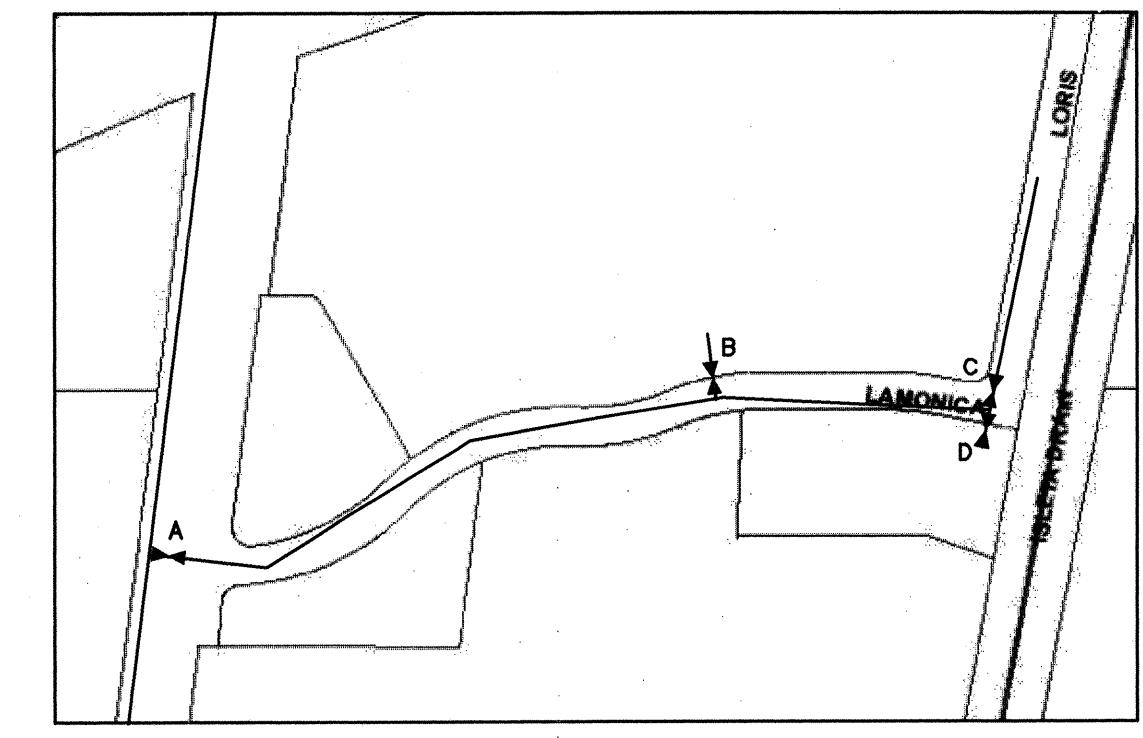
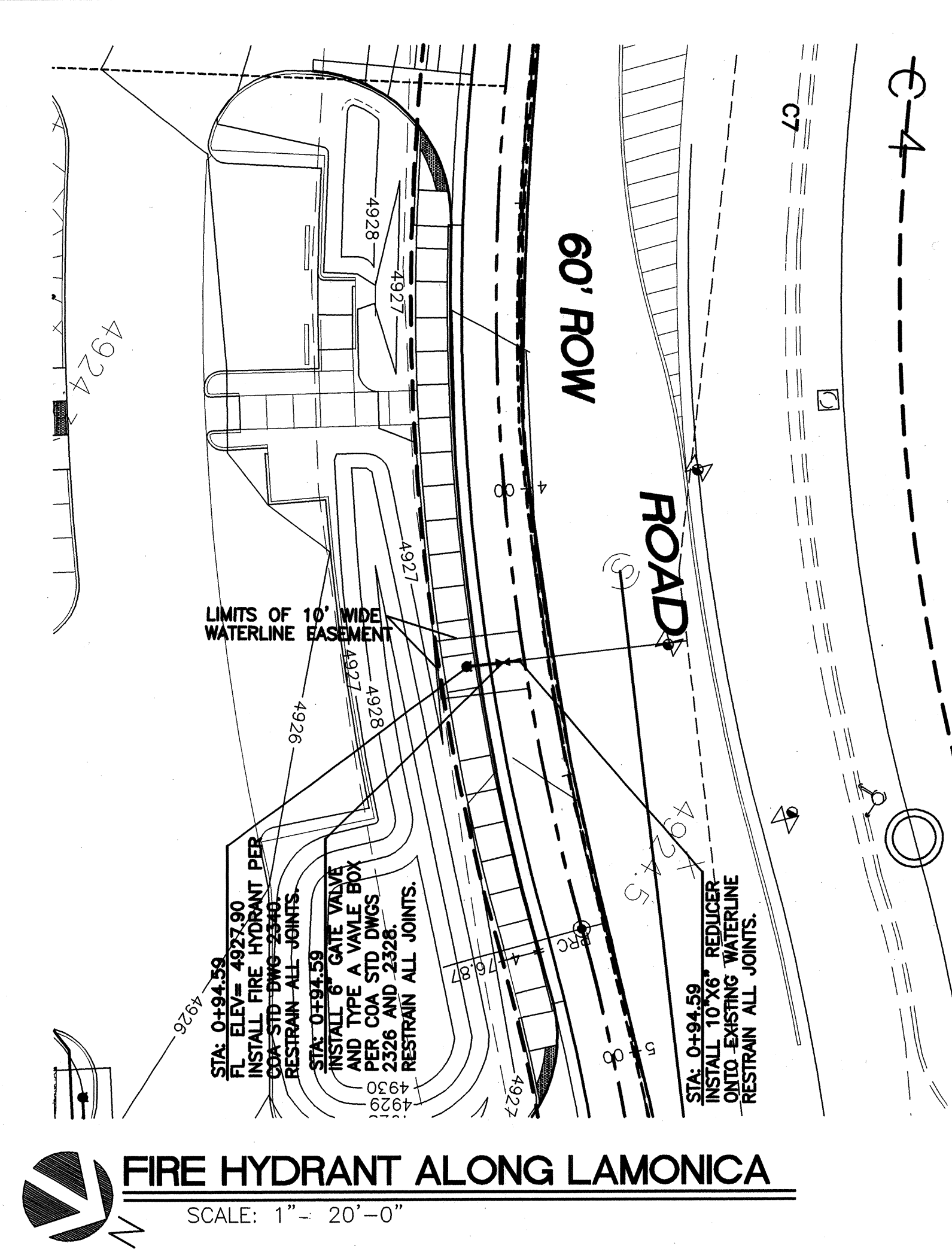
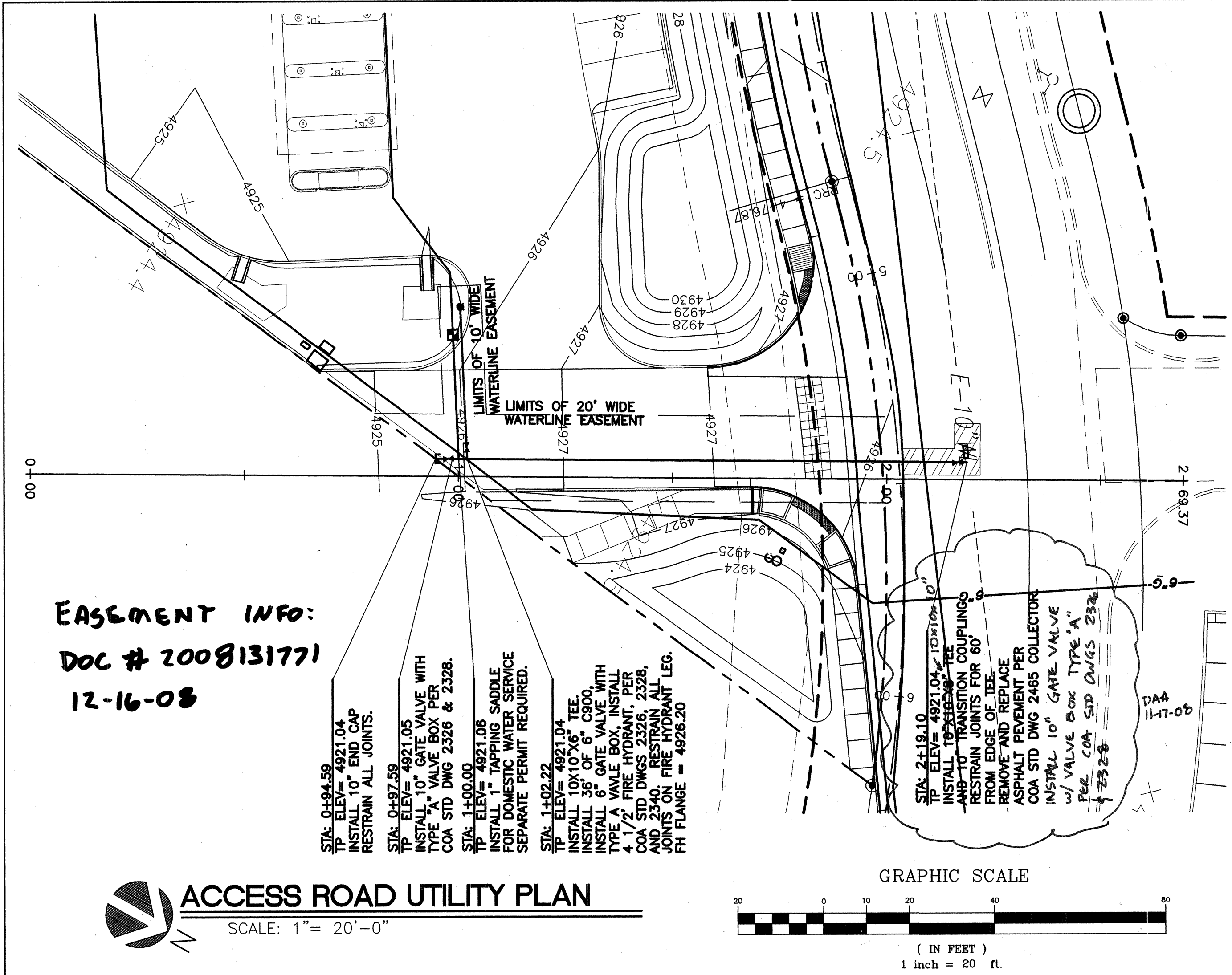

**CONTRACTOR NOTE SHUT OFF VALVES:**  
VALVE IN COORS BOULEVARD AT LAMONICA (WEST SIDE OF STREET) #(A)  
VALVE IN LAMONICA ROAD IN ENTRANCE TO WALMART #(B).  
VALVE IN LORIS DRIVE NORTH OF LAMONICA CL #(C).  
VALVE IN LORIS DRIVE SOUTH OF LAMONICA CL #(D).

ONLY WATER AUTHORITY CREWS CAN OPERATE ABCWUA WATER VALVES.

WATER SHUTOFF SHALL BE COORDINATED WITH ALBUQUERQUE BERNALILLO COUNTY WATER UTILITY AUTHORITY A MINIMUM OF SEVEN DAYS IN ADVANCE AT 857-8200.

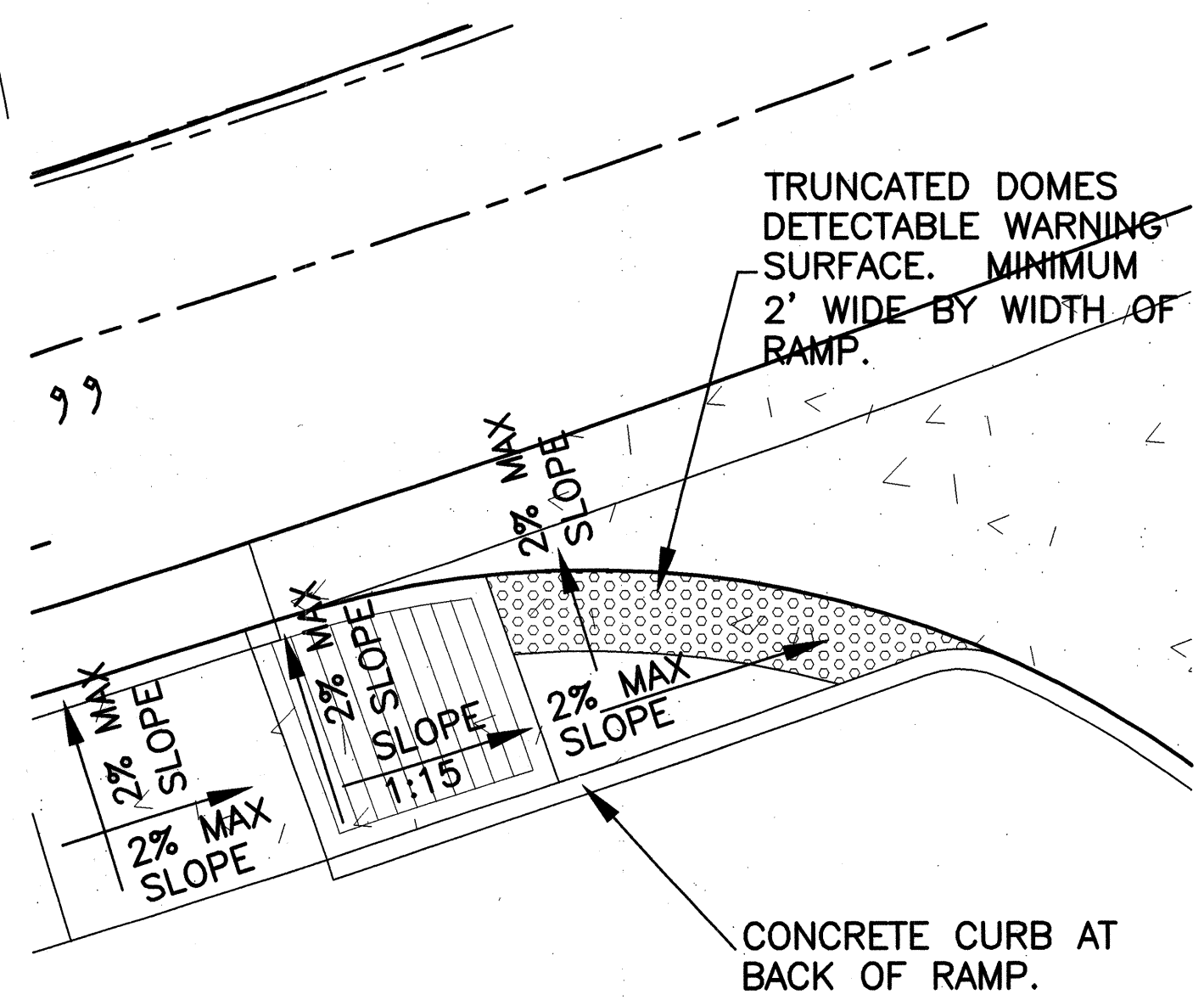
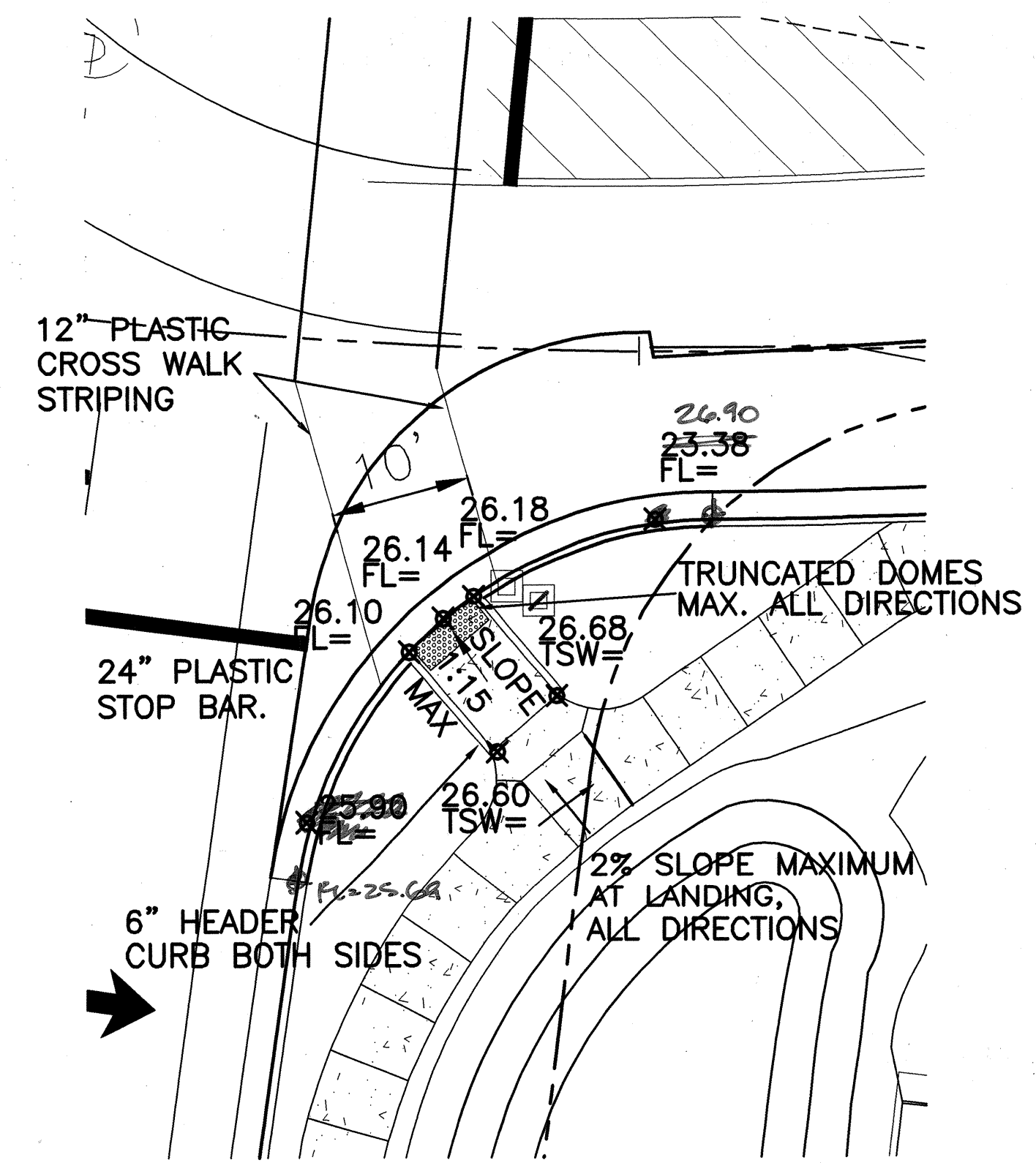
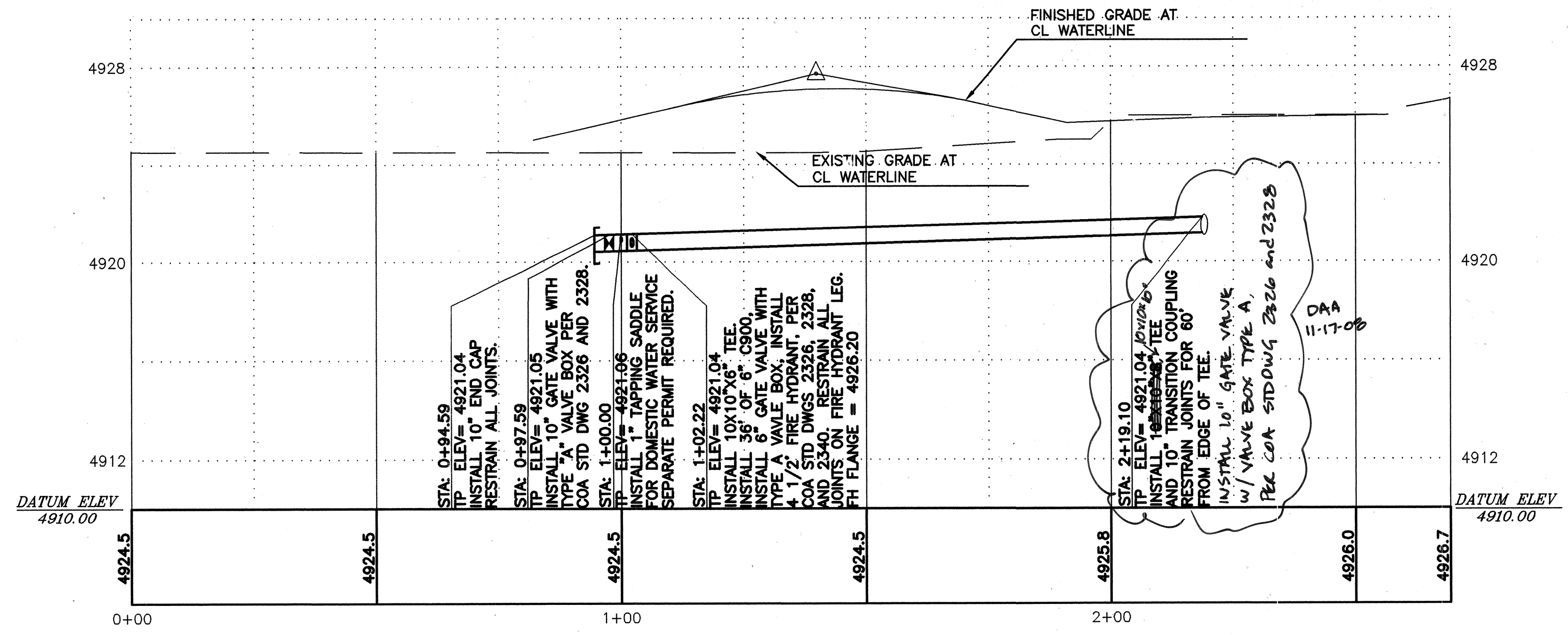

**THE DESIGN GROUP**  
ARCHITECTS • PLANNERS • INTERIOR DESIGN  
202 CENTRAL AVENUE SE SUITE 200  
ALBUQUERQUE, NEW MEXICO 87102  
PHONE: 505.242.6880 FAX: 505.242.6881

CITY OF ALBUQUERQUE  
PUBLIC WORKS DEPARTMENT  
ENGINEERING GROUP

TITLE: NEW MEXICO EDUCATORS FEDERAL CREDIT UNION  
UTILITY EXTENSION PLAN AND PROFILE

DESIGN REVIEW COMMITTEE	CITY ENGINEER APPROVAL	Mo./Day/Yr.	Mo./Day/Yr.
APPROVED NOV 28 2008 DESIGN REVIEW COMMITTEE	APPROVED DEC 04 2008 CITY ENGINEER		
Last Design Update			

City Project No. 736582 Zone Map P-10-Z Sheet 6 of 6

SURVEY INFORMATION				BENCH MARK		AS-BUILT INFORMATION	
NO.		FIELD NOTES		BY		DATE	

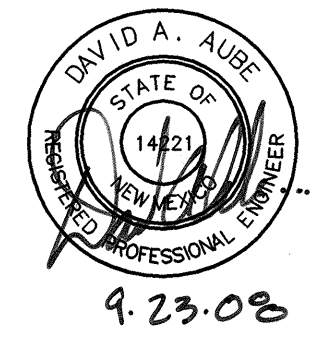



SCANNED BY  
PLANNING

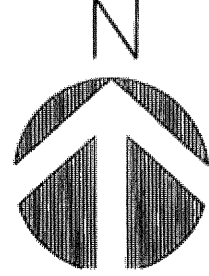
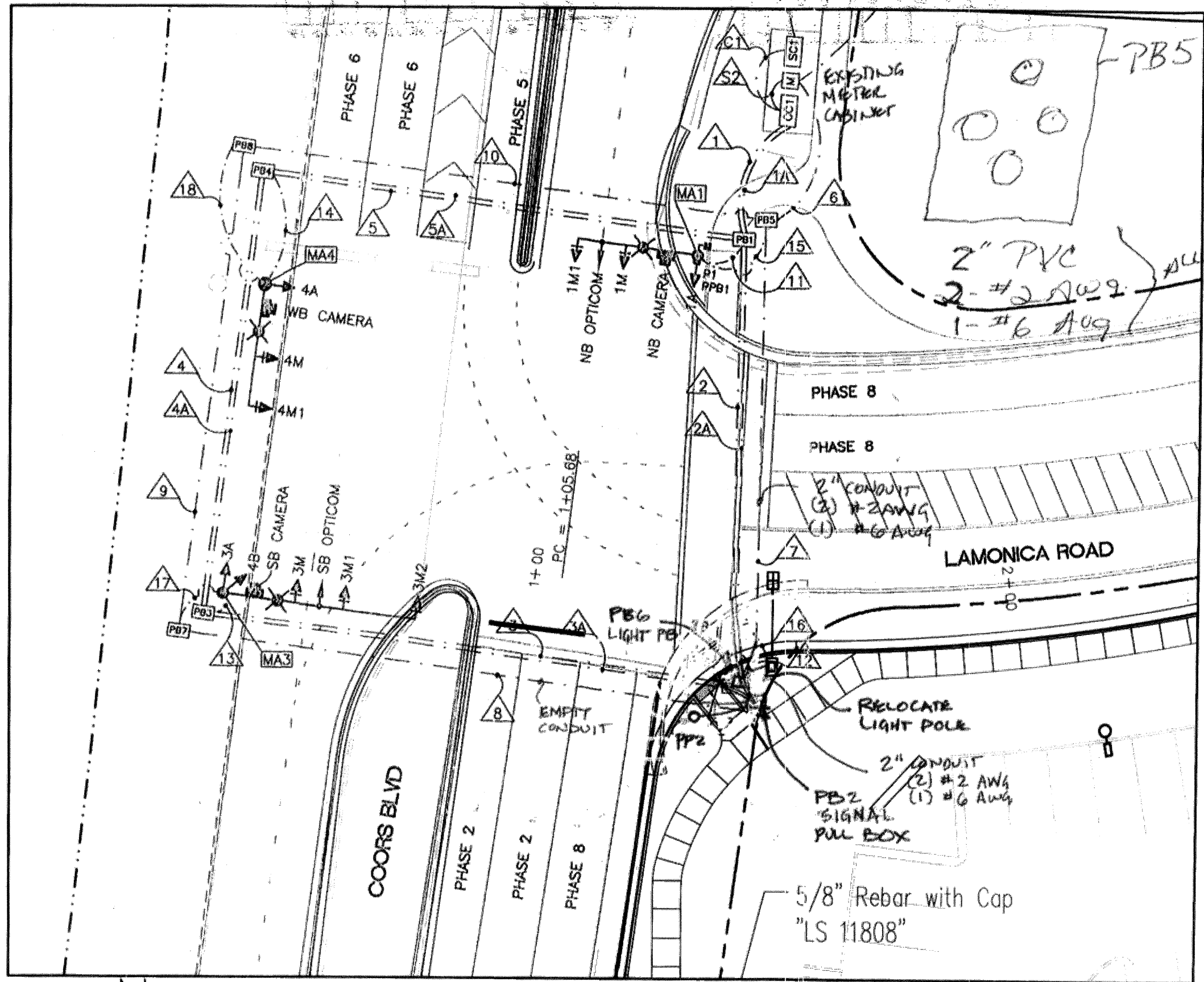

### SIGNAL RELOCATION PLAN

SCALE: 1"=30'-0" NOT TO SCALE

INFORMATION PROVIDED BY DRB ELECTRIC.

#736582

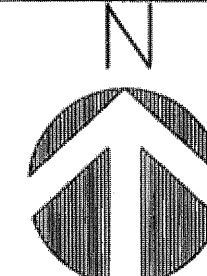
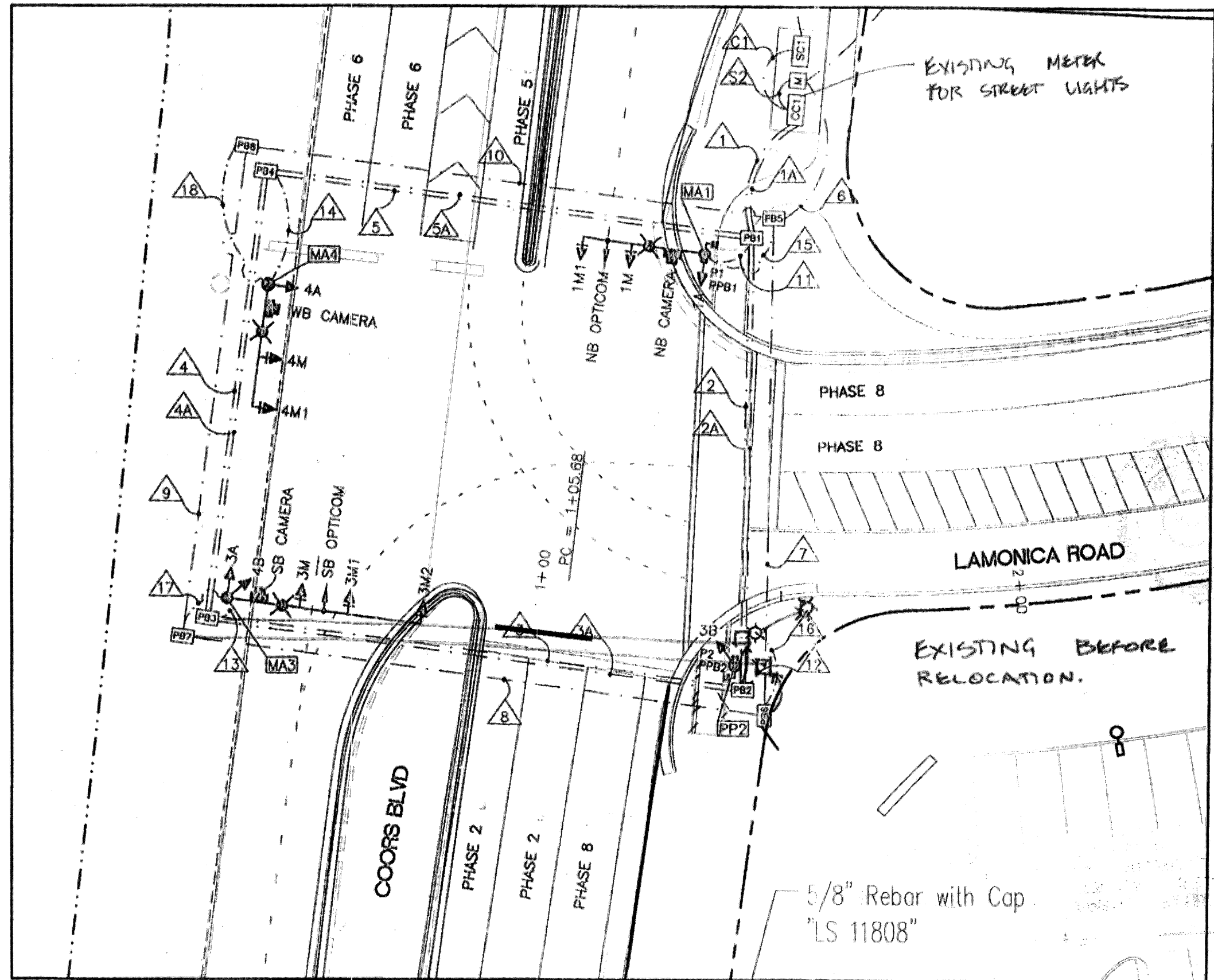
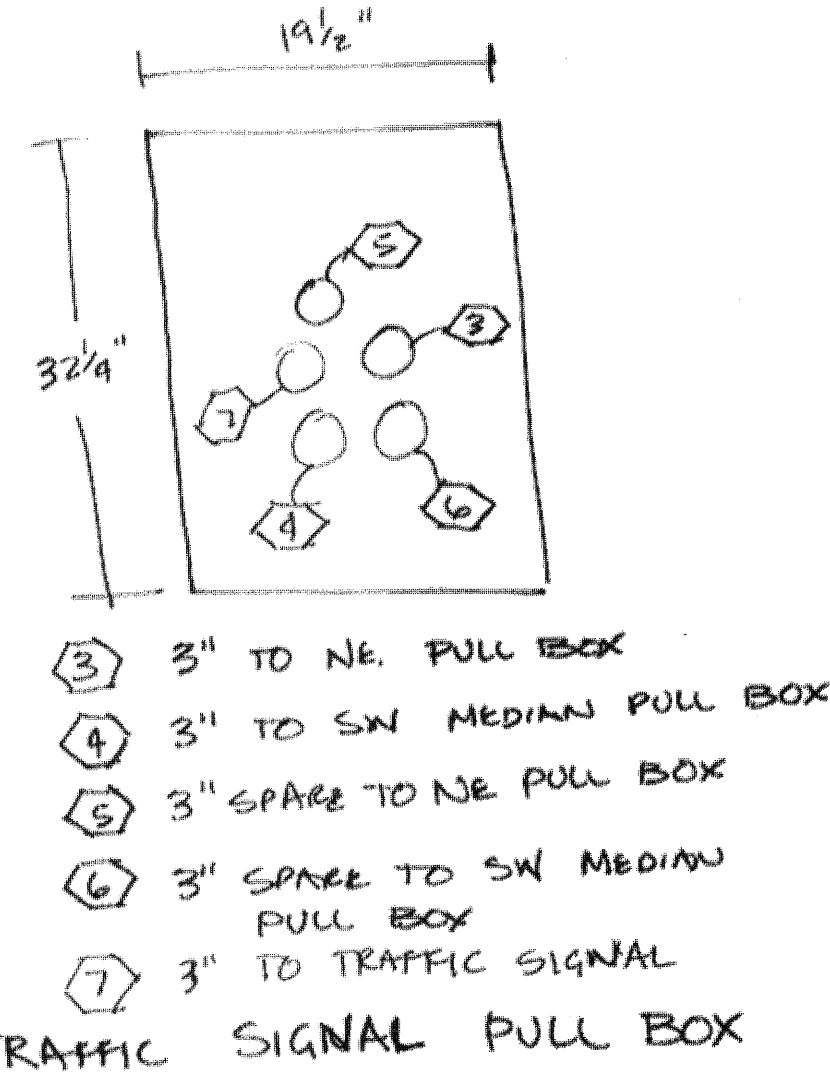
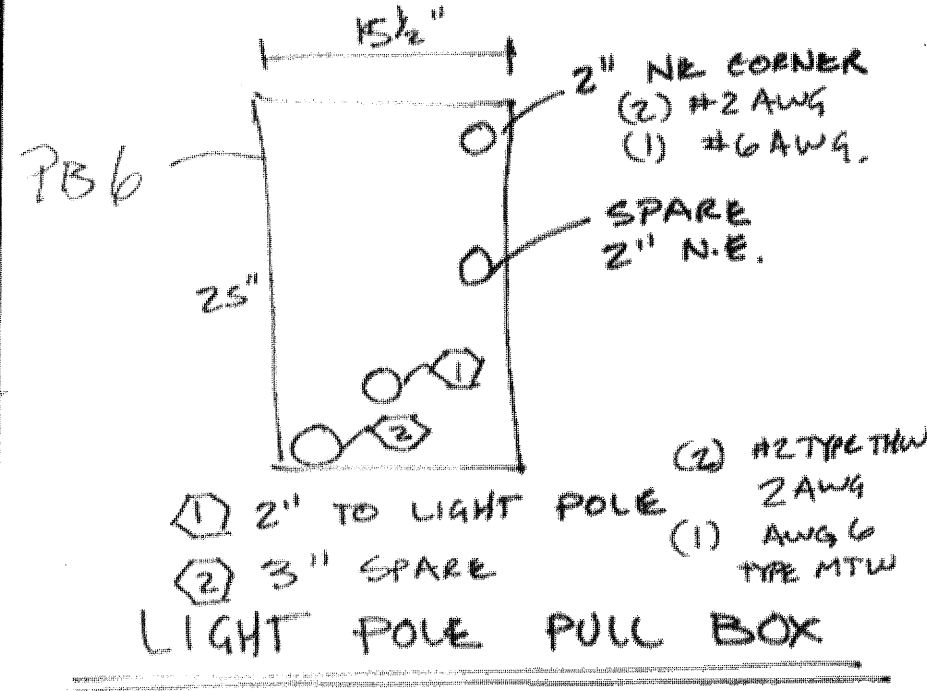

### SIGNAL RELOCATION PLAN

SCALE: 1"=30'-0" NOT TO SCALE

#736582

**THE DESIGN GROUP**  
ARCHITECTS • PLANNERS • INTERIOR DESIGN  
202 CENTRAL AVENUE SE SUITE 200  
ALBUQUERQUE, NEW MEXICO 87102  
PHONE: 505.242.6880 FAX: 505.242.6881

CITY OF ALBUQUERQUE  
PUBLIC WORKS DEPARTMENT  
ENGINEERING GROUP

TITLE: NEW MEXICO EDUCATORS FEDERAL CREDIT UNION  
TRAFFIC LIGHT WIRING AS-BUILT

Design Review Committee	City Engineer Approval	Mo./Day/Yr.	Mo./Day/Yr.

City Project No. 736582 Zone Map P-10-Z Sheet 6a Of 6



NO.	DATE	REVISIONS	BY
		DESIGN	
		DAVID A. AUBE, P.E.	
	5-21-08	DATE	
	5-21-08	DATE	
	5-21-08	DATE	

RECORD DRAWING.