

CITY OF ALBUQUERQUE  
CONSTRUCTION PLANS

FOUR HILLS ROAD MULTI-USE TRAIL  
HIDDEN VALLEY DR. SE TO STAGECOACH RD. SE

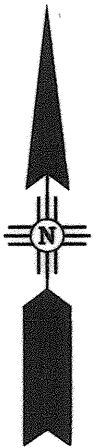

Project Location

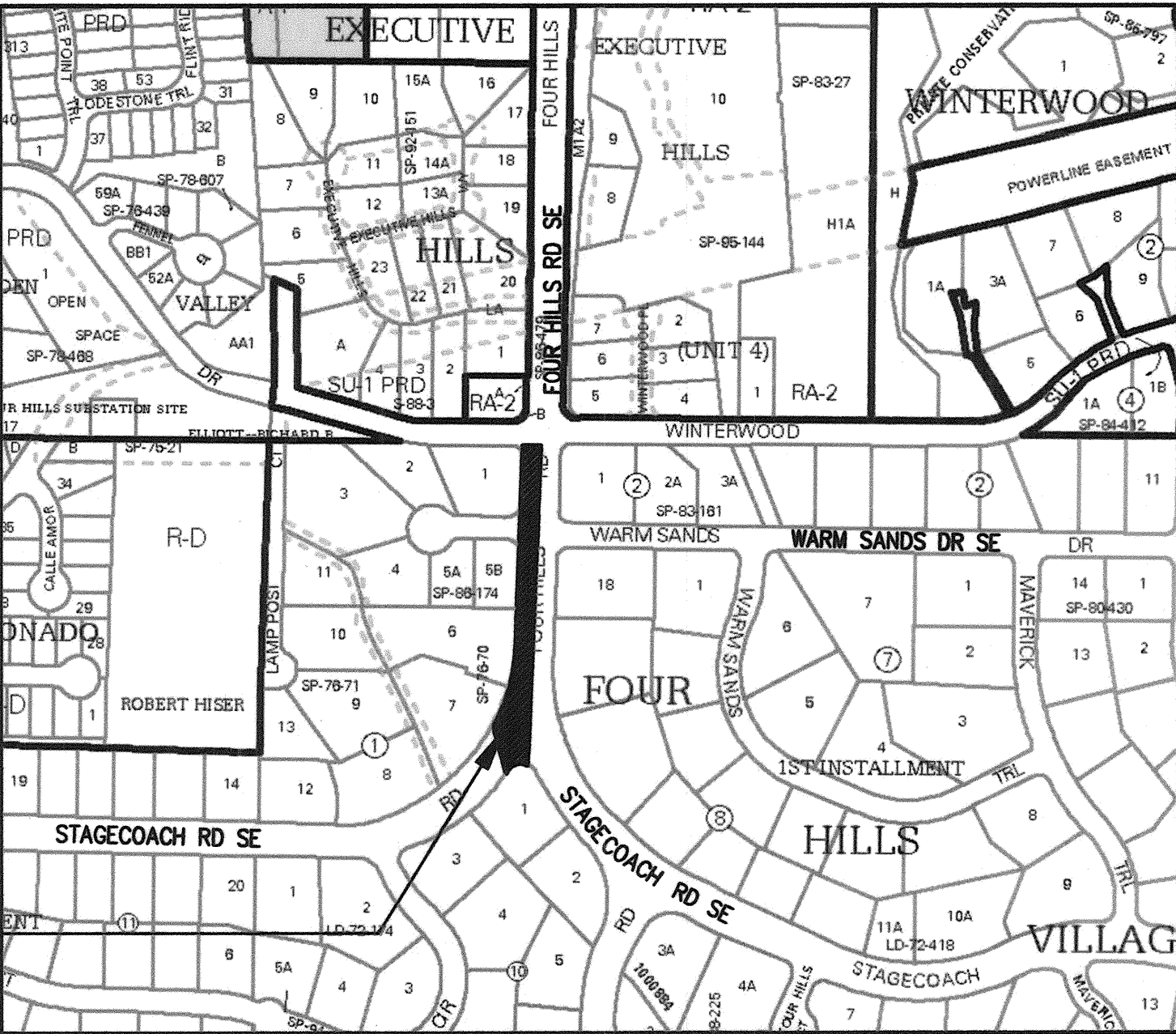

Vicinity Map  
Zone Atlas Map M-23

Index of Sheets

- 1. Cover Sheet
- 2. General Notes
- 3. Trail Plan
- 4. Trail Plan Detail at Cutoff Wall
- 5. Typical Section and Curb Ramp Details
- 6. Traffic Island Details
- 7. Signing and Driveway Details

Final Plan

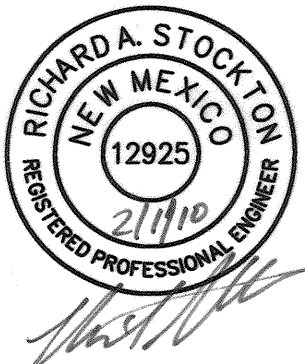

REV.	SHEETS	CITY ENGINEER	DATE	USER DEPARTMENT	DATE	USER DEPARTMENT	DATE		
ENGINEERS STAMP & SIGNATURE		APPROVALS		ENGINEER		DATE		*****	
		DRC Chairman	<i>[Signature]</i>	2-17-10	APPROVED FOR CONSTRUCTION				
		Transportation	<i>[Signature]</i>	2-4-10					
		ABCWUA	<i>[Signature]</i>	2-16-10					
		Hydrology	<i>[Signature]</i>	2-16-10					
		Parks	NA						
		Constr. Coord.	NA		<i>Bridley D. Bighan</i> 2/17/10 City Engineer Date				
		Traffic Eng.	NA						
		NMUI	NA						
		AMAFCA	NA						
PROJECT NO.				7380.02		1 of 7			



GENERAL NOTES:

1.

ALL WORK DETAILED ON THESE PLANS TO BE PERFORMED UNDER CONTRACT SHALL, EXCEPT AS OTHERWISE STATED OR PROVIDED HEREON, BE CONSTRUCTED IN ACCORDANCE WITH THE CITY OF ALBUQUERQUE STANDARD SPECIFICATIONS, 1986 EDITION, THROUGH UPDATE NO. 7.
2.

THE CONTRACTOR SHALL PROVIDE INGRESS AND EGRESS TO LOCAL BUSINESSES AND RESIDENCES FOR THE DURATION OF THE PROJECT. THE CONTRACTOR SHALL ADVISE OF AND SCHEDULE ACCESS CLOSURES, AT LEAST 24 HOURS IN ADVANCE, WITH PROPERTY OWNERS AND THE CONSTRUCTION PROJECT MANAGER.
3.

IF A PAVEMENT DROP-OFF IS CREATED DURING CONSTRUCTION, THE CONTRACTOR SHALL INITIATE PROTECTIVE ACTION IN ACCORDANCE WITH THE NMDOT'S CURRENT "DROP-OFF-GUIDELINE". THIS WORK SHALL BE CONSIDERED INCIDENTAL TO THE COMPLETION OF THE PROJECT AND NO SEPARATE MEASUREMENT OR PAYMENT WILL BE MADE THEREFOR.
4.

SEVEN (7) WORKING DAYS PRIOR TO BEGINNING CONSTRUCTION THE CONTRACTOR SHALL SUBMIT TO THE CONSTRUCTION COORDINATION DIVISION A DETAILED CONSTRUCTION SCHEDULE. TWO (2) WORKING DAYS PRIOR TO CONSTRUCTION THE CONTRACTOR SHALL OBTAIN A BARRICADING PERMIT FROM THE CONSTRUCTION COORDINATION DIVISION. THE CONTRACTOR SHALL NOTIFY BARRICADE ENGINEER (924-3400) PRIOR TO OCCUPYING AN INTERSECTION.
5.

DELETED.
6.

CRITICAL INTERSECTION WORK SHALL NOT START UNTIL THE CONTRACTOR HAS ALL MATERIAL, EQUIPMENT, AND NECESSARY PERSONNEL ON-SITE. TRAFFIC CONTROL DEVICES SHALL NOT BE PLACED PREMATURELY.
7.

OVERNIGHT PARKING OF CONSTRUCTION VEHICLES ON PRIVATE PROPERTY IS THE SOLE RESPONSIBILITY OF THE CONTRACTOR.
8.

THE CONTRACTOR SHALL NOTIFY THE ALBUQUERQUE TRAFFIC ENGINEERING DIVISION THREE (3) WORKING DAYS IN ADVANCE OF ANY WORK REQUIRED REGARDING ALL EXISTING REGULATORY SIGNS AND SIGNALS THAT NEED TO BE REMOVED, RELOCATED, OR REINSTALLED. CALL 857-8680. REFER TO SECTION 18.4.4 OF THE SPECIFICATIONS. THIS WORK SHALL BE CONSIDERED INCIDENTAL TO CONSTRUCTION AND NO ADDITIONAL PAYMENT WILL BE MADE.
9.

THE CONTRACTOR WILL BE REQUIRED TO CONFINE THEIR WORK WITHIN THE CONSTRUCTION LIMITS AND/OR R.O.W. TO PRESERVE EXISTING VEGETATION AND PRIVATE PROPERTY. OVERNIGHT PARKING OF CONSTRUCTION EQUIPMENT SHALL NOT OBSTRUCT DRIVEWAY OPENINGS OR DESIGNATED TRAFFIC LANES.
10.

IT SHALL BE THE CONTRACTOR'S RESPONSIBILITY TO ENSURE THAT BUILDING STRUCTURES ADJACENT TO THE PROJECT NOT BE DAMAGED DUE TO ANY CONSTRUCTION ACTIVITIES. DAMAGE CAUSED TO ANY BUILDING STRUCTURE WILL BE THE SOLE RESPONSIBILITY OF THE CONTRACTOR, INCLUDING ALL COSTS INCURRED IN RESTORING/REPAIRING SAID DAMAGE.
11.

THE CONTRACTOR SHALL MAINTAIN AN UP TO DATE SET OF AS-BUILT PLANS FOR THE PROJECT. THESE PLANS SHALL BE KEPT CURRENT, WITHIN TWO WEEKS, AT ALL TIMES AND SHALL BE SUBJECT TO REVIEW BY THE PROJECT MANAGER THROUGHOUT THE PROJECT AND WILL BE REVIEWED BY THE PROJECT MANAGER FOR ACCURACY AND COMPLETENESS AT LEAST ONCE EVERY 30 DAYS. THE FINAL AS-BUILT PLANS SHALL BE SUBMITTED TO THE PROJECT MANAGER PRIOR TO FINAL PAYMENT.
12.

THE CONTRACTOR SHALL MAINTAIN A GRAFFITI FREE WORK SITE AND SHALL PROMPTLY REMOVE ANY AND ALL GRAFFITI FROM EQUIPMENT, WHETHER PERMANENT OR TEMPORARY. THIS WORK SHALL BE CONSIDERED INCIDENTAL TO THE COMPLETION OF THE PROJECT AND NO SEPARATE MEASURE OR PAYMENT WILL BE MADE THEREFOR.
13.

THE CONTRACTOR SHALL BE RESTRICTED TO THE USE OF A 35 TON MAXIMUM NON-VIBRATORY ROLLER TO OBTAIN THE REQUIRED COMPACTION IN PAVEMENT STRUCTURE, ROADWAY BACKFILL, EMBANKMENT, AND SUBGRADES IN URBAN AREAS WHERE THE USE OF HEAVIER EQUIPMENT COULD DAMAGE UNDERGROUND UTILITIES OR OTHER PERMANENT STRUCTURES.
14.

ALL NEW STREET PAVING, CURB AND GUTTER, SIDEWALKS OR DRIVE PADS SHALL MATCH THE ELEVATIONS OF ABUTTING EXISTING AREAS AS SHOWN IN THE PLANS OR AS DIRECTED BY THE PROJECT MANAGER.
15.

CURB RAMPS SHALL BE CONSTRUCTED AT ALL CURB RETURNS CONSTRUCTED WITH THIS PROJECT AT THE LOCATIONS SHOWN ON PLANS, IN ACCORDANCE WITH THE CITY STANDARD DETAILS. CURB RAMPS SHALL BE MEASURED AND PAID PER SQUARE YARD OF SURFACE AREA. DETECTABLE WARNING SURFACES ARE CONSIDERED INCIDENTAL TO CURB RAMPS AND NO SEPARATE MEASUREMENT OR PAYMENT WILL BE MADE THEREFOR.
16.

WHEN ABUTTING NEW PAVEMENT TO EXISTING, CONTRACTOR SHALL SAW CUT, TO FULL PAVEMENT DEPTH, THE EXISTING PAVEMENT TO A NEAT VERTICAL STRAIGHT LINE AS REQUIRED TO REMOVE ANY BROKEN OR CRACKED PAVEMENT AND MATCH NEW TO EXISTING. THIS WORK SHALL BE CONSIDERED INCIDENTAL AND NO ADDITIONAL PAYMENT WILL BE MADE THEREFOR.
17.

ALL WATER VALVE BOXES AND SEWER MANHOLES IN THE CONSTRUCTION AREA ARE TO BE ADJUSTED TO FINISH GRADE UNDER THIS CONTRACT, AND WILL BE PAID FOR AT CONTRACT UNIT PRICES.
18.

ENDS OF NEW CURB AND GUTTER SHALL BE TAPERED FROM 8" TO 0" IN HEIGHT OVER A LENGTH OF 5 FEET. PAYMENT FOR THIS WORK SHALL BE PAID FOR AS LINEAR FEET OF STANDARD CURB AND GUTTER AND NO ADDITIONAL PAYMENT WILL BE MADE THEREFOR.
19.

THE CONTRACTOR SHALL WARP SLOPES WHERE NECESSARY TO STAY WITHIN THE RIGHT OF WAY OR CONSTRUCTION EASEMENT LIMITS. THE WORK SHALL BE AS DIRECTED BY THE PROJECT MANAGER.
20.

THE SUBGRADE PREP SHALL EXTEND ONE (1) FOOT BEYOND THE FREE EDGE OF NEW SIDEWALK.
21.

THE CONTRACTOR SHALL ASSUME RESPONSIBILITY FOR ANY DAMAGE TO EXISTING PAVEMENTS, PAVEMENT MARKINGS, CURB AND GUTTER, DRIVEPADS, CURB RAMPS, AND SIDEWALK DURING CONSTRUCTION APART FROM THOSE SECTIONS INDICATED FOR REMOVAL ON THE PLANS, AND SHALL REMOVE AND REPLACE AS PER COA STANDARDS AT THE CONTRACTOR'S EXPENSE.
22.

THE CONTRACTOR SHALL BE RESPONSIBLE FOR ALL REMOVALS REQUIRED TO COMPLETE THE PROJECT. ADDITIONAL REMOVALS NOT SHOWN ON THE PLANS WILL BE CONSIDERED AS INCLUDED IN THE CONTRACT PRICE FOR 202.01 - REMOVE AND SALVAGE OR DISPOSE STRUCTURES AND OBSTRUCTIONS. HAULING OF REMOVALS AND MATERIAL TO BE DISPOSED SHALL BE CONSIDERED AS INCIDENTAL TO THE PROJECT.
23.

WHEN REMOVAL OF EXISTING CURB AND GUTTER OR SIDEWALK IS REQUIRED, REMOVE TO NEAREST JOINT.
24.

ALL CONSTRUCTION DEBRIS, SPOIL AND NON-SALVAGEABLE ITEMS BECOME THE PROPERTY OF THE CONTRACTOR AND PROPER DISPOSAL OF THESE ITEMS IS THE RESPONSIBILITY OF THE CONTRACTOR. ANY HAUL COSTS ASSOCIATED WITH THIS WORK IS CONSIDERED INCIDENTAL TO THE PROJECT.
25.

SALVAGEABLE MATERIALS FROM THIS PROJECT ARE TO BE HAULED AND STOCKPILED AT THE CITY OF ALBUQUERQUE PINO YARDS, HAUL OF SUCH MATERIAL SHALL BE PERFORMED DURING NORMAL WORKING HOURS AS DIRECTED BY THE PROJECT MANAGER. PAYMENT FOR THIS WORK SHALL BE INCLUDED IN THE CONTRACT PRICE FOR EACH SALVAGE ITEM.

GENERAL NOTES CONTINUED:

26.

THE CONTRACTOR SHALL CLEAN ALL EXISTING STRUCTURES THAT ARE TO REMAIN OPERATIONAL. ALL STRUCTURES (NEW AND EXISTING) SHALL BE CLEAN AT THE TIME OF FINAL PROJECT ACCEPTANCE. THIS WORK SHALL BE CONSIDERED AS INCIDENTAL TO CONSTRUCTION. NO SEPARATE MEASUREMENT AND PAYMENT WILL BE MADE FOR CLEANING OF STRUCTURES.
27.

EXCAVATION, TRENCHING AND SHORING ACTIVITIES MUST BE CARRIED OUT IN ACCORDANCE WITH OSHA 29 CFR 1926.650 SUBPART P. THE CONTRACTOR SHALL BE RESPONSIBLE FOR THEIR EMPLOYEES SAFETY.
28.

THE CONTRACTOR SHALL PROVIDE AND MAINTAIN ALL CONSTRUCTION SIGNING UNTIL PROJECT HAS BEEN ACCEPTED BY THE CITY OF ALBUQUERQUE.

UTILITY OWNERS:

Musinski, Nancy	Office phone: (505) 768-2729 Office fax: 768-3629 <a href="mailto:nmusinski@abcwua.org">nmusinski@abcwua.org</a>	Water Utility Senior Engineer, Utility Engineering P.O. Box 1293 Albuquerque, NM 87103
Dunlop, Joe	Office phone: (505) 697-3156 <a href="mailto:joe.dunlop@pnm.com">joe.dunlop@pnm.com</a>	New Mexico Gas Mail Stop GS66 4625 Edith Blvd. NE Albuquerque, NM 87107
Kozlowski, Anthony	Office phone: (505) 241-3637 Cell: (505) 681-7639 Office fax: (505) 241-3620	PNM Electric 4625 Edith Blvd. NE Albuquerque, NM 87107
Stockton, David	Office phone: (303) 620-2254 Cell phone: (720) 219-8746 Area	AT&T Manager - GNFO 3910 Jacinto Street, Room 4 Dallas, TX 75024
Harrison, Royal	Office phone: (505) 938-7339 Office fax: 938-7380 <a href="mailto:Royal.Harrison@twtelecom.com">Royal.Harrison@twtelecom.com</a>	tw telecom of New Mexico LLC. Plant Manager
Jaramillo, Rita	Office phone: (505) 245-8352 Office fax: (505) 245-6733 Cell: (505) 385-4472 Pager: (505) 380-3301 <a href="mailto:rjarami@qwest.com">rjarami@qwest.com</a>	Qwest Manager - Engineering NM Engineering/Planning 400 Tijeras NW, Room 710 Albuquerque, NM 87102
Kelly, Larry	Office phone: (505) 246-0501 Office fax: (505) 246-0479 Cell: (505) 270-3442 <a href="mailto:Larry.Kelly@qwest.com">Larry.Kelly@qwest.com</a>	Qwest Long Distance Sr. Operations Tech 400 Tijeras Ave NW Suite 570 Albuquerque, NM 87102
Mortus, Mike	Office phone: (505) 761-6252 Office fax: (505) 761-0599 Cell: (505) 269-4006 <a href="mailto:Mike.Mortus@cable.comcast.com">Mike.Mortus@cable.comcast.com</a>	Comcast Project Manager 4611 Montbel Place NE Albuquerque, NM 87107
Mueller, Rick	Office phone: (505) 217-0038 Office fax: 217-0048 Cell: (505) 228-3329 <a href="mailto:richard.mueller@mcleodusa.com">richard.mueller@mcleodusa.com</a>	McLeod USA Supervisor of Outside Techs. 505 Marquette NW (Compass Bank) Suite 1600 Albuquerque, NM 87102
Korita, Brian	<a href="mailto:bkorito@redflex.com">bkorito@redflex.com</a>	Redflex
Lindell, Bill	Office phone: (505) 877-2300 Cell: (505) 235-5325 <a href="mailto:Bill-nmuci@qwest.net">Bill-nmuci@qwest.net</a>	New Mexico Underground Inc

LEGEND:

- NEW ASPHALT
- NEW CONCRETE
- SIGN, AS NOTED
- EXISTING SHRUB OR TREE
- EXISTING WATER METER OR VAULT



<div><div></div><div>CITY OF ALBUQUERQUE DEPARTMENT OF MUNICIPAL DEVELOPMENT TRANSPORTATION DIVISION</div></div>			
FOUR HILLS ROAD MULTI-USE TRAIL GENERAL NOTES			
DESIGN REVIEW COMMITTEE <div>APPROVE FEB 17 2010 DESIGN REVIEW COMMITTEE</div>	CITY ENGINEER APPROVAL <div>APPROVE FEB 17 2010 CITY ENGINEER</div>	MO./DAY/YR.	MO./DAY/YR.
City Project No. 7380.02	Zone Map No. M-23	Sheet	2 of 7







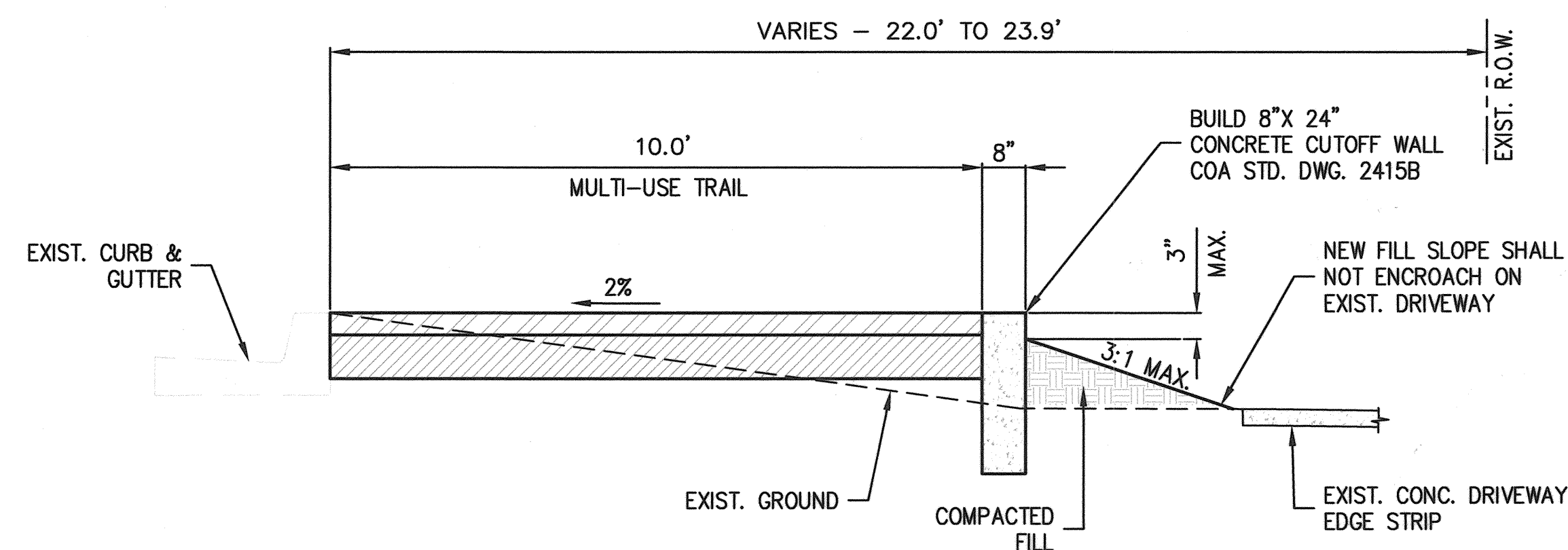
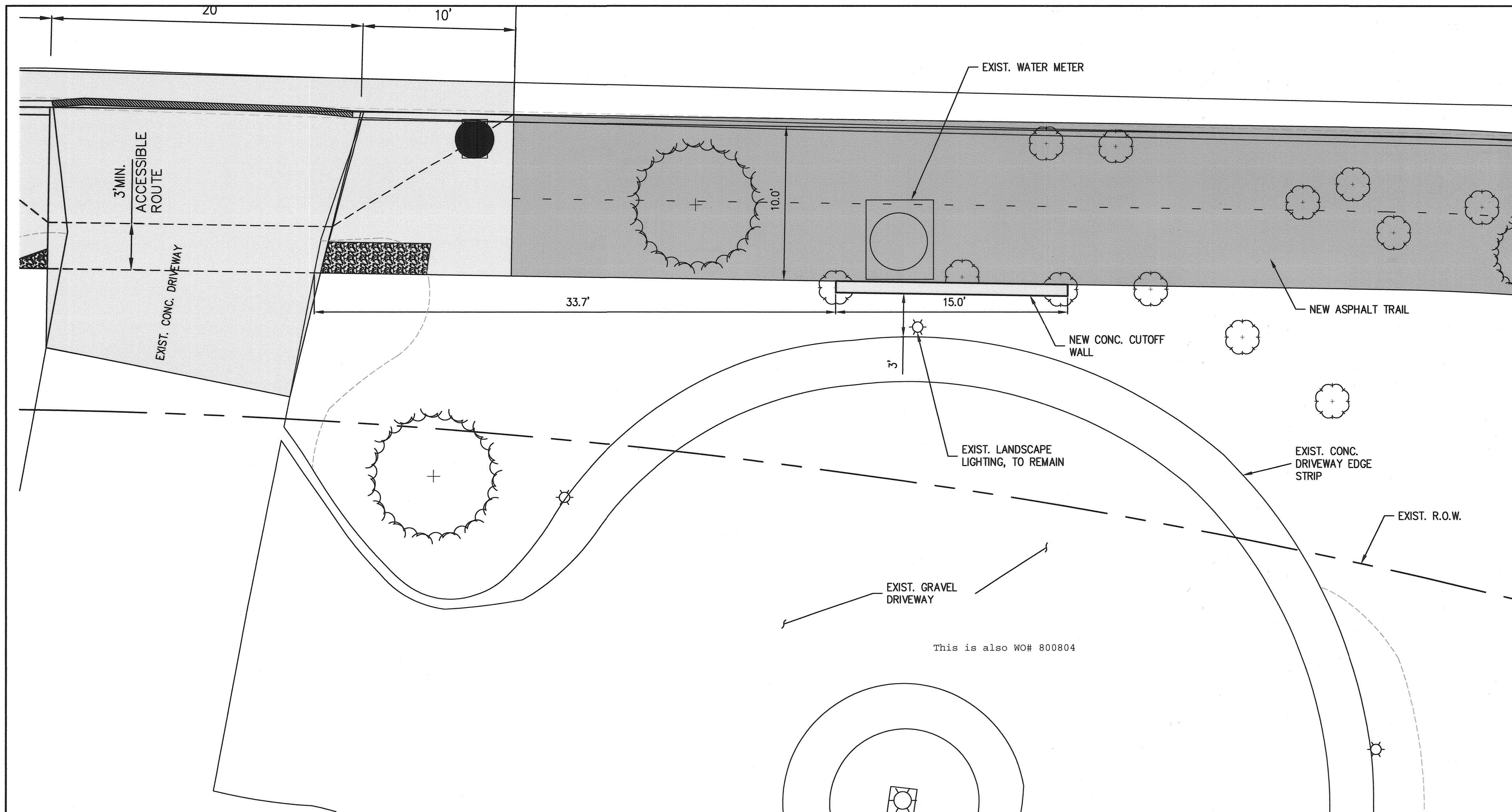

TRAIL SECTION AT CUTOFF WALL  
N.T.S

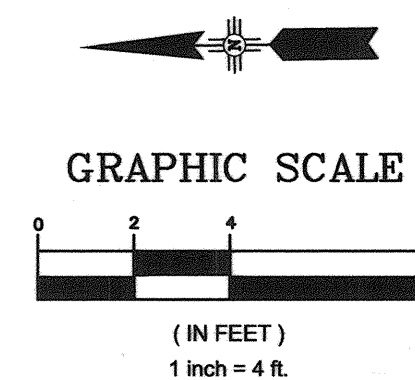

CITY OF ALBUQUERQUE DEPARTMENT OF MUNICIPAL DEVELOPMENT TRANSPORTATION DIVISION			
<b>FOUR HILLS ROAD MULTI-USE TRAIL          TRAIL PLAN DETAIL AT CUTOFF WALL</b>			
DESIGN REVIEW COMMITTEE  DESIGN REVIEW COMMITTEE	CITY ENGINEER APPROVAL  CITY ENGINEER	MO./DAY/YR.	MO./DAY/YR.
City Project No. 7380.02		Zone Map No. M-23	Sheet 4 of 7

ENGINEER'S SEAL				SURVEY INFORMATION				BENCH MARKS				AS BUILT INFORMATION			
 NO. DATE BY				FIELD NOTES				CITY OF ALBUQUERQUE CONTROL				CONTRACTOR			
				NO. BY				DATE				WORK			
				REMARKS				STATION 8+122. A 3 1/4" ALUMINUM DISC				STAMPED BY			
				DESIGN				STAMPED "8-122 1990" LOCATED AT				APPROVED BY			
				DATE: 10/2009				THE INTERSECTION OF CENTRAL AVENUE				DATE			
DESIGNED BY: HDB/KVC				AND TRAMWAY BLVD.				DRAWINGS				DATE			
DRAWN BY: KVC/WV				N = 1480177.419				CORRECTED BY				MICRO-FILM INFORMATION			
CHECKED BY: RAS				E = 1566414.815				RECORDED BY				DATE			
				ELEV. = 5668.036' (NAVD 1988)				NO.							



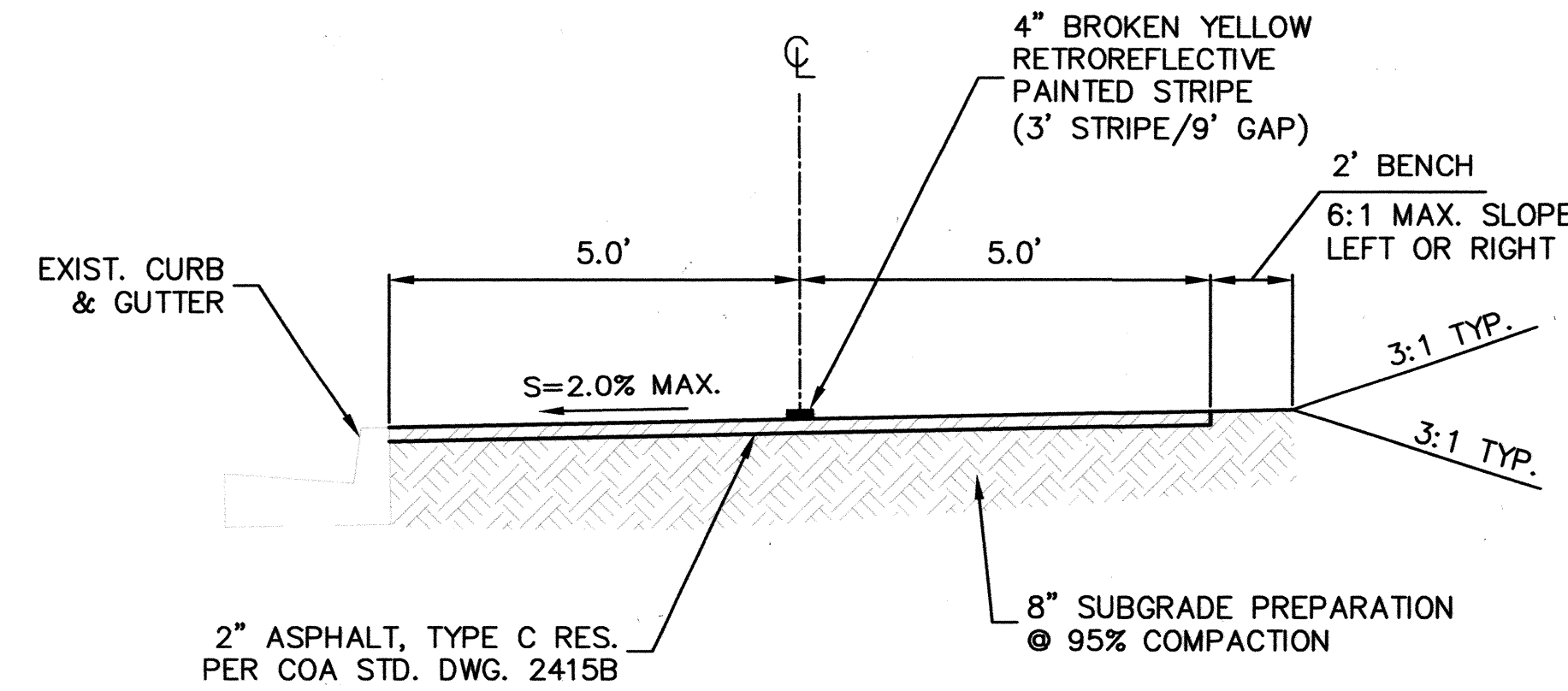
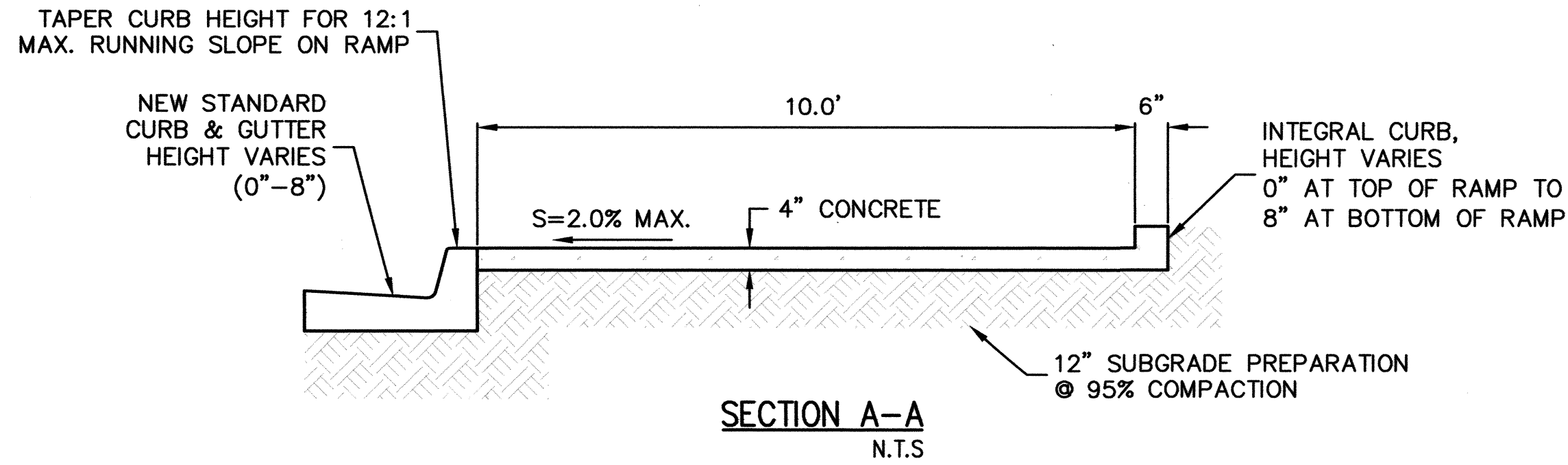

# GENERAL NOTES

1. TREES AND SHRUBS LOCATED WITHIN 2' OF TRAIL SHALL BE REMOVED UNLESS OTHERWISE NOTED ON PLAN.
2. DETECTABLE WARNING SURFACES SHALL COMPLY WITH AMERICANS WITH DISABILITIES ACT REQUIREMENTS. CONTRACTOR SHALL SUBMIT PROPOSED MATERIALS TO ENGINEER FOR APPROVAL PRIOR TO PLACEMENT.
3. TAPER CURB HEIGHT FOR SUFFICIENT LENGTH TO ACHIEVE 12:1 MAX. RUNNING SLOPE ON CURB RAMP.

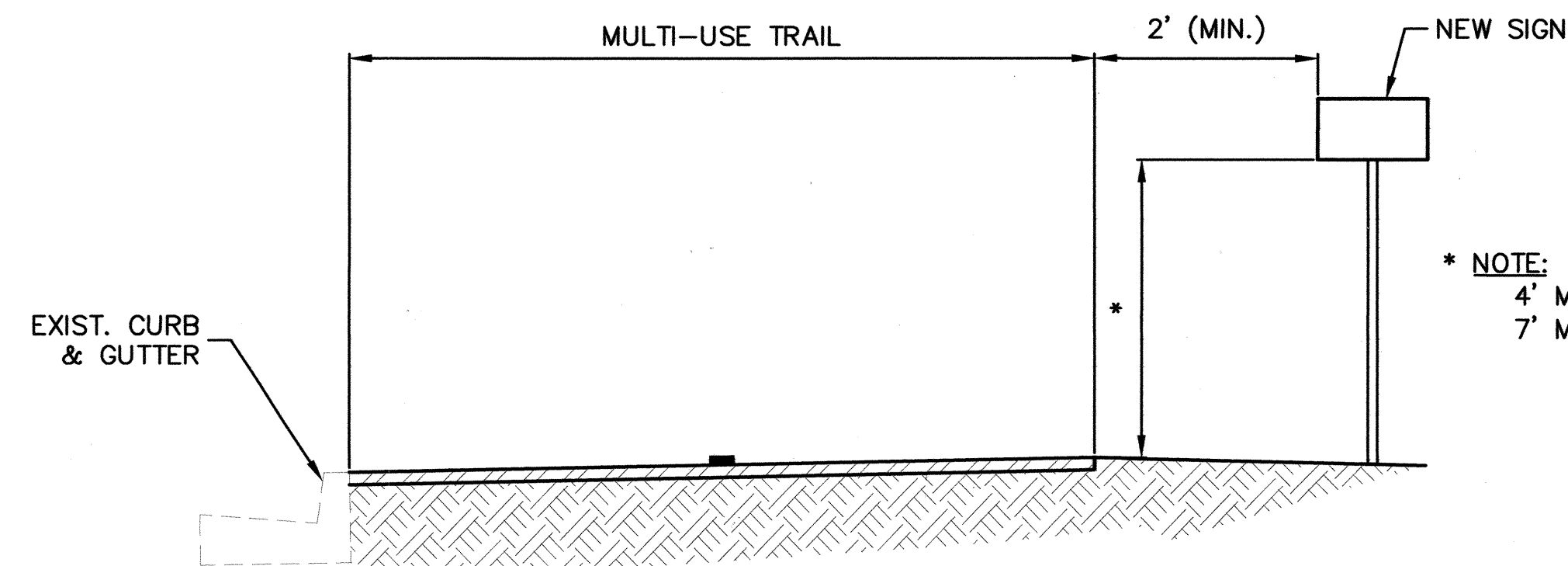
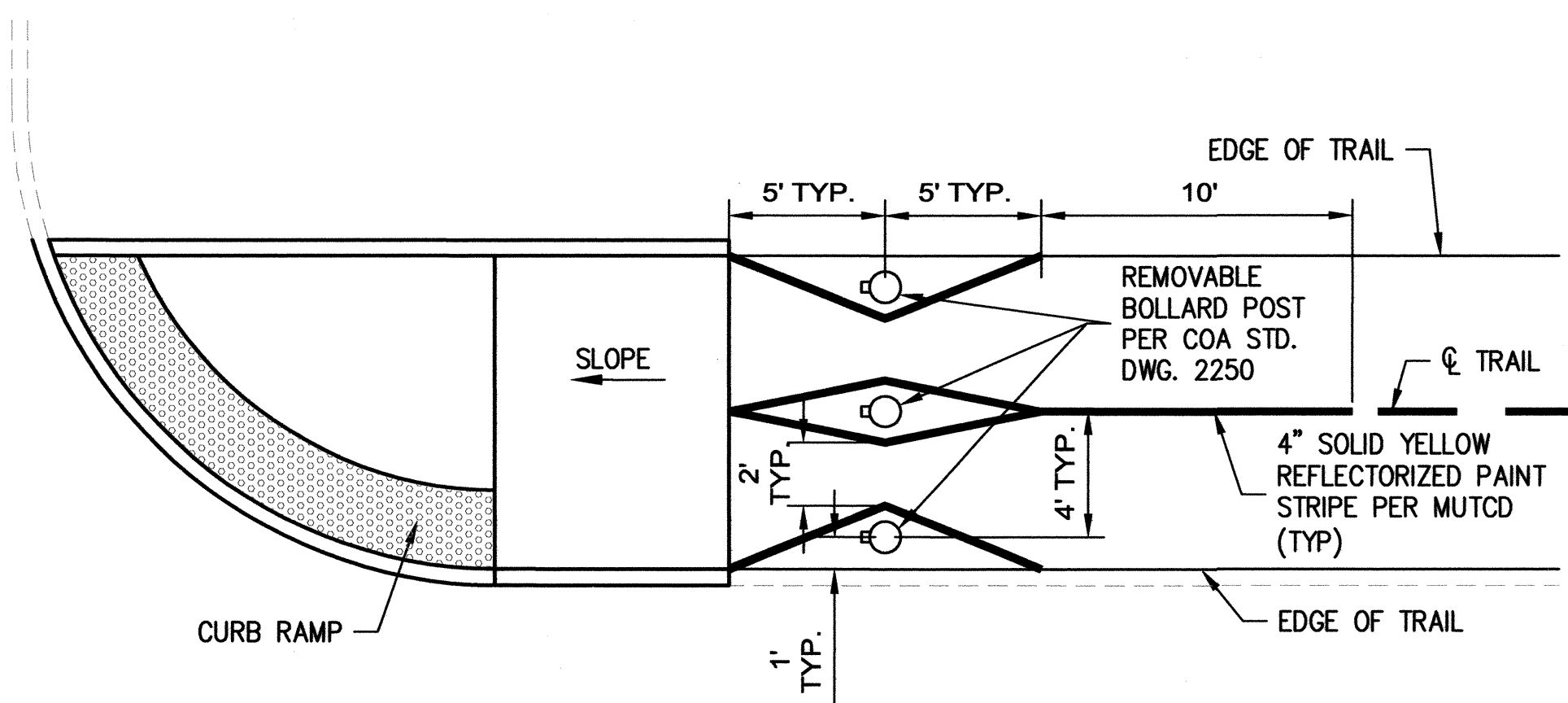
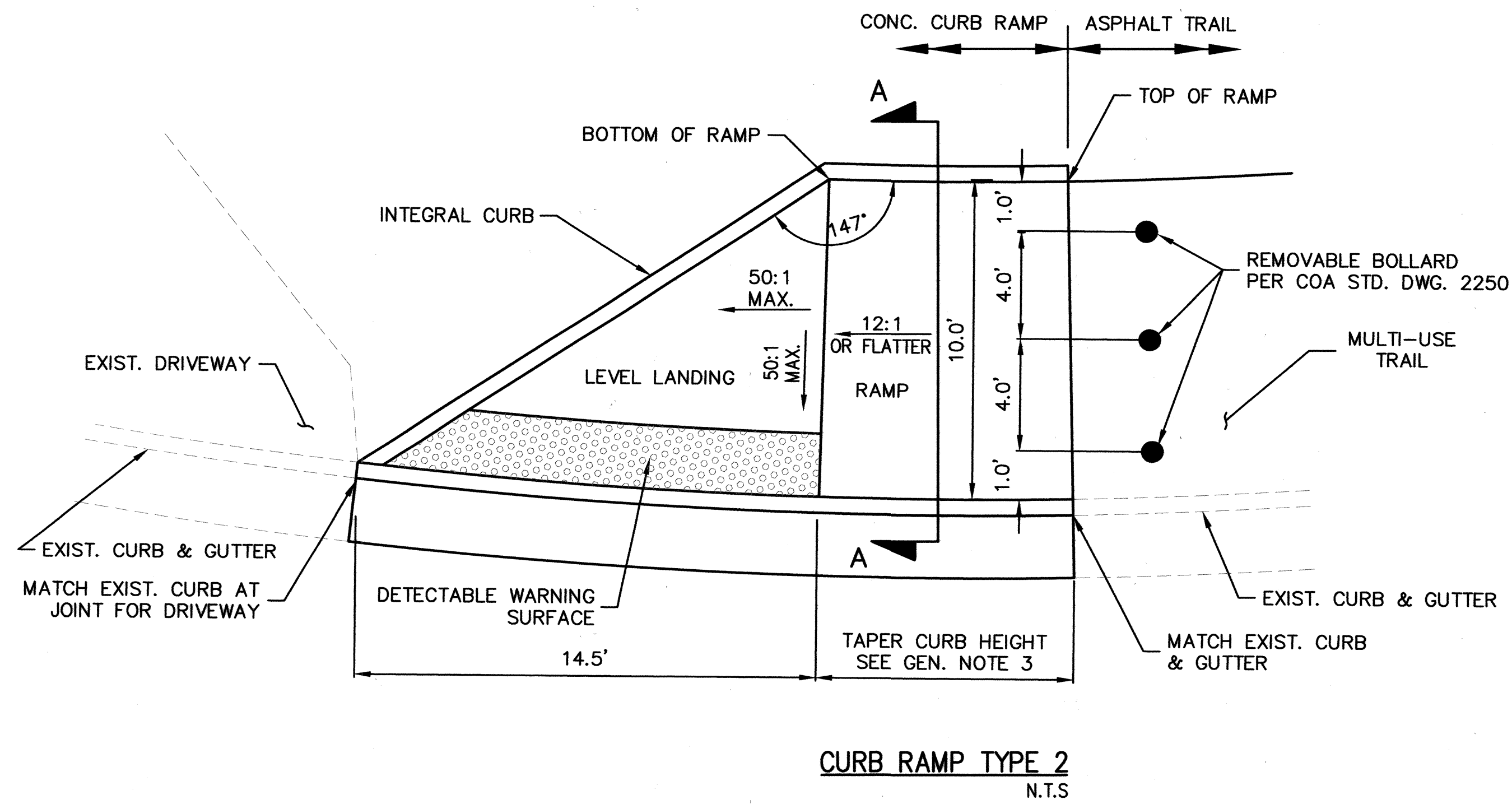
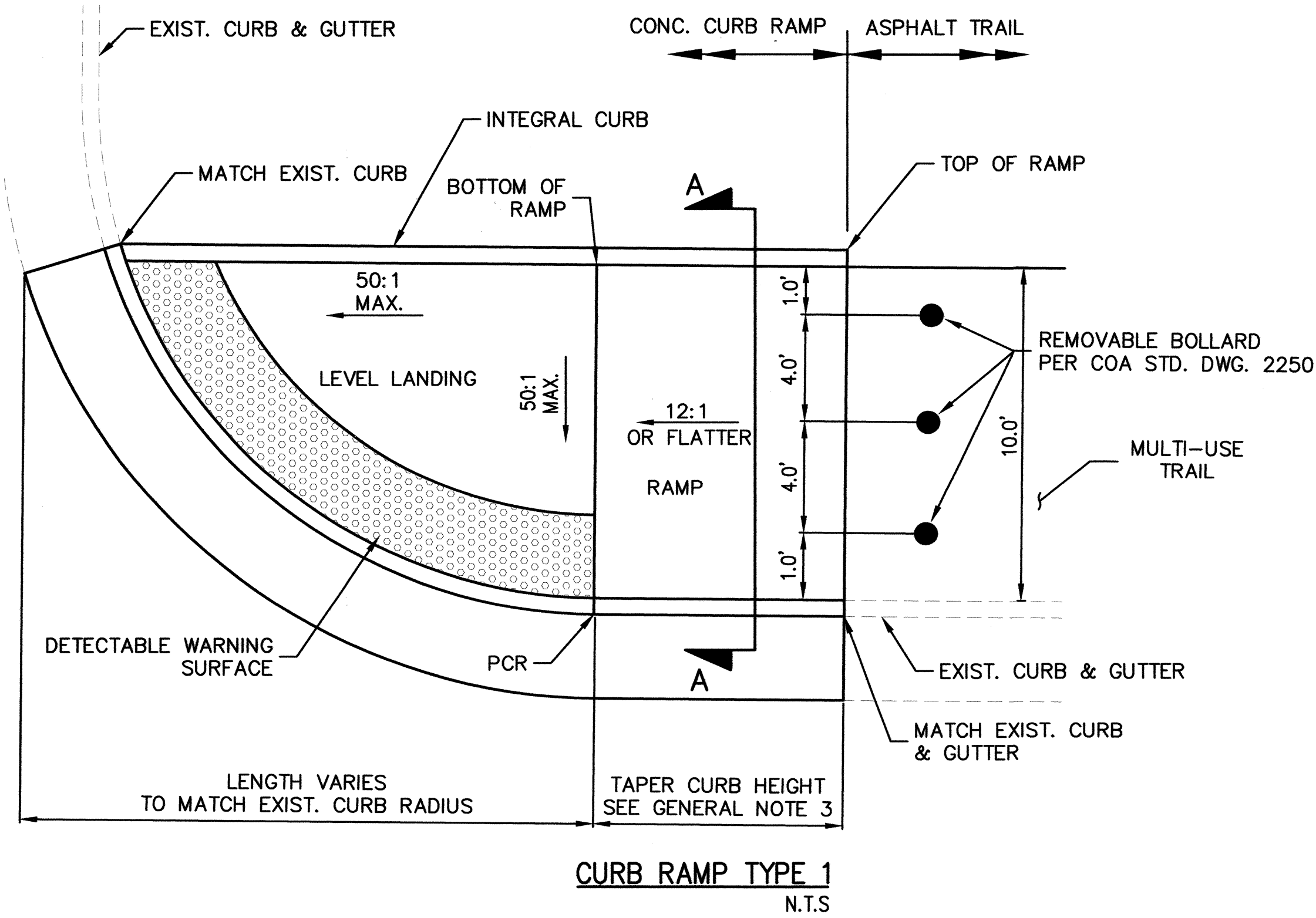

- \* NOTE:  
4' MIN. FOR NEW TRAIL SIGNS.  
7' MIN. FOR RELOCATED STREET SIGNS.

CITY OF ALBUQUERQUE DEPARTMENT OF MUNICIPAL DEVELOPMENT TRANSPORTATION DIVISION			
FOUR HILLS ROAD MULTI-USE TRAIL TYPICAL SECTION AND CURB RAMP DETAILS			
DESIGN REVIEW COMMITTEE APPROVED FEB 17 2010 DESIGN REVIEW COMMITTEE	CITY ENGINEER APPROVAL APPROVED FEB 17 2010 CITY ENGINEER	MO./DAY/YR.	MO./DAY/YR.
City Project No. 7380.02	Zone Map No. M-23	Sheet 5 of 7	









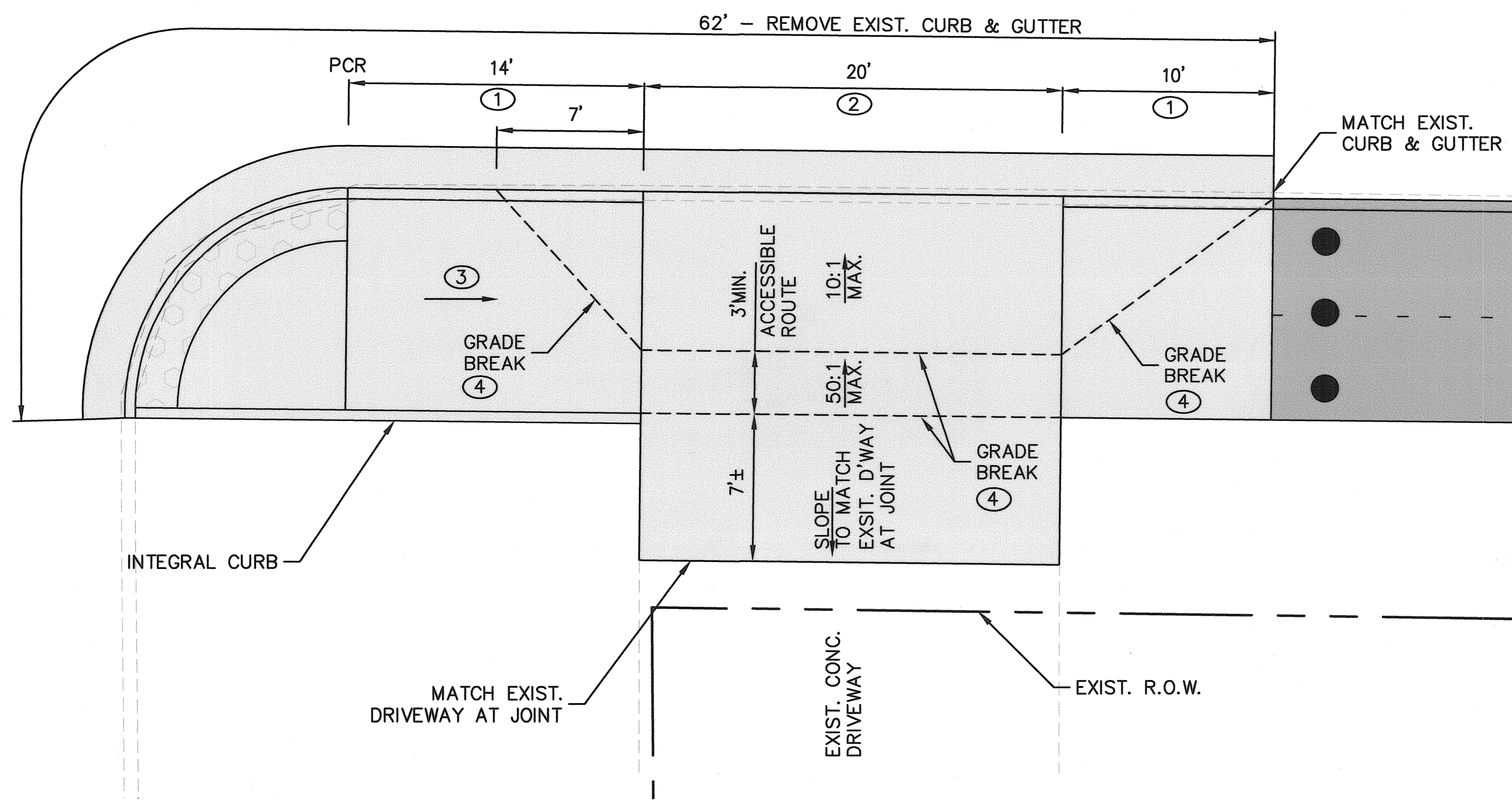

DRIVEWAY No. 1  
N.T.S.

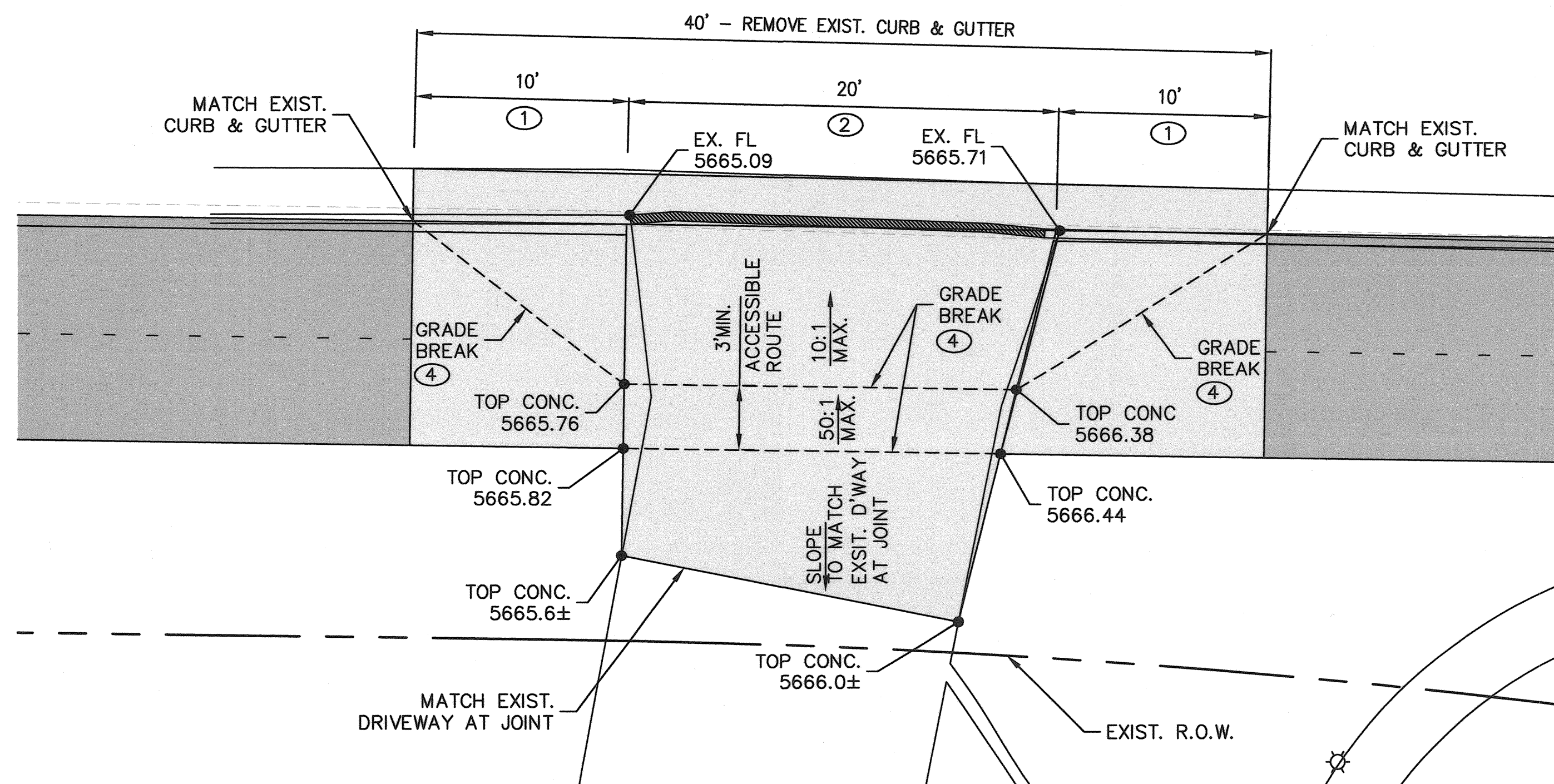

DRIVEWAY No. 2  
N.T.S.



SP-1

⑤



SP-2  
12" x 12"  
W/G



R5-3-24

## GENERAL NOTES

- NEW DRIVEWAYS SHALL BE 6" THICK CONCRETE PLACED ON 12" SUBGRADE PREP. @ 95% COMPACTION.

## KEYED NOTES:

- STANDARD CURB & GUTTER PER COA STD. DWG. 2415A, TAPER HEIGHT TO MATCH GUTTER AT DRIVEPAD
- GUTTER AT DRIVE PAD PER COA STD. DWG. 2415A.
- PROVIDE SMOOTH RAMP SLOPE (12:1 MAX.) TO CONNECT LEVEL LANDING AT CURB RAMP TO DRIVEWAY.
- PROVIDE WATERBLOCK AT DRIVEPAD. ELEVATION AT GRADE BREAK TO BE 8" ABOVE CORRESPONDING FLOWLINE ELEVATION AT STREET.
- THESE SIGNS SHALL MATCH EXISTING SIGNS PRESENT ALONG TRAIL NORTH OF HIDDEN VALLEY DRIVE.

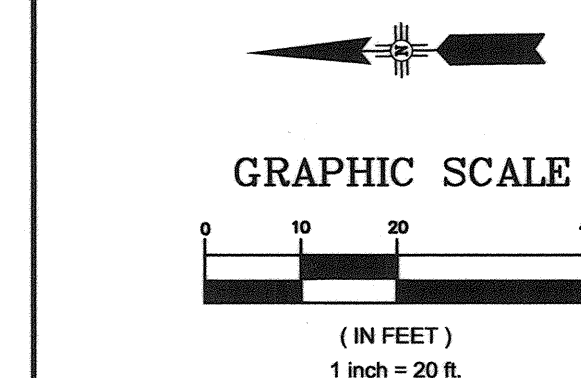

CITY OF ALBUQUERQUE DEPARTMENT OF MUNICIPAL DEVELOPMENT TRANSPORTATION DIVISION	
FOUR HILLS ROAD MULTI-USE TRAIL SIGNING & DRIVEWAY DETAILS	
DESIGN REVIEW COMMITTEE APPROVE FEB 17 2010 DESIGN REVIEW COMMITTEE	CITY ENGINEER APPROVAL APPROVE FEB 17 2010 CITY ENGINEER
City Project No. 7380.02	Zone Map No. M-23
Sheet 7 of 7	

