



(SEE PLANS FOR ITEMS WITHIN THIS PROJECT)

## GENERAL NOTES

1. ALL WORK DETAILED ON THESE PLANS TO BE PERFORMED UNDER THIS CONTRACT SHALL, EXCEPT AS OTHERWISE STATED OR PROVIDED FOR HEREON, BE CONSTRUCTED IN ACCORDANCE WITH THE CITY OF ALBUQUERQUE STANDARD SPECIFICATIONS FOR PUBLIC WORKS CONSTRUCTION - 1986 EDITION (REFERRED TO HEREAFTER AS THE STANDARD SPECIFICATIONS AS UPDATED THROUGH UPDATE NO. 7.)
2. TWO (2) WORKING DAYS PRIOR TO ANY EXCAVATION, CONTACT NEW MEXICO ONE-CALL SYSTEM, PH. 260-1990, FOR LOCATION OF EXISTING OFF-SITE UTILITIES.
3. PRIOR TO CONSTRUCTION, EXCAVATE AND VERIFY THE HORIZONTAL AND VERTICAL LOCATIONS OF ALL OBSTRUCTIONS. SHOULD A CONFLICT EXIST, NOTIFY THE ENGINEER SO THAT THE CONFLICT CAN BE RESOLVED WITH A MINIMUM AMOUNT OF DELAY.
4. COORDINATE CONSTRUCTION ACTIVITIES WITH OTHER CONTRACTORS AND UTILITY COMPANIES WORKING IN THE SAME AREA.
5. ALL PERMANENT ROW AND CONSTRUCTION EASEMENTS ON PRIVATE PROPERTY WILL BE OBTAINED BY THE CITY OF ALBUQUERQUE PRIOR TO THE BEGINNING OF CONSTRUCTION, AS APPLICABLE.
6. WHEN ABUTTING NEW PAVEMENT TO EXISTING, SAWCUT EXISTING PAVEMENT TO A STRAIGHT LINE, AS REQUIRED, TO REMOVE ANY BROKEN OR CRACKED PAVEMENT. APPLY TACK COAT AND MATCH NEW TO EXISTING.
7. EXERCISE DUE CARE TO AVOID DISTURBING EXISTING UNDERGROUND UTILITIES. COORDINATE WITH THE UTILITY COMPANIES IN ORDER TO PREVENT ANY SERVICE DISRUPTION.
8. TWO (2) WORKING DAYS PRIOR TO CONSTRUCTION, OBTAIN A BARRICADING PERMIT FROM THE CONSTRUCTION COORDINATION DIVISION. NOTIFY BARRICADE ENGINEER (924-3400) PRIOR TO OCCUPYING STREET.
9. REPLACE ALL STREET STRIPING ALTERED OR DESTROYED WITH PLASTIC REFLECTORIZED PAVEMENT MARKINGS TO EXISTING LOCATION OR AS INDICATED BY THIS PLAN SET.
10. NOTIFY THE ENGINEER NOT LESS THAN SEVEN (7) CALENDAR DAYS PRIOR TO STARTING WORK SO THAT THE ENGINEER MAY TAKE NECESSARY MEASUREMENTS TO INSURE PRESERVATION OF SURVEY MONUMENTS. DO NOT DISTURB PERMANENT SURVEY MONUMENTS WITHOUT THE CONSENT OF THE ENGINEER. NOTIFY THE ENGINEER AND BEAR THE EXPENSE OF REPLACING ANY SURVEY MONUMENTS THAT MAY BE DISTURBED WITHOUT PERMISSION. REPLACEMENT WILL BE DONE ONLY BY THE CITY SURVEYOR. WHEN A CHANGE IS MADE IN THE FINISHED ELEVATIONS OF THE PAVEMENT OF ANY ROADWAY IN WHICH A PERMANENT SURVEY MONUMENT IS LOCATED, ADJUST, AT THE CONTRACTOR'S EXPENSE, THE MONUMENT COVER TO THE NEW GRADE UNLESS OTHERWISE SPECIFIED. REFER TO SECTION 4.4 OF THE GENERAL CONDITIONS OF THE STANDARD SPECIFICATIONS.
11. AN EXCAVATION/CONSTRUCTION PERMIT WILL BE REQUIRED BEFORE BEGINNING WORK WITHIN THE CITY RIGHT-OF-WAY. AN APPROVED COPY OF THESE PLANS MUST BE SUBMITTED AT THE TIME OF APPLICATION FOR THIS PERMIT.
12. REPLACE ALL TRAFFIC SIGNS REMOVED IN KIND TO ORIGINAL LOCATIONS OR AS INDICATED BY THIS PLAN SET. THE CONTRACTOR SHALL NOTIFY THE CITY CONSTRUCTION COORDINATOR THREE (3) WORKING DAYS IN ADVANCE OF ANY REQUIRED WORK.
13. CONTRACTOR IS RESPONSIBLE FOR ANY DAMAGE TO EXISTING FACILITIES, PAVEMENTS, PAVEMENT MARKINGS, CURB AND GUTTER, DRIVEPADS, WHEELCHAIR RAMPSES, SIDEWALK, AND ANY OTHER IMPROVEMENTS DURING CONSTRUCTION EXCEPT FOR THOSE SECTIONS INDICATED FOR REMOVAL ON THE PLANS. REPAIR OR REPLACE DAMAGED IMPROVEMENTS PER COA STANDARDS AT CONTRACTOR'S EXPENSE. PROTECT CURB AND GUTTER FROM INCIDENTAL SPLASHING DURING THE TACK COAT APPLICATION AND CLEAN SAME AT CONTRACTOR'S EXPENSE SHOULD SPLASHING OCCUR.
14. MAINTAIN A GRAFFITI-FREE WORK SITE. PROMPTLY REMOVE ANY AND ALL GRAFFITI FROM EQUIPMENT, WHETHER PERMANENT OR TEMPORARY. THE COST OF THIS WORK IS INCIDENTAL TO THE PROJECT AND NO ADDITIONAL PAYMENT WILL BE MADE.
15. PERFORM ALL EXCAVATION, TRENCHING AND SHORING ACTIVITIES IN ACCORDANCE WITH OSHA 29 CFR 1926.650 SUBPART P.
16. PRIOR TO THE REMOVAL OF ANY PAVEMENT, CURB AND GUTTER, AND OTHER IMPROVEMENTS, SURVEY TO ENSURE RESTORATION OF PROPER GRADES, CROWN AND ELEVATIONS. REMOVE AND REPLACE SHORT (LESS THAN 6') EXISTING SECTIONS OF PAVEMENT AND CURB AND GUTTER REMAINING AFTER PRIMARY REMOVALS ARE COMPLETED.
17. ALL REFERENCES TO CITY STANDARD DRAWINGS WILL BE PER THE STANDARD SPECIFICATIONS.

### ADDITIONAL GENERAL NOTES

1. MAINTAIN ONE RECORD COPY OF ALL SPECIFICATIONS, DRAWINGS, ADDENDA, MODIFICATIONS AND SHOP DRAWINGS AT THE SITE IN GOOD ORDER. THESE DOCUMENTS SHALL BE ANNOTATED TO SHOW ALL CHANGES MADE DURING THE CONSTRUCTION PROCESS. THE DOCUMENTS SHALL BE AVAILABLE TO THE ENGINEER AT ALL TIMES. WITHIN 25 DAYS OF THE COMPLETION OF THE PROJECT, THE DOCUMENTS SHALL BE COLLATED INTO ONE PACKAGE AND SHALL BE CERTIFIED BY THE CONTRACTOR AS A COMPLETE SET OF AS-BUILT RECORD DOCUMENTS AND DELIVERED TO THE ENGINEER.

## GAS SYSTEM

1. CONTACT PNM GAS SERVICES (PNM), JOE DUNLOP, AT 241-7771 FOR COORDINATION OF GAS FACILITY PROTECTION AND RELOCATIONS.
2. REPORT HIT OR DAMAGED GAS LINES IMMEDIATELY BY CALLING 246-7300.
3. IN ADDITION TO CONTACTING NEW MEXICO ONE CALL, CONTACT JAMES STANOVACK AT 241-7751 FOR LINE SPOTTING OF GAS LINES.
4. FOR GAS LINES REQUIRING RELOCATION, PROVIDE 4 WEEKS MINIMUM NOTICE TO PNM GAS SERVICES.

## CONSTRUCTION SURVEYING AND AS-BUILTS

1. PROVIDE ALL CONSTRUCTION SURVEYING. SURVEYING SHALL BE CONDUCTED UNDER THE DIRECTION AND SUPERVISION OF A NEW MEXICO REGISTERED PROFESSIONAL SURVEYOR.

## ELECTRICAL SYSTEM

1. NOTIFY PNM AT LEAST 5 DAYS AHEAD OF CONSTRUCTION ACTIVITIES FOR SHIELDING OVERHEAD DISTRIBUTION LINES AND PROTECTING POWER POLES AND GUY WIRES.
2. NOTIFY PNM AT LEAST 4 WEEKS AHEAD OF CONSTRUCTION ACTIVITIES FOR RELOCATION OF PNM ELECTRIC LINES.

## TRAFFIC AND STREET

1. WHEN ABUTTING NEW CURB AND GUTTER TO EXISTING PAVEMENT, SAWCUT, REMOVE, AND REPLACE A 1' WIDE SECTION OF EXISTING PAVEMENT ADJACENT TO THE CURB AND GUTTER PER STANDARD SPECIFICATIONS.
2. USE PARALLEL OR ORTHOGONAL PAVEMENT CUTS ONLY, NO DIAGONAL CUTS IN EXISTING PAVEMENT PER COA. STD DWG 2465.
3. REMOVE AND REPLACE PAVEMENT PER STD DWG 2465.

## GEOTECHNICAL INVESTIGATION

1. A GEOTECHNICAL INVESTIGATION WAS NOT CONDUCTED FOR THIS PROJECT.

## PROTECTION OF EXISTING IMPROVEMENTS AND PROPERTY

1. VIDEO TAPE THE WORK AREA, INCLUDING ALL BUILDINGS, HOMES, AND STRUCTURES THAT FRONT THE WORK AREAS PRIOR TO BEGINNING CONSTRUCTION AND SUBMIT 2 COPIES OF ALL TAPES TO THE ENGINEER.

## UTILITY COMPANY CONTACTS

NAME	PHONES	BUSINESS
BATES, STEVE	OFFICE PHONE: (505) 898-2661ext48 OFFICE FAX: (505) 898-6379 <a href="mailto:SBATES@ECORESOURCES.COM">SBATES@ECORESOURCES.COM</a>	NEW MEXICO UTILITIES 4700 IRVING BLVD. NW SUITE 201 ALBUQUERQUE, NM 87114
BENJAMIN, STEVE	OFFICE PHONE: (505) 998-2220 OFFICE FAX: (505) 998-2200 <a href="mailto:STEVE.BENJAMIN@XSPEDIUS.COM">STEVE.BENJAMIN@XSPEDIUS.COM</a>	XSPEDIUS MANAGEMENT CO. OPERATIONS SUPPORT MANAGER 505 MARQUETTE NW STE 1605 ALBUQUERQUE, NM 87102
BOUCHARD, MARK A.	OFFICE PHONE: (505) 241-3402 OFFICE FAX: (505) 241-0559 <a href="mailto:MBUCHARD@PNM.COM">MBUCHARD@PNM.COM</a>	PNM ELECTRIC 4201 EDITH BLVD. NE MS-ES61 ALBUQUERQUE, NM 87107
CROWEL, DAVID	OFFICE PHONE: (505) 842-2911 OFFICE FAX: 842-2890 <a href="mailto:DCROWEL@ATT.COM">DCROWEL@ATT.COM</a>	AT&T RESOURCE SUPERVISOR 111 3RD STREET NW ALBUQUERQUE, NM 87103
DARNELL, ANDY	OFFICE PHONE: (505) 346-4470 OFFICE FAX: 346-4481 <a href="mailto:ANDY.DARNELL@MCI.COM">ANDY.DARNELL@MCI.COM</a>	MCI WORLDCOM OPERATIONS MANAGER 6001 MIDWAY PARK NE ALBUQUERQUE, NM 87109
DUNLOP, JOE	OFFICE PHONE: (505) 241-7771 OFFICE FAX: 214-7740 <a href="mailto:JDUNLOP@PNM.COM">JDUNLOP@PNM.COM</a>	PNM GAS CO. 4625 EDITH BLVD. NE ALBUQUERQUE, NM 87107
ERICKSON, RITA	OFFICE PHONE: (505) 761-6235 OFFICE FAX: (505) 761-0589 <a href="mailto:RITA_ERICKSON@CABLE.COMCAST.COM">RITA_ERICKSON@CABLE.COMCAST.COM</a>	COMCAST PLANNING AND DESIGN SUPERVISOR 4611 MONTBEL PLACE NE ALBUQUERQUE, NM 87107
HARRISON, ROYAL	OFFICE PHONE: (505) 938-7339 OFFICE FAX: 938-7380 <a href="mailto:ROYAL.HARRISON@TWTELECOM.COM">ROYAL.HARRISON@TWTELECOM.COM</a>	TIME WARNER TELECOM PLANT MANAGER 3830 SINGER BLVD. NE SUITE 1000 ALBUQUERQUE, NM 87109
JURGENSON, GLENN	OFFICE PHONE: (505) 291-6214	CITY OF ALBUQUERQUE STORM DRAIN DIVISION P.O. BOX 1293 ALBUQUERQUE, NM 87103
KELLY, LARRY	OFFICE PHONE: (505) 246-0501 OFFICE FAX: (505) 246-0479 <a href="mailto:LARRY.KELLY@QWEST.COM">LARRY.KELLY@QWEST.COM</a>	QWEST LONG DISTANCE SR. OPERATIONS TECH 400 TIJERAS NW SUITE 570 ALBUQUERQUE, NM 87102
MARTINEZ, JAMIE	OFFICE PHONE: (505) 328-2675 OFFICE FAX: (505) 217-0070 <a href="mailto:JHCOOKCO_JIN@ATT.NET">JHCOOKCO_JIN@ATT.NET</a>	UNIVERSAL ACCESS 505 MARQUETTE AVE NW #119A ALBUQUERQUE, NM 87102
MUELLER, RICK	OFFICE PHONE: (505) 244-3161 OFFICE FAX: 244-0094 MOBILE: 228-3329 <a href="mailto:RDUELLER@MCI.FODUSA.COM">RDUELLER@MCI.FODUSA.COM</a>	MCLEOD USA SUPERVISOR OF OUTSIDE TECHS. 505 MARQUETTE NW (COMPASS BANK) SUITE 1600 ALBUQUERQUE, NM 87102
MULLER, DAVID	OFFICE PHONE: (505) 245-8706 OFFICE FAX: 245-6733 <a href="mailto:DMULLER@QWEST.COM">DMULLER@QWEST.COM</a>	QWEST/US WEST CAPACITY PROVISIONING SPECIALIST 400 TIJERAS AVE. NW SUITE 710 ALBUQUERQUE, NM 87102
MUSINSKI, NANCY	OFFICE PHONE: (505) 768-2729 OFFICE FAX: (505) 768-3629 <a href="mailto:NMUSINSKI@CABQ.GOV">NMUSINSKI@CABQ.GOV</a>	CITY OF ALBUQUERQUE, SENIOR ENGINEER WATER UTILITY DEPARTMENT P.O. BOX 1293 ALBUQUERQUE, NM 87103
WEATHERS, ROGER	OFFICE PHONE: (720) 888-5688 OFFICE FAX: (720) 888-5254 <a href="mailto:ROGER.WEATHERS@LEVEL3.COM">ROGER.WEATHERS@LEVEL3.COM</a>	LEVEL 3 COMMUNICATIONS, LLC 1025 ELDRADO BLVD. BROOMFIELD, CO 80021

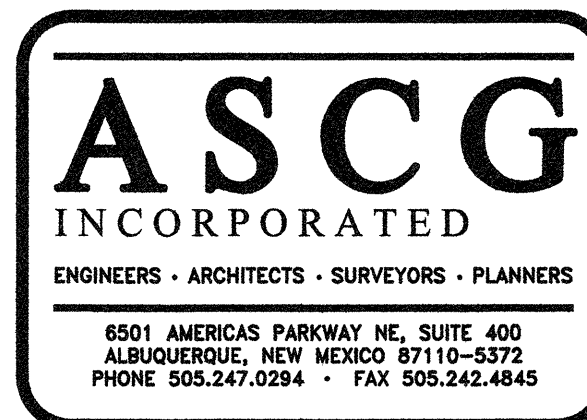

0 10' 20' 40' 60'

GRAPHIC SCALE

<p align="center">CITY OF ALBUQUERQUE DEPARTMENT OF MUNICIPAL DEVELOPMENT STORM DRAINAGE</p>							
<p><b>TITLE:</b> HIGHLAND DETENTION BASIN SYSTEM – PHASE IV COAL AVENUE SE STORM DRAIN</p>							
<p align="center"><b>GENERAL NOTES</b></p>							
Design Review Committee	City Engineer Approval	Last Design Update	Mo./Day/Yr.	Mo./Day/Yr.			
City Project No.	P7396.01	Zone, Map No.	K-17	Sheet	2	Of	9



(SEE PLANS FOR ITEMS WITHIN THIS PROJECT)

LEGEND

PROPOSED	EXISTING	DESCRIPTION	PROPOSED	EXISTING	DESCRIPTION
●	○	SANITARY SEWER MANHOLE			PCC CURB AND GUTTER
⊙	⊙	STORM DRAIN MANHOLE			AC CURB
⊙	⊙	WATER MANHOLE			SIDEWALK
○ TELE MH	○ TELE MH	TELEPHONE MANHOLE			BLOCK WALL
SAS 8"CP	SAS 8"CP	SANITARY SEWER LINE WITH SIZE AND TYPE			CHAIN LINK FENCE
SD 48"RCP	SD 48"RCP	STORM DRAIN LINE WITH SIZE AND TYPE			FIELD FENCE
W 6"CI	W 6"CI	WATER LINE WITH SIZE AND TYPE			SPOT ELEVATION
		OVERHEAD ELECTRICAL LINE			EDGE OF AC PAVEMENT
		UNDERGROUND ELECTRICAL/TRAFFIC CONTROL			RIGHT OF WAY LINES/ PROPERTY LINE
		UNDERGROUND TELEPHONE			PUBLIC EASEMENT LINE
⊙ 2"HP	⊙ 2"HP	GAS LINE WITH SIZE AND TYPE			LIGHT POLE BASE
		CABLE TELEVISION LINE			WHEELCHAIR RAMP
		ENCASEMENT			SWALE
		CATCH BASIN			CONTOURS
		GATE VALVE			SIDE SLOPES
		BUTTERFLY VALVE			SURVEY POINT
		FIRE HYDRANT			ABANDON IN PLACE
		REDUCER			DEMOLISH AND REMOVE
		SANITARY SEWER SERVICE CONNECTION			EARTH (UNDISTURBED)
		WATER SERVICE CONNECTION			COMPACTED BACKFILL
		TEE			CONCRETE
		CROSS			ANTICIPATED LIMITS OF TRENCH PRISM
		BEND			CONCRETE DRIVEPAD
		CAP AND PLUG			TEMPORARY PAVING
		WATER METER			TRANSITION CURB
		DOUBLE WATER METER			
		VALVE BOX			
		POWER POLE			
		LIGHT POLE			
		TRAFFIC LIGHT			
		TRAFFIC CONTROL BOX			
		PULL BOX			
		TELEPHONE BOOTH			

ABBREVIATIONS

AB	ANCHOR BOLT	DWG	DRAWING	MH	MANHOLE	SD	STORM DRAIN
AC	ASPHALTIC CONCRETE	E	EAST	MIN	MINIMUM	SF	SQUARE FEET
AHD	AHEAD	EA	EACH	MISC	MISCELLANEOUS	SIM	SIMILAR
APPROX	APPROXIMATELY	EF	EACH FACE	MO	MASONRY OPENING	SM	SUCTION MANIFOLD
BK	BACK	EG	EXISTING GRADE	MOV	MOTOR OPERATED VALVE	SQ	SQUARE
BLDG	BUILDING	EJ	EXPANSION JOINT	N	NORTH	STA	STATION
BLK	BLOCK	EL OR ELEV	ELEVATION	NIC	NOT IN CONTRACT	STD DWG	STANDARD DRAWING
BM	BEAM/BENCH MARK	ELEC	ELECTRICAL	NO	NUMBER	SY	SQUARE YARDS
BOP	BOTTOM OF PIPE	EP	EDGE OF PAVEMENT	NTS	NOT TO SCALE	SYM	SYMMETRICAL
BOT	BOTTOM	EWC	ELECTRIC WATER COOLER	OD	OUTSIDE DIAMETER	TA	TOP OF ASPHALT
BRG	BEARING	EXIST OR EX	EXISTING	OPP	OPPOSITE	TAN	TANGENT
CATV	CABLE TELEVISION	FD	FLOOR DRAIN	PC	POINT OF CURVE	TC	TOP OF CONCRETE
CB	STORM CATCH BASIN/INLET	F-F	FACE-TO-FACE	PED	PEDESTAL	TG	TOP OF GRAVEL
CCY	CONCRETE CYLINDER PIPE	FF	FINISH FLOOR	PI	POINT OF INTERSECTION	THC	TOP OF HEADER CURB
CFM	CUBIC FEET PER MINUTE	FG	FINISH GRADE	PL/B	PLATE	THK	THICK/THICKNESS
CFS	CUBIC FEET PER SECOND	FL	FLOW LINE ELEVATION/FLANGE	POL	POINT ON LINE	TOC	TOP OF CURB
CI	CAST IRON	FOC	FACE OF CURB	ROW	RIGHT OF WAY	T.O.P.	TOP OF PIPE
CJ	CONSTRUCTION JOINT	FPS	FEET PER SECOND	PRC	POINT REVERSE CURVE	TOS	TOP OF STEEL
CL or CL	CENTERLINE	FT	FOOT/FEET	PRV	PRESSURE REDUCING VALVE	TOW	TOP OF WALL
CL CONST	CENTERLINE OF CONSTRUCTION	GA	GAGE	PSF	POUNDS PER SQUARE FOOT	TP	TOP OF PAVEMENT
CLG	CEILING	GPM	GALLONS PER MINUTE	PSI	POUNDS PER SQUARE INCH	TYP	TYPICAL
CLR	CLEAR	HB	HOSE BIB	PT	POINT OF TANGENT	T&B	TOP AND BOTTOM
CMU	CONCRETE MASONRY UNIT	HC	HOLLOW CORE	PVC	POLY VINYL CHLORIDE	TW	TOP OF WALL
CO	CLEANOUT	HGL	HYDRAULIC GRADE LINE	Q	FLOW RATE	UE	UNDERGROUND ELECTRICAL
COA	CITY OF ALBUQUERQUE	HORIZ	HORIZONTAL	QTY	QUANTITY	V	VELOCITY
COL	COLUMN	HP	HIGH PRESSURE	R	RADIUS	VERT	VERTICAL
CONC	CONCRETE	IN	INCH	RCP	REINFORCED CONCRETE PIPE	VRT	VENT THROUGH ROOF
CONST	CONSTRUCTION	INV	INVERT	ROD	RESERVOIR OVERFLOW DRAIN	W	WEST
CP	CONTROL POINT	LB	POUND	RD	ROOF DRAIN	WC	WELL COLLECTOR
CY	CUBIC YARDS	LLH	LONG LEG HORIZONTAL	RT	RIGHT	WL	WATER LINE
DET	DETAIL	LLV	LONG LEG VERTICAL	S	SOUTH		
DI	DUCTILE IRON	LT	LIGHT/LEFT	SAS	SANITARY SEWER		
DIA	DIAMETER	MAX	MAXIMUM				
DM	DISCHARGE MANIFOLD	MFR	MANUFACTURER				
DN	DOWN						

SYMBOLS

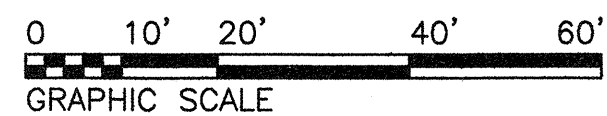
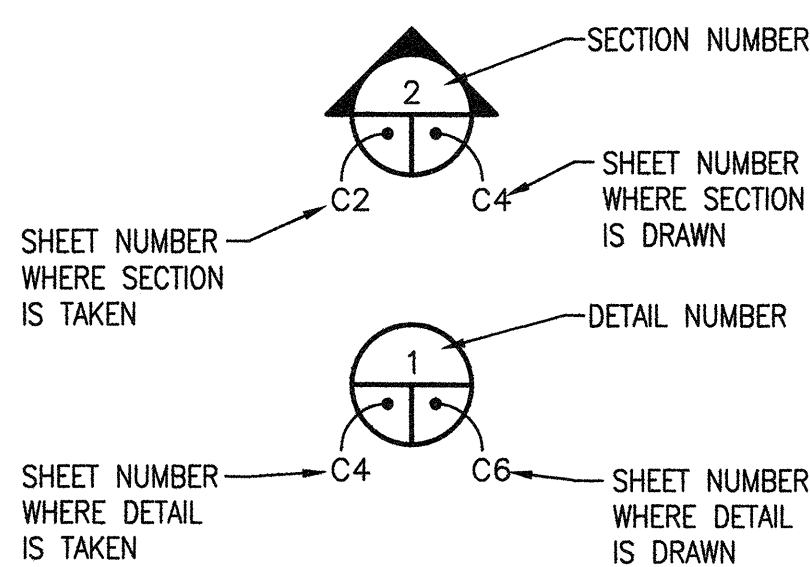

AS BUILT INFORMATION		BENCH MARKS		SURVEY INFORMATION		ENGINEER'S SEAL	
CONTRACTOR	DATE	WORK STARTED BY	DATE	FIELD NOTES	DATE	NO.	BY
ACCEPTANCE BY	DATE	FIELD REVISION BY	DATE				
DRAWINGS CORRECTED BY	DATE						
RECORDED BY	DATE						
NO.							

CITY OF ALBUQUERQUE DEPARTMENT OF MUNICIPAL DEVELOPMENT STORM DRAINAGE	
TITLE: HIGHLAND DETENTION BASIN SYSTEM - PHASE IV COAL AVENUE SE STORM DRAIN	
LEGEND & ABBREVIATIONS	
Design Review Committee	City Engineer Approval
City Project No.	Zone Map No.
P7396.01	K-17
Sheet	3 Of 9



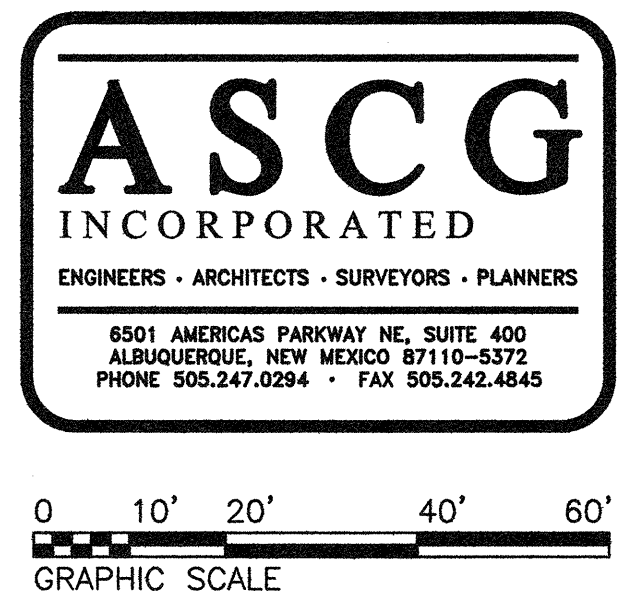

<b>A.14+00</b> LAST DESIGN UPDATE No. 17		Mo./Day/Yr. _____ _____ _____ _____ _____		Mo./Day/Yr. _____ _____ _____ _____ _____		Sheet 4 Of 9	
<b>PHASE IV DRAIN</b> <b>DEVELOPMENT</b>							
<b>ENGINEER'S SEAL</b>		<b>SURVEY INFORMATION</b>		<b>BENCH MARKS</b>		<b>AS BUILT INFORMATION</b>	
		FIELD NOTES NO. BY DATE				CONTRACTOR	
						WORK STARTED BY	
						DESIGN'S ACCEPTANCE BY	
						VERIFICATION BY	
						DRAWINGS CORRECTED BY	
						DATE	
						DATE	
						DATE	
						DATE	
						DATE	
						<b>MICRO-FILM INFORMATION</b>	
						RECORDED BY	
						DATE	
						NO.	
						DATE	

<p align="center">CITY OF ALBUQUERQUE DEPARTMENT OF MUNICIPAL DEVELOPMENT STORM DRAINAGE</p>				
<p><b>TITLE:</b></p>		<p align="center">HIGHLAND DETENTION BASIN SYSTEM -- PHASE IV COAL AVENUE SE STORM DRAIN</p>		
<p align="center"><b>P &amp; P STA.10+00 - STA.14+00</b></p>				
<p>Design Review Committee</p>	<p>City Engineer Approval</p>	<p>Lost Design Update</p>	Mo./Day/Yr.	Mo./Day/Yr.
City Project No.	Zone Map No.	Sheet	Of	
<p><b>P7396.01</b></p>	<p><b>K-17</b></p>	<p>4</p>	<p>9</p>	



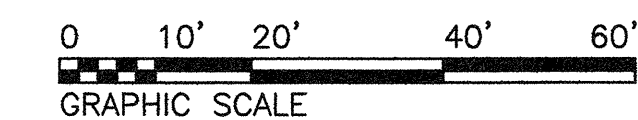
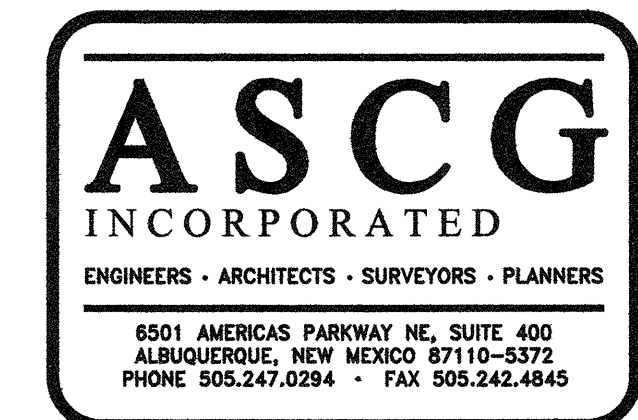
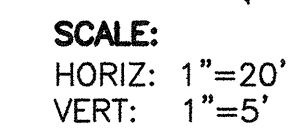
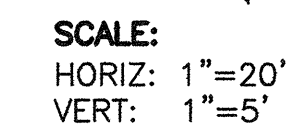

CITY OF ALBUQUERQUE  
DEPARTMENT OF MUNICIPAL DEVELOPMENT  
STORM DRAINAGE

**P & P STA.14+00 - STA.17+00**

P7396.01	Zone Map No. —	Sheet
----------	-------------------	-------

[illegible]

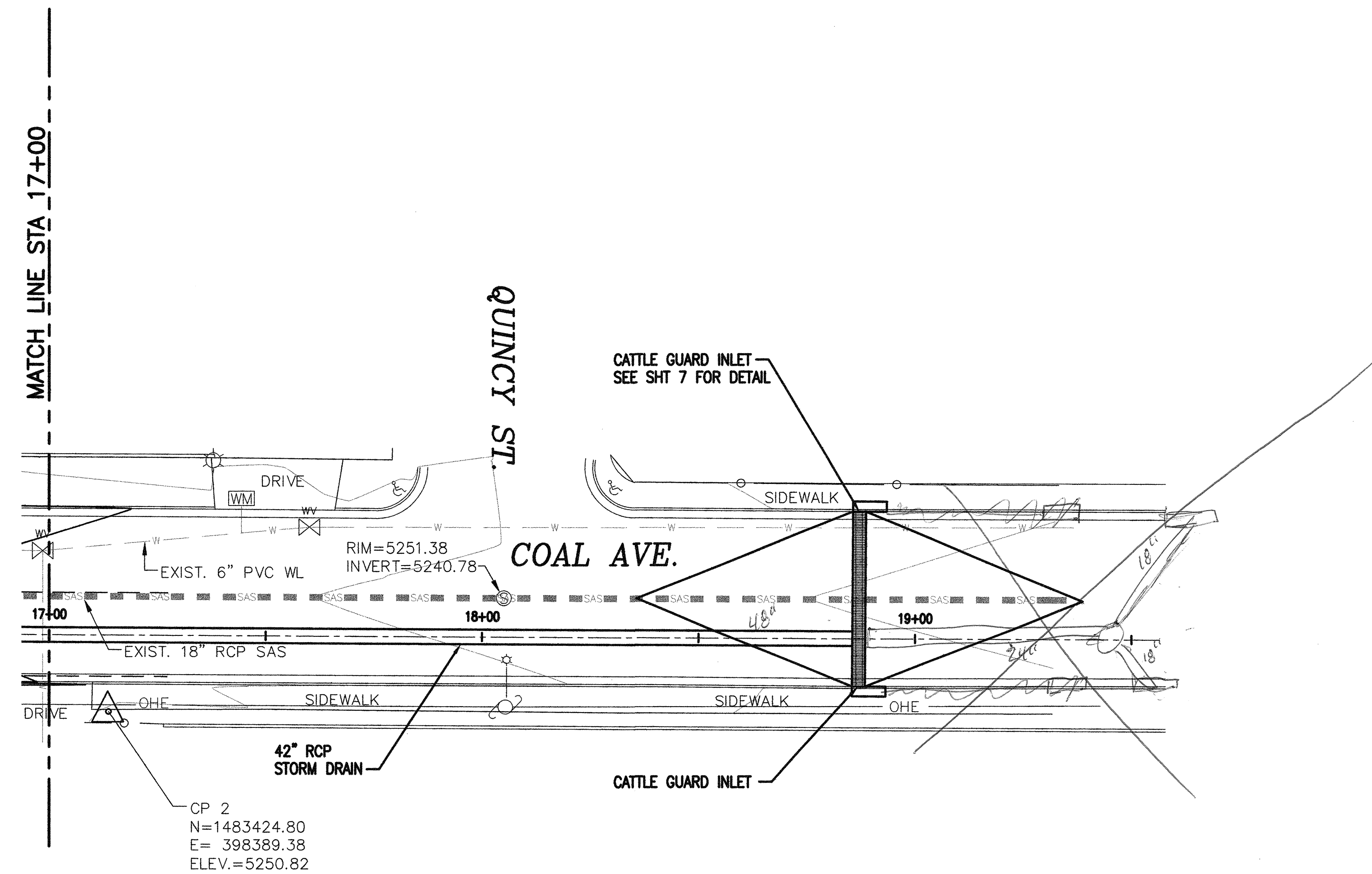

SCALE:  
HORIZ: 1"=20'  
VERT: 1"=5'

NORTH  
ASCG  
INCORPORATED

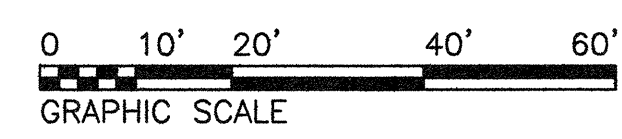
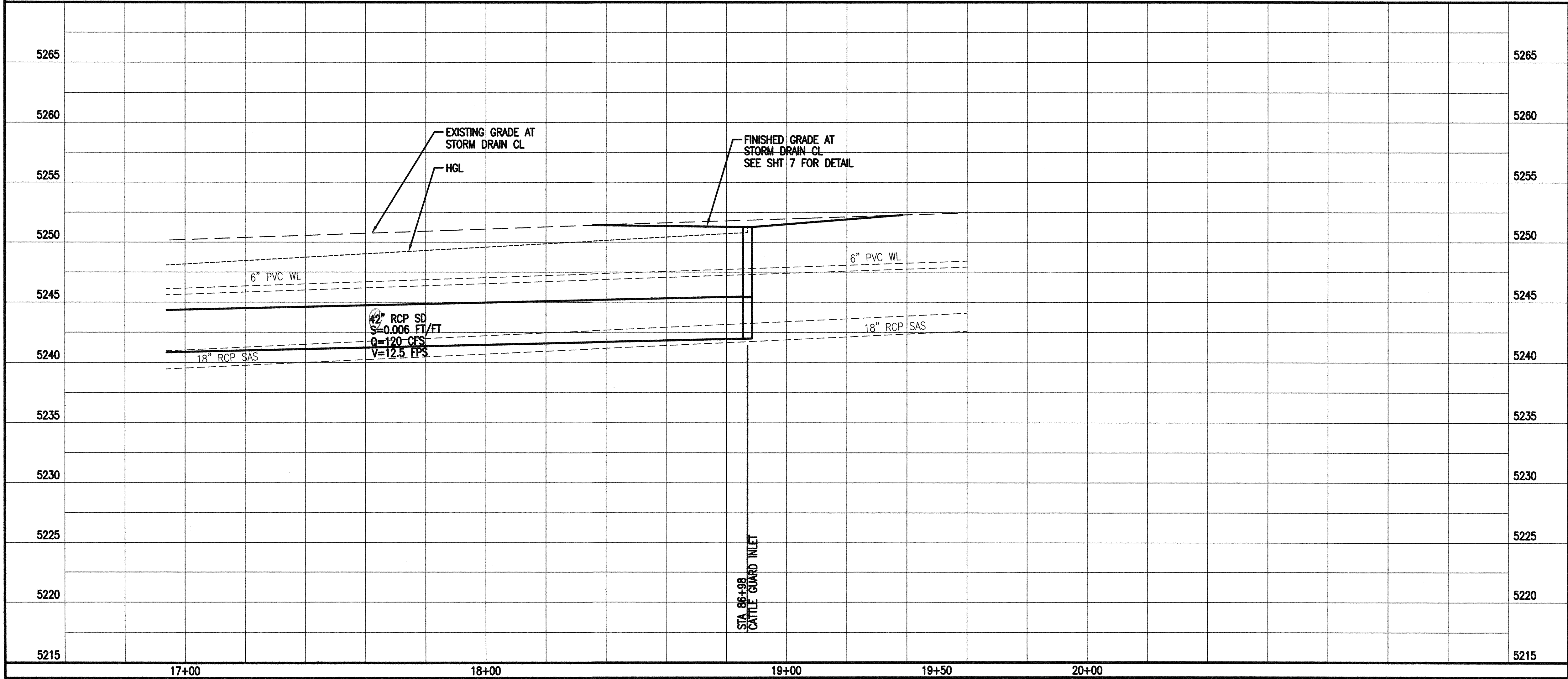

CITY OF ALBUQUERQUE DEPARTMENT OF MUNICIPAL DEVELOPMENT STORM DRAINAGE			
TITLE: HIGHLAND DETENTION BASIN SYSTEM - PHASE IV COAL AVENUE SE STORM DRAIN			
P & P STA.17+00 - STA.19+50			
Design Review Committee	City Engineer Approval	Mo./Day/Yr.	Mo./Day/Yr.
City Project No.	Zone Map No.	Sheet	Of
P7396.01		6	9

AS BUILT INFORMATION				BENCH MARKS				SURVEY INFORMATION				ENGINEER'S SEAL			
CONTRACTOR	NO.	DATE	BY	NO.	DATE	BY	NO.	NO.	DATE	BY	NO.	NO.	DATE	BY	NO.
WORKED BY															
INSPECTED BY															
ACCEPTANCE BY															
VERIFICATION BY															
DATE															
DRAWN BY															
CHECKED BY															
DATE															
MICRO-FILM INFORMATION															
RECORDED BY															
DATE															
NO.															



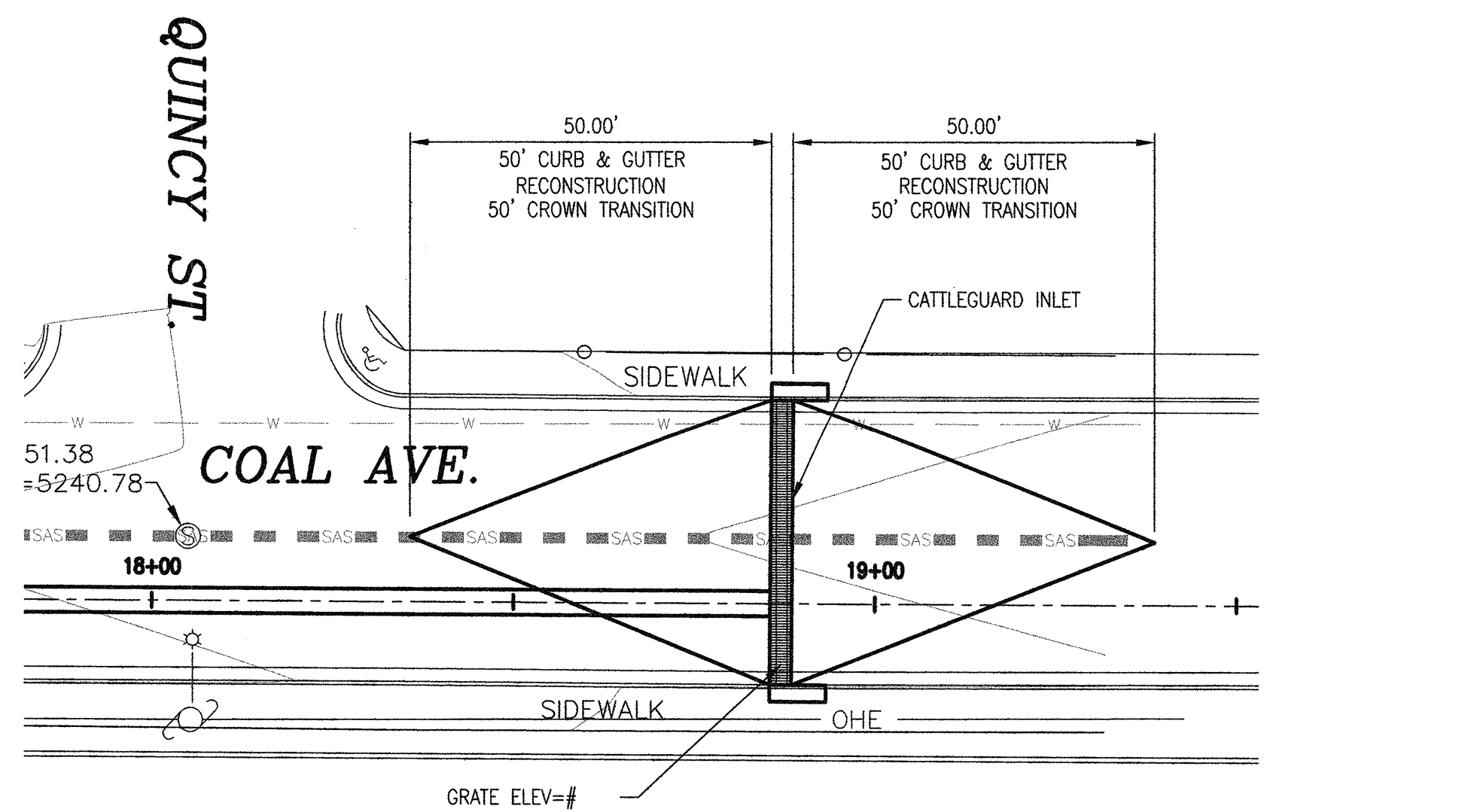

PLAN

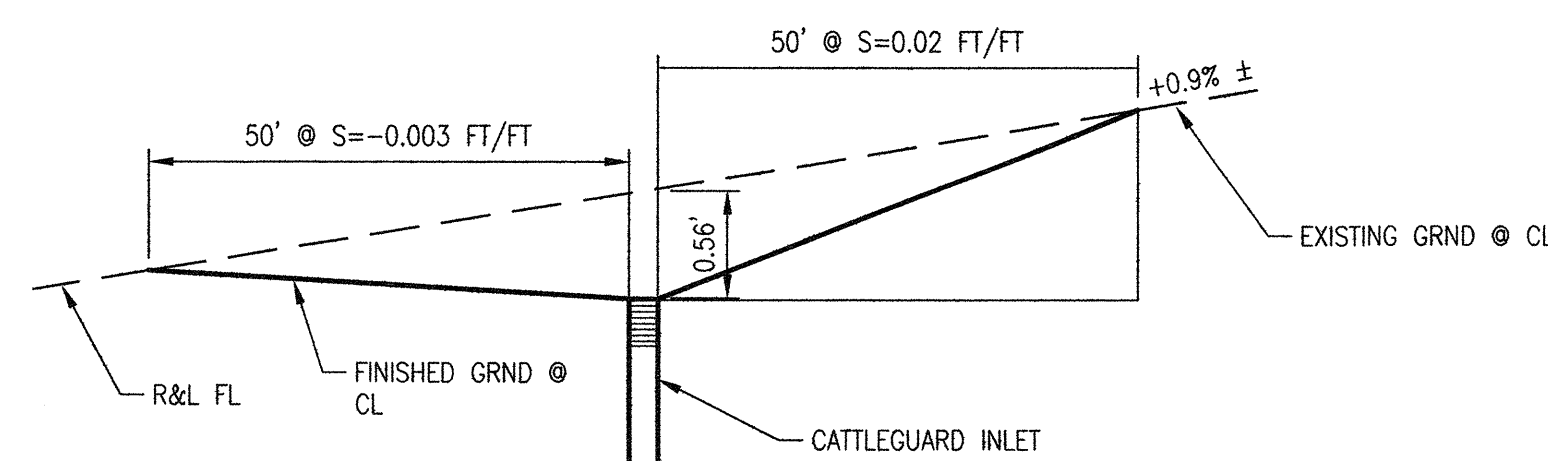

SECTION

GUTTER FL PROFILE  
AT CATTLEGUARD

SCALE: HORIZ. 1"=20'  
VERT. 1"=1'

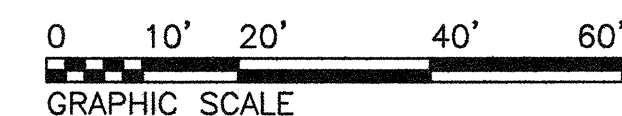

AS BUILT INFORMATION				BENCH MARKS				SURVEY INFORMATION				ENGINEER'S SEAL			
CONTRACTOR	WORK	DATE	DATE	NO.	BY	DATE	DATE	NO.	BY	DATE	DATE	NO.	BY	DATE	DATE
INSPECTOR'S	DATE	DATE	DATE												
ACCEPTANCE BY	DATE	DATE	DATE												
VERIFICATION BY	DATE	DATE	DATE												
DRAWING	DATE	DATE	DATE												
CONSTRUCTION	DATE	DATE	DATE												
MICRO-FILM INFORMATION															
RECORDED BY	DATE	DATE	DATE												
NO.															

CITY OF ALBUQUERQUE DEPARTMENT OF MUNICIPAL DEVELOPMENT STORM DRAINAGE			
TITLE: HIGHLAND DETENTION BASIN SYSTEM - PHASE IV COAL AVENUE SE STORM DRAIN			
MISCELLANEOUS DETAILS			
Design Review Committee	City Engineer Approval	Mo./Day/Yr.	Mo./Day/Yr.
City Project No.	Zone Map No.	Sheet	Of
P7396.01	K-17	7	9

CONSTRUCTION TRAFFIC CONTROL GENERAL NOTES

1. CONTRACTOR MUST OBTAIN FROM CONSTRUCTION COORDINATION AN EXCAVATION/BARRICADING PERMIT BEFORE ENGAGING IN ANY CONSTRUCTION, MAINTENANCE OR REPAIR WORK IN ANY OF THE CITY OF ALBUQUERQUE'S RIGHTS-OF-WAY. EMERGENCY WORK THAT WOULD PRESERVE LIFE OR PROPERTY IS EXCLUDED WITH THE UNDERSTANDING, THAT A PERMIT SHALL BE OBTAINED WITHIN 24 TO 48 HOURS.
2. CONTRACTOR SHALL AT THE TIME OF PERMIT REQUEST, SUBMIT FOR APPROVAL BY CONSTRUCTION COORDINATION, A TRAFFIC CONTROL PLAN DETAILING ALL EXISTING TOPOGRAPHY SUCH AS LANE WIDTHS, DRIVEWAYS, AND BUSINESS/RESIDENTIAL ACCESSES. THE TRAFFIC CONTROL PLAN SHALL INCLUDE ALL PHASES OF WORK AND SCHEDULES INVOLVED IN THE CONSTRUCTION PROJECT. ANY SEPARATE PHASES OF A CONSTRUCTION PROJECT SHALL BE GIVEN AN INDIVIDUAL PERMIT EACH. BLANKET PERMITS WILL NOT BE ISSUED.
3. THESE TYPICAL TRAFFIC CONTROL PLANS DO NOT REFLECT THE EXISTING TOPOGRAPHY SUCH AS DRIVEWAYS, LANE WIDTHS, AND BUSINESS/RESIDENTIAL ACCESSES. EVERY LOCATION THAT REQUIRES CONSTRUCTION TRAFFIC CONTROL SHALL HAVE A DETAILED TRAFFIC CONTROL PLAN SHOWING ALL EXISTING TOPOGRAPHY.
4. CONSTRUCTION SHALL NOT BEGIN UNLESS A TRAFFIC CONTROL PLAN HAS BEEN APPROVED AND VERIFIED BY CONSTRUCTION COORDINATION.
5. CONSTRUCTION COORDINATION SHALL BE NOTIFIED 48 HOURS PRIOR TO ANY TRAFFIC CONTROL CHANGES NEEDED BY CONTRACTOR, THAT WERE NOT PREVIOUSLY APPROVED. THESE TRAFFIC CONTROL CHANGES SHALL BE REQUESTED IN WRITING ACCOMPANIED WITH A TRAFFIC CONTROL PLAN REFLECTING SUCH CHANGES.
6. ALL CONSTRUCTION TRAFFIC CONTROL DEVICES SHALL COMPLY TO THE MANUAL ON UNIFORM TRAFFIC CONTROL DEVICES (MUTCD), LATEST EDITION. IT IS THE RESPONSIBILITY OF THE CONTRACTOR TO INSTALL, SERVICE AND MAINTAIN ALL TRAFFIC CONTROL DEVICES. TRAFFIC CONTROL DEVICES SHALL NOT BE REMOVED OR ALTERED IN ANY WAY WITHOUT THE APPROVAL OF CONSTRUCTION COORDINATION, PER SECTION 6A-4 OF THE MUTCD, LATEST EDITION.
7. THE CONSTRUCTION TRAFFIC CONTROL INITIAL SET-UP SHALL BE BY AN AMERICAN TRAFFIC SAFETY SERVICES ASSOCIATION (ATSSA) CERTIFIED WORKSITE TRAFFIC SUPERVISOR. THE MAINTENANCE AND SERVICING SHALL ALSO BE DONE BY AN ATSSA CERTIFIED WORKSITE TRAFFIC SUPERVISOR OR EQUIVALENT.
8. CONTRACTOR IS RESPONSIBLE TO MAINTAIN AND SERVICE ALL TRAFFIC CONTROL DEVICES 24 HOURS A DAY, 7 DAYS A WEEK THROUGHOUT LENGTH OF PROJECT. CONTRACTOR IS RESPONSIBLE THAT ALL TRAFFIC CONTROL DEVICES COMPLY WITH THE MUTCD, LATEST EDITION.
9. ALL ADVANCE WARNING SIGNS SHALL BE DOUBLE INDICATED WHENEVER THERE ARE MULTI-LANE TRAFFIC IN ANY ONE GIVEN DIRECTION AND THERE IS SUFFICIENT MEDIAN SPACE.
10. ALL BARRICADES IN ALL TAPERS AND TANGENTS SHALL BE PLACED APART, A DISTANCE MEASURED IN FEET, EQUAL TO THAT OF THE POSTED SPEED LIMIT. NO EXCEPTIONS UNLESS APPROVED BY CONSTRUCTION COORDINATION PER MUTCD SECTION 6A-4.
11. ALL WORK IN ARTERIAL ROADWAYS SHALL BE ON A CONTINUOUS 24 HOUR PER DAY BASIS UNTIL COMPLETED.
12. CONTRACTOR IS RESPONSIBLE TO PROVIDE CONSTRUCTION COORDINATION, A WEEKLY LOG OF DAILY INSPECTIONS OF BARRICADE AND MAINTENANCE SCHEDULES ON PROJECTS THAT ARE OVER ONE WEEK DURATION.
13. EQUIPMENT OR MATERIALS SHALL NOT BE STORED WITHIN 15 FEET OF A TRAVELED TRAFFIC LANE DURING NON-WORKING HOURS WITHOUT THE APPROVAL OF CONSTRUCTION COORDINATION.
14. CONTRACTOR SHALL PROVIDE AND MAINTAIN A SAFE AND ADEQUATE MEANS OF CHANNELIZING PEDESTRIAN TRAFFIC AROUND AND THROUGH THE CONSTRUCTION AREA.
15. CONTRACTOR IS RESPONSIBLE FOR OBLITERATION OF ANY CONFLICTING STRIPING AND RESPONSIBLE FOR ALL TEMPORARY STRIPING.
16. CONTRACTOR SHALL MAINTAIN ACCESS TO ALL FACILITIES, BUSINESSES AND/OR RESIDENTS AT ALL TIMES.
17. CONTRACTOR SHALL PROVIDE ACCESS SIGNS FOR BUSINESSES LOCATED WITHIN THE CONSTRUCTION AREA UNDER THE SUPERVISION OF CONSTRUCTION COORDINATION. EACH ACCESS SIGN SHALL HAVE 5 INCH, WHITE OPAQUE LETTERING ON BLUE REFLECTORIZED BACKGROUND. ACCESS SIGNS SHALL BE CONSIDERED INCIDENTAL TO THE BID AND NOT PART OF THE CONTRACT UNLESS OTHERWISE STATED. NO MORE THAN 3 BUSINESSES SHALL BE LISTED ON A ACCESS SIGN. SHOPPING CENTERS AND MALLS SHALL BE LISTED AS SUCH.
18. ALL ADVANCE WARNING SIGNS SHALL MEET THE MINIMUM REFLECTIVE INTENSITY REQUIREMENTS SET FORTH BY THE CITY OF ALBUQUERQUE. CONSTRUCTION COORDINATION SHALL DETERMINE ALL REQUIREMENTS AND APPROVE OR DISAPPROVE ANY ADVANCE WARNING SIGN PER SECTION 6A-4 OF THE MUTCD, LATEST EDITION.
19. 48 HOURS PRIOR TO OCCUPYING OR CLOSING OF A RIGHT-OF-WAY, CONTRACTOR SHALL NOTIFY: POLICE, FIRE DEPARTMENT, SCHOOLS, HOSPITALS, TRANSIT AUTHORITY, BUSINESSES AND/OR RESIDENTS THAT WILL BE AFFECTED BY THE CONSTRUCTION.
20. ANY FIELD ADJUSTMENTS SHALL BE APPROVED BY CONSTRUCTION COORDINATION.

21. EXCAVATIONS SHALL BE PLATED, TEMPORARILY PATCHED OR RESURFACED PRIOR TO OPENING OF TRAFFIC. A MINIMUM OF 11 FEET SHALL BE PROVIDED FOR TRAFFIC IN ANY GIVEN DIRECTION. CONTRACTOR IS RESPONSIBLE FOR ANY WORK INVOLVED IN SATISFYING THESE REQUIREMENTS.

22. CONTRACTOR SHALL AT ALL TIMES COMPLY WITH THE FOLLOWING:

- STANDARDS AND REQUIREMENTS SET FORTH IN THE MANUAL ON UNIFORM TRAFFIC CONTROL DEVICES, LATEST EDITION.
- THE CITY OF ALBUQUERQUE TRAFFIC CODE, LATEST EDITION.
- SECTION 19 OF THE CITY OF ALBUQUERQUE'S STANDARD SPECIFICATIONS FOR PUBLIC WORK CONSTRUCTION, AS WELL AS OTHER SECTIONS.

23. FAILURE TO COMPLY WITH ANY OF THE ABOVE MENTIONED, WILL BE ADEQUATE CAUSE TO CEASE ALL WORK ON ANY CONSTRUCTION PROJECT. WORK WILL NOT RESUME UNTIL ALL REQUIREMENTS ARE ADDRESSED AND APPROVED BY CONSTRUCTION COORDINATION.

24. ALL TRAFFIC CONTROL DEVICES SHALL BE KEPT IN NEW-CLEAN CONDITION. WASHING OF EQUIPMENT IS INCIDENTAL TO ITS PLACEMENT AND MAINTENANCE.

25. TRAFFIC CONTROL STANDARDS APPLY ONLY WHERE THE CONSTRUCTION TRAFFIC CONTROL PLANS ARE NOT SPECIFIC.

26. ADVANCE WARNING SIGNS SHALL BE 36"x36" MIN. WITH SUPER ENGINEERING GRADE SHEETING OR BETTER. MOUNTING HEIGHT AT TOP OF SIGN SHALL BE THE SAME AS FOR A 48" SIGN AS INDICATED IN THE M.U.T.C.D.

27. CONTRACTOR SHALL MAINTAIN A GRAFFITI-FREE WORKSITE. ALL GRAFFITI SHALL BE PROMPTLY REMOVED FROM ALL EQUIPMENT, BOTH PERMANENT AND TEMPORARY.

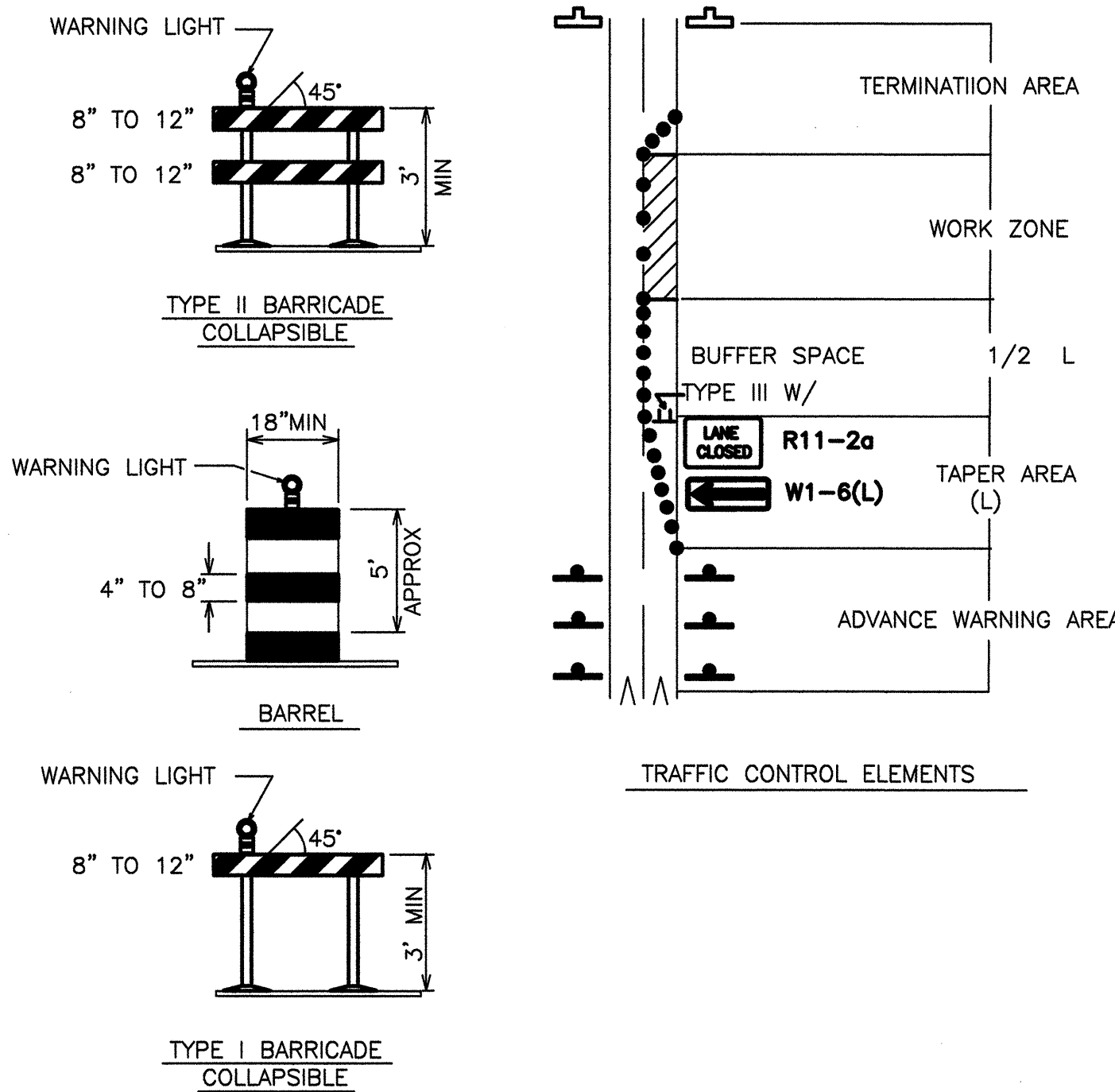
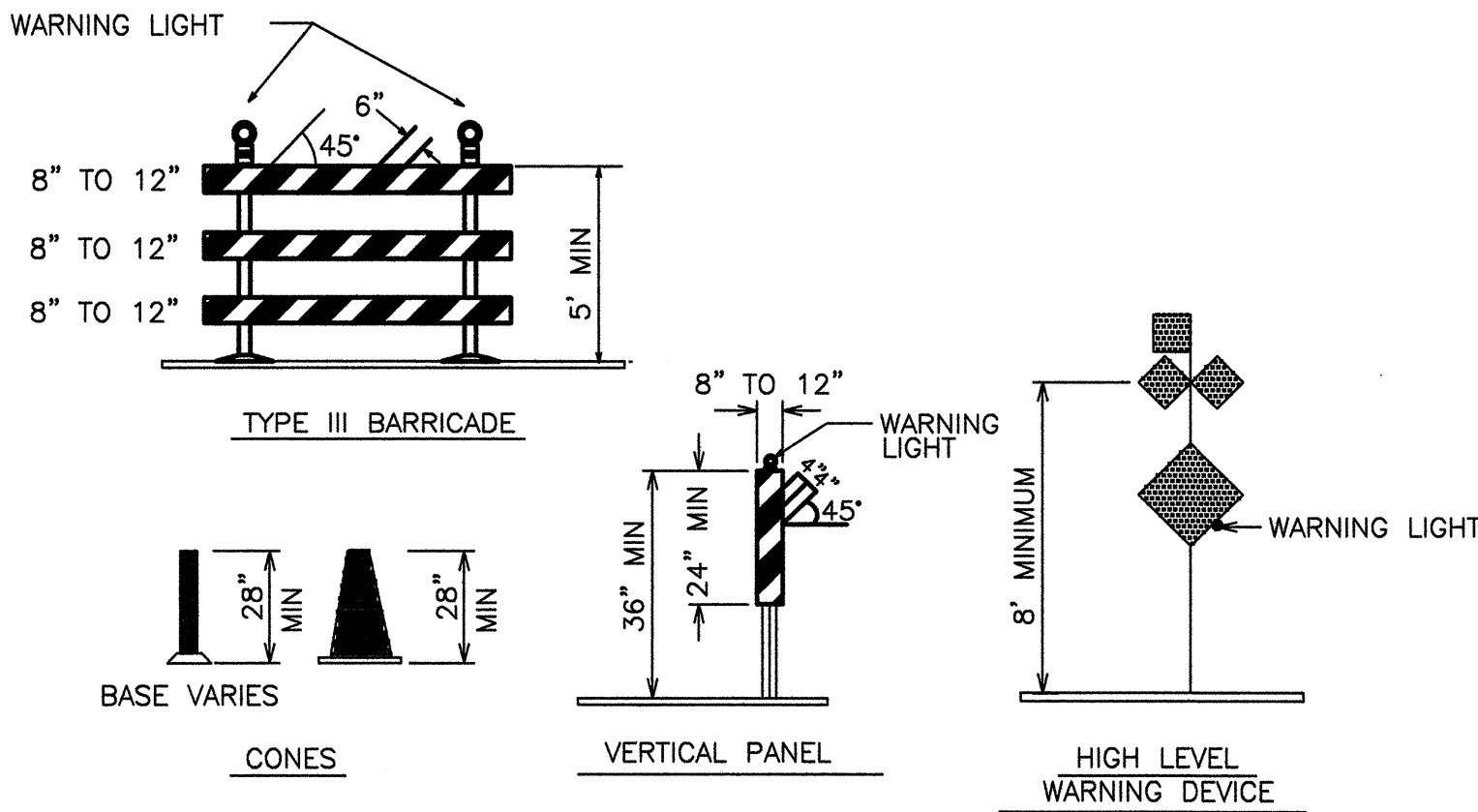

SIGN FACE DETAILS

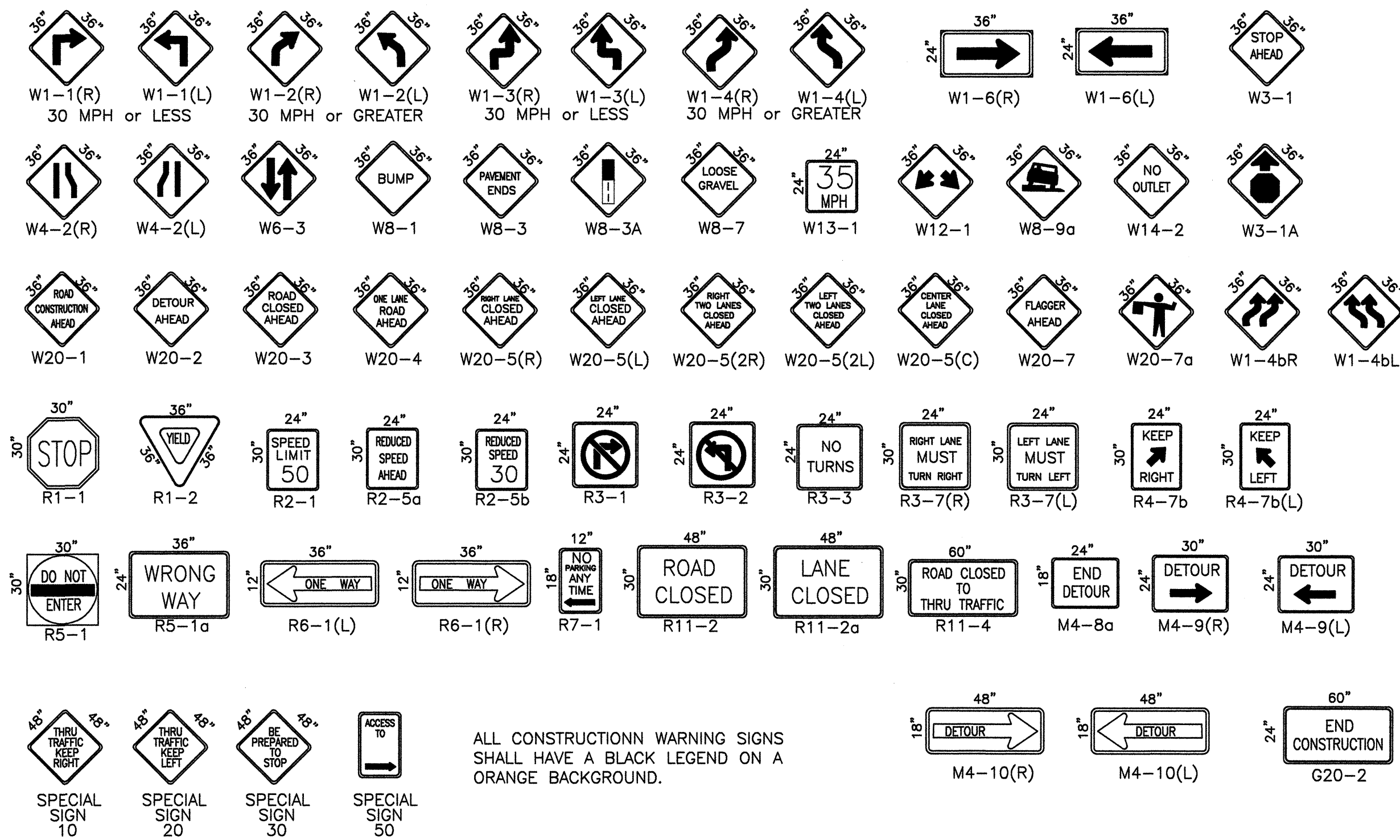

ALL CONSTRUCTION WARNING SIGNS SHALL HAVE A BLACK LEGEND ON A ORANGE BACKGROUND.

LEGEND

- WORK AREA  
BARRICADE - TYPE I, TYPE II, OR BARREL  
BARRICADE - TYPE III  
VERTICAL PANEL  
WARNING SIGN  
DISTANCE BETWEEN SIGNS - A DISTANCE MEASURED IN FEET EQUAL TO A VALUE OF TEN TIMES THE SPEED LIMIT OF THE STREET  
FLAGMAN POSITION  
SPACING BETWEEN BARRICADES - A DISTANCE MEASURED IN FEET EQUAL TO THE STREET LIMIT OF THE STREET  
TAPER LENGTH - SEE CHART BELOW

THE TANGENT LENGTH IS EQUAL TO THE TAPER LENGTH FOR A GIVEN STREET.

TAPER REQUIREMENT

SPEED LIMIT (MPH)	TAPER LENGTH(L) (FEET)			MINIMUM NUMBER OF DEVICES FOR TAPER	MAXIMUM DEVICE SPACING IN FEET	
	10' LANE	11' LANE	12' LANE		ALONG TAPER	AFTER TAPER
20	70	75	80	5	20	20
25	105	115	125	6	25	25
30	150	165	180	7	30	30
35	205	225	245	8	35	35
40	270	295	320	9	40	40
45	450	495	540	13	45	45
50	500	550	600	13	50	50
55	550	605	660	13	55	55

RECOMMENDED SIGN SPACING(D) FOR ADVANCE WARNING SIGN SERIES

SPEED MILES PER HOUR	MINIMUM DISTANCE BETWEEN SIGNS	FROM LAST SIGN TO TAPER
0-20	10 X SPEED LIMIT	10 X SPEED LIMIT
25-30	10 X SPEED LIMIT	10 X SPEED LIMIT
30-35	10 X SPEED LIMIT	10 X SPEED LIMIT
40-45	10 X SPEED LIMIT	10 X SPEED LIMIT
50-60	10 X SPEED LIMIT	10 X SPEED LIMIT

TAPER CRITERIA

TYPE OF TAPER	TAPER LENGTH
UPSTREAM TAPER:	
MERGING TAPER	L MINIMUM
SHIFTING TAPER	1/2 L MINIMUM
SHOULDER TAPER	1/2 L MINIMUM
TWO-WAY TRAFFIC TAPER	100 FEET MAXIMUM
DOWNSTREAM TAPERS	100 FEET PER LANE

TAPER LENGTH COMPUTATION

SPEED LIMIT	L =
40 MPH OR LESS	$L = \frac{WS^2}{60}$
40 MPH OR GREATER	$L = W \times S$

L = TAPER LENGTH  
W = WIDTH OF OFFSET IN FEET  
S = POSTED SPEED OR OFF-PEAK 85-PERCENTILE SPEED IN MPH



TITLE: TRAFFIC CONTROL  
SIGNING AND CONSTRUCTION TRAFFIC CONTROL STANDARDS

DESIGN REVIEW COMMITTEE	CITY ENGINEER APPROVAL	MO./DAY/YR.	MO./DAY/YR.

CITY PROJECT NO.	ZONE MAP NO.	SHEET	OF
P7396.01	K-17	8	9



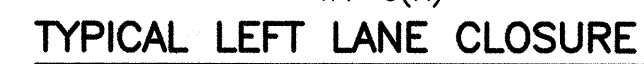

- GENERAL NOTE:

⚠ ALL ADVANCE WARNING SIGNS SHALL BE A MINIMUM OF 36" THIRTY SIX INCHES BY 36" THIRTY SIX INCHES IN SIZE AND SHALL HAVE ONE WARNING LIGHT.



- 
- Diagram illustrating the placement of signs for a left-turn lane at an intersection. The diagram shows a four-way intersection with a left-turn lane on the northbound approach. Signs include:
- Left-turn lane:** R3-7(L) (Left Turn Only) and R3-2 (No Right Turn).
  - Northbound approach:** W20-1 (One Way) and R3-2 (No Right Turn).
  - Southbound approach:** W1-6(R) (One Way) and R3-2 (No Right Turn).
  - Eastbound approach:** W20-1 (One Way) and R3-2 (No Right Turn).
  - Westbound approach:** W1-6(L) (One Way) and R3-2 (No Right Turn).
  - Intersection:** W20-1 (One Way) and R3-2 (No Right Turn).
  - Signage:** SPECIAL SIGN 10 (Left Turn Only) and R3-7(L) (Left Turn Only).
  - Dimensions:** D (Distance from intersection to sign) and 100' MIN (Minimum distance between signs).

### TYPICAL LANE CLOSURE AT INTERSECTION

**NOTE: DEPENDING ON WORK ZONE LOCATION.**

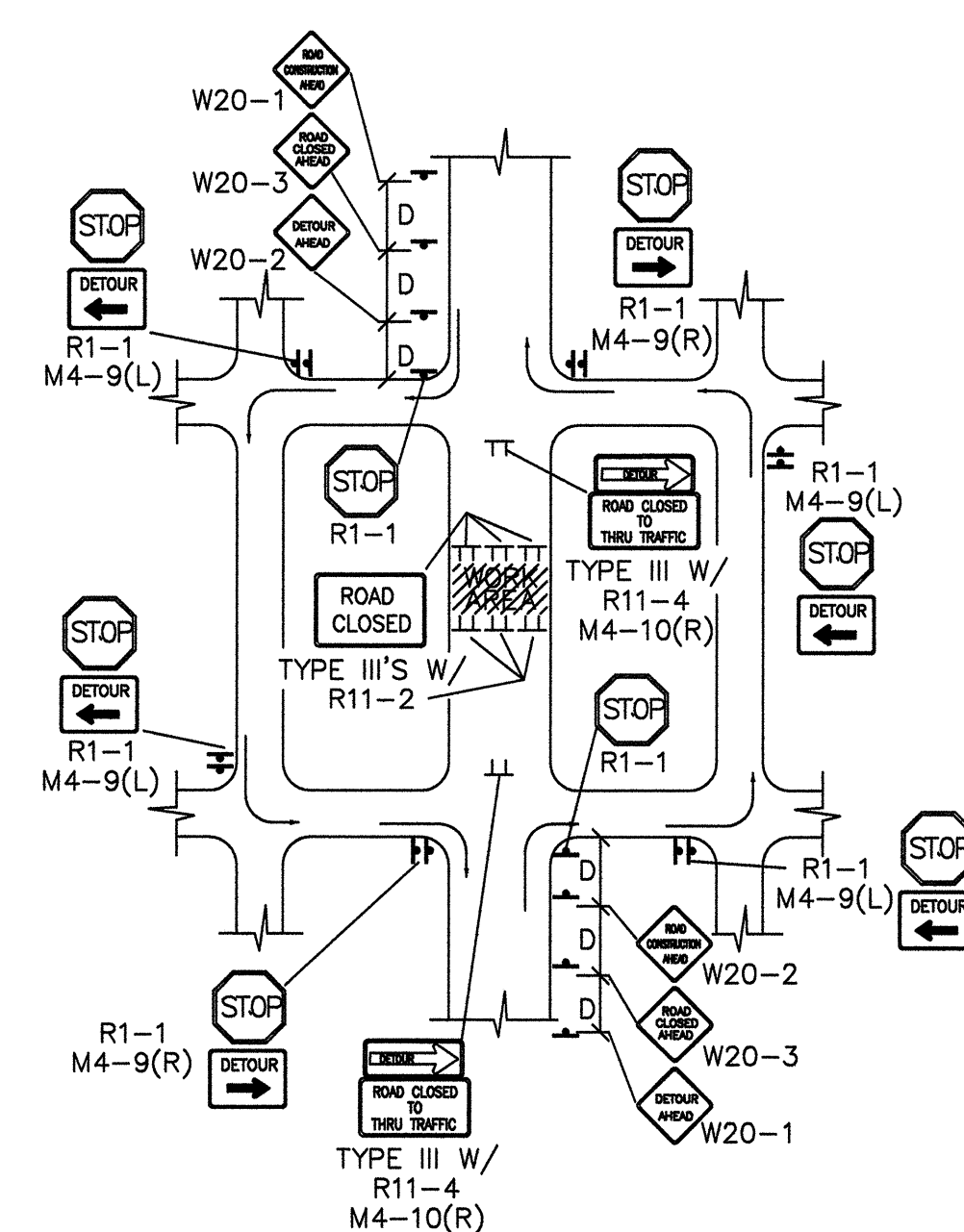

### TYPICAL MID-BLOCK CLOSURE

NOTE: (R1-1) BASED ON FIELD CONDITIONS.

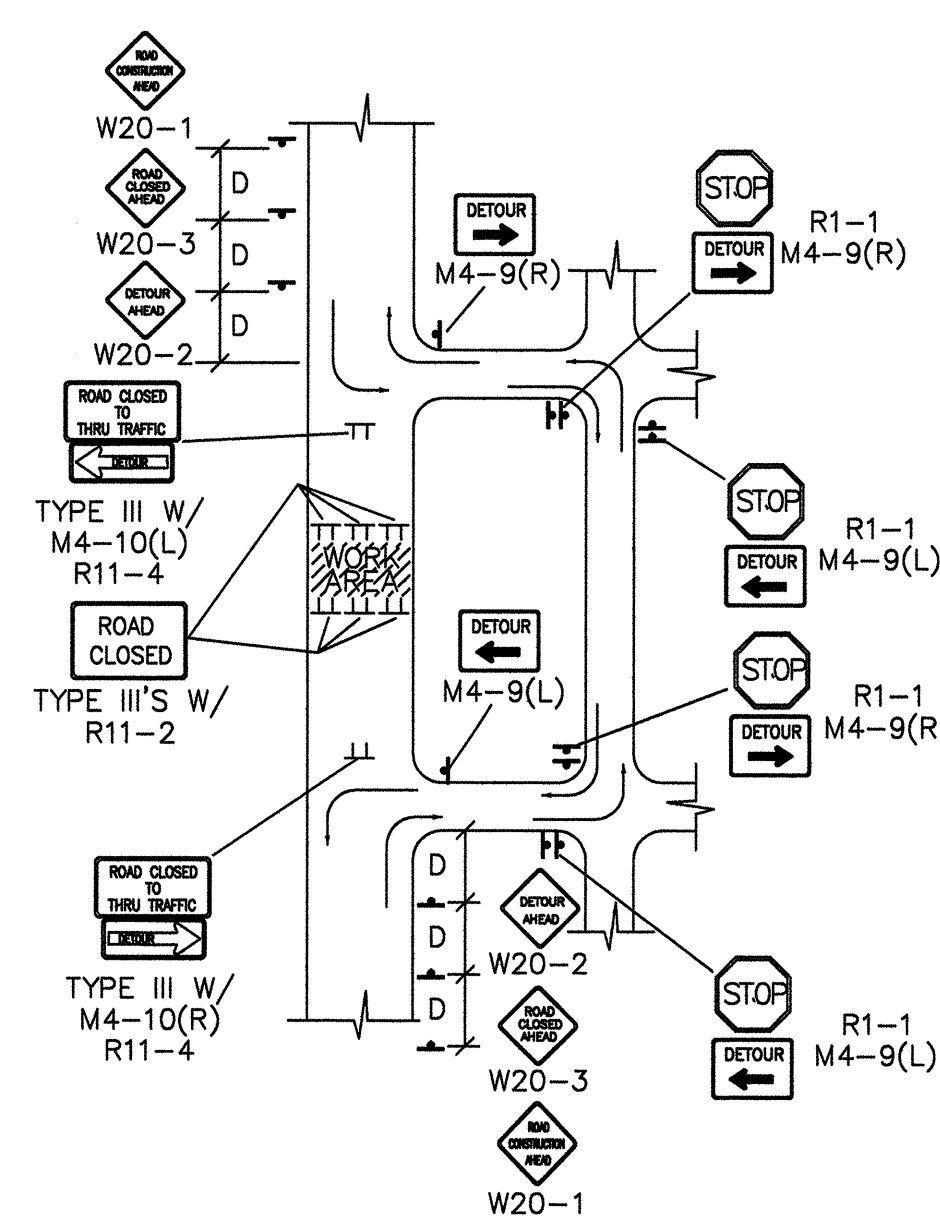

### TYPICAL STREET CLOSURE

NOTE: (R1-1) BASED ON FIELD CONDITIONS.

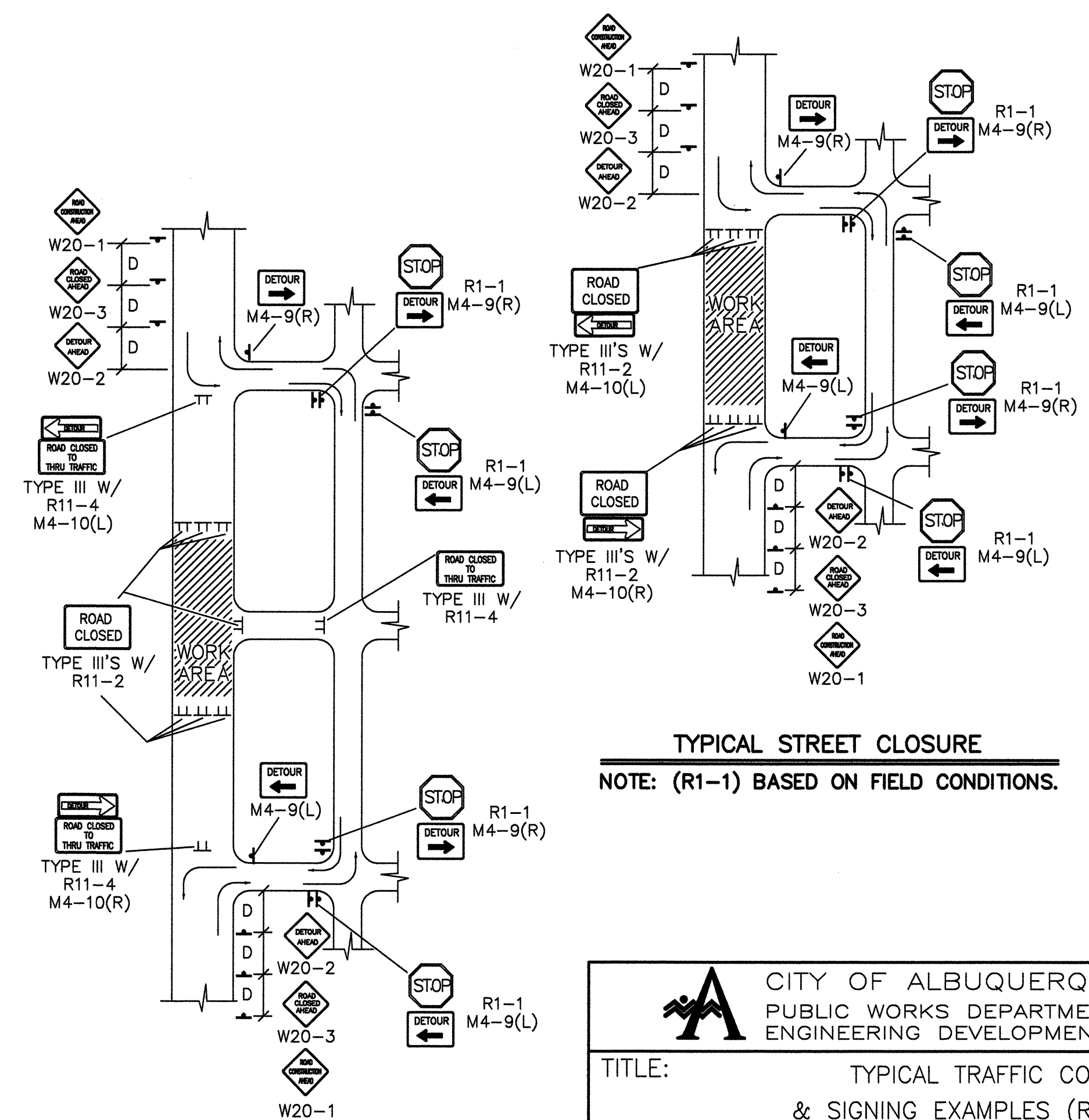

### TYPICAL STREET CLOSURE

**NOTE: (R1-1) BASED ON FIELD CONDITIONS.**

[BHI-MAIN\PROJECTS\97177\TRANS\DESIGN\SIGNAL\CITYTRAF.DWG