

SCANNED
BY PLW

CONSTRUCTION PLANS FOR **DECELARATION LANE COORS BY-PASS**

PAVING IMPROVEMENTS

CITY OF ALBUQUERQUE
NEW MEXICO
JUNE 2004

FW

CERTIFICATE OF SUBSTANTIAL COMPLIANCE ON PLANS

I, Ronald R. Bohannon, of the firm of **Tierra West LLC**, a Registered Professional Engineer in the State of New Mexico, do hereby certify, to the best of my knowledge and belief, that the infrastructure installed as part of this project has been inspected by me or by a qualified person under my direct supervision and has been constructed in accordance with the plans and specifications approved by the City Engineer and that the original design intent of the approved plans has been met, except as noted by me on the as-built construction drawings. This Certification is based on site inspections by me, or personnel under my direction with survey information provided by

Steve Walker, of **Walker Surveying**, N.M.P.S. number **6401**.

NOTE: Surveyor's Stamp is on Page 2 in the Survey Information Block.

APPROVED AS RECORD DRAWINGS
DESIGN REVIEW SECTION
CITY CONSTRUCTION ENGINEER
DATE: 6/24/04

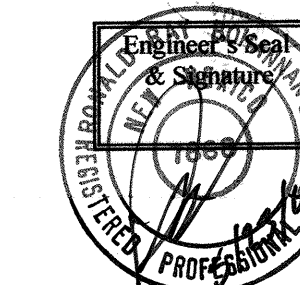

DRB # 1002397

TIERRA WEST, LLC
8509 JEFFERSON NE
ALBUQUERQUE, NEW MEXICO 87113
(505) 268-3100

INDEX TO DRAWINGS

1. TITLE SHEET
2. PAVING IMPROVEMENTS
COORS BY-PASS STA: 10+00 TO STA: 13+69.02

1/220115/22115-COORSPV.DWG/MP/06-22-2004

Elevations are in NGVD 29.

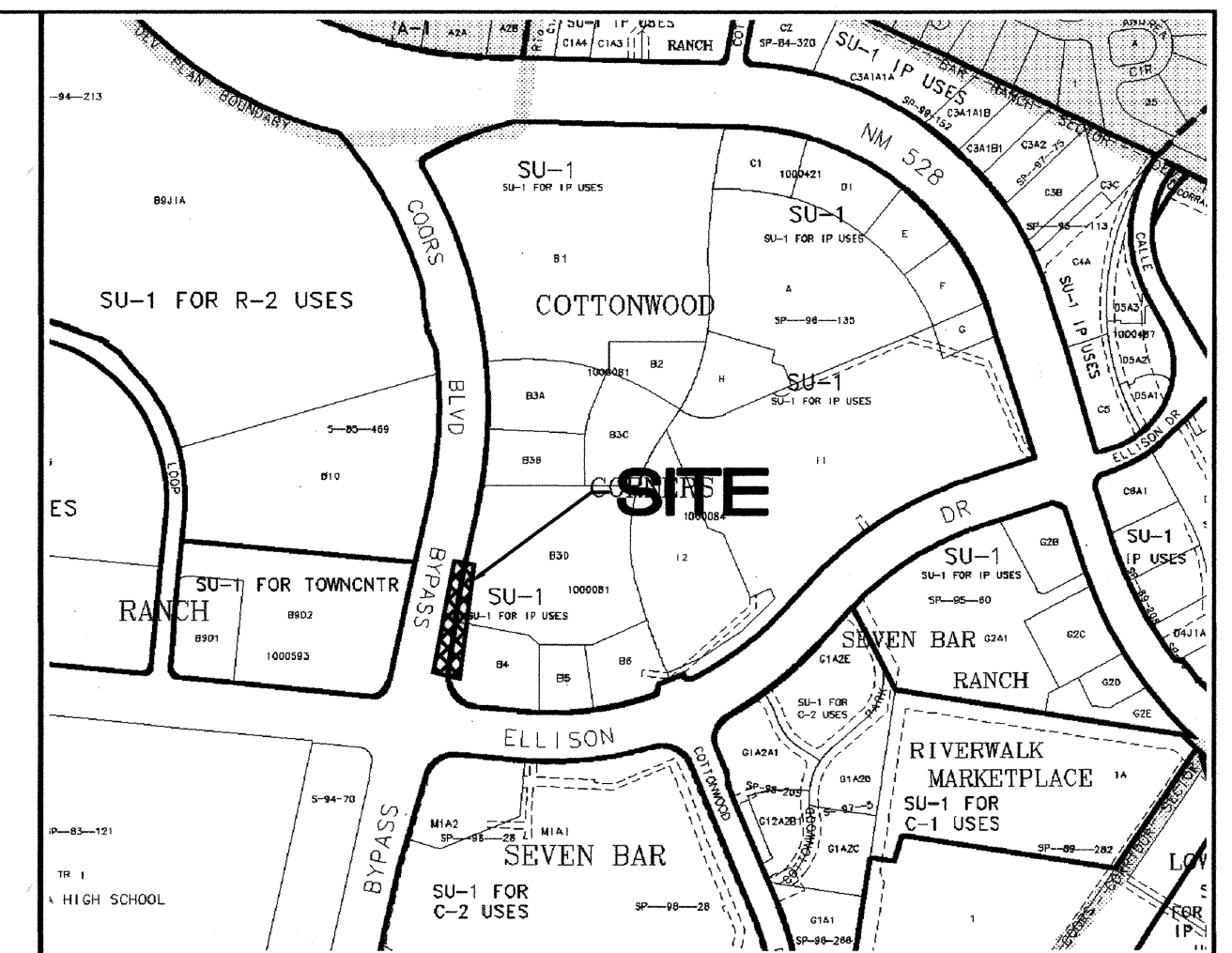

VICINITY MAP ZONE ATLAS: A-13/14-Z

NOTICE TO CONTRACTORS

SCALE NONE

1. ALL WORK DETAILED ON THESE PLANS TO BE PERFORMED UNDER CONTRACT SHALL, EXCEPT AS OTHERWISE STATED OR PROVIDED FOR HEREON, BE CONSTRUCTED IN ACCORDANCE WITH THE CITY OF ALBUQUERQUE STANDARD SPECIFICATIONS FOR PUBLIC WORKS CONSTRUCTION, 1986 EDITION (UPDATE #7)
2. TWO WORKING DAYS PRIOR TO ANY EXCAVATION, THE CONTRACTOR MUST CONTACT NEW MEXICO ONE CALL SYSTEM (280-1990) FOR LOCATION OF EXISTING UTILITIES.
3. ANY WORK AFFECTING AN ARTERIAL ROADWAY REQUIRES 24-HOUR CONSTRUCTION.
4. PRIOR TO CONSTRUCTION, THE CONTRACTOR SHALL EXCAVATE AND VERIFY THE HORIZONTAL AND VERTICAL LOCATIONS OF ALL OBSTRUCTIONS. SHOULD A CONFLICT EXIST, THE CONTRACTOR SHALL NOTIFY THE ENGINEER OR SURVEYOR IMMEDIATELY SO THAT THE CONFLICT CAN BE RESOLVED WITH A MINIMUM AMOUNT OF DELAY.
5. SEVEN (7) WORKING DAYS PRIOR TO BEGINNING OF CONSTRUCTION, THE CONTRACTOR SHALL SUBMIT TO CONSTRUCTION COORDINATIONS DIVISION A DETAILED CONSTRUCTION SCHEDULE. TWO(2) WORKING DAYS PRIOR TO CONSTRUCTION, THE CONTRACTOR SHALL OBTAIN A BARRICADING PERMIT FROM THE CONST. COORDINATION DIVISION. CONTRACTOR SHALL NOTIFY BARRICADE ENGINEER (924-3400) PRIOR TO OCCUPYING AN INTERSECTION. REFER TO STANDARD SPECIFICATIONS.
6. ALL STREET STRIPING ALTERED OR DESTROYED SHALL BE REPLACED WITH PLASTIC REFLECTORIZED PAVEMENT MARKINGS BY THE CONTRACTOR TO LOCATION AS EXISTING OR AS INDICATED BY THIS PLAN SET.
7. CONTRACTOR SHALL NOTIFY THE ENGINEER NOT LESS THAN SEVEN (7) DAYS PRIOR TO STARTING WORK IN ORDER THAT THE ENGINEER MAY TAKE NECESSARY MEASURES TO INSURE THE PRESERVATION OF SURVEY MONUMENTS. CONTRACTOR SHALL NOT DISTURB PERMANENT SURVEY MONUMENTS WITHOUT THE CONSENT OF THE ENGINEER AND SHALL NOTIFY THE ENGINEER AND BEAR THE EXPENSE OF REPLACING ANY THAT MAY BE DISTURBED WITHOUT PERMISSION. REPLACEMENT SHALL BE DONE ONLY BY THE CITY SURVEYOR. WHEN A CHANGE IS MADE IN THE FINISHED ELEVATIONS OF THE PAVEMENT OF ANY ROADWAY IN WHICH A PERMANENT SURVEY MONUMENT IS LOCATED, CONTRACTOR SHALL, AT HIS OWN EXPENSE, ADJUST THE MONUMENT COVER TO THE NEW GRADE UNLESS OTHERWISE SPECIFIED. REFER TO SECTION 4.4 OF THE GENERAL CONDITIONS OF THE STANDARD SPECIFICATIONS. ANY PERMANENT SURVEY MONUMENT LOCATED WITHIN 50' OF THIS PROJECT THAT IS NOT SHOWN ON THE PLAN AND IS DESTROYED DURING CONSTRUCTION WILL BE REPLACED AT THE DESIGNERS EXPENSE.
8. CONTRACTOR SHALL MAINTAIN A GRAFFITI-FREE WORK SITE. CONTRACTOR SHALL PROMPTLY REMOVE ANY AND ALL GRAFFITI FROM EQUIPMENT, WHETHER PERMANENT OR TEMPORARY.
9. FOR STORM DRAIN CONSTRUCTION, RCP PIPE JOINTS SHALL NOT BE GROUTED PRIOR TO FINAL INSPECTION. FINAL INSPECTION WILL DETERMINE JOINTS TO BE GROUTED FOR FINAL ACCEPTANCE OF THE CONSTRUCTION.

- THE FOLLOWING NOTES ALSO APPLY WHEN CHECKED
- ☒ ALL UTILITIES AND UTILITY SERVICE LINES SHALL BE INSTALLED PRIOR TO PAVING.
 - ☒ BACKFILL COMPACTION SHALL BE ACCORDING TO SPECIFIED STREET USE.
 - ☒ TACK COAT REQUIREMENTS SHALL BE DETERMINED BY THE PROJECT ENGINEER.
 - ☒ SIDEWALKS AND WHEELCHAIR RAMPS WITHIN THE CURB RETURNS SHALL BE CONSTRUCTED WHEREVER A NEW CURB RETURN IS CONSTRUCTED.
 - ☒ IF CURB IS DEEPER FOR A DRIVEPAD, THE DRIVEPAD SHALL BE CONSTRUCTED PRIOR TO ACCEPTANCE OF CURB AND GUTTER.
 - ☒ ALL STORM DRAINAGE FACILITIES SHALL BE COMPLETED PRIOR TO FINAL ACCEPTANCE.

REV	SHEETS	CITY ENGINEER	DATE	USER DEPT.	DATE	USER DEPT.	DATE
ENGINEERS STAMP & SIGNATURE		APPROVALS	ENGINEER	DATE	*****APPROVED FOR CONSTRUCTION*****		
		DRC Chairman	<i>[Signature]</i>	8-5-04	<i>[Signature]</i> City Engineer Date		
		Transportation	<i>[Signature]</i>	7-7-04			
		Water/Wastewater	<i>[Signature]</i>	7-10-04			
		Hydrology	<i>[Signature]</i>	7-10-04			
		C.I.P.	<i>[Signature]</i>	7-10-04			
		Constr. Coord.	<i>[Signature]</i>	8-5-04			
		N.M.U.I.	<i>[Signature]</i>	7-10-04			
		CITY PROJECT NO.	7398.81		SHEET 1 OF 2		

SCANNED
BY PLN

