

PROJECT LOCATION

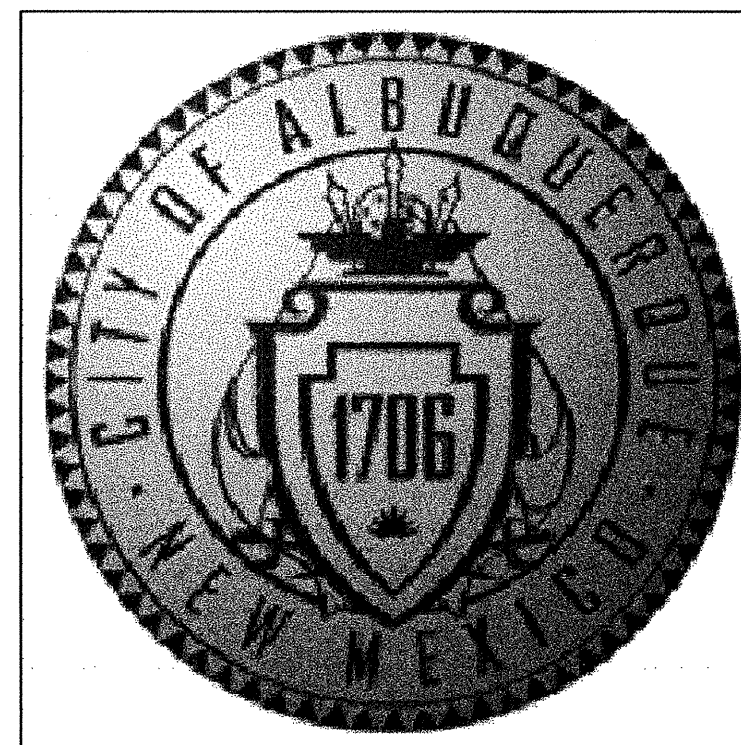

NORTH

LOCATION MAP

N.T.S.

ZONE MAP NO. H-14-Z, J-14-Z

GENERAL NOTES

1. AN EXCAVATION/ CONSTRUCTION PERMIT WILL BE REQUIRED BEGINNING ANY WORK WITHIN THE CITY RIGHT-OF-WAY.
2. ALL WORK DETAILED ON THESE PLANS TO BE PERFORMED UNDER CONTRACT SHALL, EXCEPT AS OTHERWISE STATED OR PROVIDED FOR HEREIN, BE CONSTRUCTED IN ACCORDANCE WITH THE CITY OF ALBUQUERQUE STANDARD SPECIFICATIONS FOR PUBLIC WORKS CONSTRUCTION, 1986 EDITION AND SHALL INCLUDE UPDATE NO. 7.
3. TWO (2) WORKING DAYS PRIOR TO ANY EXCAVATION, THE CONTRACTOR SHALL CONTACT NEW MEXICO ONE CALL SYSTEM (260-1990) FOR LOCATION OF EXISTING UTILITIES.
4. PRIOR TO CONSTRUCTION, THE CONTRACTOR SHALL EXCAVATE AND VERIFY THE HORIZONTAL AND VERTICAL LOCATIONS OF ALL OBSTRUCTIONS. SHOULD A CONFLICT EXIST, THE CONTRACTOR SHALL NOTIFY THE LANDSCAPE ARCHITECT IMMEDIATELY SO THAT THE CONFLICT CAN BE RESOLVED WITH A MINIMUM AMOUNT OF DELAY.
5. FIVE (5) WORKING DAYS PRIOR TO BEGINNING CONSTRUCTION, THE CONTRACTOR SHALL SUBMIT TO THE CONSTRUCTION COORDINATION DIVISION, A DETAILED CONSTRUCTION SCHEDULE. TWO (2) DAYS PRIOR TO CONSTRUCTION, THE CONTRACTOR SHALL OBTAIN A BARRICADE PERMIT FROM THE CONSTRUCTION COORDINATION DIVISION. CONTRACTOR SHALL NOTIFY BARRICADE ENGINEER (924-3400) PRIOR TO OCCUPYING AN INTERSECTION. CONTRACTOR SHALL REFER TO SECTION 19 OF THE STANDARD SPECIFICATIONS FOR TRAFFIC CONTROL.
6. ALL STREET STRIPING ALTERED OR DESTROYED SHALL BE REPLACED WITH PLASTIC REFLECTORIZED PAVEMENT MARKING BY CONTRACTOR TO SAME LOCATION AS EXISTING OR AS INDICATED BY THIS PLAN SET.
7. CONTRACTOR SHALL COORDINATE WITH WATER SYSTEMS DIVISION (857-8200) SEVEN (7) WORKING DAYS IN ADVANCE OF ANY WORK THAT MAY AFFECT EXISTING PUBLIC WATER OR SEWER UTILITIES. EXISTING VALVES TO BE OPERATED BY CITY PERSONNEL ONLY. CONTRACTOR SHALL CONTACT THE WATER SYSTEMS DIVISION SEVEN (7) DAYS PRIOR TO NEEDING VALVES TURNED ON OR OFF.
8. CONTRACTOR SHALL RECORD DATA ON ALL UTILITY LINES AND ACCESSORIES AS REQUIRED BY THE CITY OF ALBUQUERQUE FOR THE PREPARATION OF THE "AS CONSTRUCTED" DRAWINGS. CONTRACTOR SHALL NOT COVER UTILITY LINES AND ACCESSORIES UNTIL ALL DATA HAS BEEN RECORDED.
9. CONTRACTOR SHALL NOTIFY THE CITY SURVEYING NOT LESS THAN SEVEN (7) DAYS PRIOR TO STARTING WORK, IN ORDER THAT THE CITY SURVEYING MAY TAKE NECESSARY MEASURES TO INSURE THAT PRESERVATION OF SURVEY MONUMENTS. CONTRACTOR SHALL NOT DISTURB PERMANENT SURVEY MONUMENTS WITHOUT THE CONSENT OF THE CITY SURVEYING AND SHALL NOTIFY THE CITY SURVEYING AND BEAR THE EXPENSE OF REPLACING ANY THAT MAY BE DISTURBED WITHOUT PERMISSION. REPLACEMENT SHALL BE DONE ONLY BY THE CITY OF ALBUQUERQUE SURVEY SECTION. WHEN A CHANGE IS MADE IN THE FINISH ELEVATION OF THE PAVEMENT OF ANY ROADWAY IN WHICH A PERMANENT SURVEY MONUMENT IS LOCATED, CONTRACTOR SHALL, AT HIS OWN EXPENSE ADJUST THE MONUMENT COVER TO NEW GRADE, UNLESS OTHERWISE SPECIFIED. REFER TO SECTION 4.4 OF THE SPECIFICATIONS.
10. CONTRACTOR SHALL MAINTAIN A GRAFFITI-FREE WORK SITE. CONTRACTOR SHALL PROMPTLY REMOVE ANY GRAFFITI FROM ALL EQUIPMENT, WHETHER PERMANENT OR TEMPORARY.
11. IF ANY EXISTING UTILITY LINES, PIPELINES, OR UNDERGROUND UTILITY LINES ARE SHOWN ON THESE DRAWINGS THEY ARE SHOWN IN AN APPROXIMATE MANNER ONLY AND SUCH LINES MAY EXIST WHERE THEY ARE SHOWN OR IF ANY SUCH EXISTING LINES ARE SHOWN, THE LOCATION IS BASED ON INFORMATION PROVIDED BY THE OWNER OF SAID UTILITY, AND THE INFORMATION MAY BE INCOMPLETE, OR MAY BE OBSOLETE BY THE TIME CONSTRUCTION COMMENCES. THE LANDSCAPE ARCHITECT HAS CONDUCTED ONLY PRELIMINARY INVESTIGATION OF THE LOCATION, DEPTH, SIZE, OR TYPE OF EXISTING UTILITY LINES, PIPELINES OR UNDERGROUND UTILITY LINES. THIS INVESTIGATION IS NOT CONCLUSIVE, AND MAY NOT BE COMPLETE, THEREFORE, MAKE NO REPRESENTATION PERTAINING THERETO, AND ASSUMES NO RESPONSIBILITY OR LIABILITY. THEREFORE, THE CONTRACTOR SHALL INFORM ITSELF OF THE LOCATION OF ANY UTILITY LINES, PIPELINES, OR UNDERGROUND UTILITY LINE IN OR NEAR THE AREA OF WORK IN ADDITION TO AND DURING EXCAVATION WORK. THE CONTRACTOR IS FULLY RESPONSIBLE FOR ANY AND ALL DAMAGES CAUSED BY ITS FAILURE TO LOCATE, IDENTIFY AND PRESERVE ANY AND ALL EXISTING UTILITIES, PIPELINES, AND UNDERGROUND LINE. IN PLANNING AND CONDUCTING EXCAVATION, THE CONTRACTOR SHALL COMPLY WITH STATE STATUTES, MUNICIPAL AND LOCAL ORDINANCES, RULES AND REGULATIONS, IF ANY, PERTAINING TO THE LOCATION OF THESE UTILITY LINES AND FACILITIES.
12. SHOULD A CONFLICT EXIST BETWEEN THESE PLANS AND THE ACTUAL FIELD CONDITIONS, THE CONTRACTOR SHALL PROMPTLY NOTIFY THE LANDSCAPE ARCHITECT IN WRITING SO THAT THE CONFLICT CAN BE RESOLVED WITH THE MINIMUM AMOUNT OF DELAY FOR ALL PARTIES.
13. THE CONTRACTOR SHALL MAINTAIN ACCESS TO ADJACENT PROPERTIES DURING CONSTRUCTION.
14. ALL WORK ON THIS PROJECT SHALL BE PERFORMED IN ACCORDANCE WITH THE APPLICABLE FEDERAL, STATE AND LOCAL LAWS, RULES AND REGULATIONS CONCERNING SAFETY AND HEALTH.
15. ALL UTILITIES AND UTILITY SERVICE LINES SHALL BE INSTALLED PRIOR TO PAVING.
16. BACKFILL COMPACTION SHALL BE ACCORDING TO SPECIFIED STREET USE.
17. TACK COAT REQUIREMENTS SHALL BE DETERMINED DURING CONSTRUCTION BY THE LANDSCAPE ARCHITECT.
18. CAUTION, THESE DRAWINGS DO NOT INCLUDE NECESSARY COMPONENTS FOR CONSTRUCTION SAFETY WHICH SHALL REMAIN THE RESPONSIBILITY OF THE CONTRACTOR.
19. ANY WORK AFFECTING AN ARTERIAL ROADWAY REQUIRES TWENTY-FOUR (24) HOUR CONSTRUCTION.
20. ANY SIGNAL CONDUITS, LOOPS, PULL BOXES OR OTHER TRAFFIC UTILITIES THAT ARE DAMAGED BY CONSTRUCTION OPERATIONS SHALL BE REPLACED BY THE CONTRACTOR AT NO ADDITIONAL COST TO THE OWNER.
21. ANY SIDEWALK, RAMPS, CURBS AND GUTTER, OR OTHER CITY FACILITY DAMAGED BY CONSTRUCTION OPERATIONS SHALL BE REPLACED BY THE CONTRACTOR AT NO ADDITIONAL COST TO THE OWNER.
22. EVERY CARE HAS BEEN TAKEN TO ASSURE THAT PLANT MATERIAL NOT BE IN CONFLICT WITH SAs LOCATIONS. HOWEVER, CONTRACTOR SHALL UNDER NO CIRCUMSTANCES POSITION TREES OVER SAs LINES, THAT ARE NOT 6" DEEP AND OF PVC MATERIAL.

TITLE	SHEET NO.
COVER SHEET	1
DEMOLITION PLAN	2
DEMOLITION PLAN	3
DEMOLITION PLAN	4
DEMOLITION PLAN	5
DEMOLITION PLAN	6
DEMOLITION PLAN	7
PLANTING PLAN	8
PLANTING PLAN	9
PLANTING PLAN	10
PLANTING PLAN	11
PLANTING PLAN	12
PLANTING PLAN	13



08/26/04

SET NUMBER:

[illegible]

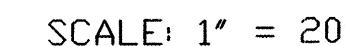

1. CONTRACTOR SHALL PROTECT EXISTING TREES AND SHRUBS DESIGNATED TO REMAIN FROM DAMAGE DUE TO CONSTRUCTION OPERATIONS. ANY PLANT DAMAGED SHALL BE REPLACED WITH PLANT OF SAME SPECIES AND SIZE. IF SIZE IS UNAVAILABLE, CONTRACTOR SHALL PROVIDE CREDIT TO OWNER FOR VALUE OF DIFFERENCE IN SIZE.
2. ALL EXISTING PLANTS ARE TO REMAIN UNLESS IDENTIFIED FOR REMOVAL BY A BOLD X.

[illegible]

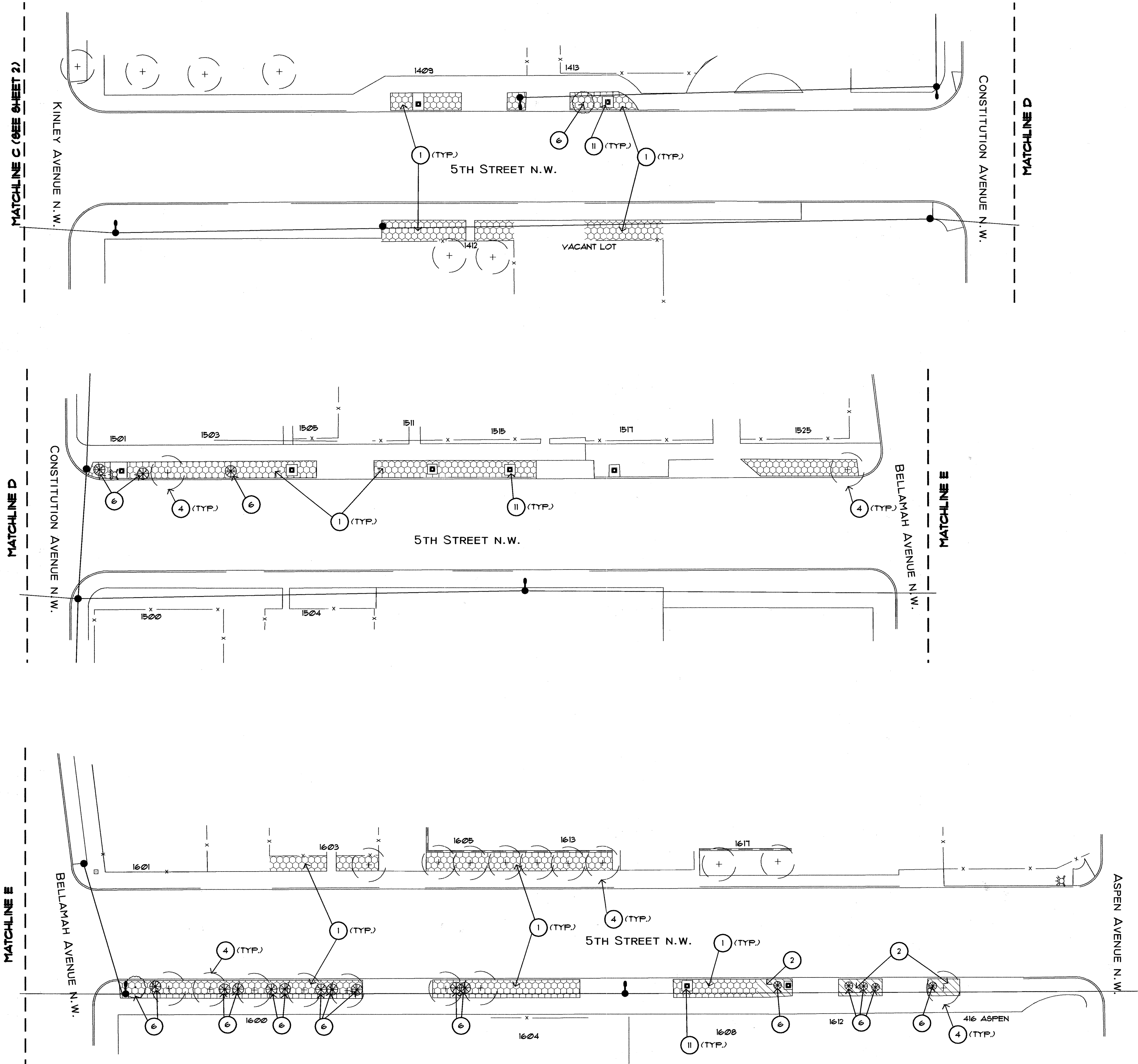



DEMOLITION KEYED NOTES

- 1 CONTRACTOR SHALL REMOVE EXISTING SOIL, TURF, GRAVEL AND DEBRIS IN PARKWAYS OR MEDIAN AS REQUIRED TO INSTALL MULCH. REFERENCE PLANTING PLAN FOR TYPE OF MULCH.
- 2 EXISTING MULCH TO REMAIN.
- 3 EXISTING TREE TO BE REMOVED AND PROPERLY DISPOSED OF. STUMP SHALL BE REMOVED TO A DEPTH OF 18" BELOW TOP OF FINISH GRADE. GRINDINGS SHALL BE REMOVED FROM HOLE AND VOID SHALL BE FILLED WITH CLEAN FILL (TYPICAL OF TREES MARKED WITH A BOLD X).
- 4 EXISTING TREE TO REMAIN.
- 5 EXISTING SHRUB TO BE REMOVED AND PROPERLY DISPOSED OF (TYPICAL FOR SHRUBS MARKED WITH A BOLD X).
- 6 EXISTING SHRUB TO REMAIN.
- 7 EXISTING STUMP TO BE REMOVED AND PROPERLY DISPOSED OF. STUMP SHALL BE REMOVED TO A DEPTH OF 18" BELOW TOP OF FINISH GRADE. GRINDINGS SHALL BE REMOVED FROM HOLE AND VOID SHALL BE FILLED WITH CLEAN FILL.
- 8 EXISTING BRICK PAVING TO BE REMOVED AND RETURNED TO PROPERTY OWNER.
- 9 EXISTING SHRUB SHALL BE REMOVED AND RELOCATED ADJACENT TO EXISTING SHRUB TO THE NORTH TO MAKE ROOM FOR PROPOSED TREE. SEE PLANTING PLAN SHEET 10.
- 10 EXISTING EXISTING BRICK PAVING TO REMAIN.
- 11 EXISTING WATER METER TO REMAIN.

DEMOLITION NOTES

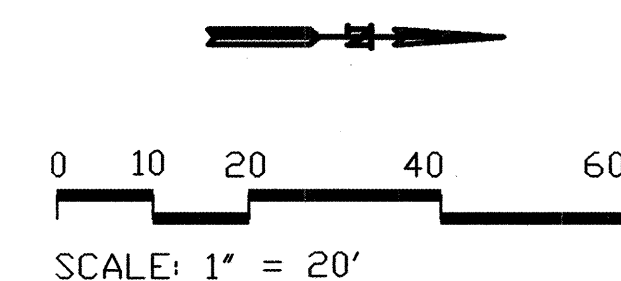
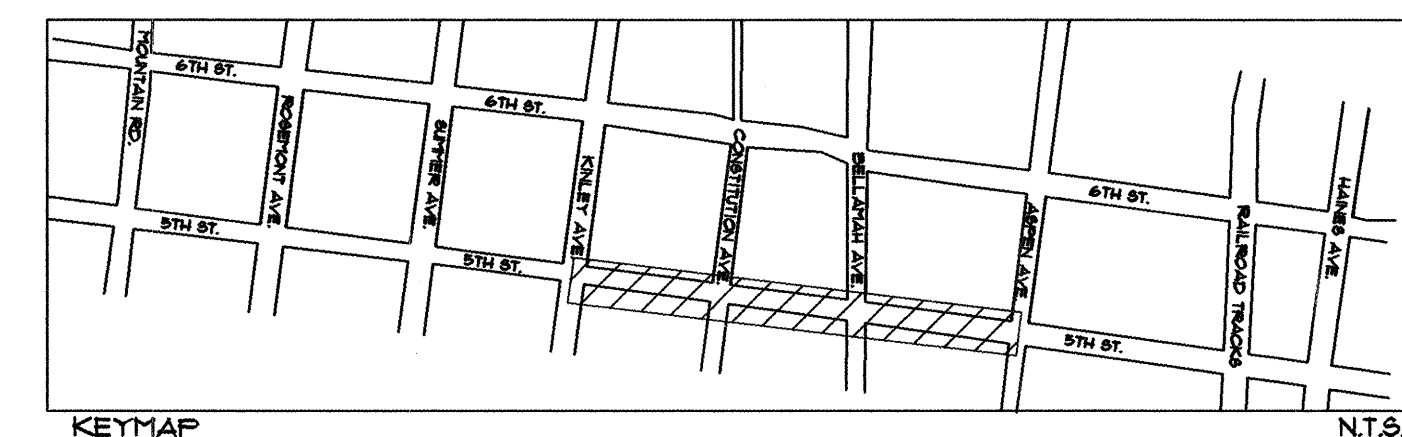
1. CONTRACTOR SHALL PROTECT EXISTING TREES AND SHRUBS DESIGNATED TO REMAIN FROM DAMAGE DUE TO CONSTRUCTION OPERATIONS. ANY PLANT DAMAGED SHALL BE REPLACED WITH PLANT OF SAME SPECIES AND SIZE. IF SIZE IS UNAVAILABLE, CONTRACTOR SHALL PROVIDE CREDIT TO OWNER FOR VALUE OF DIFFERENCE IN SIZE.
2. ALL EXISTING PLANTS ARE TO REMAIN, UNLESS IDENTIFIED FOR REMOVAL BY A BOLD X.



<div>STATE OF NEW MEXICO</div> <div></div> <div>BENJAMIN C. REARDON</div> <div>NO. 25</div> <div>LANDSCAPE ARCHITECT</div>		ENGINEER'S SEAL		SURVEY INFORMATION		BENCH MARKS		AS BUILT INFORMATION	
		FIELD NOTES		NO.		DATE		CONTRACTOR	
		BY						WORKED BY	
								INSPECTOR'S	
								ACCEPTANCE BY	
								DATE	
								DATE	
								DATE	
								DATE	
						DATE			
						DATE			
						DATE			
						DATE			
						DATE			
						DATE			
						DATE			
						DATE			
						DATE			
						DATE			
						DATE			
						DATE			
						DATE			
						DATE			
						DATE			
						DATE			
						DATE			
						DATE			
						DATE			
						DATE			
						DATE			
						DATE			
						DATE			
						DATE			
						DATE			
						DATE			
						DATE			
						DATE			
						DATE			
						DATE			
						DATE			
						DATE			
						DATE			
						DATE			
						DATE			
						DATE			
						DATE			
						DATE			
						DATE			
						DATE			
						DATE			
						DATE			
						DATE			
						DATE			
						DATE			
						DATE			
						DATE			
						DATE			
						DATE			
						DATE			
						DATE			
						DATE			
						DATE			
						DATE			
						DATE			
						DATE			
						DATE			
						DATE			
						DATE			
						DATE			
						DATE			
						DATE			
						DATE			
						DATE			
						DATE			
						DATE			
						DATE			
						DATE			
						DATE			
						DATE			
						DATE			
						DATE			
						DATE			
						DATE			
						DATE			
						DATE			
						DATE			
						DATE			
						DATE			
						DATE			
						DATE			
						DATE			
						DATE			
						DATE			
						DATE			
						DATE			
						DATE			
						DATE			
						DATE			
						DATE			
						DATE			
						DATE			
						DATE			
						DATE			
						DATE			
						DATE			
						DATE			
						DATE			
						DATE			
						DATE			
						DATE			
						DATE			
						DATE			
						DATE			
						DATE			
						DATE			
						DATE			
						DATE			
						DATE			
						DATE			
						DATE			
						DATE			
						DATE			
						DATE			
						DATE			
						DATE			
						DATE			
						DATE			
						DATE			
						DATE			
						DATE			
						DATE			
						DATE			
						DATE			
						DATE			
						DATE			
						DATE			
						DATE			
						DATE			
						DATE			
						DATE			
						DATE			
						DATE			
						DATE			
						DATE			
						DATE			
						DATE			
		</							

CITY OF ALBUQUERQUE DEPARTMENT OF MUNICIPAL DEVELOPMENT CAPITAL IMPLEMENTATION PROGRAM			
TITLE: 5th AND 6th STREETS STREETSCAPE LANDSCAPE IMPROVEMENTS DEMOLITION PLAN			
Design Review Committee	City Engineer Approval	Mo/Day/Yr	Mo/Day/Yr
APPROVED	APPROVED		
	CITY ENGINEER		
CITY PROJECT NO.	ZONE MAP NO.	SHEET	OF
744391	H-14 & J-14	3	13

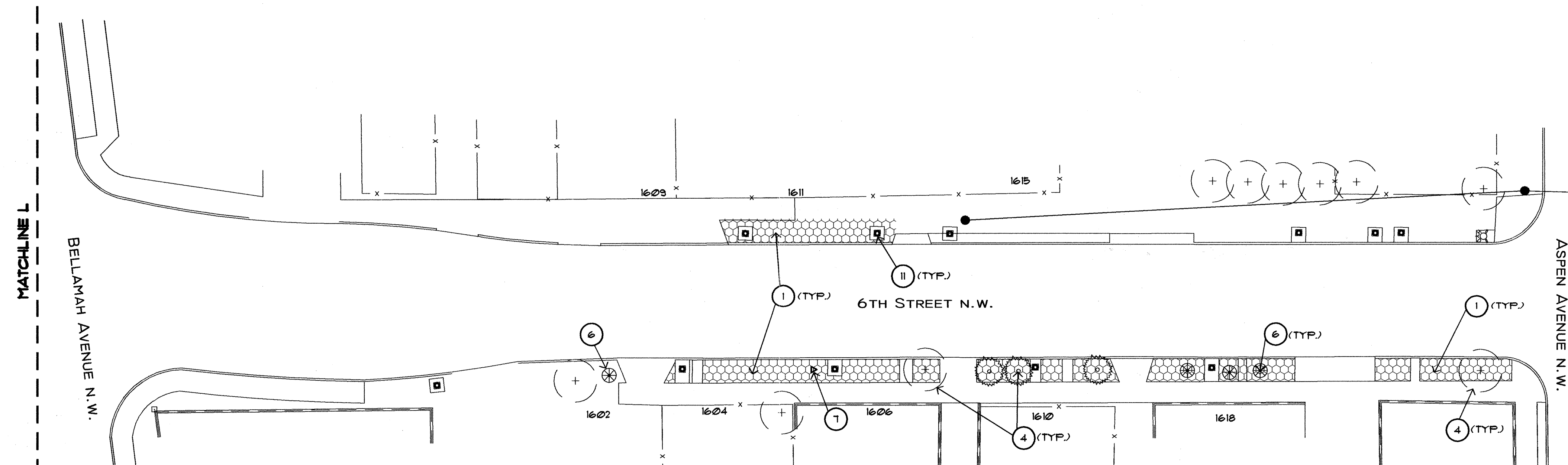



- 1 CONTRACTOR SHALL REMOVE EXISTING SOIL, TURF, GRAVEL AND DEBRIS IN PARKWAYS OR MEDIAN AS REQUIRED TO INSTALL MULCH. REFERENCE PLANTING PLAN FOR TYPE OF MULCH.
- 2 EXISTING MULCH TO REMAIN.
- 3 EXISTING TREE TO BE REMOVED AND PROPERLY DISPOSED OF. STUMP SHALL BE REMOVED TO A DEPTH OF 18" BELOW TOP OF FINISH GRADE. GRINDINGS SHALL BE REMOVED FROM HOLE AND VOID SHALL BE FILLED WITH CLEAN FILL (TYPICAL OF TREES MARKED WITH A BOLD X).
- 4 EXISTING TREE TO REMAIN.
- 5 EXISTING SHRUB TO BE REMOVED AND PROPERLY DISPOSED OF (TYPICAL FOR SHRUBS MARKED WITH A BOLD X).
- 6 EXISTING SHRUB TO REMAIN.
- 7 EXISTING STUMP TO BE REMOVED AND PROPERLY DISPOSED OF. STUMP SHALL BE REMOVED TO A DEPTH OF 18" BELOW TOP OF FINISH GRADE. GRINDINGS SHALL BE REMOVED FROM HOLE AND VOID SHALL BE FILLED WITH CLEAN FILL.
- 8 EXISTING BRICK PAVING TO BE REMOVED AND RETURNED TO PROPERTY OWNER.
- 9 EXISTING SHRUB SHALL BE REMOVED AND RELOCATED ADJACENT TO EXISTING SHRUB TO THE NORTH TO MAKE ROOM FOR PROPOSED TREE. SEE PLANTING PLAN SHEET 10.
- 10 EXISTING EXISTING BRICK PAVING TO REMAIN.
- 11 EXISTING WATER METER TO REMAIN.

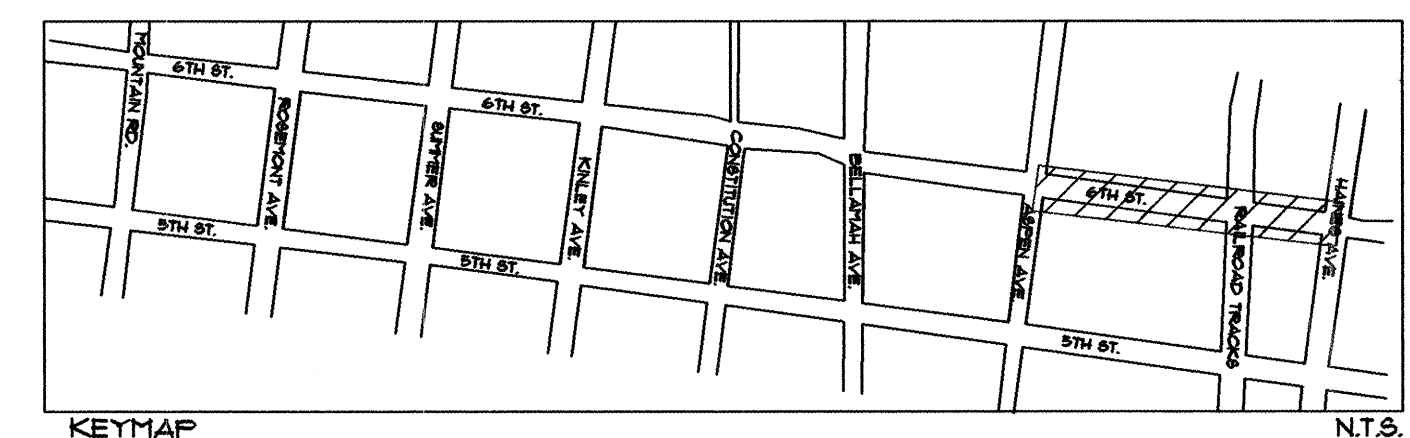

DEMOLITION NOTES

1. CONTRACTOR SHALL PROTECT EXISTING TREES AND SHRUBS DESIGNATED TO REMAIN FROM DAMAGE DUE TO CONSTRUCTION OPERATIONS. ANY PLANT DAMAGED SHALL BE REPLACED WITH PLANT OF SAME SPECIES AND SIZE. IF SIZE IS UNAVAILABLE, CONTRACTOR SHALL PROVIDE CREDIT TO OWNER FOR VALUE OF DIFFERENCE IN SIZE.
2. ALL EXISTING PLANTS ARE TO REMAIN, UNLESS IDENTIFIED FOR REMOVAL BY A BOLD X.



CITY OF ALBUQUERQUE
DEPARTMENT OF MUNICIPAL DEVELOPMENT
CAPITAL IMPLEMENTATION PROGRAM

TITLE: 5th AND 6th STREETS STREETSCAPE
LANDSCAPE IMPROVEMENTS
DEMOLITION PLAN

Design Review Committee 		City Engineer Approval 		Last Design Update	Mo/Day/Yr.	Mo/Day/Yr.
CITY PROJECT NO. 744391		ZONE MAP NO. H-14 & J-14		SHEET 6	OF 13	

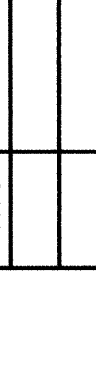
ENGINEER'S SEAL		SURVEY INFORMATION		BENCH MARKS		AS BUILT INFORMATION	
		FIELD NOTES				CONTRACTOR	
		NO.	BY	DATE		WORK STARTED BY	DATE
						WORK FINISHED BY	DATE
						FIELD OBSERVATION BY	DATE
						CHANGES COMPLETED BY	DATE
REVISIONS DESIGN						MICRO-FILM INFORMATION	
		DESIGNED BY JSP		DATE: 8/26/04		RECORDED BY	
		DRAWN BY JSP		DATE: 8/26/04		DATE	
		CHECKED BY ECR		DATE: 8/26/04			

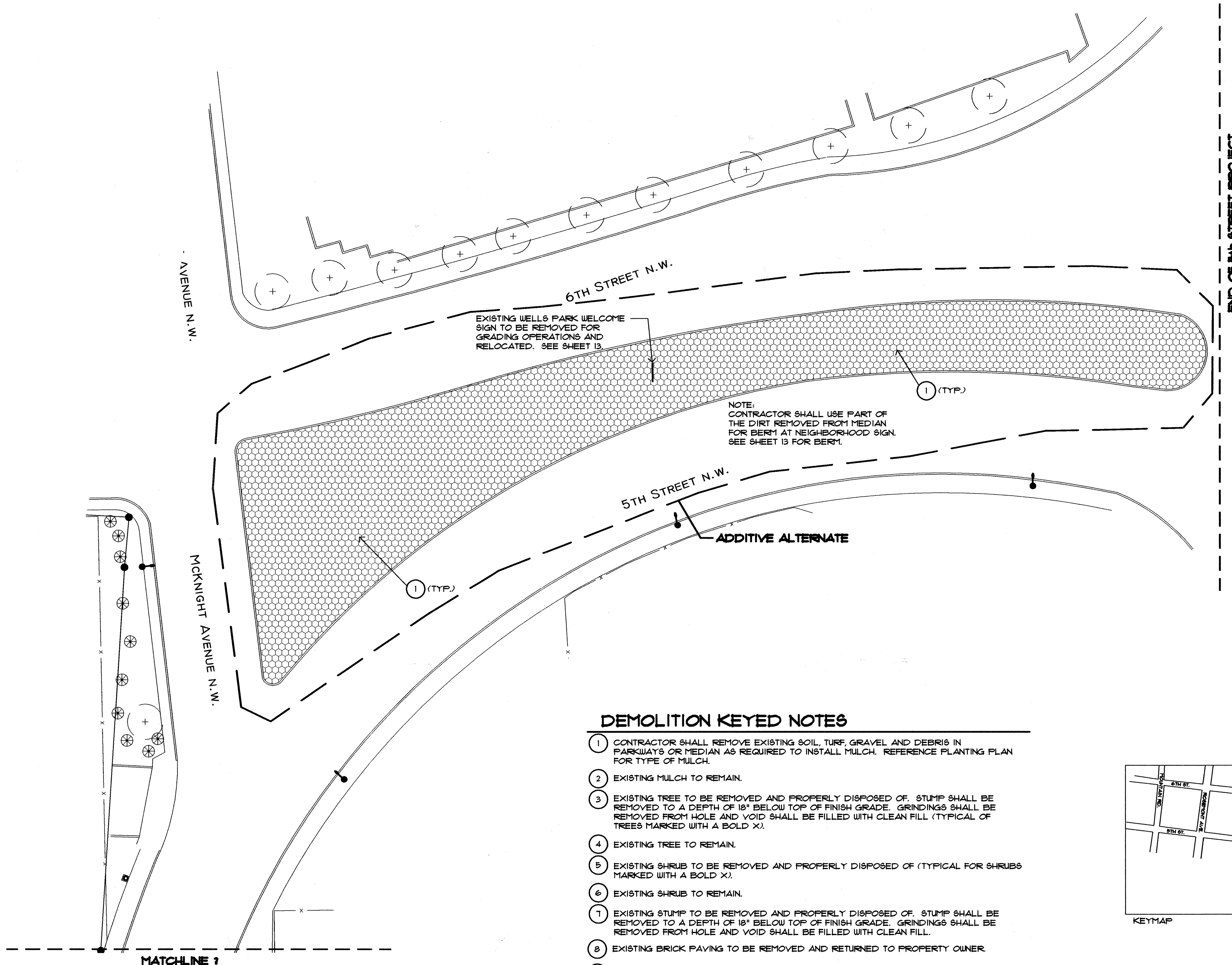

- DEMOLITION KEYED NOTES**
- 1 CONTRACTOR SHALL REMOVE EXISTING SOIL, TURF, GRAVEL AND DEBRIS IN PARKWAYS OR MEDIAN AS REQUIRED TO INSTALL MULCH. REFERENCE PLANTING PLAN FOR TYPE OF MULCH.
 - 2 EXISTING MULCH TO REMAIN.
 - 3 EXISTING TREE TO BE REMOVED AND PROPERLY DISPOSED OF. STUMP SHALL BE REMOVED TO A DEPTH OF 18" BELOW TOP OF FINISH GRADE. GRINDINGS SHALL BE REMOVED FROM HOLE AND VOID SHALL BE FILLED WITH CLEAN FILL (TYPICAL OF TREES MARKED WITH A BOLD X).
 - 4 EXISTING TREE TO REMAIN.
 - 5 EXISTING SHRUB TO BE REMOVED AND PROPERLY DISPOSED OF (TYPICAL FOR SHRUBS MARKED WITH A BOLD X).
 - 6 EXISTING SHRUB TO REMAIN.
 - 7 EXISTING STUMP TO BE REMOVED AND PROPERLY DISPOSED OF. STUMP SHALL BE REMOVED TO A DEPTH OF 18" BELOW TOP OF FINISH GRADE. GRINDINGS SHALL BE REMOVED FROM HOLE AND VOID SHALL BE FILLED WITH CLEAN FILL.
 - 8 EXISTING BRICK PAVING TO BE REMOVED AND RETURNED TO PROPERTY OWNER.
 - 9 EXISTING SHRUB SHALL BE REMOVED AND RELOCATED ADJACENT TO EXISTING SHRUB TO THE NORTH TO MAKE ROOM FOR PROPOSED TREE. SEE PLANTING PLAN SHEET 10.
 - 10 EXISTING EXISTING BRICK PAVING TO REMAIN.
 - 11 EXISTING WATER METER TO REMAIN.

- DEMOLITION NOTES**
- 1. CONTRACTOR SHALL PROTECT EXISTING TREES AND SHRUBS DESIGNATED TO REMAIN FROM DAMAGE DUE TO CONSTRUCTION OPERATIONS. ANY PLANT DAMAGED SHALL BE REPLACED WITH PLANT OF SAME SPECIES AND SIZE. IF SIZE IS UNAVAILABLE, CONTRACTOR SHALL PROVIDE CREDIT TO OWNER FOR VALUE OF DIFFERENCE IN SIZE.
 - 2. ALL EXISTING PLANTS ARE TO REMAIN, UNLESS IDENTIFIED FOR REMOVAL BY A BOLD X.

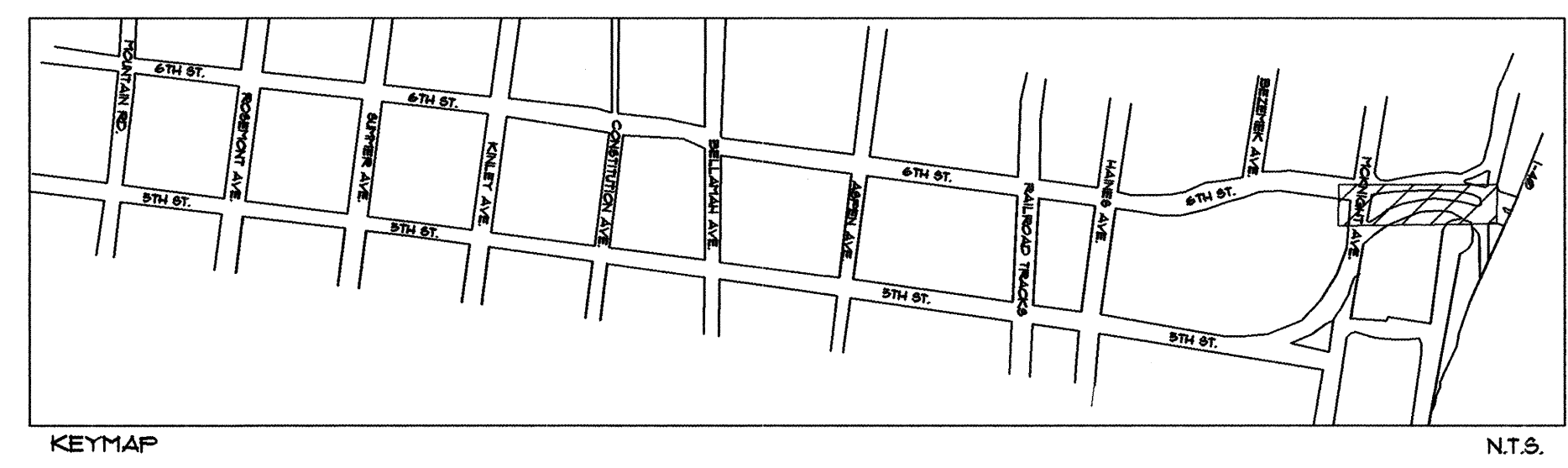

MORROW REARDON WILKINSON, LTD.
LANDSCAPE ARCHITECTS
210 La Veta NE, Albuquerque, NM 87108
505.268.2266 FAX 505.265.9637
mrw@mrwm.com

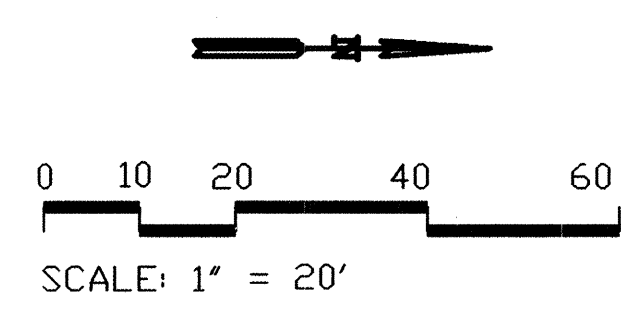

CITY OF ALBUQUERQUE DEPARTMENT OF MUNICIPAL DEVELOPMENT CAPITAL IMPLEMENTATION PROGRAM			
TITLE: 5th AND 6th STREETS STREETSCAPE LANDSCAPE IMPROVEMENTS DEMOLITION PLAN			
Design Review Committee	City Engineer Approval	Mo/Day/Yr.	Mo/Day/Yr.
APPROVED SEP - 04 DESIGN REVIEW COMMITTEE	APPROVED SEP - 04 CITY ENGINEER		
CITY PROJECT NO. 744391		ZONE MAP NO. H-14 & J-14	SHEET 7 OF 13

ENGINEER'S SEAL		SURVEY INFORMATION		BENCH MARKS		AS BUILT INFORMATION	
		FIELD NOTES					
		NO.	DATE				
		BY	DATE				
		REVISIONS	DESIGN				
		NO.	DATE				
		BY	DATE				
		DESIGNED BY	DATE: 8/26/04				
		DRAWN BY	DATE: 8/26/04				
		CHECKED BY	DATE: 8/26/04				
		RECORDED BY	DATE				
		NO.	DATE				

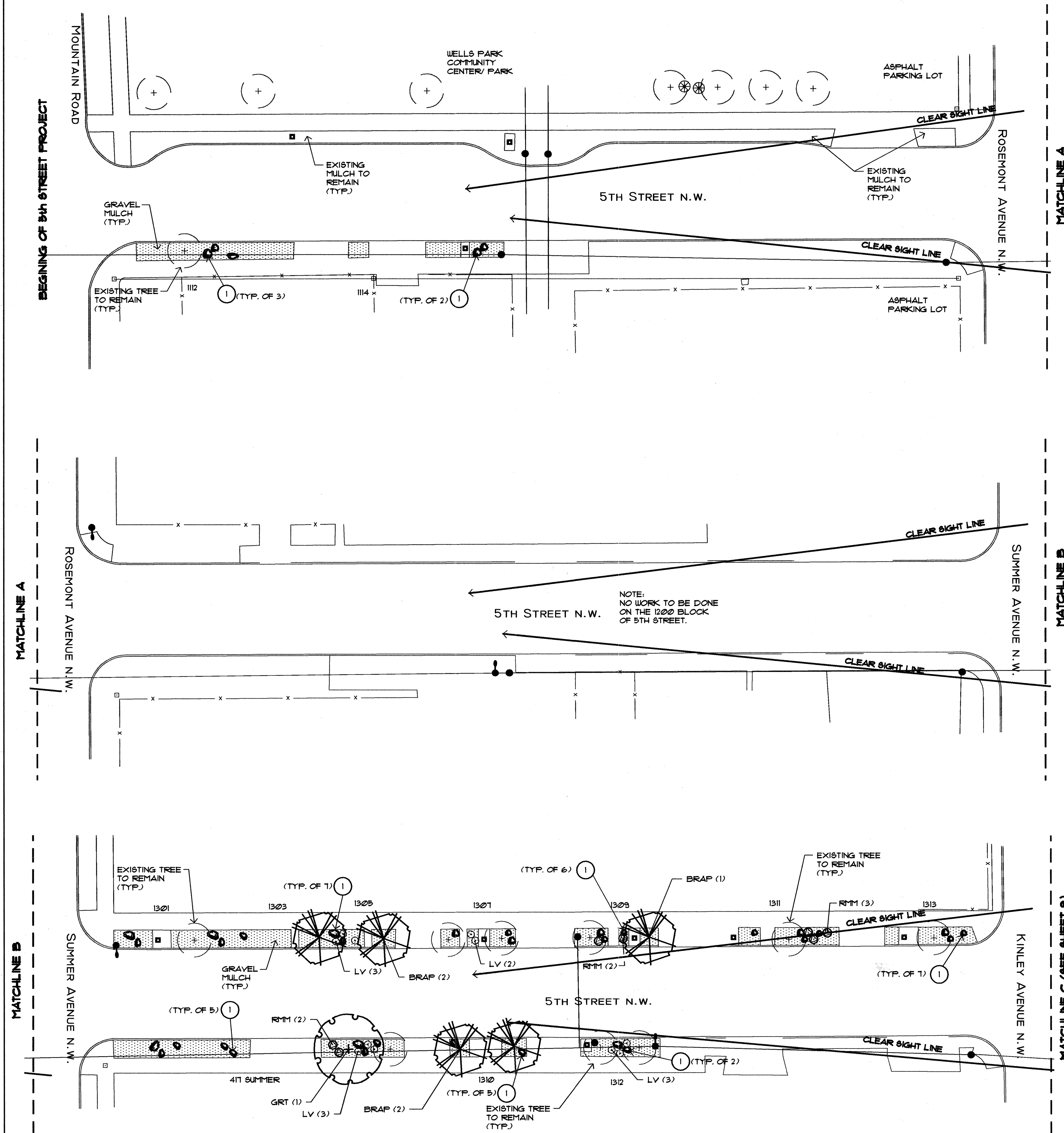

PLANT KEY (SEE SHEET 13 FOR PLANT SCHEDULE)

KEY	COMMON NAME	BOTANICAL NAME
TREES		
BRAP	Bradford Pear	<i>Pyrus calleryana</i> 'Bradford'
CHIP	Chinese pistache	<i>Pistacia chinensis</i>
GRT	Goldenrain tree	<i>Koeleruteria paniculata</i>
SHRUBS		
LV	Lavender	<i>Lavandula angustifolia</i> 'Mitcham Gray'
R1M	Regal Mist	<i>Muhlenbergia capillaris</i>

PLANTING NOTES

- IN CASE OF DISCREPANCY IN PLANT QUANTITIES SHOWN ON THE PLANT LIST AND THOSE SHOWN ON THE PLANTING PLAN, THE QUANTITIES SHOWN ON THE PLAN SHALL GOVERN. CONTRACTOR SHALL VERIFY ALL QUANTITIES PRIOR TO BID AND INSTALLATION. NO ADDITIONAL PAYMENT WILL BE MADE FOR DISCREPANCIES IN QUANTITIES BETWEEN THE PLANTING PLAN AND THE PLANT LIST.
- THE CONTRACTOR SHALL PRUNE LOWER BRANCHES OF DECIDUOUS TREES TO 6 FEET ABOVE FINISH GRADE.
- TREES SHALL BE PLANTED PER C.O.A. DRAWING # 2114 (SIMILAR - MULCH SHALL BE PER PLANTING NOTE #6).
- SHRUBS SHALL BE PLANTED PER C.O.A. DRAWING # 2111 (SIMILAR - MULCH SHALL BE PER PLANTING NOTE #6).
- CONTRACTOR SHALL PROTECT EXISTING TREES AND SHRUBS DESIGNATED TO REMAIN FROM DAMAGE DUE TO CONSTRUCTION OPERATIONS. ANY PLANT DAMAGED SHALL BE REPLACED WITH PLANT OF SAME SPECIES AND SIZE. IF SIZE IS UNAVAILABLE, CONTRACTOR SHALL PROVIDE CREDIT TO OWNER FOR VALUE OF DIFFERENCE IN SIZE.
- GRAVEL MULCH SHALL BE A 3" DEPTH OF 1" PLUM ROSE CRUSHED GRANITE. MULCH SHALL BE PLACED OVER A CONTINUOUS LAYER OF WEED BARRIER FABRIC. WEED BARRIER FABRIC SHALL BE 3.5 OZ. WOVEN, NEEDLE PUNCHED POLYPROPYLENE (DEWITT OR EQUAL). OVERLAP ENDS 3" AND TURN DOWN PERIMETER EDGE 6". TOP OF MULCH SHALL BE 1" BELOW THE TOP OF ADJACENT CURBS AND WALK.
- TREES AND SHRUBS SHALL BE HAND WATERED BY THE CONTRACTOR UNTIL FINAL PROJECT ACCEPTANCE. CONTRACTOR'S WARRANTY OF THE TREES AND SHRUBS SHALL BE THROUGH FINAL PROJECT ACCEPTANCE ONLY.
- CONTRACTOR SHALL HAND DIG HOLES FOR TREES AND SHRUBS TO ENSURE THAT EXISTING UTILITIES ARE NOT DAMAGED DUE TO CONSTRUCTION OPERATIONS.

CONSTRUCTION KEYED NOTES

- CONTRACTOR SHALL INSTALL 18CF TO 24CF 'MOSS ROCK' LANDSCAPE BOULDER PER DETAIL A/ 12.
- CONTRACTOR SHALL INSTALL A CONCRETE EDGER PER DETAIL B/ 12.
- CONTRACTOR SHALL INSTALL 4" COBBLE OVER WEED BARRIER FABRIC. SEE PLANTING NOTE #6 FOR TYPE OF WEED BARRIER FABRIC.
- CONTRACTOR SHALL INSTALL 18" BERM AT 6:1 SLOPE AT BASE OF NEIGHBORHOOD SIGN. CONTRACTOR SHALL RAISE EXISTING SIGN ACCORDINGLY AND RE-INSTALL IN CONCRETE FOOTINGS.

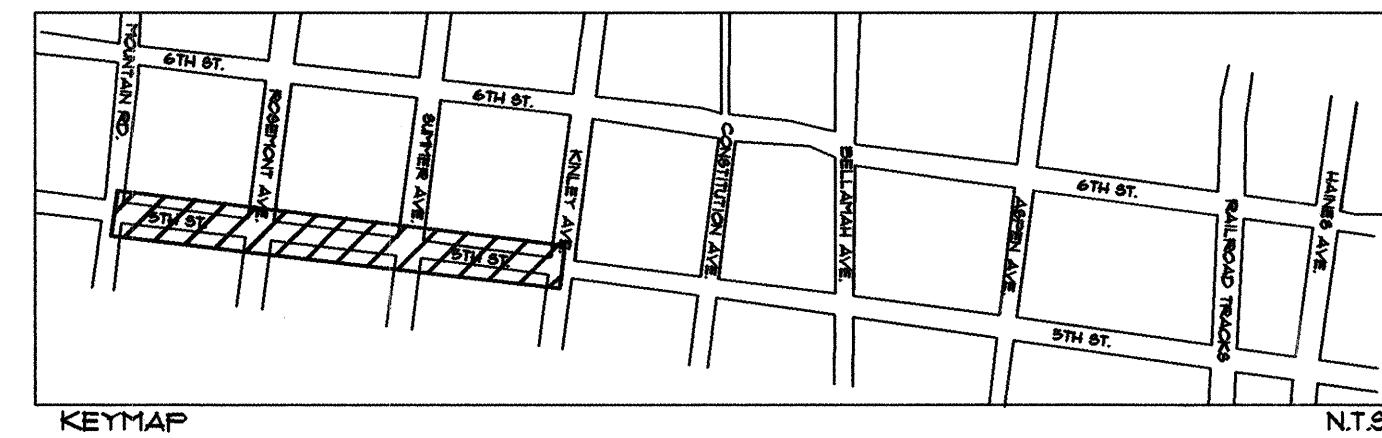

MORROW REARDON WILKINSON, LTD.
LANDSCAPE ARCHITECTS
210 La Veta NE, Albuquerque, NM 87106
505.268.2266 FAX 505.265.9637
mrw@mrwm.com

CITY OF ALBUQUERQUE DEPARTMENT OF MUNICIPAL DEVELOPMENT CAPITAL IMPLEMENTATION PROGRAM			
TITLE: 5th and 6th Streets Streetscape Landscape Improvements Planting Plan			
Design Review Committee	City Engineer Approval	Mo/Day/Yr.	Mo/Day/Yr.
APPROVED	APPROVED		
CITY PROJECT NO. 744391	ZONE MAP NO. H-14 & J-14	SHEET 8	OF 13

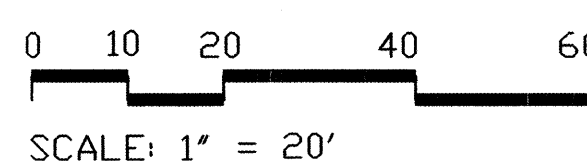

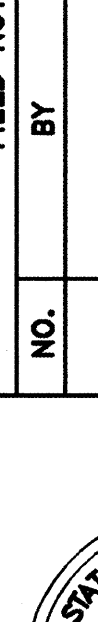
				ENGINEER'S SEAL		SURVEY INFORMATION		BENCH MARKS		AS BUILT INFORMATION	
						FIELD NOTES					
						BY		DATE			
						NO.					

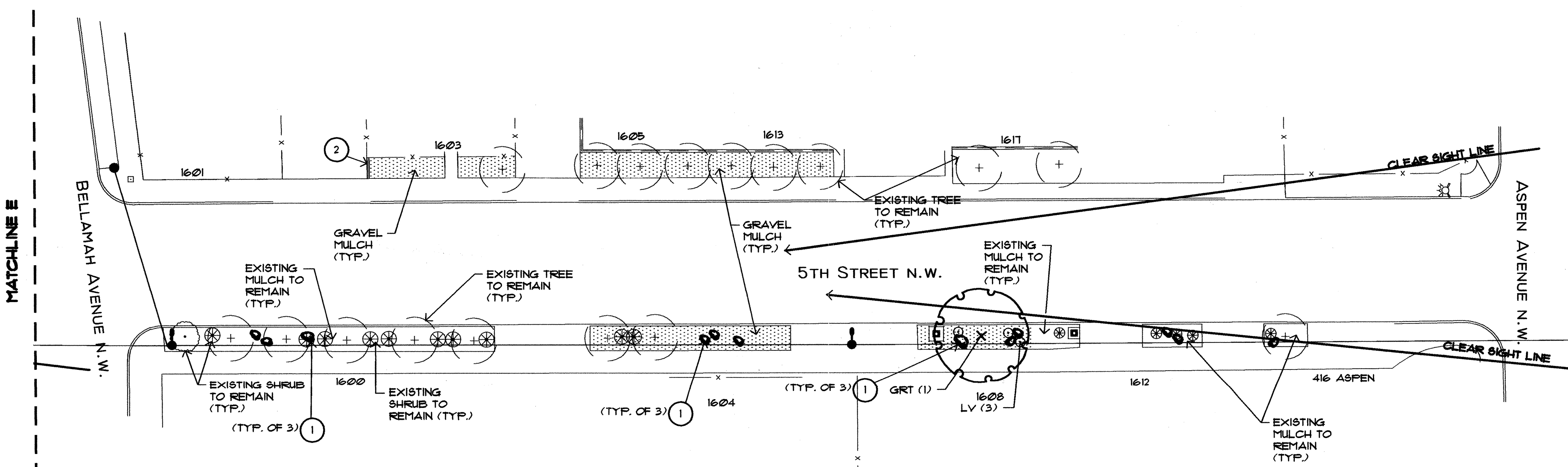
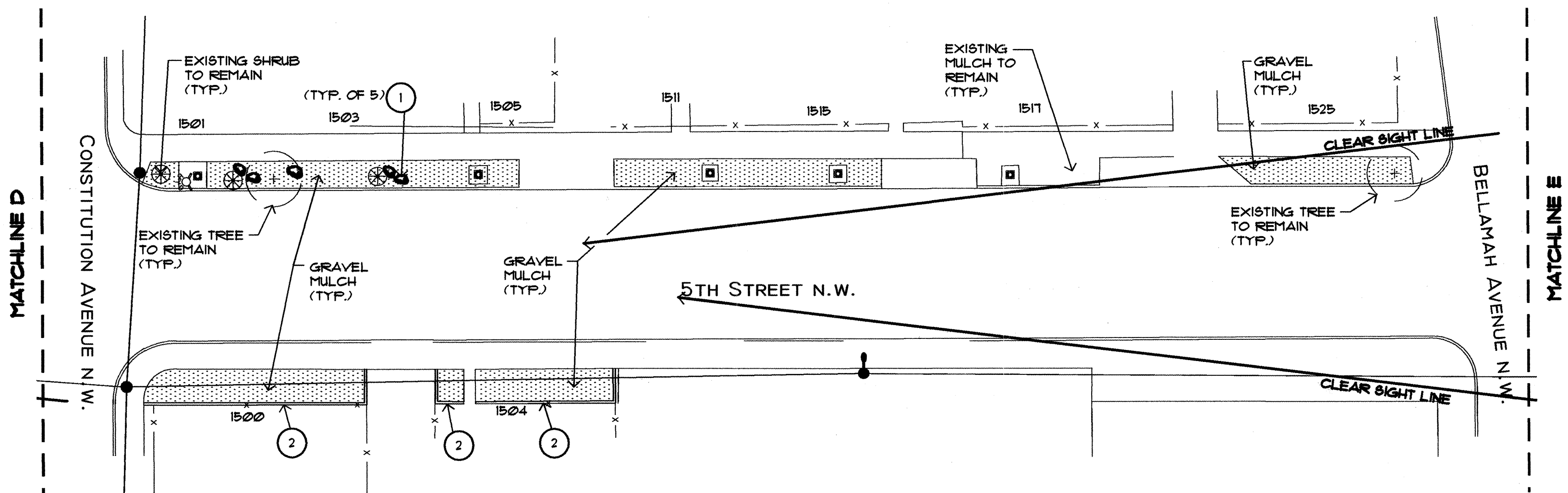
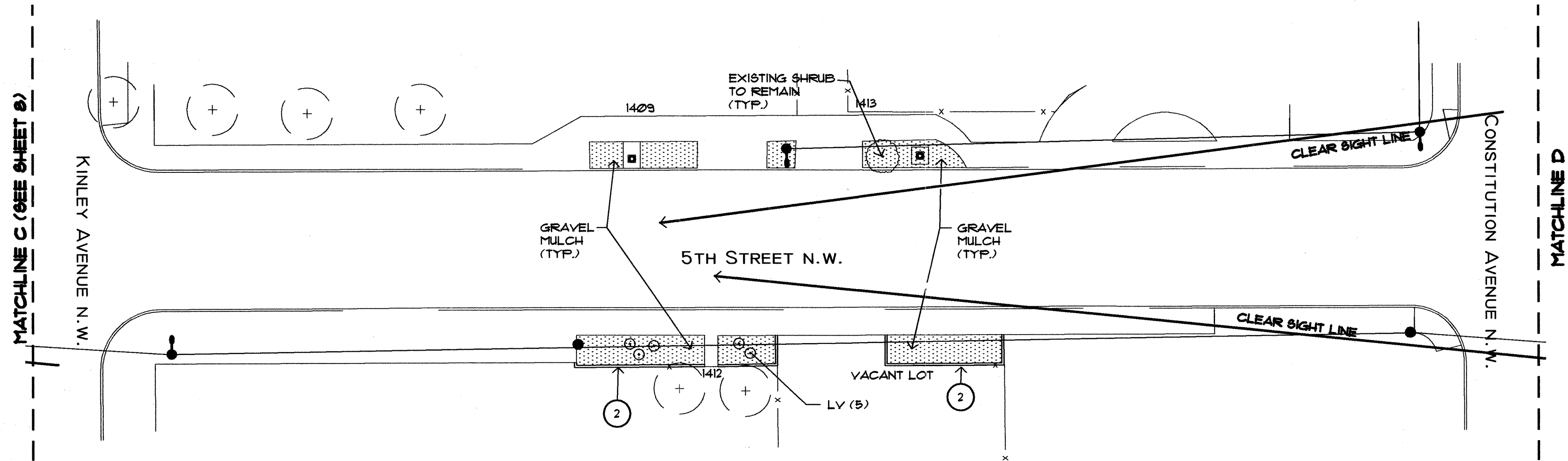

PLANT KEY (SEE SHEET 13 FOR PLANT SCHEDULE)		
KEY	COMMON NAME	BOTANICAL NAME
TREES		
BRAP	Bradford Pear	Fyrus calleryana 'Bradford'
CHIP	Chinese pistache	Pistacia chinensis
GRT	Goldenrain tree	Koeleruteria paniculata
SHRUBS		
LV	Lavender	Lavandula angustifolia 'Mitcham Gray'
RMT	Regal Mist	Muhlenbergia capillaris

- PLANTING NOTES**
- IN CASE OF DISCREPANCY IN PLANT QUANTITIES SHOWN ON THE PLANT LIST AND THOSE SHOWN ON THE PLANTING PLAN, THE QUANTITIES SHOWN ON THE PLAN SHALL GOVERN. CONTRACTOR SHALL VERIFY ALL QUANTITIES PRIOR TO BID AND INSTALLATION. NO ADDITIONAL PAYMENT WILL BE MADE FOR DISCREPANCIES IN QUANTITIES BETWEEN THE PLANTING PLAN AND THE PLANT LIST.
 - THE CONTRACTOR SHALL PRUNE LOWER BRANCHES OF DECIDUOUS TREES TO 6 FEET ABOVE FINISH GRADE.
 - TREES SHALL BE PLANTED PER C.O.A. DRAWING # 2114 (SIMILAR - MULCH SHALL BE PER PLANTING NOTE #6).
 - SHRUBS SHALL BE PLANTED PER C.O.A. DRAWING # 2111 (SIMILAR - MULCH SHALL BE PER PLANTING NOTE #6).
 - CONTRACTOR SHALL PROTECT EXISTING TREES AND SHRUBS DESIGNATED TO REMAIN FROM DAMAGE DUE TO CONSTRUCTION OPERATIONS. ANY PLANT DAMAGED SHALL BE REPLACED WITH PLANT OF SAME SPECIES AND SIZE. IF SIZE IS UNAVAILABLE, CONTRACTOR SHALL PROVIDE CREDIT TO OWNER FOR VALUE OF DIFFERENCE IN SIZE.
 - GRAVEL MULCH SHALL BE A 3" DEPTH OF 1" PLUM ROSE CRUSHED GRANITE. MULCH SHALL BE PLACED OVER A CONTINUOUS LAYER OF WEED BARRIER FABRIC. WEED BARRIER FABRIC SHALL BE 3.5 OZ. WOVEN, NEEDLE PUNCHED POLYPROPYLENE (DEWITT OR EQUAL). OVERLAP ENDS 3" AND TURN DOWN PERMETER EDGE 6". TOP OF MULCH SHALL BE 1" BELOW THE TOP OF ADJACENT CURBS AND WALK.
 - TREES AND SHRUBS SHALL BE HAND WATERED BY THE CONTRACTOR UNTIL FINAL PROJECT ACCEPTANCE. CONTRACTOR'S WARRANTY OF THE TREES AND SHRUBS SHALL BE THROUGH FINAL PROJECT ACCEPTANCE ONLY.
 - CONTRACTOR SHALL HAND DIG HOLES FOR TREES AND SHRUBS TO ENSURE THAT EXISTING UTILITIES ARE NOT DAMAGED DUE TO CONSTRUCTION OPERATIONS.

- CONSTRUCTION KEYED NOTES**
- CONTRACTOR SHALL INSTALL 18CF TO 24CF MOSS ROCK LANDSCAPE BOULDER PER DETAIL A/ 12.
 - CONTRACTOR SHALL INSTALL A CONCRETE EDGER PER DETAIL B/ 12.
 - CONTRACTOR SHALL INSTALL 4" COBBLE OVER WEED BARRIER FABRIC. SEE PLANTING NOTE #6 FOR TYPE OF WEED BARRIER FABRIC.
 - CONTRACTOR SHALL INSTALL 18" BERM AT 6:1 SLOPE AT BASE OF NEIGHBORHOOD SIGN. CONTRACTOR SHALL RAISE EXISTING SIGN ACCORDINGLY AND RE-INSTALL IN CONCRETE FOOTINGS.

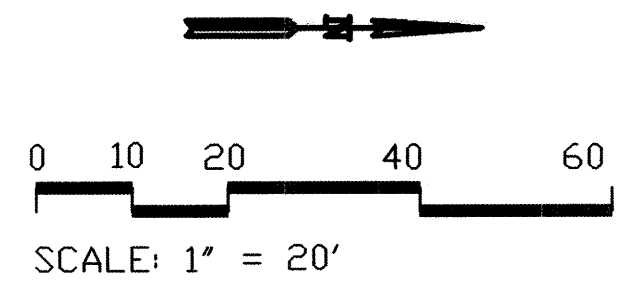
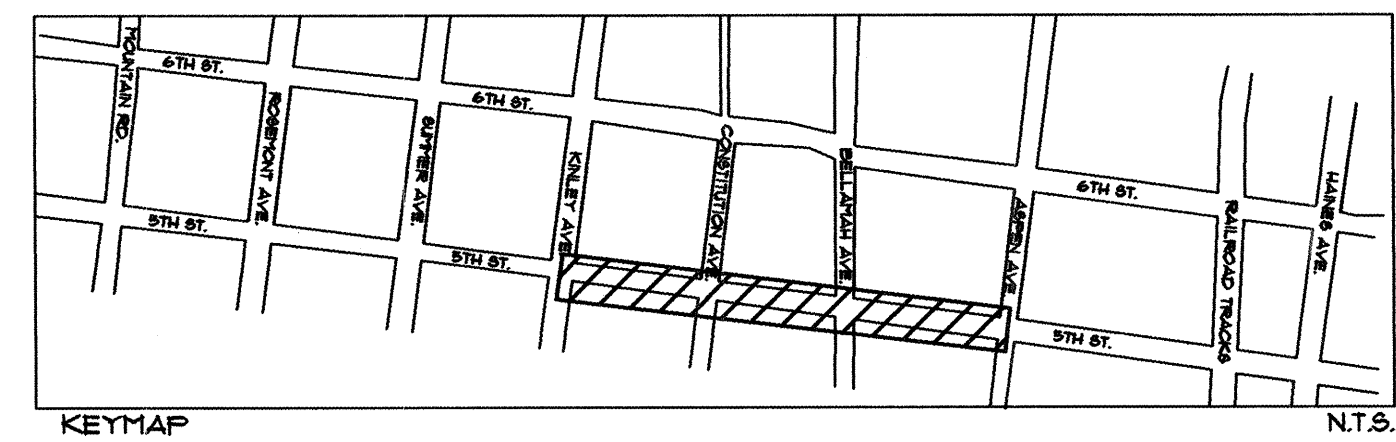

CITY OF ALBUQUERQUE DEPARTMENT OF MUNICIPAL DEVELOPMENT CAPITAL IMPLEMENTATION PROGRAM			
TITLE: 5th AND 6th STREETS STREETSCAPE LANDSCAPE IMPROVEMENTS PLANTING PLAN			
Design Review Committee	City Engineer Approval	Mo/Day/Yr. Mo/Day/Yr.	
APPROVED	APPROVED		
DESIGN REVIEW COMMITTEE	CITY ENGINEER		
CITY PROJECT NO. 744391	ZONE MAP NO. H-14 & J-14	SHEET 9	OF 13

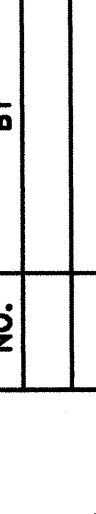
ENGINEER'S SEAL		SURVEY INFORMATION		BENCH MARKS		AS BUILT INFORMATION			
		FIELD NOTES							
		NO.	BY	DATE					
		REVISIONS							
		NO.	DATE						
		DESIGN							
DESIGNED BY JSP		DATE: 8/26/04							
DRAWN BY JSP		DATE: 8/26/04							
CHECKED BY ECR		DATE: 8/26/04							
						</			

BEGINNING OF 6th STREET PROJECT

MATCHLINE H

MATCHLINE I

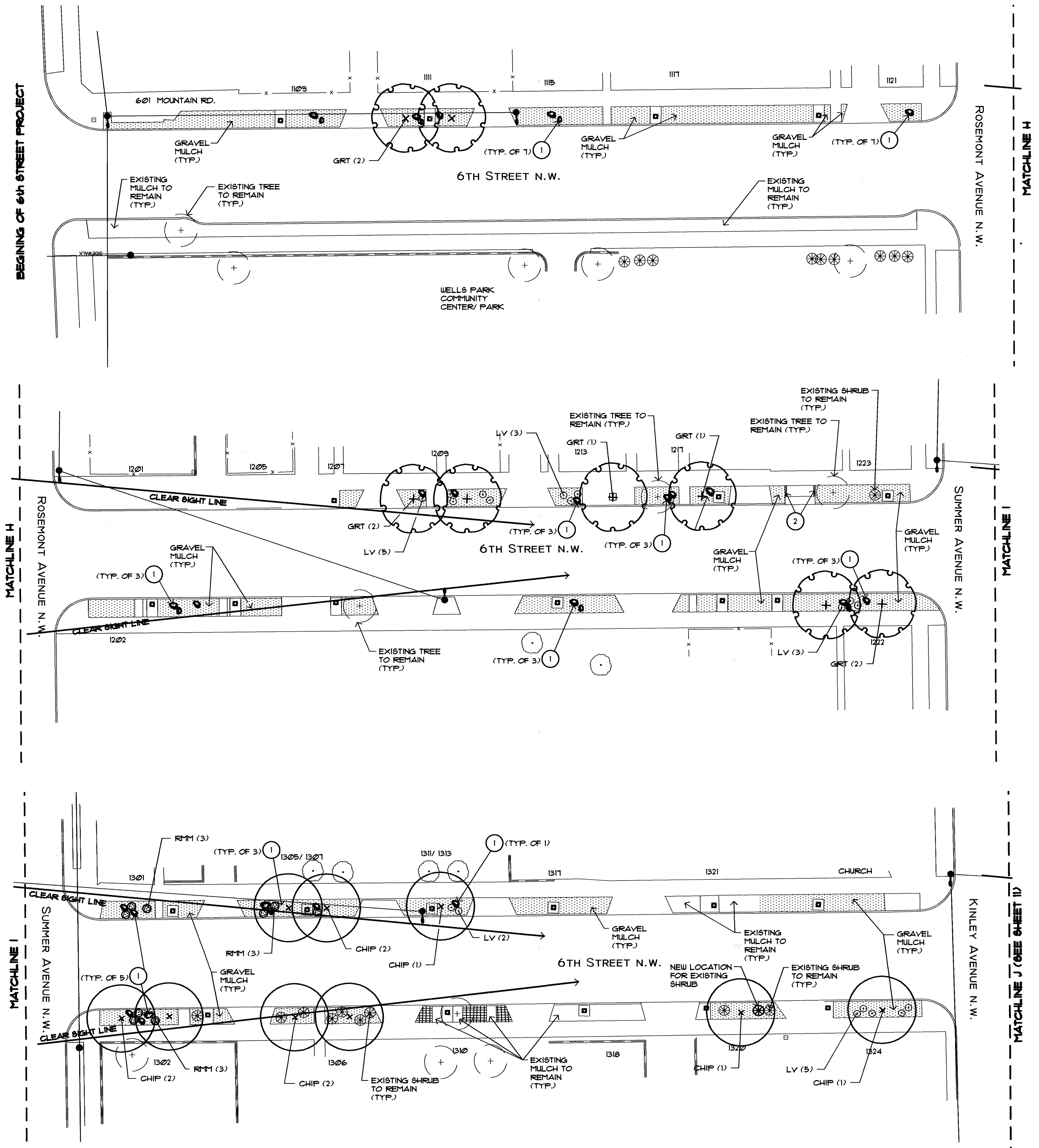

PLANT KEY (SEE SHEET 13 FOR PLANT SCHEDULE)		
KEY	COMMON NAME	BOTANICAL NAME
TREES		
BRAP	Bradford Pear	Pyrus calleryana 'Bradford'
CHIP	Chinese pistache	Pistacia chinensis
GRT	Goldrain tree	Koeleruteria paniculata
SHRUBS		
LV	Lavender	Lavandula angustifolia 'Mitcham Gray'
RMM	Regal Mist	Muhlenbergia capillaris

- PLANTING NOTES**
- IN CASE OF DISCREPANCY IN PLANT QUANTITIES SHOWN ON THE PLANT LIST AND THOSE SHOWN ON THE PLANTING PLAN, THE QUANTITIES SHOWN ON THE PLAN SHALL GOVERN. CONTRACTOR SHALL VERIFY ALL QUANTITIES PRIOR TO BID AND INSTALLATION. NO ADDITIONAL PAYMENT WILL BE MADE FOR DISCREPANCIES IN QUANTITIES BETWEEN THE PLANTING PLAN AND THE PLANT LIST.
 - THE CONTRACTOR SHALL PRUNE LOWER BRANCHES OF DECIDUOUS TREES TO 6 FEET ABOVE FINISH GRADE.
 - TREES SHALL BE PLANTED PER C.O.A. DRAWING # 2714 (SIMILAR - MULCH SHALL BE PER PLANTING NOTE #6).
 - SHRUBS SHALL BE PLANTED PER C.O.A. DRAWING # 2711 (SIMILAR - MULCH SHALL BE PER PLANTING NOTE #6).
 - CONTRACTOR SHALL PROTECT EXISTING TREES AND SHRUBS DESIGNATED TO REMAIN FROM DAMAGE DUE TO CONSTRUCTION OPERATIONS. ANY PLANT DAMAGED SHALL BE REPLACED WITH PLANT OF SAME SPECIES AND SIZE. IF SIZE IS UNAVAILABLE, CONTRACTOR SHALL PROVIDE CREDIT TO OWNER FOR VALUE OF DIFFERENCE IN SIZE.
 - GRAVEL MULCH SHALL BE A 3" DEPTH OF 1" PLUM ROSE CRUSHED GRANITE. MULCH SHALL BE PLACED OVER A CONTINUOUS LAYER OF WEED BARRIER FABRIC. WEED BARRIER FABRIC SHALL BE 35 OZ. WOVEN, NEEDLE PUNCHED POLYPROPYLENE (DEWITT OR EQUAL). OVERLAP ENDS 3" AND TURN DOWN FERMETER EDGE 6". TOP OF MULCH SHALL BE 1" BELOW THE TOP OF ADJACENT CURBS AND WALK.
 - TREES AND SHRUBS SHALL BE HAND WATERED BY THE CONTRACTOR UNTIL FINAL PROJECT ACCEPTANCE. CONTRACTOR'S WARRANTY OF THE TREES AND SHRUBS SHALL BE THROUGH FINAL PROJECT ACCEPTANCE ONLY.
 - CONTRACTOR SHALL HAND DIG HOLES FOR TREES AND SHRUBS TO ENSURE THAT EXISTING UTILITIES ARE NOT DAMAGED DUE TO CONSTRUCTION OPERATIONS.

- CONSTRUCTION KEYED NOTES**
- CONTRACTOR SHALL INSTALL 18CF TO 24CF 106SS ROCK LANDSCAPE BOULDER PER DETAIL A/ 12.
 - CONTRACTOR SHALL INSTALL A CONCRETE EDGER PER DETAIL B/ 12.
 - CONTRACTOR SHALL INSTALL 4" COBBLE OVER WEED BARRIER FABRIC. SEE PLANTING NOTE #6 FOR TYPE OF WEED BARRIER FABRIC.
 - CONTRACTOR SHALL INSTALL 18" BERM AT 6:1 SLOPE AT BASE OF NEIGHBORHOOD SIGN. CONTRACTOR SHALL RAISE EXISTING SIGN ACCORDINGLY AND RE-INSTALL IN CONCRETE FOOTINGS.

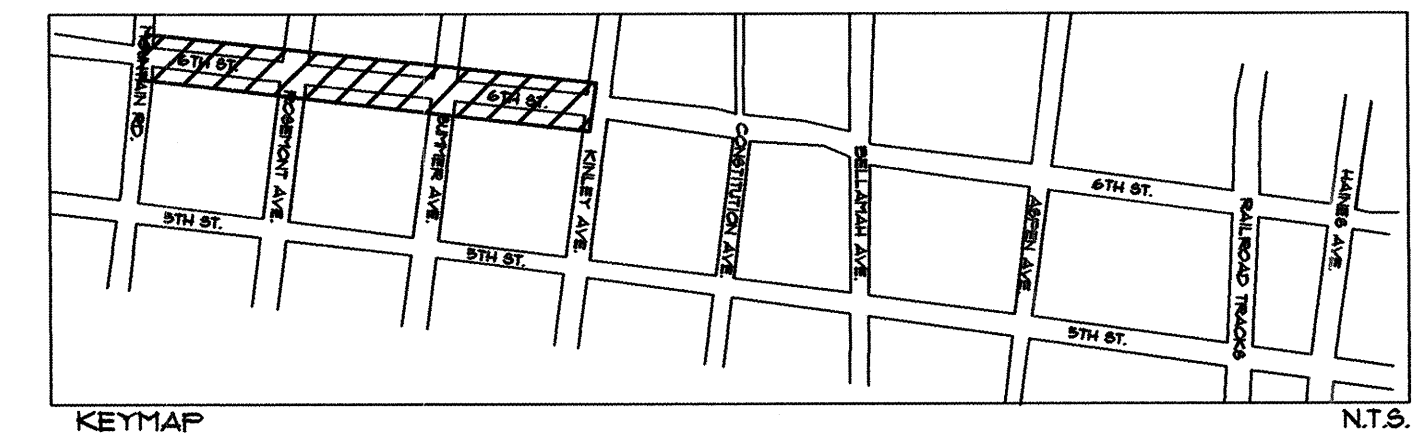

MORROW REARDON WILKINSON, LTD.
LANDSCAPE ARCHITECTS
210 La Veta NE, Albuquerque, NM 87108
505.268.2286 FAX 505.265.9637
mrw@mrwm.com

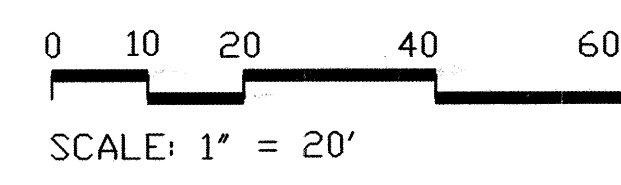

CITY OF ALBUQUERQUE DEPARTMENT OF MUNICIPAL DEVELOPMENT CAPITAL IMPLEMENTATION PROGRAM			
TITLE: 5th and 6th Streets Streetscape Landscape Improvements Planting Plan			
Design Review Committee	City Engineer Approval	Mo/Day/Yr.	Mo/Day/Yr.
APPROVED SEP - 9 2004 DESIGN REVIEW COMMITTEE	APPROVED SEP - 9 2004 CITY ENGINEER		
CITY PROJECT NO.	ZONE MAP NO.	SHEET	OF
744391	H-14 & J-14	10	13

LANDSCAPE ARCHITECTS										DESIGN DEVELOPMENT PROGRAM										AS BUILT INFORMATION									
ENGINEER'S SEAL										SURVEY INFORMATION										BENCH MARKS									
										FIELD NOTES																			
NO.		DATE		REMARKS		BY		NO.		BY		DATE		CONTRACTOR															
														DATE															
														REVISIONS															
														DATE															
														DESIGNED BY															
																DATE: 8/26/04													
																DRAWN BY													
																DATE: 8/26/04													
																CHECKED BY													
																DATE: 8/26/04													
																MICRO-FILM INFORMATION													
																RECORDED BY													
																DATE													
																NO.													

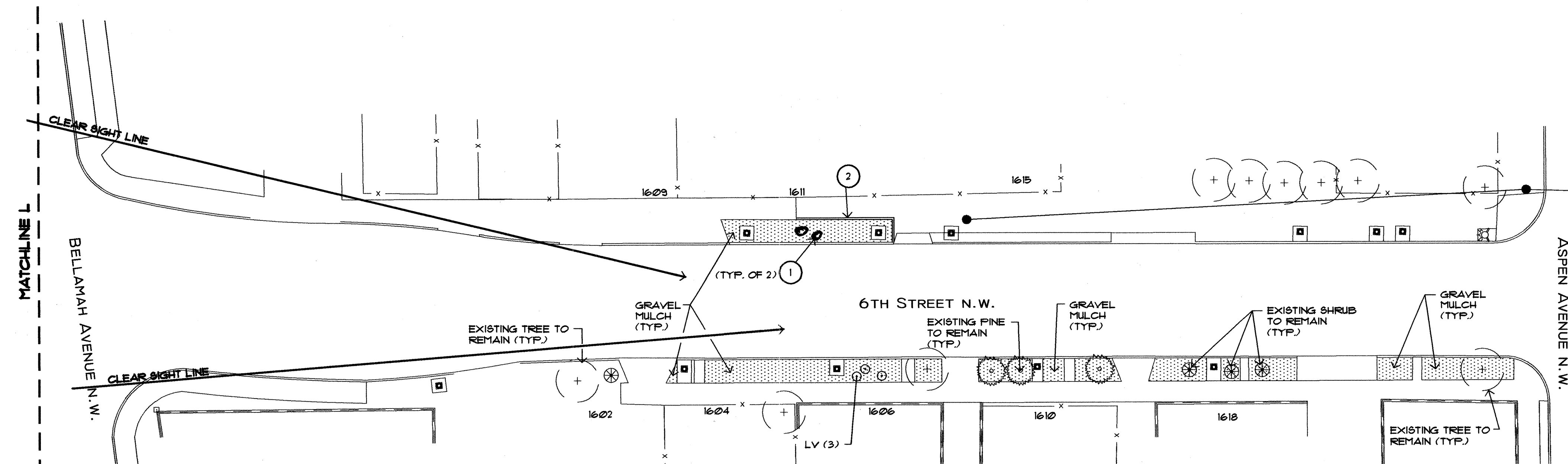
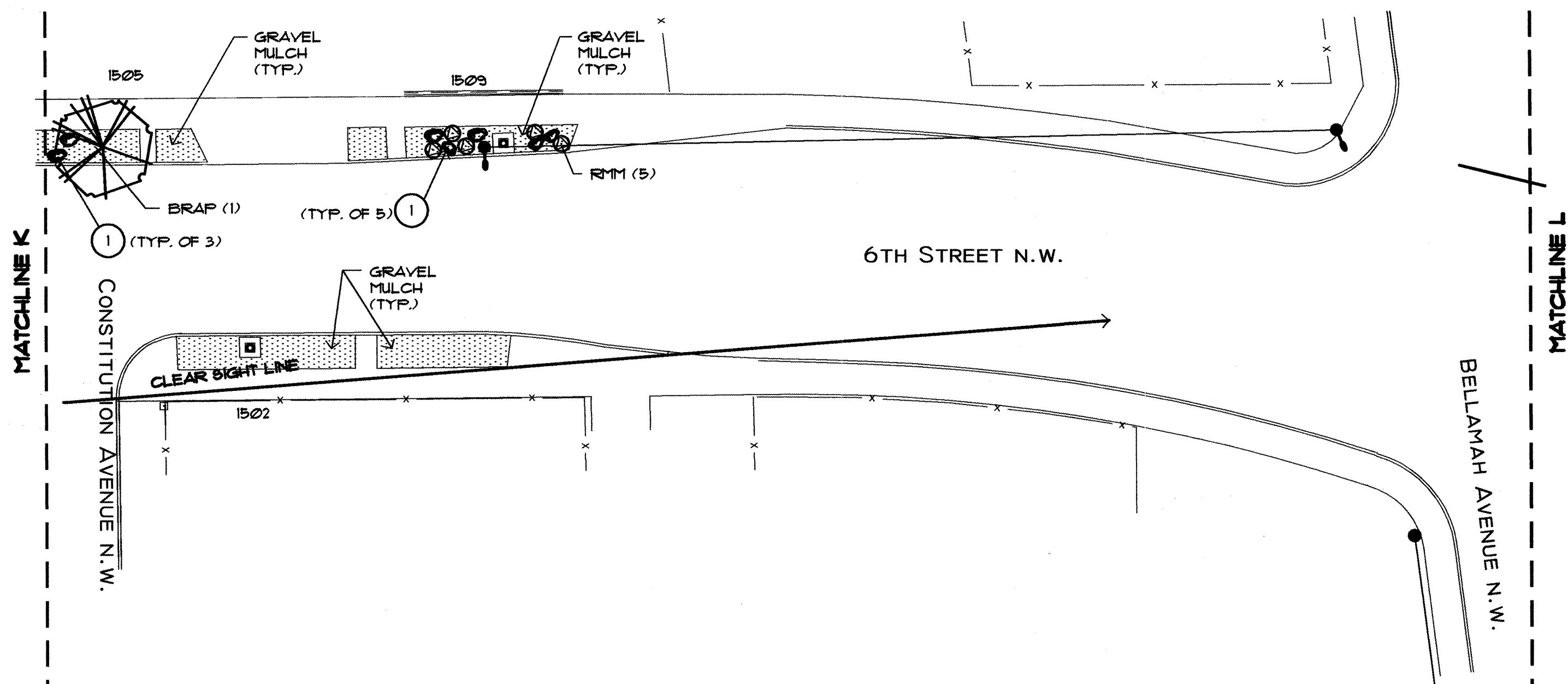
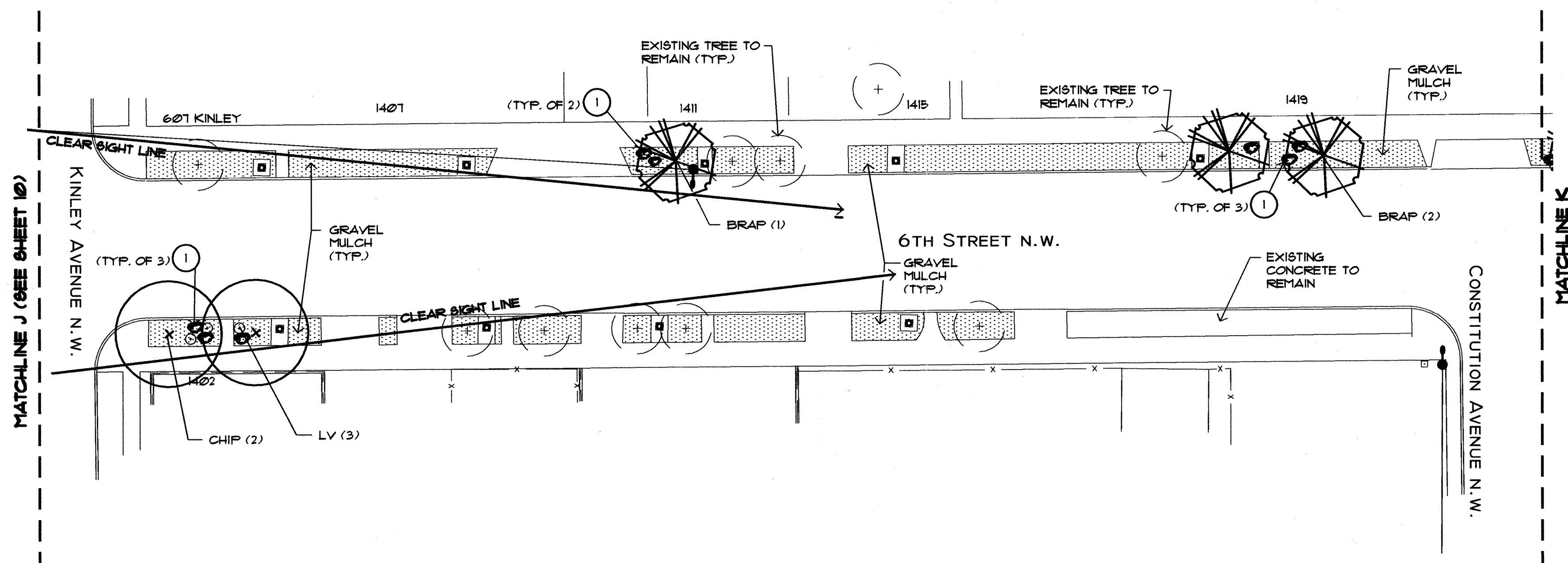

PLANT KEY (SEE SHEET 13 FOR PLANT SCHEDULE)

KEY	COMMON NAME	BOTANICAL NAME
TREES		
BRAP	Bradford Pear	<i>Pyrus calleryana</i> 'Bradford'
CHIP	Chinese pistache	<i>Pistacia chinensis</i>
GRT	Goldenrain tree	<i>Koeleruteria paniculata</i>
SHRUBS		
LV	Lavender	<i>Lavandula angustifolia</i> 'Mitcham Gray'
RMT	Regal Mist	<i>Muhlenbergia capillaris</i>

PLANTING NOTES

- IN CASE OF DISCREPANCY IN PLANT QUANTITIES SHOWN ON THE PLANT LIST AND THOSE SHOWN ON THE PLANTING PLAN, THE QUANTITIES SHOWN ON THE PLAN SHALL GOVERN. CONTRACTOR SHALL VERIFY ALL QUANTITIES PRIOR TO BID AND INSTALLATION. NO ADDITIONAL PAYMENT WILL BE MADE FOR DISCREPANCIES IN QUANTITIES BETWEEN THE PLANTING PLAN AND THE PLANT LIST.
- THE CONTRACTOR SHALL PRUNE LOWER BRANCHES OF DECIDUOUS TREES TO 6 FEET ABOVE FINISH GRADE.
- TREES SHALL BE PLANTED PER C.O.A. DRAWING # 2114 (SIMILAR - MULCH SHALL BE PER PLANTING NOTE #6).
- SHRUBS SHALL BE PLANTED PER C.O.A. DRAWING # 2111 (SIMILAR - MULCH SHALL BE PER PLANTING NOTE #6).
- CONTRACTOR SHALL PROTECT EXISTING TREES AND SHRUBS DESIGNATED TO REMAIN FROM DAMAGE DUE TO CONSTRUCTION OPERATIONS. ANY PLANT DAMAGED SHALL BE REPLACED WITH PLANT OF SAME SPECIES AND SIZE. IF SIZE IS UNAVAILABLE, CONTRACTOR SHALL PROVIDE CREDIT TO OWNER FOR VALUE OF DIFFERENCE IN SIZE.
- GRAVEL MULCH SHALL BE A 3" DEPTH OF 1" PLUM ROSE CRUSHED GRANITE. MULCH SHALL BE PLACED OVER A CONTINUOUS LAYER OF WEED BARRIER FABRIC. WEED BARRIER FABRIC SHALL BE 35 OZ. WOVEN, NEEDLE PUNCHED POLYPROPYLENE (DEWITT OR EQUAL). OVERLAP ENDS 3" AND TURN DOWN PERIMETER EDGE 6". TOP OF MULCH SHALL BE 1" BELOW THE TOP OF ADJACENT CURBS AND WALK.
- TREES AND SHRUBS SHALL BE HAND WATERED BY THE CONTRACTOR UNTIL FINAL PROJECT ACCEPTANCE. CONTRACTOR'S WARRANTY OF THE TREES AND SHRUBS SHALL BE THROUGH FINAL PROJECT ACCEPTANCE ONLY.
- CONTRACTOR SHALL HAND DIG HOLES FOR TREES AND SHRUBS TO ENSURE THAT EXISTING UTILITIES ARE NOT DAMAGED DUE TO CONSTRUCTION OPERATIONS.

CONSTRUCTION KEYED NOTES

- CONTRACTOR SHALL INSTALL 18CF TO 24CF MOSS ROCK LANDSCAPE BOULDER PER DETAIL A/ 12.
- CONTRACTOR SHALL INSTALL A CONCRETE EDGER PER DETAIL B/ 12.
- CONTRACTOR SHALL INSTALL 4" COBBLE OVER WEED BARRIER FABRIC. SEE PLANTING NOTE #6 FOR TYPE OF WEED BARRIER FABRIC.
- CONTRACTOR SHALL INSTALL 18" BERM AT 6:1 SLOPE AT BASE OF NEIGHBORHOOD SIGN. CONTRACTOR SHALL RAISE EXISTING SIGN ACCORDINGLY AND RE-INSTALL IN CONCRETE FOOTINGS.

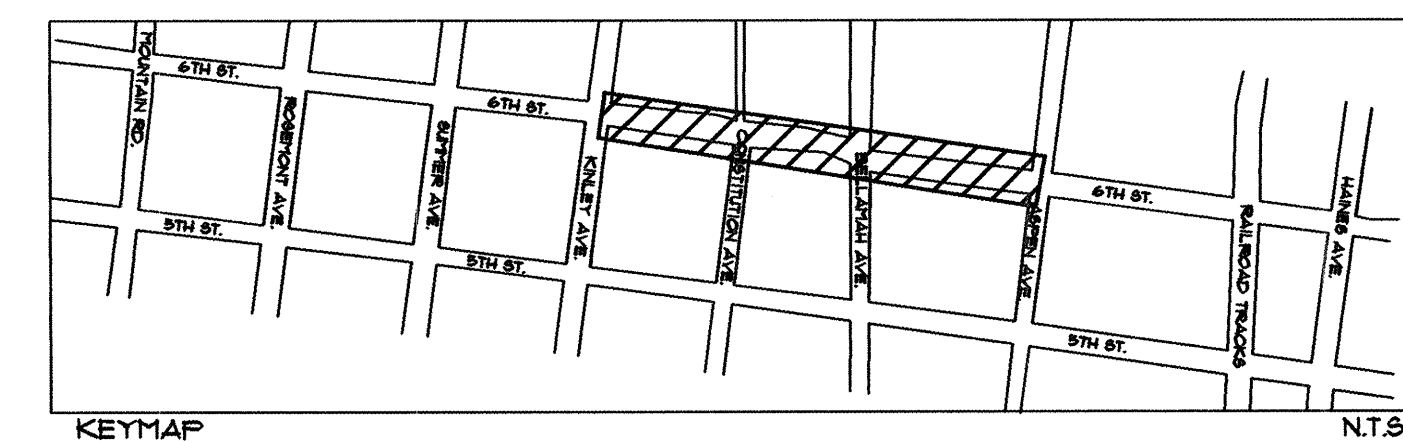

mrw@mrwnm.com

CITY OF ALBUQUERQUE
DEPARTMENT OF MUNICIPAL DEVELOPMENT
CAPITAL IMPLEMENTATION PROGRAM

TITLE: 5th AND 6th STREETS STREETSCAPE LANDSCAPE IMPROVEMENTS PLANTING PLAN		Mo/Day/Yr.	
Design-Review-Committee	City Engineer Approval	Mo/Day/Yr.	Mo/Day/Yr.
APPROVED	APPROVED		
DESIGN REVIEW COMMITTEE	CITY ENGINEER		
CITY PROJECT NO. 744391	ZONE MAP NO. H-14 & J-14	SHEET 11	OF 13

AS BUILT INFORMATION		BENCH MARKS		SURVEY INFORMATION		ENGINEER'S SEAL	
CONTRACTOR	DATE	NO.	DATE	NO.	DATE	NO.	DATE
DESIGNED BY	DATE	NO.	DATE	NO.	DATE	NO.	DATE
REVIEWED BY	DATE	NO.	DATE	NO.	DATE	NO.	DATE
VERIFIED BY	DATE	NO.	DATE	NO.	DATE	NO.	DATE
OWNERS	DATE	NO.	DATE	NO.	DATE	NO.	DATE
RECORDED BY	DATE	NO.	DATE	NO.	DATE	NO.	DATE



REVISIONS	DATE	BY
DESIGN	8/26/04	JSP
DRAWN BY	8/26/04	JSP
CHECKED BY	8/26/04	ECR

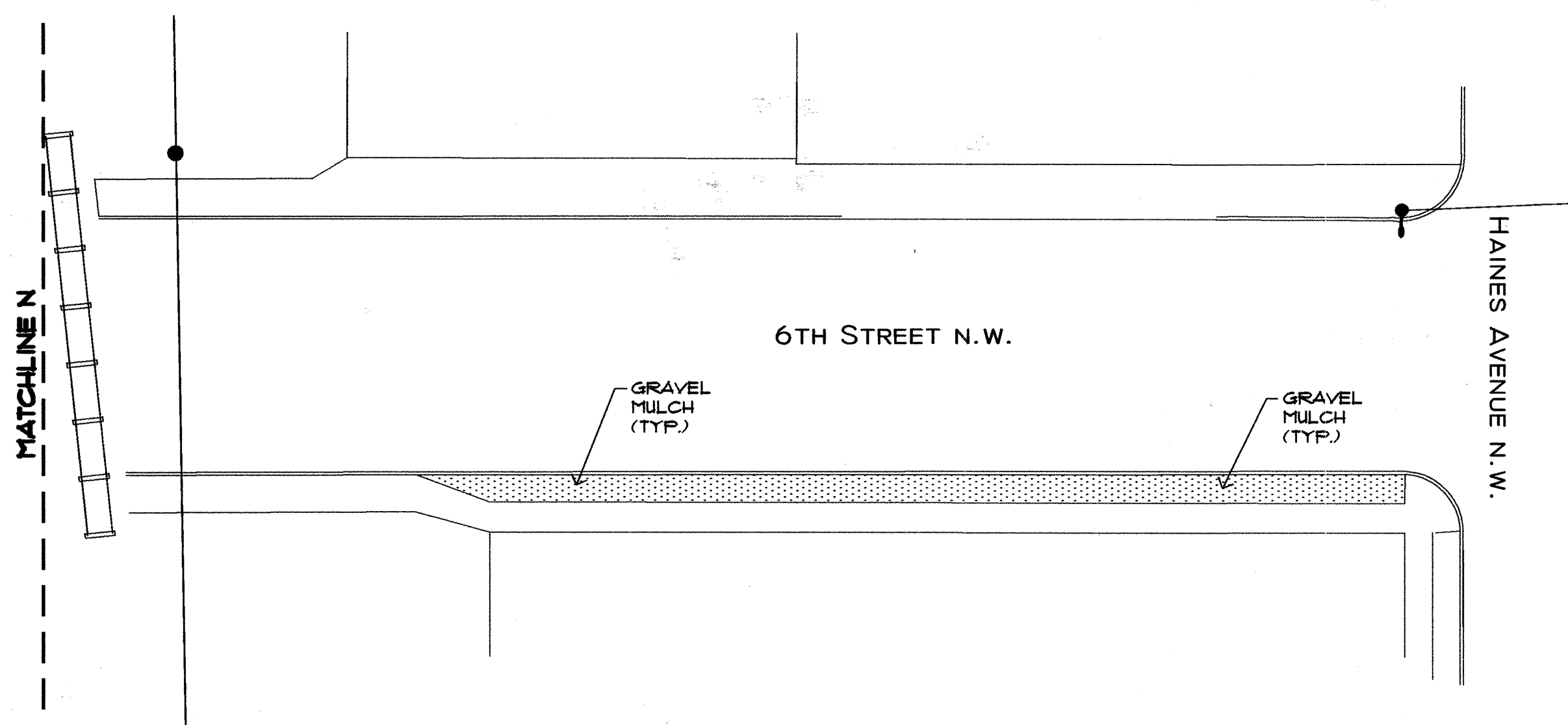

1. IN CASE OF DISCREPANCY IN PLANT QUANTITIES SHOWN ON THE PLANT LIST AND THOSE SHOWN ON THE PLANTING PLAN, THE QUANTITIES SHOWN ON THE PLANT SHALL GOVERN. CONTRACTOR SHALL VERIFY ALL QUANTITIES PRIOR TO BID AND INSTALLATION. NO ADDITIONAL PAYMENT WILL BE MADE FOR DISCREPANCIES IN QUANTITIES BETWEEN THE PLANTING PLAN AND THE PLANT LIST.
2. THE CONTRACTOR SHALL PRUNE LOWER BRANCHES OF DECIDUOUS TREES TO 6 FEET ABOVE FINISH GRADE.
3. TREES SHALL BE PLANTED PER C.O.A. DRAWING # 2714 (SIMILAR - MULCH SHALL BE PER PLANTING NOTE %).
4. SHRUBS SHALL BE PLANTED PER C.O.A. DRAWING # 2717 (SIMILAR - MULCH SHALL BE PER PLANTING NOTE %).
5. CONTRACTOR SHALL PROTECT EXISTING TREES AND SHRUBS DESIGNATED TO REMAIN FROM DAMAGE DUE TO CONSTRUCTION OPERATIONS. ANY PLANT DAMAGED SHALL BE REPLACED WITH THE SPECIES AND SIZE. IF SIZE IS UNAVAILABLE, CONTRACTOR SHALL PROVIDE CREDIT TO OWNER FOR VALUE OF DIFFERENCE IN SIZE.
6. GRAVEL MULCH SHALL BE A 3" DEPTH OF 1" PLUM ROSE CRUSHED GRANITE. MULCH SHALL BE PLACED OVER A CONTINUOUS LAYER OF WEED BARRIER FABRIC. WEED BARRIER FABRIC SHALL BE 3.5 OZ. WOVEN, NEEDLE PUNCHED POLYPROPYLENE (DEWITT OR EQUAL). OVERLAP ENDS 3" AND TURN DOWN PERIMETER EDGE 6". TOP OF MULCH SHALL BE 1" BELOW THE TOP OF ADJACENT CURBS AND WALK.
7. TREES AND SHRUBS SHALL BE HAND WATERED BY THE CONTRACTOR UNTIL FINAL PROJECT ACCEPTANCE. CONTRACTOR'S WARRANTY OF THE TREES AND SHRUBS SHALL BE THROUGH FINAL PROJECT ACCEPTANCE ONLY.
8. CONTRACTOR SHALL HAND DIG HOLES FOR TREES AND SHRUBS TO ENSURE THAT EXISTING UTILITIES ARE NOT DAMAGED DUE TO CONSTRUCTION OPERATIONS.

KEY	COMMON NAME	BOTANICAL NAME
<u>TREES</u>		
BRAP	Bradford Pear	<i>Eryus calleryana</i> 'Bradford'
CHIP	Chinese pistache	<i>Pistacia chinensis</i>
GRT	Goldenrain tree	<i>Koelreuteria paniculata</i>
<u>SHRUBS</u>		
LV	Lavender	<i>Lavandula angustifolia</i> 'Mitcham Gray'
RM	Regal Mist	<i>Muhlenbergia capillaris</i>

- 1 CONTRACTOR SHALL INSTALL 18CF TO 24CF MOSS ROCK' LANDSCAPE BOULDER PER DETAIL A/ 12.
- 2 CONTRACTOR SHALL INSTALL A CONCRETE EDGER PER DETAIL B/ 12.
- 3 CONTRACTOR SHALL INSTALL 4" COBBLE OVER WEED BARRIER FABRIC. SEE PLANTING NOTE #6 FOR TYPE OF WEED BARRIER FABRIC.
- 4 CONTRACTOR SHALL INSTALL 18" BERM AT 6:1 SLOPE AT BASE OF NEIGHBORHOOD SIGN. CONTRACTOR SHALL RAISE EXISTING SIGN ACCORDINGLY AND RE-INSTALL IN CONCRETE FOOTINGS.

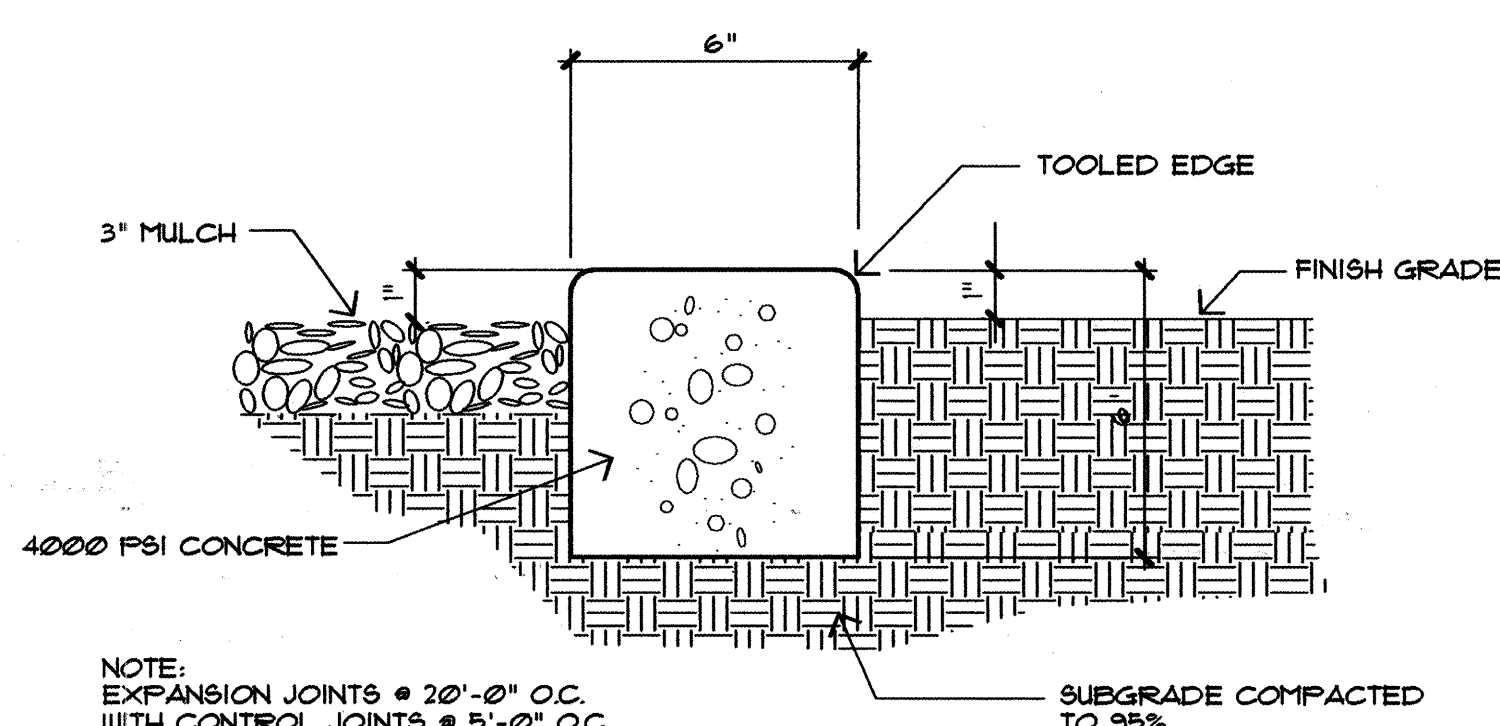
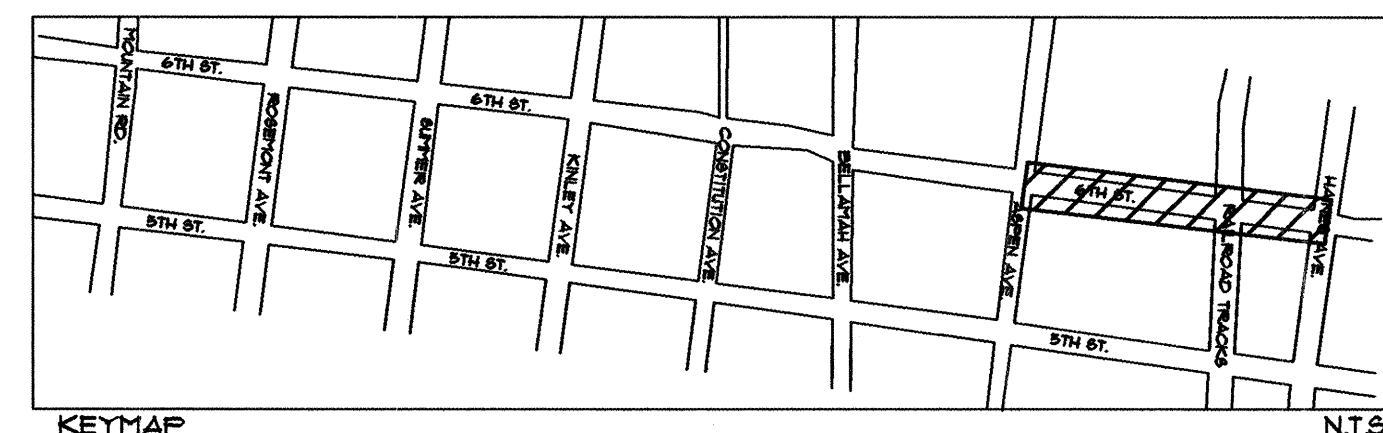

A BOULDER INSTALLATION
12 BOULDER-INSTALLATION.DWG 060203 3/4" = 1'

B CONCRETE EGDER
12 MCD-0024 110895 3" = 1'-0"

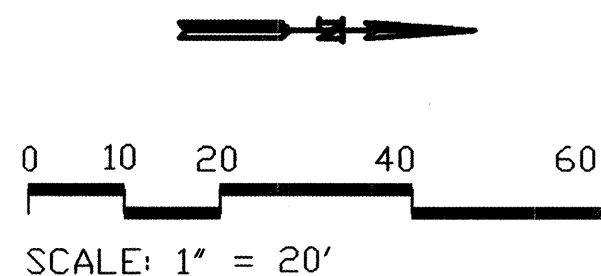
[illegible]

CITY OF ALBUQUERQUE DEPARTMENT OF MUNICIPAL DEVELOPMENT CAPITAL IMPLEMENTATION PROGRAM					
TITLE: 5th AND 6th STREETS STREETSCAPE LANDSCAPE IMPROVEMENTS PLANTING PLAN					
Design Review Committee 		City Engineer Approval 		Last Design Update	Mo/Day/Yr.
CITY PROJECT NO. 744391	ZONE MAP NO. H-14 & J-14	SHEET	OF	12	13

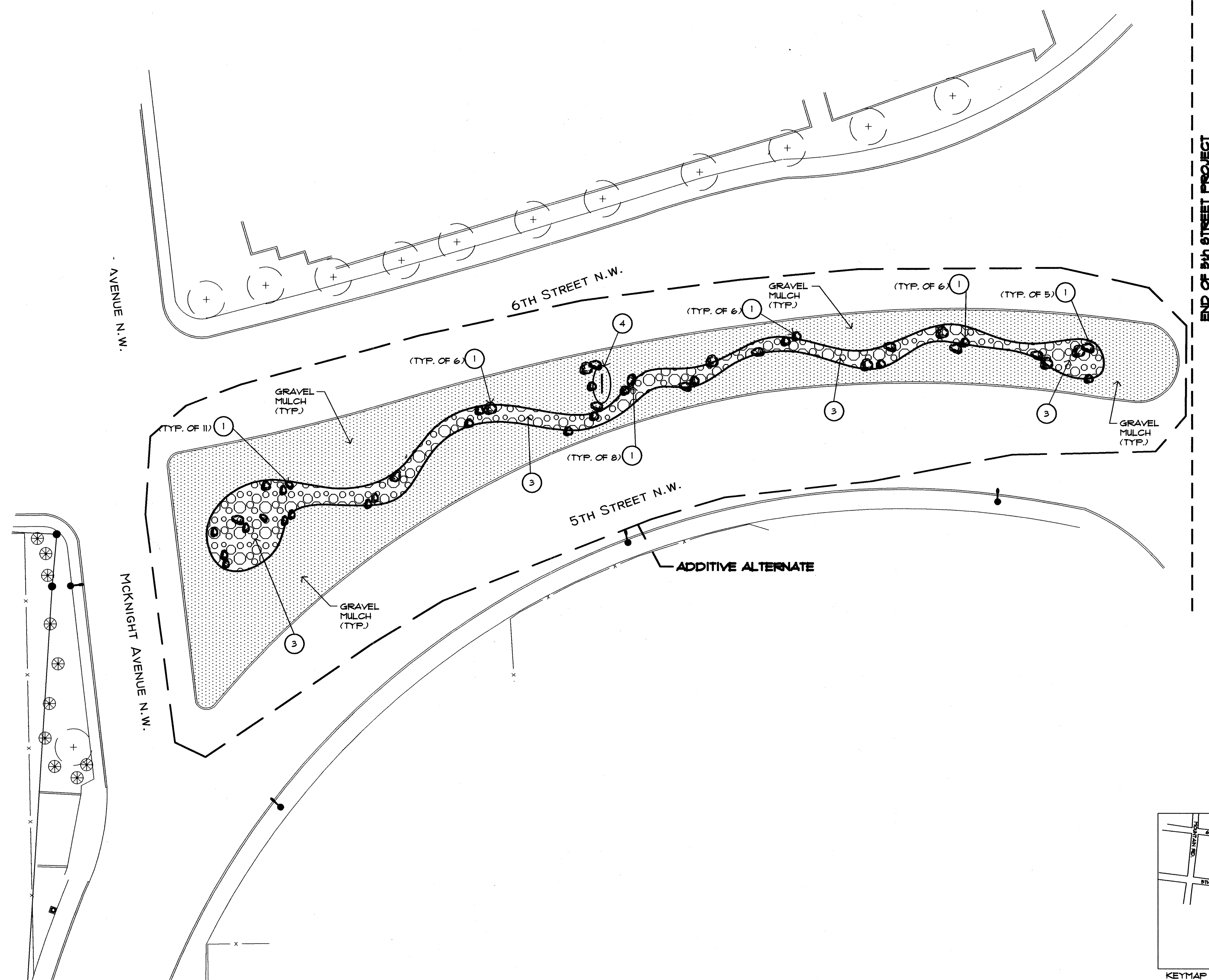

PLANTING NOTES

- IN CASE OF DISCREPANCY IN PLANT QUANTITIES SHOWN ON THE PLANT LIST AND THOSE SHOWN ON THE PLANTING PLAN, THE QUANTITIES SHOWN ON THE PLANT LIST SHALL GOVERN. CONTRACTOR SHALL VERIFY ALL QUANTITIES PRIOR TO BID AND INSTALLATION. NO ADDITIONAL PAYMENT WILL BE MADE FOR DISCREPANCIES IN QUANTITIES BETWEEN THE PLANTING PLAN AND THE PLANT LIST.
- THE CONTRACTOR SHALL PRUNE LOWER BRANCHES OF DECIDUOUS TREES TO 6 FEET ABOVE FINISH GRADE.
- TREES SHALL BE PLANTED PER C.O.A. DRAWING # 2114 (SIMILAR - MULCH SHALL BE PER PLANTING NOTE #6).
- SHRUBS SHALL BE PLANTED PER C.O.A. DRAWING # 2117 (SIMILAR - MULCH SHALL BE PER PLANTING NOTE #6).
- CONTRACTOR SHALL PROTECT EXISTING TREES AND SHRUBS DESIGNATED TO REMAIN FROM DAMAGE DUE TO CONSTRUCTION OPERATIONS. ANY PLANT DAMAGED SHALL BE REPLACED WITH PLANT OF SAME SPECIES AND SIZE. IF SIZE IS UNAVAILABLE, CONTRACTOR SHALL PROVIDE CREDIT TO OWNER FOR VALUE OF DIFFERENCE IN SIZE.
- GRAVEL MULCH SHALL BE A 3" DEPTH OF 1" PLUM ROSE CRUSHED GRANITE. MULCH SHALL BE PLACED OVER A CONTINUOUS LAYER OF WEED BARRIER FABRIC. WEED BARRIER FABRIC SHALL BE 35 OZ. WOVEN, NEEDLE PUNCHED POLYPROPYLENE (DEWITT OR EQUAL). OVERLAP ENDS 3" AND TURN DOWN PERIMETER EDGE 6". TOP OF MULCH SHALL BE 1" BELOW THE TOP OF ADJACENT CURBS AND WALK.
- TREES AND SHRUBS SHALL BE HAND WATERED BY THE CONTRACTOR UNTIL FINAL PROJECT ACCEPTANCE. CONTRACTOR'S WARRANTY OF THE TREES AND SHRUBS SHALL BE THROUGH FINAL PROJECT ACCEPTANCE ONLY.
- CONTRACTOR SHALL HAND DIG HOLES FOR TREES AND SHRUBS TO ENSURE THAT EXISTING UTILITIES ARE NOT DAMAGED DUE TO CONSTRUCTION OPERATIONS.

CONSTRUCTION KEYED NOTES

- CONTRACTOR SHALL INSTALL 18CF TO 24CF 'MOSS ROCK' LANDSCAPE BOULDER PER DETAIL A/ 12.
- CONTRACTOR SHALL INSTALL A CONCRETE EDGER PER DETAIL B/ 12.
- CONTRACTOR SHALL INSTALL 4" COBBLE OVER WEED BARRIER FABRIC. SEE PLANTING NOTE #6 FOR TYPE OF WEED BARRIER FABRIC.
- CONTRACTOR SHALL INSTALL 18" BERM AT 6:1 SLOPE AT BASE OF NEIGHBORHOOD SIGN. CONTRACTOR SHALL RAISE EXISTING SIGN ACCORDINGLY AND RE-INSTALL IN CONCRETE FOOTINGS.

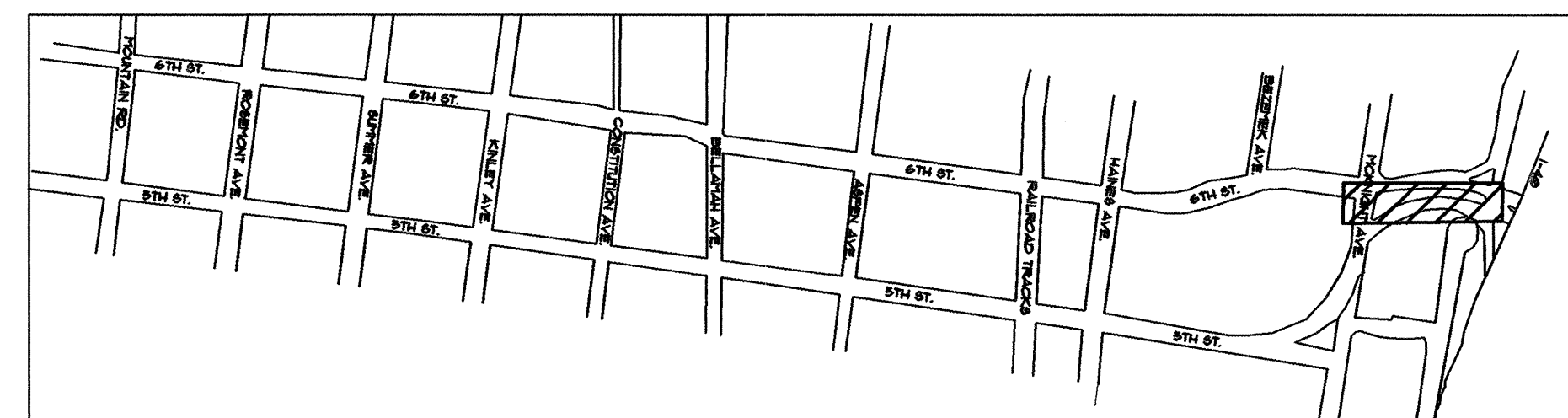

KEYMAP

N.T.S.

PLANT SCHEDULE						
KEY	COMMON NAME	BOTANICAL NAME	QUANTITY	SIZE		COMMENTS
				INSTALLED	MATURE	
TREES						
BRAP	Bradford Pear	<i>Pyrus calleryana</i> 'Bradford'	9	2 1/2" cal.	30'-35' ht., 4 20'-25' spd.	
CHIP	Chinese pistache	<i>Pistacia chinensis</i>	11	2 1/2" cal.	30'-35' ht., 4 30' spd.	
GRT	Goldenrain tree	<i>Koeleruteria paniculata</i>	10	2 1/2" cal.	25'-30' ht., 4 spd.	
SHRUBS						
LV	Lavender	<i>Lavandula angustifolia</i> 'Mitcham Gray'	41	3 gal.	20" ht., 4 spd.	
RTM	Regal Mist	<i>Muhlenbergia capillaris</i>	21	5 gal.	3' ht., 4 spd.	

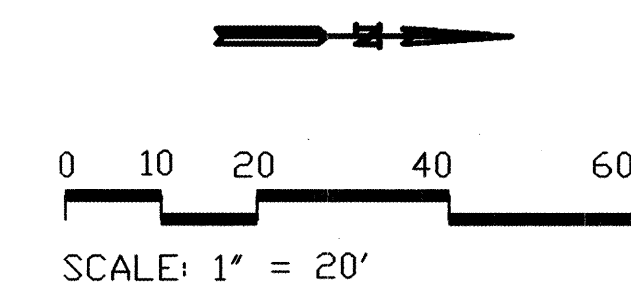

CITY OF ALBUQUERQUE DEPARTMENT OF MUNICIPAL DEVELOPMENT CAPITAL IMPLEMENTATION PROGRAM			
TITLE: 5th AND 6th STREETS STREETScape LANDSCAPE IMPROVEMENTS PLANTING PLAN			
Design Review Committee APPROVED SEP - 9 2004 DESIGN REVIEW COMMITTEE	City Engineer Approval APPROVED SEP - 9 2004 CITY ENGINEER	Mo/Day/Yr.	Mo/Day/Yr.
CITY PROJECT NO. 744391		ZONE MAP NO. H-14 & J-14	SHEET 13 OF 13

ENGINEER'S SEAL		SURVEY INFORMATION		BENCH MARKS		AS BUILT INFORMATION	
		NO.	DATE	CONTRACTOR	DATE	RECORD BY	DATE
		BY	DATE	INSPECTED BY	DATE	RECORD BY	DATE
		NO.	DATE	VERIFIED BY	DATE	RECORD BY	DATE
REVISIONS		MICRO-FILM INFORMATION					
NO.	DATE	NO.	DATE				
DESIGNED BY JSP	DATE: 8/26/04						
DRAWN BY JSP	DATE: 8/26/04						
CHECKED BY ECR	DATE: 8/26/04						