

# 5TH & 6TH STREET PHASE 2 LANDSCAPE IMPROVEMENTS

DEPARTMENT OF MUNICIPAL  
DEVELOPMENT CAPITAL IMPLEMENTATION  
PROGRAM  
INDEX OF DRAWINGS

TITLE SHEET NO.

COVER SHEET	1
IRRIGATION PLAN	2
PLANTING PLAN	3-8
DETAILS	9
AS-BUILT IRRIGATION OF WELLS PARK	10

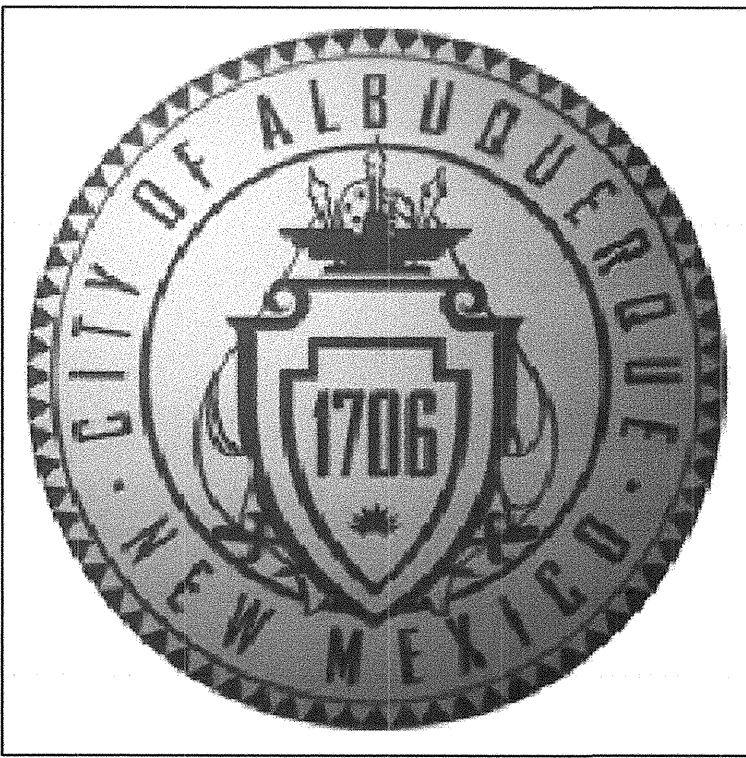
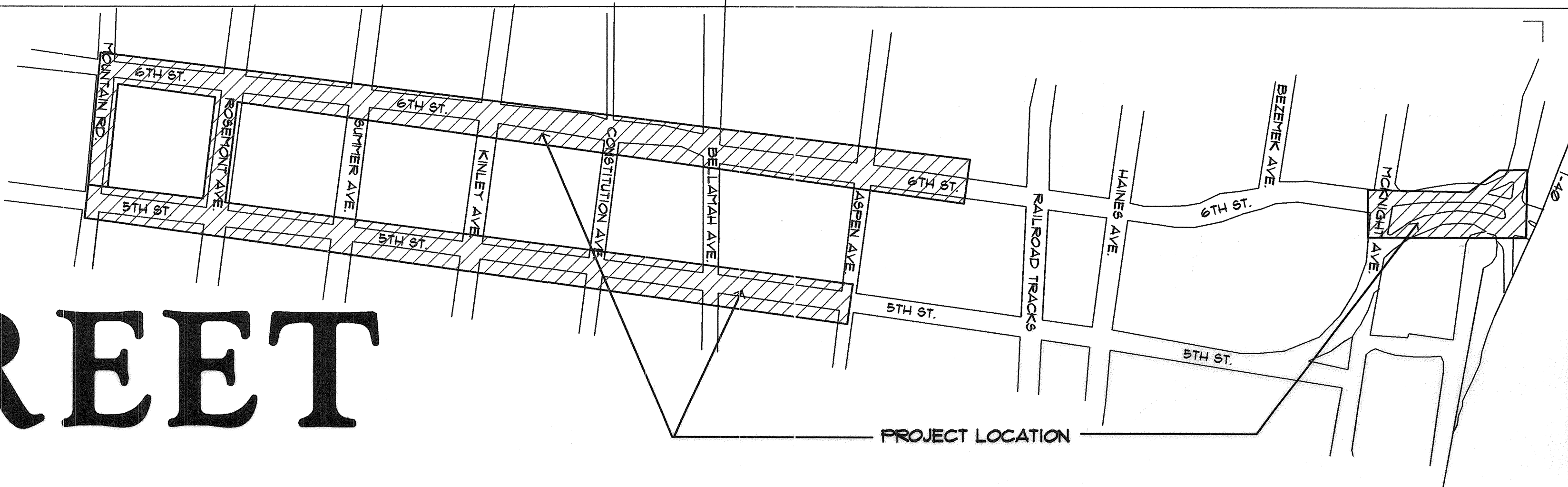

LOCATION MAP

N.T.S.

ZONE MAP NO. H-14-Z, J-14-Z

## GENERAL NOTES

- AN EXCAVATION/ CONSTRUCTION PERMIT WILL BE REQUIRED BEFORE BEGINNING ANY WORK WITHIN THE CITY RIGHT-OF-WAY.
- ALL WORK DETAILED ON THESE PLANS TO BE PERFORMED UNDER CONTRACT SHALL, EXCEPT AS OTHERWISE STATED OR PROVIDED FOR HEREIN, BE CONSTRUCTED IN ACCORDANCE WITH THE CITY OF ALBUQUERQUE STANDARD SPECIFICATIONS FOR PUBLIC WORKS CONSTRUCTION, 1986 EDITION AND SHALL INCLUDE UPDATE NO. 7.
- TWO (2) WORKING DAYS PRIOR TO ANY EXCAVATION, THE CONTRACTOR SHALL CONTACT NEW MEXICO ONE CALL SYSTEM (260-1990) FOR LOCATION OF EXISTING UTILITIES.
- PRIOR TO CONSTRUCTION, THE CONTRACTOR SHALL EXCAVATE AND VERIFY THE HORIZONTAL AND VERTICAL LOCATIONS OF ALL OBSTRUCTIONS. SHOULD A CONFLICT EXIST, THE CONTRACTOR SHALL NOTIFY THE LANDSCAPE ARCHITECT IMMEDIATELY SO THAT THE CONFLICT CAN BE RESOLVED WITH A MINIMUM AMOUNT OF DELAY.
- FIVE (5) WORKING DAYS PRIOR TO BEGINNING CONSTRUCTION, THE CONTRACTOR SHALL SUBMIT TO THE CONSTRUCTION COORDINATION DIVISION, A DETAILED CONSTRUCTION SCHEDULE. TWO (2) DAYS PRIOR TO CONSTRUCTION, THE CONTRACTOR SHALL OBTAIN A BARRICADE PERMIT FROM THE CONSTRUCTION COORDINATION DIVISION. CONTRACTOR SHALL NOTIFY BARRICADE ENGINEER (924-3400) PRIOR TO OCCUPYING AN INTERSECTION. CONTRACTOR SHALL REFER TO SECTION 19 OF THE STANDARD SPECIFICATIONS FOR TRAFFIC CONTROL.
- ALL STREET STRIPING ALTERED OR DESTROYED SHALL BE REPLACED WITH PLASTIC REFLECTORIZED PAVEMENT MARKING BY CONTRACTOR TO SAME LOCATION AS EXISTING OR AS INDICATED BY THIS PLAN SET.
- CONTRACTOR SHALL COORDINATE WITH WATER SYSTEMS DIVISION (857-8200) SEVEN (7) WORKING DAYS IN ADVANCE OF ANY WORK THAT MAY AFFECT EXISTING PUBLIC WATER OR SEWER UTILITIES. EXISTING VALVES TO BE OPERATED BY CITY PERSONNEL ONLY. CONTRACTOR SHALL CONTACT THE WATER SYSTEMS DIVISION SEVEN (7) DAYS PRIOR TO NEEDING VALVES TURNED ON OR OFF.
- CONTRACTOR SHALL RECORD DATA ON ALL UTILITY LINES AND ACCESSORIES AS REQUIRED BY THE CITY OF ALBUQUERQUE FOR THE PREPARATION OF THE "AS CONSTRUCTED" DRAWINGS. CONTRACTOR SHALL NOT COVER UTILITY LINES AND ACCESSORIES UNTIL ALL DATA HAS BEEN RECORDED.
- CONTRACTOR SHALL NOTIFY THE CITY SURVEYING NOT LESS THAN SEVEN (7) DAYS PRIOR TO STARTING WORK, IN ORDER THAT THE CITY SURVEYING MAY TAKE NECESSARY MEASURES TO INSURE THAT PRESERVATION OF SURVEY MONUMENTS. CONTRACTOR SHALL NOT DISTURB PERMANENT SURVEY MONUMENTS WITHOUT THE CONSENT OF THE CITY SURVEYING AND SHALL NOTIFY THE CITY SURVEYING AND BEAR THE EXPENSE OF REPLACING ANY THAT MAY BE DISTURBED WITHOUT PERMISSION. REPLACEMENT SHALL BE DONE ONLY BY THE CITY OF ALBUQUERQUE SURVEY SECTION. WHEN A CHANGE IS MADE IN THE FINISH ELEVATION OF THE PAVEMENT OF ANY ROADWAY IN WHICH A PERMANENT SURVEY MONUMENT IS LOCATED, CONTRACTOR SHALL, AT HIS OWN EXPENSE ADJUST THE MONUMENT COVER TO NEW GRADE, UNLESS OTHERWISE SPECIFIED. REFER TO SECTION 4.4 OF THE SPECIFICATIONS.
- CONTRACTOR SHALL MAINTAIN A GRAFFITI-FREE WORK SITE. CONTRACTOR SHALL PROMPTLY REMOVE ANY GRAFFITI FROM ALL EQUIPMENT, WHETHER PERMANENT OR TEMPORARY.
- IF ANY EXISTING UTILITY LINES, PIPELINES, OR UNDERGROUND UTILITY LINES ARE SHOWN ON THESE DRAWINGS THEY ARE SHOWN IN AN APPROXIMATE MANNER ONLY, AND SUCH LINES MAY EXIST WHERE NONE ARE SHOWN. IF ANY SUCH EXISTING LINES ARE SHOWN, THE LOCATION IS BASED ON INFORMATION PROVIDED BY THE OWNER OF SAID UTILITY, AND THE INFORMATION MAY BE INCOMPLETE, OR MAY BE OBSOLETE BY THE TIME CONSTRUCTION COMMENCES. THE LANDSCAPE ARCHITECT HAS CONDUCTED ONLY PRELIMINARY INVESTIGATION OF THE LOCATION, DEPTH, SIZE, OR TYPE OF EXISTING UTILITY LINES, PIPELINES OR UNDERGROUND UTILITY LINES. THIS INVESTIGATION IS NOT CONCLUSIVE, AND MAY NOT BE COMPLETE, THEREFORE, MAKE NO REPRESENTATION PERTAINING THERETO, AND ASSUMES NO RESPONSIBILITY OR LIABILITY. THEREFORE, THE CONTRACTOR SHALL INFORM ITSELF OF THE LOCATION OF ANY UTILITY LINES, PIPELINES, OR UNDERGROUND UTILITY LINE IN OR NEAR THE AREA OF THE WORK IN ADVANCE OF AND DURING EXCAVATION WORK. THE CONTRACTOR IS FULLY RESPONSIBLE FOR ANY AND ALL DAMAGES CAUSED BY ITS FAILURE TO LOCATE, IDENTIFY AND PRESERVE ANY AND ALL EXISTING UTILITIES, PIPELINES, AND UNDERGROUND LINE. IN PLANNING AND CONDUCTING EXCAVATION, THE CONTRACTOR SHALL COMPLY WITH STATE STATUTES, MUNICIPAL AND LOCAL ORDINANCES, RULES AND REGULATIONS, IF ANY, PERTAINING TO THE LOCATION OF THESE UTILITY LINES AND FACILITIES.
- SHOULD A CONFLICT EXIST BETWEEN THESE PLANS AND THE ACTUAL FIELD CONDITIONS, THE CONTRACTOR SHALL PROMPTLY NOTIFY THE LANDSCAPE ARCHITECT IN WRITING SO THAT THE CONFLICT CAN BE RESOLVED WITH THE MINIMUM AMOUNT OF DELAY FOR ALL PARTIES.
- THE CONTRACTOR SHALL MAINTAIN ACCESS TO ADJACENT PROPERTIES DURING CONSTRUCTION.
- ALL WORK ON THIS PROJECT SHALL BE PERFORMED IN ACCORDANCE WITH THE APPLICABLE FEDERAL, STATE AND LOCAL LAWS, RULES AND REGULATIONS CONCERNING SAFETY AND HEALTH.
- ALL UTILITIES AND UTILITY SERVICE LINES SHALL BE INSTALLED PRIOR TO PAVING.
- BACKFILL COMPACTION SHALL BE ACCORDING TO SPECIFIED STREET USE.
- TACK COAT REQUIREMENTS SHALL BE DETERMINED DURING CONSTRUCTION BY THE LANDSCAPE ARCHITECT.
- CAUTION, THESE DRAWINGS DO NOT INCLUDE NECESSARY COMPONENTS FOR CONSTRUCTION SAFETY WHICH SHALL REMAIN THE RESPONSIBILITY OF THE CONTRACTOR.
- ANY WORK AFFECTING AN ARTERIAL ROADWAY REQUIRES TWENTY-FOUR (24) HOUR CONSTRUCTION.
- ANY SIGNAL CONDUITS, LOOPS, PULL BOXES OR OTHER TRAFFIC UTILITIES THAT ARE DAMAGED BY CONSTRUCTION OPERATIONS SHALL BE REPLACED BY THE CONTRACTOR AT NO ADDITIONAL COST TO THE OWNER.
- ANY SIDEWALK, RAMPS, CURBS AND GUTTER, OR OTHER CITY FACILITY DAMAGED BY CONSTRUCTION OPERATIONS SHALL BE REPLACED BY THE CONTRACTOR AT NO ADDITIONAL COST TO THE OWNER.
- EVERY CARE HAS BEEN TAKEN TO ASSURE THAT PLANT MATERIAL NOT BE IN CONFLICT WITH SAS LOCATIONS. HOWEVER, CONTRACTOR SHALL UNDER NO CIRCUMSTANCES POSITION TREES OVER SAS LINES, THAT ARE NOT 6" DEEP AND OF PVC MATERIAL.



09/14/05

SET NUMBER: \_\_\_\_\_



REV.	SHEETS	CITY ENGINEER	DATE	USER DEPARTMENT	DATE	USER DEPARTMENT	DATE
LANDSCAPE ARCHITECT'S SEAL		APPROVALS	ENGINEER	DATE	*****		
		DRC CHAIRMAN		10-11-05	APPROVED FOR CONSTRUCTION		
		TRANSPORTATION		9/30/05			
		WATER/WASTEWATER		9/16/05			
		HYDROLOGY		9/30/05			
		C.I.P.					
		CONSTR. MGMT.					
		CONSTR. COORD.		10-11-05			
		City Project Number			Sheet	Of	
					1	10	





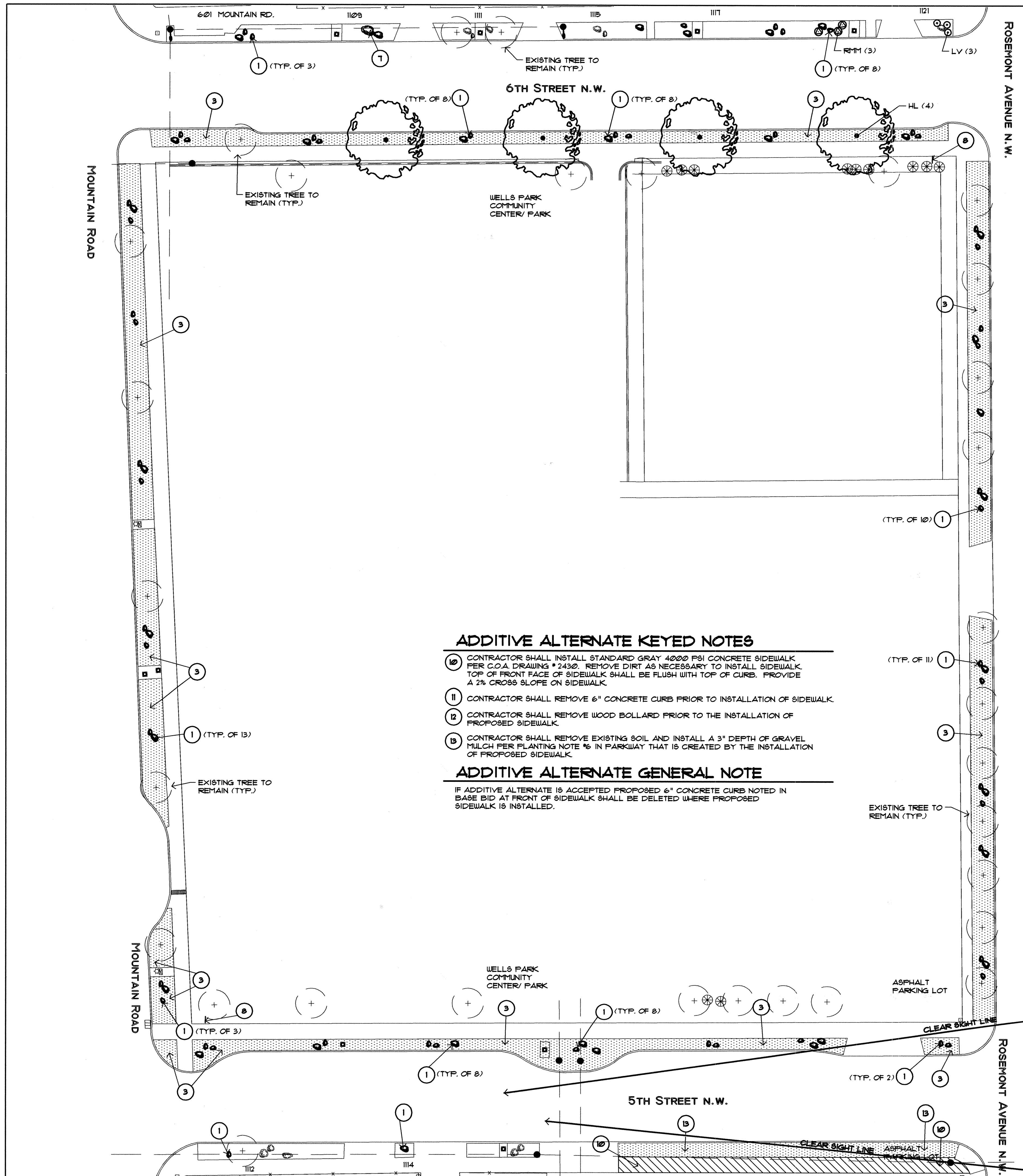

ADDITIVE ALTERNATE KEYED NOTES

- 10 CONTRACTOR SHALL INSTALL STANDARD GRAY 4000 PSI CONCRETE SIDEWALK PER C.O.A. DRAWING # 2430. REMOVE DIRT AS NECESSARY TO INSTALL SIDEWALK. TOP OF FRONT FACE OF SIDEWALK SHALL BE FLUSH WITH TOP OF CURB. PROVIDE A 2% CROSS SLOPE ON SIDEWALK.
- 11 CONTRACTOR SHALL REMOVE 6" CONCRETE CURB PRIOR TO INSTALLATION OF SIDEWALK.
- 12 CONTRACTOR SHALL REMOVE WOOD BOLLARD PRIOR TO THE INSTALLATION OF PROPOSED SIDEWALK.
- 13 CONTRACTOR SHALL REMOVE EXISTING SOIL AND INSTALL A 3" DEPTH OF GRAVEL MULCH PER PLANTING NOTE #6 IN PARKWAY THAT IS CREATED BY THE INSTALLATION OF PROPOSED SIDEWALK.

ADDITIVE ALTERNATE GENERAL NOTE

IF ADDITIVE ALTERNATE IS ACCEPTED PROPOSED 6" CONCRETE CURB NOTED IN BASE BID AT FRONT OF SIDEWALK SHALL BE DELETED WHERE PROPOSED SIDEWALK IS INSTALLED.

PLANT SCHEDULE (FOR PLANT SCHEDULE SEE SHEET 8)

KEY	COMMON NAME	BOTANICAL NAME
<b>TREES</b>		
BRAP	Bradford Pear	Pyrus calleryana 'Bradford'
CHIP	Chinese Pistache	Pistacia chinensis
GRT	Goldenrain tree	Koeberlinia paniculata
HL	Honey Locust	Gleditsia triacanthos inermis 'Shademaster'
<b>SHRUBS</b>		
BJ	Buffalo Juniper	Juniperus sabina 'Buffalo'
LV	Lavender	Lavandula angustifolia 'Mitcham Gray'
RMM	Regal Mist	Muhlenbergia capillaris
TRY	Texas Red Yucca	Hesperaloe parviflora
<b>CACTI</b>		
BLC	Bailey's Lace Cactus	Echinocereus reichenbachii v. baileyi
CCC	Claret Cup Cactus	Echinocereus triglochidiatus
NRH	New Mexico Rainbow Hedgehog	Echinocereus dasyacanthus
SH	Royal George Spiny Hedgehog	Echinocereus coccineus

PLANTING NOTES

- IN CASE OF DISCREPANCY IN PLANT QUANTITIES SHOWN ON THE PLANT LIST AND THOSE SHOWN ON THE PLANTING PLAN, THE QUANTITIES SHOWN ON THE PLAN SHALL GOVERN. CONTRACTOR SHALL VERIFY ALL QUANTITIES PRIOR TO BID AND INSTALLATION. NO ADDITIONAL PAYMENT WILL BE MADE FOR DISCREPANCIES IN QUANTITIES BETWEEN THE PLANTING PLAN AND THE PLANT LIST.
- THE CONTRACTOR SHALL PRUNE LOWER BRANCHES OF DECIDUOUS TREES TO 6 FEET ABOVE FINISH GRADE.
- TREES SHALL BE PLANTED PER DETAIL B/3.
- SHRUBS SHALL BE PLANTED PER DETAIL D/3.
- CONTRACTOR SHALL PROTECT EXISTING TREES AND SHRUBS DESIGNATED TO REMAIN FROM DAMAGE DUE TO CONSTRUCTION OPERATIONS. ANY PLANT DAMAGED SHALL BE REPLACED WITH PLANT OF SAME SPECIES AND SIZE. IF SIZE IS UNAVAILABLE, CONTRACTOR SHALL PROVIDE CREDIT TO OWNER FOR VALUE OF DIFFERENCE IN SIZE.
- GRAVEL MULCH SHALL BE A 3" DEPTH OF 1" PLUM ROSE CRUSHED GRANITE. MULCH SHALL BE PLACED OVER A CONTINUOUS LAYER OF WEED BARRIER FABRIC. WEED BARRIER FABRIC SHALL BE 3.5 OZ. WOVEN, NEEDLE PUNCHED POLYPROPYLENE (DEWITT OR EQUAL). OVERLAP ENDS 3" AND TURN DOWN FERMETER EDGE 6". TOP OF MULCH SHALL BE 1" BELOW THE TOP OF ADJACENT CURBS AND WALK.
- TREES AND SHRUBS SHALL BE HAND WATERED BY THE CONTRACTOR UNTIL FINAL PROJECT ACCEPTANCE. PROVIDE ADEQUATE VOLUME OF WATER AT EACH PLANT TO THOROUGHLY SOAK THE ROOTS AND REMOVE ALL AIR POCKETS IN THE ROOT ZONE. CONTRACTOR'S WARRANTY OF THE TREES AND SHRUBS SHALL BE THROUGH FINAL PROJECT ACCEPTANCE ONLY. THE CACTUS PLANTS SHALL BE HAND WATERED ONE (1) TIME IMMEDIATELY FOLLOW INSTALLATION.
- CONTRACTOR SHALL HAND DIG HOLES FOR TREES AND SHRUBS TO ENSURE THAT EXISTING UTILITIES ARE NOT DAMAGED DUE TO CONSTRUCTION OPERATIONS.
- EXISTING GRAVEL MULCH AND BOULDERS IN PARKWAYS AND MEDIANS ON 5TH AND 6TH STREET SHALL REMAIN UNLESS OTHERWISE NOTED. EXISTING GRAVEL THAT IS DISTURBED DUE TO THE INSTALLATION OF BOULDERS AND PLANT MATERIAL SHALL BE RE-INSTALLED TO ITS PRE-EXISTING CONDITION. IN ALL DISTURBED AREAS THE CONTRACTOR SHALL RE-INSTALL WEED BARRIER FABRIC PER PLANTING NOTE #6 PRIOR TO RELAYING THE GRAVEL MULCH.

CONSTRUCTION KEYED NOTES

- CONTRACTOR SHALL INSTALL 18CF TO 24CF MOSS ROCK' LANDSCAPE BOULDER PER DETAIL A/3.
- CONTRACTOR SHALL INSTALL A CONCRETE EDGER PER DETAIL E/3.
- CONTRACTOR SHALL REMOVE EXISTING BARK MULCH AND SOIL AS REQUIRED TO INSTALL A 3" DEPTH OF GRAVEL MULCH PER PLANTING NOTE #6.
- CONTRACTOR SHALL REMOVE EXISTING GRAVEL AND SOIL AS REQUIRED TO INSTALL A 3" DEPTH OF GRAVEL MULCH PER PLANTING NOTE #6.
- CONTRACTOR SHALL REMOVE EXISTING ASPHALT AND SOIL AS REQUIRED TO INSTALL A 3" DEPTH OF GRAVEL MULCH PER PLANTING NOTE #6.
- NOT USED.
- CONTRACTOR SHALL REMOVE TWO EXISTING BOULDERS AND INSTALL 2 LARGE (24 CF - 30 CF) BOULDERS.
- CONTRACTOR SHALL FURNISH AND INSTALL NEIGHBORHOOD SIGN PER DETAIL C/3.
- CONTRACTOR SHALL REMOVE EXISTING SOIL AS REQUIRED TO INSTALL A 3" DEPTH OF GRAVEL MULCH PER PLANTING NOTE #6.

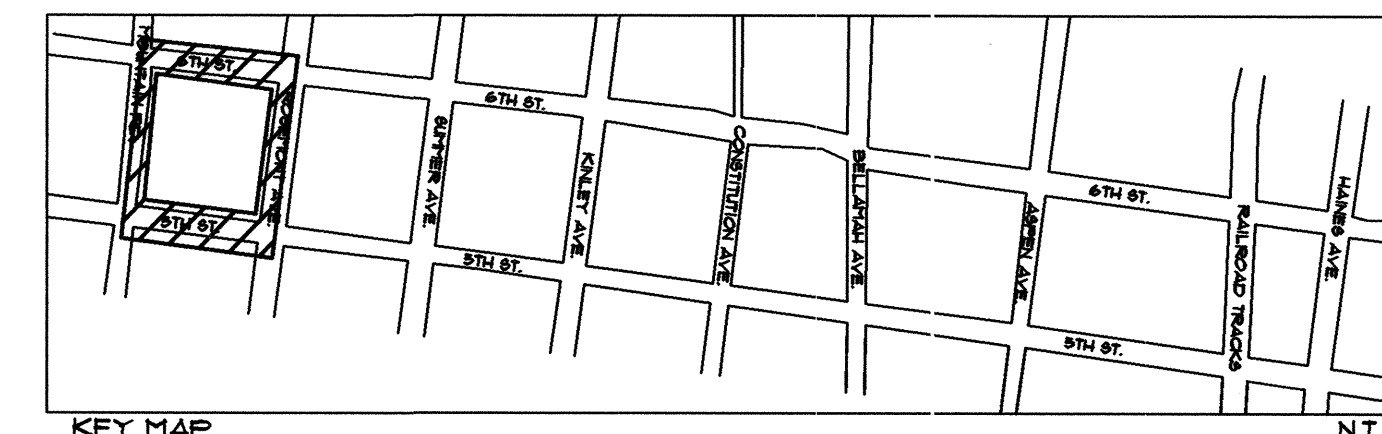

GENERAL DEMOLITION NOTE

CONTRACTOR SHALL PROPERLY DISPOSE OF GRAVEL, ASPHALT, SOIL AND PLANT MATERIAL THAT IS REMOVED FROM PARKWAYS AND MEDIANS IN ORDER TO INSTALL PROPOSED DESIGN.

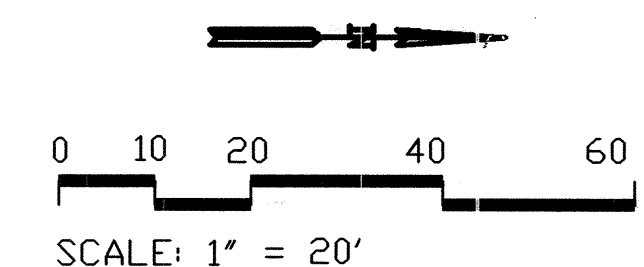

CITY OF ALBUQUERQUE DEPARTMENT OF MUNICIPAL DEVELOPMENT CAPITAL IMPLEMENTATION PROGRAM			
TITLE: 5th and 6th STREETS STREETSCAPE LANDSCAPE IMPROVEMENTS PLANTING PLAN			
Design Review Committee	City Engineer Approval	Mo/Day/Yr.	Mo/Day/Yr.
APPROVED OCT 11 2005 DESIGN REVIEW COMMITTEE	APPROVED OCT 11 2005 CITY ENGINEER		
CITY PROJECT NO. 744392	ZONE MAP NO. H-14 & J-14	SHEET 3	OF 10



[illegible]



MATCHLINE D (SEE SHEET 4)

CONSTITUTION AVENUE N.W.

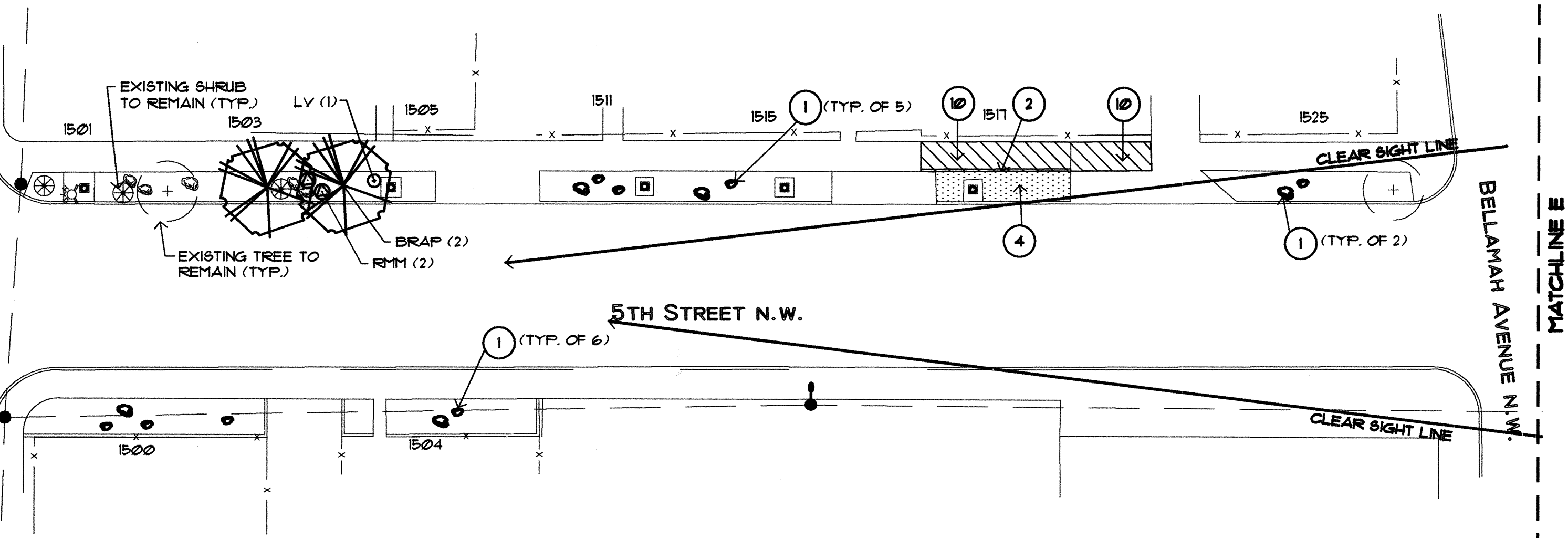

MATCHLINE E

BELLAMAH AVENUE N.W.

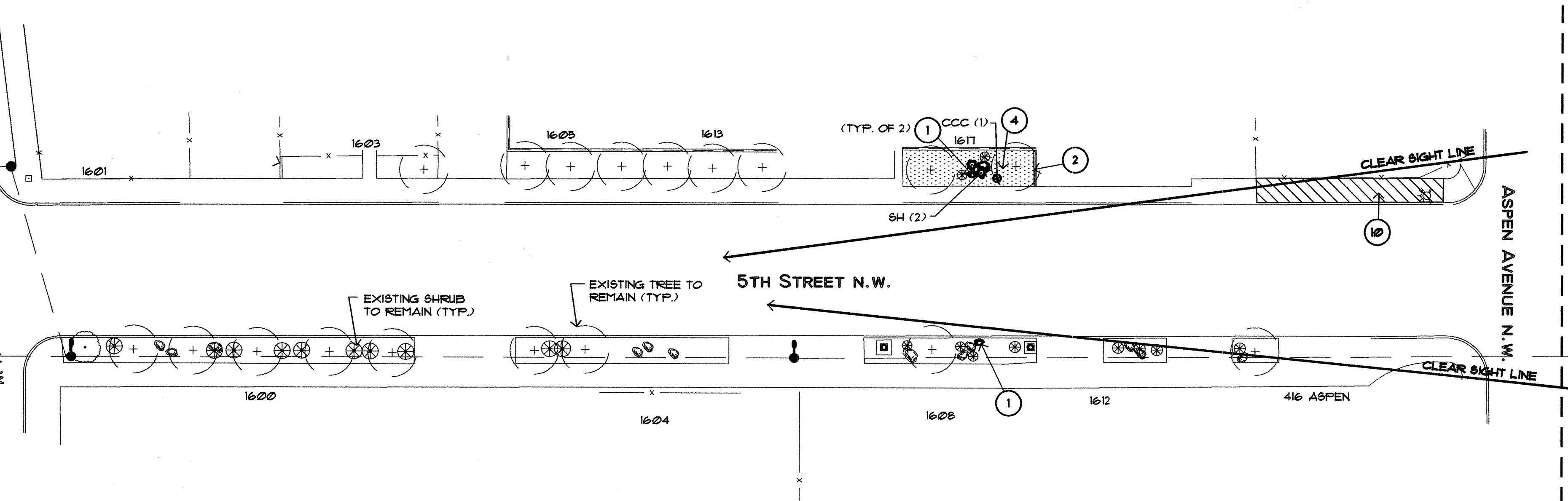

#### ADDITIVE ALTERNATE KEYED NOTES

- 10 CONTRACTOR SHALL INSTALL STANDARD GRAY 4000 PSI CONCRETE SIDEWALK PER C.O.A. DRAWING #2430. REMOVE DIRT AS NECESSARY TO INSTALL SIDEWALK. TOP OF FRONT FACE OF SIDEWALK SHALL BE FLUSH WITH TOP OF CURB. PROVIDE A 2% CROSS SLOPE ON SIDEWALK.
- 11 CONTRACTOR SHALL REMOVE 6" CONCRETE CURB PRIOR TO INSTALLATION OF SIDEWALK.
- 12 CONTRACTOR SHALL REMOVE WOOD BOLLARD PRIOR TO THE INSTALLATION OF PROPOSED SIDEWALK.
- 13 CONTRACTOR SHALL REMOVE EXISTING SOIL AND INSTALL A 3" DEPTH OF GRAVEL MULCH PER PLANTING NOTE #6 IN PARKWAY THAT IS CREATED BY THE INSTALLATION OF PROPOSED SIDEWALK.

#### ADDITIVE ALTERNATE GENERAL NOTE

IF ADDITIVE ALTERNATE IS ACCEPTED PROPOSED 6" CONCRETE CURB NOTED IN BASE BID AT FRONT OF SIDEWALK SHALL BE DELETED WHERE PROPOSED SIDEWALK IS INSTALLED.

#### PLANT SCHEDULE (FOR PLANT SCHEDULE SEE SHEET 8)

KEY	COMMON NAME	BOTANICAL NAME
<b>TREES</b>		
BRAP	Bradford Pear	<i>Pyrus calleryana</i> 'Bradford'
CHIP	Chinese Pistache	<i>Pistacia chinensis</i>
GRT	Goldenrain tree	<i>Koeleruteria paniculata</i>
HL	Honey Locust	<i>Gleditsia triacanthos</i> inermis 'Shademaster'
<b>SHRUBS</b>		
BJ	Buffalo Juniper	<i>Juniperus sabina</i> 'Buffalo'
LV	Lavender	<i>Lavandula angustifolia</i> 'Mitcham Gray'
RHM	Regal Mist	<i>Muhlenbergia capillaris</i>
TRY	Texas Red Yucca	<i>Hesperaloe parviflora</i>
<b>CACTI</b>		
BLC	Bailey's Lace Cactus	<i>Echinocereus reichenbachii</i> v. baileyi
CCC	Claret Cup Cactus	<i>Echinocereus triglochidiatus</i>
NRH	New Mexico Rainbow Hedgehog	<i>Echinocereus dasyacanthus</i>
SH	Royal George Spiny Hedgehog	<i>Echinocereus coccineus</i>

#### PLANTING NOTES

1. IN CASE OF DISCREPANCY IN PLANT QUANTITIES SHOWN ON THE PLANT LIST AND THOSE SHOWN ON THE PLANTING PLAN, THE QUANTITIES SHOWN ON THE PLAN SHALL GOVERN. CONTRACTOR SHALL VERIFY ALL QUANTITIES PRIOR TO BID AND INSTALLATION. NO ADDITIONAL PAYMENT WILL BE MADE FOR DISCREPANCIES IN QUANTITIES BETWEEN THE PLANTING PLAN AND THE PLANT LIST.
2. THE CONTRACTOR SHALL PRUNE LOWER BRANCHES OF DECIDUOUS TREES TO 6 FEET ABOVE FINISH GRADE.
3. TREES SHALL BE PLANTED PER DETAIL B/3.
4. SHRUBS SHALL BE PLANTED PER DETAIL D/3.
5. CONTRACTOR SHALL PROTECT EXISTING TREES AND SHRUBS DESIGNATED TO REMAIN FROM DAMAGE DUE TO CONSTRUCTION OPERATIONS. ANY PLANT DAMAGED SHALL BE REPLACED WITH PLANT OF SAME SPECIES AND SIZE. IF SIZE IS UNAVAILABLE, CONTRACTOR SHALL PROVIDE CREDIT TO OWNER FOR VALUE OF DIFFERENCE IN SIZE.
6. GRAVEL MULCH SHALL BE A 3" DEPTH OF 1" PLUM ROSE CRUSHED GRANITE. MULCH SHALL BE PLACED OVER A CONTINUOUS LAYER OF WEED BARRIER FABRIC. WEED BARRIER FABRIC SHALL BE 3.5 OZ. WOVEN, NEEDLE PUNCHED POLYPROPYLENE (DEWITT OR EQUAL). OVERLAP ENDS 3" AND TURN DOWN FERMETER EDGE 6". TOP OF MULCH SHALL BE 1" BELOW THE TOP OF ADJACENT CURBS AND WALK.
7. TREES AND SHRUBS SHALL BE HAND WATERED BY THE CONTRACTOR UNTIL FINAL PROJECT ACCEPTANCE. PROVIDE ADEQUATE VOLUME OF WATER AT EACH PLANT TO THOROUGHLY SOAK THE ROOTS AND REMOVE ALL AIR POCKETS IN THE ROOT ZONE. CONTRACTOR'S WARRANTY OF THE TREES AND SHRUBS SHALL BE THROUGH FINAL PROJECT ACCEPTANCE ONLY. THE CACTUS PLANTS SHALL BE HAND WATERED ONE (1) TIME IMMEDIATELY FOLLOW INSTALLATION.
8. CONTRACTOR SHALL HAND DIG HOLES FOR TREES AND SHRUBS TO ENSURE THAT EXISTING UTILITIES ARE NOT DAMAGED DUE TO CONSTRUCTION OPERATIONS.
9. EXISTING GRAVEL MULCH AND BOULDERS IN PARKWAYS AND MEDIANS ON 5TH AND 6TH STREET SHALL REMAIN UNLESS OTHERWISE NOTED. EXISTING GRAVEL THAT IS DISTURBED DUE TO THE INSTALLATION OF BOULDERS AND PLANT MATERIAL SHALL BE RE-INSTALLED TO ITS PRE-EXISTING CONDITION. IN ALL DISTURBED AREAS THE CONTRACTOR SHALL RE-INSTALL WEED BARRIER FABRIC PER PLANTING NOTE #6 PRIOR TO RELAYING THE GRAVEL MULCH.

#### CONSTRUCTION KEYED NOTES

- 1 CONTRACTOR SHALL INSTALL 18CF TO 24CF MOSS ROCK' LANDSCAPE BOULDER PER DETAIL A/3.
- 2 CONTRACTOR SHALL INSTALL A CONCRETE EDGER PER DETAIL E/3.
- 3 CONTRACTOR SHALL REMOVE EXISTING BARK MULCH AND SOIL AS REQUIRED TO INSTALL A 3" DEPTH OF GRAVEL MULCH PER PLANTING NOTE #6.
- 4 CONTRACTOR SHALL REMOVE EXISTING GRAVEL AND SOIL AS REQUIRED TO INSTALL A 3" DEPTH OF GRAVEL MULCH PER PLANTING NOTE #6.
- 5 CONTRACTOR SHALL REMOVE EXISTING ASPHALT AND SOIL AS REQUIRED TO INSTALL A 3" DEPTH OF GRAVEL MULCH PER PLANTING NOTE #6.
- 6 NOT USED.
- 7 CONTRACTOR SHALL REMOVE TWO EXISTING BOULDERS AND INSTALL 2 LARGE (24 CF - 30 CF) BOULDERS.
- 8 CONTRACTOR SHALL FURNISH AND INSTALL NEIGHBORHOOD SIGN PER DETAIL C/3.
- 9 CONTRACTOR SHALL REMOVE EXISTING SOIL AS REQUIRED TO INSTALL A 3" DEPTH OF GRAVEL MULCH PER PLANTING NOTE #6.

#### GENERAL DEMOLITION NOTE

CONTRACTOR SHALL PROPERLY DISPOSE OF GRAVEL, ASPHALT, SOIL AND PLANT MATERIAL THAT IS REMOVED FROM PARKWAYS AND MEDIANS IN ORDER TO INSTALL PROPOSED DESIGN.

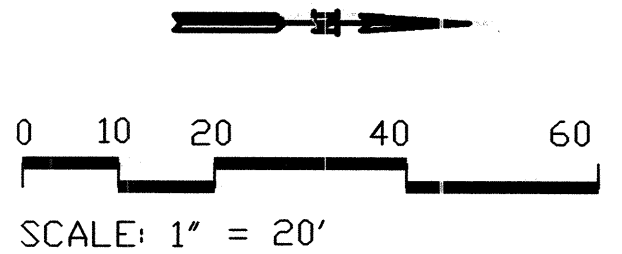
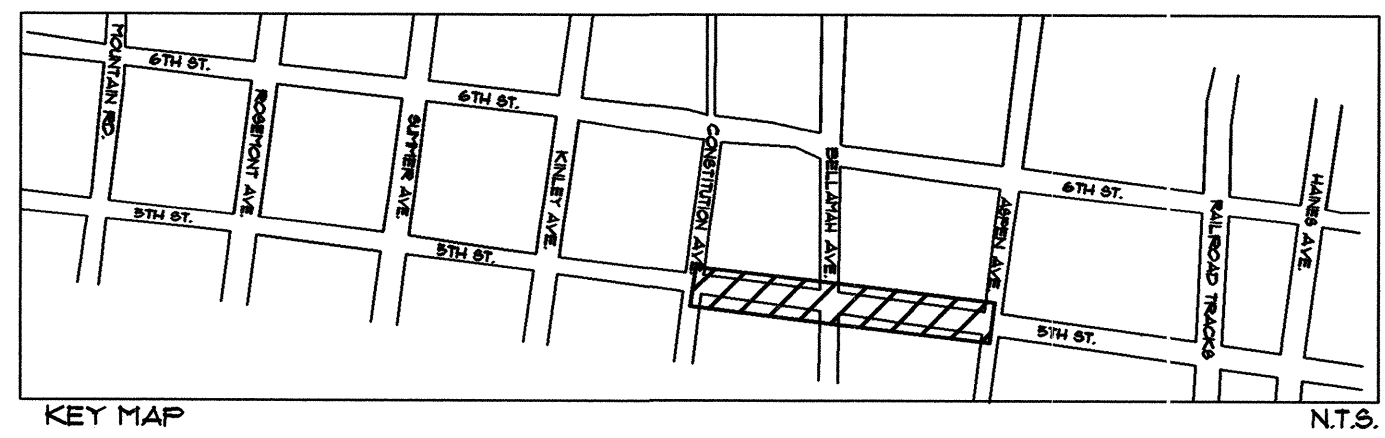

CITY OF ALBUQUERQUE  
DEPARTMENT OF MUNICIPAL DEVELOPMENT  
CAPITAL IMPLEMENTATION PROGRAM

TITLE: 5th AND 6th STREETS STREETSCAPE LANDSCAPE IMPROVEMENTS PLANTING PLAN	
Design-Review Committee APPROVED OCT 11 2005 DESIGN REVIEW COMMITTEE	City Engineer Approval APPROVED OCT 11 2005 CITY ENGINEER
CITY PROJECT NO. 744392	ZONE MAP NO. H-14 & J-14
SHEET 5	OF 10



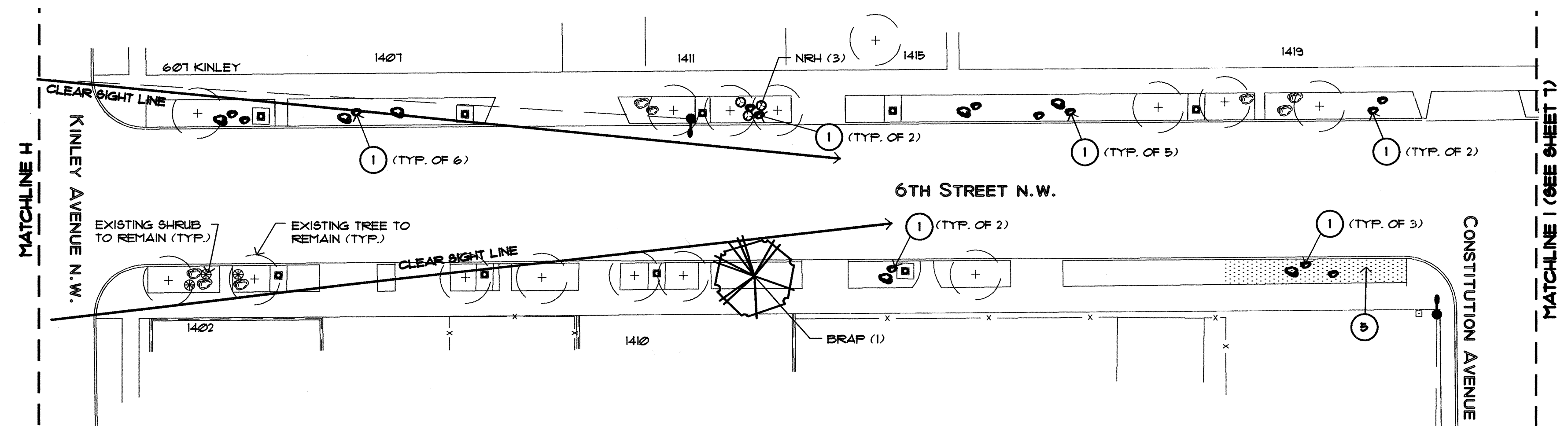

10. CONTRACTOR SHALL INSTALL STANDARD GRAY 4000 PSI CONCRETE SIDEWALK PER C.O.A. DRAWING # 2430. REMOVE DIRT AS NECESSARY TO INSTALL SIDEWALK. TOP OF FRONT FACE OF SIDEWALK SHALL BE FLUSH WITH TOP OF CURB. PROVIDE A 2% CROSS SLOPE ON SIDEWALK.
11. CONTRACTOR SHALL REMOVE 6" CONCRETE CURB PRIOR TO INSTALLATION OF SIDEWALK.
12. CONTRACTOR SHALL REMOVE WOOD BOLLARD PRIOR TO THE INSTALLATION OF PROPOSED SIDEWALK.
13. CONTRACTOR SHALL REMOVE EXISTING SOIL AND INSTALL A 3" DEPTH OF GRAVEL UNDER PERMISSIBLE 4% IN PARKWAY THAT IS CREATED BY THE INSTALLATION OF PROPOSED SIDEWALK.

IF ADDITIVE ALTERNATE IS ACCEPTED PROPOSED 6" CONCRETE CURB NOTED IN  
BASE BID AT FRONT OF SIDEWALK SHALL BE DELETED WHERE PROPOSED  
SIDEWALK IS INSTALLED.

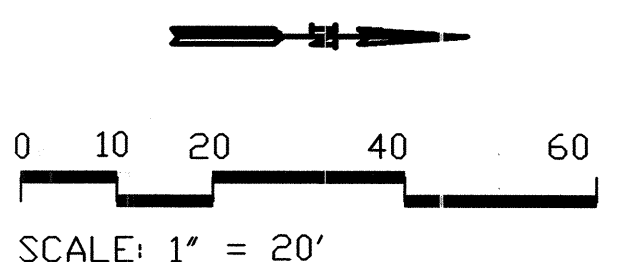

CONTRACTOR SHALL PROPERLY DISPOSE OF GRAVEL, ASPHALT, SOIL AND PLANT MATERIAL THAT IS REMOVED FROM PARKWAYS AND MEDIANS IN ORDER TO INSTALL PROPOSED DESIGN.



**MORROW  
REARDON  
WILKINSON, LTD.,  
LANDSCAPE ARCHITECTS**

210 La Veta NE, Albuquerque, NM 87108  
505.288.2286 FAX 505.285.9637

[mrw@mrwdm.com](mailto:mrw@mrwdm.com)

				Last Design Update	Mo./Day./yr.	Mo./Day./yr.
CITY PROJECT NO.		ZONE MAP NO.		SHEET	OF	
744392		H-14 & J-14			6	10



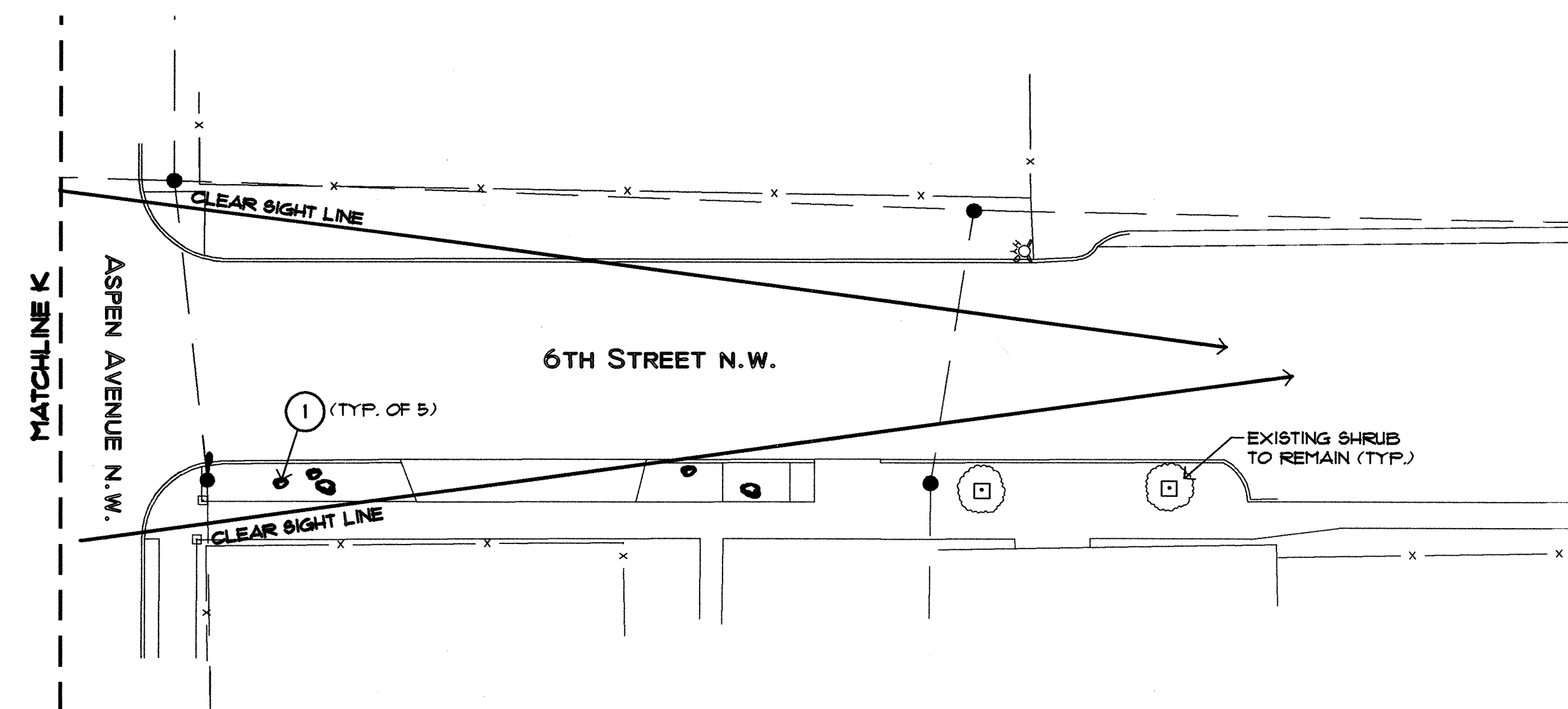
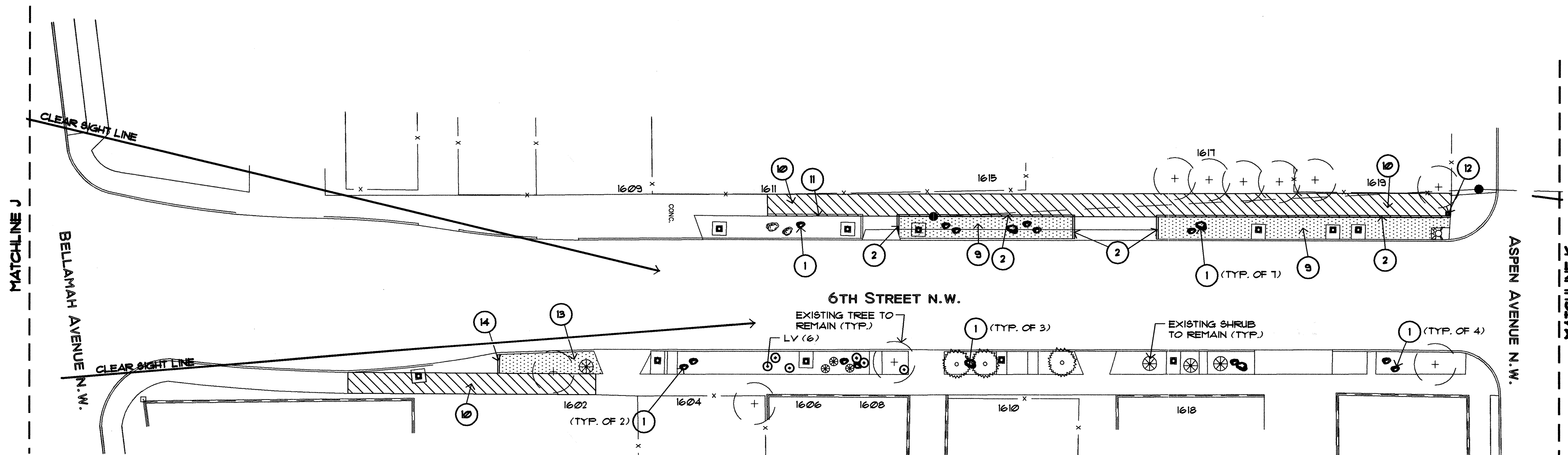
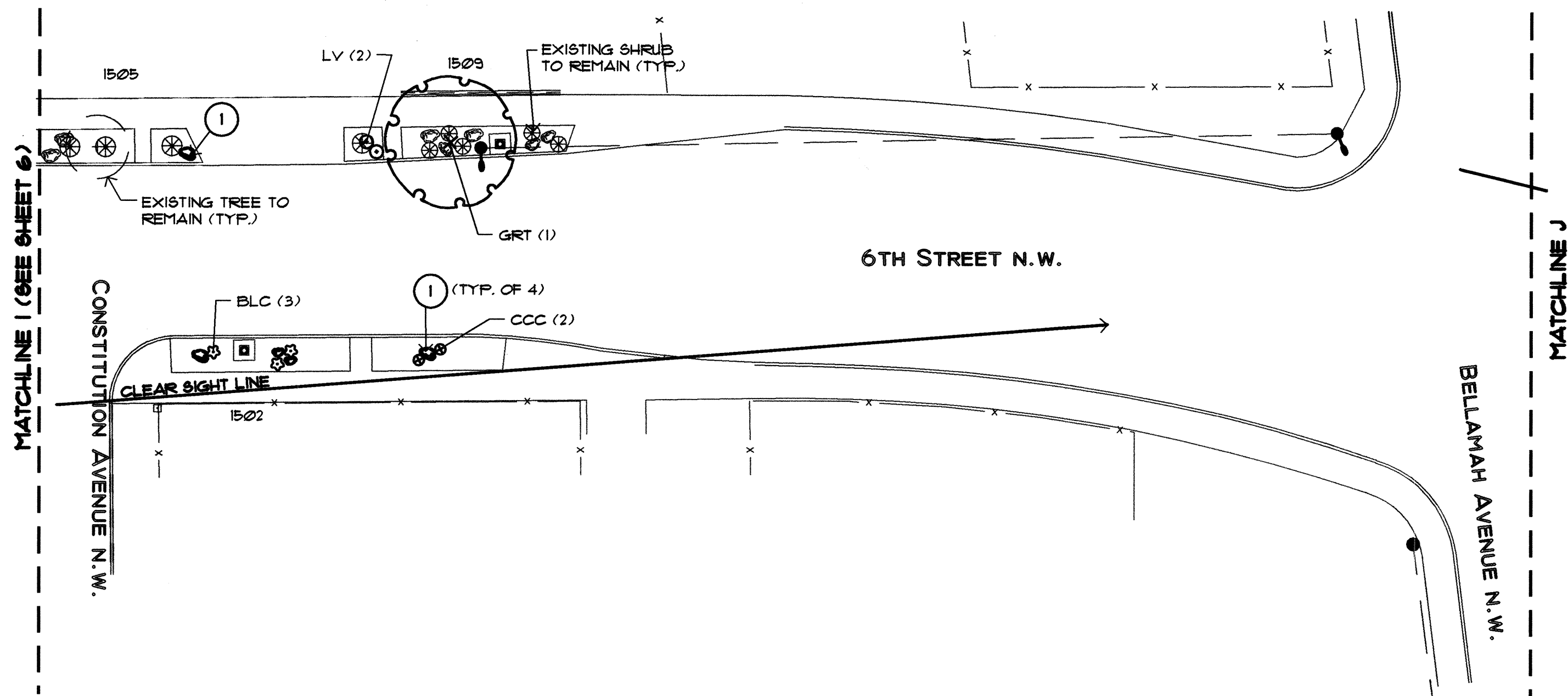

#### ADDITIVE ALTERNATE KEYED NOTES

- 10 CONTRACTOR SHALL INSTALL STANDARD GRAY 4000 PSI CONCRETE SIDEWALK PER C.O.A. DRAWING # 2430. REMOVE DIRT AS NECESSARY TO INSTALL SIDEWALK. TOP OF FRONT FACE OF SIDEWALK SHALL BE FLUSH WITH TOP OF CURB. PROVIDE A 2% CROSS SLOPE ON SIDEWALK.
- 11 CONTRACTOR SHALL REMOVE 6" CONCRETE CURB PRIOR TO INSTALLATION OF SIDEWALK.
- 12 CONTRACTOR SHALL REMOVE WOOD BOLLARD PRIOR TO THE INSTALLATION OF PROPOSED SIDEWALK.
- 13 CONTRACTOR SHALL REMOVE EXISTING SOIL AND INSTALL A 3" DEPTH OF GRAVEL MULCH PER PLANTING NOTE #6 IN PARKWAY THAT IS CREATED BY THE INSTALLATION OF PROPOSED SIDEWALK.
- 14 CONTRACTOR SHALL INSTALL A CONCRETE EDGER PER DETAIL E/ 9.

#### ADDITIVE ALTERNATE GENERAL NOTE

IF ADDITIVE ALTERNATE IS ACCEPTED PROPOSED 6" CONCRETE CURB NOTED IN BASE BID AT FRONT OF SIDEWALK SHALL BE DELETED WHERE PROPOSED SIDEWALK IS INSTALLED.

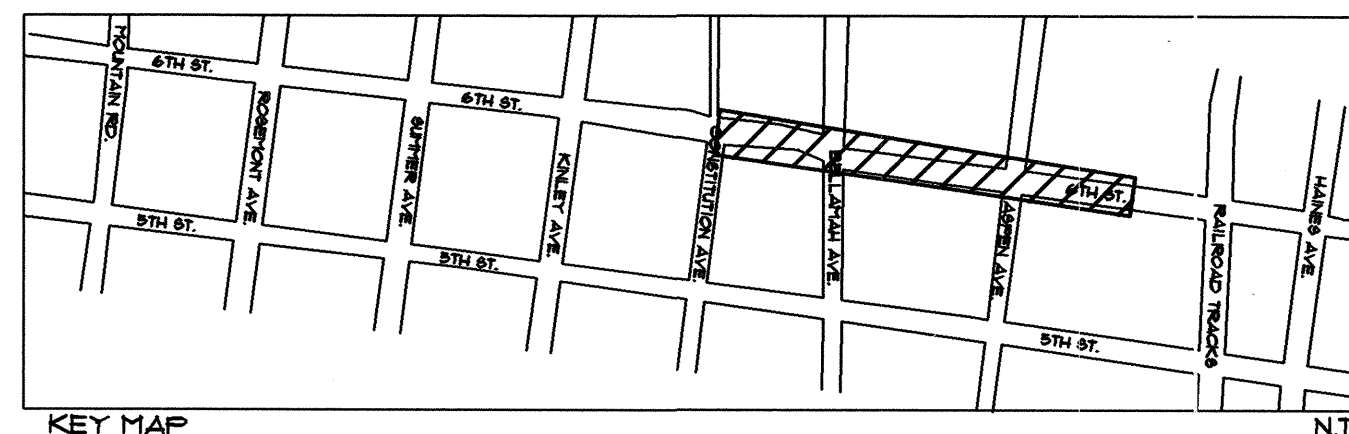

#### PLANT SCHEDULE (FOR PLANT SCHEDULE SEE SHEET 8)

KEY	COMMON NAME	BOTANICAL NAME
<b>TREES</b>		
BRAP	Bradford Pear	<i>Pyrus calleryana</i> 'Bradford'
CHIP	Chinese Pistache	<i>Pistacia chinensis</i>
GRT	Goldenrain tree	<i>Koeleruteria paniculata</i>
HL	Honey Locust	<i>Gleditsia triacanthos</i> inermis 'Shademaster'
<b>SHRUBS</b>		
BJ	Buffalo Juniper	<i>Juniperus sabin</i> 'Buffalo'
LV	Lavender	<i>Lavandula angustifolia</i> 'Mitcham Gray'
RMM	Regal Mist	<i>Muhlenbergia capillaris</i>
TRY	Texas Red Yucca	<i>Hesperaloe parviflora</i>
<b>CACTI</b>		
BLC	Bailey's Lace Cactus	<i>Echinocereus reichenbachii</i> v. baileyi
CCC	Claret Cup Cactus	<i>Echinocereus triglochidiatus</i>
NRH	New Mexico Rainbow Hedgehog	<i>Echinocereus dasyacanthus</i>
SH	Royal George Spiny Hedgehog	<i>Echinocereus coccineus</i>

#### PLANTING NOTES

1. IN CASE OF DISCREPANCY IN PLANT QUANTITIES SHOWN ON THE PLANT LIST AND THOSE SHOWN ON THE PLANTING PLAN, THE QUANTITIES SHOWN ON THE PLAN SHALL GOVERN. CONTRACTOR SHALL VERIFY ALL QUANTITIES PRIOR TO BID AND INSTALLATION. NO ADDITIONAL PAYMENT WILL BE MADE FOR DISCREPANCIES IN QUANTITIES BETWEEN THE PLANTING PLAN AND THE PLANT LIST.
2. THE CONTRACTOR SHALL PRUNE LOWER BRANCHES OF DECIDUOUS TREES TO 6 FEET ABOVE FINISH GRADE.
3. TREES SHALL BE PLANTED PER DETAIL B/ 9.
4. SHRUBS SHALL BE PLANTED PER DETAIL D/ 9.
5. CONTRACTOR SHALL PROTECT EXISTING TREES AND SHRUBS DESIGNATED TO REMAIN FROM DAMAGE DUE TO CONSTRUCTION OPERATIONS. ANY PLANT DAMAGED SHALL BE REPLACED WITH PLANT OF SAME SPECIES AND SIZE. IF SIZE IS UNAVAILABLE, CONTRACTOR SHALL PROVIDE CREDIT TO OWNER FOR VALUE OF DIFFERENCE IN SIZE.
6. GRAVEL MULCH SHALL BE A 3" DEPTH OF 1" PLUM ROSE CRUSHED GRANITE. MULCH SHALL BE PLACED OVER A CONTINUOUS LAYER OF WEED BARRIER. WEED BARRIER FABRIC SHALL BE 35 OZ. WOVEN, NEEDLE PUNCHED POLYPROPYLENE (DEWITT OR EQUAL). OVERLAP ENDS 3' AND TURN DOWN PERIMETER EDGE 6". TOP OF MULCH SHALL BE 1" BELOW THE TOP OF ADJACENT CURBS AND WALK.
7. TREES AND SHRUBS SHALL BE HAND WATERED BY THE CONTRACTOR UNTIL FINAL PROJECT ACCEPTANCE. PROVIDE ADEQUATE VOLUME OF WATER AT EACH PLANT TO THOROUGHLY SOAK THE ROOTS AND REMOVE ALL AIR POCKETS IN THE ROOT ZONE. CONTRACTOR'S WARRANTY OF THE TREES AND SHRUBS SHALL BE THROUGH FINAL PROJECT ACCEPTANCE ONLY. THE CACTUS PLANTS SHALL BE HAND WATERED ONE (1) TIME IMMEDIATELY FOLLOW INSTALLATION.
8. CONTRACTOR SHALL HAND DIG HOLES FOR TREES AND SHRUBS TO ENSURE THAT EXISTING UTILITIES ARE NOT DAMAGED DUE TO CONSTRUCTION OPERATIONS.
9. EXISTING GRAVEL MULCH AND BOULDERS IN PARKWAYS AND MEDIANS ON 5TH AND 6TH STREET SHALL REMAIN UNLESS OTHERWISE NOTED. EXISTING GRAVEL THAT IS DISTURBED DUE TO THE INSTALLATION OF BOULDERS AND PLANT MATERIAL SHALL BE RE-INSTALLED TO ITS PRE-EXISTING CONDITION. IN ALL DISTURBED AREAS THE CONTRACTOR SHALL RE-INSTALL WEED BARRIER FABRIC PER PLANTING NOTE #6 PRIOR TO RELAYING THE GRAVEL MULCH.

#### CONSTRUCTION KEYED NOTES

- 1 CONTRACTOR SHALL INSTALL 18CF TO 24CF MOSS ROCK LANDSCAPE BOULDER PER DETAIL A/ 9.
- 2 CONTRACTOR SHALL INSTALL A CONCRETE EDGER PER DETAIL E/ 9.
- 3 CONTRACTOR SHALL REMOVE EXISTING BARK MULCH AND SOIL AS REQUIRED TO INSTALL A 3" DEPTH OF GRAVEL MULCH PER PLANTING NOTE #6.
- 4 CONTRACTOR SHALL REMOVE EXISTING GRAVEL AND SOIL AS REQUIRED TO INSTALL A 3" DEPTH OF GRAVEL MULCH PER PLANTING NOTE #6.
- 5 CONTRACTOR SHALL REMOVE EXISTING ASPHALT AND SOIL AS REQUIRED TO INSTALL A 3" DEPTH OF GRAVEL MULCH PER PLANTING NOTE #6.
- 6 NOT USED.
- 7 CONTRACTOR SHALL REMOVE TWO EXISTING BOULDERS AND INSTALL 2 LARGE (24 CF - 30 CF) BOULDERS.
- 8 CONTRACTOR SHALL FURNISH AND INSTALL NEIGHBORHOOD SIGN PER DETAIL C/ 9.
- 9 CONTRACTOR SHALL REMOVE EXISTING SOIL AS REQUIRED TO INSTALL A 3" DEPTH OF GRAVEL MULCH PER PLANTING NOTE #6.

#### GENERAL DEMOLITION NOTE

CONTRACTOR SHALL PROPERLY DISPOSE OF GRAVEL, ASPHALT, SOIL AND PLANT MATERIAL THAT IS REMOVED FROM PARKWAYS AND MEDIANS IN ORDER TO INSTALL PROPOSED DESIGN.



CITY OF ALBUQUERQUE DEPARTMENT OF MUNICIPAL DEVELOPMENT CAPITAL IMPLEMENTATION PROGRAM			
TITLE: 5th and 6th STREETS STREETScape LANDSCAPE IMPROVEMENTS PLANTING PLAN			
Design Review Committee OCT 11 2005 DESIGN REVIEW COMMITTEE	City Engineer Approval OCT 11 2005 CITY ENGINEER	Mo/Day/Yr.	Mo/Day/Yr.
CITY PROJECT NO. 744392	ZONE MAP NO. H-14 & J-14	SHEET 7	OF 10





1. IN CASE OF DISCREPANCY IN PLANT QUANTITIES SHOWN ON THE PLANT LIST AND THOSE SHOWN ON THE PLANTING PLAN, THE QUANTITIES SHOWN ON THE PLAN SHALL GOVERN. CONTRACTOR SHALL VERIFY ALL QUANTITIES PRIOR TO BID AND INSTALLATION. NO ADDITIONAL PAYMENT WILL BE MADE FOR DISCREPANCIES IN QUANTITIES BETWEEN THE PLANTING PLAN, AND THE PLANT LIST.
2. THE CONTRACTOR SHALL PRUNE LOWER BRANCHES OF DECIDUOUS TREES TO 6 FEET ABOVE FINISH GRADE.
3. TREES SHALL BE PLANTED PER DETAIL B/ 9.
4. SHRUBS SHALL BE PLANTED PER DETAIL D/ 9.
5. CONTRACTOR SHALL PROTECT EXISTING TREES AND SHRUBS DESIGNATED TO REMAIN FROM DAMAGE DUE TO CONSTRUCTION OPERATIONS. ANY PLANT DAMAGED SHALL BE REPLACED WITH PLANT OF SAME SPECIES AND SIZE. IF SIZE IS UNAVAILABLE, CONTRACTOR SHALL PROVIDE CREDIT TO OWNER FOR VALUE OF DIFFERENCE IN SIZE.
6. GRAVEL MULCH SHALL BE A 3" DEPTH OF 1" PLUM ROSE CRUSHED GRANITE. MULCH SHALL BE PLACED OVER A CONTINUOUS LAYER OF WEED BARRIER FABRIC. WEED BARRIER FABRIC SHALL BE 35 OZ WOVEN, NEEDLE PUNCHED POLYPROPYLENE (DEWITT OR EQUAL). OVERLAP ENDS 3" AND TURN DOWN PERIMETER EDGE 6". TOP OF MULCH SHALL BE 1" BELOW THE TOP OF ADJACENT CURBS AND WALK.
7. TREES AND SHRUBS SHALL BE HAND WATERED BY THE CONTRACTOR UNTIL FINAL PROJECT ACCEPTANCE. PROVIDE ADEQUATE VOLUME OF WATER AT EACH PLANT TO THOROUGHLY SOAK THE ROOTS AND REMOVE ALL AIR POCKETS IN THE ROOT ZONE. CONTRACTOR'S WARRANTY OF THE TREES AND SHRUBS SHALL BE THROUGH FINAL PROJECT ACCEPTANCE ONLY. THE CACTUS PLANTS SHALL BE HAND WATERED ONE (1) TIME IMMEDIATELY FOLLOW INSTALLATION.
8. CONTRACTOR SHALL HAND DIG HOLES FOR TREES AND SHRUBS TO ENSURE THAT EXISTING UTILITIES ARE NOT DAMAGED DUE TO CONSTRUCTION OPERATIONS.
9. EXISTING GRAVEL MULCH AND BOULDERS IN PARKWAYS AND MEDIANS ON 5TH AND 6TH STREET SHALL REMAIN UNLESS OTHERWISE NOTED. EXISTING GRAVEL THAT IS DISTURBED DURING THE INSTALLATION OF BOULDERS AND PLANT MATERIAL SHALL BE RE-INSTALLED TO ITS PRE-EXISTING CONDITION. IN ALL DISTURBED AREAS THE CONTRACTOR SHALL RE-INSTALL WEED BARRIER FABRIC PER PLANTING NOTE 16 PRIOR TO RELAYING THE GRAVEL MULCH.

- (1) CONTRACTOR SHALL INSTALL 18CF TO 24CF 'MOSS ROCK' LANDSCAPE BOULDER PER DETAIL A/ 9.
- (2) CONTRACTOR SHALL INSTALL A CONCRETE EDGER PER DETAIL E/ 9.
- (3) CONTRACTOR SHALL REMOVE EXISTING BARK MULCH AND SOIL AS REQUIRED TO INSTALL A 3" DEPTH OF GRAVEL MULCH PER PLANTING NOTE %.
- (4) CONTRACTOR SHALL REMOVE EXISTING GRAVEL AND SOIL AS REQUIRED TO INSTALL A 3" DEPTH OF GRAVEL MULCH PER PLANTING NOTE %.
- (5) CONTRACTOR SHALL REMOVE EXISTING ASPHALT AND SOIL AS REQUIRED TO INSTALL A 3" DEPTH OF GRAVEL MULCH PER PLANTING NOTE %.
- (6) NOT USED.
- (7) CONTRACTOR SHALL REMOVE TWO EXISTING BOULDERS AND INSTALL 2 LARGE ( 24 CF - 30 CF ) BOULDERS.
- (8) CONTRACTOR SHALL FURNISH AND INSTALL NEIGHBORHOOD SIGN PER DETAIL C/ 9.
- (9) CONTRACTOR SHALL REMOVE EXISTING SOIL AS REQUIRED TO INSTALL A 3" DEPTH OF GRAVEL MULCH PER PLANTING NOTE %.

CONTRACTOR SHALL PROPERLY DISPOSE OF GRAVEL, ASPHALT, SOIL AND PLANT MATERIAL THAT IS REMOVED FROM PARKWAYS AND MEDIANS IN ORDER TO INSTALL PROPOSED DESIGN.

10. CONTRACTOR SHALL INSTALL STANDARD GRAY 4000 PSI CONCRETE SIDEWALK PER C.O.A. DRAWING # 2430. REMOVE DIRT AS NECESSARY TO INSTALL SIDEWALK. TOP OF FRONT FACE OF SIDEWALK SHALL BE FLUSH WITH TOP OF CURB. PROVIDE A 2% CROSS SLOPE ON SIDEWALK.
11. CONTRACTOR SHALL REMOVE 6" CONCRETE CURB PRIOR TO INSTALLATION OF SIDEWALK.
12. CONTRACTOR SHALL REMOVE WOOD BOLLARD PRIOR TO THE INSTALLATION OF PROPOSED SIDEWALK.
13. CONTRACTOR SHALL REMOVE EXISTING SOIL AND INSTALL A 3" DEPTH OF GRAVEL MULCH PER PLANTING NOTE #6 IN PARKWAY THAT IS CREATED BY THE INSTALLATION OF PROPOSED SIDEWALK.

IF ADDITIVE ALTERNATE IS ACCEPTED PROPOSED 6" CONCRETE CURB NOTED IN  
BASE BID AT FRONT OF SIDEWALK SHALL BE DELETED WHERE PROPOSED  
SIDEWALK IS INSTALLED.

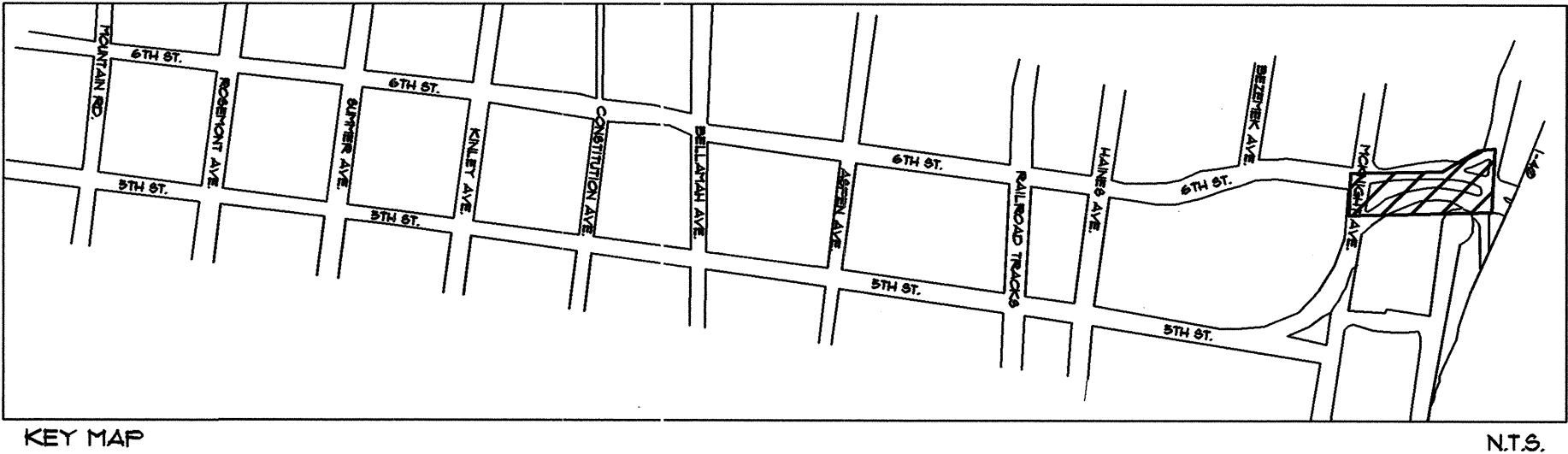

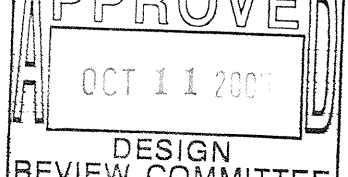
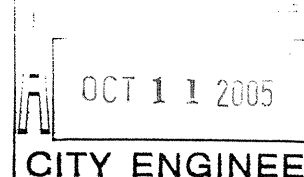
<p align="center"><b>CITY OF ALBUQUERQUE</b>  <b>DEPARTMENT OF MUNICIPAL DEVELOPMENT</b>  <b>CAPITAL IMPLEMENTATION PROGRAM</b></p>				
<p><b>TITLE: 5th AND 6th STREETS STREETSCAPE          LANDSCAPE IMPROVEMENTS          PLANTING PLAN</b></p>				
<p>Design Review Committee</p> 		<p>City Engineer Approval</p> 		<p>Mo./Day/Yr.</p>
<p>CITY PROJECT NO.</p> <p align="center"><b>744392</b></p>		<p>ZONE MAP NO.</p> <p align="center"><b>H-14 &amp; J-14</b></p>		<p>SHEET</p> <p align="center"><b>8</b></p>
				<p>OF</p> <p align="center"><b>10</b></p>



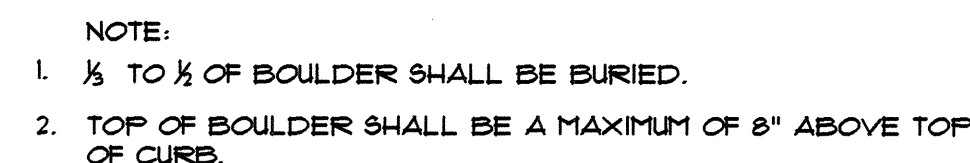

## Boulder-Installation Diagram

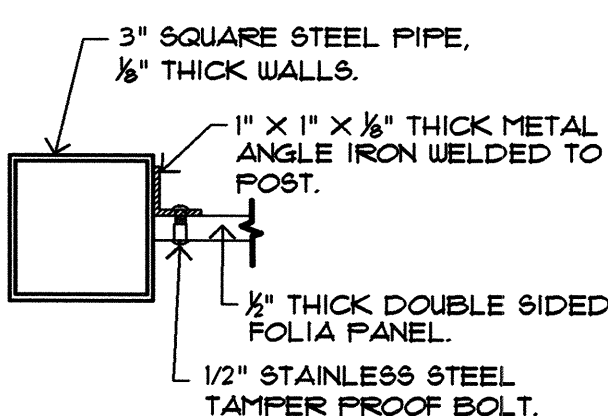

PLAN VIEW A

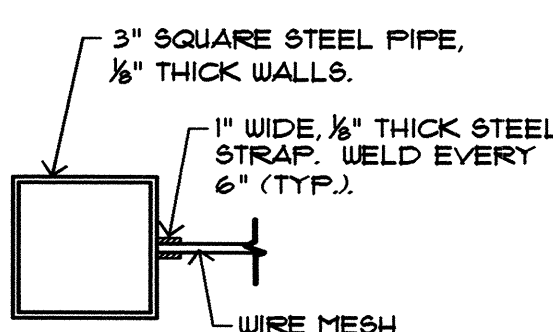

PLAN VIEW B

- 1 EXISTING SIDEWALK.
- 2 EXISTING CURB AND GUTTER
- 3 EXISTING ASPHALT PAVING.
- 4 3" SQUARE STEEL PIPE, 1/2" THICK WALLS. PAINT FRAME WITH 2 COATS OF SHERWIN-WILLIAMS INDUSTRIAL ENAMEL. COLOR: BLACK
- 5 STEEL WELDED WIRE MESH WITH 2" SQUARE OPENINGS. WIRE SHALL BE #32 GAUGE. PAINT WIRE MESH WITH 2 COATS OF SHERWIN-WILLIAMS INDUSTRIAL ENAMEL. COLOR: BLACK
- 6 1" WIDE, 1/2" THICK STEEL STRAP ONE ON EACH SIDE OF WIRE MESH SEE PLAN VIEW B. PAINT STRAP WITH 2 COATS OF SHERWIN-WILLIAMS INDUSTRIAL ENAMEL. COLOR: THERMAL ORANGE, MODEL # 8U4033.
- 7 24" X 36" X 1/4" THICK DOUBLE-SIDED "FOLIA" EMBEDDED GRAPHIC PANEL (TWO 1/4" EXTERIOR GRADE PANELS GLUED BACK TO BACK). AVAILABLE FROM FOLIA 450-264-6122. THERE WILL BE A DIFFERENT GRAPHIC ON EACH SIDE OF SIGN. LANDSCAPE ARCHITECT WILL PROVIDE ELECTRONIC FILE OF GRAPHICS TO BE PRINTED ON PANELS.
- 8 4000 PSI CONCRETE FOOTING.
- 9 1" X 1" X 1/8" THICK METAL ANGLE IRON. SEE PLAN VIEW A. PAINT METAL ANGLE IRON WITH 2 COATS OF SHERWIN-WILLIAMS INDUSTRIAL ENAMEL. COLOR: BLACK
- 10 3" X 3" X 1/8" STEEL CAP WITH DECORATIVE BALL AT TOP. PAINT CAP WITH 2 COATS OF SHERWIN-WILLIAMS INDUSTRIAL ENAMEL. COLOR: BLACK
- 11 95% COMPACTED SUBGRADE.
- 12 EXISTING SUBGRADE NOT TO BE DISTURBED.
- 13 1" DIAMETER PVC PIPE.

**NOTE:**  
WELD AND GRIND SMOOTH ALL JOINTS. PRIME THE FABRICATED PIECES COMPLETELY WITH SHERWIN-WILLIAMS RED OXIDE PRIMER.

N-SIGN 052504

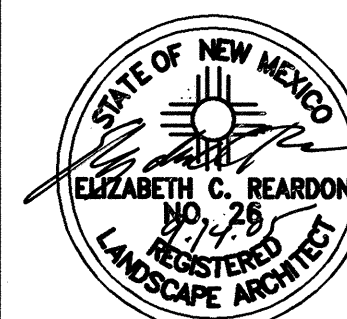

CONCRETE  
MCD-0024 110895

[illegible]

DESIGNED BY		JSP		DATE: 9/14/05	
DRAWN BY		JSP		DATE: 9/14/05	
REVISIONS					
DESIGN					
NO.	DATE	REMARKS	BY		



**MORROW  
REARDON  
WILKINSON, LTD.,  
LANDSCAPE ARCHITECTS**

210 La Veta N.E., Albuquerque, NM 87108  
505.268.2266 FAX 505.265.9637

[mrw@mrwnm.com](mailto:mrw@mrwnm.com)

CITY OF ALBUQUERQUE  
DEPARTMENT OF MUNICIPAL DEVELOPMENT  
CAPITAL IMPLEMENTATION PROGRAM

**TITLE: 5th AND 6th STREETS STREETSCAPE  
LANDSCAPE IMPROVEMENTS  
IRRIGATION PLAN**

[illegible]

CITY PROJECT NO.	744392	ZONE MAP NO.	H-14 & J-14	SHEET	9	OF	10
------------------	--------	--------------	-------------	-------	---	----	----



