

LEGEND

MATERIALS

CONCRETE
RIP-RAP

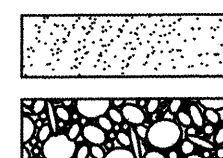

LINES

SUBDIVISION BOUNDARY
PROPERTY LINE (PLAN)
PROPERTY LINE (SECTION)
CENTERLINE
EASEMENT LINE
MATCH LINE
SECTION CUT LINE

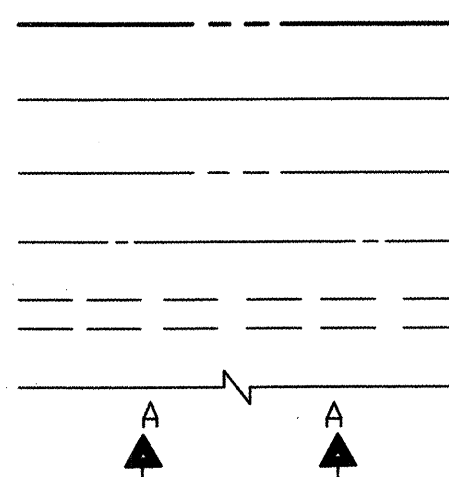

EARTHWORK

CONTOUR LINE
SPOT ELEVATION
PROJECT / PHASE BOUNDARY
FLOWLINE
DIRECTION OF FLOW

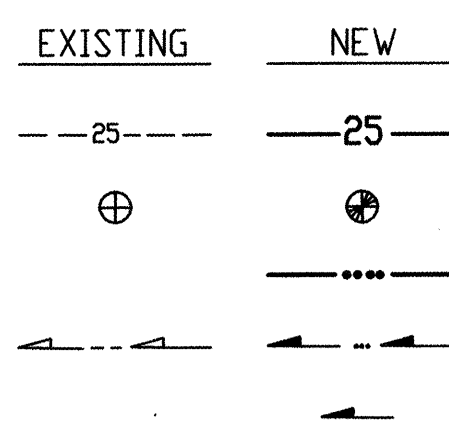

MISCELLANEOUS UTILITIES

GAS LINE
UNDERGROUND TELEPHONE
UNDERGROUND ELECTRICAL
STORM DRAIN
STORM DRAIN MANHOLE
STORM DRAIN INLET

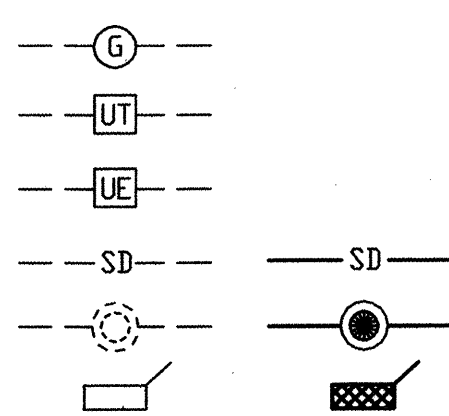

SANITARY SEWER

SANITARY SEWER LINE
SANITARY SEWER MANHOLE
SAS SERVICE CONNECTIONS
SAS CAP OR PLUG
ENCASEMENT

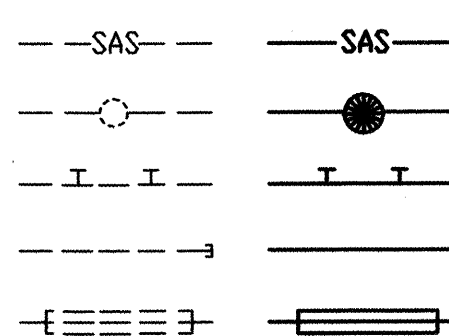

WATER

WATER LINE
WATER SERVICE CONNECTIONS
GATE VALVE
FIRE HYDRANT
BUTTERFLY VALVE
REDUCER
WATER PRESSURE ZONE BOUNDARY

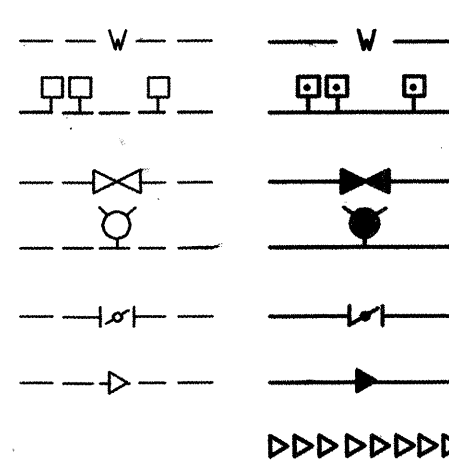

WATER FITTINGS

CAPS AND PLUGS
ELBOW
CROSS
TEE

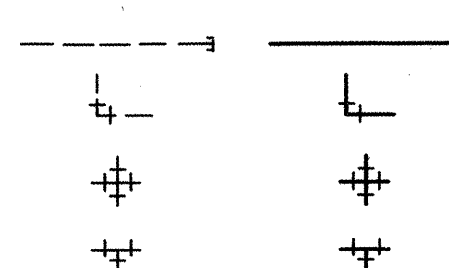

MISCELLANEOUS

CHAINLINK FENCE
FIELD FENCE
COMMON YARD WALL
RETAINING WALL
POWER OR TELEPHONE POLE

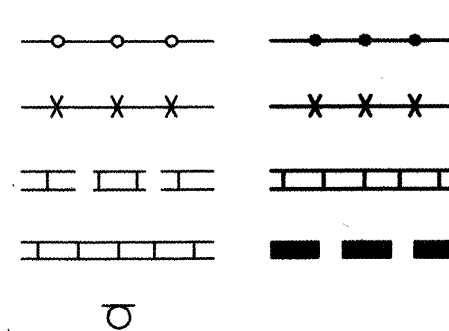

RECORD DRAWING

CONSTRUCTION PLANS

for

NAVAJO ELEMENTARY SCHOOL PUBLIC WATER LINE EXTENSION AND FIRE HYDRANT INSTALLATIONS

BERNALILLO COUNTY, NEW MEXICO

AUGUST, 2004

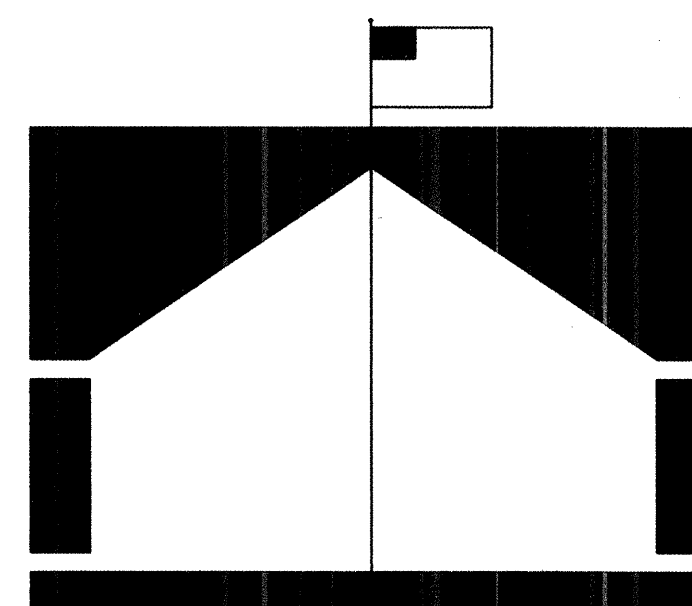

INDEX OF DRAWINGS

SHEET	DESCRIPTION
1	COVER SHEET, VICINITY MAP, GENERAL NOTES, LEGEND AND INDEX OF DRAWINGS
2	EASEMENT SURVEY
3	GRADING PLAN (NOT PART OF WORK ORDER)
4	SITE PLAN
5	WATER LINE EXTENSION PLAN & PROFILE STA 10+17.37 TO STA 13+00.31
6	WATER LINE EXTENSION PLAN & PROFILE STA 13+00.31 TO STA 16+63.68
7	WATER VALVE SHUTOFF PLAN; SECTIONS AND DETAILS

CERTIFICATE OF SUBSTANTIAL COMPLIANCE

I, J. GRAEME MEANS, NMPE 13676, OF THE FIRM JEFF MORTENSEN & ASSOCIATES, INC., HEREBY CERTIFY THAT THE INFRASTRUCTURE CONSTRUCTED AS PART OF THIS PROJECT HAS BEEN INSPECTED BY ME OR PERSONNEL UNDER MY DIRECT SUPERVISION AND, TO THE BEST OF MY KNOWLEDGE AND BELIEF, HAS BEEN CONSTRUCTED IN ACCORDANCE WITH THE PLANS AND SPECIFICATIONS AND THE ORIGINAL DESIGN INTENT OF THE CITY ENGINEER APPROVED PLANS. THE RECORD INFORMATION EDITED ONTO THIS ORIGINAL DESIGN DOCUMENT HAS BEEN OBTAINED BY OR UNDER MY DIRECT SUPERVISION AND IS TRUE AND CORRECT TO THE BEST OF MY KNOWLEDGE AND BELIEF. THIS RECORD INFORMATION IS NOT NECESSARILY COMPLETE AND INTENDED ONLY TO VERIFY SUBSTANTIAL COMPLIANCE OF THE DESIGN INTENT OF THIS PROJECT. THOSE RELYING ON THIS DOCUMENT ARE ADVISED TO OBTAIN INDEPENDENT VERIFICATION OF ITS ACCURACY BEFORE USING IT FOR ANY OTHER PURPOSE. THIS CERTIFICATION IS SUBMITTED IN SUPPORT OF A REQUEST FOR ACCEPTANCE OF THE PROJECT BY THE CITY ENGINEER.

J. Graeme Means
J. GRAEME MEANS, NMPE 13676
01/31/2005
DATE

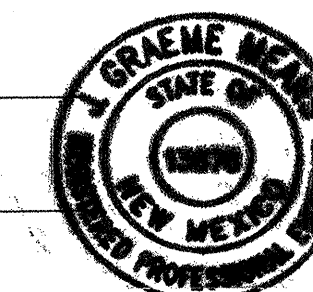

APPROVED AS RECORD DRAWINGS
DESIGN REVIEW SECTION
CITY ENGINEER
DATE: 8/25/05

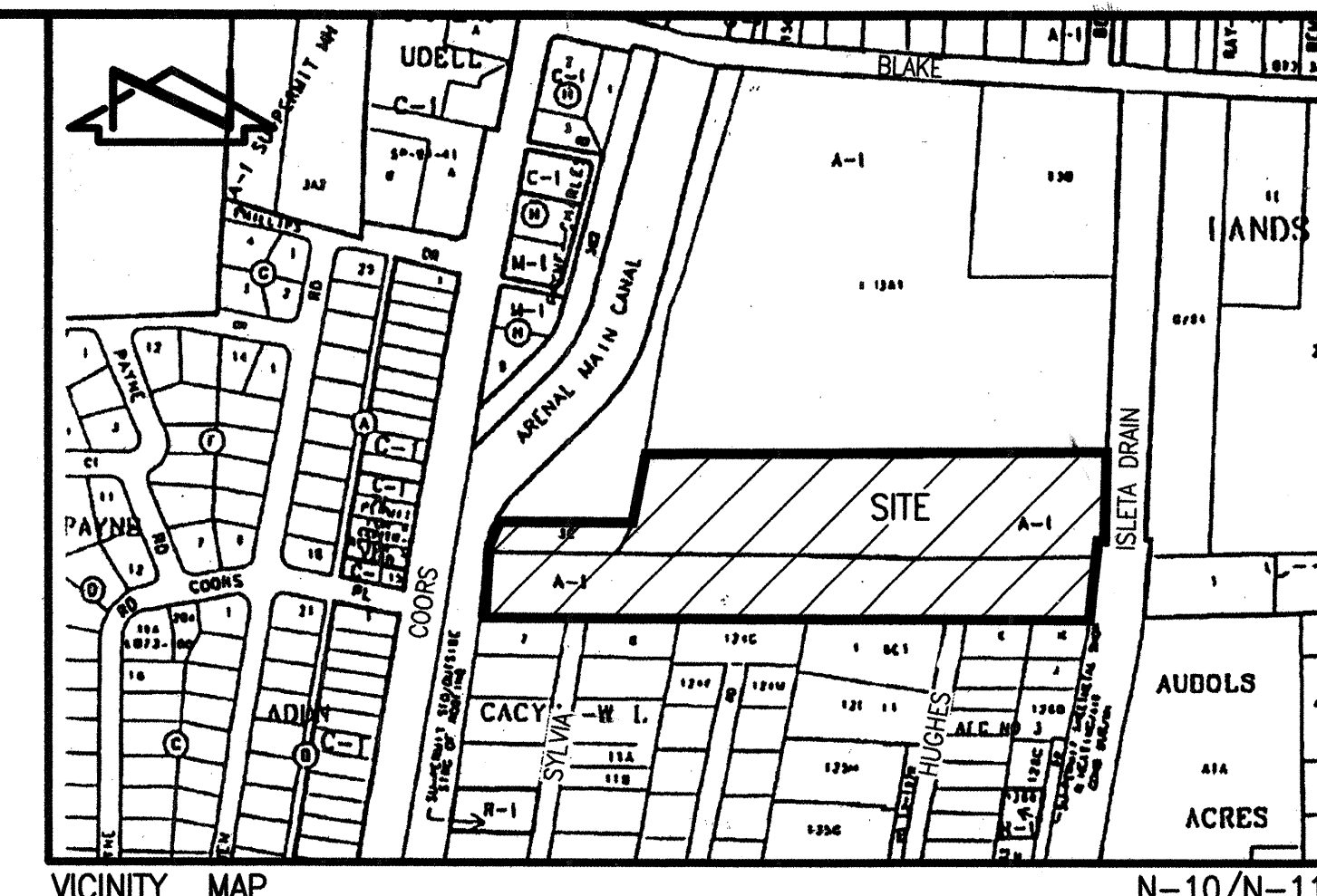

VICINITY MAP
SCALE: 1" = 750'

GENERAL NOTES:





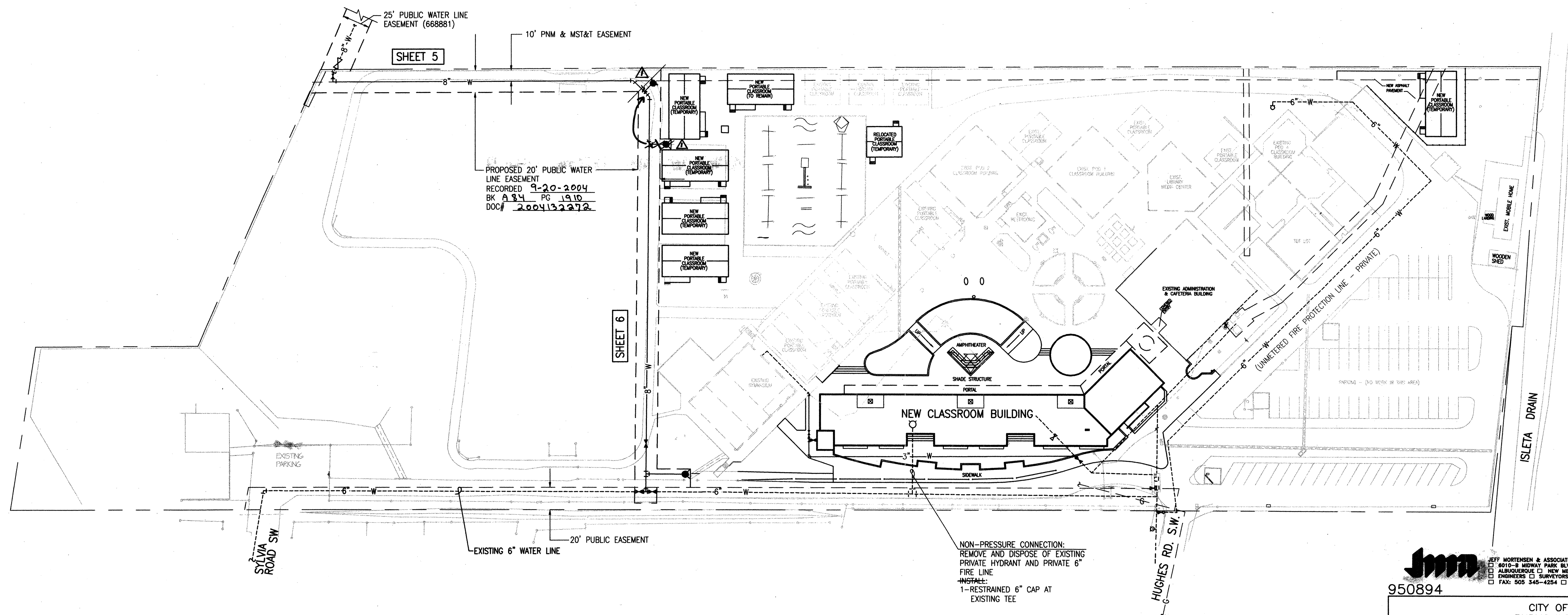
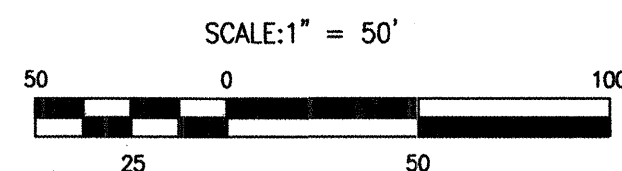

- ALL WORK DETAILED ON THESE PLANS TO BE PERFORMED UNDER CONTRACT SHALL, EXCEPT AS OTHERWISE STATED OR PROVIDED FOR HEREON, BE CONSTRUCTED IN ACCORDANCE WITH THE CITY OF ALBUQUERQUE STANDARD SPECIFICATIONS-PUBLIC WORKS CONSTRUCTION-1986 - UPDATE NO. 7, OR BERNALILLO COUNTY STANDARDS, WHICHEVER ARE MORE STRINGENT.
- TWO (2) WORKING DAYS PRIOR TO ANY EXCAVATION, CONTRACTOR MUST CONTACT NEW MEXICO ONE CALL SYSTEM, 260-1990, (ALBUQUERQUE AREA) 1-800-321-ALERT (2537) (STATEWIDE) FOR LOCATION OF EXISTING UTILITIES AND APS MAINTENANCE & OPERATIONS (765-5950) FOR LOCATION OF EXISTING PRIVATE UTILITIES.
- IF ANY UTILITY LINES, PIPELINES, OR UNDERGROUND UTILITY LINES ARE SHOWN ON THESE DRAWINGS, THEY ARE SHOWN IN AN APPROXIMATE MANNER ONLY, AND SUCH LINES MAY EXIST WHERE NONE ARE SHOWN. IF ANY SUCH EXISTING LINES ARE SHOWN, THE LOCATION IS BASED UPON INFORMATION PROVIDED BY THE OWNER OF SAID UTILITY, AND THE INFORMATION MAY BE INCOMPLETE, OR MAY BE OBSOLETE BY THE TIME CONSTRUCTION COMMENCES. THE ENGINEER HAS CONDUCTED ONLY PRELIMINARY INVESTIGATION OF THE LOCATION, DEPTH, SIZE, OR TYPE OF EXISTING UTILITY LINES, PIPELINES, OR UNDERGROUND UTILITY LINES. THIS INVESTIGATION IS NOT CONCLUSIVE, AND MAY NOT BE COMPLETE, THEREFORE, MAKES NO REPRESENTATION PERTAINING THERETO, AND ASSUMES NO RESPONSIBILITY OR LIABILITY THEREFOR. THE CONTRACTOR SHALL INFORM ITSELF OF THE LOCATION OF ANY UTILITY LINE, PIPELINE, OR UNDERGROUND UTILITY LINE IN OR NEAR THE AREA OF THE WORK IN ADVANCE OF AND DURING EXCAVATION WORK. THE CONTRACTOR IS FULLY RESPONSIBLE FOR ANY AND ALL DAMAGE CAUSED BY ITS FAILURE TO LOCATE, IDENTIFY AND PRESERVE ANY AND ALL EXISTING UTILITIES, PIPELINES, AND UNDERGROUND UTILITY LINES. IN PLANNING AND CONDUCTING EXCAVATION, THE CONTRACTOR SHALL COMPLY WITH STATE STATUTES, MUNICIPAL AND LOCAL ORDINANCES, RULES AND REGULATIONS, IF ANY, PERTAINING TO THE LOCATION OF THESE LINES AND FACILITIES.
- SHOULD A CONFLICT EXIST BETWEEN THESE PLANS AND ACTUAL FIELD CONDITIONS, THE CONTRACTOR SHALL PROMPTLY NOTIFY THE ENGINEER IN WRITING SO THAT THE CONFLICT CAN BE RESOLVED WITH A MINIMUM AMOUNT OF DELAY FOR ALL PARTIES.
- THE CONTRACTOR SHALL MAINTAIN ACCESS TO ADJACENT PROPERTIES DURING CONSTRUCTION.
- ALL WORK ON THIS PROJECT SHALL BE PERFORMED IN ACCORDANCE WITH APPLICABLE FEDERAL, STATE AND LOCAL LAWS, RULES AND REGULATIONS CONCERNING SAFETY AND HEALTH.
- ALL UTILITIES AND UTILITY SERVICE LINES SHALL BE INSTALLED PRIOR TO PAVING.
- BACKFILL COMPACTION SHALL BE ACCORDING TO SPECIFIED STREET USE.
- TACK COAT REQUIREMENTS SHALL BE DETERMINED DURING CONSTRUCTION BY THE PROJECT ENGINEER.
- SIDEWALKS AND WHEELCHAIR RAMPS WITHIN THE CURB RETURNS SHALL BE CONSTRUCTED WHEREVER A NEW CURB RETURN IS CONSTRUCTED.
- IF CURB IS DEEPER FOR A DRIVEPAD OR A HANDICAP RAMP, THE DRIVEPAD OR RAMP SHALL BE CONSTRUCTED PRIOR TO ACCEPTANCE OF THE CURB AND GUTTER.
- ALL STORM DRAINAGE FACILITIES SHALL BE COMPLETED PRIOR TO FINAL ACCEPTANCE.
- CONTRACTOR SHALL COORDINATE WITH THE WATER SYSTEM DIVISION FOR THE EXECUTION OF THE VALVE SHUT OFF PLANS; NOT LESS THAN SEVEN (7) WORKING DAYS IN ADVANCE OF ANY WORK THAT MAY AFFECT THE EXISTING PUBLIC WATER UTILITIES. ONLY WATER SYSTEM DIVISION PERSONNEL SHALL OPERATE EXISTING VALVES. REFER TO SECTION 18 OF THE SPECIFICATIONS. THE WATER SYSTEM DIVISION PHONE NUMBER IS 857-8200.
- CONTRACTOR SHALL NOTIFY THE CITY SURVEYOR NOT LESS THAN SEVEN (7) DAYS PRIOR TO STARTING WORK IN ORDER THAT THE CITY SURVEYOR MAY TAKE NECESSARY MEASURES TO INSURE THE PRESERVATION OF SURVEY MONUMENTS. CONTRACTOR SHALL NOT DISTURB PERMANENT SURVEY MONUMENTS WITHOUT THE CONSENT OF THE CITY SURVEYOR AND SHALL NOTIFY THE CITY SURVEYOR AND BEAR THE EXPENSE OF REPLACING ANY THAT MAY BE DISTURBED WITHOUT PERMISSION. REPLACEMENT SHALL BE DONE ONLY BY THE CITY SURVEYOR. WHEN A CHANGE IS MADE IN THE FINISHED ELEVATION OF THE PAVEMENT OF ANY ROADWAY IN WHICH A PERMANENT SURVEY MONUMENT IS LOCATED, CONTRACTOR SHALL, AT HIS OWN EXPENSE, ADJUST THE MONUMENT COVER TO THE NEW GRADE UNLESS OTHERWISE SPECIFIED. REFER TO SECTION 4.4 OF THE SPECIFICATIONS.
- FIVE (5) WORKING DAYS PRIOR TO BEGINNING CONSTRUCTION THE CONTRACTOR SHALL SUBMIT TO THE TRAFFIC CONTROL DIVISION A DETAILED CONSTRUCTION SCHEDULE. TWO (2) WORKING DAYS PRIOR TO CONSTRUCTION THE CONTRACTOR SHALL OBTAIN A BARRICADING PERMIT FROM THE TRAFFIC CONTROL DIVISION. CONTRACTOR SHALL NOTIFY TRAFFIC CONTROL MANAGER (848-1543) PRIOR TO OCCUPYING AN INTERSECTION.
- ALL STREET STRIPING ALTERED OR DESTROYED SHALL BE REPLACED WITH PLASTIC REFLECTORIZED STRIPING BY CONTRACTOR TO EXISTING LOCATION OR AS INDICATED BY THIS PLAN SET.
- CAUTION: THESE DRAWINGS DO NOT INCLUDE NECESSARY COMPONENTS FOR CONSTRUCTION SAFETY WHICH SHALL REMAIN THE RESPONSIBILITY OF THE CONTRACTOR. ALL EXCAVATION, TRENCHING AND SHORING ACTIVITIES MUST BE CARRIED-OUT IN ACCORDANCE WITH OSHA 29 CFR 1926, SUBPART P-EXCAVATIONS.
- ANY WORK OCCURRING WITHIN AN ARTERIAL ROADWAY REQUIRES TWENTY-FOUR HOUR CONSTRUCTION.
- CONTRACTOR SHALL MAINTAIN A GRAFFITI-FREE WORK SITE. CONTRACTOR SHALL PROMPTLY REMOVE ANY AND ALL GRAFFITI FROM EQUIPMENT, WHETHER PERMANENT OR TEMPORARY.
- THIS PROJECT IS TO BE CONSTRUCTED UNDER, AND IS SUBJECT TO THE TERMS AND CONDITIONS OF THE MASTER UTILITY EASEMENT AND RIGHT-OF-WAY AGREEMENT ENTERED INTO BETWEEN THE COUNTY OF BERNALILLO AND THE CITY OF ALBUQUERQUE EFFECTIVE DATE 08/20/90.
- WHEN APPLICABLE, CONTRACTOR SHALL SECURE "TOPSOIL DISTURBANCE PERMIT" FROM THE CITY AND/OR FILE A NOTICE OF INTENT (N.O.I.) WITH THE EPA PRIOR TO BEGINNING CONSTRUCTION.

950894

REV.	SHEETS	CITY ENGINEER	DATE	USER DEPARTMENT	DATE	USER DEPARTMENT	DATE
1-7							
ENGINEERS STAMP & SIGNATURE		APPROVALS		ENGINEER		DATE	
J. GRAEME MEANS		J. GRAEME MEANS		J. GRAEME MEANS		8/19/2004	
CITY ENGINEER		CITY ENGINEER		CITY ENGINEER		8/19/2004	
CITY PROJECT NO.		744581		SHEET		1 OF 7	

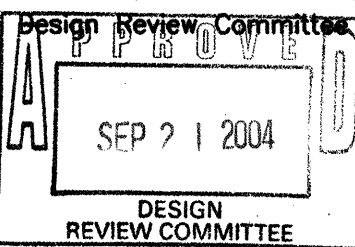
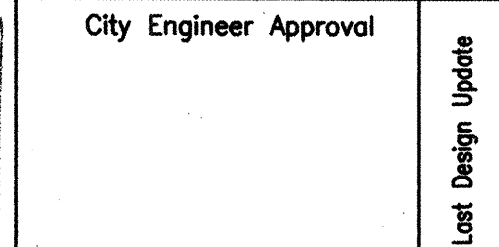
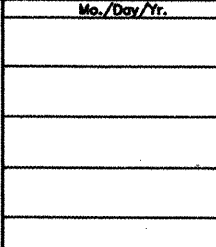

SEE SHEET 1 FOR CERTIFICATION

	JEFF WORTEN & ASSOCIATES, INC. 6010-S MIDWAY PARK BLVD. N.E. ALBUQUERQUE □ NEW MEXICO 87109 ENGINEERS □ SURVEYORS (360) 345-4250 FAX: (505) 345-4254 □ ESTABLISHED 1977						
		950894	DME	NO.	Designed By	Drawn By	Checked By
CITY OF ALBUQUERQUE PUBLIC WORKS DEPARTMENT ENGINEERING DEVELOPMENT GROUP							
TITLE: NAVAJO ELEMENTARY SCHOOL PUBLIC WATER LINE EXTENSION AND FIRE HYDRANT INSTALLATIONS SITE PLAN							
Design Review Committee 	City Engineer Approval 	Last Design Update 	Mr./Mrs./Mr.	Mr./Mrs./Mr.	Sheet 4 Of 7		
City Project No. 744581	Zone Map No. N10/N11						

<u>△</u>	<u>01/05</u>	<u>RECORD DRINGS.</u>	<u>TEN</u>	ENGINEER'S SEAL 	SURVEY INFORMATION	BENCH MARKS	AS BUILT INFORMATION
No.	Date	Remarks	By	Feld Notes	STATION IS A 3 1/4" ALUMINUM TABLET STAMPED "ACS, B-NIT, 1983". SET IN CONCRETE 0.1' BELOW ASPHALT PAVEMENT IN INTERSECTION OF BARCELONA ROAD AND COUNTRY VIEW ROAD. ELEVATION = 4927.384 FEET (NGVD 1929)		<u>CONTRACTOR</u> <u>DUNLAP P&T MECHANICAL</u> <u>WORK STARTED BY</u> <u>JMA</u> <u>ASSISTANCE BY</u> <u>TEN</u> <u>FIELD VERIFICATION BY</u> <u>RLE</u> <u>CHECKED BY</u> <u>JMA</u>
Designed By J.C.M.							<u>MICRO-FILM INFORMATION</u> <u>RECORDED BY</u> _____ <u>N.L.</u> _____
Drawn By ACAD							
Checked By J.C.M.							

File Path: E:\JMA\NORTH\150004
File Name: 950894INF00.DWG
Plot Date: 08-10-2004
Plot Time: 1:32 pm

CONSTRUCTION NOTES:

1. TWO (2) WORKING DAYS PRIOR TO ANY EXCAVATION, CONTRACTOR MUST CONTACT NEW MEXICO ONE CALL SYSTEM 260-1990 (ALBUQUERQUE AREA), 1-800-321-ALERT(2537) (STATEWIDE), FOR LOCATION OF EXISTING UTILITIES.
2. PRIOR TO CONSTRUCTION, THE CONTRACTOR SHALL EXCAVATE AND VERIFY THE HORIZONTAL AND VERTICAL LOCATION OF ALL POTENTIAL OBSTRUCTIONS. SHOULD A CONFLICT EXIST, THE CONTRACTOR SHALL NOTIFY THE ENGINEER IN WRITING SO THAT THE CONFLICT CAN BE RESOLVED WITH A MINIMUM AMOUNT OF DELAY. THE CONTRACTOR SHALL BE RESPONSIBLE FOR ALL INTERPRETATIONS IT MAKES WITHOUT FIRST CONTACTING THE ENGINEER AS REQUIRED ABOVE.
3. ALL WORK ON THIS PROJECT SHALL BE PERFORMED IN ACCORDANCE WITH APPLICABLE FEDERAL, STATE AND LOCAL LAWS, RULES AND REGULATIONS CONCERNING CONSTRUCTION SAFETY AND HEALTH.
4. ALL CONSTRUCTION WITHIN PUBLIC RIGHT-OF-WAY SHALL BE PERFORMED IN ACCORDANCE WITH APPLICABLE BERNALILLO COUNTY STANDARDS AND PROCEDURES.
5. IF ANY UTILITY LINES, PIPELINES, OR UNDERGROUND UTILITY LINES ARE SHOWN ON THESE DRAWINGS, THEY ARE SHOWN IN AN APPROXIMATE MANNER ONLY, AND SUCH LINES MAY EXIST WHERE NONE ARE SHOWN. IF ANY SUCH EXISTING LINES ARE SHOWN, THE LOCATION IS BASED UPON INFORMATION PROVIDED BY THE OWNER OF SAID UTILITY, AND THE INFORMATION MAY BE INCOMPLETE, OR MAY BE OBSOLETE BY THE TIME CONSTRUCTION COMMENCES. THE ENGINEER HAS CONDUCTED ONLY PRELIMINARY INVESTIGATION OF THE LOCATION, DEPTH, SIZE, OR TYPE OF EXISTING UTILITY LINES, PIPELINES, OR UNDERGROUND UTILITY LINES. THIS INVESTIGATION IS NOT CONCLUSIVE, AND MAY NOT BE COMPLETE, THEREFORE, MAKES NO REPRESENTATION PERTAINING THERETO, AND ASSUMES NO RESPONSIBILITY OR LIABILITY THEREFOR. THE CONTRACTOR SHALL INFORM ITSELF OF THE LOCATION OF ANY UTILITY LINE, PIPELINE, OR UNDERGROUND UTILITY LINE IN OR NEAR THE AREA OF THE WORK IN ADVANCE OF AND DURING EXCAVATION WORK. THE CONTRACTOR IS FULLY RESPONSIBLE FOR ANY AND ALL DAMAGE CAUSED BY ITS FAILURE TO LOCATE, IDENTIFY AND PRESERVE ANY AND ALL EXISTING UTILITIES, PIPELINES, AND UNDERGROUND UTILITY LINES. IN PLANNING AND CONDUCTING EXCAVATION, THE CONTRACTOR SHALL COMPLY WITH STATE STATUTES, MUNICIPAL AND LOCAL ORDINANCES, RULES AND REGULATIONS, IF ANY, PERTAINING TO THE LOCATION OF THESE LINES AND FACILITIES.
6. THE DESIGN OF PLANTERS AND LANDSCAPED AREAS IS NOT PART OF THIS PLAN. ALL PLANTERS AND LANDSCAPED AREAS ADJACENT TO THE BUILDING(S) SHALL BE PROVIDED WITH POSITIVE DRAINAGE TO AVOID ANY PONDING ADJACENT TO THE STRUCTURE. FOR CONSTRUCTION DETAILS, REFER TO LANDSCAPING PLAN.

EROSION CONTROL MEASURES:

1. THE CONTRACTOR SHALL ENSURE THAT NO SOIL ERODES FROM THE SITE INTO PUBLIC RIGHT-OF-WAY OR ONTO PRIVATE PROPERTY.
2. THE CONTRACTOR SHALL PROMPTLY CLEAN UP ANY MATERIAL EXCAVATED WITHIN THE PUBLIC RIGHT-OF-WAY SO THAT THE EXCAVATED MATERIAL IS NOT SUSCEPTIBLE TO BEING WASHED DOWN THE STREET.
3. WHEN APPLICABLE, CONTRACTOR SHALL SECURE "TOPSOIL DISTURBANCE PERMIT" FROM THE CITY AND/OR FILE A NOTICE OF INTENT (N.O.I.) WITH THE EPA PRIOR TO BEGINNING CONSTRUCTION.
4. UNLESS FINAL STABILIZATION IS OTHERWISE PROVIDED FOR, ANY AREAS OF EXCESS DISTURBANCE (TRAFFIC ACCESS, STORAGE YARD, EXCAVATED MATERIAL, ETC.) SHALL BE RE-SEEDING ACCORDING TO C.O.A. SPECIFICATION 1012 "NATIVE GRASS SEEDING". THIS WILL BE CONSIDERED INCIDENTAL TO CONSTRUCTION, THEREFORE, NO SEPARATE PAYMENT WILL BE MADE.

LEGEND AND KEYED NOTES

ASV	ANTI-SIPHON VALVE	SAS BY PM	SANITARY SEWER BY PAINT MARK
B/OH	BUILDING OVERHANG	SCB	SPRINKLER CONTROL BOX
BW	BARBED WIRE	SD	STORM DRAIN
CATVR	CABLE TELEVISION RISER	SDP	SERVICE DROP POLE
CBC	CONCRETE BUILDING COLUMN	SW	SIDEWALK
CLD	CENTERLINE OF DOOR	SWC	SIDEWALK CULVERT
CLDD	CENTERLINE OF DOUBLE DOOR	TA	TOP OF ASPHALT
CLF	CHAINLINK FENCE	TCO	TOP OF CONCRETE
CMP	CORRUGATED METAL PIPE	TG	TOP OF GRATE
CO	SANITARY SEWER CLEAN-OUT	TP	TOP OF PIPE
CPTR	CONCRETE PLANTER	TR	TELEPHONE RISER
CR	CONCRETE RAMP	TS	TRAFFIC SIGN
CSW	CONCRETE SIDEWALK	U/GT	UNDERGROUND TELEPHONE
CT	CONIFEROUS TREE	VG	VALLEY GUTTER
CWCR	CONCRETE WHEELCHAIR RAMP	W BY PM	WATER LINE BY PAINT MARK
DCO	SANITARY SEWER DOUBLE CLEAN-OUT	W	WITH
EA	EDGE OF ASPHALT	W/FN	WOOD FENCE
ECOND	ELECTRIC CONDUIT	WLP	WOOD LIGHT POLE
EM	ELECTRIC METER	WMB	WOOD METER BOX
EMST	ELECTRIC MAST	WPP	WOOD POWER POLE
END FN	END OF FENCE	WPP/C	WOOD POWER POLE WITH CONDUIT
EP	ELECTRIC PANEL	WPP/B	WOOD PLANTER WITH BENCH
EPB	ELECTRIC PULLBOX	WVB/OC	WATER VALVE BOX ON CONCRETE
EVLT	ELECTRIC VAULT	WVLT	WATER VAULT
F.F.	FINISHED FLOOR ELEVATION	WWF	WOVEN WIRE FENCE
F.A.	FIRE ALARM		CROSS-WALK
FH	FIRE HYDRANT		EXISTING CONTOUR
FO	FENCE OPENING		EXISTING SPOT ELEVATION
HTR	HEATER		
INV	INVERT ELEVATION		
MB	METAL BENCH		
MCB	METAL BUILDING COLUMN		
MGP	METAL GUARD POST		
MGR	METAL GUARD RAIL		
MP	METAL POST		
MR	METAL RAMP		
MSL	METAL SIGN		
MSR	METAL STEPS AND LANDING		
MSR/WWHR	METAL STEPS AND RAMP WITH METAL HANDRAIL		
O/HE(1)	OVERHEAD ELECTRIC (NO. OF LINES)		
O/HT(2)	OVERHEAD TELEPHONE (NO. OF LINES)		
PB	PARKING BUMPER		
PT	PICNIC TABLE		
RD	RAILROAD TIE		
RRT	RAILROAD TIE		

PROJECT BENCHMARK

STATION IS A 3 1/4" ALUMINUM TABLE STAMPED "ACS. 6-N11, 1983", SET IN CONCRETE 0.1' BELOW ASPHALT PAVEMENT IN THE INTERSECTION OF BARCELONA ROAD AND COUNTRY VIEW ROAD.
ELEVATION = 4927.364 FEET (NGVD 1929)

T.B.M.

T.B.M. #1
A "C" CHISELED ON TOP OF THE CONCRETE AT THE NE CORNER OF THE TRANSFORMER PAD AS SHOWN ON THE DRAWING.
ELEVATION = 4930.07 FEET (M.S.L.D.)

LEGAL DESCRIPTION

A PORTION OF M.R.G.C.D. TRACTS A-1 AND 93A2

KEYED NOTES:

- ① DAYLIGHT 4" D.I.P. THROUGH FACE OF PLANTER WALL
- ② CONSTRUCT 4" D.I.P. CURB PENETRATION

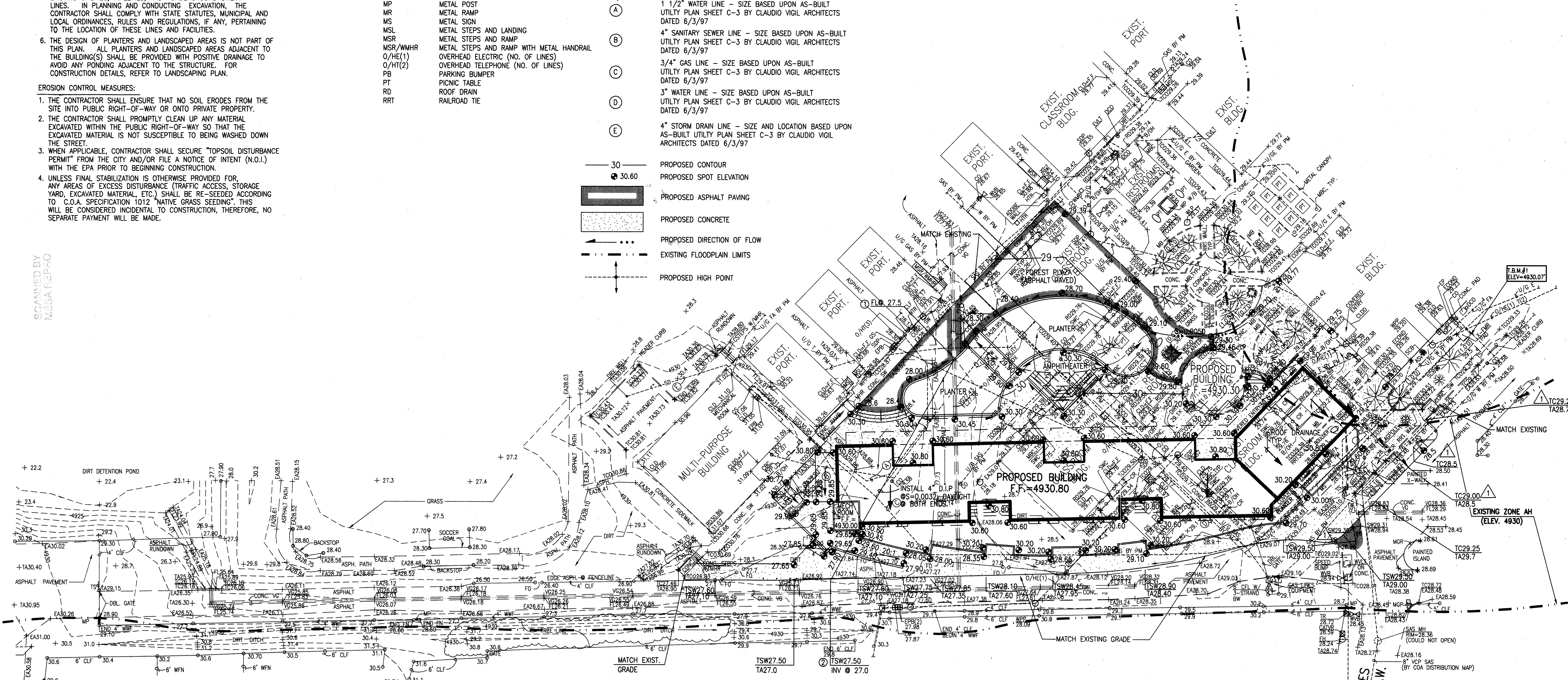
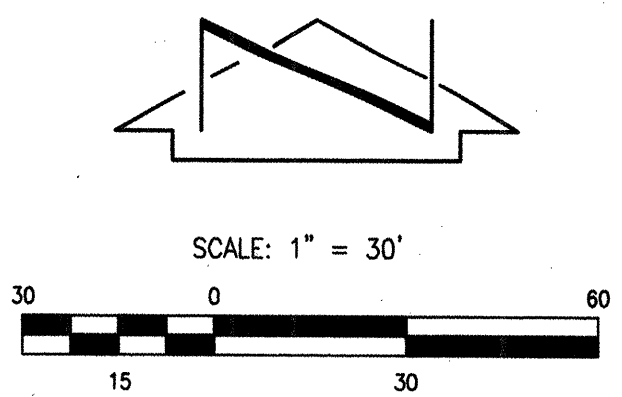

FOR INFORMATION ONLY

RECORD DRAWING

Jma

JEFF MORTENSEN & ASSOCIATES, INC.
8010-9 MIDWAY PARK BLVD., N.E.
ALBUQUERQUE, NEW MEXICO 87109
ENGINEERS SURVEYORS (505) 345-4250
FAX: (505) 345-4254 ESTABLISHED 1977

CITY PROJECT NO. 744581
SHEET 3 OF 7

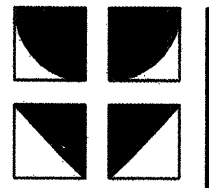

Architects, Inc. AIA
Albuquerque, New Mexico 87102
(505) 249-2724

Kells + Craig

400 GOLD SW, SUITE 880
Albuquerque, New Mexico 87102

New Classroom Building & Restrooms
Navajo Elementary School Albuquerque, NM
GRADING PLAN (BASE BID & ADD. ALTERNATE #1)

Project No. 302.00
Drawn JLP
Checked J.G.M.
Date 05.21.2004
Revisions 08.09.2004

C103

File Path: E:\JMM\0813\0813.DWG
File Name: 950894PR1.DWG
Plot Date: 08-13-2004
Plot Time: 4:58 pm

SCANNED BY
MESA REPRO

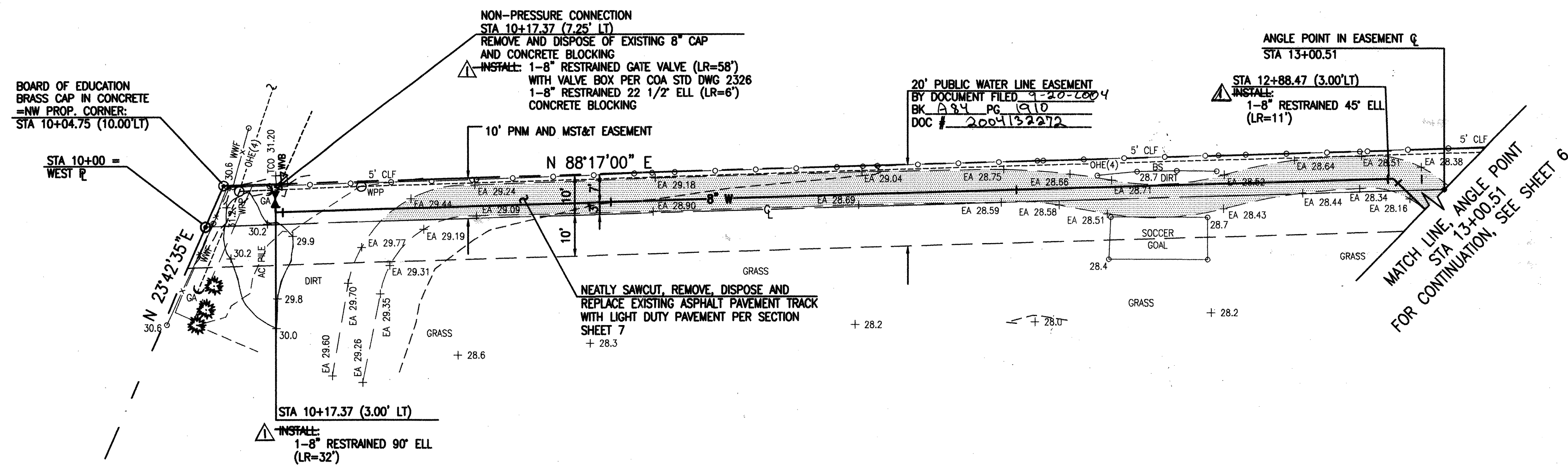

PUBLIC WATER LINE EASEMENT

RECORD DRAWING

SEE SHEET 1 FOR CERTIFICATION

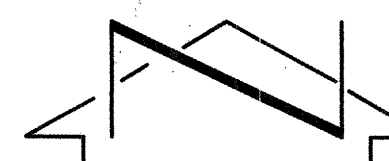

SCALE:
HORIZONTAL: 1" = 20'
VERTICAL: 1" = 5'

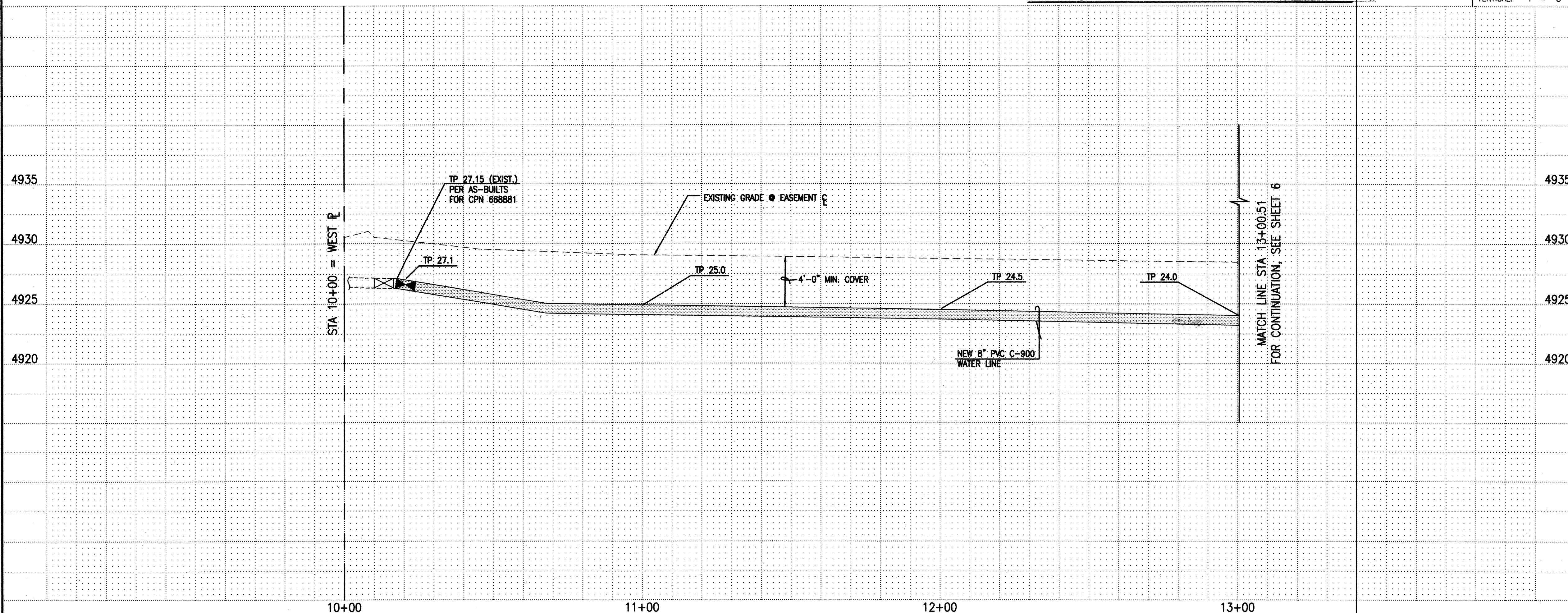

ELEVATIONS ARE IN NGVD 1929

WATER LINE CONSTRUCTION NOTES:

- ALL STATIONING IS BASED ON EASEMENT CENTERLINE UNLESS INDICATED OTHERWISE.
- FOR ALL LINES 12" AND SMALLER, WATER MAIN SHALL BE PVC C-900 PIPE OR AS APPROVED BY THE CITY OF ALBUQUERQUE CITY ENGINEER. DUCTILE IRON IS AN ACCEPTABLE PIPE MATERIAL IN LIEU OF PVC.
- FOR ALL LINES 14" AND LARGER, WATER MAIN SHALL BE DUCTILE IRON OR PVC C-905 OR AS APPROVED BY THE CITY OF ALBUQUERQUE CITY ENGINEER. CONCRETE CYLINDER IS AN ACCEPTABLE PIPE MATERIAL IN LIEU OF DUCTILE IRON.
- WATER LINE SHALL HAVE A MINIMUM COVER OF 4'-0" (FINISHED GRADE TO TOP OF PIPE). EXTRA DEPTH TRENCHING, IF REQUIRED, SHALL BE CONSIDERED INCIDENTAL TO CONSTRUCTION, THEREFORE, NO SEPARATE PAYMENT WILL BE MADE.
- ELECTRONIC MARKER DISCS (EMD) SHALL BE INSTALLED IN ACCORDANCE WITH THE STANDARD SPECIFICATION.
- IN ACCORDANCE WITH SECTION 801 OF THE "STANDARD SPECIFICATIONS", METALIZED DETECTABLE WARNING TAPE SHALL BE INSTALLED 18" ABOVE ALL PVC PIPE INSTALLED ON THIS PROJECT.
- VALVE STEM AND FIRE HYDRANT EXTENSIONS SHALL BE PROVIDED IN ACCORDANCE WITH THE STANDARD SPECIFICATIONS. THE COST OF EACH EXTENSION SHALL BE CONSIDERED INCIDENTAL TO CONSTRUCTION THEREFORE NO SEPARATE PAYMENT WILL BE MADE.
- JOINT RESTRAINT SHALL BE CONSIDERED INCIDENTAL TO WATER LINE CONSTRUCTION THEREFORE NO SEPARATE PAYMENT WILL BE MADE.
- JOINT RESTRAINT SHALL BE PROVIDED ON ALL JOINTS OF FIRE HYDRANT LEGS FROM TEE TO FIRE HYDRANT INCLUDING THE TEE AND FIRE HYDRANT.
- FOR THE PURPOSES OF THIS PROJECT, ALL RESTRAINED JOINTS AND JOINT RESTRAINT SHALL BE MECHANICALLY RESTRAINED. JOINT RESTRAINT LENGTHS SPECIFIED HEREON ARE THE LENGTHS TO BE RESTRAINED EACH SIDE OF THE FITTING.
- THE CONTRACTOR SHALL BE RESPONSIBLE FOR SELECTING APPROPRIATE MEANS AND METHODS TO EXCAVATE AND TRENCH AND INSTALL PIPE SO AS TO NOT EXCEED RIGHT-OF-WAY OR EASEMENT LIMITS, AND SO AS NOT TO INTERFERE WITH OTHER UTILITIES. THIS SHALL BE CONSIDERED INCIDENTAL TO TRENCHING, THEREFORE, NO SEPARATE PAYMENT WILL BE MADE.
- THE CONTRACTOR SHALL BE RESPONSIBLE FOR PROTECTING, SUPPORTING AND REPLACING, IF DAMAGED, ALL OTHER UTILITIES ENCOUNTERED DURING CONSTRUCTION. THIS SHALL BE CONSIDERED INCIDENTAL TO TRENCHING, THEREFORE, NO SEPARATE PAYMENT WILL BE MADE.
- WHERE WATER AND SANITARY SEWER LINES CROSS, THE SANITARY SEWER LINE SHALL BE INSTALLED AS PRESSURE PIPE BETWEEN MANHOLES IF 18 INCHES OF VERTICAL SEPARATION DOES NOT EXIST.
- ALL FIRE HYDRANTS SHALL BE SECURELY WRAPPED IN BLACK PLASTIC UNTIL SUCH TIME AS THE NEW WATER LINE IS PUT INTO SERVICE BY WATER SYSTEM DIVISION PERSONNEL.

AS BUILT INFORMATION		BENCH MARKS		SURVEY INFORMATION		ENGINEER'S SEAL	
CONTRACTOR	DATE	STATION	MARK	NO.	DATE	NO.	DATE
CONTRACTOR: SUNSTATE MECHANICAL	DATE: 11/04	STATION: 6-N11, 1983"	MARK: 1/4" ALUMINUM TABLET STAMPED "ACS"	NO. 950896	DATE: 06/2004	NO. 950896	DATE: 06/2004
WORK SHOWN BY: JMA	DATE: 12/04	PAVEMENT IN INTERSECTION OF BARCELONA ROAD AND COUNTRY VIEW ROAD.		NO. 950894	DATE: 06/2004	NO. 950894	DATE: 06/2004
FIELD ACCEPTANCE BY: JMA	DATE: 11/05	ELEVATION = 4927.384 FEET (NGVD 1929)		NO. 950894	DATE: 06/2004	NO. 950894	DATE: 06/2004
DESIGNED BY: JMA	DATE: 11/05			NO. 950894	DATE: 06/2004	NO. 950894	DATE: 06/2004
RECORDED BY: JMA	DATE: 11/05			NO. 950894	DATE: 06/2004	NO. 950894	DATE: 06/2004

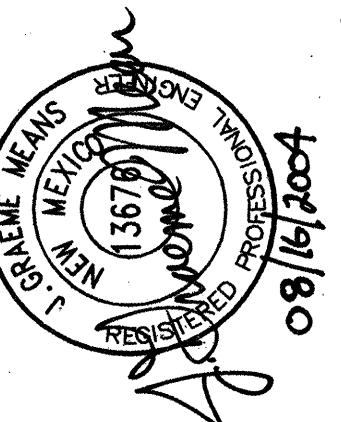

JEFF MORTENSEN & ASSOCIATES, INC.
6010-B MIDWAY PARK BLVD. N.E.
ALBUQUERQUE, NM 87109
ENGINEERS, SURVEYORS (505) 345-4250
FAX: 505 345-4254 ESTABLISHED 1977

CITY OF ALBUQUERQUE
PUBLIC WORKS DEPARTMENT
ENGINEERING DEVELOPMENT GROUP

TITLE: NAVAJO ELEMENTARY SCHOOL
PUBLIC WATER LINE EXTENSION AND FIRE HYDRANT INSTALLATIONS
WATER LINE EXTENSION PLAN AND PROFILE STA 10+17.37 TO STA 13+00.51

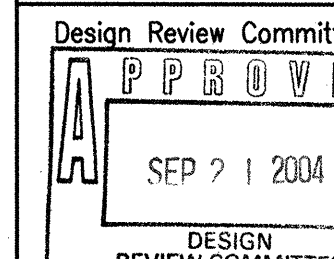

City Engineer Approval

City Engineer

City Project No.

744581

Zone Map No.
N10/N11

Sheet

5

Of

7

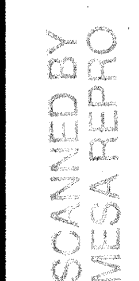

SEE SHEET 1 FOR CERTIFICATION

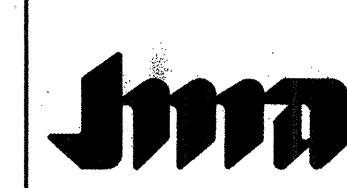

08/11/80

WATER LINE CONSTRUCTION NOTES:

1. ALL STATIONING IS BASED ON EASEMENT CENTERLINE UNLESS INDICATED OTHERWISE.
2. FOR ALL LINES 12" AND SMALLER, WATER MAIN SHALL BE PVC C-900 PIPE OR AS APPROVED BY THE CITY OF ALBUQUERQUE CITY ENGINEER. DUCTILE IRON IS AN ACCEPTABLE PIPE MATERIAL IN LIEU OF PVC.
3. FOR ALL LINES 14" AND LARGER, WATER MAIN SHALL BE DUCTILE IRON OR PVC C-905 OR AS APPROVED BY THE CITY OF ALBUQUERQUE CITY ENGINEER. CONCRETE CYLINDER IS AN ACCEPTABLE PIPE MATERIAL IN LIEU OF DUCTILE IRON.
4. WATER LINE SHALL HAVE A MINIMUM COVER OF 4'-0" (FINISHED GRADE TO TOP OF PIPE). EXTRA DEPTH TRENCHING, IF REQUIRED, SHALL BE CONSIDERED INCIDENTAL TO CONSTRUCTION, THEREFORE, NO SEPARATE PAYMENT WILL BE MADE.
5. ELECTRONIC MARKER DISCS (EMD) SHALL BE INSTALLED IN ACCORDANCE WITH THE STANDARD SPECIFICATION.
6. IN ACCORDANCE WITH SECTION 801 OF THE "STANDARD SPECIFICATIONS", METALIZED DETECTABLE WARNING TAPE SHALL BE INSTALLED 18" ABOVE ALL PVC PIPE INSTALLED ON THIS PROJECT.
7. VALVE STEM AND FIRE HYDRANT EXTENSIONS SHALL BE PROVIDED IN ACCORDANCE WITH THE STANDARD SPECIFICATIONS. THE COST OF EACH EXTENSION SHALL BE CONSIDERED INCIDENTAL TO CONSTRUCTION THEREFORE NO SEPARATE PAYMENT WILL BE MADE.
8. JOINT RESTRAINT SHALL BE CONSIDERED INCIDENTAL TO WATER LINE CONSTRUCTION THEREFORE NO SEPARATE PAYMENT WILL BE MADE.
9. JOINT RESTRAINT SHALL BE PROVIDED ON ALL JOINTS OF FIRE HYDRANT LEGS FROM TEE TO FIRE HYDRANT INCLUDING THE ABOVE HYDRANT.
10. FOR THE PURPOSES OF THIS PROJECT, ALL RESTRAINED JOINTS AND JOINT RESTRAINT SHALL BE MECHANICALLY RESTRAINED. JOINT RESTRAINT LENGTHS SPECIFIED HEREON ARE THE LENGTHS TO BE RESTRAINED EACH SIDE OF THE FITTING.
11. THE CONTRACTOR SHALL BE RESPONSIBLE FOR SELECTING APPROPRIATE MEANS AND METHODS TO EXCAVATE AND TRENCH AND INSTALL PIPE SO AS TO NOT EXCEED RIGHT-OF-WAY OR EASEMENT LIMITS, AND SO AS NOT TO INTERFERE WITH OTHER UTILITIES. THIS SHALL BE CONSIDERED INCIDENTAL TO TRENCHING, THEREFORE, NO SEPARATE PAYMENT WILL BE MADE.
12. THE CONTRACTOR SHALL BE RESPONSIBLE FOR PROTECTING, SUPPORTING AND REPLACING, IF DAMAGED, ALL OTHER UTILITIES ENCOUNTERED DURING CONSTRUCTION. THIS SHALL BE CONSIDERED INCIDENTAL TO TRENCHING, THEREFORE, NO SEPARATE PAYMENT WILL BE MADE.
13. WHERE WATER AND SANITARY SEWER LINES CROSS, THE SANITARY SEWER LINE SHALL BE INSTALLED AS PRESSURE PIPE BETWEEN MANHOLES IF 18 INCHES OF VERTICAL SEPARATION DOES NOT EXIST.
14. ALL FIRE HYDRANTS SHALL BE SECURELY WRAPPED IN BLACK PLASTIC UNTIL SUCH TIME AS THE NEW WATER LINE IS PUT INTO SERVICE BY WATER SYSTEM DIVISION PERSONNEL.

[illegible]

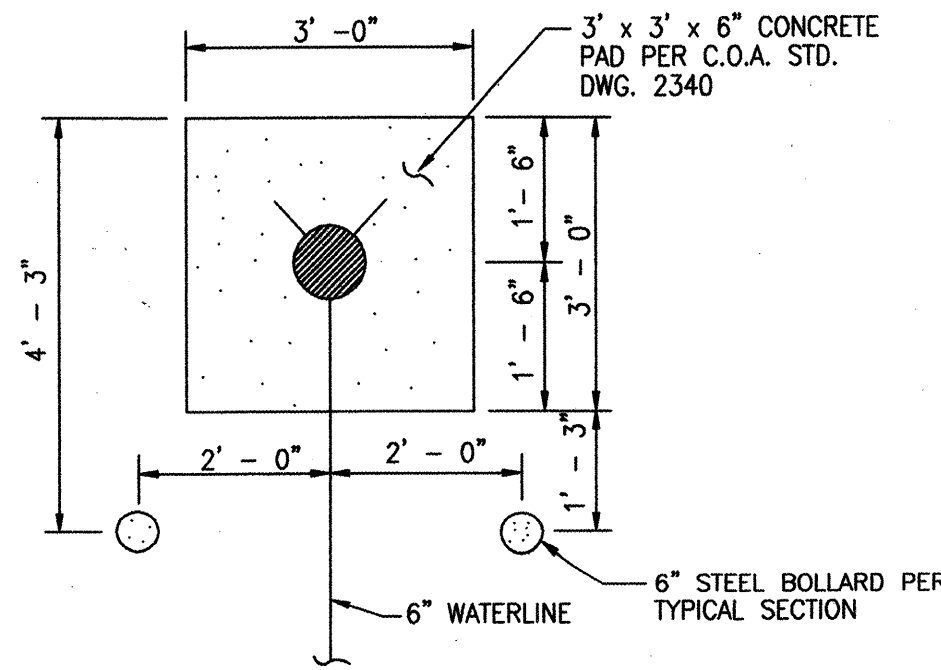

FIRE HYDRANT BOLLARD DETAIL
SCALE: 1" = 2' - 0"

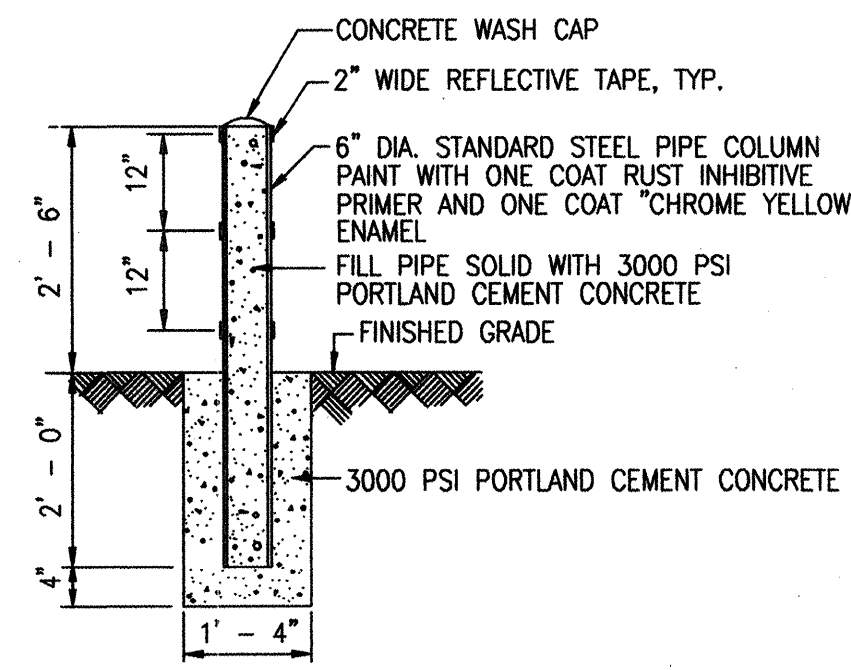

TYPICAL BOLLARD SECTION
SCALE: 1" = 2' - 0"

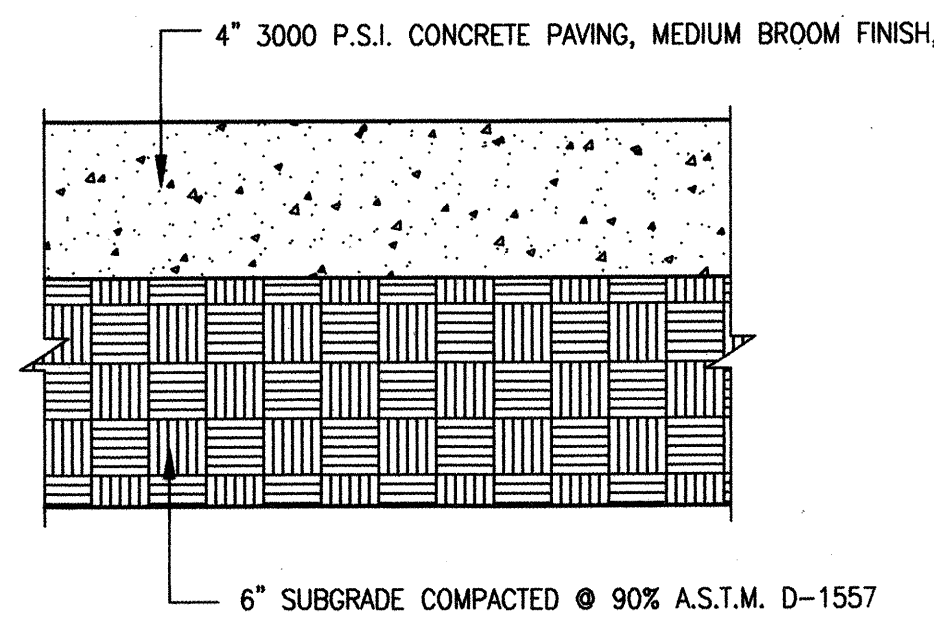

TYPICAL CONCRETE PAVEMENT/SIDEWALK SECTION (PRIVATE)
SCALE: 1" = 5"

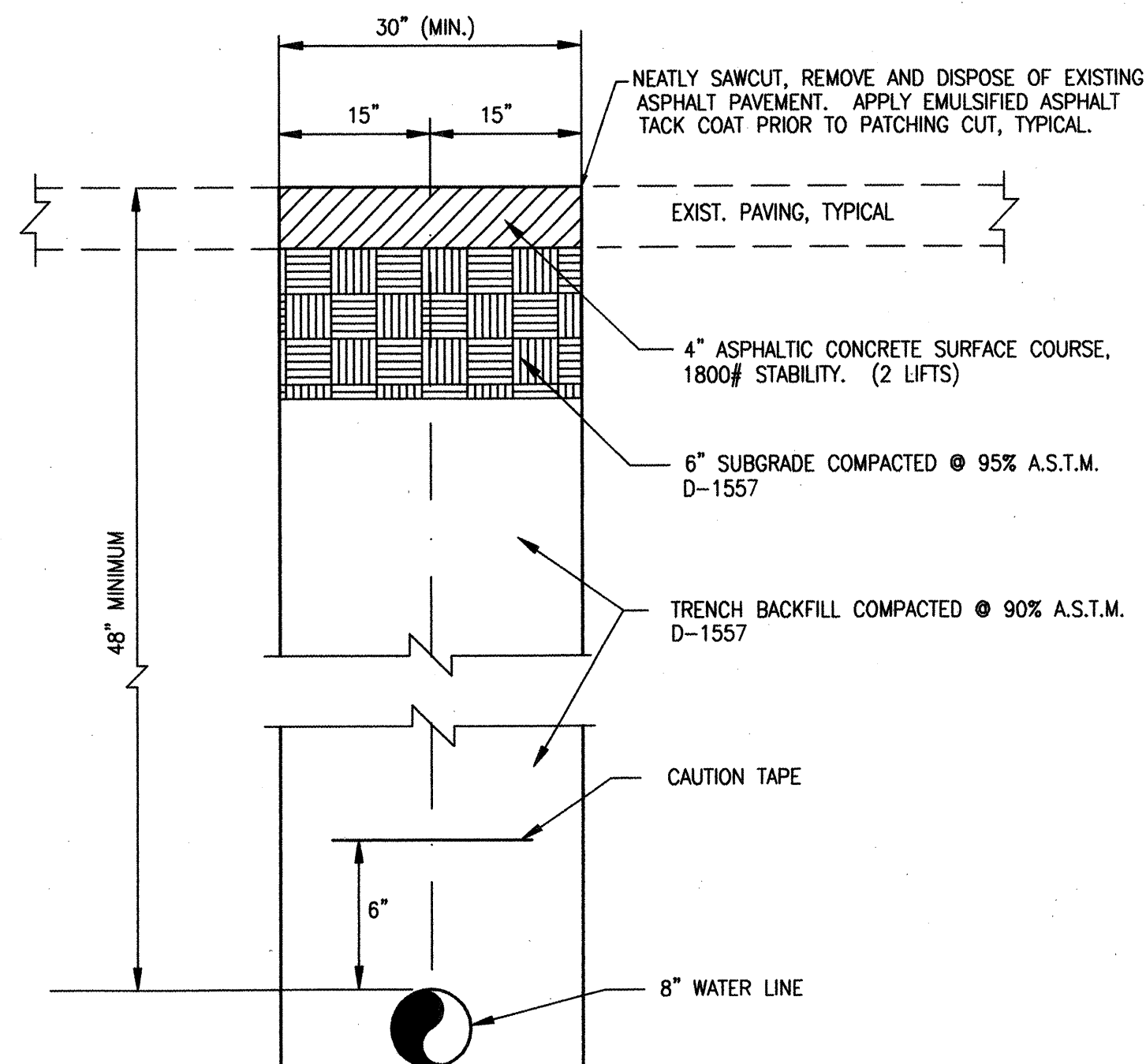

TYPICAL PRIVATE PAVING UTILITY CUT & PAVEMENT REPLACEMENT SECTION
SCALE: 1" = 6"

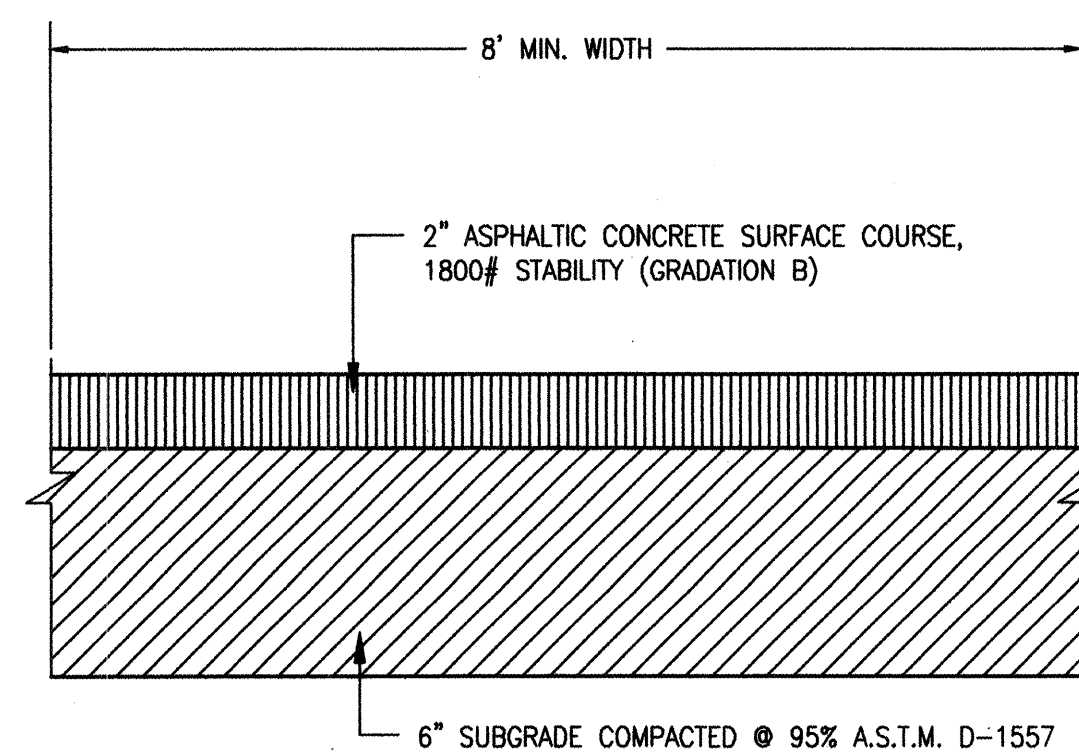

TYPICAL LIGHT DUTY PAVEMENT SECTION (PRIVATE)
SCALE: 1" = 5"

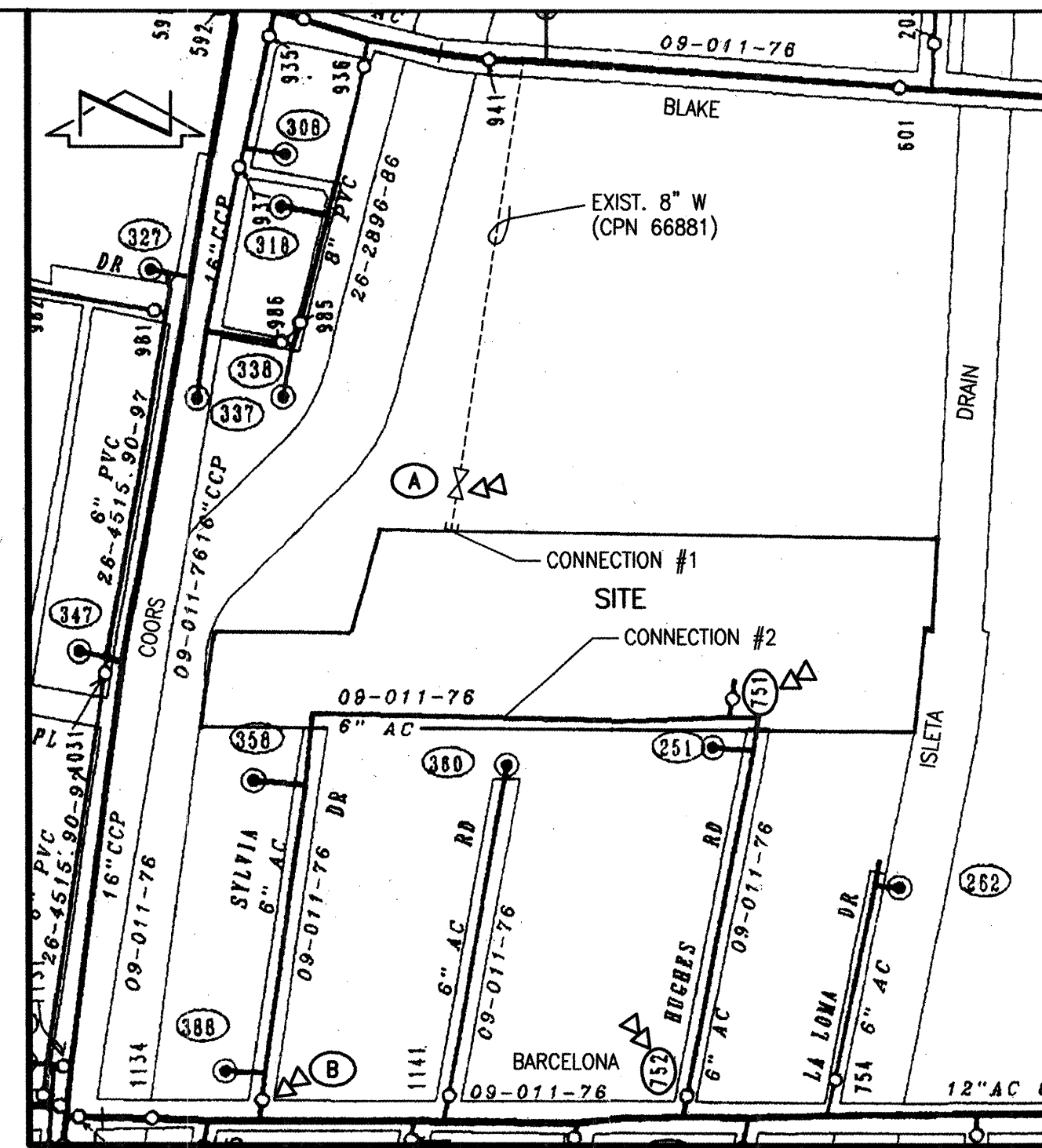

WATER VALVE SHUT-OFF PLAN
SCALE: 1" = 300'

WATER VALVE SHUTOFF PLAN NOTES:

1. AT A MINIMUM, THE FOLLOWING VALVES SHALL BE CLOSED TO FACILITATE THE PROPOSED NON-PRESSURE CONNECTIONS:
 - CONNECTION #1; VALVE A
 - CONNECTION #2; VALVES B, 751, 752
2. WATER SYSTEMS PERSONNEL SHALL PERFORM ALL SHUTOFFS. THE CONTRACTOR SHALL NOT OPERATE ANY VALVES THAT MAY AFFECT SYSTEM OPERATIONS.
3. THE CONTRACTOR SHALL REQUEST A WATER SHUTOFF IN WRITING, A MINIMUM OF SEVEN (7) DAYS IN ADVANCE PER STANDARD CITY OF ALBUQUERQUE PROCEDURES.
4. WITHIN FIVE (5) DAYS AFTER RECEIPT OF CONTRACTOR'S SHUTOFF REQUEST, TRAIL SHUTOFFS WILL BE CONDUCTED. CITY TO FURNISH LABOR AND APPURTENANCES NECESSARY TO VERIFY COMPLETENESS OF SHUTOFFS.
5. THE CONTRACTOR SHALL HAVE ALL FITTINGS, MATERIALS AND EQUIPMENT ON SITE PRIOR TO VALVE SHUTOFF. ALL EXCAVATION SHALL BE COMPLETE EXCEPT AS NECESSARY TO MAINTAIN SAFE SYSTEM OPERATION WHILE UNDER PRESSURE.
6. THE CONTRACTOR SHALL PROVIDE ALL RESTRAINTS AND THRUST BLOCKS NECESSARY TO EFFECT ALL NECESSARY SHUTOFFS AND CONNECTIONS.
7. EXISTING WATER VALVE AND WATER LINE INFORMATION OBTAINED FROM CITY OF ALBUQUERQUE AUTOMATED WATER DISTRIBUTION SYSTEM SECTIONAL MAPS, MAP GRIDS N10 & N11
8. AT THE TIME OF WATER SHUTOFF APPLICATION, THE CONTRACTOR SHALL REQUEST THAT WATER SYSTEMS DIVISION NOTIFY ALL AFFECTED PROPERTY OWNERS AT LEAST TWENTY-FOUR (24) HOURS IN ADVANCE OF THE RESPECTIVE SHUTOFFS.

RECORD DRAWING

SEE SHEET 1 FOR CERTIFICATION

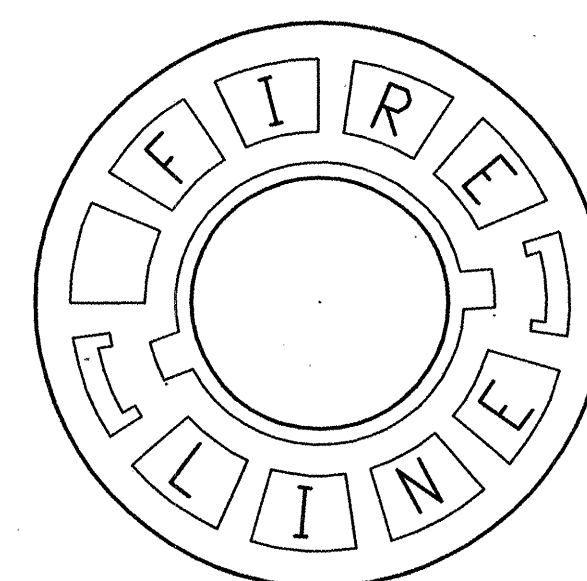

FIRELINE VALVE BOX LID
NO SCALE

JMA
JEFF MORTENSEN & ASSOCIATES, INC.
6800-B MIDWAY PARK BLVD. NE
ALBUQUERQUE, NM 87109
ENGINEERS & SURVEYORS (CSD) 945-4250
FAX: 505 345-4254 ESTABLISHED 1977

95.089.4

CITY OF ALBUQUERQUE PUBLIC WORKS DEPARTMENT ENGINEERING DEVELOPMENT GROUP	
TITLE: NAVAJO ELEMENTARY SCHOOL PUBLIC WATER LINE EXTENSION AND FIRE HYDRANT INSTALLATIONS WATER VALVE SHUTOFF PLAN; SECTIONS & DETAILS	
City Project No. 744581	Zone Map No. N-10/N11
Sheet 7	Of 7

AS BUILT INFORMATION			
CONTRACTOR	SUNSTATE MECHANICAL	DATE	11/04
INSPECTED BY	JMA	DATE	12/04
INSPECTION BY	TEW	DATE	01/05
VERIFICATION BY	RJE	DATE	01/05
COMPLETED BY	JMA	DATE	01/05
MICRO-FILM INFORMATION			
RECORDED BY		DATE	
NO.			

BENCH MARKS	
STATION IS A 3 1/4" ALUMINUM TABLE STAMPED "ACS, 6-N11, 1983", SET IN CONCRETE 0.1' BELOW ASPHALT PAVEMENT IN INTERSECTION OF BARCELONA ROAD AND COUNTRY VIEW ROAD.	
ELEVATION = 4927.364 FEET (NGVD 1929)	

SURVEY INFORMATION	
DATE	08/2004
BY	JMA
NO.	950894

ENGINEER'S SEAL	
TEW	BY
NO.	DATE
DESIGNED BY	JCM, Date 08-04
DRAWN BY	ACAD, Date 08-04
CHECKED BY	JCM, Date 08-04

REVISIONS	
NO.	DATE
DESIGN	
REVISIONS	
DATE	