

2 3 4 5 6 7 8 9 10 11 12 13 14 15
a b c d e f g h i j k l m n o p q r s t u v w x y z

CONSTRUCTION PLANS FOR EDITH BLVD. AND OSUNA RD. NW

PAVING IMPROVEMENTS

CITY OF ALBUQUERQUE
NEW MEXICO
MARCH, 2007

INDEX TO DRAWINGS

- TITLE SHEET
- EDITH BOULEVARD PAVING IMPROVEMENTS
- EDITH BOULEVARD STRIPING PLAN

RECORD DRAWING

I, **SHAHAB BIAZAR**, OF THE FIRM OF **ADVANCED ENGINEERING AND CONSULTING, LLC**, A REGISTERED PROFESSIONAL ENGINEER IN THE STATE OF NEW MEXICO, DO HEREBY CERTIFY, TO THE BEST OF MY KNOWLEDGE AND BELIEF, THAT THE INFRASTRUCTURE INSTALLED AS PART OF THIS PROJECT HAS BEEN INSPECTED BY ME OR BY A QUALIFIED PERSON UNDER MY DIRECT SUPERVISION AND HAS BEEN CONSTRUCTED IN ACCORDANCE WITH THE PLANS AND SPECIFICATIONS APPROVED BY THE CITY ENGINEER AND THAT THE ORIGINAL DESIGN INTENT OF THE APPROVED PLANS HAS BEEN MET, EXCEPT AS NOTED BY ME ON THE AS-BUILT CONSTRUCTION DRAWINGS. THIS CERTIFICATION IS BASED ON SITE INSPECTIONS BY ME OR PERSONNEL UNDER MY DIRECTION AND SURVEY INFORMATION PROVIDED BY **REX J. VOGLER PROFESSIONAL SURVEYOR**, NMPS NUMBER 10466.

Shahab Biazar 1/15/09
SHAHAB BIAZAR, PE DATE
NMPE NO. 13479 Advanced Eng. & Cons., LLC



- THE FOLLOWING NOTES ALSO APPLY WHEN CHECKED
- ☐ ALL UTILITIES AND UTILITY SERVICE LINES SHALL BE INSTALLED PRIOR TO PAVING.
 - ☒ BACKFILL COMPACTION SHALL BE ACCORDING TO SPECIFIED STREET USE.
 - ☐ TACK COAT REQUIREMENTS SHALL BE DETERMINED BY THE DESIGN ENGINEER.
 - ☐ SIDEWALKS AND WHEELCHAIR RAMP WITHIN THE CURB RETURNS SHALL BE CONSTRUCTED WHEREVER A NEW CURB RETURN IS CONSTRUCTED.
 - ☐ IF CURB IS DEPRESSED FOR A DRIVEPAD, THE DRIVEPAD SHALL BE CONSTRUCTED PRIOR TO ACCEPTANCE OF CURB AND GUTTER.
 - ☒ ALL STORM DRAINAGE FACILITIES SHALL BE COMPLETED PRIOR TO FINAL ACCEPTANCE.

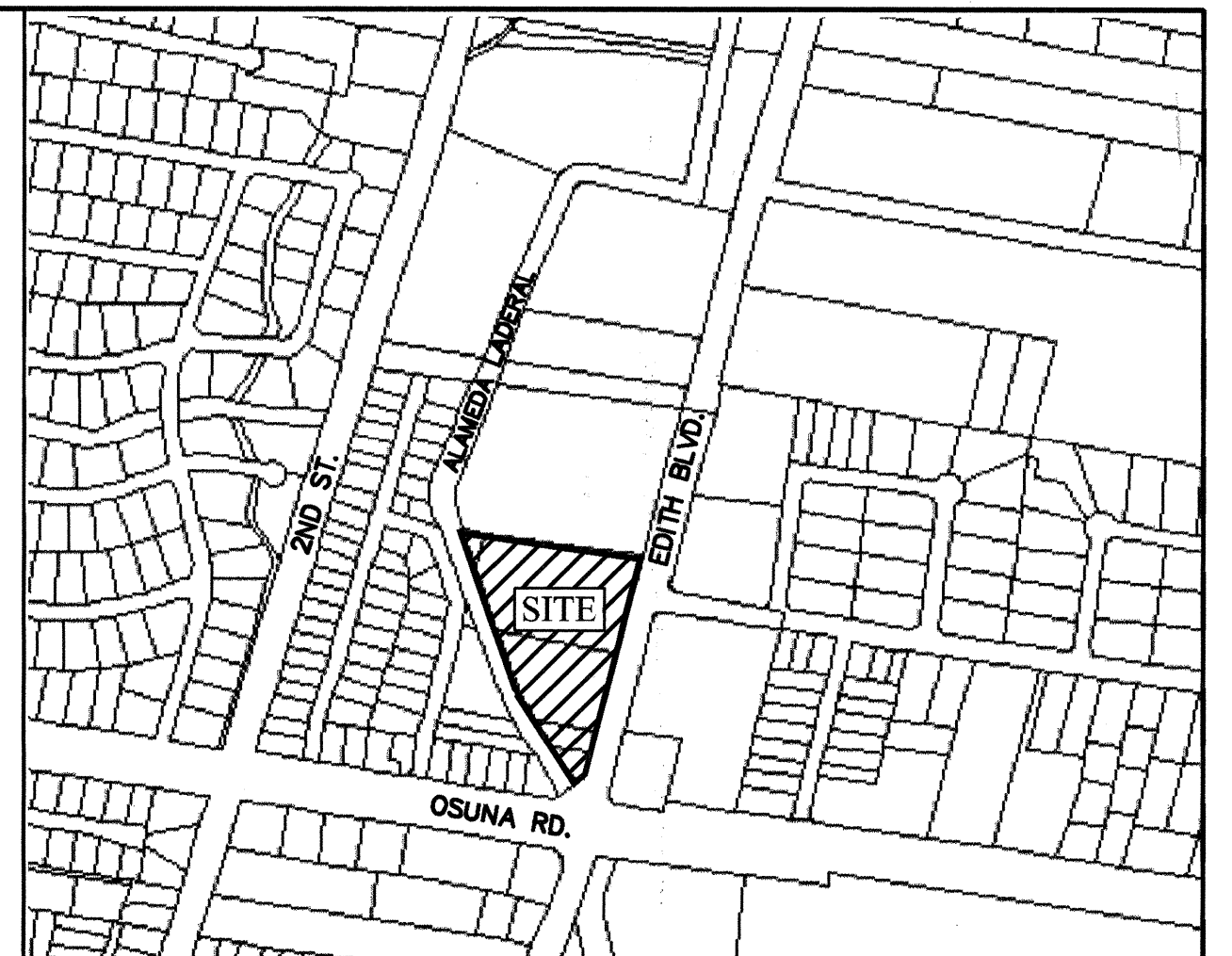

VICINITY MAP ZONE ATLAS E-15-Z

- N.T.S.**
- NOTICE TO CONTRACTORS**
- ALL WORK DETAILED ON THESE PLANS TO BE PERFORMED UNDER CONTRACT SHALL, EXCEPT AS OTHERWISE STATED OR PROVIDED FOR HEREON, BE CONSTRUCTED IN ACCORDANCE WITH THE CITY OF ALBUQUERQUE STANDARD SPECIFICATIONS FOR PUBLIC WORKS CONSTRUCTION, 1986 EDITION (UPDATE #7 INCLUDING AMENDMENT 1).
 - TWO WORKING DAYS PRIOR TO ANY EXCAVATION, THE CONTRACTOR MUST CONTACT NEW MEXICO ONE CALL SYSTEM (260-1990) FOR LOCATION OF EXISTING UTILITIES.
 - ANY WORK AFFECTING AN ARTERIAL ROADWAY REQUIRES 24-HOUR CONSTRUCTION.
 - PRIOR TO CONSTRUCTION, THE CONTRACTOR SHALL EXCAVATE AND VERIFY THE HORIZONTAL AND VERTICAL LOCATION OF ALL OBSTRUCTIONS. SHOULD A CONFLICT EXIST, THE CONTRACTOR SHALL NOTIFY THE ENGINEER OR SURVEYOR IMMEDIATELY SO THAT THE CONFLICT CAN BE RESOLVED WITH A MINIMUM AMOUNT OF DELAY.
 - FIVE (5) WORKING DAYS PRIOR TO BEGINNING OF CONSTRUCTION, THE CONTRACTOR SHALL SUBMIT TO CONSTRUCTION COORDINATION DIVISION A DETAILED CONSTRUCTION SCHEDULE. TWO (2) WORKING DAYS PRIOR TO CONSTRUCTION, THE CONTRACTOR SHALL OBTAIN A BARRICADING PERMIT FROM THE CONST. COORDINATION DIVISION. CONTRACTOR SHALL NOTIFY BARRICADE ENGINEER (924-3400) PRIOR TO OCCUPYING AN INTERSECTION. REFER TO STANDARD SPECIFICATIONS.
 - ALL STREET STRIPING ALTERED OR DESTROYED SHALL BE REPLACED WITH PLASTIC REFLECTORIZED PAVEMENT MARKINGS BY THE CONTRACTOR TO LOCATION AS EXISTING OR AS INDICATED BY THIS PLAN SET.
 - CONTRACTOR SHALL NOTIFY THE ENGINEER NOT LESS THAN SEVEN (7) DAYS PRIOR TO STARTING WORK IN ORDER THAT THE ENGINEER MAY TAKE NECESSARY MEASURES TO INSURE THE PRESERVATION OF SURVEY MONUMENTS. CONTRACTOR SHALL NOT DISTURB PERMANENT SURVEY MONUMENTS WITHOUT THE CONSENT OF THE ENGINEER AND SHALL NOTIFY THE ENGINEER AND BEAR THE EXPENSE OF REPLACING ANY THAT MAY BE DISTURBED WITHOUT PERMISSION. REPLACEMENT SHALL BE DONE ONLY BY THE CITY SURVEYOR. WHEN A CHANGE IS MADE IN THE FINISHED ELEVATIONS OF THE PAVEMENT OF ANY ROADWAY IN WHICH A PERMANENT SURVEY MONUMENT IS LOCATED, CONTRACTOR SHALL, AT HIS OWN EXPENSE, ADJUST THE MONUMENT COVER TO THE NEW GRADE UNLESS OTHERWISE SPECIFIED. REFER TO SECTION 4.4 OF THE GENERAL CONDITIONS OF THE STANDARD SPECIFICATIONS. ANY PERMANENT SURVEY MONUMENT LOCATED WITHIN 50' OF THIS PROJECT THAT IS NOT SHOWN ON THE PLAN AND IS DESTROYED DURING CONSTRUCTION WILL BE REPLACED AT THE DESIGNER'S EXPENSE.
 - FOR STORM DRAIN CONSTRUCTION, RCP PIPE JOINTS SHALL NOT BE GROUTED PRIOR TO FINAL INSPECTION. FINAL INSPECTION WILL DETERMINE JOINTS TO BE GROUTED FOR FINAL ACCEPTANCE OF THE CONSTRUCTION.
 - ALL EXCAVATION, TRENCHING AND SHORING ACTIVITIES MUST BE CARRIED-OUT IN ACCORDANCE WITH OSHA 29 CFR 1926.650 SUBPART P.
 - THE CONTRACTOR WILL BE RESPONSIBLE FOR DISPOSING OF ALL DEBRIS, INCLUDING, NOT LIMITED TO, HAZARDOUS WASTE AT DISPOSAL SITES APPROVED BY GOVERNMENTAL AGENCIES REGULATING THE DISPOSAL OF SUCH MATERIALS.
 - TACK COAT FOR SURFACE COURSE REQUIREMENTS WILL BE DETERMINED BY THE ENGINEER.
 - PERMANENT PAVEMENT STRIPING AND MARKINGS WILL BE PLACED BY THE CONTRACTOR. THE ROAD SHALL NOT BE OPENED TO THE TRAFFIC UNTIL IT IS STRIPED. ALL STRIPING, PAVEMENT MARKINGS INCLUDING CROSSWALKS, ARROWS AND LINE MARKINGS ARE TO BE CONSTRUCTED OF HOT PLASTICS OR COLD PLASTIC IN ACCORDANCE WITH THE MANUAL OF UNIFORM TRAFFIC CONTROL DEVICES.
 - CONTRACTOR SHALL MAINTAIN A GRAFFITI-FREE WORK SITE. CONTRACTOR SHALL PROMPTLY REMOVE ANY AND ALL GRAFFITI FROM EQUIPMENT, WHETHER PERMANENT OR TEMPORARY.
 - CONTRACTOR WILL BE RESPONSIBLE FOR PROVIDING AND MAINTAINING ALL CONSTRUCTION SIGNING UNTIL PROJECT HAS BEEN ACCEPTED BY THE CITY.
 - ALL WATER VALVE BOXES/MANHOLES IN THE STREET CONSTRUCTION ARE TO BE ADJUSTED TO FINISH GRADE AND WILL BE MEASURED AND PAID PER EACH.
 - ALL UTILITY WORK SHALL BE CONSTRUCTED IN ACCORDANCE WITH CITY OF ALBUQUERQUE SPECIFICATIONS FOR WATER AND WASTEWATER FACILITIES (MOST RECENT REVISIONS). THE CONTRACTOR SHALL NOTIFY CITY OF ALBUQUERQUE THREE (3) WORKING DAYS PRIOR TO BEGINNING THE CONSTRUCTION OF THE UTILITIES.
 - THE CONTRACTOR SHALL COORDINATE WITH WATER SYSTEMS DIVISION (857-8200) SEVEN (7) WORKING DAYS PRIOR TO ANY WORK WHICH MAY AFFECT THE EXISTING CITY PUBLIC WATER OR SEWER UTILITIES. CONTRACTOR SHALL BE RESPONSIBLE FOR TIMING AND COORDINATION OF WATER SHUTOFF. EXISTING CITY VALVES TO BE OPERATOR BY CITY PERSONNEL ONLY. REFER TO SECTION 18 OF THE STANDARD SPECIFICATIONS.
 - ELECTRONIC MARKER DISKS (EMD) WILL BE PLACED ACCORDING TO SECTION 170 OF THE CITY OF ALBUQUERQUE STANDARD SPECIFICATIONS FOR PUBLIC WORKS CONSTRUCTION, 1986 EDITION AS REVISED THROUGH UPDATE #7.
 - PRIVATE STREETS REQUIRE STREET NAME SIGNS, STOP SIGNS, AND ANY NECESSARY STRIPING (DEVELOPER'S RESPONSIBILITY).
 - IF PROJECT LOCATED IN THE VALLEY THE FOLLOWING NOTE APPLIES: IF HUMAN REMAINS ARE ENCOUNTERED, STOP CONSTRUCTION AND CONTACT THE OFFICE OF MEDICAL INVESTIGATION (OMI) AT 273-3053.
 - INLET GRATE DESIGN IS BASED ON C.O.A. STANDARD DRAWING #2220.

DRB No: 1004367

APPROVED AS RECORD DRAWINGS
DESIGN REVIEW SECTION
CITY OF ALBUQUERQUE
Anthony J. ...
DATE: 02/18/09



DRAWING: 200458-TITLE DRAWN BY: ORO DATE: 3-23-07

--	--	--	--	--	--	--	--	--	--	--	--	--	--	--	--	--	--	--	--	--	--	--	--	--	--	--	--	--	--	--	--	--	--	--	--	--	--	--	--	--	--	--	--	--	--	--	--	--	--	--	--	--	--	--	--	--	--	--	--	--	--	--	--	--	--	--	--	--	--	--	--	--	--	--	--	--	--	--	--	--	--	--	--	--	--	--	--	--	--	--	--	--	--	--	--	--	--	--	--	--	--	--	--	--	--	--	--	--	--	--	--	--	--	--	--	--	--	--	--	--	--	--	--	--	--	--	--	--	--	--	--	--	--	--	--	--	--	--	--	--	--	--	--	--	--	--	--	--	--	--	--	--	--	--	--	--	--	--	--	--	--	--	--	--	--	--	--	--	--	--	--	--	--	--	--	--	--	--	--	--	--	--	--	--	--	--	--	--	--	--	--	--	--	--	--	--	--	--	--	--	--	--	--	--	--	--	--	--	--	--	--	--	--	--	--	--	--	--	--	--	--	--	--	--	--	--	--	--	--	--	--	--	--	--	--	--	--	--	--	--	--	--	--	--	--	--	--	--	--	--	--	--	--	--	--	--	--	--	--	--	--	--	--	--	--	--	--	--	--	--	--	--	--	--	--	--	--	--	--	--	--	--	--	--	--	--	--	--	--	--	--	--	--	--	--	--	--	--	--	--	--	--	--	--	--	--	--	--	--	--	--	--	--	--	--	--	--	--	--	--	--	--	--	--	--	--	--	--	--	--	--	--	--	--	--	--	--	--	--	--	--	--	--	--	--	--	--	--	--	--	--	--	--	--	--	--	--	--	--	--	--	--	--	--	--	--	--	--	--	--	--	--	--	--	--	--	--	--	--	--	--	--	--	--	--	--	--	--	--	--	--	--	--	--	--	--	--	--	--	--	--	--	--	--	--	--	--	--	--	--	--	--	--	--	--	--	--	--	--	--	--	--	--	--	--	--	--	--	--	--	--	--	--	--	--	--	--	--	--	--	--	--	--	--	--	--	--	--	--	--	--	--	--	--	--	--	--	--	--	--	--	--	--	--	--	--	--	--	--	--	--	--	--	--	--	--	--	--	--	--	--	--	--	--	--	--	--	--	--	--	--	--	--	--	--	--	--	--	--	--	--	--	--	--	--	--	--	--	--	--	--	--	--	--	--	--	--	--	--	--	--	--	--	--	--	--	--	--	--	--	--	--	--	--	--	--	--	--	--	--	--	--	--	--	--	--	--	--	--	--	--	--	--	--	--	--	--	--	--	--	--	--	--	--	--	--	--	--	--	--	--	--	--	--	--	--	--	--	--	--	--	--	--	--	--	--	--	--	--	--	--	--	--	--	--	--	--	--	--	--	--	--	--	--	--	--	--	--	--	--	--	--	--	--	--	--	--	--	--	--	--	--	--	--	--	--	--	--	--	--	--	--	--	--	--	--	--	--	--	--	--	--	--	--	--	--	--	--	--	--	--	--	--	--	--	--	--	--	--	--	--	--	--	--	--	--	--	--	--	--	--	--	--	--	--	--	--	--	--	--	--	--	--	--	--	--	--	--	--	--	--	--	--	--	--	--	--	--	--	--	--	--	--	--	--	--	--	--	--	--	--	--	--	--	--	--	--	--	--	--	--	--	--	--	--	--	--	--	--	--	--	--	--	--	--	--	--	--	--	--	--	--	--	--	--	--	--	--	--	--	--	--	--	--	--	--	--	--	--	--	--	--	--	--	--	--	--	--	--	--	--	--	--	--	--	--	--	--	--	--	--	--	--	--	--	--	--	--	--	--	--	--	--	--	--	--	--	--	--	--	--	--	--	--	--	--	--	--	--	--	--	--	--	--	--	--	--	--	--	--	--	--	--	--	--	--	--	--	--	--	--	--	--	--	--	--	--	--	--	--	--	--	--	--	--	--	--	--	--	--	--	--	--	--	--	--	--	--	--	--	--	--	--	--	--	--	--	--	--	--	--	--	--	--	--	--	--	--	--	--	--	--	--	--	--	--	--	--	--	--	--	--	--	--	--	--	--	--	--	--	--	--	--	--	--	--	--	--	--	--	--	--	--	--	--	--	--	--	--	--	--	--	--	--	--	--	--	--	--	--	--	--	--	--	--	--	--	--	--	--	--	--	--	--	--	--	--	--	--	--	--	--	--	--	--	--	--	--	--	--	--	--	--	--	--	--	--	--	--	--	--	--	--	--	--	--	--	--	--	--	--	--	--	--	--	--	--	--	--	--	--	--	--	--	--	--	--	--	--	--	--	--	--	--	--	--	--	--	--	--	--	--	--	--	--	--	--	--	--	--	--	--	--	--	--	--	--	--	--	--	--	--	--	--	--	--	--	--	--	--	--	--	--	--	--	--	--	--	--	--	--	--	--	--	--	--	--	--	--	--	--	--	--	--	--	--	--	--	--	--	--	--	--	--	--	--	--	--	--	--	--	--	--	--	--	--	--	--	--	--	--	--	--	--	--	--	--	--	--	--	--	--	--	--	--	--	--	--	--	--	--	--	--	--	--	--	--	--	--	--	--	--	--	--	--	--	--	--	--	--	--	--	--	--	--	--	--	--	--	--	--	--	--	--	--	--	--	--	--	--	--	--	--	--	--	--	--	--	--	--	--	--	--	--	--	--	--	--	--	--	--	--	--	--	--	--	--	--	--	--	--	--	--	--	--	--	--	--	--	--	--	--	--	--	--	--	--	--	--	--	--	--	--	--	--	--	--	--	--	--	--	--	--	--	--	--	--	--	--	--	--	--	--	--	--	--	--	--	--	--	--	--	--	--	--	--	--	--	--	--	--	--	--	--	--	--	--	--	--	--	--	--	--	--	--	--	--	--	--	--	--	--	--	--	--	--	--	--	--	--	--	--	--	--	--	--	--	--	--	--	--	--	--	--	--	--	--	--	--	--	--	--	--	--	--	--	--	--	--	--	--	--	--	--	--	--	--	--	--	--	--	--	--	--	--	--	--	--	--	--	--	--	--	--	--	--	--	--	--	--	--	--	--	--	--	--	--	--	--	--	--	--	--	--	--	--	--	--	--	--	--	--	--	--	--	--	--	--	--	--	--	--	--	--	--	--	--	--	--	--	--	--	--	--	--	--	--	--	--	--	--	--	--	--	--	--	--	--	--	--	--	--	--	--	--	--	--	--	--	--	--	--	--	--	--	--	--	--	--	--	--	--	--	--	--	--	--	--	--	--	--	--	--	--	--	--	--	--	--	--	--	--

SCANNED BY
PLANNING

CURVE TABLE					
CURVE	DELTA	RADIUS	LENGTH	TANGENT	CHORD DIRECTION
C1	90°03'52"	25.00	39.30	25.03	N31°04'12"W
C2	90°00'00"	25.00	39.27	25.00	N58°57'44"E
C3	95°14'11"	25.00	41.55	27.40	N33°43'14"W

QUARTER POINTS

C1	PTS	FL. ELEV.
C1	1	5005.35
	2	5005.17
	3	5004.98

C2	PTS	FL. ELEV.
C2	1	5005.99
	2	5006.18
	3	5006.36

C3	PTS	FL. ELEV.
C3	1	5009.23
	2	5009.05
	3	5008.86

LEGEND

- PROPOSED STRIPING
- PROPOSED CURB & GUTTER
- PROPOSED SIDEWALK
- EXISTING SAS MANHOLE
- EXISTING SD MANHOLE
- EXISTING GATE VALVE
- EXISTING FIRE HYDRANT
- EXISTING STORM DROP INLET
- EXISTING WATER METER
- EXISTING TURN ARROW
- EXISTING POWER POLE
- EXISTING STIPING
- EXISTING CURB & GUTTER
- BOUNDARY LINE

NOTES:

- CONTRACTOR SHALL VERIFY PERMANENT PAVEMENT LOCATION AND COORDINATE WITH PROJECT ENGINEER
- CONTRACTOR SHALL VERIFY THE LOCATION OF ALL EXISTING MH, FH, WM, AND GATE VALVES AND ADJUST TO MATCH NEW GRADE.
- ALL DIMENSIONS ARE TO FACE CURB UNLESS OTHERWISE NOTED.
- SEE SHEET 3 FOR TYPICAL STREET SECTIONS AND STRIPING DETAILS.

SAWCUT EXISTING ASPHALT AND REPLACE W/PERMANENT PAVEMENT SEE CITY PROJECT NUMBER 745681 SEE SHEET 3 OF 3

KEYED NOTES:

- NEW 6" VALLEY GUTTER PER C.O.A. STANDARD DRAWING #2420.
- STANDARD CURB AND GUTTER PER C.O.A. STD. DWG. #2415A.
- EDGE OF EXISTING ASPHALT.
- NEW 6" SIDEWALK PER C.O.A. STD. DWG. #2430.
- NEW DRIVE WAY ENTRANCE PER C.O.A. STD. DWG. #2426.
- EXISTING POWER POLE. PROVIDE PEDESTRIAN CLEARANCE SEE C.O.A. DWG # 2431
- UNI-DIRECTIONAL HC RAMP PER C.O.A. #2426, INCLUDE TRUNCATED DOMES. (DETECTED WARNING SURFACES) -DESIGN PER ADA GUIDELINES. -SUBMIT SPEC'S TO C.O.A. CONSTRUCTION ENGINEER FOR EVALUATION PRIOR TO CONSTRUCTION.
- EXISTING WATER METER. REMOVE AND REPLACE WITH NEW METER BOX PER COA DWG 2363.
- EXISTING FIRE HYDRANT, PROVIDE PEDESTRIAN CLEARANCE SEE C.O.A. DWG # 2431
- EXISTING DRIVE PAD TO BE REMOVED.
- PROVIDE 3' WIDE (MIN.) PEDESTRIAN CROSSING WITH 2% CROSS SLOPE TOWARD CURB & GUTTER.
- 3.5' ROADWAY EASEMENT GRANTED TO THE CITY OF ALBUQUERQUE DOC. # 2007050506 BOOK A135, PAGE 407, RECORDED ON 04/04/2007.

SCALE: HORIZ. 1"=50'
VERT. 1"= 5'

ELEVATIONS ARE NAD 1929

EDITH BOULEVARD

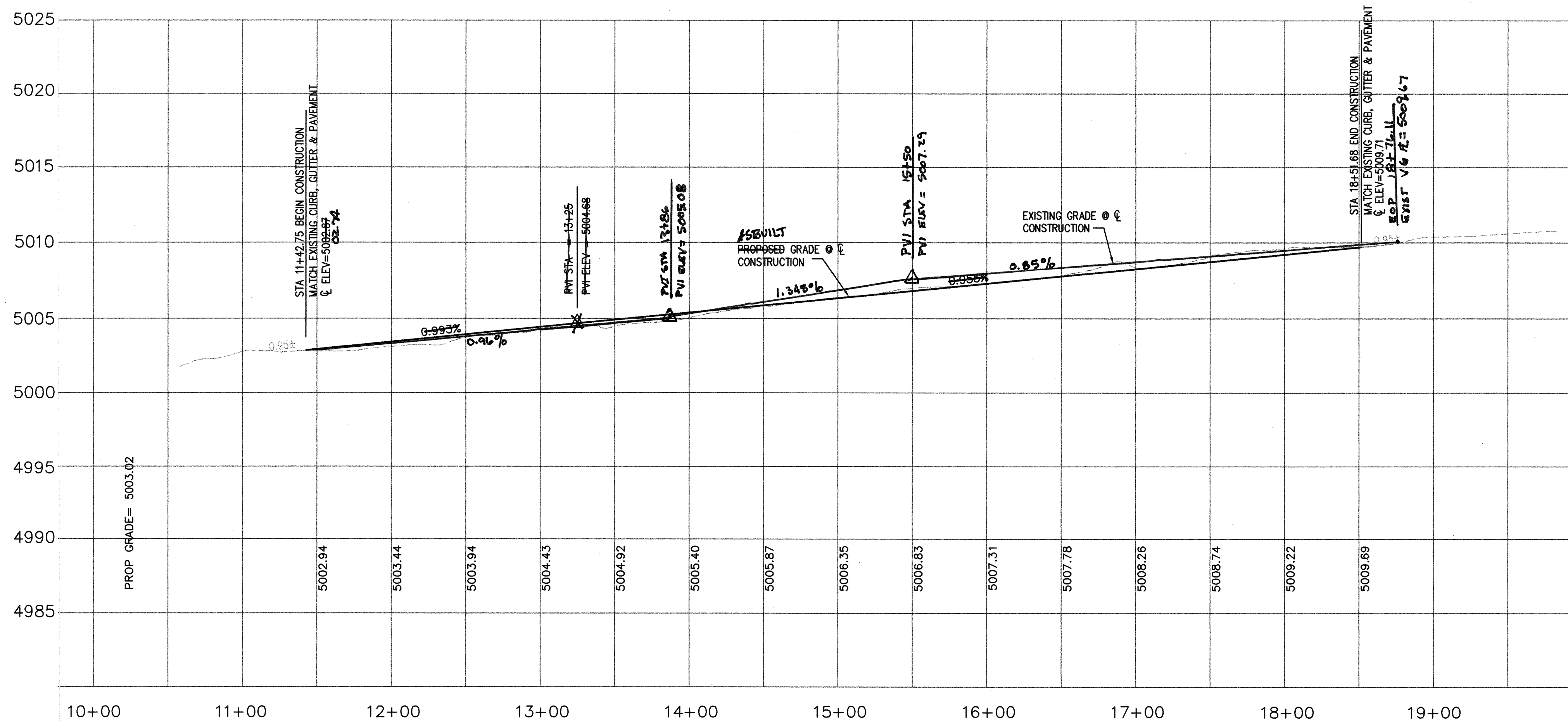

CITY OF ALBUQUERQUE PUBLIC WORKS DEPARTMENT ENGINEERING GROUP	
TITLE: EDITH AND OSUNA PAVING IMPROVEMENTS	
DESIGN REVIEW COMMITTEE APPROVE JAN 10 2008 DESIGN REVIEW COMMITTEE	CITY ENGINEER APPROVAL APPROVE APR 17 2008 CITY ENGINEER
LAST DESIGN UPDATE	MO./DAY/YR. MO./DAY/YR.
CITY PROJECT NO. 745684	ZONE MAP NO. E-15-Z
SHEET 2 OF 3	DATE 03-07 DATE 03-07 DATE 03-07

DRAWING: 200458-P&P-UTL DATE: 3-20-07

SCANNED BY PLANNING

OSUNA ROAD NE
(60.00' R.O.W.)

EDITH BLVD. NE.
(60.00' R.O.W.)

STRIPING PLAN EDITH BLVD.

DETAIL A
NTS

EDITH BLVD. TYPICAL SECTION
NTS
STA 11+42.75 TO 17+12.08
CITY PROJECT NUMBER 745681

EDITH BLVD. TYPICAL SECTION
NTS
STA 17+12.08 TO 18+51.68
CITY PROJECT NUMBER 745681

NOTES:

- ALL STRIPING TO BE THERMO PLASTIC REFLECTIVE TAPE.
- REMOVE ALL STRIPING FROM STA 11+27± TO STA 18+05±.
- STRIPING ERADICATION SHALL BE ACCOMPLISHED BY WATER BLASTING OR SURFACE PLANNING TO A MAXIMUM DEPTH OF 0.25 INCHES AND A WIDTH EQUAL TO TWO TIMES THE WIDTH OF THE STRIPE OR MARKING TO BE REMOVED.

SCALE: 1"=40'

ADVANCED ENGINEERING and CONSULTING, LLC
4416 ANAHEIM AVE. NE
ALBUQUERQUE, NEW MEXICO 87113
(505)899-5570

CITY OF ALBUQUERQUE PUBLIC WORKS DEPARTMENT ENGINEERING GROUP

EDITH AND OSUNA STRIPING IMPROVEMENTS

TITLE:
EDITH AND OSUNA STRIPING IMPROVEMENTS

DESIGN REVIEW COMMITTEE APPROVED JAN 10 2008
CITY ENGINEER APPROVED APR 17 2008

DESIGNED BY SB DATE 03-07
DRAWN BY ORO DATE 03-07
CHECKED BY SB DATE 03-07

DRAWING: 200458-P&P-STRIPE DATE: 3-20-07
CITY PROJECT NO. 745684 ZONE MAP NO. E-15-Z SHEET 3 OF 3

AS BUILT INFORMATION	
CONTRACTOR	7LC
WORK STAGED BY	Rex Vogler
ACCEPTANCE BY	Alvin By
FIELD CORRECTION BY	Rex Vogler
DRAWINGS CORRECTED BY	Alvin By
MICRO-FILM INFORMATION	
RECORDED BY	
NO.	

SURVEY INFORMATION	
DATE	
BY	
NO.	

ENGINEER'S SEAL	
SEAL	
BY	
REMARKS	
NO.	
DATE	
DESIGNED BY	SB
DRAWN BY	ORO
CHECKED BY	SB
DATE	03-07
DATE	03-07
DATE	03-07



SCALE: 1"=40'

ADVANCED
ENGINEERING
and CONSULTING, LLC

4416 ANAHEIM AVE., NE
ALBUQUERQUE, NEW MEXICO 87113
(505)899-5570

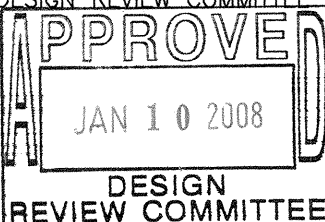
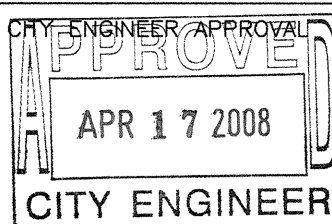
CITY OF ALBUQUERQUE PUBLIC WORKS DEPARTMENT ENGINEERING GROUP				
TITLE: EDITH AND OSUNA STRIPING IMPROVEMENTS				
DESIGN REVIEW COMMITTEE 		CITY ENGINEER APPROVAL 		LAST DESIGN UPDATE
		MO./DAY/YR.		MO./DAY/YR.
CITY PROJECT NO. 745684		ZONE MAP NO. F-15-7	SHEET 3	OF 3